

BENCH MARK
SW Cor. of cellar window sill coping, to Bldg.
SE Cor. Plum St & Curtis Ave. Elev. 32.50

NW COR. 20+53.3
20+500 W.F.E. 37.22

20+750 W.F.E. 37.36

0.072% W.F.E.

SW COR. 2+70.5
Alley
NW COR. 2+70.5

22+750 W.F.E. 39.30

23+000 W.F.E. 39.80
23+050 W.F.E. 39.82
SE COR.

LOCUST
ST
23+250 W.F.E. 39.60

SW COR. 23+01.63

23+21.23 NE COR
23+300 W.F.E. 39.55

NW COR. 23+43.7

23+750 W.F.E. 39.41

0.017% W.F.E.

SW COR. 24+57.6
Alley
NW COR. 24+70.5

SW COR. 25+66.1

OLMSTEAD ST.

NW COR. 25+10.8

SW COR. 27+14.2

Alley

NW COR. 27+34.1

0.017% W.F.E.

SW COR. 28+66.2

Sheet 4

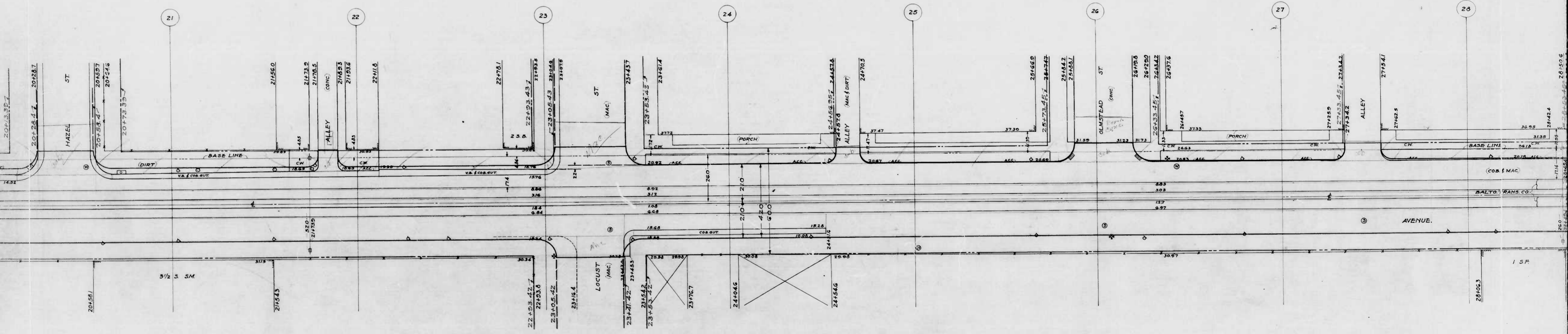

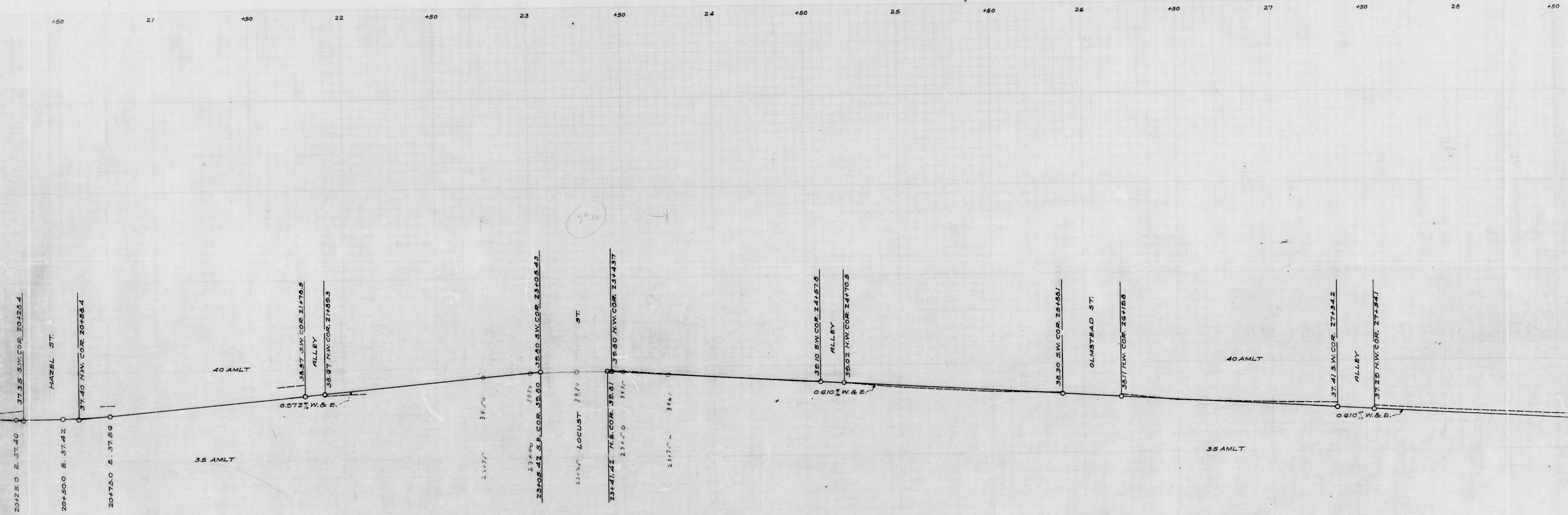

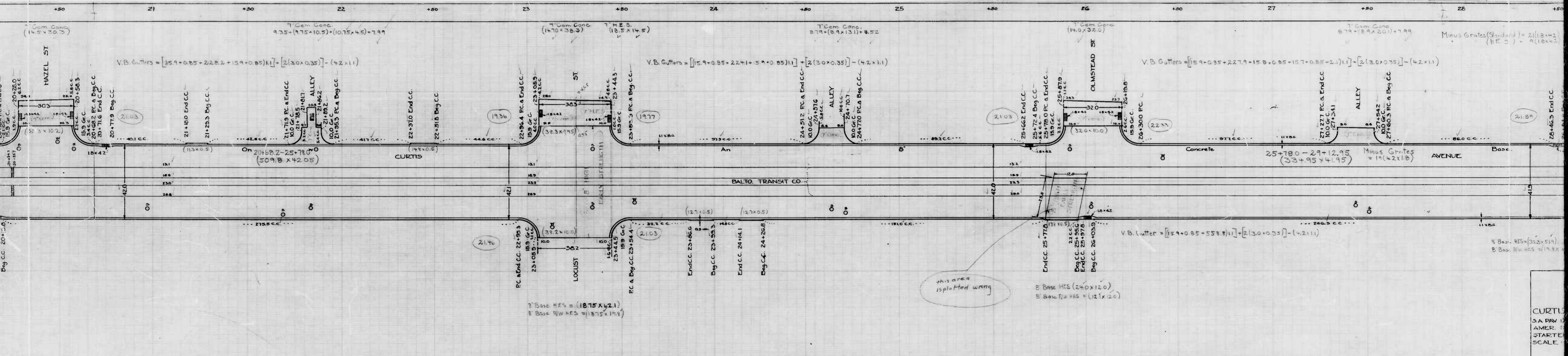

BENCH MARK
SW Cor of cellar window sill coping, to Bldg.
SE. cor Plum St & Curtis Ave. Elev. 36.59

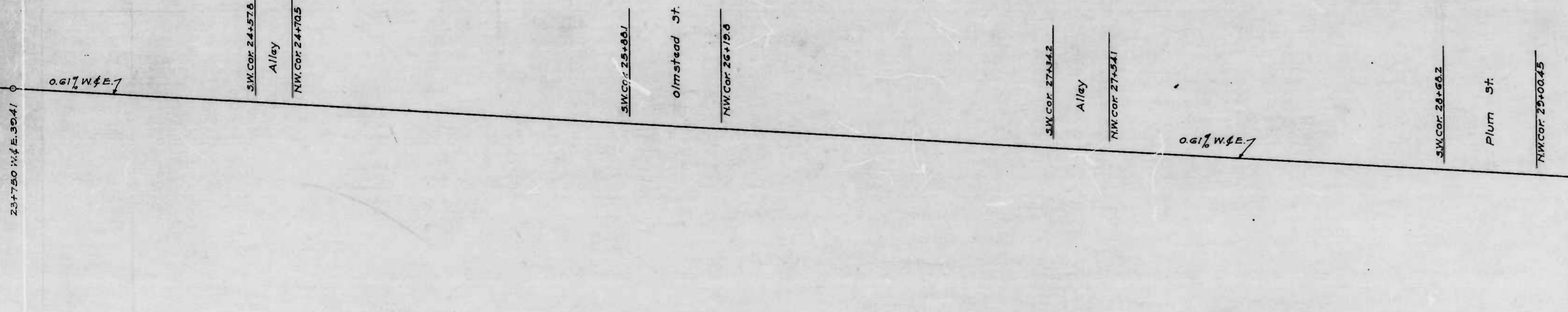

CITY OF BALTIMORE
DEPARTMENT OF PUBLIC WORKS
BUREAU OF HIGHWAYS
PROFILE OF RAILWAY TRACKS
CURTIS AVE. - BENHILL AVE. - PLUM ST.
CONT. No. 754
SCALE: HOR: 1" = 200' DATE: FEB. 27, 1942
VER: 1" = 2.0'

CORRECTED: _____ APPROVED: _____
Geo. S. Sapping *Geo. H. Carter*
 ASSOCIATE ENGINEER HIGHWAYS ENGINEER

Curtis Ave. - Benhill Ave. - Plum St.
TRACK GRADE
COLL. 12-1-33

Sheet 4

Sheet 5

24 +50 25 +50 26 +50 27 +50 28 +50 29

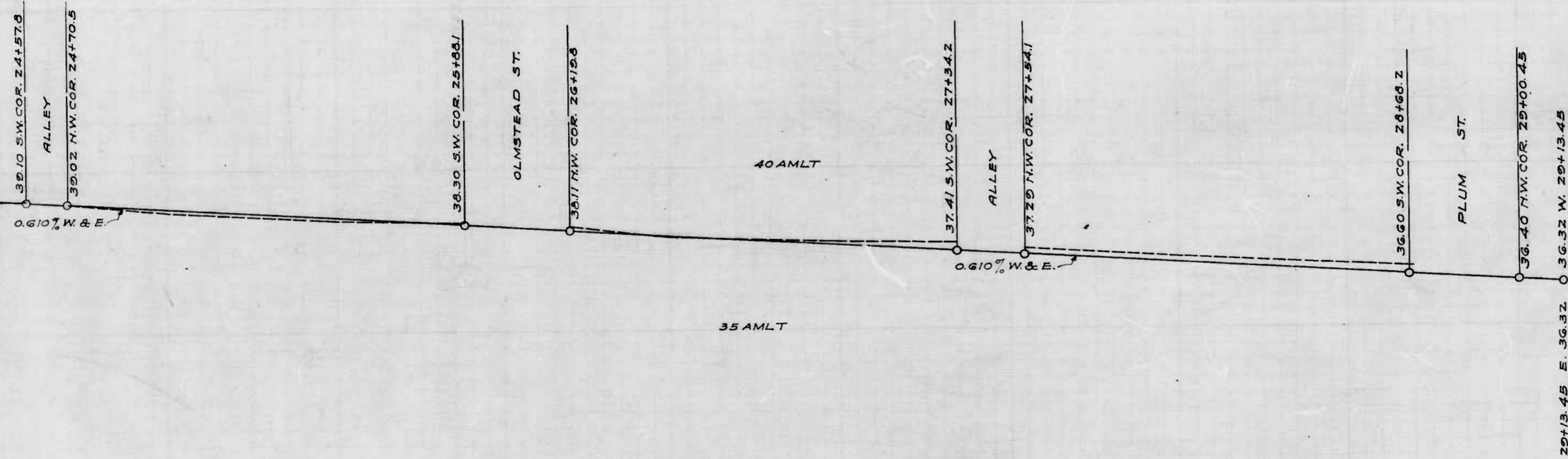

CITY OF BALTIMORE
 DEPARTMENT OF PUBLIC WORKS
 BUREAU OF HIGHWAYS
 PROFILE OF
 CURTIS AVE. - BENHILL AVE. - PLUM ST.
 CONT. NO. 754
 SCALE: HOR. - 1" = 200' DEC. 4, 1941
 VER. - 1" = 20' BOOK NO. X-146

APPROVED: APPROVED: CORRECT: APPROVED:

George Collis CHIEF ENGINEER ENGR. PLANS & SURVEYS
 Fred J. Gunning ASSOCIATE ENGINEER
 Geo. H. Carter HIGHWAYS ENGINEER

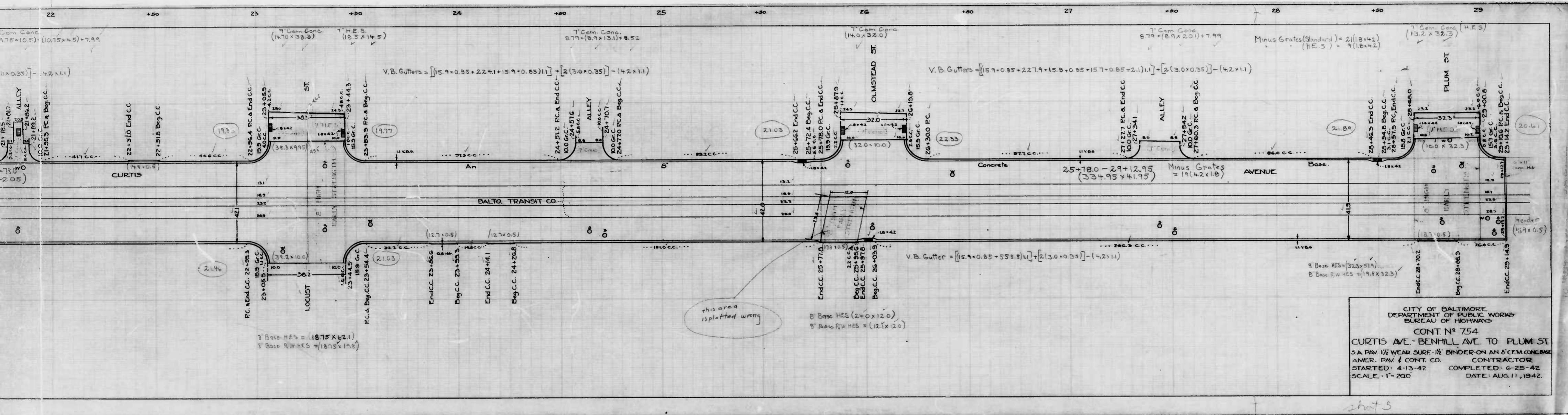

BENCH MARK
Int of bott step ent to restaurant, NW Cor.
Benhill & Curtis Ave. Elev. 41.03

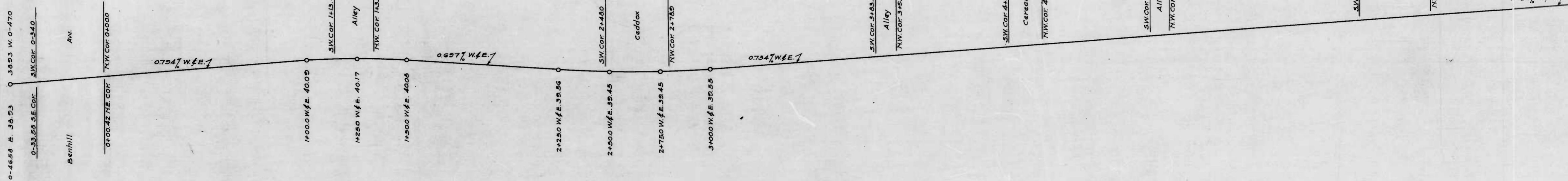

CONT. N754
TRACK GRADE
Curtis Ave. - Benhill Ave. - Plum St.

3

Sheet 1

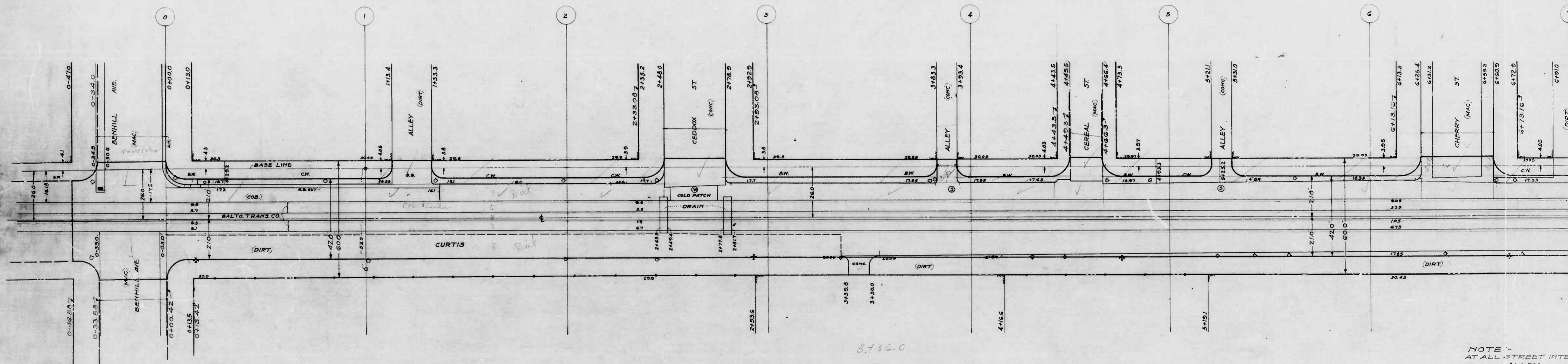

NOTE -
AT ALL STREET INTER
" " ALLEY "

DRAWN BY D. MURLEY
ENGINEER BY H. H. HENNING
SUPERVISOR IN CHARGE OF DIST.

1 sheet

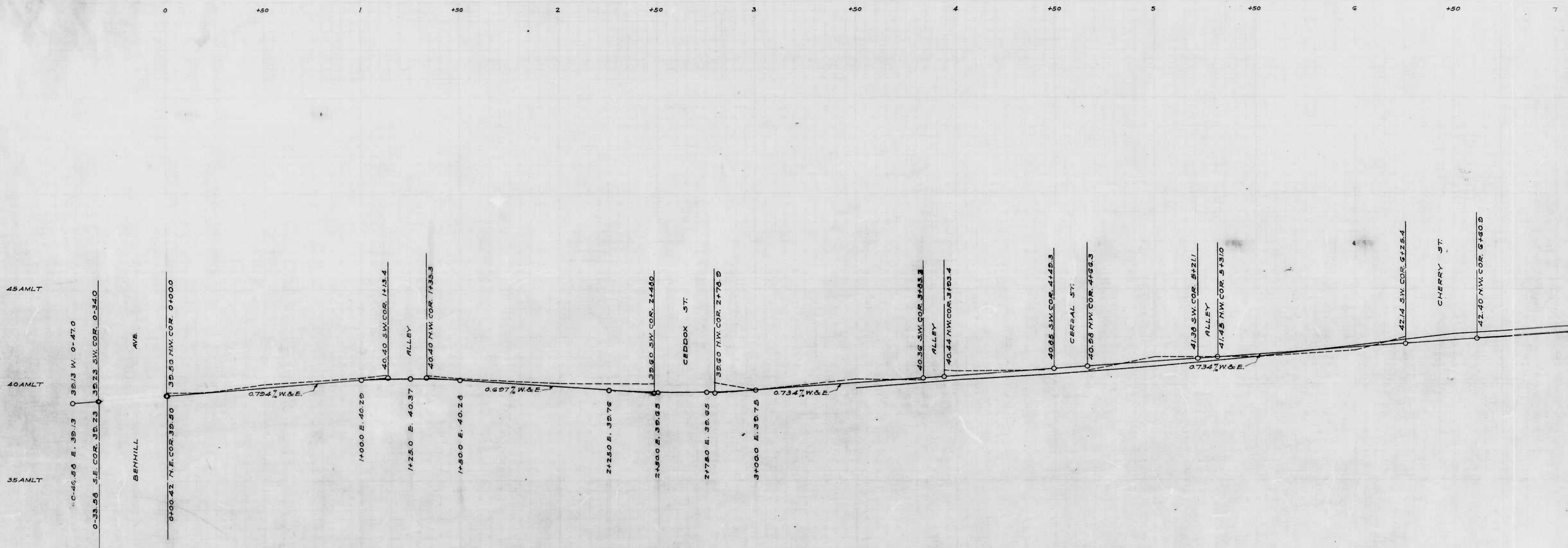

D. Marley
Hewenberg

(1)

754

RATIO - 24

No. 3

SW COR 6+254

Cherry St

NW COR 6+200

0.734% W.F.E.

SW COR 7+735

Alley

NW COR 7+835

6+750 W.F.E. 43.78

SW COR 8+053

5+000 W.F.E. 43.86

Church St

5+250 W.F.E. 43.93

NW COR 8+411

5+500 W.F.E. 43.90

5+750 W.F.E. 43.82

SW COR 10+532

Alley

NW COR 10+877

0.53% W.F.E.

11+750 W.F.E. 42.76

SW COR 11+863

Cypress St

12+000 W.F.E. 42.60

NW COR 12+203

12+250 W.F.E. 42.44

0.856% W.F.E.

SW COR 13+376

Alley

NW COR 13+520

shot 2

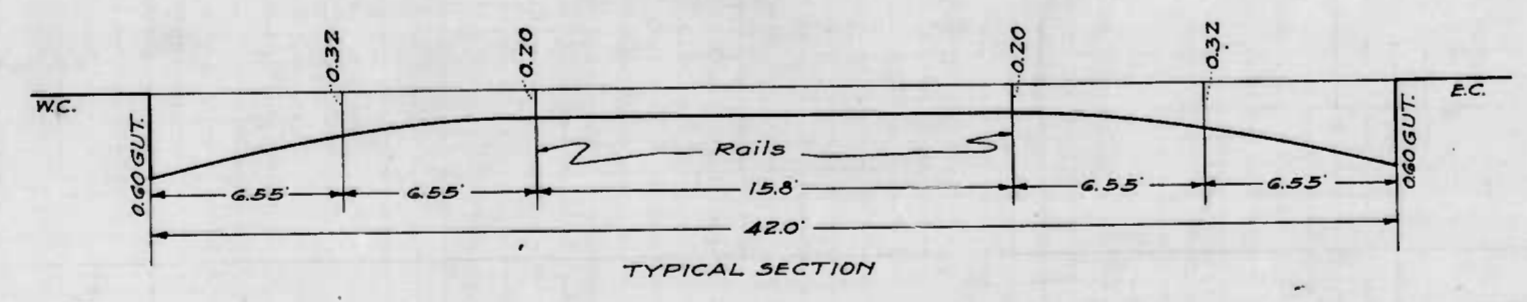
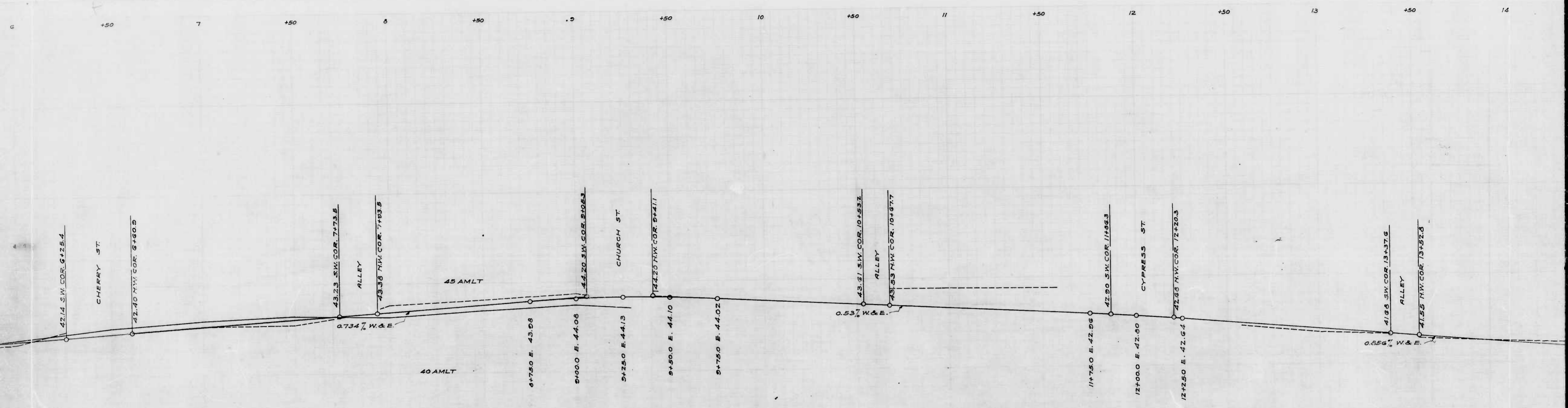

754

RATIO - 24

No.

3

BENCH MARK
SE Cor bot step ent. 45 22 Curtis Ave. Elev. 41.48

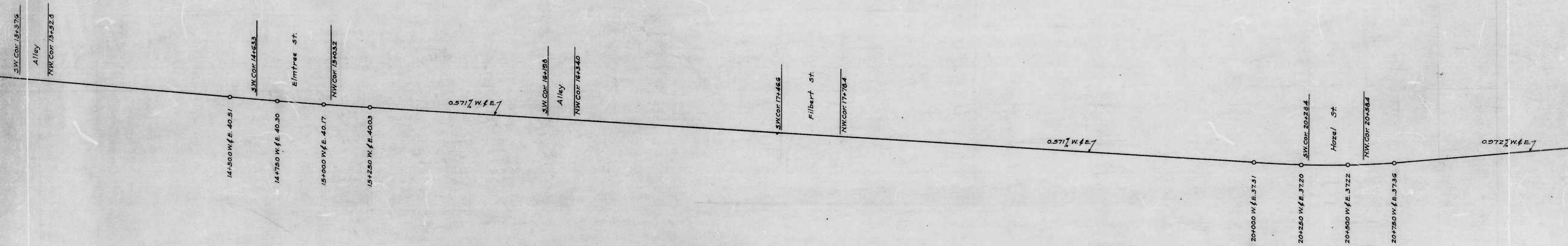

point 3

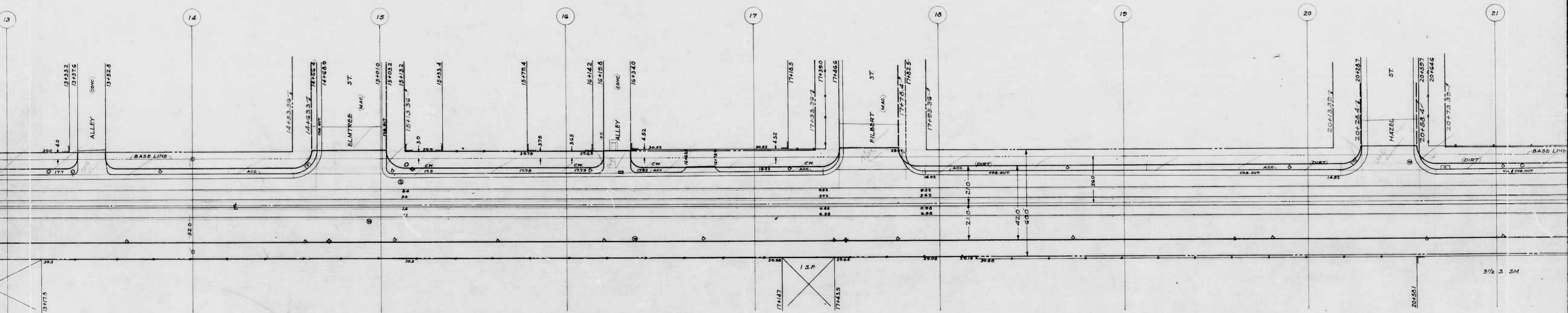

+50 14 +50 15 +50 16 +50 17 +50 18 +50 19 +50 20 +50 21

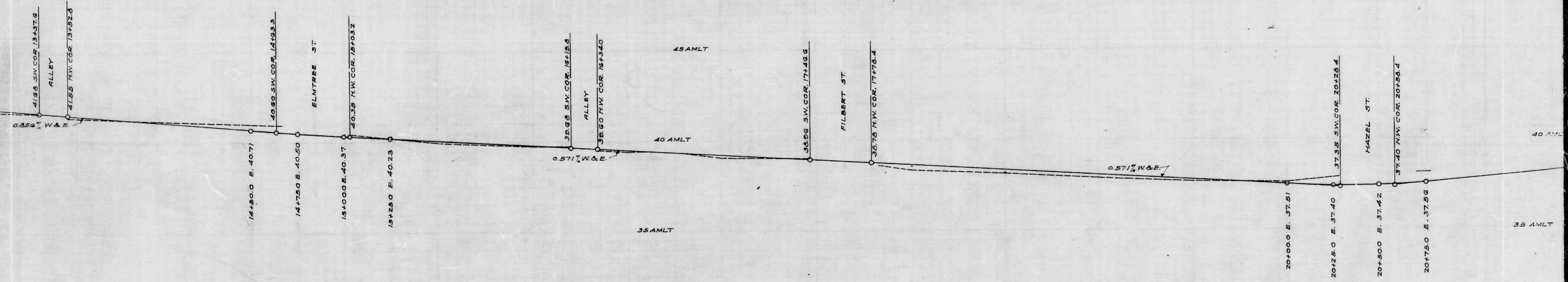

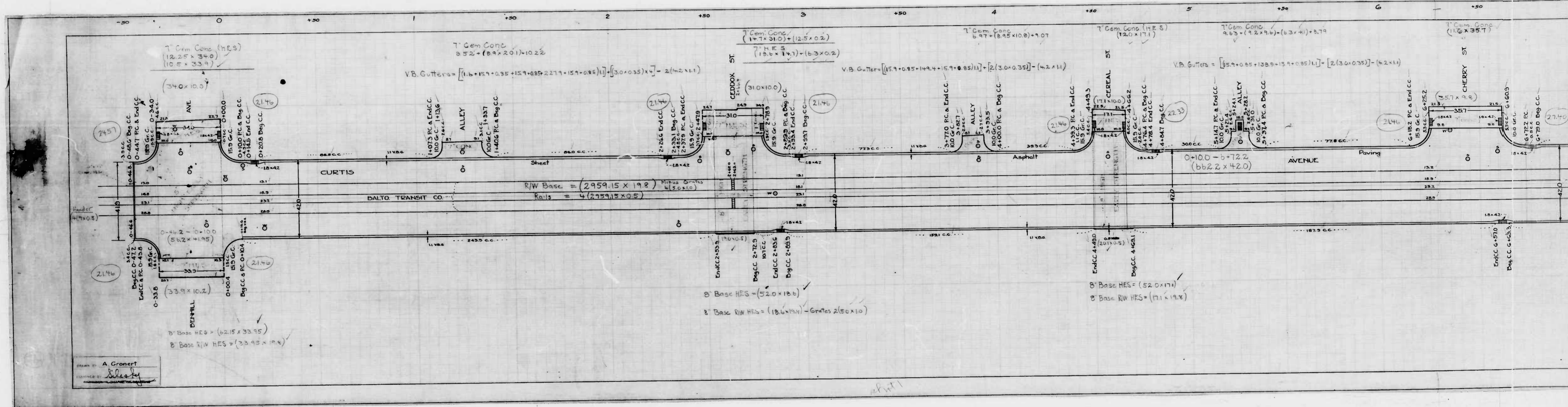

Drawn by: A. Cronert
 Checked by: [Signature]

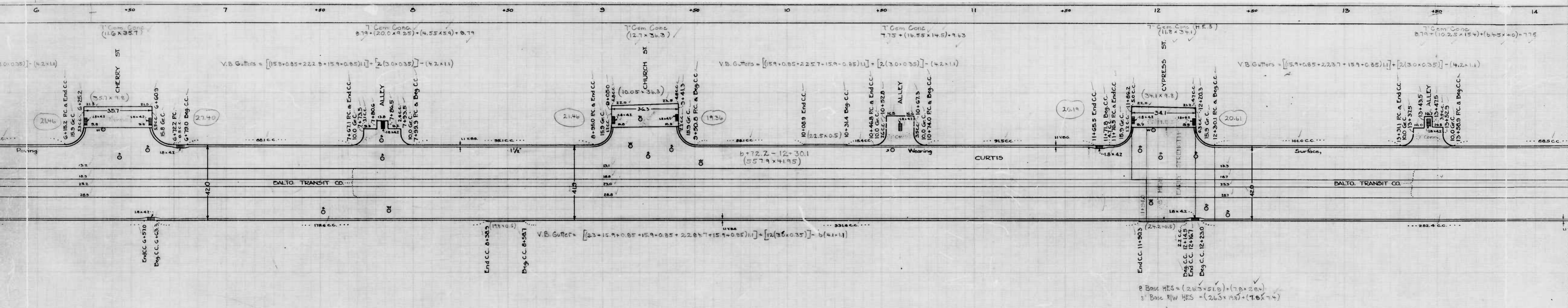

Sheet 1

Sheet 2

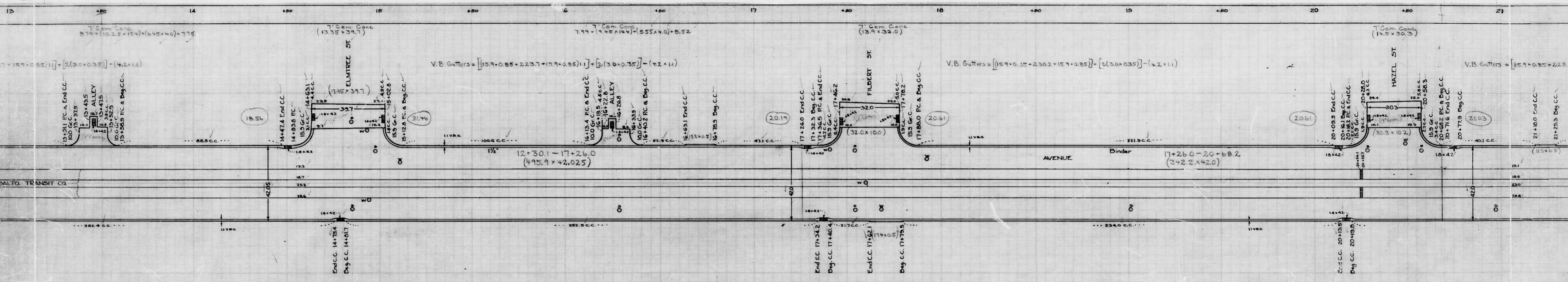

stwt 3