

CITY OF BALTIMORE  
 DEPARTMENT OF PUBLIC WORKS  
 BUREAU OF HIGHWAYS  
 PROFILE OF  
 LOCHWOOD RD.-FENWICK AVE.-WELBOURNE RD.  
 SCALE: HOR: 1" = 20' BOOK NO C-753  
 VER: 1" = 20' DATE: FEB. 25, 1942.  
 CONT. NO 753

CORRECT: *Frank J. ...*  
 ASSOCIATE ENGINEER

APPROVED: *Geo. H. Carter*  
 HIGHWAYS ENGINEER

APPROVED: *Edward ...*  
 ENGR. PEANS & SURVEYS

APPROVED: *George ...*  
 CHIEF ENGINEER

A. Gronert  
*Hilteberg*



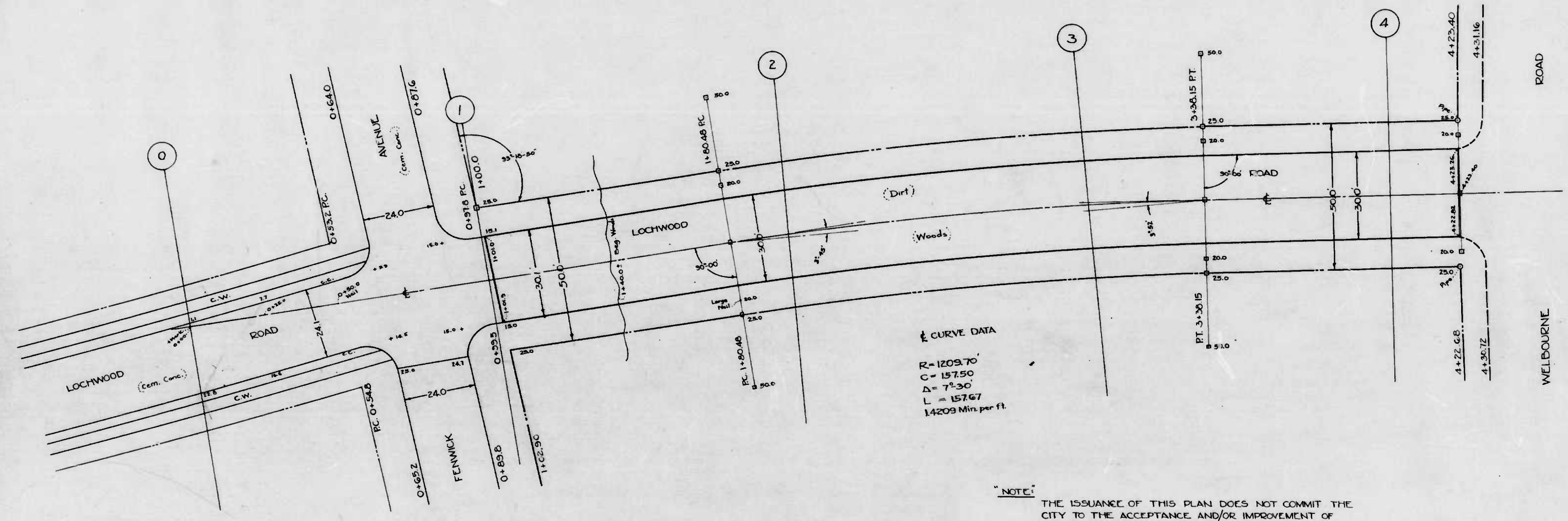

**NOTE:**  
 THE ISSUANCE OF THIS PLAN DOES NOT COMMIT THE CITY TO THE ACCEPTANCE AND/OR IMPROVEMENT OF ANY THOROUGHFARE SHOWN THEREON.

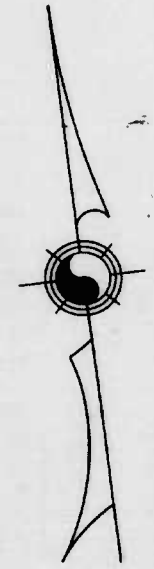

CITY OF BALTIMORE  
 DEPARTMENT OF PUBLIC WORKS  
 BUREAU OF HIGHWAYS  
 PLAN OF  
 LOCHWOOD RD.-FENWICK AVE.-WELBOURNE RD.  
 SCALE: 1"=200'  
 CONT. NO. 753  
 DATE: JAN. 26, 1942.

CORRECT:  
*Edmund Madson*  
 ASSOCIATE ENGINEER

APPROVED:  
*Geo. A. Carter*  
 HIGHWAYS ENGINEER

APPROVED:  
*Edmund Madson*  
 ENGR. PLANS & SURVEYS

APPROVED:  
*George A. Call*  
 CHIEF ENGINEER

A. Gronert  
*H. Weisberg*

*one sheet*



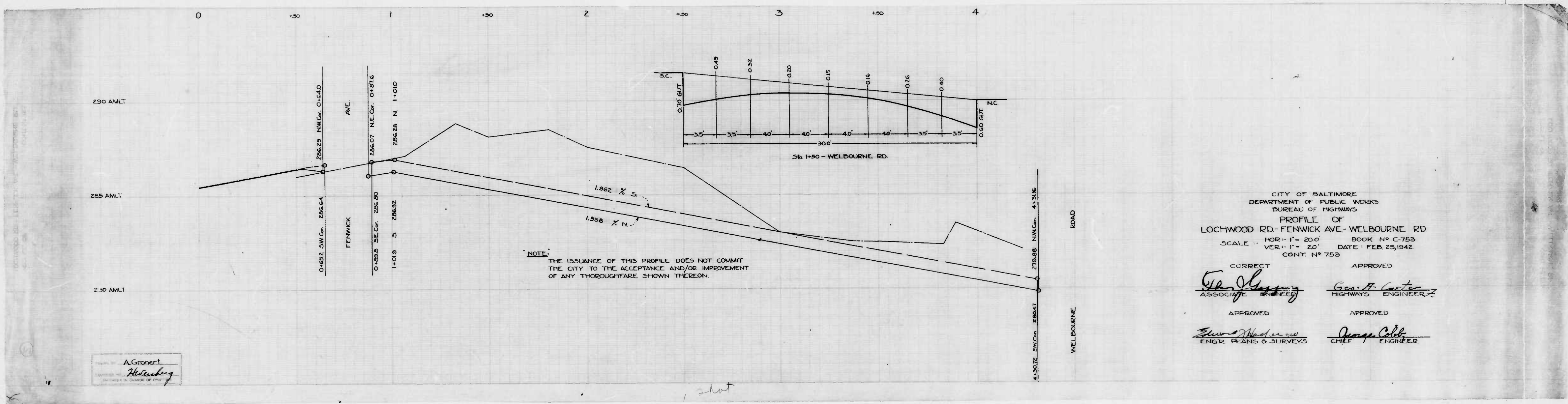

NOTE:  
 THE ISSUANCE OF THIS PROFILE DOES NOT COMMIT  
 THE CITY TO THE ACCEPTANCE AND/OR IMPROVEMENT  
 OF ANY THOROUGHFARE SHOWN THEREON.

CITY OF BALTIMORE  
 DEPARTMENT OF PUBLIC WORKS  
 BUREAU OF HIGHWAYS  
 PROFILE OF  
 LOCHWOOD RD - FENWICK AVE - WELBOURNE RD  
 HOR. 1" = 20' BOOK No. C-753  
 SCALE VER. 1" = 20' DATE: FEB. 25, 1942  
 CONT. No. 753

CORRECT APPROVED  
*Edw. J. [Signature]* *Geo. H. Carter*  
 ASSOCIATE ENGINEER HIGHWAYS ENGINEER  
 APPROVED APPROVED  
*Edward [Signature]* *George [Signature]*  
 ENGR. PLANS & SURVEYS CHIEF ENGINEER

A. Gronert  
*Handwritten Signature*



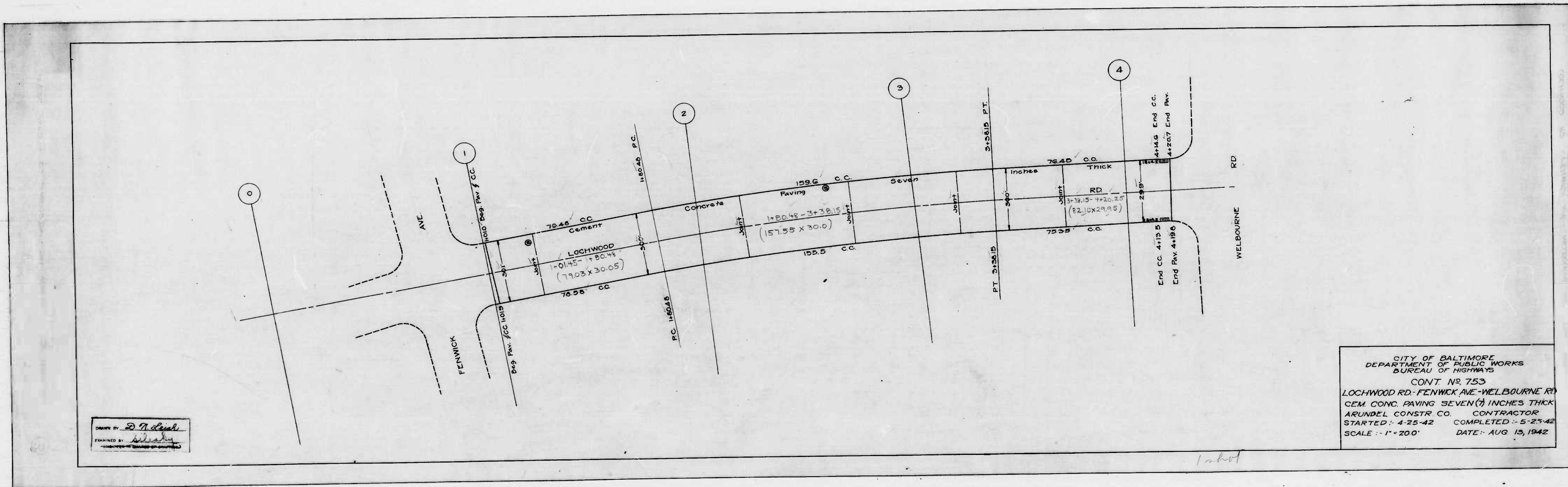

DRAWN BY *D. A. Walsh*  
 CHECKED BY *[Signature]*  
 APPROVED BY *[Signature]*

CITY OF BALTIMORE  
 DEPARTMENT OF PUBLIC WORKS  
 BUREAU OF HIGHWAYS  
 CONT. No. 753  
 LOCHWOOD RD - FENWICK AVE - WELBOURNE RD  
 CEM. CONC. PAVING SEVEN (7) INCHES THICK  
 ARUNDEL CONSTR. CO. CONTRACTOR  
 STARTED - 4-25-42 COMPLETED - 5-25-42  
 SCALE - 1" = 200' DATE - AUG 15, 1942





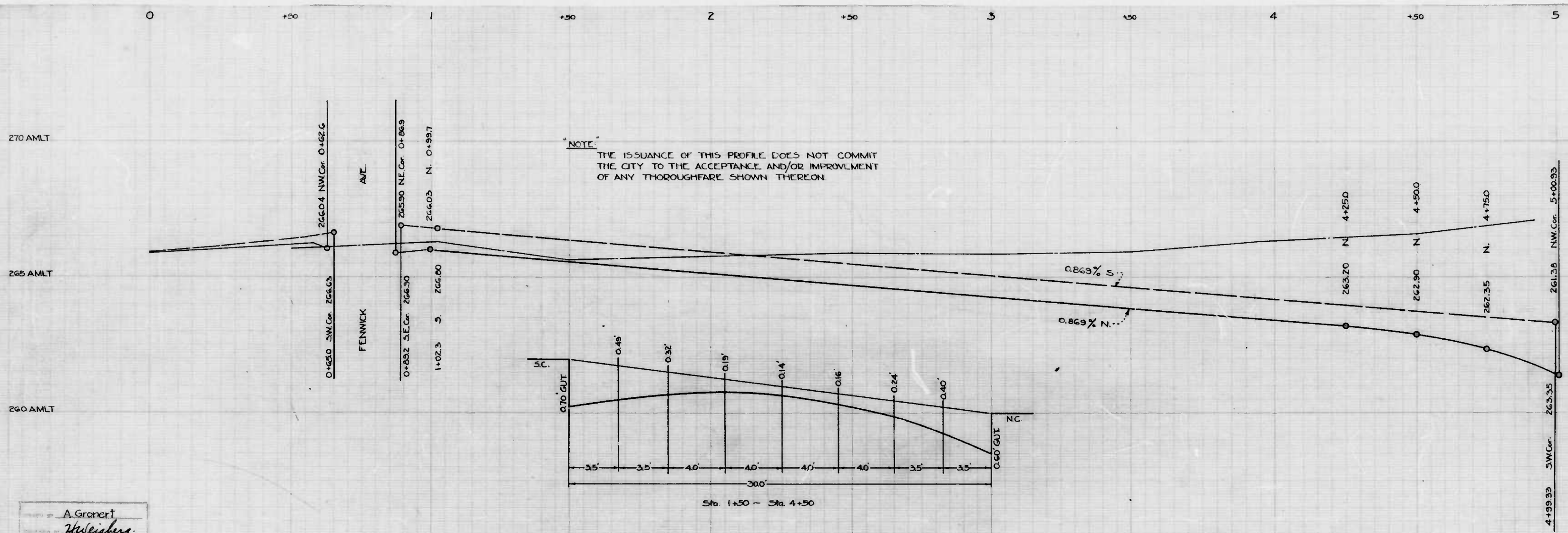

CITY OF BALTIMORE  
DEPARTMENT OF PUBLIC WORKS  
BUREAU OF HIGHWAYS  
PROFILE OF  
NORTHWICK ROAD-FENWICK AVE-WELBOURNE RD.  
SCALE - HOR. 1" = 20.0' BOOK N° C-753  
VER. 1" = 20' DATE: FEB 26, 1942  
CONT. N° 753

CORRECT APPROVED  
*Edw. J. Kasper* ASSOCIATE ENGINEER *Geo. H. Carter* HIGHWAYS ENGINEER  
APPROVED APPROVED  
*Edward J. Hines* ENGR. PLANS & SURVEYS *George C. Cole* CHIEF ENGINEER

A. Gronert  
*H. W. H. H. H.*



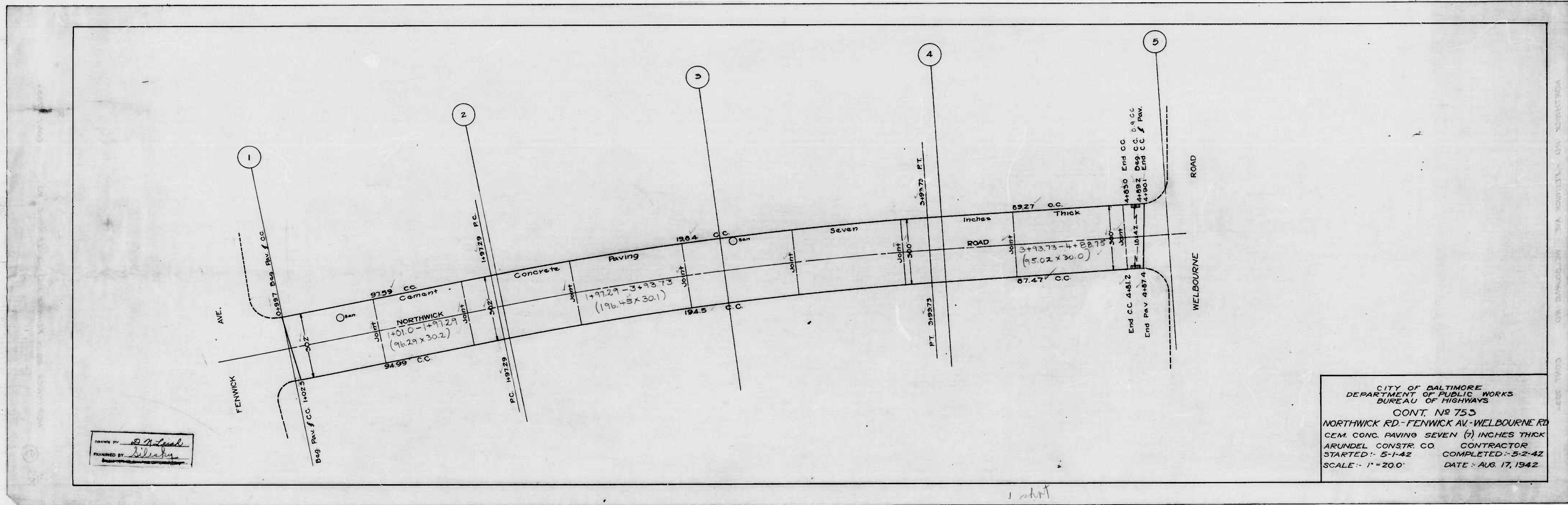





753

RATIO - 24 No.

7

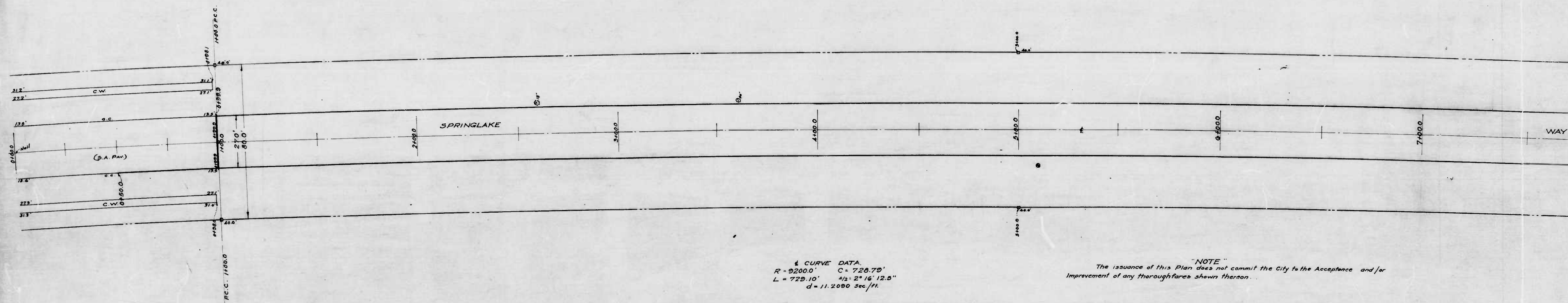

4 CURVE DATA  
 R = 9200.0' C = 720.70'  
 L = 720.10'  $\Delta/2 = 2^\circ 16' 12.5''$   
 d = 11.2000 Sec./ft.

ENGINEER  
*John H. Campbell*  
 ENGINEER IN CHARGE OF THE PROJECT

*one sheet*



0 +50 1 +50 2 +50 3 +50 4 +50 5 +50 6 +50 7 +50 +50

395 AMLT

390 AMLT

385 AMLT

380 AMLT

375 AMLT

370 AMLT

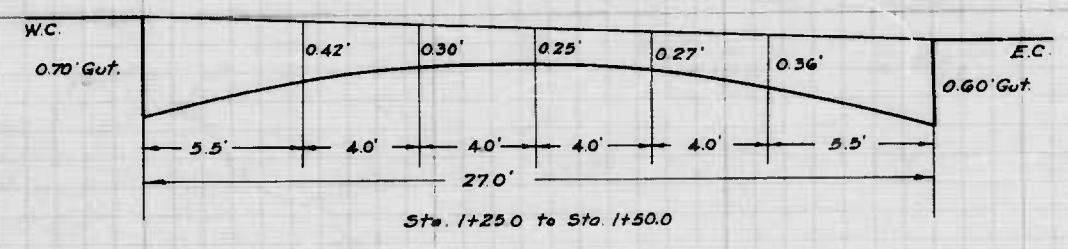

2.58% W 4E

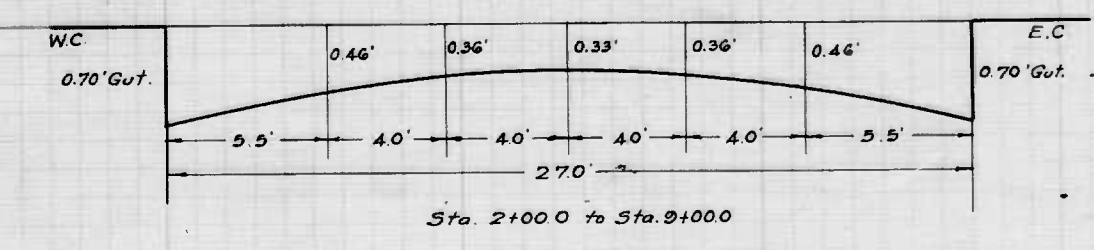

0+500 E. 372.42

0+750 E. 372.68

P.C.C. 1+000 E. 372.90

1+250 E. 373.25

1+500 E. 373.65

1+750 E. 374.15

2+000 E. 374.75

2+250 E. 375.41

373.18 W. 0+800

373.45 W. 1+250

373.80 W. 1+800

374.25 W. 1+750

374.80 W. 2+000

375.41 W. 2+250

Wm. H. Connel  
Helenberg  
REGISTERED IN CALIFORNIA

one sheet



753

RATIO - 24 No. 9

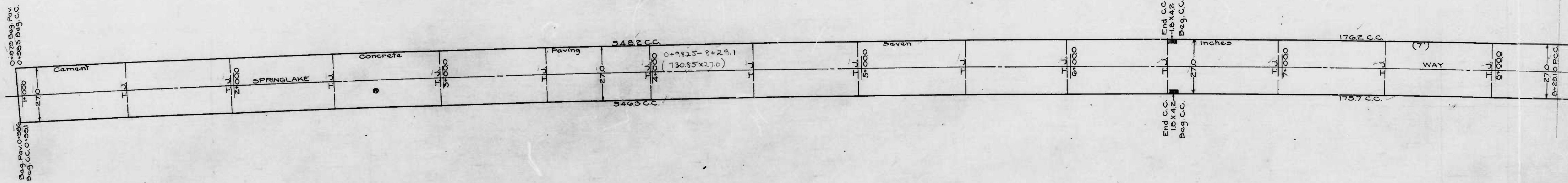

DRAWN BY J.G.F.  
CHECKED BY [Signature]  
DATE 10/1/51

ONE CHPT



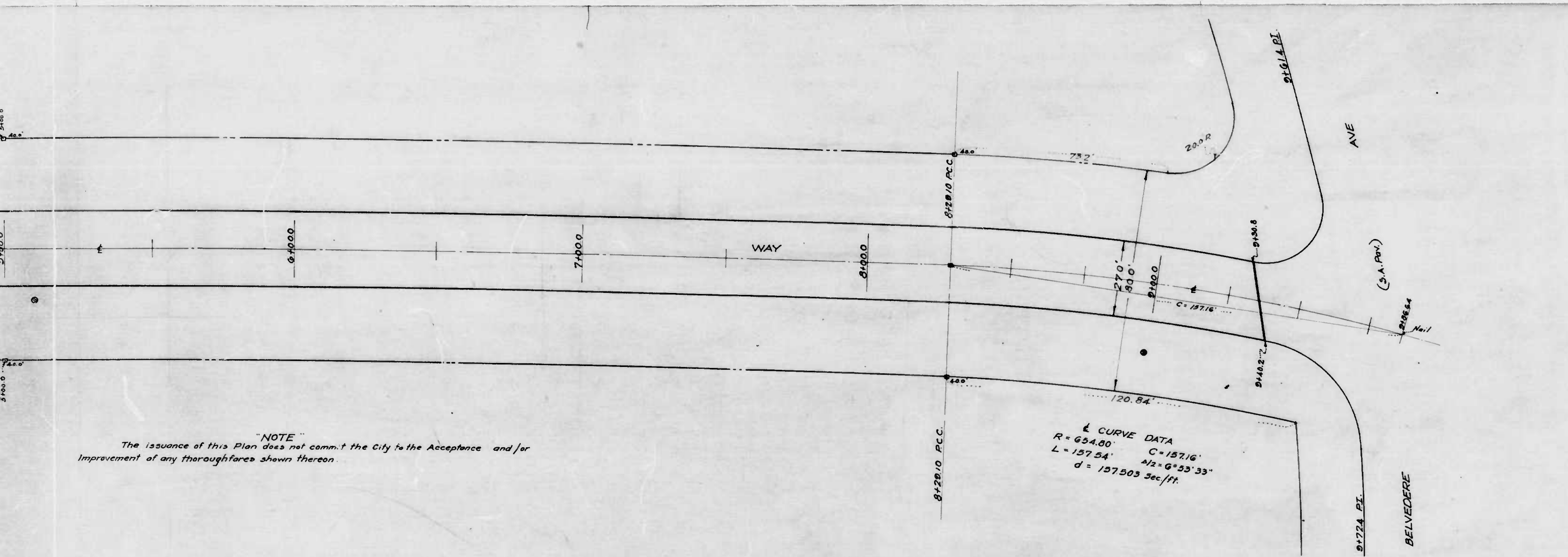

**"NOTE"**  
 The issuance of this Plan does not commit the City to the Acceptance and/or Improvement of any thoroughfares shown thereon.

**Curve Data**  
 R = 634.00' C = 157.16'  
 L = 157.54'  $\Delta/2 = 0^{\circ}53'33''$   
 d = 157.503 Sec/ft.

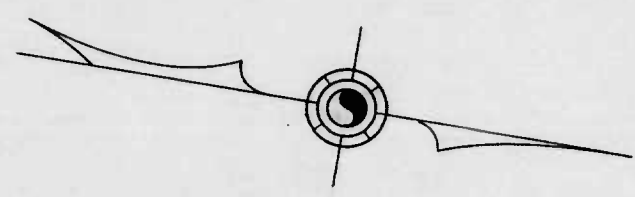

CITY OF BALTIMORE  
 DEPARTMENT OF PUBLIC WORKS  
 BUREAU OF HIGHWAYS  
 PLAN OF  
 SPRINGLAKE WAY - END OF PAVING - BELVEDERE AVE.  
 SCALE: 1" = 200' BOOK N° X-147 DATE: DEC. 14, 1941.  
 CONT. N° 753

CORRECT  
*Edward J. Hoehner*  
 ASSOCIATE ENGINEER  
 APPROVED  
 ENGR. PLANS & SURVEYS

APPROVED  
*Geo. H. Carter*  
 HIGHWAYS ENGINEER  
 APPROVED  
*Gene Colby*  
 CHIEF ENGINEER

2 sheets



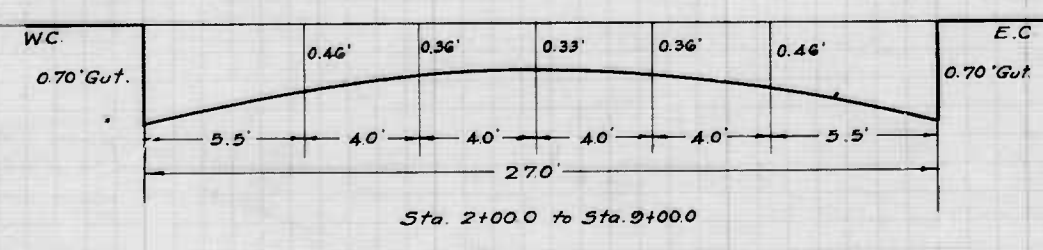
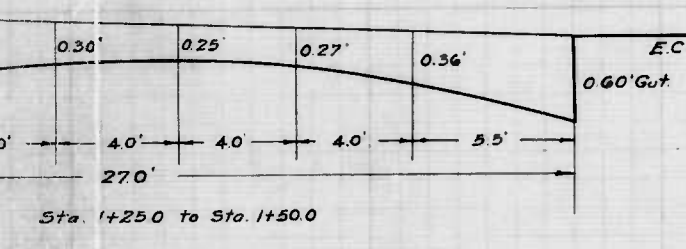
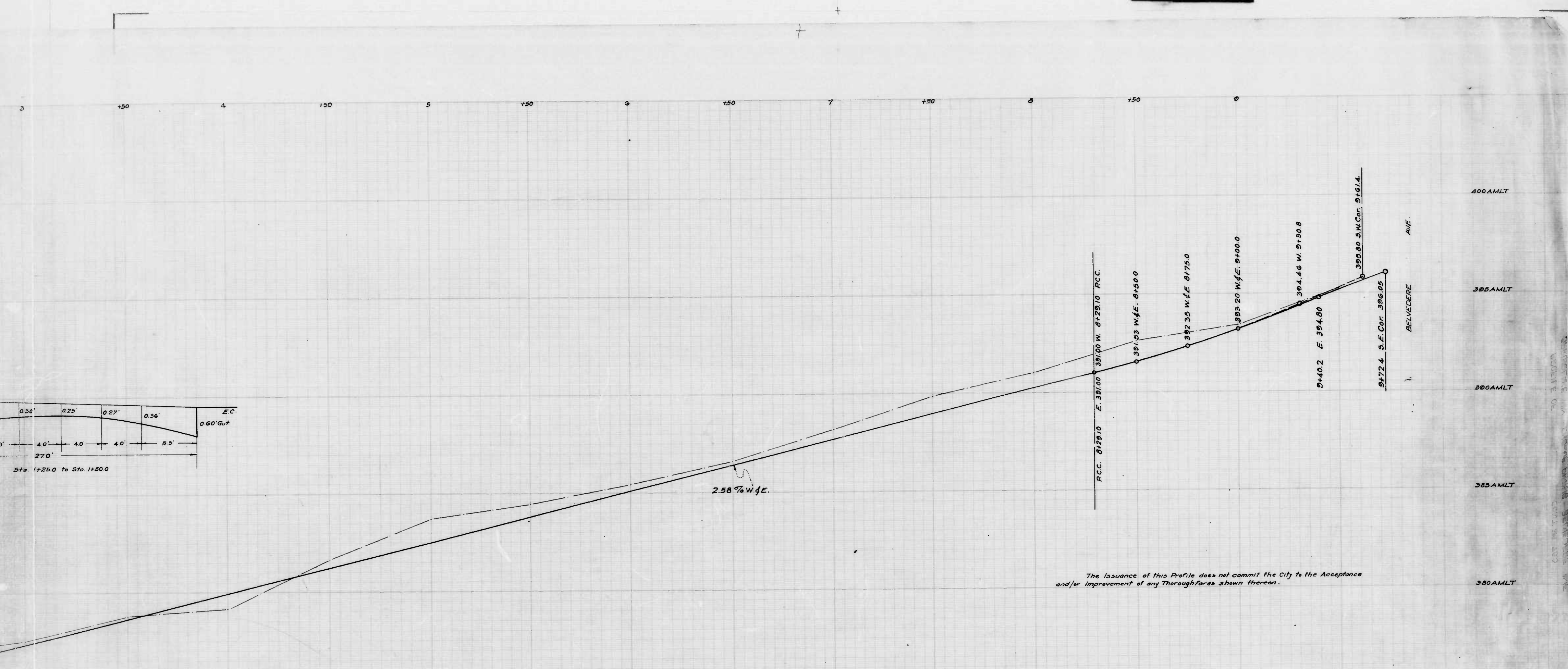

The issuance of this Profile does not commit the City to the Acceptance and/or Improvement of any Thoroughfares shown thereon.

CITY OF BALTIMORE  
 DEPARTMENT OF PUBLIC WORKS  
 BUREAU OF HIGHWAYS  
 PROFILE OF  
 SPRINGLAKE WAY-END OF PAVING-BELVEDERE AVE  
 SCALE: HOR: 1" = 20.0' VER: 1" = 2.0'  
 BOOK N° X-147 DATE: DEC. 16, 1941.  
 CONT N° 753

CORRECT  
*Edw. J. Sweeney*  
 ASSOCIATE ENGINEER  
 APPROVED

APPROVED  
*Geo. F. Carter*  
 HIGHWAYS ENGINEER  
 APPROVED

*Edward Flecker*  
 ENGR. PLANS & SURVEYS CAL.

*George Cobb*  
 CHIEF ENGINEER

one sheet







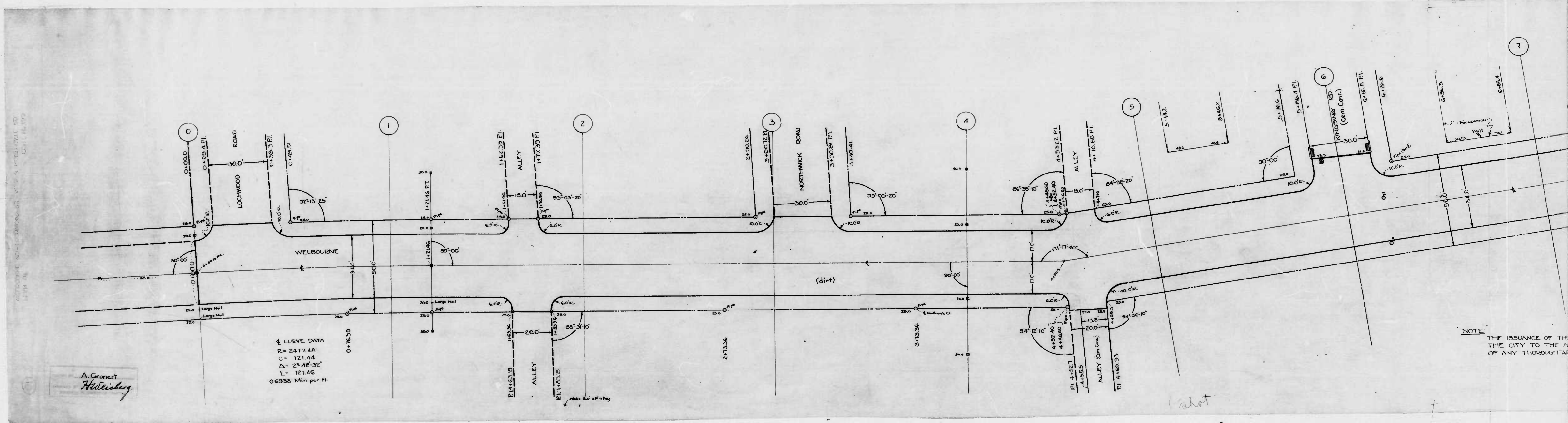

A. Gronert  
Hillsbury

shot



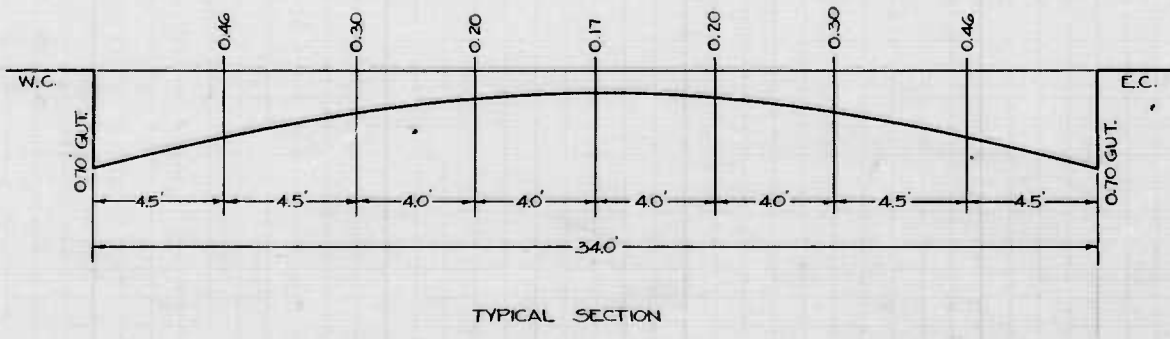
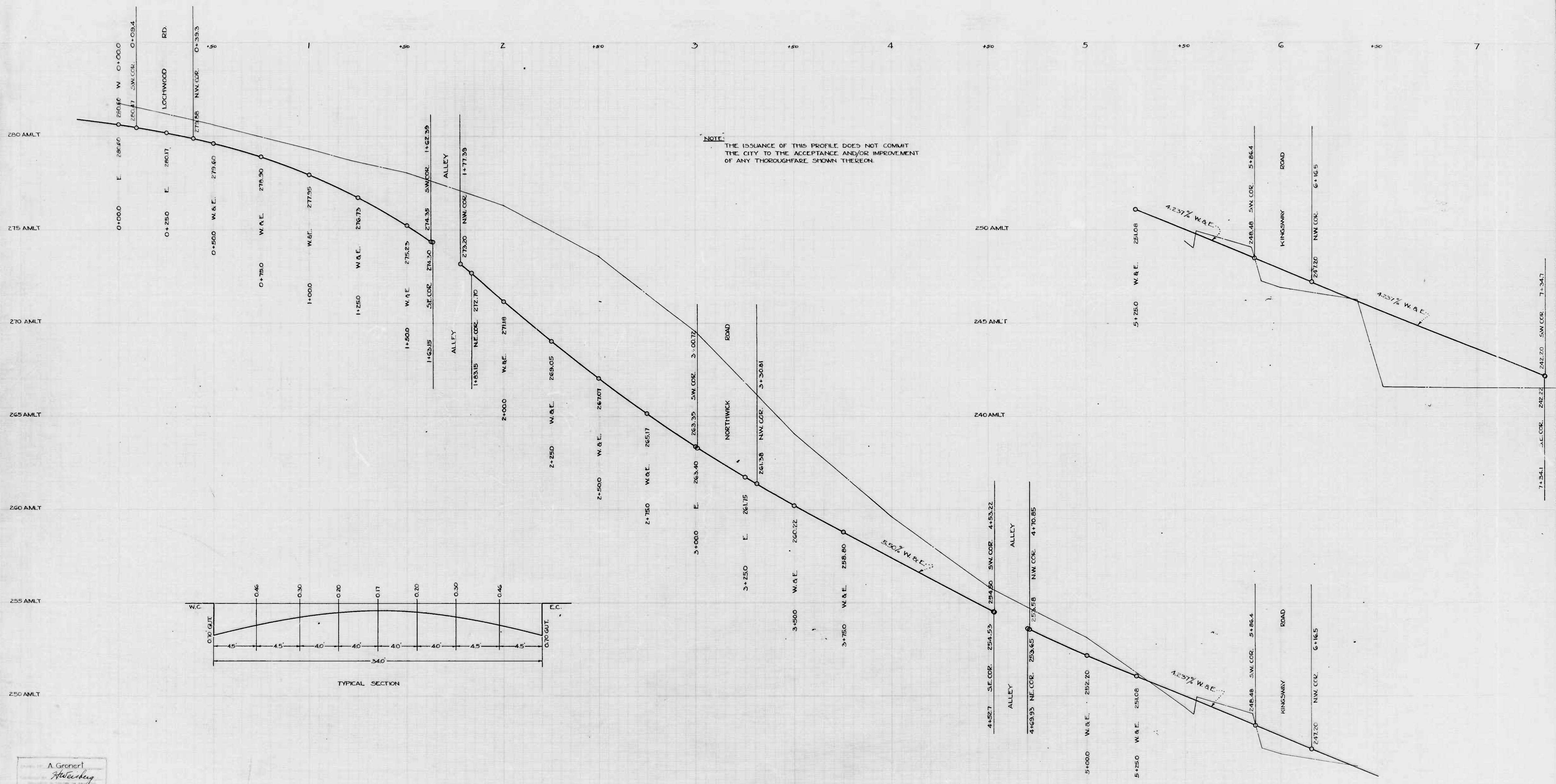

A. Gronert  
*Hawkey*

one sheet



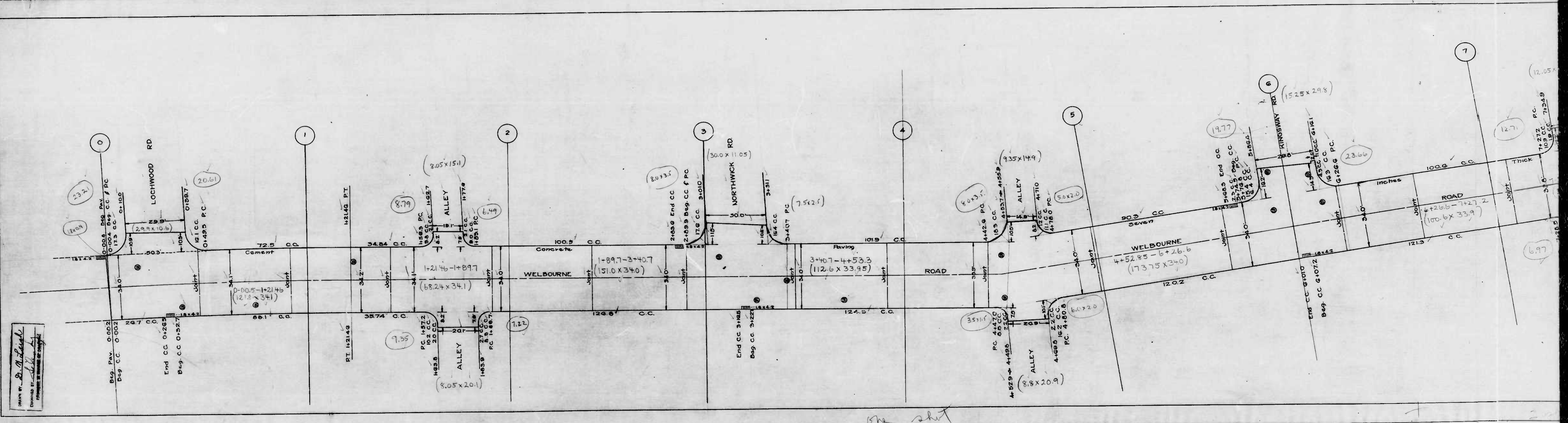

one sheet







NOTE: THE ISSUANCE OF THIS PROFILE DOES NOT COMMIT THE CITY TO THE ACCEPTANCE AND/OR IMPROVEMENT OF ANY THOROUGHFARE SHOWN THEREON.

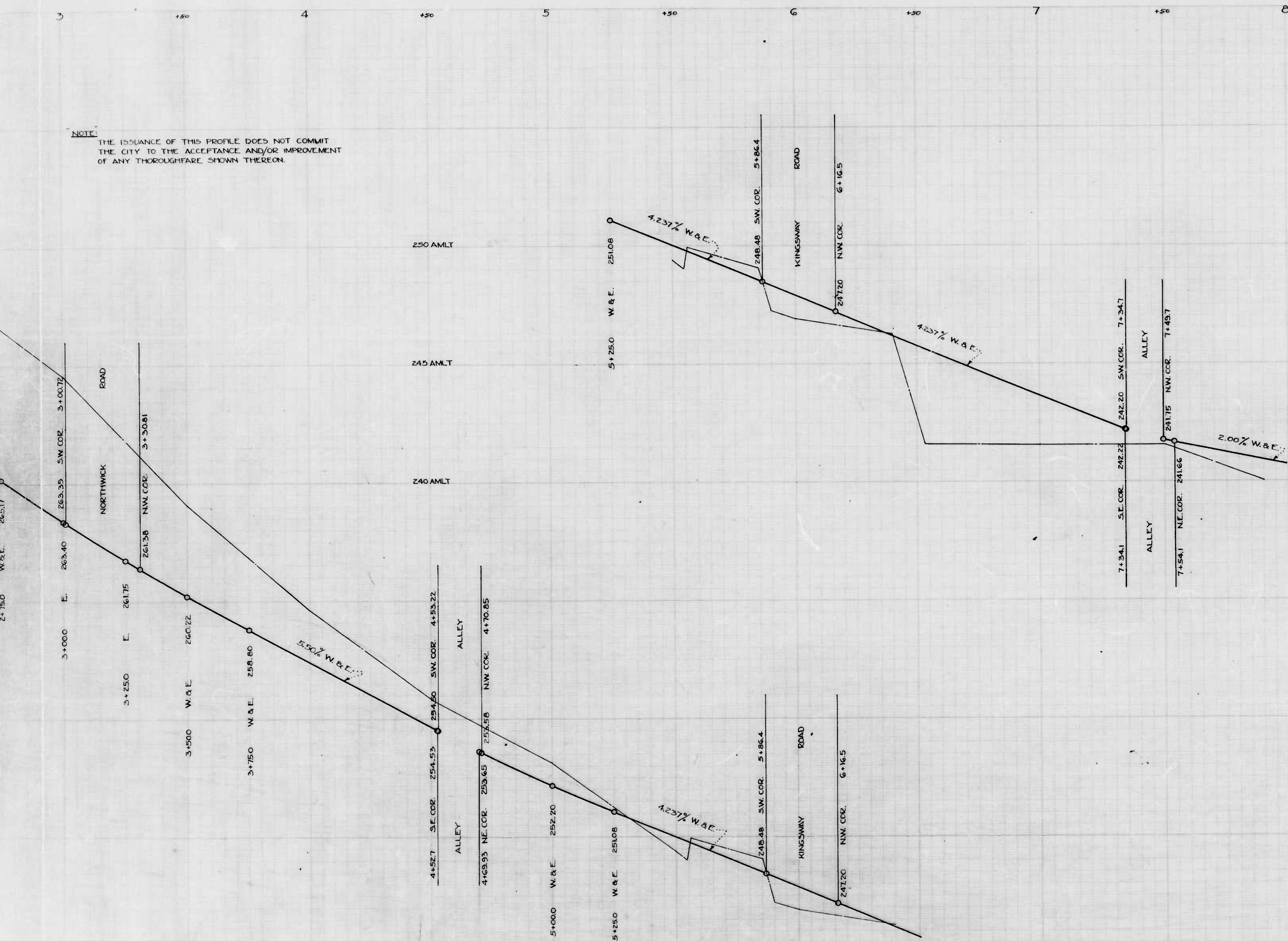

one shot

2 shots

CITY OF BALTIMORE  
 DEPARTMENT OF PUBLIC WORKS  
 BUREAU OF HIGHWAYS  
 PROFILE OF  
 WELBOURNE RD-LOCHWOOD RD-AL S of NORTHGATE RD.  
 SCALE: HOR: 1" = 200' BOOK NO C-753  
 VER: 1" = 20' DATE: MAR 6, 1942.  
 CONT. NO 753

CORRECT: *Edw J. [Signature]* ASSOCIATE ENGINEER  
 APPROVED: *George [Signature]* HIGHWAYS ENGINEER  
 APPROVED: *Edw J. [Signature]* ENGR. PLANS & SURVEYS  
 APPROVED: *George [Signature]* CHIEF ENGINEER



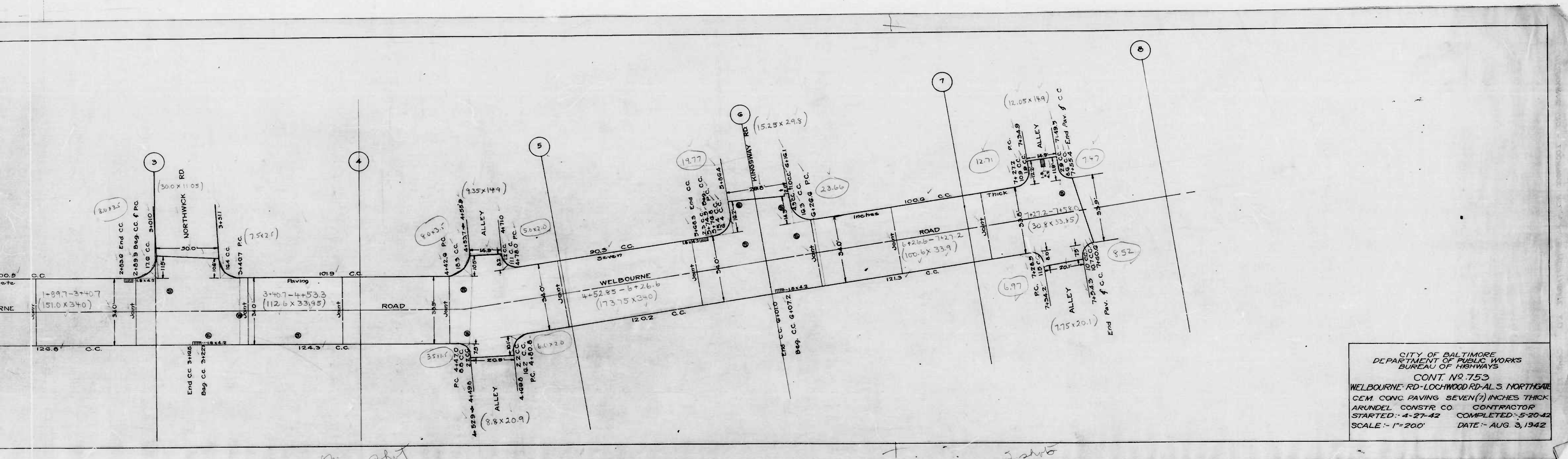

one shot

2 shot

CITY OF BALTIMORE  
 DEPARTMENT OF PUBLIC WORKS  
 BUREAU OF HIGHWAYS  
 CONT. No. 753  
 WELBOURNE RD-LOCHWOOD RD-ALS. NORTHGATE  
 CEM. CONC. PAVING SEVEN (7) INCHES THICK  
 ARUNDEL CONSTR. CO. CONTRACTOR  
 STARTED - 4-27-42 COMPLETED - 5-20-42  
 SCALE - 1"=200' DATE - AUG. 3, 1942



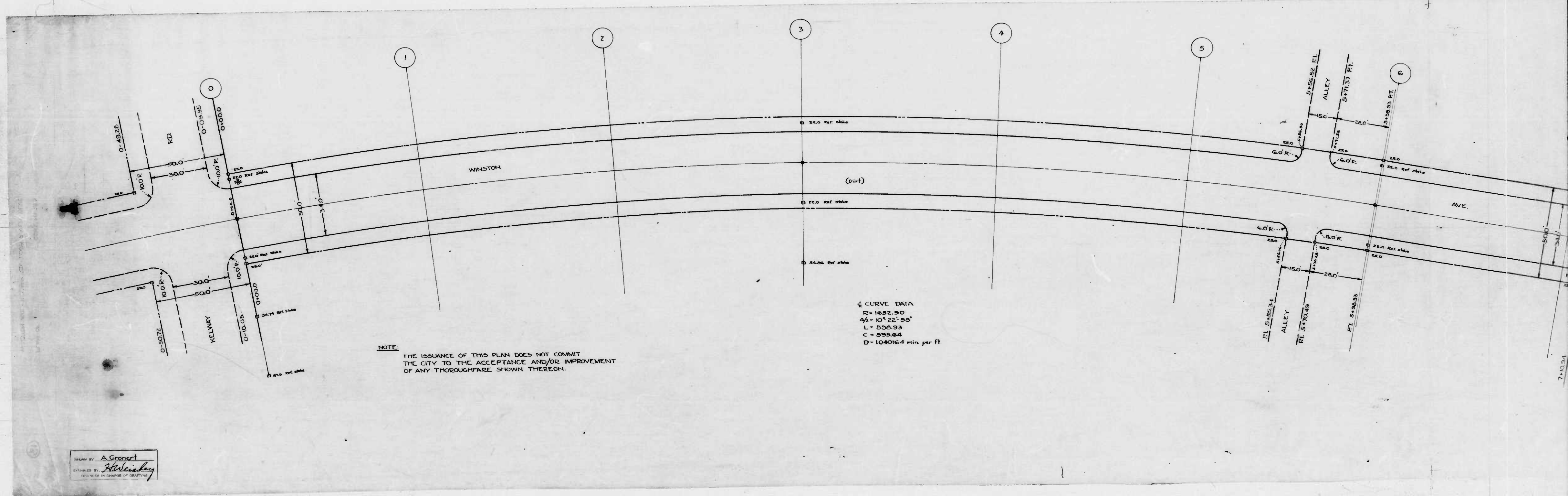



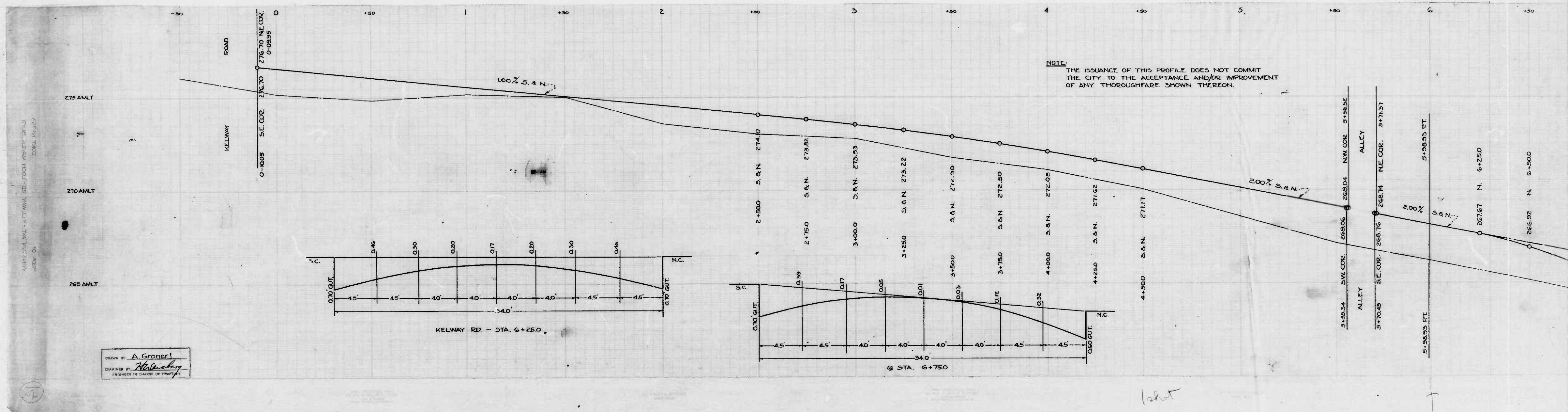

NOTE:  
THE ISSUANCE OF THIS PROFILE DOES NOT COMMIT  
THE CITY TO THE ACCEPTANCE AND/OR IMPROVEMENT  
OF ANY THOROUGHFARE SHOWN THEREON.

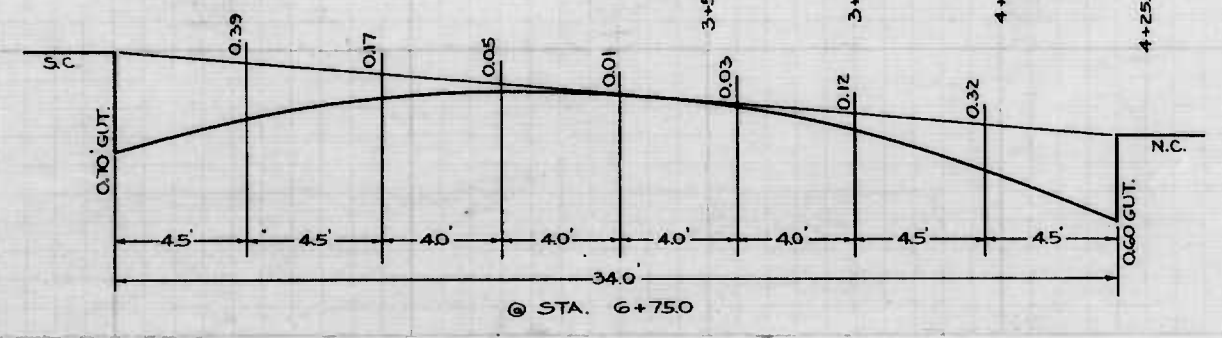
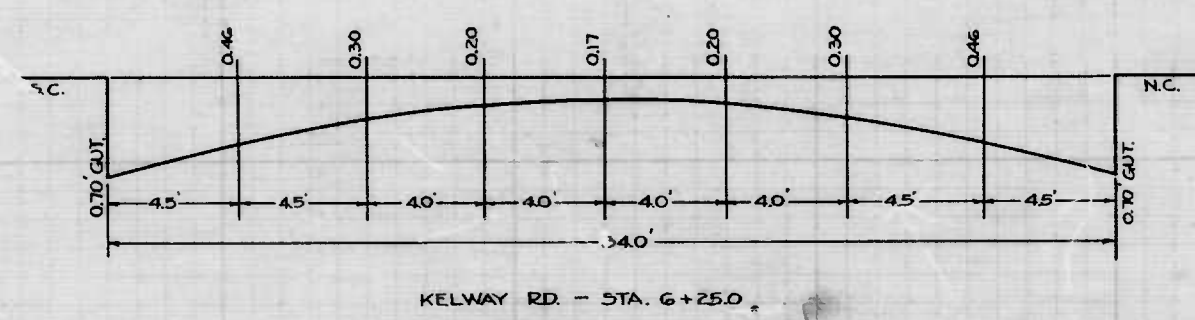

DESIGNED BY: A. Groner  
 DRAWN BY: *H. H. H.*  
 ENGINEER: *H. H. H.*

Lat



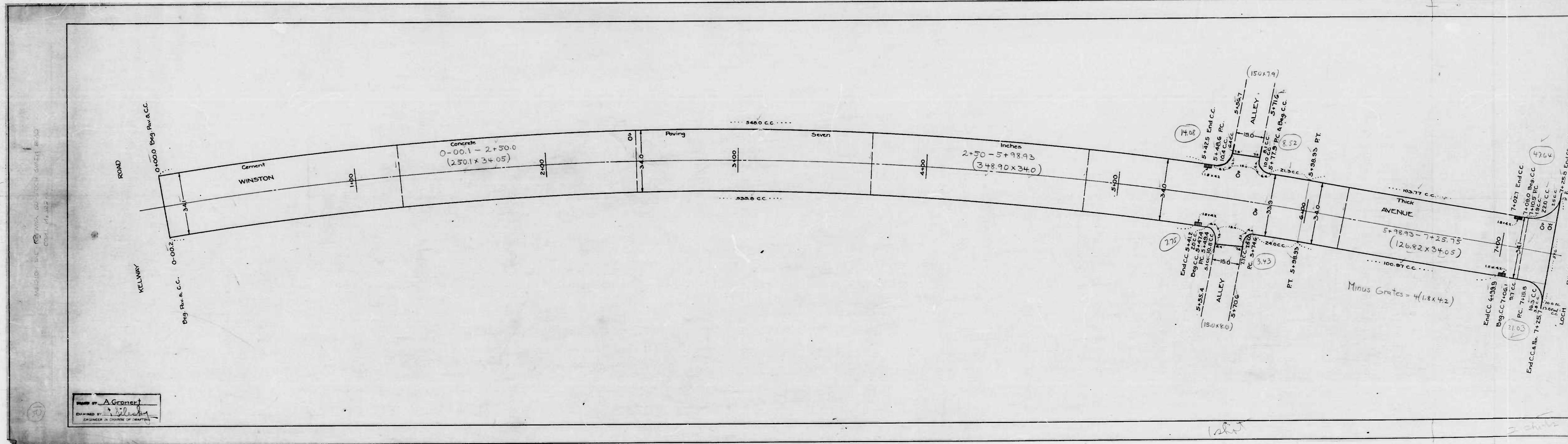

DESIGNED BY A. Groner  
 EXAMINED BY [Signature]  
 ENGINEER IN CHARGE OF MAPS



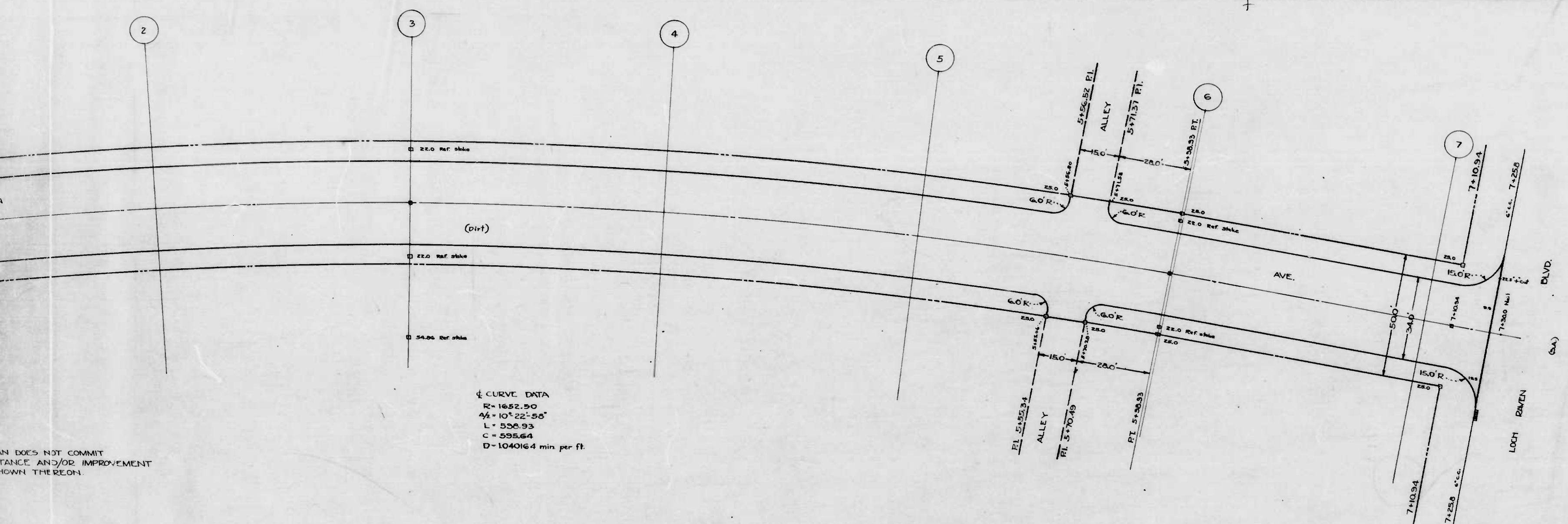

CURVE DATA  
 R = 1652.50  
 Δ = 10° 22' 56"  
 L = 555.93  
 C = 535.64  
 D = 104016.4 min. per ft.

DOES NOT COMMIT  
 TANCE AND/OR IMPROVEMENT  
 DOWN THE ROAD.

CITY OF BALTIMORE  
 DEPARTMENT OF PUBLIC WORKS  
 BUREAU OF HIGHWAYS  
 LAYOUT OF  
 WINSTON AVE.-KELWAY RD.-LOCH RAVEN BLVD  
 CONT. N° 753  
 SCALE: 1" = 200'  
 CORRECT  
 MAY 21, 1942  
 APPROVED: *George J. Carter*  
 HIGHWAYS ENGINEER  
 APPROVED: *George Colby*  
 CHIEF ENGINEER  
 APPROVED: *Edward J. ...*  
 ENGR. - PLANS & SURVEYS



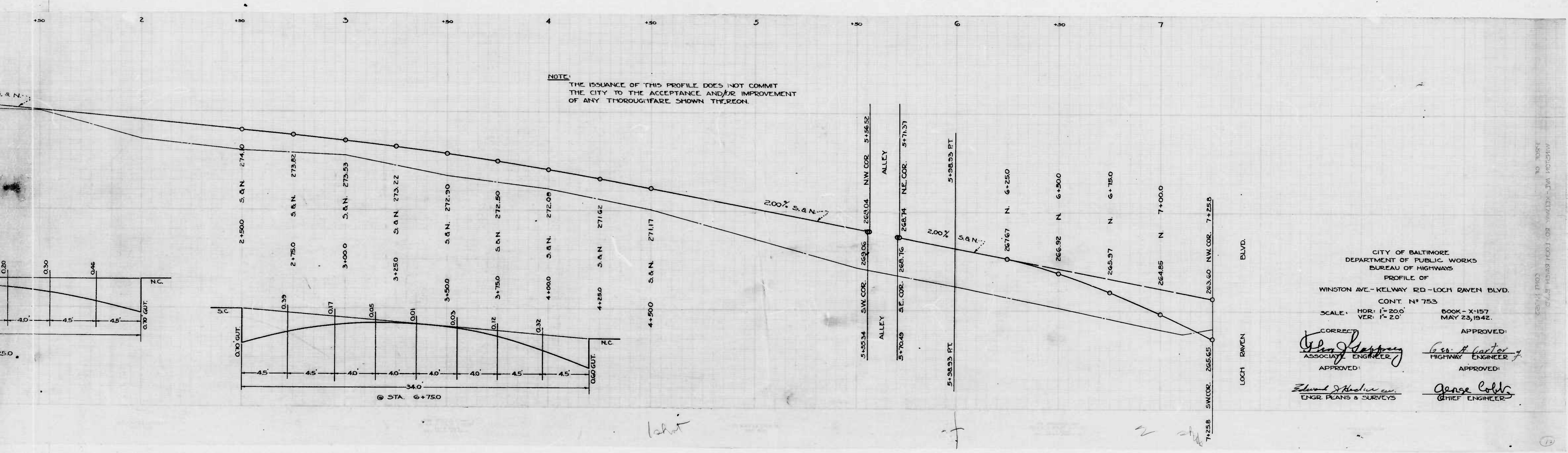

NOTE: THE ISSUANCE OF THIS PROFILE DOES NOT COMMIT THE CITY TO THE ACCEPTANCE AND/OR IMPROVEMENT OF ANY THOROUGHFARE SHOWN THEREON.

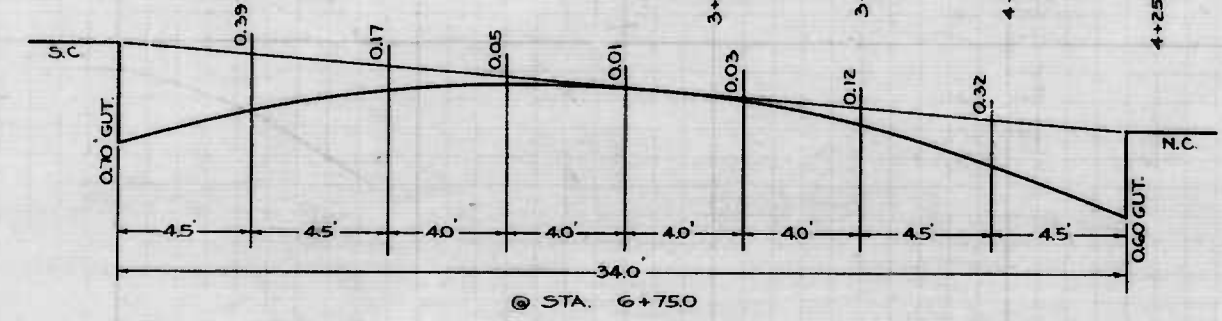
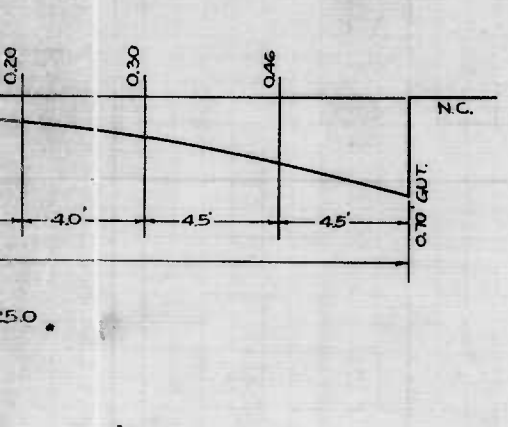

CITY OF BALTIMORE  
 DEPARTMENT OF PUBLIC WORKS  
 BUREAU OF HIGHWAYS  
 PROFILE OF  
 WINSTON AVE. - KELWAY RD - LOCH RAVEN BLVD.  
 CONT. N° 753  
 SCALE: HOR: 1" = 20.0' VER: 1" = 2.0'  
 BOOK - X-157  
 MAY 23, 1942.

CORRECTED: *Wm. H. Perry*  
 ASSOCIATE ENGINEER  
 APPROVED: *Edmund J. Hines, Jr.*  
 ENGR. PLANS & SURVEYS

APPROVED: *Geo. A. Carter*  
 HIGHWAY ENGINEER  
 APPROVED: *George Colby*  
 CHIEF ENGINEER

NO. 7057  
 12 1/2" x 17 1/2" (100) OR WIDER - 3/4" PITCH



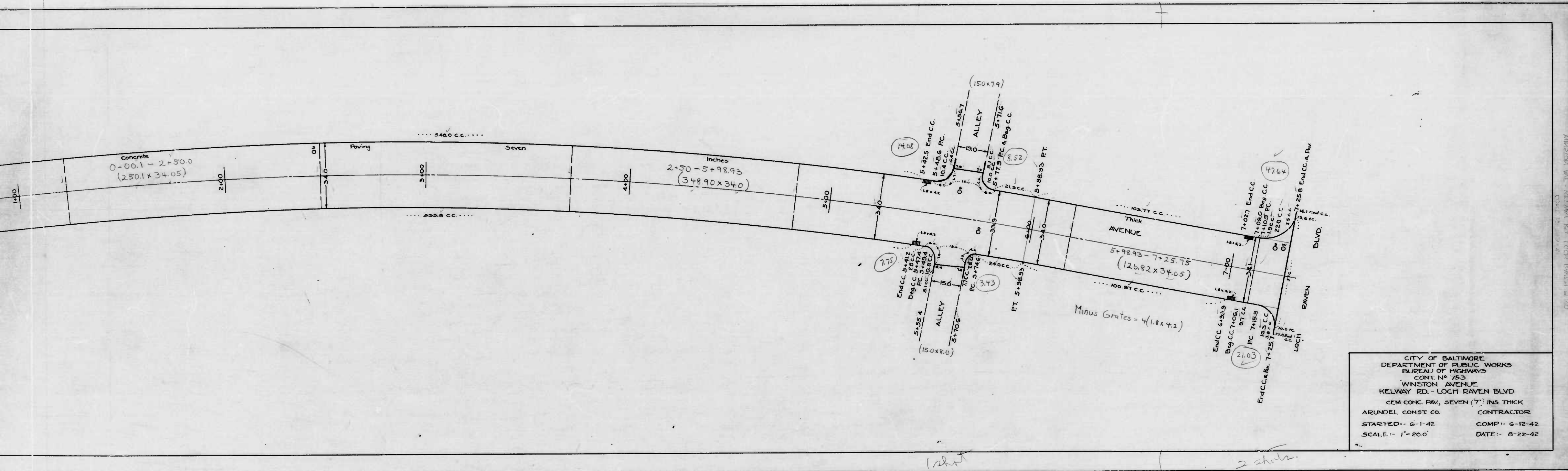

CITY OF BALTIMORE  
DEPARTMENT OF PUBLIC WORKS  
BUREAU OF HIGHWAYS  
CONT. NO. 753  
WINSTON AVENUE  
KELWAY RD. - LOCH RAVEN BLVD.  
CEM CONC. PAV., SEVEN (7") INS. THICK  
ARUNDEL CONST. CO. CONTRACTOR  
STARTED - 6-1-42 COMP. - 6-12-42  
SCALE - 1" = 20.0' DATE - 8-22-42