

750/751

RATIO - 24

No.

3

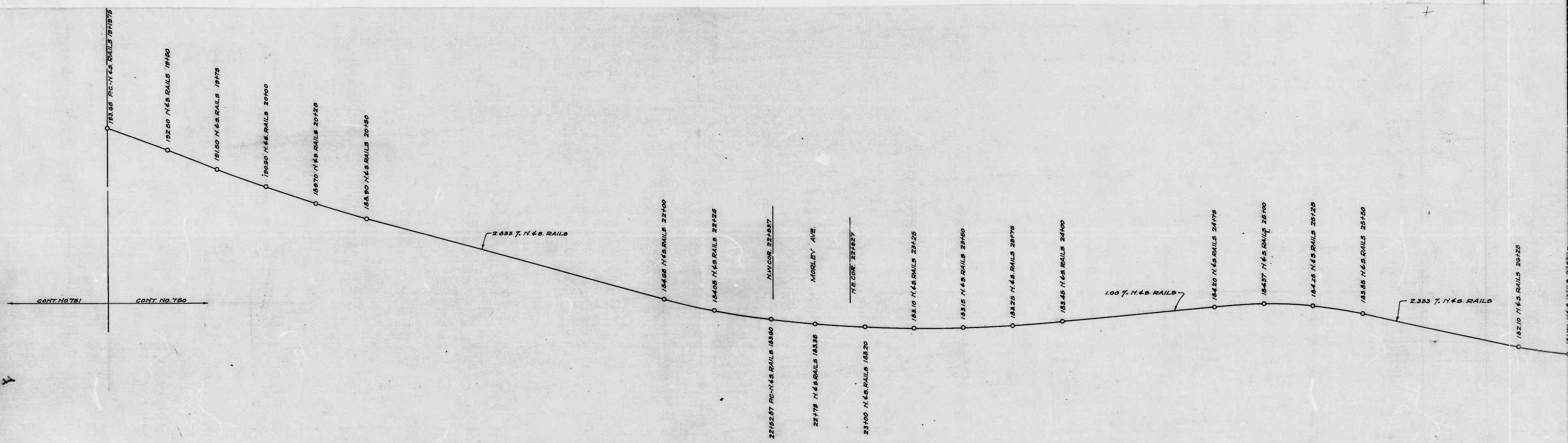

DRAWN BY
ENGINEER IN CHARGE OF TRAILING

750/751

RATIO - 24 No.

2

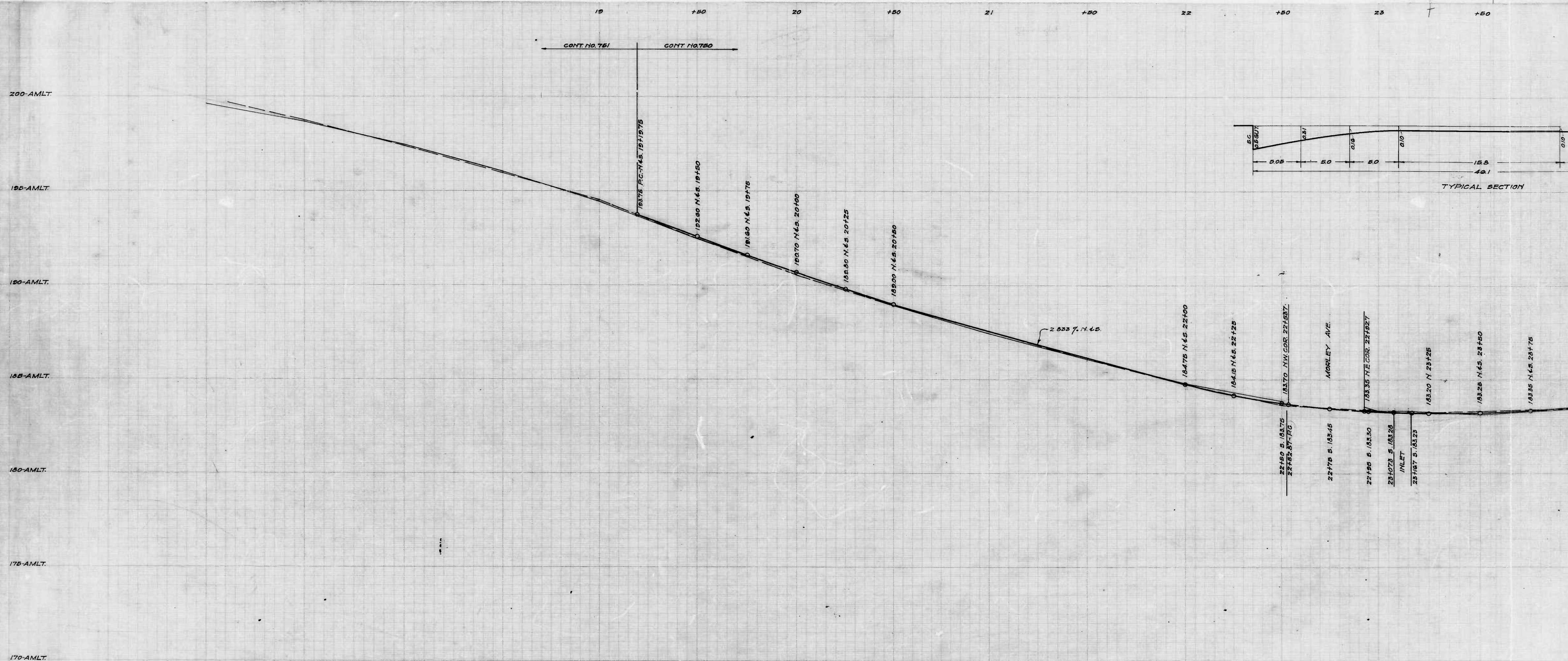

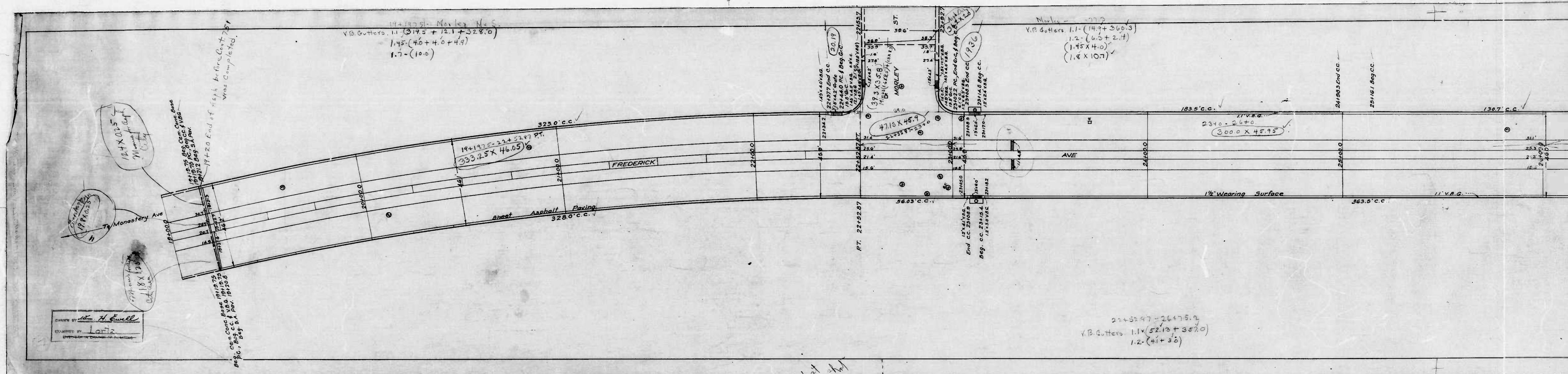

750/751

RATIO - 24

No.

3

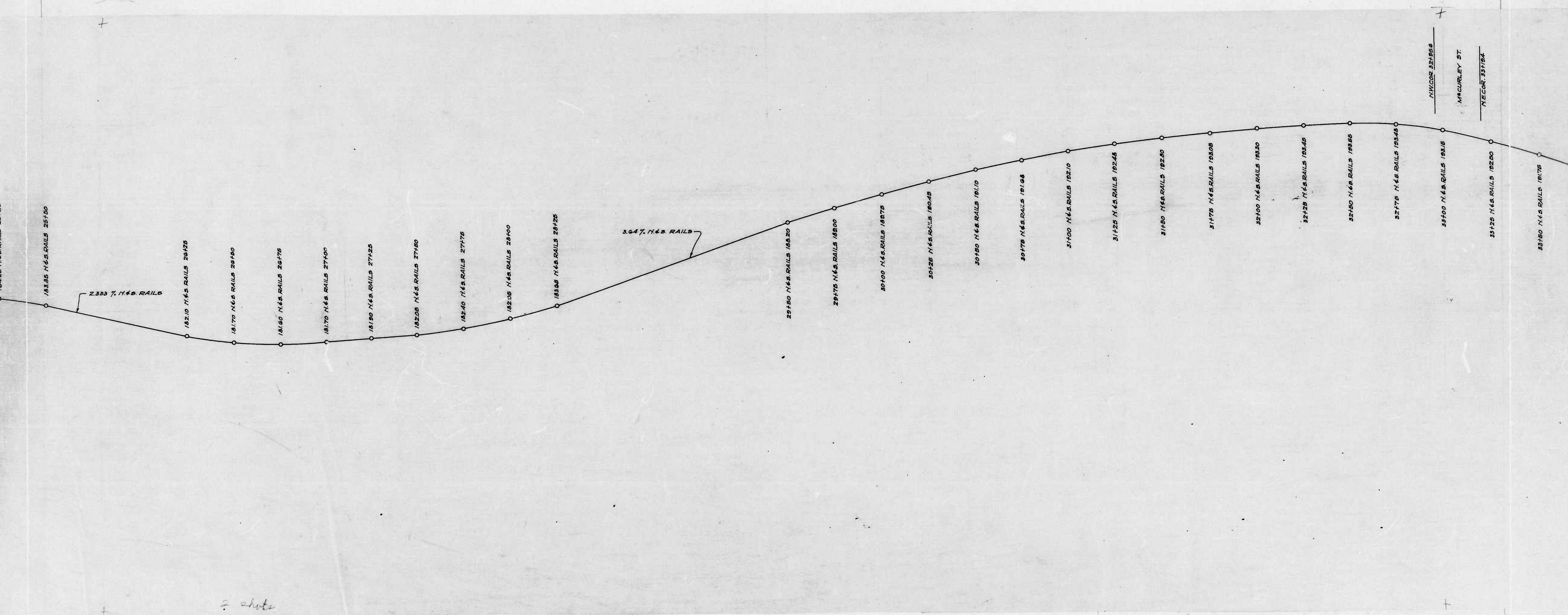

750/751

RATIO - 24 No.

2

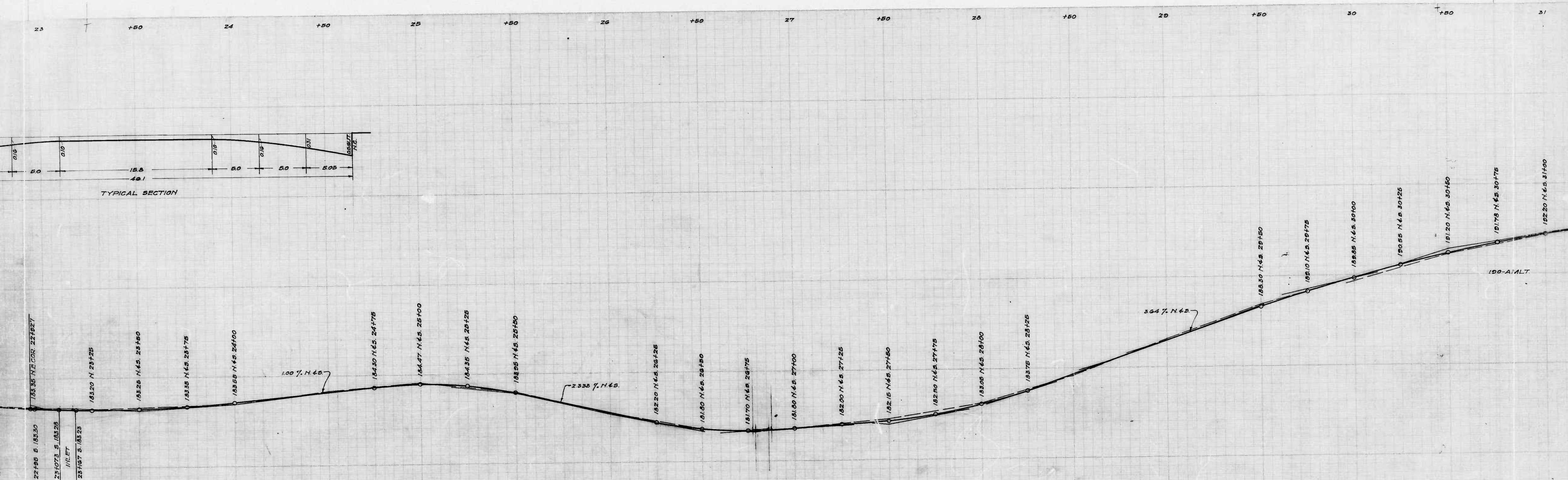

750/751

RATIO - 24 No.

4

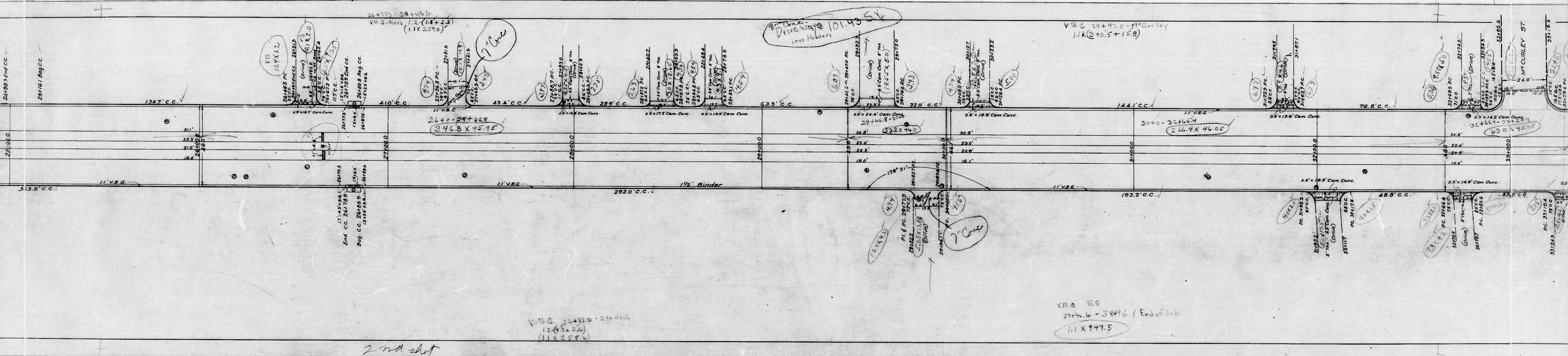

750/751

RATIO - 24

No.

3

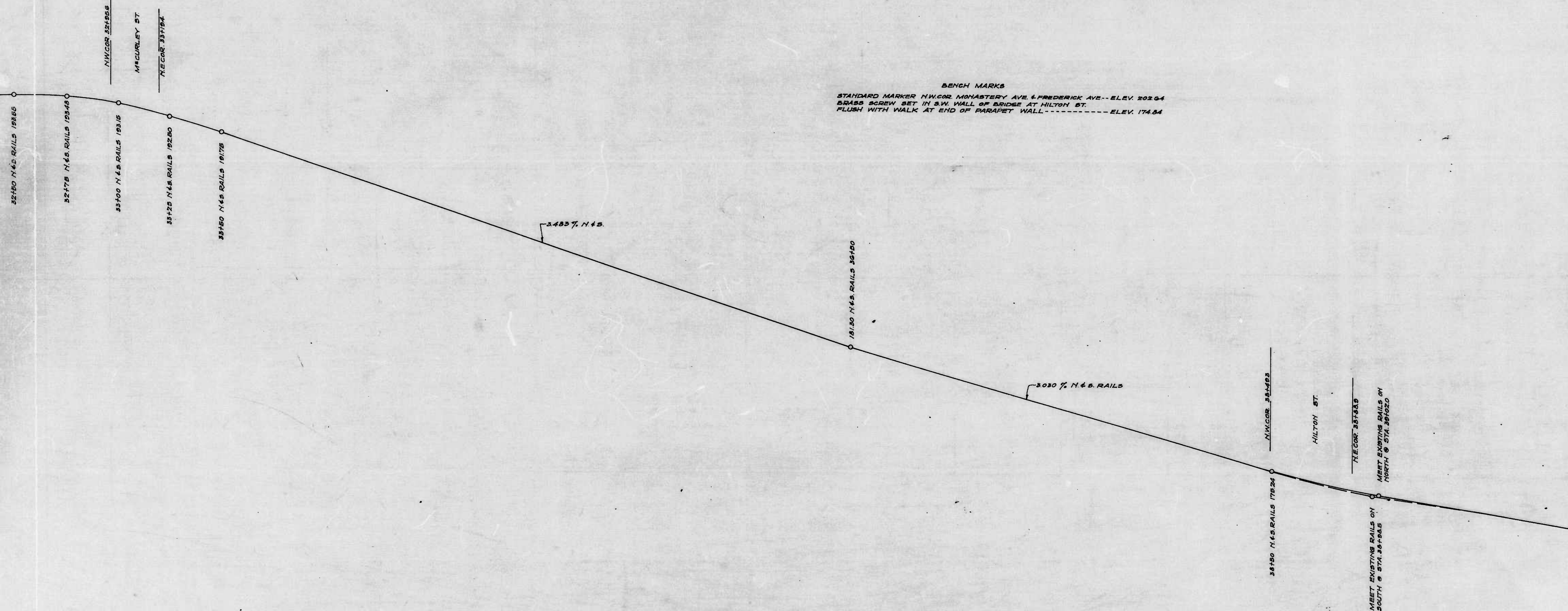

750/751

RATIO - 24

No.

2

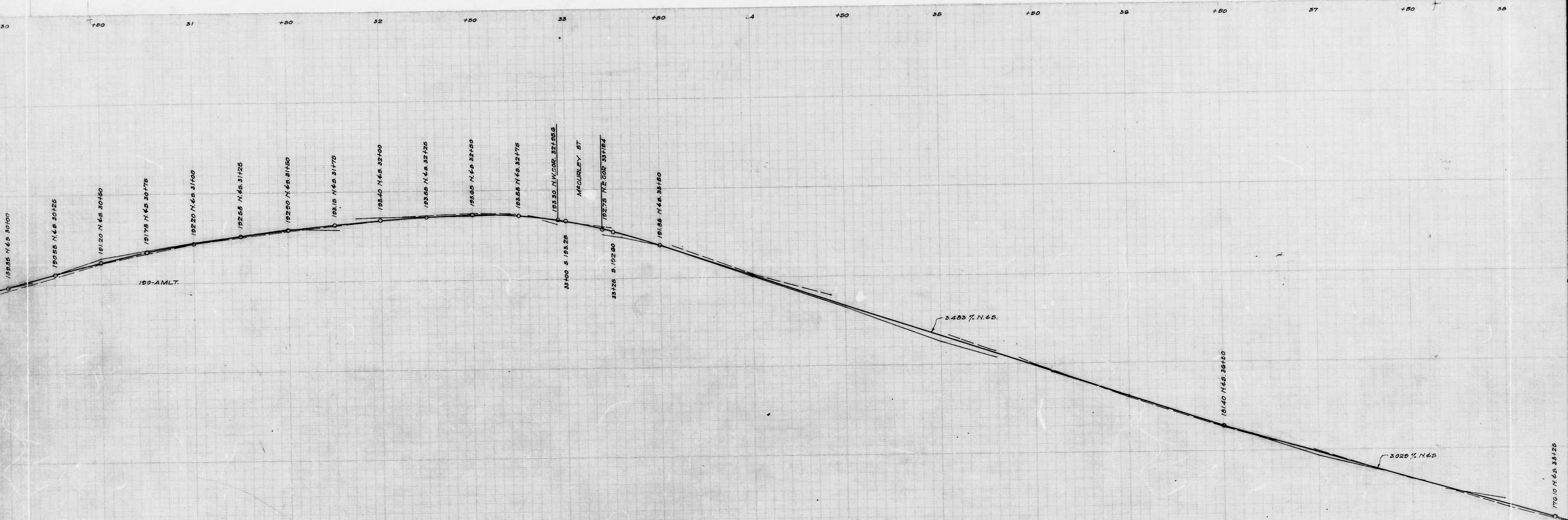

2 dots

750/751

RATIO - 24 No.

4

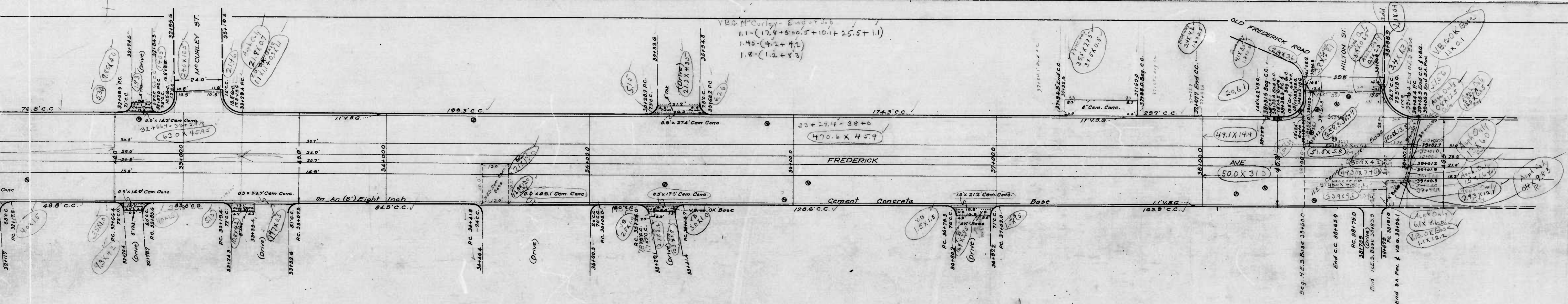

CITY OF BALTIMORE
DEPARTMENT OF PUBLIC WORKS
BUREAU OF HIGHWAYS
CONT. NO. 1
FREDERICK AVE - 550' E MON
SA. PAV. 1 1/2" WEAR SURF. 12" BINDER
ASPH. 1 1/2" PAV. & CONT. CO.
STARTED - 8-10-41
SCALE - 1" = 20.0'

HES 323.448

3rd sheet

750/751

RATIO - 24 No.

3

BENCH MARKS
STANDARD MARKER NW COR. MONASTERY AVE. & FREDERICK AVE. - ELEV. 202.64
BRASS SCREW SET IN SW WALL OF BRIDGE AT HILTON ST.
FLUSH WITH WALK AT END OF PARAPET WALL - ELEV. 174.84

18.20 N 4.5 RAILS 35150

3.030 % N 4.5 RAILS

NW COR. 35149

HILTON ST.

NE COR. 35149

MEET EXISTING RAILS ON NORTH @ STA. 351020

35150 N 4.5 RAILS 17524

MEET EXISTING RAILS ON SOUTH @ STA. 351025

CITY OF BALTIMORE
DEPARTMENT OF PUBLIC WORKS
BUREAU OF HIGHWAYS
PROFILE OF RAILWAY TRACKS
FREDERICK AVE. - 550' E.E. OF MONASTERY AVE. TO HILTON ST.
CONT. NO. 750

SCALE: - HOR. 1" = 200'
VER. 1" = 20'

BOOK NO. 147
JUNE 23, 1941

CORRECTED
Ed. J. Rapp
ASSOCIATE ENGINEER

APPROVED
James S. [Signature]
HIGHWAYS ENGINEER

4 sheets

750/751

RATIO - 24

No. 2

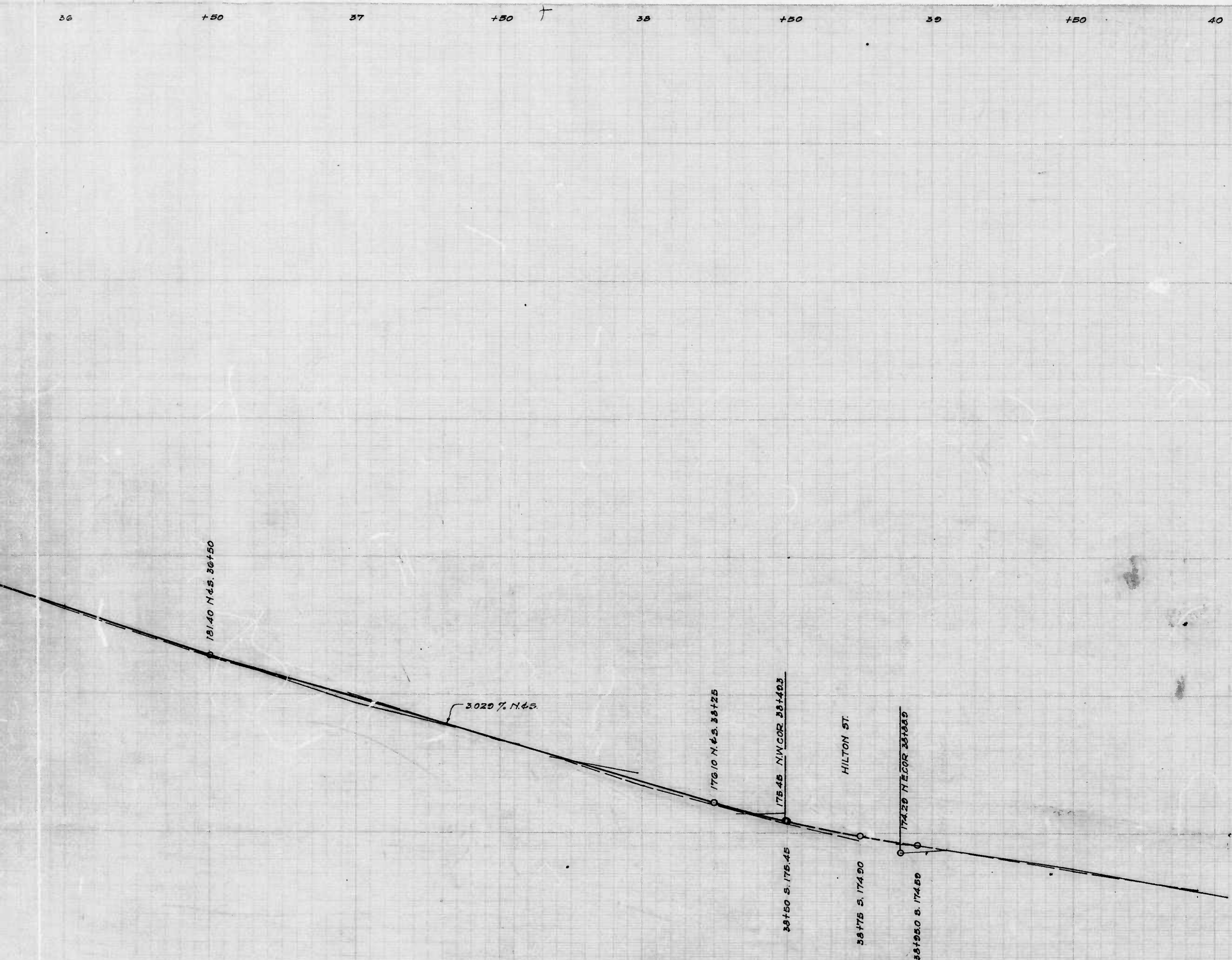

CITY OF BALTIMORE
DEPARTMENT OF PUBLIC WORKS
BUREAU OF HIGHWAYS
ESTABLISHED GRADE OF
FREDERICK AVE. - 550' E. OF MONASTERY AVE. TO HILTON ST.

CONT. NO. 750
BOOK - X-147
JUNE 11, 1941

APPROVED: *Edmund J. Macken*
ASSOCIATE ENGINEER
APPROVED: *George E. Holt*
CHIEF ENGINEER

4 sheets

750/751

RATIO - 24

No. 6

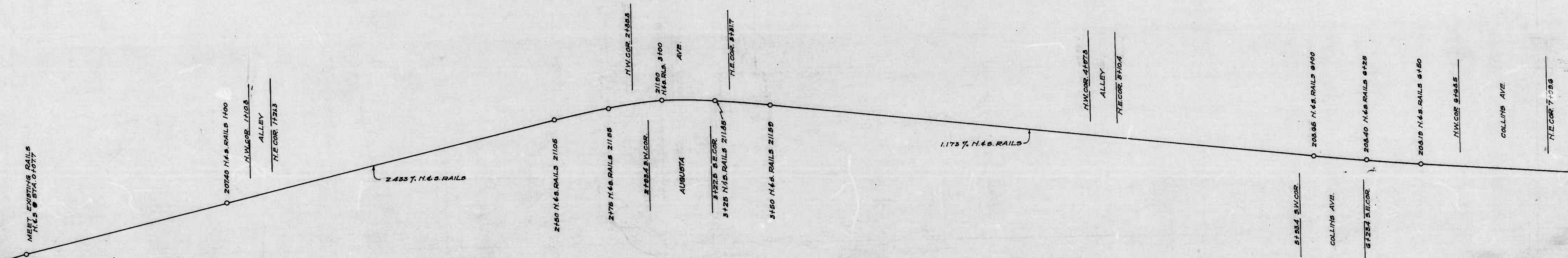

DESIGNED BY J. J. HAYDEN, JR.
 DRAWN BY *[Signature]*
 ENGINEER IN CHARGE OF RAILROAD

Sheet 1

750/751

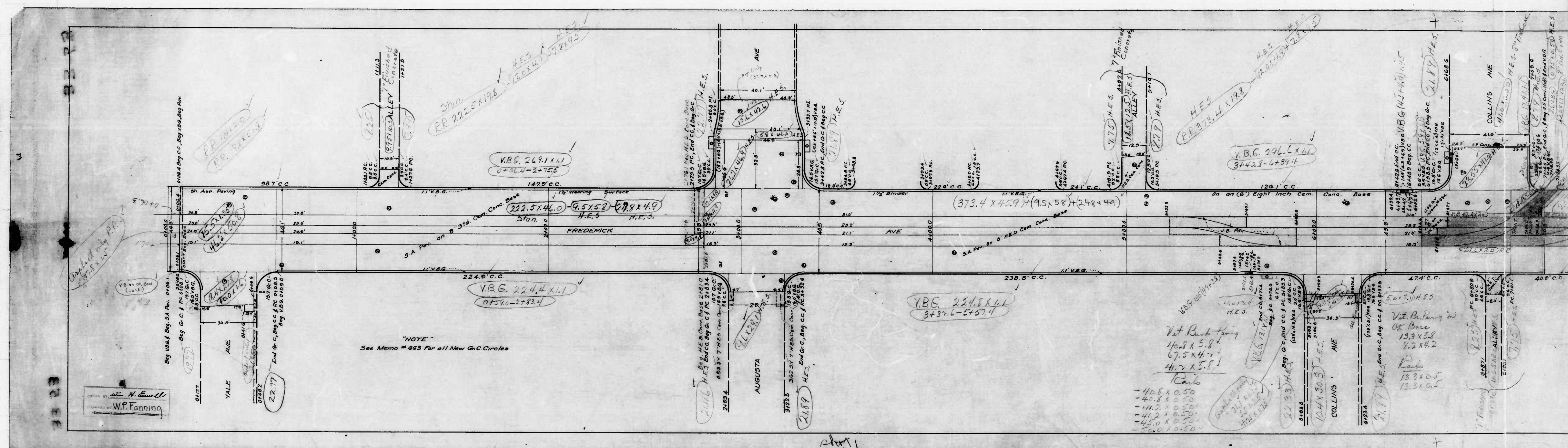

750/751

RATIO - 24

No.

5

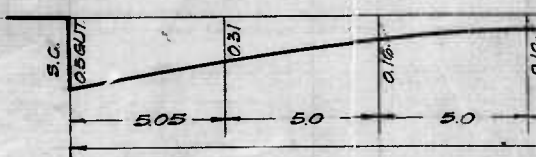
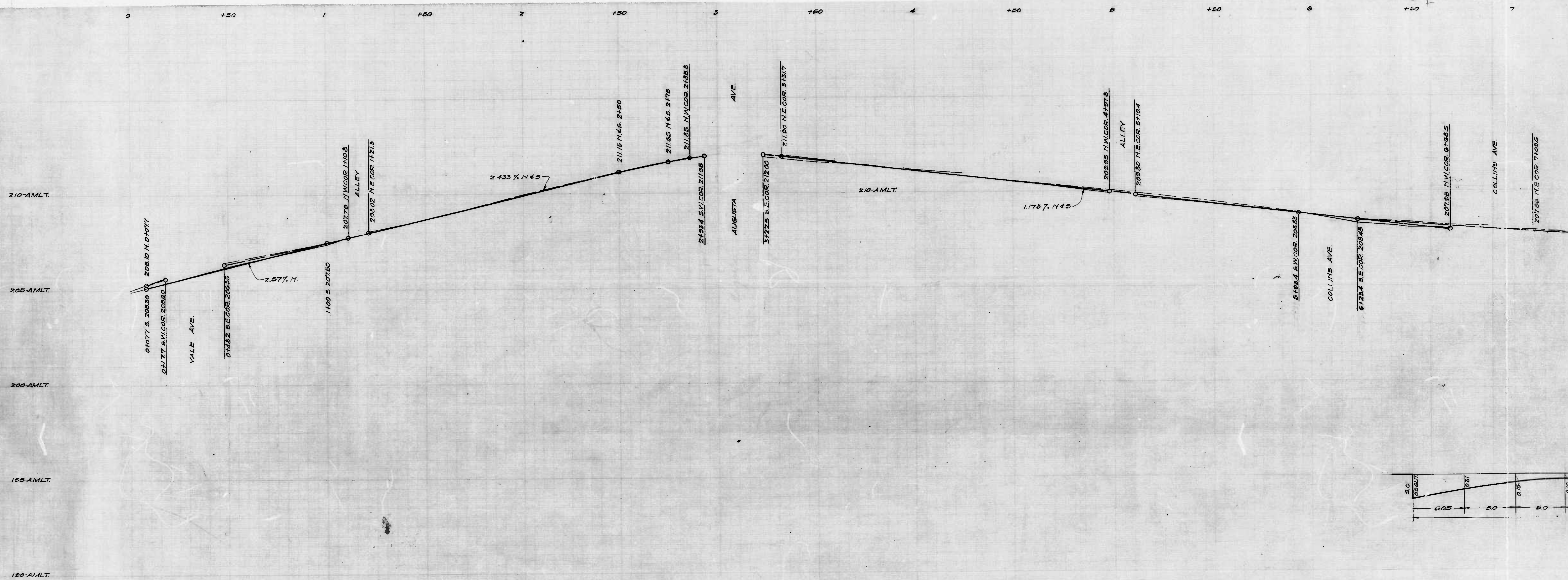

DESIGNED BY J. J. HAYDEN JR.
 DRAWN BY H. J. HAYDEN JR.
 CHECKED BY H. J. HAYDEN JR.

short

750/751

RATIO - 24 No.

1

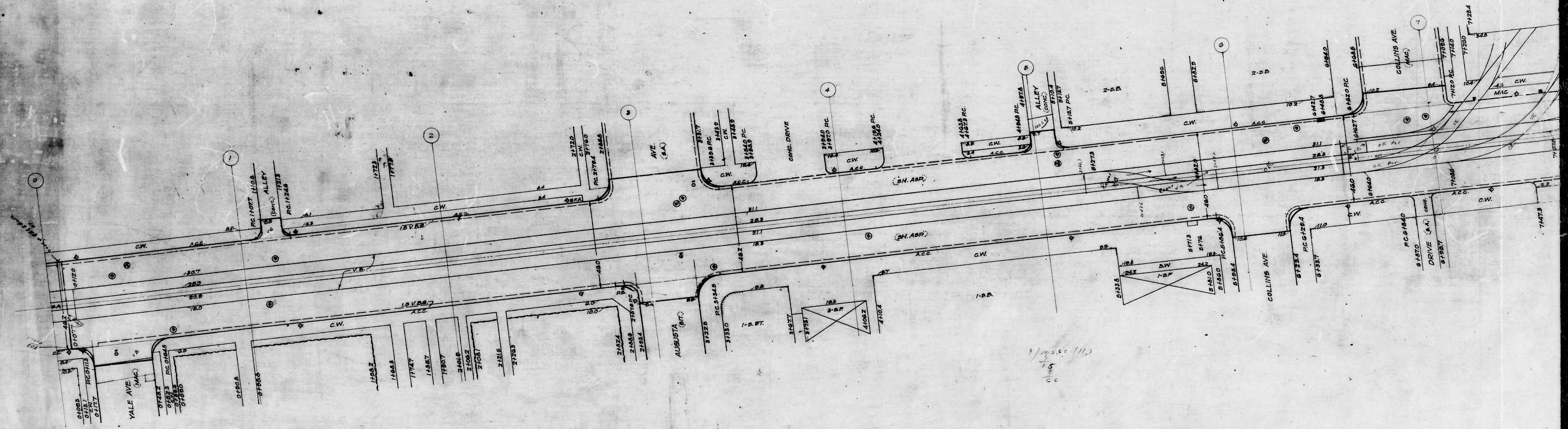

shot 1

750/751

RATIO - 24 No.

1

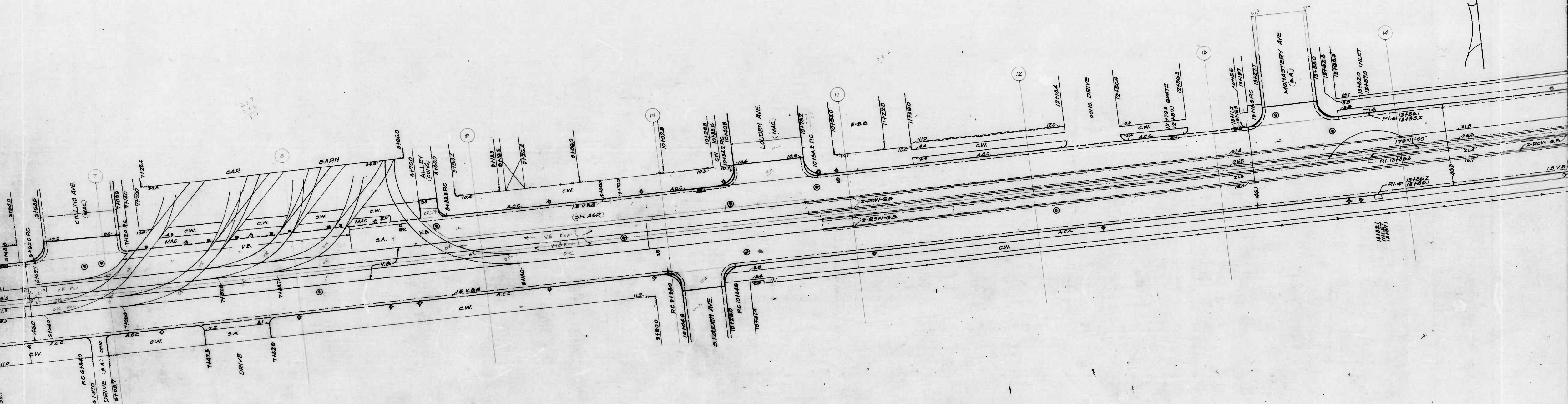

NOTE:
ALL STREET CIRCLES TO BE 10.0' RADIUS.
ALL ALLEY CIRCLES TO BE 60' RADIUS.

shot 2

750/751

RATIO - 24

No.

6

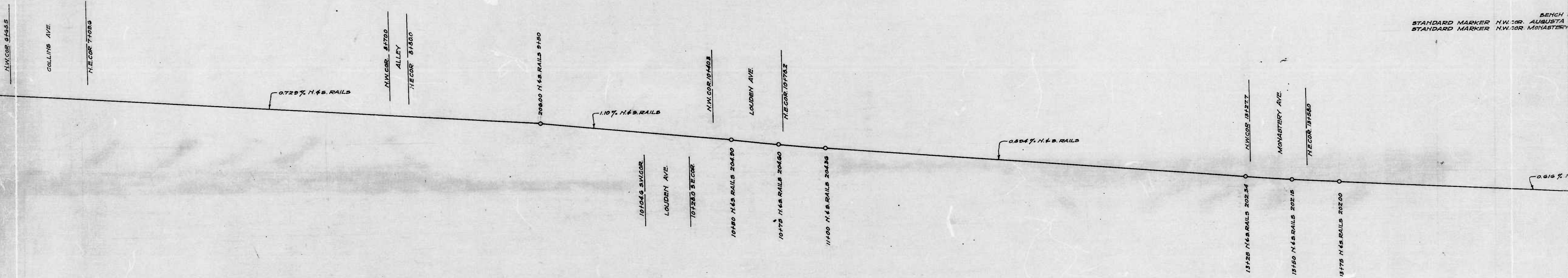

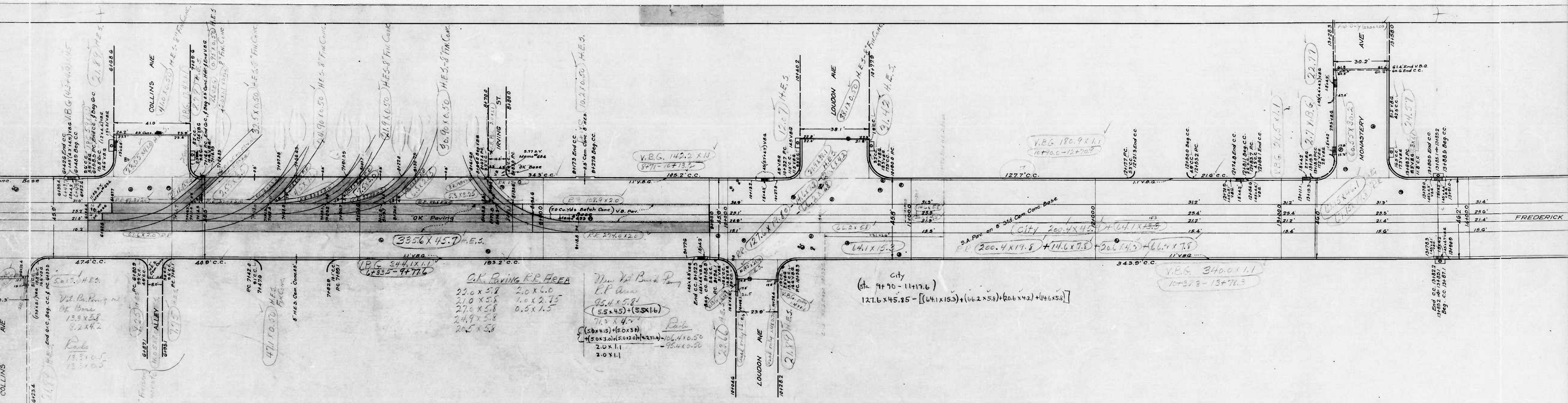

750/751

RATIO - 24 No. **6**

BENCH MARKS
STANDARD MARKER N.W. COR. AUGUSTA AVE. & FREDERICK AVE. --- ELEV. 2120.9
STANDARD MARKER N.W. COR. MONASTERY AVE. & FREDERICK AVE. --- ELEV. 202.64

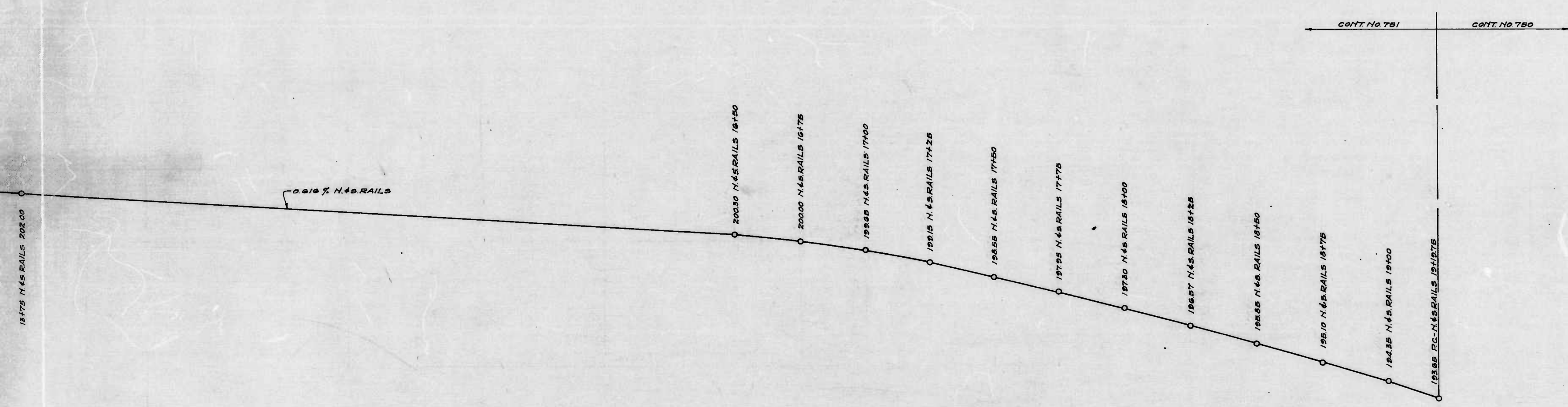

CITY OF BALTIMORE
DEPARTMENT OF PUBLIC WORKS
BUREAU OF HIGHWAYS
PROFILE OF RAILWAY TRACKS
FREDERICK AVE. - YALE AVE. TO 580' E. OF MONASTERY AVE.
CONT. NO. 751
SCALE: HORIZ. 1"=200' VERT. 1"=20'
BOOK NO. X-147
JUNE 23, 1941
APPROVED: *[Signature]* ASSOCIATE ENGINEER
APPROVED: *[Signature]* HIGHWAYS ENGINEER

chart 3

750/751

RATIO - 24 No.

7

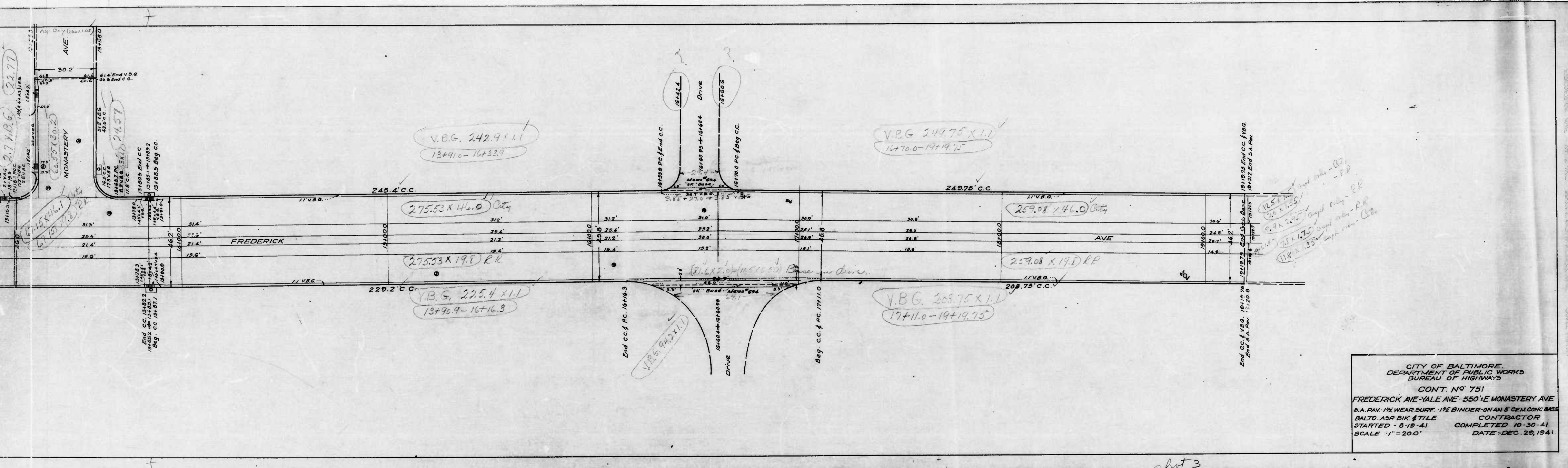

750/751

RATIO - 24

No.

5

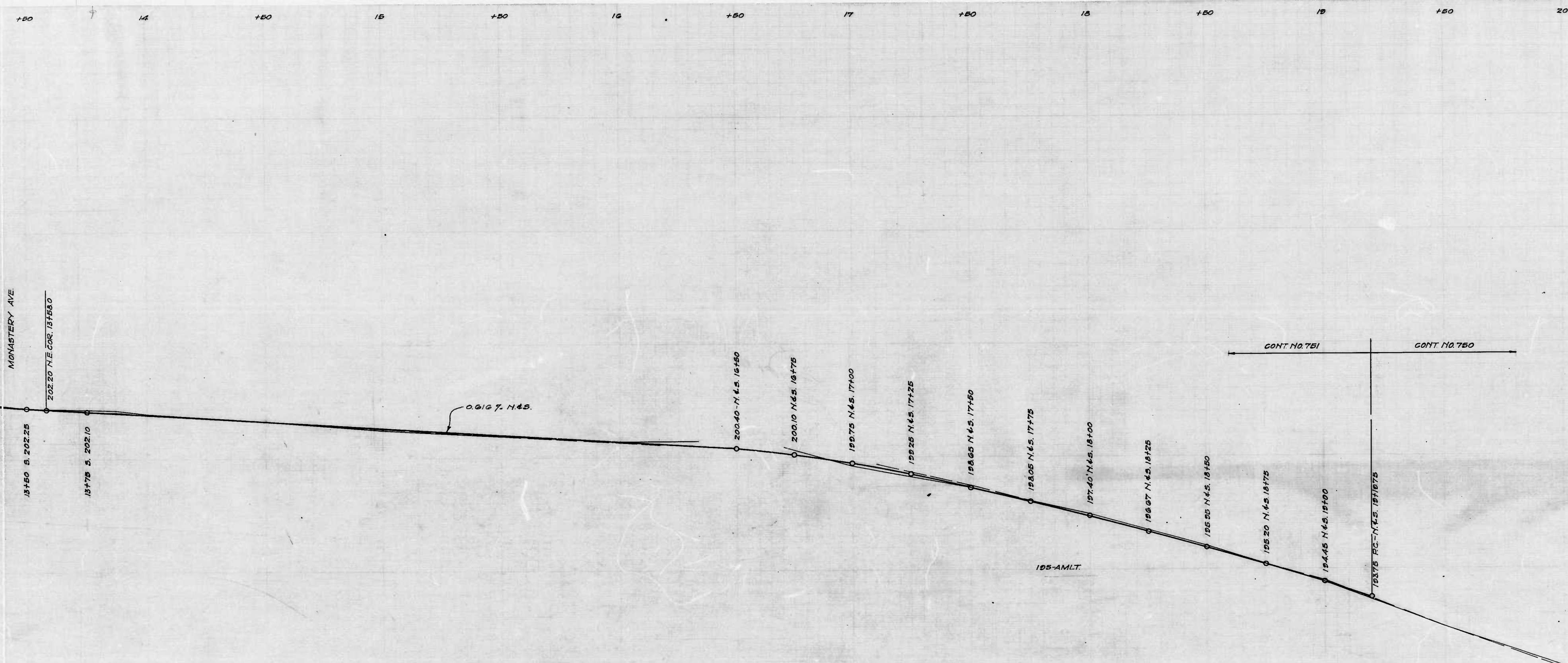

3rd shot

CITY OF BALTIMORE
DEPARTMENT OF PUBLIC WORKS
BUREAU OF HIGHWAYS
ESTABLISHED GRADE OF
FREDERICK AVE. - YALE AVE. TO 550' E. OF
CONT. NO. 751
HOR. - 1" = 200'
VER. - 1" = 20'
CORRECTED
Edward J. H. [Signature]
ASSOCIATE ENGINEER
APPROVED: *Edward J. H. [Signature]*
ENGR. PLANS & SURVEYS

1

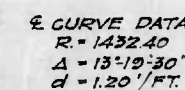

BOOK NO.-X 147.
JUNE 11, 1941

APPROVED:

George A. Lutz
HIGHWAYS ENGINEER

APPROVED:

Genze Cobb
CHIEF ENGINEER

DRAWN BY *J. J. H. H. H. H.*
EXAMINED BY *H. W. H. H.*
ENGINEER IN CHARGE OF DRAFTING

shot 3

750/751

RATIO - 24 No.

5

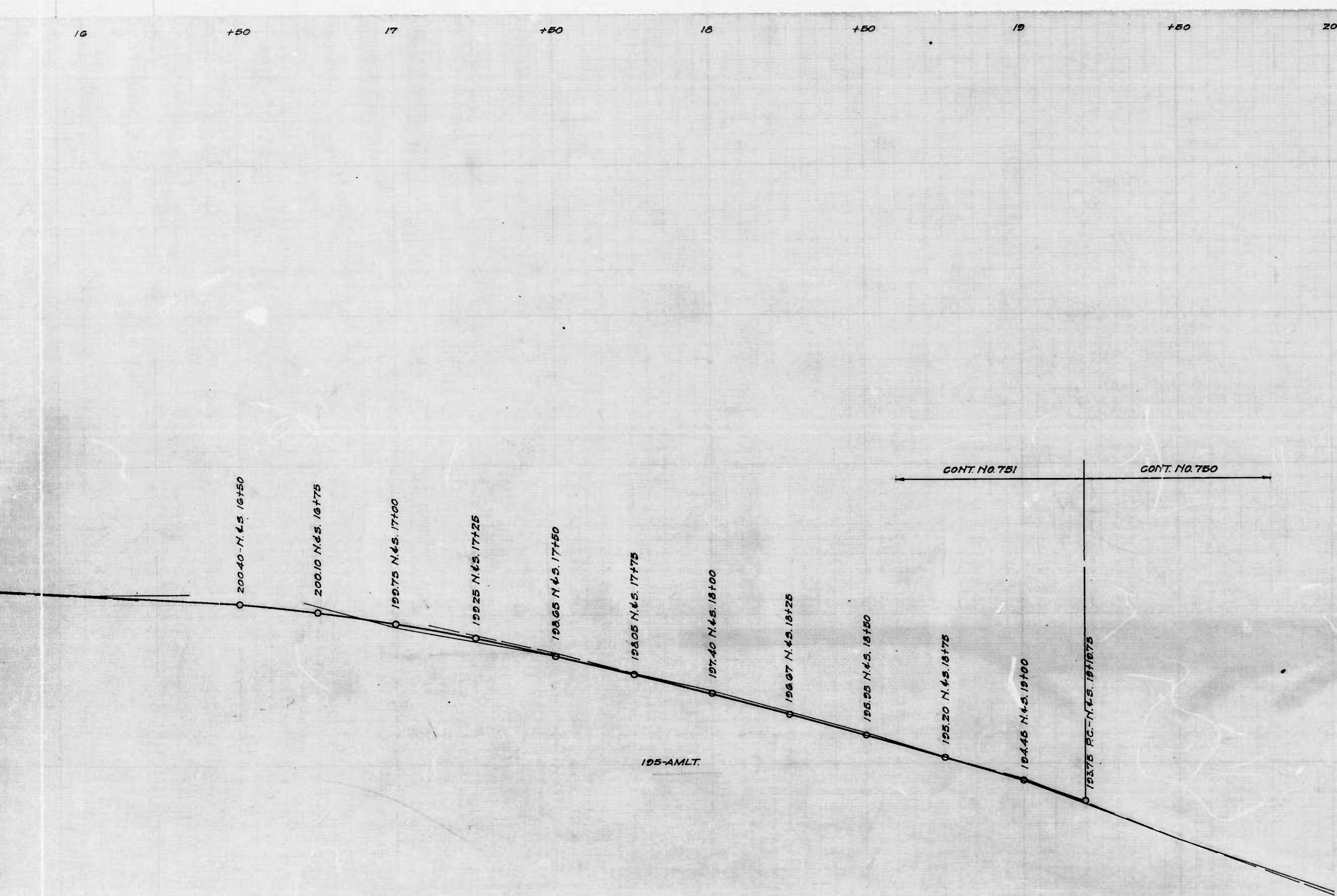

CITY OF BALTIMORE
 DEPARTMENT OF PUBLIC WORKS
 BUREAU OF HIGHWAYS
 ESTABLISHED GRADE OF
 FREDERICK AVE. - YALE AVE. TO 550'± E. OF MONASTERY AVE.
 CONT. NO. 751

SCALE: HOR. 1"=20.0'
 VER. 1"=20'

BOOK NO. X-147
 JUNE 11, 1941

CORRECTED
Edward J. Heston
 ASSOCIATE ENGINEER

APPROVED
George C. Cobb
 HIGHWAY ENGINEER

APPROVED
Edward J. Heston
 ENGR. - PLANS & SURVEYS

APPROVED
George C. Cobb
 CHIEF ENGINEER

3rd shot

4th shot

750/751

RATIO - 24 No.

1

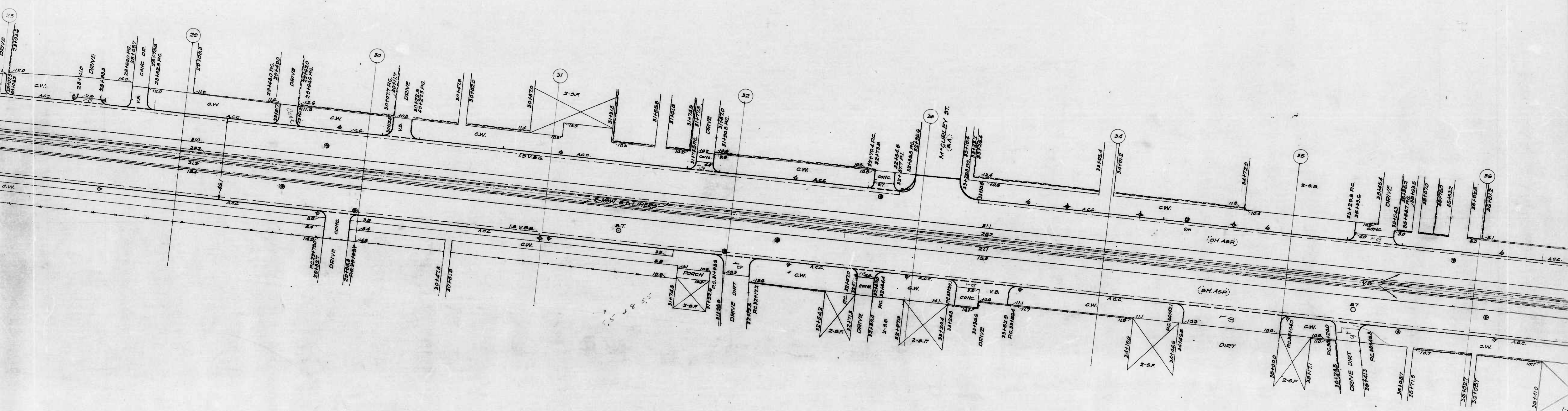

CITY OF BALTIMORE
DEPARTMENT OF PUBLIC WORKS
BUREAU OF HIGHWAYS
LAYOUT OF
FREDERICK AVE.-550'± E. OF MONASTERY AVE. TO HILTON ST.
CONT. NO. 750

SCALE: 1" = 200'

BOOK NO. X-147
JUNE 11, 1941

APPROVED: _____

APPROVED: *ms*

CORRECT

APPROVED: _____

George Cobb
CHIEF ENGINEER

Edward J. Hechman
ENGR-PLANS & SURVEYS

Glen J. Payne
ASSOCIATE ENGINEER

[Signature]
HIGHWAYS ENGINEER

