

BENCH MARK  
 Brass Screw in Top of Granite Wall  
 Of Aseway to Basement of Metropolitan  
 Savings Bank On SW Cor Charles St  
 & Saratoga St. Elev. 85.68

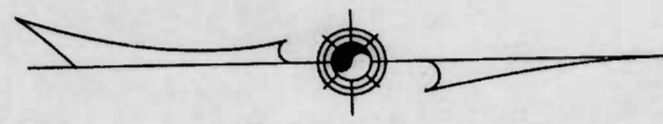

CITY OF BALTIMORE  
 DEPARTMENT OF PUBLIC WORKS  
 BUREAU OF HIGHWAYS  
 PROFILE OF RAILWAY TRACKS  
 CHARLES ST. AT SARATOGA ST.  
 SCALE: HOR - 1" = 20.0' BOOK N° X-143  
 VER - 1" = 20' JUNE 16, 1941  
 CONT N° 749

CORRECTED: *Edwin J. Keffner*  
 ASSOCIATE ENGINEER  
 APPROVED: *Henry Roberts*  
 HIGHWAY ENGINEER

DESIGNED BY: *A. Greiner*  
 DRAWN BY: *H. H. H. H.*  
 ENGINEER IN CHARGE OF DRAWING

CHECKED BY: *W. H. H. H.*  
 DRAWN BY: *W. H. H. H.*  
 DATE: *6/16/41*

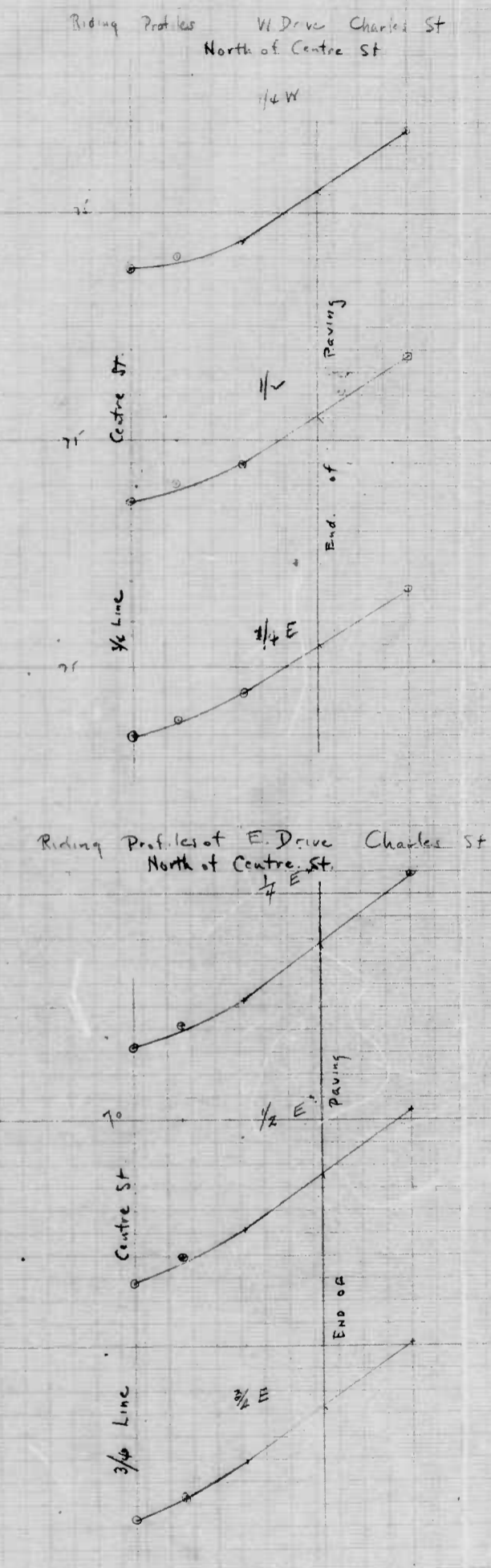
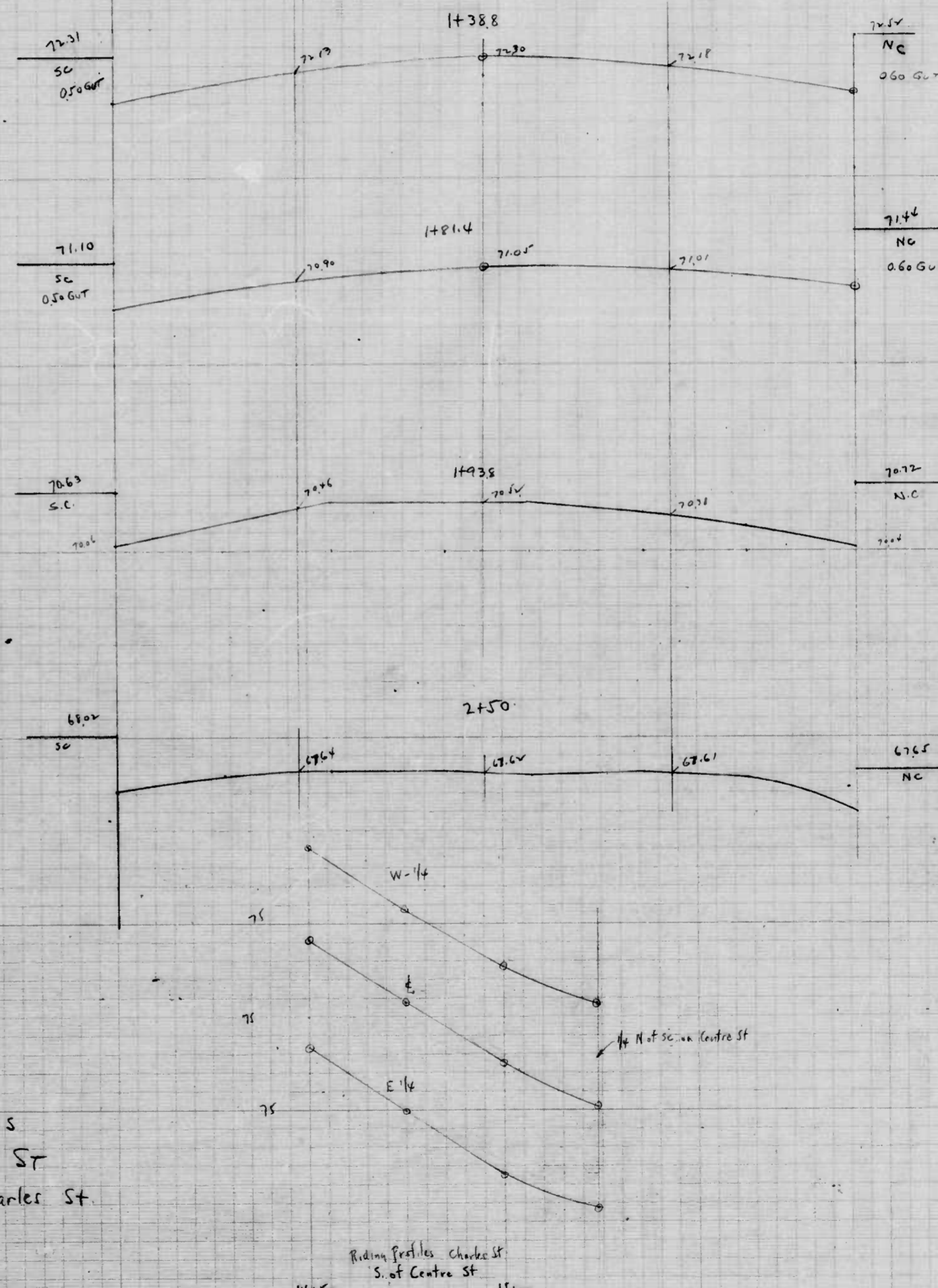
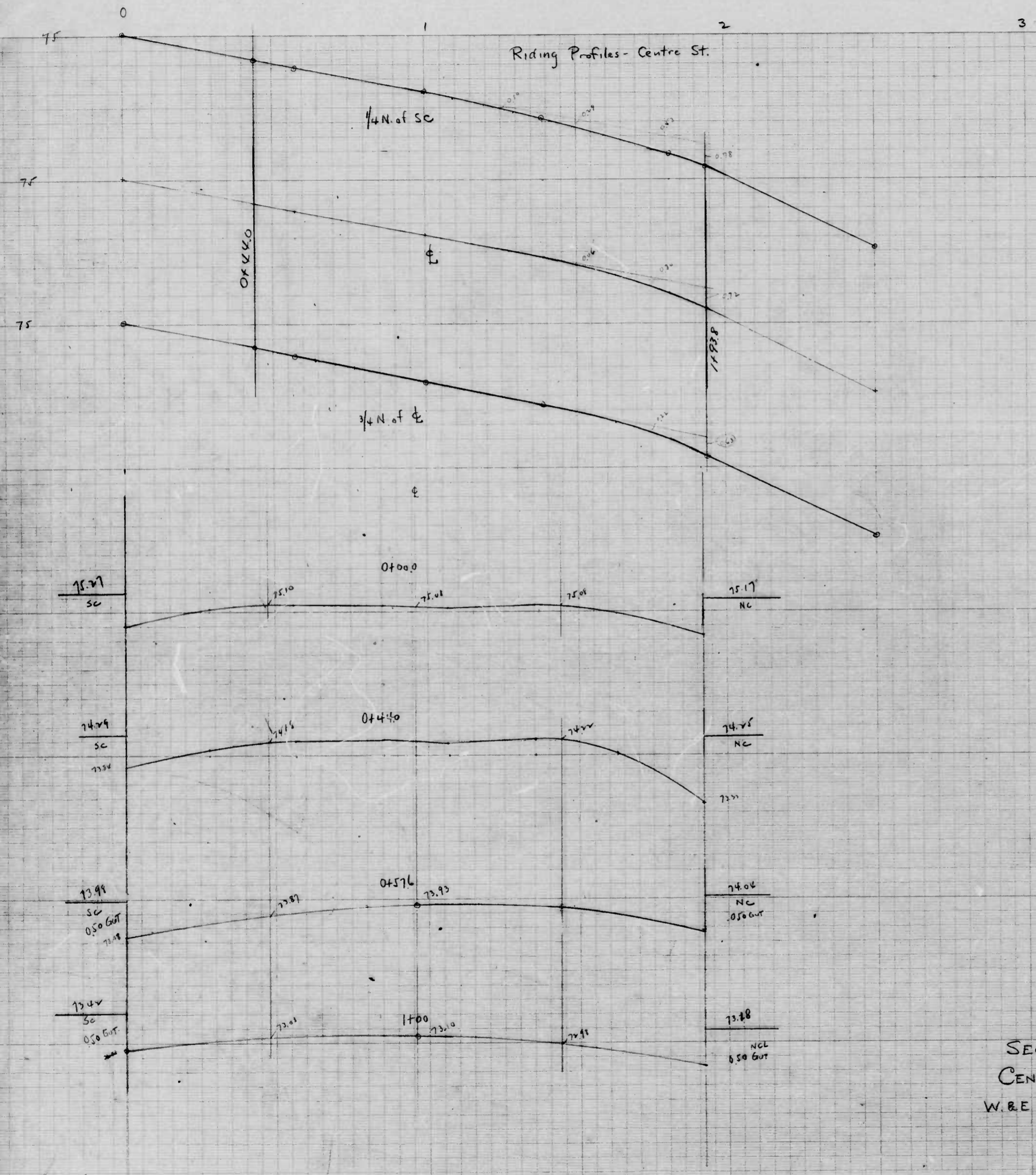

PRINTED IN U.S.A.

PRINTED IN U.S.A. IN 100% RECYCLED PAPER MADE IN U.S.A.

PRINTED IN U.S.A.

1 sheet

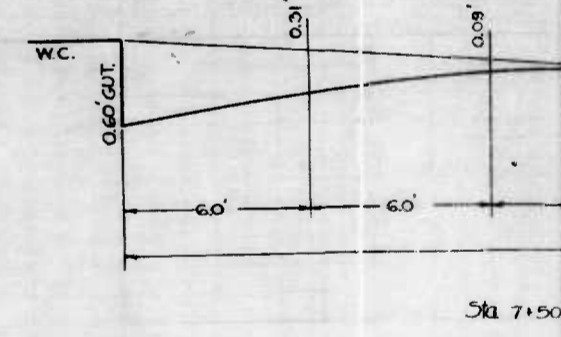
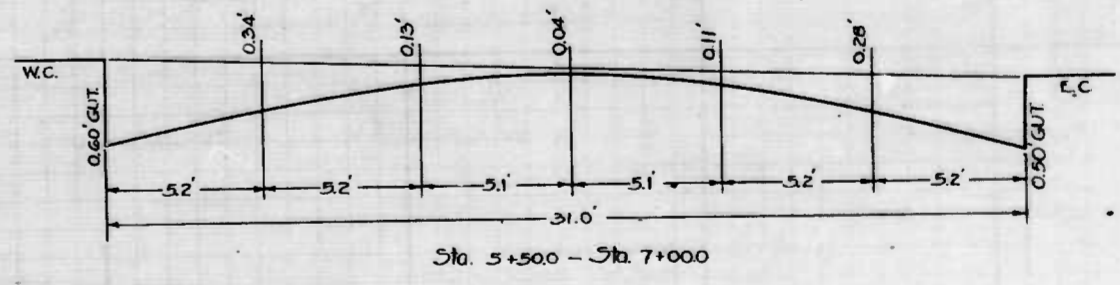
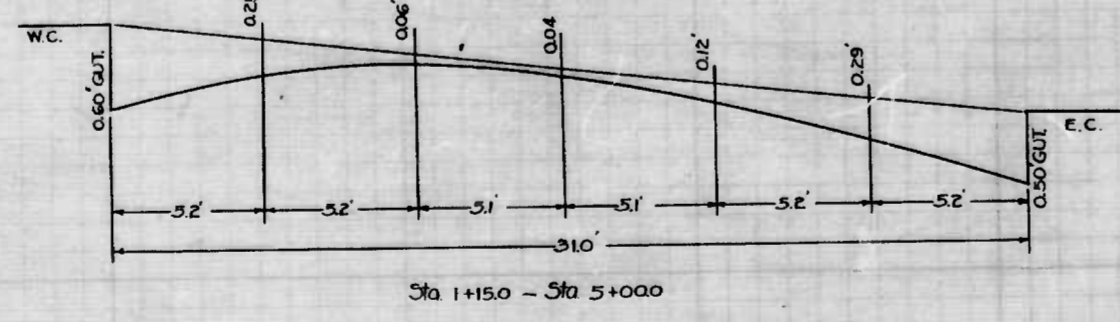
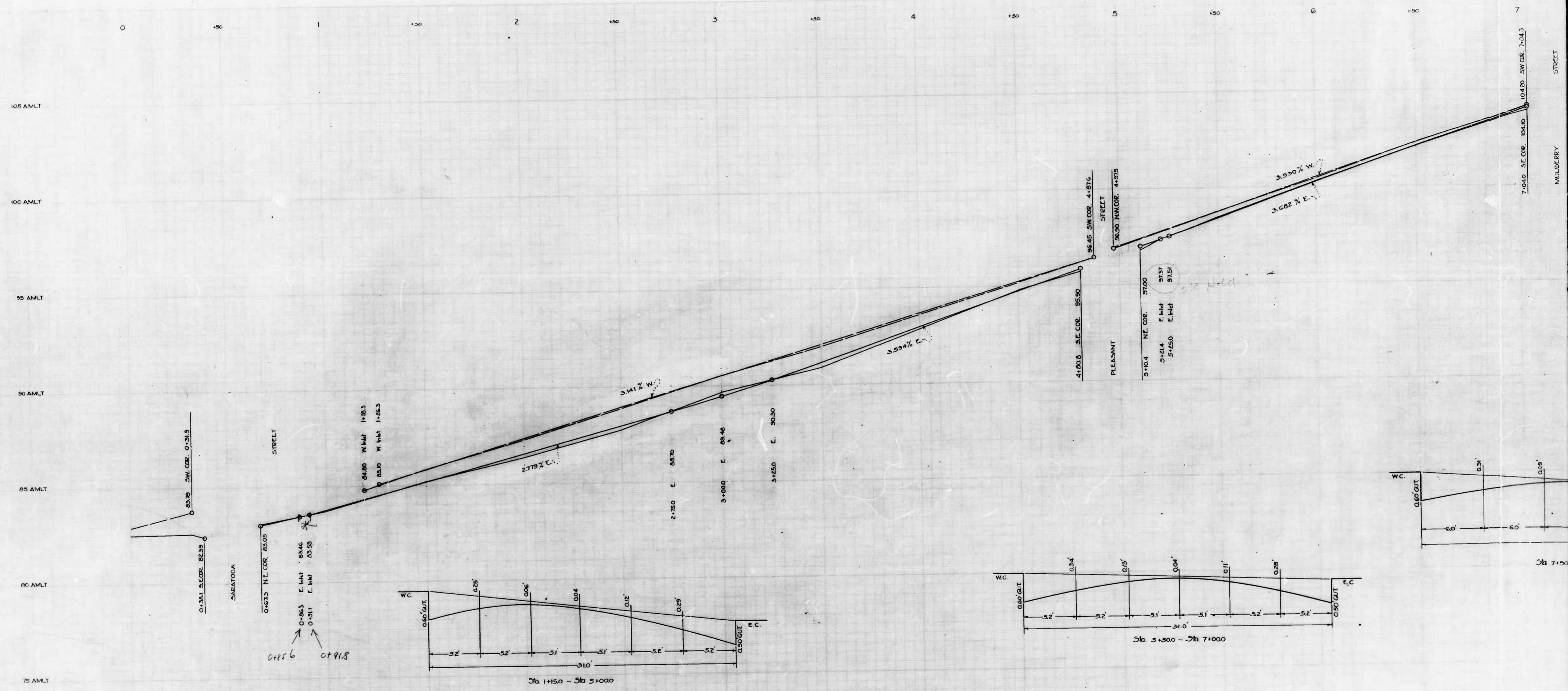

DRAWN BY: A. Grunert  
 CHECKED BY: H. Rosenberg

Sheet 1

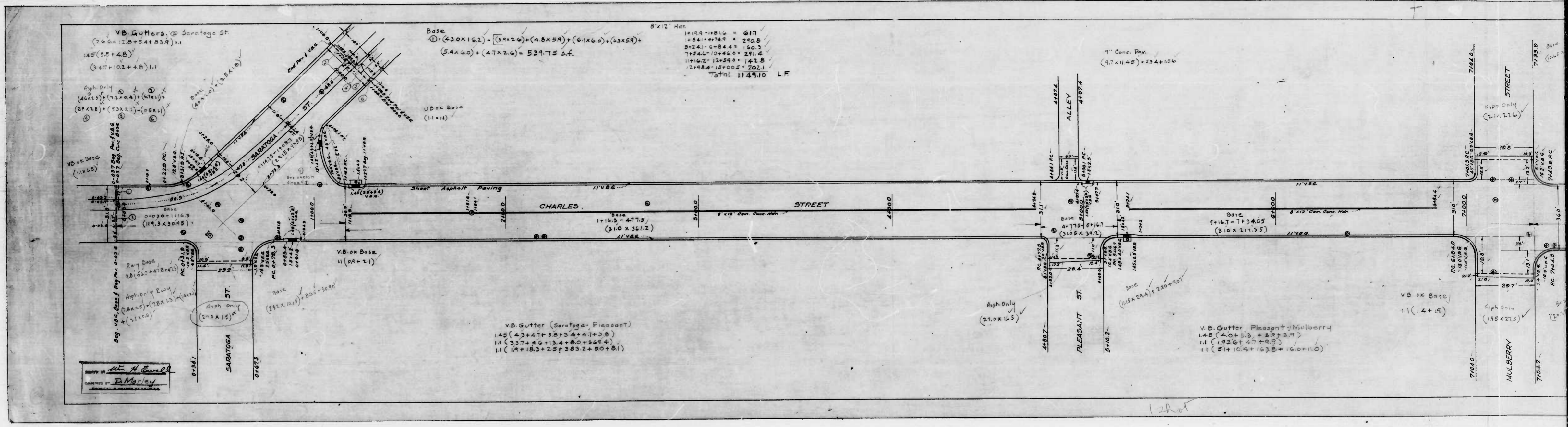

DESIGNED BY *W. H. Connel*  
 CHECKED BY *D. Morley*

12/21

Profile of R.R. W. Drive Charles St North of Centre St

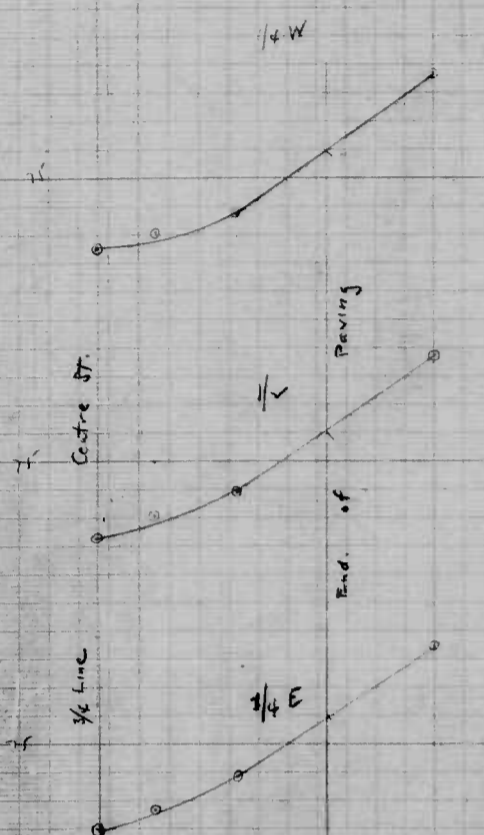

Profile of R.R. Saratoga St @ Charles St

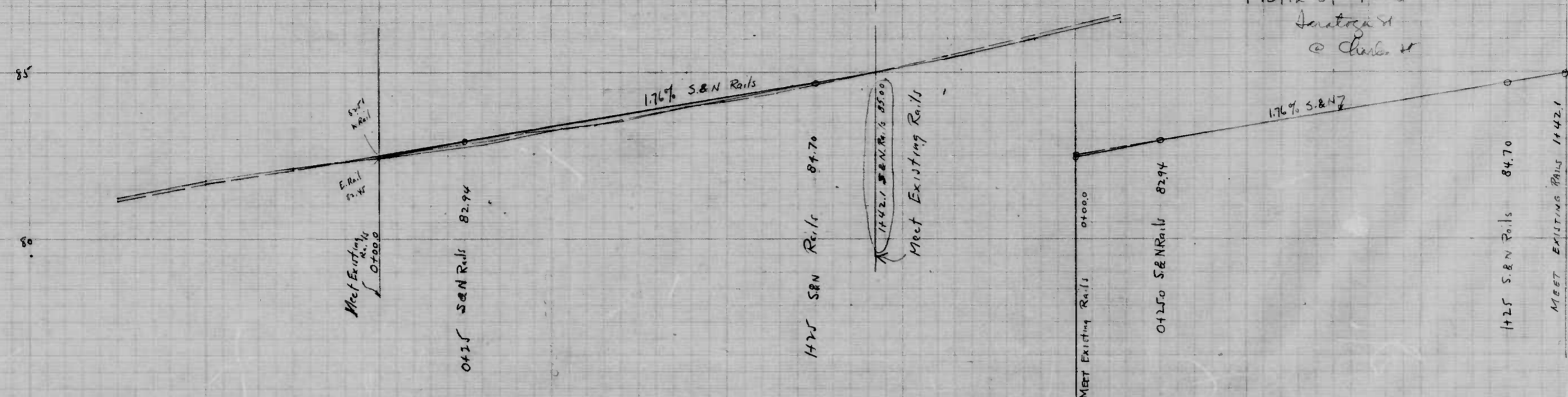

Profile of R.R. Saratoga St @ Charles St

Profile of R.R. E. Drive Charles St North of Centre St

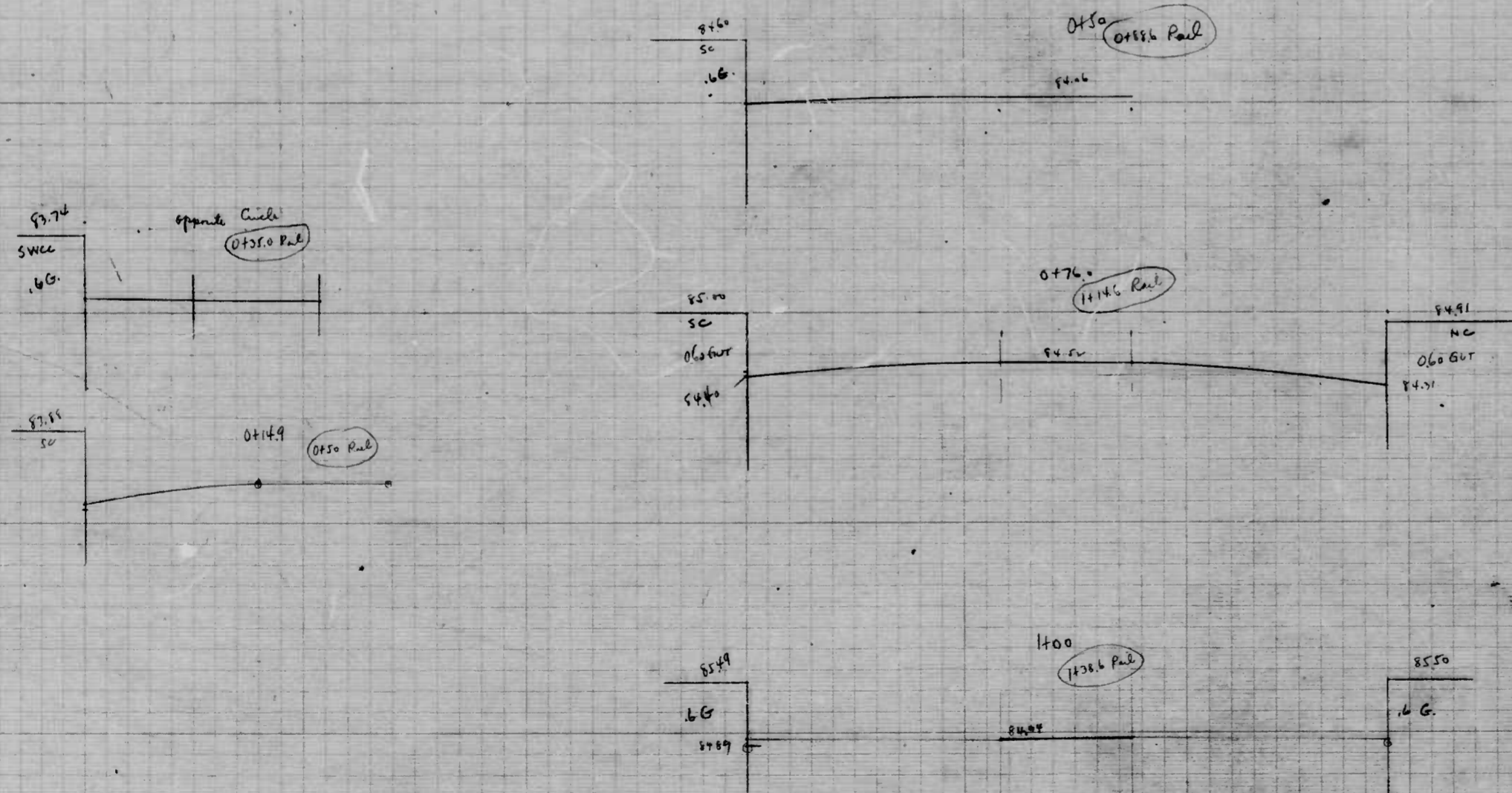
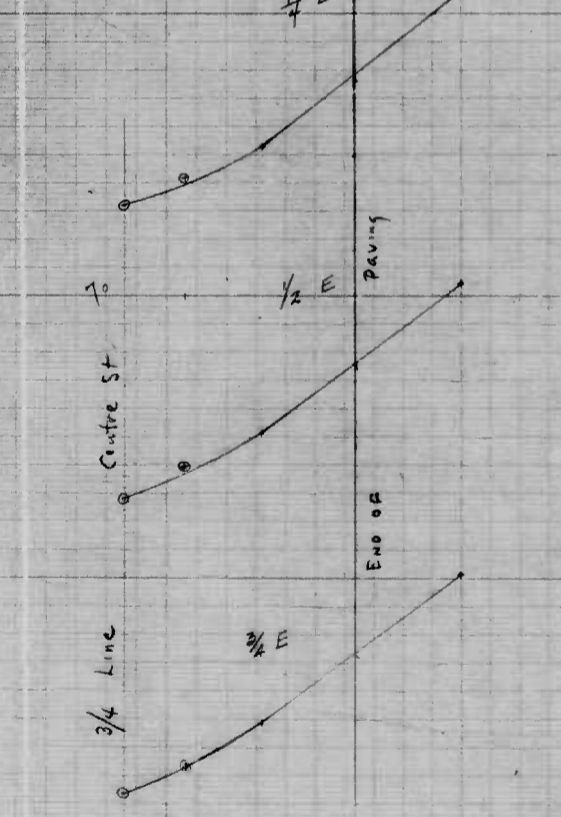

Sections

2 sheets

PRINTED IN U.S.A. ON 100% RECYCLED PAPER MADE IN U.S.A.

PRINTED IN U.S.A. ON 100% RECYCLED PAPER MADE IN U.S.A.

PRINTED IN U.S.A. ON 100% RECYCLED PAPER MADE IN U.S.A.

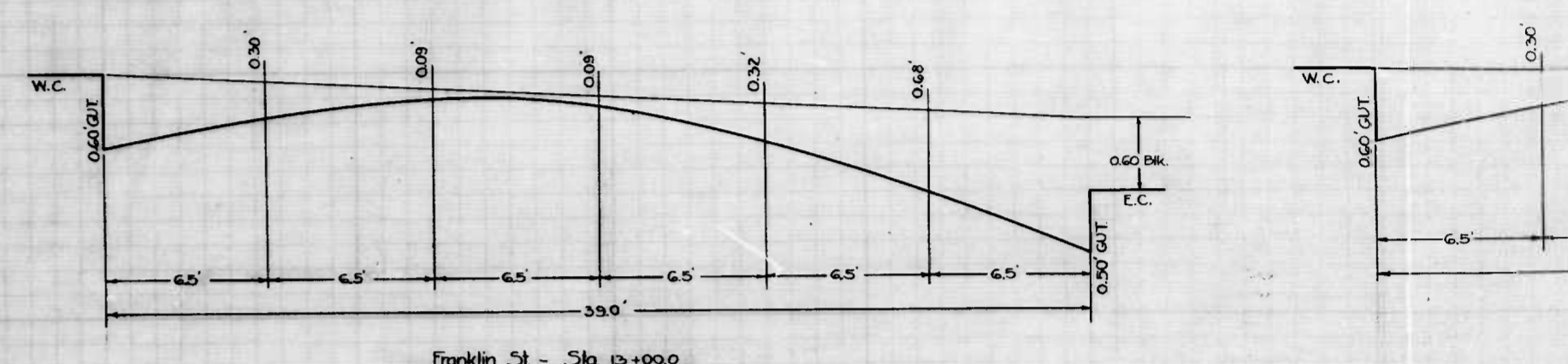
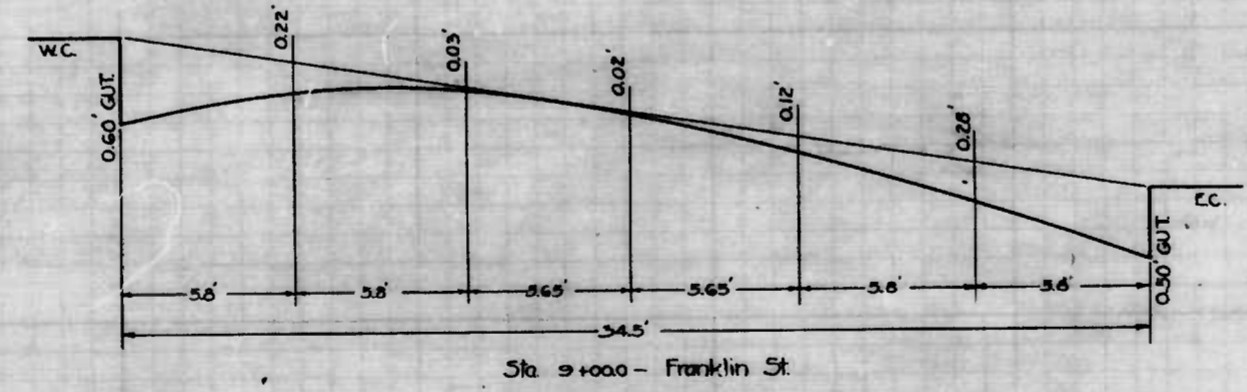
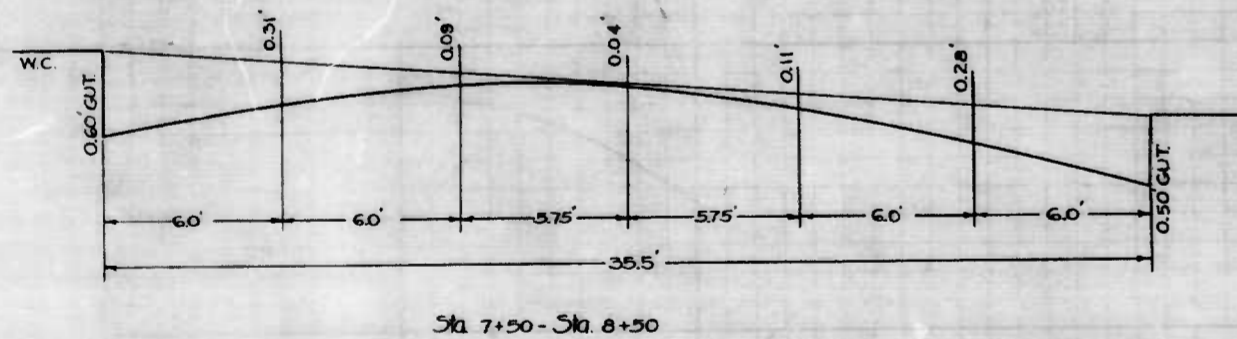
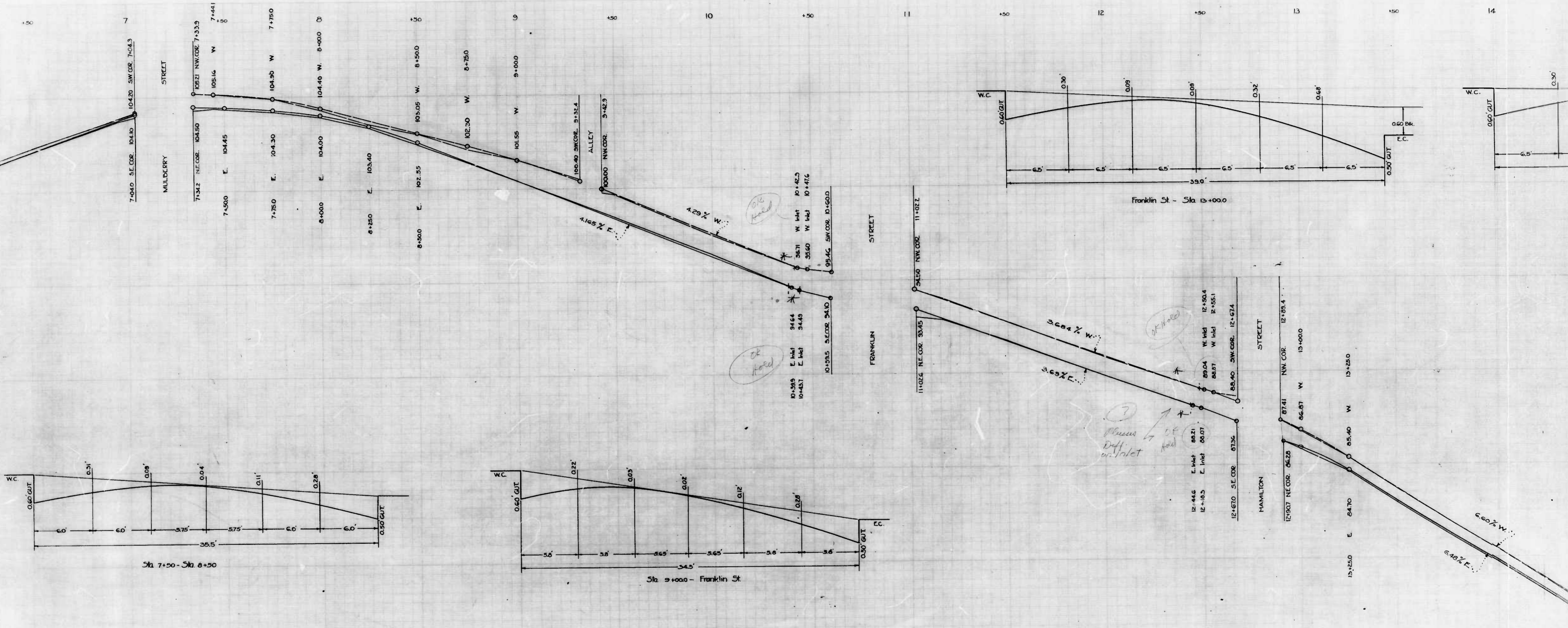

Planned Diff. on Inlet

shot =



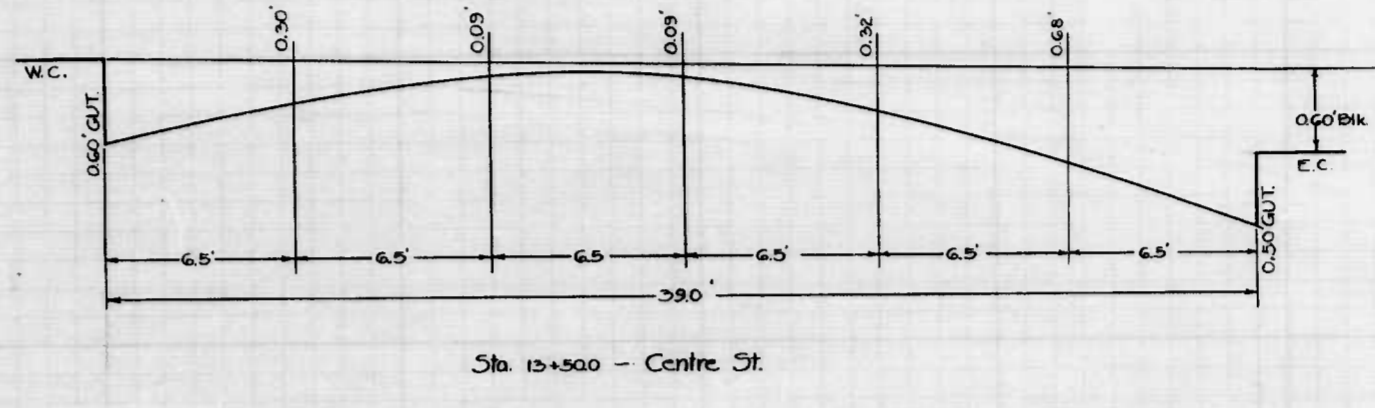
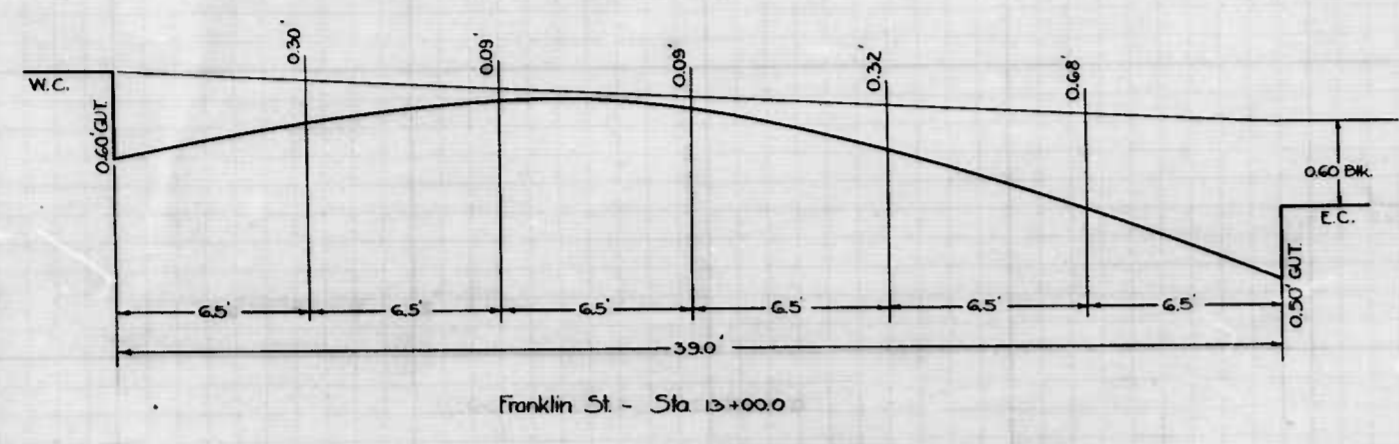
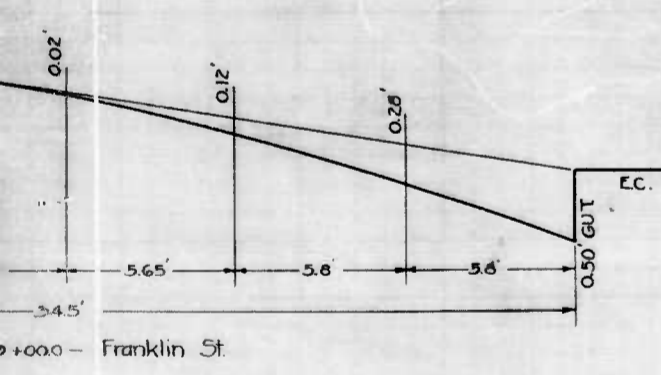
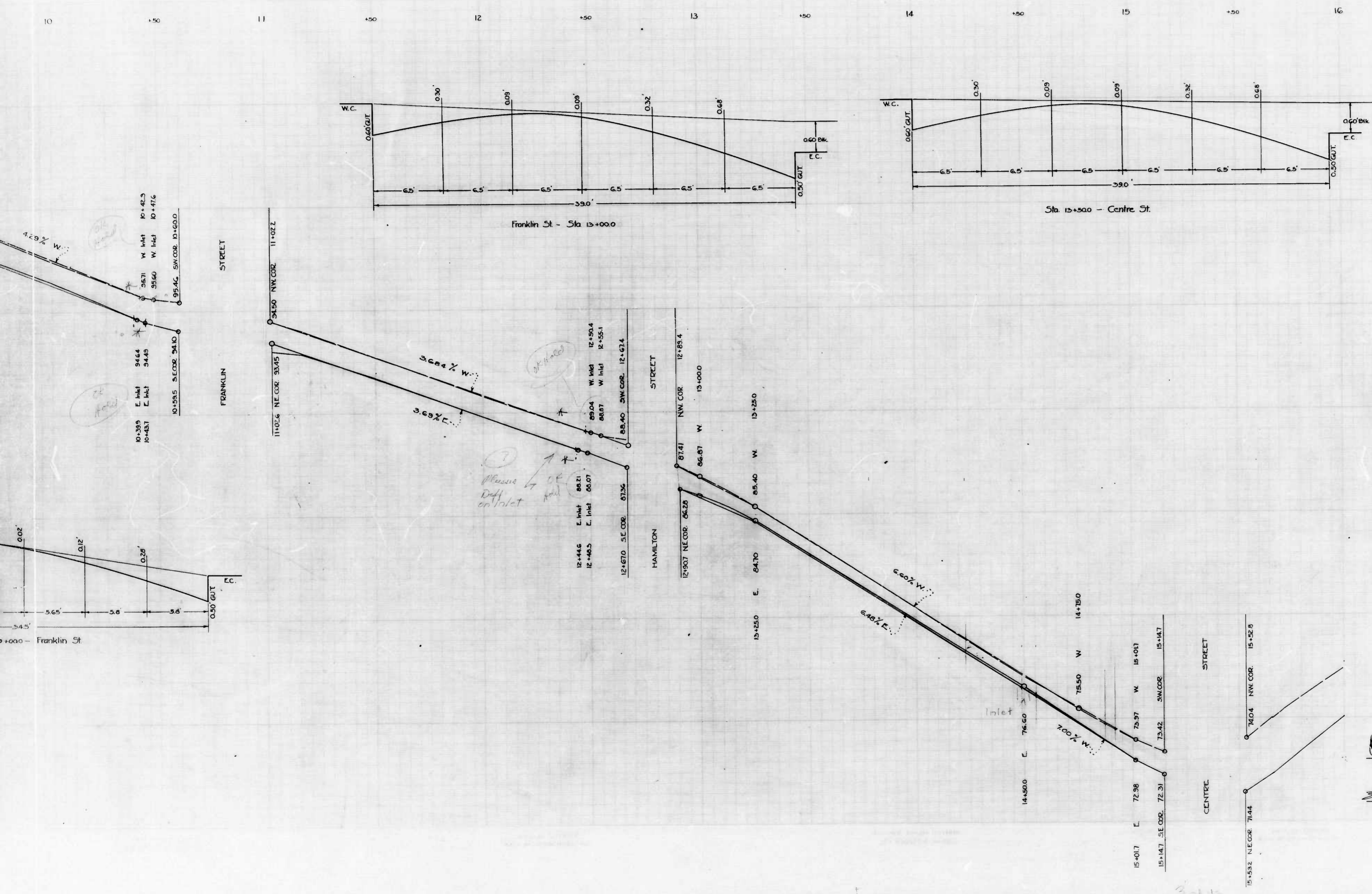

CITY OF BALTIMORE  
 DEPARTMENT OF PUBLIC WORKS  
 BUREAU OF HIGHWAYS  
 PROFILE OF  
 CHARLES ST - SARATOGA ST - CENTRE ST  
 CONT. N<sup>o</sup> 749  
 SCALE: HOR - 1" = 20.0'    BOOK N<sup>o</sup> X-143  
 VER - 1" = 2.0'    JUNE 3, 1941.

CORRECTED: *J.P. Gray* ASSOCIATE ENGINEER  
 APPROVED: *George Albert* HIGHWAYS ENGINEER  
 APPROVED: *Edward H. Medley* ENG. PLANNING SURVEYS DIV.  
 APPROVED: *George Cobb* CHIEF ENGINEER



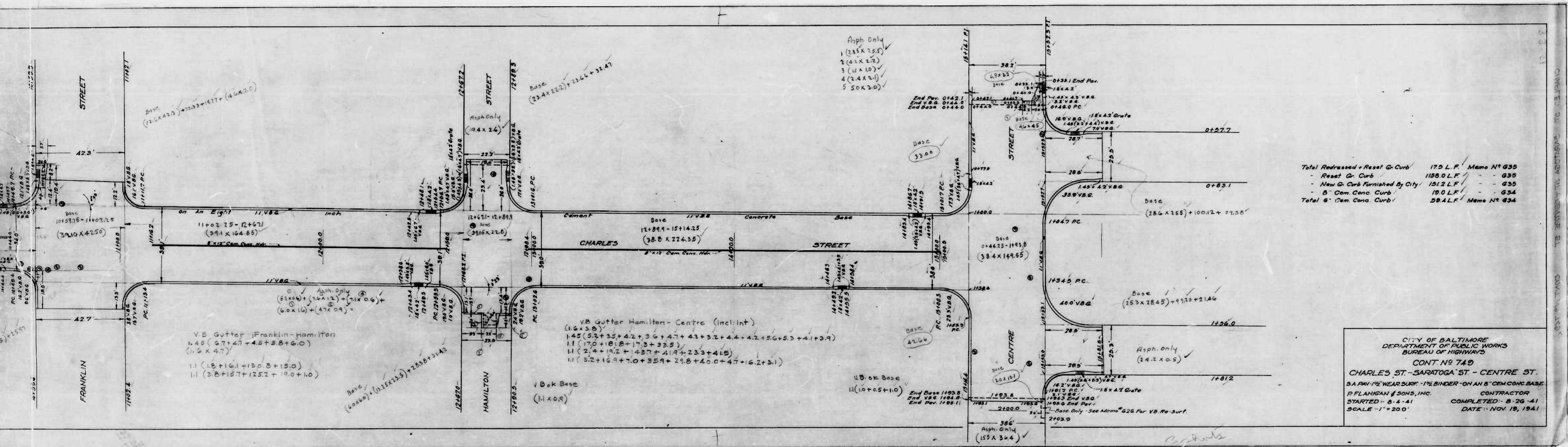

Total Redressed - Reset Gr. Curb	170 L.F.	Memo N° 635
- Reset Gr. Curb	1180 L.F.	- 635
- New Gr. Curb Furnished By City	1512 L.F.	- 635
- 6" Cem Conc. Curb	19 L.F.	- 634
Total 6" Cem Conc. Curb	59 L.F.	Memo N° 634

CITY OF BALTIMORE  
 DEPARTMENT OF PUBLIC WORKS  
 BUREAU OF HIGHWAYS  
 CONT. NO. 749  
 CHARLES ST. - SARATOGA ST. - CENTRE ST.  
 3/4" P.V. WEAR SURF - 1 1/2" BINDER - ON AN 8" CEM. CONC. BASE  
 P. FLANGAN & SONS, INC. CONTRACTOR  
 STARTED - 8-4-41 COMPLETED - 8-26-41  
 SCALE - 1" = 20' DATE - NOV. 19, 1941

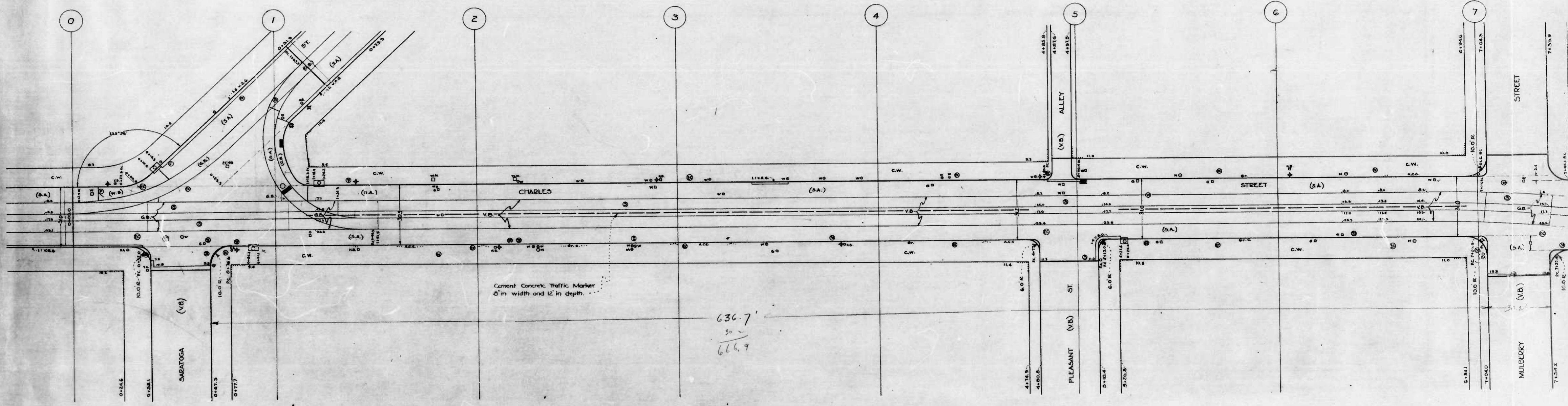

DESIGNED BY A. Gronert  
 DRAWN BY H. Heston  
 ENGINEER IN CHARGE OF DRAWING

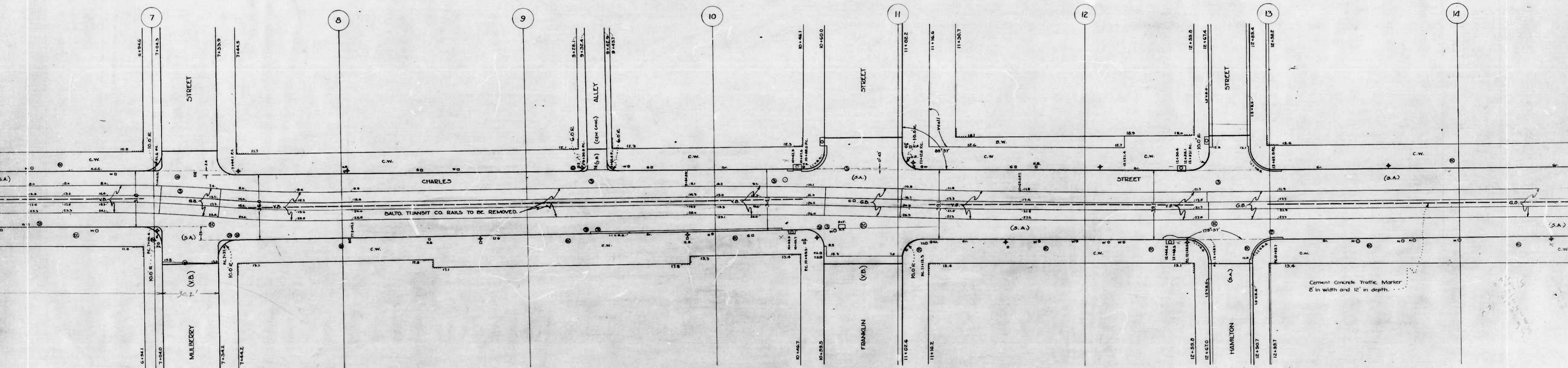

2 sheets

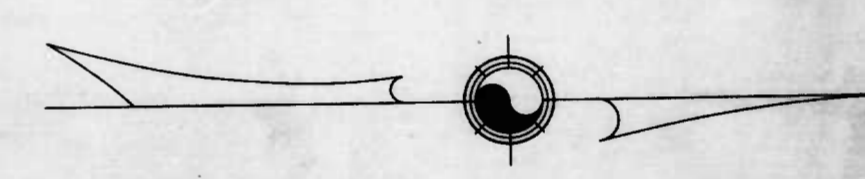
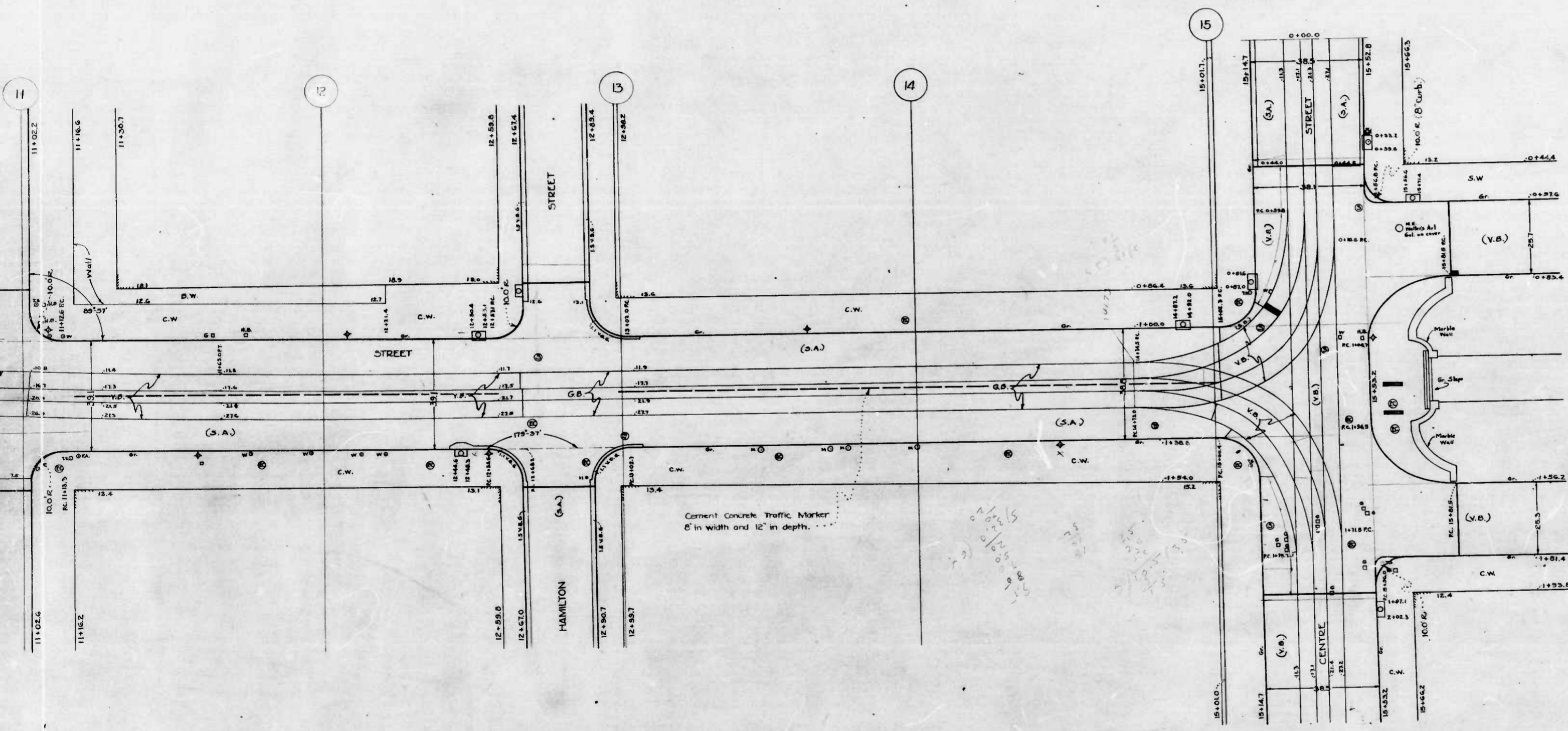

CITY OF BALTIMORE  
 DEPARTMENT OF PUBLIC WORKS  
 BUREAU OF HIGHWAYS  
 LAYOUT OF  
 CHARLES ST - SARATOGA ST TO CENTRE ST  
 CONT. N<sup>o</sup> 749  
 SCALE: 1" = 20.0' BOOK N<sup>o</sup> X-143  
 JUNE 3, 1941.

APPROVED: *George Call* CHIEF ENGINEER  
 APPROVED: *Edward H. Hester* ENGR. - PLANS & SURVEYS  
 CORRECT: *John R. Kestner* ASSOCIATE ENGINEER  
 APPROVED: *John R. Kestner* HIGHWAYS EN