

745/746

RATIO - 24 No. 2

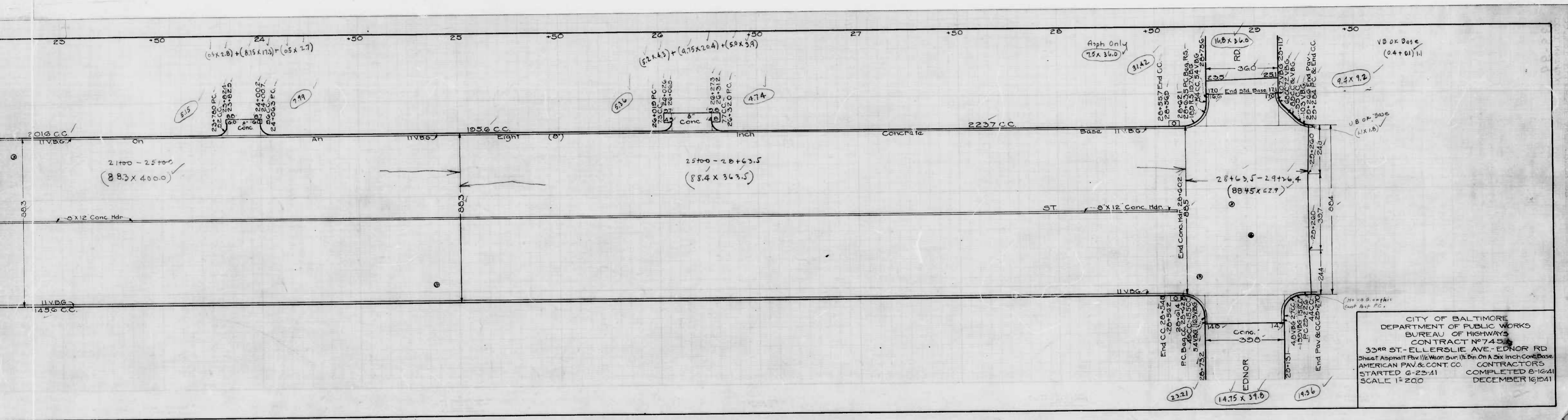

CITY OF BALTIMORE
 DEPARTMENT OF PUBLIC WORKS
 BUREAU OF HIGHWAYS
 CONTRACT NO. 745
 33RD ST. - ELLERSLIE AVE. - EDNOR RD.
 Sheet Asphalt Pav. 1/2" Worn Sur. 1/2" On A Six Inch Conc. Base
 AMERICAN PAV. & CONT. CO. CONTRACTORS
 STARTED 6-23-41 COMPLETED 6-16-41
 SCALE 1" = 200' DECEMBER 16, 1941

745/746

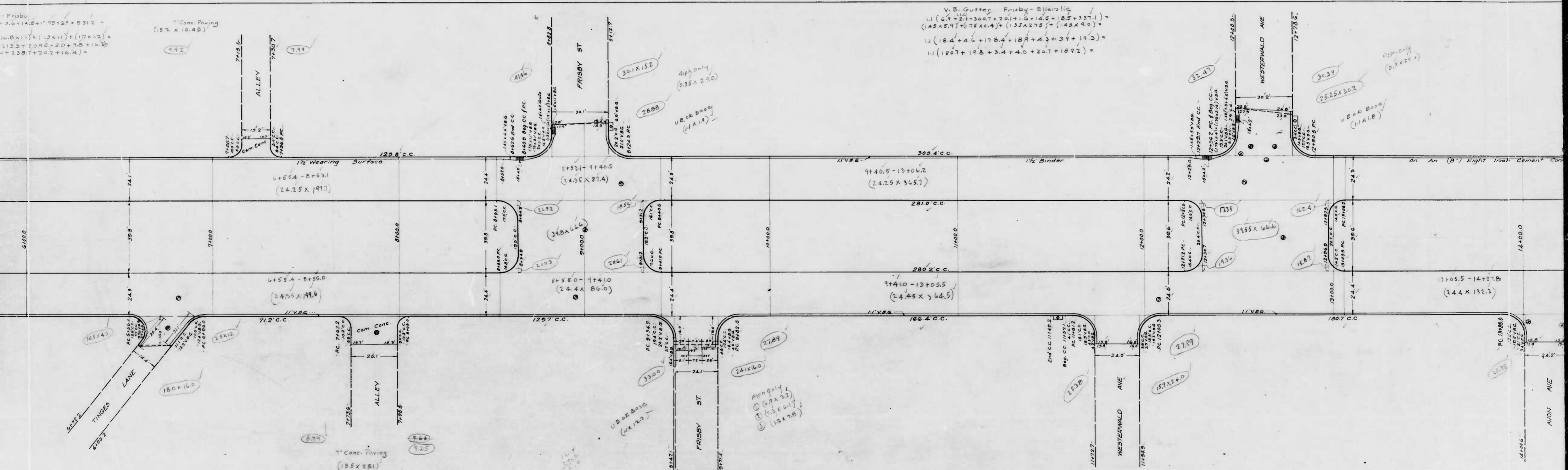

V. B. Gutley Frisby - Ellerlie
 $1.1 (2.9 \times 3.1 + 300.7 + 201 + 1.6 + 14.6 + 18.5 + 337.1) =$
 $(1.45 \times 5.9) + (7.5 \times 0.4) + (1.37 \times 27.5) + (1.43 \times 9.0) =$
 $1.1 (18.4 + 4.6 + 17.8 + 18.9 + 4.3 + 3.9 + 19.5) =$
 $1.1 (180.7 + 19.8 + 2.4 + 4.0 + 20.7 + 18.92) =$

Asph Only
 ① (6.9 x 3.2)
 ② (3.3 x 6.1)
 ③ (12.2 x 7.6)

2nd sheet

745/746

RATIO - 24 No.

4

V.B. Gutter Frisby-Ellerslie
 $11(6.4+2.7+300.7+20.1+1.6+14.5+18.5+33.1) =$
 $(4.5 \times 5.9) + (0.75 \times 0.4) + (1.3 \times 2.75) + (1.42 \times 9.0) =$
 $11(6.4+2.6+17.64+18.9+4.3+3.9+19.3) =$
 $11(120.7+19.8+3.4+4.0+20.7+18.92) =$

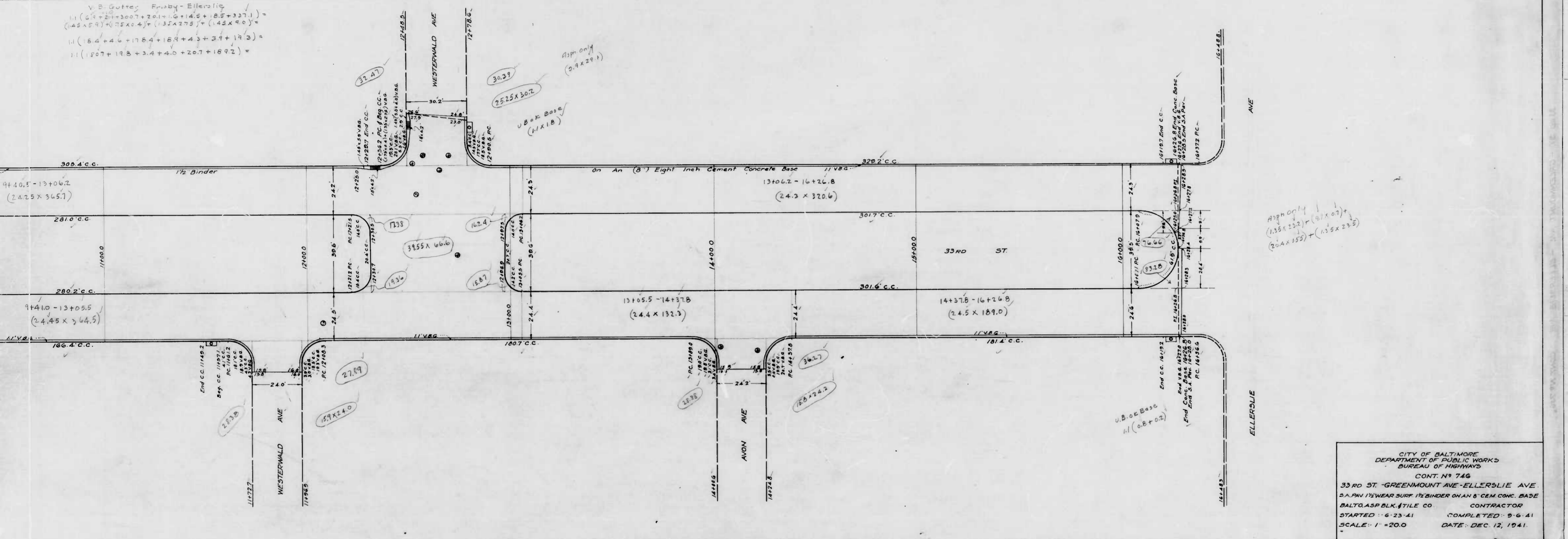

CITY OF BALTIMORE
 DEPARTMENT OF PUBLIC WORKS
 BUREAU OF HIGHWAYS
 CONT. N^o 746
 33 RD ST - GREENMOUNT AVE - ELLERSLIE AVE.
 3/4" PAV 1/2" WEAR SURF 1/2" BINDER ON AN 8" CEM. CONC. BASE
 BALTO. ASP. BLK. TILE CO. CONTRACTOR
 STARTED 11-6-23-41 COMPLETED 9-6-41
 SCALE: 1" = 20.0' DATE: DEC. 12, 1941.

745/746

RATIO - 24 No. 1

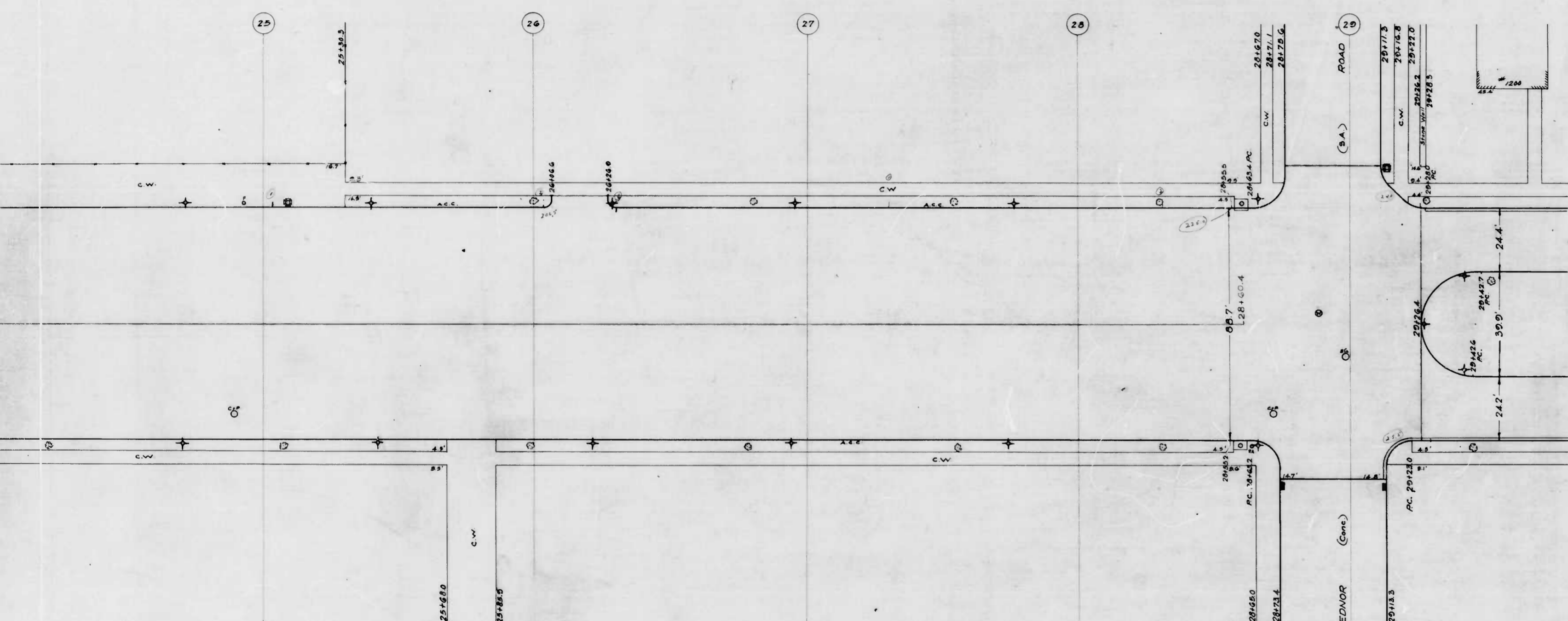

CITY OF BALTIMORE
 DEPARTMENT OF PUBLIC WORKS
 BUREAU OF HIGHWAYS
 PLAN OF
 33RD ST-ELLERSLIE AVE-EDNOR RD.
 SCALE: 1"=20.0' BOOK NO. X-145A
 CONT. NO. 745 DATE: APR. 1, 1941

CORRECT
Edw. J. Richardson
 ASSOCIATE ENGINEER
 APPROVED
 ENGR. PLANS & SURVEYS

APPROVED
George P. Kelly
 HIGHWAY ENGINEER
 APPROVED
 CHIEF ENGINEER

33RD ST-ELLERSLIE AVE - EDNOR ROAD
 33RD ST-ELLERSLIE AVE - EDNOR ROAD
 PLAN OF
 CONT. NO. 745

sheet 3

745/746

RATIO - 24 No. **2**

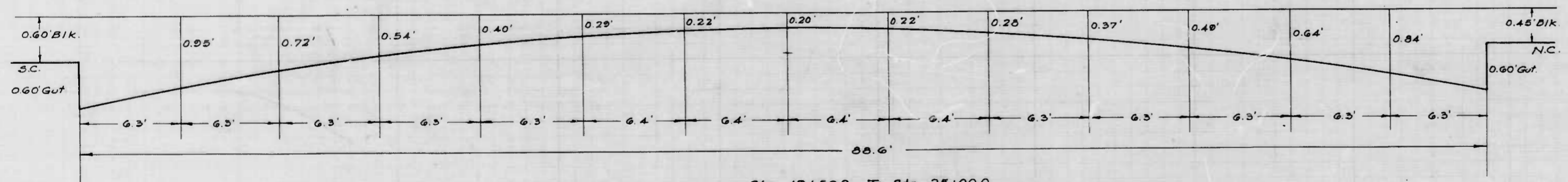
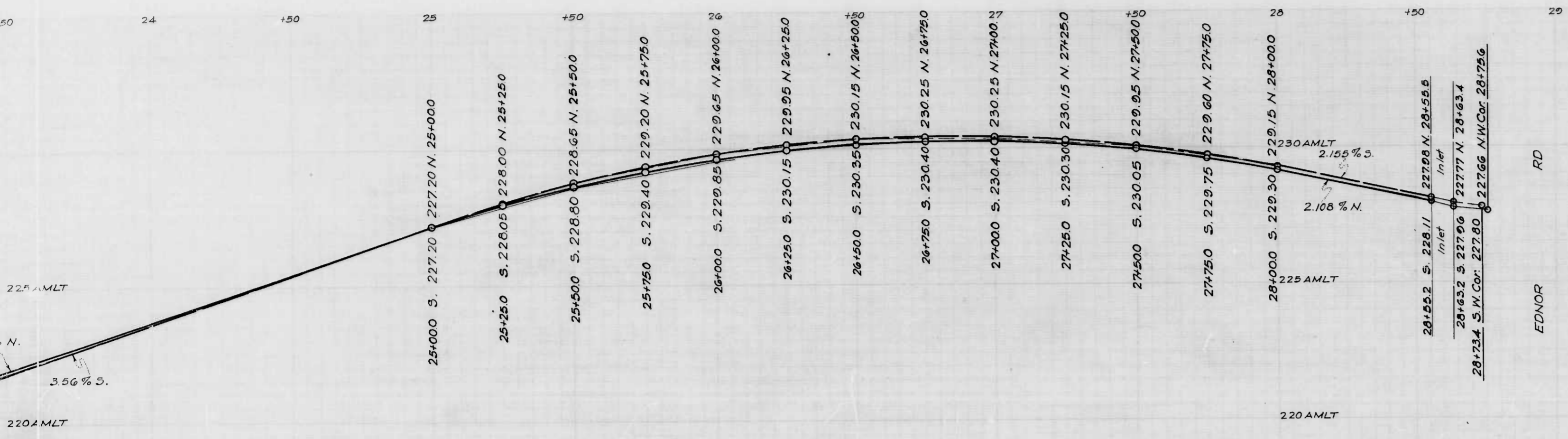

Sta. 19+50.0 To Sta. 25+00.0
Sta. 25+20.0 To EDNOR RD. (Section Reversed)

CITY OF BALTIMORE
DEPARTMENT OF PUBLIC WORKS
BUREAU OF HIGHWAYS
PROFILE OF
33 RD ST - ELLERSLIE AVE.-EDNOR RD.
SCALE: HOR. 1" = 20' BOOK N° X-145A
VER. 1" = 20' DATE: APRIL 5, 1941
CONT. N° 745

CORRECT APPROVED
Wm. K. ... *George A. ...*
ASSOCIATE ENGINEER HIGHWAYS ENGINEER
APPROVED APPROVED
Edward ... *James ...*
ENGR. PLANS & SURVEYS CHIEF ENGINEER

Sheet 4

Sheet 5

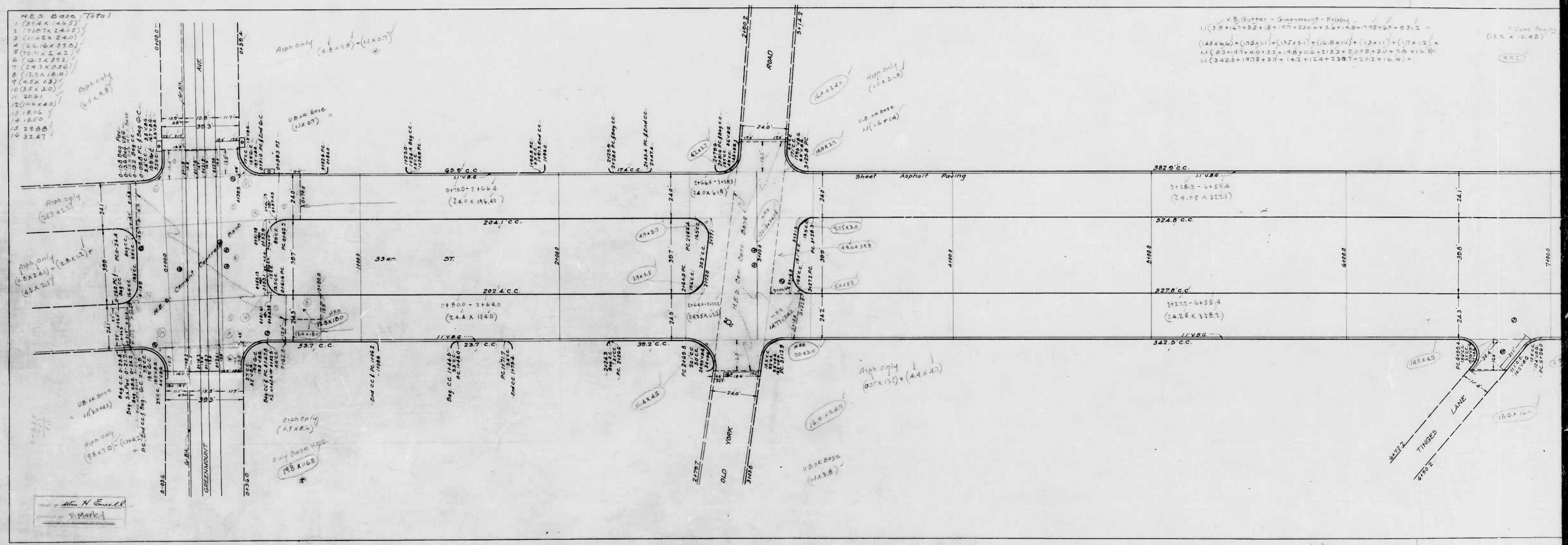

V.B. Gutter - Greenmount - Frisby
 $11(3.8+1.67+5.5+1.8+1.7+2.20+3.6+1.48-1.95-2.9-5.31) =$
 $(4.8 \times 6.6) + (1.5 \times 1.1) + (1.5 \times 3.1) + (1.6 \times 1.1) + (1.3 \times 1.1) + (1.7 \times 1.2) =$
 $11(8.3+1.7+4.0+3.2+1.87+0.6+2.13+2.08+2.0+1.8+1.63) =$
 $11(34.25+1.75+3.7+1.42+2.4+2.387+2.02+1.64) =$

- H.E.S. Base Total
- (39.4 x 4.65)
 - (71.07 x 2.40)
 - (11.62 x 2.40)
 - (66.16 x 3.90)
 - (70.7 x 2.42)
 - (10.3 x 3.93)
 - (2.3 x 2.56)
 - (12.3 x 1.80)
 - (4.5 x 1.3)
 - (3.5 x 3.0)
 - 20.61
 - (10.4 x 4.0)
 - 18.16
 - 15.50
 - 29.80
 - 32.47

H. H. Enell
 P. Mark

745/746

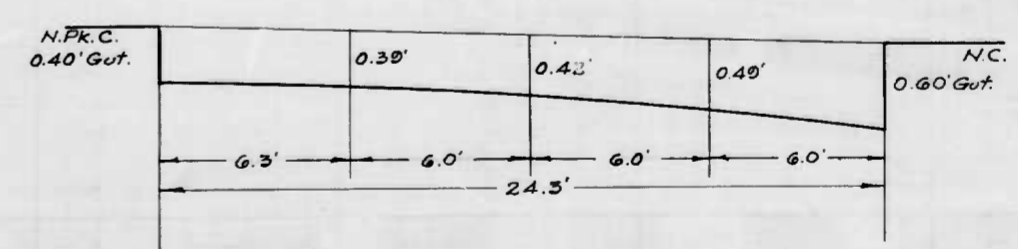
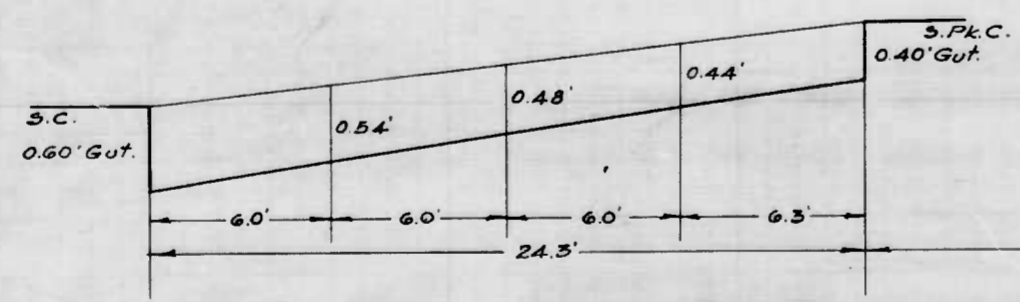
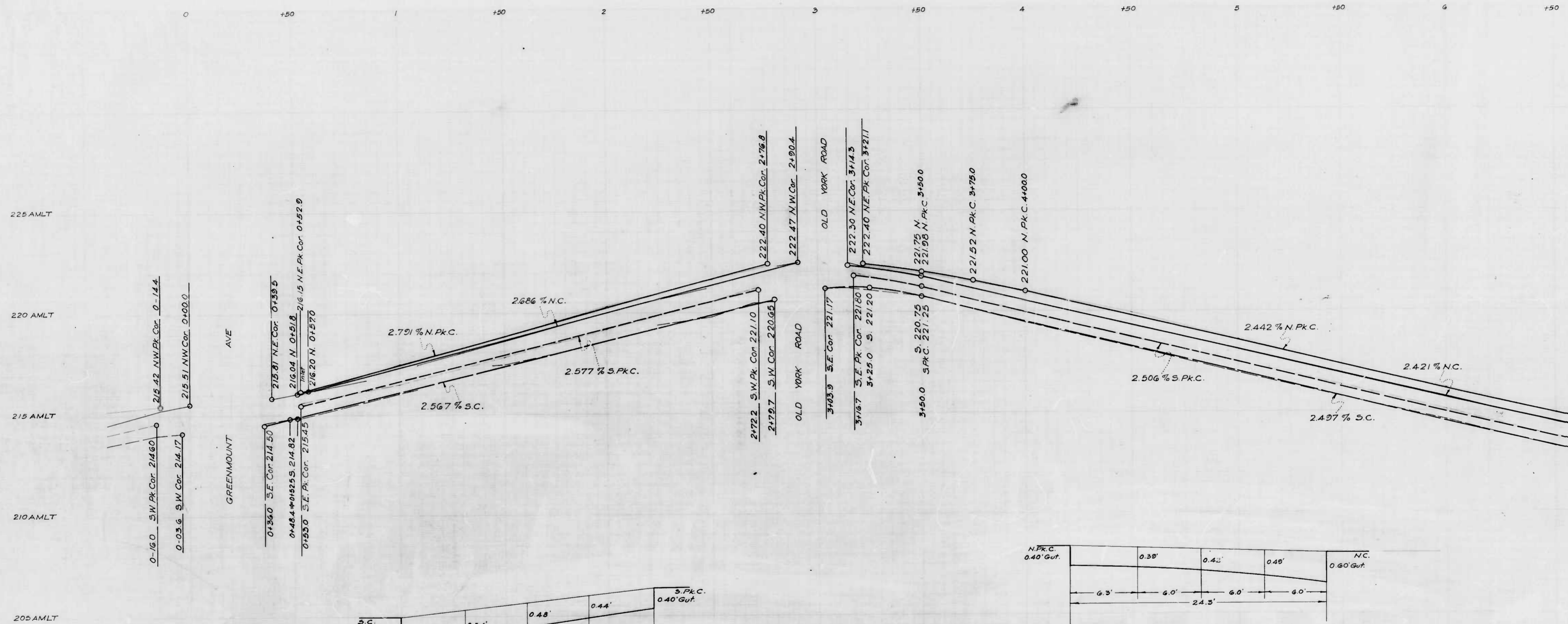

TYPICAL SECTION FOR DRIVES

DESIGNED BY *H. E. G. Smith*
 ENGINEER & SURVEYOR

shot 1

745/746

RATIO - 24

No.

1

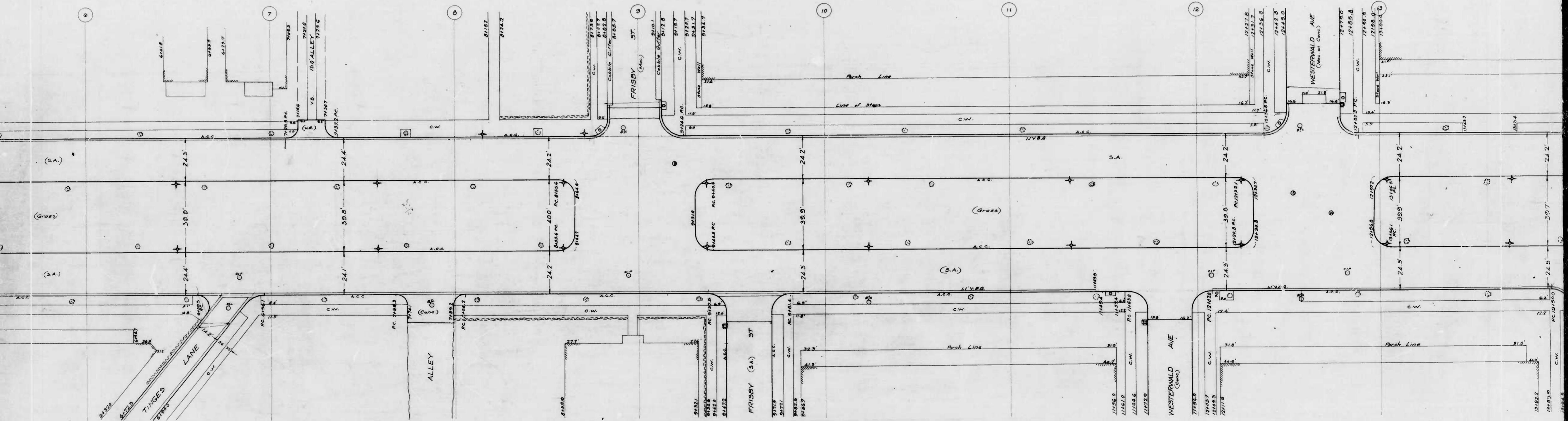

745/746

RATIO - 24 No. **2**

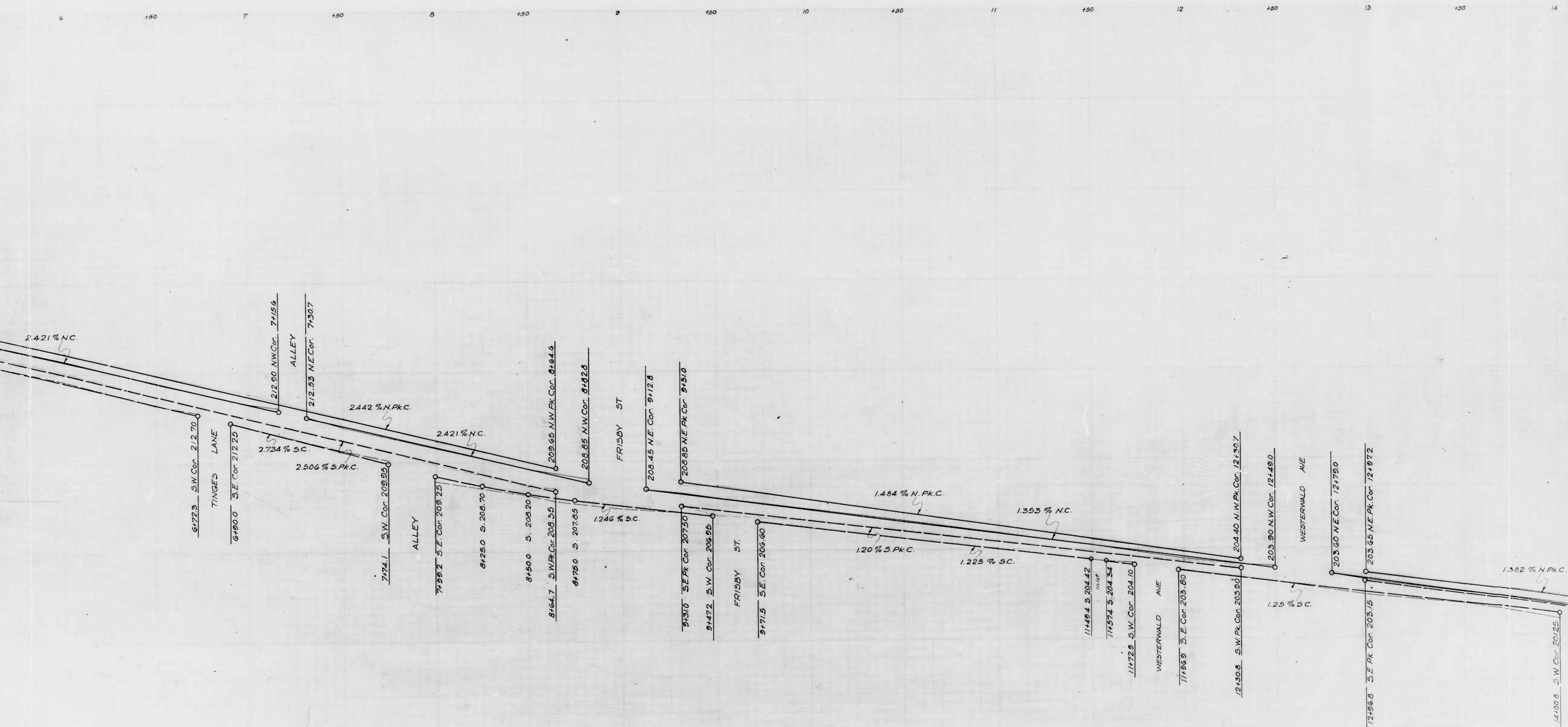

shot 2

745/746

RATIO - 24 No. **2**

+50 14 +50 15 +50 16 +50 17 +50 18 +50 19 +50 20 +50 21

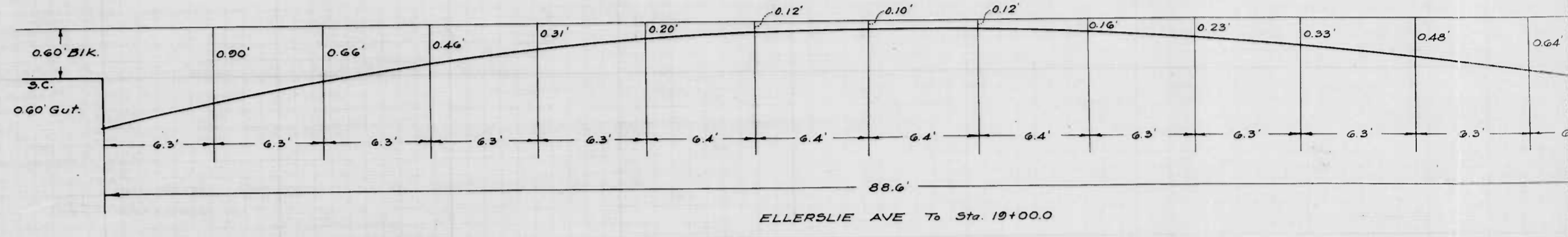

CITY OF BALTIMORE
DEPARTMENT OF PUBLIC WORKS
BUREAU OF HIGHWAYS

PROFILE OF
33 RD. ST. - GREENMOUNT AVE. - ELLERSLIE AVE

HOR. 1" = 200'
SCALE: VER. 1" = 20'

BOOK No. X-145A
DATE: MAY 4, 1941

CONT. No. 746

CORRECT APPROVED

Wm. H. Ewell *George C. Holt*
ASSOCIATE ENGINEER HIGHWAYS ENGINEER
APPROVED APPROVED

George C. Holt
ENGR. PLANS & SURVEYS CHIEF ENGINEER

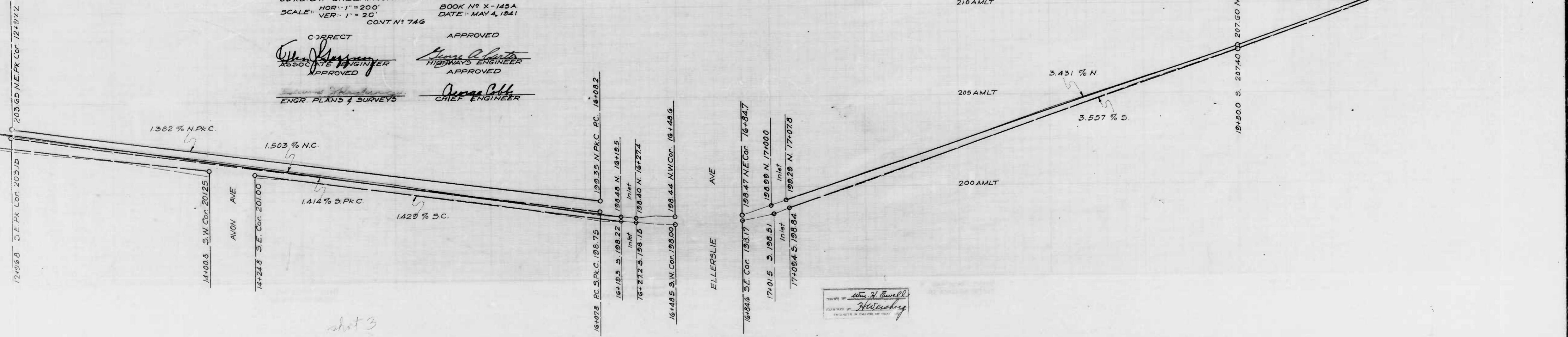

shot 3

Wm. H. Ewell
ENGINEER IN CHARGE OF TRAIL

745/746

RATIO - 24

No. **1**

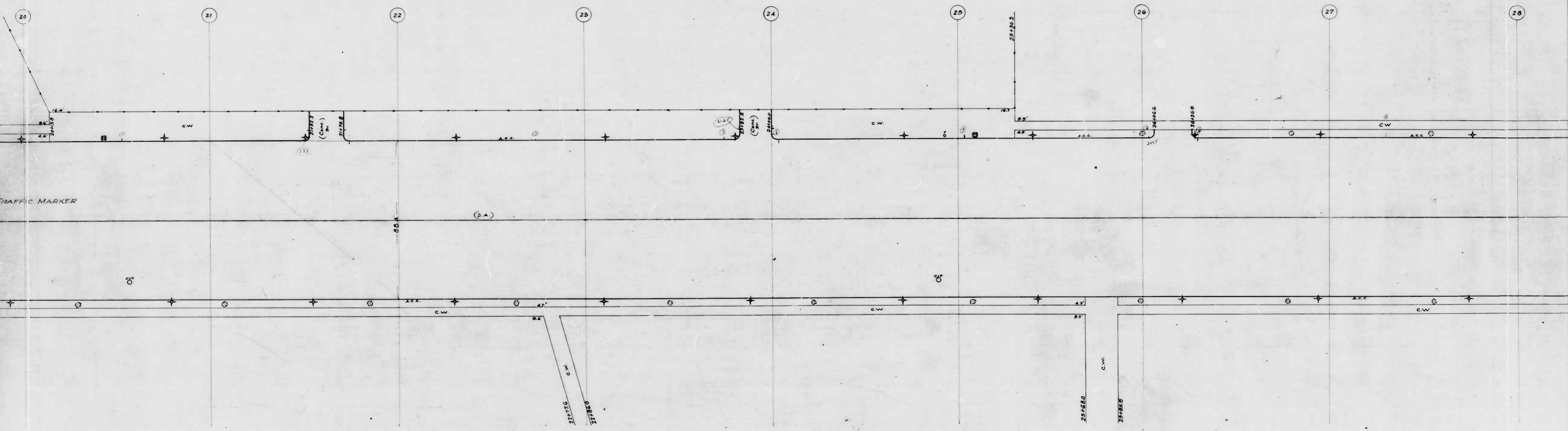

Sheet 4

745/746

RATIO - 24 No. **2**

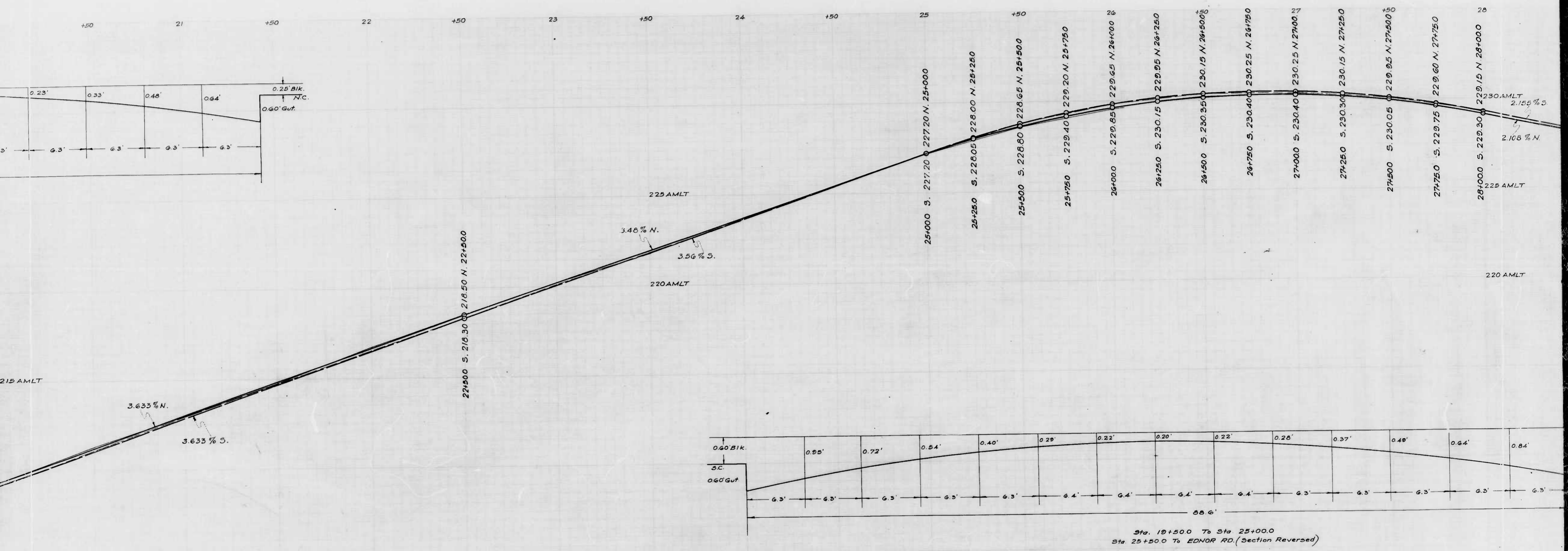

Sheet 4