

DRAWN BY *M. HAYDEN*
 EXAMINED BY *H. H. HAYDEN*
 ENGINEER IN CHARGE OF DRAWING

CITY OF BALTIMORE
 DEPARTMENT OF PUBLIC WORKS
 BUREAU OF HIGHWAYS
 PROFILE OF RAILWAY TRACKS
 MILTON AVE. - NORTH AVE. TO 270' SOUTH
 CONT. NO. 739
 SCALES - HOR. 1" = 20.0'
 VER. 1" = 2.0'
 FEB. 14, 1941
 CORRECTED BY *[Signature]*
 APPROVED BY *[Signature]*
 ASSOCIATE ENGINEER HIGHWAYS ENGINEER

3

5

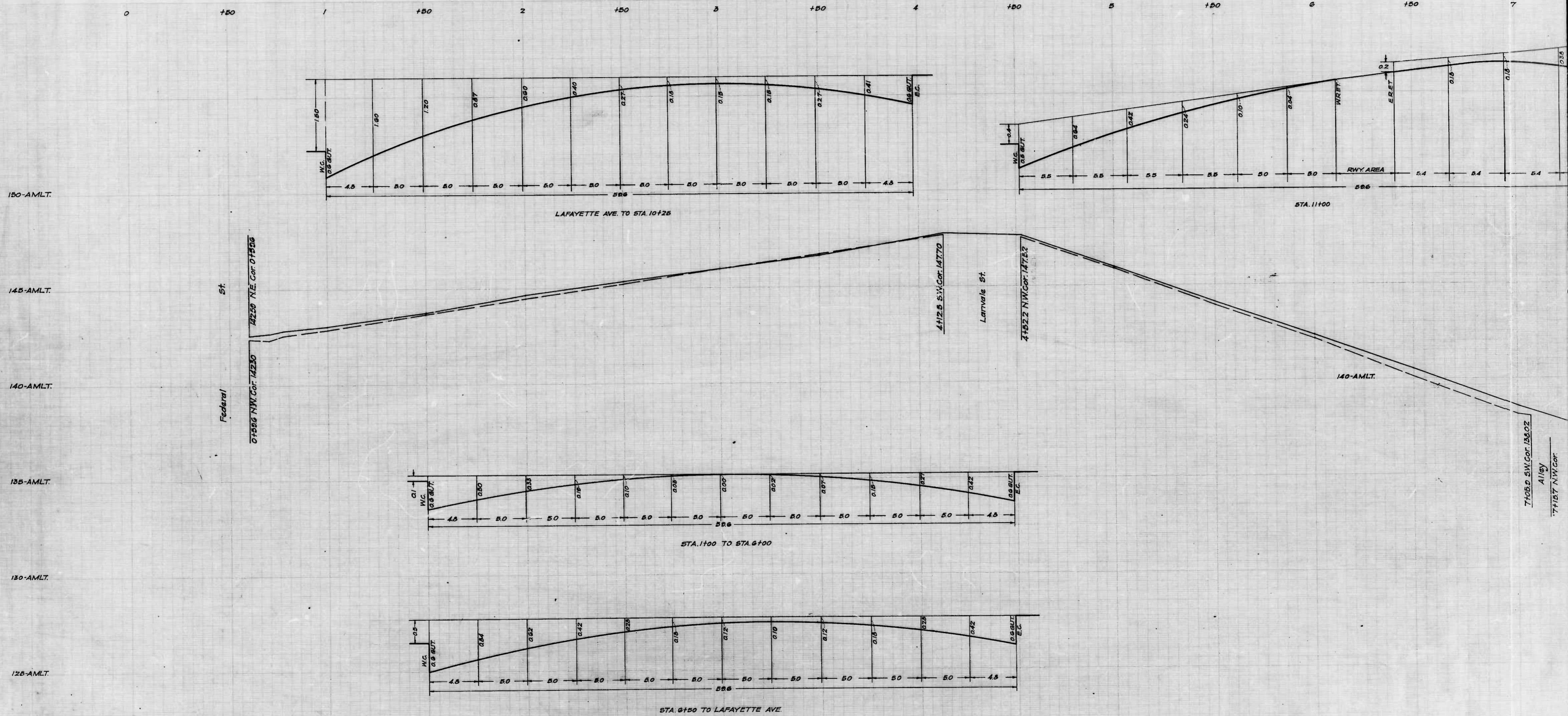

1st sheet

DRAWN BY J.J. HAYDEN
 EXAMINED BY *H. Steenberg*
 ENGINEER IN CHARGE OF DRAWING

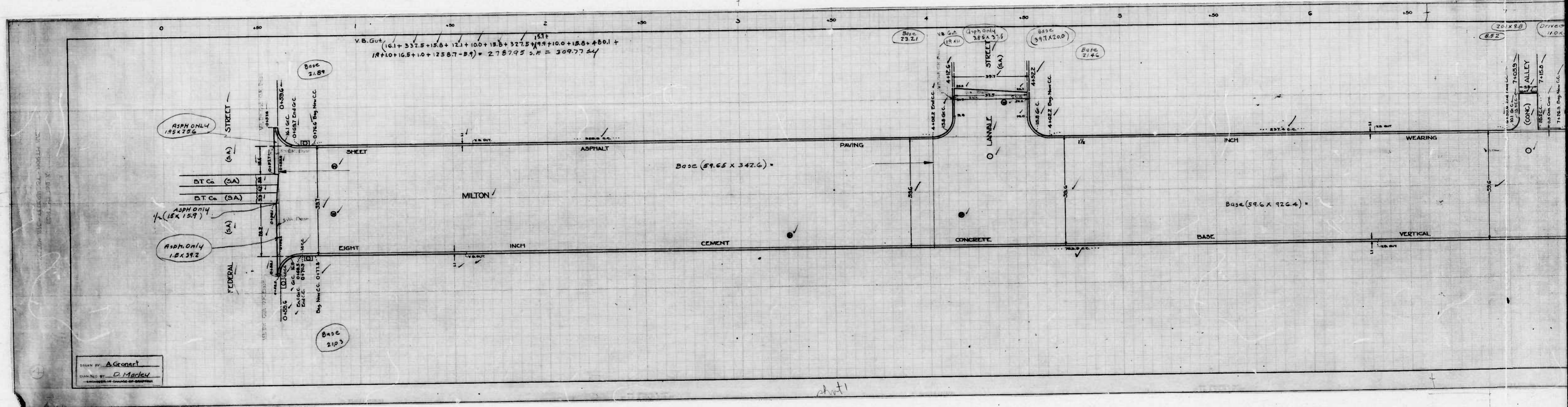

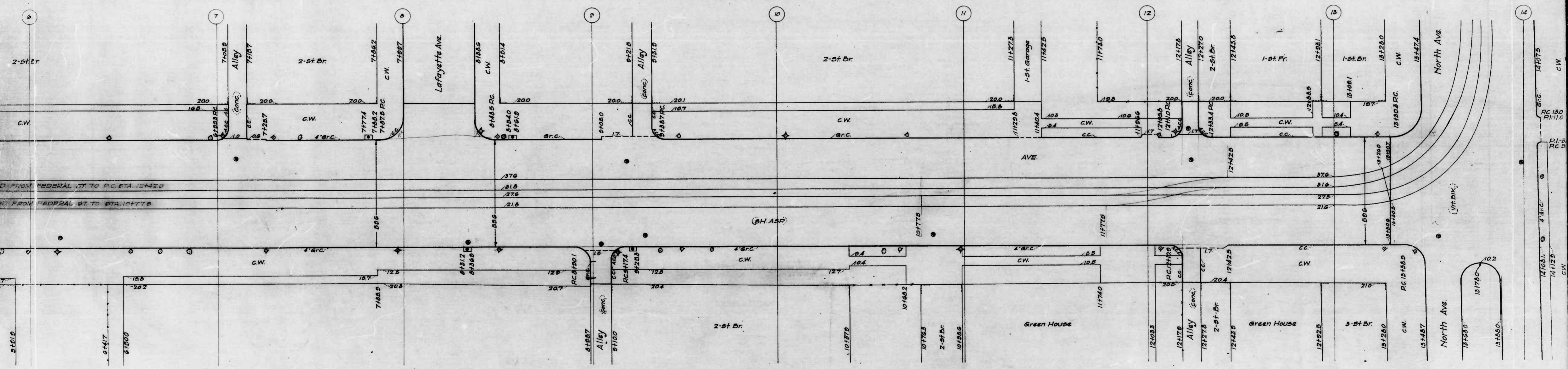

2nd shot

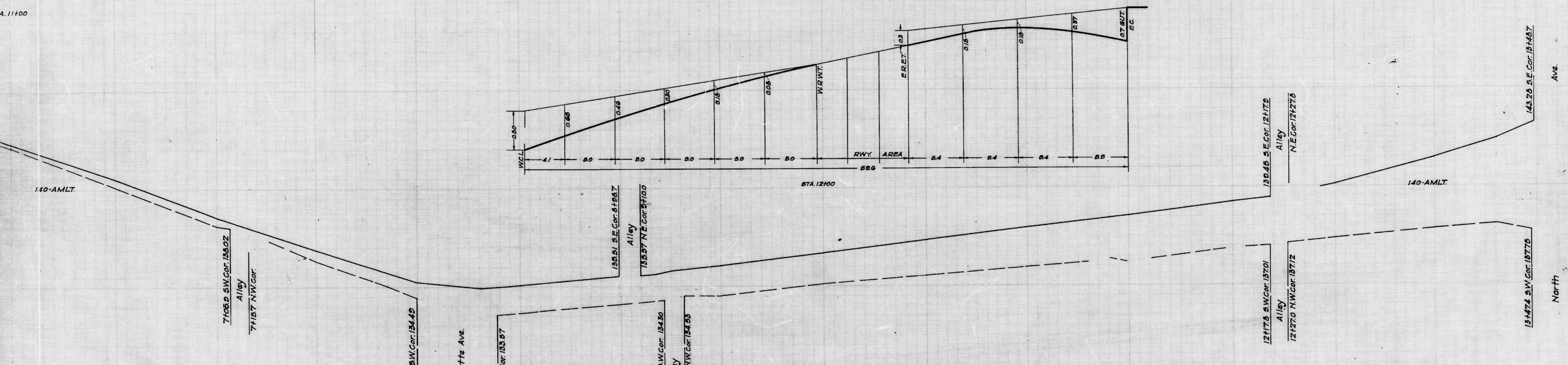
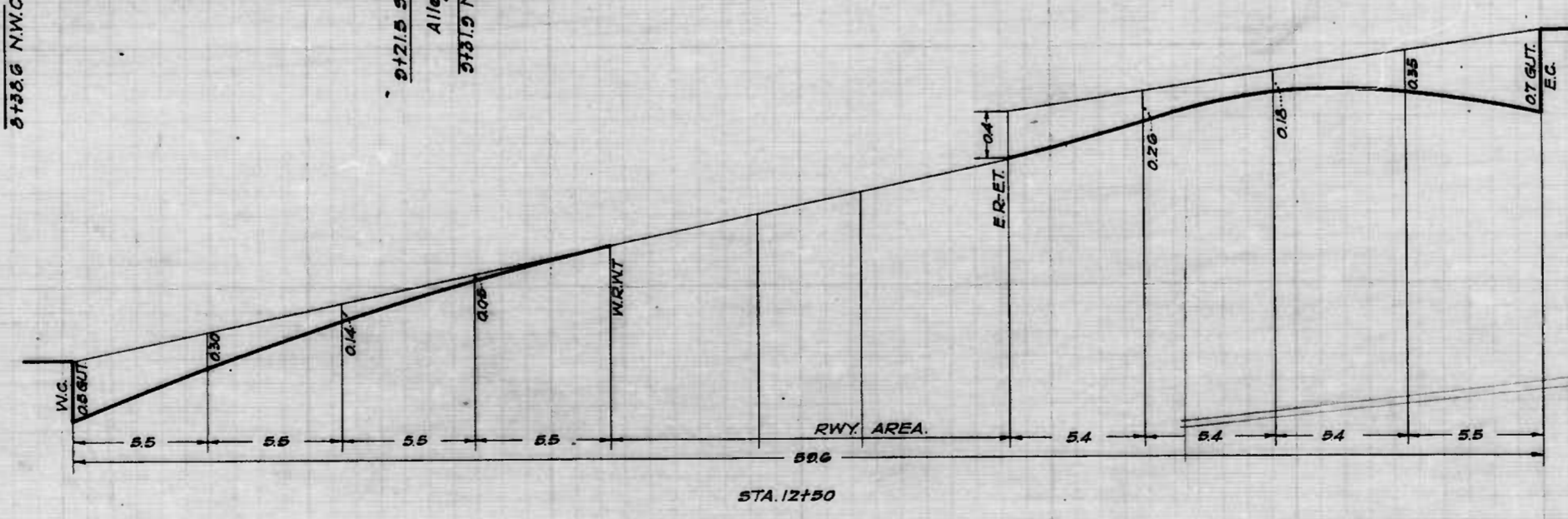
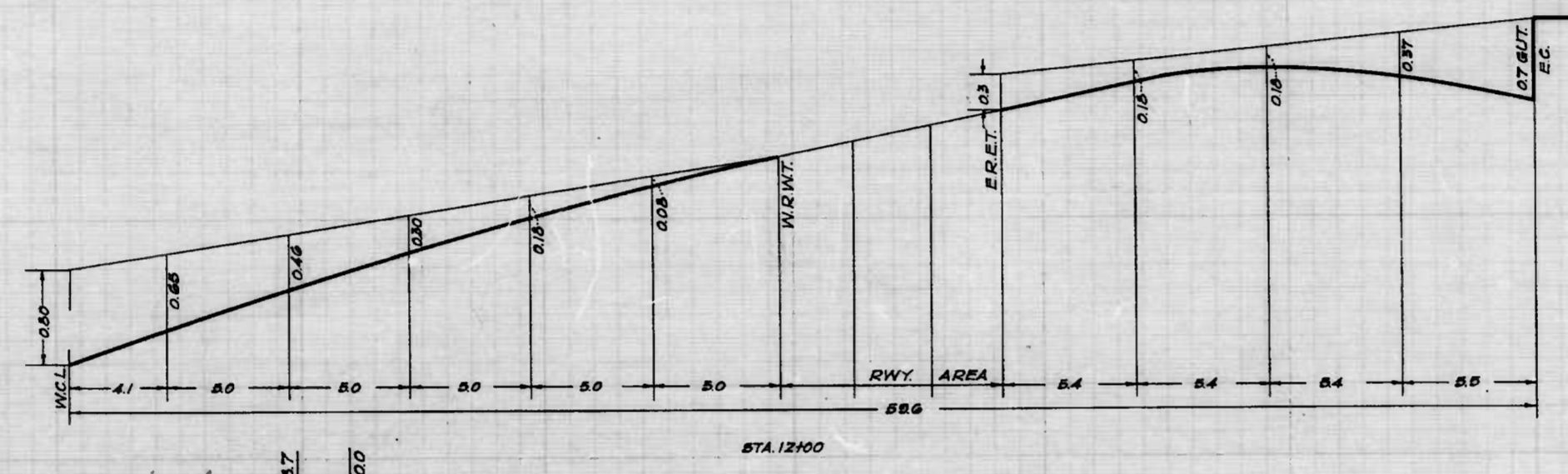
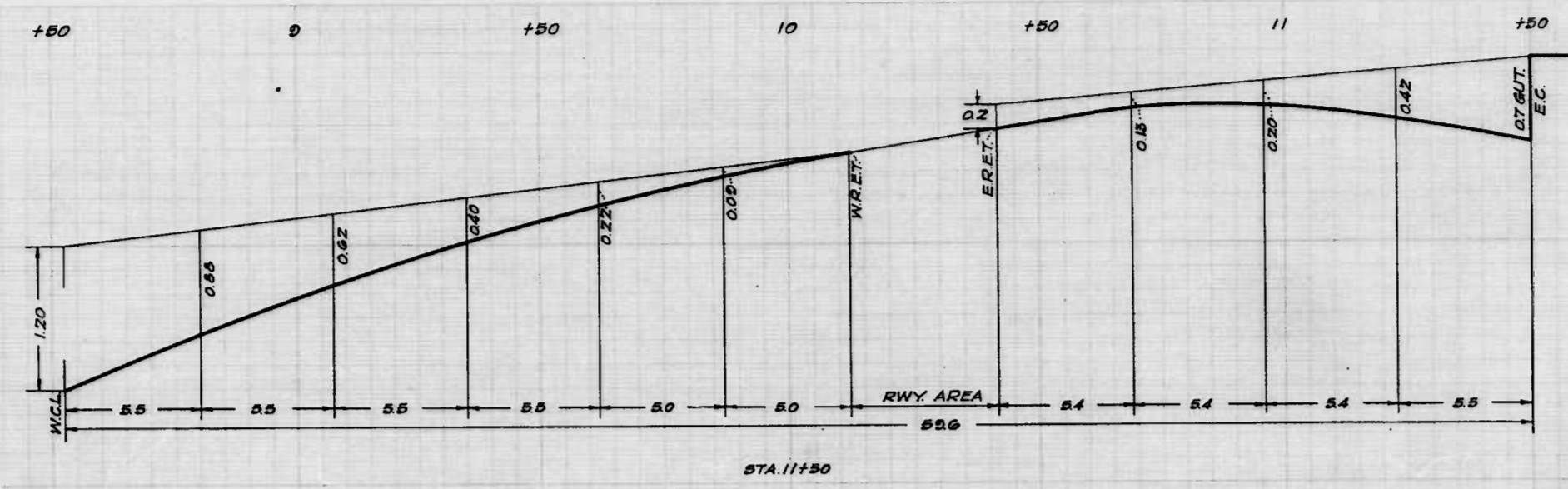
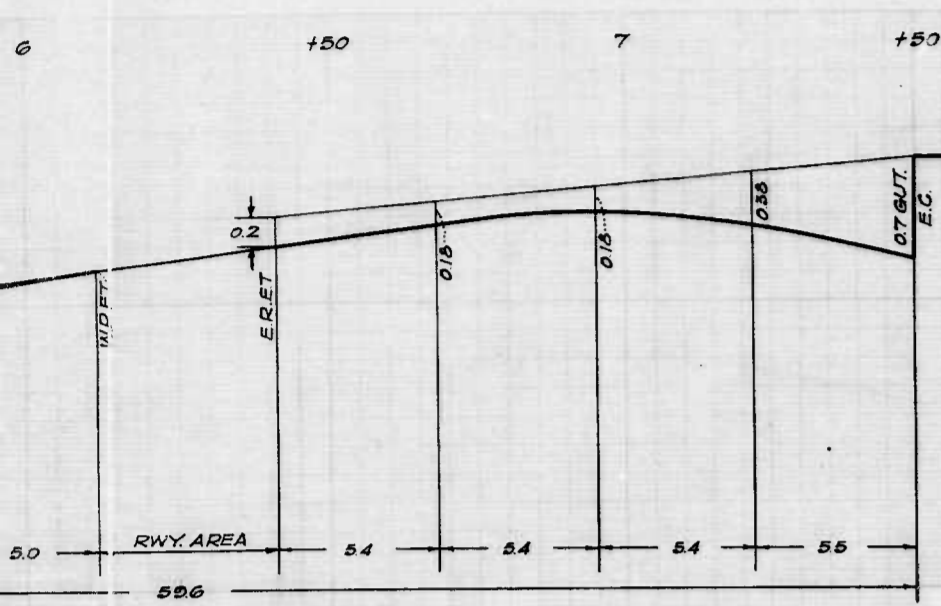

MILTON
SCALE
APPROVED -
APPROVED -
Oscar Bell
CHIEF ENGINEER
Edwards
ENGR. - PL.

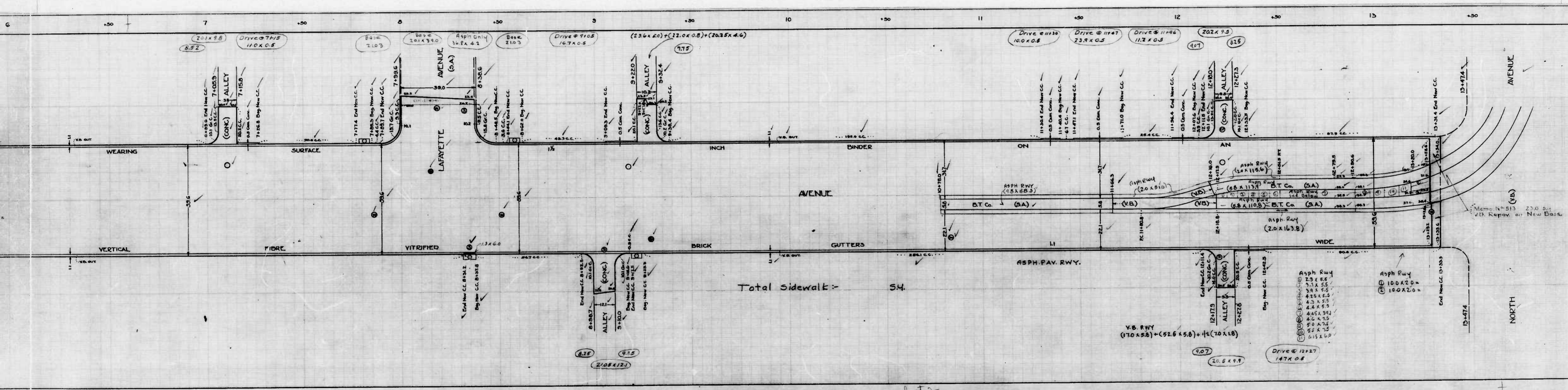

CITY DEPARTMENT
 MILTON AVENUE
 34 ASP PAV-17 W
 IN CONC. BASE
 AMERICAN PAV. C
 STARTED 4-7-4
 SCALE: 1" = 20'

Sheet 2

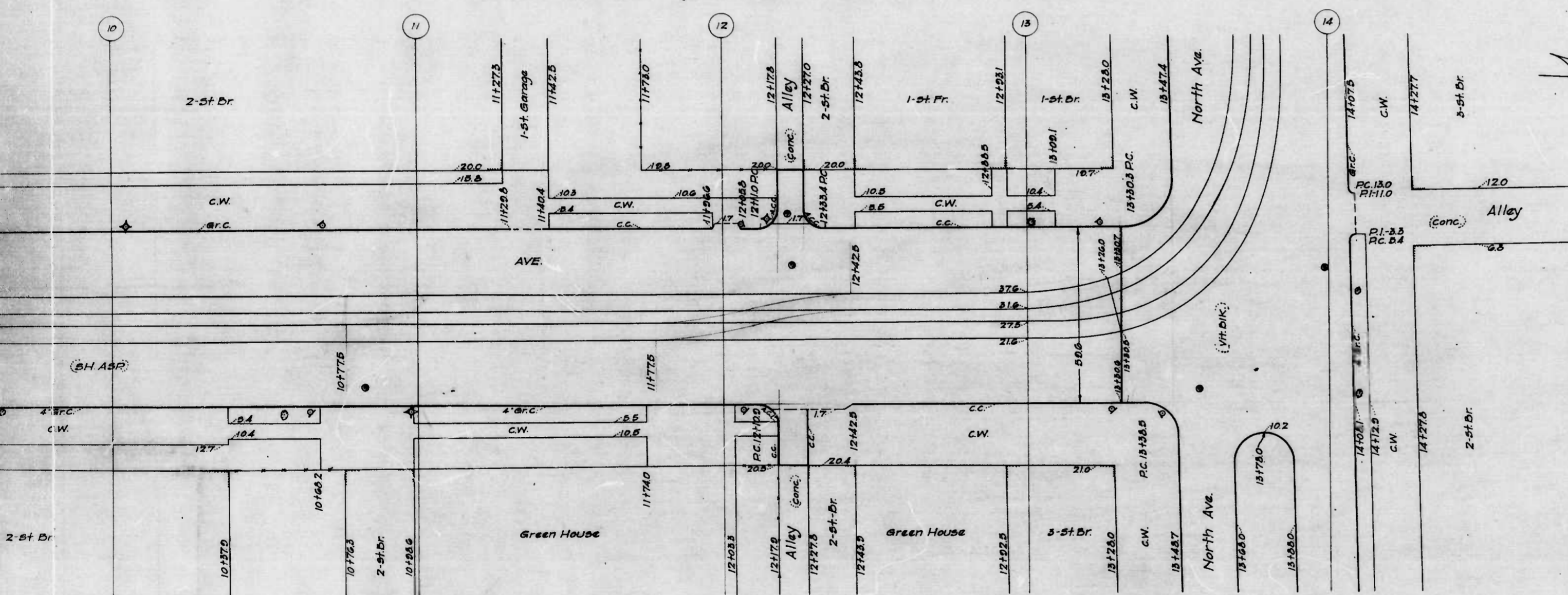

CITY OF BALTIMORE
 DEPARTMENT OF PUBLIC WORKS
 BUREAU OF HIGHWAYS
 LAYOUT OF
 MILTON AVE. - FEDERAL ST. TO NORTH AVE.
 Cont. No. 739 Book No. X-96

Scale: 1" = 200'

Approved: *[Signature]* Chief Engineer
 Approved: *[Signature]* Engr. Plans & Surveys
 Correct: *[Signature]* Associate Engineer
 Approved: *[Signature]* Highway Engineer

3rd

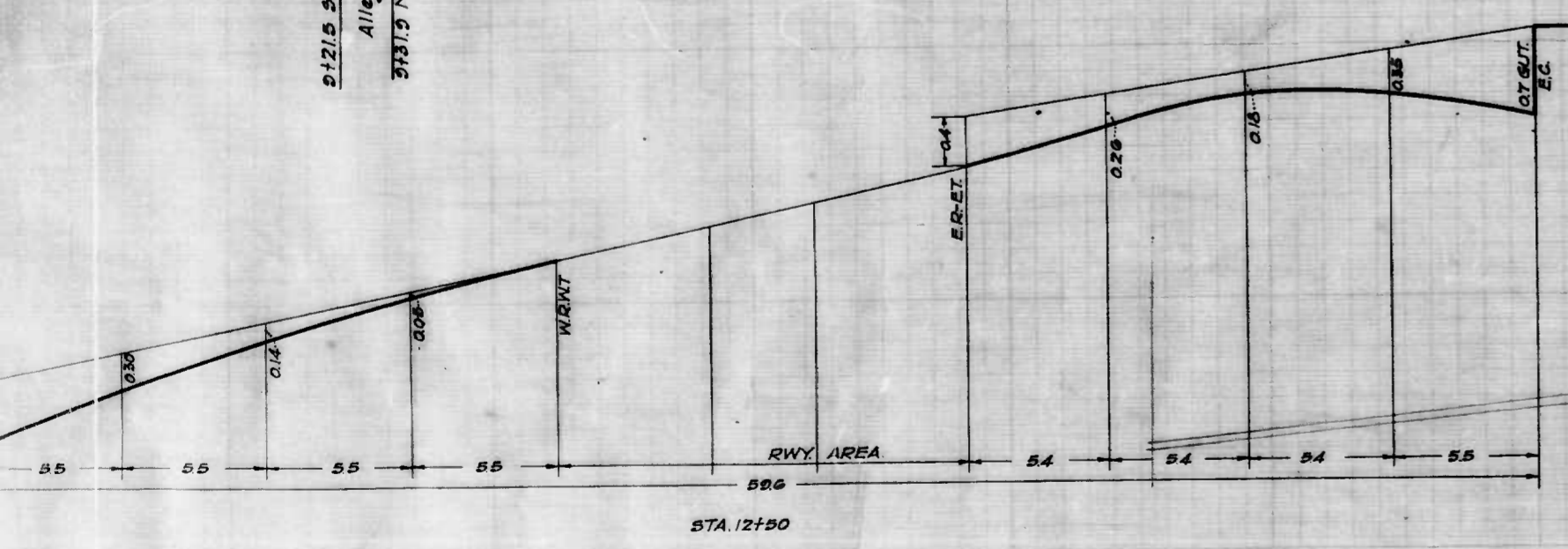
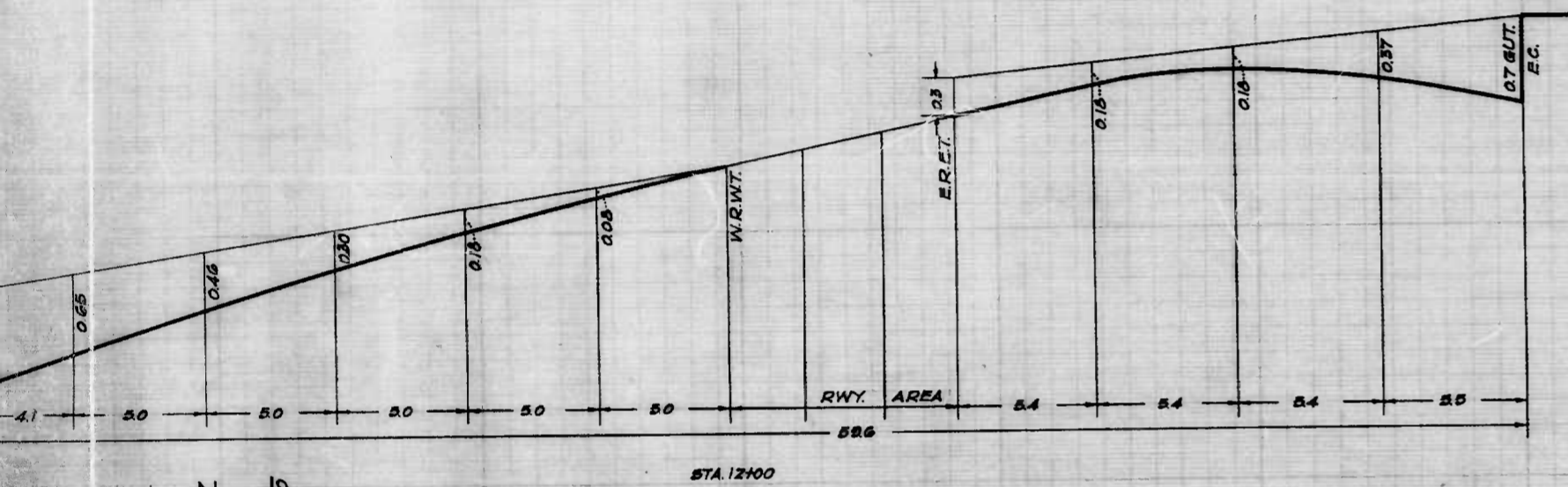
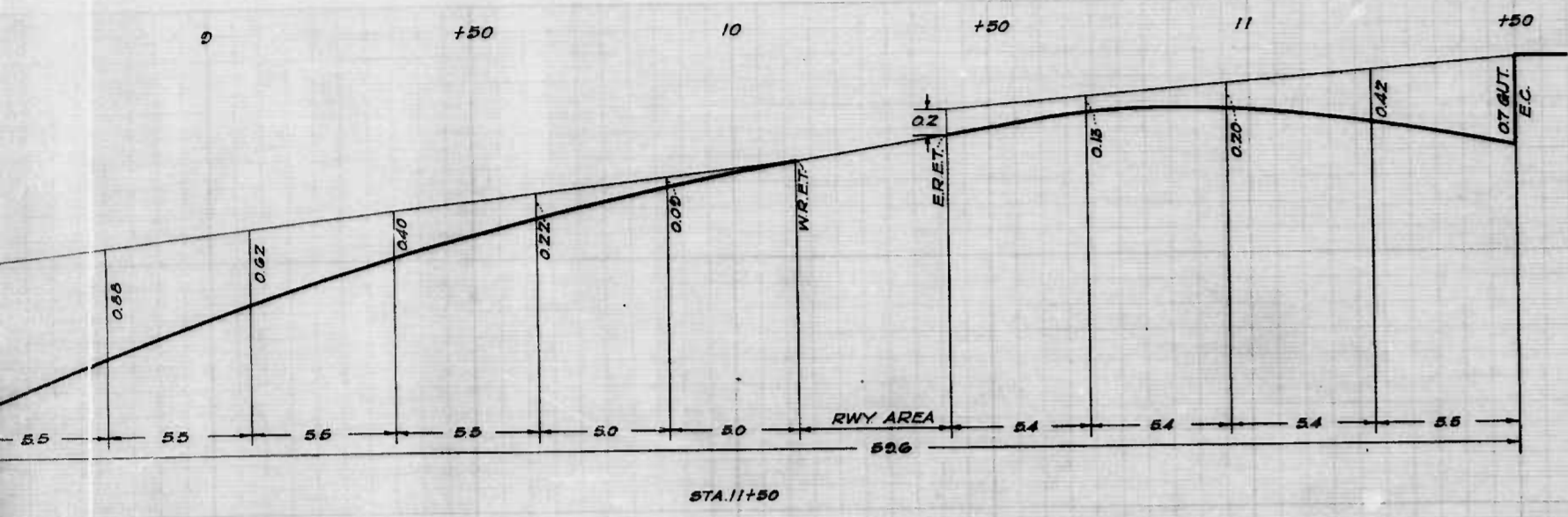

135.51 S.E. Cor. 134.50
 Alley
 135.57 N.E. Cor. 134.50
 Alley
 121.17 S.W. Cor. 137.01
 Alley
 121.27 N.W. Cor. 137.12
 Alley
 130.45 S.E. Cor. 137.12
 Alley
 N.E. Cor. 137.26

140-AMLT.

143.26 S.E. Cor. 134.87
 Ave.
 North
 131.474 S.W. Cor. 137.12

CITY OF BALTIMORE
 DEPARTMENT OF PUBLIC WORKS
 BUREAU OF HIGHWAYS
 ESTABLISHED GRADE OF
 MILTON AVE.-FEDERAL ST. TO NORTH AVE.

CONT. No. 738 BOOK No. X-26
 SCALES: HOR. - 1" = 200' VER. - 1" = 20'

APPROVED: *[Signature]* CHIEF ENGINEER
 APPROVED: *[Signature]* ENGR.-PLANS & SURVEYS
 CORRECT: *[Signature]* ASSOCIATE ENGINEER
 APPROVED: *[Signature]* HIGHWAYS ENGINEER

