

E CURVE DATA
 R - 470.66
 L - 307.64
 Δ - 23°54'35"
 d - 3.0000'/FT

NOTE - ALL STREET CIRCLES TO BE 100' RADIUS - UNLESS NOTED
 ALL ALLEY CIRCLES TO BE 60' RADIUS - UNLESS NOTED

DESIGNED BY J. H. HAYDEN
 DRAWN BY H. W. HAYDEN
 ENGINEERS AND ARCHITECTS
 177 N. W. 10th St. Miami, Fla.

sheet 1

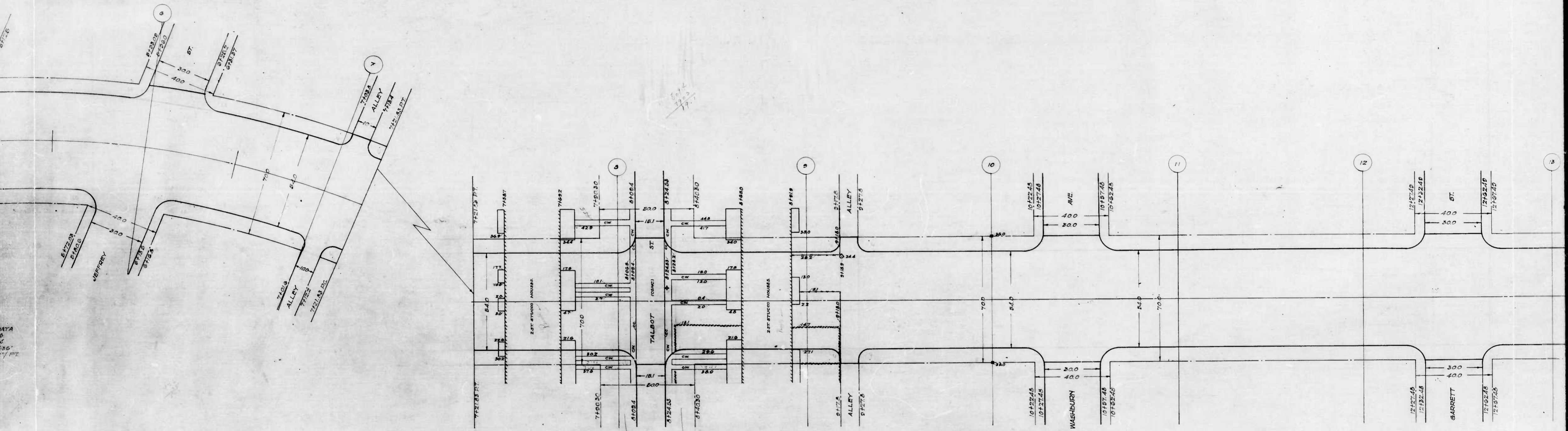

E 10.0 RADIUS - UNLESS NOTED.
E 60.0 RADIUS - UNLESS NOTED.

shot 2

12 +80 13 +80 14 +80 15 +80 16 +80 17 +80 18 +80 19 +80 20

TYPICAL CROSS SECTION FOR GRADING

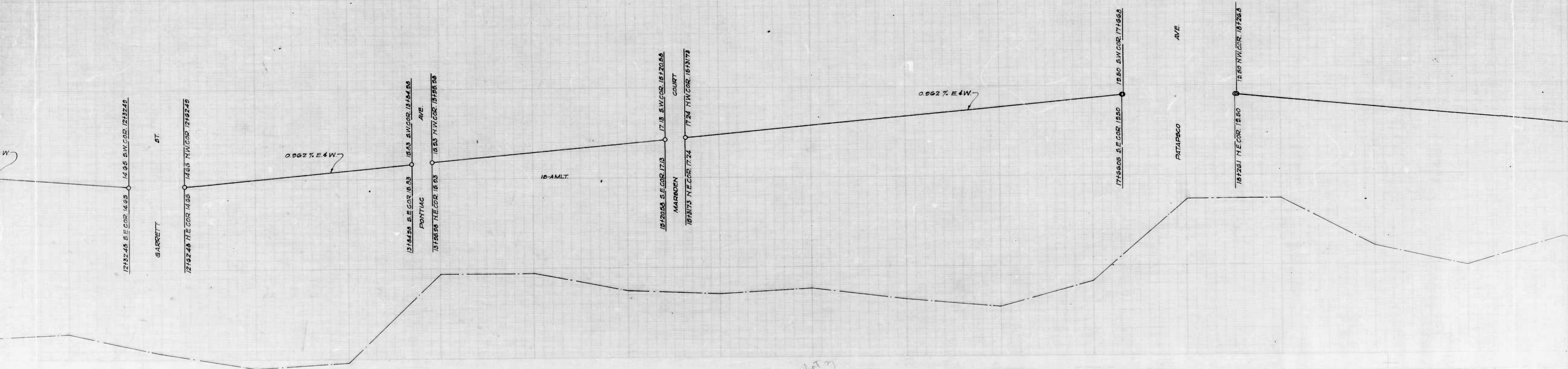
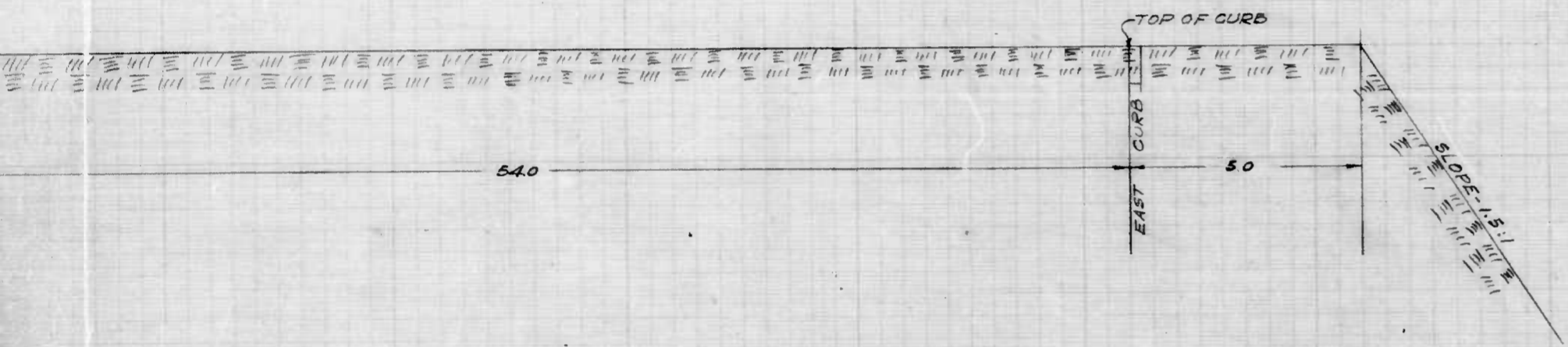

736

RATIO - 24

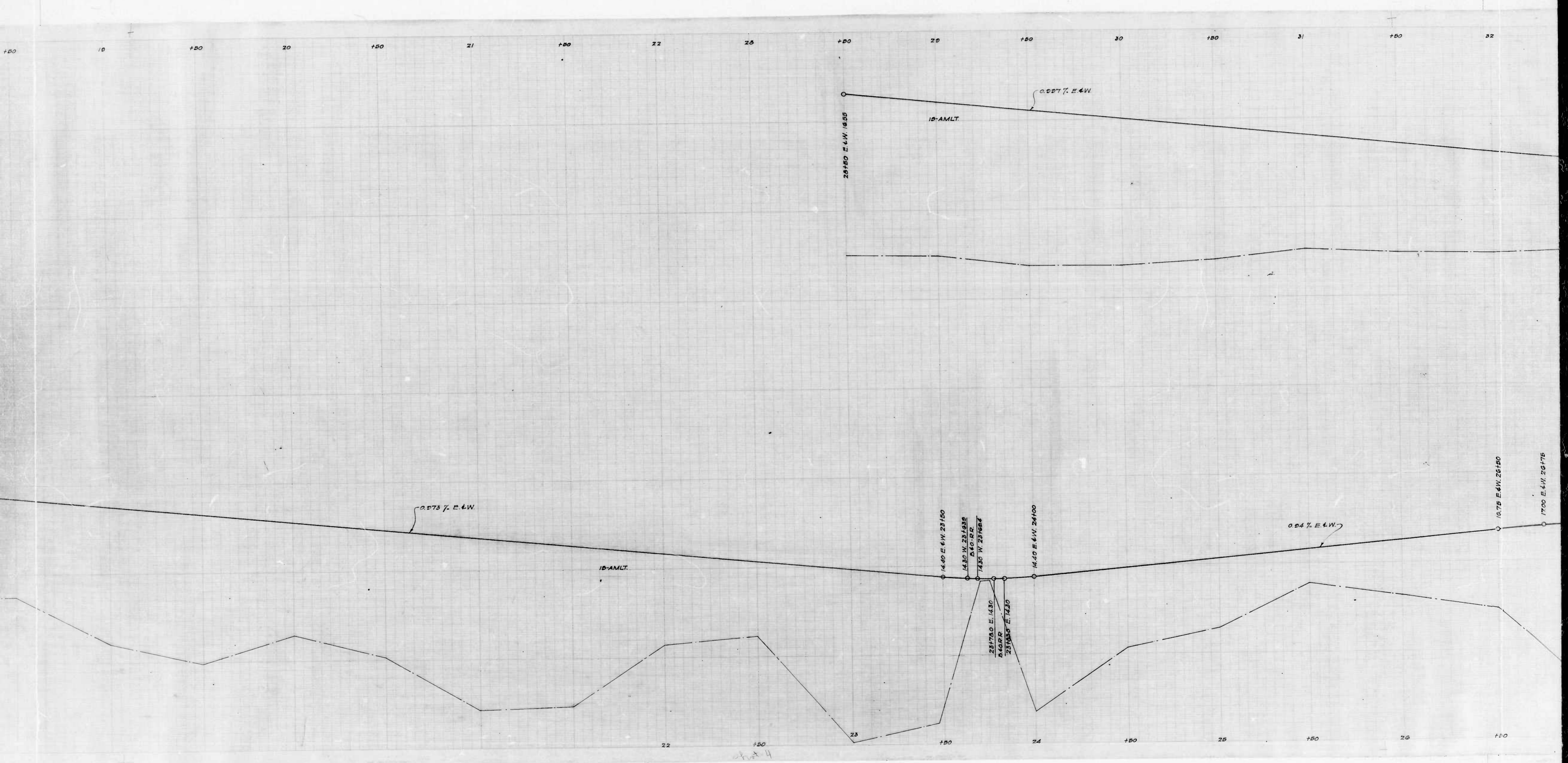

736

RATIO - 24

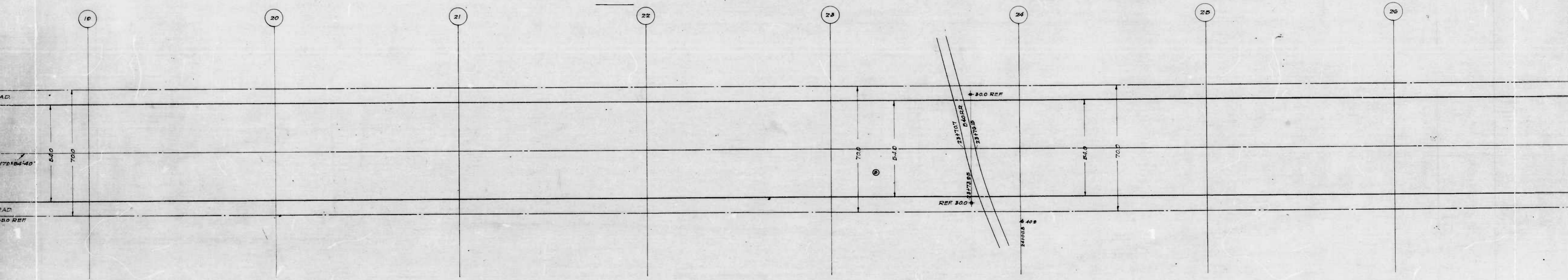

736

RATIO - 24

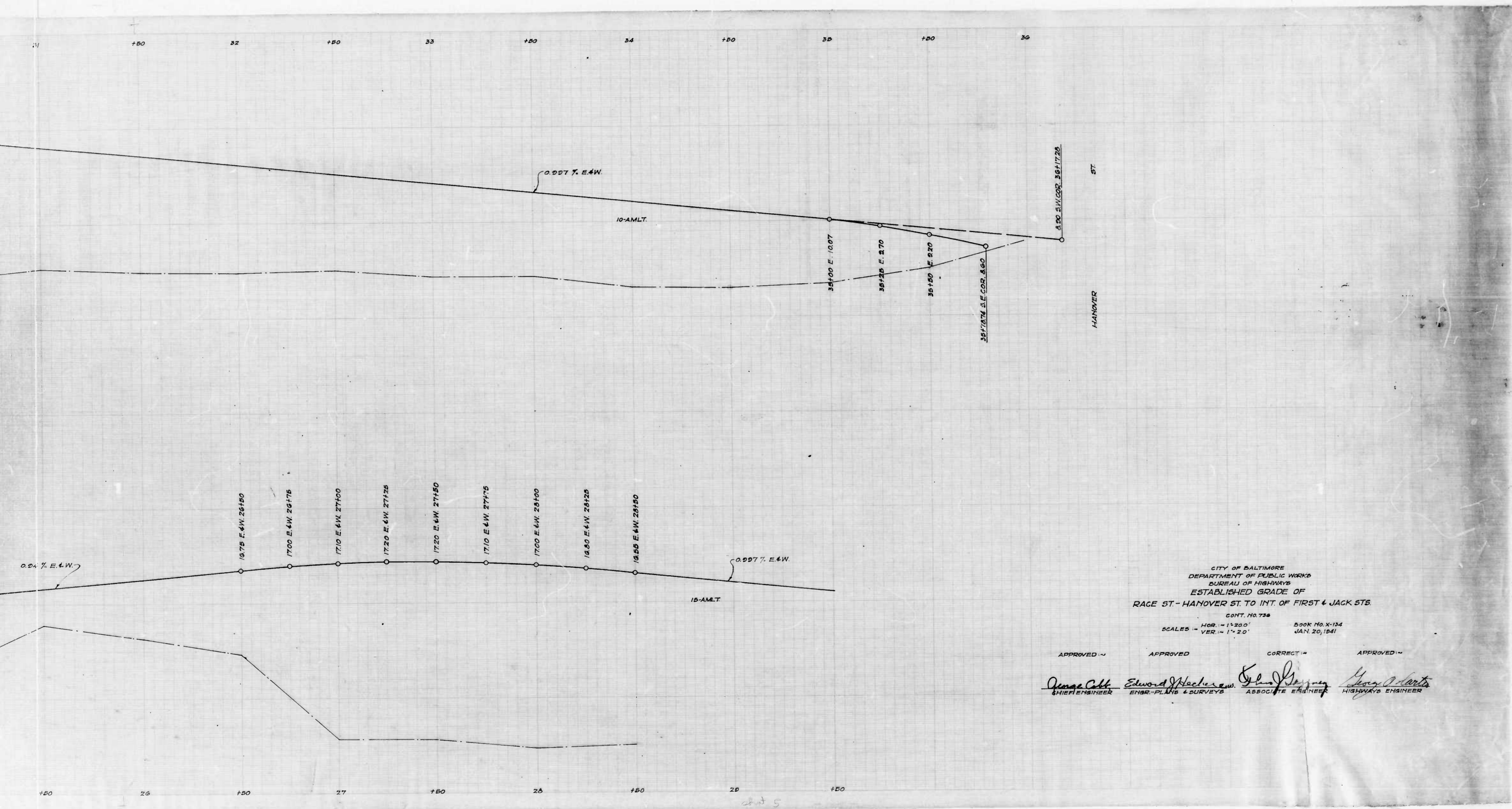

CITY OF BALTIMORE
 DEPARTMENT OF PUBLIC WORKS
 BUREAU OF HIGHWAYS
 ESTABLISHED GRADE OF
 RACE ST. - HANOVER ST. TO INT. OF FIRST & JACK STS.

CONT. No. 736
 SCALES - HOR. - 1"=20'
 VER. - 1"=20'
 BOOK No. X-134
 JAN. 20, 1941

APPROVED - ✓ APPROVED APPROVED - ✓ APPROVED - ✓
James Cobb CHIEF ENGINEER *Edward Hecker* ENGR.-PLANS & SURVEYS *John G. Gentry* ASSOCIATE ENGINEER *Harold Roberts* HIGHWAYS ENGINEER

736

RATIO - 24

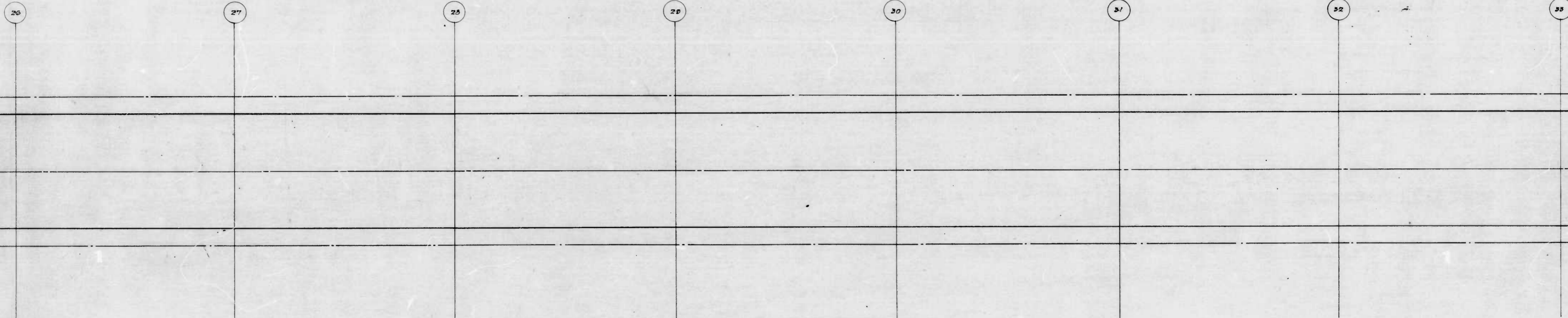

NOTE - ALL STREET CIRCLES TO BE 100' RADIUS - UNLESS NOTED
ALL ALLEY CIRCLES TO BE 50' RADIUS - UNLESS NOTED

2.24

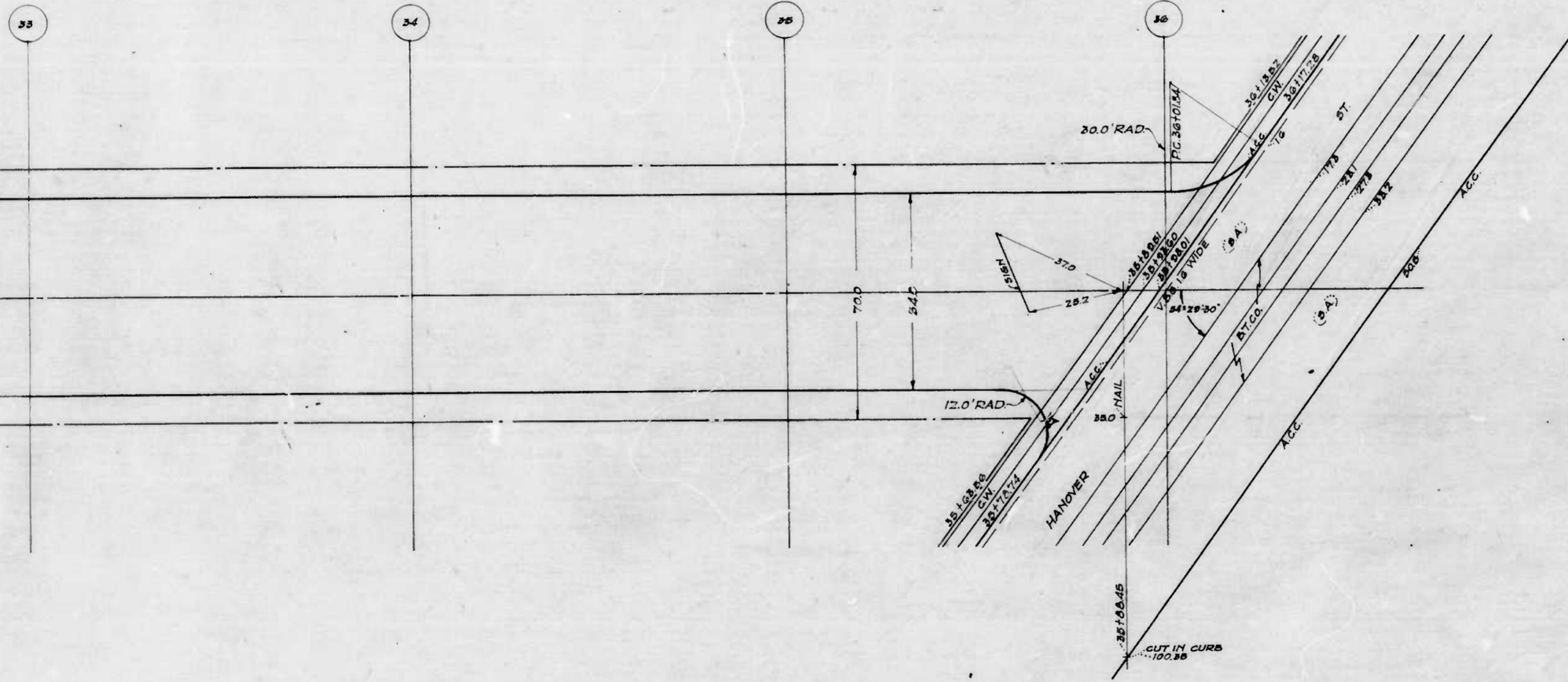

NOTE - ALL STREET CIRCLES TO BE 100' RADIUS - UNLESS NOTED.
 ALL ALLEY CIRCLES TO BE 30' RADIUS - UNLESS NOTED.

CITY OF BALTIMORE
 DEPARTMENT OF PUBLIC WORKS
 BUREAU OF HIGHWAYS
 LAYOUT OF
 RACE ST. - HANOVER ST. TO INT. OF FIRST & JACK STS.
 CONT. NO. 736

SCALE: 1" = 200'
 BOOK NO. X-134
 JAN. 20, 1941

APPROVED -
 APPROVED -
 CORRECT -
 APPROVED -

Henry C. Bell CHIEF ENGINEER
Edward Hecker ENGR-PLDG & SURVEYS
John K. ... ASSOCIATE ENGINEER
George A. ... HIGHWAYS ENGINEER

24.5