

NOTE:-
THE ISSUANCE OF THIS PROFILE DOES NOT COMMIT THE CITY TO THE
ACCEPTANCE AND/OR IMPROVEMENT OF ANY THOROUGHFARES
SHOWN THEREON.

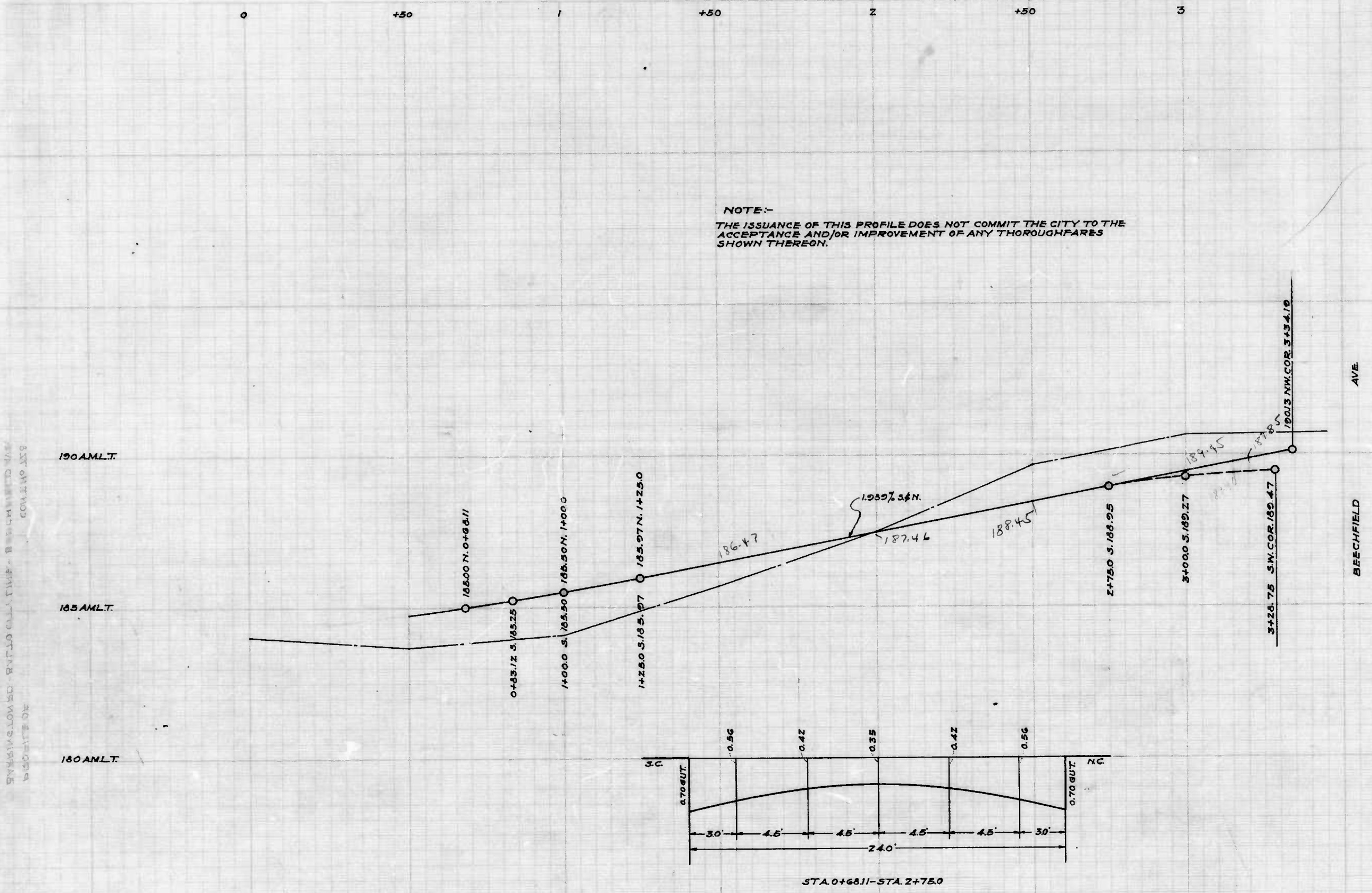

ELEVATION IN FEET ALL THRU. BENCH MARKS ARE
GALATIUS 333

ELEVATION
GALATIUS 333

CITY OF BALTIMORE
DEPARTMENT OF PUBLIC WORKS
BUREAU OF HIGHWAYS
PROFILE OF
BARRINGTON RD.-BALTO. CITY LINE.-BEECHFIELD AVE.
CONT. No. 728
SCALE: HOR.-1"=200' JUNE 11, 1940
VER.-1"=20'

CORRECT:-
Edward J. Hecker
ASSOCIATE ENGINEER

APPROVED:-
George C. Holt
HIGHWAYS ENGINEER

APPROVED:-
Edward J. Hecker
ENGR. PLANS & SURVEYS

APPROVED:-
George C. Holt
CHIEF ENGINEER

DESIGNED BY
D. Marley
D. Marley
ENGINEER IN CHARGE OF ROAD

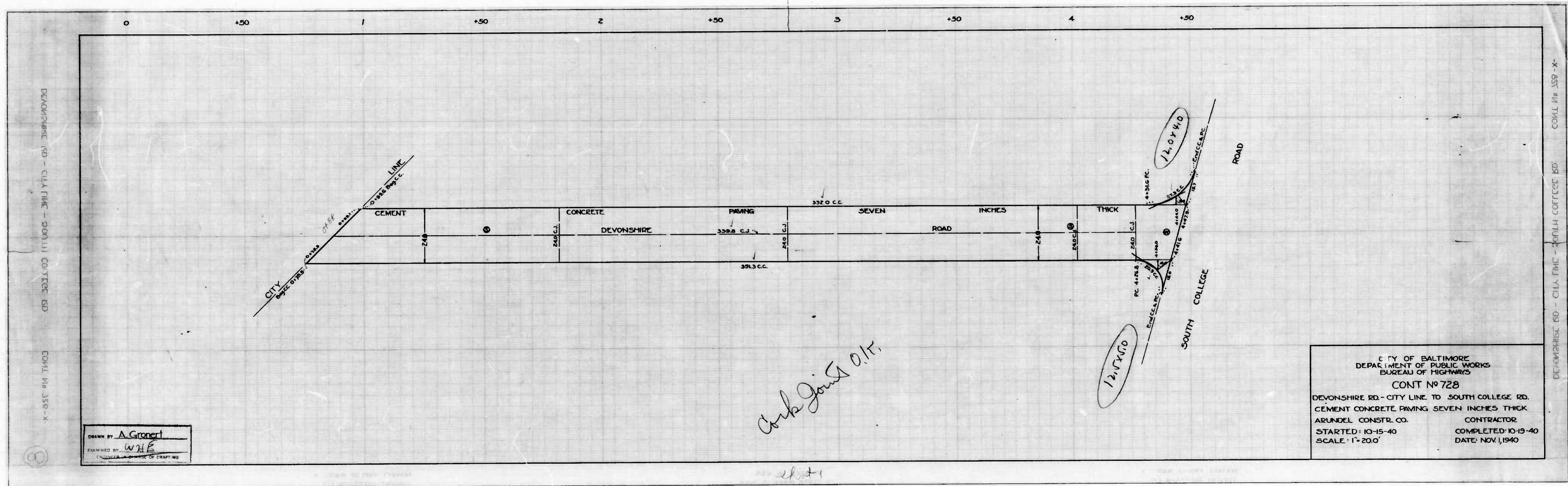

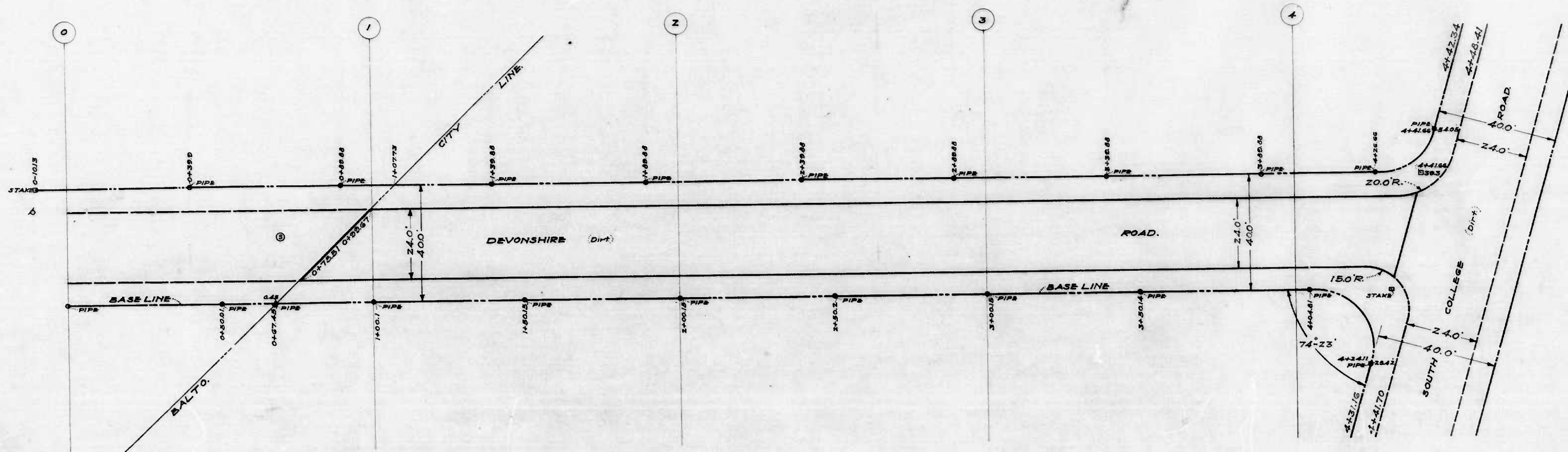

NOTE:-
THE ISSUANCE OF THIS PLAN & PROFILE DOES NOT COMMIT THE CITY TO THE
ACCEPTANCE AND/OR IMPROVEMENT OF ANY THOROUGHFARES SHOWN THEREON.

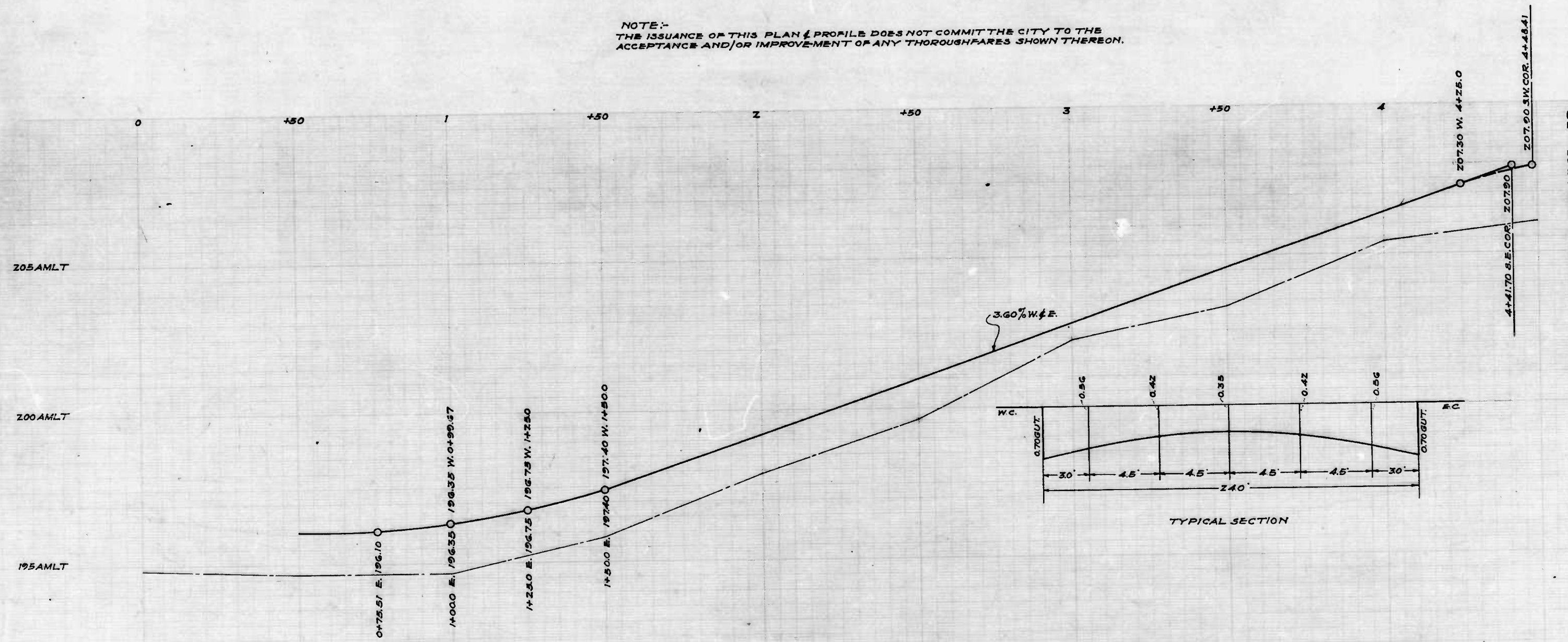

CITY OF BALTIMORE
DEPARTMENT OF PUBLIC WORKS
BUREAU OF HIGHWAYS
PLAN & PROFILE
DEVONSHIRE RD.-BALTO. CITY LINE-SOUTH COLLEGE RD.
CONT. No. 728
SCALE: HOR. - 1" = 20.0'
VER. - 1" = 2.0'
JUNE 10, 1940

CORRECTED: *Glen J. Jessup* ASSOCIATE ENGINEER
APPROVED: *James A. ...* HIGHWAYS ENGINEER
APPROVED: *James A. ...* CHIEF ENGINEER
APPROVED: *James A. ...* CHIEF ENGINEER
ENGR. PLANS & SURVEYS.

D. Morley
H. ...
ENGR. PLANS & SURVEYS.

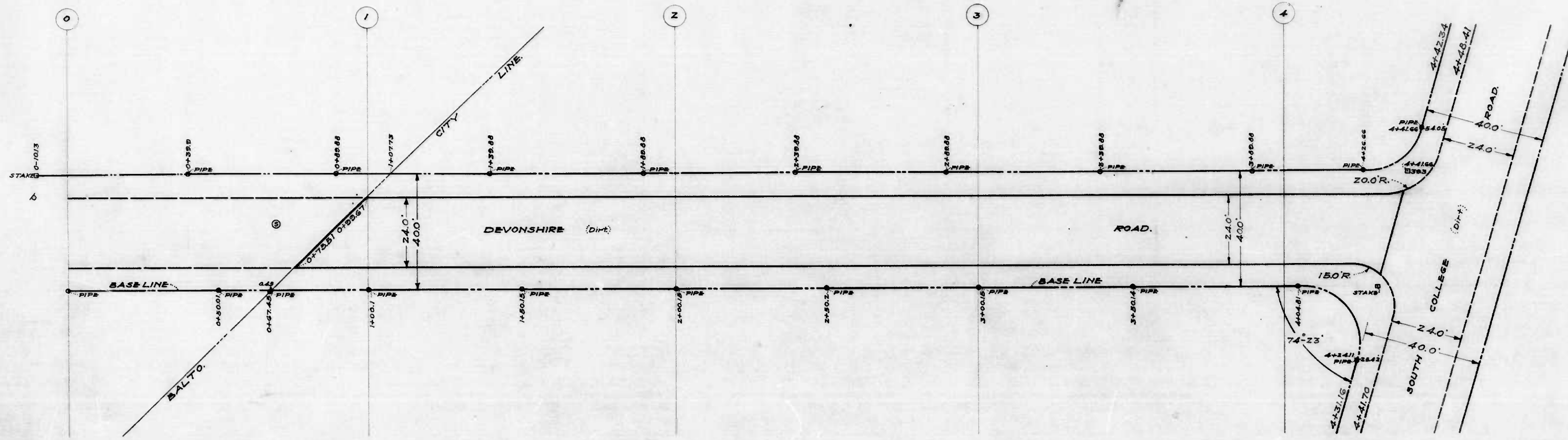

NOTE:-
THE ISSUANCE OF THIS PLAN & PROFILE DOES NOT COMMIT THE CITY TO THE
ACCEPTANCE AND/OR IMPROVEMENT OF ANY THOROUGHFARES SHOWN THEREON.

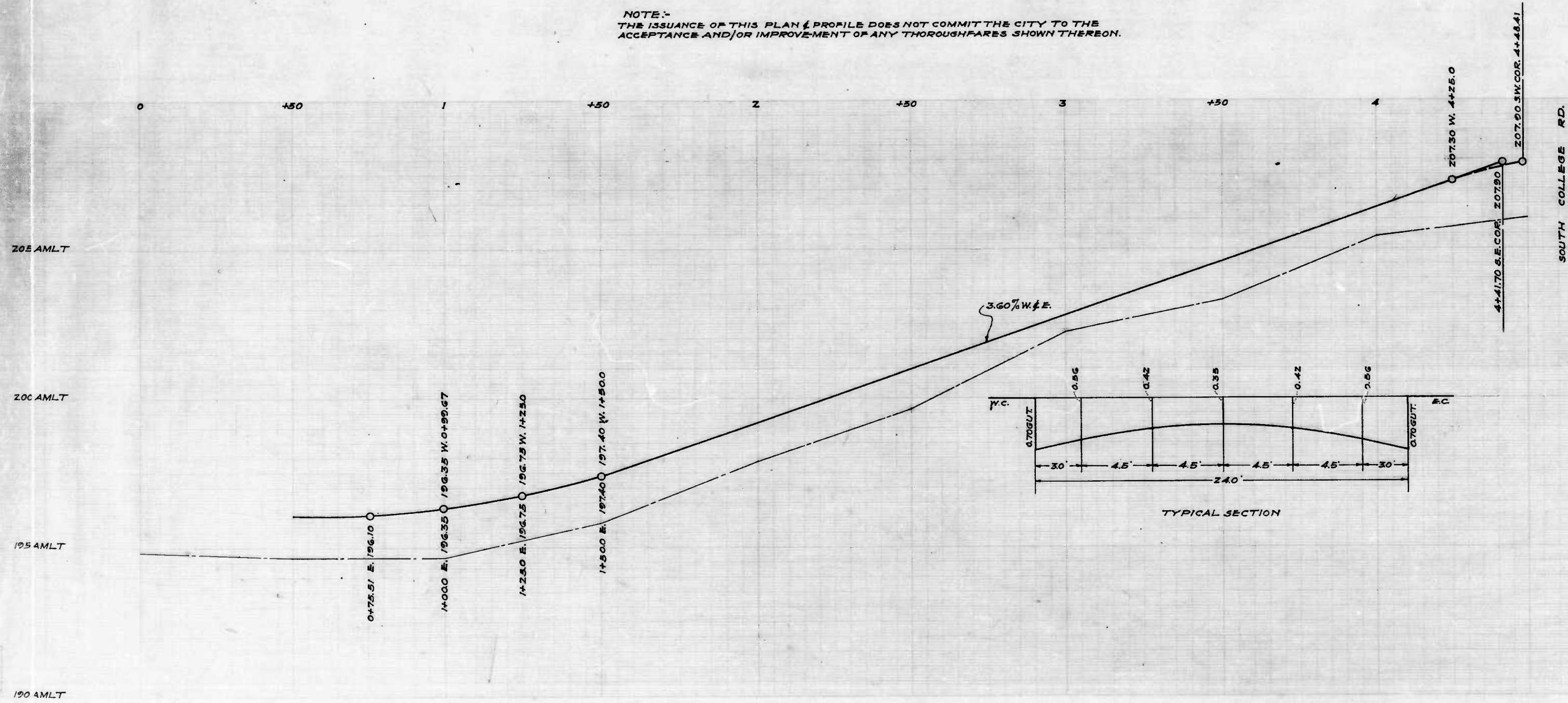

CITY OF BALTIMORE
DEPARTMENT OF PUBLIC WORKS
BUREAU OF HIGHWAYS
PLAN & PROFILE
DEVONSHIRE RD.-BALTO. CITY LINE-SOUTH COLLEGE RD.
CONT. No. 728

SCALE: HOR. 1"=20.0'
VER. 1"=2.0'

JUNE 10, 1940

CORRECT:-
Ed. J. Giffney
ASSOCIATE ENGINEER

APPROVED:-
George Colth
HIGHWAYS ENGINEER

APPROVED:-
Edward J. Hester
ENGR. PLANS & SURVEYS.

APPROVED:-
George Colth
CHIEF ENGINEER.

Sheet 1 (+) Sheet 2

CURVE DATA
 R=102.00
 C=482.29
 A/2=741.08
 L=490.23
 T=246.84

NOTE:-
 THE ISSUANCE OF THIS PLAN DOES NOT COMMIT THE CITY TO THE
 ACCEPTANCE AND/OR IMPROVEMENT OF ANY THOROUGHFARES
 SHOWN THEREON.

CITY OF BALTIMORE
 DEPARTMENT OF PUBLIC WORKS
 BUREAU OF HIGHWAYS
 PLAN OF
 DORCHESTER RD.-BALTO. CITY LINE- SOUTH COLLEGE RD.
 CONT. No. 728

SCALE - 1"=20.0'

BOOK X-141
 JUNE 7, 1940

CORRECTED
Edward J. Hecker
 ASSOCIATE ENGINEER

APPROVED:-
James A. ...
 HIGHWAYS ENGINEER

APPROVED:-
Edward J. Hecker
 ENGR. PLANS & SURVEYS.

APPROVED:-
James A. ...
 CHIEF ENGINEER

DESIGNED BY
D. Mezley
 DRAWN BY
H. Weisberg

Sheet 1

Sheet 2

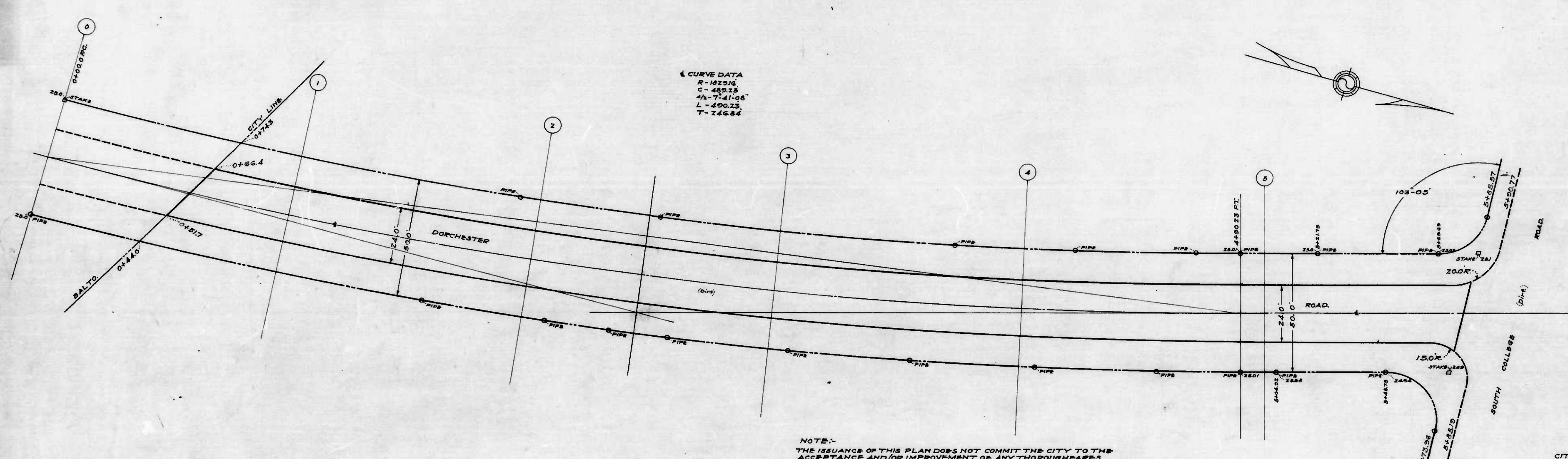

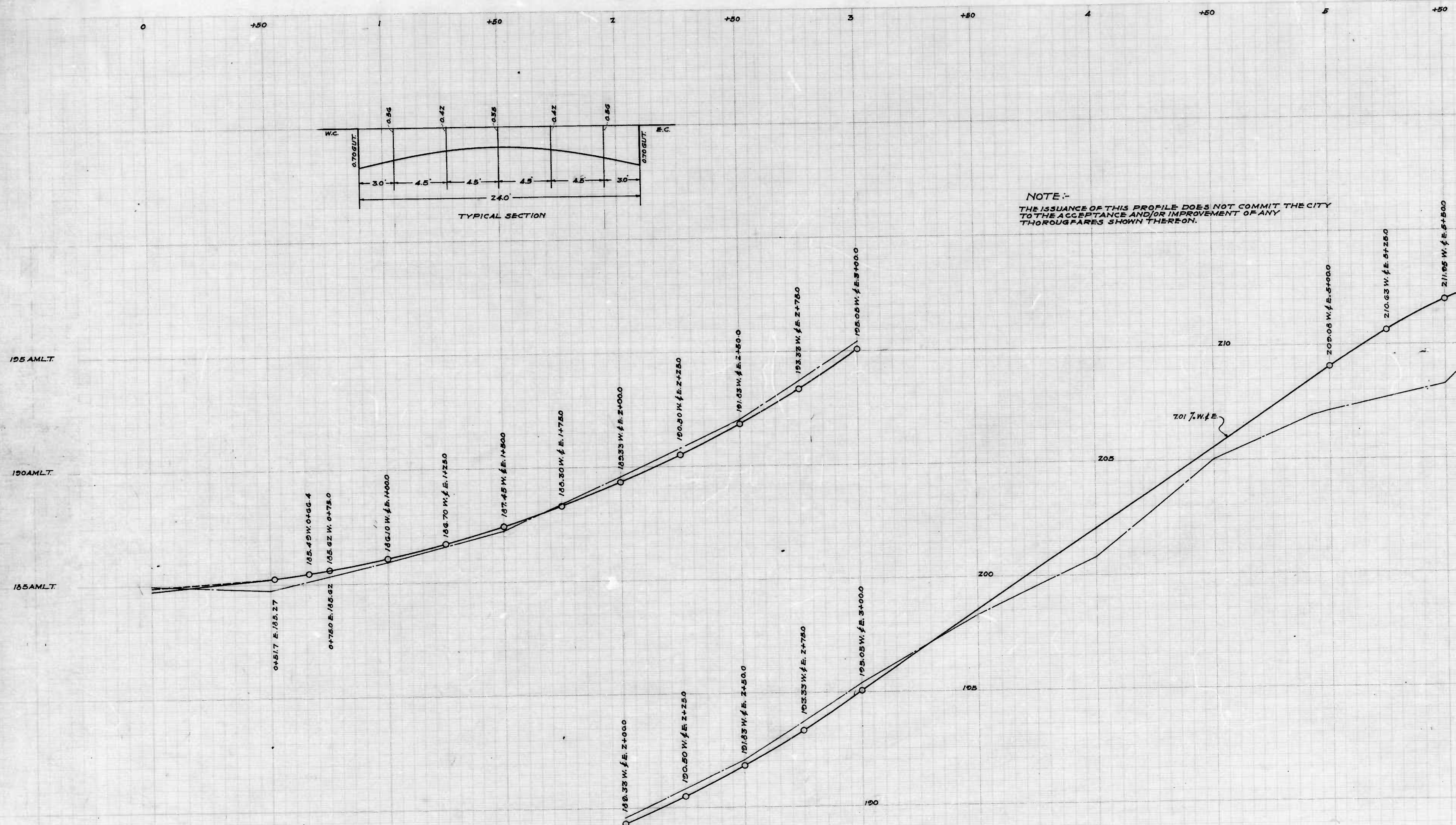

CITY OF BALTIMORE
 DEPARTMENT OF PUBLIC WORKS
 BUREAU OF HIGHWAYS
 PROFILE OF
 DORCHESTER RD.-BALTO. CITY LINE-SOUTH COLLEGE RD.
 CONT. No. 728

SCALE - HOR. - 1"=200'
 VER. - 1"=20' JUNE 13, 1940

CORRECT - APPROVED -
Edmund J. Hecker *George A. Hill*
 ASSOCIATE ENGINEER HIGHWAYS ENGINEER

APPROVED - APPROVED -
Edmund J. Hecker *George A. Hill*
 ENGR. PLANS & SURVEY CHIEF ENGINEER

DESIGNED BY
D. Marley
 ENGINEER
Heckerberg
 ENGINEER IN CHARGE OF SURVEY

Sheet 1

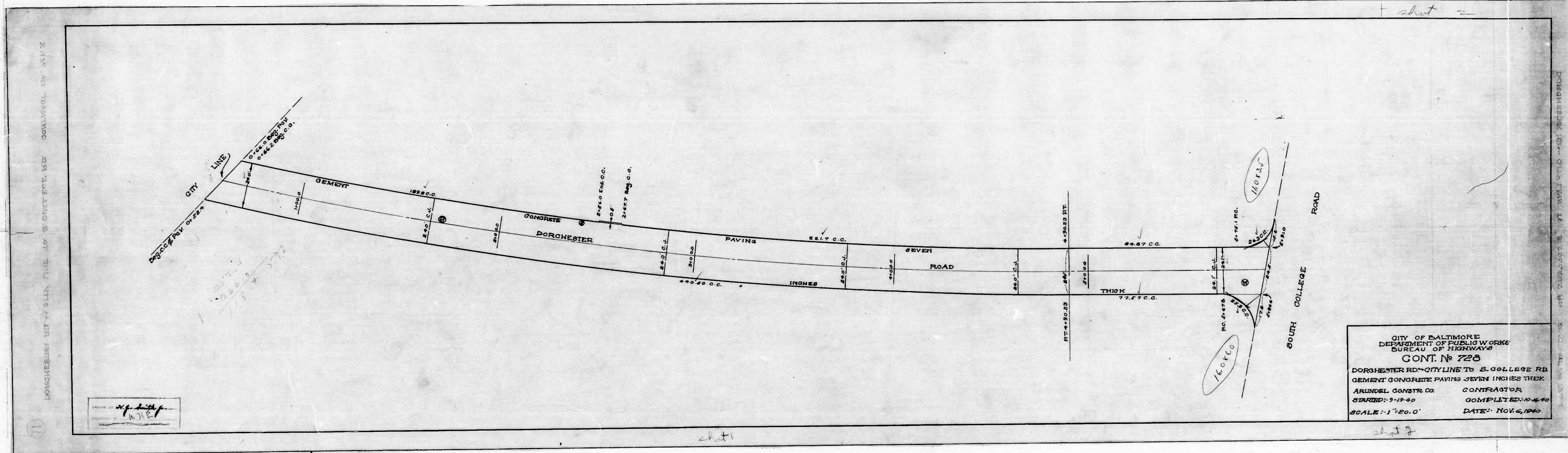

DORCHESTER RD - CITY LINE TO S. COLLEGE RD. CONTRACT NO. 3342

DORCHESTER RD - CITY LINE TO S. COLLEGE RD. CONTRACT NO. 3342

DESIGNED BY *W.P. [Signature]*
CHECKED BY *W.P.E.*

CITY OF BALTIMORE
 DEPARTMENT OF PUBLIC WORKS
 BUREAU OF HIGHWAYS
 CONT. No. 728
 DORCHESTER RD - CITY LINE TO S. COLLEGE RD.
 CEMENT CONCRETE PAVING SEVEN INCHES THICK
 ARUNDEL CONSTR. CO. CONTRACTOR
 STARTED: 9-19-40 COMPLETED: 10-4-40
 SCALE: 1"=20.0' DATE: NOV. 6, 1940

Sheet 1

Sheet 2

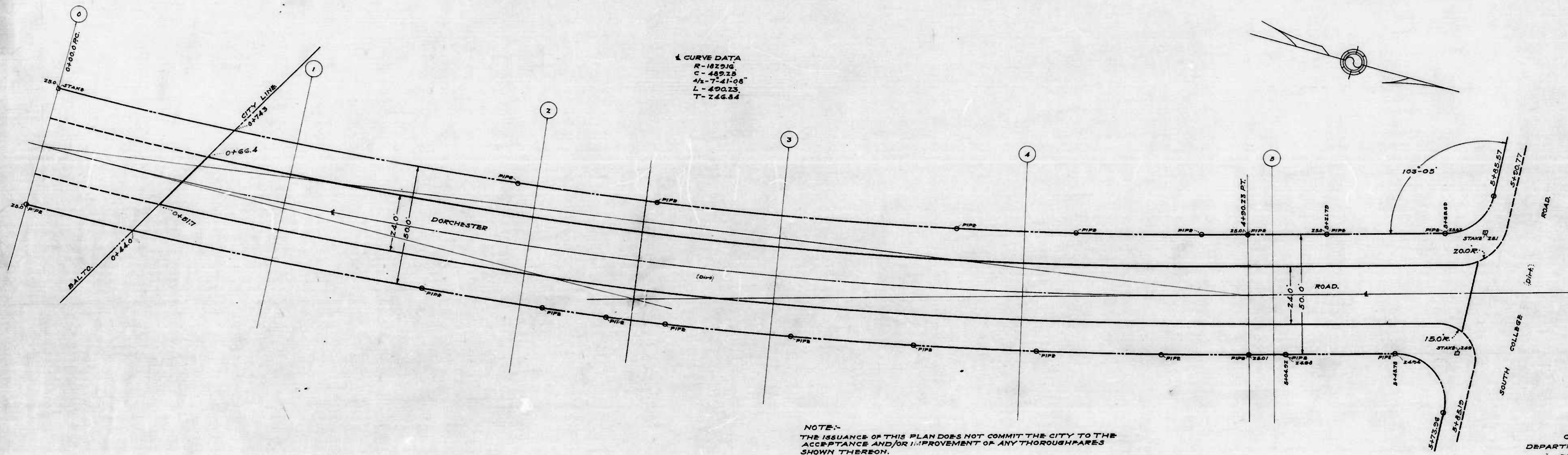

4 CURVE DATA
 R-1829.6
 C-489.23
 Δs-7-41-05
 L-400.33
 T-246.84

NOTE:-
 THE ISSUANCE OF THIS PLAN DOES NOT COMMIT THE CITY TO THE
 ACCEPTANCE AND/OR IMPROVEMENT OF ANY THOROUGHFARES
 SHOWN THEREON.

CITY OF BALTIMORE
 DEPARTMENT OF PUBLIC WORKS
 BUREAU OF HIGHWAYS
 PLAN OF
 DORCHESTER RD.-BALTO. CITY LINE- SOUTH COLLEGE RD.
 CONT. NO. 728

SCALE-1"=20.0'

BOOK X-141
 JUNE 7, 1940

CORRECTED
Edward J. Heisey
 ASSOCIATE ENGINEER.

APPROVED:-
George A. ...
 HIGHWAYS ENGINEER.

APPROVED:-
Edward J. Heisey
 ENGR. PLANS & SURVEYS.

APPROVED:-
George A. ...
 ENGINEER.

PAID BY
 D. Metzley
 Heisey
 ENGINEER IN CHARGE OF DESIGN

Sheet 1

Sheet 2

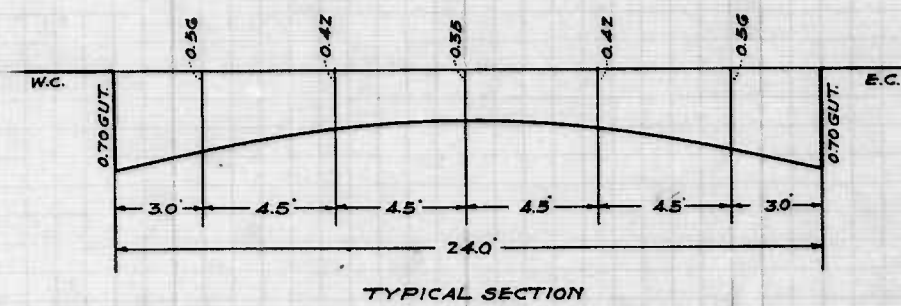

NOTE:-

THE ISSUANCE OF THIS PROFILE DOES NOT COMMIT THE CITY TO THE ACCEPTANCE AND/OR IMPROVEMENT OF ANY THOROUGHFARES SHOWN THEREON.

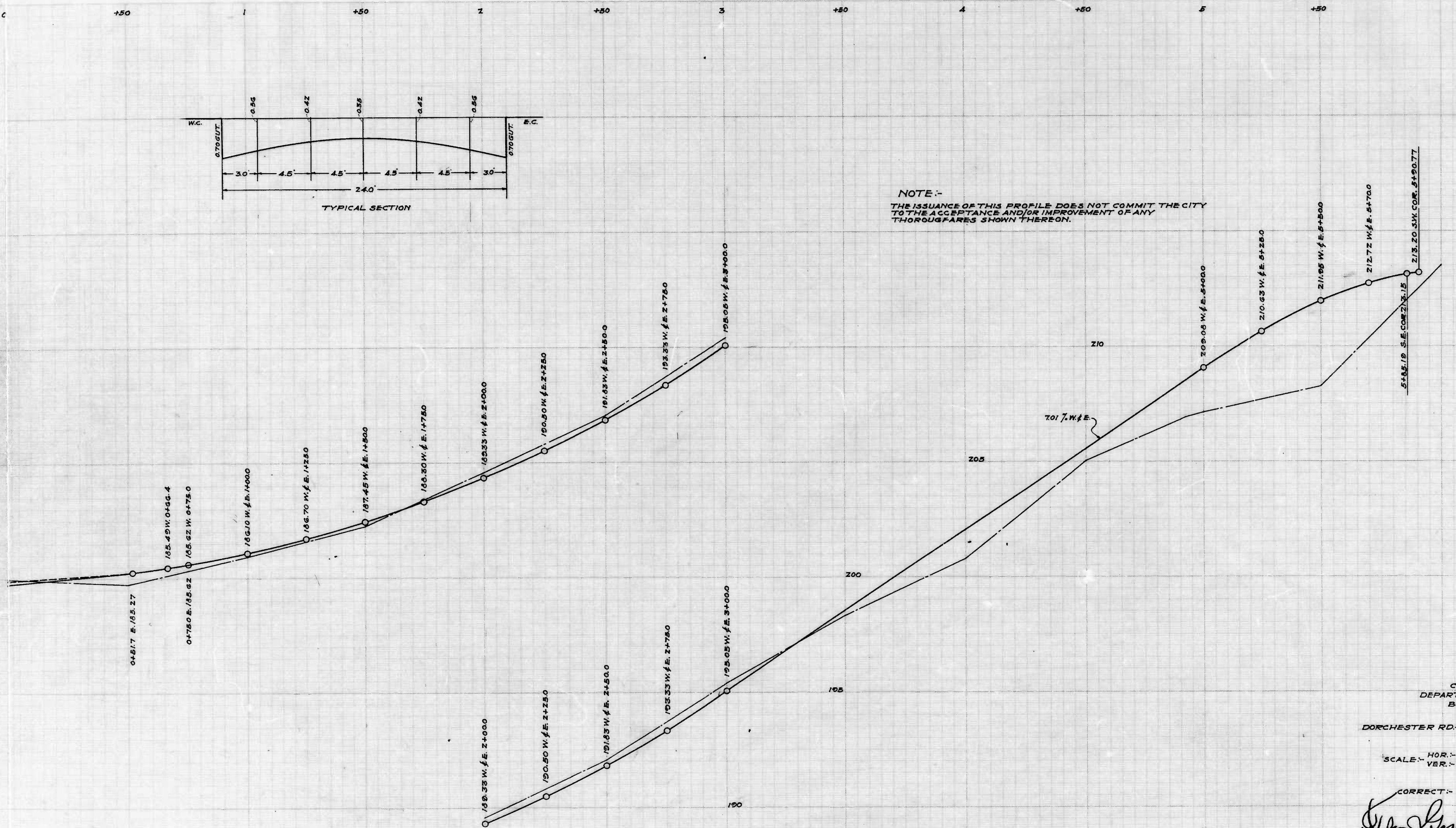

CITY OF BALTIMORE
 DEPARTMENT OF PUBLIC WORKS
 BUREAU OF HIGHWAYS
 PROFILE OF
 DORCHESTER RD.-BALTO CITY LINE-SOUTH COLLEGERD.
 CONT. No. 728

SCALE: HOR. - 1"=20'
 VER. - 1"=20' JUNE 13, 1940

CORRECT:-
Edw. J. Heckman
 ASSOCIATE ENGINEER

APPROVED:-
George A. Holt
 HIGHWAYS ENGINEER

APPROVED:-

APPROVED:-

Edw. J. Heckman
 ENGR. PLANS & SURVEY

George A. Holt
 CHIEF ENGINEER

DORCHESTER RD.-BALTO CITY LINE-SOUTH COLLEGERD.
 PROFILE OF
 CONT. No. 728

728

RATIO - 24

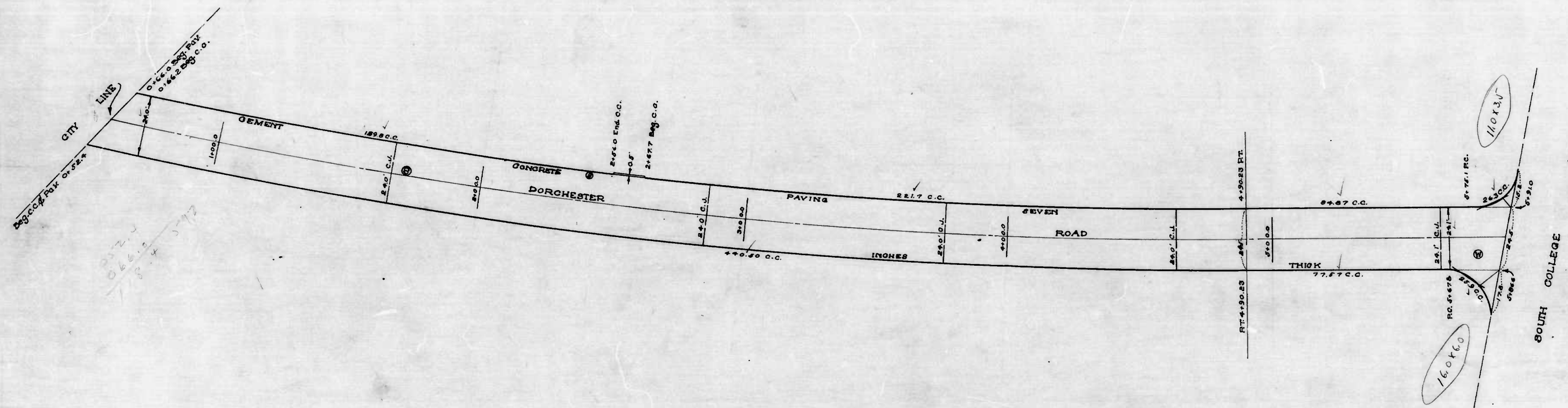

CITY OF BALTIMORE
 DEPARTMENT OF PUBLIC WORKS
 BUREAU OF HIGHWAYS
 CONT. No 728
 DORCHESTER RD - CITY LINE TO S. COLLEGE RD
 CEMENT CONCRETE PAVING SEVEN INCHES THICK
 ARUNDEL CONSTR. Co. CONTRACTOR
 STARTED: 7-19-40 COMPLETED: 10-4-40
 SCALE: 1"=20.0' DATE: NOV. 6, 1940

Drawn by *W.P.E.*
 Checked by *W.P.E.*

DORCHESTER RD - CITY LINE TO S. COLLEGE RD - CONTINUED ON SHEET 729

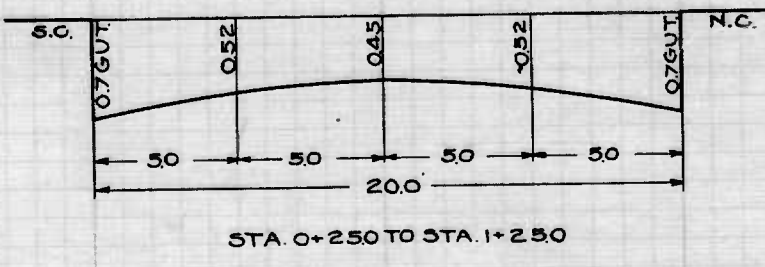
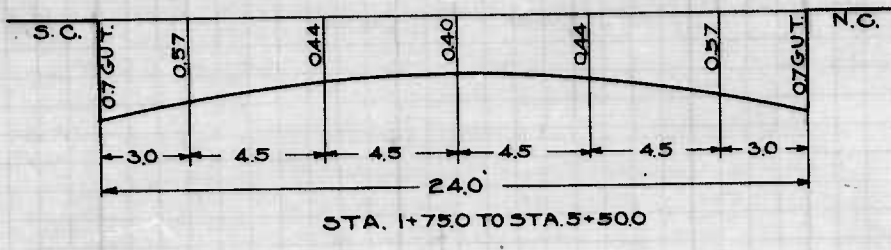
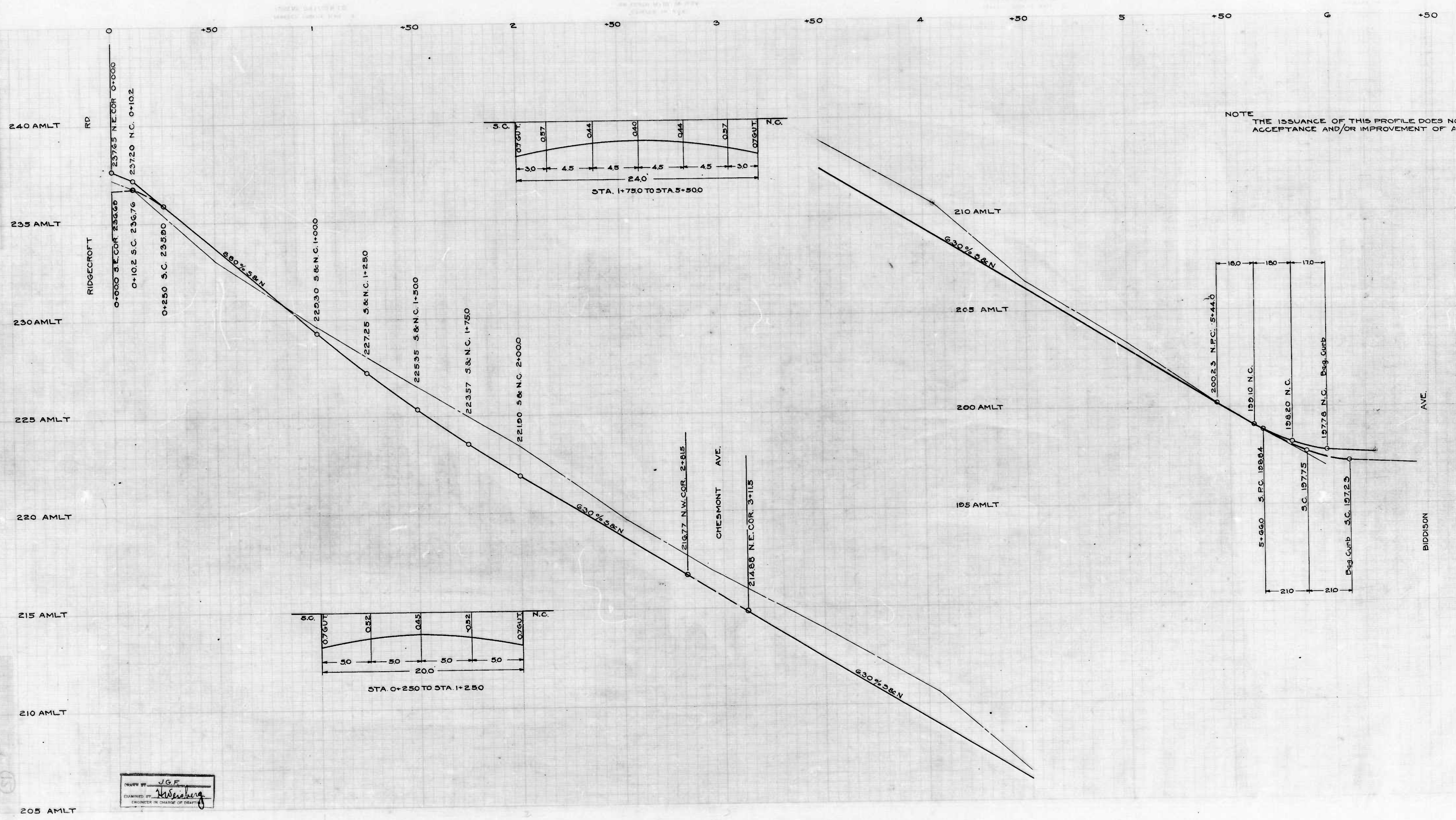

NOTE
THE ISSUANCE OF THIS PROFILE DOES NOT COMMIT
ACCEPTANCE AND/OR IMPROVEMENT OF ANY THOR...

DESIGNED BY J.G.F.
EXAMINED BY *H. Weisberg*
ENGINEER IN CHARGE OF DEPT.

REPRODUCTION OF THIS DRAWING FOR ANY PURPOSE IS PROHIBITED WITHOUT THE WRITTEN PERMISSION OF THE ENGINEER.

2/21/11

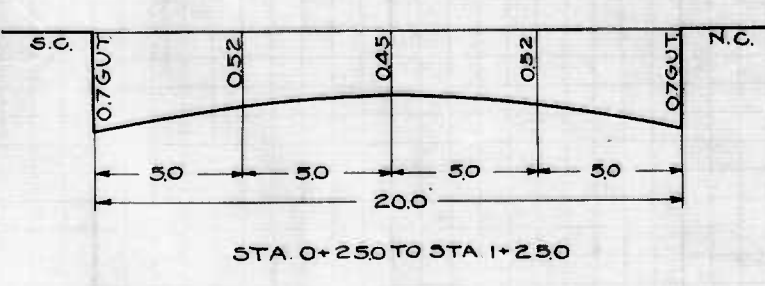
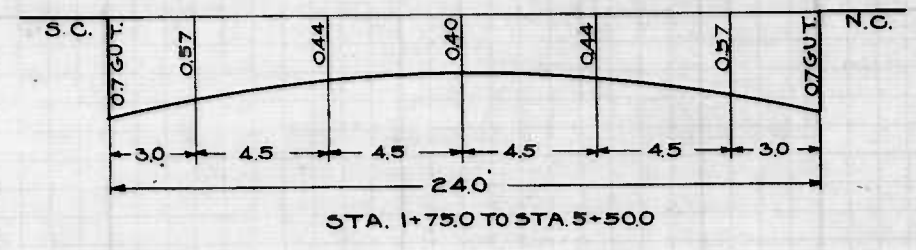
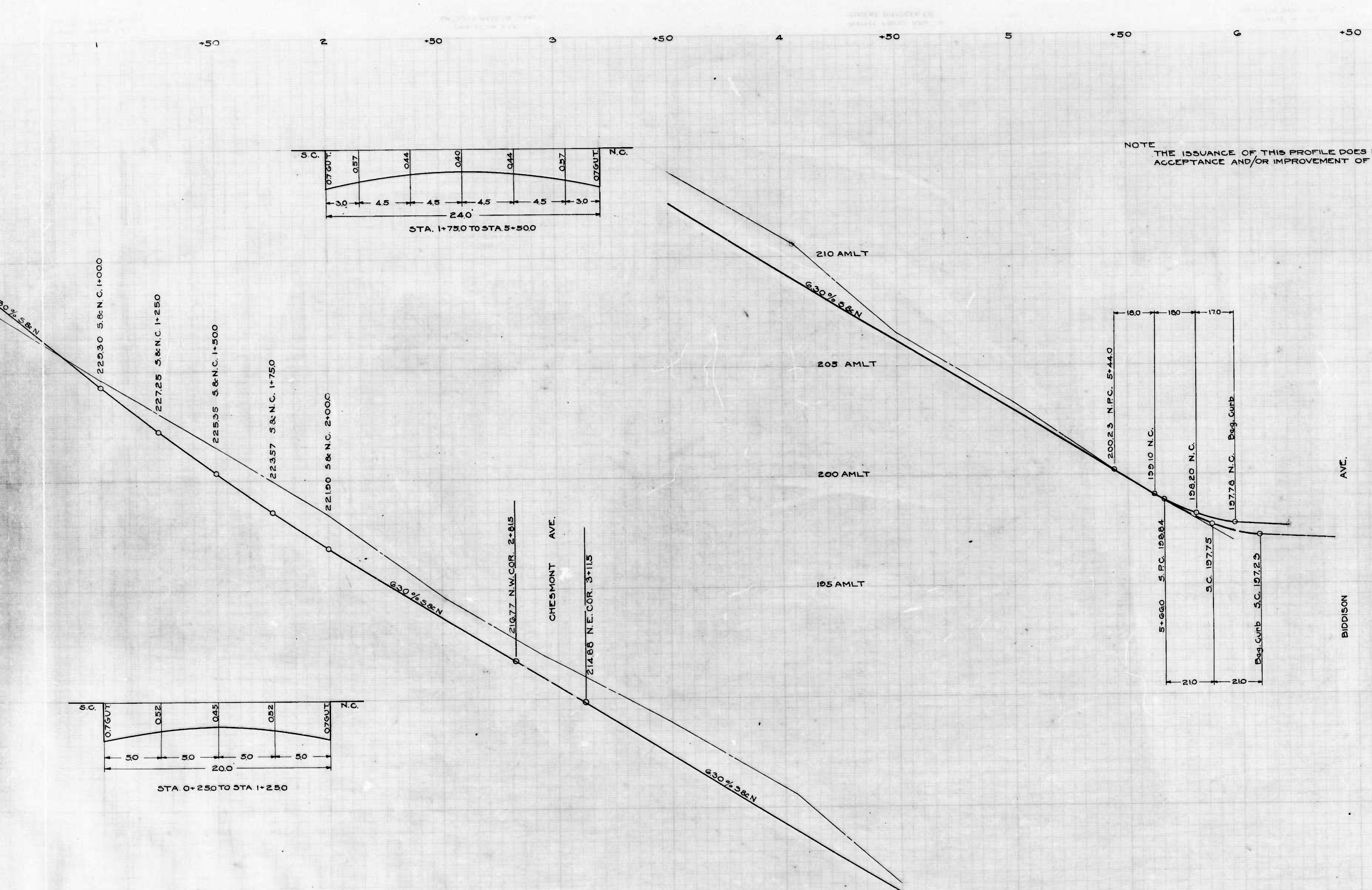

NOTE
THE ISSUANCE OF THIS PROFILE DOES NOT COMMIT THE CITY TO THE
ACCEPTANCE AND/OR IMPROVEMENT OF ANY THOROUGHFARE SHOWN THEREON

CITY OF BALTIMORE
DEPARTMENT OF PUBLIC WORKS
BUREAU OF HIGHWAYS
PROFILE OF
REMMELL AVE - RIDGECROFT RD-BIDDISON AVE.
CONTRACT NO 728
SCALE HOR 1"=200 JULY 11, 1946
VER. 1"=20
CORRECT APPROVED
Edw. J. Hechinger *George Call*
ASSOCIATE ENGINEER HIGHWAYS ENGINEER
APPROVED APPROVED
Edw. J. Hechinger *George Call*
ENGR. PLANS & SURVEYS CHIEF ENGINEER

sheet 1

sheet 2

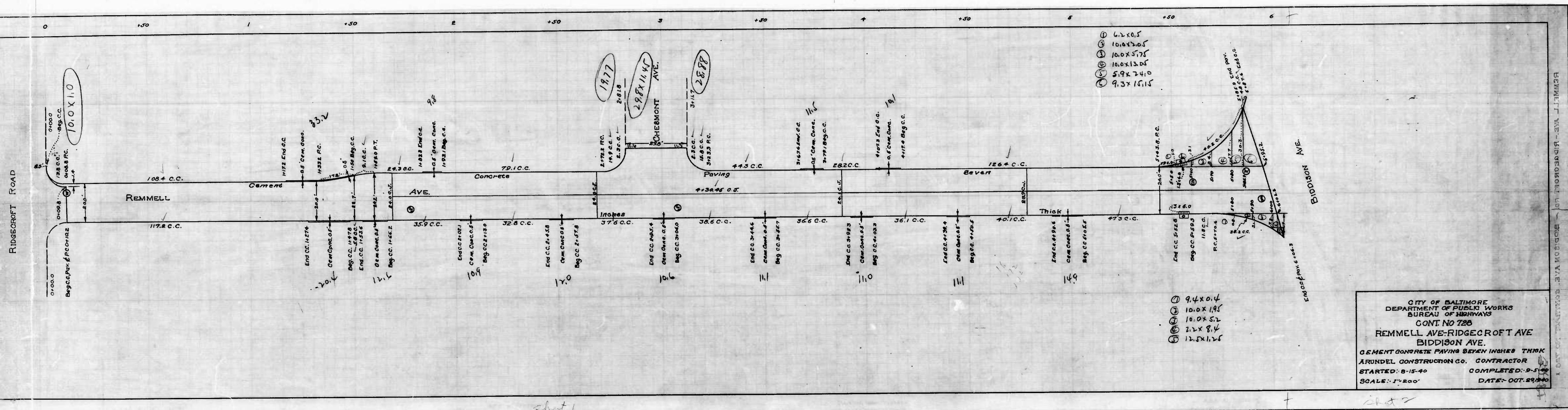

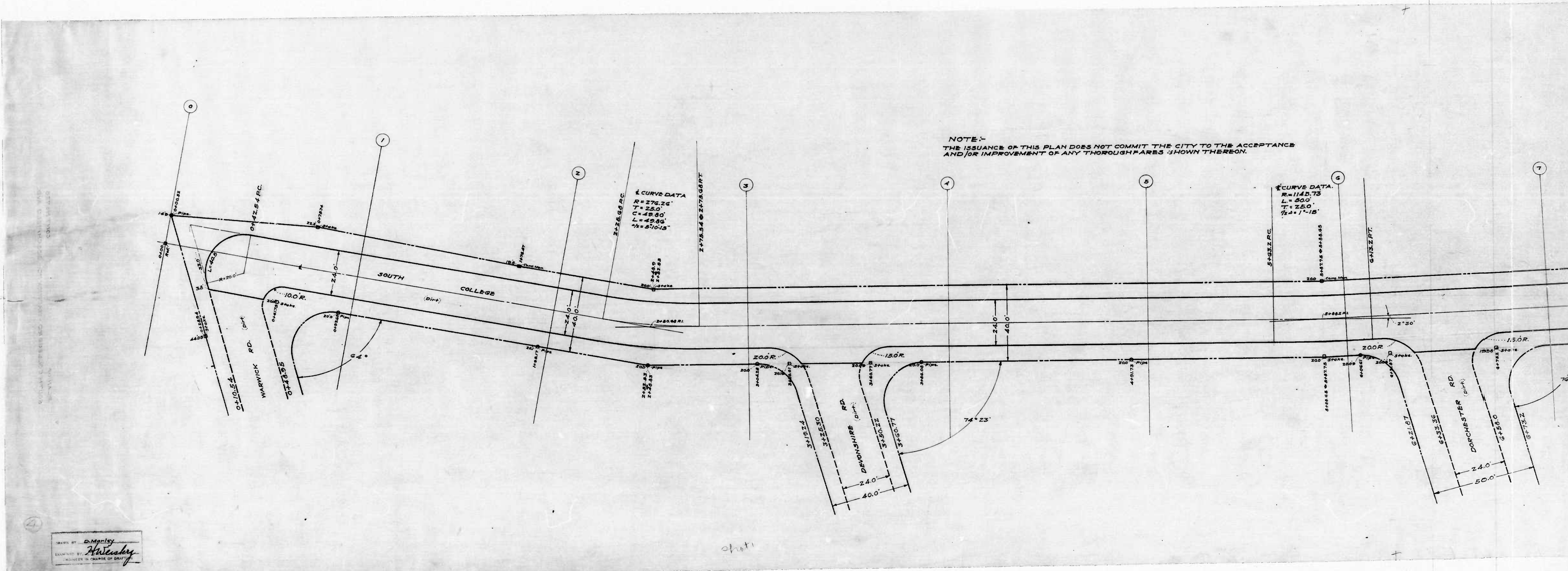

DRAWN BY: D. M. M. M.
ENGINEER: H. H. H. H.
CHECKED BY: J. J. J. J.
IN CHARGE OF DRAFT

photo

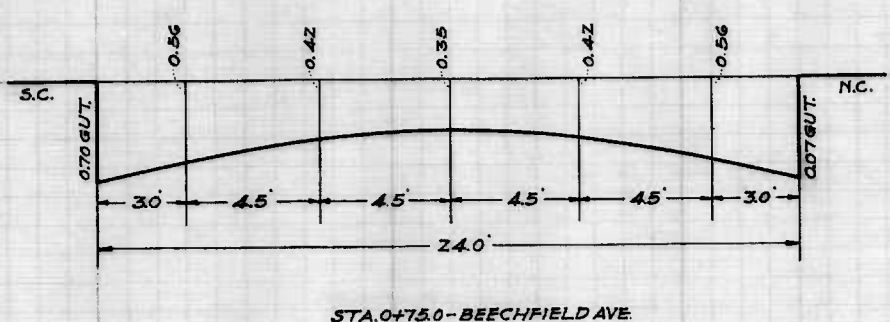
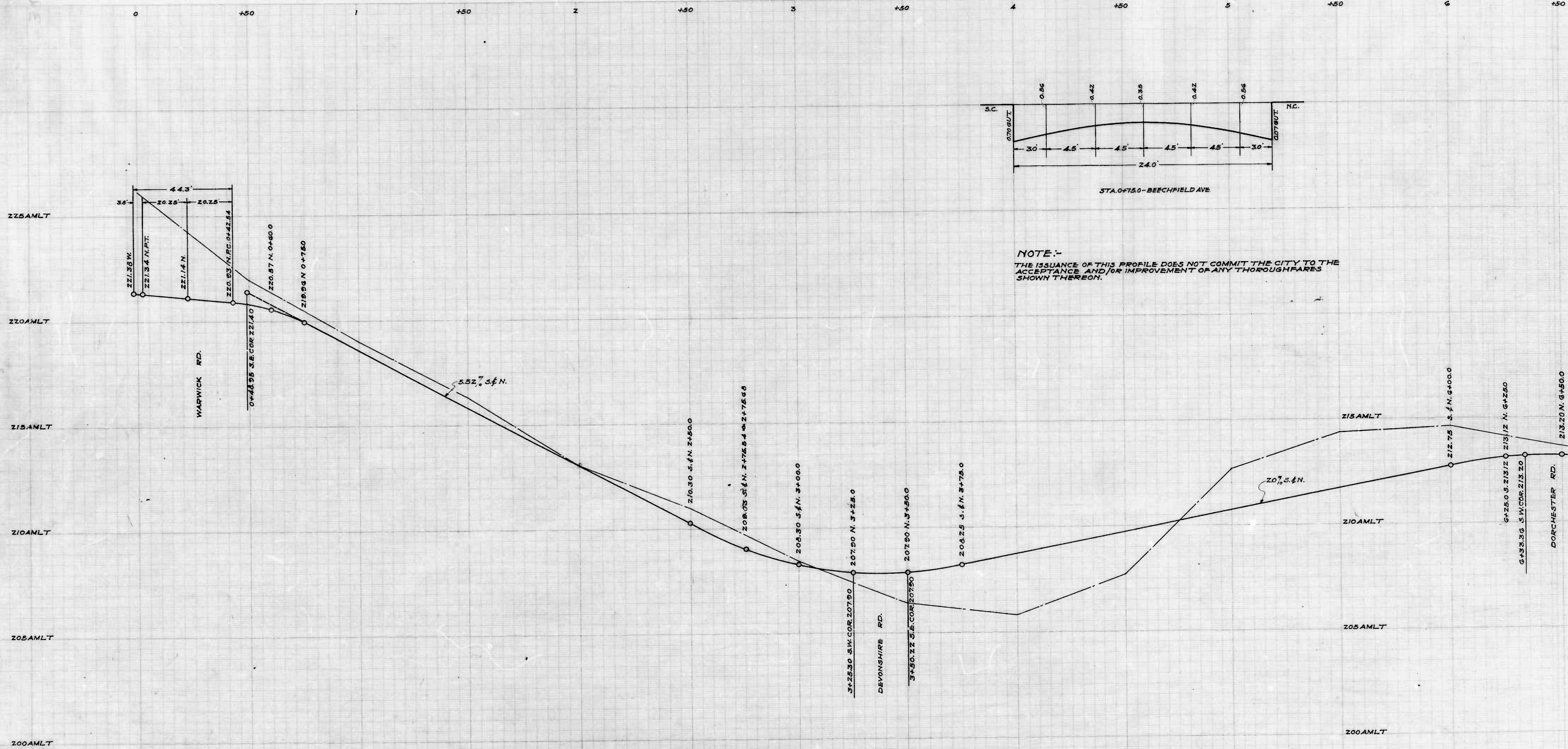

NOTE:-
 THE ISSUANCE OF THIS PROFILE DOES NOT COMMIT THE CITY TO THE ACCEPTANCE AND/OR IMPROVEMENT OF ANY THOROUGHFARES SHOWN THEREON.

CITY ENGINEER ED. WATKINS, 50 - BEECHFIELD AVE
 COVINGTON, LA 70420

DRAWN BY D. Marley
 CHECKED BY H. Weisberg
 ENGINEER IN CHARGE OF DESIGN

Sheet 1

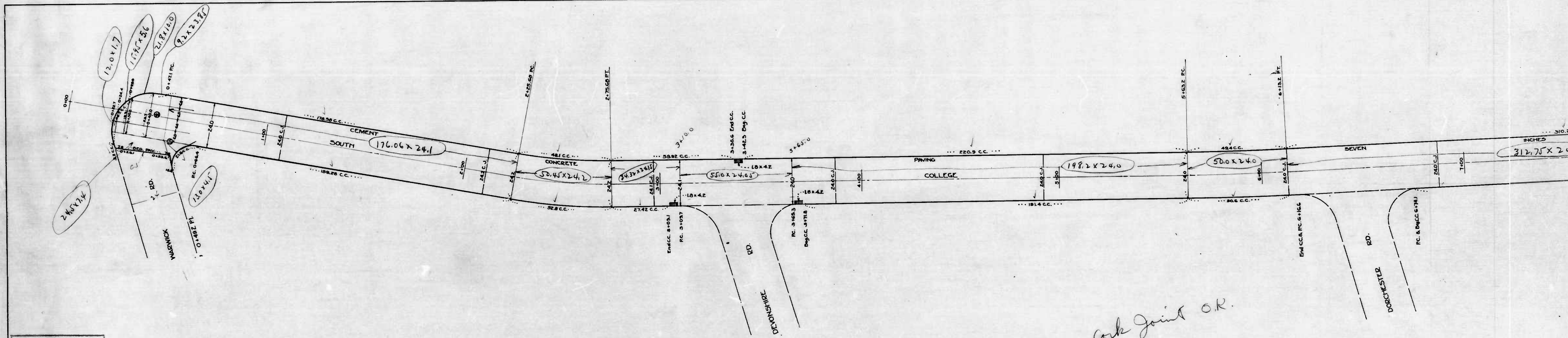

Ask Joint O.K.

DRAWN BY A. Gronet
EXAMINED BY WHE

ent

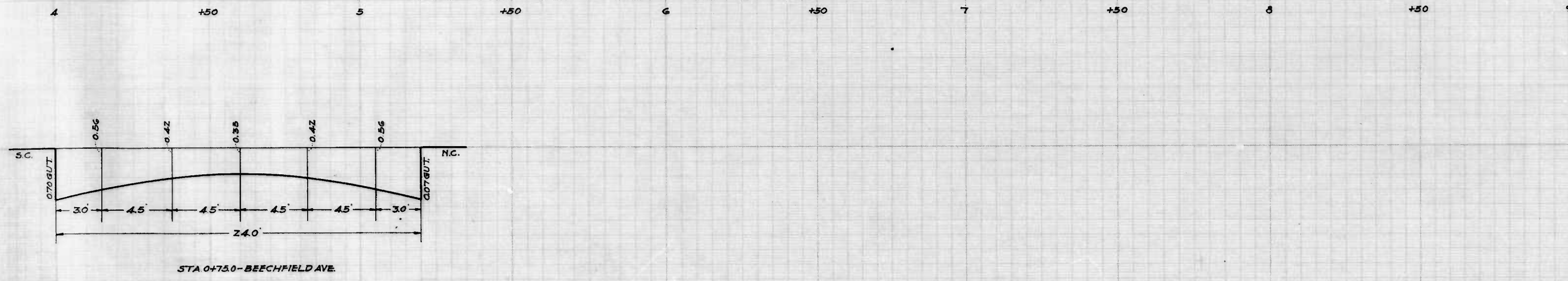

NOTE:-
 THE ISSUANCE OF THIS PROFILE DOES NOT COMMIT THE CITY TO THE
 ACCEPTANCE AND/OR IMPROVEMENT OF ANY THOROUGHFARES
 SHOWN THEREON.

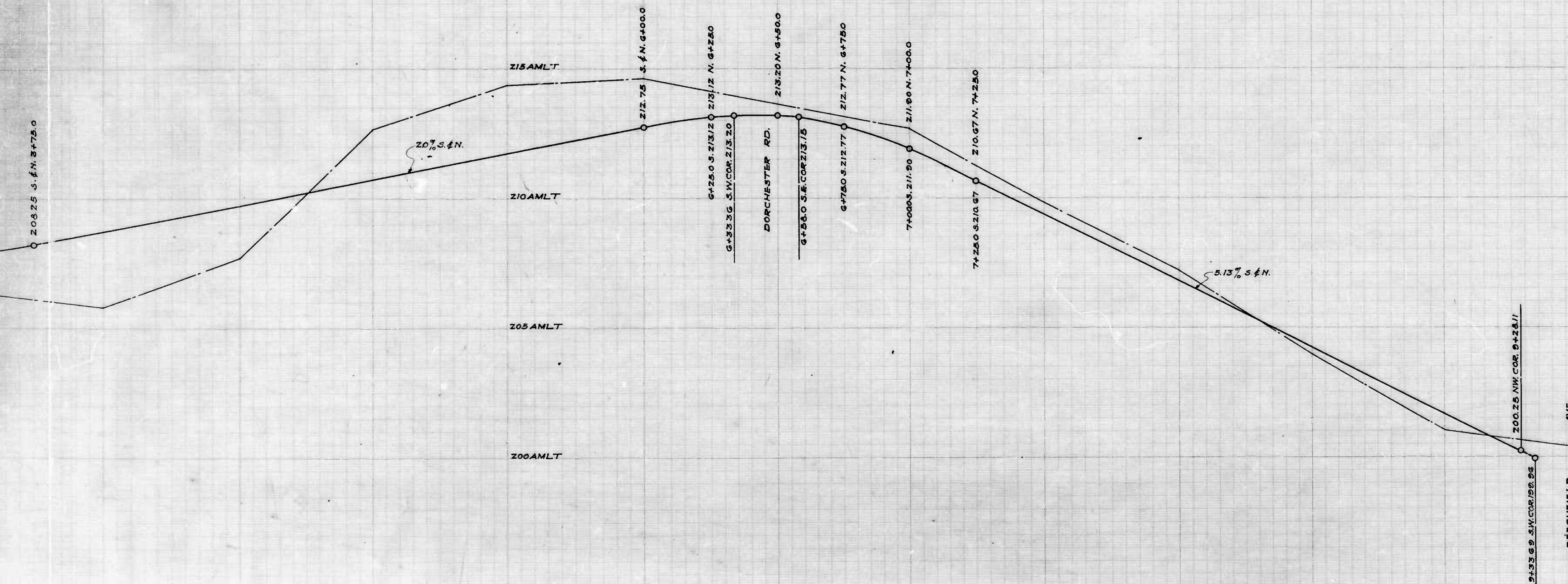

CITY OF BALTIMORE
 DEPARTMENT OF PUBLIC WORKS
 BUREAU OF HIGHWAYS
 PROFILE OF
 SOUTH COLLEGE RD - WARWICK RD - BEECHFIELD AVE.
 CONT. No. 728
 SCALE - HOR - 1" = 200'
 VER - 1" = 2.0'
 BOOK No. X-141
 JUNE 25, 1940

CORRECT
John J. Gorman
 ASSOCIATE ENGINEER
 APPROVED:-
Edward J. Gorman
 ENGR. PLANS & SURVEYS.

APPROVED:-
George A. Gorman
 HIGHWAYS ENGINEER
 APPROVED:-
George A. Gorman
 CHIEF ENGINEER.

SOUTH COLLEGE RD - WARWICK RD - BEECHFIELD AVE
 PROFILE OF
 CONT. No. 728

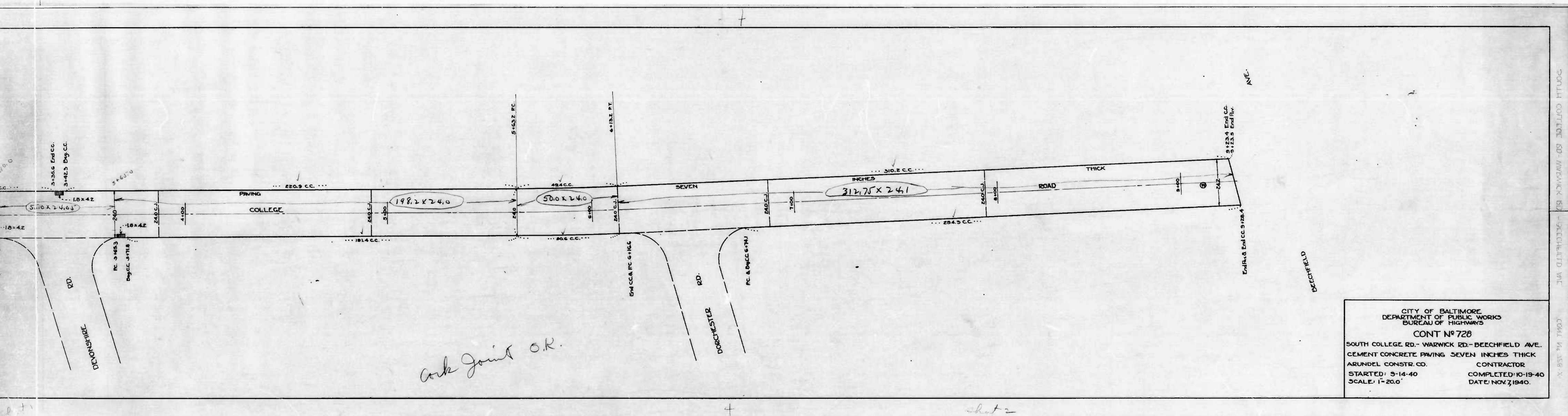

CITY OF BALTIMORE
 DEPARTMENT OF PUBLIC WORKS
 BUREAU OF HIGHWAYS

CONT N^o 728

SOUTH COLLEGE RD. - WARWICK RD. - BEECHFIELD AVE.
 CEMENT CONCRETE PAVING SEVEN INCHES THICK

ARUNDEL CONSTR. CO. CONTRACTOR

STARTED: 3-14-40 COMPLETED: 10-19-40
 SCALE: 1"=20.0' DATE: NOV 7 1940.

CONT. N^o 728
 SOUTH COLLEGE RD. - WARWICK RD. - BEECHFIELD AVE.
 CEMENT CONCRETE PAVING SEVEN INCHES THICK
 ARUNDEL CONSTR. CO. CONTRACTOR
 STARTED: 3-14-40 COMPLETED: 10-19-40
 SCALE: 1"=20.0' DATE: NOV 7 1940.