

shot 3

CITY OF BALTIMORE
DEPARTMENT OF PUBLIC WORKS
BUREAU OF HIGHWAYS
PROFILE OF
THE ALAMEDA-HARFORD RD.-30TH ST.
SCALE: HOR: 1"=20.0' BOOK NO. X-135
VER: 1"=20' DATE: MAY 4, 1940.
CONT. NO. 723

CORRECT
Edmund J. [Signature]
ASSOCIATE ENGINEER

APPROVED
George A. [Signature]
HIGHWAYS ENGINEER

APPROVED
Edmund J. [Signature]
ENGR. PLANS & SURVEYS

APPROVED
George A. [Signature]
CHIEF ENGINEER

THE ALAMEDA-HARFORD RD.-30TH ST.
PROFILE OF
CONT. NO. 723

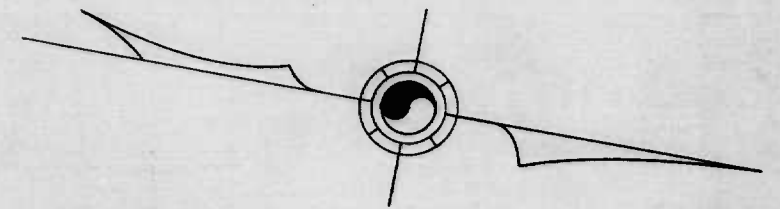
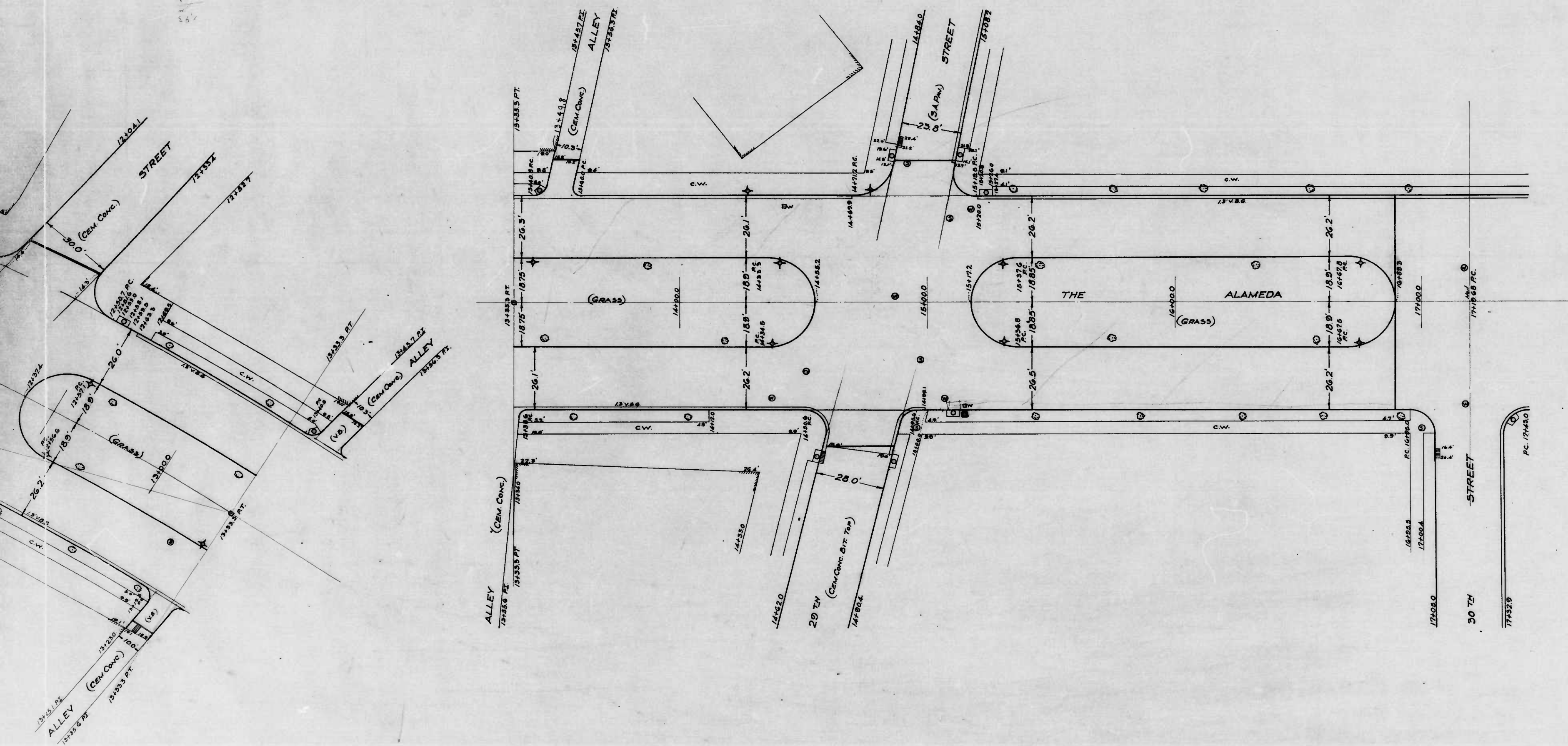

CITY OF BALTIMORE
DEPARTMENT OF PUBLIC WORKS
BUREAU OF HIGHWAYS
PLAN OF
THE ALAMEDA - HARFORD RD - 30TH ST.
SCALE: 1" = 200'
BOOK N° X-135
CONT. N° 723
DATE: APR 10, 1940
APPROVED
CORRECT
APPROVED
APPROVED
ENGR. PLANS & SURVEYS
CHIEF ENGINEER

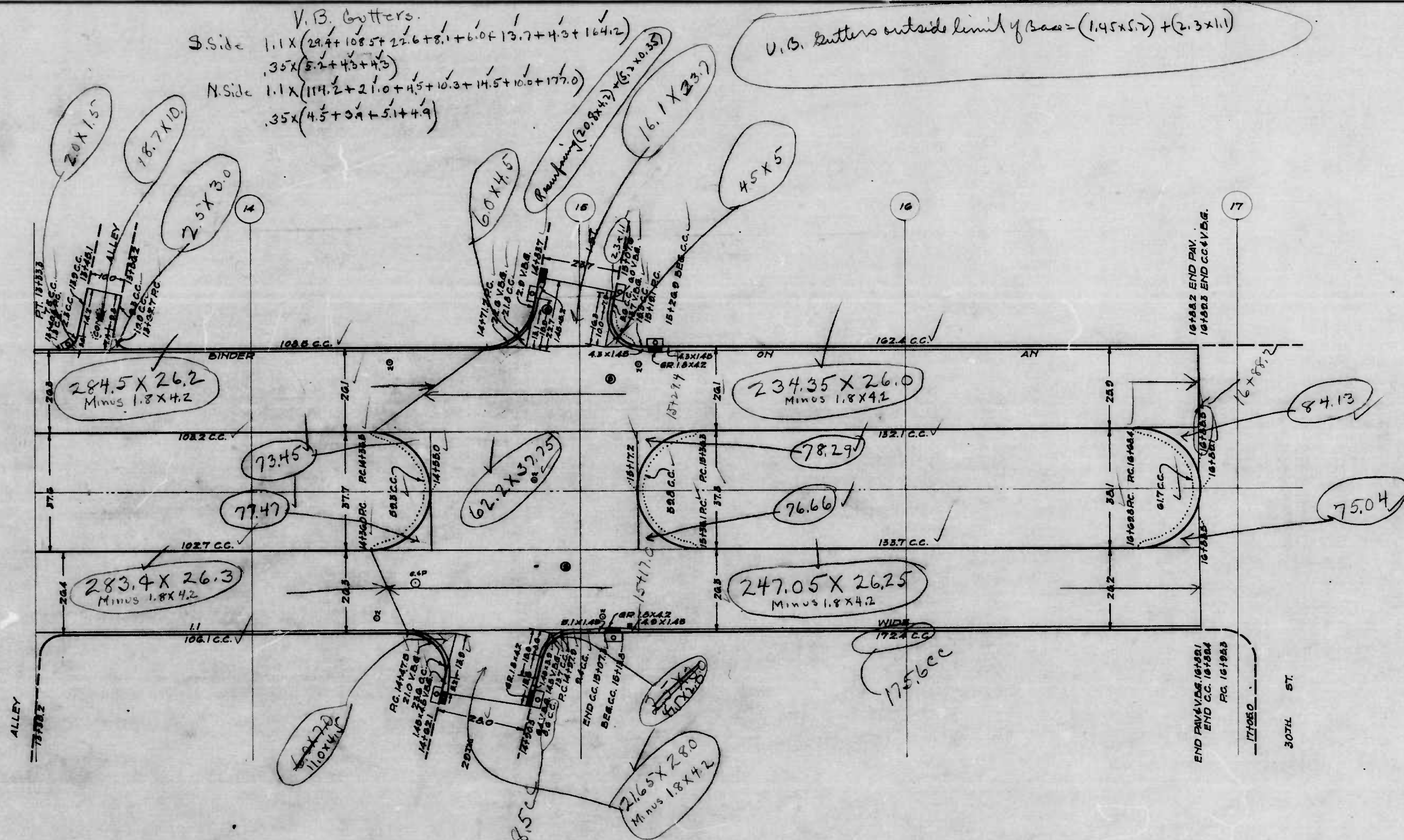
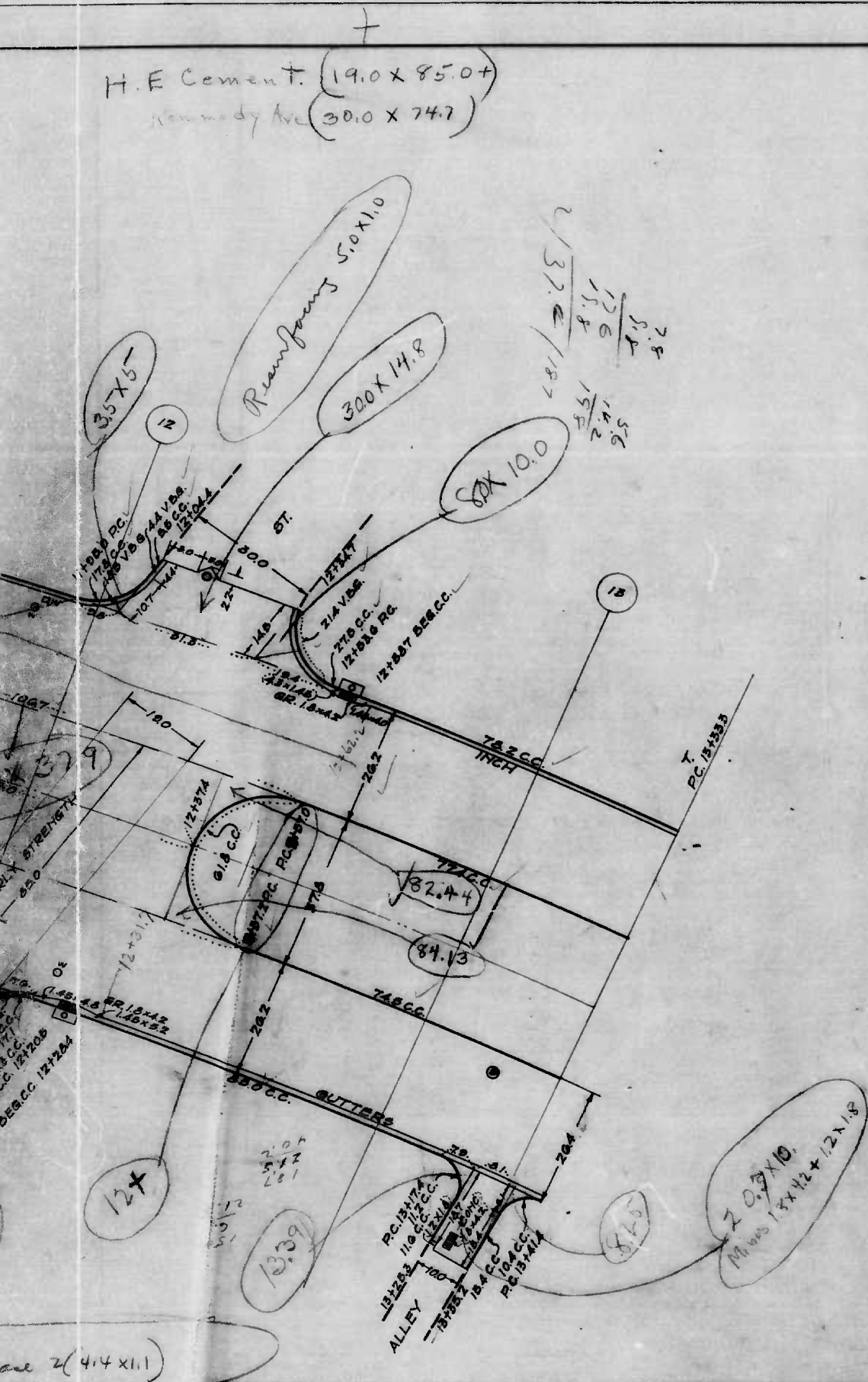

CITY OF BALTIMORE
DEPARTMENT OF PUBLIC WORKS
BUREAU OF HIGHWAYS
CONT. NO. 723
THE ALAMEDA - HARFORD RD - 30TH
SH. ASP. PAV. 1/2" WEARIN. SUR. 1/2" BINDER OF
AN 8" CONC. BASE VER. PAV. 1/2" BR. BUT. 1/2" WIDE
BALTA. ASP. BLK. & TILE CO.
STARTED - 7-16-40
SCALE - 1" = 200'

CONTRACT
COMPR. 8-25
DATE - 11-22

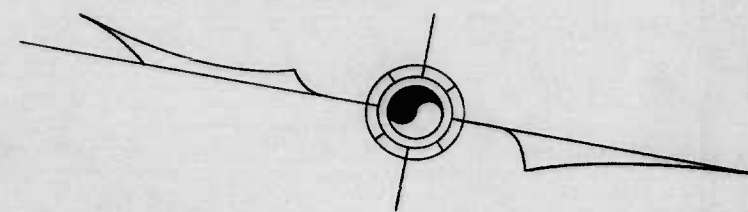
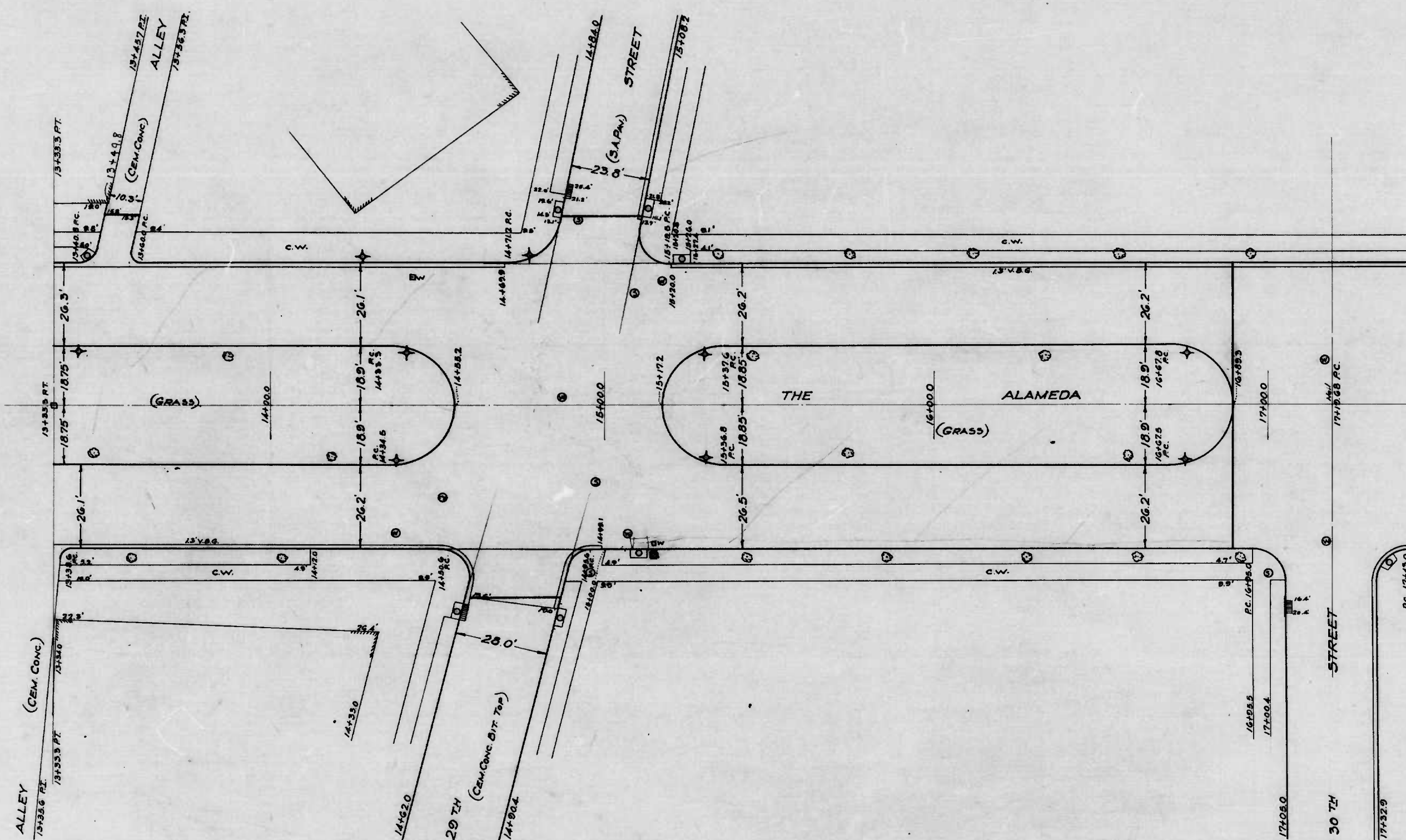

CITY OF BALTIMORE
DEPARTMENT OF PUBLIC WORKS
BUREAU OF HIGHWAYS
PLAN OF
THE ALAMEDA - HARFORD RD - 30 TH ST.
SCALE: 1" = 20' 500K N° X-138
CONT. N° 723 DATE: APR. 10, 1940
CORRECT APPROVED
Chas. G. Hays
ASSOCIATE ENGINEER
APPROVED
George A. Hays
HIGHWAYS ENGINEER
APPROVED
Edward J. Hays
ENGR. PLANS & SURVEYS
George A. Hays
CHIEF ENGINEER

RATIO - 24

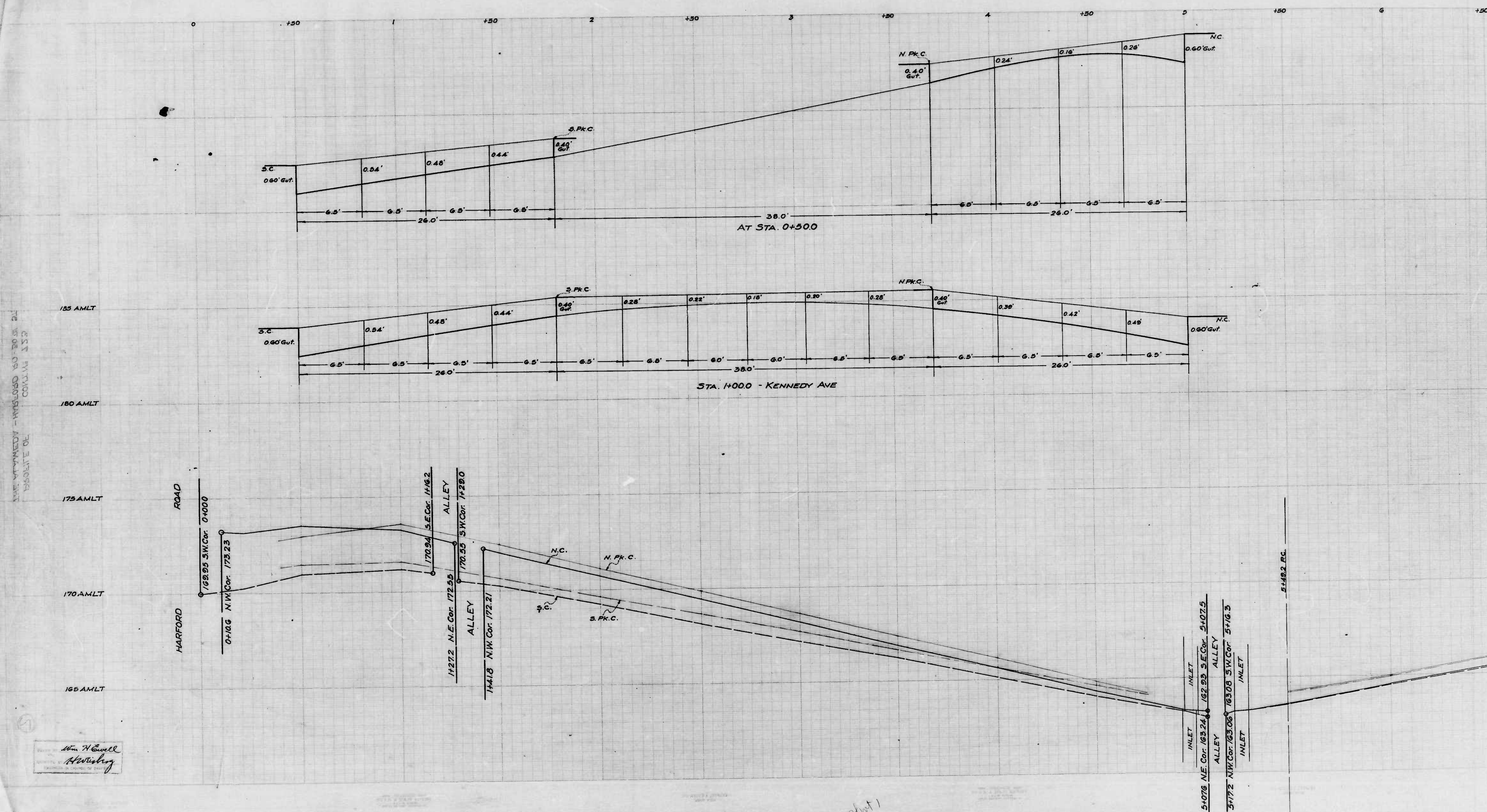

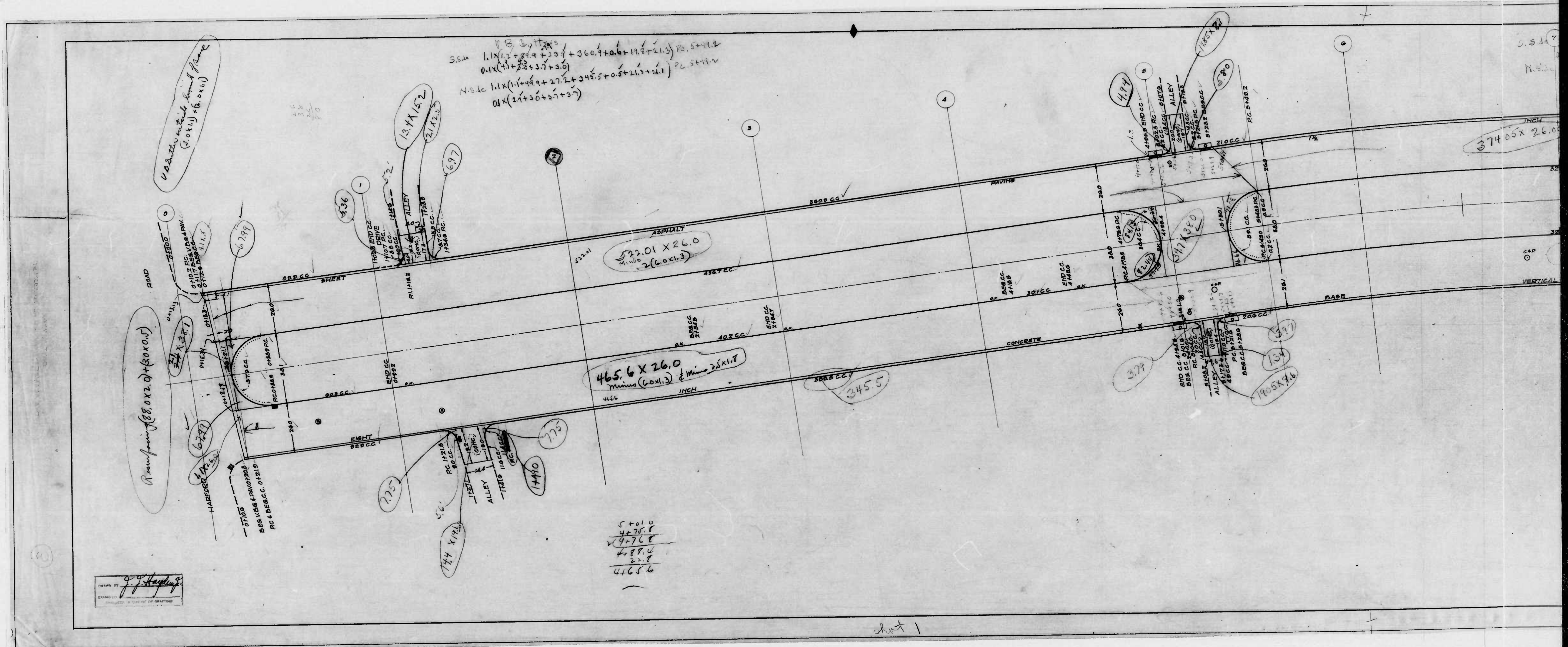

7 2 3

RATIO - 24

