

51
102
100

Marley
Horseshy

Sheet 1

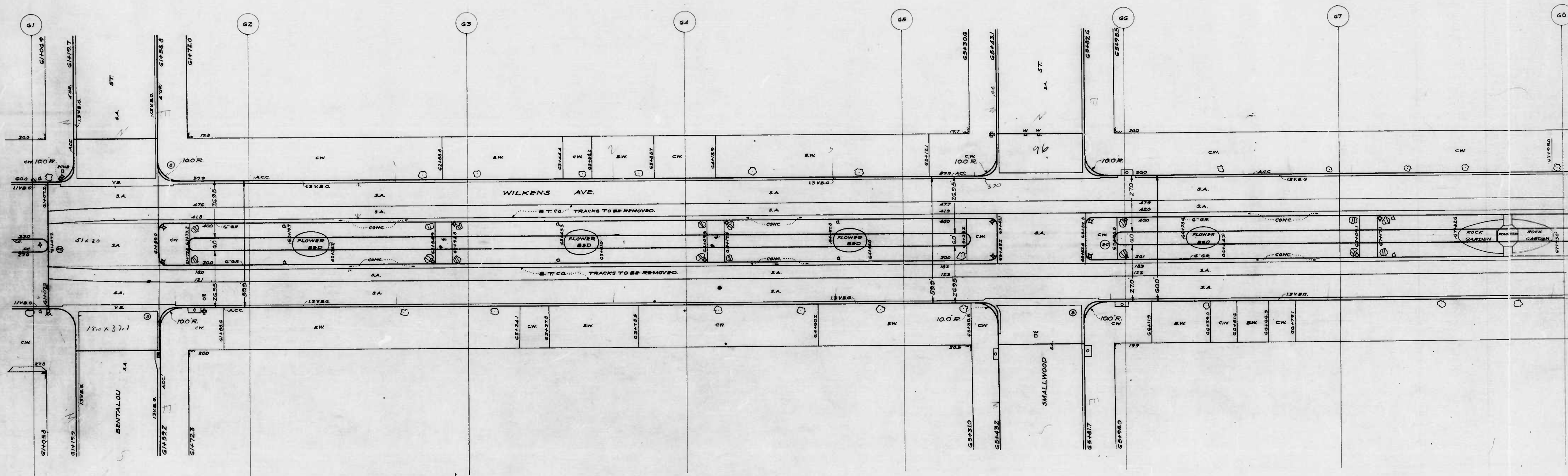

51
52
102
100

D. Marley
Horseshoe

Sheet 1

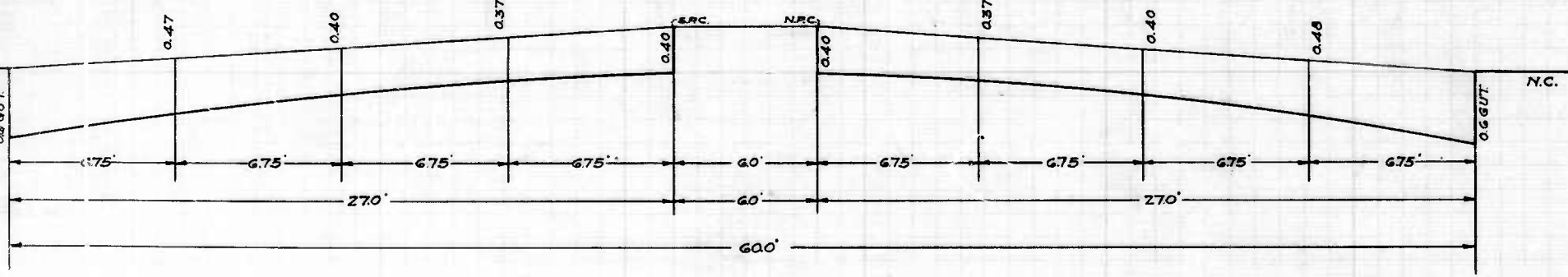
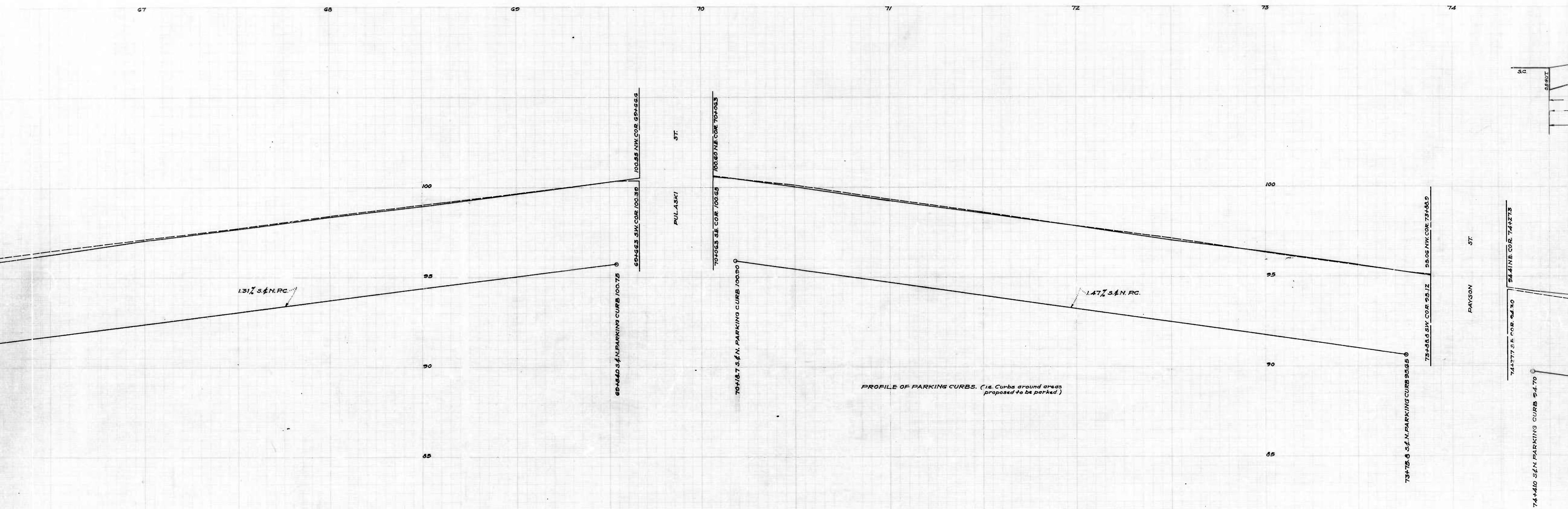

SMALLWOOD ST - PULASKI ST.
 PULASKI ST - PAYSON ST.

ch 12

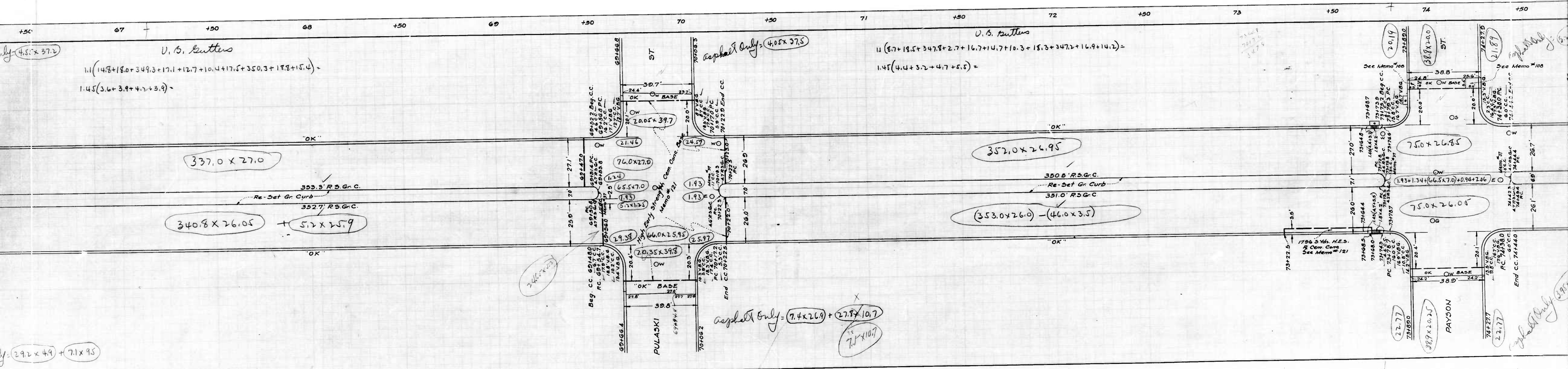

U. B. Kuttus
 $1.1(14.8+18.0+34.3+17.1+12.7+10.4+17.5+35.0+3+18.8+15.4) =$
 $1.45(3.6+3.9+4.7+3.9) =$

U. B. Kuttus
 $11(8.7+18.5+34.8+2.7+16.7+14.7+10.3+15.3+34.7+16.9+14.2) =$
 $1.45(4.4+3.7+4.7+5.5) =$

337.0 X 27.0
 340.8 X 26.05 + 5.2 X 25.9

352.0 X 26.95
 350.6 R.S.G.C.
 Re-Set Gr Curb
 351.0 R.S.G.C.
 (353.0 X 26.0) - (46.0 X 3.5)

asphalt Only = 7.4 X 26.9 + 27.8 X 10.7
 7.5 X 10.7

22.77
 38.9 X 20.25
 PAYSON

2.92 X 4.9 + 7.1 X 9.5

shot 2

1.53
4
6.12

2538

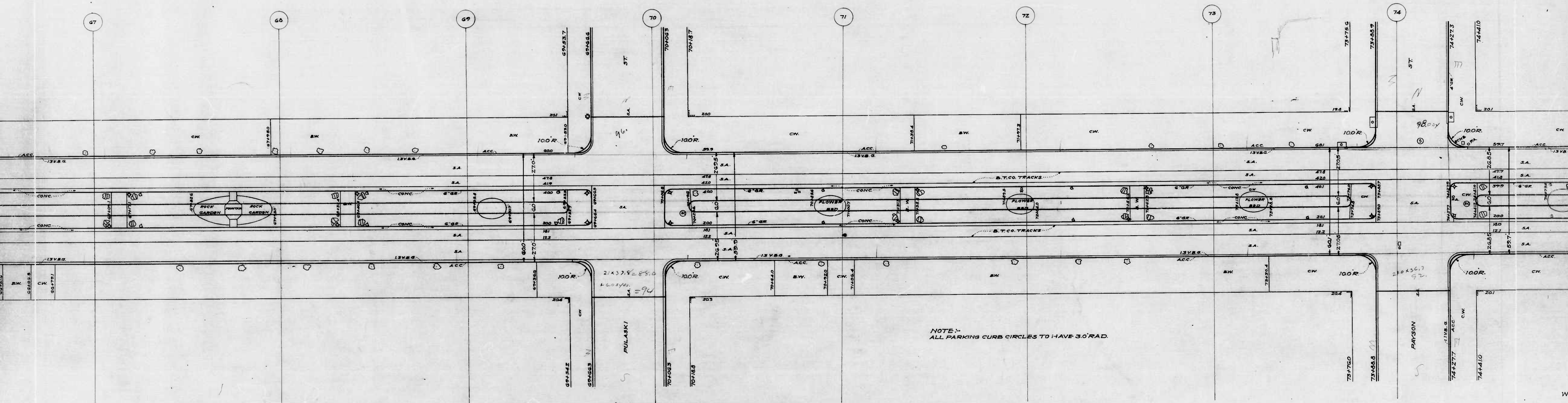

NOTE:- ALL PARKING CURB CIRCLES TO HAVE 30' RAD.

shot 2

WILL
SCA
CORRECT
ASSOCIAT
APPROV
ENGR PLAN

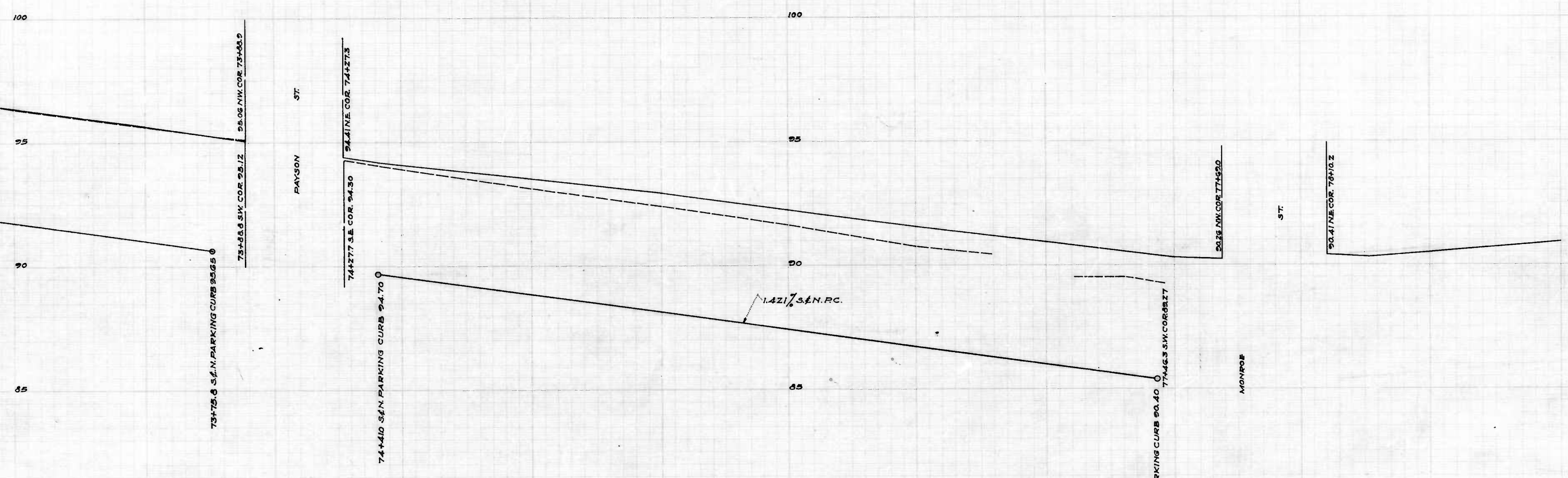
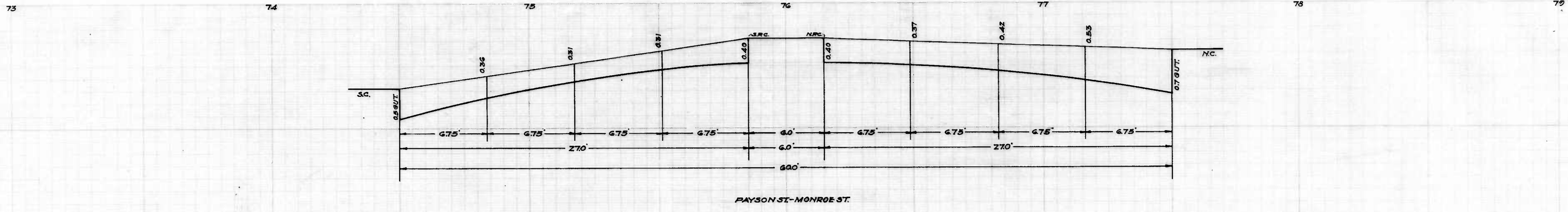

CITY OF BALTIMORE
 DEPARTMENT OF PUBLIC WORKS
 BUREAU OF HIGHWAYS
 PROFILE OF
 WILKENS AVE. - BENTALOU ST. - MONROE ST.
 CONT. NO. 721
 SCALES: - HOR. 1" = 20.0' BOOK X-59
 VER. 1" = 20' MAR. 27, 1940

CORRECTED:
[Signature]
 ASSOCIATE ENGINEER

APPROVED:-
[Signature]
 HIGHWAYS ENGINEER

APPROVED:-
[Signature]
 ENGR. PLANS & SURVEYS.

APPROVED:-
[Signature]
 CHIEF ENGINEER.

Sheet 3

WILKENS AVE. - BENTALOU ST. - MONROE ST.
 CONT. NO. 721

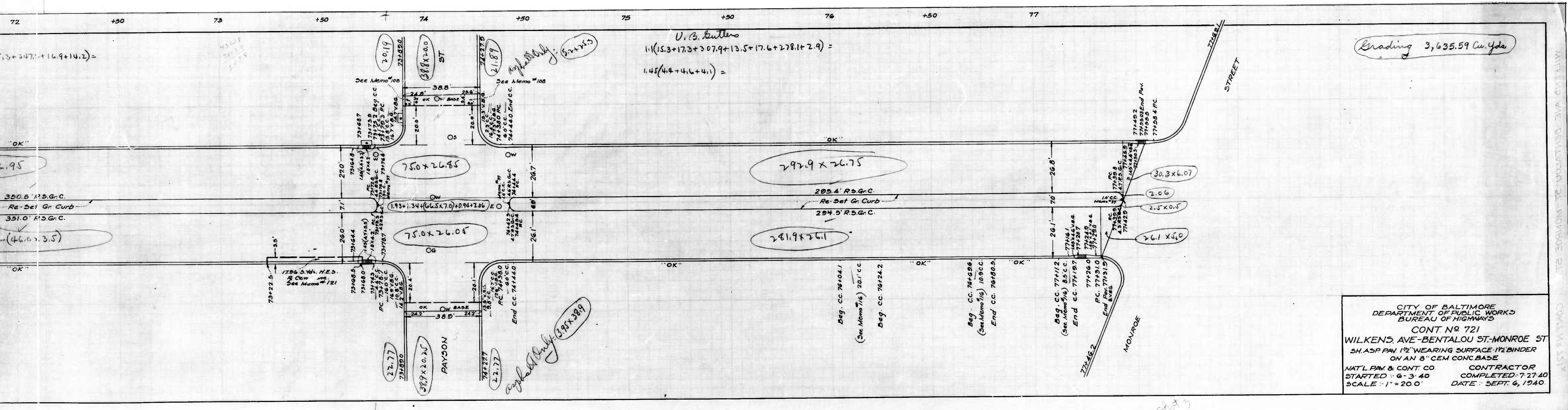

CITY OF BALTIMORE
 DEPARTMENT OF PUBLIC WORKS
 BUREAU OF HIGHWAYS
 CONT NO 721
 WILKENS AVE-BENTALOU ST-MONROE ST
 SH. ASP PAV 1 1/2" WEARING SURFACE 1 1/2" BINDER
 ON AN 8" CEM. CONC. BASE
 NAT'L PAV. & CONT. CO. CONTRACTOR
 STARTED 6-3-40 COMPLETED 7-27-40
 SCALE 1" = 20' DATE SEPT. 6, 1940

22481.1
18+01.5
211.2

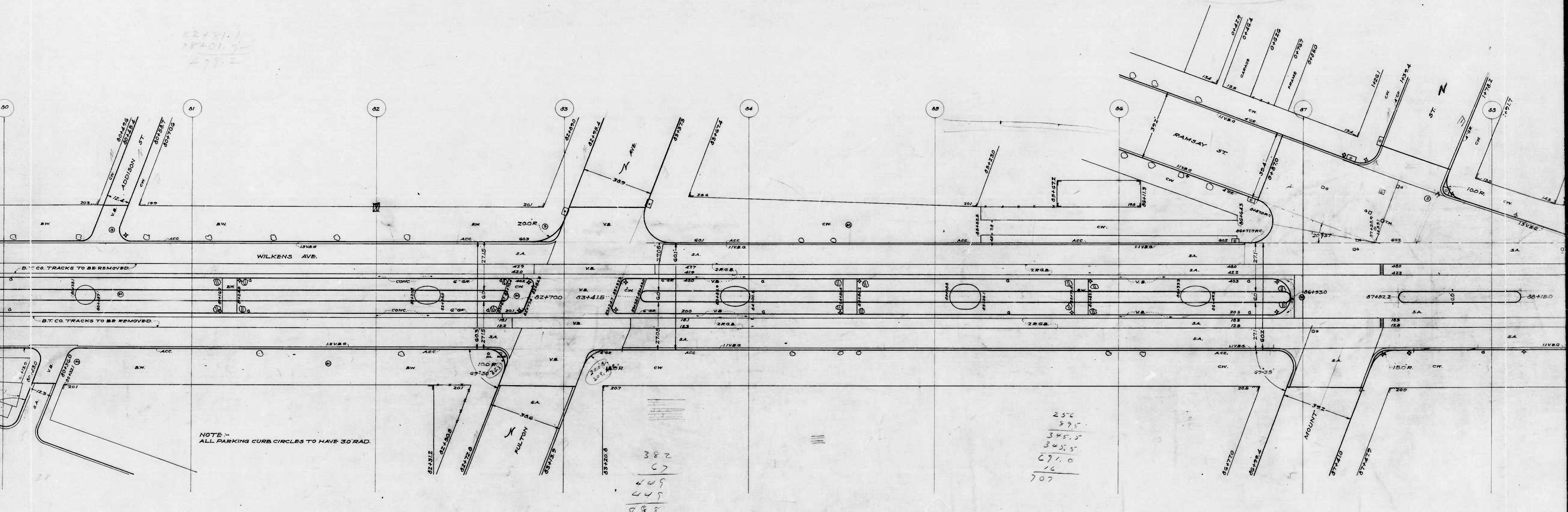

NOTE -
ALL PARKING CURB CIRCLES TO HAVE 30' RAD.

382
67
449
449
898

252
895
345.5
345.5
691.0
16
707

Sheet 4

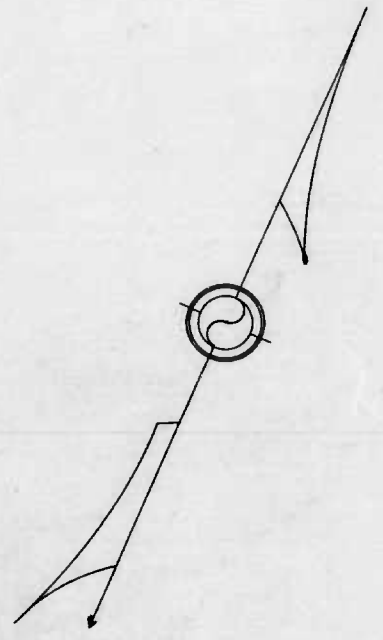
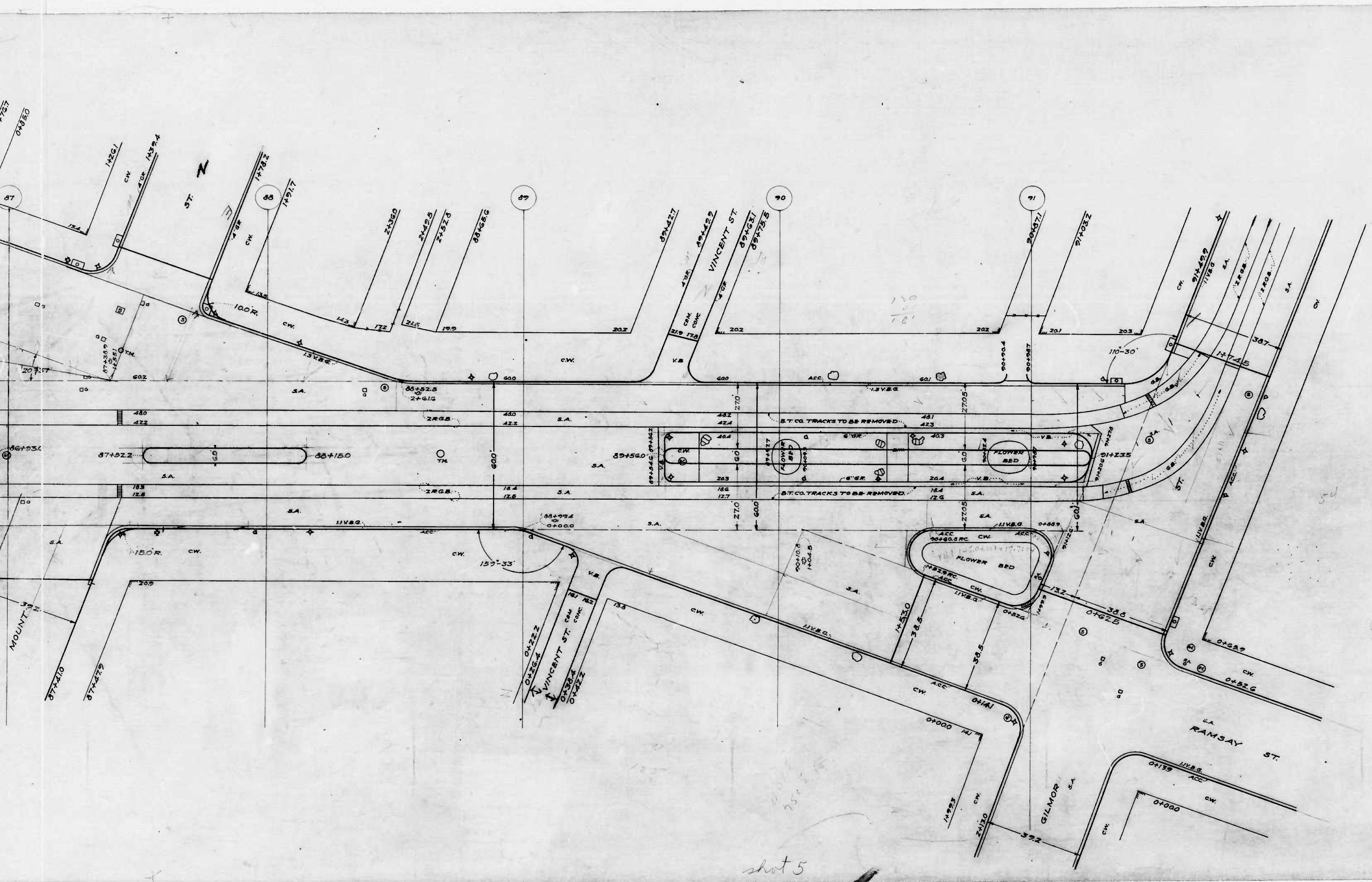

CITY OF BALTIMORE
 DEPARTMENT OF PUBLIC WORKS
 BUREAU OF HIGHWAYS
 PLAN OF
 WILKENS AVE - MONROE ST - GILMOR ST.

SCALE: 1"=200' CONT. No. 722 BOOK X-59
 MAR. 27, 1940

CORRECT.
[Signature]
 ASSOCIATE ENGINEER

APPROVED
[Signature]
 HIGHWAYS ENGINEER

APPROVED
[Signature]
 ENGR. PLANS & SURVEYS

APPROVED
[Signature]
 CHIEF ENGINEER

shot 5

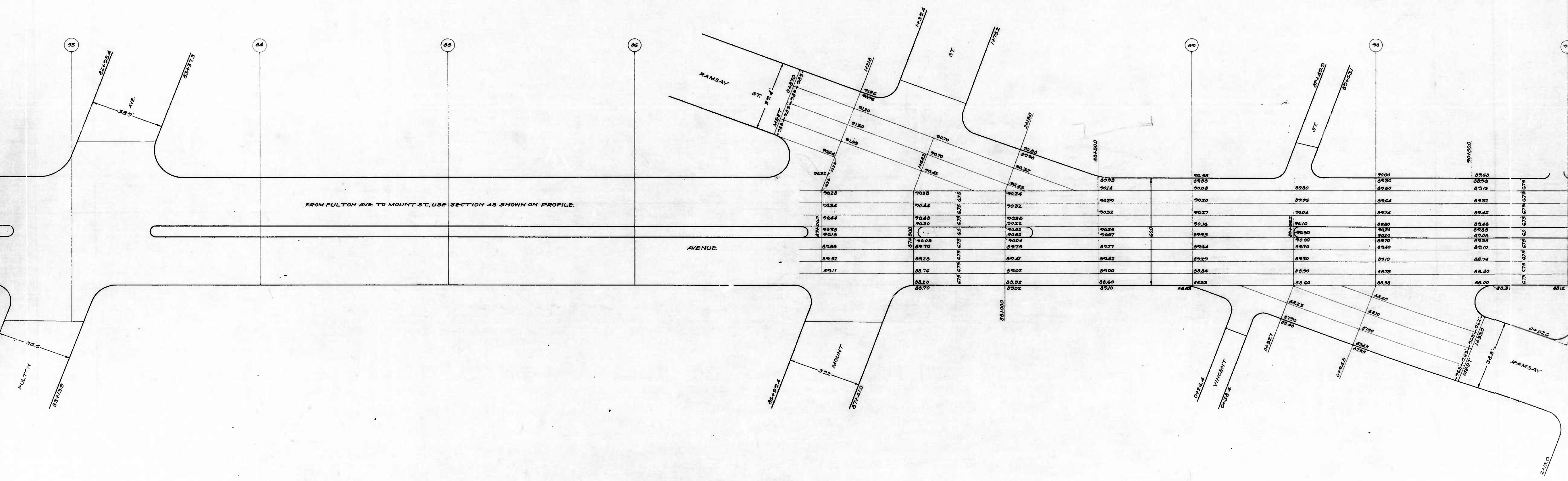

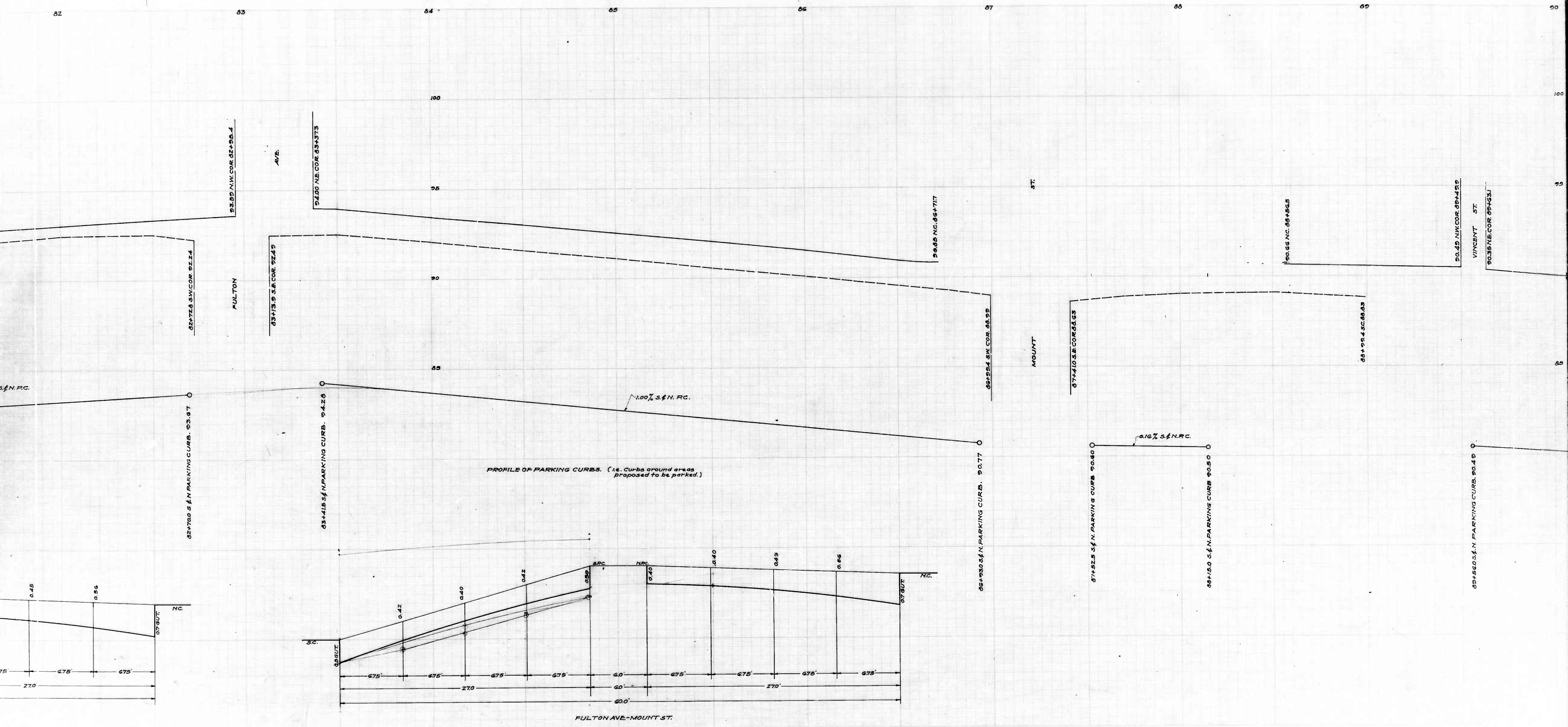

Sheet 2

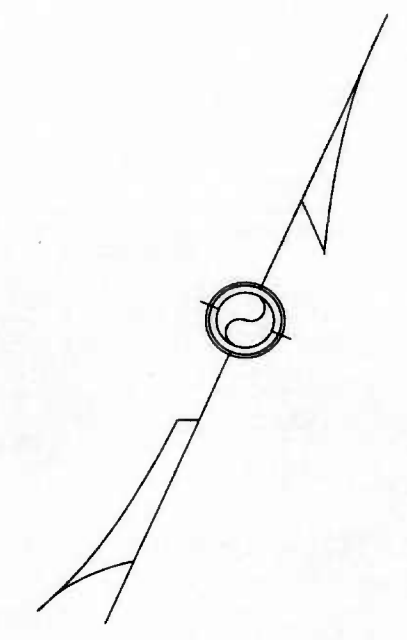
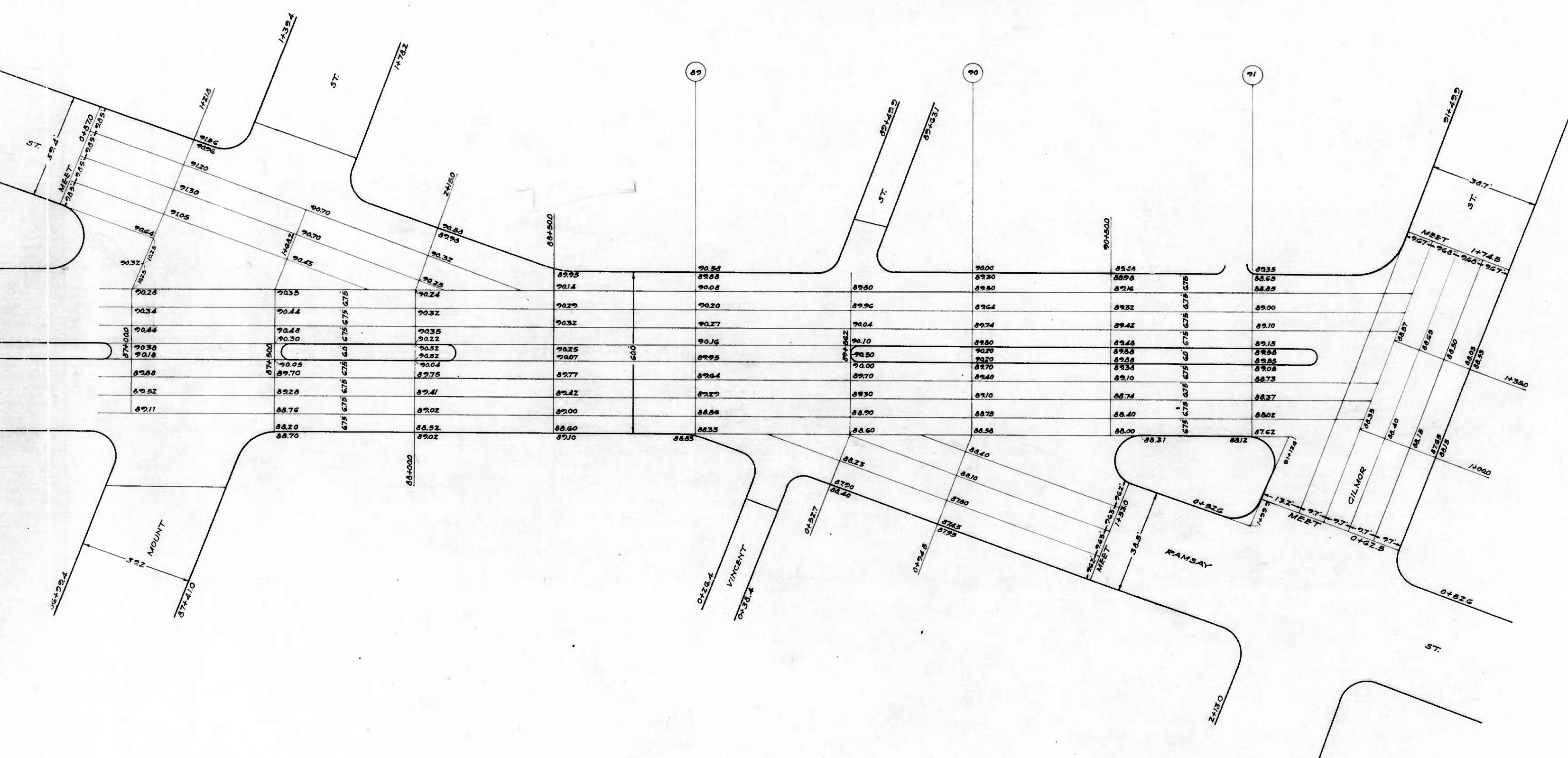

CITY OF BALTIMORE
 DEPARTMENT OF PUBLIC WORKS
 BUREAU OF HIGHWAYS
 PLAN SHOWING ELEVATIONS OF IMPROVEMENT
 WILKENS AVE. - MONROE ST. - GILMOR ST.
 CONT'G. 722
 SCALE - 1" = 200' MAR. 27, 1940

CORRECTED: *Edmund J. Reppner* ASSOCIATE ENGINEER
 APPROVED: *George A. Adams* HIGHWAYS ENGINEER
 APPROVED: *Edmund J. Reppner* ENGINEERS & SURVEYS
 APPROVED: *George A. Adams* CHIEF ENGINEER

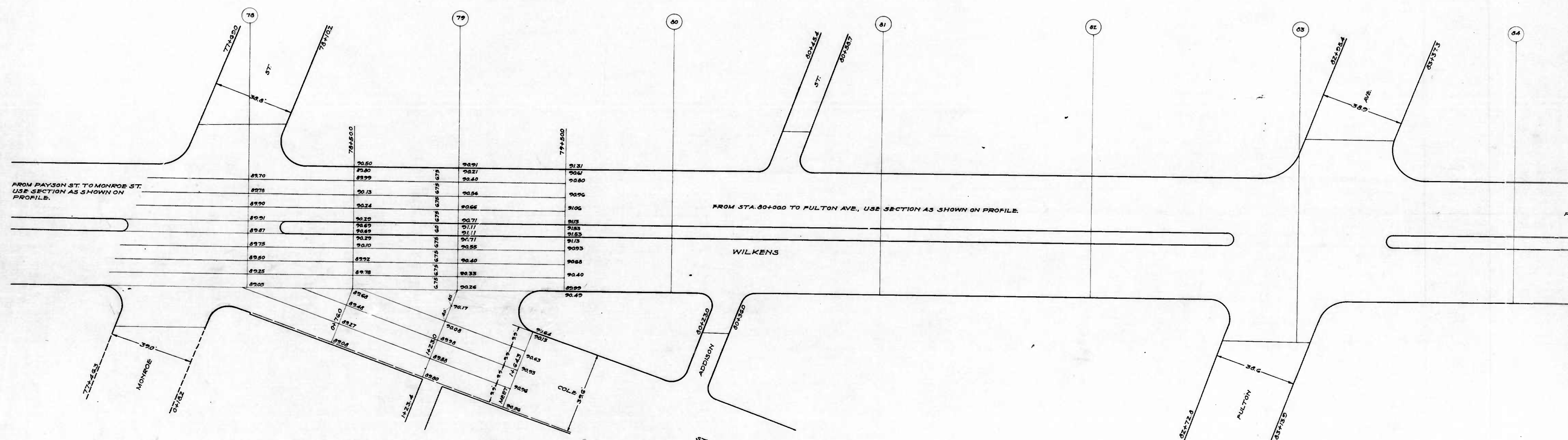



D. Marley
H. Marley
 ENGINEER - COURTESY OF DRAWING

STA 80+000 - FULTON AVE.