

Notes - All Street Circles To Have 15.0 Radius.
All Alley Circles To Have 6.0 Radius.

E. Curve Data
R - 1710.12
T - 223.66
C - 443.07
A - 14°49'30"
D - 3°20'00"
600 Pac / Ft.

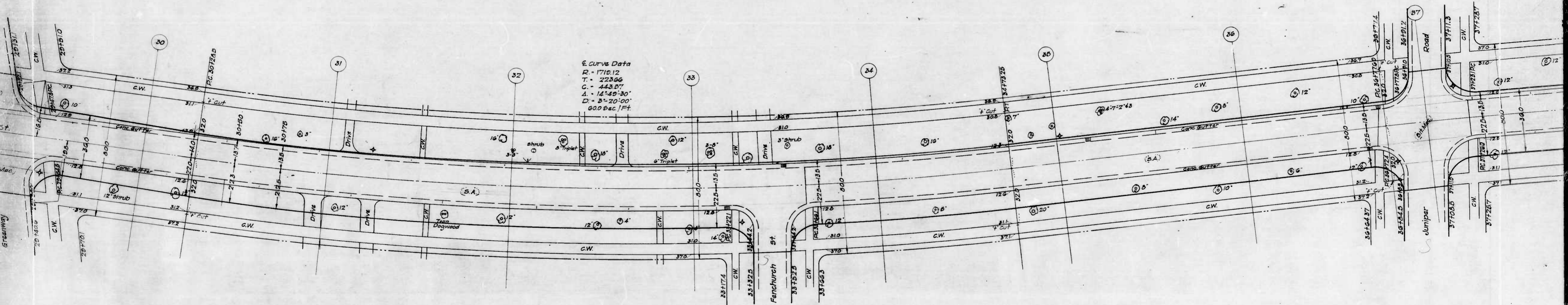

2nd sheet

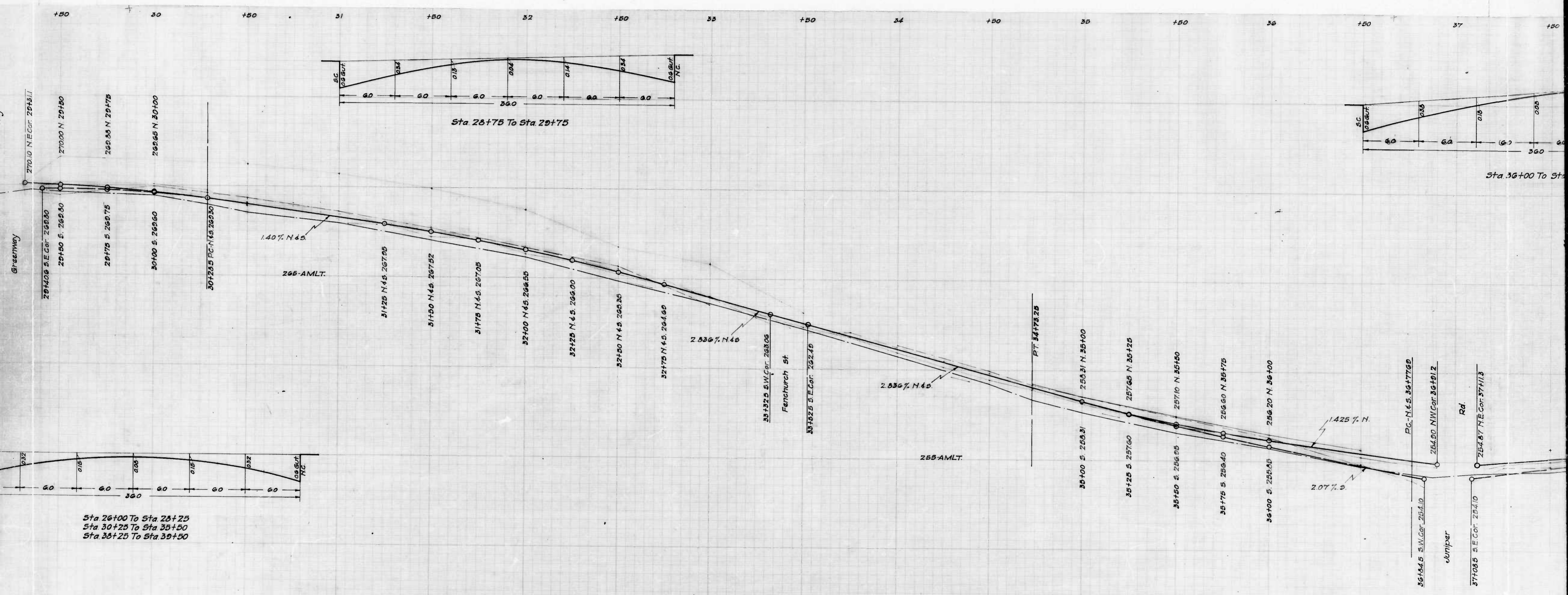

Sta 26+00 To Sta 26+25
 Sta 30+25 To Sta 35+50
 Sta 36+25 To Sta 39+50

Sheet 2

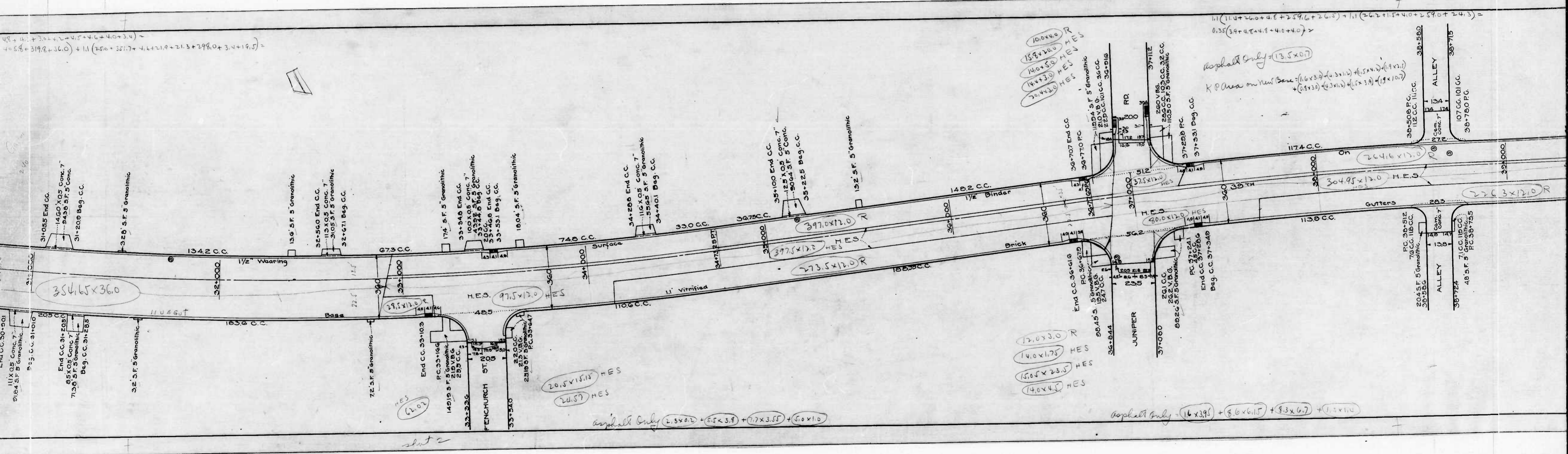

$$48 + 41 + 32 + 22 + 45 + 46 + 40 + 34 = 268$$

$$4058 + 3192 + 360 + 11(256 + 351.7 + 4.6 + 21.9 + 21.3 + 298.0 + 3.4 + 19.5) = 4058 + 3192 + 360 + 11(1050.8) = 4058 + 3192 + 360 + 11558.8 = 19368.8$$

$$1.1(11.0 + 26.0 + 4.8 + 259.6 + 26.0) + 1.1(26.2 + 154.0 + 259.6 + 24.3) = 0.35(39 + 4.8 + 4.0 + 4.0) = 2.8$$

Asphalt Only = 13.5×0.7
 K.P. Area on New Base = $(1.6 \times 3.0) + (1.5 \times 1.2) + (1.5 \times 1.2) + (0.8 \times 3.0) + (0.8 \times 1.2) + (1.9 \times 1.0) = 7.5$

- 100x40 R
- 158x20.0 HES
- 140x5.0 HES
- 144x3.0 HES
- 70.4x3.0 HES

- 12.0x3.0 R
- 14.0x1.75 HES
- 15.0x23.5 HES
- 14.0x4.5 HES

- 20.5x11.15 HES
- 20.5 HES

Asphalt Only = $2.3 \times 0.2 + 0.5 \times 3.8 + 7.7 \times 3.35 + 5.0 \times 1.0$

Asphalt Only = $(16 \times 3.95) + (8.6 \times 6.15) + (3 \times 6.7) + 1.3 \times 1.0$

slat 2

