

NOTE :-  
 THE ISSUANCE OF THIS PLAN DOES NOT COMMIT THE CITY  
 TO THE ACCEPTANCE AND/OR IMPROVEMENT OF ANY  
 THOROUGHFARES SHOWN THEREON.

DESIGNED BY D. M. H. H. H.  
 H. H. H.

SHOT 1

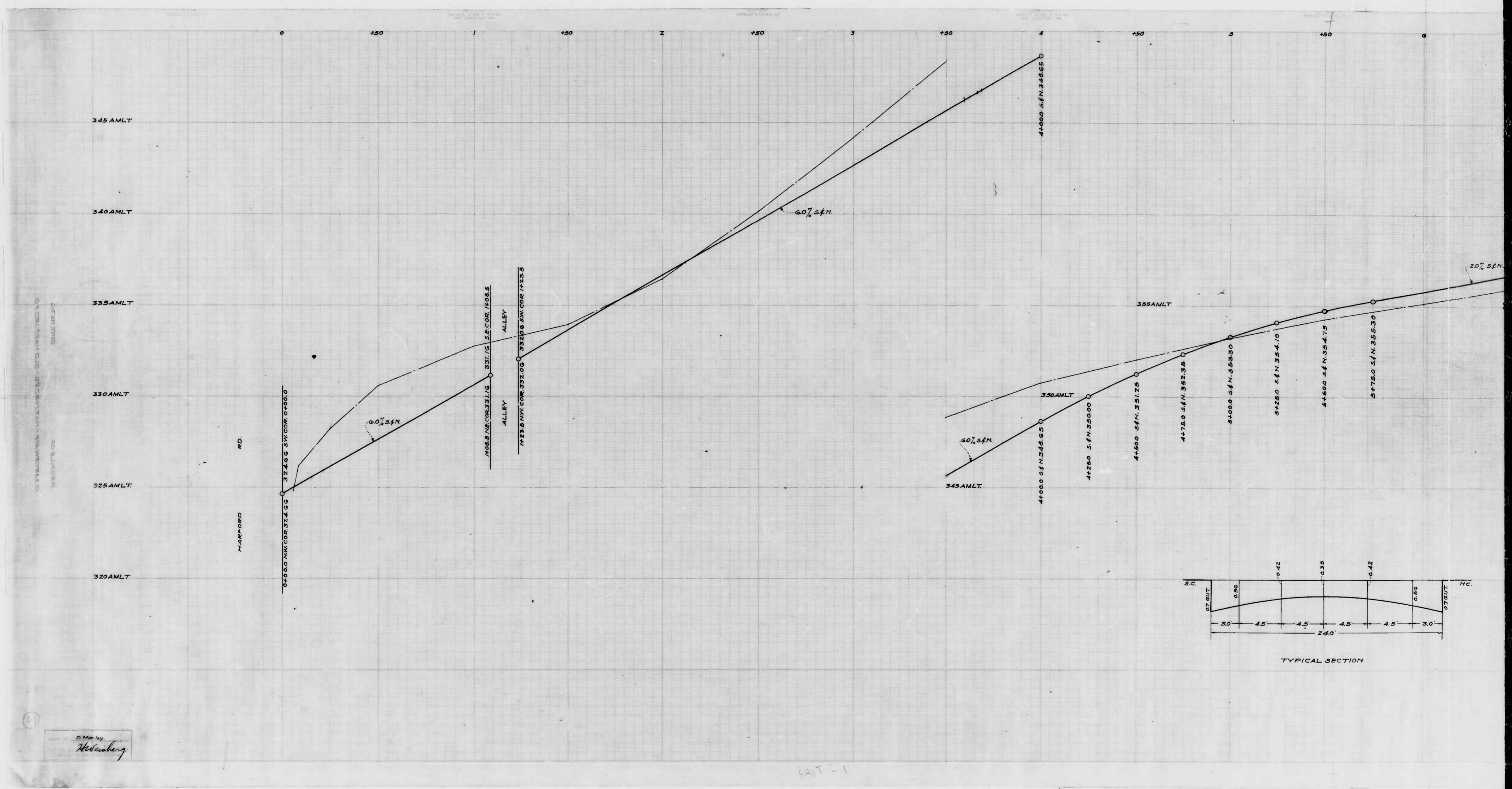

SHOT - 1



716

RATIO - 24

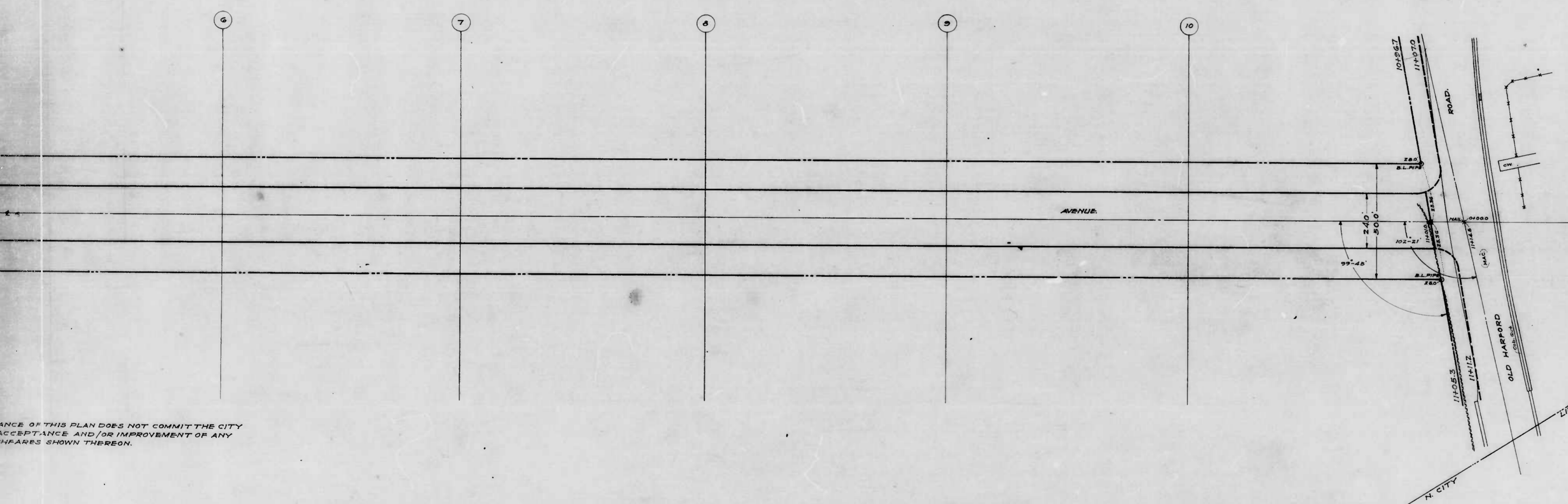

ANCE OF THIS PLAN DOES NOT COMMIT THE CITY  
ACCEPTANCE AND/OR IMPROVEMENT OF ANY  
FEATURES SHOWN THEREON.

CITY OF BALTIMORE  
DEPARTMENT OF PUBLIC WORKS  
BUREAU OF HIGHWAYS  
PLAN OF  
CLEARVIEW AVE. - HARFORD RD. - OLD HARFORD RD.  
CONT. NO. 716

SCALE - 1" = 20'  
BOOK No. X-130  
APR. 9, 1940

APPROVED: \_\_\_\_\_  
 APPROVED: \_\_\_\_\_  
 CORRECT: \_\_\_\_\_  
 APPROVED: \_\_\_\_\_

*George C. [Signature]*  
CHIEF ENGINEER

*[Signature]*  
ENGR. PLANS & SURVEYS

*[Signature]*  
ASSOCIATE ENGINEER

*[Signature]*  
HIGHWAYS ENGINEER

467-2

467-3

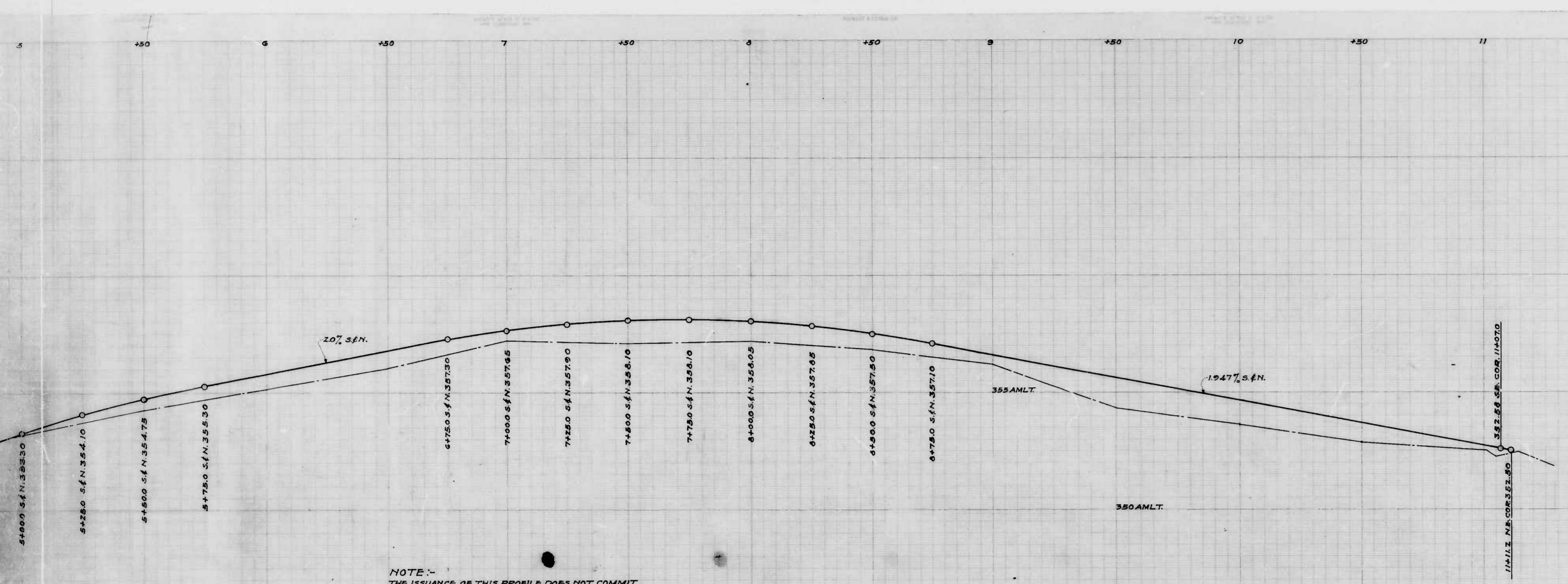

NOTE:-  
 THE ISSUANCE OF THIS PROFILE DOES NOT COMMIT  
 THE CITY TO THE ACCEPTANCE AND/OR IMPROVE-  
 MENT OF ANY THOROUGHFARES SHOWN THEREON.

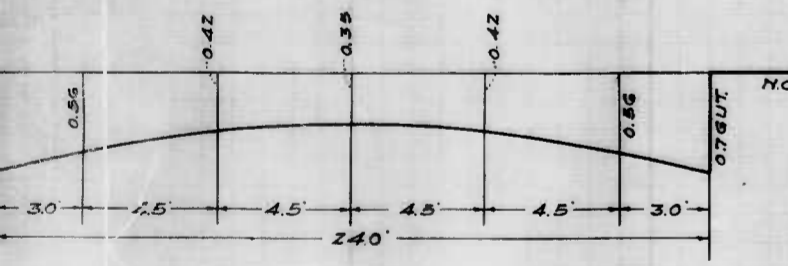

TYPICAL SECTION

CITY OF BALTIMORE  
 DEPARTMENT OF PUBLIC WORKS  
 BUREAU OF HIGHWAYS  
 PROFILE OF  
 CLEARVIEW AVE. - HARFORD RD. - OLD HARFORD RD.  
 CONT. No. 716  
 SCALE - HOR. - 1" = 20'  
 VER. - 1" = 2.0'

APPROVED:- APPROVED:- CORRECT:- APPROVED:-

*James C. Kelly* CHIEF ENGINEER  
*Francis J. ...* ENGR. PLANS & SURVEYS  
*Ed. J. ...* ASSOCIATE ENGINEER  
*Henry A. ...* HIGHWAYS ENGINEER

BOOK No. X-139  
 APRIL 11, 1940



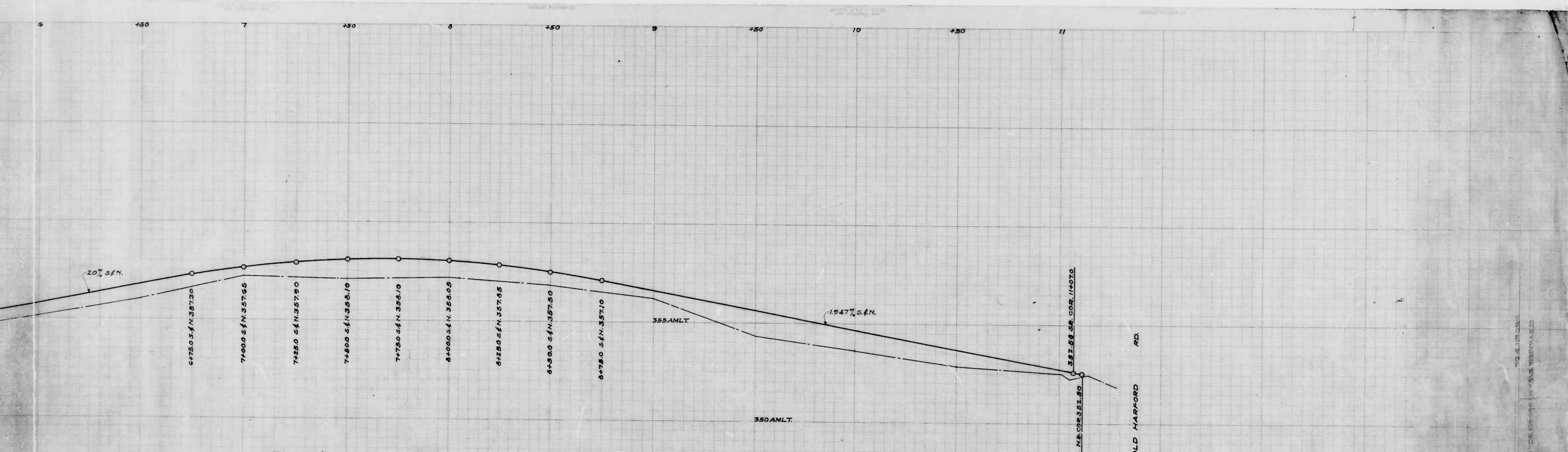

NOTE:-  
 THE ISSUANCE OF THIS PROFILE DOES NOT COMMIT  
 THE CITY TO THE ACCEPTANCE AND/OR IMPROVE-  
 MENT OF ANY THOROUGHFARES SHOWN THEREON.

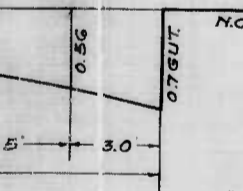

CITY OF BALTIMORE  
 DEPARTMENT OF PUBLIC WORKS  
 BUREAU OF HIGHWAYS

PROFILE OF  
 CLEARVIEW AVE. - HARFORD RD. - OLD HARFORD RD.  
 CONT. No. 716

SCALE - HOR. - 1" = 200'  
 VER. - 1" = 20'

BOOK No X-139  
 APRIL 11, 1940

APPROVED:- APPROVED:- CORRECT:- APPROVED:-

*George Cobb*  
 CHIEF ENGINEER

*Edmund J. ...*  
 ENGR. PLANS & SURVEYS

*Edw. J. ...*  
 ASSOCIATE ENGINEER

*Henry A. ...*  
 HIGHWAYS ENGINEER



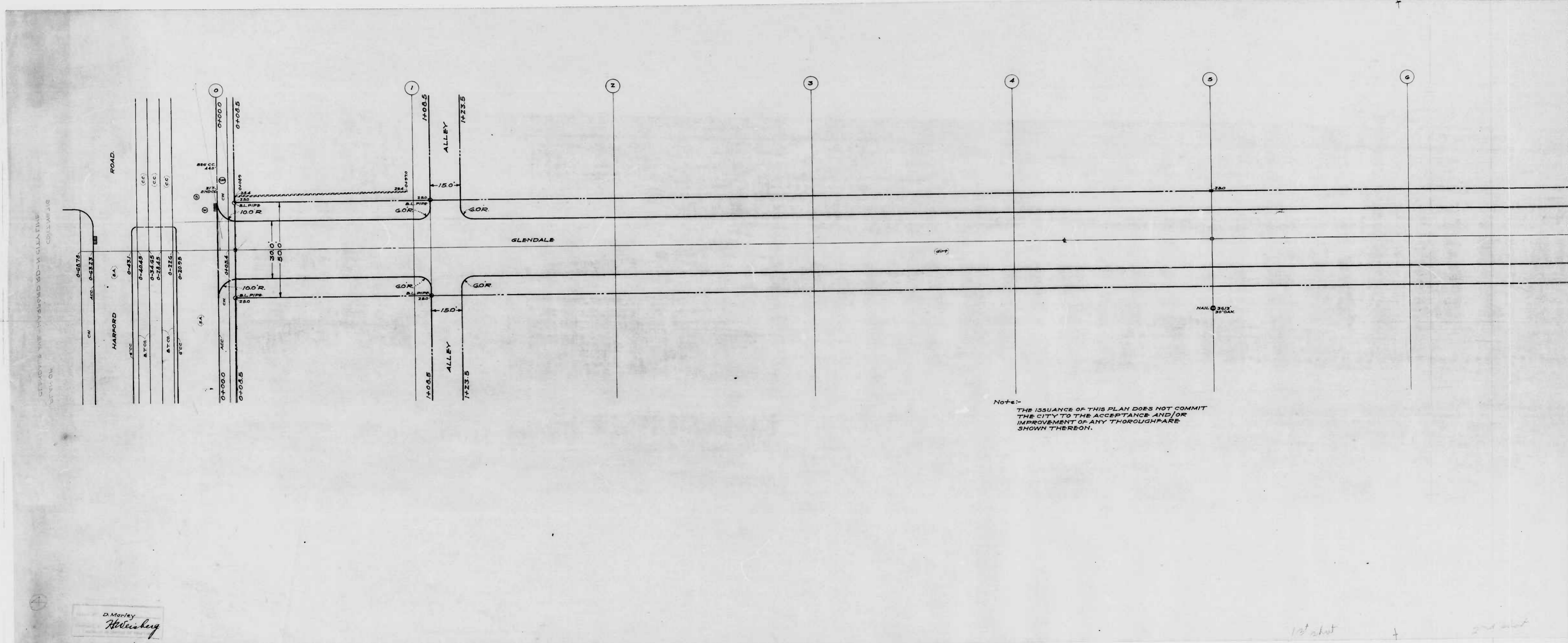

Note:-  
 THE ISSUANCE OF THIS PLAN DOES NOT COMMIT  
 THE CITY TO THE ACCEPTANCE AND/OR  
 IMPROVEMENT OF ANY THROUGHFARE  
 SHOWN THEREON.

D. Menley  
 H. Hensley

1st sheet

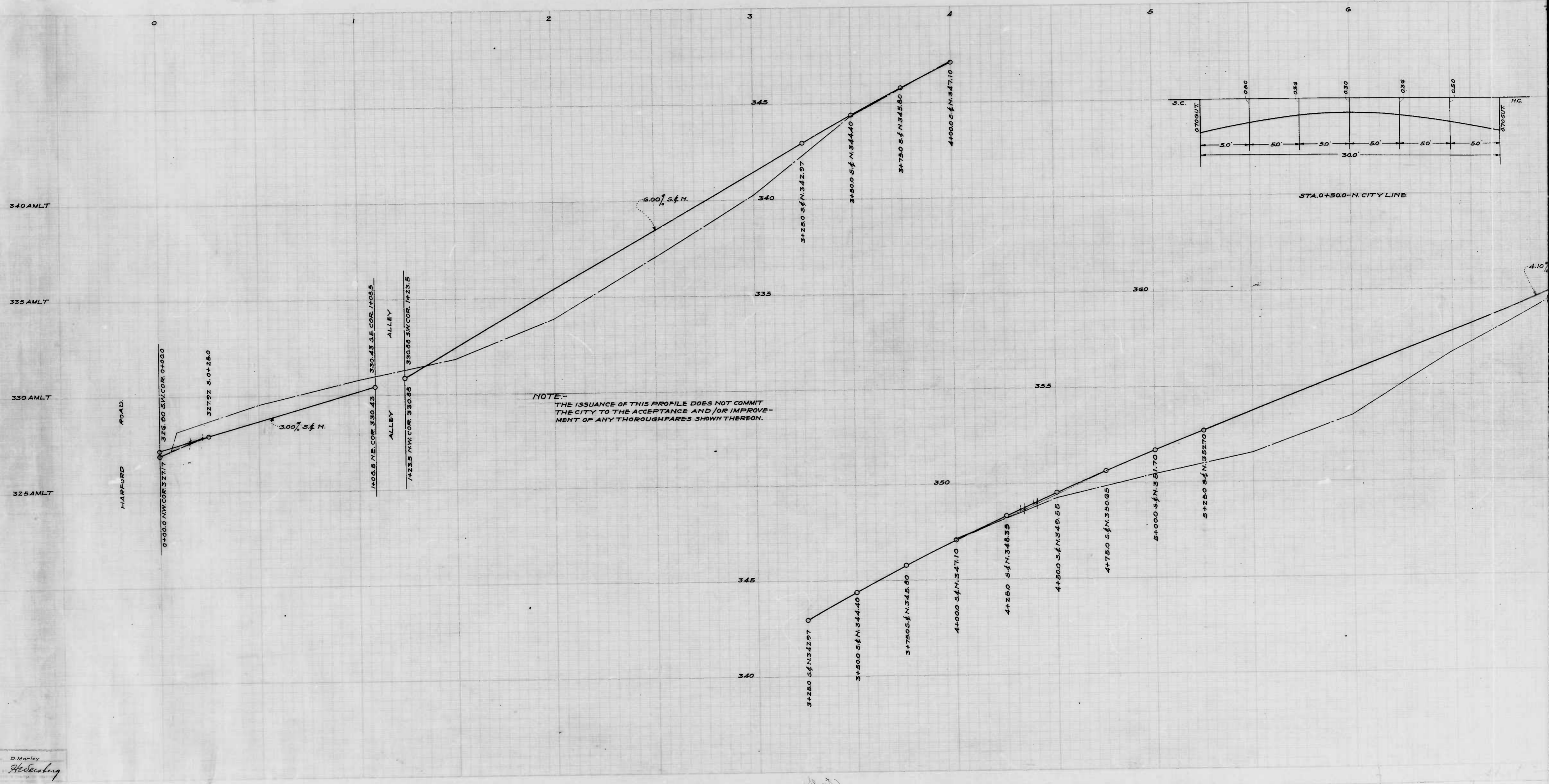

D. Manley  
Hedecberg

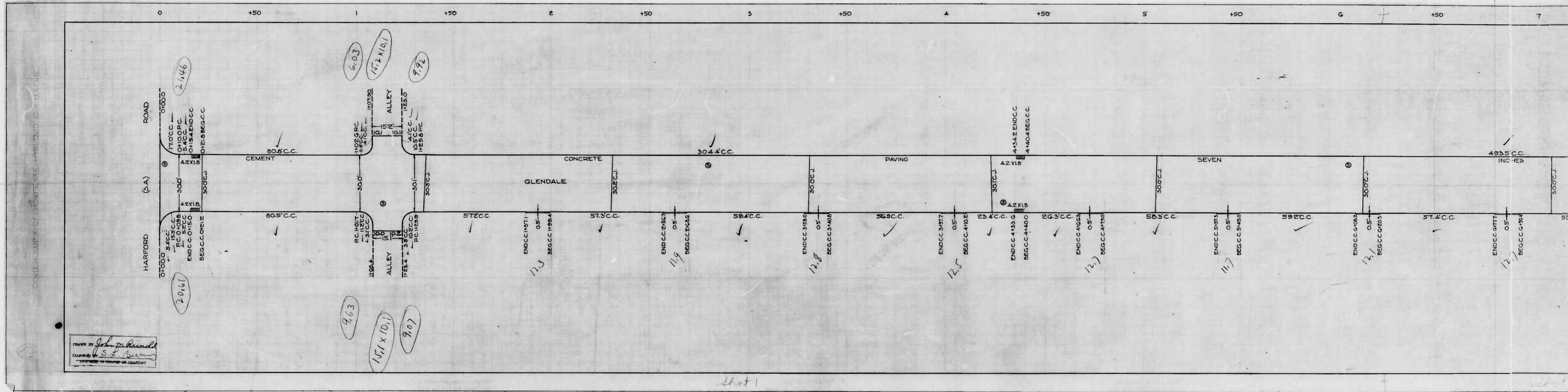

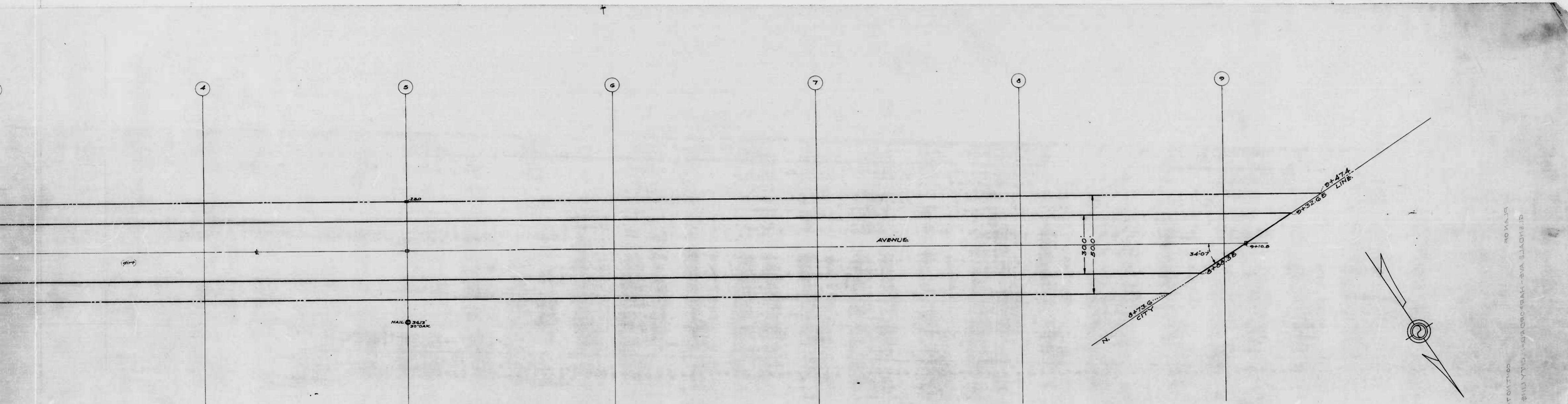

Notes:-  
 THE ISSUANCE OF THIS PLAN DOES NOT COMMIT  
 THE CITY TO THE ACCEPTANCE AND/OR  
 IMPROVEMENT OF ANY THOROUGHFARE  
 SHOWN THEREON.

CITY OF BALTIMORE  
 DEPARTMENT OF PUBLIC WORKS  
 BUREAU OF HIGHWAYS  
 PLAN OF  
 GLENDALE AVE - HARFORD RD. - N. CITY LINE.  
 CONT. No. 716  
 SCALE - 1" = 20.0'  
 BOOK No. X-133  
 MAR. 28, 1940

APPROVED: \_\_\_\_\_ APPROVED: \_\_\_\_\_ CORRECT: \_\_\_\_\_ APPROVED: \_\_\_\_\_  
 George C. Call Chief Engineer      Edward J. Swartz Engr. Plans & Surveys      Wm. J. Gaffney Associate Engineer      James C. Blatch Highways Engineer

1st sheet + 2nd sheet

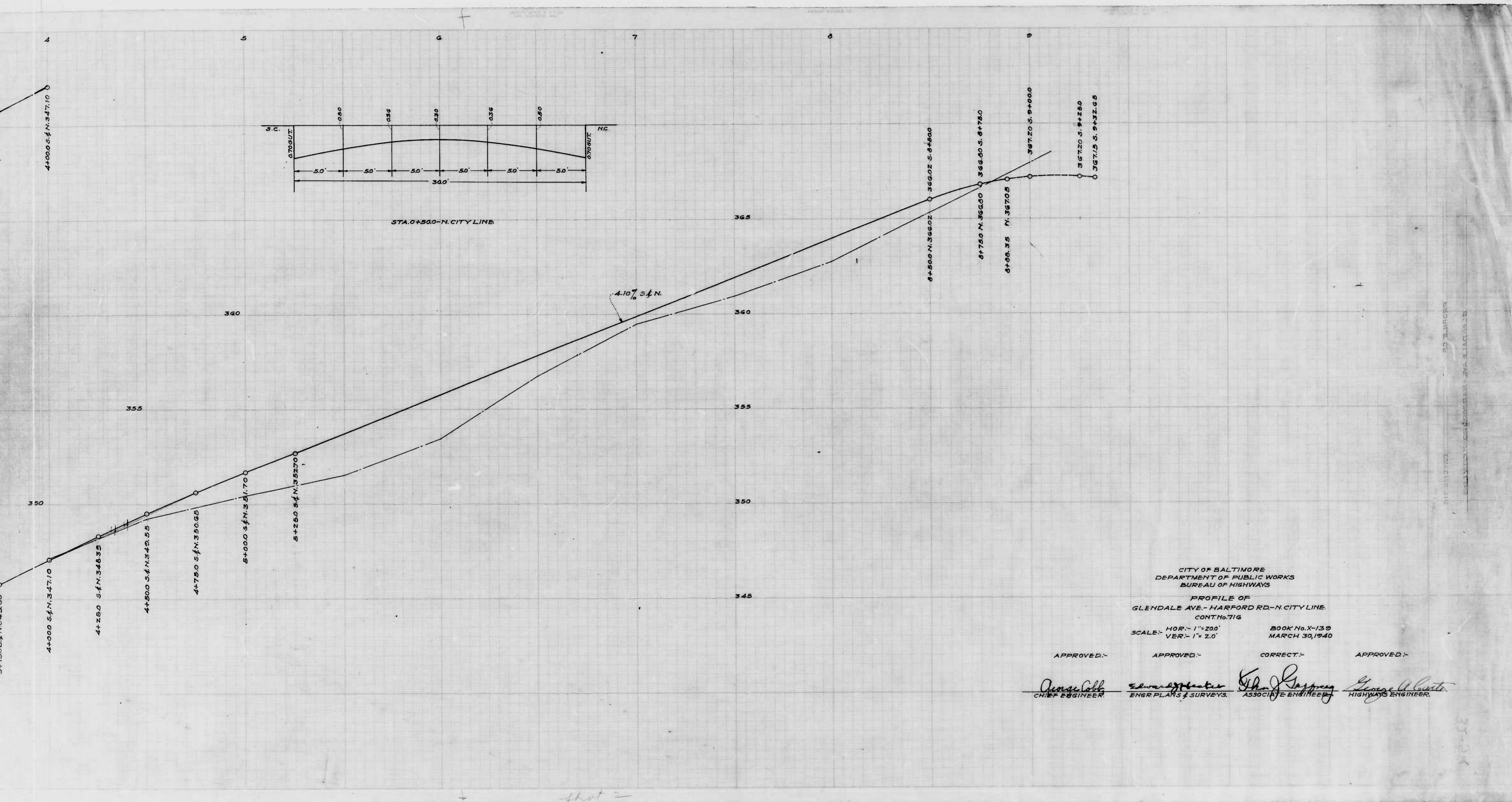

CITY OF BALTIMORE  
 DEPARTMENT OF PUBLIC WORKS  
 BUREAU OF HIGHWAYS

PROFILE OF  
 GLENDALE AVE. - HARFORD RD. - N. CITY LINE.  
 CONT. No. 716

SCALE - HOR: 1" = 200'  
 VER: 1" = 2.0'

BOOK No. X-139  
 MARCH 30, 1940

APPROVED: *George A. Kelly* CHIEF ENGINEER  
 APPROVED: *Edward J. ...* ENGR. PLANS & SURVEYS.  
 CORRECT: *Edw. J. ...* ASSOCIATE ENGINEER  
 APPROVED: *George A. ...* HIGHWAYS ENGINEER.

shot 2



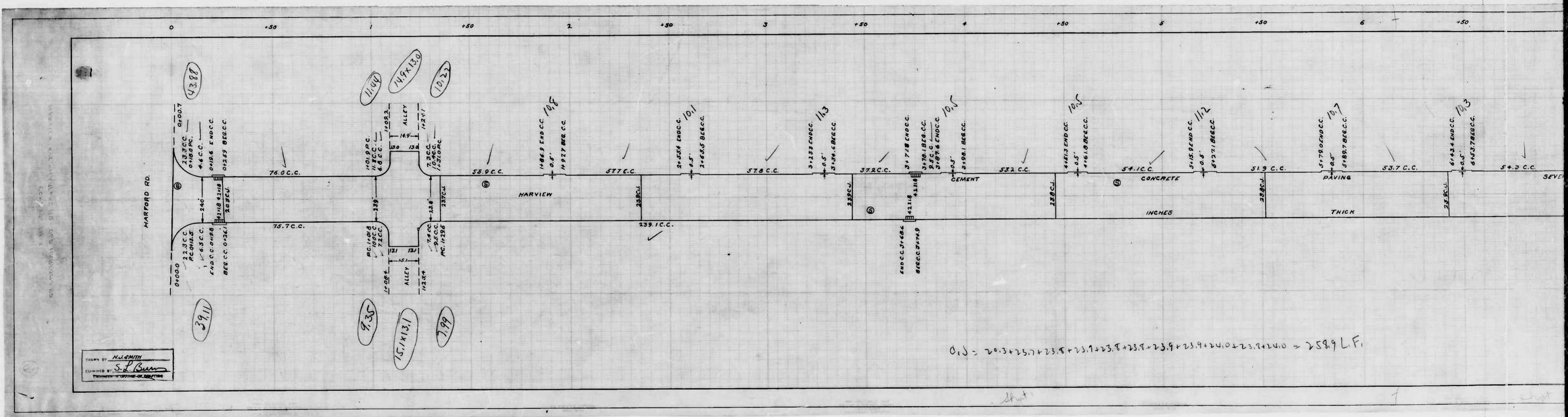

DRAWN BY *M. SMITH*  
 CHECKED BY *S. J. BURN*  
 PROJECT NO. 1000-1000

$$0.1 = 20.3 + 25.7 + 23.8 + 23.9 + 23.8 + 23.9 + 23.9 + 24.0 + 23.7 + 24.0 = 258.9 \text{ L.F.}$$





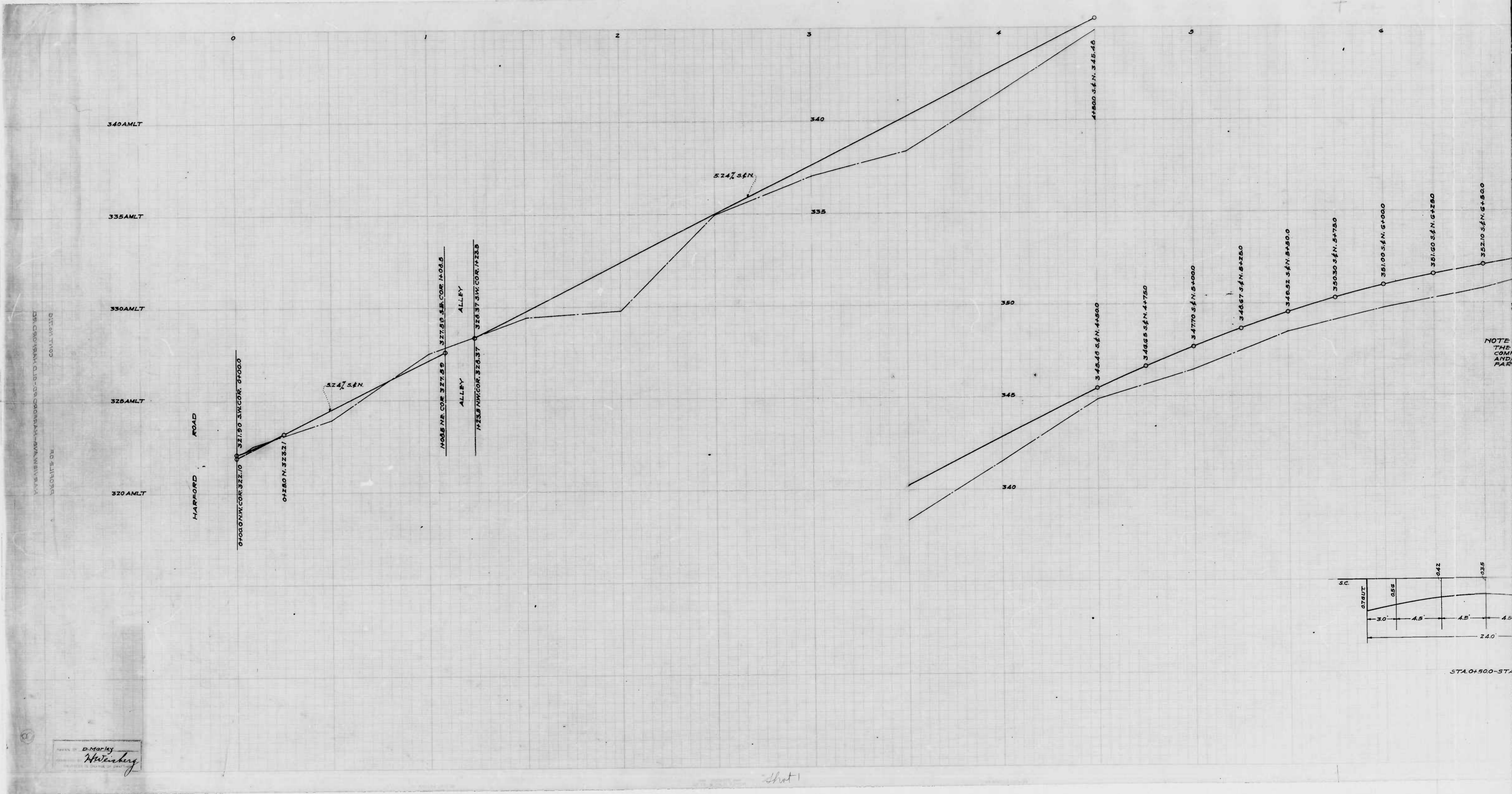

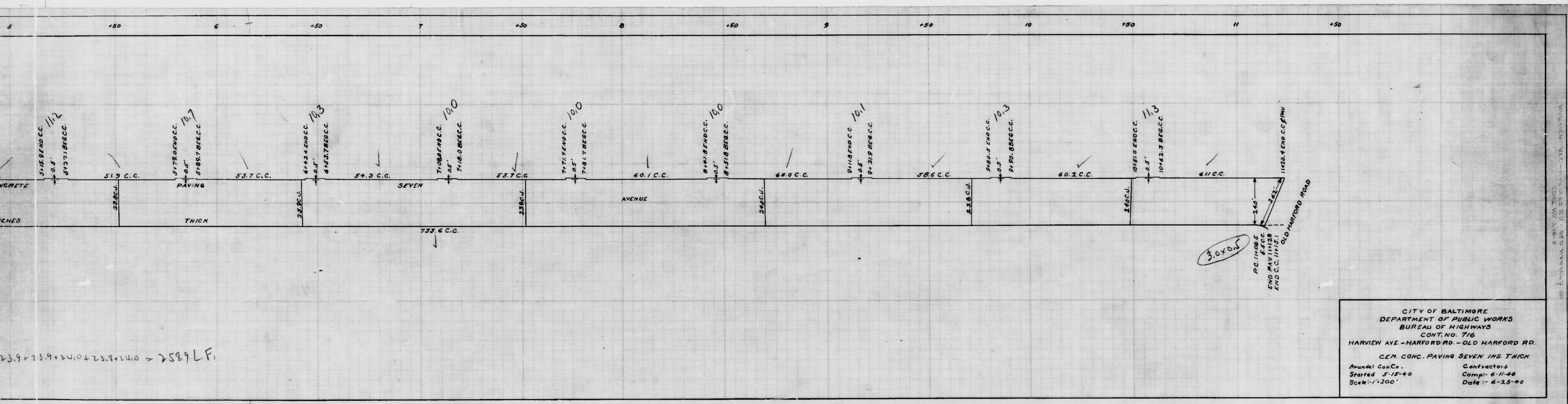

23.9+23.9+24.0+23.9+24.0 = 258.9 L.F.

Sheet 2

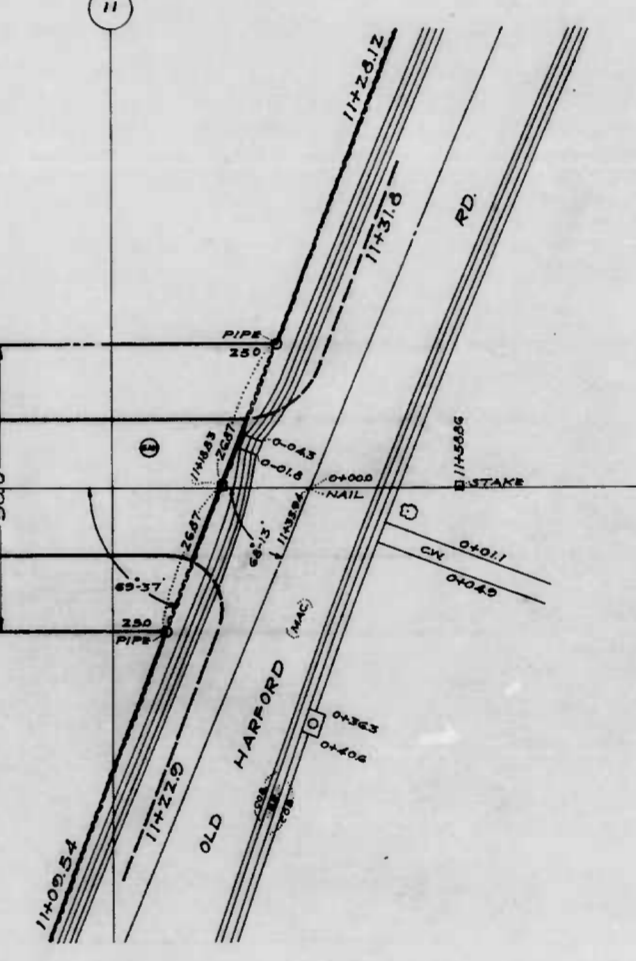
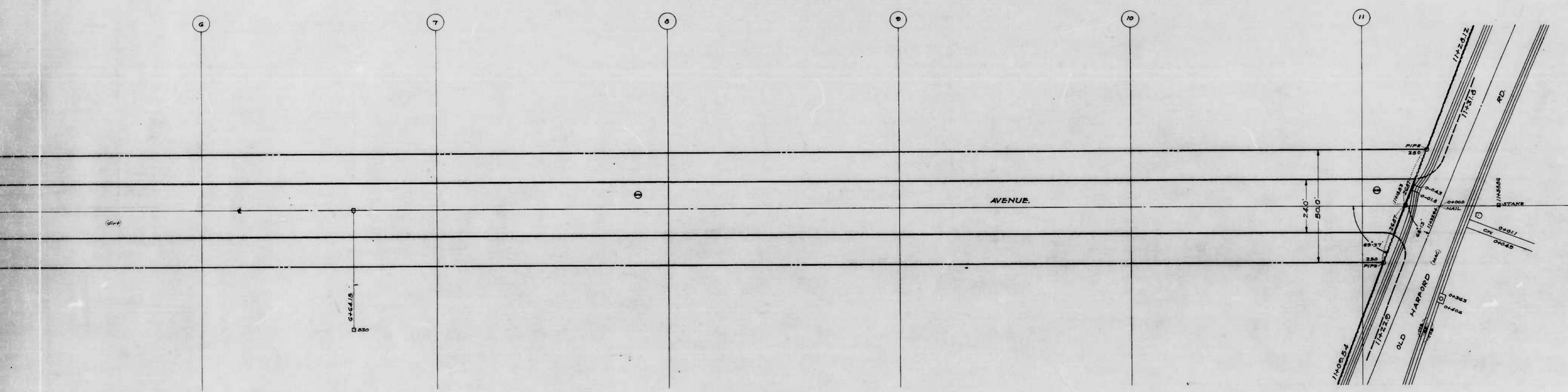

CITY OF BALTIMORE  
 DEPARTMENT OF PUBLIC WORKS  
 BUREAU OF HIGHWAYS  
 PLAN OF  
 HARVIEW AVE - HARFORD RD - OLD HARFORD RD  
 CONT. NO. 716  
 SCALE - 1" = 200'

APPROVED: *James Coll* CHIEF ENGINEER  
 APPROVED: *Edward H. ...* ENGR. PLANNING & SURVEYS  
 CORRECT: *Wm. J. ...* ASSOCIATE ENGINEER  
 APPROVED: *...* HIGHWAYS ENGINEER

Sheet 2

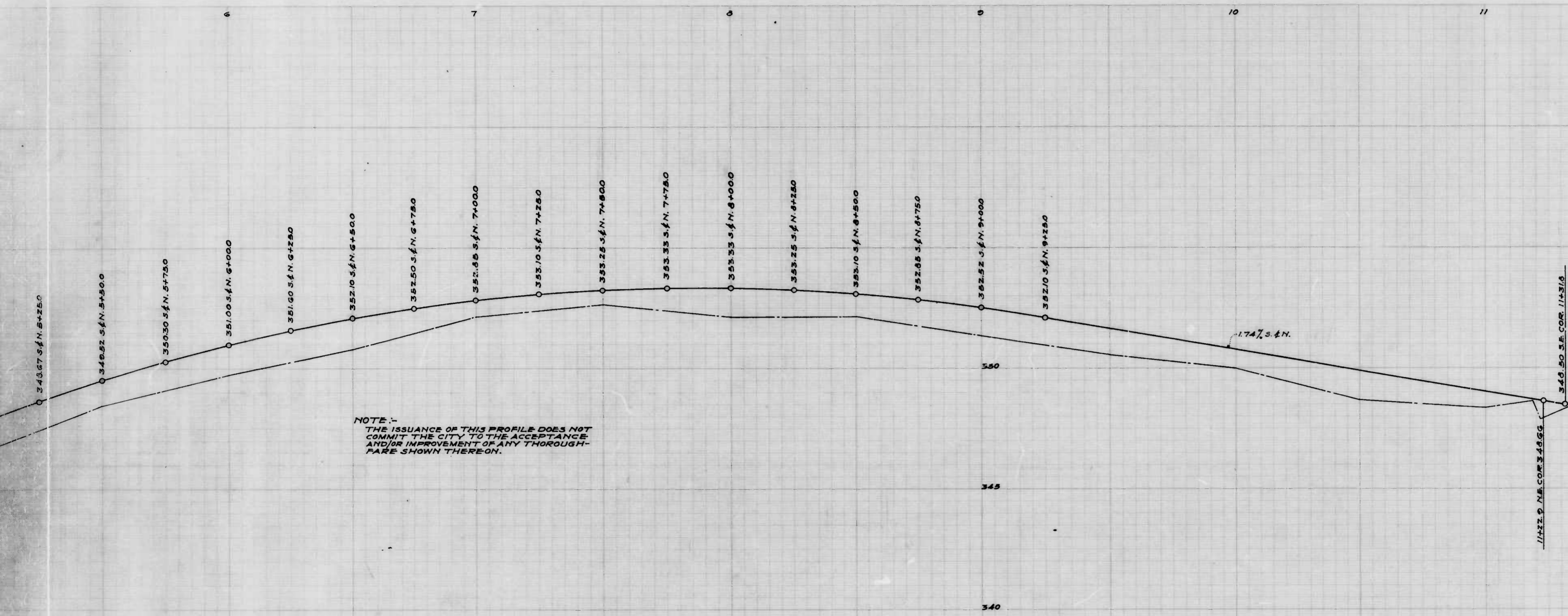

NOTE:-  
 THE ISSUANCE OF THIS PROFILE DOES NOT  
 COMMIT THE CITY TO THE ACCEPTANCE  
 AND/OR IMPROVEMENT OF ANY THROUGH-  
 FARE SHOWN THEREON.

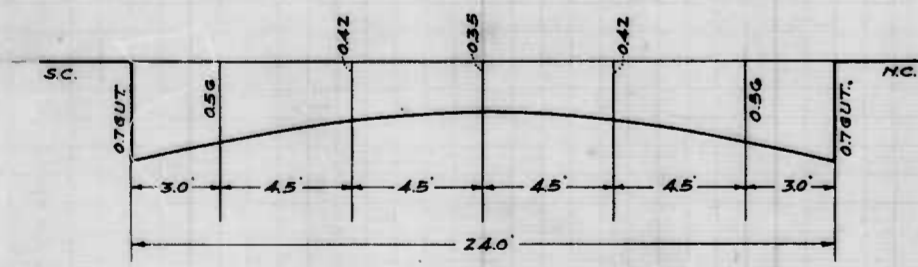

STA 04500-57A.11+00.0

CITY OF BALTIMORE  
 DEPARTMENT OF PUBLIC WORKS  
 BUREAU OF HIGHWAYS

PROFILE OF  
 HARVIEW AVE - HARFORD RD - OLD HARFORD RD  
 CONT. No. 716

HOR. - 1" = 200'  
 VER. - 1" = 20'      MARCH 27, 1940

APPROVED:      APPROVED:      CORRECT:      APPROVED:

*George Call*      *Edward J. ...*      *Edna ...*      *Henry ...*  
 CHIEF ENGINEER      ENGR. PLANS & SURVEYS      ASSOCIATE ENGINEER      HIGHWAYS ENGINEER



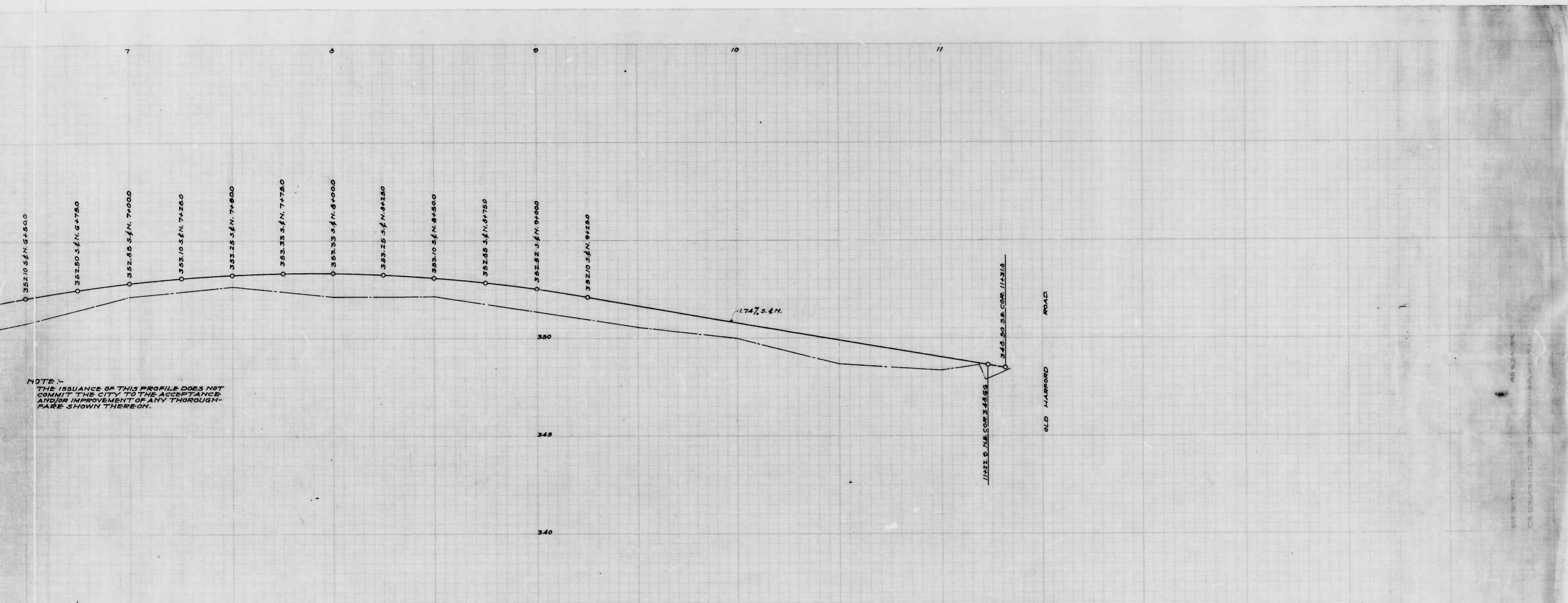

NOTE -  
THE ISSUANCE OF THIS PROFILE DOES NOT  
COMMIT THE CITY TO THE ACCEPTANCE  
AND/OR IMPROVEMENT OF ANY THROUGH-  
FARE SHOWN THEREON.

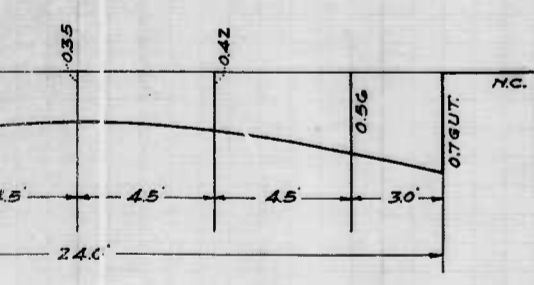

0+500 - STA. 11+000

CITY OF BALTIMORE  
DEPARTMENT OF PUBLIC WORKS  
BUREAU OF HIGHWAYS  
PROFILE OF  
HARVIEWAVE - HARFORD RD. - OLD HARFORD RD.  
CONT. No. 716  
SCALES - HOR. - 1" = 20'  
VER. - 1" = 20'  
MARCH 27, 1940

APPROVED: \_\_\_\_\_ APPROVED: \_\_\_\_\_ CORRECT: \_\_\_\_\_ APPROVED: \_\_\_\_\_  
*James Galt* *Edward P. Hicken* *Edmund J. Gorman* *Henry Albert*  
 CHIEF ENGINEER ENGR. PLANS & SURVEYS. ASSOCIATE ENGINEER HIGHWAYS ENGINEER

4013