

REPLACE THE PAVEMENT SURFACE - KENWOOD W/ CONCRETE

REPLACE THE PAVEMENT SURFACE - LAKELAND W/ CONCRETE

"NOTE"
 THE ISSUANCE OF THIS PLAN & PROFILE DOES NOT COMMIT THE CITY TO THE ACCEPTANCE AND/OR IMPROVEMENT OF ANY THOROUGHFARE SHOWN THEREON

CITY OF BALTIMORE
 DEPARTMENT OF PUBLIC WORKS
 BUREAU OF HIGHWAYS
 PLAN & PROFILE
 BERYL AVE.-LAKEWOOD AVE.-KENWOOD AVE.
 FEB. 26, 1940
 SCALES: PLAN - 1"=100'
 PROF. - 1"=20.0'
 VER. 1/2"=10.0'
 BOOK NO. X-129
 CONT. NO. 715

CORRECTED: *Edmund J. Hester* ASSOCIATE ENGINEER
 APPROVED: *George Roberts* HIGHWAYS ENGINEER
 APPROVED: *Edmund J. Hester* ENGR. PLANS & SURVEYS
 APPROVED: *George Roberts* CHIEF ENGINEER

80 A.M.L.T.
John M. Kimball
 EXAMINED BY *Edmund J. Hester*
 ENGINEER IN CHARGE OF DISTRICT

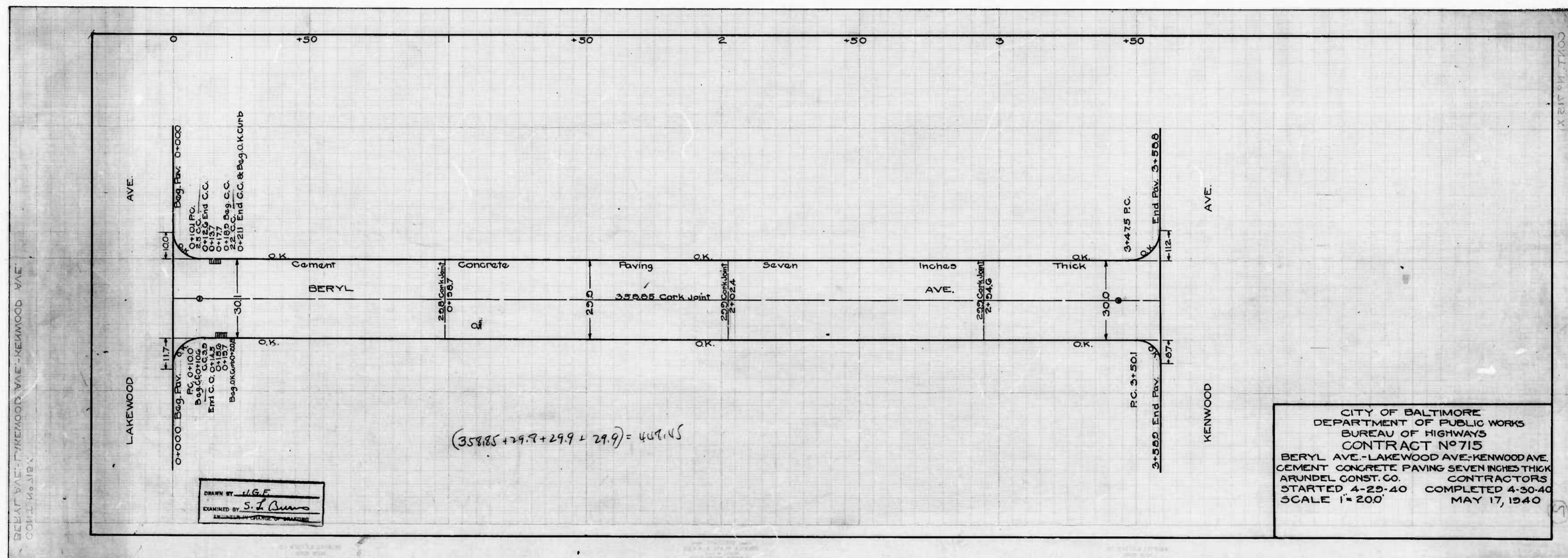

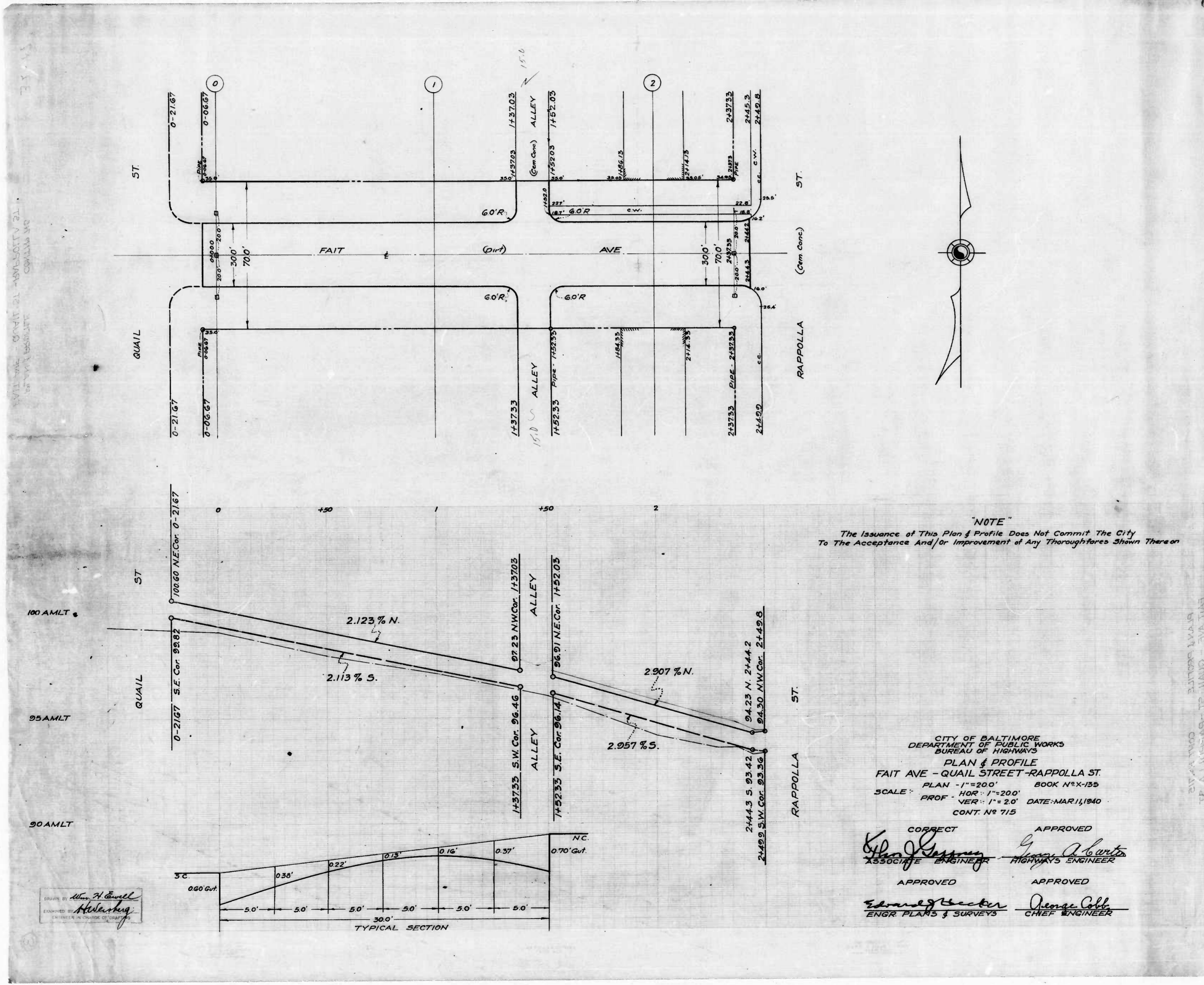

CITY OF BALTIMORE DEPARTMENT OF PUBLIC WORKS BUREAU OF HIGHWAYS

CITY OF BALTIMORE DEPARTMENT OF PUBLIC WORKS BUREAU OF HIGHWAYS

"NOTE"
The Issuance of This Plan & Profile Does Not Commit The City
To The Acceptance And/or Improvement of Any Thoroughfares Shown Thereon

CITY OF BALTIMORE
DEPARTMENT OF PUBLIC WORKS
BUREAU OF HIGHWAYS
PLAN & PROFILE
FAITH AVE - QUAIL STREET - RAPPOLLA ST.
PLAN - 1" = 20.0' BOOK No. X-135
SCALE: HOR - 1" = 20.0' PROF - VER - 1" = 2.0' DATE - MAR 14, 1940
CONT. No. 715

CORRECT APPROVED
Edmund J. Becker *George A. Colby*
ASSOCIATE ENGINEER HIGHWAYS ENGINEER
APPROVED APPROVED
Edmund J. Becker *George A. Colby*
ENGR. PLANS & SURVEYS CHIEF ENGINEER

DRAWN BY *Wm. H. Conell*
EXAMINED BY *H. W. Hensley*
SUPERVISOR IN CHARGE OF DRAWING

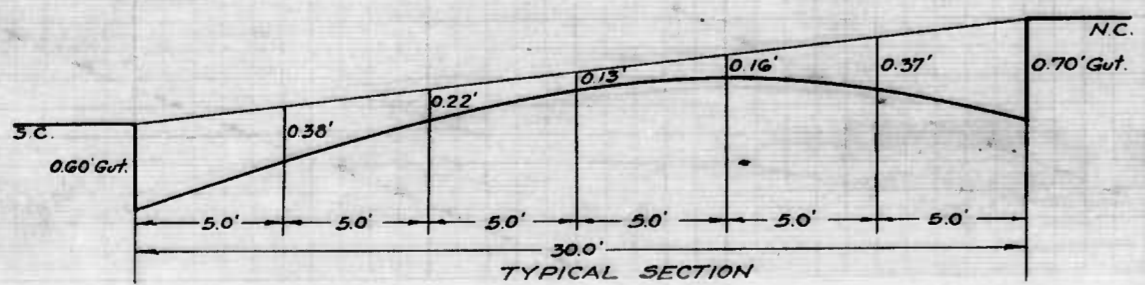

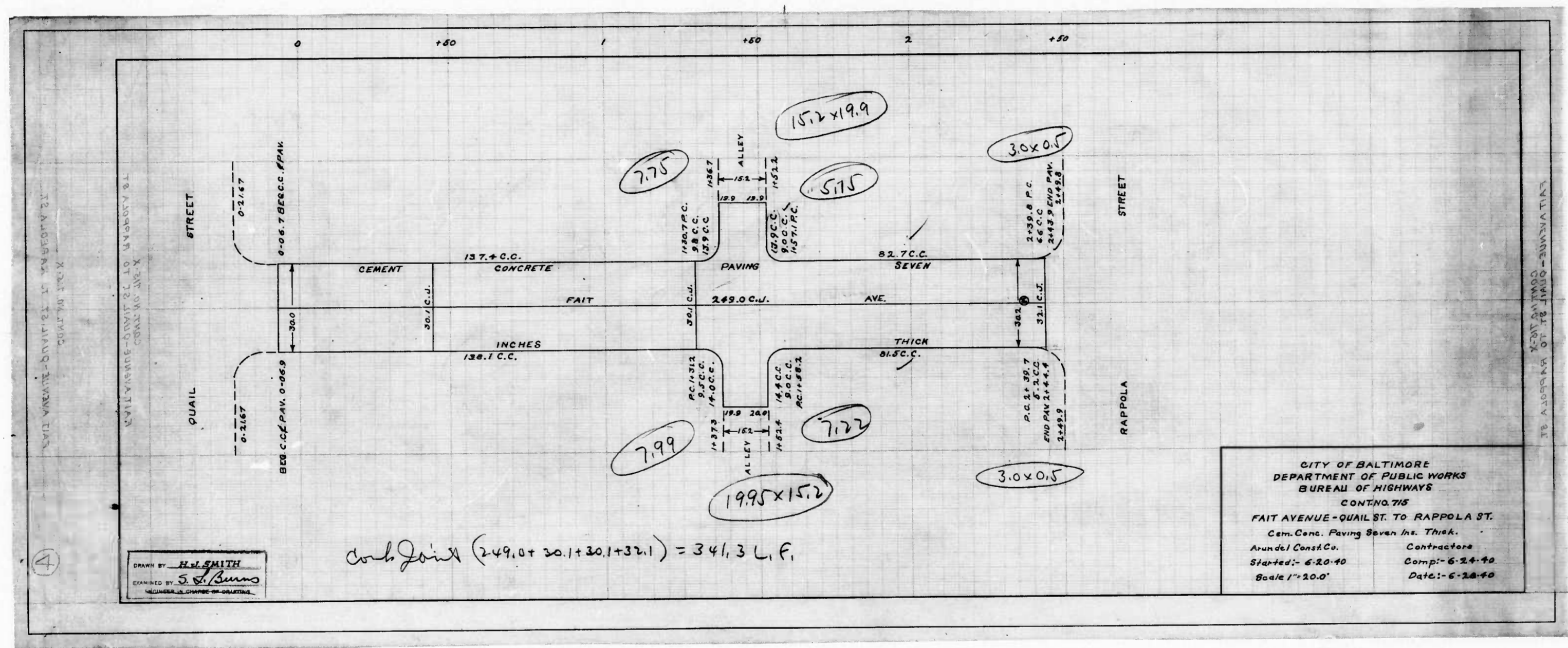

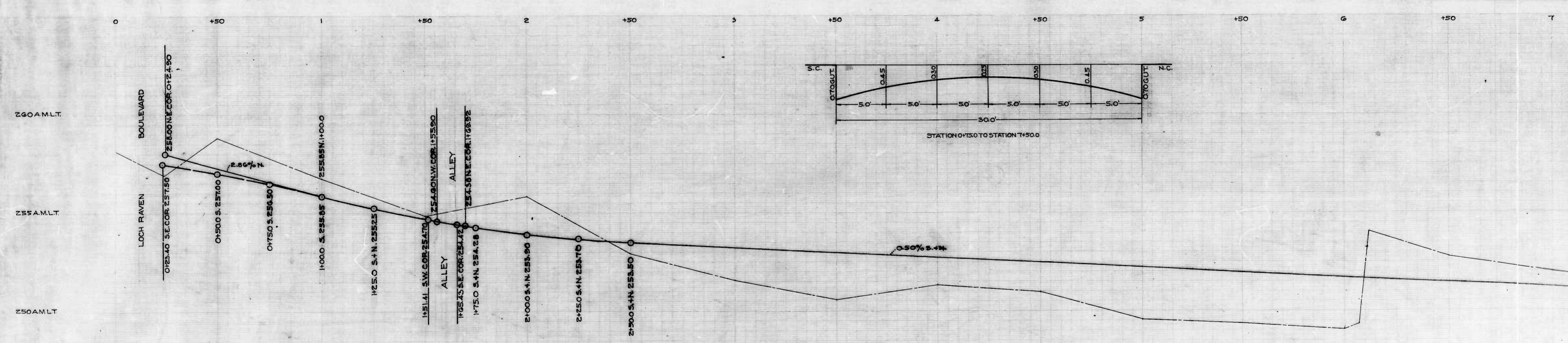
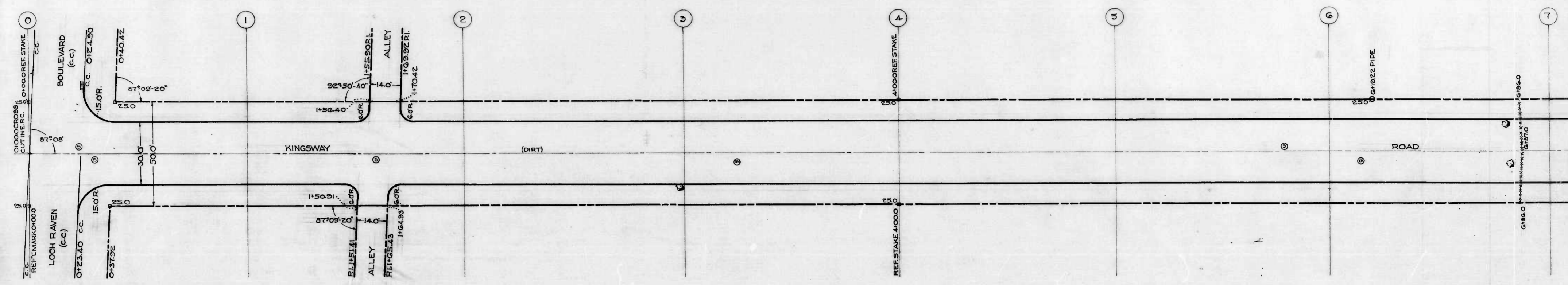

John M. Diamond
 Engineer
 Registered Professional Engineer
 State of Maryland

Sheet 1

Sheet 2

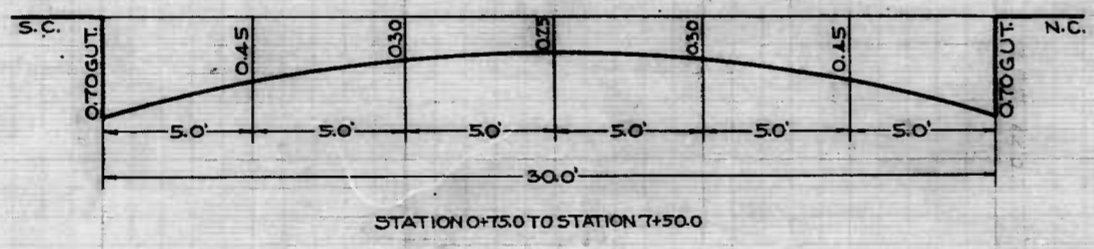
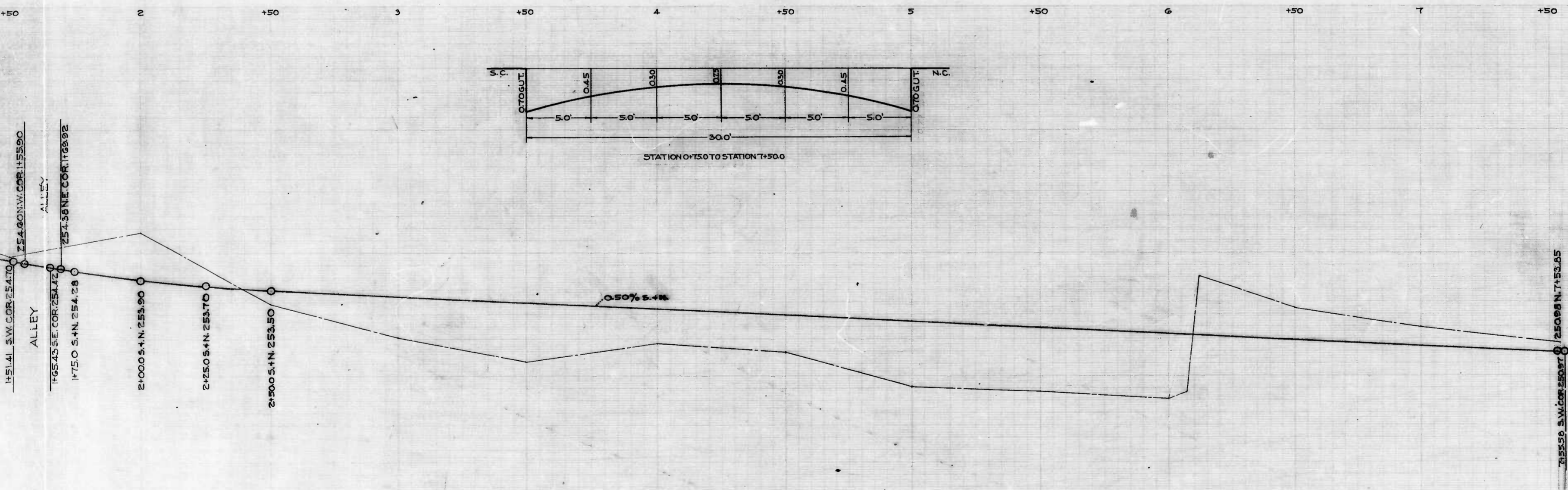
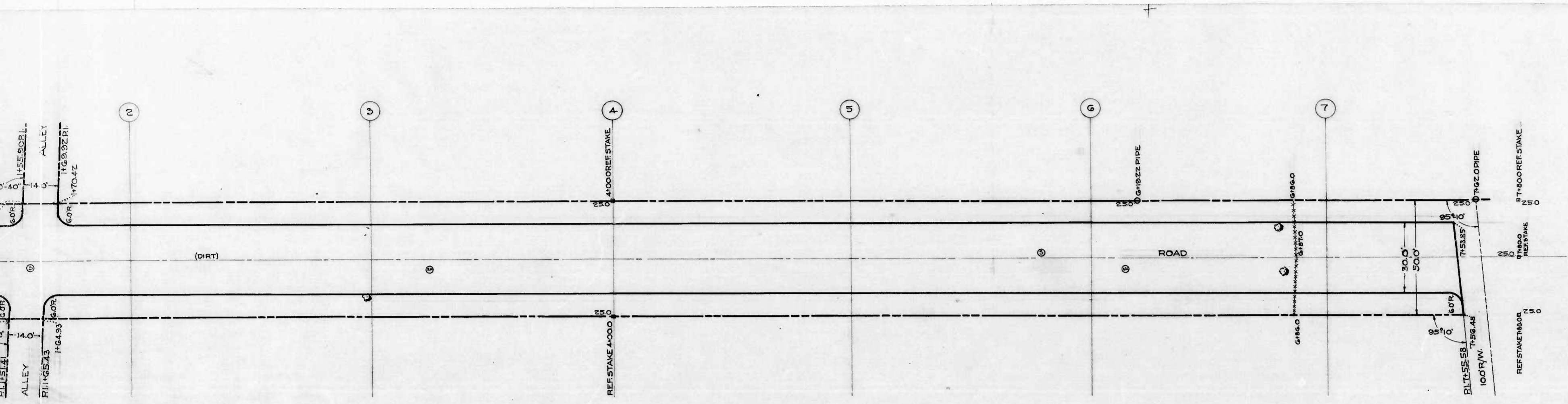

"NOTE"
 THE ISSUANCE OF THIS PLAN & PROFILE DOES NOT
 COMMIT THE CITY TO THE ACCEPTANCE AND/OR
 IMPROVEMENT OF ANY THOROUGHFARE SHOWN
 THEREON.

CITY OF BALTIMORE
 DEPARTMENT OF PUBLIC WORKS
 BUREAU OF HIGHWAYS
 PLAN & PROFILE
 KINGSWAY ROAD-LOCH RAVEN BLVD. T40° EAST
 PLAN: 1"=20.0' MARCH 27, 1940
 SCALES: HOR: 1"=20.0' BOOK NO. X-110
 VER: 1"=2.0'
 CONT. NO. 715

CORRECT: *Edmund J. Goffney*
 ASSOCIATE ENGINEER

APPROVED: *George A. Calk*
 CHIEF ENGINEER

APPROVED: *Edmund J. Goffney*
 ENGR. PLANS & SURVEYS

APPROVED: *George A. Calk*
 CHIEF ENGINEER

Sheet 1

Sheet 2

THE CITY OF BALTIMORE
 DEPARTMENT OF PUBLIC WORKS
 BUREAU OF HIGHWAYS
 PLAN & PROFILE
 KINGSWAY ROAD-LOCH RAVEN BLVD. T40° EAST
 PLAN: 1"=20.0' MARCH 27, 1940
 SCALES: HOR: 1"=20.0' BOOK NO. X-110
 VER: 1"=2.0'
 CONT. NO. 715

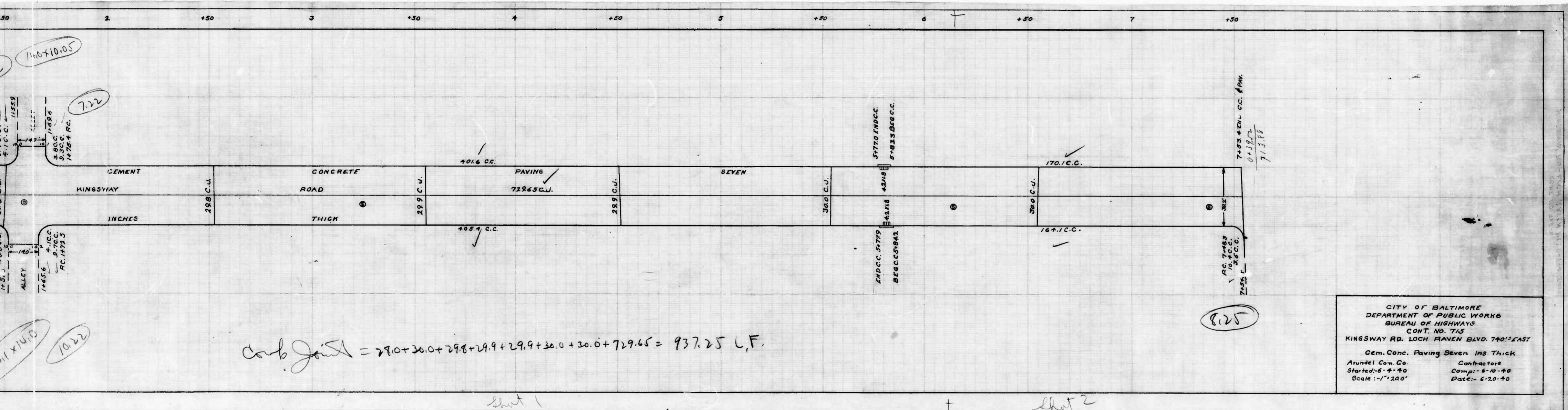

carb joint = 28.0 + 30.0 + 29.8 + 29.9 + 29.9 + 30.0 + 30.0 + 729.65 = 937.25 C.F.

CITY OF BALTIMORE
 DEPARTMENT OF PUBLIC WORKS
 BUREAU OF HIGHWAYS
 CONT. NO. 715
 KINGSWAY RD. LOCH RAVEN BLVD. 740° EAST
 Gen. Conc. Paving Seven 1 1/2" Thick
 Arundel Con. Co. Contractor
 Started: 6-8-40
 Scale: 1" = 20'
 Date: 6-20-40

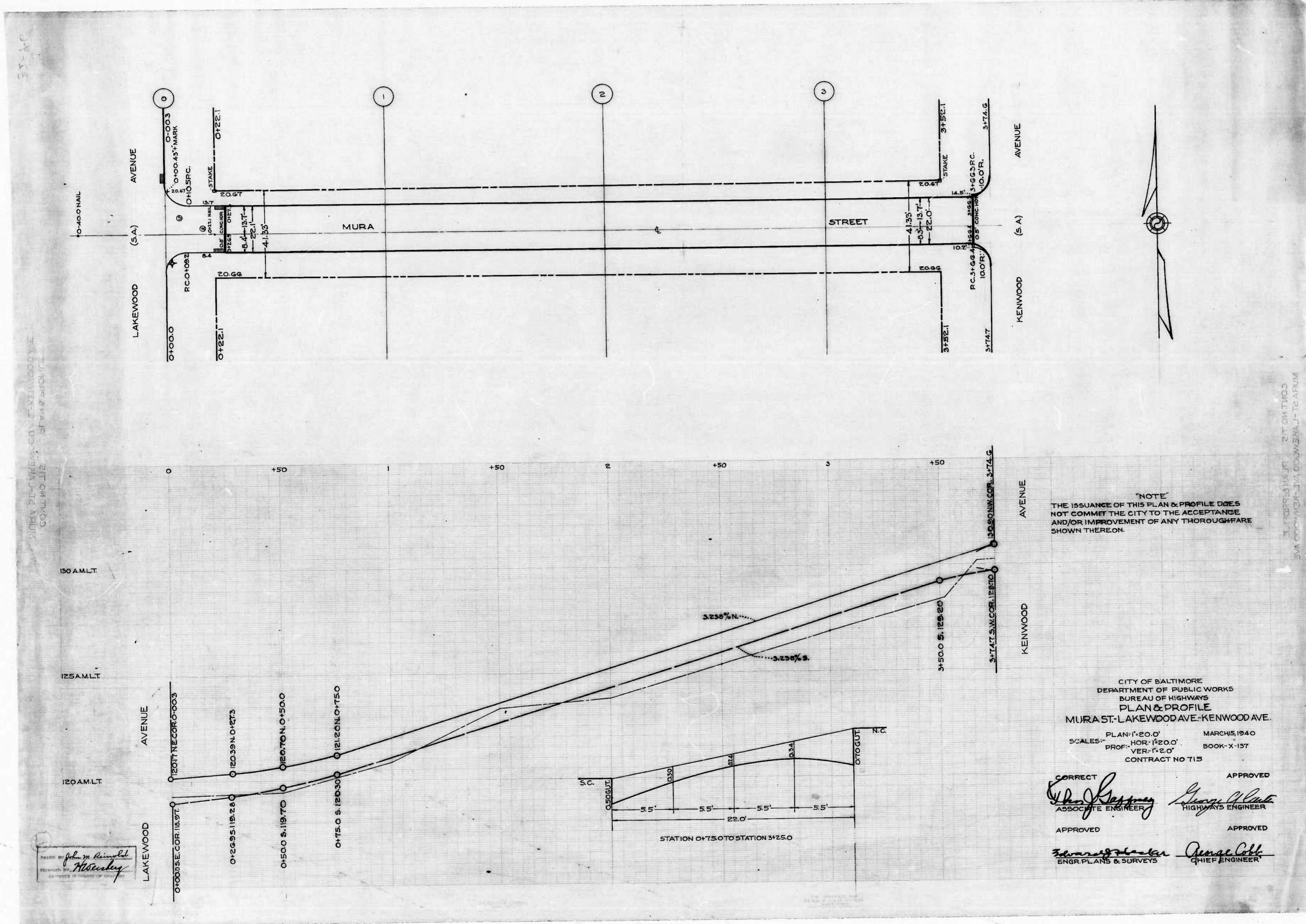

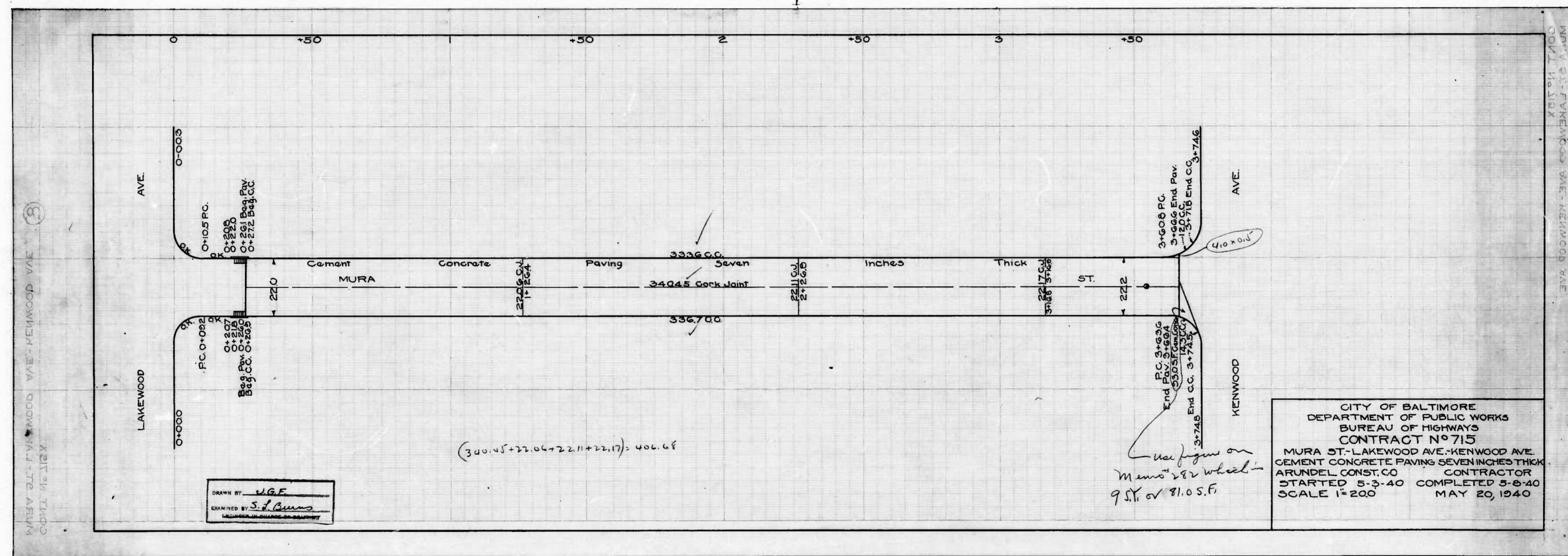

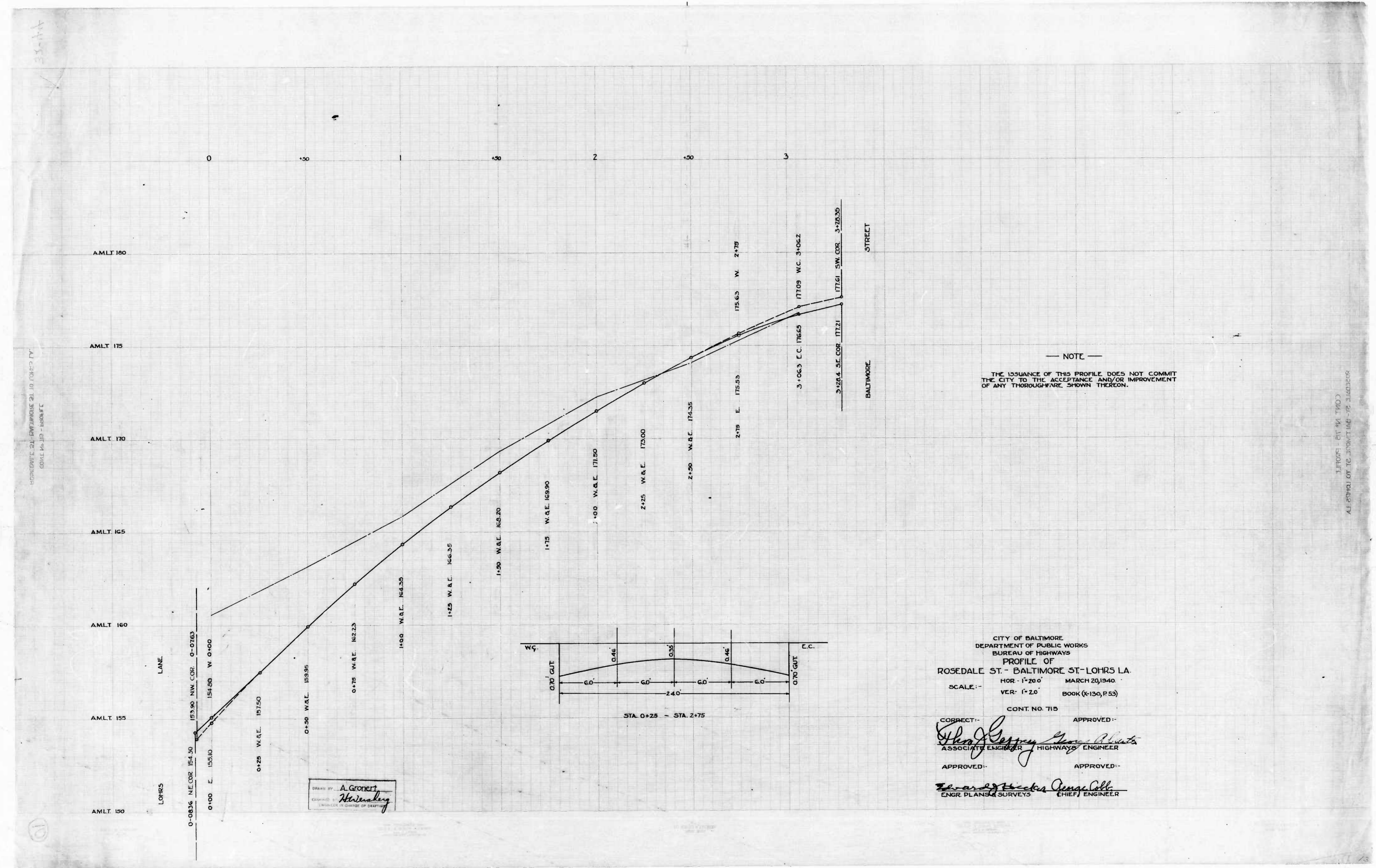

NOTE
 THE ISSUANCE OF THIS PROFILE DOES NOT COMMIT THE CITY TO THE ACCEPTANCE AND/OR IMPROVEMENT OF ANY THOROUGHFARE SHOWN THEREON.

CITY OF BALTIMORE
 DEPARTMENT OF PUBLIC WORKS
 BUREAU OF HIGHWAYS
 PROFILE OF
 ROSEDALE ST. - BALTIMORE ST. - LOHRS LA.
 HOR - 1"=20' MARCH 20, 1940
 SCALE: - VER - 1"=20' BOOK (K-130, P.53)

CONT. NO. 715
 CORRECTED: APPROVED:
John J. Gaffney *George A. White*
 ASSOCIATE ENGINEER HIGHWAYS ENGINEER
 APPROVED: APPROVED:
Edward J. Hecker *James C. Kelly*
 ENGR. PLANS & SURVEYS CHIEF ENGINEER

DRAWN BY: A. Gronert
A. Gronert
 ENGINEER IN CHARGE OF SURVEYING

44-5-44

CORRECTED 21-10-1940 BY: [illegible]

CORRECTED 21-10-1940 BY: [illegible]

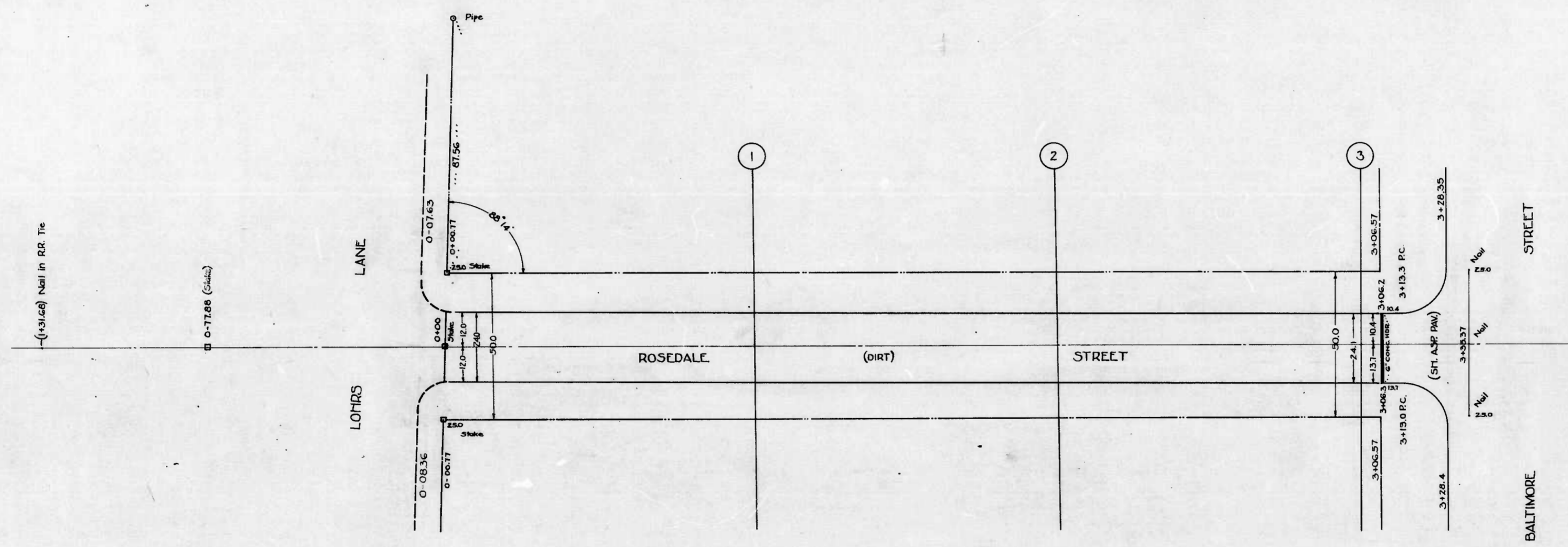

NOTE
 THE ISSUANCE OF THIS PLAN DOES NOT COMMIT THE CITY TO THE ACCEPTANCE AND/OR IMPROVEMENT OF ANY THOROUGHFARE SHOWN THEREON.

CITY OF BALTIMORE
 DEPARTMENT OF PUBLIC WORKS
 BUREAU OF HIGHWAYS
 LAYOUT
 ROSEDALE ST - BALTIMORE ST TO LOHRS LA.
 SCALE: 1"=20.0' CONT. 715 MAR. 15, 1940.
 BOOK (X-130, R-53)

CORRECTED: *John K. ...* ASSOCIATE ENGINEER
 APPROVED: *...* HIGHWAYS ENGINEER
 APPROVED: *...* ENGR. PLANS & SURVEYS
 APPROVED: *...* CHIEF ENGINEER

DRAWN BY: A. Gronert
 EXAMINED BY: *W. ...*

BOARD OF PUBLIC WORKS
 CONT. IN 715 - 131A

BOARD OF PUBLIC WORKS
 CONT. IN 715 - 131A

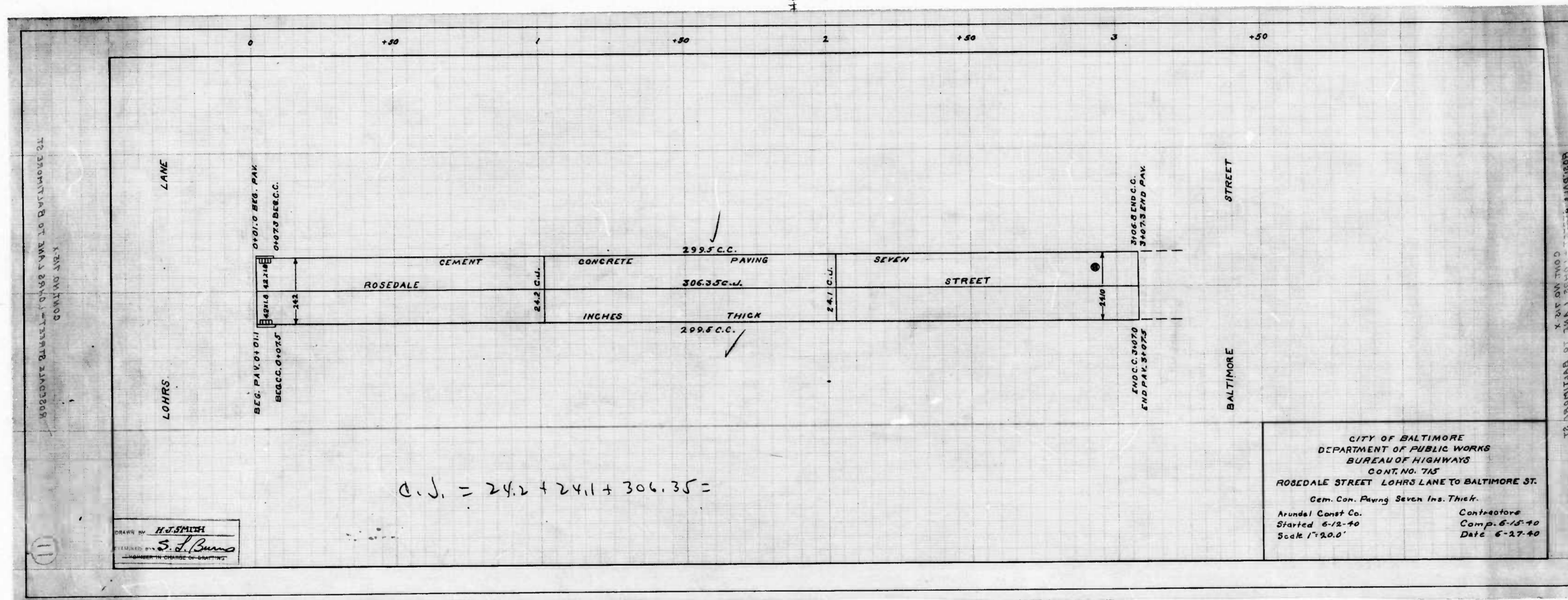

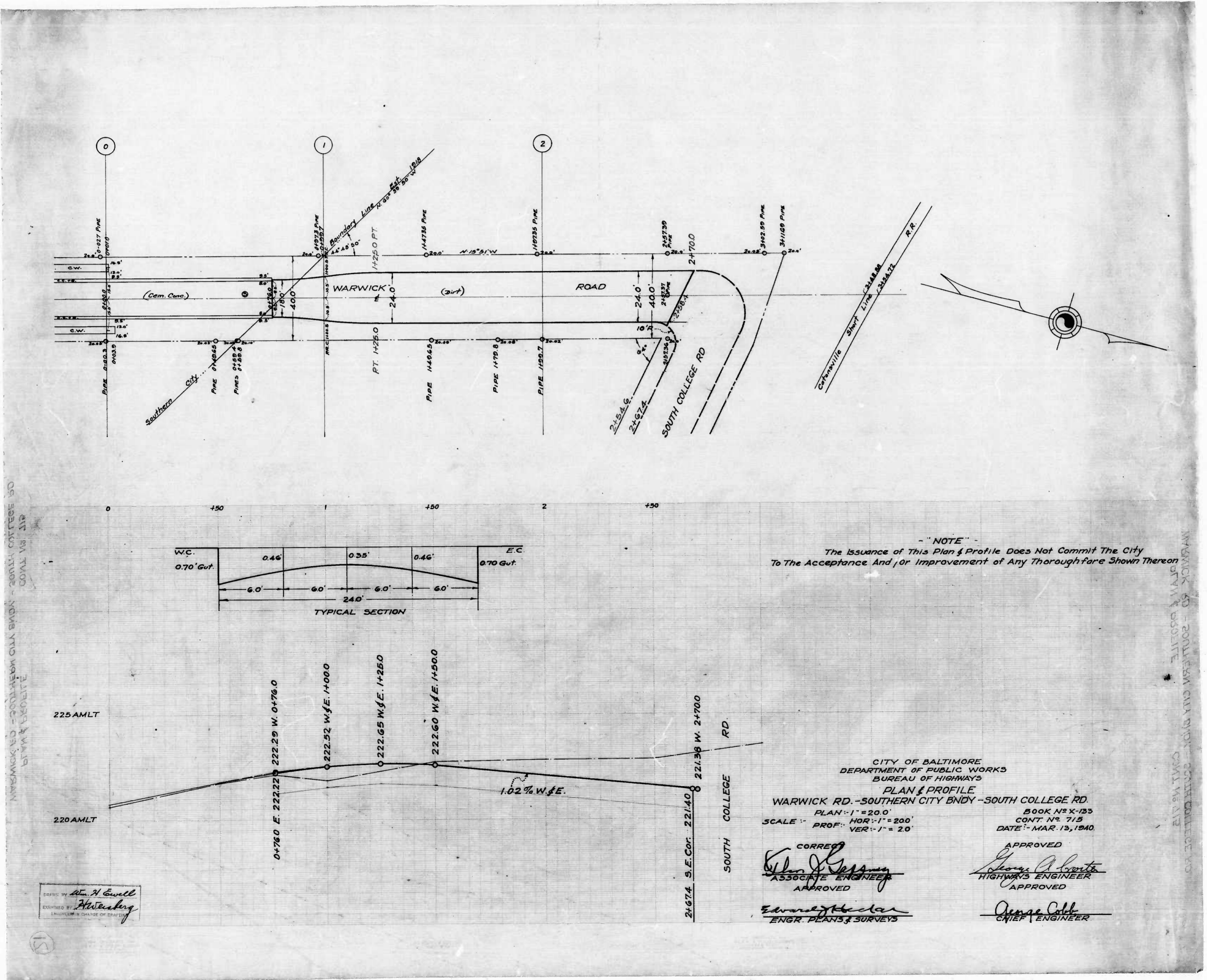

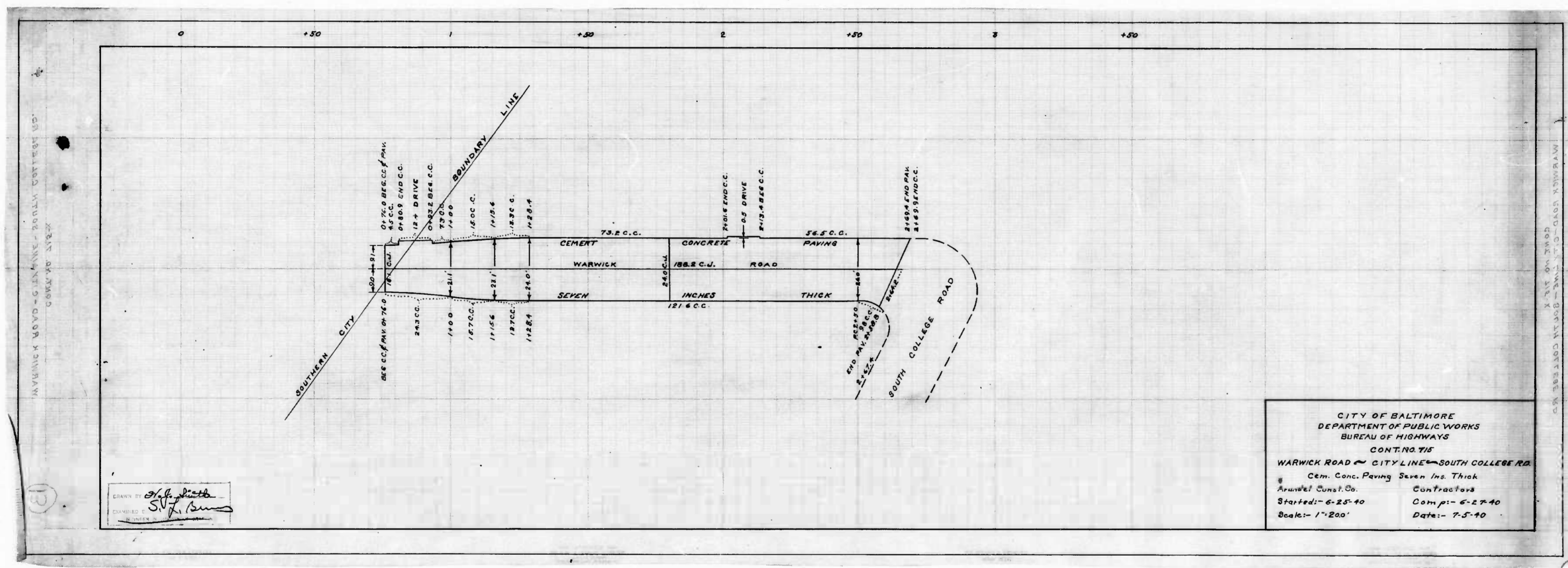

DRAWN BY *S. J. Smith*
 CHECKED BY *S. J. Smith*
 DATE: 6-25-40

CITY OF BALTIMORE
 DEPARTMENT OF PUBLIC WORKS
 BUREAU OF HIGHWAYS
 CONT. NO. 715
 WARWICK ROAD ~ CITY LINE ~ SOUTH COLLEGE RD.
 Cem. Conc. Paving Seven Ins. Thick
 Architect Const. Co. Contractors
 Started: 6-25-40 Comp. 6-27-40
 Scale: 1"=200' Date: 7-5-40

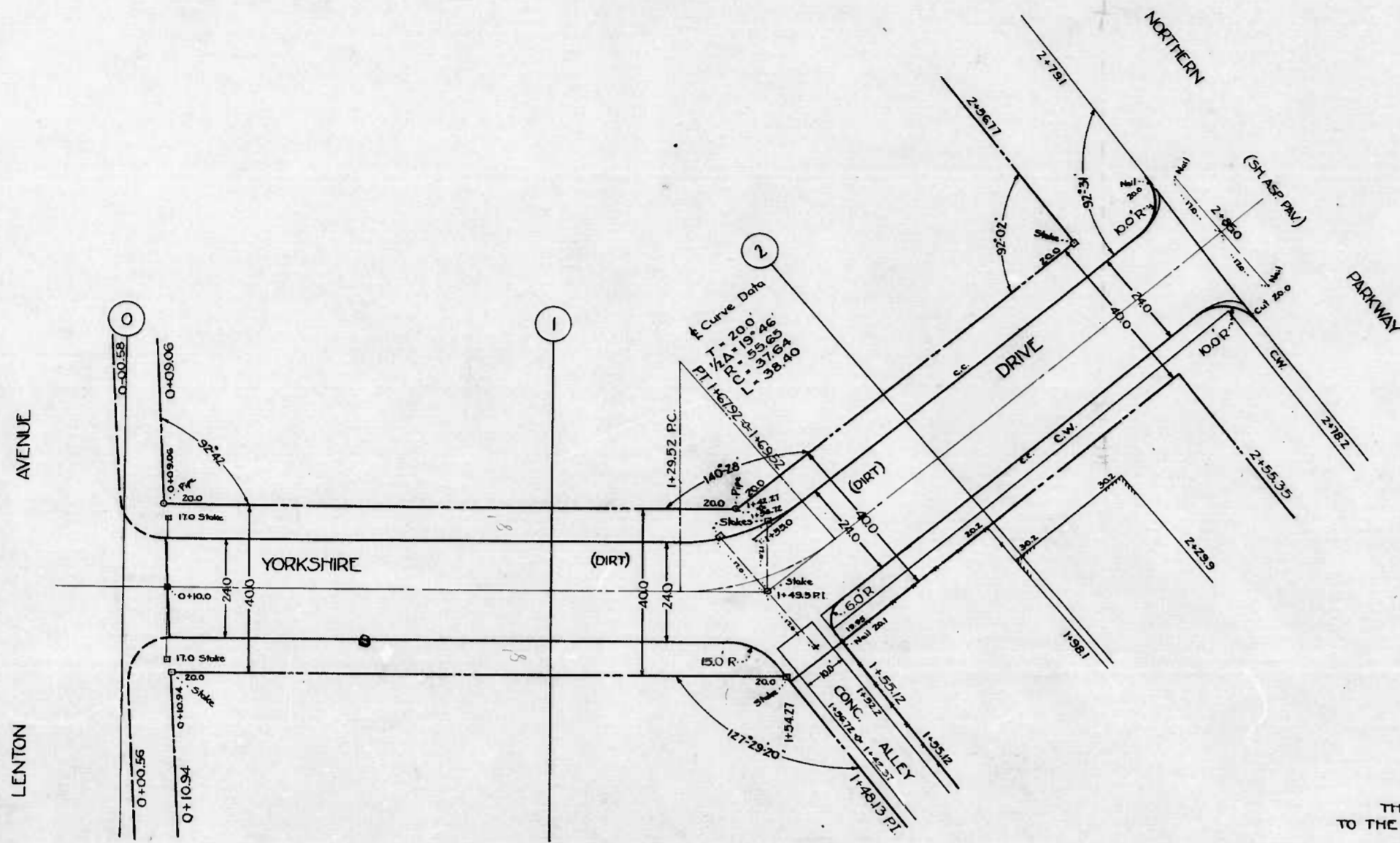

NOTE
 THE ISSUANCE OF THIS PLAN & PROFILE DOES NOT COMMIT THE CITY
 TO THE ACCEPTANCE AND/OR IMPROVEMENT OF ANY THOROUGHFARE SHOWN THEREON.

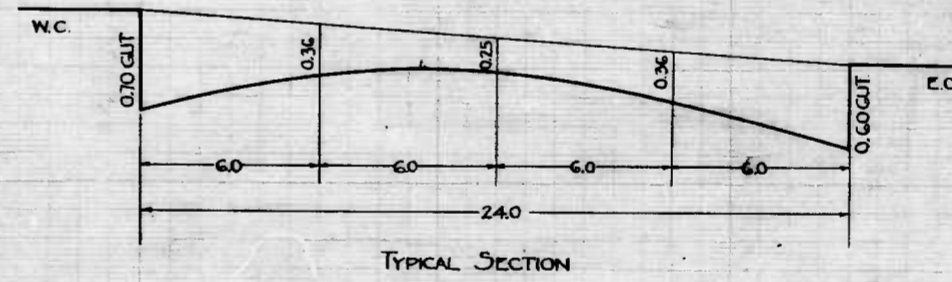
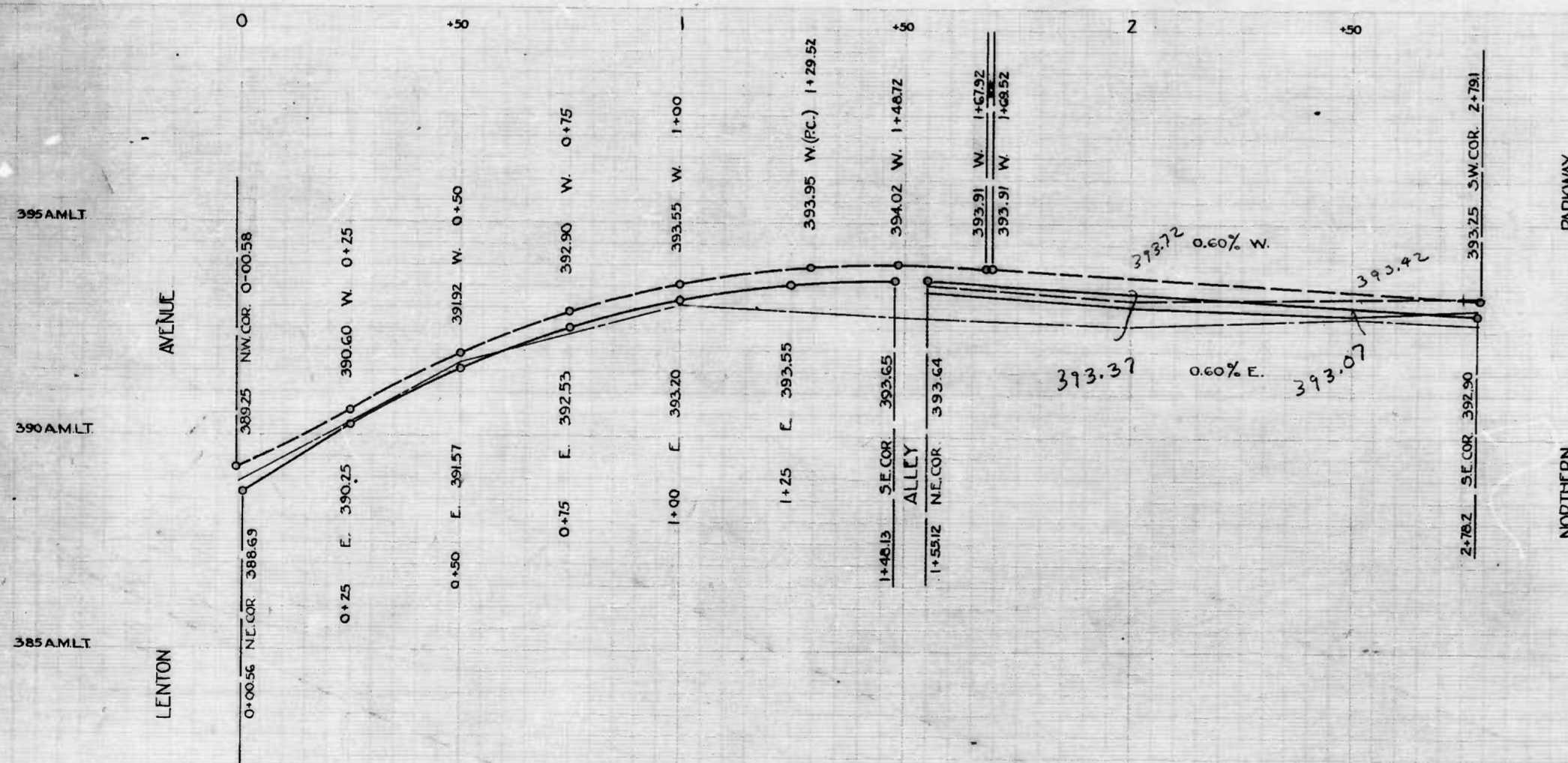

CITY OF BALTIMORE
 DEPARTMENT OF PUBLIC WORKS
 BUREAU OF HIGHWAYS
 PLAN & PROFILE
 YORKSHIRE DR - LENTON AVE TO NORTHERN PKWY.
 PLAN: 1"=20.0'
 SCALES: HOR: 1"=20.0' APR 1, 1940.
 PROF: 1"=2.0' BOOK(X-131, P-41)
 CONT. N° 715

CORRECT: APPROVED:
John H. Gessner *George A. ...*
 ASSOCIATE ENGINEER HIGHWAYS ENGINEER
 APPROVED: APPROVED:
Edward ... *James ...*
 ENGR. PLANS & SURVEYS CHIEF ENGINEER

DESIGNED BY: A. Gronert
 DRAWN BY: *H. ...*
 CHECKED BY: *...*

YORKSHIRE DR - LENTON AVE TO NORTHERN PKWY
 CONT. N° 715

YORKSHIRE DR - LENTON AVE TO NORTHERN PKWY
 CONT. N° 715

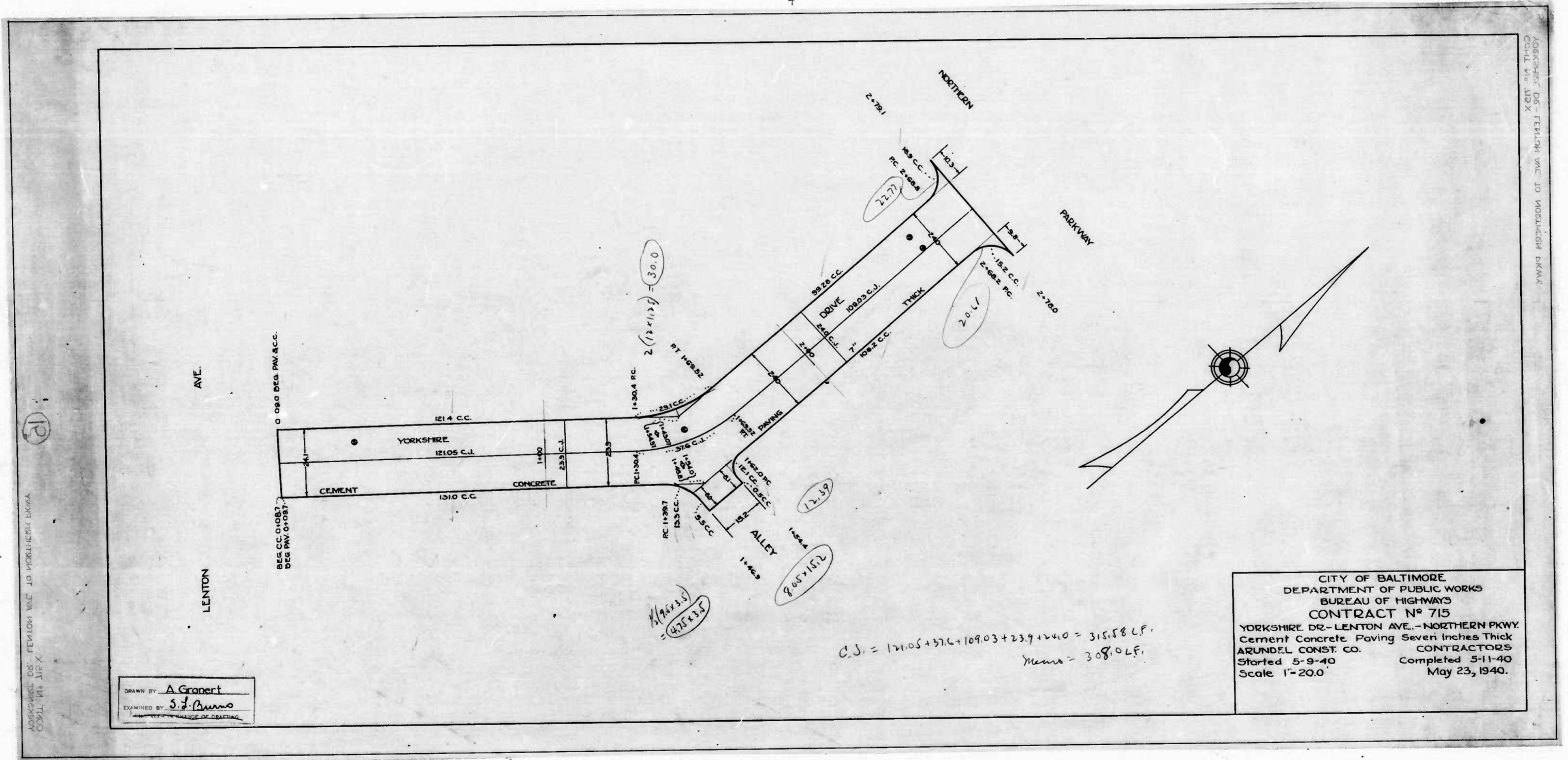

DRAWN BY: A. Grapert
 EXAMINED BY: S. J. Burns

CITY OF BALTIMORE
 DEPARTMENT OF PUBLIC WORKS
 BUREAU OF HIGHWAYS
 CONTRACT NO. 715
 YORKSHIRE DR. - LENTON AVE. - NORTHERN PKWY.
 Cement Concrete Paving Seven Inches Thick
 ARUNDEL CONST. CO. CONTRACTORS
 Started 5-9-40 Completed 5-11-40
 Scale 1"=20.0' May 23, 1940.

C.S. = 12105 + 576 + 10903 + 239 + 1440 = 31583 LF.
 Mens = 3080 LF.

Handwritten note: 30.0

Handwritten note: 12.39

Handwritten note: 90571572

APPROVED FOR THE CITY OF BALTIMORE
 CIVIL ENGINEER

APPROVED FOR THE CITY OF BALTIMORE
 CIVIL ENGINEER