

CITY OF BALTIMORE
 DEPARTMENT OF PUBLIC WORKS
 BUREAU OF HIGHWAYS
 PLAN OF
 WILDWOOD PKWY - GELSTON DR - COLBORNE RD
 SCALE - 1" = 200'
 OCT 10, 1939
 BOOK C-714

CONT. No. 714

CORRECTED -
John G. Geyney
 ASSOCIATE ENGINEER

APPROVED -
George A. Smith
 HIGHWAYS ENGINEER

APPROVED -
James H. Hackett
 ENGR. PLANS & SURVEYS

APPROVED -
George Coll
 CHIEF ENGINEER

Sheet 2

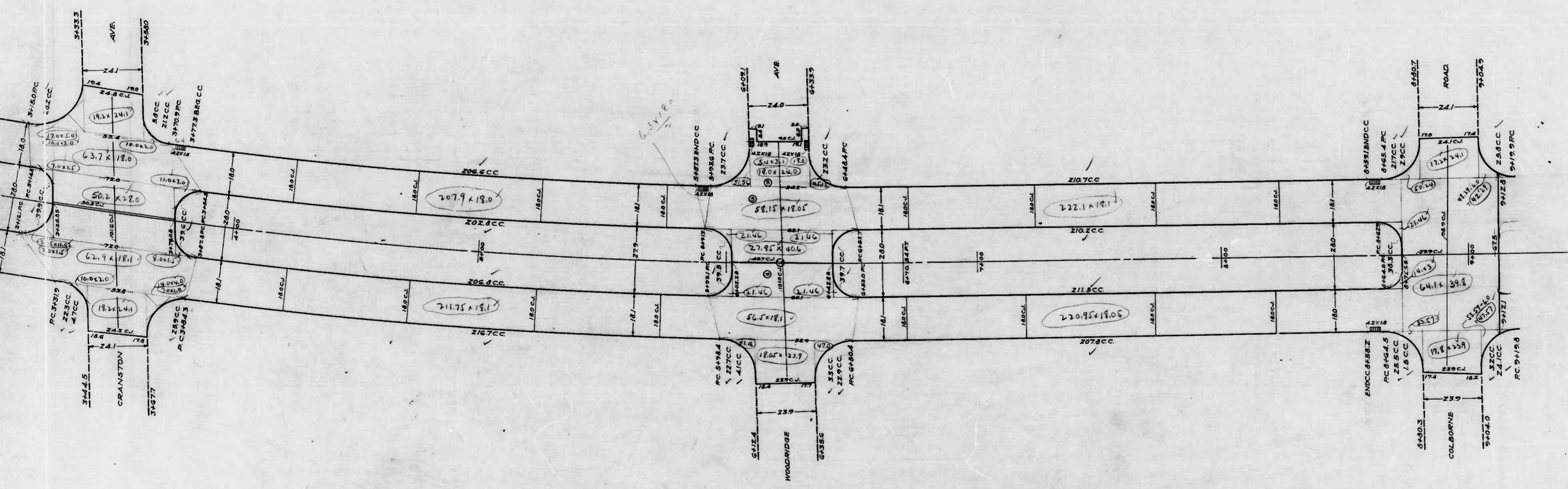

CITY OF BALTIMORE
 DEPARTMENT OF PUBLIC WORKS
 BUREAU OF HIGHWAYS
 CONT No. 714
 WILDWOOD PKWY-GELSTON DR-COLBORNE RD.
 CEM.CONC. PAV. SEVEN INCHES THICK.
 Paramount Const. Co. Contractors.
 Started:-10-24-39 Comp:-11-29-39
 Scale:-1"=200' Date:-12-29-39

shot 2

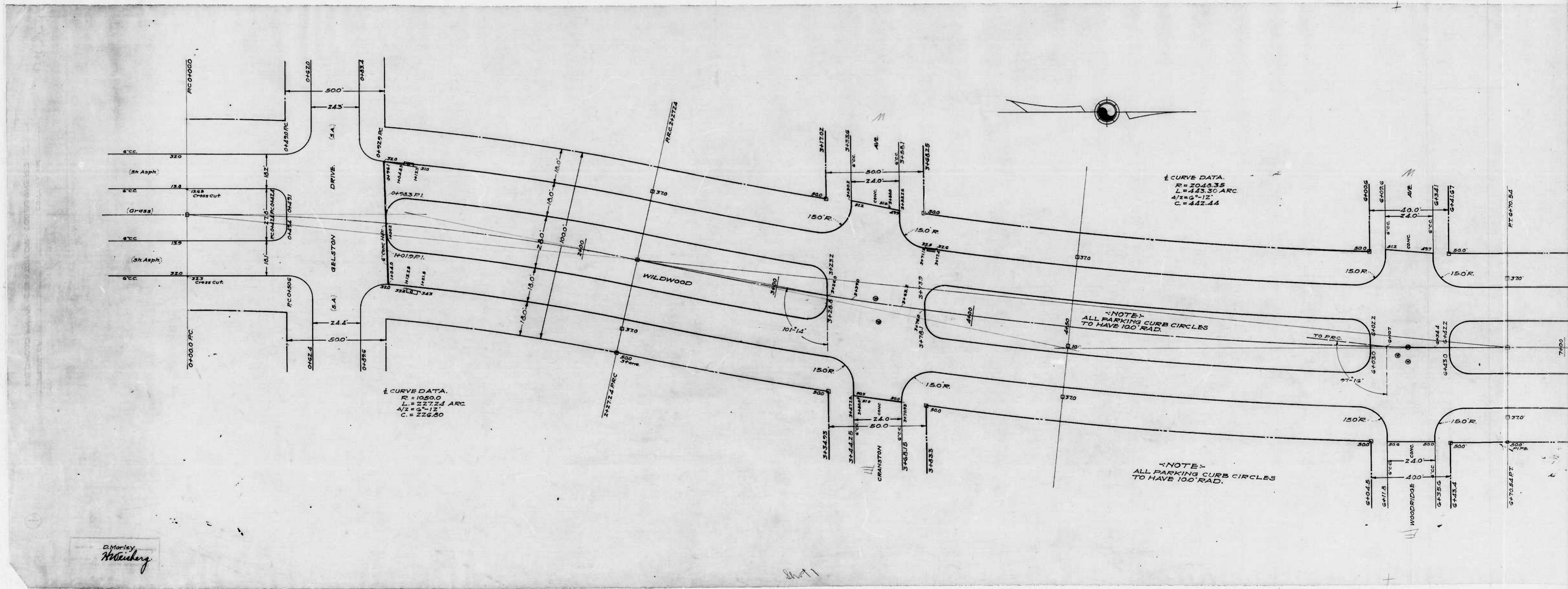

NOTE:-
ELEV. OF PARKING CURBS TO BE 0.20' HIGHER
THAN ELEV. OF OUTSIDE CURBS.

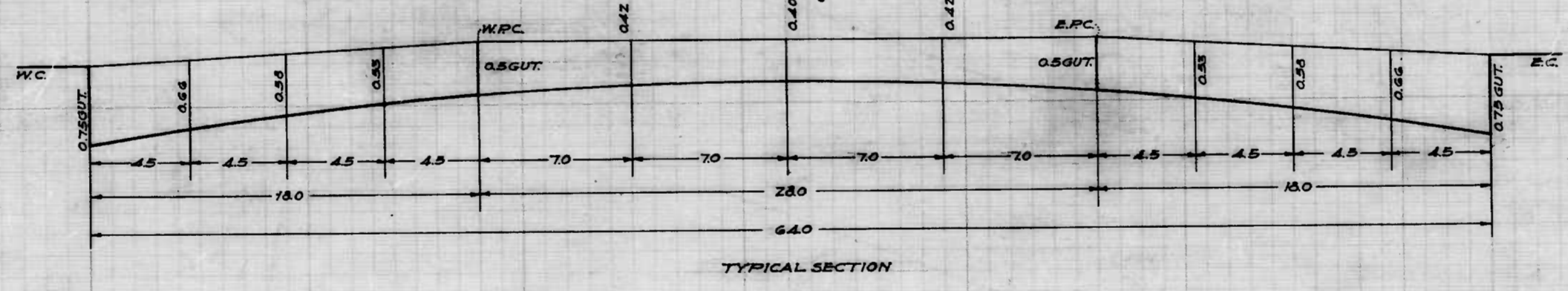
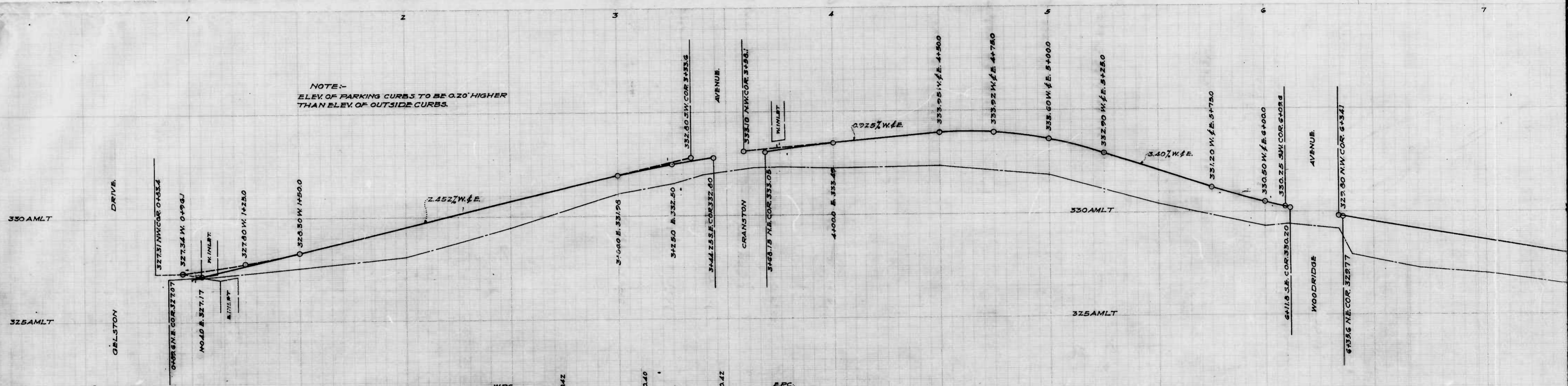

DESIGNED BY
CHECKED BY
DATE

Sheet 1

NOTE
ELEV. OF
THAN E

