

"NOTE"
The Issuance of This Plan & Profile Does Not Commit The City
To The Acceptance And/or Improvement of Any Thoroughfare Shown Thereon.

CITY OF BALTIMORE
DEPARTMENT OF PUBLIC WORKS
BUREAU OF HIGHWAYS
PLAN & PROFILE
BENNINGHAUS ROAD - CLEAR SPRING ROAD - 250' ± E
PLAN 1" = 20.0' BOOK N 2 X-85
SCALE: PROF. HOR. 1" = 20.0' DATE: SEPT. 13, 1938
VER. 1" = 2.0' CONT. N 713

CORRECTED
Edmund Hunter
ASSOCIATE ENGINEER
APPROVED
George Bell
ACTING HIGHWAYS ENGINEER
APPROVED
Walter D. ...
CHIEF ENGINEER

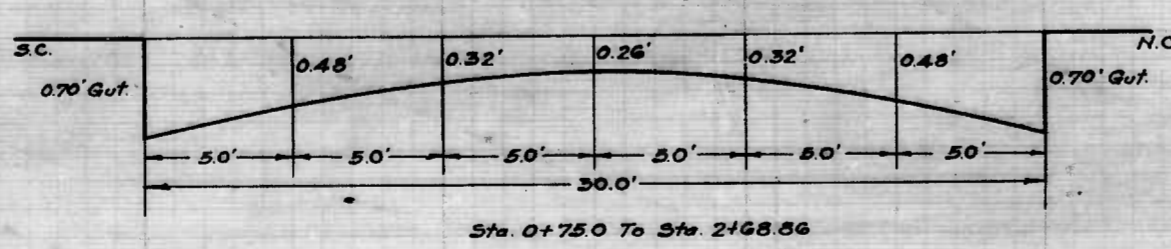

DRAWN BY: *Alvin H. Cowell*
EXAMINED BY: *Heinrich*
PROJECT IN CHARGE: *...*

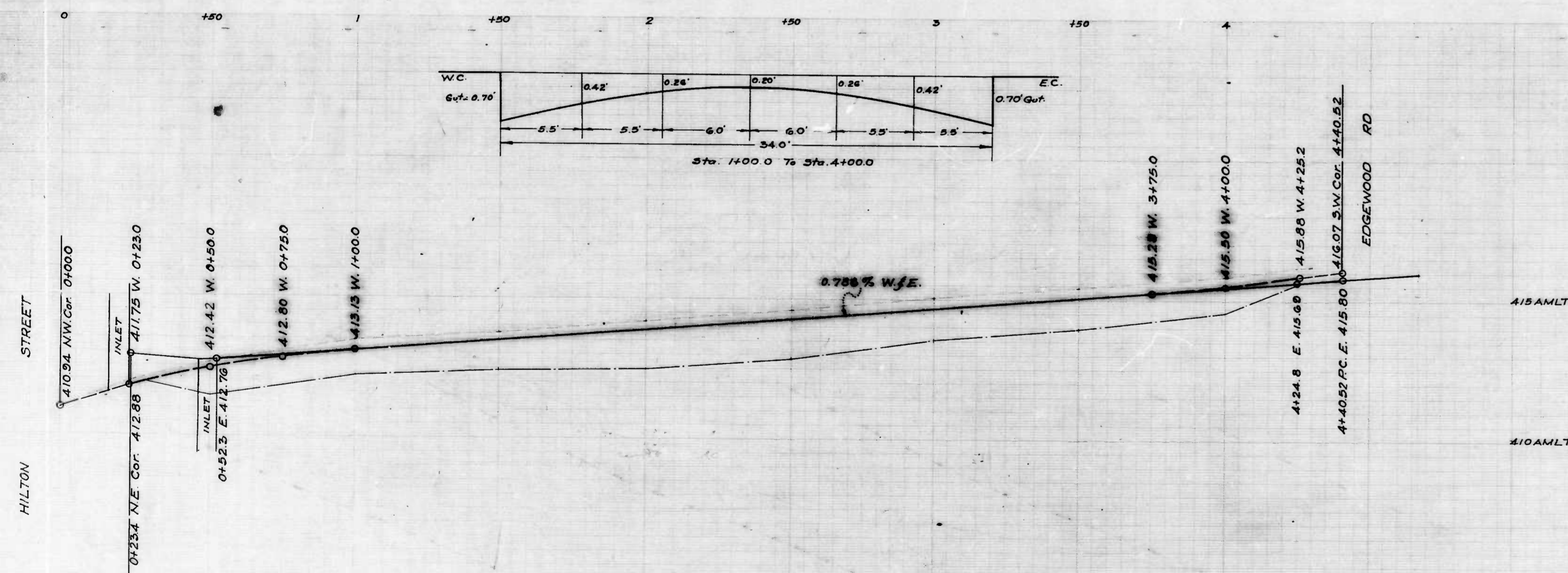
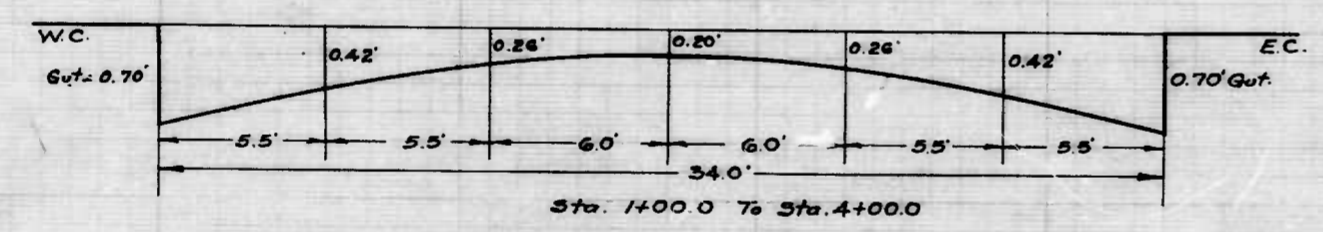
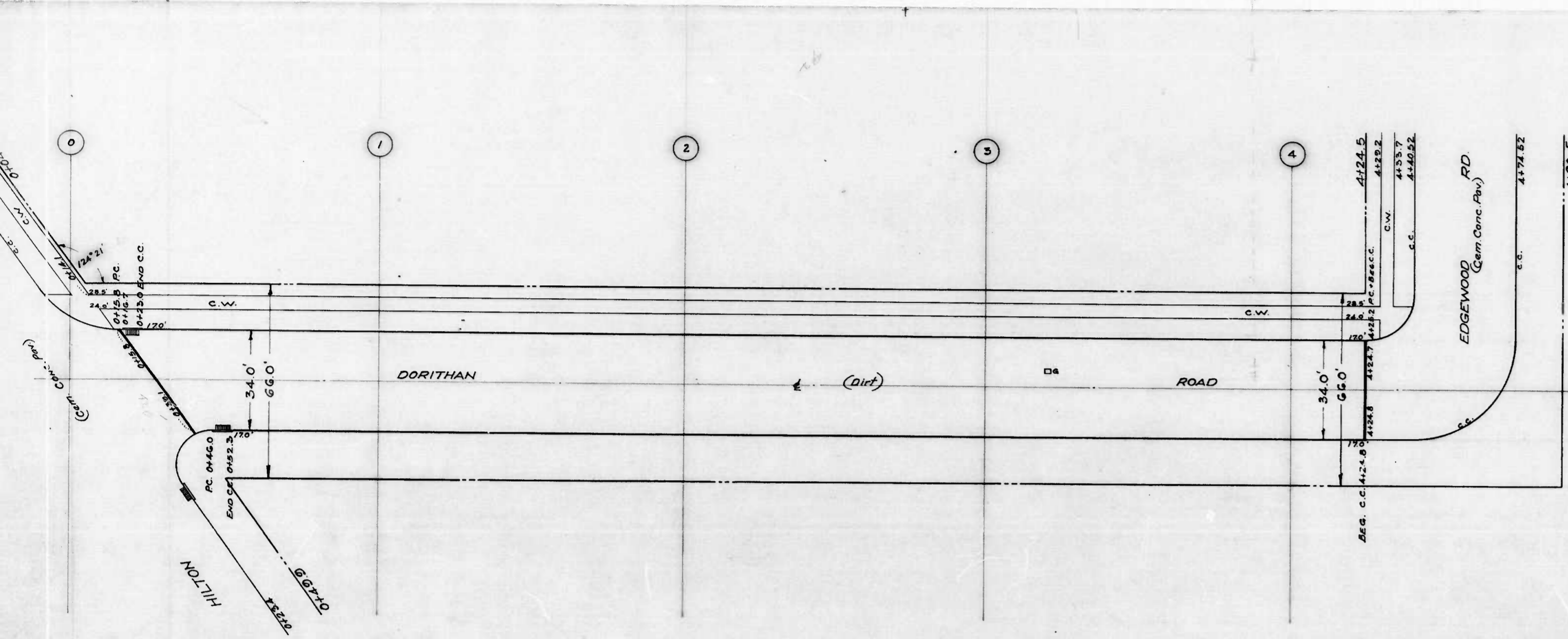

"NOTE"
The Issuance Of This Plan & Profile Does Not Commit The City
To The Acceptance And/or Improvement Of Any Thoroughfare Shown Thereon.

CITY OF BALTIMORE
DEPARTMENT OF PUBLIC WORKS
BUREAU OF HIGHWAYS
PLAN & PROFILE
DORITHAN RD. - HILTON ST. - EDGEWOOD RD.
HOR: 1" = 200' BOOK NO. X-120
VER: 1" = 20' DATE: SEPT. 22, 1939
SCALE: PLAN: 1" = 20.0' CONT. NO. 713
CORRECT APPROVED
John J. Jeffrey *George L. Hill*
ASSOCIATE ENGINEER ACTING HIGHWAYS ENGINEER
APPROVED APPROVED
Ernest H. Becker *Frank W. ...*
ENGR. PLANS & SURVEYS CHIEF ENGINEER

Sheet 1

Sheet 2

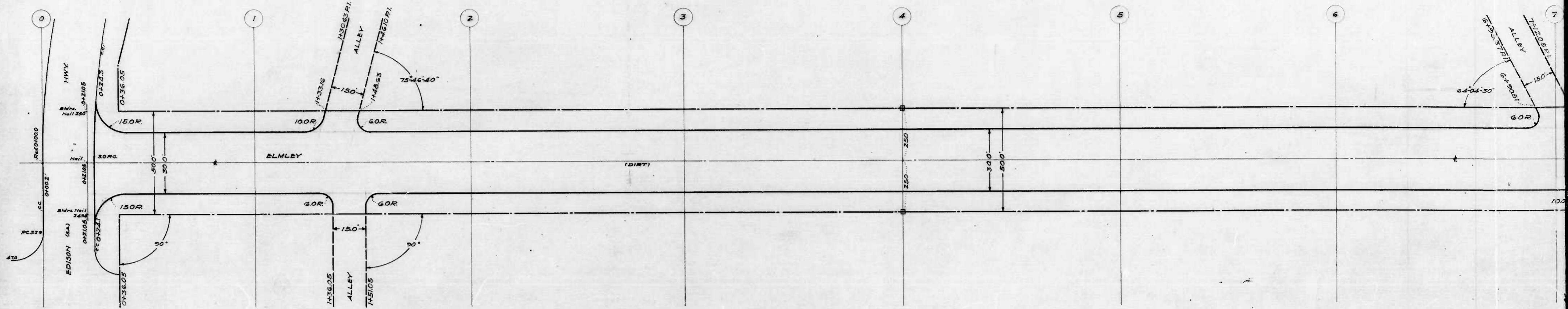

"NOTE"
 THE ISSUANCE OF THIS PLAN & PROFILE DOES NOT COMMIT THE CITY TO THE
 ACCEPTANCE AND/OR IMPROVEMENT OF ANY THOROUGHFARES SHOWN THEREON.

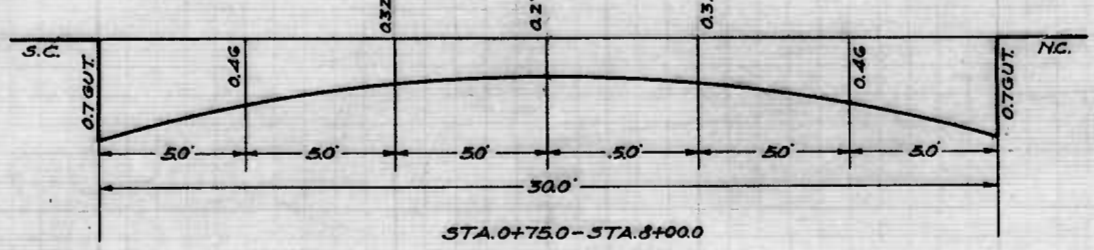
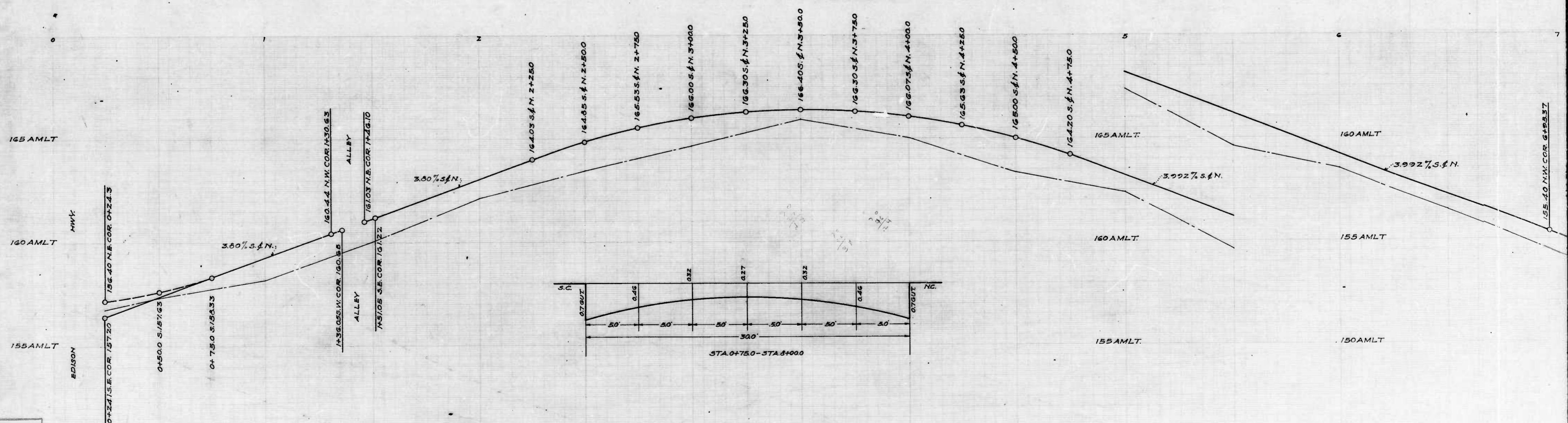

DESIGNED BY D. Marley
 ENGINEER
 HUBBARD
 REGISTERED PROFESSIONAL ENGINEER

Sheet 1

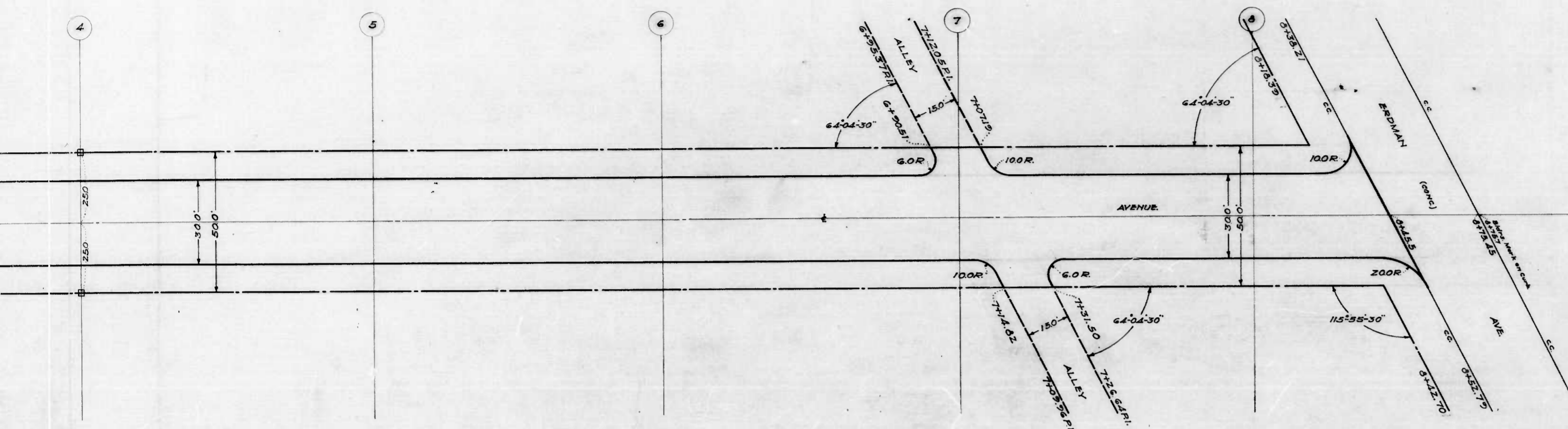

"NOTE"
 THE ISSUANCE OF THIS PLAN & PROFILE DOES NOT COMMIT THE CITY TO THE
 ACCEPTANCE AND/OR IMPROVEMENT OF ANY THOROUGHFARES SHOWN THEREON.

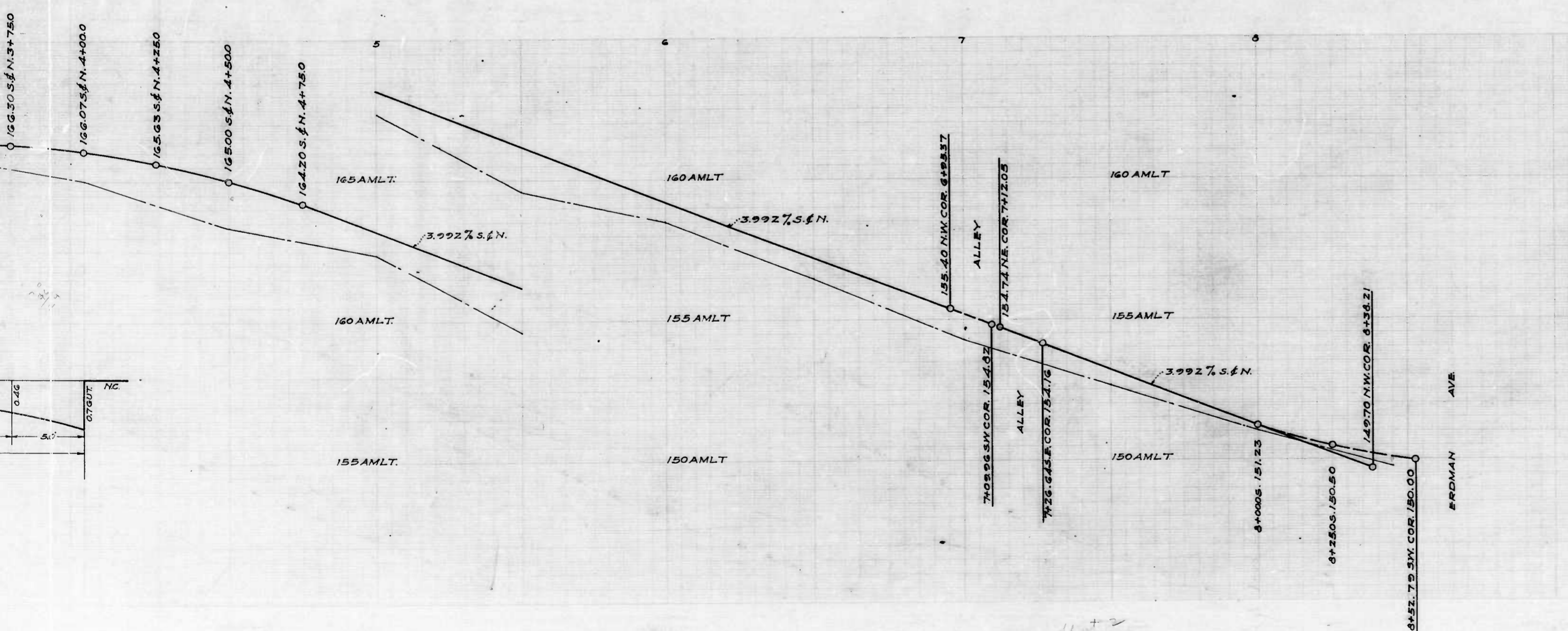

CITY OF BALTIMORE
 DEPARTMENT OF PUBLIC WORKS
 BUREAU OF HIGHWAYS
 PLAN & PROFILE
 ELMLEY AVE - EDISON HWY - ERDMAN AVE.
 PLAN - 1" = 200' BOOK No. X-126
 SCALES - HOR. - 1" = 200' DATE - SEPT. 23, 1939
 PROF. - 1" = 20' CONT. No. 713

CORRECTED: *John Gessney* ASSOCIATE ENGINEER
 APPROVED: *George Cobb* HIGHWAYS ENGINEER (ACTING)
 APPROVED: *Edward J. ...* ENGR. PLANS & SURVEYS
 APPROVED: *...* CHIEF ENGINEER

STATIONING AVE - EDISON HWY - ERDMAN AVE
 CONT. PLAN 713

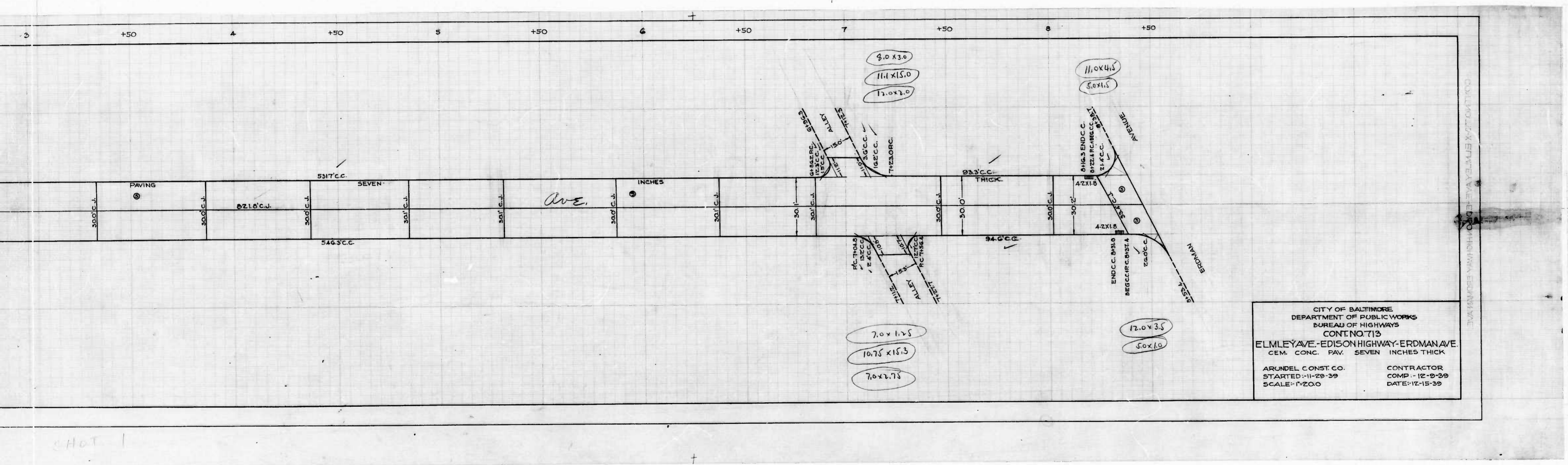

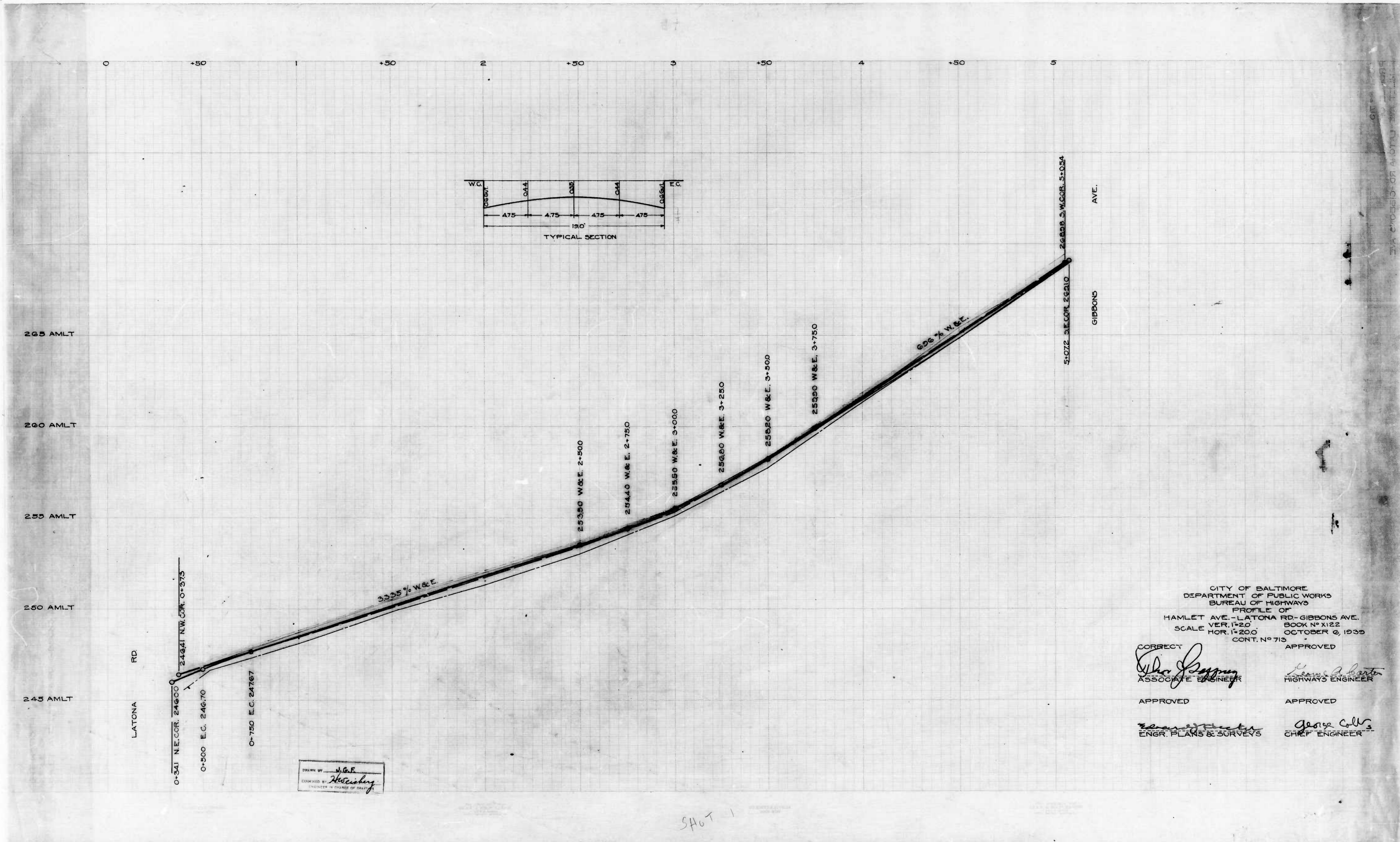

CITY OF BALTIMORE
 DEPARTMENT OF PUBLIC WORKS
 BUREAU OF HIGHWAYS
 PROFILE OF
 HAMLET AVE. - LATONA RD. - GIBBONS AVE.
 SCALE VER. 1"=20' BOOK NO. X122
 HOR. 1"=20.0' OCTOBER 6, 1935
 CONT. NO. 713

CORRECT APPROVED
Edwin J. Fisher *George A. Carter*
 ASSOCIATE ENGINEER HIGHWAYS ENGINEER
 APPROVED APPROVED
Edwin J. Fisher *George A. Carter*
 ENGR. PLANS & SURVEYS CHIEF ENGINEER

DRAWN BY *J.G.F.*
 EXAMINED BY *Hesterberg*
 ENGINEER IN CHARGE OF DIST.

SHOT 1

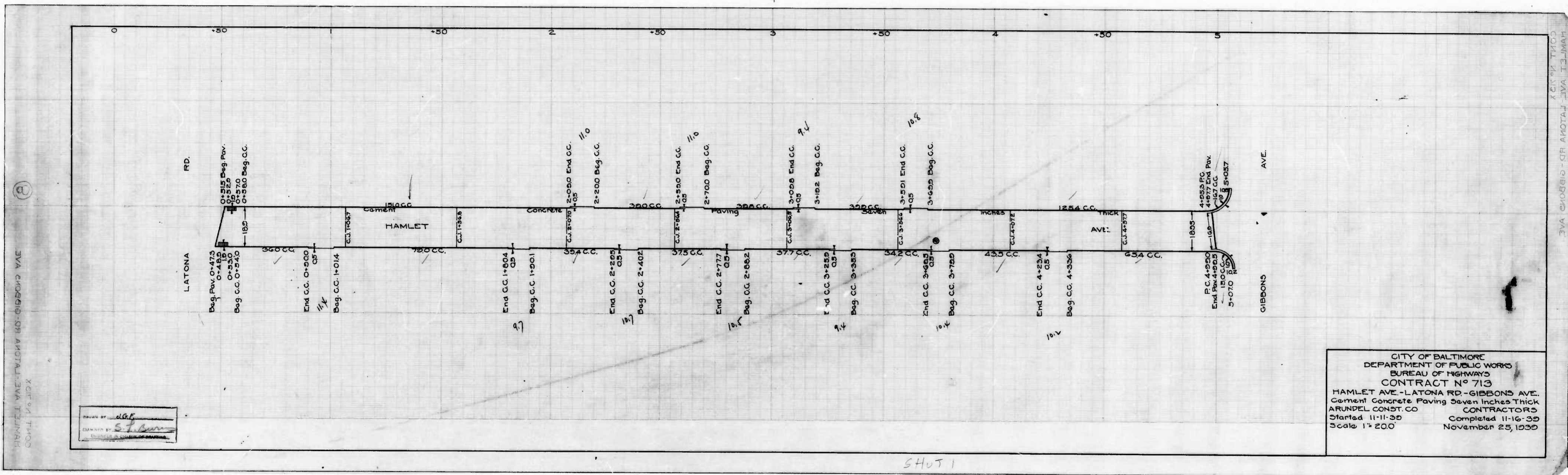

CITY OF BALTIMORE
 DEPARTMENT OF PUBLIC WORKS
 BUREAU OF HIGHWAYS
 CONTRACT N^o 713
 HAMLET AVE - LATONA RD - GIBBONS AVE.
 Cement Concrete Paving Seven Inches Thick
 ARUNDEL CONST. CO CONTRACTORS
 Started 11-11-35 Completed 11-16-35
 Scale 1" = 200' November 25, 1935

DESIGNED BY *[Signature]*
 DRAWN BY *[Signature]*

SHUT 1

PC-28

Subcontract 58 - E.H. of L.S. E. of Wagon Ave. to Miller St. Company

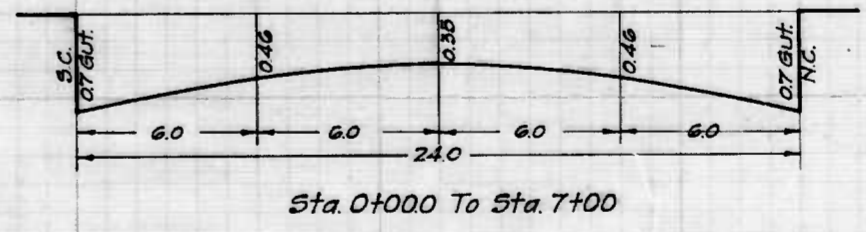
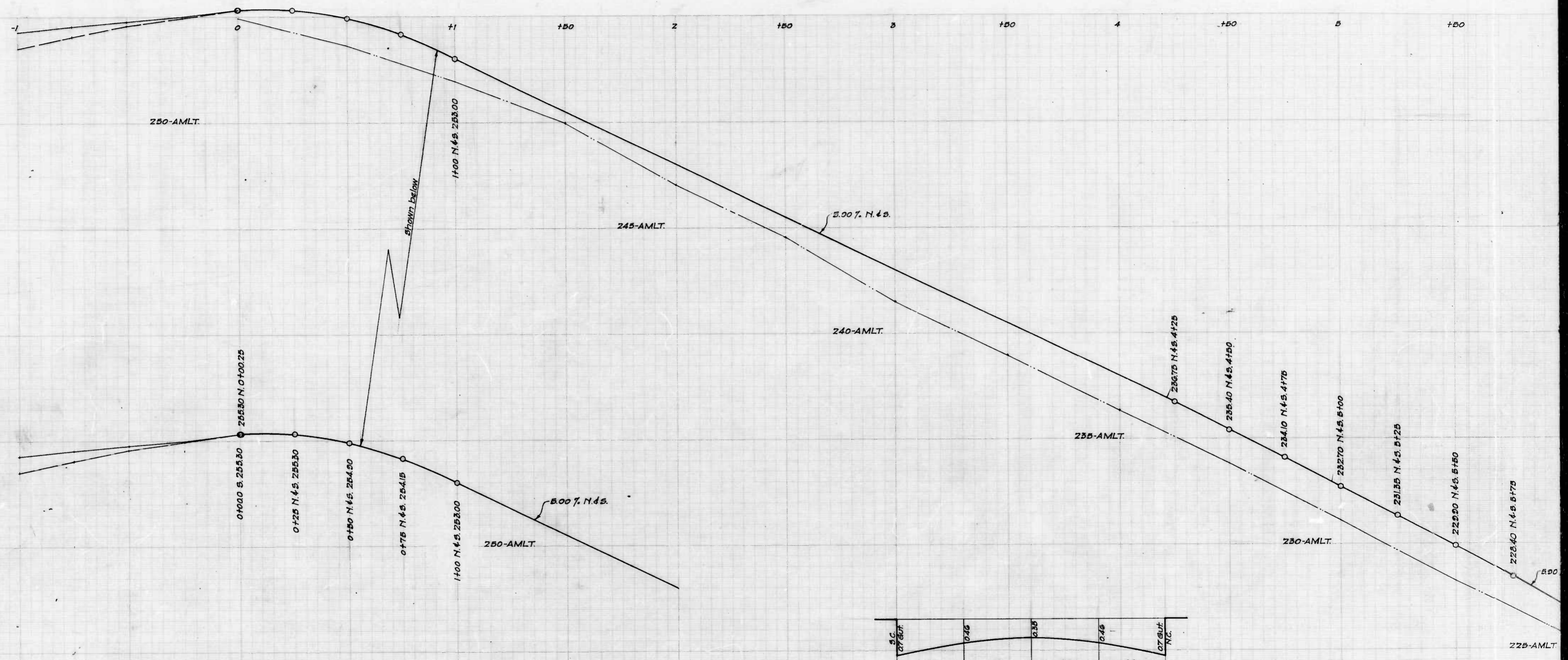

DRAWN BY *[Signature]*
 CHECKED BY *[Signature]*
 ENGINEER IN CHARGE *[Signature]*

Sheet 1

713

RATIO - 24

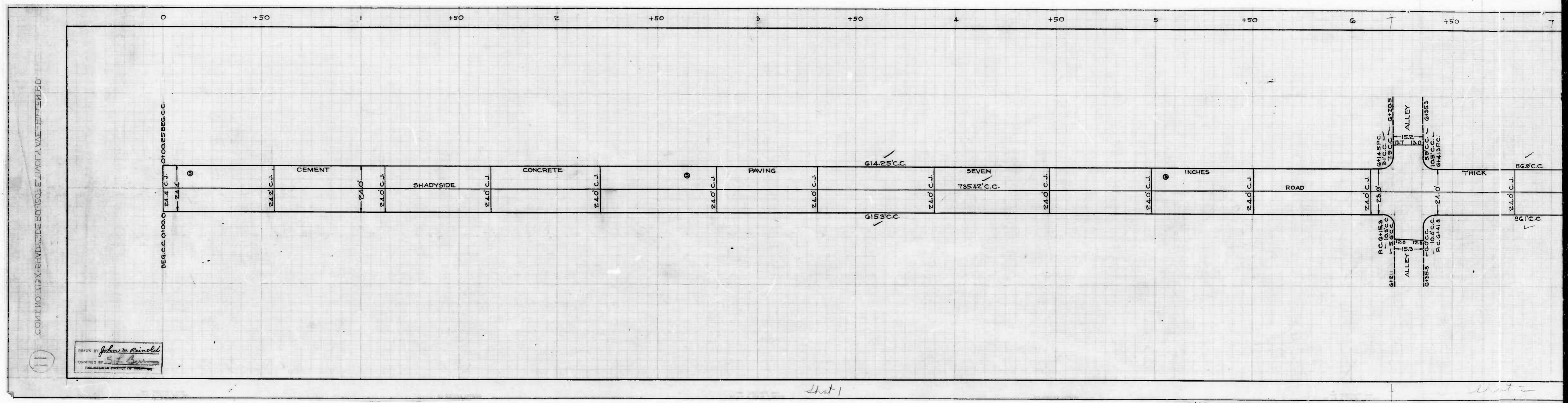

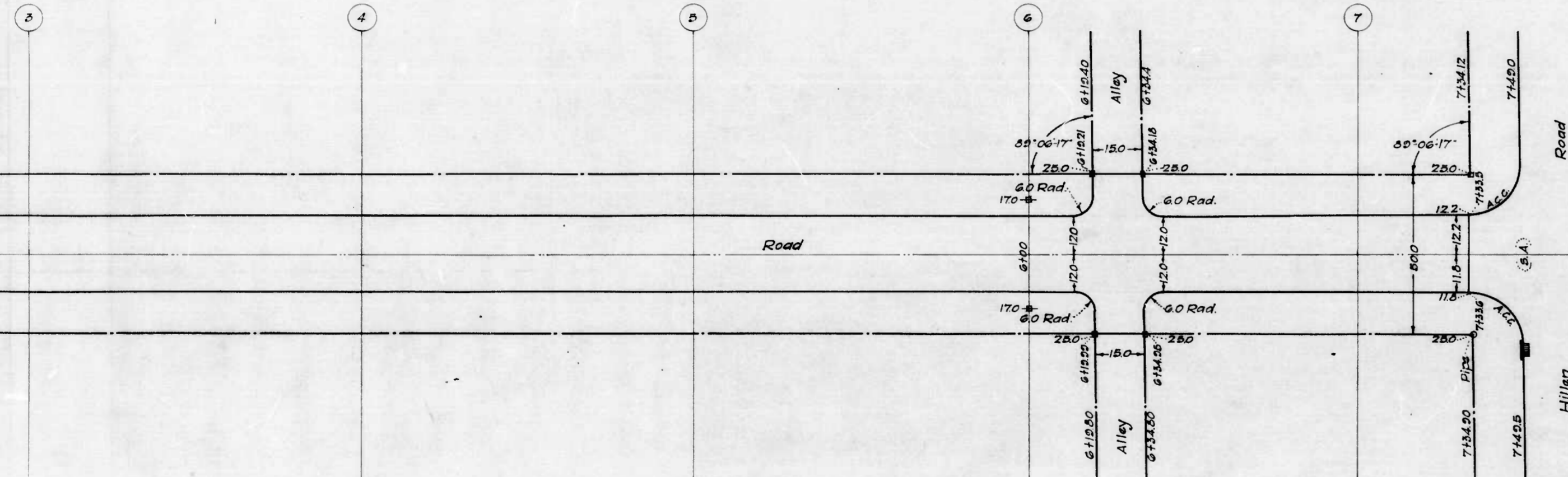

CITY OF BALTIMORE
 DEPARTMENT OF PUBLIC WORKS
 BUREAU OF HIGHWAYS
 LAYOUT OF
 SHADYSIDE RD.-END OF PAV.E. OF TIVOLY AVE. TO HILLEN RD.
 Cont. No. 713
 Scale - 1"=200'
 Book No. X-127
 Nov. 6, 1939

Approved: _____ Approved: _____ Contract: _____ Approved: _____
 George Coll Chief Engineer
 Engr. - Plans & Surveys
 Associate Engineer
 Highway Engineer

Note: The issuance of this plan does not commit the City to the acceptance and/or improvement of any thoroughfares shown thereon.

Note: The issuance of this profile does not commit the City to the acceptance and/or improvement of any thoroughfares shown thereon.

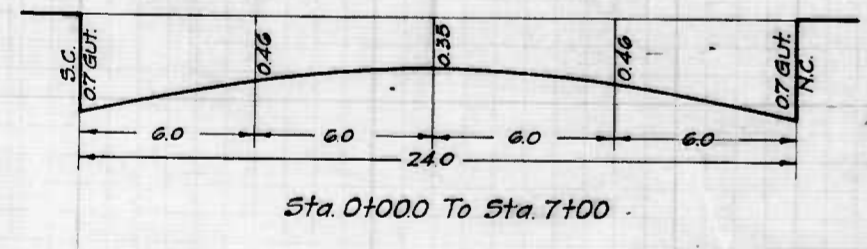
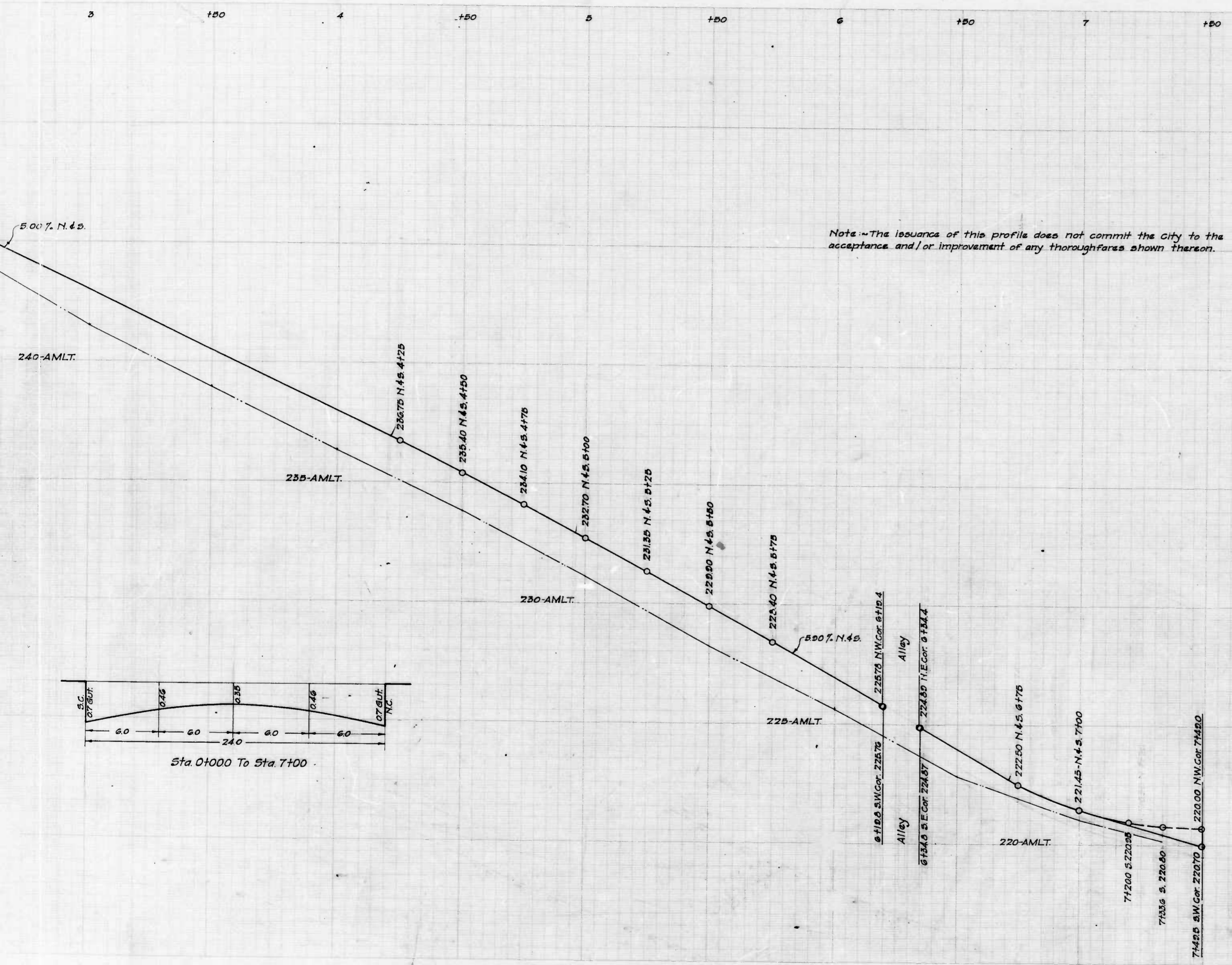

CITY OF BALTIMORE
 DEPARTMENT OF PUBLIC WORKS
 BUREAU OF HIGHWAYS
 ESTABLISHED GRADE OF
 SHADYSIDE RD.-END OF PAV. E. OF TIVOLY AVE.-HILLEN RD.

Cont. No. 718
 Scale: Hor. = 1" = 200'
 Ver. = 1" = 20'

Book No. X-127
 Nov. 9, 1939

Approved: *George C. Bell* Chief Engineer
 Approved: *James H. ...* Engr. - Plans & Surveys
 Approved: *John J. ...* Associate Engineer
 Approved: *George ...* Highways Engineer

CITY OF BALTIMORE
 DEPARTMENT OF PUBLIC WORKS
 BUREAU OF HIGHWAYS
 ESTABLISHED GRADE OF
 SHADYSIDE RD.-END OF PAV. E. OF TIVOLY AVE.-HILLEN RD.

Sheet 2

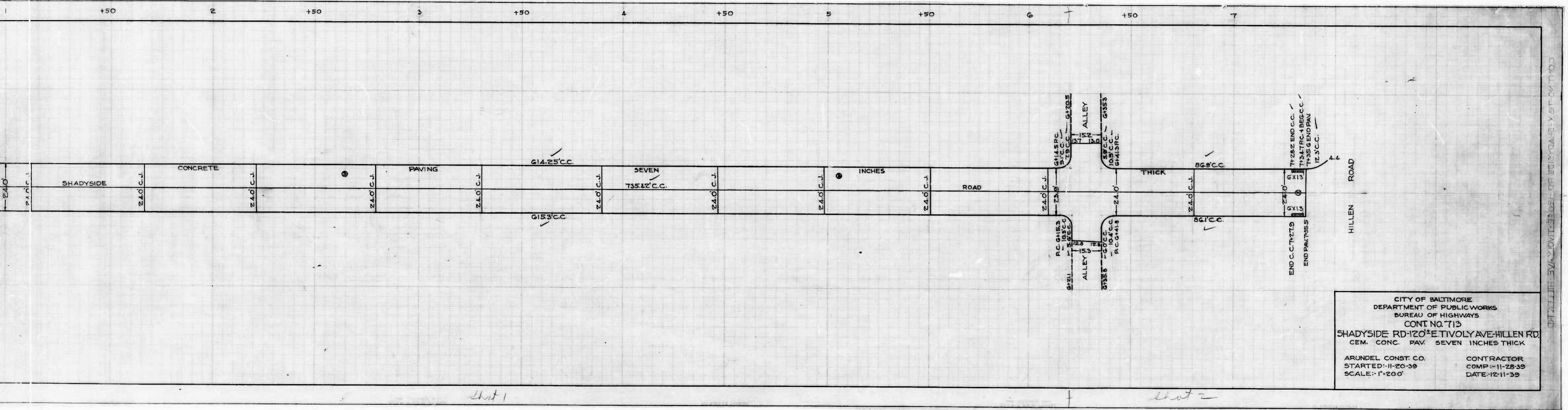

CITY OF BALTIMORE
 DEPARTMENT OF PUBLIC WORKS
 BUREAU OF HIGHWAYS
 CONT. NO. 713
 SHADYSIDE RD TO E TIVOLY AVE HILLEN RD
 CEM. CONC. PAV. SEVEN INCHES THICK
 ARUNDEL CONST. CO. CONTRACTOR
 STARTED 11-20-39 COMP 11-28-39
 SCALE 1"=200' DATE 12-11-39

Sheet 1

Sheet 2

COLLECTOR DRAINAGE TO TIVOLY AVE HILLEN RD