

-Note-
 The Issuance Of This Plan Does Not Commit The City To The
 Acceptance And/or Improvement Of Any Thoroughfares Shown Thereon.

VTF EVIDENCE ST. - WOODRIDGE AVE - COLBORNE AVE
 COLBORNE AVE - MT. HOLLY ST - ALLENDALE ST
 MT. HOLLY ST - WOODRIDGE AVE - COLBORNE AVE
 DIVISION OF
 COMING 115

CITY OF BALTIMORE
 DEPARTMENT OF PUBLIC WORKS
 BUREAU OF HIGHWAYS
 PLAN OF
 MT. HOLLY ST.-WOODRIDGE AVE.-COLBORNE AVE.
 COLBORNE AVE-MT. HOLLY ST-ALLENDALE ST.
 ALLENDALE ST-WOODRIDGE AVE.-COLBORNE AVE.
 SCALE - 1" = 20.0' DATE - AUG. 2, 1939.
 CONT. N^o 712

CORRECT APPROVED
[Signature] *[Signature]*
 ASSOCIATE ENGINEER ACTING HIGHWAYS ENGINEER

APPROVED APPROVED
[Signature] *[Signature]*
 ENGR. PLANS & SURVEYS CHIEF ENGINEER

DRAWN BY *[Signature]*
 CHECKED BY *[Signature]*
 ENGINEER IN CHARGE OF DRAWING

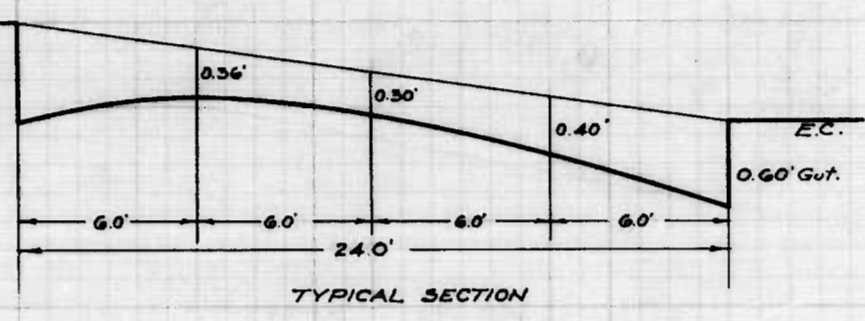
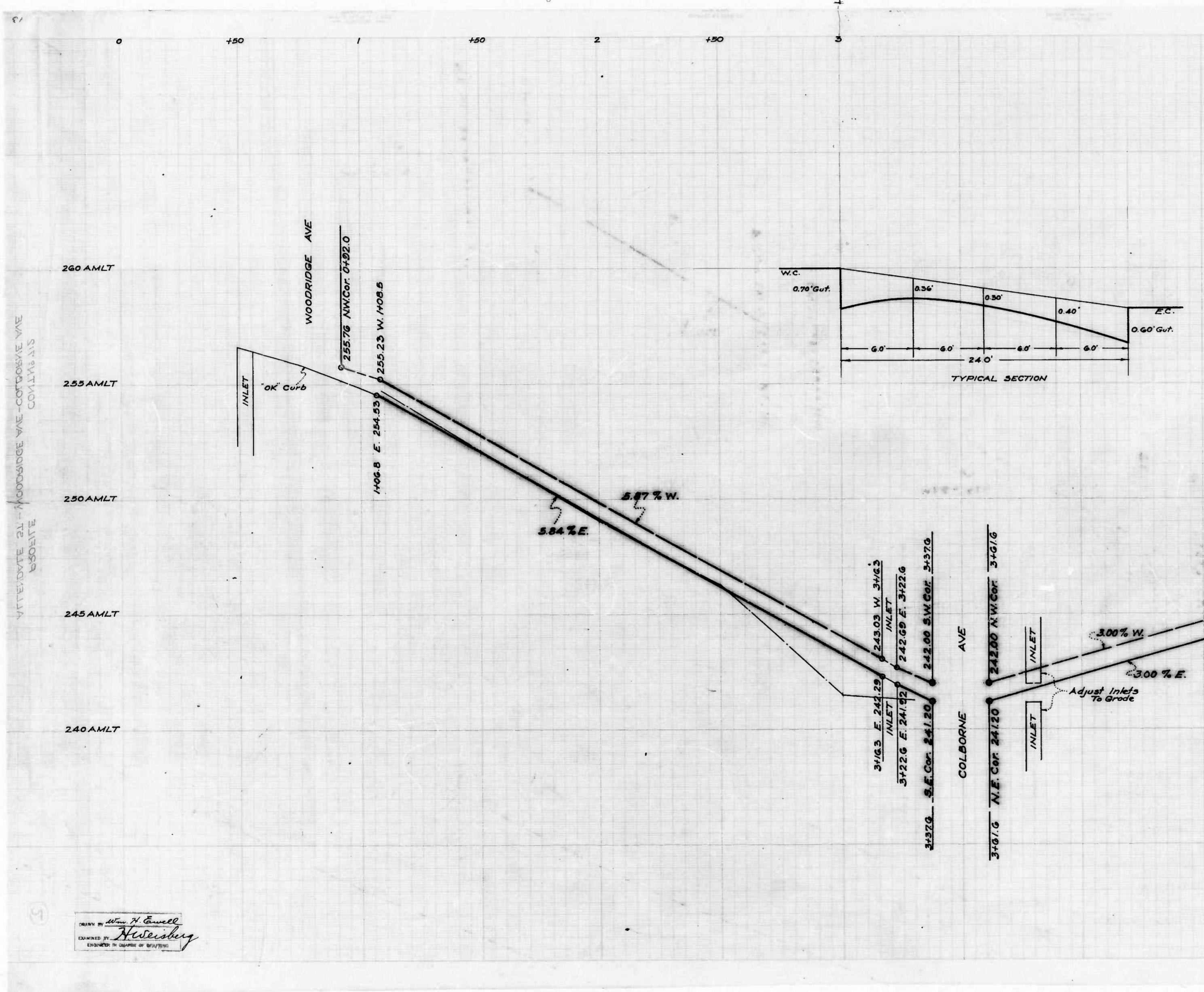

NOTE
The Issuance Of This Profile Does Not Commit The City To The Acceptance And/or Improvement Of Any Thoroughfares Shown Thereon.

CITY OF BALTIMORE
DEPARTMENT OF PUBLIC WORKS
BUREAU OF HIGHWAYS
PROFILE OF
ALLEDALE ST.-WOODRIDGE AVE.-COLBORNE AVE.
SCALE: HOR. 1" = 200' BOOK NO. C-712
VER. 1" = 20' DATE: AUG. 4, 1939
CONT. NO. 712

CORRECT **APPROVED**
John J. Larson *George C. ...*
ASSOCIATE ENGINEER ACTING HIGHWAYS ENGINEER

APPROVED **APPROVED**
Edward ... *...*
ENGR. PLANS & SURVEYS CHIEF ENGINEER

DESIGNED BY *Wm. H. ...*
DRAWN BY *H. ...*
CHECKED BY *...*

ALLEDALE ST.-WOODRIDGE AVE.-COLBORNE AVE PROFILE

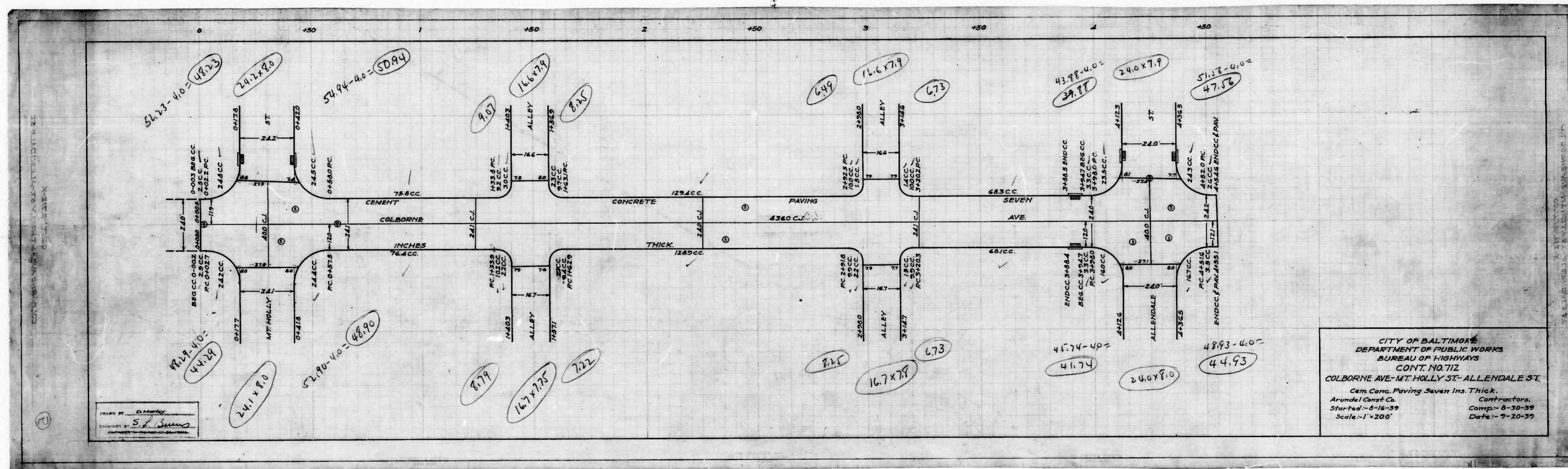

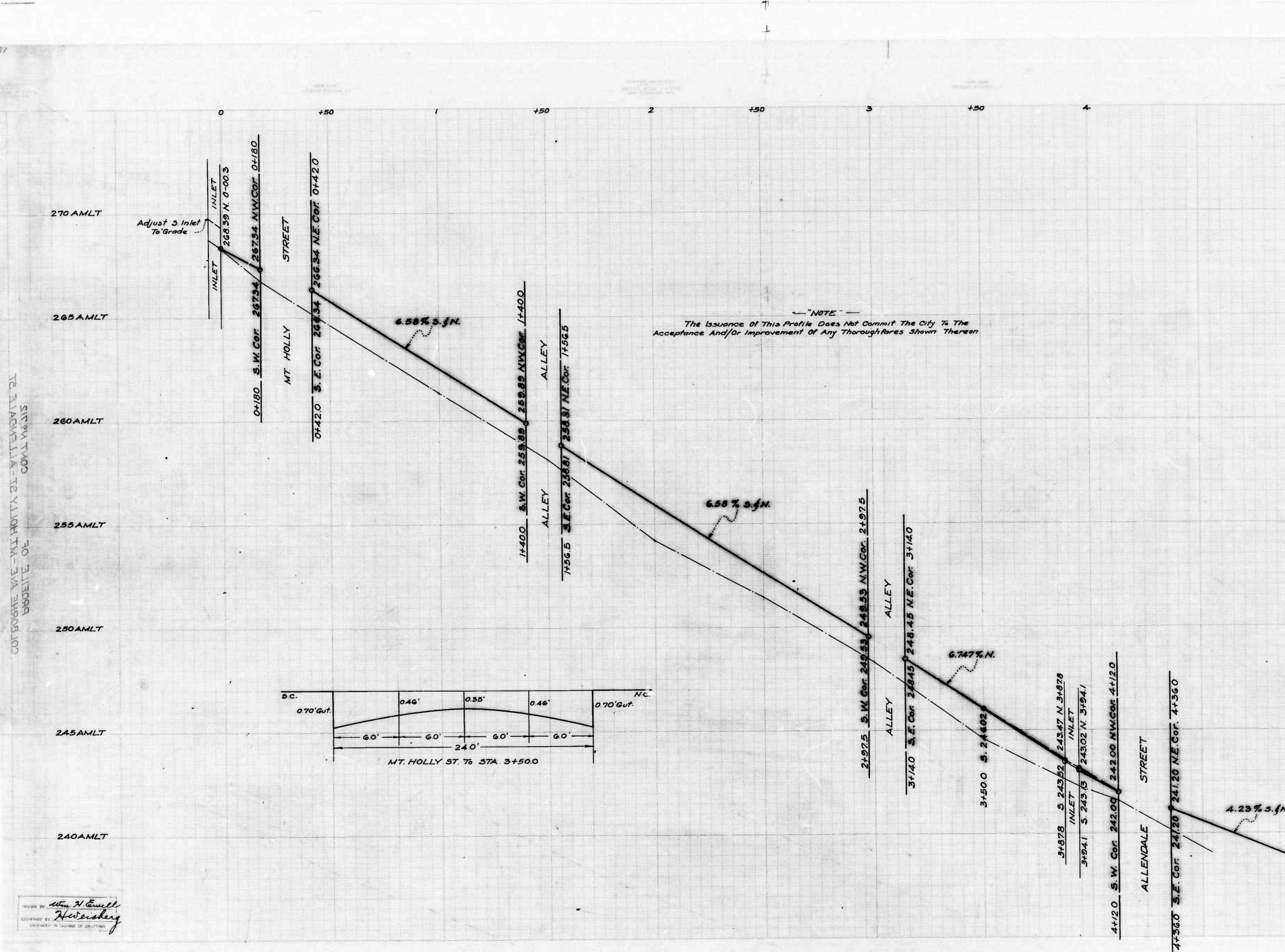

NOTE
The issuance of this profile does not commit the City to the acceptance and/or improvement of any thoroughfares shown thereon.

CITY OF BALTIMORE
DEPARTMENT OF PUBLIC WORKS
BUREAU OF HIGHWAYS
PROFILE OF
COLBORNE AVE - MT. HOLLY ST - ALLENDALE ST.
BOOK NO. 712
SCALE - HOR. 1" = 20.0' DATE - AUG 7, 1939.
VER. 1" = 20' CONT. NO. 712

CORRECT APPROVED
[Signature] *[Signature]*
ASSOCIATE ENGINEER ACTING HIGHWAYS ENGINEER
APPROVED APPROVED

[Signature] *[Signature]*
ENGR. PLANS & SURVEYS CHIEF ENGINEER

DESIGNED BY
[Signature]
CHECKED BY
[Signature]
ENGINEER IN CHARGE OF SURVEYS

Sheet 1

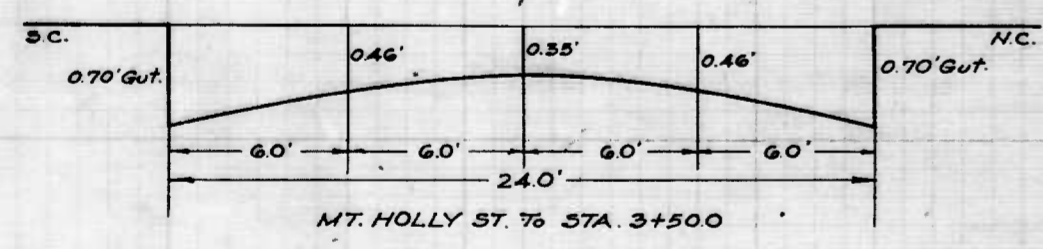
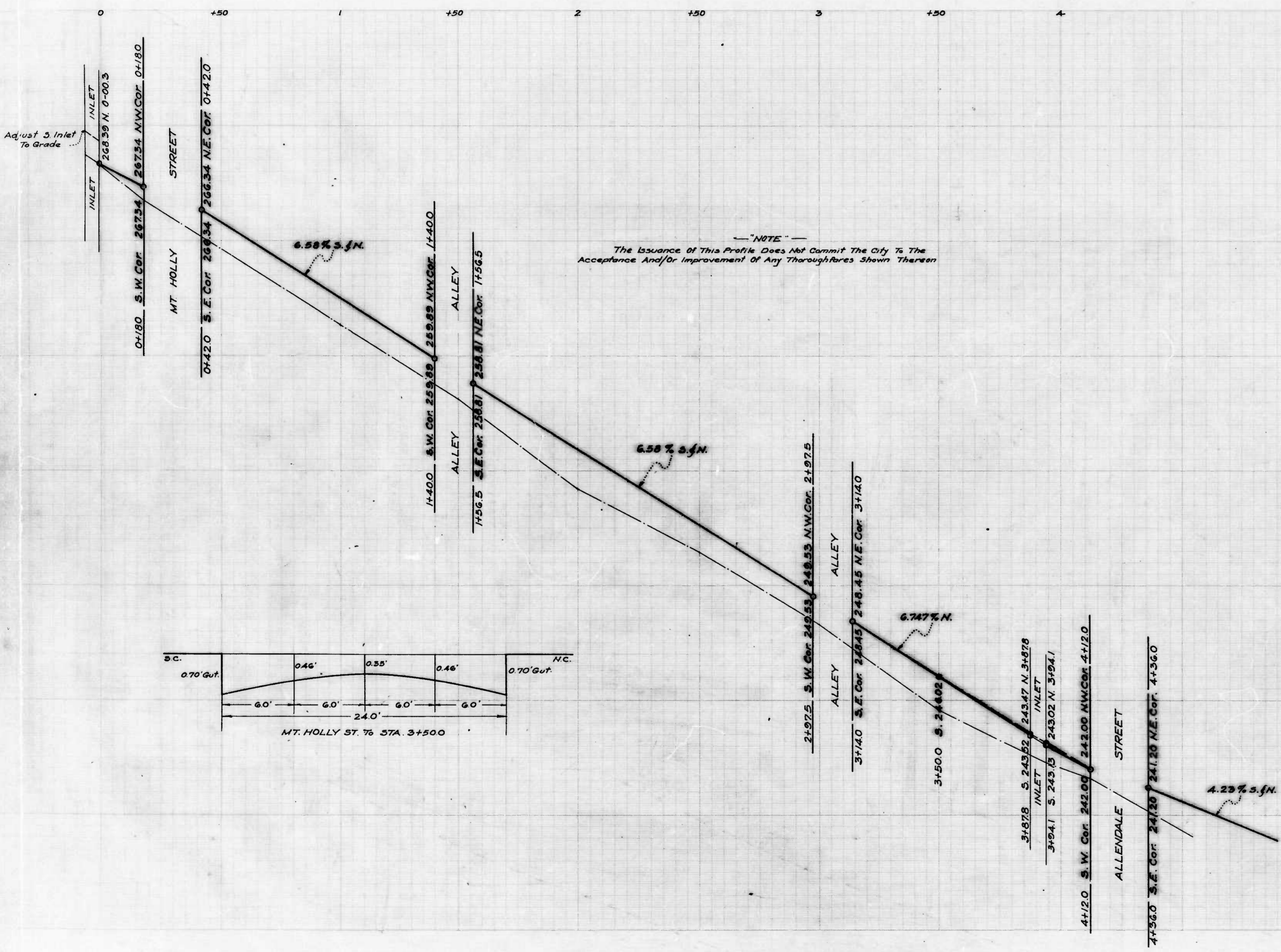

NOTE
 The Issuance of This Profile Does Not Commit The City To The
 Acceptance And/or Improvement Of Any Thoroughfares Shown Thereon

CITY OF BALTIMORE
 DEPARTMENT OF PUBLIC WORKS
 BUREAU OF HIGHWAYS
 PROFILE OF
 COLBORNE AVE.-MT. HOLLY ST.- ALLENDALE ST.
 HOR. 1" = 200'
 VER. 1" = 20'
 BOOK NO. 712
 DATE - AUG. 7, 1939
 CONT. NO. 712

CORRECT APPROVED
[Signature] *[Signature]*
 ASSOCIATE ENGINEER ACTING HIGHWAYS ENGINEER
 APPROVED APPROVED
[Signature] *[Signature]*
 ENGR. PLANS & SURVEYS CHIEF ENGINEER

COLBORNE AVE - MT. HOLLY ST - ALLENDALE ST
 PROFILE OF
 CONT. NO. 712

shot 1

shot 2

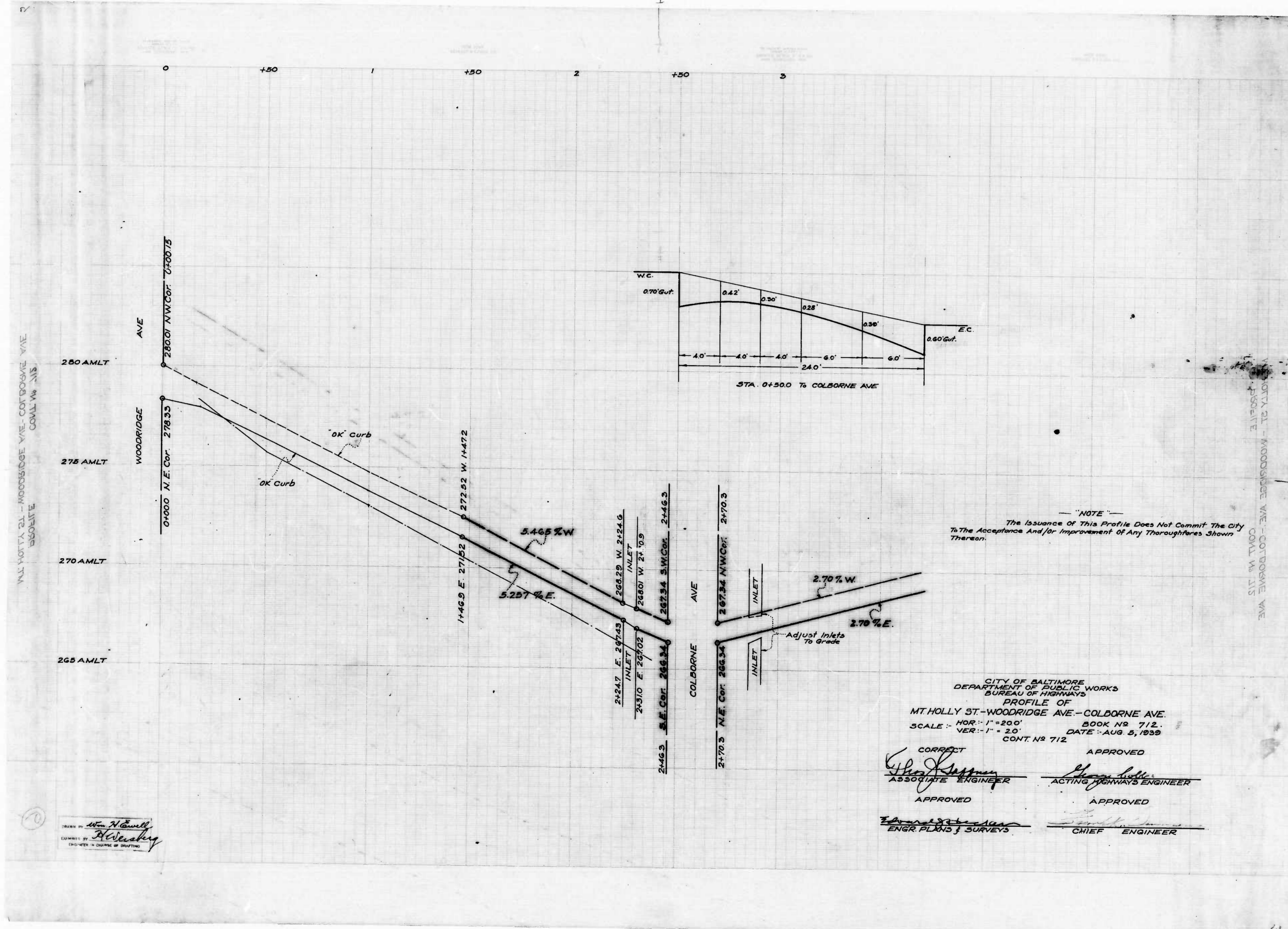

MT HOLLY ST - WOODRIDGE AVE - COLBORNE AVE
CONV. W. 1/8
ELEVATE

MT HOLLY ST - WOODRIDGE AVE - COLBORNE AVE
CONV. W. 1/8

NOTE
The Issuance Of This Profile Does Not Commit The City
To The Acceptance And/or Improvement Of Any Thoroughfares Shown
Thereon.

CITY OF BALTIMORE
DEPARTMENT OF PUBLIC WORKS
BUREAU OF HIGHWAYS
PROFILE OF
MT HOLLY ST - WOODRIDGE AVE - COLBORNE AVE.
SCALE - HOR: 1" = 20.0' BOOK NO 712
VER: 1" = 2.0' DATE - AUG. 5, 1939
CONT. NO 712

CORRECT APPROVED
Edmund J. ... *...*
 ASSOCIATE ENGINEER ACTING HIGHWAYS ENGINEER
 APPROVED APPROVED
Edmund J. ... *...*
 ENGR. PLANS & SURVEYS CHIEF ENGINEER

DRAWN BY *Wm. H. ...*
CHECKED BY *...*
ENGINEER IN CHARGE OF DRAFTING

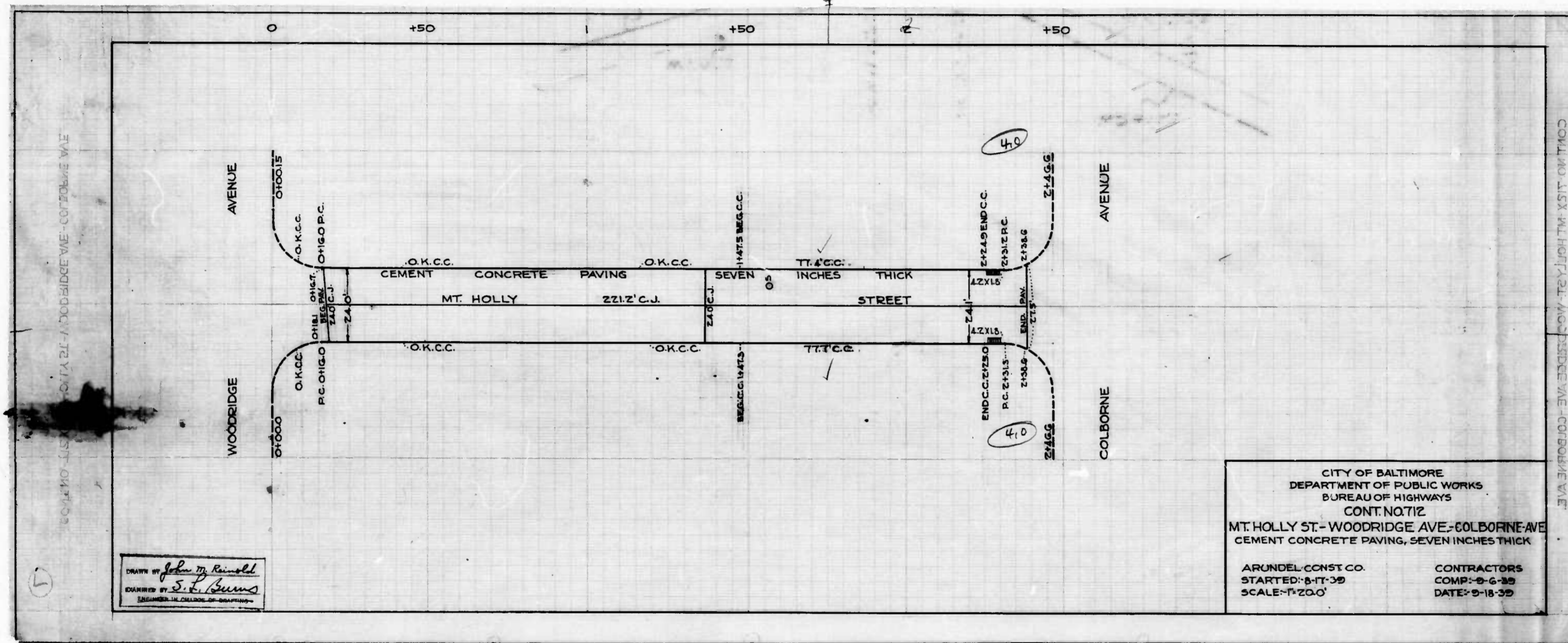

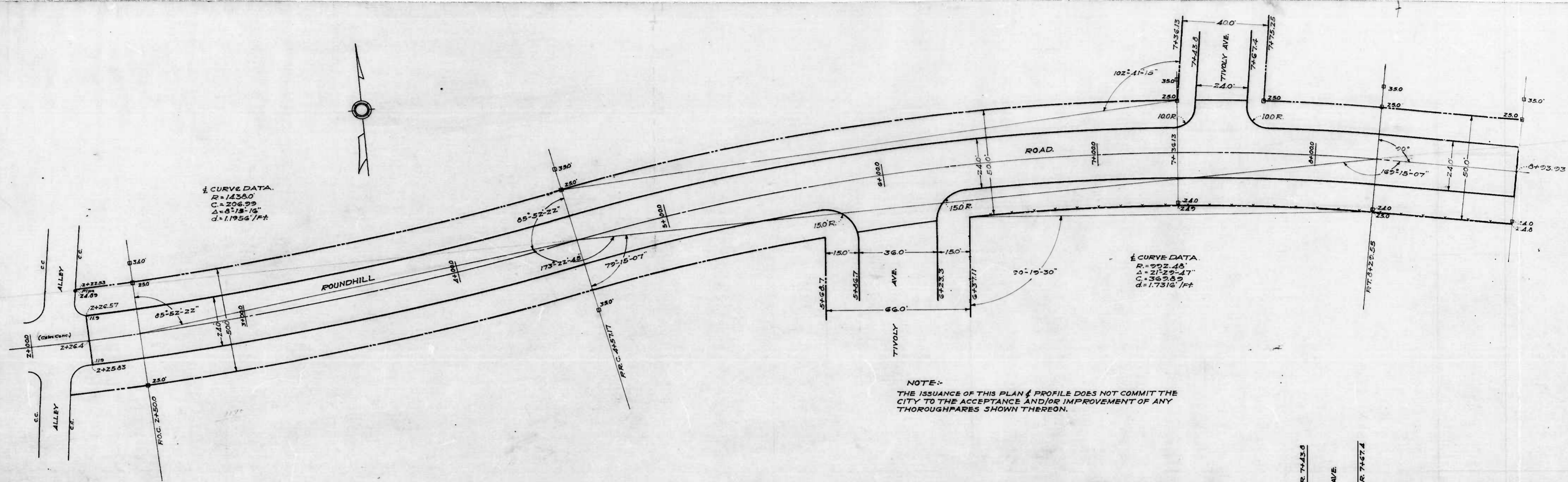

1/2 CURVE DATA
 R = 1436.0
 Δ = 206.95
 Δ = 87.8-16
 d = 1.1956 / ft

1/2 CURVE DATA
 R = 992.48
 Δ = 272.47
 Δ = 36.9-8.9
 d = 1.7316 / ft

NOTE:-
 THE ISSUANCE OF THIS PLAN & PROFILE DOES NOT COMMIT THE CITY TO THE ACCEPTANCE AND/OR IMPROVEMENT OF ANY THOROUGHFARES SHOWN THEREON.

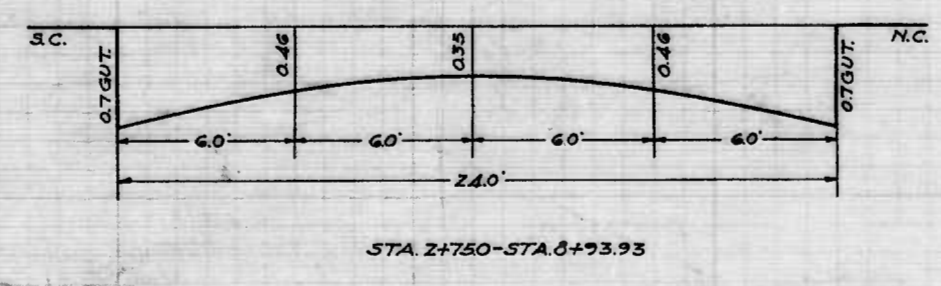
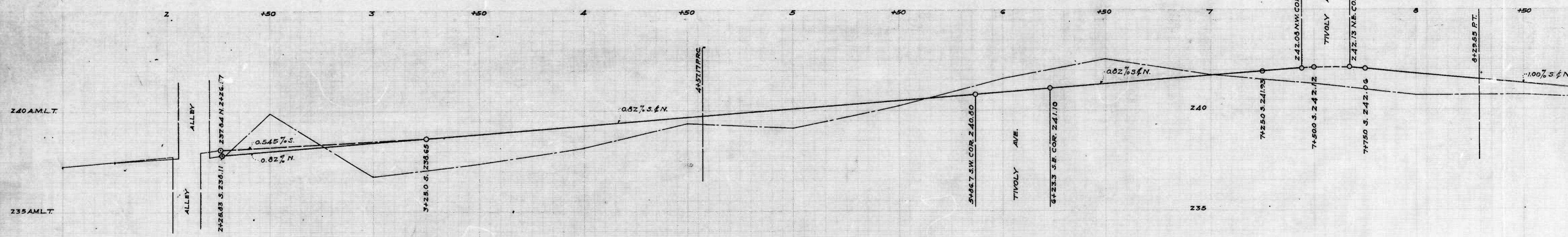

SUBMITTED BY: TOWN OF EASTAD-130 #E LINDA WINE
 COLLAPSE 11

DRAWN BY: P. Merky
 CHECKED BY: H. Weisberg
 ENGINEER IN CHARGE OF DRAFTING

Sheet 1

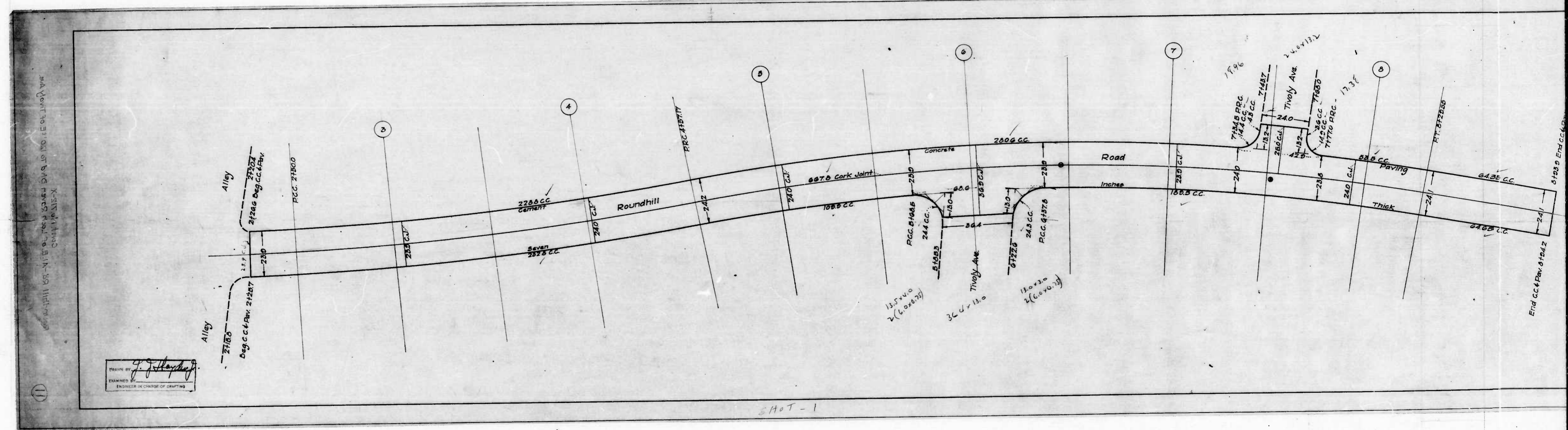

DRAWN BY *J. J. J. J.*
 ENGINEER IN CHARGE OF DRAFTING

S110T-1

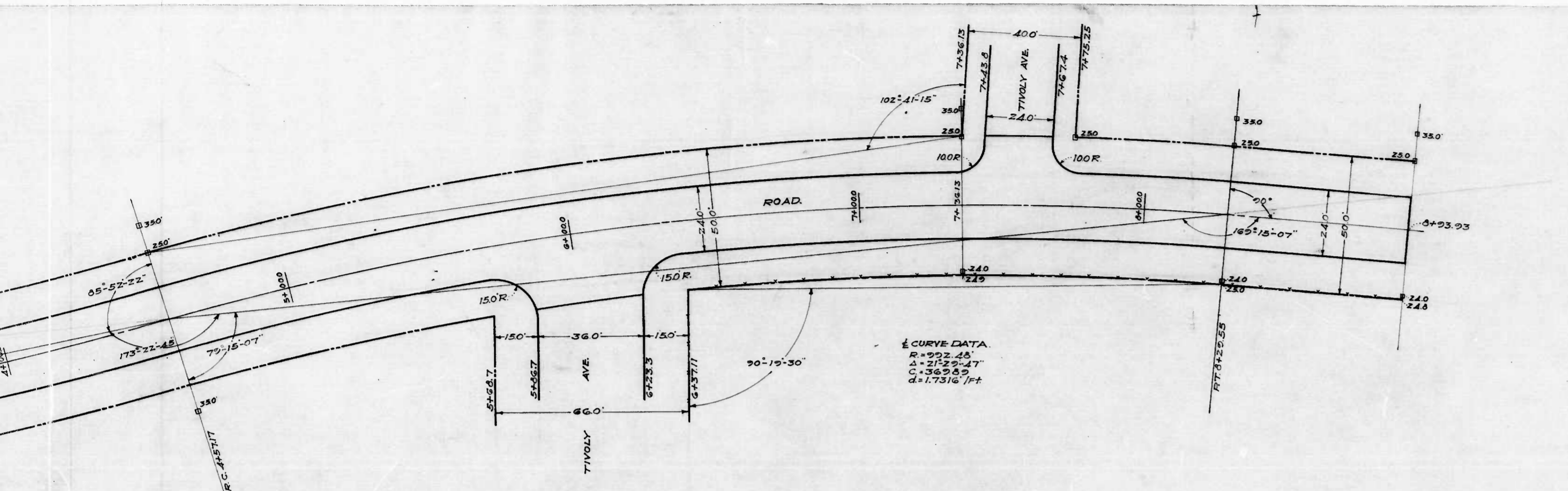

NOTE:-
THE ISSUANCE OF THIS PLAN & PROFILE DOES NOT COMMIT THE CITY TO THE ACCEPTANCE AND/OR IMPROVEMENT OF ANY THOROUGHFARES SHOWN THEREON.

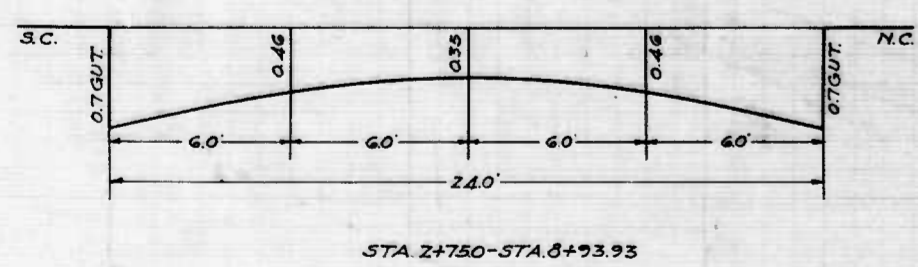
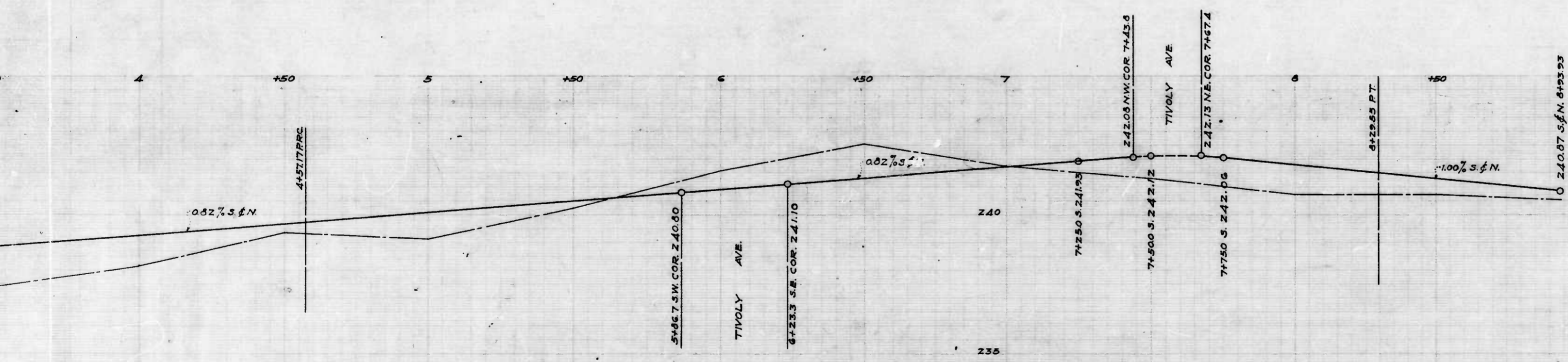

CITY OF BALTIMORE
DEPARTMENT OF PUBLIC WORKS
BUREAU OF HIGHWAYS
PLAN & PROFILE
ROUNDHILL RD-AL.E. LOCH RAVEN BLVD.-120± E. TIVOLY AVE.
CONT. No. 712

Scales - Plan - 1"=20.0'
Profile - Hor. - 1"=200'
Ver. - 1"=2.0'
Aug 21, 1939
Book-X-127-Page-24

Approved:-
[Signature] Chief Engineer.
[Signature] Engin. Plans & Surveys.
 Location Approved:-
[Signature] Associate Engineer.
 Correct:-
[Signature]
 Approved:-
[Signature] Highway Engineer - Acting

Sheet 1

Sheet 2

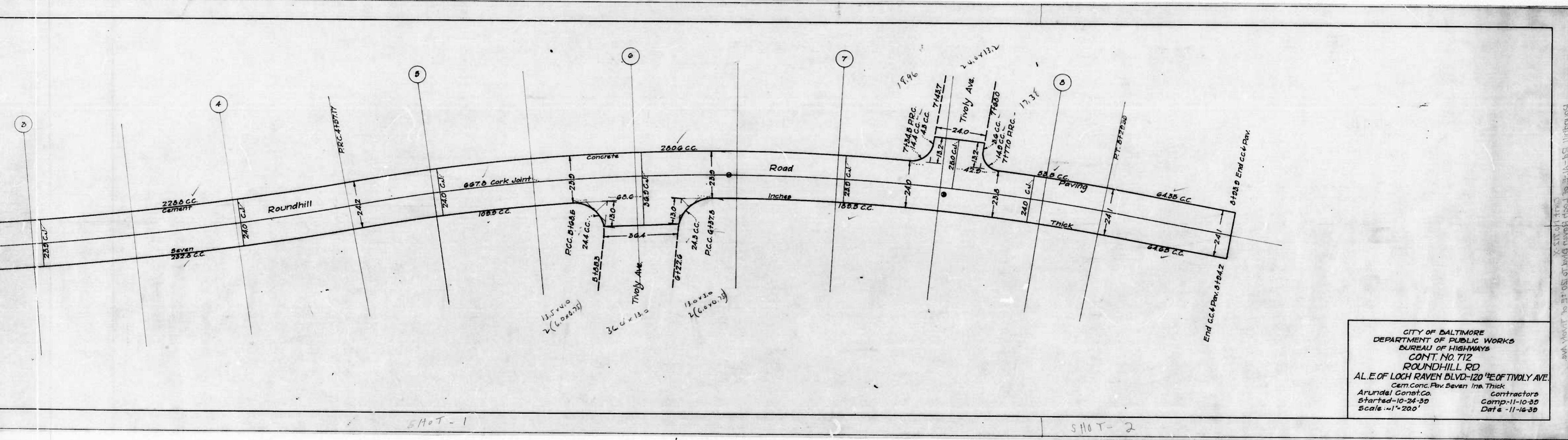

CITY OF BALTIMORE
 DEPARTMENT OF PUBLIC WORKS
 BUREAU OF HIGHWAYS
 CONT. NO. 712
 ROUNDHILL RD.
 AL. E. OF LOCH RAVEN BLVD-120' E. OF TIVOLY AVE.
 Cem Conc. Pav. Seven In. Thick
 Arundel Const. Co. Contractors
 Started-10-24-30 Comp-11-10-30
 Scale-1/4" = 1'-0"

5110 T - 1

5110 T - 2

Vertical text on the right edge of the drawing area, possibly a scale or reference note.

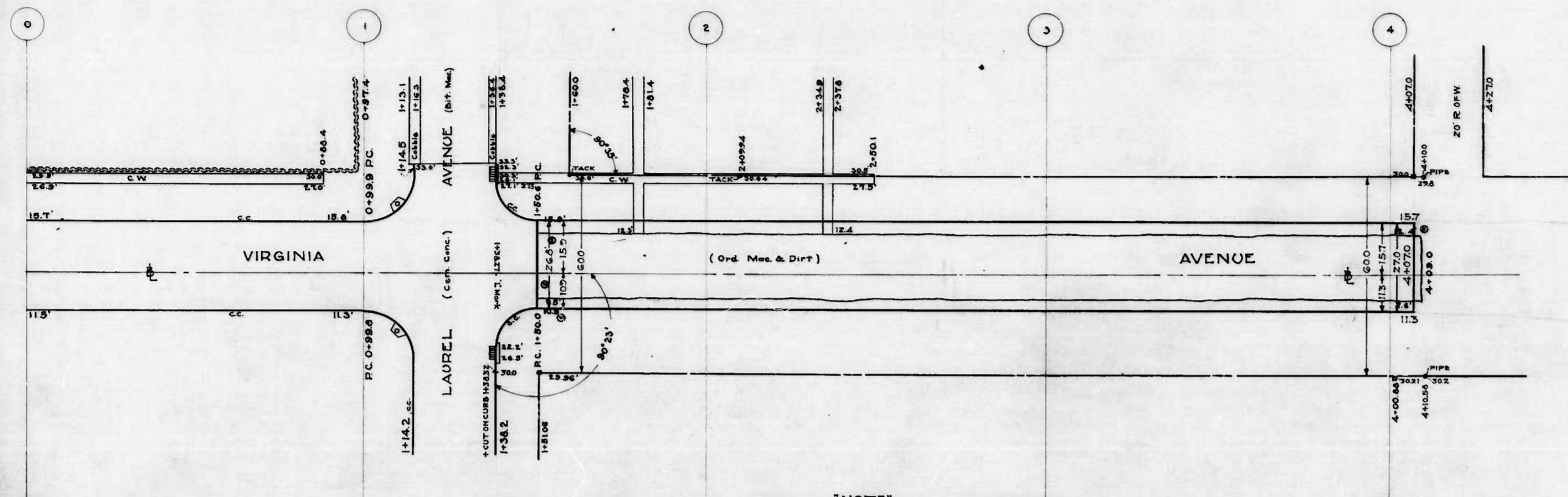

"NOTE"
 THE ISSUANCE OF THIS PLAN & PROFILE DOES NOT COMMIT THE CITY TO THE ACCEPTANCE AND/OR IMPROVEMENT OF ANY THOROUGHFARES SHOWN THEREON.

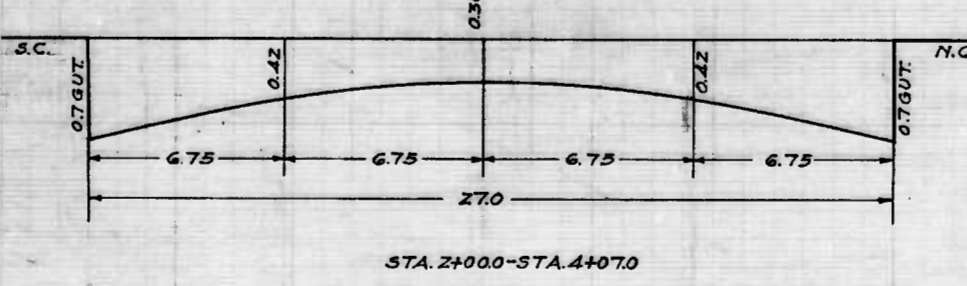
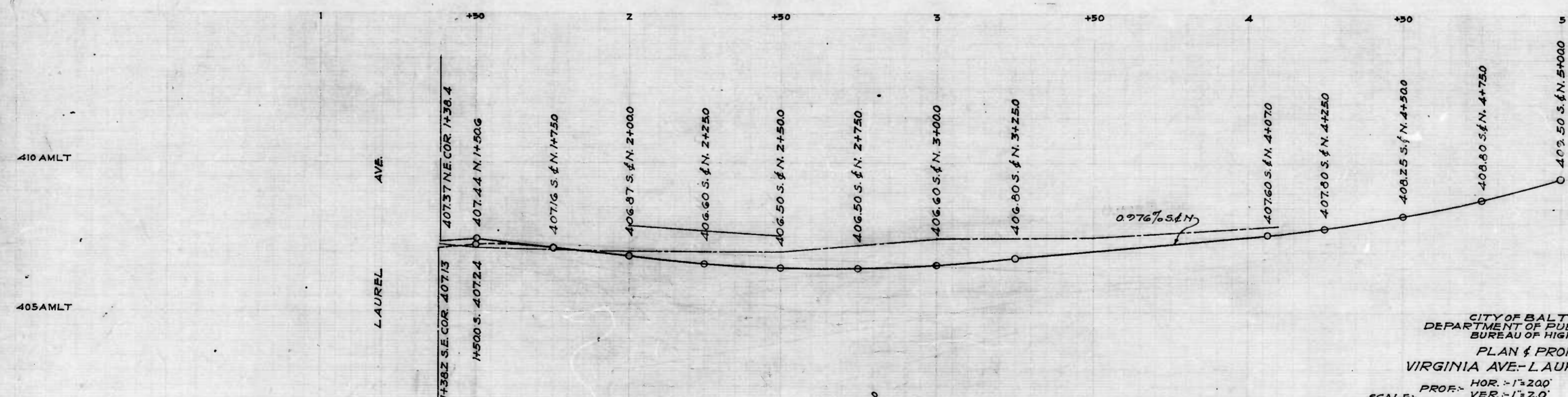

CITY OF BALTIMORE
 DEPARTMENT OF PUBLIC WORKS
 BUREAU OF HIGHWAYS
 PLAN & PROFILE
 VIRGINIA AVE - LAUREL AVE - 250'± E.
 HOR. - 1" = 200'
 VER. - 1" = 20'
 PLAN - 1" = 200'
 DATE - SEPT. 6, 1939
 CONT. No. 712

CORRECT
John J. Haffey
 ASSOCIATE ENGINEER
 APPROVED

APPROVED
George A. Lantz
 HIGHWAYS ENGINEER
 APPROVED

Edward H. Keenan
 ENGR. PLANS & SURVEYS.

Charles W. ...
 CHIEF ENGINEER.

D. Morley
 DRAWN BY
H. W. ...

SITE OF THE ...
 ...
 ...

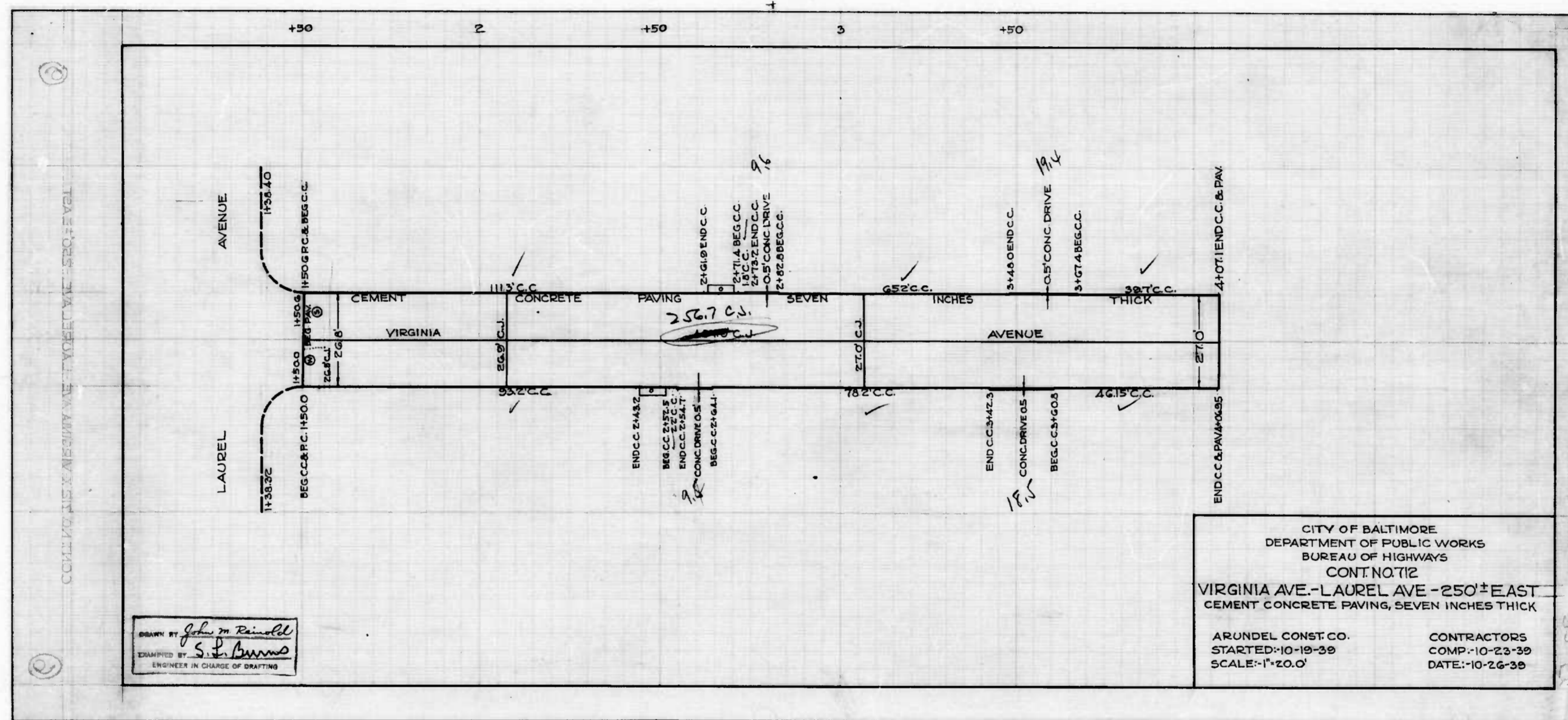

DRAWN BY *John W. Russell*
 SUPERVISED BY *S. J. Burns*
 ENGINEER IN CHARGE OF DRAFTING

CITY OF BALTIMORE
 DEPARTMENT OF PUBLIC WORKS
 BUREAU OF HIGHWAYS
 CONT. NO. 712
 VIRGINIA AVE.-LAUREL AVE - 250'± EAST
 CEMENT CONCRETE PAVING, SEVEN INCHES THICK
 ARUNDEL CONST. CO. CONTRACTORS
 STARTED-10-19-38 COMP.-10-23-38
 SCALE-1"=20.0' DATE-10-26-38