

CONC DRIVE
010200
010975
013530
013535
013540
013545
013550
013555
013560
013565
013570
013575
013580
013585
013590
013595
013600
013605
013610
013615
013620
013625
013630
013635
013640
013645
013650
013655
013660
013665
013670
013675
013680
013685
013690
013695
013700
013705
013710
013715
013720
013725
013730
013735
013740
013745
013750
013755
013760
013765
013770
013775
013780
013785
013790
013795
013800
013805
013810
013815
013820
013825
013830
013835
013840
013845
013850
013855
013860
013865
013870
013875
013880
013885
013890
013895
013900
013905
013910
013915
013920
013925
013930
013935
013940
013945
013950
013955
013960
013965
013970
013975
013980
013985
013990
013995
014000

PLANETARY MAP - DISTRICT OF COLUMBIA
RECORDED BY - SURVEY MAPS & RECORDS DIVISION
CONTRACT NO. 100

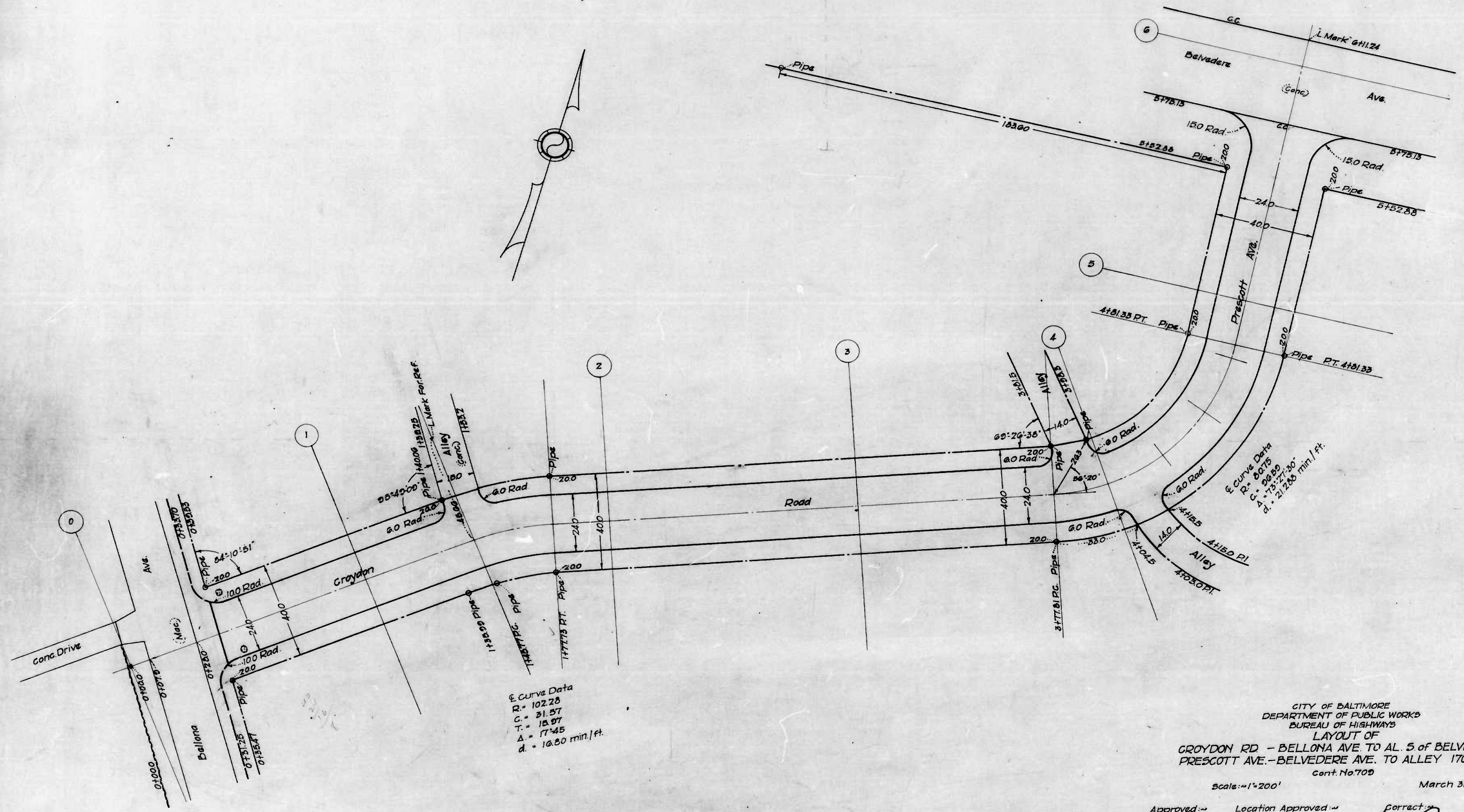

Curve Data
 R = 102.28
 C = 31.57
 T = 15.97
 Δ = 17°45'
 d = 16.80 min./ft.

CITY OF BALTIMORE
 DEPARTMENT OF PUBLIC WORKS
 BUREAU OF HIGHWAYS
 LAYOUT OF
 GROYDON RD - BELLONA AVE TO AL. S of BELVEDERE AVE.
 PRESCOTT AVE - BELVEDERE AVE. TO ALLEY 170'± SOUTH
 cont. No 709

Scale - 1" = 200' March 31, 1959

Approved - [Signature] Location Approved - [Signature] Contract - [Signature] Approved - [Signature]
 Chief Engineer - Engr. Plans & Surveys Associate Engineer - Highways Engineer

Note - The issuance of this plan does not commit the City to the acceptance and/or improvement of any thoroughfares shown thereon.

DRAWN BY: J. J. Handberg
 EXAMINED BY: H. Weisberg
 ENGINEER IN CHARGE OF DRAFTING

Sheet 1

34-54

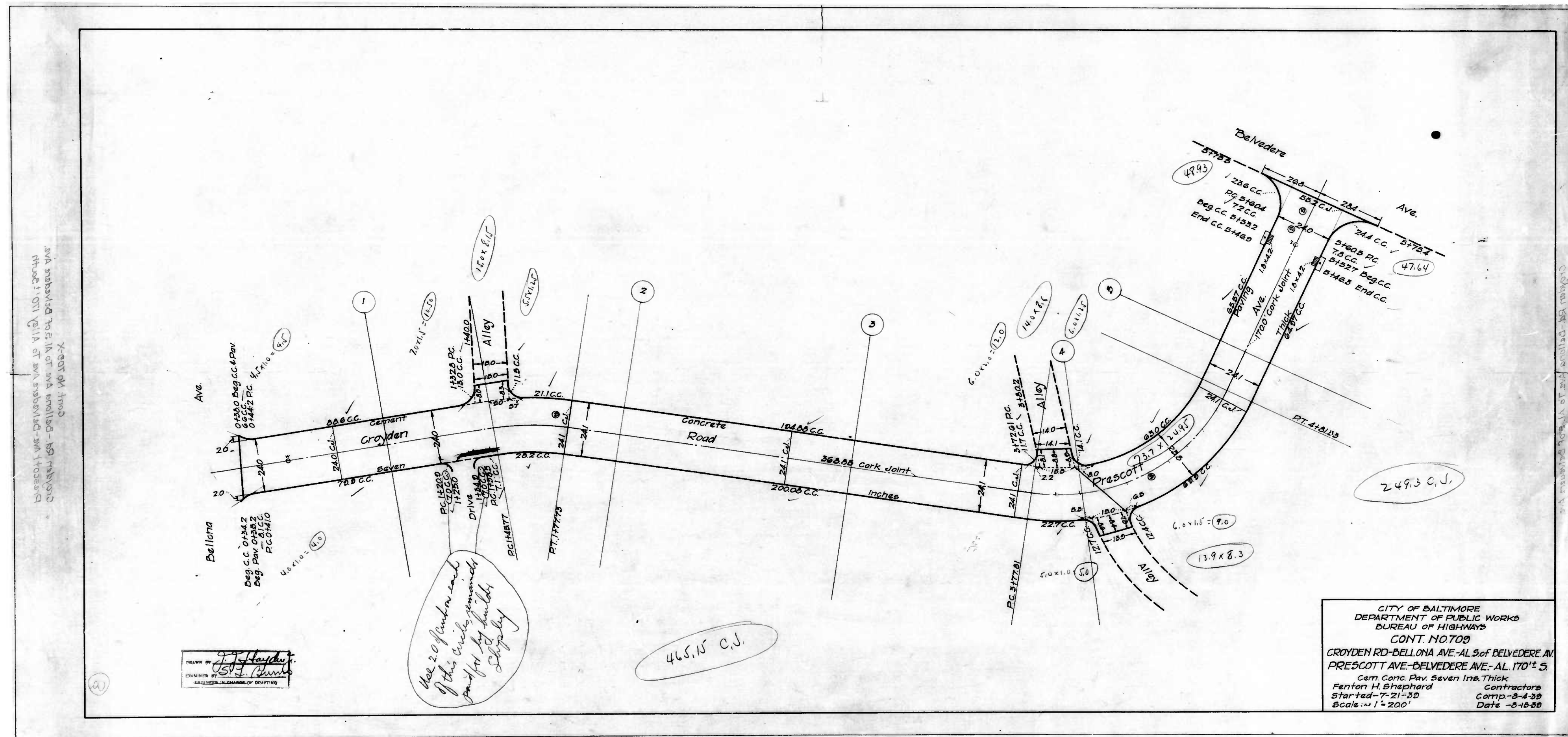

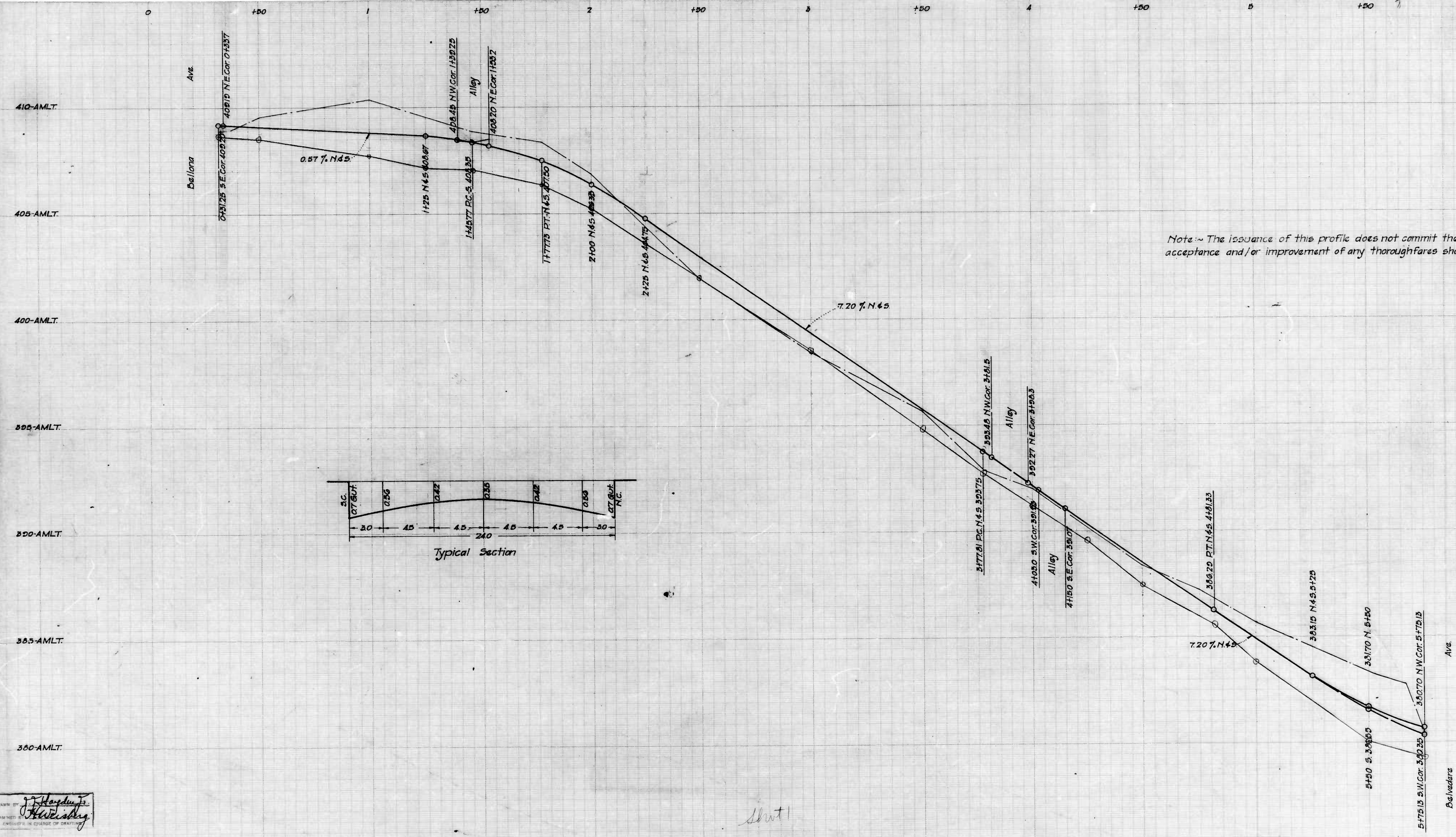

Note: The issuance of this profile does not commit the City to the acceptance and/or improvement of any thoroughfares shown thereon.

DRAWN BY: *J. H. H. H.*
 ENGINEER IN CHARGE OF DRAFTING

Sheet 1

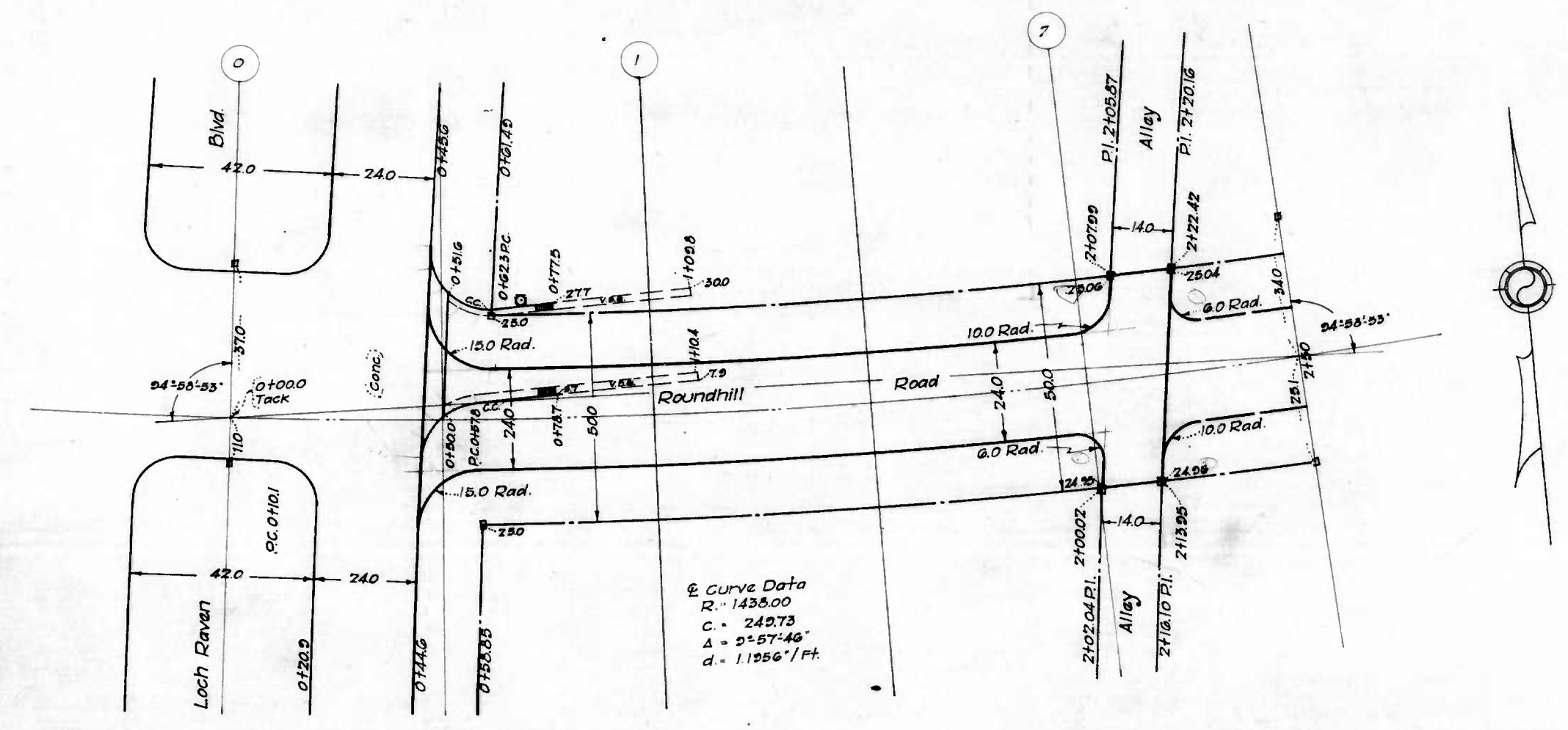

Note: - The issuance of this plan & profile does not commit the City to the acceptance and/or improvement of any thoroughfares shown thereon.

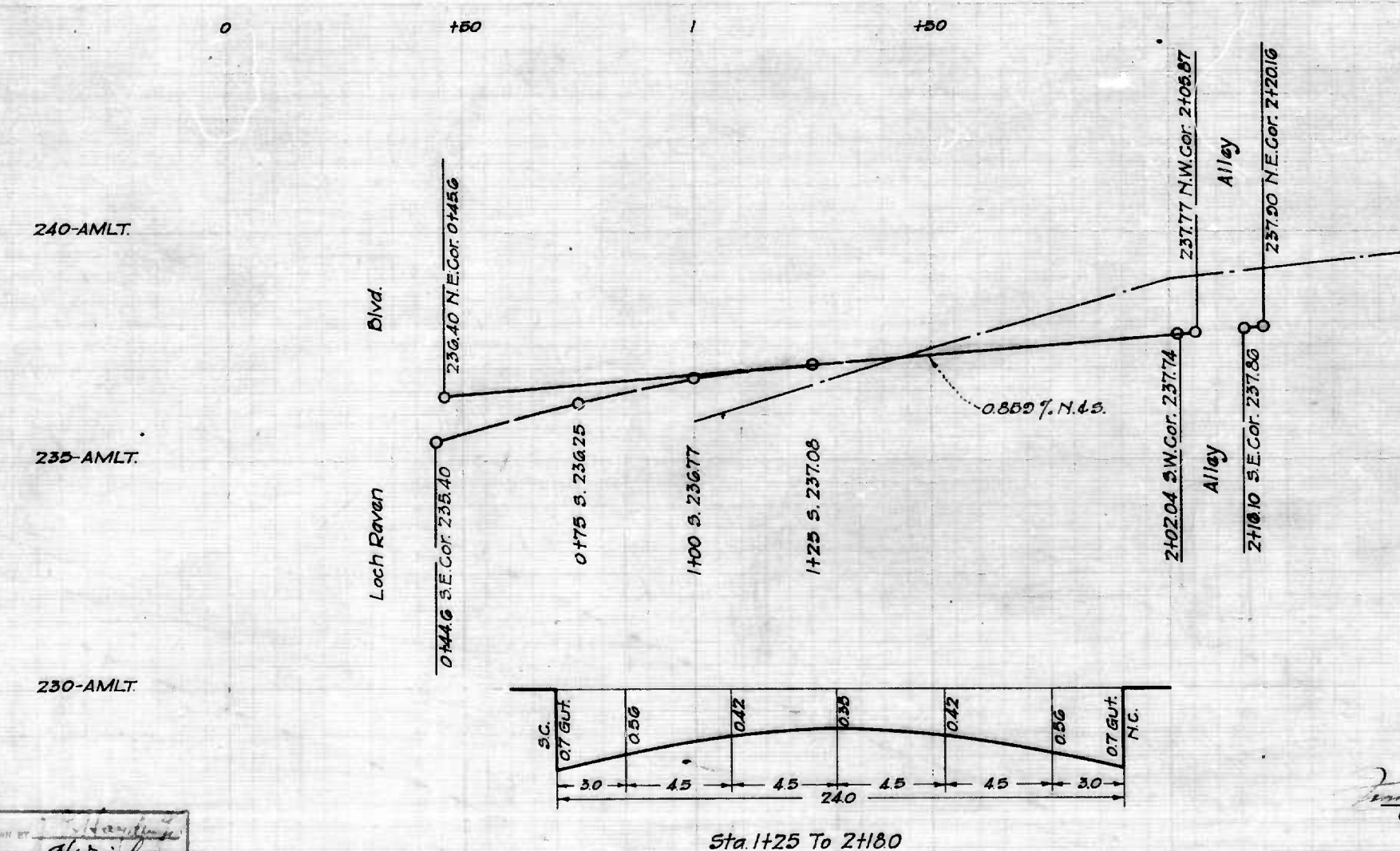

CITY OF BALTIMORE
 DEPARTMENT OF PUBLIC WORKS
 BUREAU OF HIGHWAYS
 PLAN & PROFILE
 ROUNDHILL RD. - LOCH RAVEN BLVD TO ALLEY 160' EAST
 Cont. No. 709
 Scale: - Plan - 1" = 200'
 Profile - Hor. - 1" = 200'
 Ver. - 1" = 20'
 April 17, 1939
 Book - X-118 - Page - 71

Approved: _____ Location Approved: _____ Correct: _____ Approved: _____
 Chief Engineer Engr. - Plans & Surveys Associate Engineer Highways Engineer

Huttenberg

Sta 1+25 To 21+80

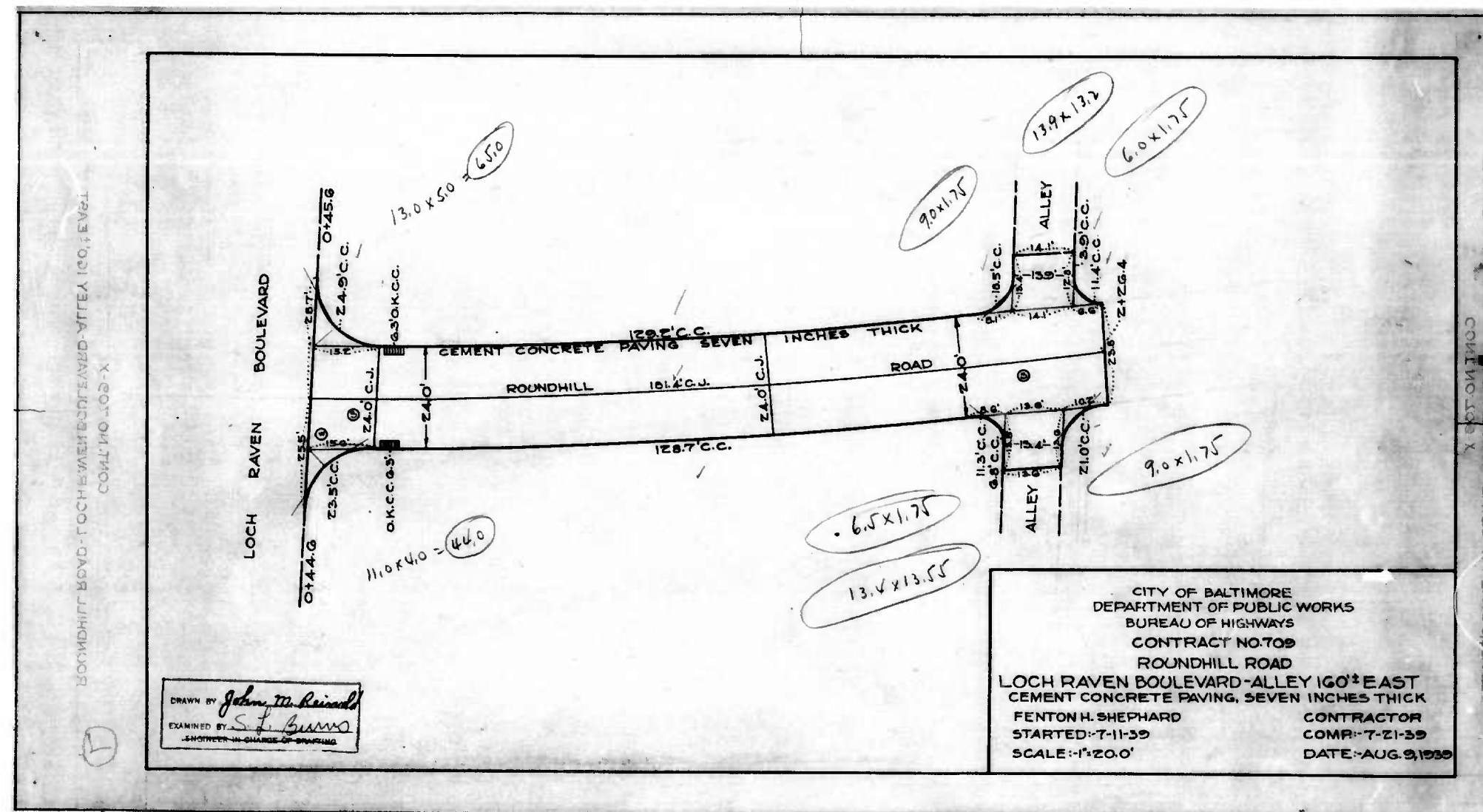

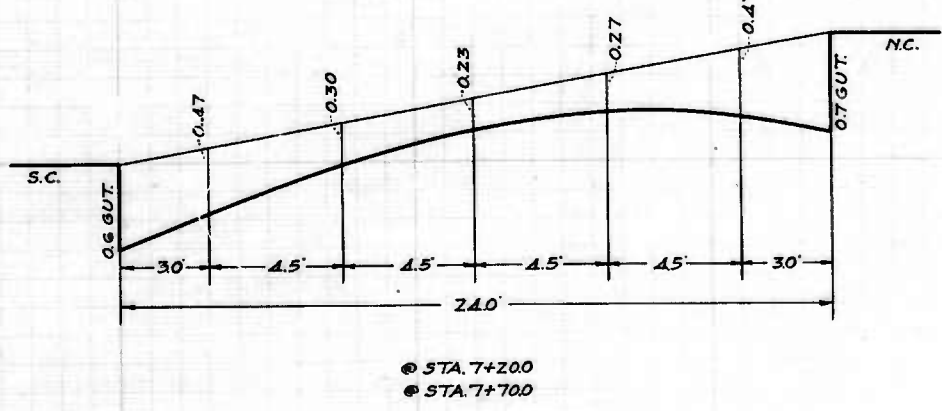
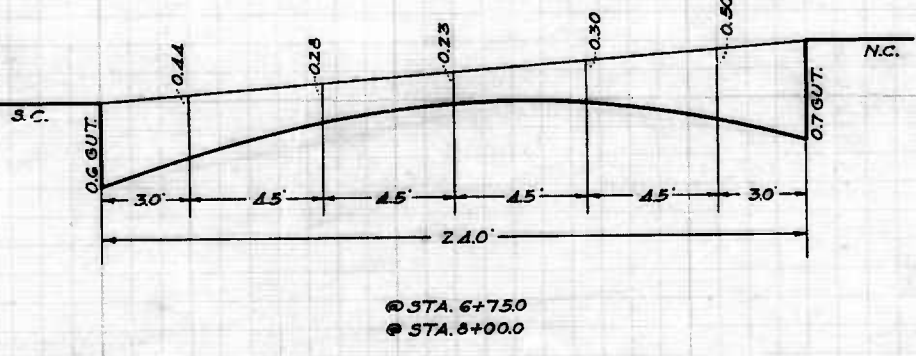
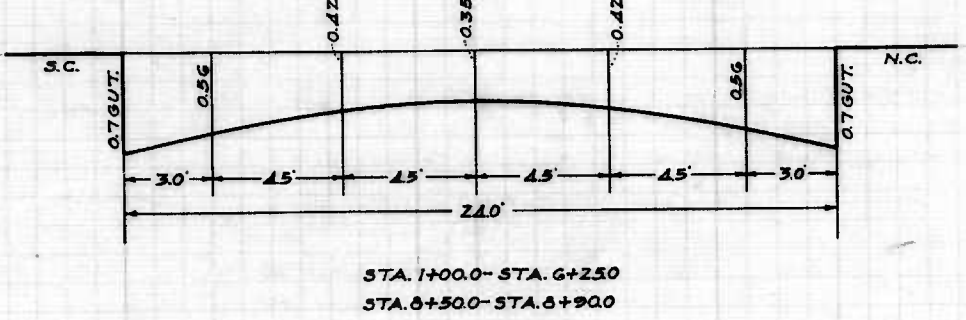
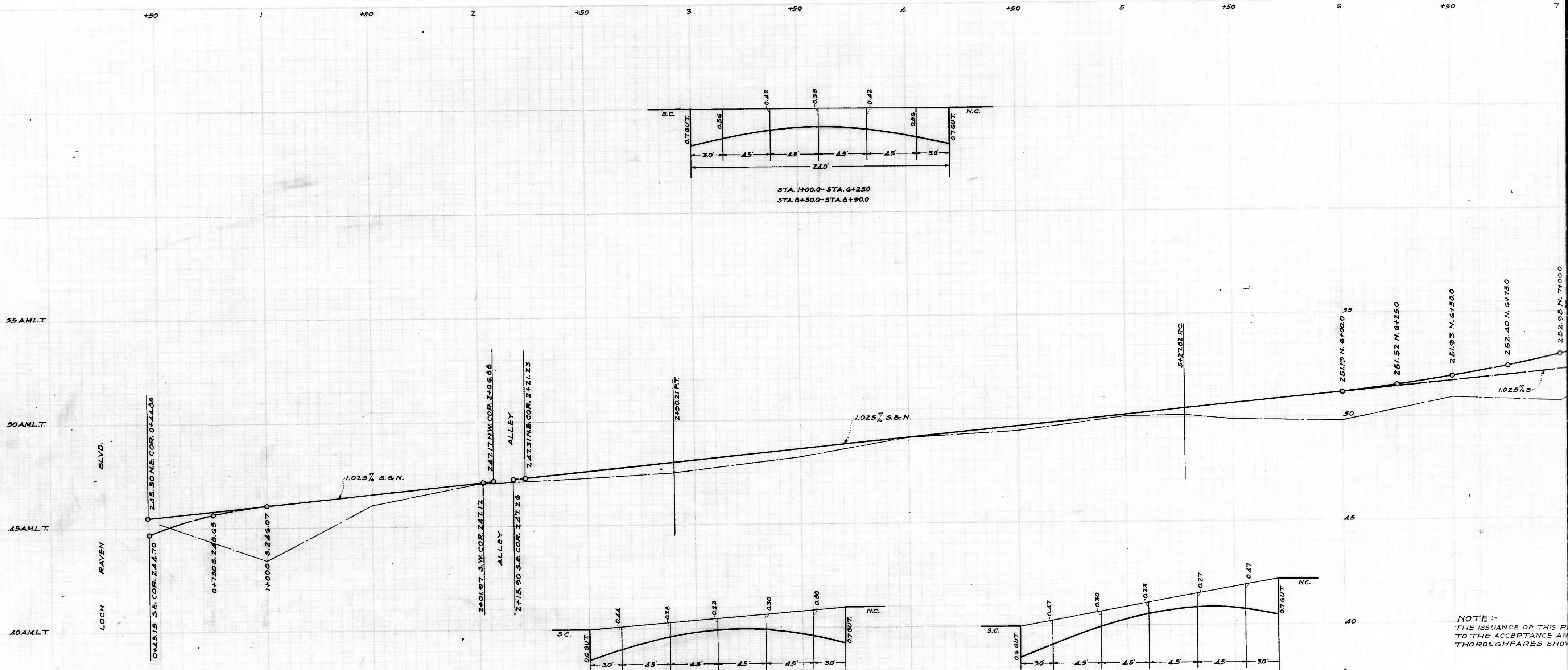

NOTE:
THE ISSUANCE OF THIS P
TO THE ACCEPTANCE AN
THOROLGHFARES SHOV

D. Marley
Husenby

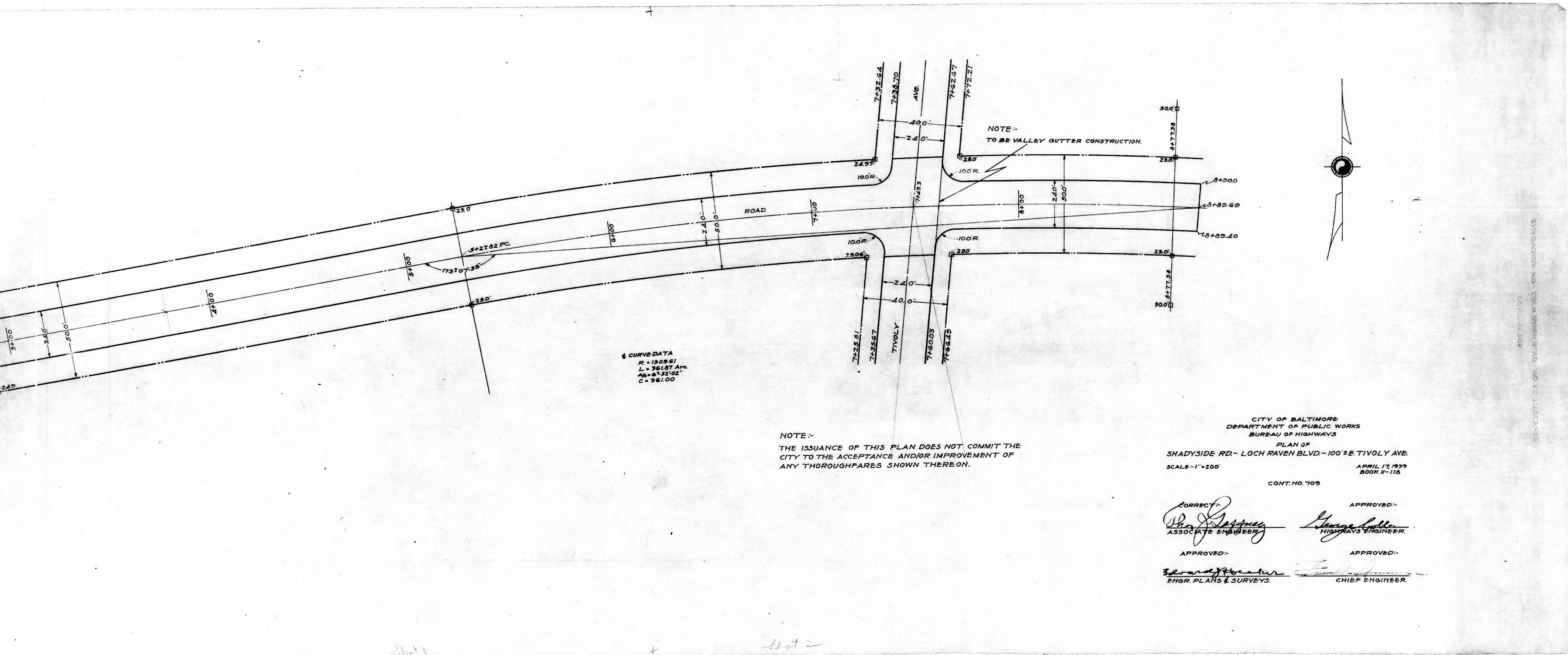

CURVE DATA
 R = 1909.61
 L = 561.87 Arc.
 Δ = 6° 32' 02"
 C = 361.00

NOTE:-
 THE ISSUANCE OF THIS PLAN DOES NOT COMMIT THE
 CITY TO THE ACCEPTANCE AND/OR IMPROVEMENT OF
 ANY THOROUGHFARES SHOWN THEREON.

NOTE:-
 TO BE VALLEY GUTTER CONSTRUCTION.



CITY OF BALTIMORE
 DEPARTMENT OF PUBLIC WORKS
 BUREAU OF HIGHWAYS
 PLAN OF
 SHADYSIDE RD - LOCH RAVEN BLVD - 100 ± E. TIVOLY AVE.
 SCALE: 1" = 200' APRIL 17, 1939
 BOOK X-116
 CONT. NO. 709

CORRECTED:
[Signature]
 ASSOCIATE ENGINEER

APPROVED:-
[Signature]
 HIGHWAYS ENGINEER

APPROVED:-
[Signature]
 ENGR. PLANS & SURVEYS

APPROVED:-
[Signature]
 CHIEF ENGINEER

807-111100
 807-111100

