

Sheet 1

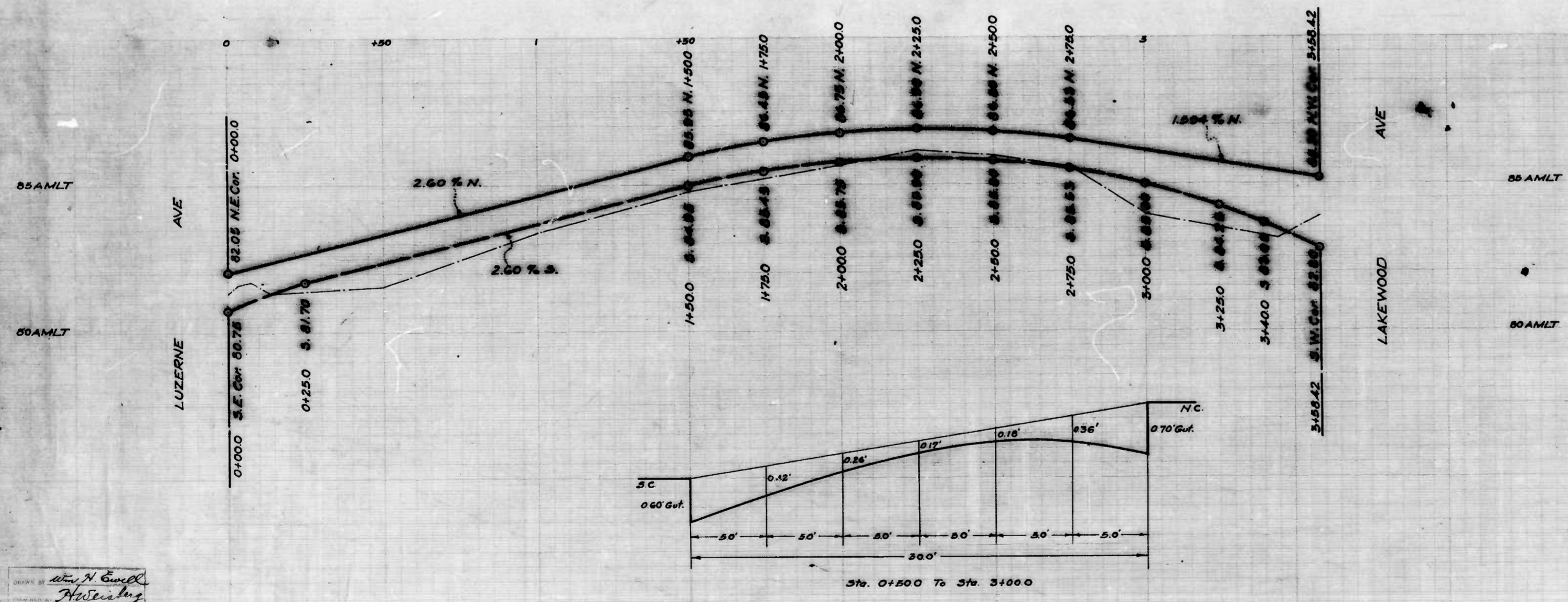
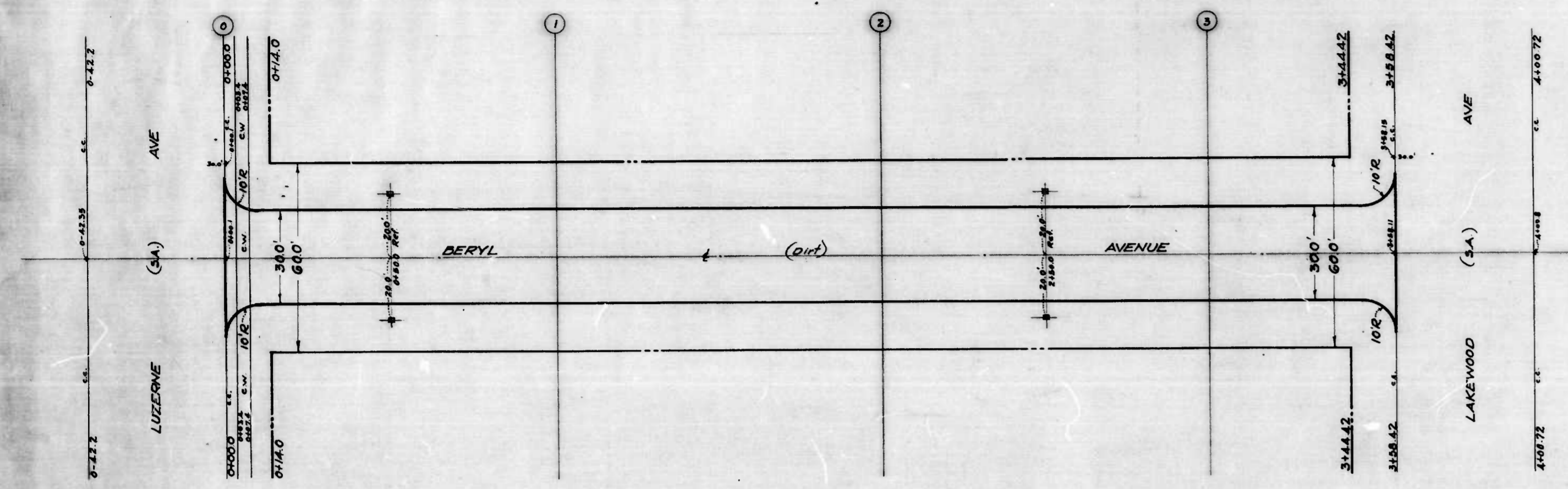

"NOTE"
 The issuance of this Plan & Profile does not commit the City to the acceptance and/or improvement of any thoroughfares shown thereon.

CITY OF BALTIMORE
 DEPARTMENT OF PUBLIC WORKS
 BUREAU OF HIGHWAYS
 PLAN & PROFILE
 BERYL AVE - LUZERNE AVE - LAKEWOOD AVE.
 HOR: 1" = 20.0' BOOK N° X-118
 PROF: VER: 1" = 20' CONT. N° 708
 SCALE: PLAN: 1" = 20.0' DATE: MAR. 23, 1939

CORRECT APPROVED
Edgar A. [Signature] *[Signature]*
 ASSOCIATE ENGINEER HIGHWAYS ENGINEER

APPROVED APPROVED
[Signature] *[Signature]*
 ENGR. PLANS & SURVEYS CHIEF ENGINEER

Drawn by
[Signature]
 Checked by
[Signature]

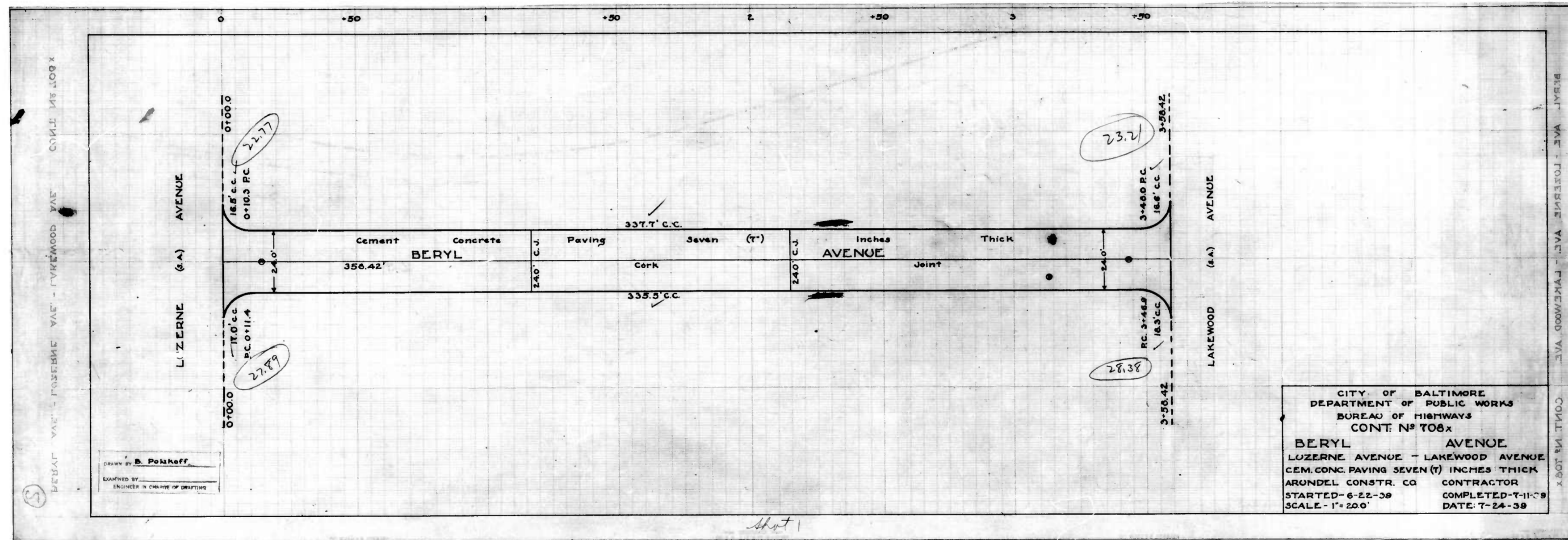

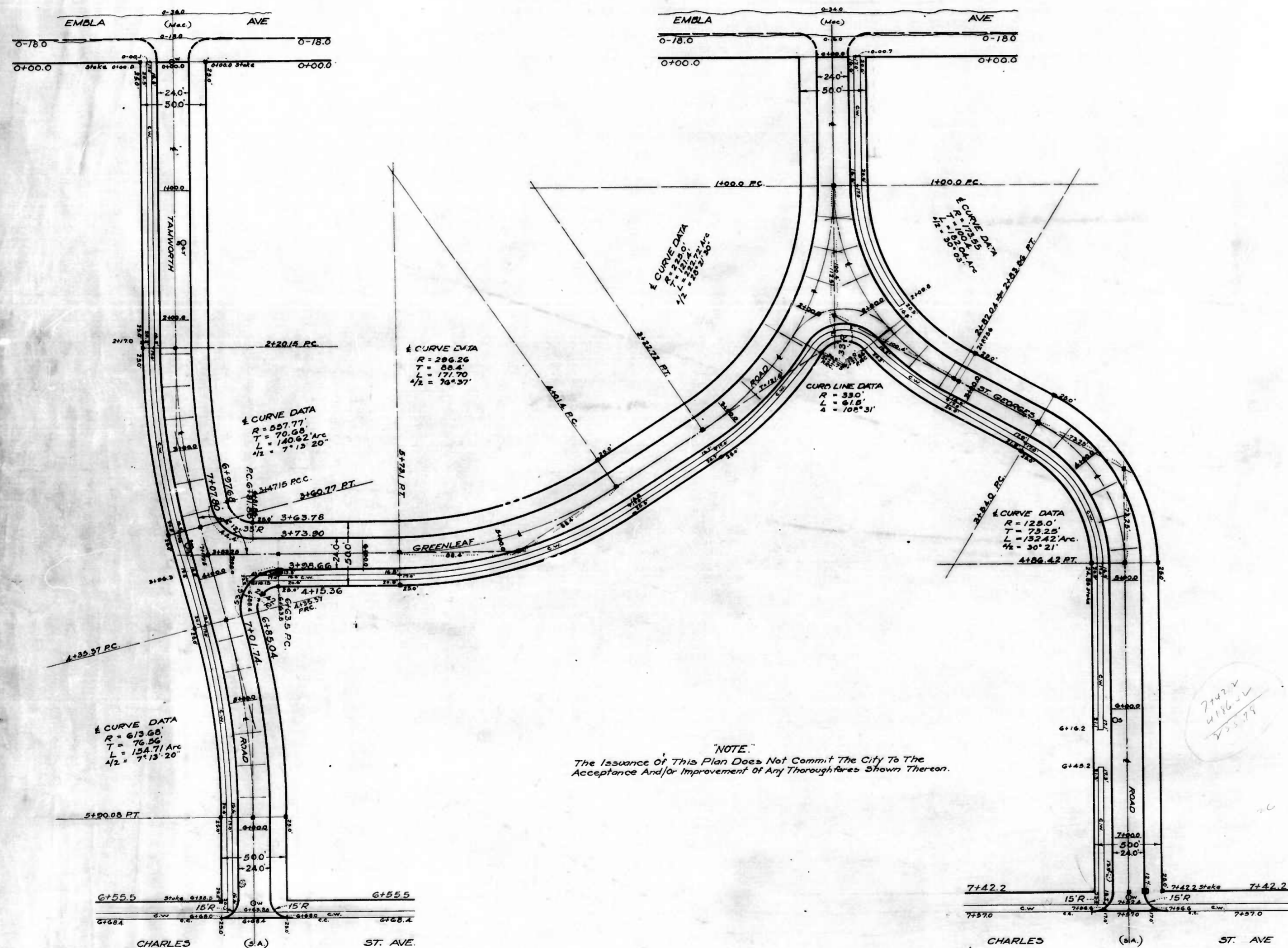

NOTE:
The Issuance Of This Plan Does Not Commit The City To The
Acceptance And/or Improvement Of Any Thoroughfares Shown Thereon.

CITY OF BALTIMORE
DEPARTMENT OF PUBLIC WORKS
BUREAU OF HIGHWAYS
PLAN OF
GREENLEAF RD - EMBLA AVE - TAMWORTH RD
ST. GEORGE'S RD - GREENLEAF RD - CHARLES ST. AVE
TAMWORTH RD - EMBLA AVE - CHARLES ST. AVE
SCALE 1" = 400' BOOK N° C-708
CONT. N° 708

CORRECTED APPROVED
John J. Kappes *George L. ...*
ASSOCIATE ENGINEER HIGHWAYS ENGINEER
APPROVED APPROVED
Thomas ...
ENGR. PLANS & SURVEYS CHIEF ENGINEER

DRAWN BY *Wm. H. ...*
ENGINEER IN CHARGE OF DISTRICT

Sheet 1

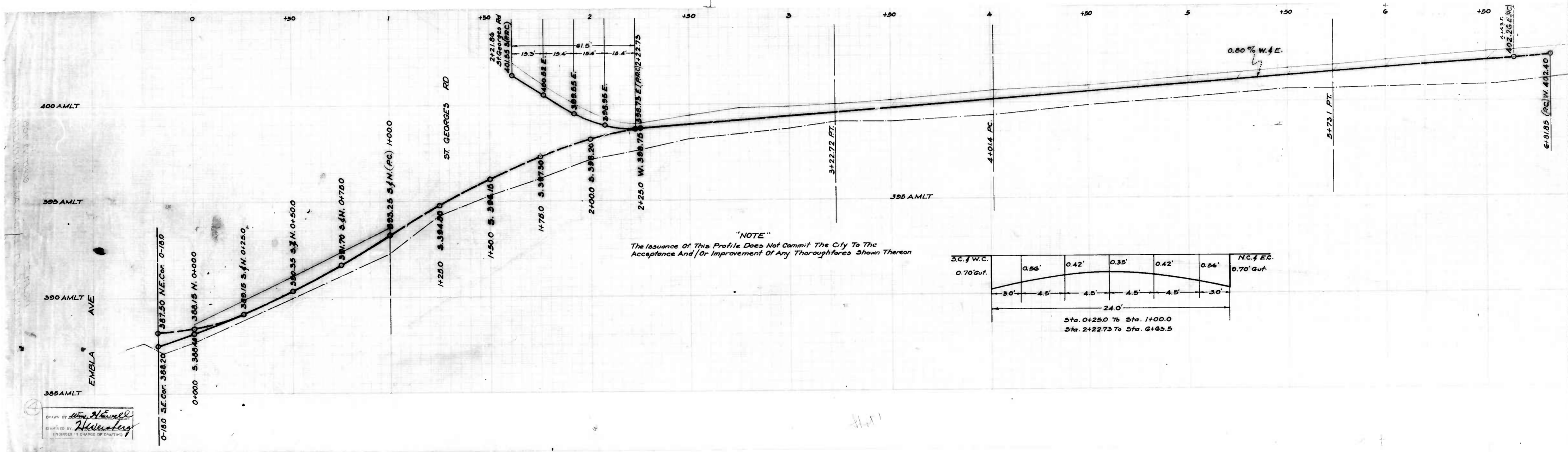

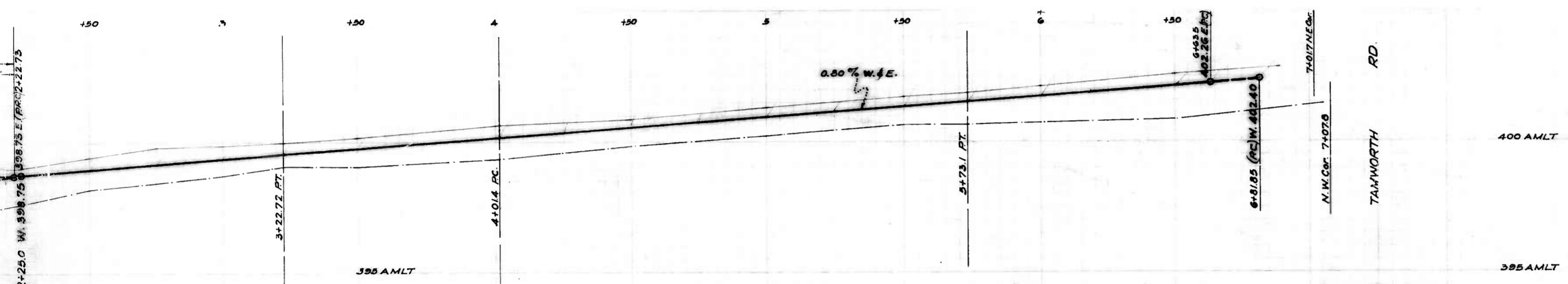

"NOTE"
The issuance of this profile does not commit the City to the acceptance and/or improvement of any thoroughfares shown thereon.

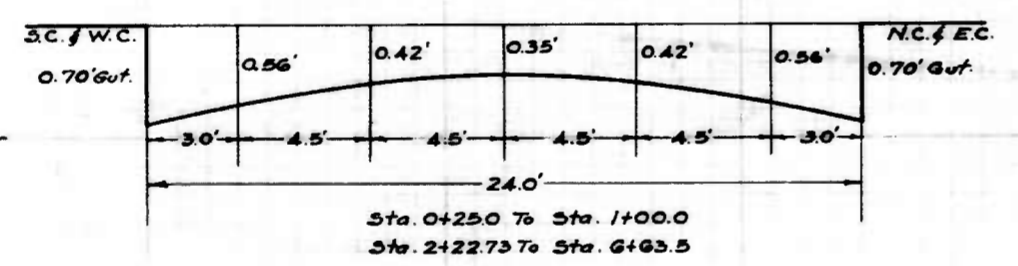

CITY OF BALTIMORE
DEPARTMENT OF PUBLIC WORKS
BUREAU OF HIGHWAYS
PROFILE OF
GREENLEAF RD-EMBLA AVE.- TAMWORTH ROAD
SCALE: HOR: 1" = 200' BOOK NO C-708
VER: 1" = 20' DATE: APRIL 13, 1939
CONT. NO 708

CORRECT APPROVED
Wm. J. Keenan *Harold L. ...*
ASSOCIATE ENGINEER HIGHWAYS ENGINEER
APPROVED APPROVED

Edward ... *...*
ENGR. PLANS & SURVEYS CHIEF ENGINEER

GREENLEAF RD - EMBLA AVE - TAMWORTH RD

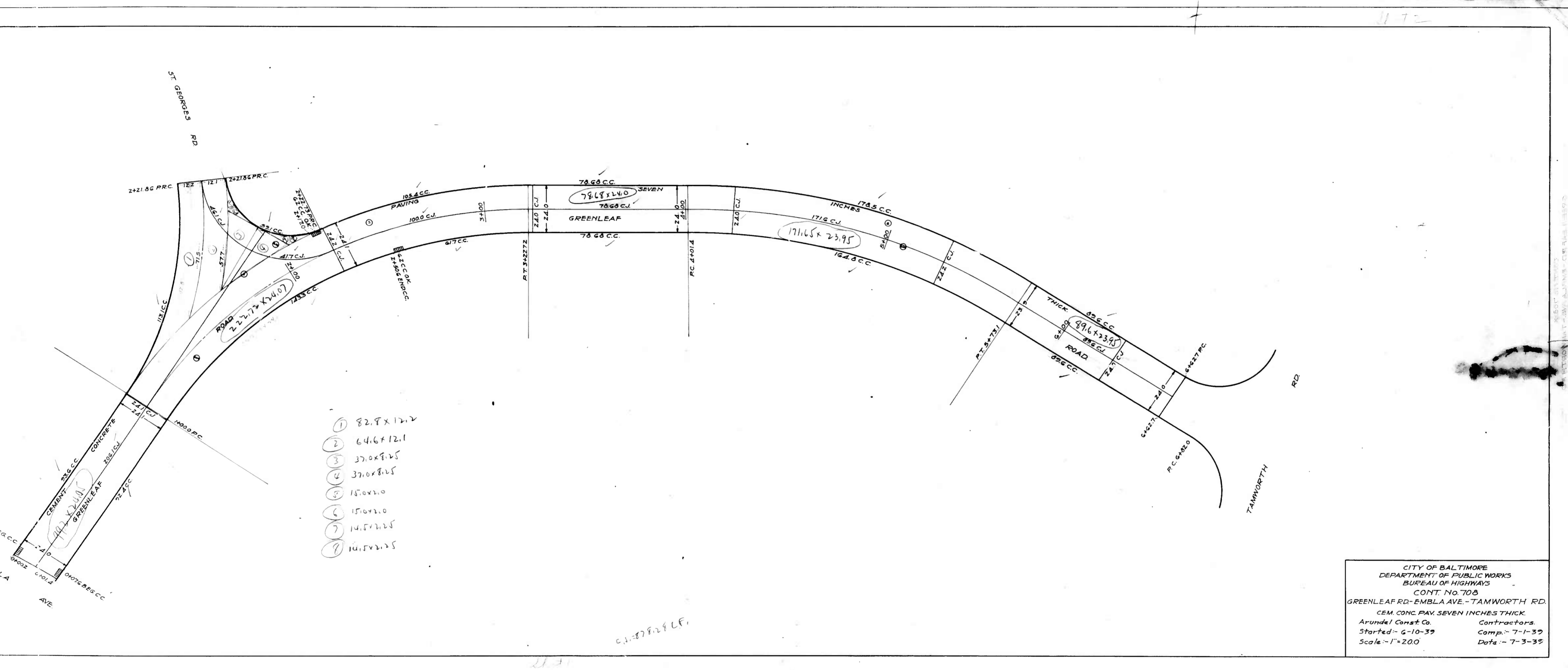

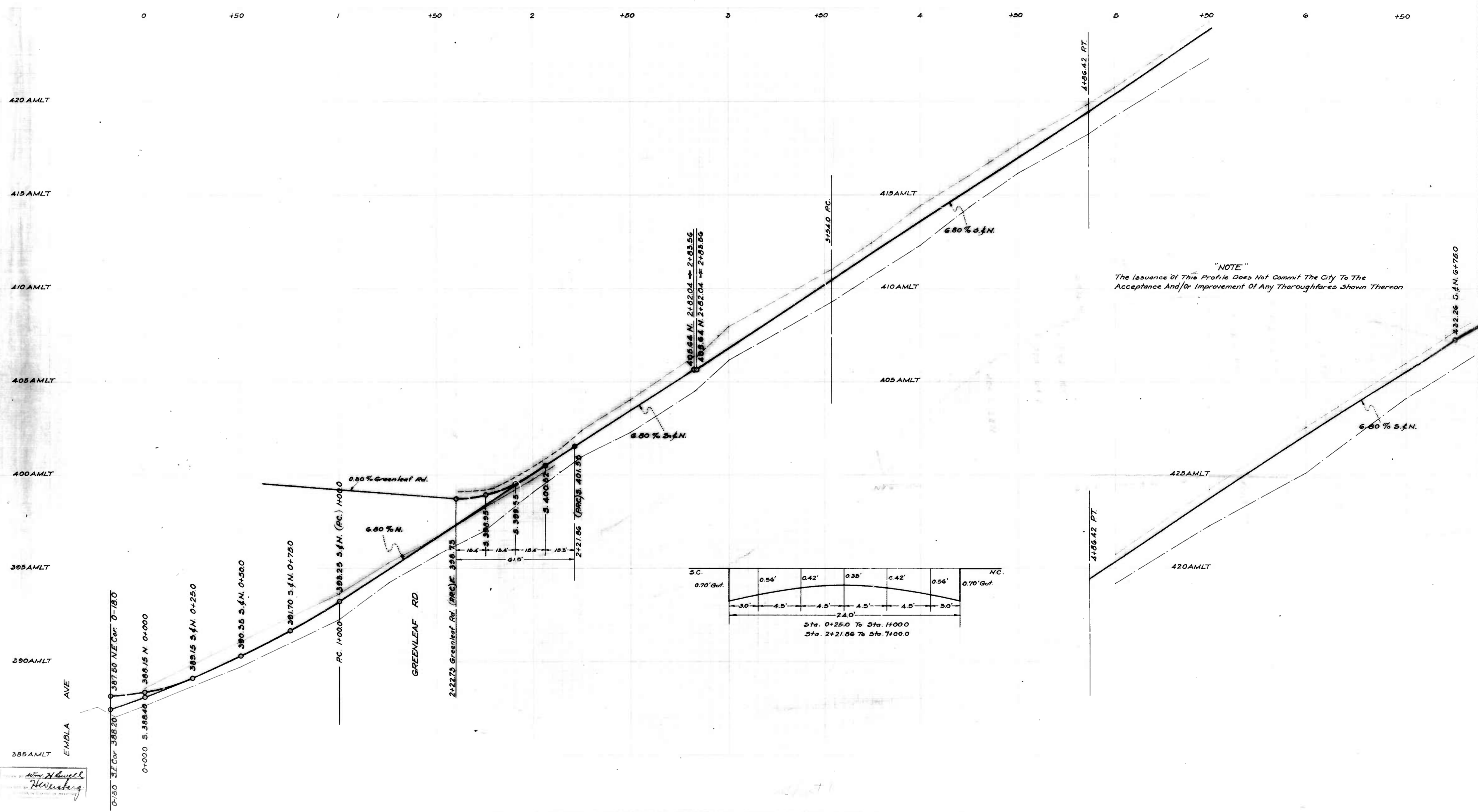

Howard H. Weisberg
 State of Missouri
 No. 10000

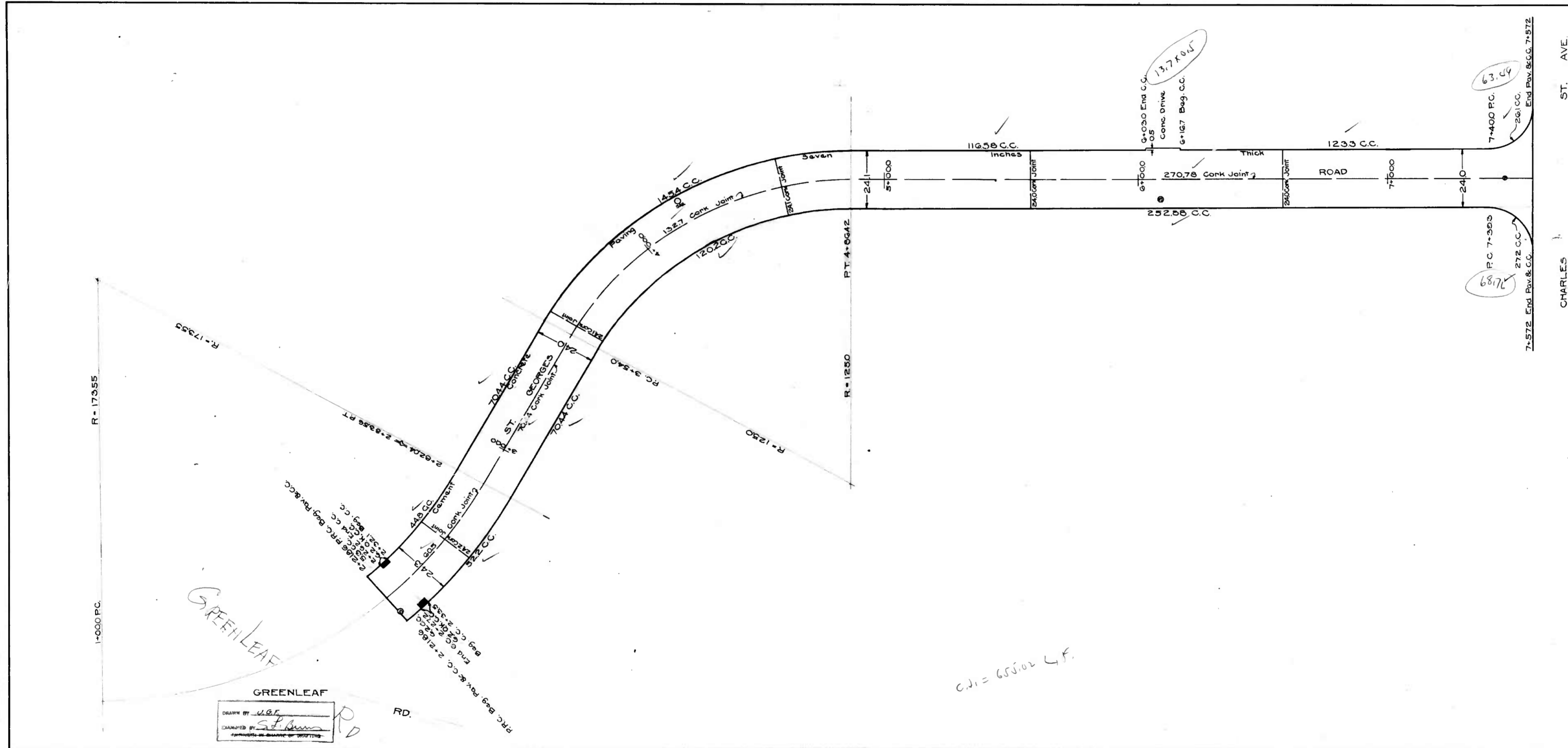

CHARLES ST. AVE

GREENLEAF

GREENLEAF RD.

DESIGNED BY *U.S.F.*

DRAWN BY *[Signature]*

DATE *[Date]*

C.J. = 605.02 LF.

CITY OF BALTIMORE
 DEPARTMENT OF PUBLIC WORKS
 BUREAU OF HIGHWAYS
 CONTRACT NO. 708
 ST. GEORGES RD. - GREENLEAF RD. - CHARLES ST.
 Cement Concrete Paving Seven Inches Thick
 ARUNDEL CONST. CO. CONTRACT
 Started 6-15-39 Completed 7-6-39
 Scale 1"=200' August 3, 1939

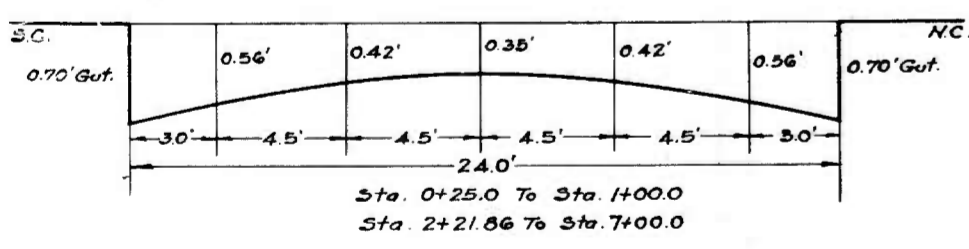
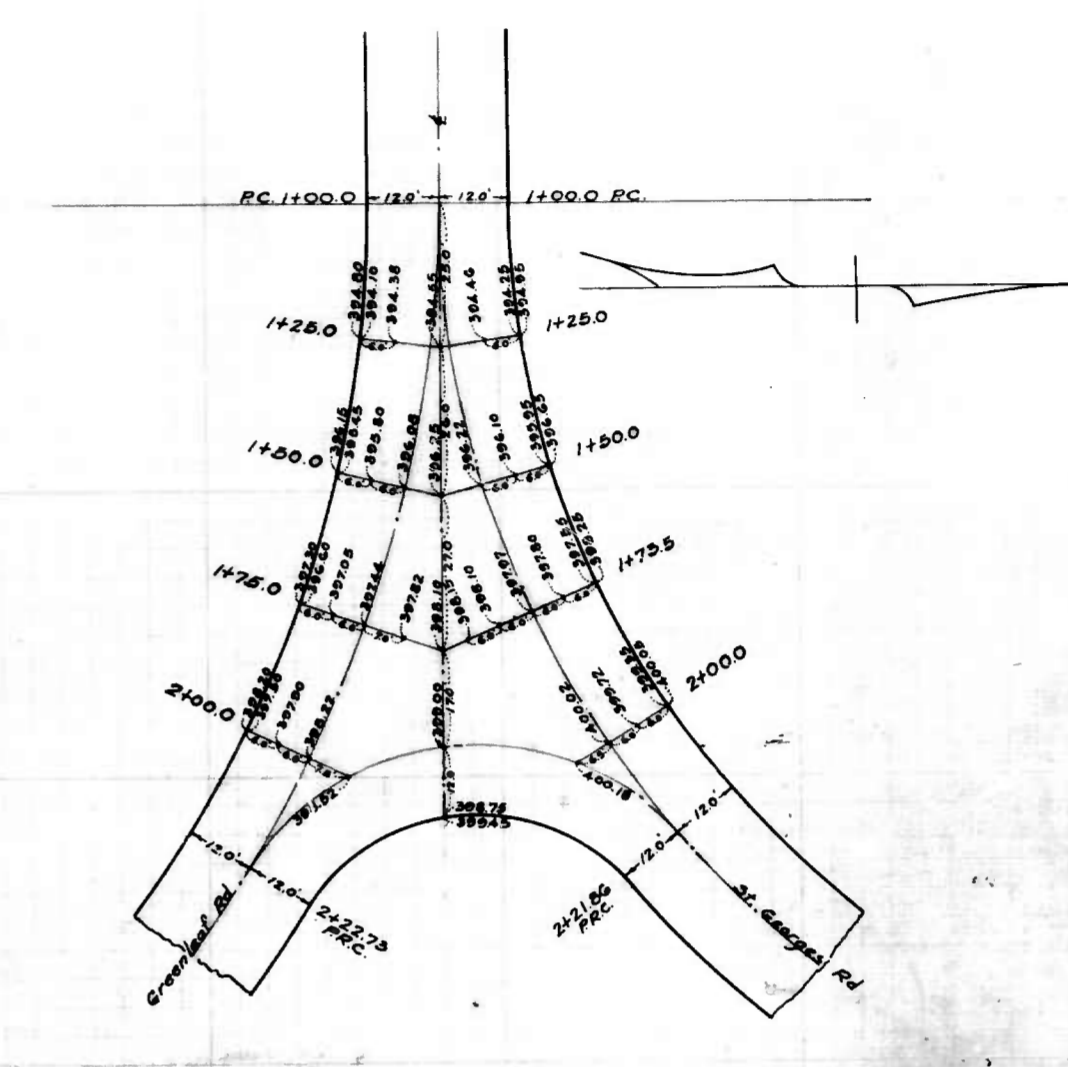
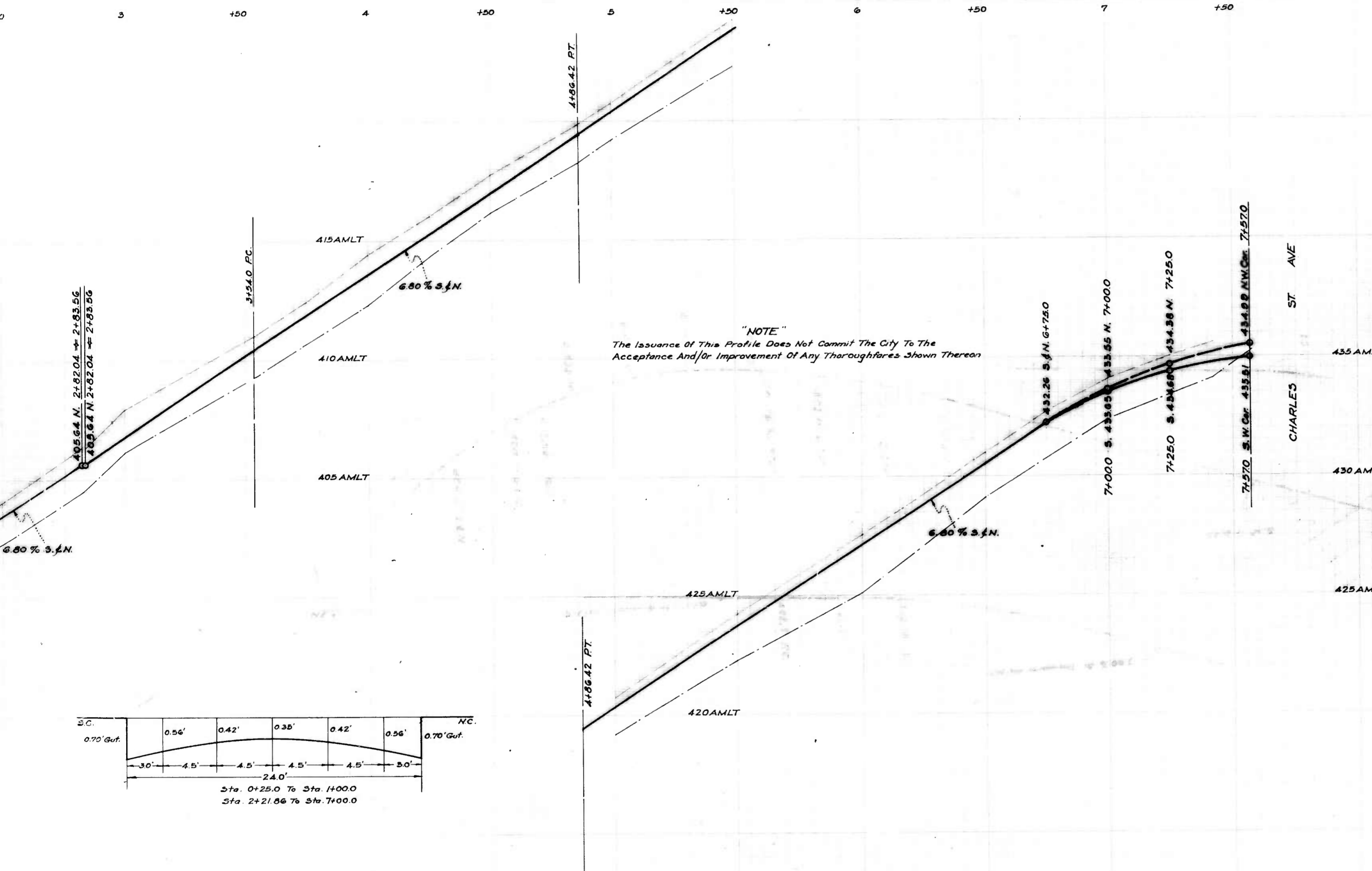

CITY OF BALTIMORE
 DEPARTMENT OF PUBLIC WORKS
 BUREAU OF HIGHWAYS
 PROFILE OF
 ST. GEORGE'S RD - GREENLEAF RD - CHARLES ST. AVE.
 SCALE: HOR: 1" = 20.0' BOOK N° C - 708
 VER: 1" = 20' DATE: APRIL 12, 1939
 CONT N° 708

CORRECTED
[Signature]
 ASSOCIATE ENGINEER

APPROVED
[Signature]
 HIGHWAYS ENGINEER

APPROVED
[Signature]
 ENGR. PLANS & SURVEYS

APPROVED
[Signature]
 CHIEF ENGINEER

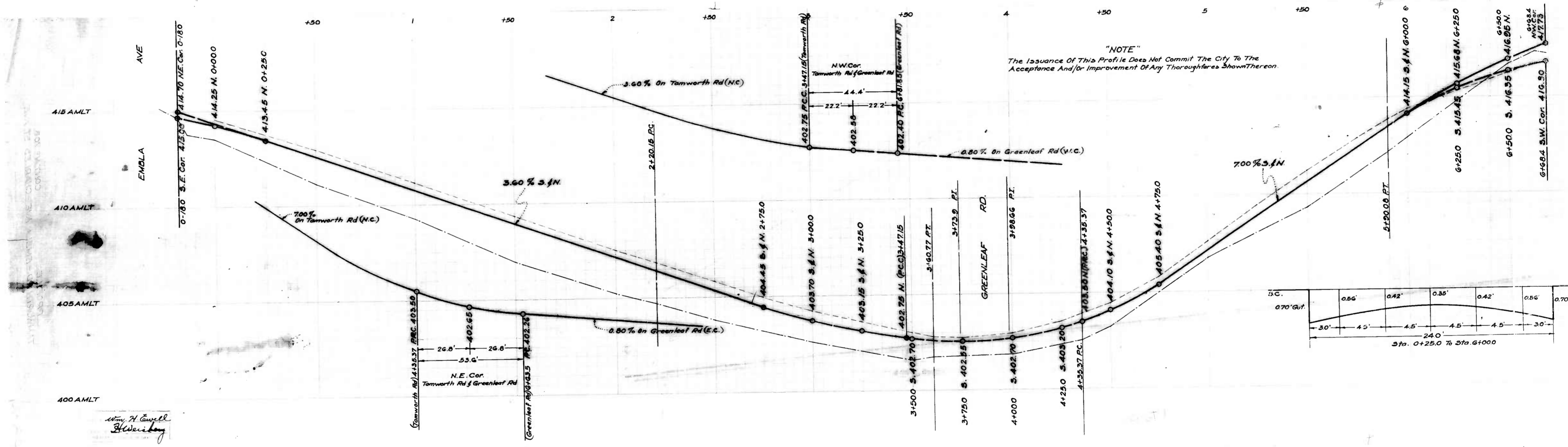

"NOTE"
 The Issuance Of This Profile Does Not Commit The City To The Acceptance And/or Improvement Of Any Thoroughfares Shown Thereon.

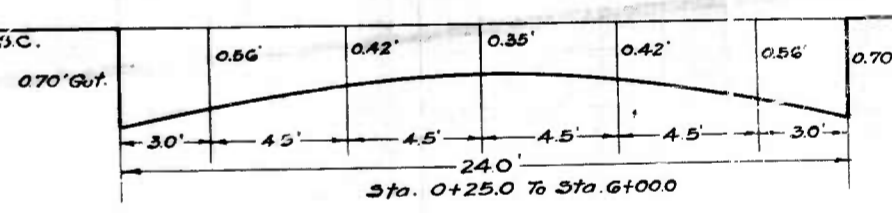

Wm. H. Cavell
 H. W. Wiley

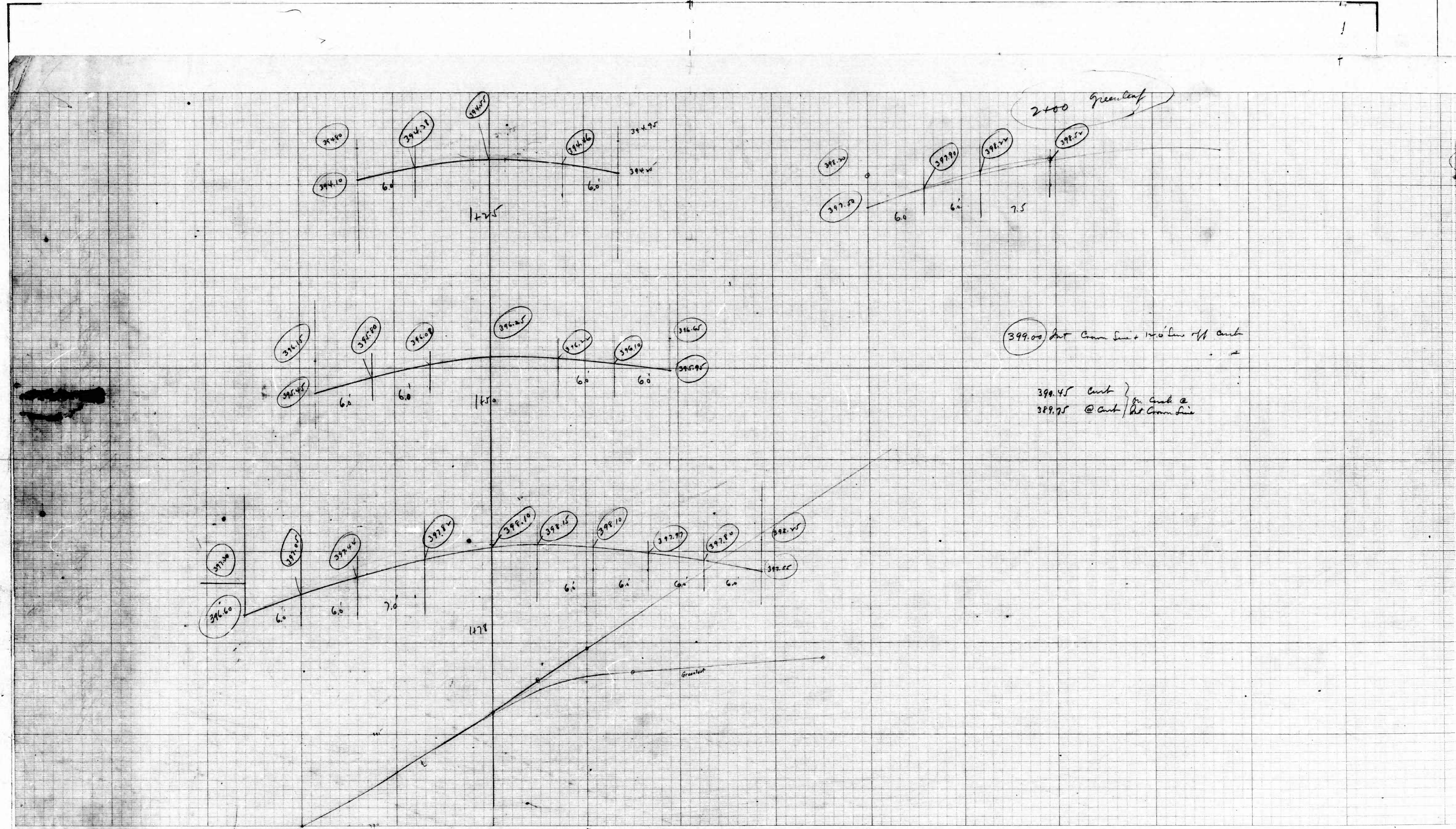

399.00 @ cut from line 140' line off cut

399.45 cut }
 389.75 @ cut }
 } for cut a
 } at cut / at from line

Sheet 1

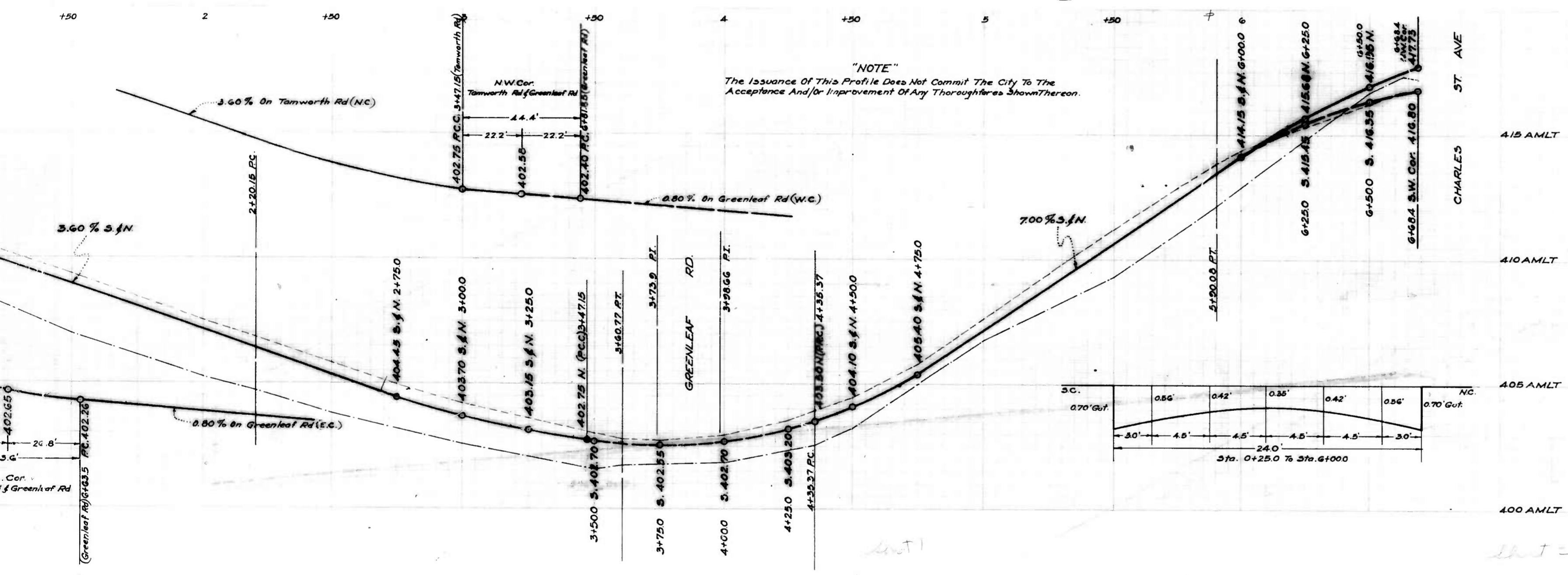

"NOTE"
 The Issuance Of This Profile Does Not Commit The City To The
 Acceptance And/or Improvement Of Any Thoroughfares Shown Thereon.

CITY OF BALTIMORE
 DEPARTMENT OF PUBLIC WORKS
 BUREAU OF HIGHWAYS
PROFILE OF
TAMWORTH RD. - EMBLA AVE. - CHARLES ST. AVE.
 SCALE: HOR: 1" = 20.0' BOOK N° C-708
 VER: 1" = 2.0' DATE: APR. 13, 1939
 CONT. N° 708

CORRECT
[Signature]
 ASSOCIATE ENGINEER

APPROVED
[Signature]
 HIGHWAYS ENGINEER

APPROVED
[Signature]
 ENGR. PLANS & SURVEYS

APPROVED
[Signature]
 CHIEF ENGINEER

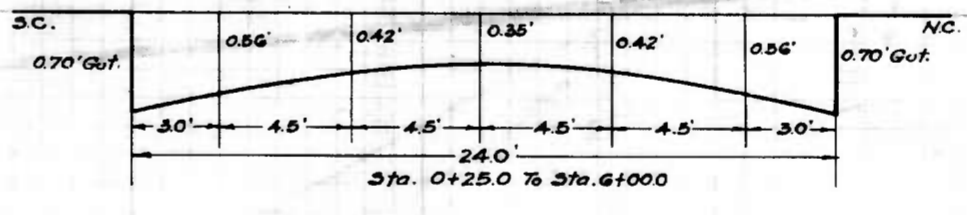

TAMWORTH RD. - EMBLA AVE. - CHARLES ST. AVE.
 PROFILE
 BOOK N° C-708
 DATE: APR. 13, 1939
 CONT. N° 708

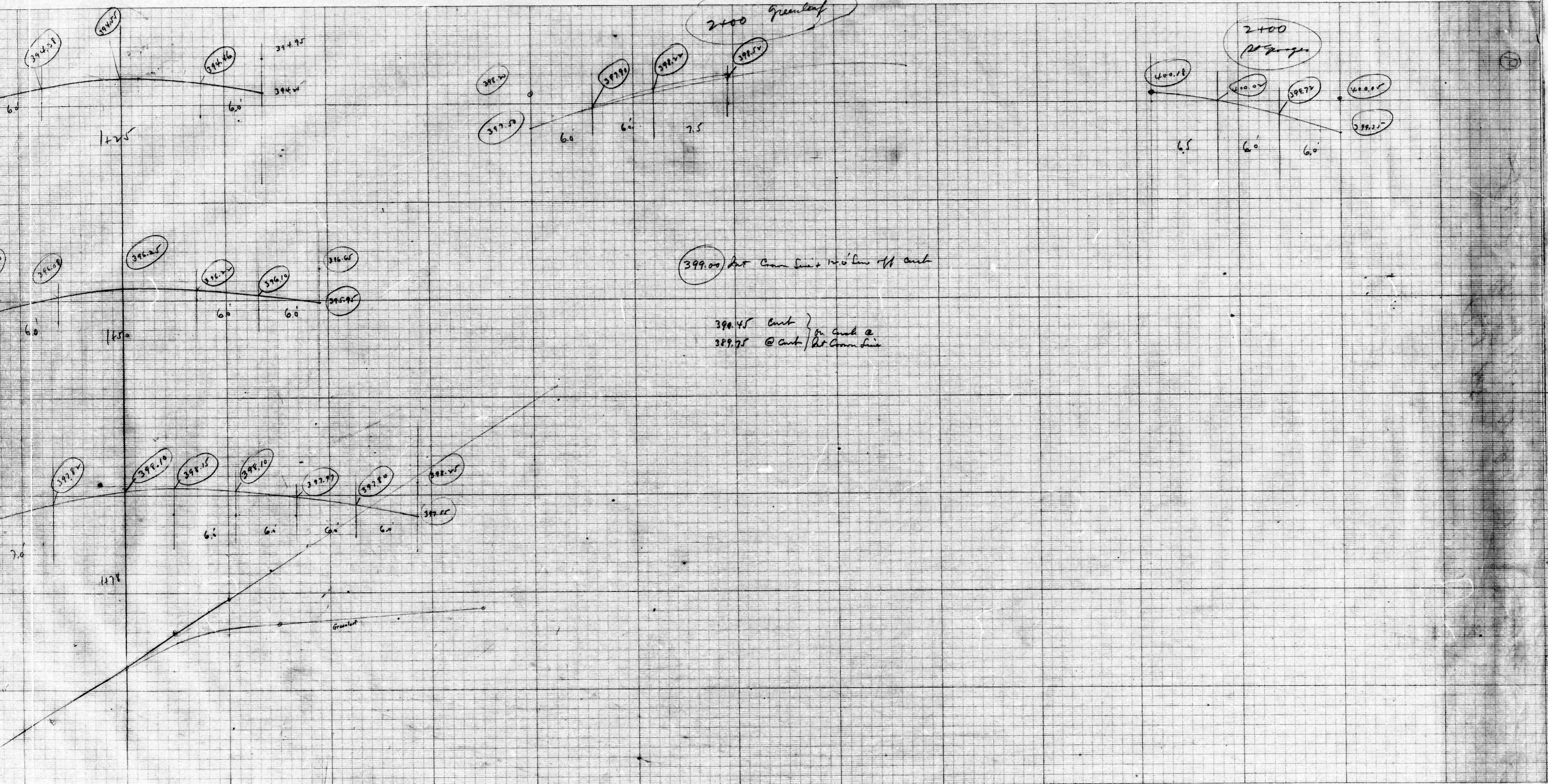

Sheet 1

Sheet 2

