

Wm. H. Ewell  
 Hesterberg

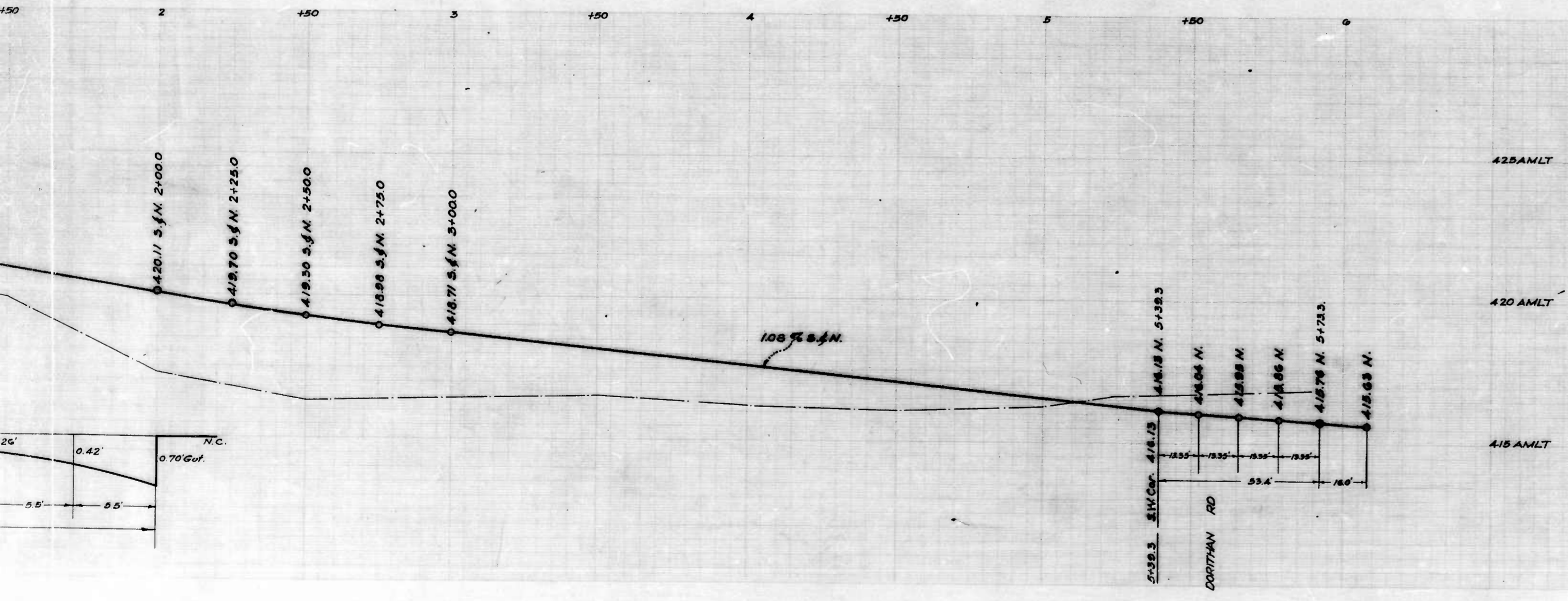

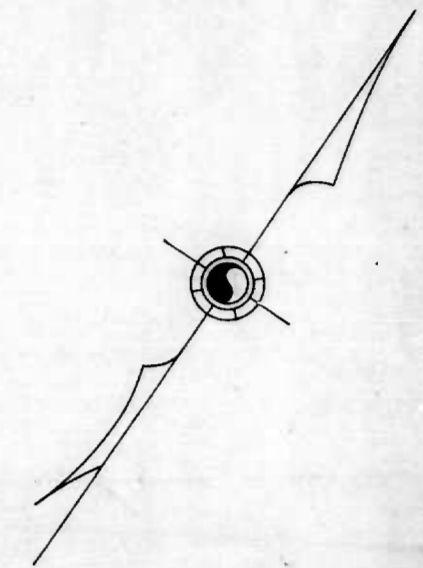
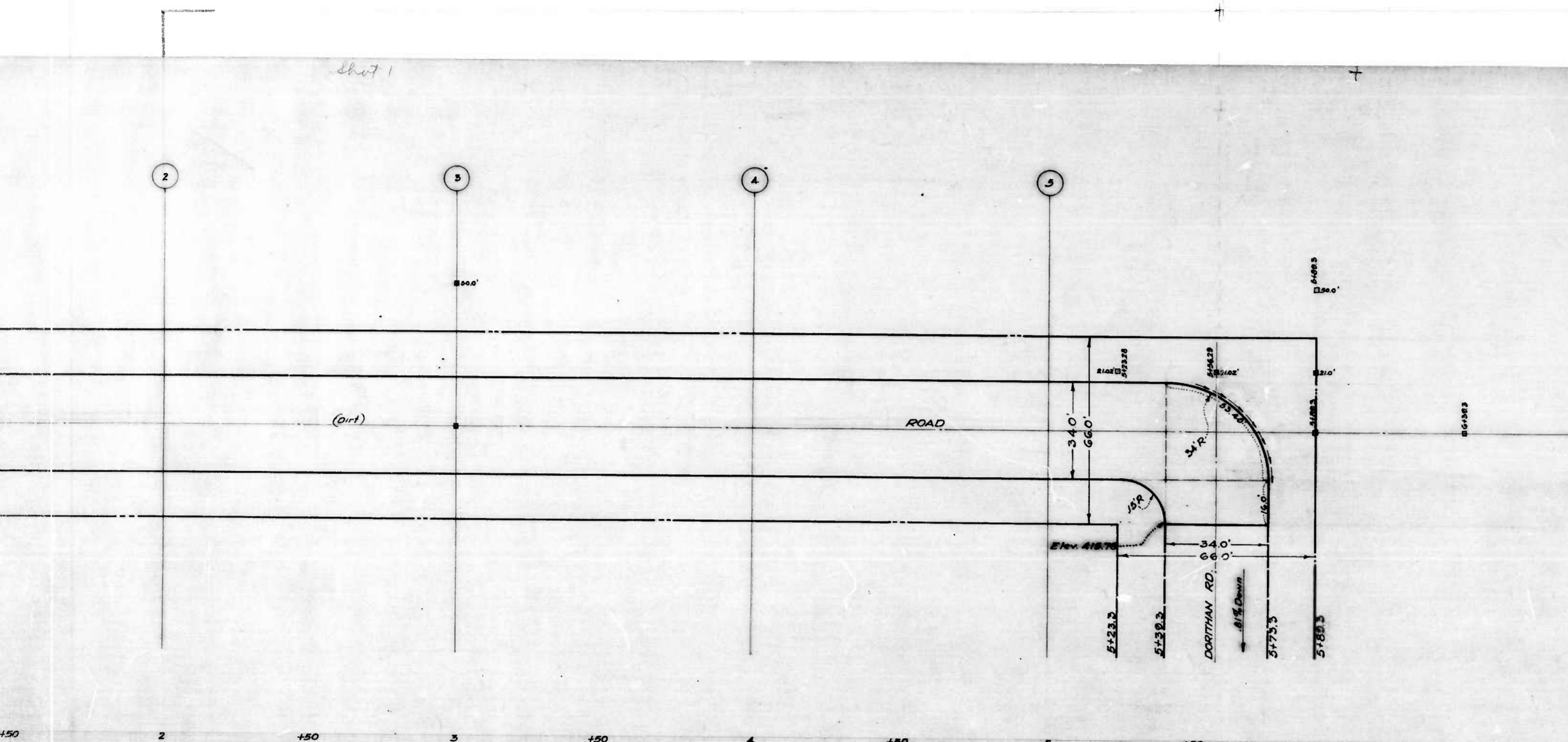

CITY OF BALTIMORE  
 DEPARTMENT OF PUBLIC WORKS  
 BUREAU OF HIGHWAYS  
 PLAN & PROFILE  
 EDGEWOOD RD - DOLFIELD AVE - DORITHAN RD.  
 PLAN: 1" = 20.0' BOOK N° X-120  
 SCALE: HOR: 1" = 20.0' DATE: MAR. 11, 1959  
 PROF: VER: 1" = 20' CONT. N° 707

CORRECT: *[Signature]*  
 ASSOCIATE ENGINEER APPROVED

APPROVED: *[Signature]*  
 HIGHWAYS ENGINEER APPROVED

*[Signature]*  
 ENGR. PLANS & SURVEYS

*[Signature]*  
 CHIEF ENGINEER

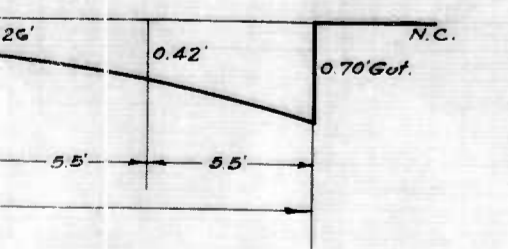



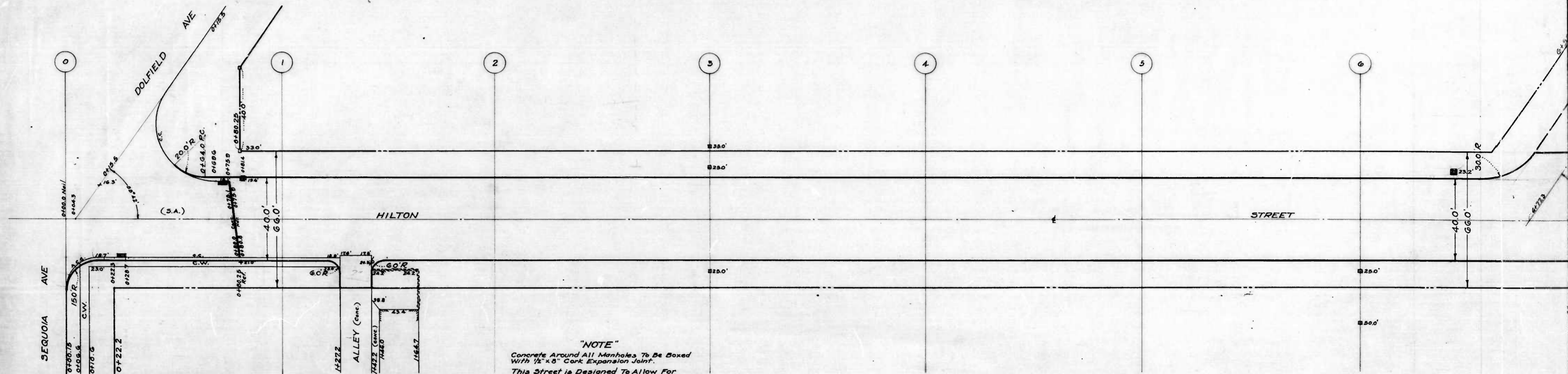

**"NOTE"**  
 Concrete Around All Manholes To Be Boxed  
 With 1/2" x 8" Cork Expansion Joint.  
 This Street is Designed To Allow For  
 Surfacing At Some Future Date.

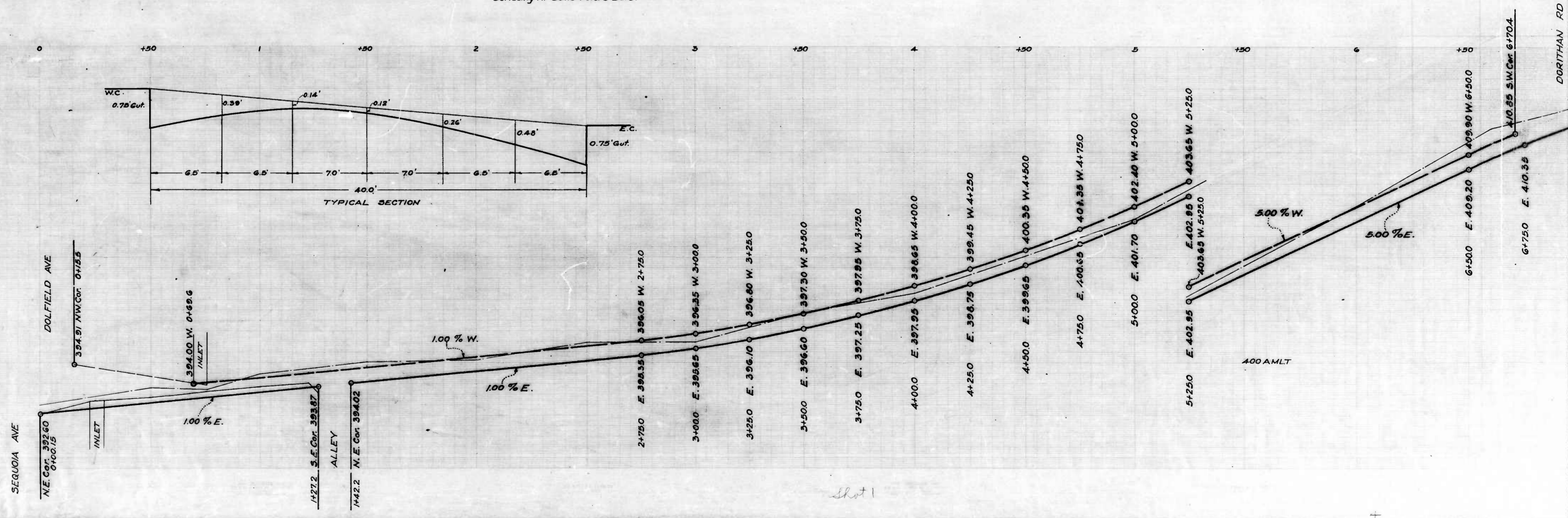
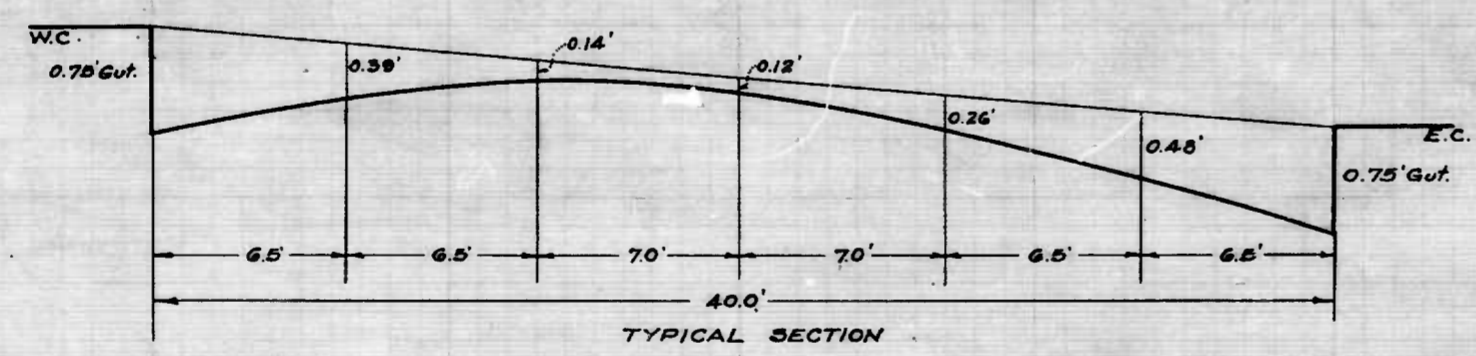

DESIGNED BY *Wm. H. Conell*  
 ENGINEER  
 H. Tenby

Sheet 1



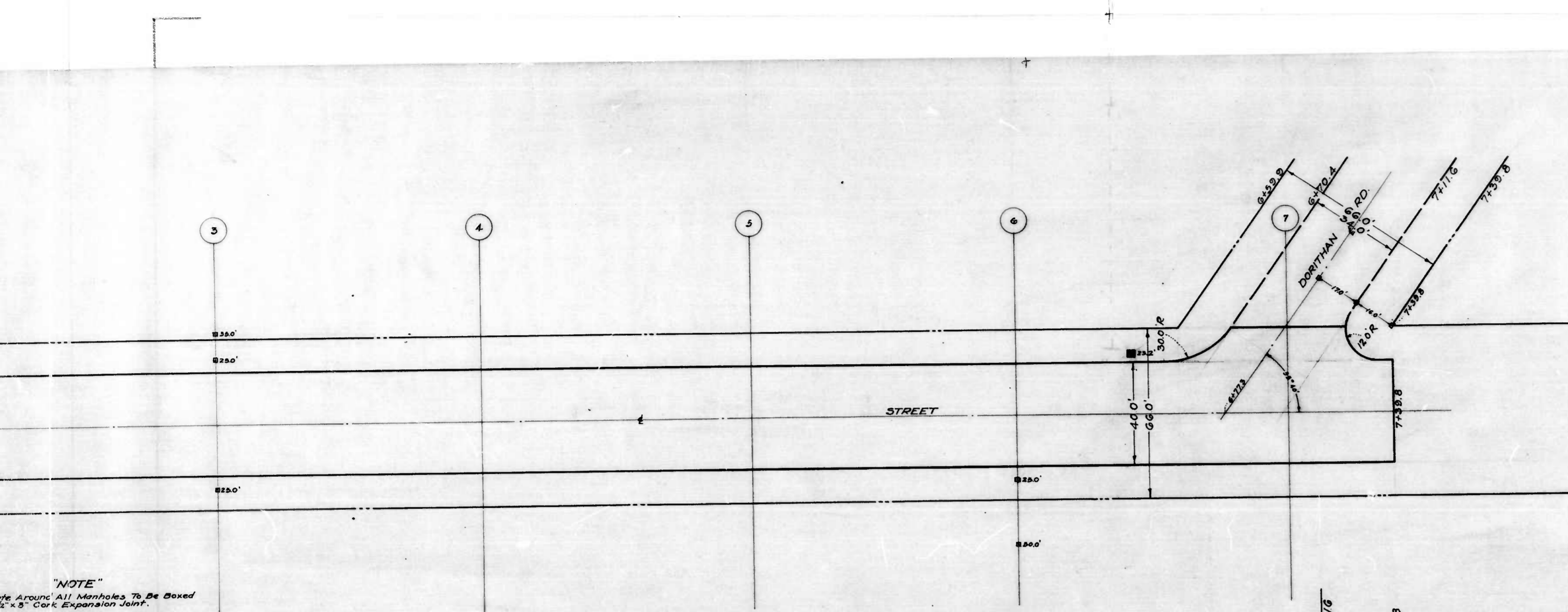

"NOTE"  
 The Area Around All Manholes To Be Boxed  
 2' x 8" Cork Expansion Joint.  
 Street is Designed To Allow For  
 Widening At Some Future Date.

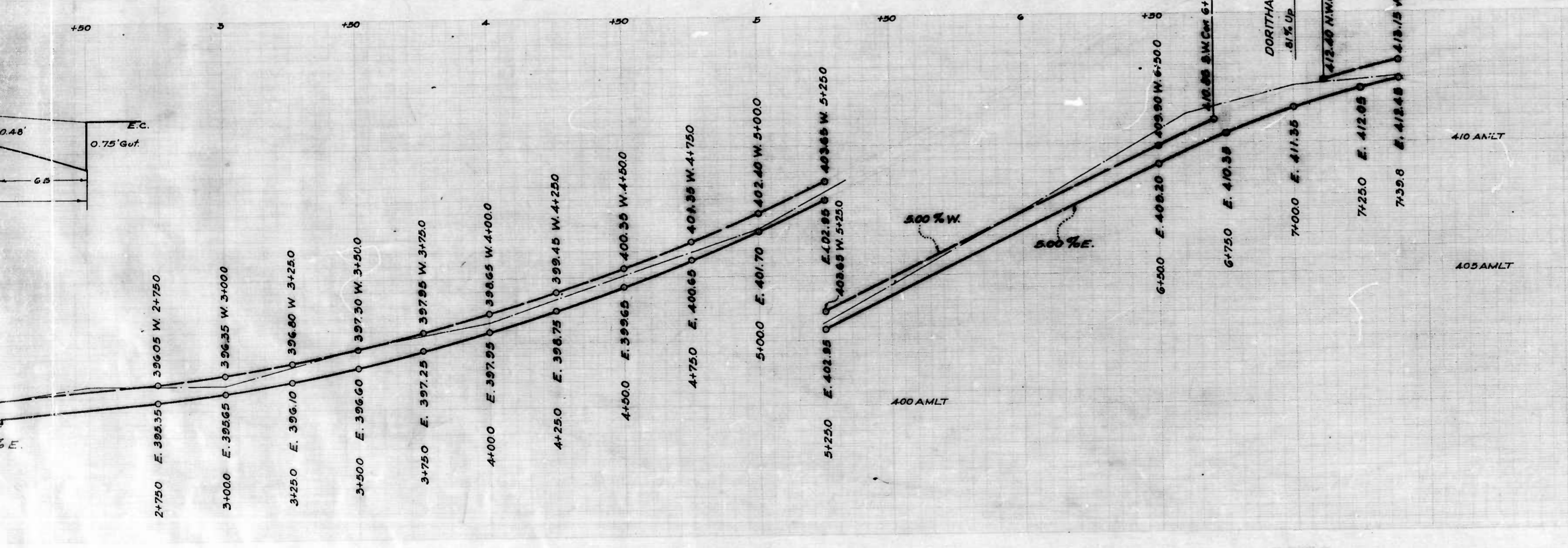

CITY OF BALTIMORE  
 DEPARTMENT OF PUBLIC WORKS  
 BUREAU OF HIGHWAYS  
 PLAN & PROFILE  
 HILTON ST - DOLFIELD AVE - DORITHAN RD.  
 PLAN - 1" = 20.0' BOOK No X-120  
 SCALE - PROF - 1" = 20.0'  
 VER - 1" = 20' DATE - MAR. 2, 1939  
 CONT. No 707

CORRECT APPROVED  
*W. J. [Signature]* *[Signature]*  
 ASSOCIATE ENGINEER HIGHWAYS ENGINEER  
 APPROVED APPROVED  
 ENGR. PLANS & SURVEYS CHIEF ENGINEER

HILTON ST - DOLFIELD AVE - DORITHAN RD.  
 CONT. No 707 - 24

Sheet 2

