

Note: 10.0' Curb Circles At Benzinger Ave.  
6.0' Curb Circles At All Alleys  
Use 2.0' Curb Circles At Any Proposed Drives

CITY OF BALTIMORE  
DEPARTMENT OF PUBLIC WORKS  
BUREAU OF HIGHWAYS  
LAYOUT OF  
ARION PARK RD - CITY LINE TO WILKENS AVE.  
Cont. No. 705  
Scale - 1" = 200'  
June 4, 1936

Approved: \_\_\_\_\_ Location Approved: \_\_\_\_\_ Correct: \_\_\_\_\_ Approved: \_\_\_\_\_  
Chief Engineer Engr. Plans & Surveys Associate Engineer Highway Engineer

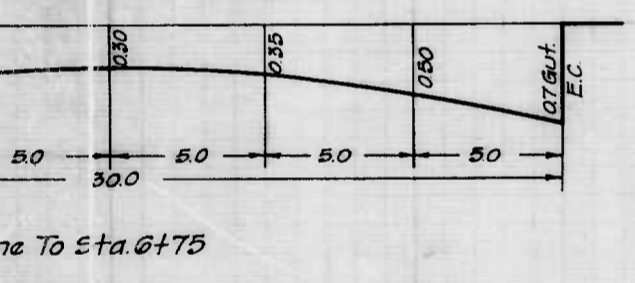
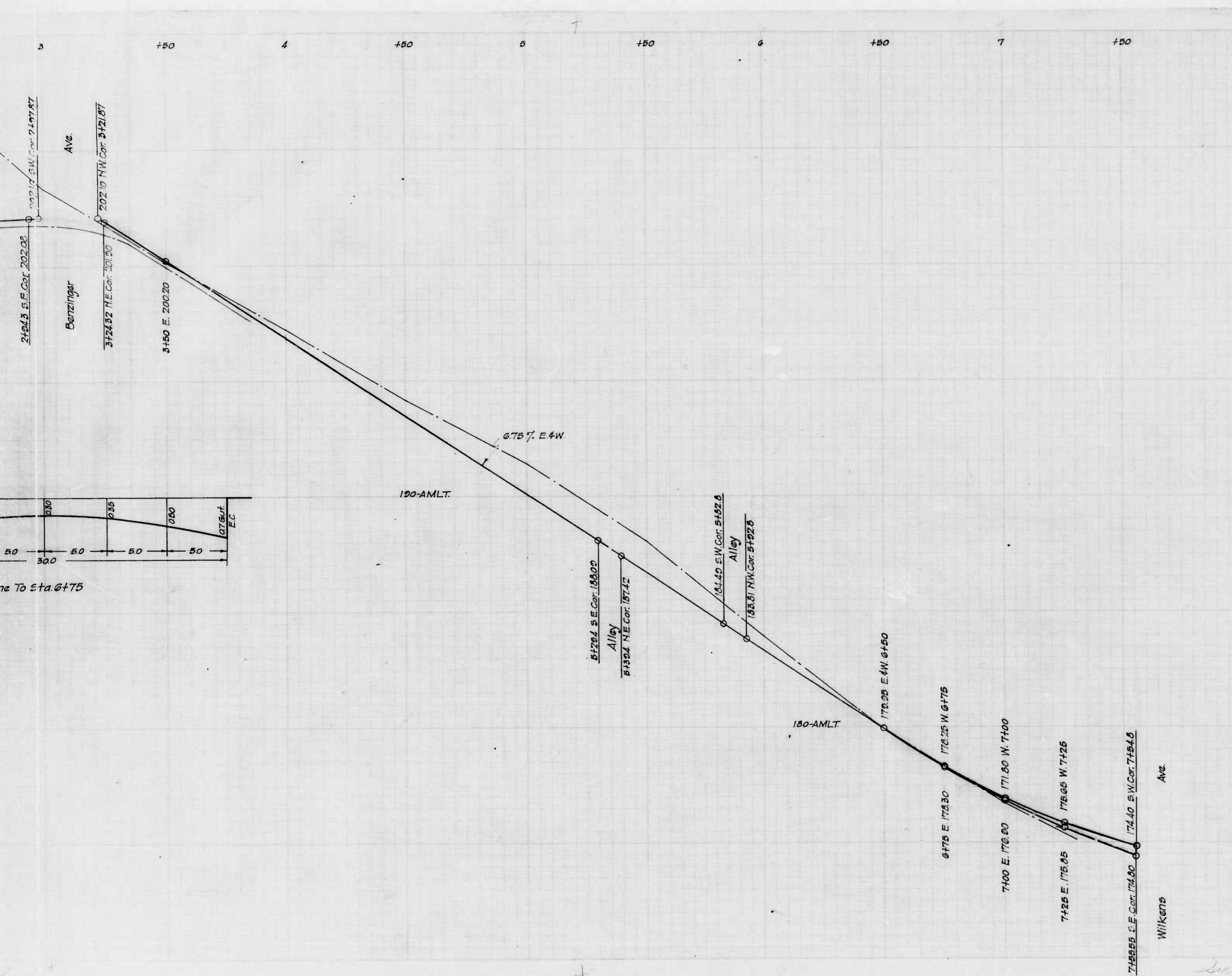

CITY OF BALTIMORE  
 DEPARTMENT OF PUBLIC WORKS  
 BUREAU OF HIGHWAYS  
 ESTABLISHED GRADE OF  
 ARION PARK ROAD - CITY LINE TO WILKENS AVE.

Cont. No. 705  
 Hor. - 1" = 200'  
 Ver. - 1" = 20' June 4, 1938

Approved - Location Approved - Corrected - Approved -  
 Chief Engineer Engr.-Plans & Surveys Associate Engineer Highways Engineer

Second sheet

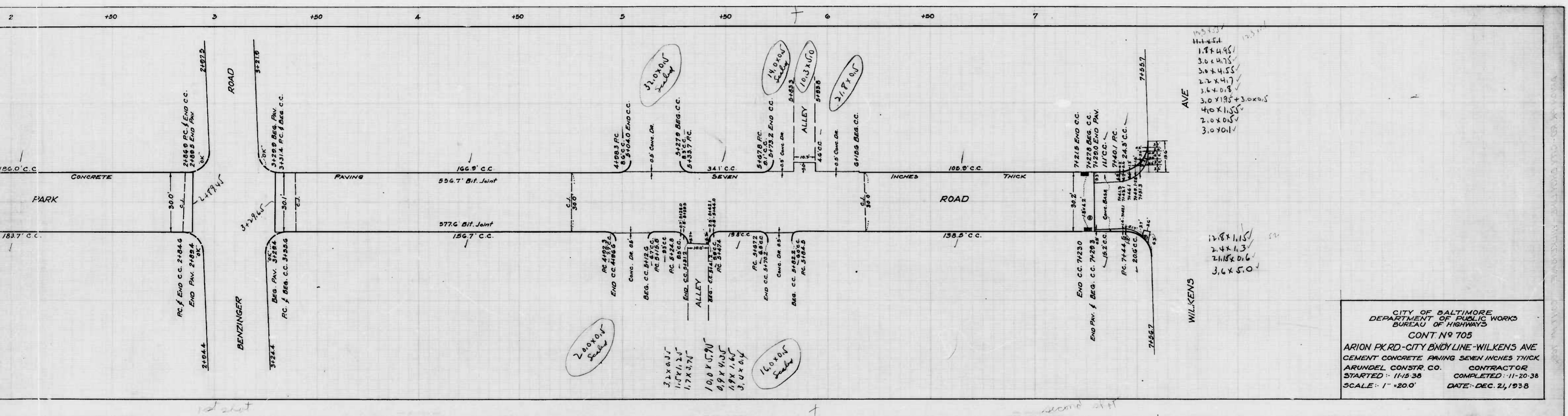

CITY OF BALTIMORE  
 DEPARTMENT OF PUBLIC WORKS  
 BUREAU OF HIGHWAYS  
 CONT. N<sup>o</sup> 705  
 ARION PK. RD - CITY BNDY LINE - WILKENS AVE  
 CEMENT CONCRETE PAVING SEVEN INCHES THICK  
 ARUNDEL CONSTR. CO. CONTRACTOR  
 STARTED - 11-15-38 COMPLETED - 11-20-38  
 SCALE - 1" = 20.0' DATE - DEC. 21, 1938

1st sheet

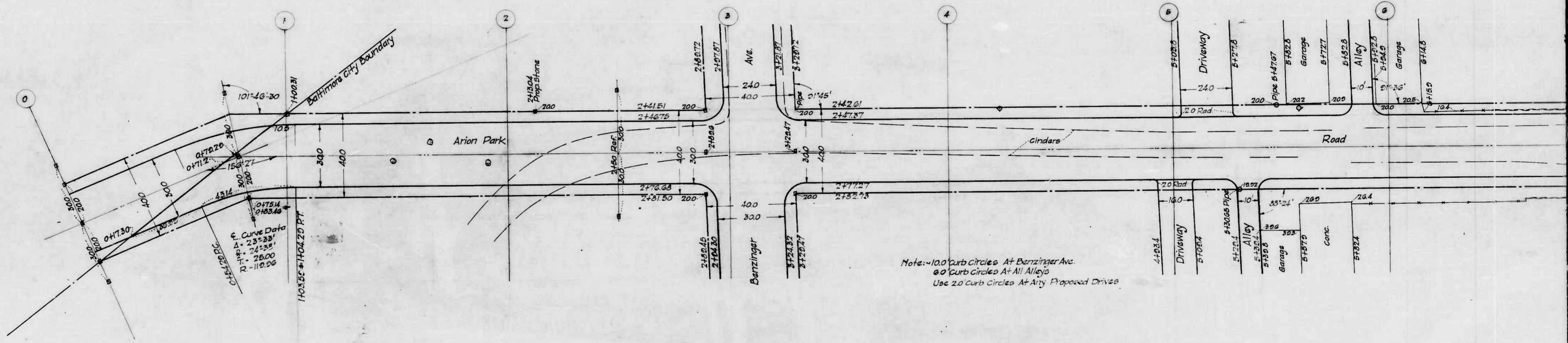

Note: -10.0' curb circles At Benzinger Ave.  
 6.0' curb circles At All Alleys  
 Use 2.0' curb circles At Any Proposed Drives

DESIGNED BY: J. J. Hayden  
 EXAMINED BY: H. H. Rosenberg  
 ENGINEER IN CHARGE OF DESIGN

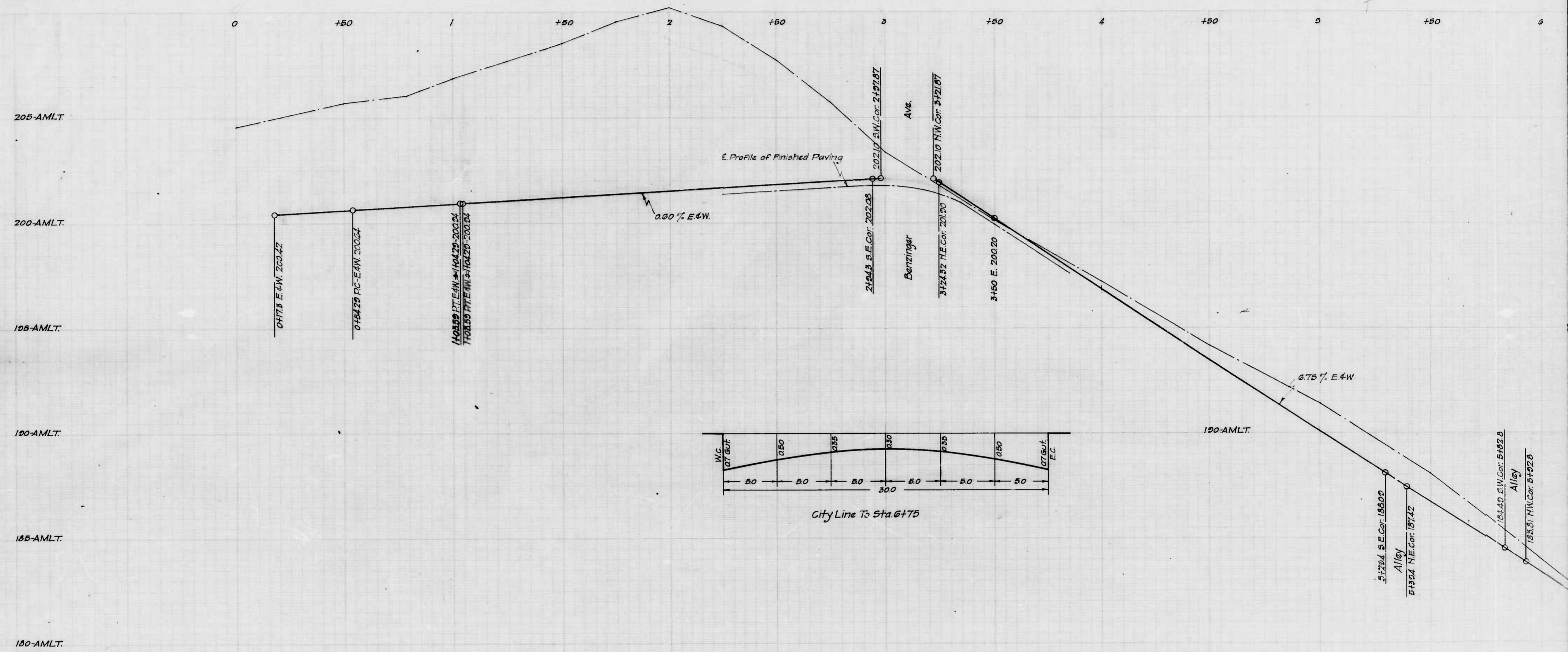

DRAWN BY *J. Steyer*  
 EXAMINED BY *H. Rosenberg*  
 ENGINEER IN CHARGE OF DRAWING

12 24 87

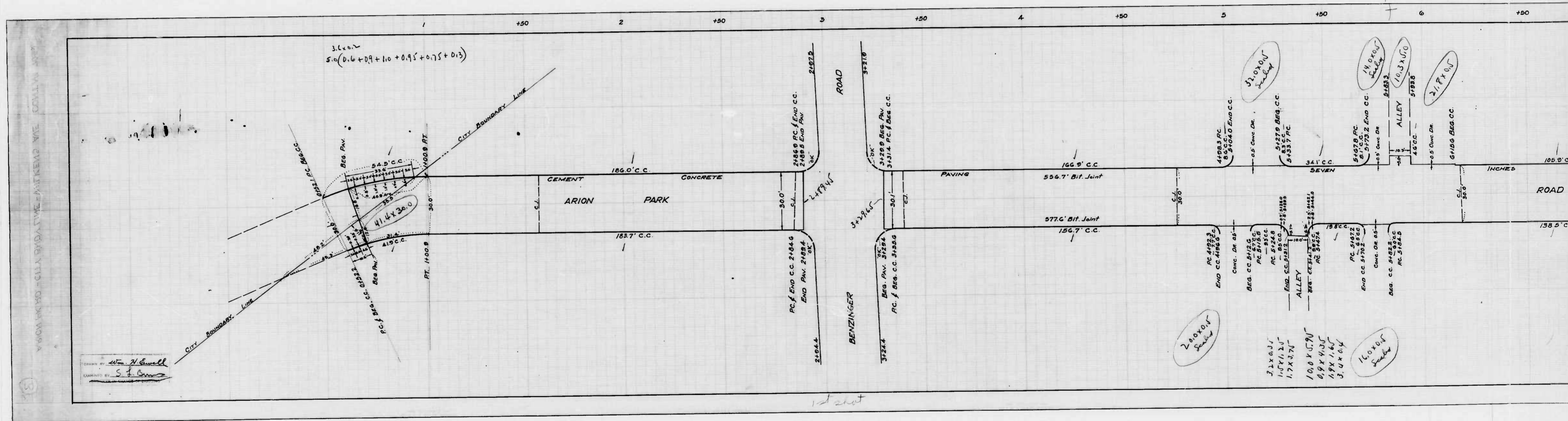

35-9

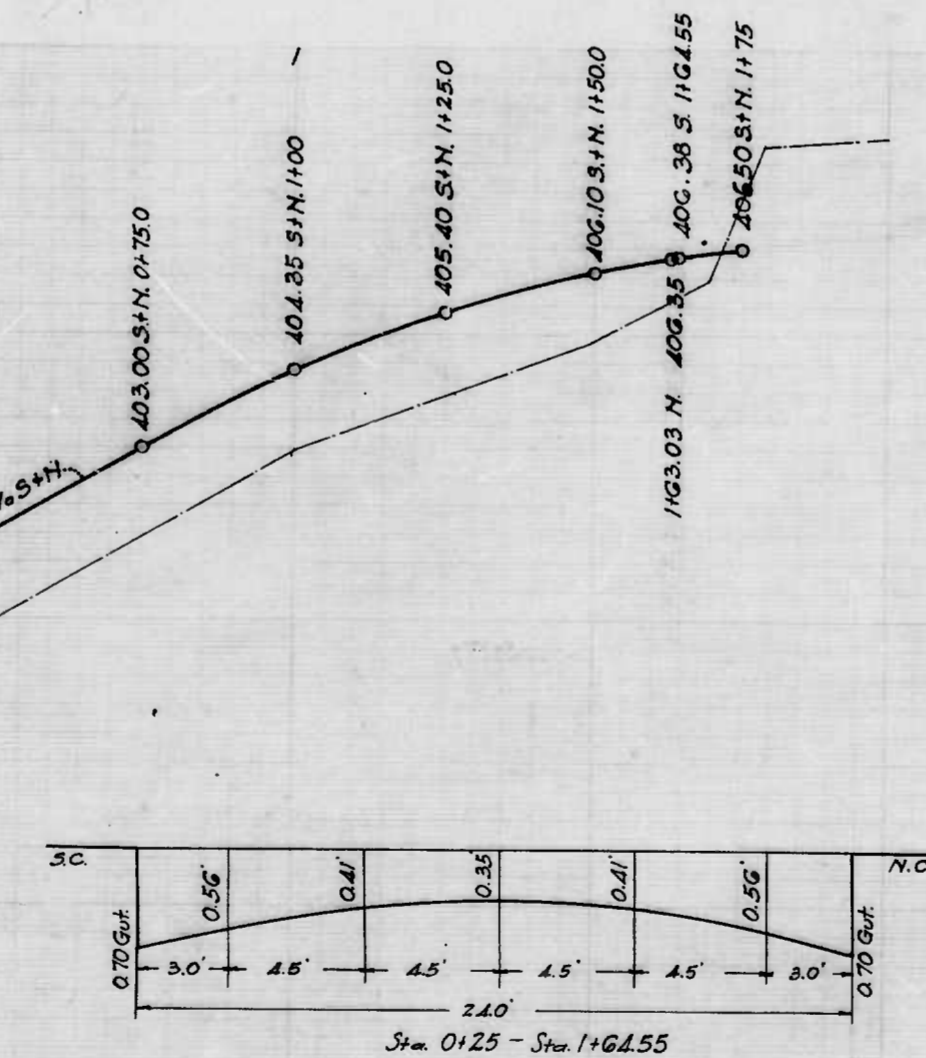
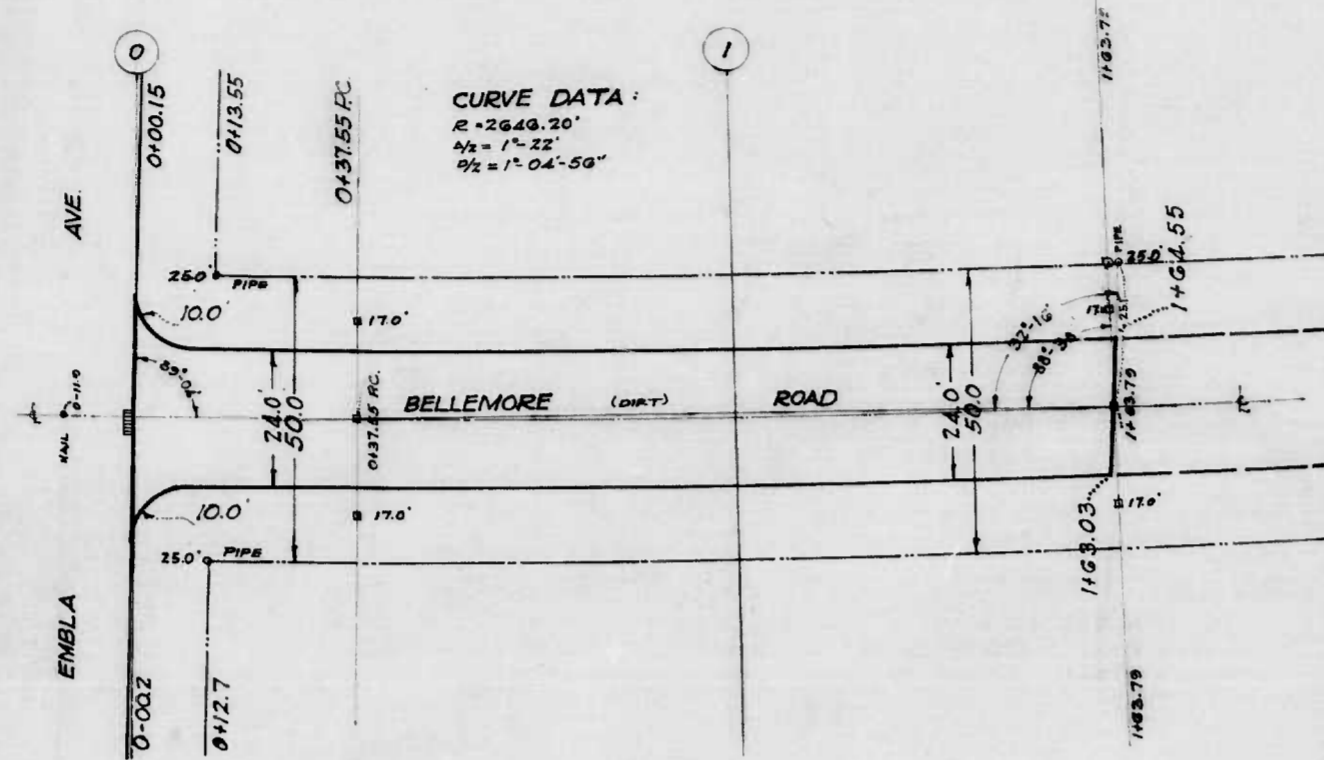

BETWEEN 10' SW CORNER OF

VERTICULAR ELEVATION 112' MEAL  
SCALE 1/8\"/>

405 AMLT.  
400 AMLT.  
395 AMLT.

DRAWN BY S.J. ASBERG  
ENGINEER IN CHARGE OF DRAFTING  
*S.J. Asberg*

CITY OF BALTIMORE  
DEPARTMENT OF PUBLIC WORKS  
BUREAU OF HIGHWAYS  
BELLEMORE RD. - EMBLA AVE - 173 ± West  
SCALES: HOR. 1"=20'  
VER. 1"=2.0' JULY 14, 1938.  
BOOK X-100

PLAN: 1"=20' CONT. NO. 705  
CORRECT. APPROVED:  
*Edmund H. Hester* ASSOC. ENGINEER  
*Edmund H. Hester* ENGR. PLANS & SURVEYS  
*Edmund H. Hester* CHIEF ENGINEER

1 sheet





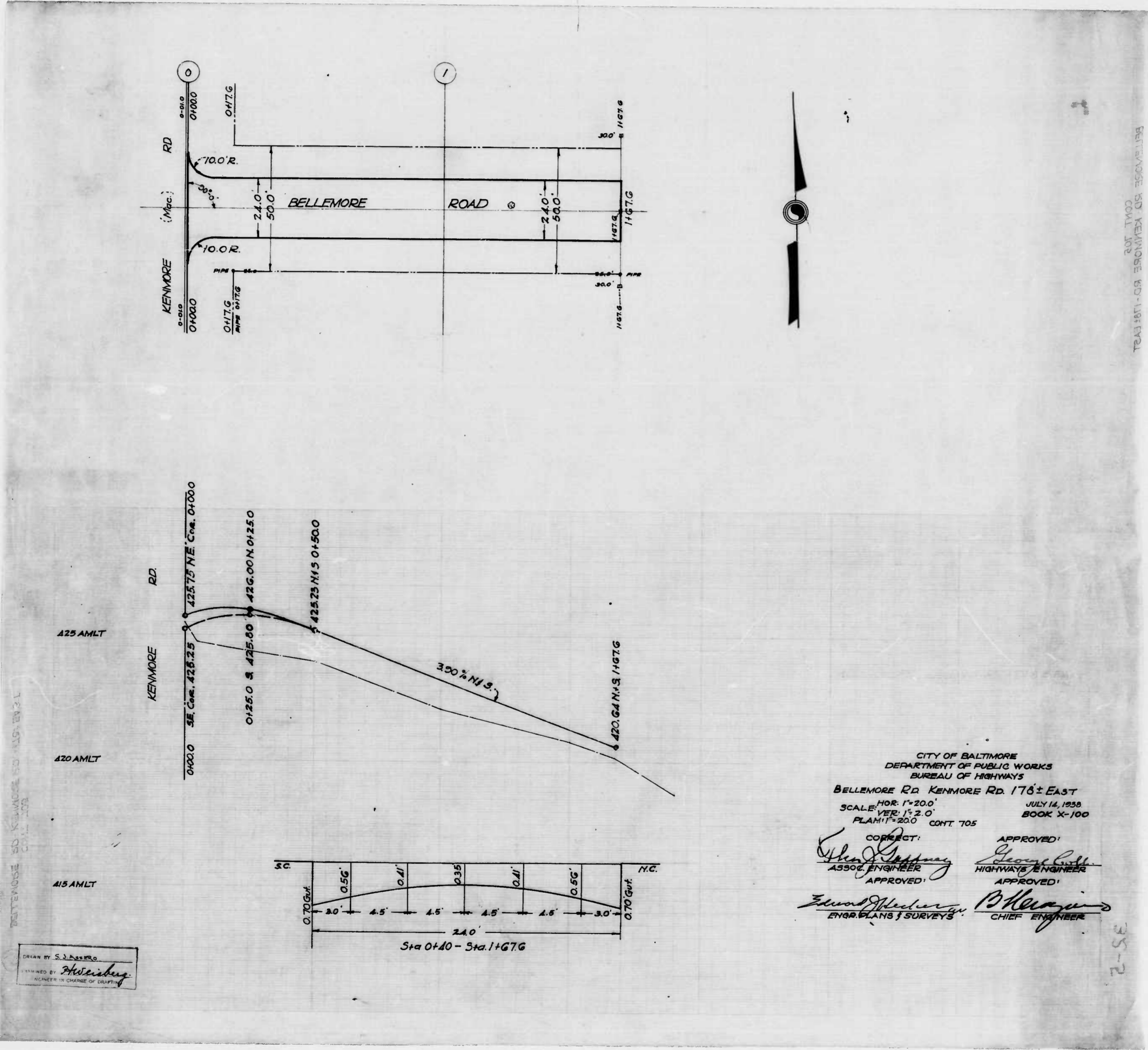

CITY OF BALTIMORE  
 DEPARTMENT OF PUBLIC WORKS  
 BUREAU OF HIGHWAYS  
 BELLEMORE RD KENMORE RD 176± EAST  
 SCALE: HOR. 1"=20.0' JULY 14, 1938  
 SCALE: VERT. 1"=2.0' BOOK X-100  
 PLAN 1"=20.0' CONT. 705

CORRECT: *[Signature]* APPROVED: *[Signature]*  
 ASSOC. ENGINEER HIGHWAYS ENGINEER  
 APPROVED: *[Signature]* APPROVED: *[Signature]*  
 ENGR. PLANS & SURVEYS CHIEF ENGINEER

DESIGNED BY S. J. [Signature]  
 DRAWN BY [Signature]  
 CHECKED BY [Signature]

2-52

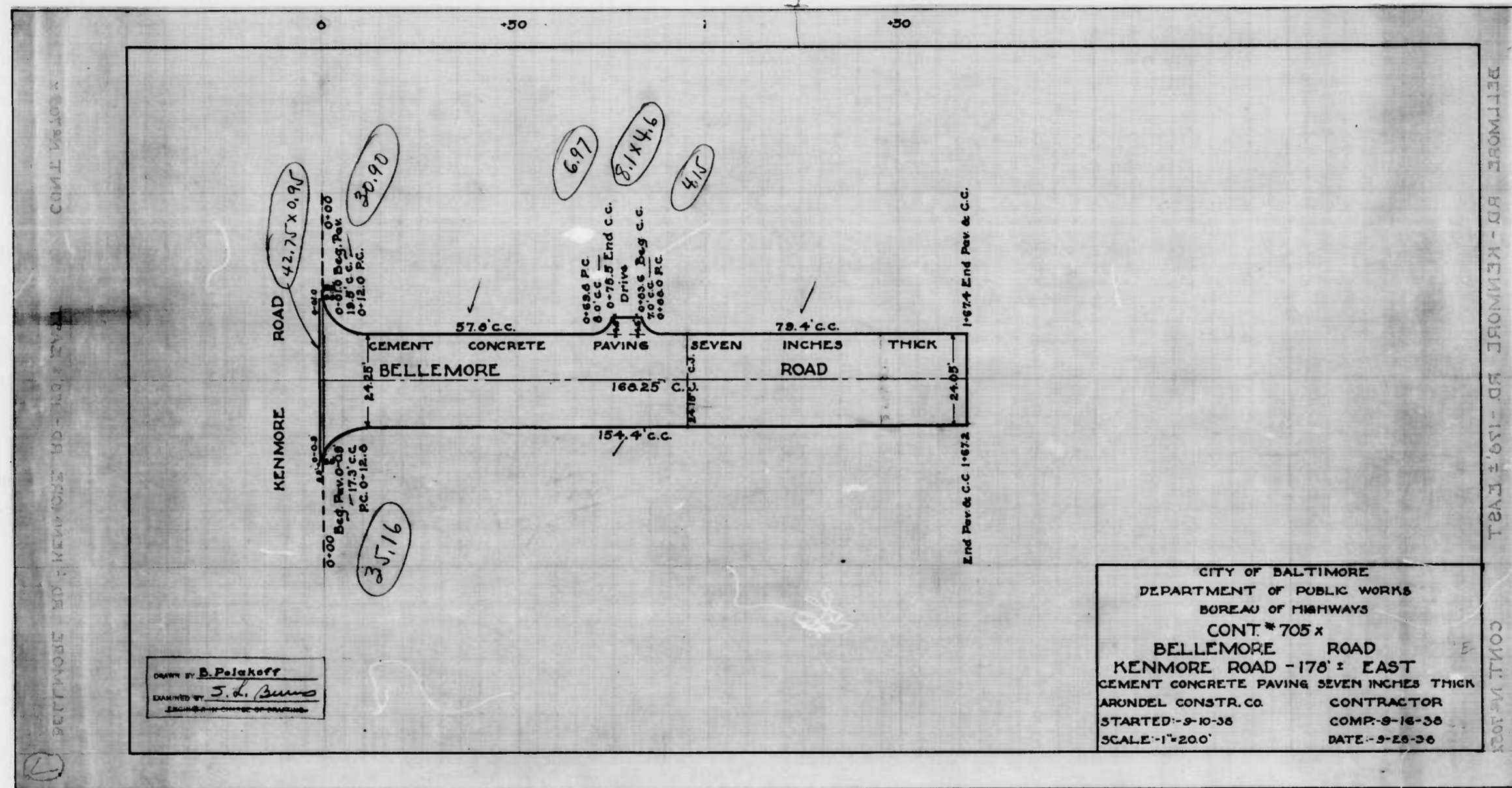

1st shot

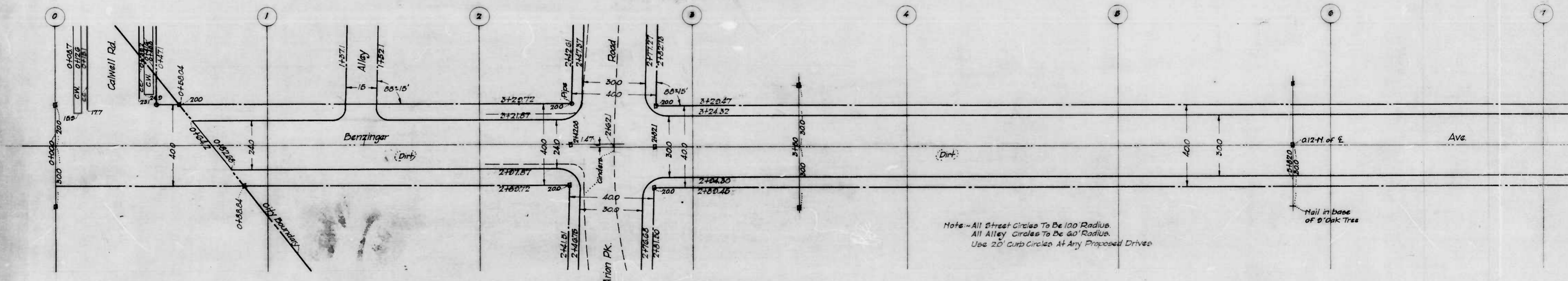

DRAWN BY: *[Signature]*  
 EXAMINED BY: *[Signature]*  
 PROJECT IN CHARGE OF: *[Signature]*

10/10/10 10:00 AM  
 10/10/10 10:00 AM  
 10/10/10 10:00 AM

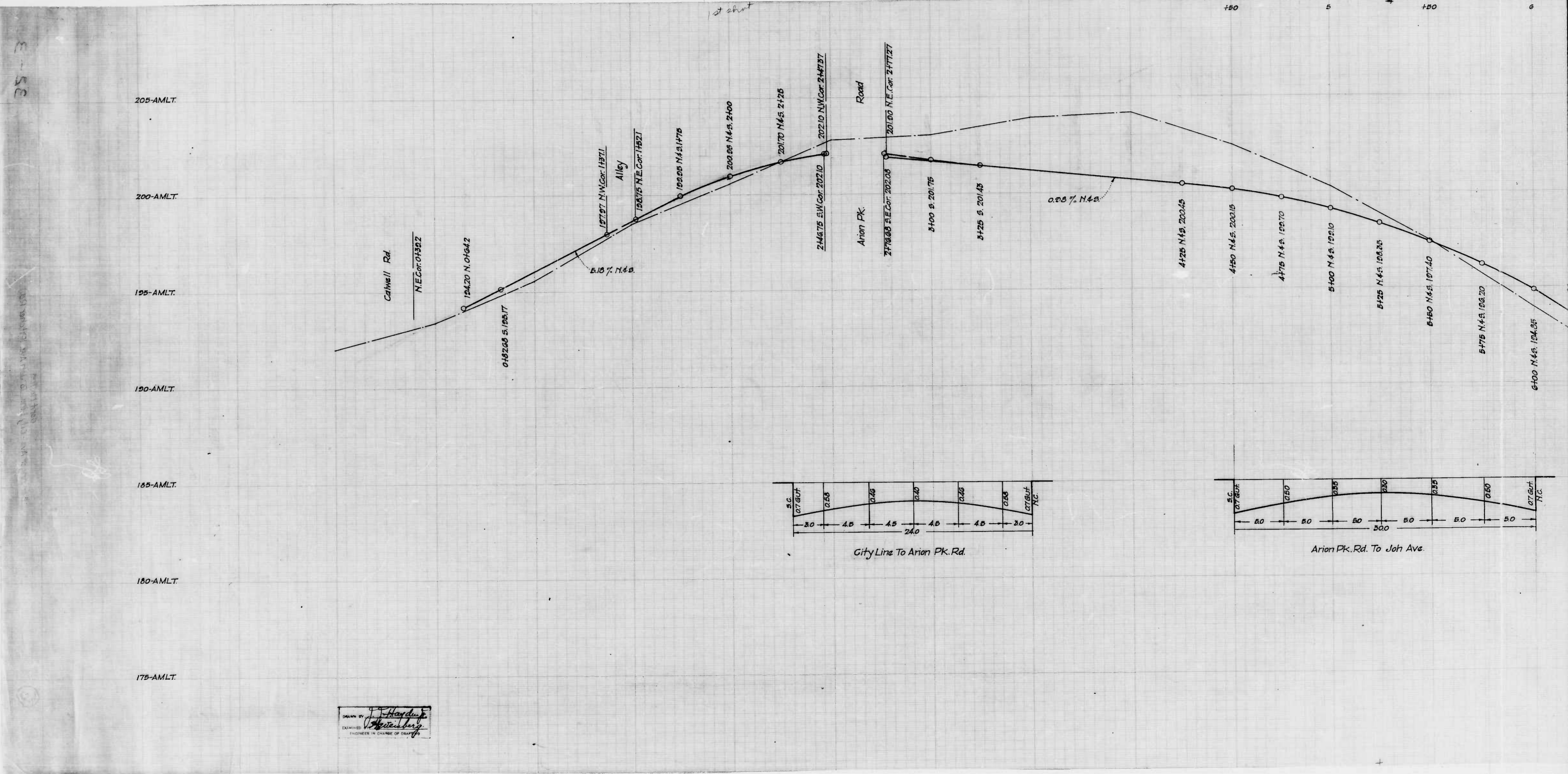

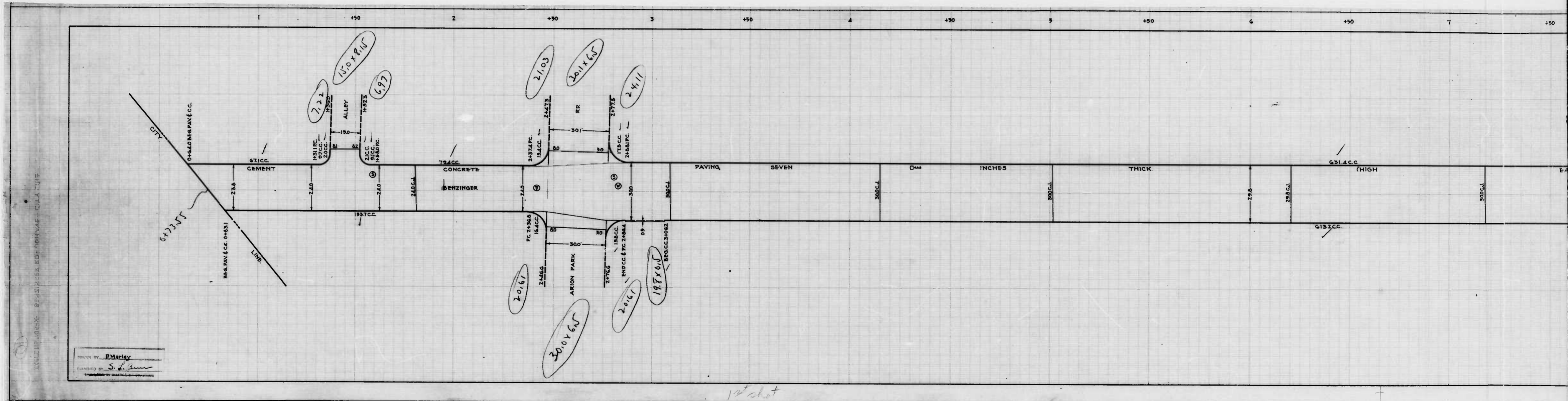

Second sheet

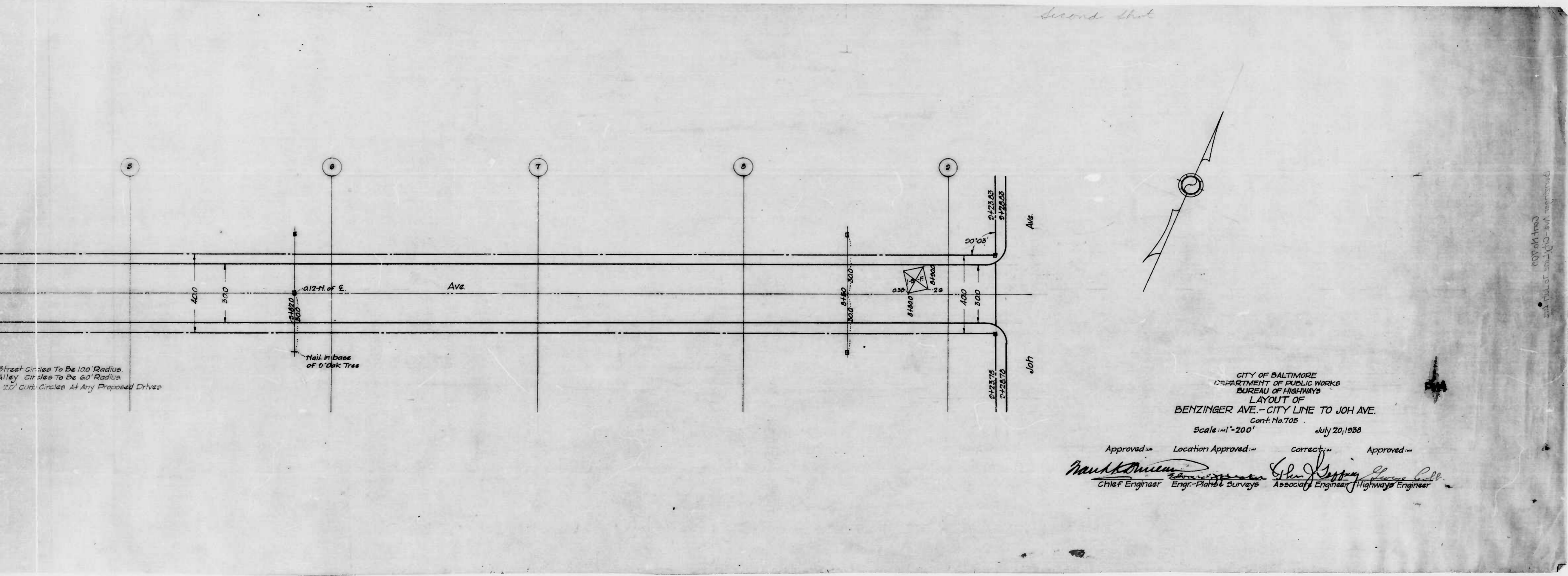

CITY OF BALTIMORE  
 DEPARTMENT OF PUBLIC WORKS  
 BUREAU OF HIGHWAYS  
 LAYOUT OF  
 BENZINGER AVE. - CITY LINE TO JOH AVE.  
 Cont. No. 705  
 Scale: 1" = 20.0' July 20, 1938

Approved: \_\_\_\_\_ Location Approved: \_\_\_\_\_ Correct: \_\_\_\_\_ Approved: \_\_\_\_\_  
 Chief Engineer    Engr. Plans & Surveys    Associate Engineer    Highways Engineer

Proposed by: \_\_\_\_\_  
 Checked by: \_\_\_\_\_  
 Date: \_\_\_\_\_

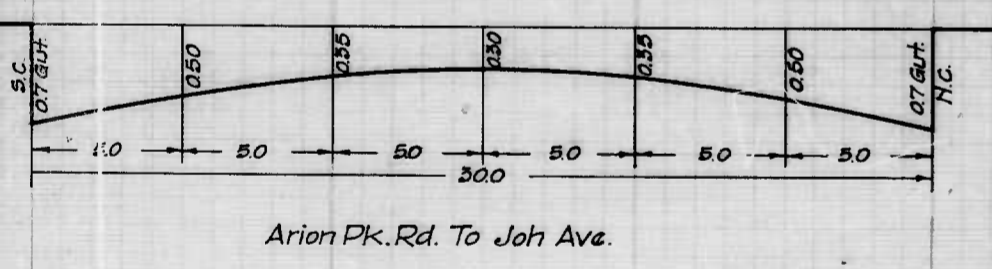
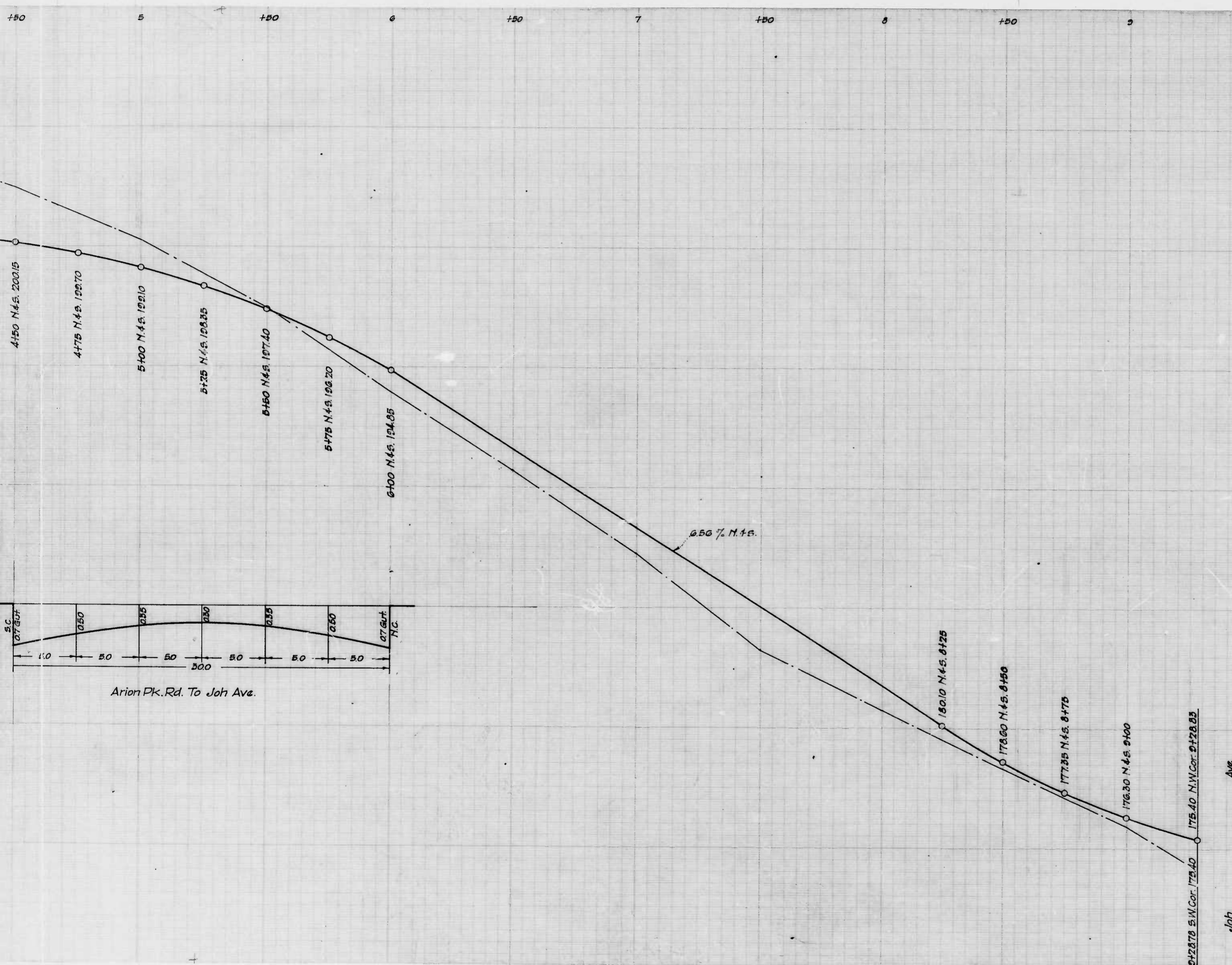

CITY OF BALTIMORE  
DEPARTMENT OF PUBLIC WORKS  
BUREAU OF HIGHWAYS  
ESTABLISHED GRADE OF  
BENZINGER AVE. - CITY LINE TO JOH AVE.  
Cont. No. 705  
Scales: Hor. - 1" = 20.0'  
Ver. - 1" = 2.0'  
June 4, 1938

Approved: \_\_\_\_\_ Location Approved: \_\_\_\_\_ Correct: \_\_\_\_\_ Approved: \_\_\_\_\_  
Chief Engineer - Engr. Plans & Surveys. Associate Engineer Highways Engineer

1938 JUN 4 PM 10 10  
 1938 JUN 4 PM 10 10  
 1938 JUN 4 PM 10 10

705

RATIO - 24

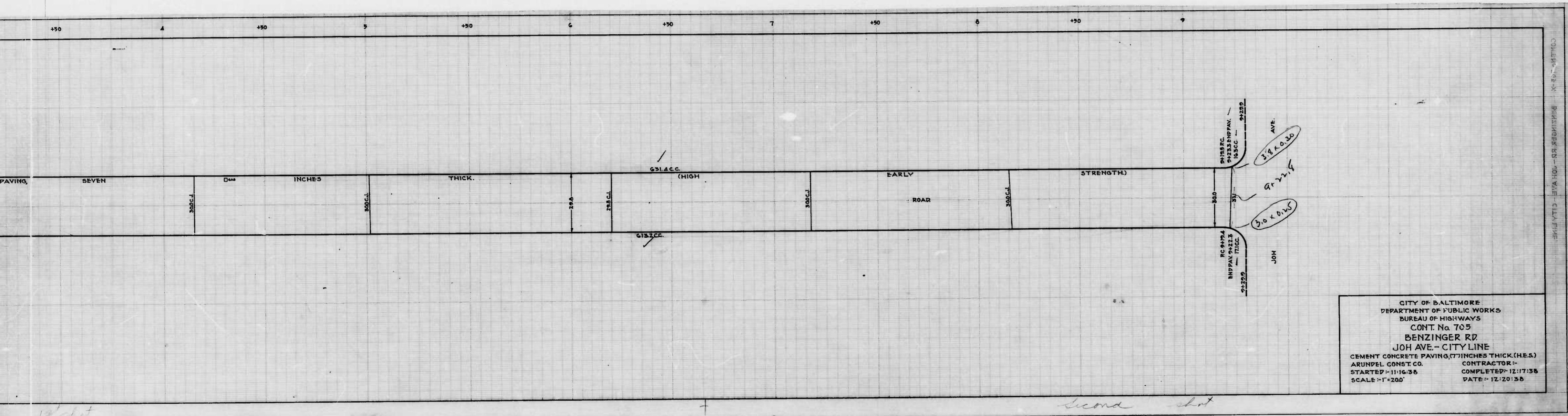

CITY OF BALTIMORE  
 DEPARTMENT OF PUBLIC WORKS  
 BUREAU OF HIGHWAYS  
 CONT. No. 705  
 BENZINGER RD  
 JOH AVE. - CITY LINE  
 CEMENT CONCRETE PAVING, 7 INCHES THICK (H.E.S.)  
 ARUNDEL CONST. CO. CONTRACTOR -  
 STARTED - 11-16-35 COMPLETED - 12-17-35  
 SCALE - 1" = 20' DATE - 12-20-35

*second sheet*

CONT. No. 705 - BENZINGER RD - JOH AVE - CITY LINE



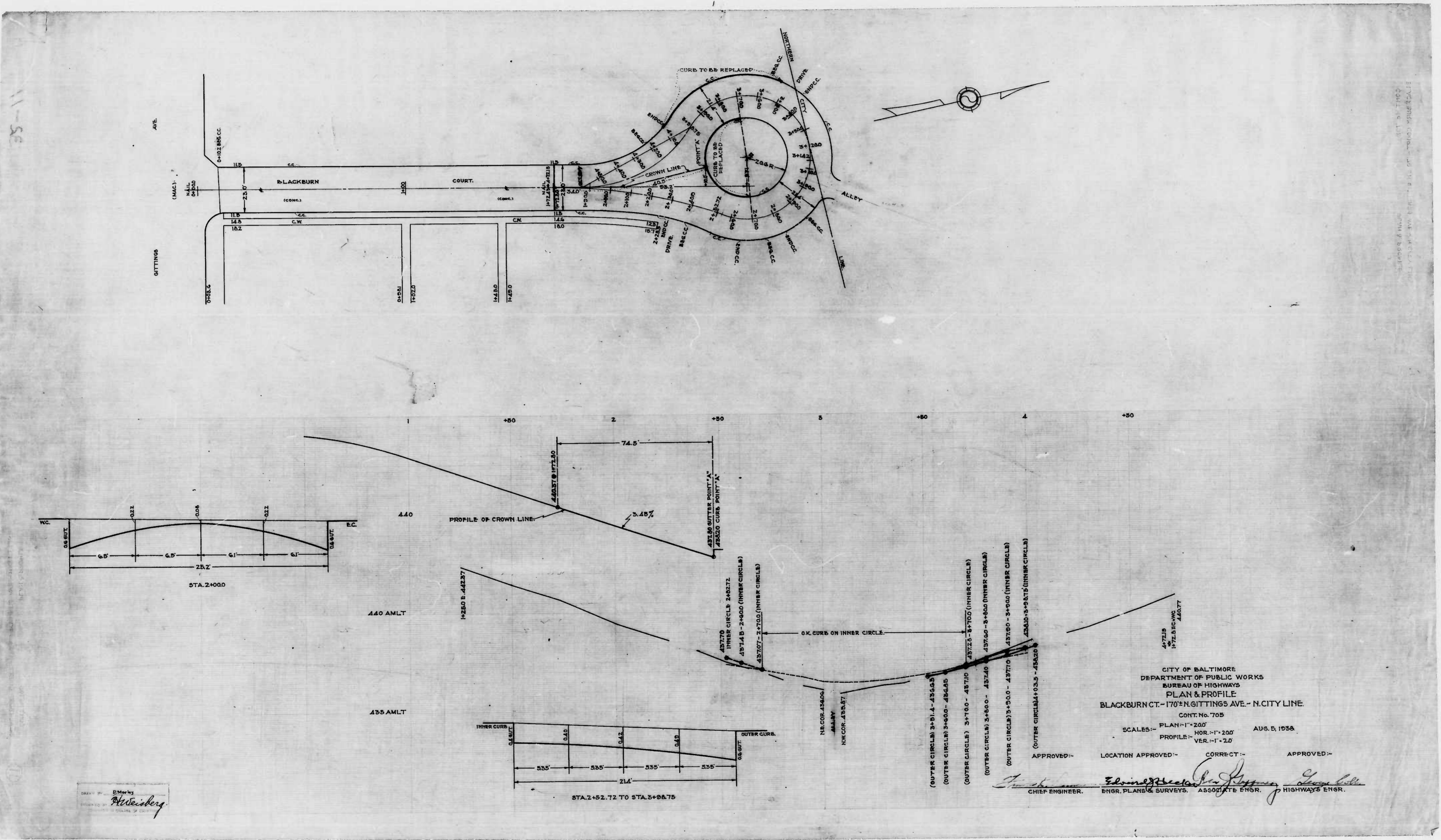

11-55

ENGINEER CONSULTING CO. INC. 1100 N. CALVERT ST. BALTIMORE, MD. 21202

CITY OF BALTIMORE  
 DEPARTMENT OF PUBLIC WORKS  
 BUREAU OF HIGHWAYS  
 PLAN & PROFILE  
 BLACKBURN CT. - 170<sup>th</sup> N. GITTINGS AVE. - N. CITY LINE.

CONT. NO. 705  
 SCALES: PLAN - 1" = 20'  
 PROFILE - 1" = 20'  
 VER. - 1" = 20'

AUG. 5, 1958

APPROVED: \_\_\_\_\_ LOCATION APPROVED: \_\_\_\_\_ CORRECT: \_\_\_\_\_ APPROVED: \_\_\_\_\_  
 CHIEF ENGINEER. ENGR. PLANS & SURVEYS. ASSOCIATE ENGR. HIGHWAYS ENGR.

DESIGNED BY: *E. M. M. M.*  
 DRAWN BY: *H. Weisberg*

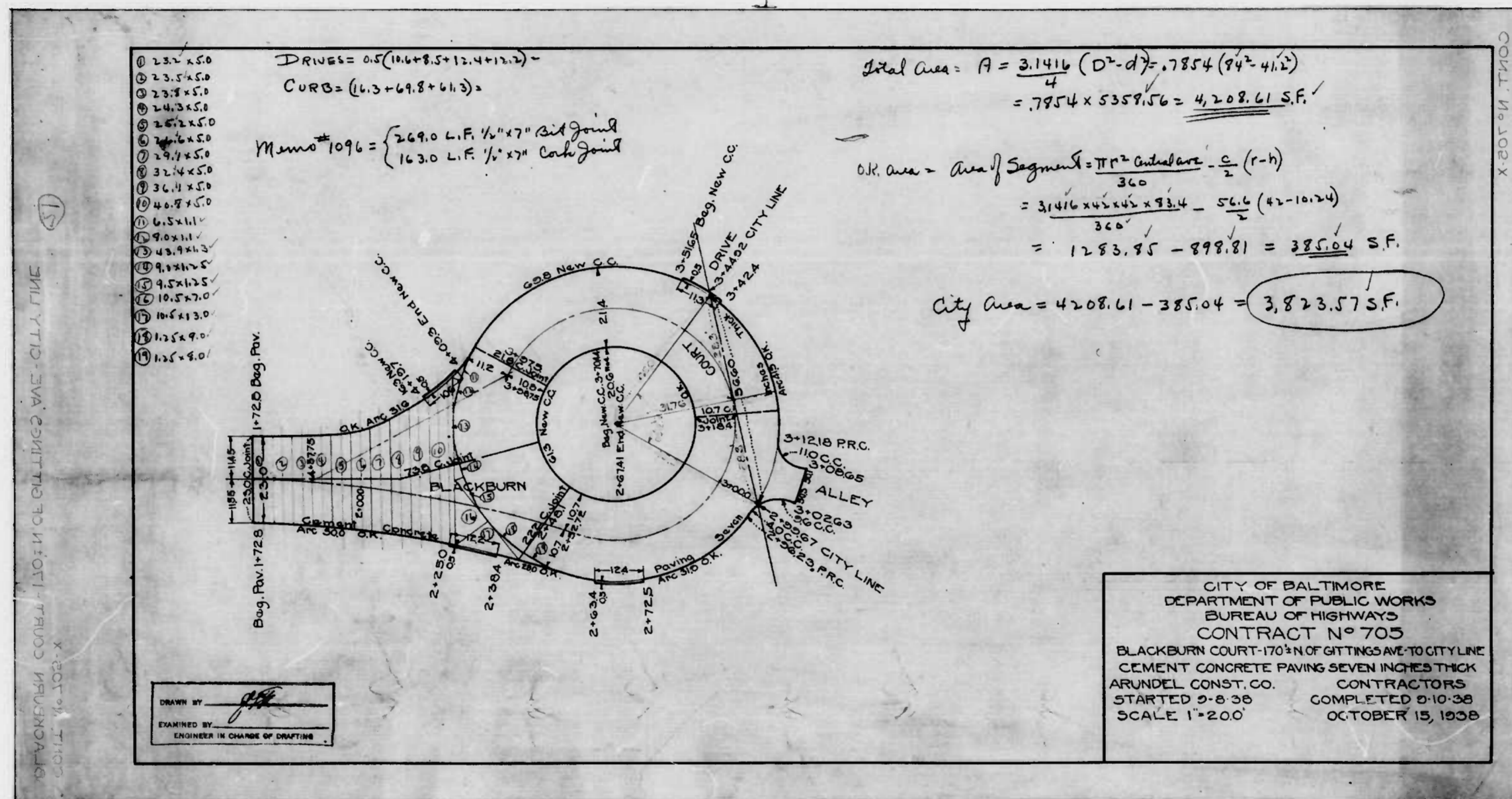

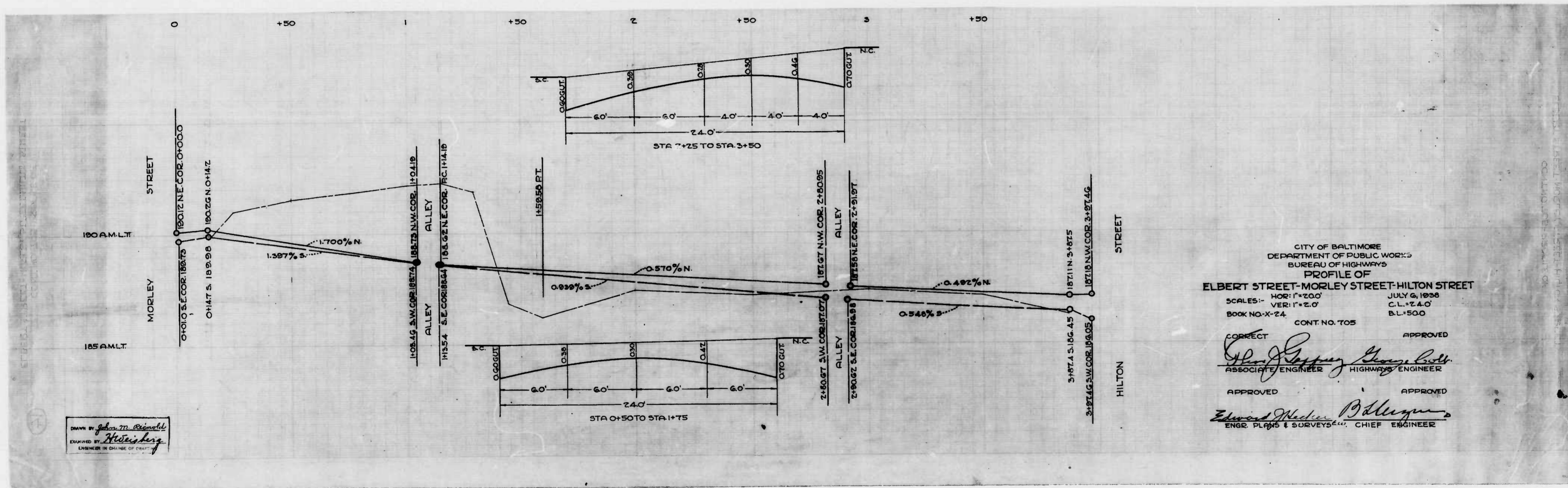

DRAWN BY *John M. Reynolds*  
 ENGINEER IN CHARGE OF DRAWING

CITY OF BALTIMORE  
 DEPARTMENT OF PUBLIC WORKS  
 BUREAU OF HIGHWAYS  
**PROFILE OF**  
**ELBERT STREET-MORLEY STREET-HILTON STREET**  
 SCALES:- HOR: 1"=20' JULY 6, 1938  
 VER: 1"=2.0' C.L.=2.4' B.L.=50.0'  
 BOOK NO.-X-24 CONT. NO. 705

CORRECT APPROVED  
*John J. Gaffney* *George Bell*  
 ASSOCIATE ENGINEER HIGHWAYS ENGINEER

APPROVED APPROVED  
*Edward Macken* *D. H. Quinn*  
 ENGR. PLANS & SURVEYS, CHIEF ENGINEER

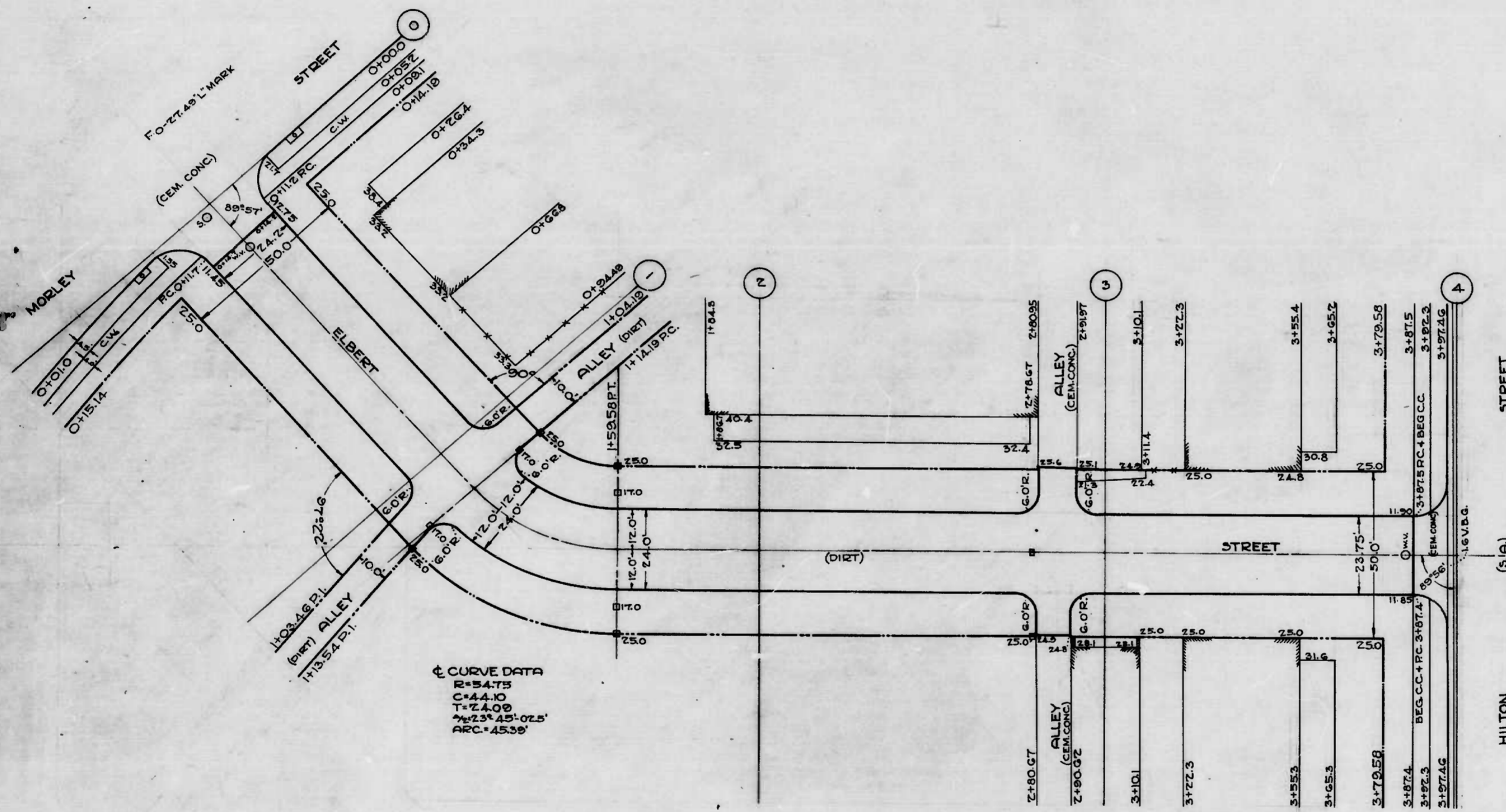

CURVE DATA  
 R=54.75  
 C=44.10  
 T=24.00  
 Δ=23°45'02.5"  
 ARC=45.38'

HILTON STREET (S.A.)  
 413751  
 41423  
 F=414386 L MARK  
 41473

CITY OF BALTIMORE  
 DEPARTMENT OF PUBLIC WORKS  
 BUREAU OF HIGHWAYS  
 PLAN OF  
 ELBERT STREET-MORLEY STREET-HILTON STREET  
 SCALE 1"=200' BOOK NO. X-24 JUNE 20, 1958  
 CONT. NO. 705

CORRECT APPROVED  
*Edmund H. ...* *Edmund H. ...*  
 ASSOCIATE ENGINEER HIGHWAYS ENGINEER  
 APPROVED APPROVED  
*Edmund H. ...* *Edmund H. ...*  
 ENGR. PLANS & SURVEYS CHIEF ENGINEER

DRAWN BY *John M. ...*  
 CHECKED BY *H. Weisberg*  
 ENGINEER IN CHARGE OF DISTRICT

FIG. 21-215-ELBERT-MORLEY-STREET-HILTON-STREET  
 CONTAINING JOB PLAN OF

35-15

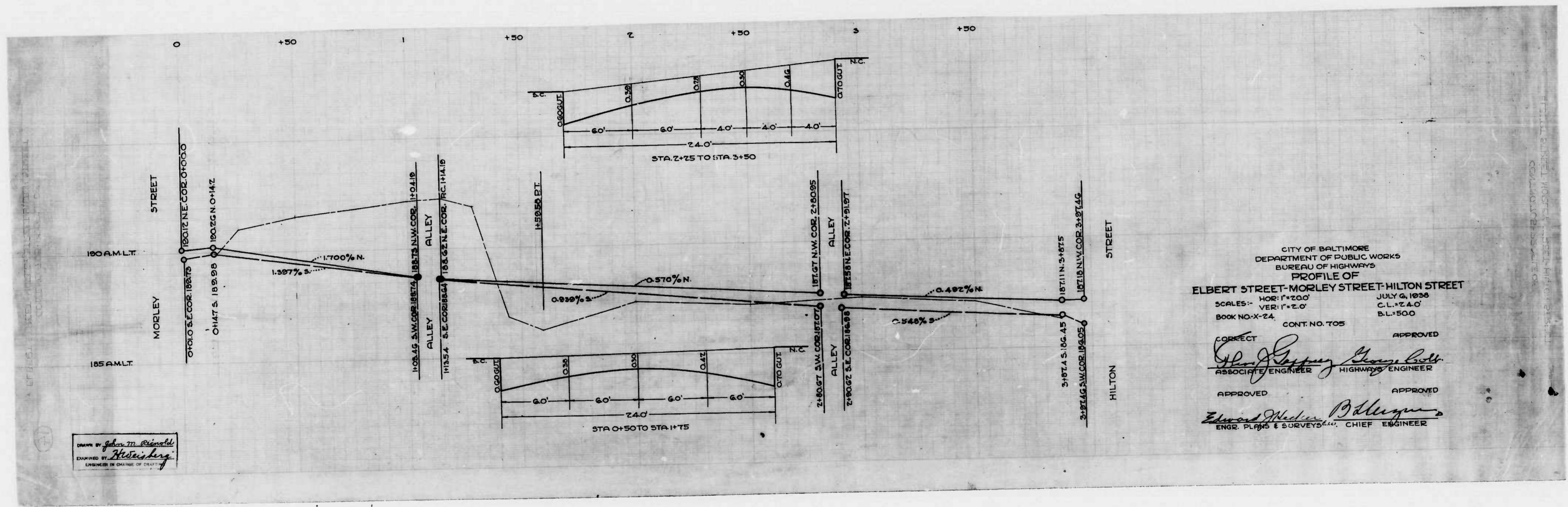

DRAWN BY *John M. Reinold*  
 EXAMINED BY *Robert Berg*  
 ENGINEER IN CHARGE OF DESIGN

CITY OF BALTIMORE  
 DEPARTMENT OF PUBLIC WORKS  
 BUREAU OF HIGHWAYS  
**PROFILE OF**  
**ELBERT STREET-MORLEY STREET-HILTON STREET**  
 SCALES: HOR: 1"=200' JULY 6, 1938  
 VER: 1"=2.0' C.L. = 24.0'  
 BOOK NO. X-24. CONT. NO. 705 B.L. = 500  
 CORRECT APPROVED  
*Robert Berg* *Charles G. Bell*  
 ASSOCIATE ENGINEER HIGHWAYS ENGINEER  
 APPROVED APPROVED  
*Edward M. ...* *...*  
 ENGR. PLANS & SURVEYS CHIEF ENGINEER

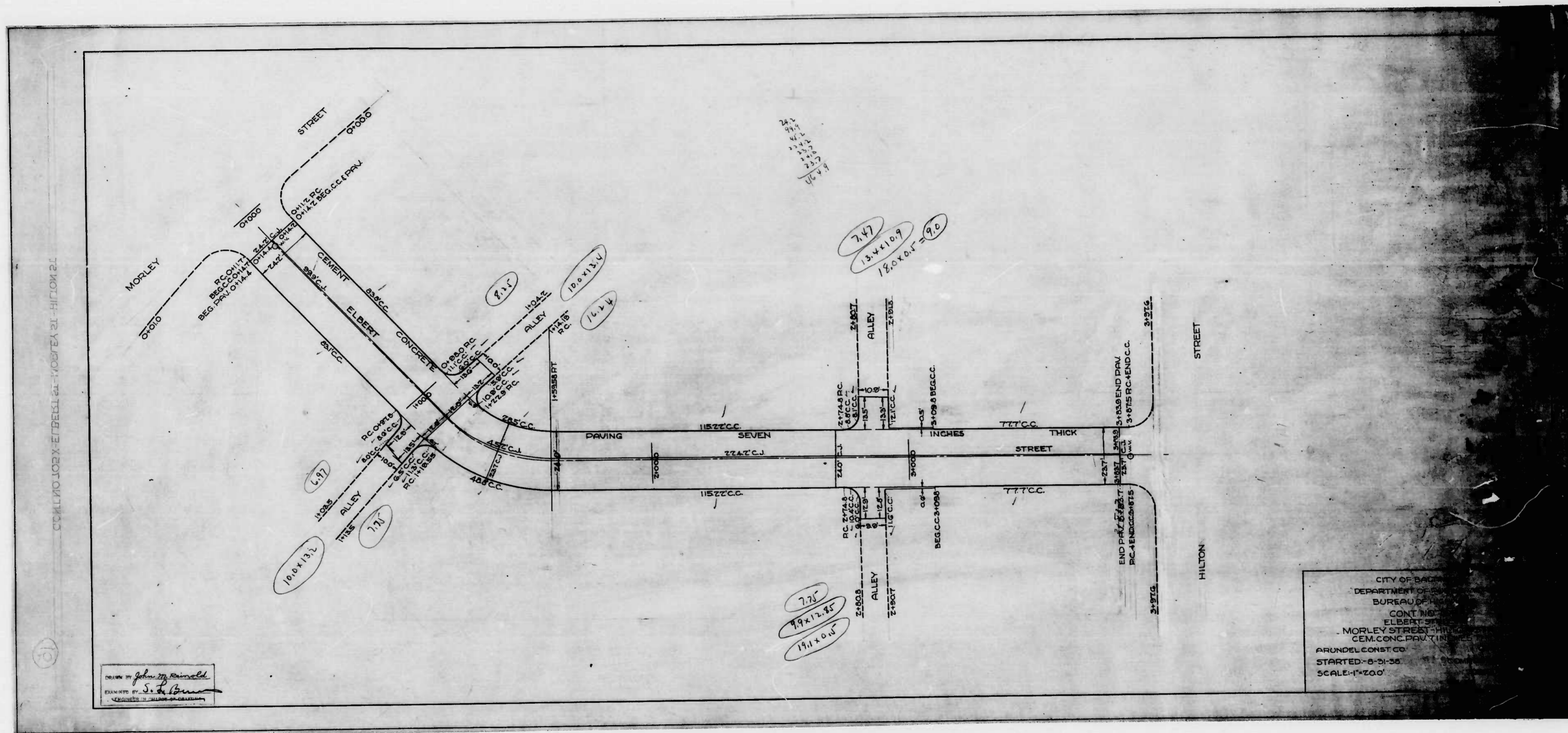

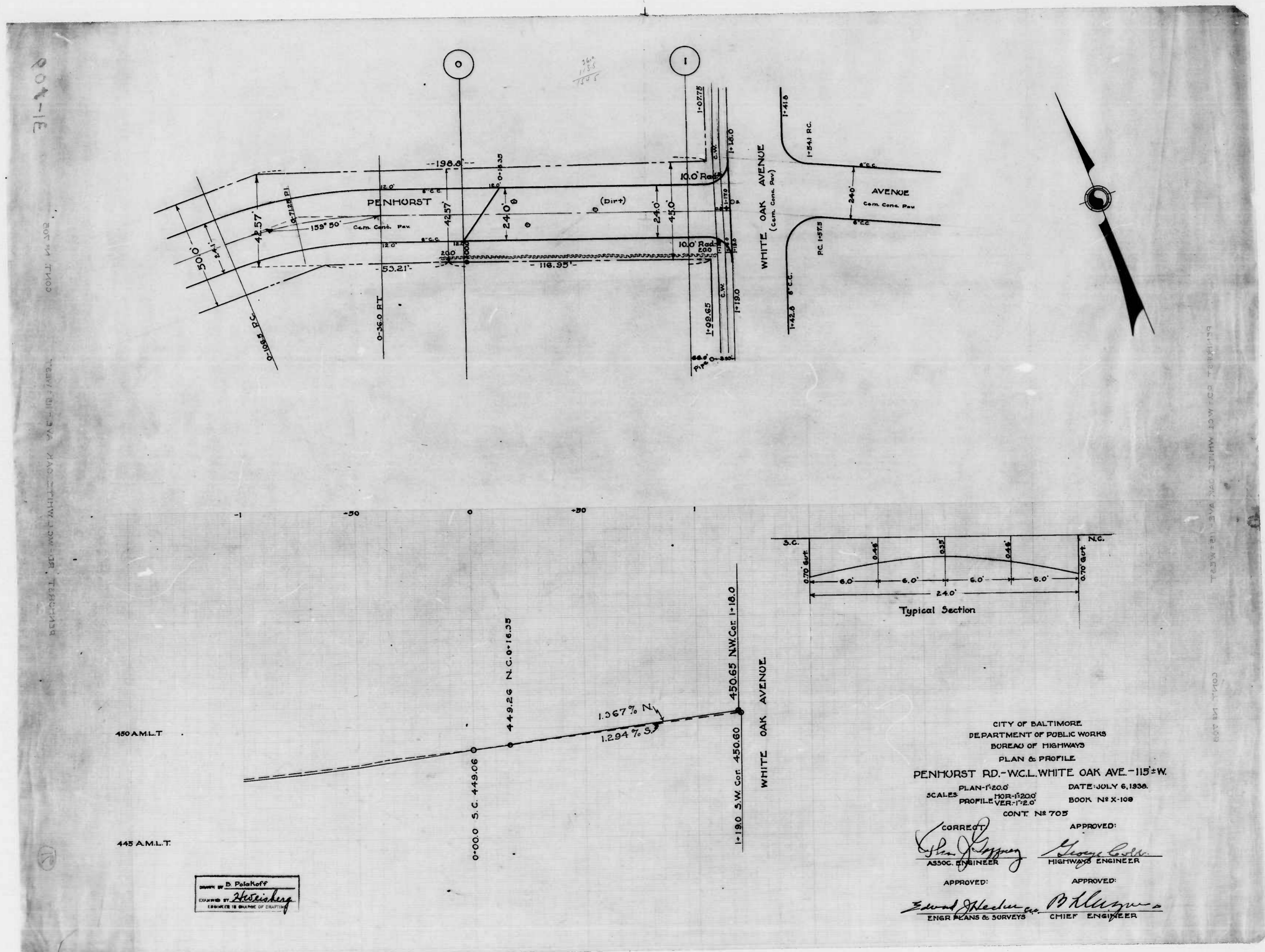

204-1E

CONTRACT NO. 117103

CONTRACT NO. 117103

