

J.H. Bernstein  
*[Signature]*

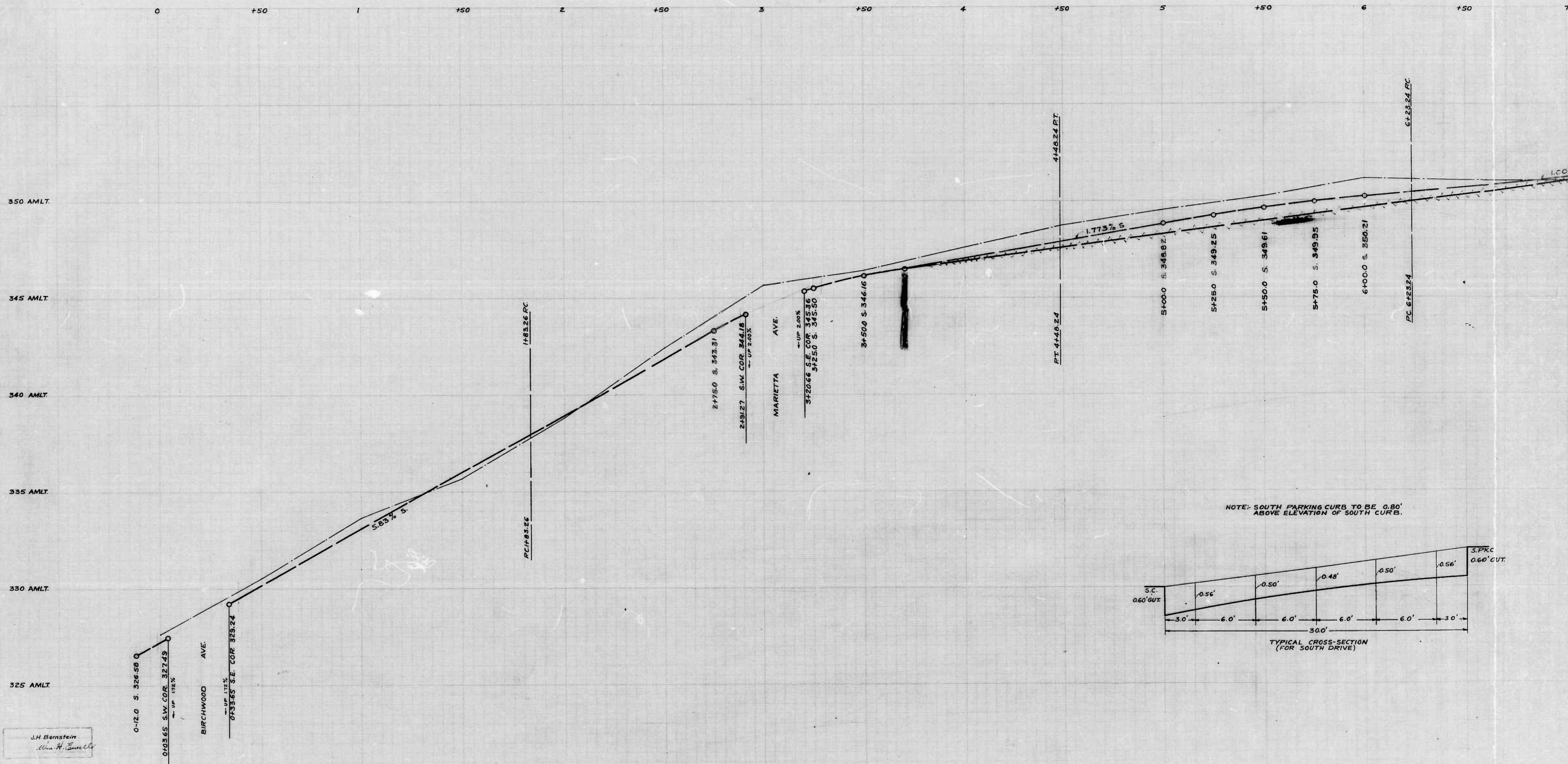

NOTE: SOUTH PARKING CURB TO BE 0.80' ABOVE ELEVATION OF SOUTH CURB.

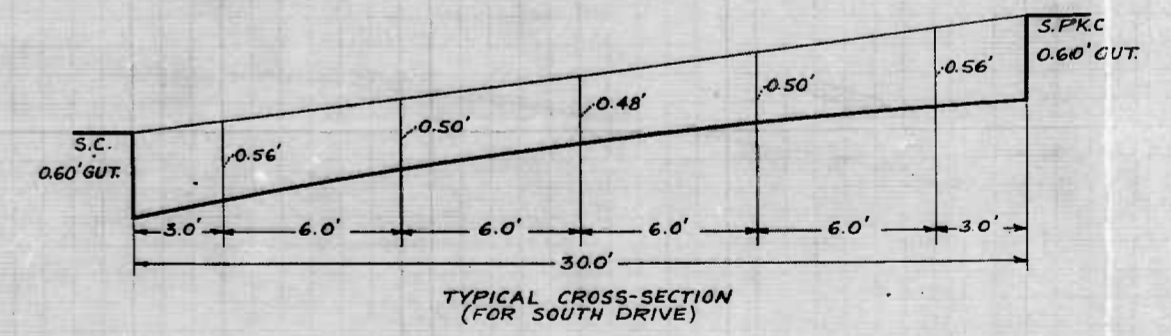

J.H. Bernstein  
Alan H. Swell

1

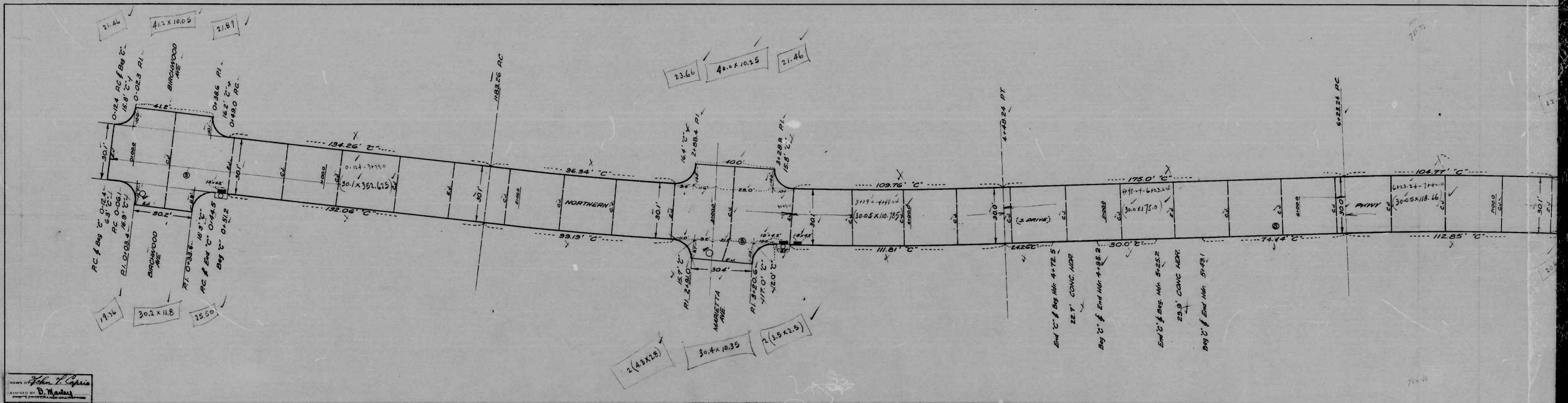

DRAWN BY *John P. Caprio*  
 CHECKED BY *D. Marley*  
 DATE: 10/1/54

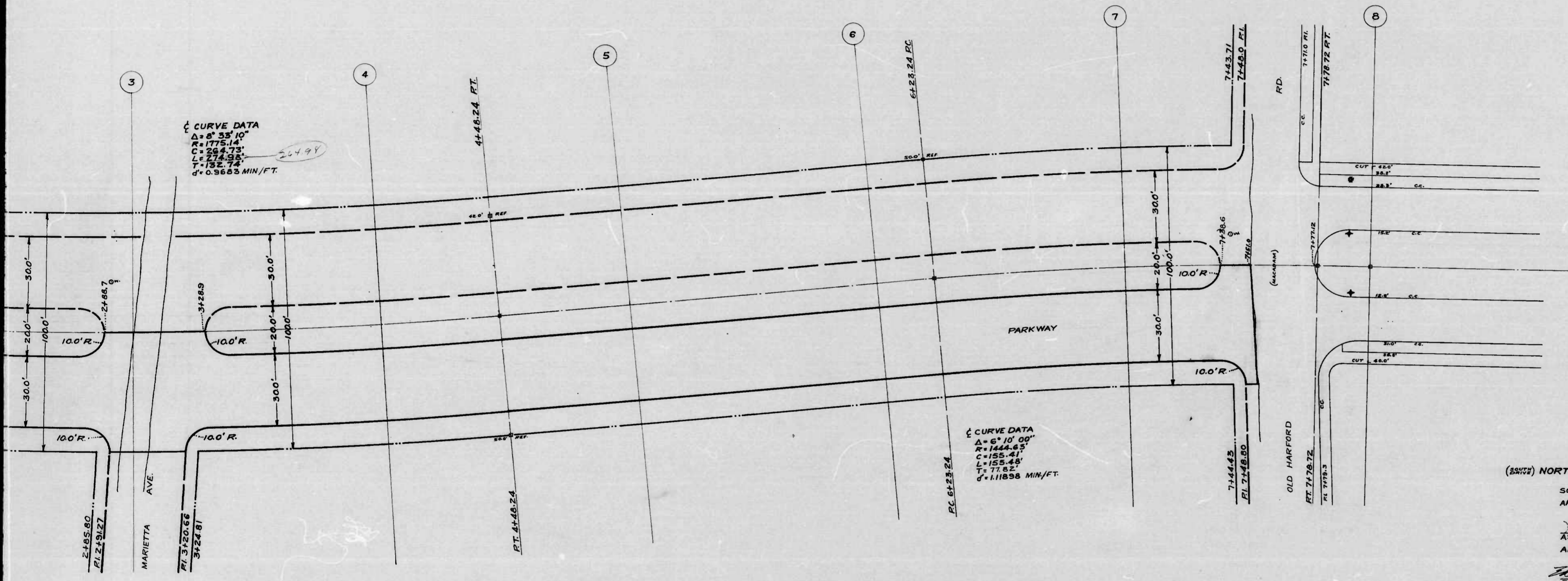

NOTE: THE SUB-GRADE AREA SHALL BE COVERED WITH A ONE (1) INCH COMPACTED LAYER OF STONE SCREENINGS.

UNDERDRAIN PIPE SHALL BE INSTALLED IF AND WHERE IT IS DEEMED NECESSARY BY THE ENGINEER.

TO BE CEM CONC. PAVING NINE (9) INCHES THICK

CITY OF BALTIMORE  
DEPARTMENT OF PUBLIC WORKS  
BUREAU OF HIGHWAYS  
PLAN OF

(SOUTH) NORTHERN PKWY - BIRCHWOOD AVE - OLD HARFORD RD.  
CONTRACT NO. 1041 AA

SCALE: 1" = 20.0' DATE: 5-15-50  
BOOK NO. X-267

APPROVED: *[Signature]* ASSOCIATE ENGINEER  
APPROVED: *[Signature]* HIGHWAYS ENGINEER  
APPROVED: *[Signature]* ENGINEER OF SURVEYS  
APPROVED: *[Signature]* DIR. OF PUBLIC WORKS

①

②

3513



NOTE: SOUTH PARKING CURB TO BE 0.80' ABOVE ELEVATION OF SOUTH CURB.

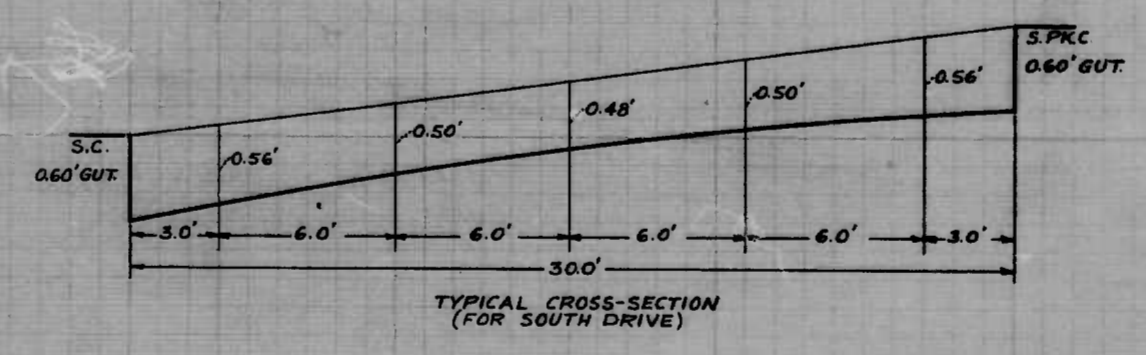

CITY OF BALTIMORE  
 DEPARTMENT OF PUBLIC WORKS  
 BUREAU OF HIGHWAYS  
 PROFILE OF  
 (S.W. 1/4) NORTHERN PKWY - BIRCHWOOD AVE - OLD HARFORD RD.  
 CONTRACT NO. 1041 AA

SCALE: HOR. - 1" = 20'  
 VER. - 1" = 2.0' BOOK NO. X-267 DATE: 5-15-50

APPROVED: *Henry Weisberg*  
 ASSOCIATE ENGINEER  
 APPROVED: *James W. L. King*  
 HIGHWAYS ENGINEER  
 APPROVED: *Edward J. Hader*  
 ENGINEER OF SURVEYS  
 APPROVED: *John W. Clark*  
 DIR. OF PUBLIC WORKS

REVISED 4-21-51

(1)

(1)

3513

5 6 7 8 9 10 11 12

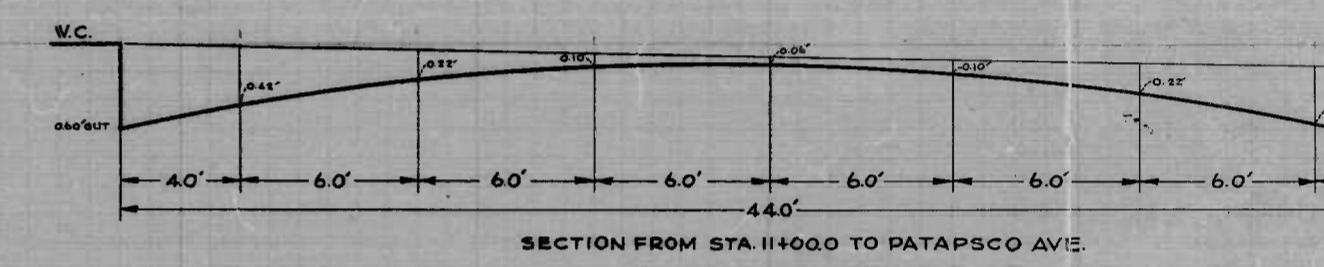
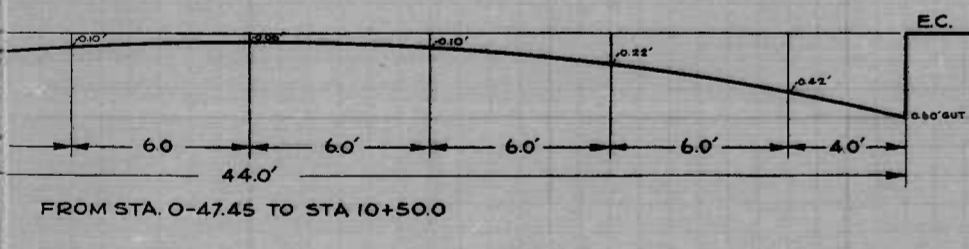
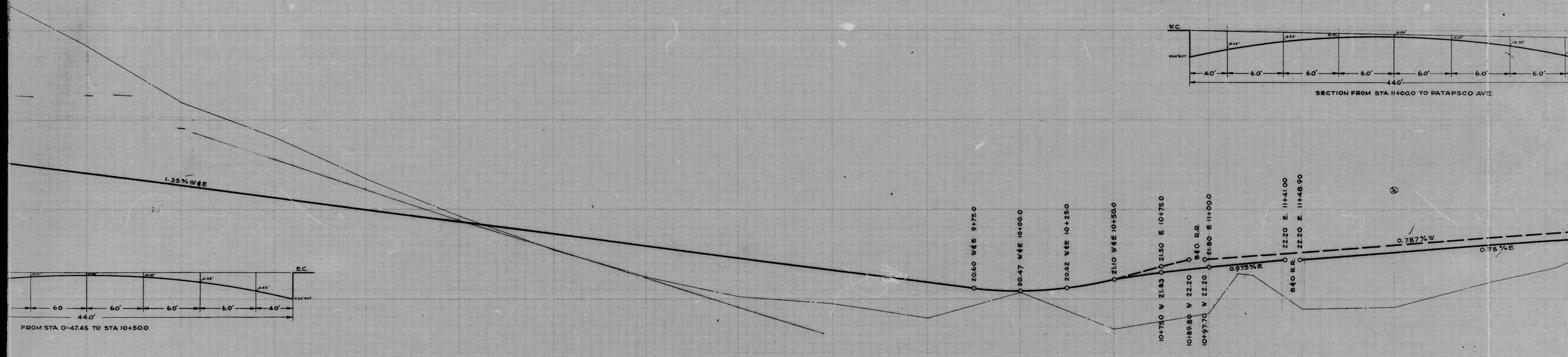

6 CURVE DATA  
Δ = 37° 41' 05"  
R = 143.80'  
C = 92.89'  
L = 94.58'  
T = 49.07'  
d = 11.9528 mi/ft

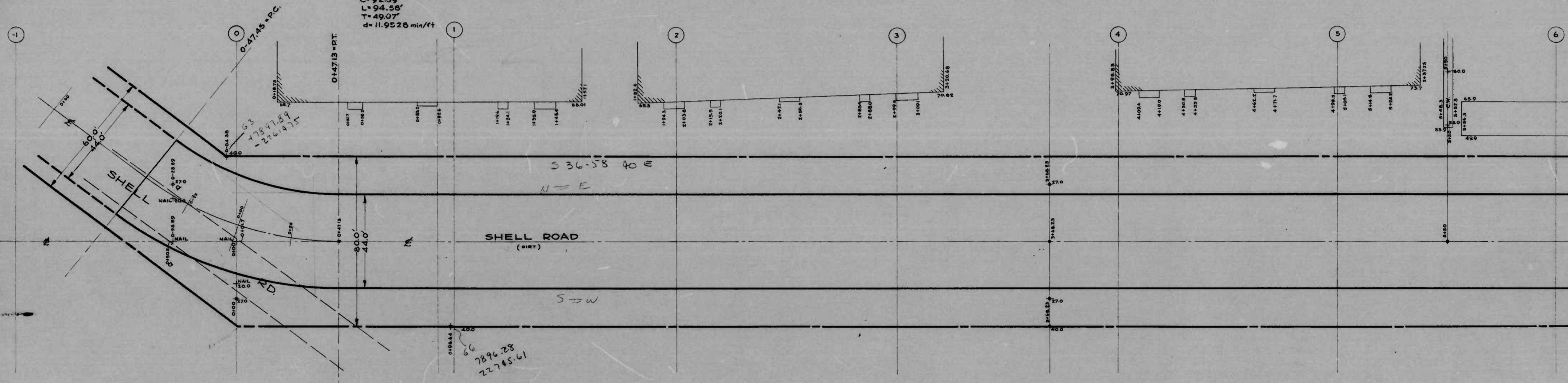

DRAWN BY JIM HOLDEN  
EXAMINED BY [Signature]  
ENGINEER IN CHARGE OF SURVEYING

①

SHEET 501 OF 501 - 10/10/77  
SACRIFICED

40 AMLT  
35 AMLT  
30 AMLT  
25 AMLT  
20 AMLT  
15 AMLT

0+47.45 = P.C.  
0+47.13 = P.T.  
31.20 W&E 0+47.45 = P.C.  
31.80 W&E 0+25.0  
32.27 W&E 0+00.0  
32.57 W&E 0+25.0  
32.69 W&E 0+47.13 = P.T.  
32.65 W&E 0+75.0  
32.42 W&E 1+00.0

DRAWN BY: JIM HILDEN  
EXAMINED BY: [Signature]  
ENGINEER IN CHARGE OF OFFICE

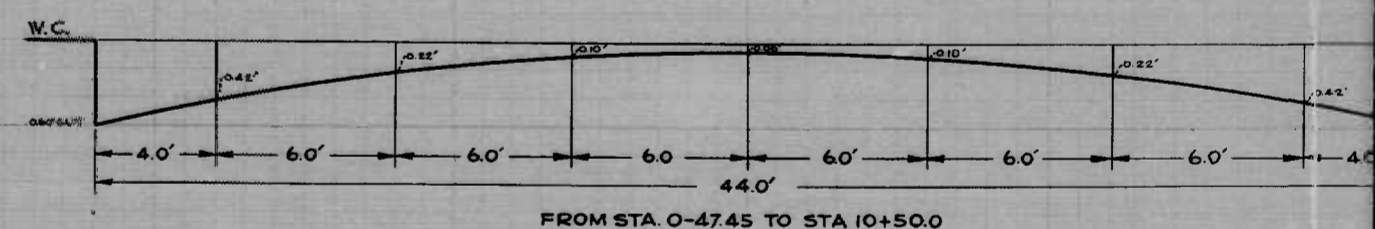

1.35% W&E



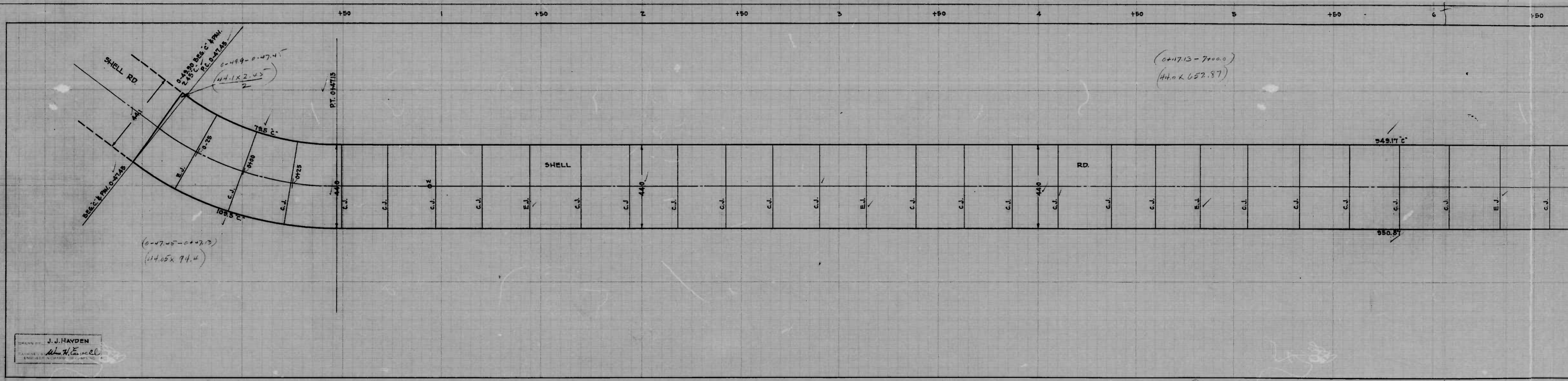

PRINTED BY THE STATE OF CALIFORNIA

J. J. HAYDEN  
W. H. G. M. C. L.

(1)

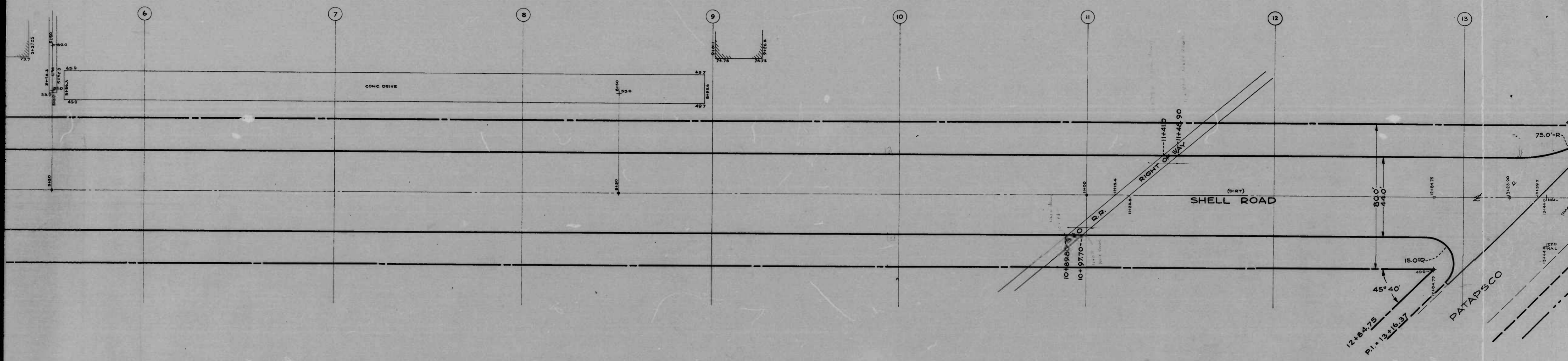

BETWEEN STA. 1+50 & STA. 4+50, THE SUB-GRADE AREA SHALL BE COVERED WITH A THREE (3) INCH COMPACTED LAYER OF SOIL STABILIZATION MATERIALS, IF AS DIRECTED BY THE ENGINEER

①

②

+50 6 +50 7 +50 8 +50 9 +50 10 +50 11 +50 12 +50 13 +50

(7+00.0 - 10+50.0)  
44.05 x 380.0

(10+30.0 - 13+38.9)  
44.1 x 253.9

349.17 c.

350.87

5+95.3 END C.  
10+03.0 BEG. C.

END C. 9+95.0  
BEG. C. 10+03.6

130.2 c.

END C. 10+85.0  
BEG. C. 11+04.3  
END C. 11+02.7  
BEG. C. 11+12.8

HES Cone @ RR  
15.45 x 44.1

11+32.2 END C.

14+52.3 BEG. C.  
15+00.0 END C.  
11+56.6 END C.  
11+65.0 BEG. C.

162.4 c.

PC 12+73.9  
PT 12+93.7

15+254 PC

54.94 + (21.4 x 21.4) / 2

(1)

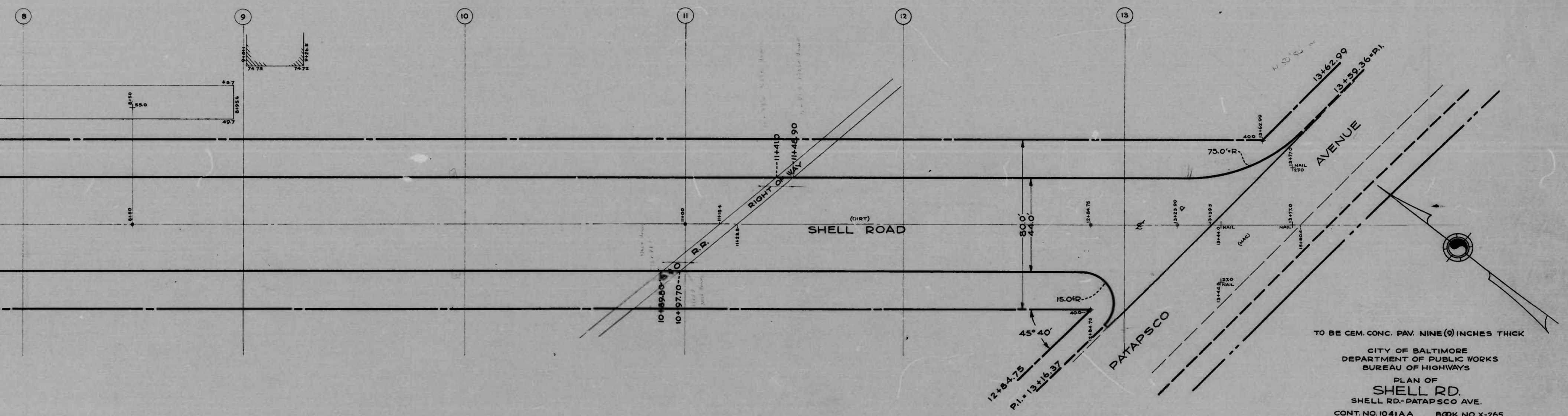

BETWEEN STA. 1+50 & STA 4+50. THE SUB-GRADE AREA SHALL BE COVERED WITH A THREE(3) INCH COMPACTED LAYER OF SOIL STABILIZATION MATERIALS, IF & AS DIRECTED BY THE ENGINEER

TO BE CEM. CONC. PAV. NINE(9) INCHES THICK  
 CITY OF BALTIMORE  
 DEPARTMENT OF PUBLIC WORKS  
 BUREAU OF HIGHWAYS  
 PLAN OF  
 SHELL RD.  
 SHELL RD.-PATAPSCO AVE.  
 CONT. NO. 1041AA    BOOK NO. X-265  
 SCALE 1"=20.0'    DATE 4-4-50  
 APPROVED    APPROVED  
*Henry Weisberg*    *James N. McKay*  
 ASSOCIATE ENGINEER    HIGHWAYS ENGINEER  
 APPROVED    APPROVED  
*Edward J. Madson*    *P. S. Hollman*  
 ENGINEER OF SURVEYS    DIRECTOR OF PUBLIC WORKS

3

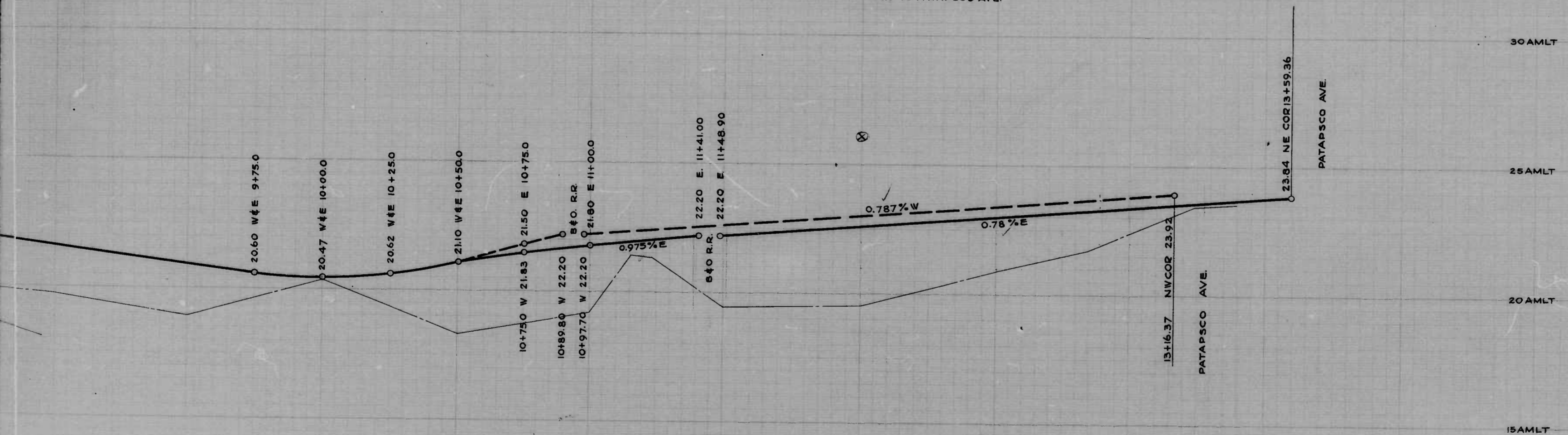
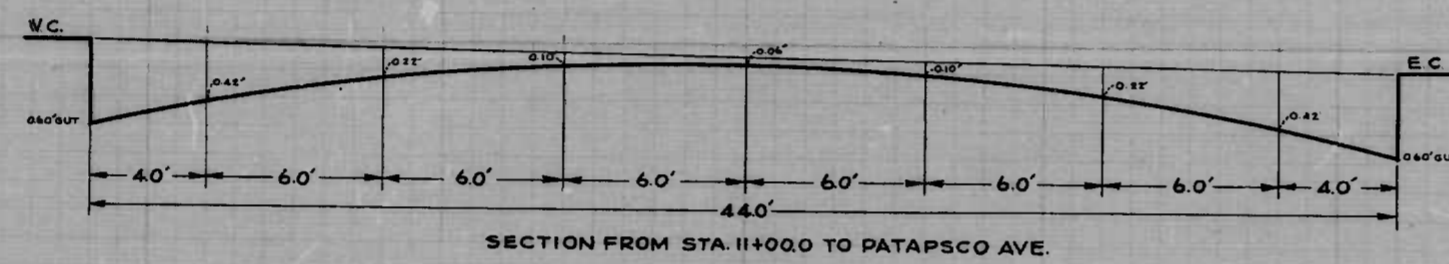

40 AMLT  
35 AMLT  
30 AMLT  
25 AMLT  
20 AMLT  
15 AMLT

CITY OF BALTIMORE  
DEPARTMENT OF PUBLIC WORKS  
BUREAU OF HIGHWAYS  
PROFILE OF  
**SHELL RD.**  
SHELL RD. - PATAPSCO AVE.  
CONT. NO. 1041 AA

SCALE HOR. 1"=20.0' VER. 1"=20.0' BOOK NO. X265 DATE APR. 4, '50

APPROVED *Henry Weisberg* ASSOCIATE ENGINEER  
APPROVED *James N. ...* HIGHWAYS ENGINEER  
APPROVED *Edmond ...* ENGINEER OF SURVEYS  
APPROVED *...* DIRECTOR OF PUBLIC WORKS

3

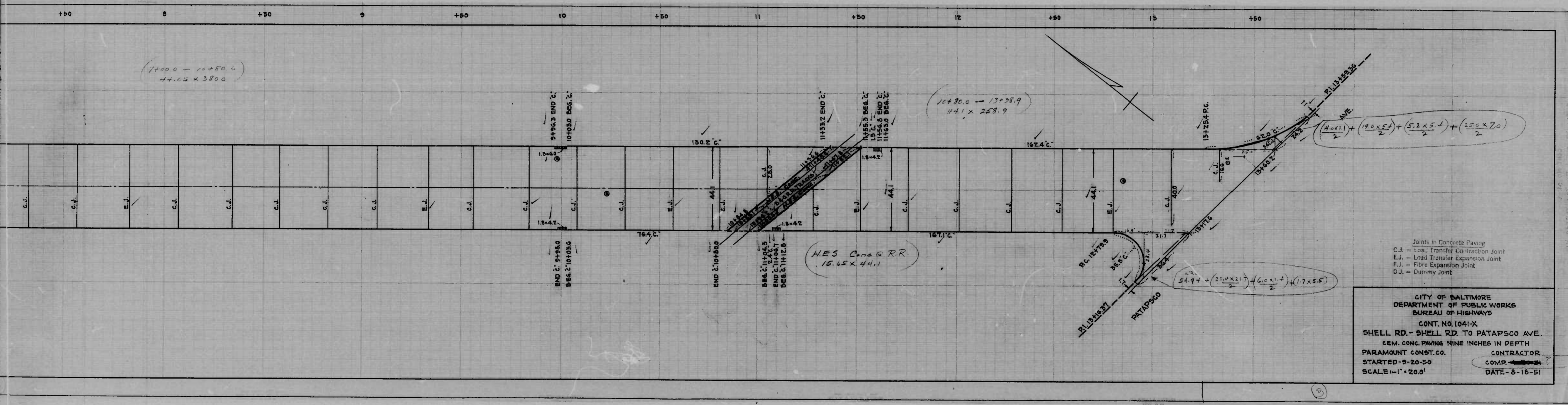

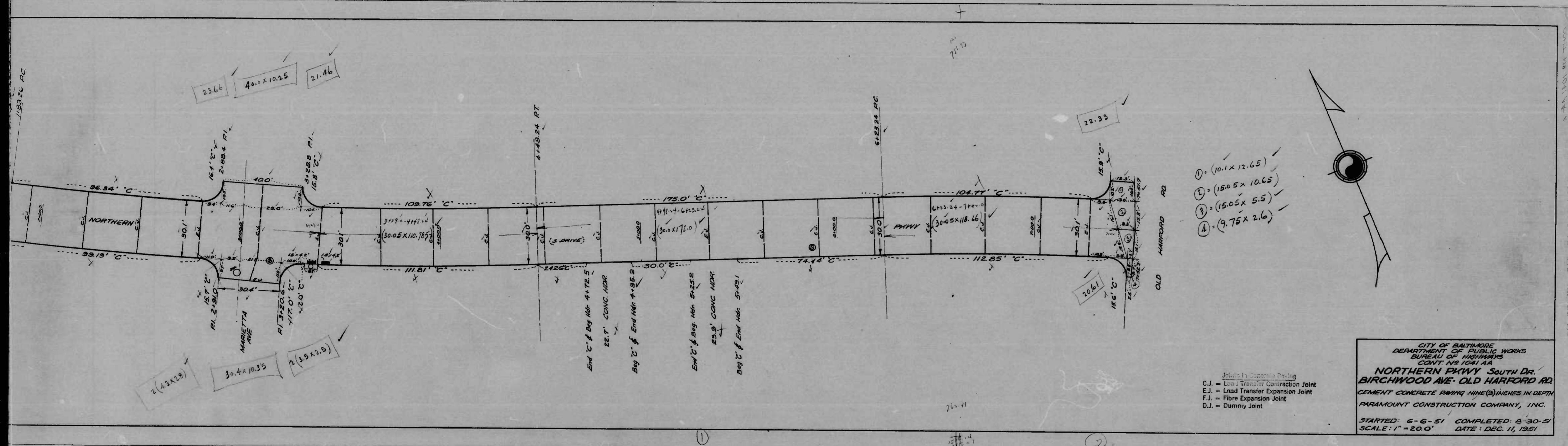

- ① = (10.1 x 12.65)
- ② = (15.05 x 10.65)
- ③ = (15.05 x 5.5)
- ④ = (9.75 x 2.6)

Joints in Concrete Paving  
 C.J. = Load Transfer Contraction Joint  
 E.J. = Load Transfer Expansion Joint  
 F.J. = Fibre Expansion Joint  
 D.J. = Dummy Joint

CITY OF BALTIMORE  
 DEPARTMENT OF PUBLIC WORKS  
 BUREAU OF HIGHWAYS  
 CONT NO 1041 AA  
**NORTHERN PKWY South Dr.**  
**BIRCHWOOD AVE- OLD HARFORD RD.**  
 CEMENT CONCRETE PAVING NINE(9) INCHES IN DEPTH  
 PARAMOUNT CONSTRUCTION COMPANY, INC.  
 STARTED: 6-6-51 COMPLETED: 8-30-51  
 SCALE: 1" = 20.0' DATE: DEC. 11, 1951