

DESIGNED BY
C.V. Walters
CHECKED BY
H. H. Connel

CITY OF BALTIMORE
DEPARTMENT OF PUBLIC WORKS
BUREAU OF HIGHWAYS
CONT. NO. 1025
AISQUITH ST. - 25TH ST. - 125TH N. EXETER HALL AVE.
EXETER HALL AVE. - ROBB ST. - AISQUITH ST.
S.A. PAV. (1) ONE INCH WEARING SUR. (1) ONE INCH
BINDER ON CEM. CONC. PAV. EIGHT (8) INCHES IN DEPTH
AMERICAN PAV. & CONT. CO. CONTRACTOR
STARTED: 3-18-52 COMP. : 5-14-52
SCALE: 1" = 20.0' DATE: 6-18-52

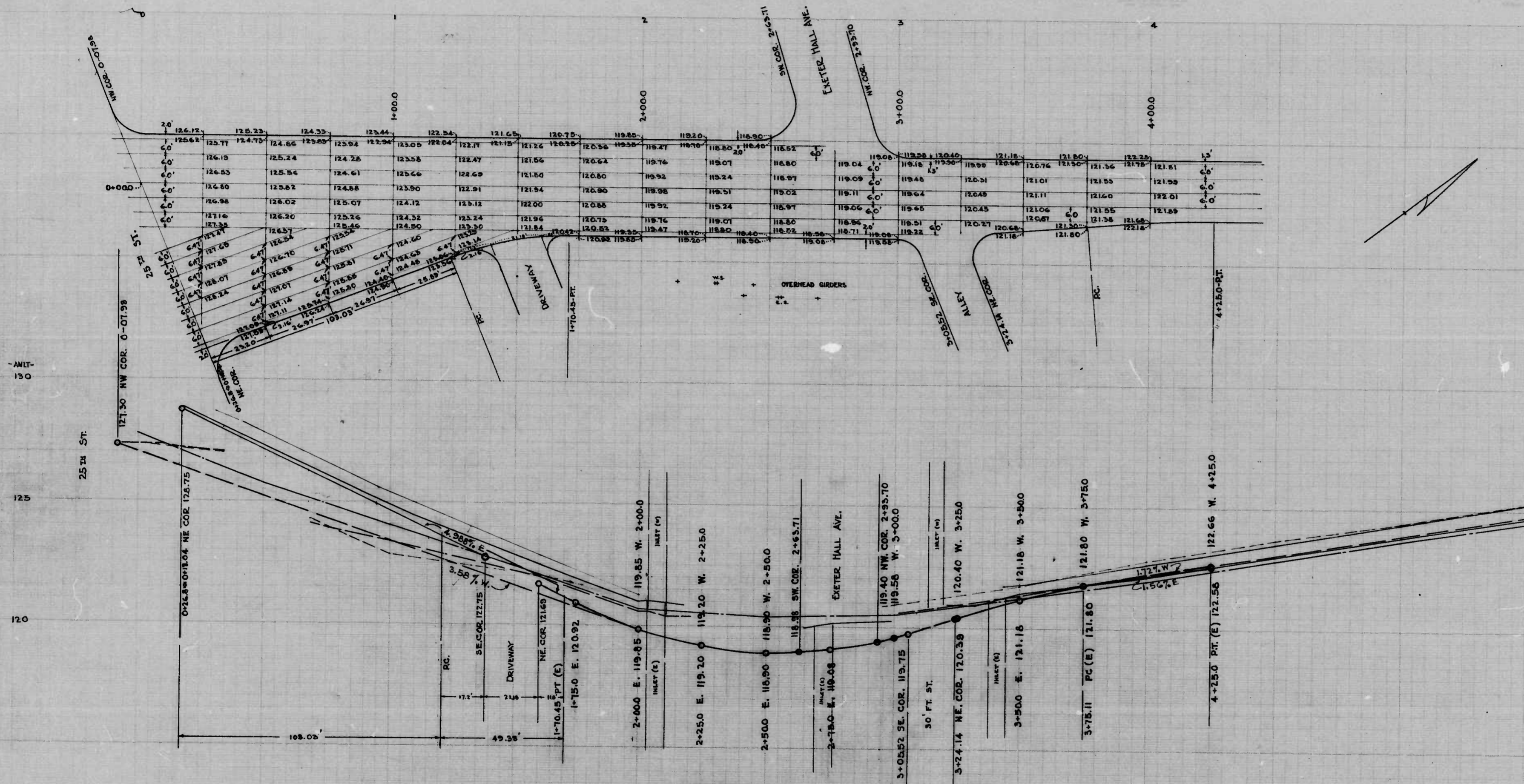

CITY OF BALTIMORE
 DEPARTMENT OF PUBLIC WORKS
 BUREAU OF HIGHWAYS
 PROFILE
 AISQUITH ST. - 25TH ST. - 125TH N. EXETER HALL AVE.
 CONT-1025

SCALES HOR. 1" = 200'
 VER. 1" = 2.0'

BOOK X-266
 OCT. 7, 1949
 REVISED FEB 15, 1950

APPROVED-

Henry Weisberg
 ASSOCIATE ENGINEER

James H. Van...
 HIGHWAYS ENGINEER

APPROVED-

Edward M. Hester
 ENGR. OF SURVEYS

APPROVED-

P. J. Williams
 DIRECTOR OF PUBLIC WORKS

DRAWN BY *Eugene...*
 EXAMINED BY *W. H. ...*
 PROJECT ENGINEER

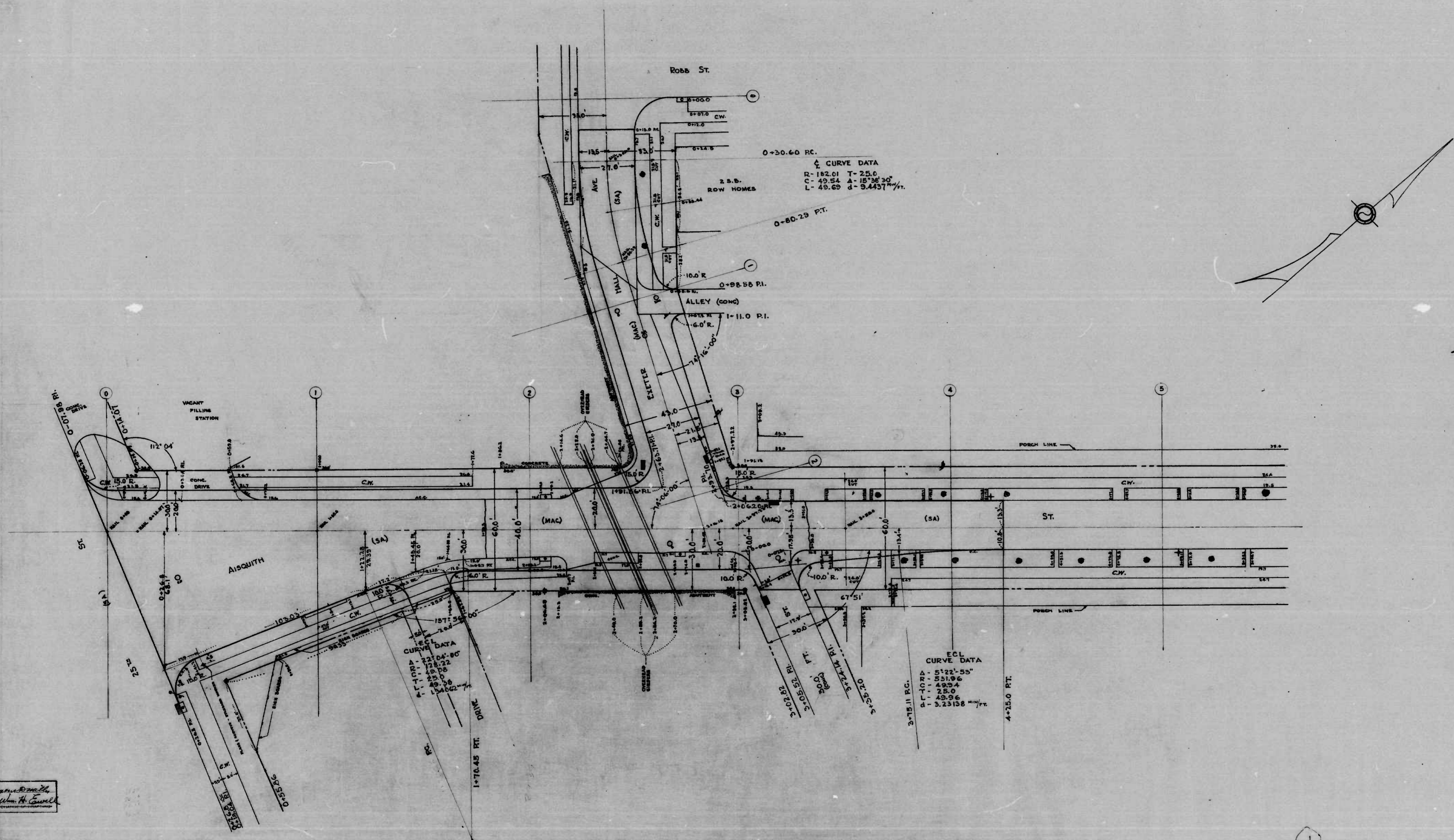

NOTE: TO BE SHEET ASPHALT PAVING (1) ON SURFACE (1) ONE INCH BINDER, ON PAVING, EIGHT (8) INCHES IN DEPT SIX (6) INCHES OF SOIL STABILIZER UNDERDRAIN SHALL BE REQUIRED DIRECTED BY THE ENGINEER.

CITY OF BALTIMORE
DEPARTMENT OF PUBLIC
BUREAU OF HIGHWAY
-PLAN OF-
AISQUITH ST - 25TH ST - 125TH N. E.
EXETER HALL AVE - ROBB ST - A
SCALE 1"=200'
SEPT. 30, 1948
REVISED FEB 15, 1950

APPROVED -
Henry Heiberg
ASSOCIATE ENGINEER

APPROVED -
Edward Hecker
ENGINEER OF SURVEYS

Drawn by *Eugene Powell*
Checked by *Wm. H. Caswell*

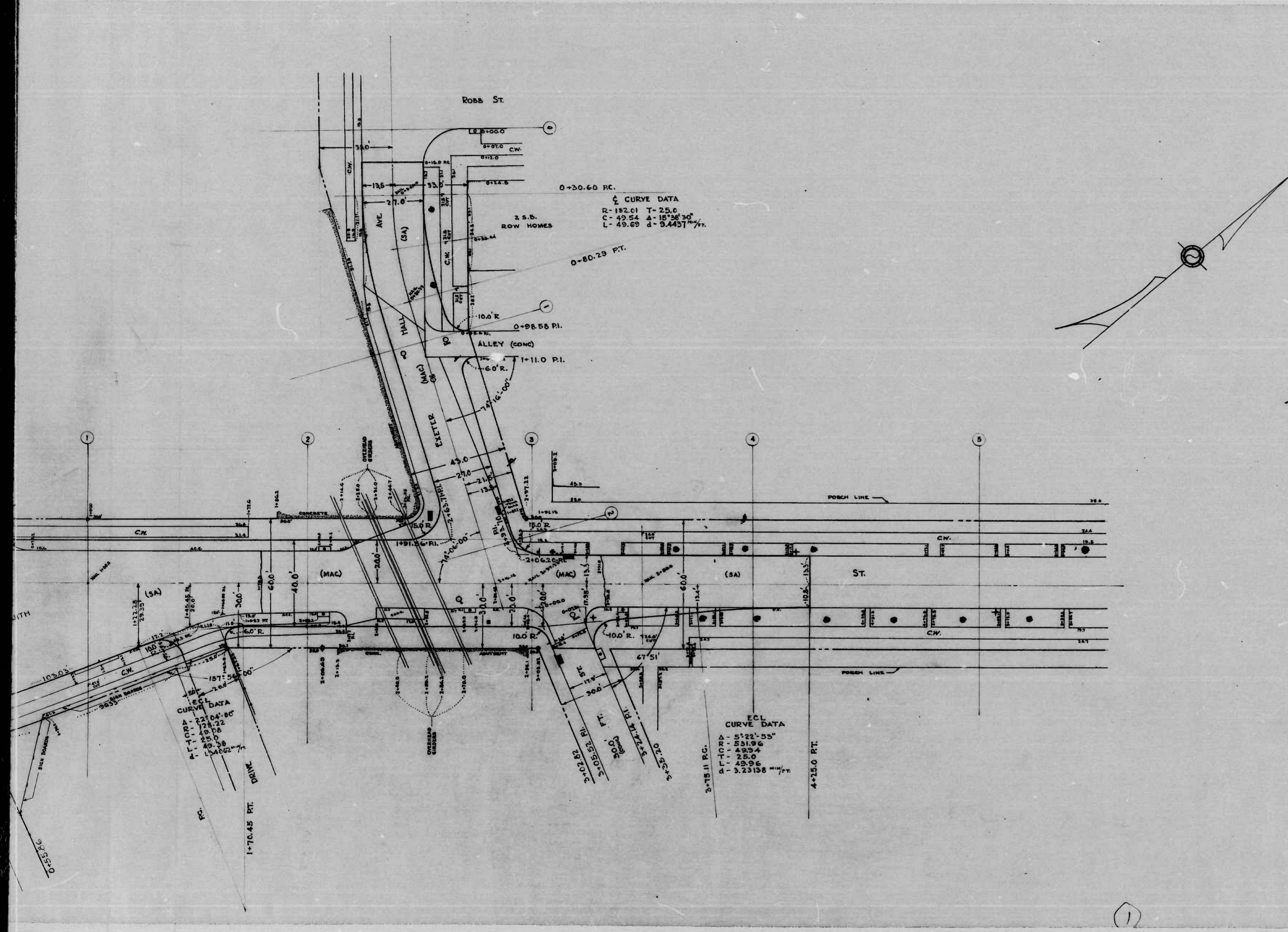

NOTE: TO BE SHEET ASPHALT PAVING (1) ONE INCH WEARING SURFACE (1) ONE INCH DINDER, ON CEMENT CONCRETE PAVING, EIGHT (8) INCHES IN DEPTH.

SIX (6) INCHES OF SOIL STABILIZATION AND/OR UNDERDRAIN SHALL BE REQUIRED IF AND WHERE DIRECTED BY THE ENGINEER.

CITY OF BALTIMORE
DEPARTMENT OF PUBLIC WORKS
BUREAU OF HIGHWAYS

PLAN
AISQUITH ST. - 25TH ST. - 125TH N. EXETER HALL AVE.
EXETER HALL AVE. - ROBB ST. - AISQUITH ST.
SCALE 1"=200
SEPT. 30, 1949
REVISED FEB 15, 1950

APPROVED -
Henry Weisberg
ASSOCIATE ENGINEER

APPROVED -
James M. ...
HIGHWAYS ENGINEER

APPROVED -
Edward ...
ENGR. OF SURVEYS

APPROVED -
Ed ...
DIR. OF PUBLIC WORKS

1

2