

1 CURVE DATA
R=65.0'
L=102.10'
C=91.92'
Δ=45°00'-00"
d=26.445 min/ft

2 CURVE DATA
R=225.0'
L=185.61'
C=180.48'
Δ=23°38'-40"
d=7.643266 min/ft

CONTRACT NO. 100-1001-1000-01

DRAWN BY: JIM HOLDEN JR.
EXAMINED BY: [Signature]
CHECKED BY: [Signature]

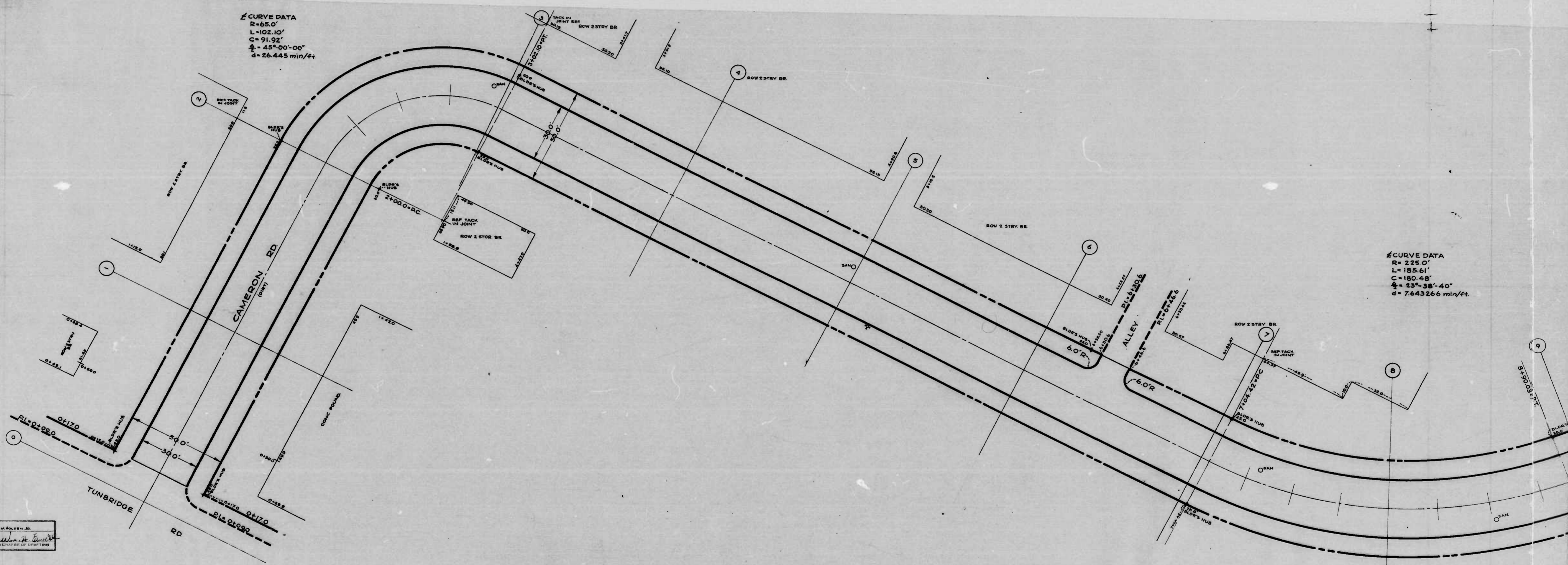

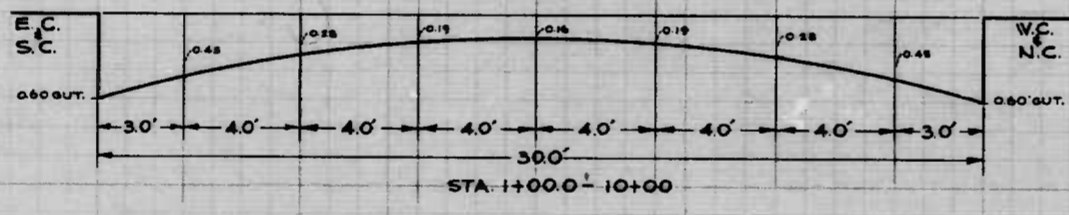
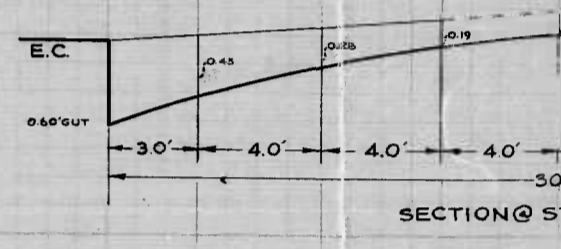
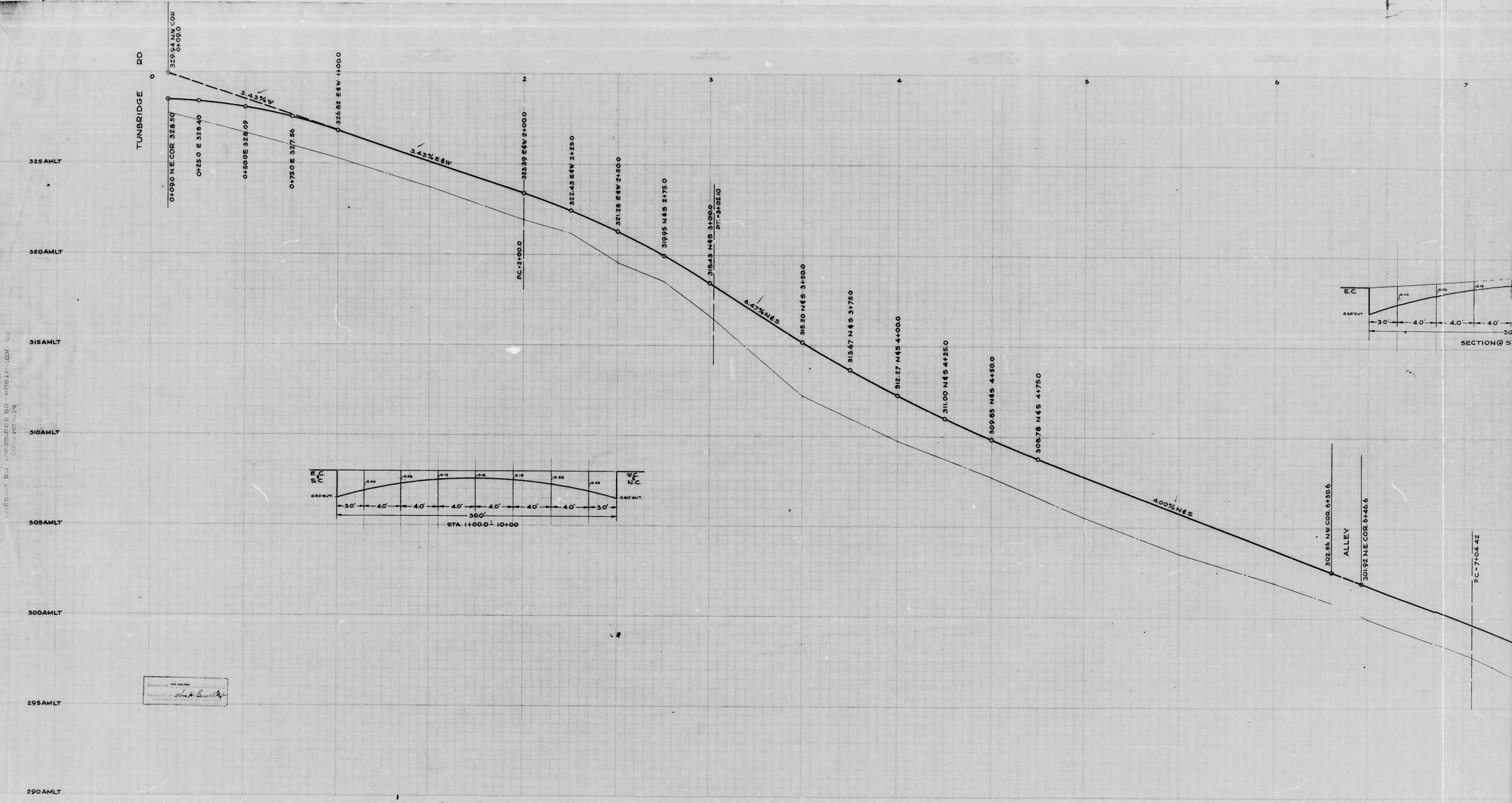

DRAWN BY
 CHECKED BY
 DATE
 PROJECT NO.

PC+7+04.42

1

CAMERON RD - TUNBRIDGE RD - MOBILWOOD DIS
CONT. 1034 X

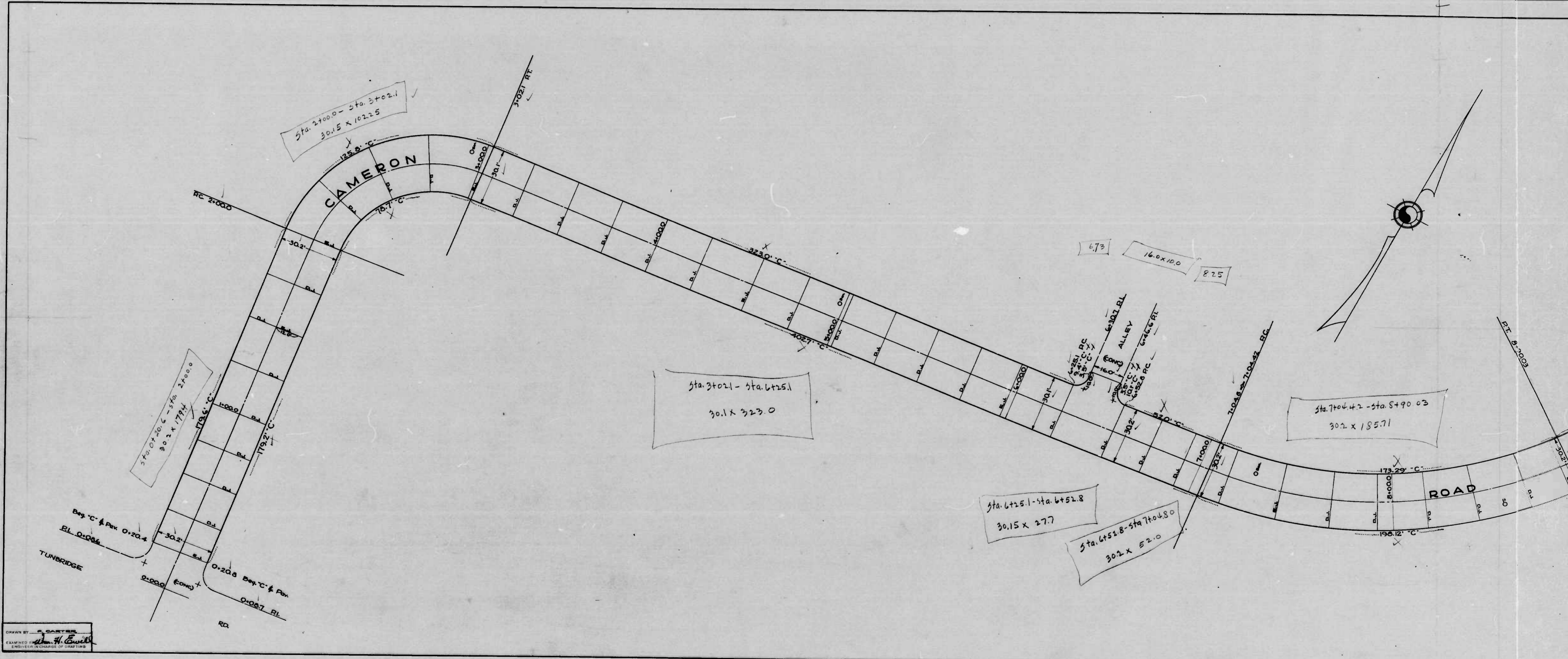

47
DRAWN BY: S. CARTER
EXAMINED BY: D. H. Egan
ENGINEER IN CHARGE OF DRAWING

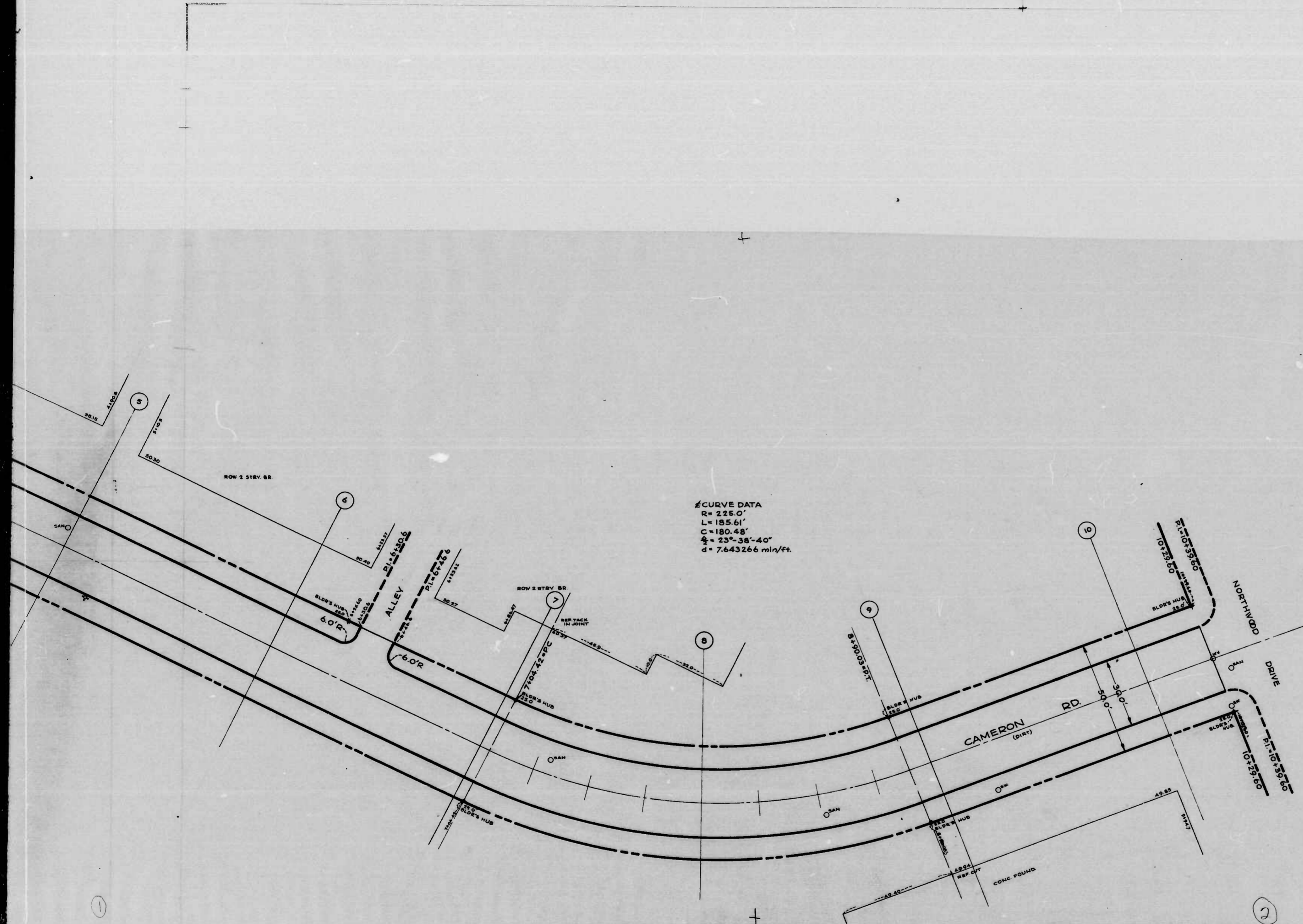

CURVE DATA
 R = 225.0'
 L = 185.61'
 C = 180.48'
 $\Delta = 23^{\circ}-38'-40''$
 d = 7.643266 min/ft.

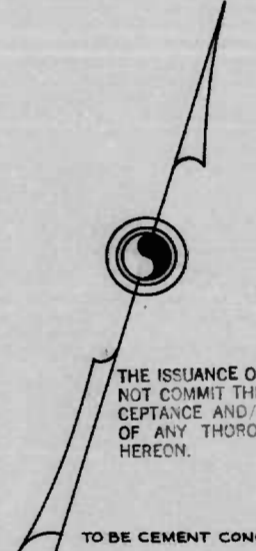

THE ISSUANCE OF THIS PLAN DOES
 NOT COMMIT THE CITY TO THE AC-
 CEPTANCE AND/OR IMPROVEMENT
 OF ANY THOROUGHFARE SHOWN
 HEREON.

TO BE CEMENT CONCRETE PAVING SEVEN(7) IN. THICK
 SOIL STABILIZATION MATERIALS
 AND/OR UNDERDRAINS ARE NOT
 REQUIRED.

CITY OF BALTIMORE
 DEPARTMENT OF PUBLIC WORKS
 BUREAU OF HIGHWAYS
 PLAN OF
 CAMERON RD-TUNBRIDGE RD-NORTHWOOD DRIVE

CONT NO. 1024
 SCALE: 1" = 20.0'

BOOK NO. X263
 DATE: 2-6-50

APPROVED
Henry Meister
 ASSOCIATE ENGINEER

APPROVED
James H. DeLong
 HIGHWAYS ENGINEER

APPROVED
Edward Meeker
 ENGINEER OF SURVEYS C.E.

APPROVED
P. J. Williams
 DIRECTOR OF PUBLIC WORKS

CIVIL ENGINEER - REGISTERED PROFESSIONAL ENGINEER - NO. 12345

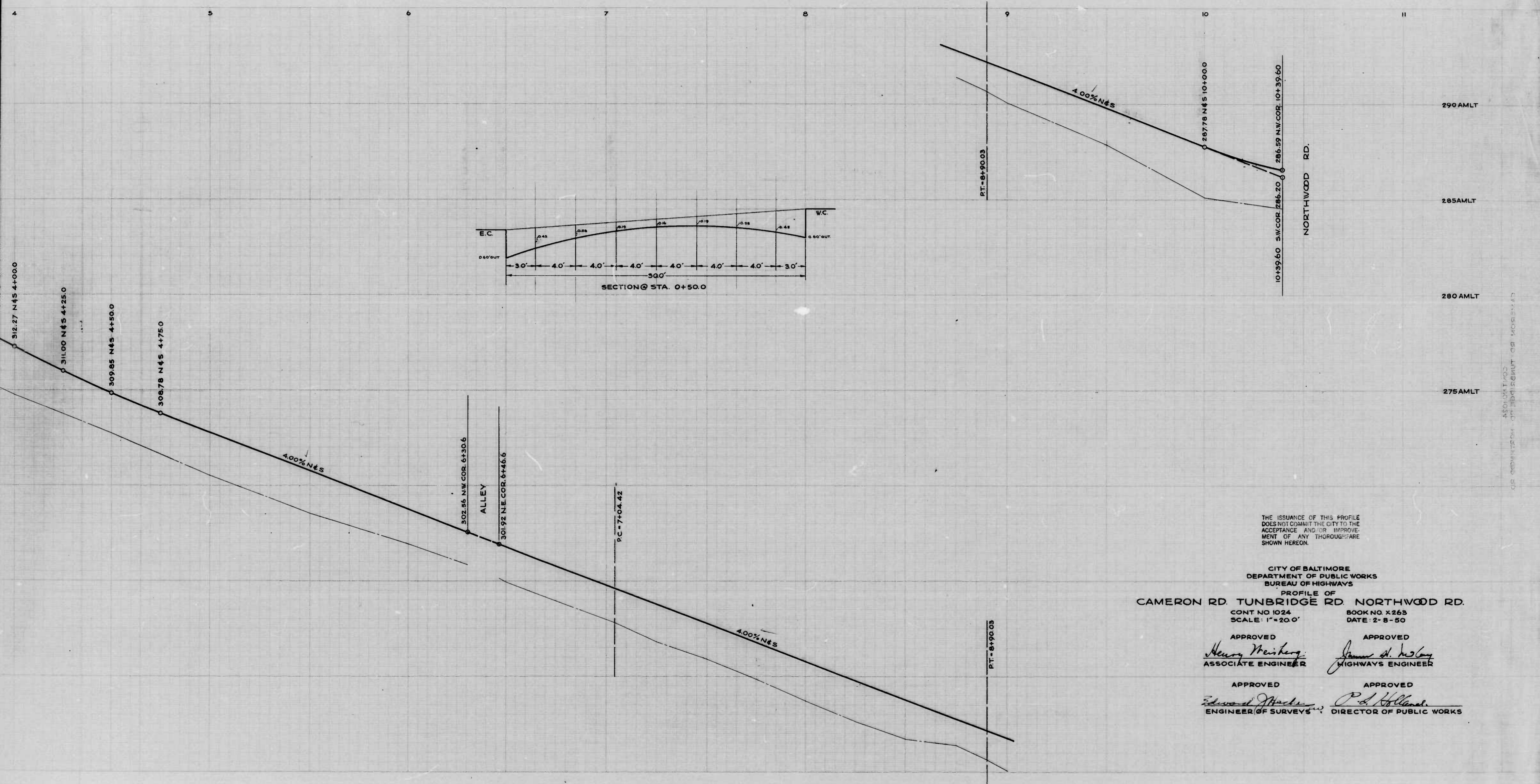

THE ISSUANCE OF THIS PROFILE DOES NOT COMMIT THE CITY TO THE ACCEPTANCE AND/OR IMPROVEMENT OF ANY THOROUGHFARE SHOWN HEREON.

CITY OF BALTIMORE
 DEPARTMENT OF PUBLIC WORKS
 BUREAU OF HIGHWAYS
 PROFILE OF
 CAMERON RD. TUNBRIDGE RD. NORTHWOOD RD.

CONT NO 1024 BOOK NO X263
 SCALE: 1"=20.0' DATE: 2-8-50

APPROVED
Henry Weiskopf
 ASSOCIATE ENGINEER

APPROVED
James H. McCarty
 HIGHWAYS ENGINEER

APPROVED
Edward H. Hickey
 ENGINEER OF SURVEYS

APPROVED
P. H. Hollander
 DIRECTOR OF PUBLIC WORKS

①

②

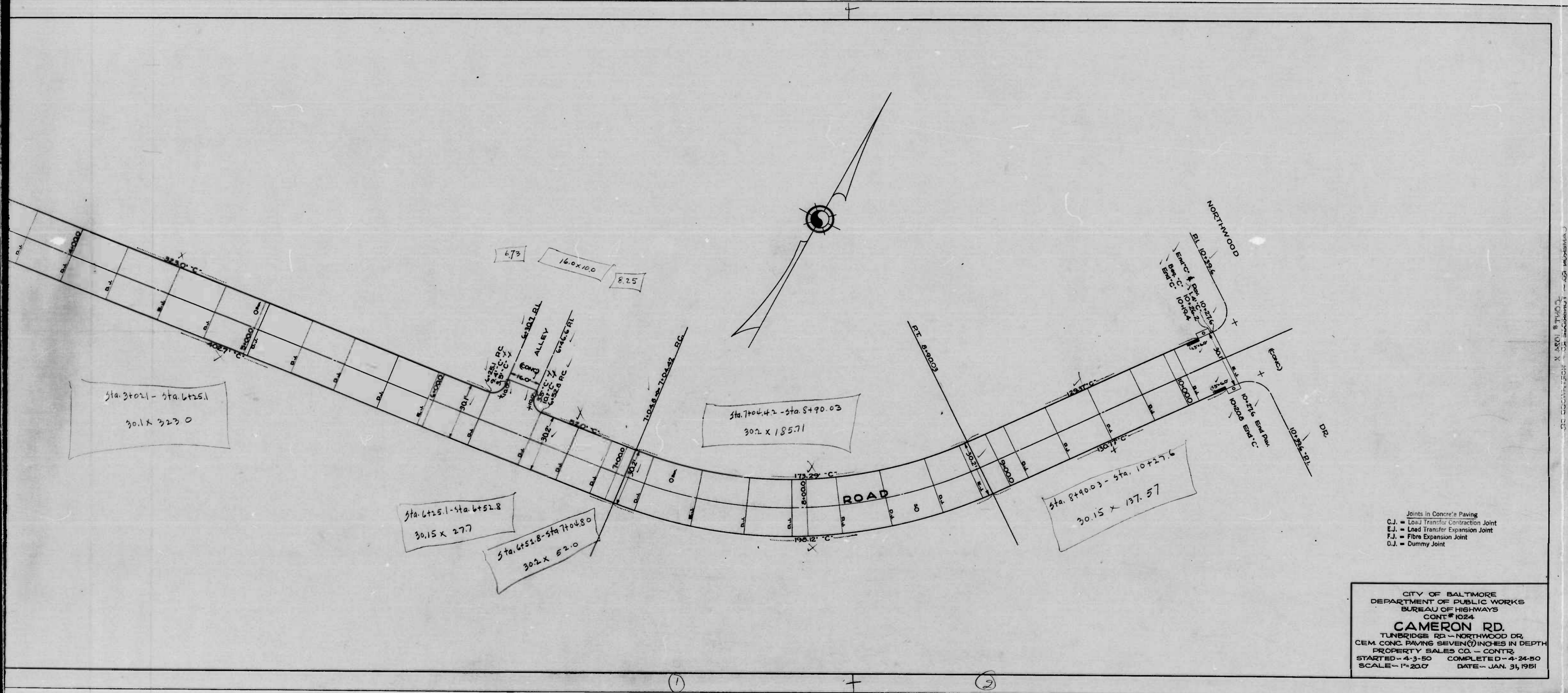

Joints in Concrete Paving
 C.J. - Load Transfer Contraction Joint
 E.J. - Load Transfer Expansion Joint
 F.J. - Fibre Expansion Joint
 D.J. - Dummy Joint

CITY OF BALTIMORE
 DEPARTMENT OF PUBLIC WORKS
 BUREAU OF HIGHWAYS
 CONT # 1024
CAMERON RD.
 TUNBRIDGE RD - NORTHWOOD DR.
 CEM. CONC. PAVING SEVEN (7) INCHES IN DEPTH
 PROPERTY SALES CO. - CONTR.
 STARTED - 4-3-50 COMPLETED - 4-24-50
 SCALE - 1"=20.0' DATE - JAN. 31, 1951

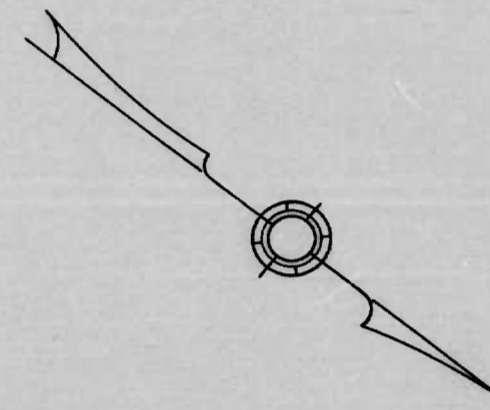
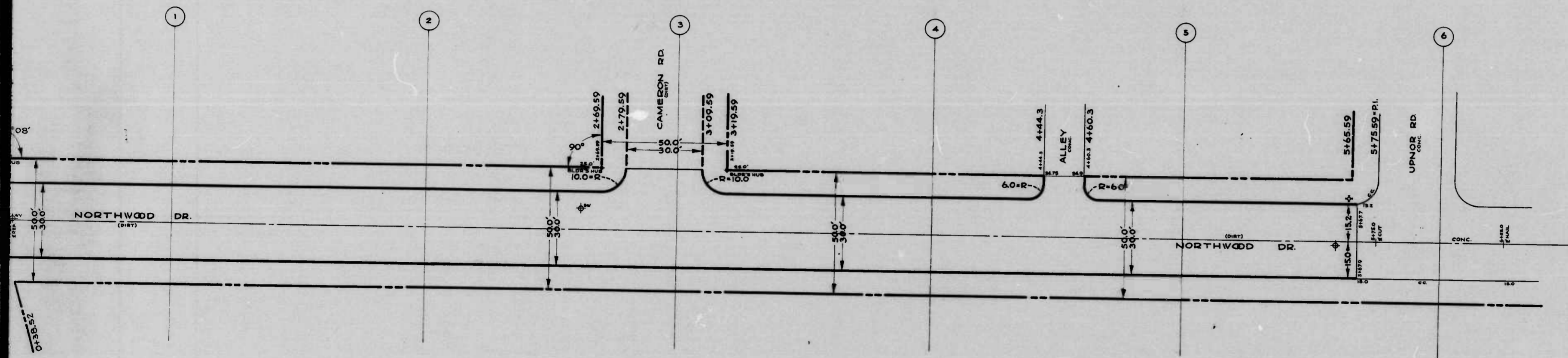

THE ISSUANCE OF THIS PLAN DOES NOT COMMIT THE CITY TO THE ACCEPTANCE AND/OR IMPROVEMENT OF ANY THOROUGHFARE SHOWN HEREON.
SOIL STABILIZATION MATERIALS AND/OR UNDERDRAINS ARE NOT REQUIRED.

TO BE CEM. CONC. PAVING SEVEN(7) IN. THICK

CITY OF BALTIMORE
DEPARTMENT OF PUBLIC WORKS
BUREAU OF HIGHWAYS

PLAN OF
NORTHWOOD DR.
BEAUREGARD AVE. TO UPNOR RD.

CONT NO 1024
SCALE 1"=200'

BOOK NO X263
DATE: 2-21-50

APPROVED
Henry W. King
ASSOCIATE ENGINEER

APPROVED
James H. McKey
HIGHWAYS ENGINEER

APPROVED
Edward W. Wickham
ENGINEER OF SURVEYS

APPROVED
C. L. H. O'Connell
DIRECTOR OF PUBLIC WORKS

NORTHWOOD DR. BEAUREGARD AVE - UPNOR RD. CONT. SHEET

①

+

②

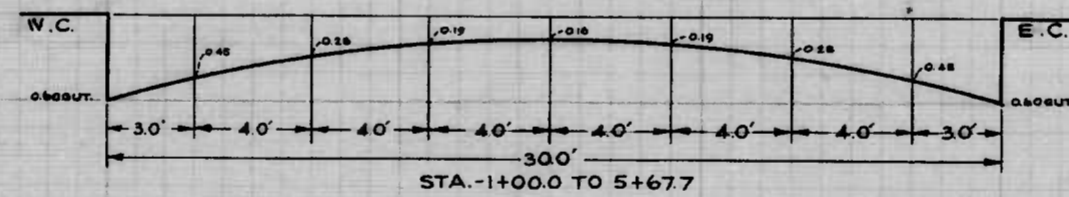
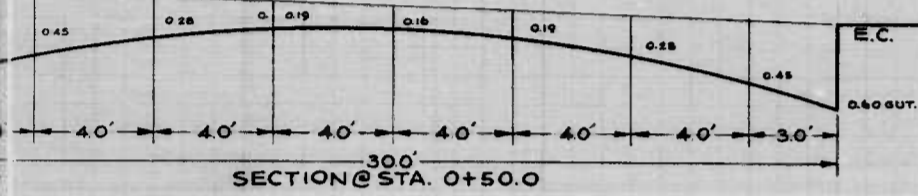
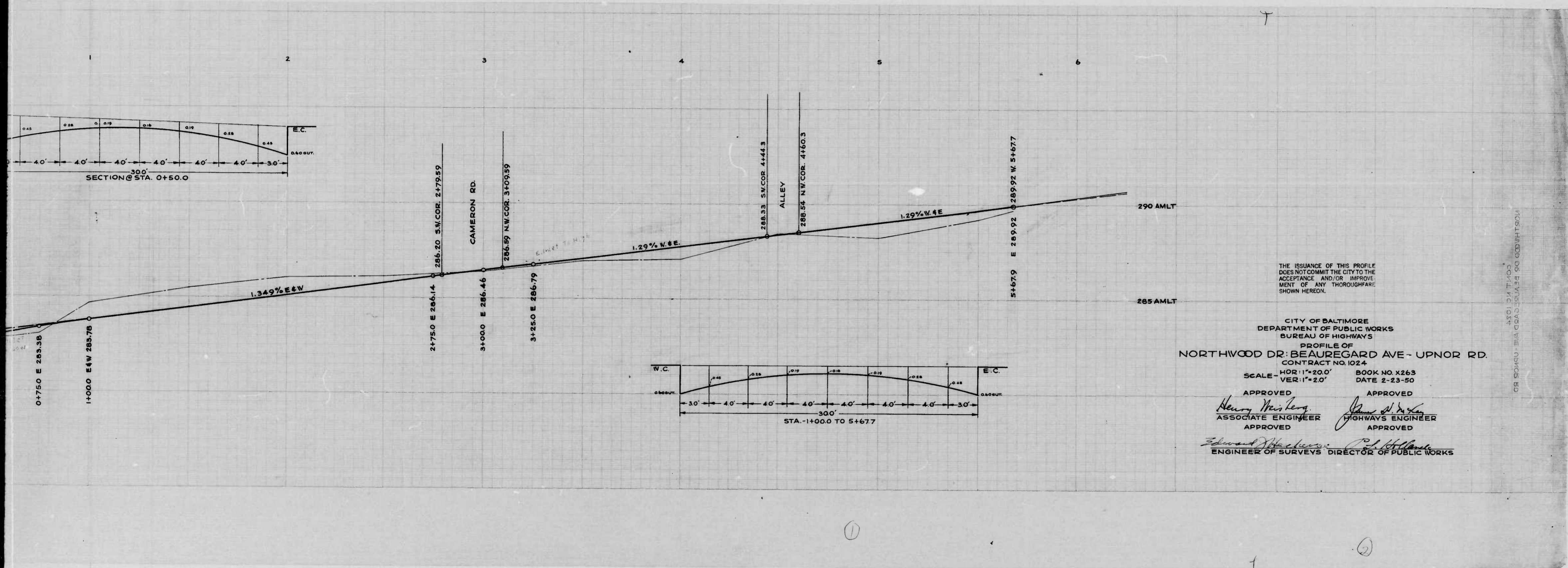

THE ISSUANCE OF THIS PROFILE DOES NOT COMMIT THE CITY TO THE ACCEPTANCE AND/OR IMPROVEMENT OF ANY THOROUGHFARE SHOWN HEREON.

CITY OF BALTIMORE
 DEPARTMENT OF PUBLIC WORKS
 BUREAU OF HIGHWAYS
 PROFILE OF
 NORTHWOOD DR. BEAUREGARD AVE - UPNOR RD.
 CONTRACT NO. 1024

SCALE - HOR: 1"=20.0' BOOK NO. X263
 VER: 1"=20' DATE 2-23-50

APPROVED *Henry Weisberg* ASSOCIATE ENGINEER
 APPROVED *James J. ...* HIGHWAYS ENGINEER
 APPROVED *Edward ...* ENGINEER OF SURVEYS
 APPROVED *P. H. ...* DIRECTOR OF PUBLIC WORKS

NORTHWOOD DR. BEAUREGARD AVE - UPNOR RD. CONTRACT NO. 1024

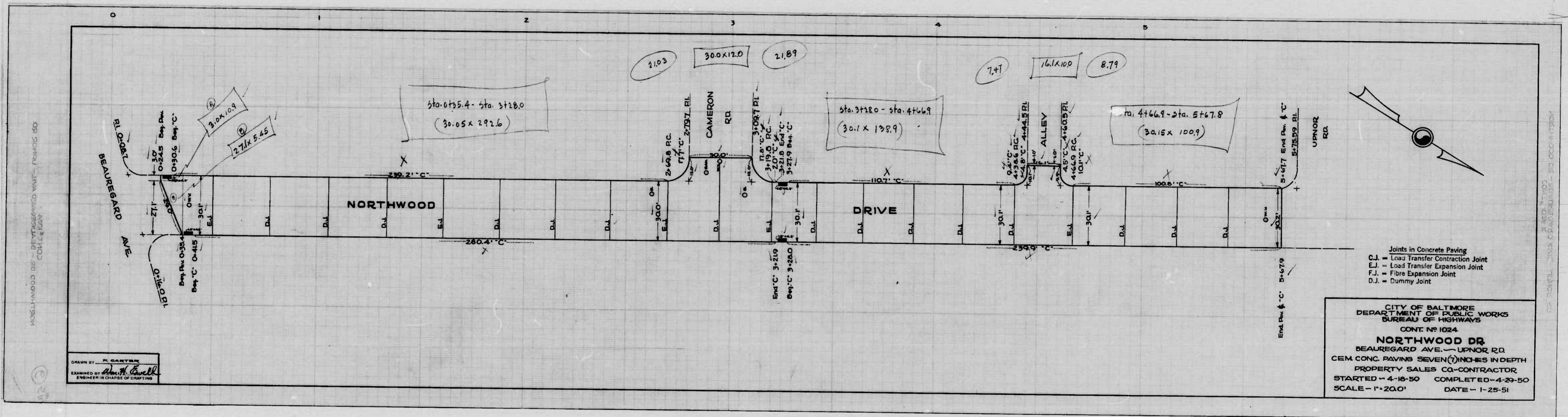

Joints in Concrete Paving
 C.J. = Load Transfer Contraction Joint
 E.J. = Load Transfer Expansion Joint
 F.J. = Fibre Expansion Joint
 D.J. = Dummy Joint

CITY OF BALTIMORE
 DEPARTMENT OF PUBLIC WORKS
 BUREAU OF HIGHWAYS
 CONT. NO. 1024
NORTHWOOD DR.
 BEAUREGARD AVE. - UPNOR RD.
 CEM. CONC. PAVING SEVEN INCHES IN DEPTH
 PROPERTY SALES CO-CONTRACTOR
 STARTED - 4-18-50 COMPLETED - 4-29-50
 SCALE - 1" = 20.0' DATE - 1-25-51

DRAWN BY: R. CARTER
 EXAMINED BY: *[Signature]*
 ENGINEER IN CHARGE OF DISTRICT

NORTHWOOD DR. - BEAUREGARD AVE. - UPNOR RD. - 1024

NORTHWOOD DR. - BEAUREGARD AVE. - UPNOR RD. - 1024

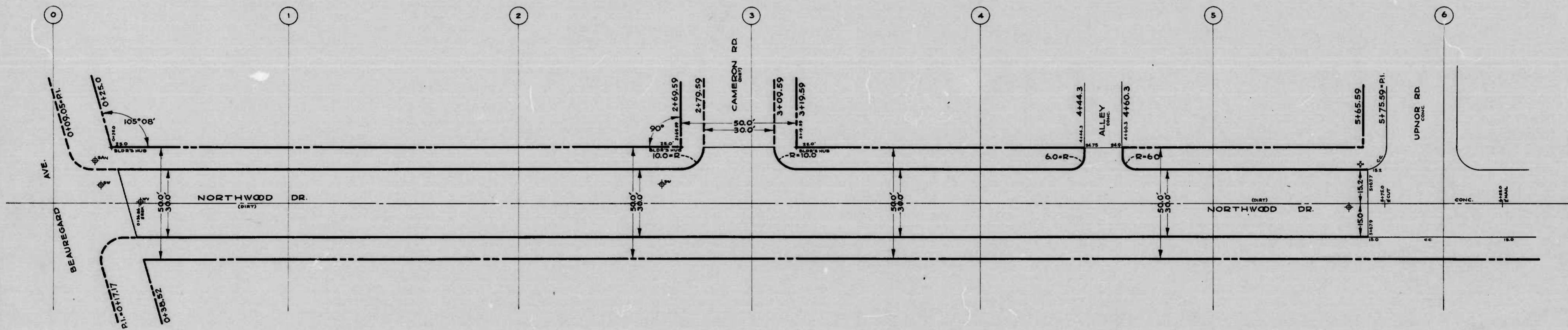

THE ISSUANCE OF THIS PLAN DOES NOT COMMIT THE CITY TO THE ACCEPTANCE AND/OR IMPROVEMENT OF ANY THOROUGHFARE SHOWN HEREON.
 SOIL STABILIZATION MATERIALS AND/OR UNDERDRAINS ARE NOT REQUIRED.
 TO BE CEM. CONC. PAVING SEVEN (7) IN. TH.

CITY OF BALTIMORE
 DEPARTMENT OF PUBLIC WORKS
 BUREAU OF HIGHWAYS

PLAN OF
 NORTHWOOD DR.
 BEAUREGARD AVE. TO UPNOR RD.

CONT. NO. 1024
 SCALE: 1"=200'
 BOOK NO. 2-21
 DATE: 2-21

APPROVED: *Henry Wisking*
 ASSOCIATE ENGINEER
 APPROVED: *James A. De...*
 HIGHWAYS EN...
 APPROVED: *Edward J. ...*
 ENGINEER OF SURVEYS DIRECTOR OF...

DRAWN BY JIM HOLDEN
 EXAMINED BY *John H. ...*
 ENGINEER IN CHARGE OF DRAWING

①

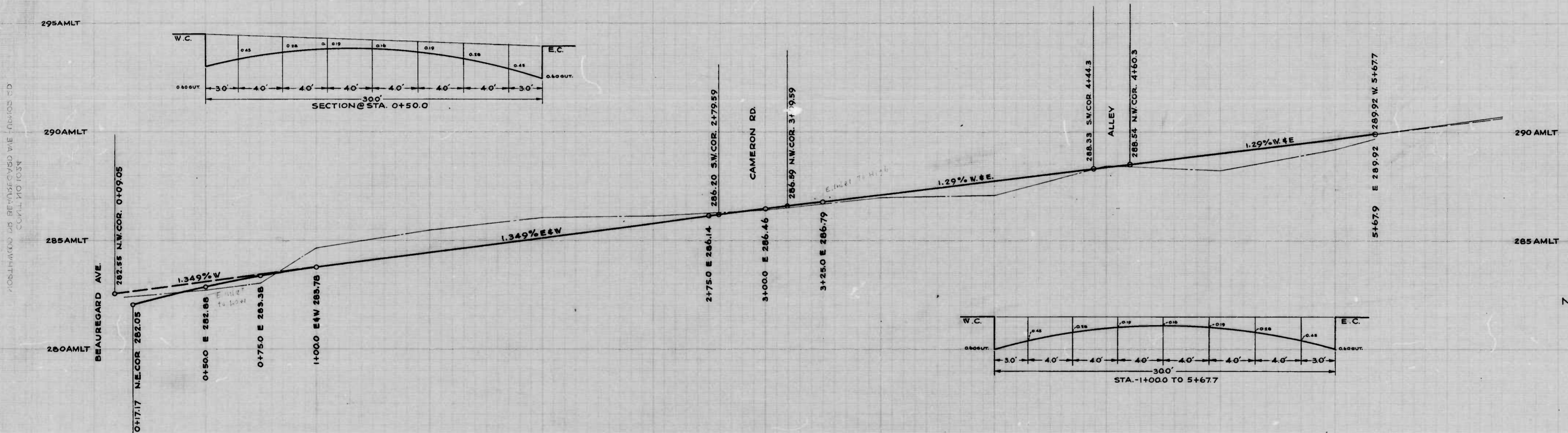

THE ISSUANCE OF THIS PROFILE DOES NOT COMMIT THE CITY TO THE ACCEPTANCE AND/OR IMPROVEMENT OF ANY THROUGHFARE SHOWN HEREON.

CITY OF BALTIMORE
 DEPARTMENT OF PUBLIC WORKS
 BUREAU OF HIGHWAYS
 PROFILE OF
 NORTHWOOD DR: BEAUREGARD AVE
 CONTRACT NO. 1024
 SCALE - HOR: 1"=20.0' BOOK NO.
 VER: 1"=20' DATE 2-
 APPROVED: *Henry Wisleng* ASSOCIATE ENGINEER
 APPROVED: *Edmund J. ...* ENGINEER OF SURVEYS DIRECTOR OF HIGHWAYS

DRAWN BY: JIM MOORE
 EXAMINED BY: *...*
 ENGINEER IN CHARGE OF DRAFTING

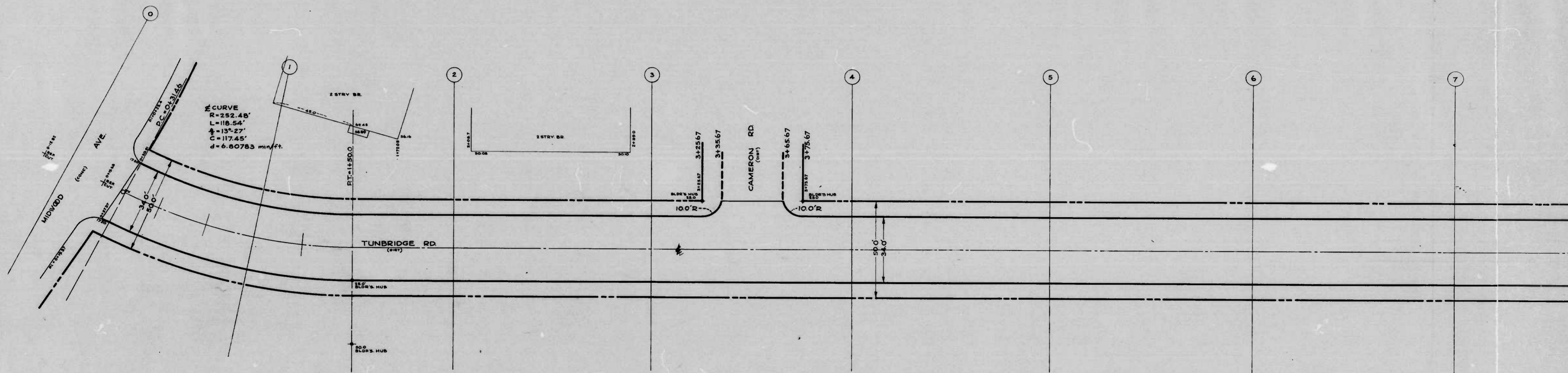

DRAWN BY J.C. COLLETT, JR.
EXAMINED BY [Signature]
ENGINEER IN CHARGE OF DRAFTING

①

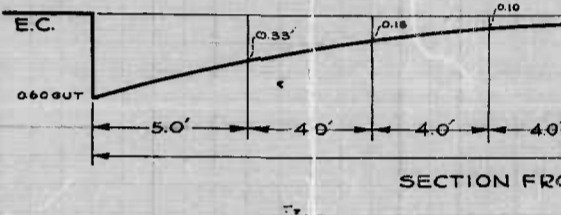
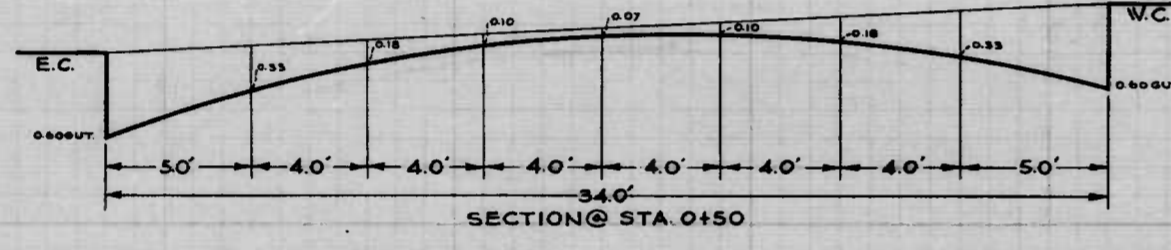
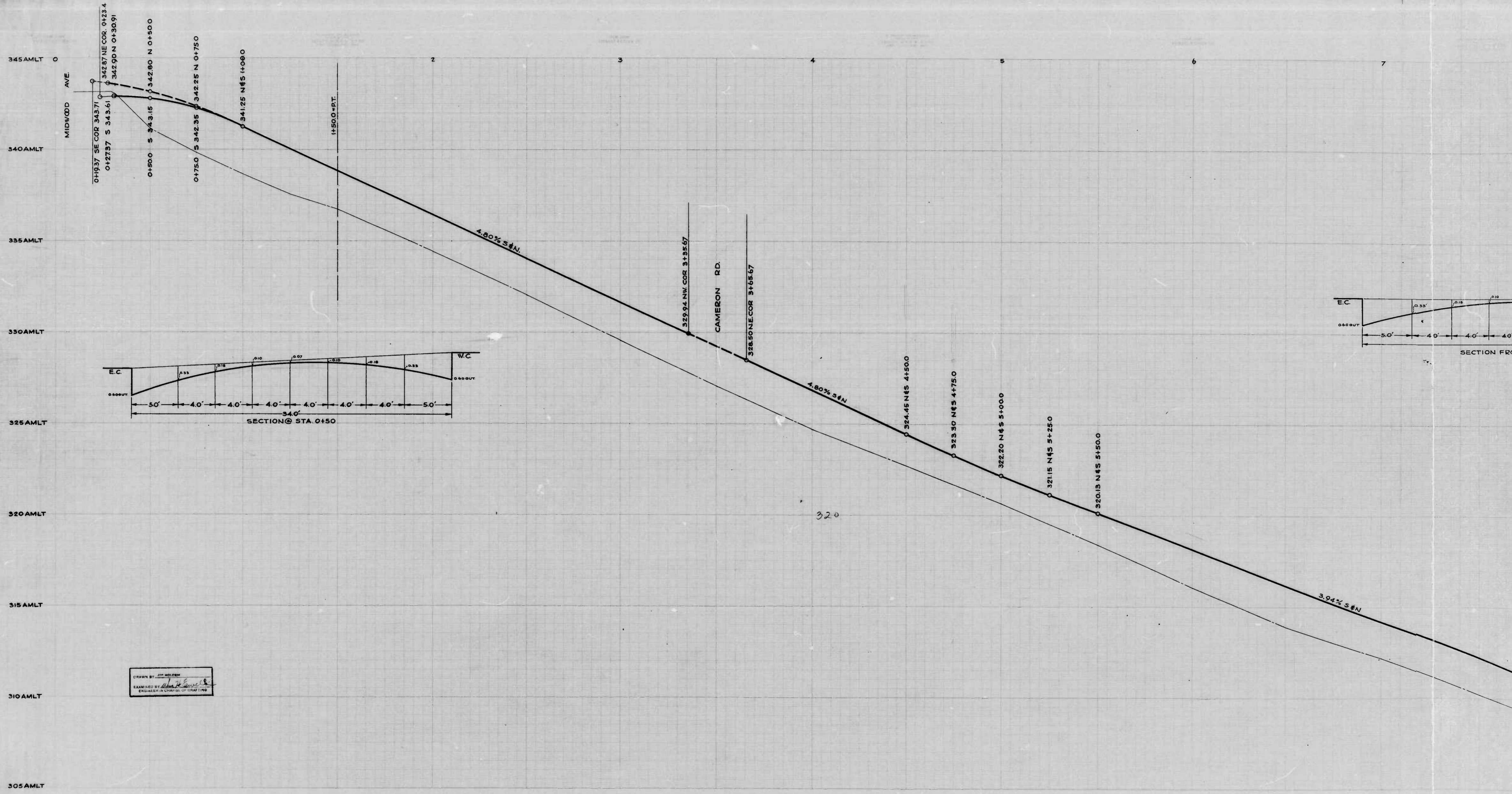

DRAWN BY J.H. WOLFE
 EXAMINED BY *[Signature]*
 ENGINEER IN CHARGE OF DRAFTING

BRIDGE 80 MIDWOOD AVE-BEWINCKLES
 CONT. SHEET

320

①

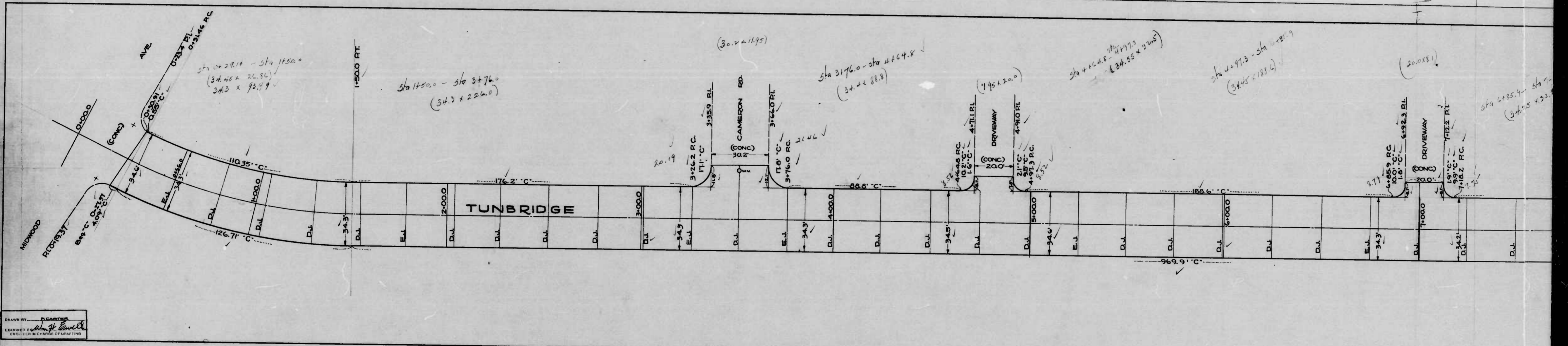

DRAWN BY: J. CARTER
EXAMINED BY: [Signature]
ENGINEER IN CHARGE OF DRAWING

LIVINGSIDE 60 - MIDWOOD AVE - REVISED T&E
CONC. & CURB X

Scale

(1)

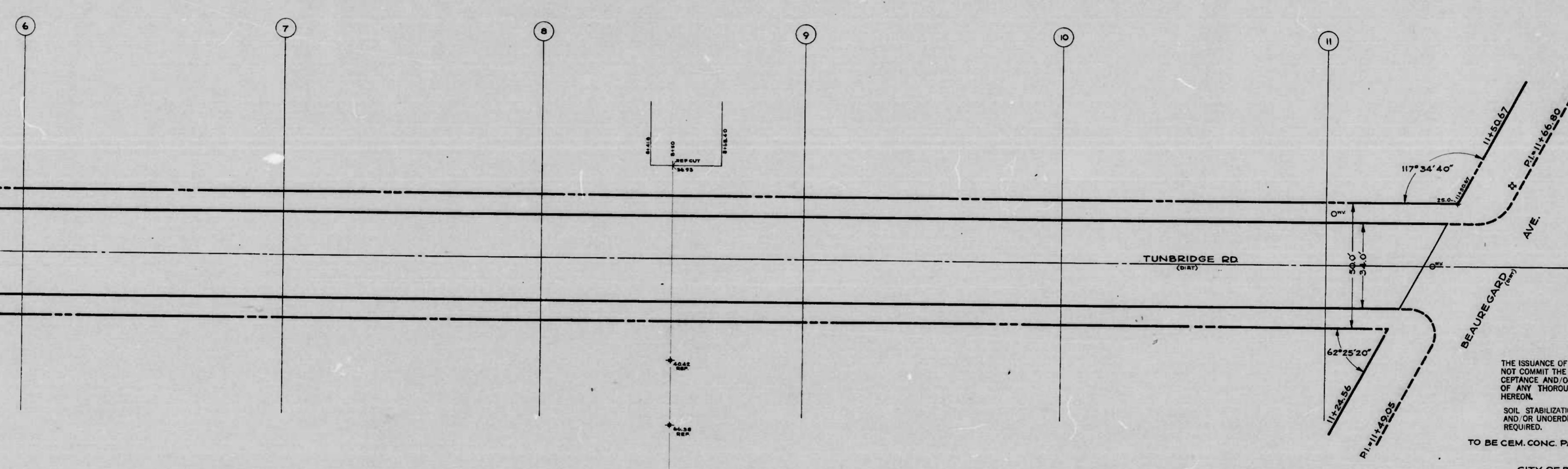

THE ISSUANCE OF THIS PLAN DOES NOT COMMIT THE CITY TO THE ACCEPTANCE AND/OR IMPROVEMENT OF ANY THOROUGHFARE SHOWN HEREON.

SOIL STABILIZATION MATERIALS AND/OR UNDERDRAINS ARE NOT REQUIRED.

TO BE CEM. CONC. PAVING SEVEN (7) IN. THICK

CITY OF BALTIMORE
DEPARTMENT OF PUBLIC WORKS
BUREAU OF HIGHWAYS

PLAN OF
TUNBRIDGE RD - MIDWOOD AVE - BEAUREGARD AVE.
CONT. NO. 1024 BOOK NO. X263
SCALE: 1"=200' DATE: 2-14-50

APPROVED
Henry Weisberg
ASSOCIATE ENGINEER

APPROVED
James A. McKey
HIGHWAYS ENGINEER

APPROVED
Edward J. Mackenzie
ENGINEER OF SURVEYS DIRECTOR OF PUBLIC WORKS

TUNBRIDGE RD - MIDWOOD AVE - BEAUREGARD AVE
CONT. NO. 1024

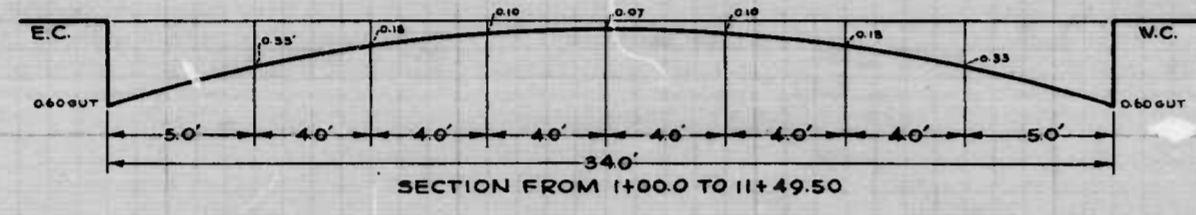
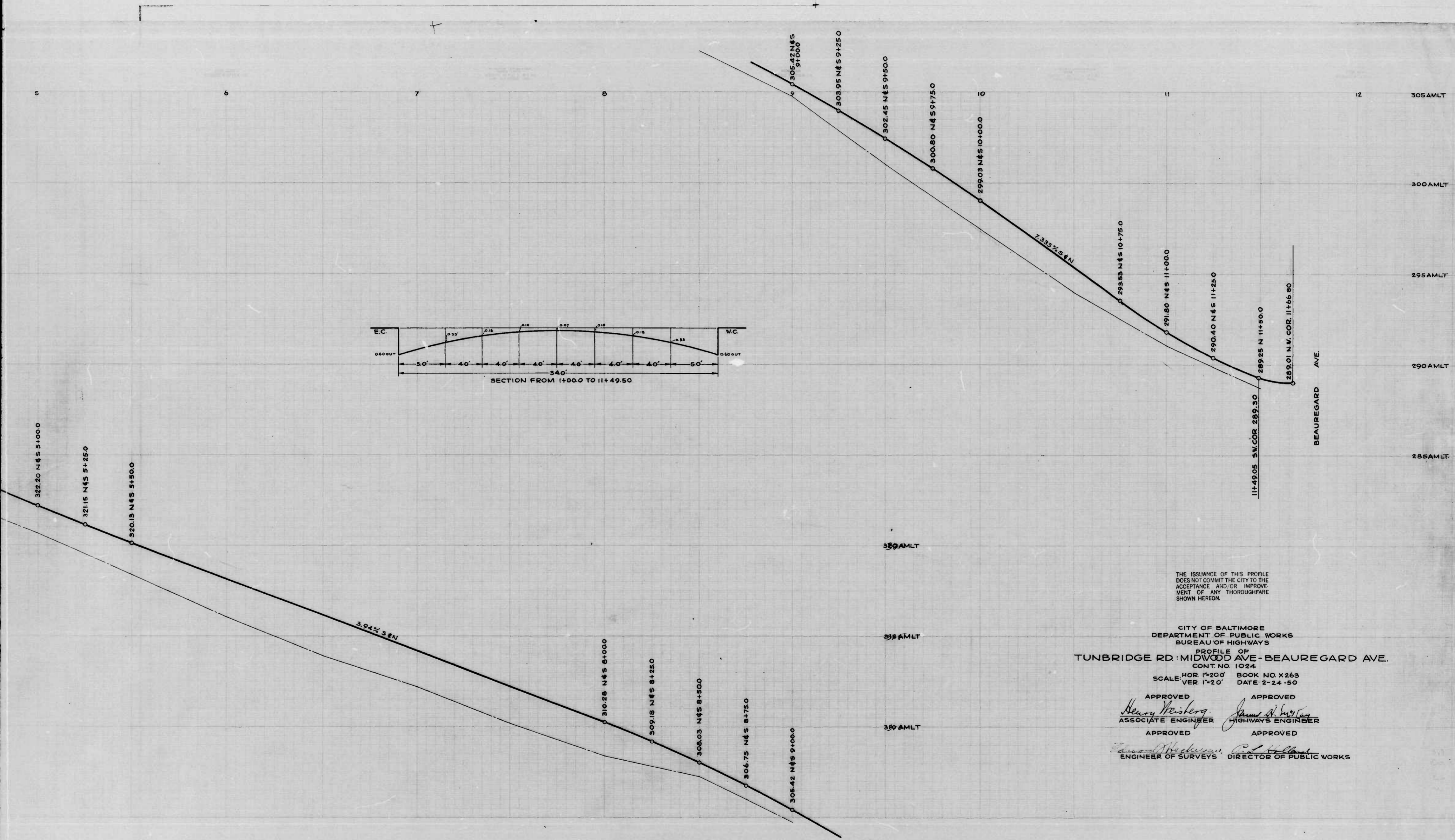

THE ISSUANCE OF THIS PROFILE DOES NOT COMMIT THE CITY TO THE ACCEPTANCE AND/OR IMPROVEMENT OF ANY THOROUGHFARE SHOWN HEREON.

CITY OF BALTIMORE
 DEPARTMENT OF PUBLIC WORKS
 BUREAU OF HIGHWAYS
 PROFILE OF
 TUNBRIDGE RD: MIDWOOD AVE - BEAUREGARD AVE.
 CONT. NO. 1024
 SCALE: HOR 1"=20' BOOK NO. X263
 VER 1"=20' DATE 2-24-50

APPROVED *Henry Weisberg* ASSOCIATE ENGINEER
 APPROVED *James H. ...* HIGHWAYS ENGINEER
 APPROVED *Edward ...* ENGINEER OF SURVEYS
 APPROVED *Carl ...* DIRECTOR OF PUBLIC WORKS

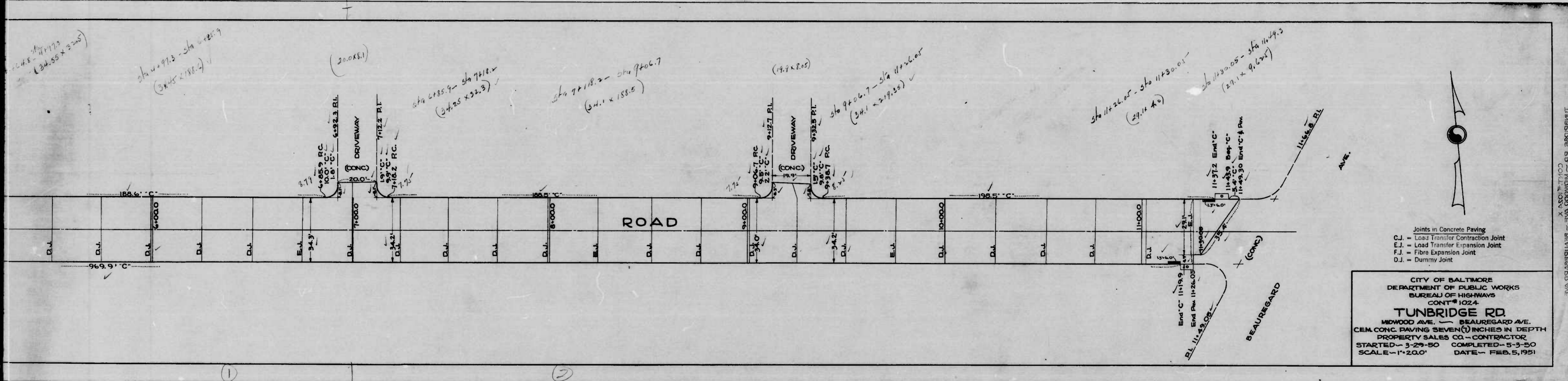

Joints in Concrete Paving
 C.J. - Load Transfer Contraction Joint
 E.J. - Load Transfer Expansion Joint
 F.J. - Fibre Expansion Joint
 D.J. - Dummy Joint

CITY OF BALTIMORE
 DEPARTMENT OF PUBLIC WORKS
 BUREAU OF HIGHWAYS
 CONT # 1024
TUNBRIDGE RD.
 MIDWOOD AVE. - BEAUREGARD AVE.
 CEM. CONC. PAVING SEVEN (7) INCHES IN DEPTH
 PROPERTY SALES CO. - CONTRACTOR
 STARTED - 3-29-50 COMPLETED - 5-5-50
 SCALE - 1" = 20.0' DATE - FEB. 5, 1951



TUNBRIDGE RD. - MIDWOOD AVE. - BEAUREGARD AVE.