

INDEX OF SHEETS

SHEET NO 1	TITLE PAGE & LAYOUT
2	TYPICAL CROSS SECTION OF IMPROVEMENT
3	PLAN & PROFILE
4	PLAN & PROFILE
5	PLAN
6	PROFILE
7	PLAN & PROFILE

STATE OF MARYLAND  
STATE ROADS COMMISSION

PLAN AND PROFILE OF PROPOSED  
STATE HIGHWAY

FEDERAL AID PROJECT NO. B.C. 161-736

BALTIMORE CITY  
FALLS ROAD

SCALE | PLAN, 1 IN. = 40 FT.  
| PROFILE, HOR. 1 IN. = 20 FT. VERT. 1 IN. = 2 FT.

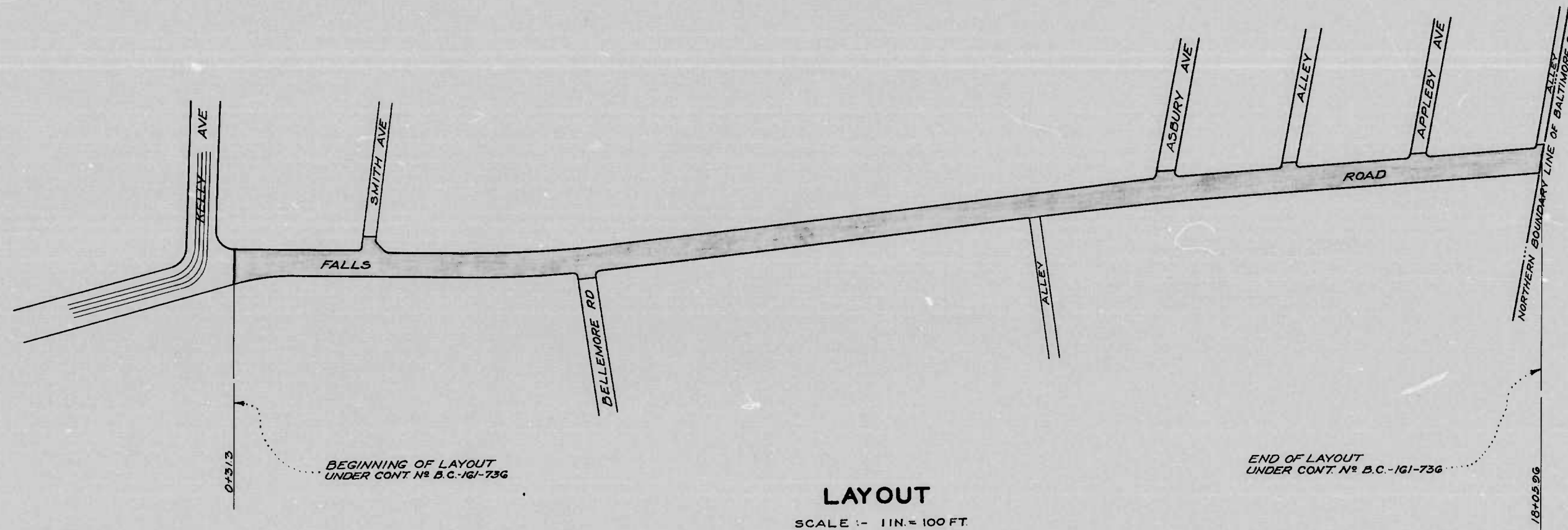
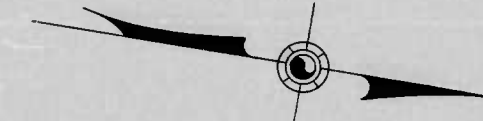

LAYOUT  
SCALE - 1 IN. = 100 FT.

CONVENTIONAL SIGNS

STATE AND NATIONAL LINE	---	CULVERTS	---
COUNTY LINE	---	RETAINING WALL	---
CITY OR VILLAGE	---	DROP INLET	---
FENCE LINE (GUARD RAIL)	---	TROLLEY POLE	---
UNFENCED PROPERTY	---	POWER POLE	---
RIGHT OF WAY LINE	---	TELEPHONE OR TELEGRAPH POLE	---
TRAVELED WAY	---	MARSH	---
RAILROADS	---	HEDGE	---
BASE OR SURVEY LINE	---	GROUND ELEVATION	DATUM LINE 172.5
		GRADE ELEVATION	DATUM LINE 172.5

FOR DETAILS OF CULVERTS, ETC. SEE STANDARD SHEET.  
STATE SPECIFICATIONS AND STANDARD PLANS ON FILE IN BUREAU OF PUBLIC ROADS.

BC-161-736

1178

DATA MAN [Redacted]

DRAWER [Redacted]

APPROVED  
*Robert Blair*  
CHIEF ENGINEER, STATE ROADS COMMISSION  
2/21/57

RECOMMENDED FOR APPROVAL  
DISTRICT ENGINEER, BUREAU OF PUBLIC ROADS  
RECOMMENDED FOR APPROVAL  
CHIEF ENGINEER, BUREAU OF PUBLIC ROADS  
APPROVED  
DIRECTOR, BUREAU OF PUBLIC ROADS

MICROFILMED ON APERTURE CARDS



FALLS ROAD  
 KELLY AVE - CITY BOUNDARY LINE  
 DALLAS, MOBILE CITY  
 SWEET #2 OF 7

MICROFILMED  
 ON  
 APERTURE CARDS

*John S. Smith*  
 7/2/37

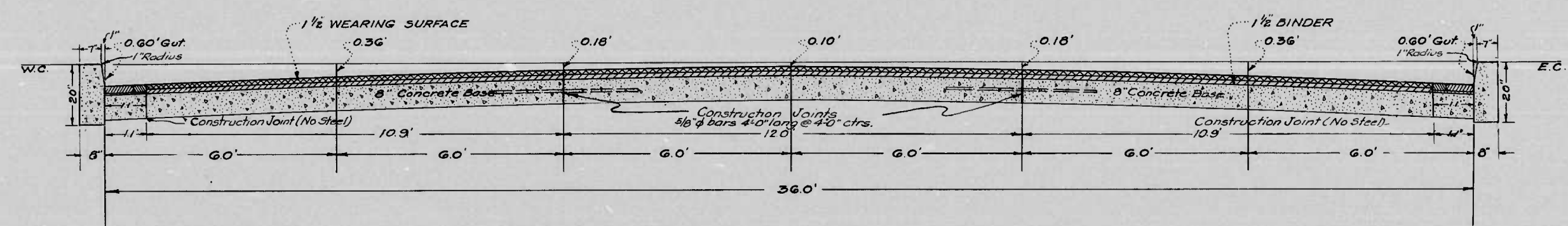

NOTE:  
 300 Lin Ft. 4" Vitrified Tile Underdrain (For Ret Wall Backfill Drainage)  
 120 Lin Ft. 4" " " Outlets  
 50 Lin Ft. 4" " " Outlets  
 To be placed where directed. The quantities, therefore, should be approved by the Engineer before the materials are ordered by the Contractor.

TYPICAL SECTION - LEVEL CURBS  
 STA. 2+75 - STA. 18+05.96

NOTE:  
 The proposal quantities provide a tonnage of "Asphaltic Binder" to be used at the discretion of the Engineer for the removal of depressions in the existing base course or other points where its use is justified.

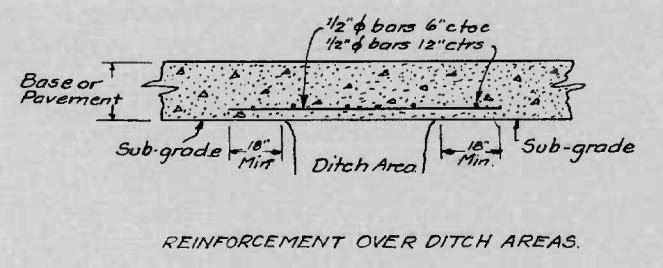

TYPICAL CROSS SECTION OF IMPROVEMENT  
 FALLS ROAD - KELLY AVE - CITY BOUNDARY LINE  
 SCALE 1/2" = 1' 0"

DRAWER [Redacted]

CORRECT  
*John S. Smith*  
 ASSOCIATE ENGINEER

APPROVED  
*George L. Smith*  
 HIGHWAYS ENGINEER

APPROVED  
*J. L. Brown*  
 CHIEF ENGINEER - BALTIMORE

1178



FALLS ROAD  
 KELLY AVE CITY BOUNDARY LINE  
 BALTIMORE CITY  
 COMT. NO. 161-736  
 SHEET NO. 3 OF 7

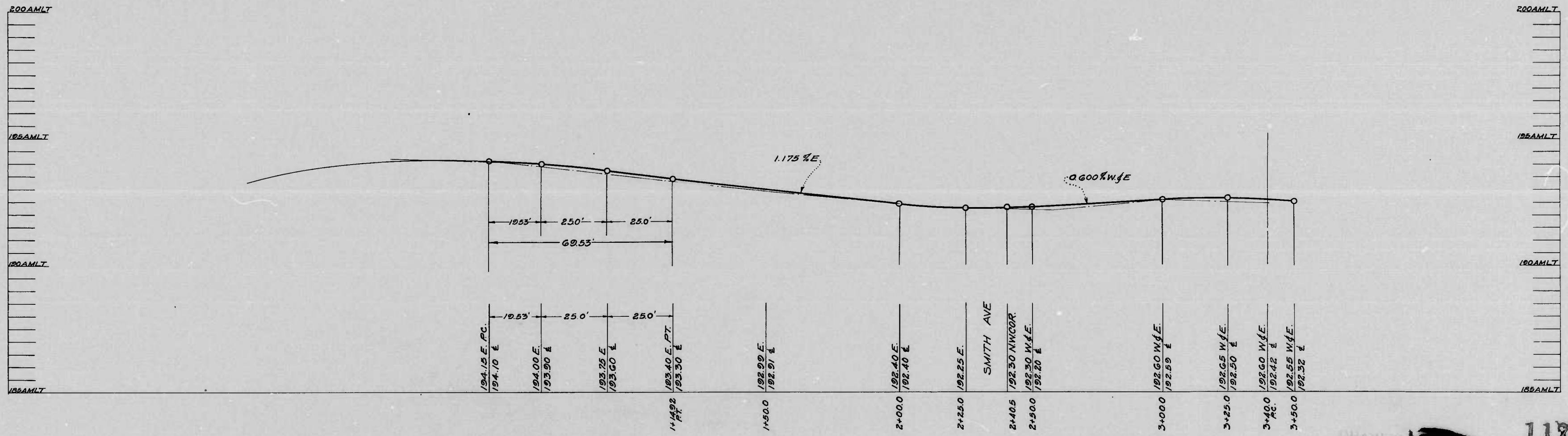
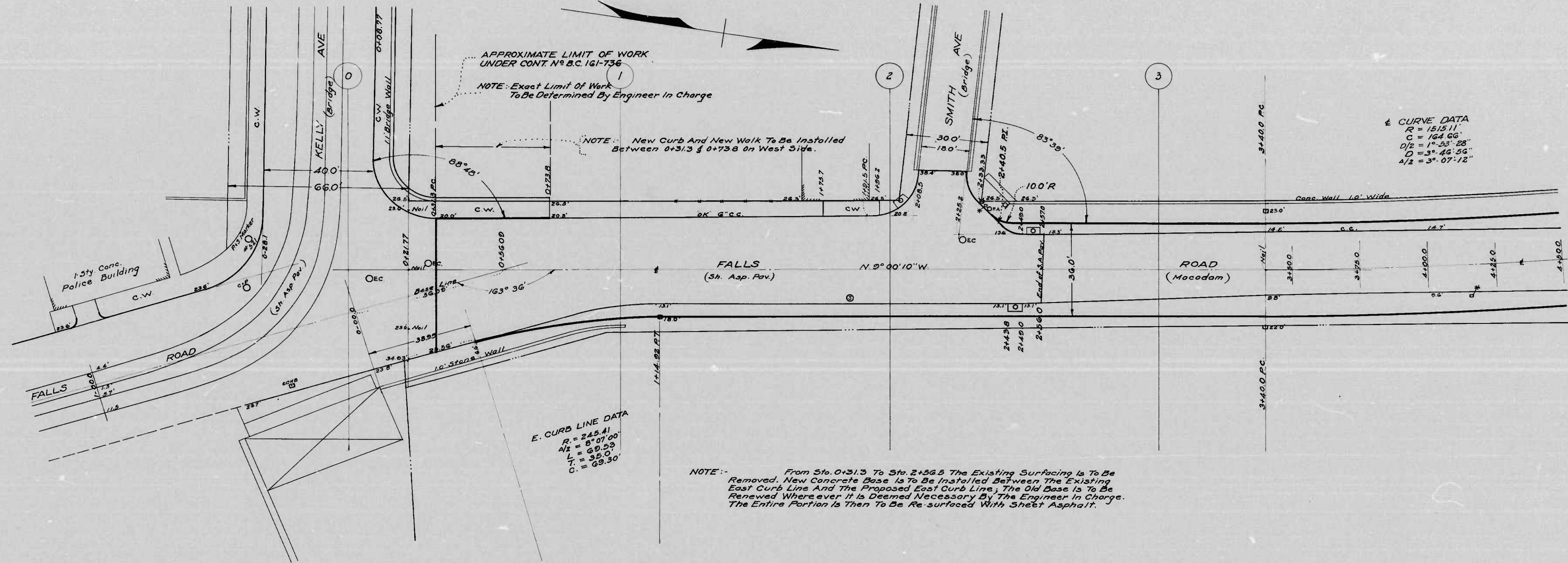

MICROFILMED  
 ON  
 APERTURE CARDS

1173



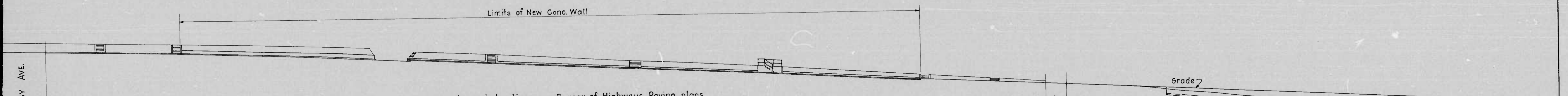
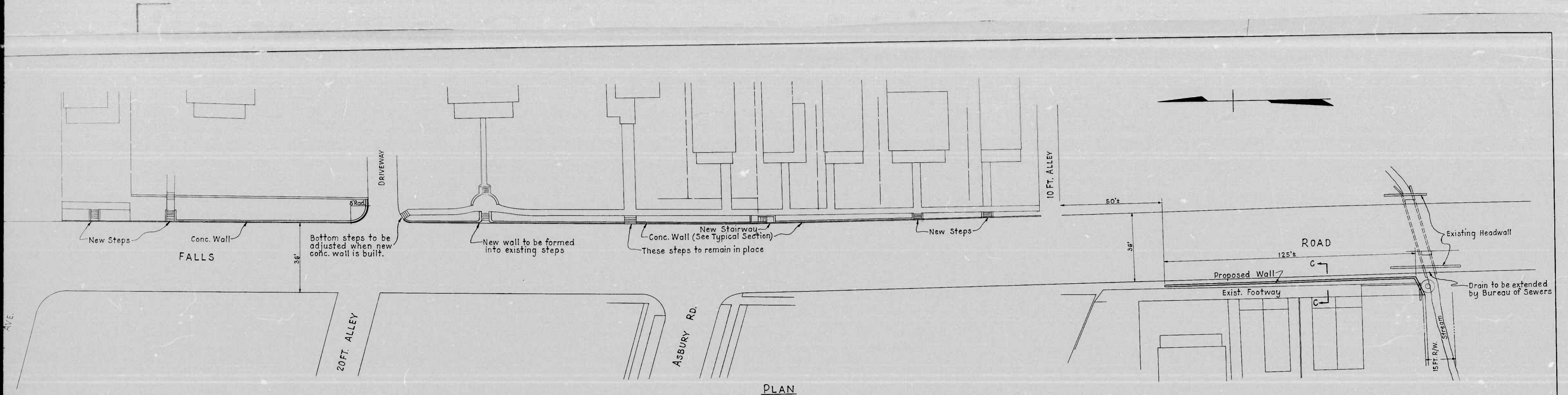

Note: Provide expansion joints, not over 30 Feet apart, in all walls. See Details. Cost of all expansion joints, felt, cork or rubber, copper plate, dowels, sleeves, keys, etc., shall be included in the contract unit price for "Class A Concrete".

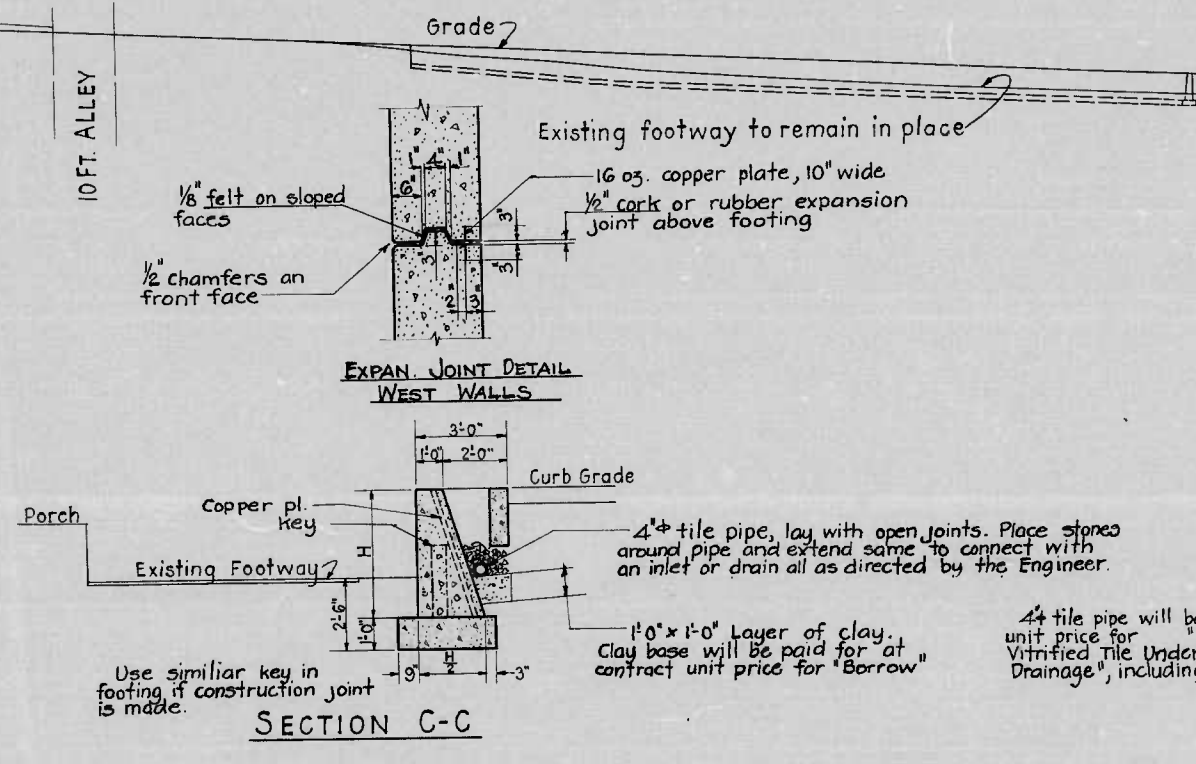
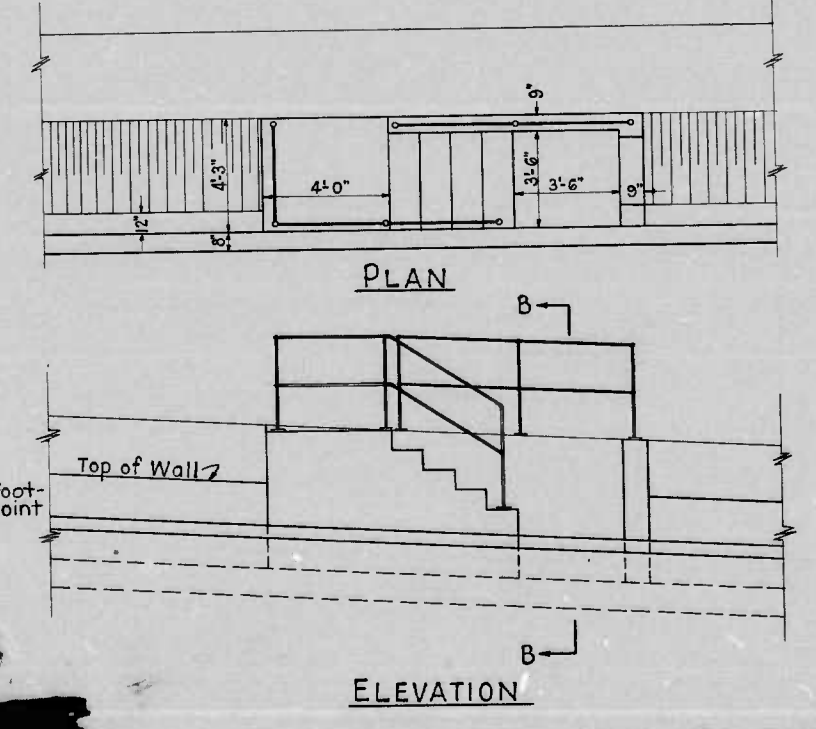
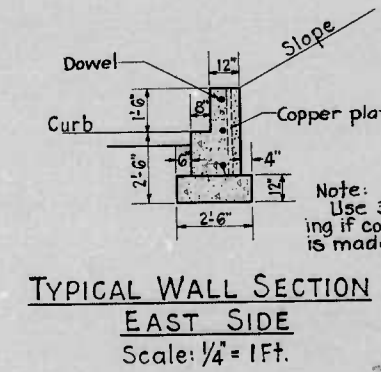
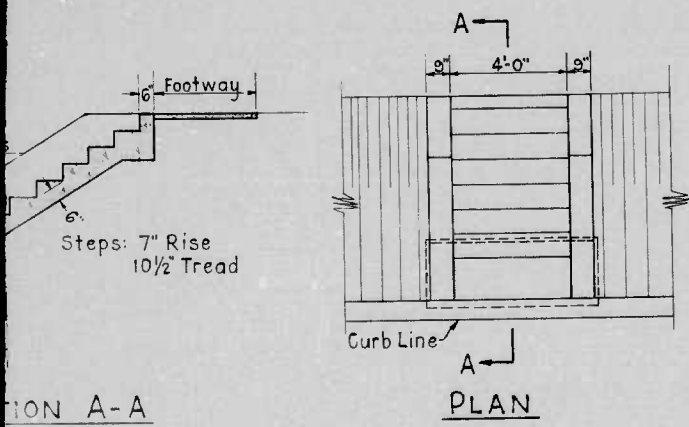
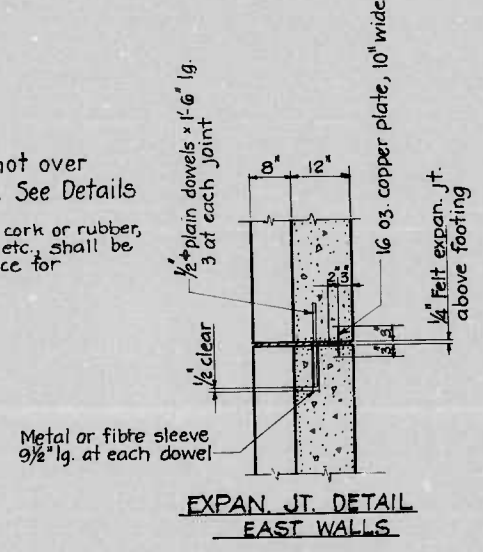

1173  
DRAWER

Be-161-736

CITY OF BALTIMORE  
DEPARTMENT OF PUBLIC WORKS  
BUREAU OF HIGHWAYS  
BRIDGE DIVISION  
NEW CONCRETE WALLS AND STEPS  
IN CONNECTION WITH  
FALLS ROAD IMPROVEMENT  
KELLY AVE. TO CITY LINE  
SCALES: AS SHOWN JUNE 1, 1937

APPROVED: [Signature] ASSOCIATE ENGINEER  
APPROVED: [Signature] HIGHWAYS ENGINEER  
APPROVED: [Signature] CHIEF ENGINEER