

FALLS ROAD
KELLY AVE - CITY BOUNDARY LINE
BALTIMORE CITY
CONT. N. 2C 191-236
SHEET N. 2 4-17

MICROFILMED
ON
APERTURE CARDS

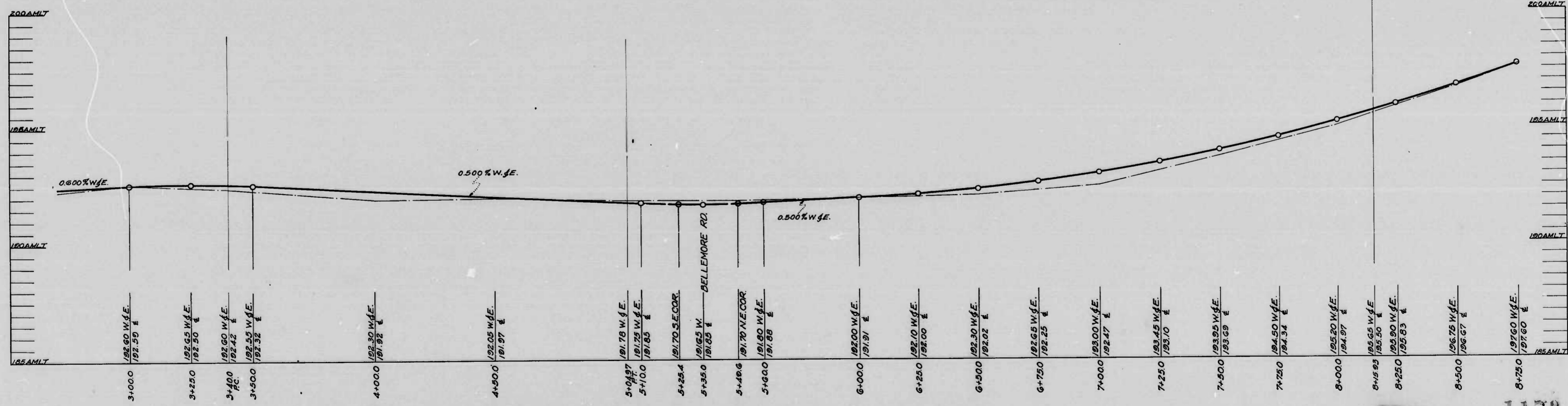
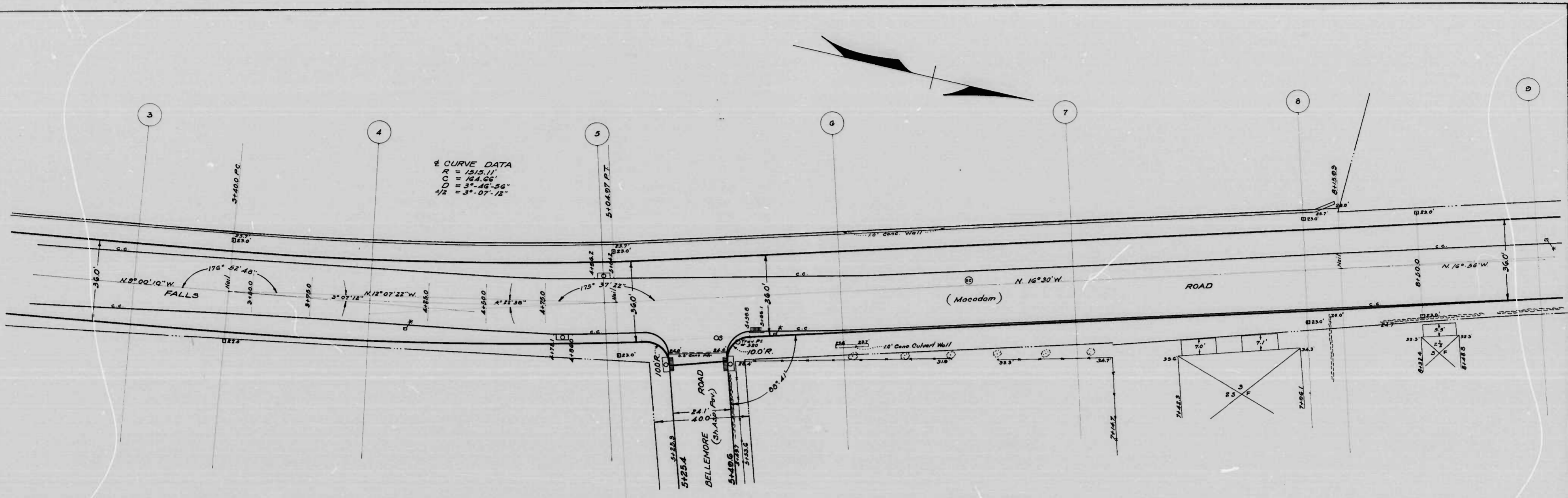

1179

FALLS ROAD
KELLY AVE - CITY BOUNDARY LINE
BALTIMORE CITY
CONV. BY B.C. 167-786
SHEET N. 5 417

MICROFILMED
ON
APERTURE CARDS

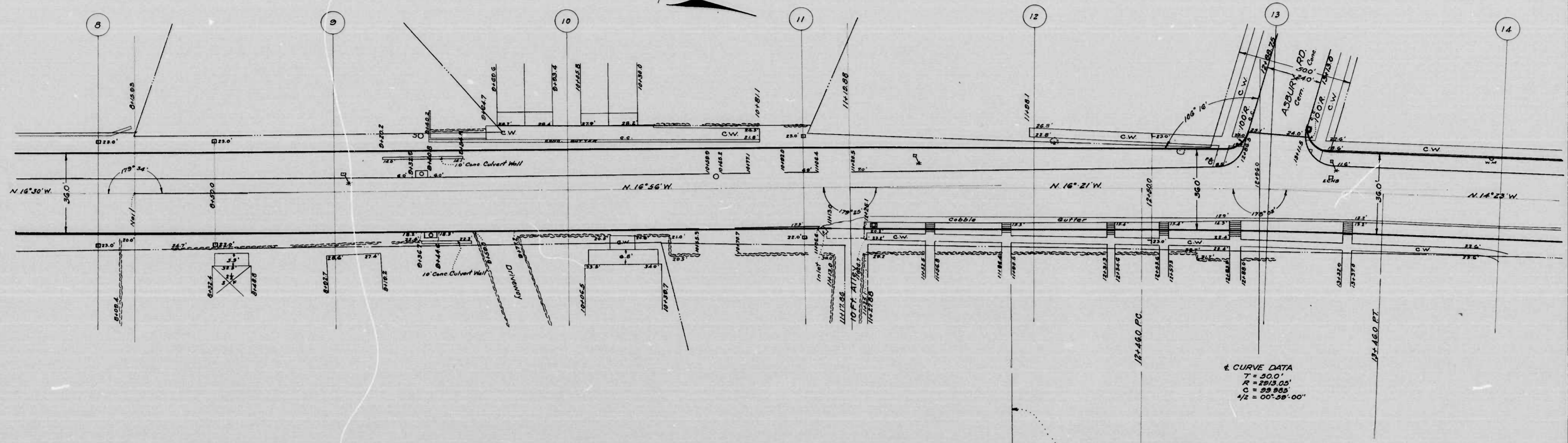

NOTE - Between Sta. 11+50.5 and Sta. 15+63.4 on the East Side, the Conc. Curb will be installed as a part of the New Conc. Retaining Wall. See Typical Wall Section on Detail Plan of New Conc. Walls & Steps.

1173

FALLS ROAD
KELLY AVE - CITY BOUNDARY LINE
BALTIMORE CITY
CONT. N.E.C. 41-735
SHEET N1 G 477

MICROFILMED
ON
APERTURE CARDS

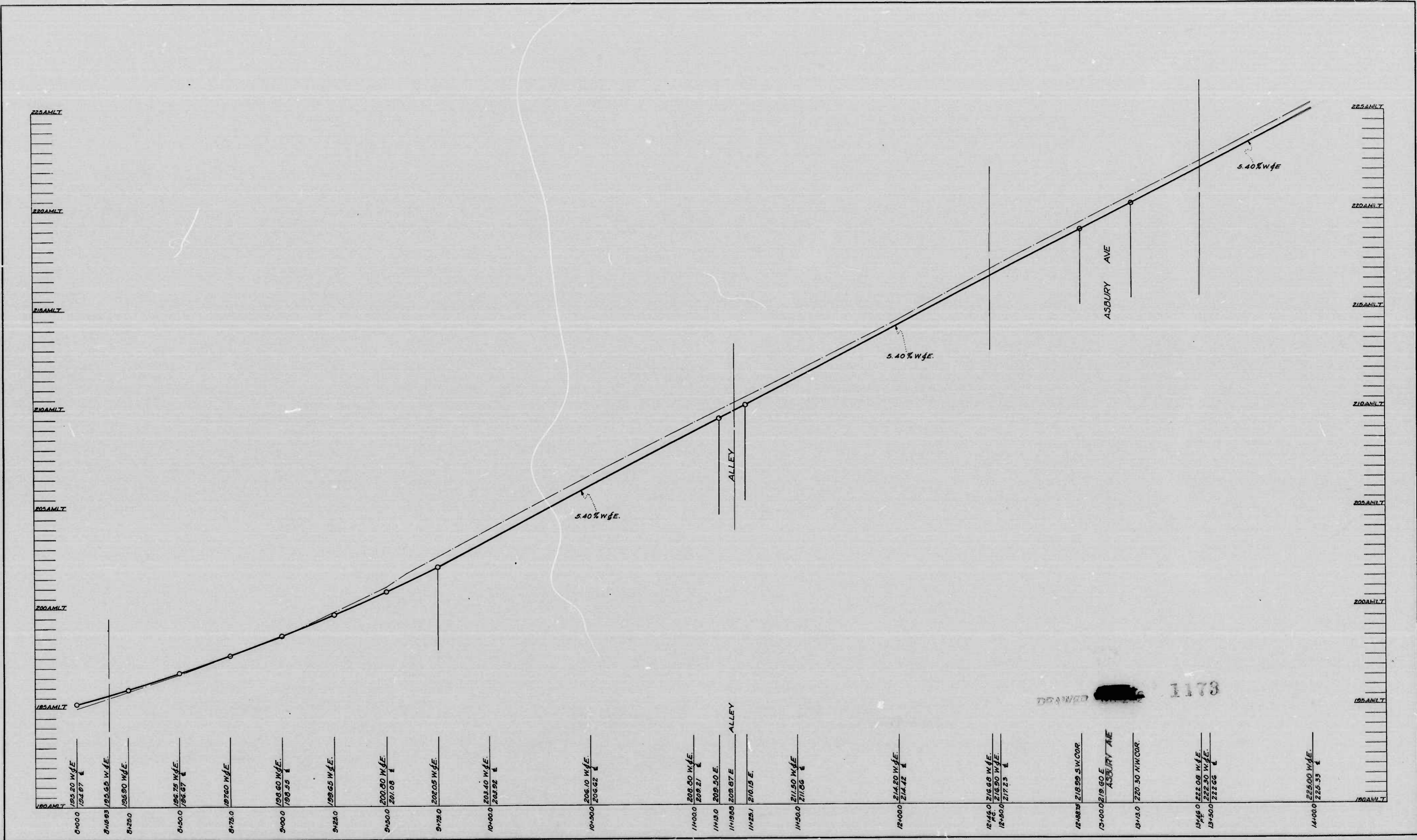

DRAWN 1173

FALLS ROAD
 KELLY AVE - CITY BOUNDARY LINE
 BALTIMORE, CITY
 CONTRACT NO. 101-736
 SHEET NO. 14-7

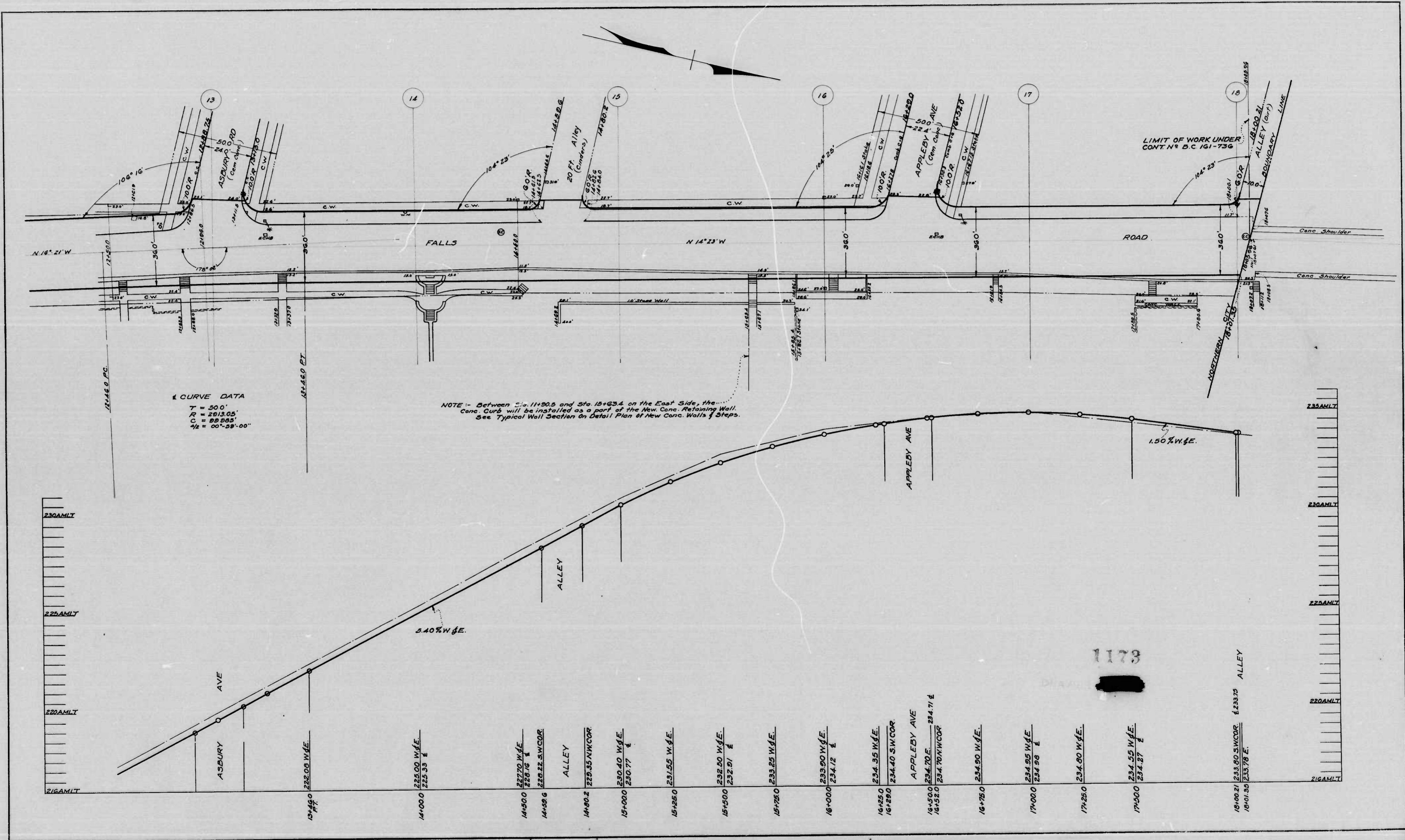

1 CURVE DATA
 T = 50.0'
 R = 2913.05'
 C = 28° 28' 55"
 1/2 = 00° 28' 00"

NOTE - Between Sta. 11+50.5 and Sta. 15+63.4 on the East Side, the Conc. Curb will be installed as a part of the New Conc. Retaining Wall. See Typical Wall Section on Detail Plan of New Conc. Walls & Steps.

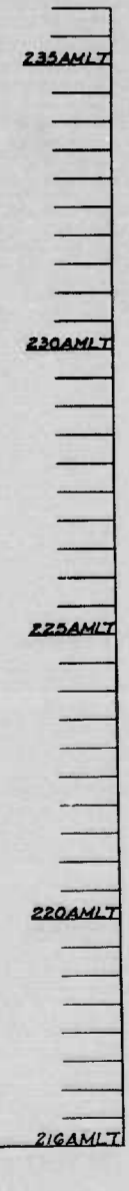

14+00.0	225.00 W.A.E.	225.33 E.
14+50.0	227.70 W.A.E.	228.76 E.
14+58.6	228.22 SWCOR.	
14+80.2	229.35 NWCOR.	
15+00.0	230.40 W.A.E.	230.77 E.
15+25.0	231.55 W.A.E.	
15+50.0	232.50 W.A.E.	232.91 E.
15+75.0	233.25 W.A.E.	
16+00.0	233.90 W.A.E.	234.12 E.
16+25.0	234.35 W.A.E.	
16+50.0	234.70 E.	234.71 E.
16+75.0	234.90 W.A.E.	
17+00.0	234.95 W.A.E.	234.98 E.
17+25.0	234.90 W.A.E.	
17+50.0	234.55 W.A.E.	234.27 E.
18+00.0	235.60 SWCOR.	233.75
18+07.35	235.78 E.	

1173