

NOTES:

- 1. SEE DWG. NO. 12 & 13 FOR UTILITY WORK OTHER THAN STORM DRAINS
- 2. REMOVAL OF POLLS AND POLES TO BE ABANDONED
- 3. USE CAUTION WHEN PLACING FOOTINGS FOR POLLS, POLE FRANCHISES, ETC. IN THE VICINITY OF UTILITIES. USE TEST PIT TO DETERMINE EXACT LOCATION OF UTILITIES. EXCAVATIONS IN OTHER LOCATIONS, EASEMENTS, ETC.
- 4. EXISTING MANHOLE - ADJUST TO FINISH GRADE
- 5. EXISTING MANHOLE, VALVE VAULT, HANDBOX, ETC. TO BE ABANDONED
- 6. EXISTING LIGHTPOLE - SEE DWG. NOS. 12 & 13
- 7. EXISTING LIGHTPOLE - SEE DWG. NOS. 12 & 13
- 8. EXISTING LIGHTPOLE - SEE DWG. NOS. 12 & 13
- 9. EXISTING ELEC./TELEPHONE POLE TO BE ABANDONED
- 10. EXISTING FIRE CALL BOX TO BE REMOVED BY FIRE DEPT.
- 11. EXISTING POLE TO BE REMOVED
- 12. EXISTING UTIL. HANDBOX, VALVEBOX, ETC. ADJUST TO FINISH GRADE
- 13. EXISTING POLICE CALL BOX TO BE RELOCATED OR REMOVED BY OTHERS
- 14. EXISTING MANHOLE - SEE DWG. NO. 12
- 15. NEW MANHOLE - SEE DWG. NO. 12
- 16. NEW 4" WATER METER - SEE THIS DWG. 12
- 17. NEW LOCATION OF MOUNTED LIGHTPOLE - SEE NOTE 7
- 18. EXISTING UTIL. POLE TO BE ABANDONED
- 19. EXISTING FIRE HYDRANT TO BE REMOVED & NEW ONE INSTALLED
- 20. 4" WATER METER SHALL BE LOCATED ON THE ALLEY OR LEADENHALL AT AN APPROX. 25' FROM THE END OF LEADENHALL. AN APPROX. 25' FROM THE END OF LEADENHALL. SEE DWG. NO. 12
- 21. YARD HYDRANT - SEE DWG. NO. 12
- 22. TRAFFIC POLE
- 23. EXISTING MANHOLE ADJUST TO FINISH GRADE - MONITOR TRAFFIC TO CROSS MH
- 24. FORM CONCRETE ENTRANCE IN UTILITY CONC. WALL SHALL BE SAME CONFIGURATION AS CONC. ENTRANCE DETAILED ON DWG. NO. 7

GENERAL NOTES:

- 1. USE CAUTION WHEN PLACING FOOTINGS FOR POLLS, POLE FRANCHISES, ETC. IN THE VICINITY OF UTILITIES. USE TEST PIT TO DETERMINE EXACT LOCATION OF UTILITIES. EXCAVATIONS IN OTHER LOCATIONS, EASEMENTS, ETC.
- 2. EXISTING TRUCKWAY TRACKS IN SHARP ST. ARE TO BE REMOVED.
- 3. ALL WATER METERS/VALVE BOXES SERVING DEMOLISHED HOUSES SHALL BE REMOVED (CONSIDERED AN INCIDENTAL TO REMOVAL OF HOUSE)
- 4. ALL AREAS WITHIN THE CONTRACT LIMITS NOT INDICATED FOR OTHER TREATMENT, SHALL RECEIVE 4" TOPSOIL AND 4" MUD (SUB-DRAWN)
- 5. EXISTING UTILITY LOCATIONS INDICATED ON THIS PLAN WERE OBTAINED FROM THE BEST AVAILABLE RECORDS. LOCATIONS ARE APPROXIMATE AND IT WILL BE THE CONTRACTOR'S RESPONSIBILITY TO VERIFY THE EXACT LOCATION OF UTILITIES. THE CITY OF BALTIMORE AND THE STATE HIGHWAY ADMINISTRATION WILL NOT BE RESPONSIBLE FOR THE ACCURACY OF UTILITY LOCATIONS. NOTE ANY DISCREPANCIES AROUND THESE RECORDS.
- 6. RECORDED PLAT SHOWING PROPERTY LINES, EASEMENTS, ETC. WILL BE AVAILABLE ON OR BEFORE DATE OF AWARD OF CONTRACT

BALTIMORE CITY PUBLIC SCHOOLS  
ELEMENTARY SCHOOL FOR EXCEPTIONAL CHILDREN  
SCHOOL # 314

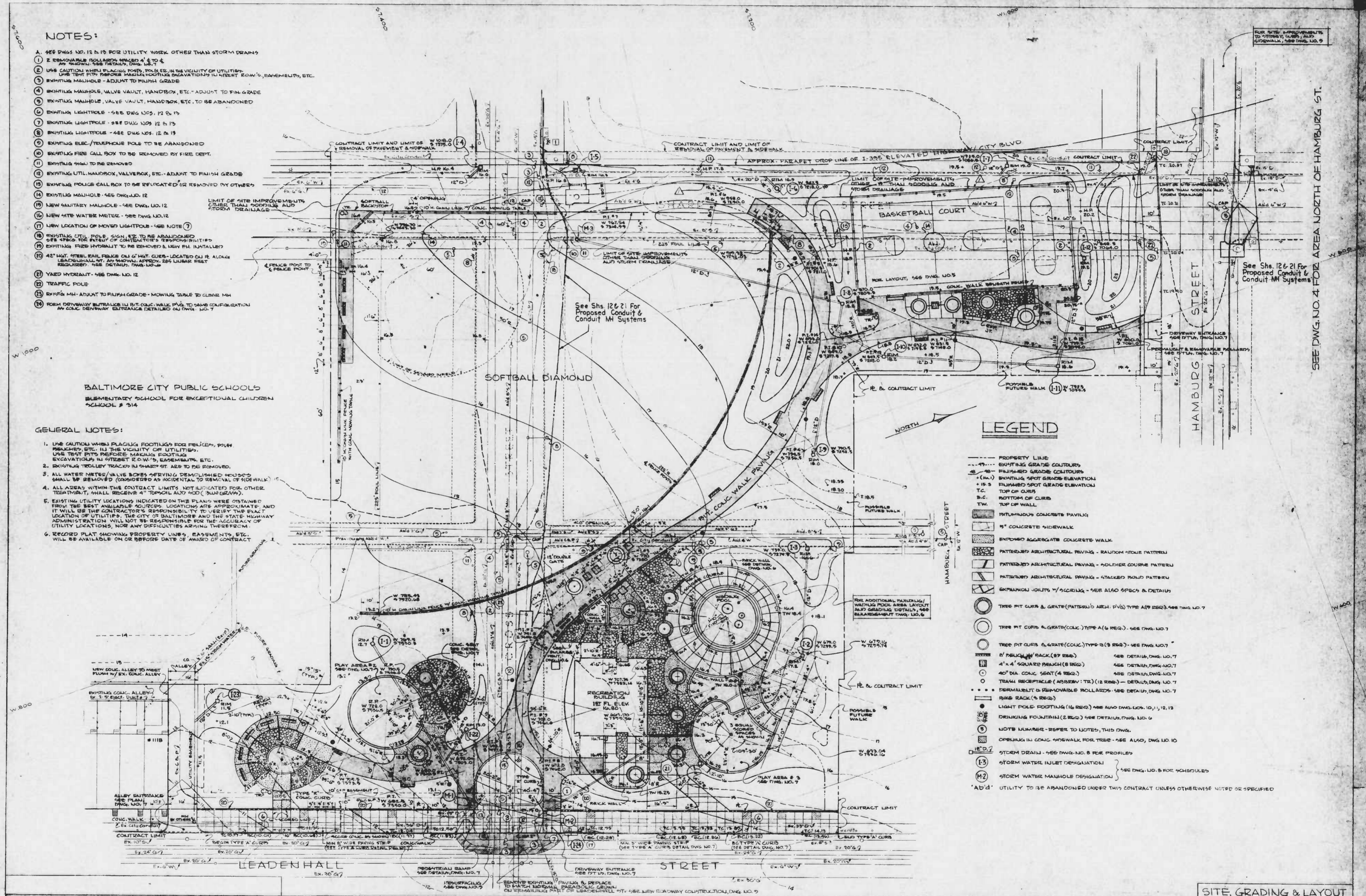

LEGEND

- PROPERTY LINE
- - - - - EXISTING GRADE CONTOURS
- - - - - PROPOSED GRADE CONTOURS
- (ELEV.) EXISTING SPOT GRADE ELEVATION
- (ELEV.) PROPOSED SPOT GRADE ELEVATION
- TC TOP OF CURB
- BC BOTTOM OF CURB
- T.W. TOP OF WALL
- PERVIOUS CONCRETE PAVING
- CONCRETE SIDEWALK
- ENTRANCE AGGREGATE CONCRETE WALK
- PATTERNED ARCHITECTURAL PAVING - RANDOM STONE PATTERN
- PATTERNED ARCHITECTURAL PAVING - HOLLAND COURSE PATTERN
- PATTERNED ARCHITECTURAL PAVING - STAGGERED ROUND PATTERN
- EXPANDED JOINTS 1/4" SPACING - SEE ALSO SPEC. & DETAILS
- TREE PIT CURB & GRATE (PATTERN) 18" HIGH (18" DIA) TYPE A (REG.) - SEE DWG. NO. 7
- TREE PIT CURB & GRATE (CONC.) TYPE A (REG.) - SEE DWG. NO. 7
- TREE PIT CURB & GRATE (CONC.) TYPE B (REG.) - SEE DWG. NO. 7
- RECYCLED RUBBER BACK (BY REG.) - SEE DETAIL DWG. NO. 7
- 4" x 4" SQUARE PAVING (BY REG.) - SEE DETAIL DWG. NO. 7
- 40" DIA. CONC. SEAT (A REG.) - SEE DETAIL DWG. NO. 7
- TRAIL RECEPTACLE (ASSEMBLY) (BY REG.) - SEE DETAIL DWG. NO. 7
- PERVIOUS & REINFORCED ROLLERS - SEE DETAIL DWG. NO. 7
- RUBBER RACK (BY REG.)
- LIGHT POLE FOOTING (BY REG.) - SEE DWG. NOS. 10, 11, 12, 13
- DRAINAGE FOUNTAIN (BY REG.) - SEE DETAIL DWG. NO. 6
- NOTE NUMBER - REFER TO NOTES, THIS DWG.
- OPENING IN CONC. SIDEWALK FOR TREE - SEE ALSO, DWG. NO. 10
- STORM DRAIN - SEE DWG. NO. 8 FOR PROFILES
- STORM WATER INLET DESIGNATION - SEE DWG. NO. 8 FOR SCHEDULES
- STORM WATER MANHOLE DESIGNATION - SEE DWG. NO. 8 FOR SCHEDULES
- 'ADJ.' UTILITY TO BE ABANDONED UNDER THIS CONTRACT UNLESS OTHERWISE NOTED OR SPECIFIED

# SHARP-LEADENHALL PARK

FEDERAL AID PROJECT NO. 1-395-8(210)  
STATE HIGHWAY ADMINISTRATION PROJ. NO. BC-255-11-815  
HIGHWAY ENGINEERING DIV. CONTRACT NO. 2496

SHARP & SCHIFFMAN, INC.  
ENGINEERS & ARCHITECTS  
1111 REVISION NO. 1  
ADDED MH IN SHARP ST. AT CROSS ST.  
BY EBA-SBT 1-3-79

**SITE, GRADING & LAYOUT**

DRAWING NO. **3**  
SHEET 3 OF 22  
DATE 6/20/78  
SCALE: 1" = 20'  
FILE:

SEE DWG. NO. 4 FOR AREA NORTH OF HAMBURG ST.



RATIO 29.4

NOTES

- 1 NEW SITE WATER METER - 1 1/2" METER - 2" SERVICE
- 2 NEW SANITARY MANHOLE - SEE DETAIL DWG NO. 13
- 3 DRINKING FOUNTAIN & YARD HYDRANT STRUCTURE - SEE DETAIL DWG NO. 6
- 4 TRANSFORMER BY B.G. & E. CO.
- 5 CAP EXIST. WATER MAIN - B.G. STIP.
- 6 REMOVE EXIST. WATER MAIN VALVES & BOXES & STORE ON SITE FOR CITY
- 7 REMOVE EXIST. WATER MAIN - B.G. STIP.
- 8 REMOVE EXIST. WATER MAIN VALVES & BOXES & STORE ON SITE FOR CITY
- 9 REMOVE EXIST. WATER MAIN VALVES & BOXES & STORE ON SITE FOR CITY
- 10 REMOVE EXIST. WATER MAIN VALVES & BOXES & STORE ON SITE FOR CITY
- 11 LIGHTING FIXTURE & STD. TO BE RELOCATED BY CITY. CONTRACTOR SHALL DISCONNECT TO HANDBOX & SEAL HANDBOX FRAME & COVER TO GRADE
- 12 RESET HANDBOX TO NEW GRADE ELEVATION
- 13 RAISE SANITARY MANHOLE FRAME & COVER ON BRICK COLLAR TO NEW GRADE ELEVATION ACCORD. TO B.G. STIP.
- 14 REMOVE EXISTING FIRE HYDRANT & INSTALL NEW FIRE HYDRANT.
- 15 ABANDON SANITARY MANHOLE
- 16 CONNECT 3" SAN. INTO EXIST. 8" AT LOCATION OF REMOVED MANHOLE
- 17 ABANDON CONDUIT MANHOLE
- 18 TRAFFIC POLE
- 19 TRAFFIC POLE & CONTROLLER
- 20 WATER VALVE MANHOLE REMOVE
- 21 RAISE CONDUIT MANHOLE FRAME & COVER
- 22 ELUCIDATE PAUL CALL BOX SAME AS PAUL RELOCATION OF STREET LIGHT
- 23 FIRE CALL BOX TO BE REMOVED BY FIRE DEPARTMENT
- 24 GAS VALVE BOXES - REMOVE

LEGEND - UTILITIES

- W WATER
- E ELECTRIC CONDUIT
- T TELEPHONE CONDUIT
- S SANITARY CONDUIT SYSTEM
- D DRAIN (STORM WATER)
- G GATE VALVE
- B GAS
- NEW LIGHTING FIXTURE & STANDARD SEE DWGS NO. 3, 4, 6, 10 & 11 FOR EXACT LOCATION.
- EXISTING LIGHTING STANDARD
- ELECTRIC HANDBOX
- WATER VAULT - SEE DETAIL
- BACKFLOW PREVENTER VAULT - SEE DETAIL
- YARD HYDRANT - SEE DETAIL
- WATER METER VAULT
- MANHOLE
- UTILITY ABANDONED UNDER THIS CONTRACT
- SIGNAL POLE

- NOTES:
1. MANHOLE COVERS & FRAMES, WATER VALVES, VAULTS, PIPES, ETC. NOT SUPPLIED BY THIS WORK SHALL BE STORED ON SITE FOR PICKUP BY BALTIMORE CITY BUREAU OF OPERATIONS.
  2. SEE DRAWINGS NO. 3 & NO. 4 FOR:
    - a. STORM DRAIN WORK
    - b. GRADES
  3. NO DEMOLITION OF UTILITIES SHALL BE PERFORMED WITHOUT AUTHORITY OF RESIDENT ENGINEER. RELOCATION OF UTILITIES SHALL BE PERFORMED BY THE BUREAU OF OPERATIONS THROUGH REQUEST OF RESIDENT ENGINEER.
  4. TEST FIT ALL EXISTING UTILITIES BEFORE EXCAVATING FOR NEW WORK.

- 25 RAIL WATER METER BOX
- 26 GAS MANHOLE FRAME & COVER - RAISE
- 27 RAISE C&T TEL. CO. MANHOLE FRAME & COVER
- 28 EXISTING C&T TEL. CO. MANHOLE TO BE ABANDONED BY C&T
- 29 INSTALL NEW 3" C. DUCT TYPE "Y" AND HANDBOXES FROM EXIST. CITY CONDUIT TO TWO SIGNAL POLES
- 30 SIGNAL POLES & BASES

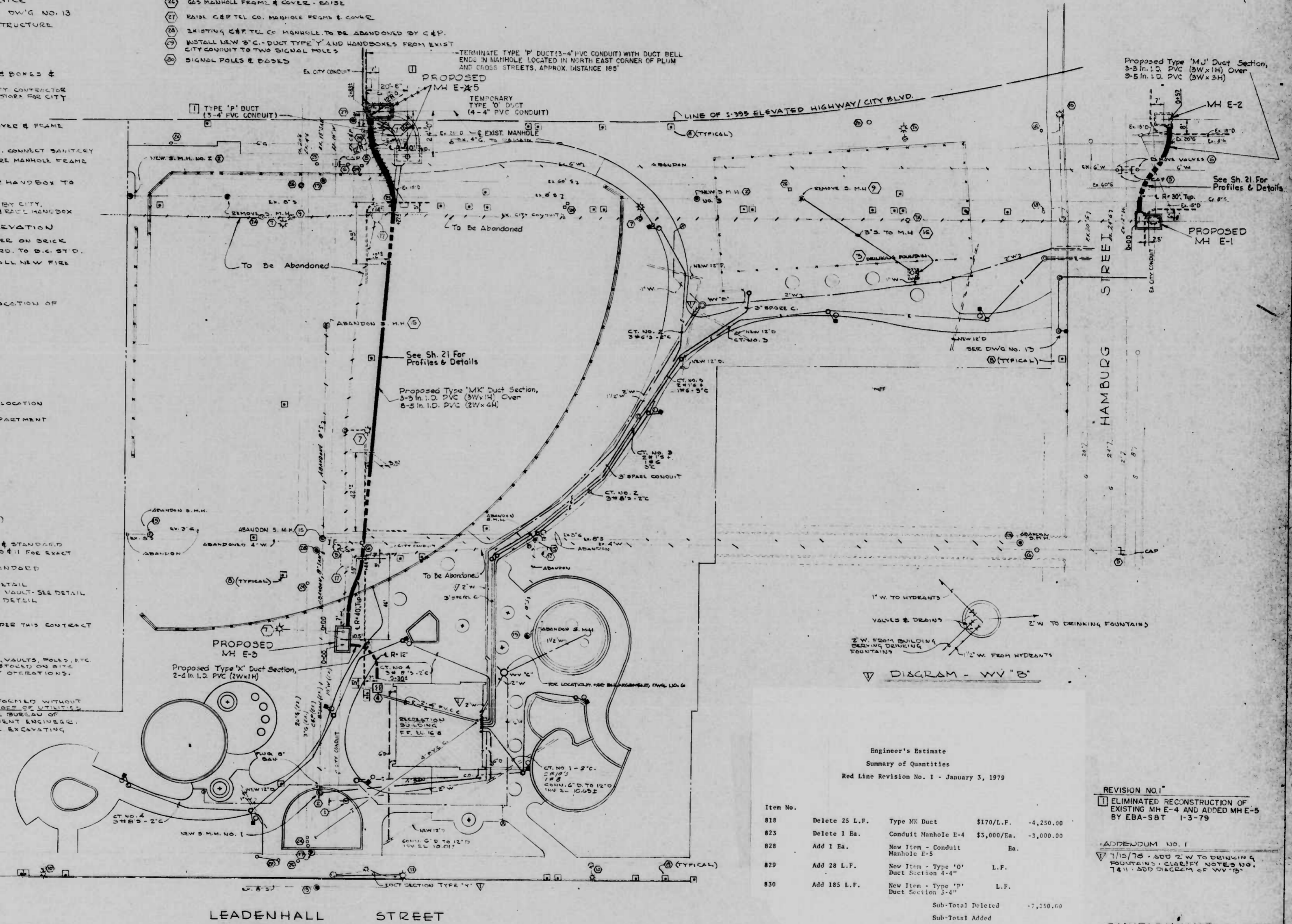

Engineer's Estimate  
Summary of Quantities  
Red Line Revision No. 1 - January 3, 1979

Item No.	Description	Unit	Rate	Quantity	Amount
818	Delete 25 L.F. Type MK Duct	L.F.	\$170/L.F.	-25	-4,250.00
823	Delete 1 Ea. Conduit Manhole E-4	Ea.	\$3,000/Ea.	-1	-3,000.00
828	Add 1 Ea. New Item - Conduit Manhole E-5	Ea.		1	
829	Add 28 L.F. New Item - Type 10' Duct Section 4.4"	L.F.		28	
830	Add 185 L.F. New Item - Type 10' Duct Section 5.4"	L.F.		185	
	Sub-Total Deleted				-7,250.00
	Sub-Total Added				
	Net Increase				

REVISION NO. 1

1 ELIMINATED RECONSTRUCTION OF EXISTING MH E-4 AND ADDED MH E-5 BY EBA-SBT 1-3-79

APPENDUM NO. 1

7/15/78 - ADD 2" W TO DRINKING FOUNTAIN'S CLARITY NOTES NO. 14.11 - ADD DIAGRAM OF WV "B"

SANITARY, WATER, GAS CONDUIT

UTILITY SITE PLAN & DETAILS

Thomas & Schifano, Inc.  
DRAWING NO. 12  
SHEET 12 OF 22  
DATE 6/23/78

SHARP LEADENHALL PARK

FEDERAL AID PROJECT NO. 1-395-8 (2)0  
STATE HIGHWAY ADMINISTRATION PROJ. NO. BC-255-11-815  
HIGHWAY ENGINEERING DIV. CONTRACT NO. 2496







RATIO 29.4

AREA REGION	STATE	FEED AND PROJ. NO.	SHEET NO.	TOTAL SHEETS
3	MD.	I-395-B(2)O	1	22

CITY OF BALTIMORE  
DEPARTMENT OF PUBLIC WORKS  
AND  
STATE HIGHWAY ADMINISTRATION OF MARYLAND  
INTERSTATE DIVISION FOR BALTIMORE CITY

**SHARP - LEADENHALL PARK**  
FUNCTIONAL REPLACEMENT OF HAMBURG ST.  
PLAYGROUND

FEDERAL AID PROJECT NO. I-395-B(2)O  
STATE HIGHWAY ADMINISTRATION PROJ. NO. BC-255-11-815  
HIGHWAY ENGINEERING DIV. CONTRACT NO. 2496

INDEX OF SHEETS

- SHEET 1 COVER SHEET
  - 2 DEMOLITION/SEWER DISCONNECT
  - 3 SITE, GRADING & LAYOUT
  - 4 SITE & GRADING PLAN
  - 5 CONSTRUCTION DETAILS
  - 6 ELLARGEMENT & MISC.
  - 7 PLAY AREA DETAILS & MISC.
  - 8 STORM DRAIN DETAILS
  - 9 HAMBURG STREET IMPROVEMENTS
  - 10 PLANTING PLAN
  - 11 PLANTING PLAN
  - 12 UTILITY SITE PLAN & DETAILS
  - 13 UTILITY SITE PLAN & DETAILS
  - 14 SEDIMENT CONTROL PLAN
  - 15 SEDIMENT CONTROL PLAN
  - 16 REC. BLDG. (FLOOR PLAN & ELEVATIONS)
  - 17 REC. BLDG. (FLOOR PLAN - CROSS SECTION & DETAIL)
  - 18 REC. BLDG. (FRAMING PLAN & WALL SECTION)
  - 19 REC. BLDG. (MECH. & ELEC. - FLOOR PLAN)
  - 20 REC. BLDG. (MECH. & ELEC. - DETAILS)
  - 21 MECH. ELEC. COND. PROFILES & MH DETAILS
  - 22 QUANTITIES SHEET
- (1) 21A MANH. LE. E-5 DETAILS (MECHANICAL ELECTRICAL)

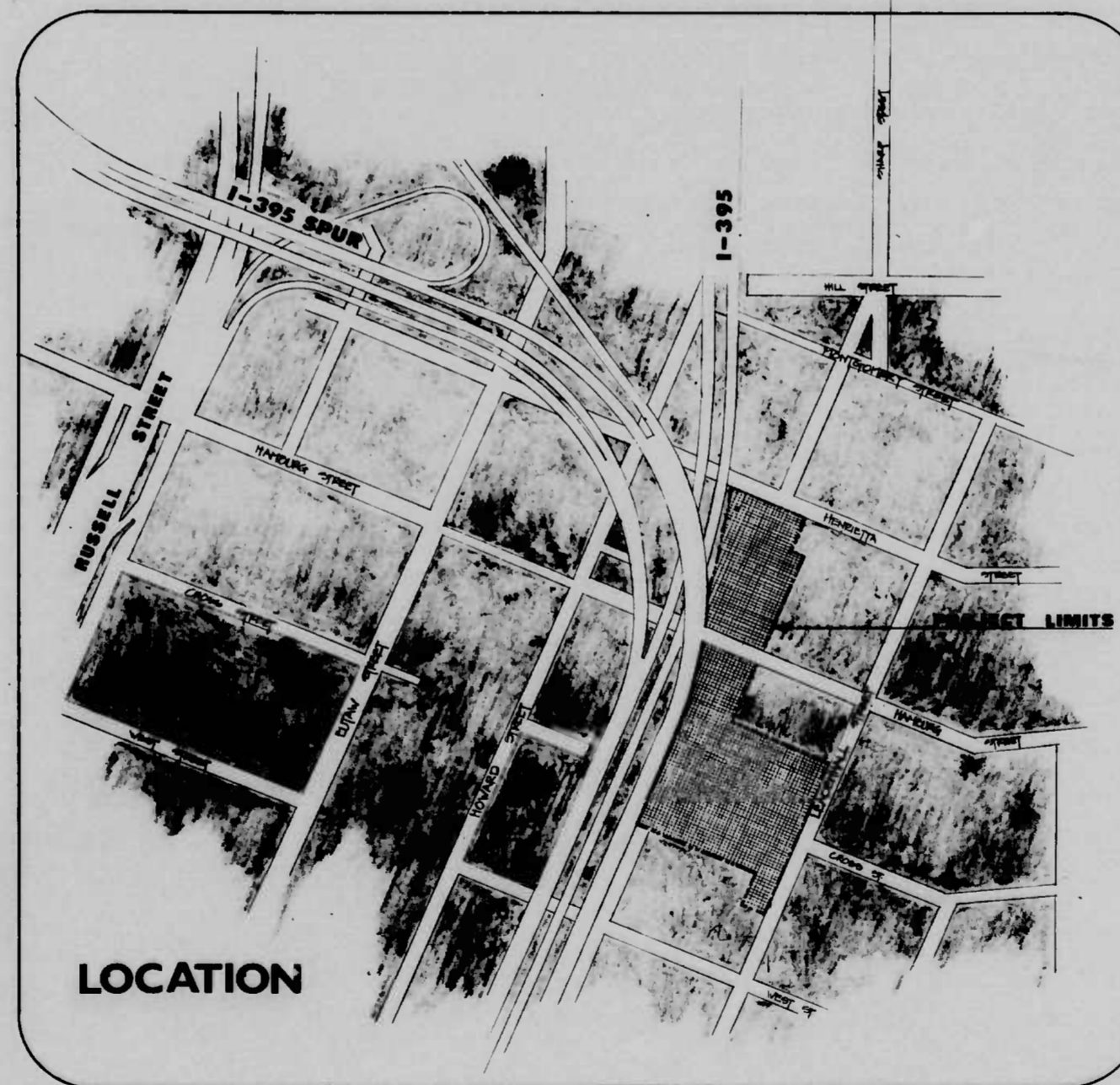

EXPLANATORY NOTES & REFERENCES

- VERTICAL CONTROL**  
ALL ELEVATIONS SHOWN ARE BASED ON BALTIMORE CITY DATUM.
- HORIZONTAL CONTROL**  
THE PROJECT IS ORIENTED TO CONFORM WITH THE BALTIMORE CITY GRID SYSTEM.
- INVERT ELEVATIONS**  
IF APPROVED BY THE ENGINEER PROPOSED INVERT ELEVATIONS MAY BE MODIFIED TO MEET CONDITIONS ENCOUNTERED DURING INSTALLATION OF UNDERGROUND FACILITIES.
- SPECIFICATIONS**  
STATE ROAD COMMISSION SPECIFICATIONS FOR MATERIALS, HIGHWAYS, BRIDGES AND INCIDENTAL STRUCTURES, DATED MARCH 1968; SUPPLEMENT TO SPECIFICATIONS FOR MATERIALS, HIGHWAYS, BRIDGES AND INCIDENTAL STRUCTURES DATED MARCH 1978 AND THE ADDENDUMS INCLUDED IN THE PROPOSAL AND SPECIAL PROVISIONS.
- MAINTENANCE OF TRAFFIC**  
SPECIAL ATTENTION IS DIRECTED TO THE REQUIREMENTS FOR MAINTENANCE OF TRAFFIC DURING THE CONSTRUCTION OF THIS PROJECT. SEE SPECIAL PROVISIONS.
- EXISTING UTILITIES**  
EXISTING UTILITY LOCATIONS SHOWN ON PLANS ARE APPROXIMATE. IT SHALL BE THE CONTRACTOR'S RESPONSIBILITY TO VERIFY THE EXACT LOCATION PRIOR TO COMMENCING WORK. THE UNDERGROUND UTILITIES AND/OR ADJUSTMENT OF THE EXISTING UTILITIES WILL BE PERFORMED BY OTHERS UNLESS OTHERWISE PROVIDED FOR IN THE PROPOSAL OR SPECIAL PROVISIONS.
- STANDARD PLATES**  
ALL BALTIMORE CITY STANDARD PLATES REFERRED TO IN THE PLANS ARE INCLUDED IN THE SPECIAL PROVISIONS.
- SEDIMENT & EROSION CONTROL**  
NO EXCAVATION SHALL COMMENCE UNTIL A SEDIMENT CONTROL PLAN HAS BEEN SUBMITTED BY THE CONTRACTOR AND APPROVED BY THE SUPERINTENDENT OF EROSION CONTROL OFFICES. SEE THE INTERPRETED DIVISION FOR BALTIMORE CITY. THE EXACT LOCATION & TYPE OF SEDIMENT CONTROL DEVICES WILL BE SUBJECT TO THE APPROVAL OF THE ENGINEER AND THE EROSION CONTROL OFFICES. THE CONTRACTOR SHALL BE RESPONSIBLE FOR OBTAINING ALL NECESSARY PERMITS AND DEVICES. SEE STD. LOC. MD. 388.01, 02, 11, 12, & 21.
- CLEARING & GRADING**  
SPECIAL ATTENTION IS DIRECTED TO THE FACT THAT NO CLEARING, DEMOLITION, GRADING OR GRADING MAY COMMENCE FOR THIS PROJECT UNTIL THE CONTRACTOR HAS AN APPROVED SEDIMENT & EROSION CONTROL PLAN AND THE LIMITS ARE GRADED IN THE FIELD AND APPROVED BY THE ENGINEER. NO CLEARING WILL BE ALLOWED BEYOND PROJECT LIMITS.
- CONSTRUCTION**  
CONSTRUCTION ARE SHOWN ON THE DRAWINGS FOR THE CONVENIENCE OF THE CONTRACTOR ONLY. ALSO THE CITY DOES NOT WARRANT OR GUARANTEE THE CORRECTNESS OR THE COMPLETENESS OF THE INFORMATION GIVEN. THE CONTRACTOR MUST VERIFY ALL DATA INFORMATION TO HIS SATISFACTION.

REVISION NO. 1  
DATE: 6/18/78  
BY: EBA-SBT 1-3-79

CHECKED BY:	INITIALS	DATE
BUREAU OF ENGINEERING	RJK	6/18/78
WATER DIVISION	WFC	6/17/78
WASTE WATER DIVISION	WFC	6/17/78
HIGHWAY ENGINEERING DIVISION	WFC	6/17/78
SURVEY AND RECORDS DIVISION	WFC	6/17/78
BUREAU OF OPERATIONS	WFC	6/17/78
LIGHTING SECTION - HIGHWAY MAINTENANCE DIV.	WFC	6/17/78
CONDUIT SECTION - HIGHWAY MAINTENANCE DIV.	WFC	6/17/78
BUREAU OF UTILITIES - IDEC	WFC	6/17/78
DEPARTMENT OF TRANSIT AND TRAFFIC	JWE	6/18/78

APPROVAL RECOMMENDED	APPROVED
CITY OF BALTIMORE DEPARTMENT OF PUBLIC WORKS	CITY OF BALTIMORE DEPARTMENT OF PUBLIC WORKS
HEAD, BUREAU OF ENGINEERING	DIRECTOR OF PUBLIC WORKS

PREPARED BY  
**Thomas & Schifano, Inc.**  
1000 North Avenue  
Baltimore, Maryland 21202  
Tel. 527-1100

DATE: 6/9/78

APPROVED:	STATE HIGHWAY ADMINISTRATION OF MARYLAND
RECREATION & PARKS ENGINEER	REVIEWED AND APPROVAL RECOMMENDED
SUPERINTENDENT, BUREAU OF PARKS	CHIEF, BUREAU OF DESIGN
DIRECTOR, DEPT. OF RECREATION & PARKS	APPROVAL RECOMMENDED
SUPERINTENDENT, BUREAU OF RECREATION	APPROVED
COMMISSIONER, DEPARTMENT OF HOUSING AND COMMUNITY DEVELOPMENT	CHIEF, INTERSTATE DIVISION FOR BALTIMORE CITY

U. S. DEPARTMENT OF TRANSPORTATION FEDERAL HIGHWAY ADMINISTRATION
APPROVED
DIVISION ADMINISTRATOR
DATE



RATIO 29.4

ITEM NO.	DESCRIPTION	UNIT	QUANTITY CONTRACT	AS-BUILT QUANTITY	QUANTITY PER DRAWING			
					1	2	3	4
<b>CATEGORY NO. 1 - PRELIMINARY</b>								
101	ENGINEERING FACILITIES	L.S.	L.S.					
102	REMOVAL AND DISPOSAL OF EXISTING BUILDINGS	L.S.	L.S.					
103	MAINTENANCE OF TRAFFIC	L.S.	L.S.					
104	CONTINGENT EXPENDITURE	L.S.	L.S.					
105	UTILIZATION	L.S.	L.S.					
106	ON THE SPOT TRAINING	H.R.	1000					
107	CLEARING & GRUBBING	L.S.	L.S.					
<b>CATEGORY NO. 2 - GRADING</b>								
201	CLASS I EXCAVATION	C.Y.	2000		1900	200		
202	BROWN EXCAVATION	C.Y.	6000		5700	230	70	
203	TRUCK PIT EXCAVATION	C.Y.	150		70	10		
204	CONTINGENT CLASS I-A EXCAVATION	C.Y.	600	600				
205	SELECT BROWN EXCAVATION	C.Y.	750		450			
206	REMOVAL OF EXISTING PAVEMENT	C.Y.	4000		4000	1000	300	
207	REMOVAL OF EXISTING SIDEWALK	C.Y.	4000		3100	1700	470	
208	CONTINGENT BROWN EXCAVATION	C.Y.	600	600				
<b>CATEGORY NO. 3 - DRAINAGE</b>								
301	CONTINGENT CLASS 2 EXCAVATION FOR INCIDENTAL CONSTRUCTION	C.Y.	200	200				
302	CONTINGENT SELECTED BACKFILL DRAIN NO. 6 MATERIAL	C.Y.	100	100				
303	18" IN. R.E. PIPE CLASS A	L.F.	1944		876	968		
304	24" IN. R.E. PIPE CONNECTION BRICK T	EA	1			1		
305	18" IN. R.E. PIPE CONNECTION BRICK T	EA	1			1		
306	24" IN. R.E. PIPE CONNECTION BRICK T	EA	2		2			
307	ADJUST EXISTING INLET	EA	1			1		
308	ADJUST EXIST. MANHOLE	EA	1			1		
309	SINGLE VE INLET	EA	13		10	0		
310	DOUBLE TYPE B INLET	EA	1		1			
311	STANDARD OPEN WATER MANHOLE	EA	1			1		
312	STANDARD OPEN WATER MANHOLE, W/DECK	EA	3		2	1		
313	CONTINGENT 18" IN. R.E. PIPE FOR PIPES, CONDUITS AND EXHAUSTS	C.Y.	5	5				
314	CONTINGENT 18" IN. R.E. PIPE FOR MISCELLANEOUS STRUCTURES	C.Y.	5	5				
315	CONTINGENT 18" IN. R.E. PIPE FOR MISCELLANEOUS STRUCTURES	C.Y.	5	5				
316	18" IN. R.E. PIPE CLASS B	L.F.	4		4			
317	REMOVAL OLD INLETS OR MANHOLES, ANY SIZE, PER TYPE	EA	7		5	2		
318	12" IN. R.E. PIPE CONNECTION BRICK T	EA	1			1		
319	CONTINGENT SELECTED BACKFILL USING CRUSHED RUN CR&G	C.Y.	100	100				
320	CONTINGENT ORDINARY BRICK MASONRY FOR MISC. STRUCTURES	C.Y.	5	5				
321	CONTINGENT SPECIAL BRICK MASONRY	C.Y.	5	5				
<b>CATEGORY NO. 4 - STRUCTURES</b>								
401	RECONSTRUCTION BUILDING, COMPLETE	L.S.	L.S.					
402	BRICK WALL	C.Y.	95		90			
403	CONCRETE WALL	C.Y.	40		40			
404	TERRAZZO CONCRETE PRACTICE WALL	L.S.	1			1		
405	REPAIRS TO CONCRETE WALLS, PER. COMPLETE	L.S.	1			1		
<b>CATEGORY NO. 5 - PAVING</b>								
501	6" CRUSH AGGREGATE STRIP AREA, BASE COURSE WITH ASPHALT BULLDOZED ON CEMENT	S.F.	910		900	20	90	
502	BITUMINOUS GRC WALKS AND/OR LOWERING COURSE	TEN	95		10	10	10	
503	BITUMINOUS GRC WALKS AND/OR LOWERING COURSE	TEN	195		19	20	150	
504	BITUMINOUS GRC WALKS AND/OR LOWERING COURSE	TEN	185		20	20	140	
505	BITUMINOUS GRC FOR MAINTENANCE OF TRAFFIC	TEN	20		0	0	10	
506	CRUSHED RUN AGGREGATE FOR MAINTENANCE OF TRAFFIC	TEN	20		0	0	10	
507	CALCIUM CHLORIDE	TEN	10		2	0	5	
<b>CATEGORY NO. 6 - SHOULDERS</b>								
601	SOFTBALL DIAMOND SHOULDERS	L.S.	L.S.					
602	CONCRETE POLE CURB	L.F.	200		200			
603	STANDARD TYPE A CONCRETE CURB & GUTTER, 24" TYPICAL, 10' LENGTH	L.F.	940				940	
604	RC TYPE A CURB 12" X 24"	L.F.	265		265			
605	CONCRETE SIDEWALK	S.F.	12520		8700		3820	
606	BITUMINOUS CONCRETE WALK PAVING	S.F.	2200		1270		930	
607	TERRAZZO CURBS, COMPLETE	L.S.	L.S.					
608	BASEBALL CURBS, COMPLETE	L.S.	L.S.					
609	SOFTBALL CURBS, COMPLETE	L.S.	L.S.					
610	TENNIS COURT PAVING & GUTTERS	L.S.	L.S.					
611	BASEBALL CURBS, PAVING	L.S.	L.S.					
612	40' FT CHANNEL PAVING, INCLUDING GATES	L.F.	976		976			
613	CONCRETE WALKING DECK 18 IN. X 9 IN.	L.F.	580		580			
614	ARCHITECTURAL PATTERNED CONCRETE PAVING, 6" THICK	S.F.	6790		4770		1920	
615	SPECIAL TYPE B CURB	L.F.	240		170		100	
616	PLAY AREA NO. 1 COMPLETE	L.S.	L.S.					
617	PLAY AREA NO. 2 COMPLETE	L.S.	L.S.					
618	PLAY AREA NO. 3 COMPLETE	L.S.	L.S.					
619	6 FT BENCH WITH BACK	EA	32		17		15	
620	4 FT X 4 FT BENCH	EA	5		5			
621	40 IN DIA CONCRETE GENT	EA	4		4			

PLANT LIST (PART OF CATEGORY 7 - LANDSCAPING)												
ITEM	DESCRIPTION	ROOT	D.B.H.	HEIGHT AT SPREAD	STEP	PIT SIZE	EQU. TRACT QUANT.	AS-BILT QUANT.	SUBTYPE			
									10	11		
<b>MAJORS OF INTERMEDIATE PERIODICUS TREES</b>												
706	ACER RUBRUM - RED MAPLE	D.B.	36"	21'-4"	62"	30'	71		20	0		
707	FRAXINUS AMERICANA - GREEN CHERRY	D.B.	24"	21'-3"	52"	30'	6		5	0		
708	FRAXINUS AMERICANA - GREEN CHERRY	D.B.	36"	21'-4"	62"	30'	18		10	0		
709	FRAXINUS AMERICANA - GREEN CHERRY	D.B.	36"	21'-4"	62"	30'	22		11	11		
710	FRAXINUS AMERICANA - GREEN CHERRY	D.B.	36"	21'-4"	62"	30'	5			5		
711	FRAXINUS AMERICANA - GREEN CHERRY	D.B.	36"	21'-4"	62"	30'	6		4	2		
712	FRAXINUS AMERICANA - GREEN CHERRY	D.B.	36"	21'-4"	62"	30'	14		6	8		
713	FRAXINUS AMERICANA - GREEN CHERRY	D.B.	36"	21'-4"	62"	30'	14		11	3		
<b>MINOR PERIODIC TREES</b>												
714	FRAXINUS AMERICANA - GREEN CHERRY	D.B.	24"	8'-10" HGT	1'-1/4"	42"	24'		21			
715	FRAXINUS AMERICANA - GREEN CHERRY	D.B.	24"	8'-10" HGT	1'-1/4"	42"	24'		7	4		
<b>SMALL TREES</b>												
716	FRAXINUS AMERICANA - GREEN CHERRY	D.B.	12"	8'-10" HGT		40"	24'		17	10		
717	FRAXINUS AMERICANA - GREEN CHERRY	D.B.	12"	8'-10" HGT		40"	24'		90	97		
<b>SHRUBS</b>												
718	FRAXINUS AMERICANA - GREEN CHERRY	1 GAL CAN		18" - 24" SPREAD					100	20		
719	FRAXINUS AMERICANA - GREEN CHERRY	5 GAL	12"	8'-10" HGT		24"	16'		22			
<b>CATEGORY NO. 7 - LANDSCAPING</b>												
721	TEMPORARY PAVING PLACE 4 IN DEPTH	C.Y.	16000				1700	4700				
722	TEMPORARY PAVING	C.Y.	1600		1600							
723	GRASS SEEDING	S.F.	16000				1700	4700				
724	LANDSCAPE MATERIAL 2 IN THICK	C.Y.	220				170	90				
725	WATERING	M.GAL.	20									
726	SEE PLANT LIST FOR ITEMS 706 TO 719											
<b>CATEGORY NO. 8 - UTILITIES</b>												
801	CONCRETE CURB	L.S.	L.S.									
802	CONCRETE CURB	EA	2									
803	ADJUST EXISTING UTILITY SERVICE MENHOLE	EA	50				5	2	3			
804	STANDARD EXISTING UTILITY SERVICE MENHOLE	EA	5									
805	STANDARD EXISTING UTILITY SERVICE MENHOLE	EA	5									
806	WATER SERVICE AND FLUSH HYDRANT SYSTEM	L.S.	L.S.									
807	6" CAST IRON PIPE AND FITTINGS	L.F.	150						150			
808	6" CAST IRON PIPE AND FITTINGS	L.F.	16						16			
809	FIRE HYDRANT (REPLACE EXIST. FIRE HYDRANT)	EA	1						1			
810	REMOVAL OF EXISTING SANITARY MANHOLE	EA	2						2			
811	REMOVAL OF EXISTING WATER METE VAULT OR WATER VALVE VAULT OR BOX	EA	1						1			
812	PARK LIGHTING SYSTEM	L.S.	L.S.									
813	REMOVAL OF EXISTING MANHOLES FOR STREET LIGHTING	EA	7						7			
814	CAPTURE EXISTING WATER MAINS	EA	6						6			
815	ADJUST EXISTING SANITARY MANHOLE	EA	3						3			
816	TYPE Y DUCT, 3" PVC	L.F.	130						130			
817	TYPE 'M' DUCT SECTION, 3-3 IN. I.D. PVC (3W X 2H)	L.F.	90						90			
818	TYPE 'M' DUCT SECTION, 3-3 IN. I.D. PVC (3W X 2H)	L.F.	24247						24247			
819	TYPE 'X' DUCT SECTION, 3-4 IN. I.D. PVC (3W X 2H)	L.F.	26						26			
820	CONDUIT MANHOLE 'E-1'	EA	1						1			
821	CONDUIT MANHOLE 'E-2'	EA	1						1			
822	CONDUIT MANHOLE 'E-3'	EA	1						1			
823	CONDUIT MANHOLE 'E-4'	EA	4						4			
824	APPROVAL & REMOVE WATER MAIN VALVES	EA	5						5			
825	TRAFFIC SIGNAL LIGHTING STANDARD	EA	2						2			
826	TRAFFIC SIGNAL POLE FOUNDATION	EA	2						2			
827	HAND BOX FOR TRAFFIC DEVICE	EA	3						3			
828	CONDUIT MANHOLE 'E-5'	EA	1						1			
829	TYPE 'O' DUCT SECTION, 4-4 IN. I.D. PVC (2W X 2H)	L.F.	28						28			
830	TYPE 'P' DUCT SECTION, 3-4 IN. I.D. PVC (3W X 1H)	L.F.	185						185			

# SHARP-LEADENHALL PARK

FEDERAL AID PROJECT NO. 1-3-78  
 STATE HIGHWAY DEPARTMENT, DIVISION OF HIGHWAYS, NO. 1-3-78  
 HIGHWAY ENGINEERING DIV. CONTRACT NO. 1-3-78

ADDENDUM NO. 1  
 7-15-78  
 REVISION NO. 1  
 QUANTITIES BY  
 EBA-SBT 1-3-79

QUANTITIES SHEET  
 22  
 SHEET 24 OF 28  
 DATE 6/21/78



RATIO 29.4

FED. AID REGION	STATE	FED. AID PROJ. NO.	SHEET NO.	TOTAL SHEETS
3	MD.	I-395-B(2)O	1	22

CITY OF BALTIMORE  
DEPARTMENT OF PUBLIC WORKS  
AND  
STATE HIGHWAY ADMINISTRATION OF MARYLAND  
INTERSTATE DIVISION FOR BALTIMORE CITY

**SHARP - LEADENHALL PARK**  
FUNCTIONAL REPLACEMENT OF HAMBURG ST.  
PLAYGROUND

FEDERAL AID PROJECT NO. I-395-B(2)O  
STATE HIGHWAY ADMINISTRATION PROJ. NO. BC-255-11-815  
HIGHWAY ENGINEERING DIV. CONTRACT NO. 2496

INDEX OF SHEETS

- SHEET 1 COVER SHEET
  - 2 DEMOLITION/SEWER DISCONNECT
  - 3 SITE, GRADING & LAYOUT
  - 4 SITE & GRADING PLAN
  - 5 CONSTRUCTION DETAILS
  - 6 ENLARGEMENT & MISC.
  - 7 PLAY AREA DETAILS & MISC.
  - 8 STORM DRAIN DETAILS
  - 9 HAMBURG STREET IMPROVEMENTS
  - 10 PLANTING PLAN
  - 11 PLANTING PLAN & DETAILS
  - 12 UTILITY SITE PLAN & DETAILS
  - 13 UTILITY SITE PLAN & DETAILS
  - 14 SEDIMENT CONTROL PLAN
  - 15 SEDIMENT CONTROL PLAN
  - 16 REC. BLDG. (FLOOR PLAN & ELEVATION)
  - 17 REC. BLDG. (PARTIAL PLAN - CROSS SECTIONS & DETAIL)
  - 18 REC. BLDG. (MECH. & ELEC. - FLOOR PLANS)
  - 19 REC. BLDG. (MECH. & ELEC. - DETAILS)
  - 20 REC. BLDG. (MECH. & ELEC. - DETAILS)
  - 21 MECH. ELEC. COND. PROFILES & MH DETAILS
  - 22 QUANTITIES SHEET
- [1] MANH. LE. E-5 DETAILS (MECHANICAL, ELECTRICAL)

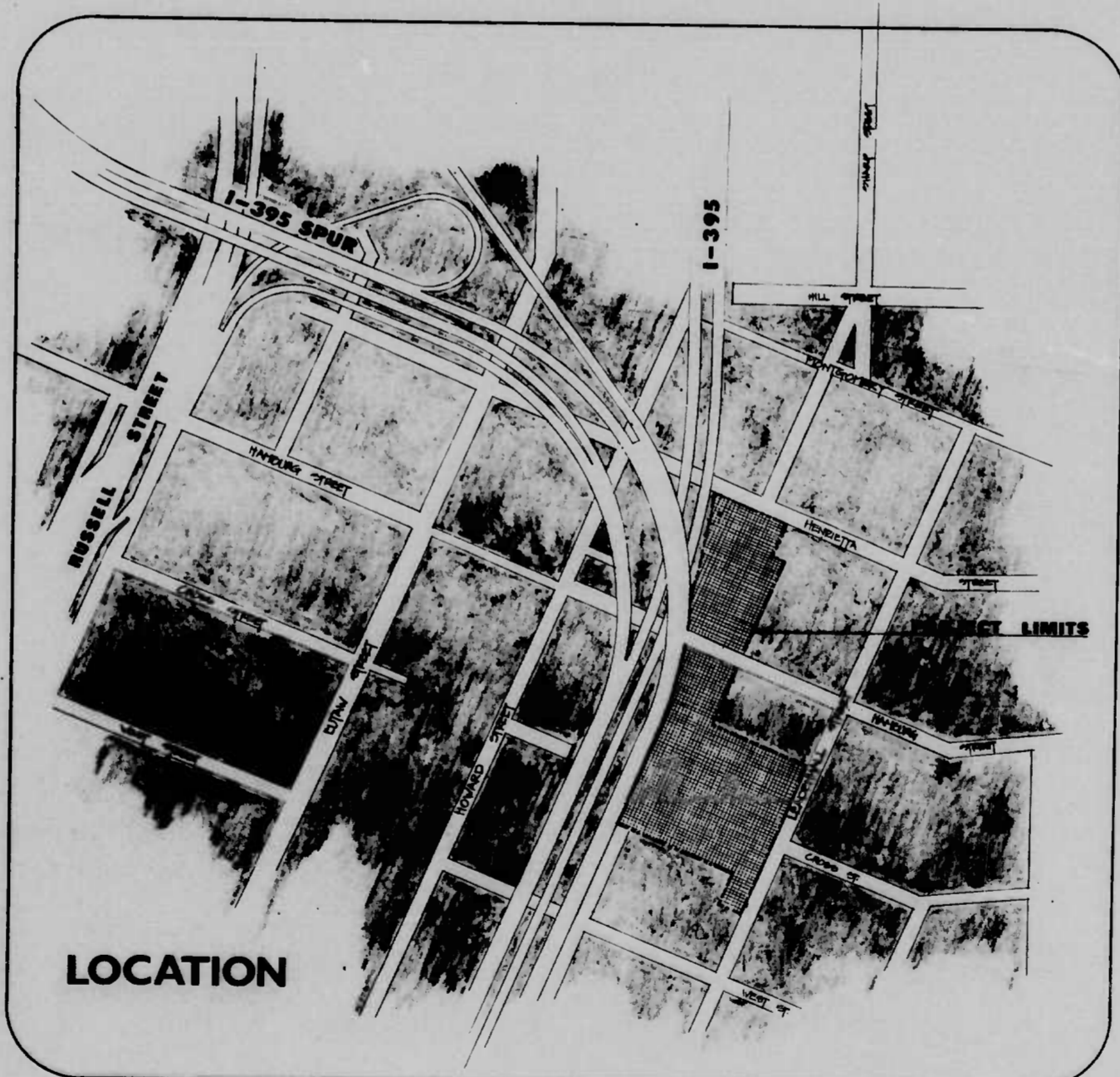

EXPLANATORY NOTES & REFERENCES

- VERTICAL CONTROL**  
ALL ELEVATIONS SHOWN ARE BASED ON BALTIMORE CITY DATUM.
- HORIZONTAL CONTROL**  
THE PROJECT IS ORIENTED TO CONFORM WITH THE BALTIMORE CITY GRID SYSTEM.
- INVERT ELEVATIONS**  
IF APPROVED BY THE ENGINEER PROPOSED INVERT ELEVATIONS MAY BE MODIFIED TO MEET CONDITIONS ENCOUNTERED DURING INSTALLATION OF UNDERGROUND FACILITIES.
- SPECIFICATIONS**  
STATE ROAD COMMISSION SPECIFICATIONS FOR MATERIALS, HIGHWAYS, BRIDGES AND INCIDENTAL STRUCTURES, LATEST EDITION, SHALL BE SUPPLEMENTED BY SPECIFICATIONS FOR MATERIALS, HIGHWAYS, BRIDGES AND INCIDENTAL STRUCTURES DATED MARCH 1978 AND THE ADDENDUMS INCLUDED IN THE PROPOSAL AND SPECIAL PROVISIONS.
- MAINTENANCE OF TRAFFIC**  
SPECIAL ATTENTION IS DIRECTED TO THE REQUIREMENTS FOR MAINTENANCE OF TRAFFIC DURING THE CONSTRUCTION OF THIS PROJECT. SEE SPECIAL PROVISIONS.
- EXISTING UTILITIES**  
EXISTING UTILITY LOCATIONS SHOWN ON PLANS ARE APPROXIMATE. IT SHALL BE THE CONTRACTOR'S RESPONSIBILITY TO VERIFY THE EXACT LOCATION PRIOR TO COMMENCING WORK. THE NECESSARY RELOCATION AND/OR ADJUSTMENT OF THE EXISTING UTILITIES WILL BE PROVIDED BY OTHER AGENCIES UNLESS OTHERWISE PROVIDED FOR IN THE PROPOSAL OR SPECIAL PROVISIONS.
- STANDARD PLATES**  
ALL BALTIMORE CITY STANDARD PLATES REFERRED TO IN THE PLANS ARE INCLUDED IN THE SPECIAL PROVISIONS.
- SEDIMENT & EROSION CONTROL**  
NO EXCAVATION SHALL COMMENCE UNTIL A SEDIMENT CONTROL PLAN HAS BEEN SUBMITTED BY THE CONTRACTOR AND APPROVED BY THE SUPERINTENDENT OF SEDIMENT & EROSION CONTROL. FOR THE ILLUSTRATED DIVISION FOR BALTIMORE CITY, THE EXACT LOCATION, TYPE OF SEDIMENT CONTROL DEVICES WILL BE SUBJECT TO THE APPROVAL OF THE ENGINEER AND THE SEDIMENT CONTROL OFFICER. TO P.O.C. THEY RESERVE THE RIGHT TO ORDER ADDITIONAL DEVICES AND SEDIMENT DEVICES. SEE STD. D.O. MD. 288/01, 02, 11, 12, & 21.
- CLEARING & GRUBBING**  
SPECIAL ATTENTION IS DIRECTED TO THE FACT THAT NO CLEARING, DEMOLITION, GRUBBING OR GRADING MAY COMMENCE FOR THE PROJECT UNTIL THE CONTRACTOR HAS AN APPROVED SEDIMENT & EROSION CONTROL PLAN AND THE LIMITS ARE STAKED IN THE FIELD AND APPROVED BY THE ENGINEER. NO CLEARING WILL BE ALLOWED BEYOND PROJECT LIMITS.
- CONSTRUCTION**  
CONSTRUCTION ARE SHOWN ON THE DRAWINGS FOR THE CONVENIENCE OF THE CONTRACTOR ONLY. ALSO THE CITY DOES NOT WARRANT OR GUARANTEE THE CORRECTNESS OR THE COMPLETENESS OF THE INFORMATION GIVEN. THE CONTRACTOR MUST VERIFY ALL SUCH INFORMATION TO BE SATISFACTORY.

REVISION NO. 1  
BY EBA-SBT 1-3-79

INTERSTATE DIVISION FOR BALTIMORE CITY  
APPROVED: *[Signature]* DATE: 6/7/78  
SEEDMENT CONTROL OFFICER

CHECKED BY:	INITIALS	DATE
BUREAU OF ENGINEERING	<i>[Initials]</i>	6/11/78
WATER DIVISION	<i>[Initials]</i>	6/12/78
WASTE WATER DIVISION	<i>[Initials]</i>	6/12/78
HIGHWAY ENGINEERING DIVISION	<i>[Initials]</i>	6/11/78
SURVEY AND RECORDS DIVISION	<i>[Initials]</i>	6/12/78
BUREAU OF OPERATIONS	<i>[Initials]</i>	6/18/78
LIGHTING SECTION - HIGHWAY MAINTENANCE DIV.	<i>[Initials]</i>	6/12/78
CONDUIT SECTION - HIGHWAY MAINTENANCE DIV.	<i>[Initials]</i>	6/12/78
BUREAU OF UTILITIES - IDBC	<i>[Initials]</i>	6/15/78
DEPARTMENT OF TRANSIT AND TRAFFIC	<i>[Initials]</i>	6/18/78

CITY OF BALTIMORE  
DEPARTMENT OF PUBLIC WORKS

APPROVAL RECOMMENDED  
*[Signature]*  
HEAD, BUREAU OF ENGINEERING

APPROVED  
*[Signature]*  
DIRECTOR OF PUBLIC WORKS

PREPARED BY  
**Thomas & Schifano, Inc.**  
2000 N. W. 10th Street, Suite 200  
Fort Lauderdale, Florida 33309

DATE OF MARYLAND  
REGISTERED PROFESSIONAL ENGINEER  
NO. 10000  
DATE: 6-9-78

APPROVED:  
*[Signature]*  
RECREATION & PARKS ENGINEER

*[Signature]*  
SUPERINTENDENT, BUREAU OF PARKS

*[Signature]*  
DIRECTOR, DEPT. OF RECREATION & PARKS

*[Signature]*  
SUPERINTENDENT, BUREAU OF RECREATION

*[Signature]*  
COMMISSIONER, DEPARTMENT OF HOUSING AND COMMUNITY DEVELOPMENT

STATE HIGHWAY ADMINISTRATION OF MARYLAND

REVIEWED AND APPROVAL RECOMMENDED  
*[Signature]*  
CHIEF, BUREAU OF DESIGN

APPROVAL RECOMMENDED  
*[Signature]*  
CHIEF, INTERSTATE DIVISION FOR BALTIMORE CITY

APPROVED  
*[Signature]*  
CHIEF ENGINEER

U. S. DEPARTMENT OF TRANSPORTATION  
FEDERAL HIGHWAY ADMINISTRATION

APPROVED  
*[Signature]*  
DIVISION ADMINISTRATOR

DATE