

38° 50' 00"  
MAP NO. G-14  
360  
4295  
350  
340  
4290

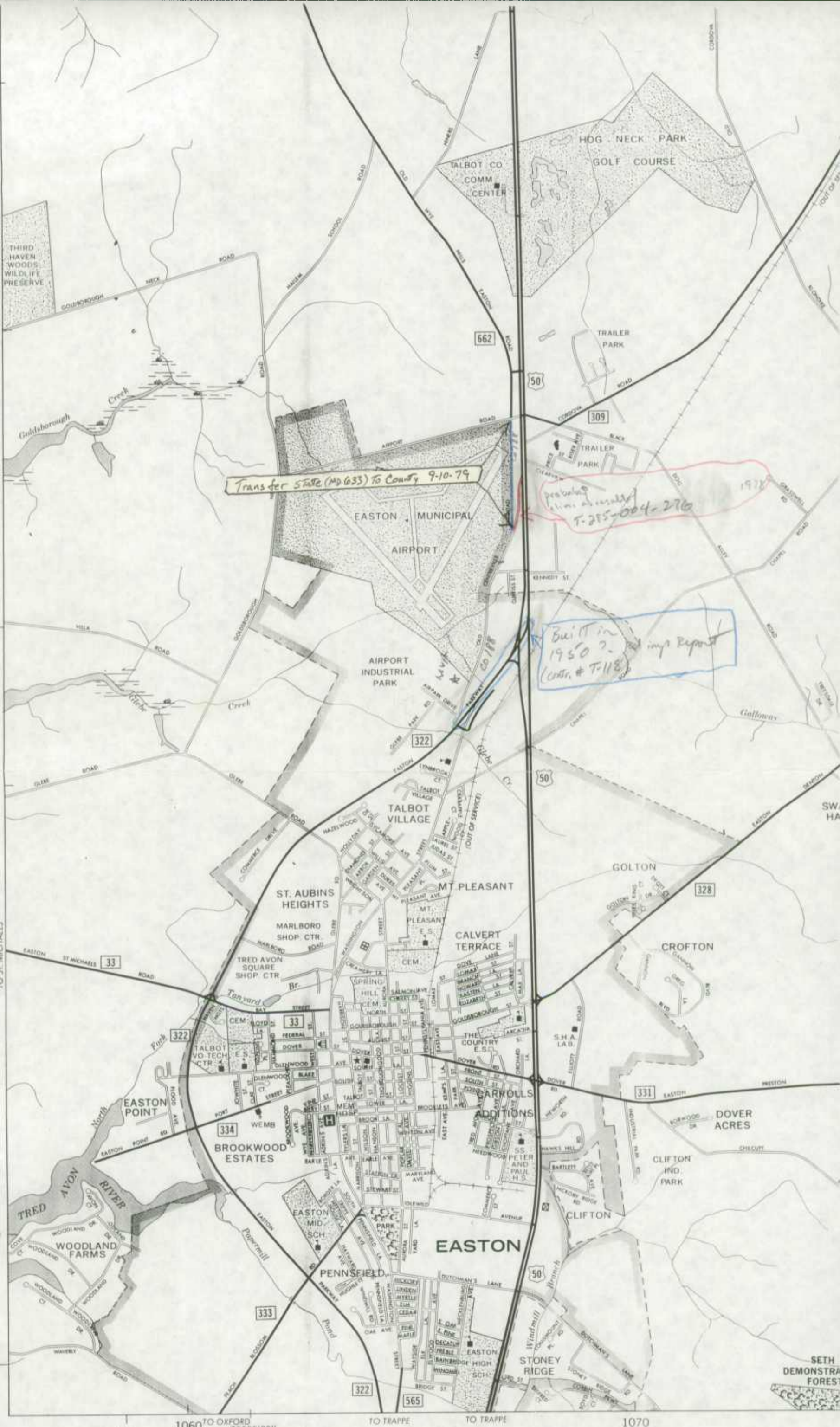

MAP

ROADSIDE CULTURE

- Army
- Hospital
- Post Office

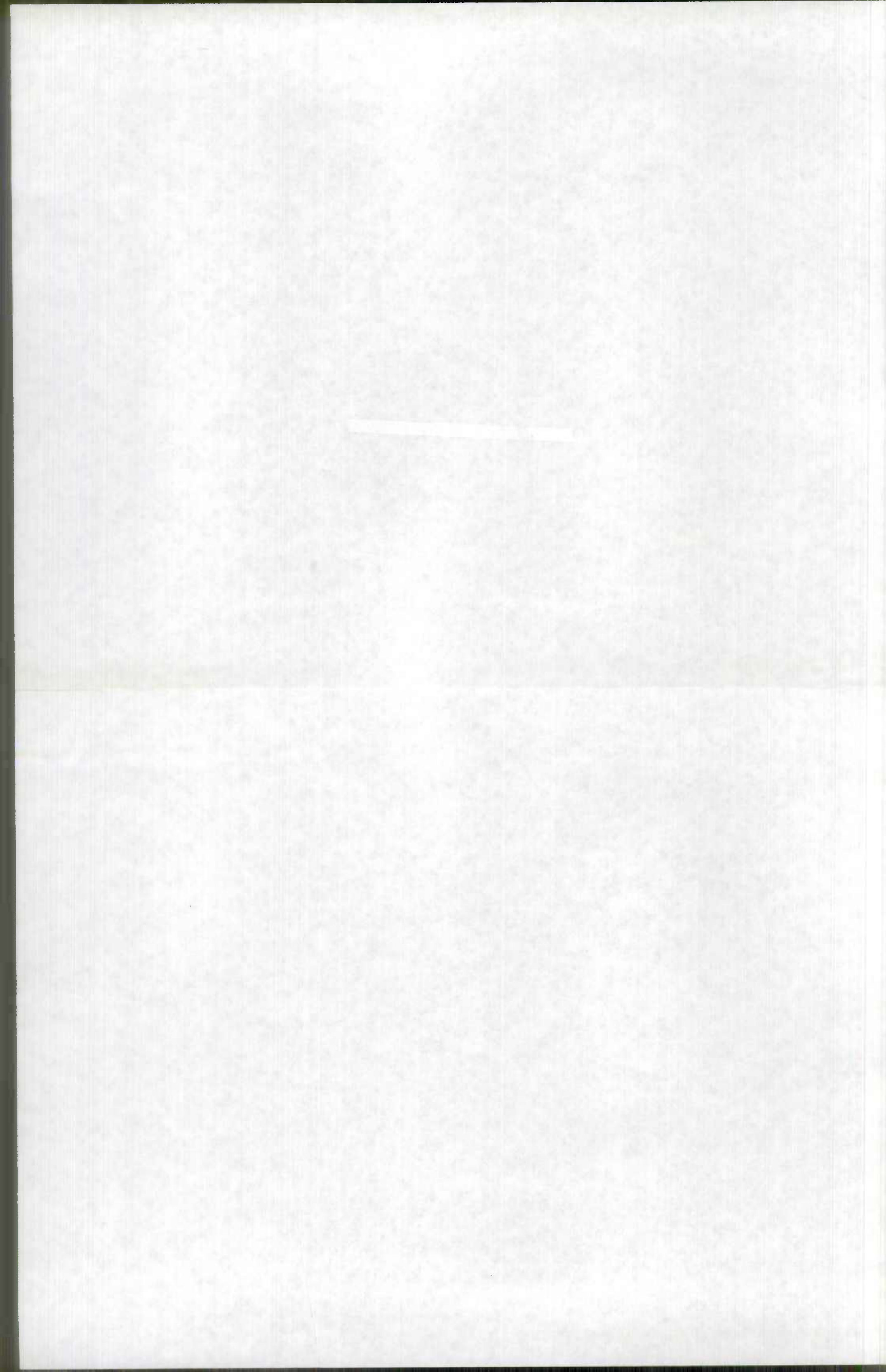



The first part of the document discusses the importance of maintaining accurate records of all transactions. It emphasizes that every entry should be supported by a valid receipt or invoice. This ensures transparency and allows for easy verification of the data.

In the second section, the author details the various methods used to collect and analyze the data. This includes both manual and automated processes, as well as the use of specialized software tools. The goal is to ensure that the data is both reliable and easy to interpret.

The third part of the document provides a detailed breakdown of the results. It shows that there is a clear trend in the data, which is consistent with the initial hypothesis. This finding is significant as it provides strong evidence for the proposed model.

Finally, the document concludes with a summary of the key findings and a list of recommendations for future research. It suggests that further studies should be conducted to explore the underlying causes of the observed trends and to test the model under different conditions.

Date: 10/25/2023  
 Author: John Doe



114-150-111

old Inventory (old alignment)  
1067 1/2 - 357



ROAD INVENTORY SHEET

Party Chief F. SETTAN  
Recorder T. LANDON  
Chairman S. MARTIN



T. LANDON  
F. RHODES

Road No. Co 188  
Name (JONES RD)  
Sheet No. 10F1  
Date 6-3-66  
County TALBOT

SEE

VERIFIED  
5/26/77

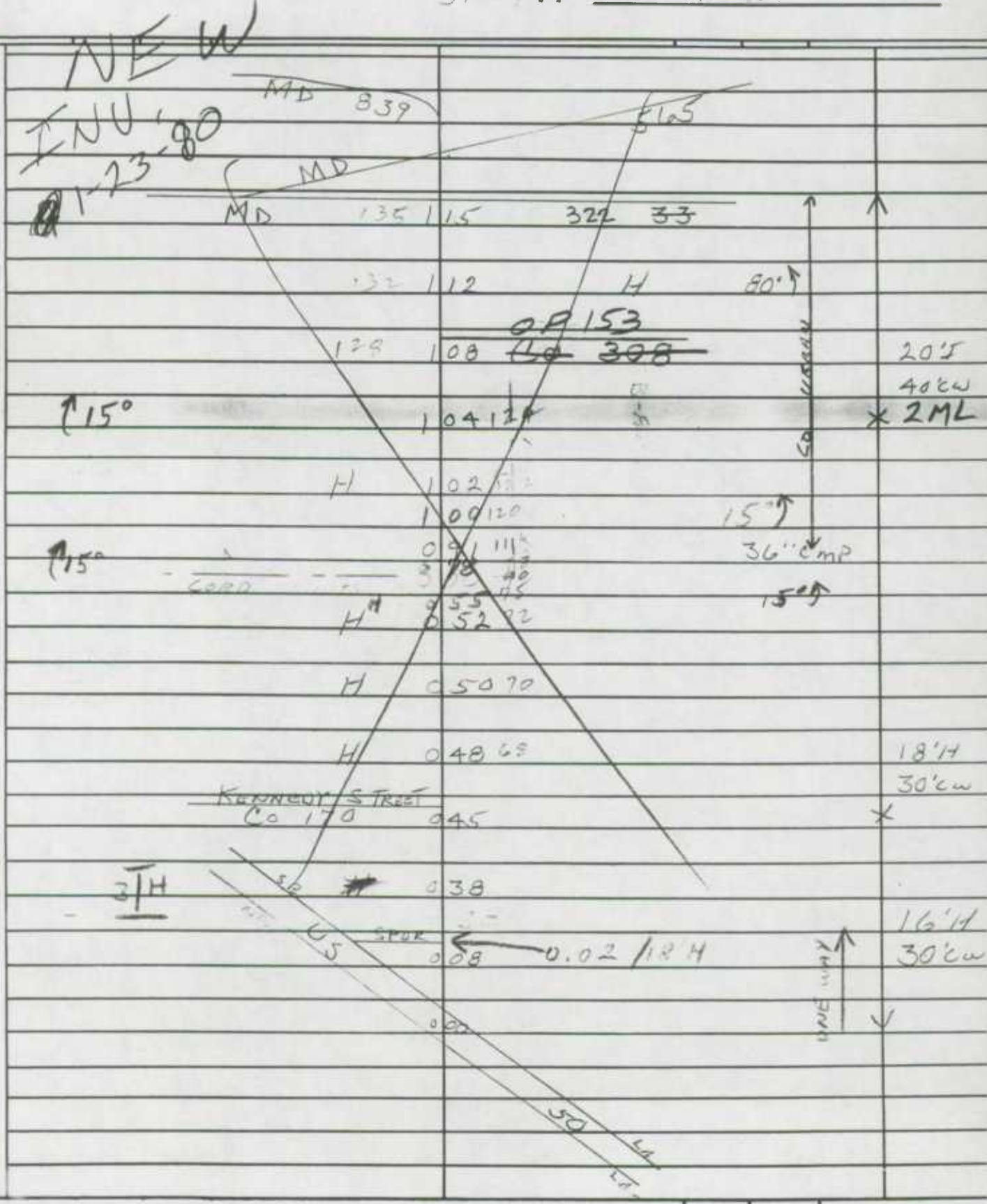

No.	Name	Address	City	State
1	John A. Smith	123 Main St.	Chicago	Ill.
2	James B. Jones	456 Elm St.	New York	N.Y.
3	Robert C. Brown	789 Oak St.	Philadelphia	Pa.
4	William D. White	1011 Pine St.	San Francisco	Calif.
5	Charles E. Black	1313 Cedar St.	Boston	Mass.
6	Thomas F. Green	1615 Birch St.	Washington	D.C.
7	Richard G. Gray	1917 Spruce St.	St. Louis	Mo.
8	Henry H. Hall	2219 Ash St.	Portland	Ore.
9	George I. King	2521 Willow St.	Seattle	Wash.
10	Frank J. Lee	2823 Poplar St.	Denver	Colo.
11	Edward K. Miller	3125 Magnolia St.	San Diego	Calif.
12	Arthur L. Moore	3427 Hickory St.	Los Angeles	Calif.
13	Harold M. Taylor	3729 Sycamore St.	San Jose	Calif.
14	Clarence N. Walker	4031 Chestnut St.	San Antonio	Texas
15	Walter O. Young	4333 Walnut St.	Dallas	Texas
16	Albert P. Adams	4635 Elm St.	Fort Worth	Texas
17	Samuel Q. Baker	4937 Maple St.	Austin	Texas
18	Joseph R. Clark	5239 Cedar St.	Houston	Texas
19	Charles S. Evans	5541 Birch St.	San Francisco	Calif.
20	Frederick T. Fisher	5843 Spruce St.	San Francisco	Calif.
21	William U. Grant	6145 Ash St.	San Francisco	Calif.
22	Robert V. Hill	6447 Willow St.	San Francisco	Calif.
23	George W. Jackson	6749 Poplar St.	San Francisco	Calif.
24	Edward X. King	7051 Magnolia St.	San Francisco	Calif.
25	Harold Y. Lee	7353 Hickory St.	San Francisco	Calif.
26	Clarence Z. Miller	7655 Sycamore St.	San Francisco	Calif.
27	Walter A. Moore	7957 Chestnut St.	San Francisco	Calif.
28	Albert B. Taylor	8259 Walnut St.	San Francisco	Calif.
29	Samuel C. Walker	8561 Elm St.	San Francisco	Calif.
30	Joseph D. Young	8863 Maple St.	San Francisco	Calif.
31	Charles E. Adams	9165 Cedar St.	San Francisco	Calif.
32	Frederick F. Baker	9467 Birch St.	San Francisco	Calif.
33	William G. Clark	9769 Spruce St.	San Francisco	Calif.
34	Robert H. Evans	10071 Ash St.	San Francisco	Calif.
35	George I. Fisher	10373 Willow St.	San Francisco	Calif.
36	Harold J. Grant	10675 Poplar St.	San Francisco	Calif.
37	Clarence K. Hill	10977 Magnolia St.	San Francisco	Calif.
38	Walter L. King	11279 Hickory St.	San Francisco	Calif.
39	Albert M. Lee	11581 Sycamore St.	San Francisco	Calif.
40	Samuel N. Miller	11883 Chestnut St.	San Francisco	Calif.
41	Joseph O. Moore	12185 Walnut St.	San Francisco	Calif.
42	Charles P. Taylor	12487 Elm St.	San Francisco	Calif.
43	Frederick Q. Walker	12789 Maple St.	San Francisco	Calif.
44	William R. Young	13091 Cedar St.	San Francisco	Calif.
45	Edward S. Adams	13393 Birch St.	San Francisco	Calif.
46	Harold T. Baker	13695 Spruce St.	San Francisco	Calif.
47	Clarence U. Clark	13997 Ash St.	San Francisco	Calif.
48	Walter V. Evans	14299 Willow St.	San Francisco	Calif.
49	Albert W. Fisher	14601 Poplar St.	San Francisco	Calif.
50	Samuel X. Grant	14903 Magnolia St.	San Francisco	Calif.
51	Joseph Y. Hill	15205 Hickory St.	San Francisco	Calif.
52	Charles Z. King	15507 Sycamore St.	San Francisco	Calif.
53	Frederick A. Lee	15809 Chestnut St.	San Francisco	Calif.
54	William B. Miller	16111 Walnut St.	San Francisco	Calif.
55	Robert C. Moore	16413 Elm St.	San Francisco	Calif.
56	George D. Taylor	16715 Maple St.	San Francisco	Calif.
57	Harold E. Walker	17017 Cedar St.	San Francisco	Calif.
58	Clarence F. Young	17319 Birch St.	San Francisco	Calif.
59	Walter G. Adams	17621 Spruce St.	San Francisco	Calif.
60	Albert H. Baker	17923 Ash St.	San Francisco	Calif.
61	Samuel I. Clark	18225 Willow St.	San Francisco	Calif.
62	Joseph J. Evans	18527 Poplar St.	San Francisco	Calif.
63	Charles K. Fisher	18829 Magnolia St.	San Francisco	Calif.
64	Frederick L. Grant	19131 Hickory St.	San Francisco	Calif.
65	William M. Hill	19433 Sycamore St.	San Francisco	Calif.
66	Robert N. King	19735 Chestnut St.	San Francisco	Calif.
67	George O. Lee	20037 Walnut St.	San Francisco	Calif.
68	Harold P. Miller	20339 Elm St.	San Francisco	Calif.
69	Clarence Q. Moore	20641 Maple St.	San Francisco	Calif.
70	Walter R. Taylor	20943 Cedar St.	San Francisco	Calif.
71	Albert S. Walker	21245 Birch St.	San Francisco	Calif.
72	Samuel T. Young	21547 Spruce St.	San Francisco	Calif.
73	Joseph U. Adams	21849 Ash St.	San Francisco	Calif.
74	Charles V. Baker	22151 Willow St.	San Francisco	Calif.
75	Frederick W. Clark	22453 Poplar St.	San Francisco	Calif.
76	William X. Evans	22755 Magnolia St.	San Francisco	Calif.
77	Robert Y. Fisher	23057 Hickory St.	San Francisco	Calif.
78	George Z. Grant	23359 Sycamore St.	San Francisco	Calif.
79	Harold A. Hill	23661 Chestnut St.	San Francisco	Calif.
80	Clarence B. King	23963 Walnut St.	San Francisco	Calif.
81	Walter C. Lee	24265 Elm St.	San Francisco	Calif.
82	Albert D. Miller	24567 Maple St.	San Francisco	Calif.
83	Samuel E. Moore	24869 Cedar St.	San Francisco	Calif.
84	Joseph F. Taylor	25171 Birch St.	San Francisco	Calif.
85	Charles G. Walker	25473 Spruce St.	San Francisco	Calif.
86	Frederick H. Young	25775 Ash St.	San Francisco	Calif.
87	William I. Adams	26077 Willow St.	San Francisco	Calif.
88	Robert J. Baker	26379 Poplar St.	San Francisco	Calif.
89	George K. Clark	26681 Magnolia St.	San Francisco	Calif.
90	Harold L. Evans	26983 Hickory St.	San Francisco	Calif.
91	Clarence M. Fisher	27285 Sycamore St.	San Francisco	Calif.
92	Walter N. Grant	27587 Chestnut St.	San Francisco	Calif.
93	Albert O. Hill	27889 Walnut St.	San Francisco	Calif.
94	Samuel P. King	28191 Elm St.	San Francisco	Calif.
95	Joseph Q. Lee	28493 Maple St.	San Francisco	Calif.
96	Charles R. Miller	28795 Cedar St.	San Francisco	Calif.
97	Frederick S. Moore	29097 Birch St.	San Francisco	Calif.
98	William T. Taylor	29399 Spruce St.	San Francisco	Calif.
99	Robert U. Walker	29701 Ash St.	San Francisco	Calif.
100	George V. Young	30003 Willow St.	San Francisco	Calif.





Chapter 10: Concentration of acids

T	D	O	B	L.A	2017 19/11/16	2017 20/11/16
10/11/16		0.5201	0.5	(0.5201/0.5) x 100	104.02%	104.02%
10/11/16			0.5	(0.5201/0.5) x 100	104.02%	104.02%
10/11/16			0.5	(0.5201/0.5) x 100	104.02%	104.02%
10/11/16			0.5	(0.5201/0.5) x 100	104.02%	104.02%

(0.5201/0.5) x 100 = 104.02%

TALBOT County Rural Road Mileage - Jan. 1952

Co. Rd. Number	Total Mileage	Mileage by Type											
		A	B	C	D	E	F	G-1	G-2	H-1	H-2	I	J
-184	0.220 (NEW)			+0.220									
-185	0.395 (NEW)					+0.39							
-186	0.220 (NEW)					+0.22							
-187	0.485 (NEW)					+0.49							
-188	1.158 (FROM STATE TO COUNTY)									+1.16			
CREAMERY LANE	-0.19 (FROM CO. TO MUNI.)					-0.19							
SUB TOTAL	272.89	—	4.05	18.37	88.57	96.48	63.60	0.16	—	1.16			0.50
C 167	AUREA ST -0.23 (FROM CO. TO Co. U)							-0.23					
Co 95	DUTCHMAN LA -0.16 (FROM CO. TO Co. U)					-0.16							
Co 37	GLEBE RD -0.54 (FROM CO. TO Co. U)					-0.54							
TOTAL 12-31-51	271.96		4.05	18.37	88.57	95.78	63.37	0.16		1.16			0.50

WRH

1921  
Major Tomášek's land parcels