

MD 18013
NIMES AVE

ROY CANNON R/W
DIST 304
1801-635-5119

STATE HIGHWAY ADMINISTRATION
DESIGN DIVISION

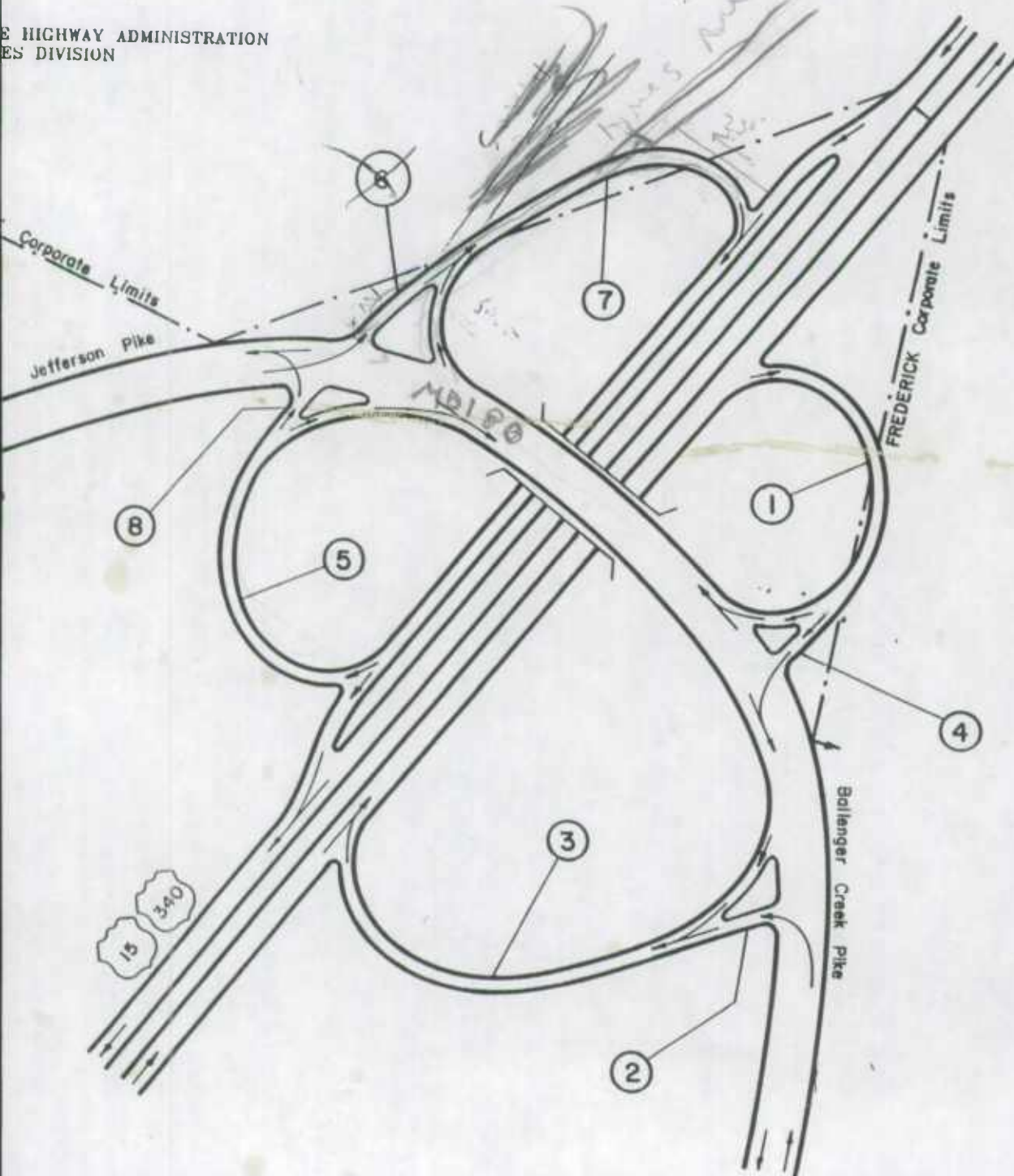

US 15 / 340
INTERCHANGE
MD 180 Ballenger Ck. Pk. / Je

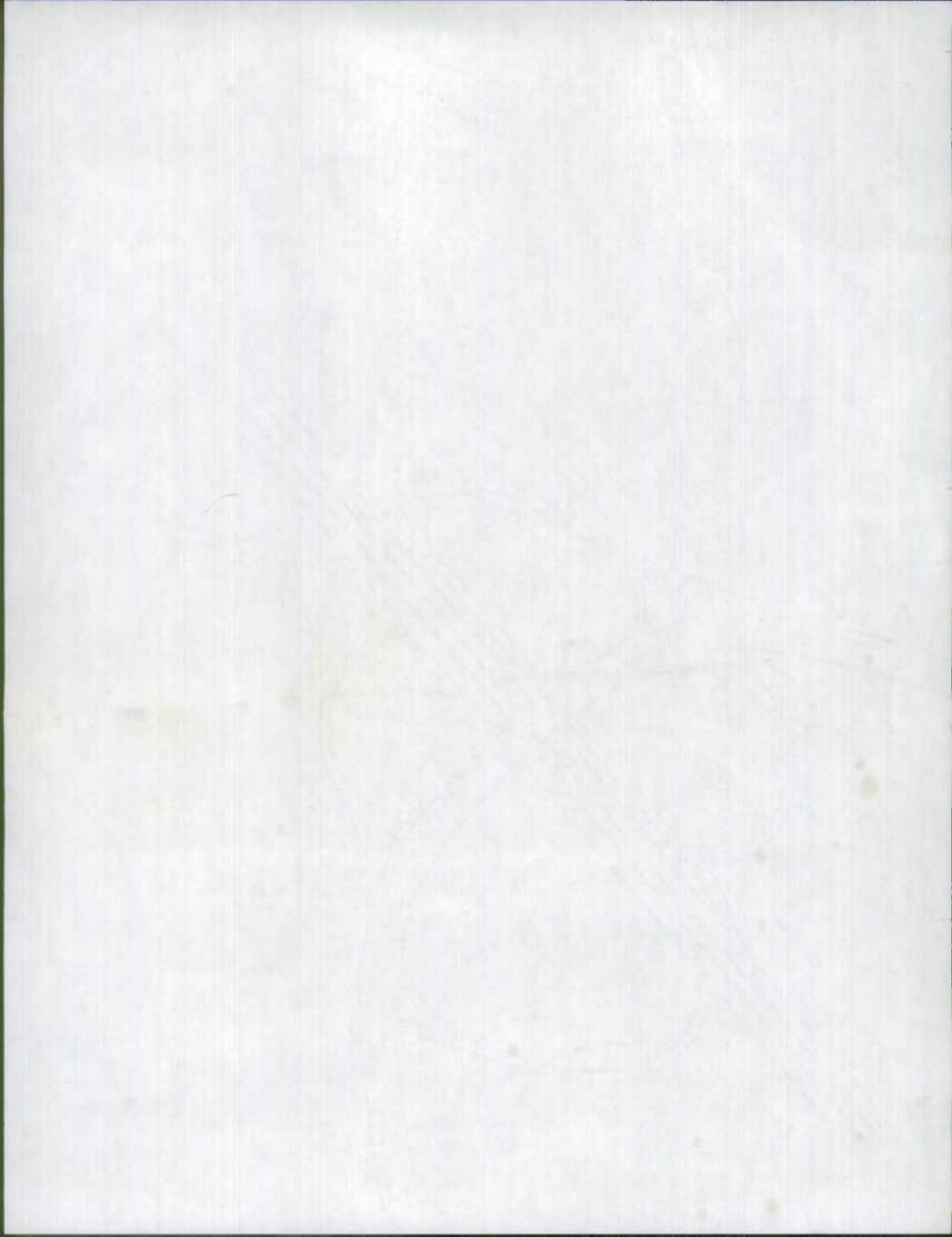

Party
Recorder
Assistant
Map No.
State

51.3 - 8 Revised
4.83

Party Chief
Recorder
Assistant
Map No./Dir.
State Coordinate

SYSTEM				TRAFFIC	
FED. AID	FUNCT. CLASS.	HWY. SYST.	HPMS SAMPLE	PRG. REST.	COM/ING ACCESS

SYSTEM				TRAFFIC	
FED. AID	FUNCT. CLASS.	HWY. SYST.	HPMS SAMPLE	PRG. REST.	COM/ING ACCESS

SYSTEM				TRAFFIC	
FED. AID	FUNCT. CLASS.	HWY. SYST.	HPMS SAMPLE	PRG. REST.	COM/ING ACCESS

SYSTEM				TRAFFIC	
FED. AID	FUNCT. CLASS.	HWY. SYST.	HPMS SAMPLE	PRG. REST.	COM/ING ACCESS

SYSTEM				TRAFFIC	
FED. AID	FUNCT. CLASS.	HWY. SYST.	HPMS SAMPLE	PRG. REST.	COM/ING ACCESS

SYSTEM				TRAFFIC	
FED. AID	FUNCT. CLASS.	HWY. SYST.	HPMS SAMPLE	PRG. REST.	COM/ING ACCESS

SYSTEM				TRAFFIC	
FED. AID	FUNCT. CLASS.	HWY. SYST.	HPMS SAMPLE	PRG. REST.	COM/ING ACCESS

SYSTEM				TRAFFIC	
FED. AID	FUNCT. CLASS.	HWY. SYST.	HPMS SAMPLE	PRG. REST.	COM/ING ACCESS

SYSTEM				TRAFFIC	
FED. AID	FUNCT. CLASS.	HWY. SYST.	HPMS SAMPLE	PRG. REST.	COM/ING ACCESS

SYSTEM				TRAFFIC	
FED. AID	FUNCT. CLASS.	HWY. SYST.	HPMS SAMPLE	PRG. REST.	COM/ING ACCESS

SYSTEM				TRAFFIC	
FED. AID	FUNCT. CLASS.	HWY. SYST.	HPMS SAMPLE	PRG. REST.	COM/ING ACCESS

LINE DIAGRAM

Lines 25600

LINE DIAGRAM

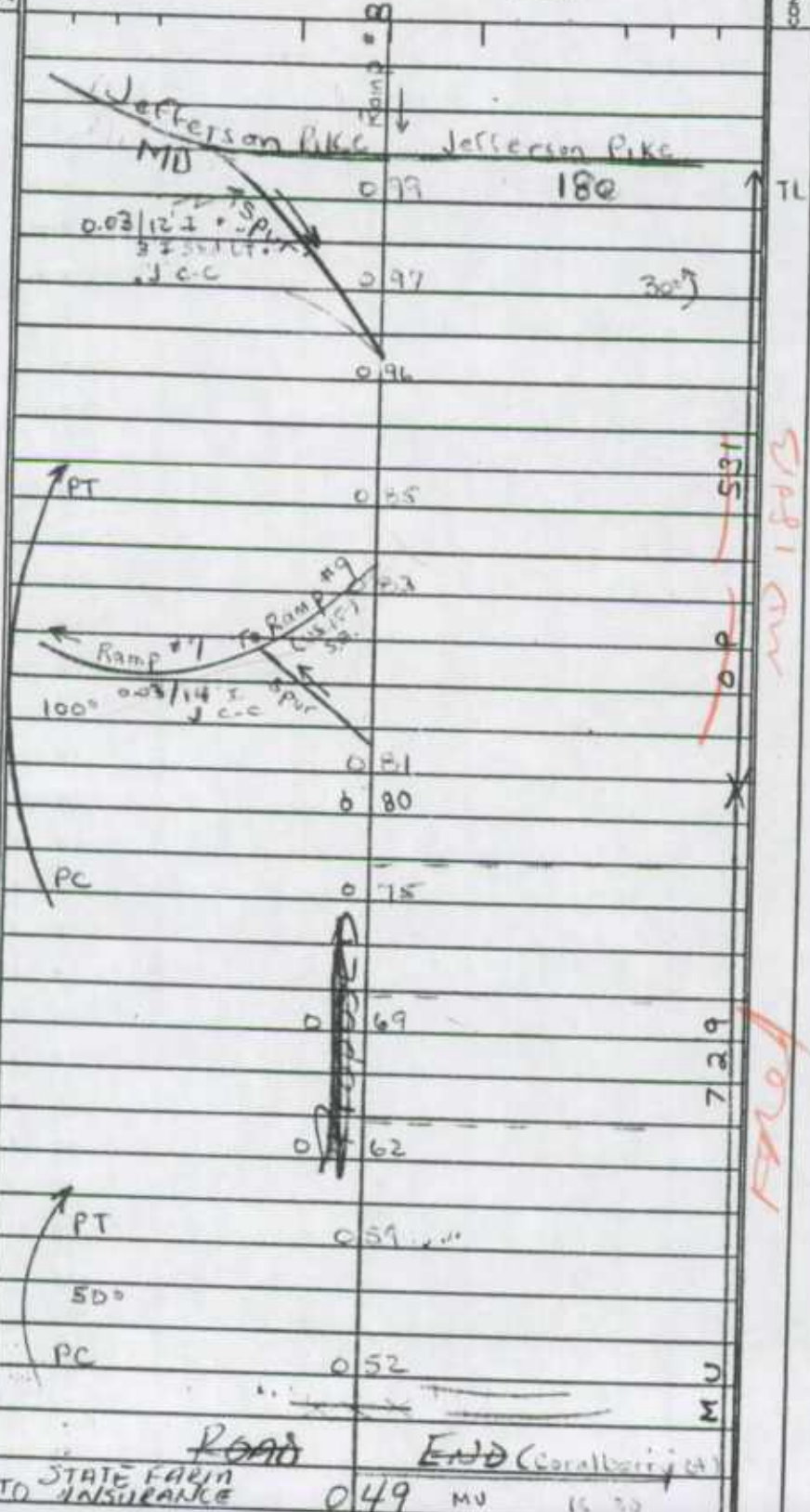

5081 m

44
50
4/20

E

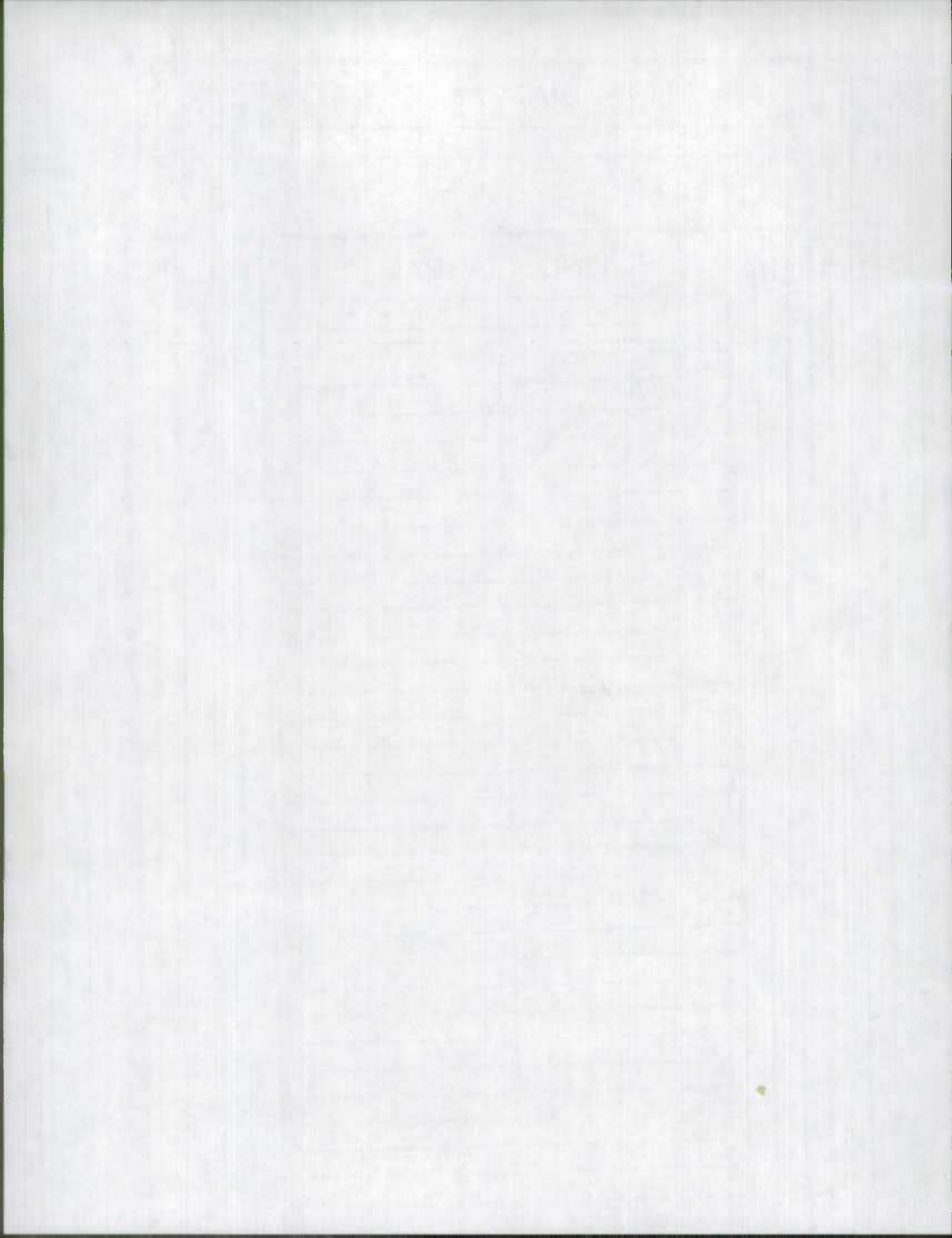

DEPARTMENT OF TRANSPORTATION

STATE HIGHWAY ADMINISTRATION

PERMIT NUMBER
B-F-3883-90

OF MARYLAND

DATE OF ISSUE
June 8, 1990ROUTE
180

Baltimore, Md.

EXPIRATION DATE
June 8, 1991

PERMISSION IS HEREBY GIVEN:

QUAD RESIDENTIAL DEVELOPMENT INC, 6525 BELCREST ROAD SUITE 300, HYATTSVILLE, MD, 20782, 301-779-4800, so far as the State Highway Administration has the right and power to grant same, to reconstruct Himes Avenue extended located on the north side of (Route 180) 320 feet east of Butterfly Lane and widen Ramp 'D' from U.S. Route 15/340 to Maryland Route 180 in conjunction with the Overlook Subdivision.

Unless otherwise specified below, construction shall be in accordance with Maryland State Highway construction standards, specifications and the attached plan specifically sheets 4 and 5, as revised in red, copies of which are on file in this office.

It is agreed and understood that the issuance of this permit shall be construed to indicate complete acceptance of the specifications and terms outlined therein, unless the permittee notifies the State Highway Administration to the contrary within ten (10) days from the issued date.

IMPORTANT:

Notify Mr. Nelson Smith, Permit Inspector, State Highway Administration, Frederick, Maryland (Phone: 301-694-2025) 48 hours in advance of commencing work.

AND

Make notifications in accordance with sections 1:Utilities and 5:Traffic prior to commencing work.

NOTE: If prior notice has not been given, it will be necessary to immediately suspend work for a minimum period of 24 hours to allow time for notification to the proper agencies.

It is necessary that a copy of the SHA's Permit be on the job site at all times, in order that the Permittee's personnel and/or the Permittee's Contractor is in a position to comply with the requirements of the permit. The Permit Inspector shall have the option of closing down projects where the Permittee's representative does not have a copy of the permit on the job site and/or is not familiar with the contents of the permit.

The District Engineer has requested that an SHA inspector may be assigned to this construction. It is agreed and understood by the acceptance of this permit, that the Permittee shall reimburse the SHA for the full cost of this inspection. Arrangements shall be made with the District Engineer to pay for this service prior to the beginning of any construction outlined in this permit.

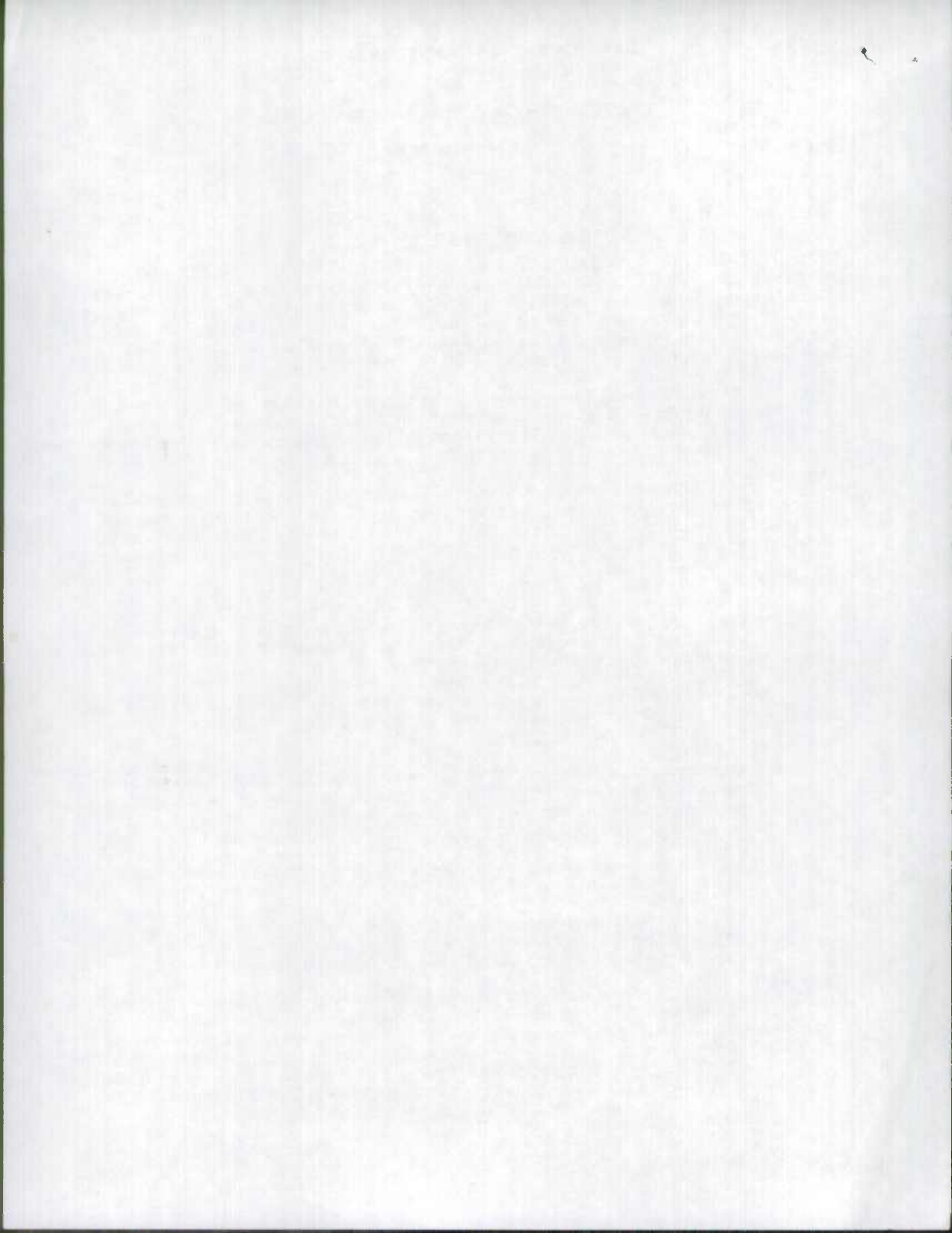

SUITE 300
HYATTSVILLE, MARYLAND 20782
301-778-4800

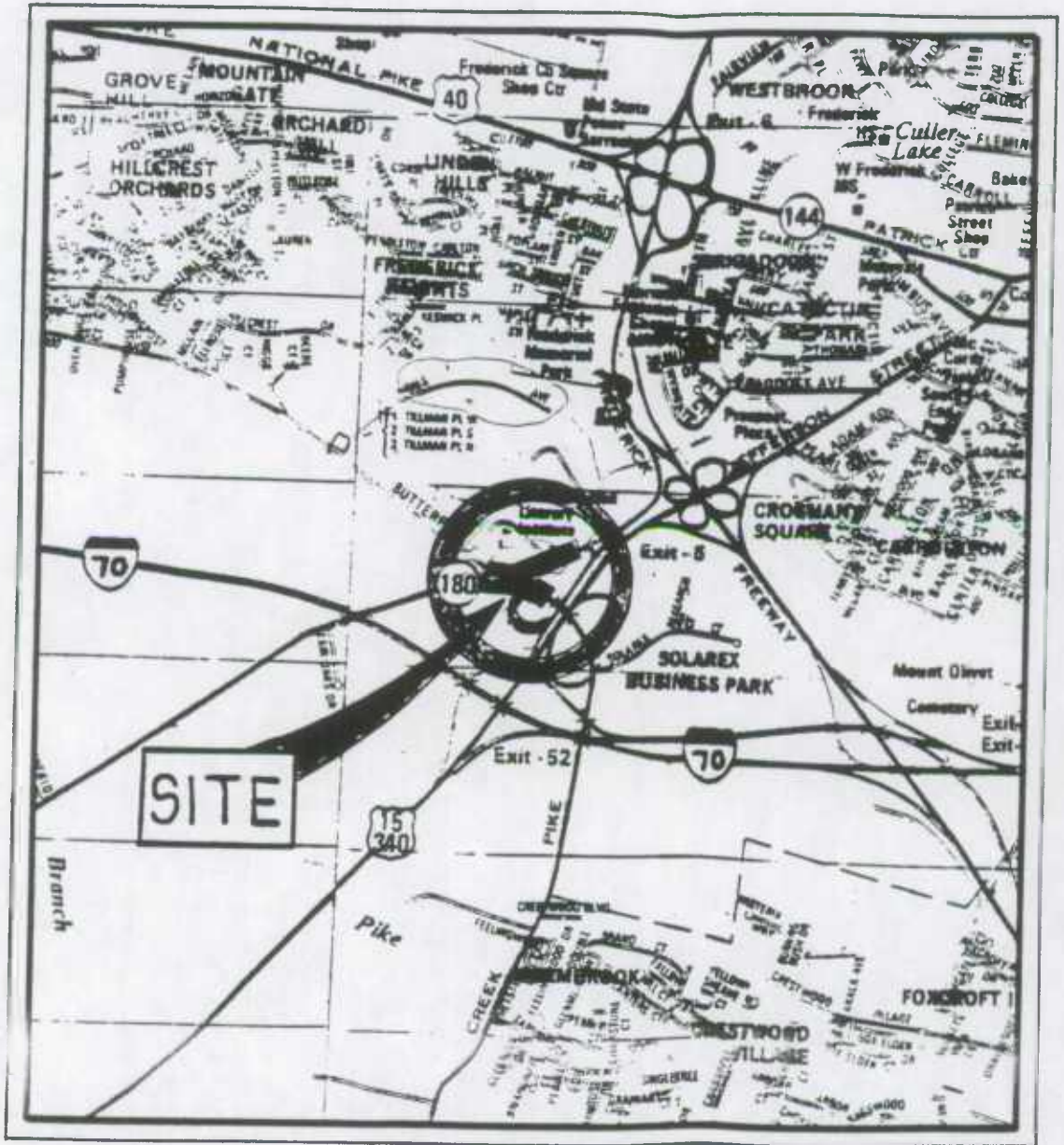

VICINITY MAP

SCALE: 1"=2000'

Q

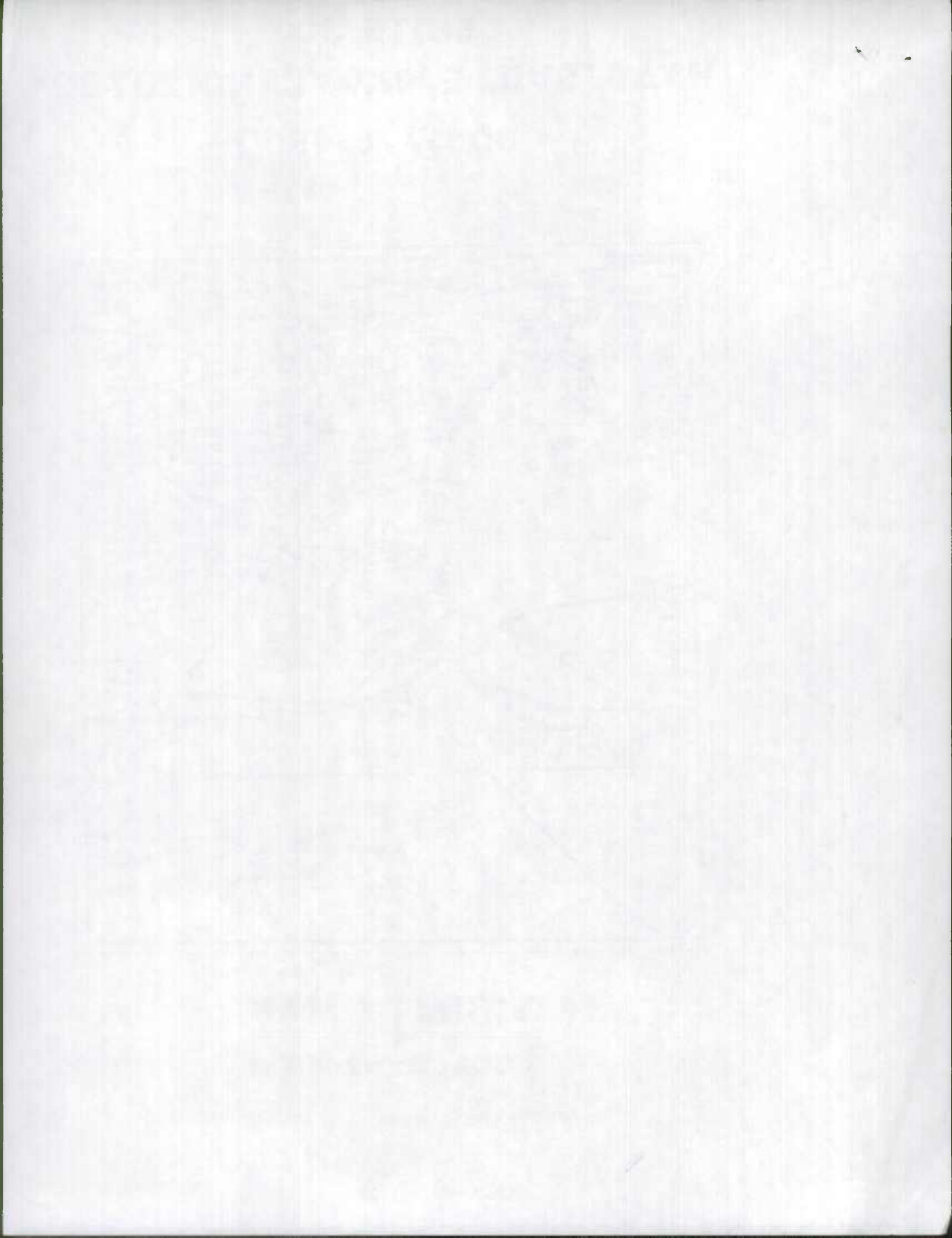

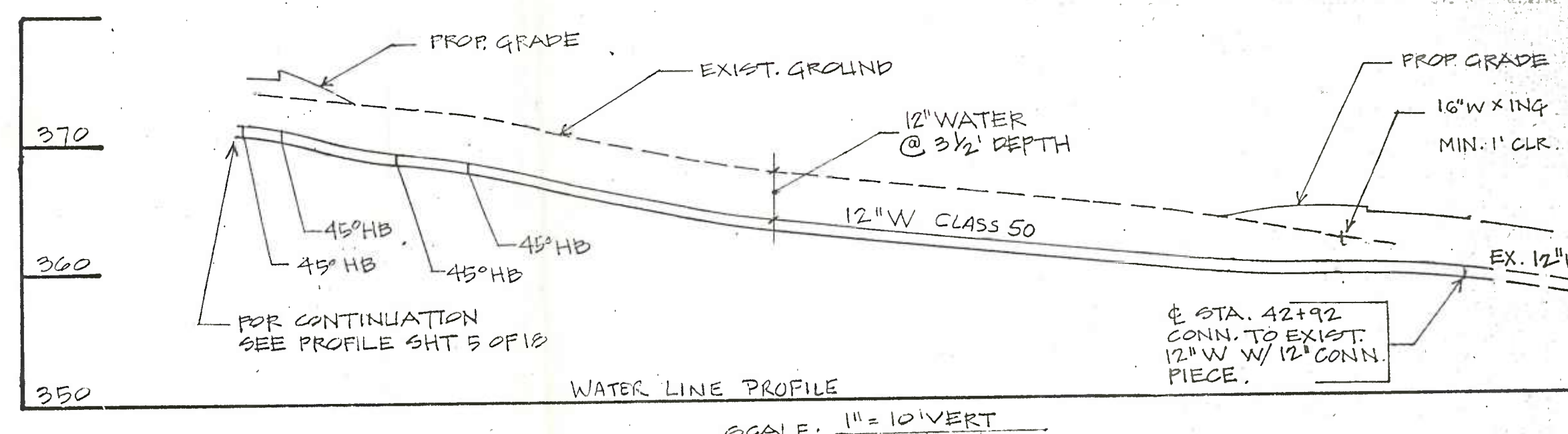
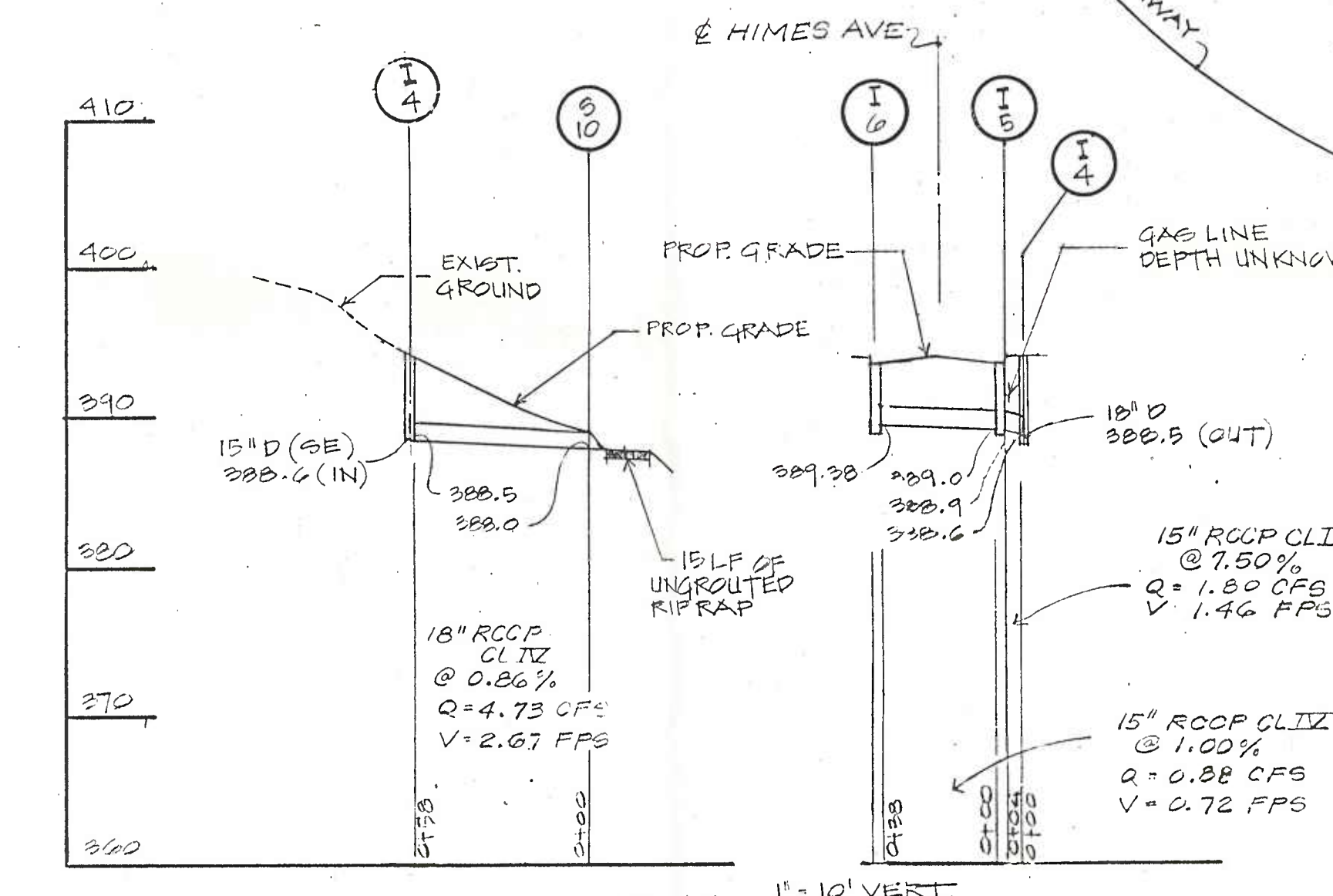
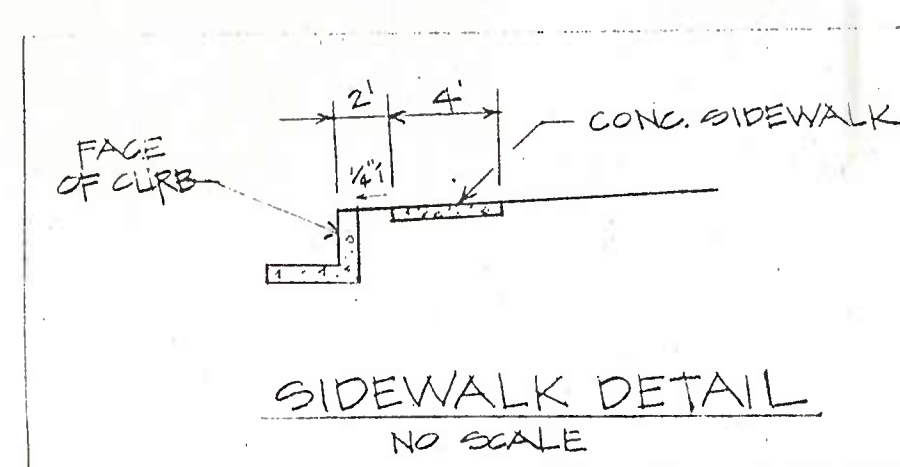
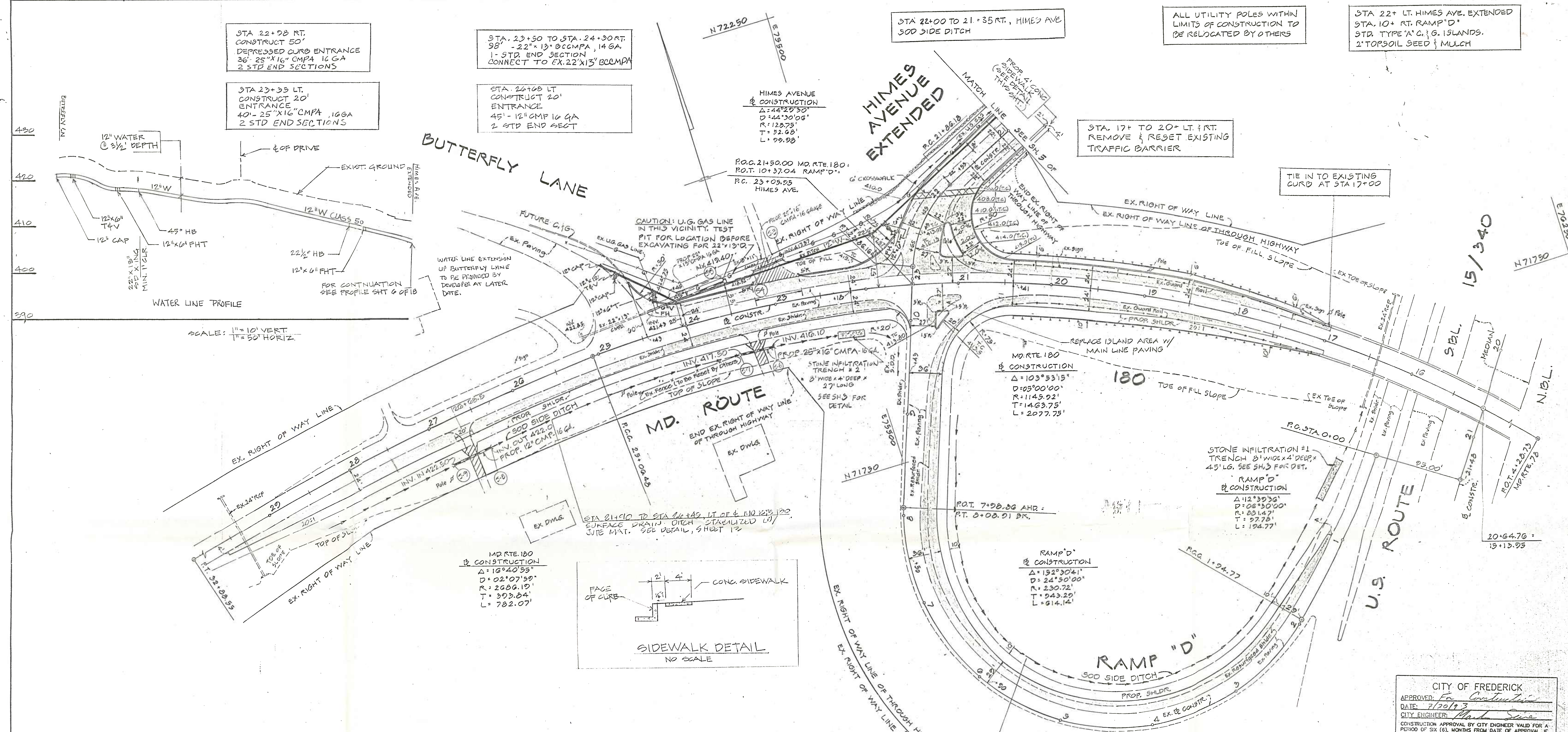

Harris, Smariga, Matz, Inc.
Planners/Engineers/Surveyors
115-B Sudbrook Lane/Pikesville, MD 21208
(301) 488-1511

PLAN

THE OVERLOOK
ROADWAY IMPROVEMENTS

RAMP "D" WIDENING
MD. RTE. 180 WIDENING
HIMES AVENUE EXTENDED

DATE: 6/22/89
SHEET: 2 OF 18
PROJECT NO.

CITY OF FREDERICK
APPROVED: [Signature]
DATE: 7/20/93
CITY ENGINEER: [Signature]

CONSTRUCTION APPROVAL BY CITY ENGINEER VALID FOR A PERIOD OF SIX (6) MONTHS FROM DATE OF APPROVAL. IF A PERMITS ATTEMPT TO COMMENCE CONSTRUCTION HAS NOT OCCURRED IN THIS 6-MONTH PERIOD, CITY APPROVAL SHALL BE NULL AND VOID.

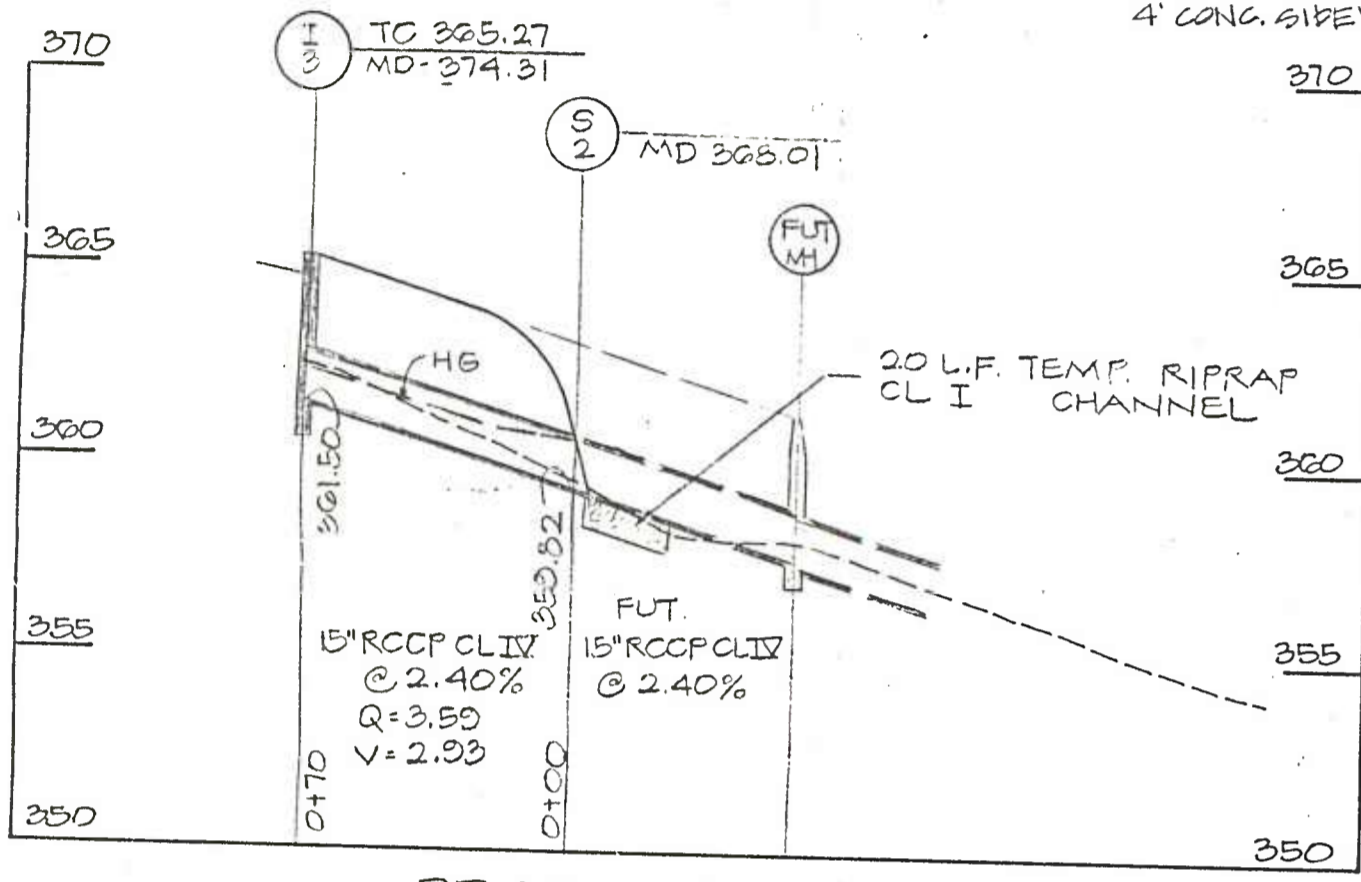
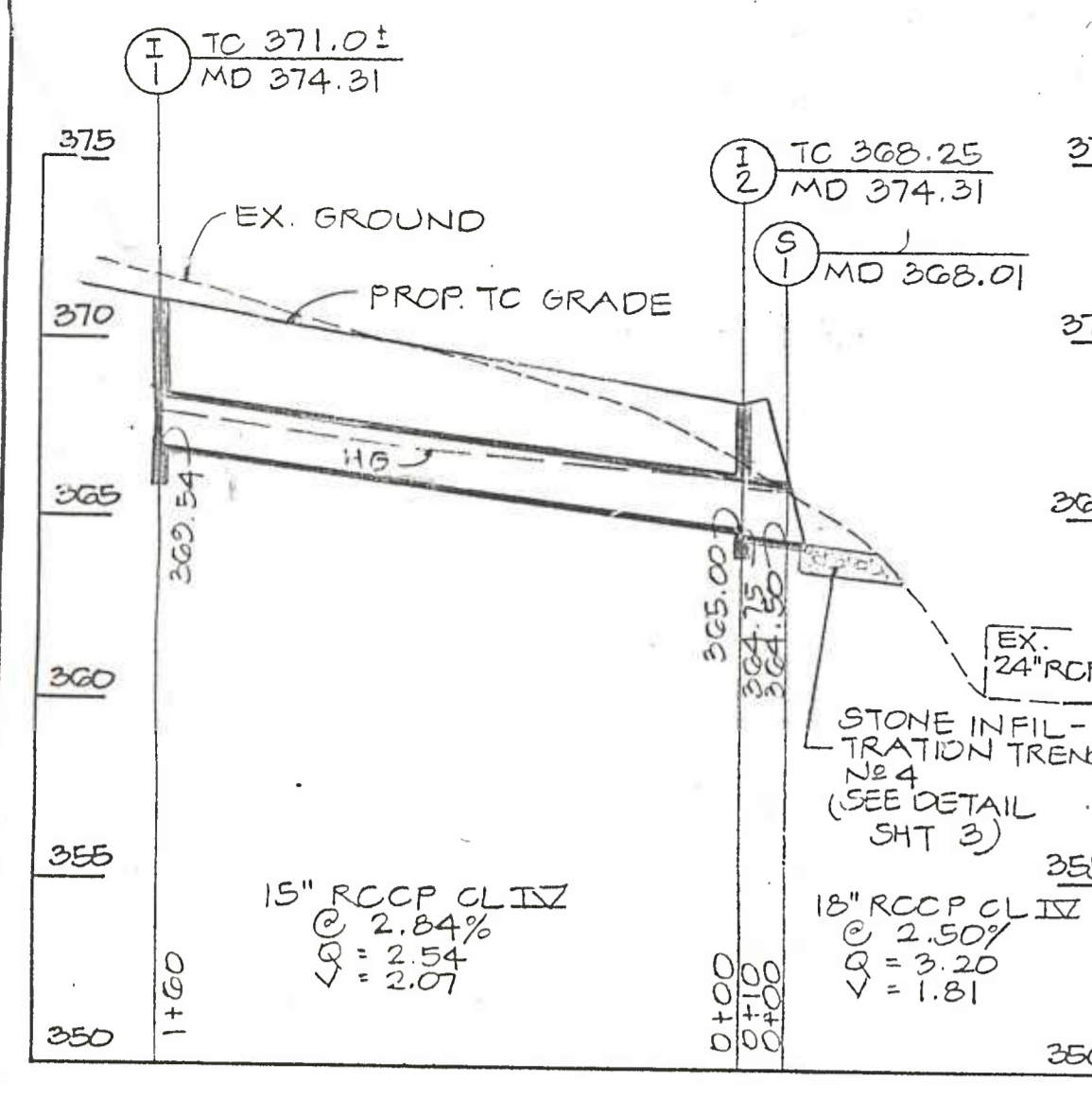

PROFILES
SCALE: HOR. 1"=50'
VERT. 1"=5'

STA. 16+62 LT.
STA. 17+83 LT.
20' DEPRESS CURB ENTRANCES

STA. 19+30 TO STA. 20+05
DEPRESS CURB ENTRANCE TO CHURCH.

STA. 42+80 TO STA. 43+55, RT
TO L.F. - 15" R.C.C.P. CL. I.V.
1-STD CONC. END SECTIONS
1-COG-20 INLET

STA. 44+72 LT.
10 L.F. - 15" R.C.C.P. CL. I.V.
1-STD CONC. END SECTIONS
1-COG-15 INLET

STA. 18+25 TO 19+75 RT,
30D SIDE DITCH

THE CONTRACTOR SHALL LOCATE
AND RELOCATE LATERALLY SIGN
REFERENCING GEORGE WASHINGTON.

ALL UTILITY POLES WITHIN LIMITS
OF CONSTRUCTION TO BE RELOCATED
BY OTHERS

TOPS OF WATER VALVES STA. 43+, HIMES
AVENUE EXTENDED, TO BE ADJUSTED
TO NEW FINISHED GRADE

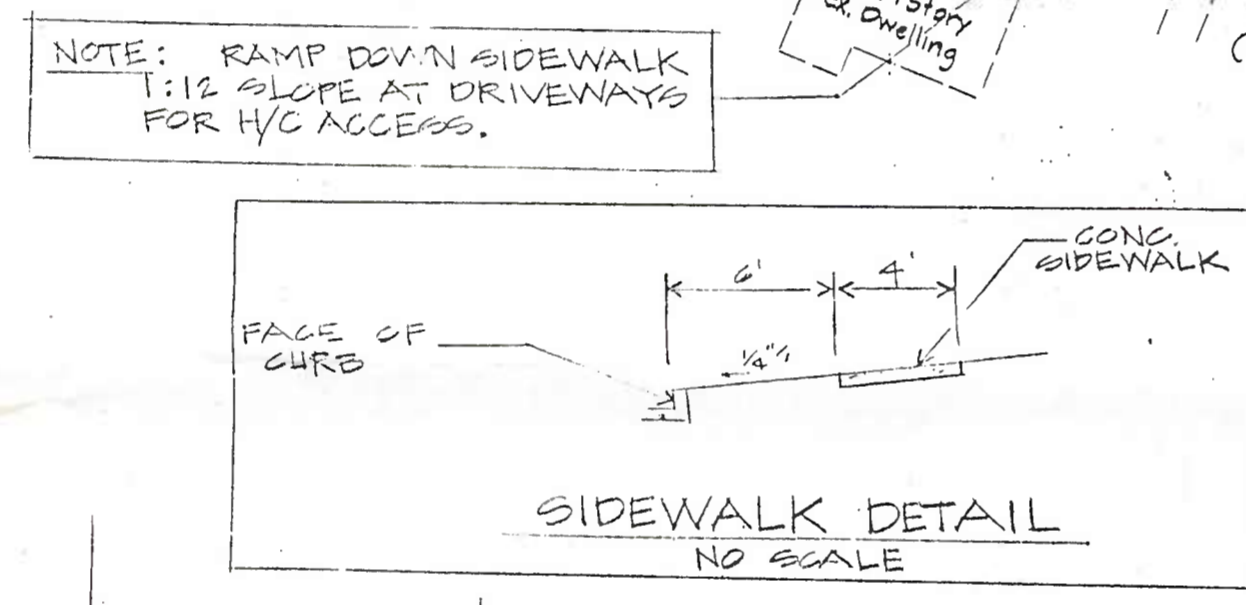
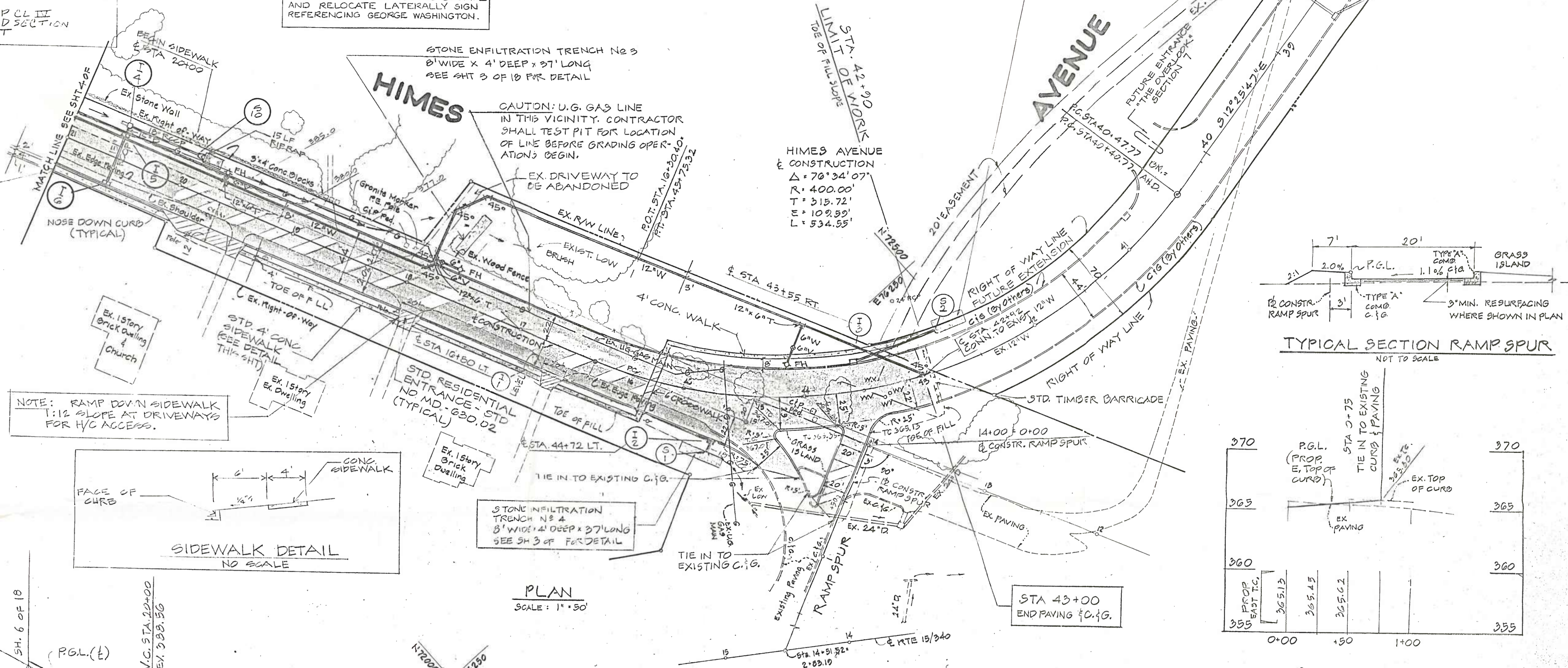

PLAN
SCALE: 1"=50'

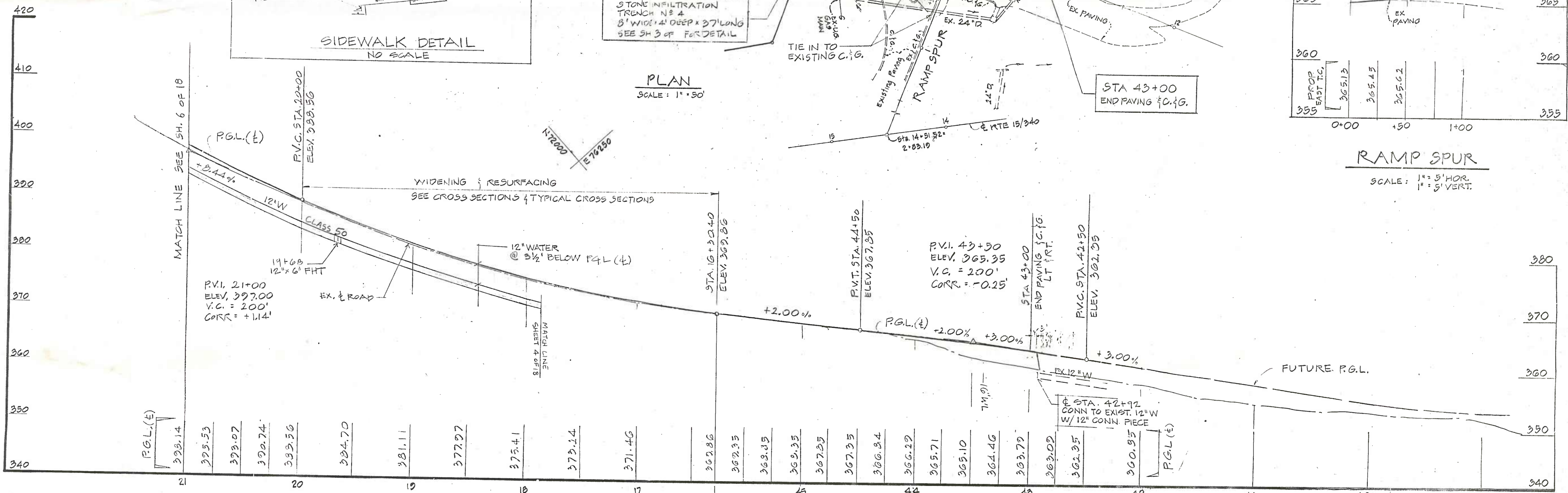

PROFILE
SCALE: 1"=50' HOR.
1"=10' VERT.

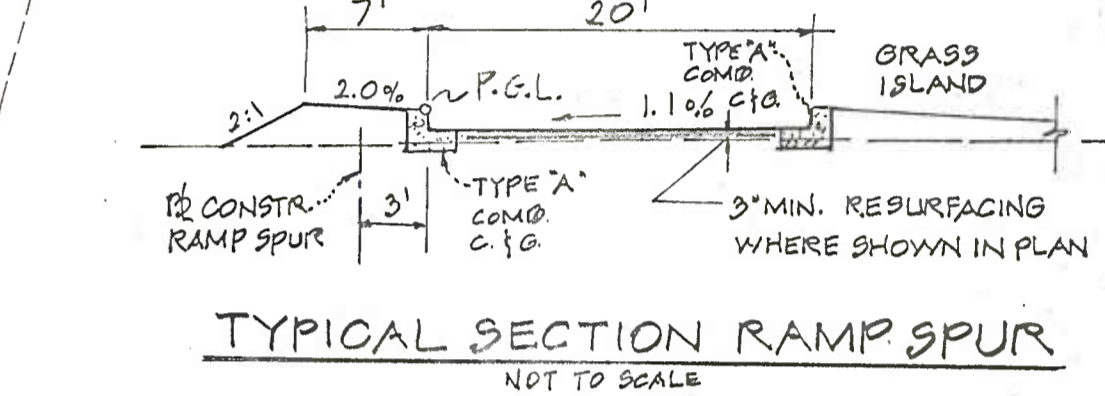

TYPICAL SECTION RAMP SPUR
NOT TO SCALE

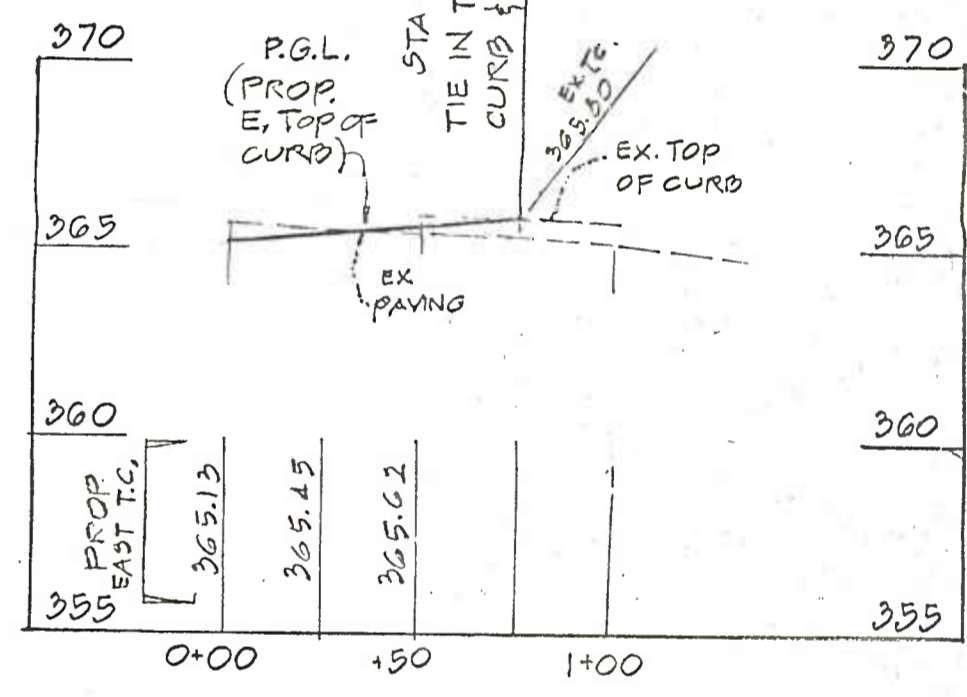

RAMP SPUR
SCALE: 1"=5' HOR.
1"=5' VERT.

CITY OF FREDERICK
APPROVED: *[Signature]*
DATE: 7/20/93
CITY ENGINEER: *[Signature]*

CONSTRUCTION APPROVAL BY CITY ENGINEER VALID FOR A PERIOD OF SIX (6) MONTHS FROM DATE OF APPROVAL. IF A BONA FIDE ATTEMPT TO COMMENCE CONSTRUCTION HAS NOT BEGUN IN THIS SIX-MONTH PERIOD, CITY APPROVAL SHALL BE NULL AND VOID.

Harris, Smariga, Matz, Inc.
Planners/Engineers/Surveyors
115-B Sudbrook Lane/Pikesville, MD 21208
(301) 486-1511

REVISIONS:
5-23-91 ALL L.F. 15" R.C.C.P. TO 1/2"
4/18/93 ADD 15" R.C.C.P. & SIDEWALK
5-15-93 ASHED FH'S, SIDEWALK
5-15-93 ADJ. W. CURB

PLAN & PROFILE
THE OVERLOOK
ROADWAY IMPROVEMENTS

HIMES AVENUE
EXTENDED

ELECTION
DISTRICT 2
FREDERICK

SCALE: A.S. 9"=3" MN
DRAWN BY: Y.J.H.
CHECKED BY: T.W.L.
DATE: 6/22/93
SHEET: 5 OF 18
PROJECT NO: 3932