

ROUTE NUMBER INDEX MAP ANNAPOLIS

HISD / DATA SUPPORT TEAM
CORRECTION MAP

ANNE ARUNDEL COUNTY
STATE CAPITAL OF MARYLAND

PREPARED BY THE
MARYLAND DEPARTMENT OF TRANSPORTATION
STATE HIGHWAY ADMINISTRATION
IN COOPERATION WITH THE
U. S. DEPARTMENT OF TRANSPORTATION
FEDERAL HIGHWAY ADMINISTRATION

PUBLISHED: 2003

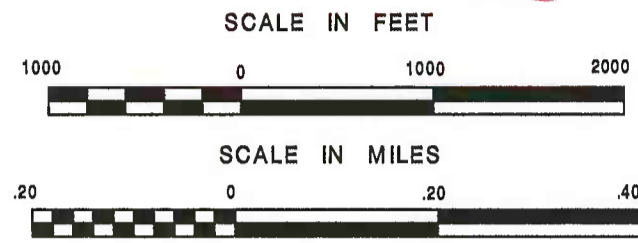

STATEWIDE GRID MAP KEY

D-12	D-13
E-12	E-13
F-12	F-13
G-12	G-13
H-12	H-13

TOWN LOCATED ON GRID MAP F-13
AND ON INDEX MAPS F-15A AND F-15C
MUNICIPAL INDEX MAP REVISED TO JANUARY 1, 2003

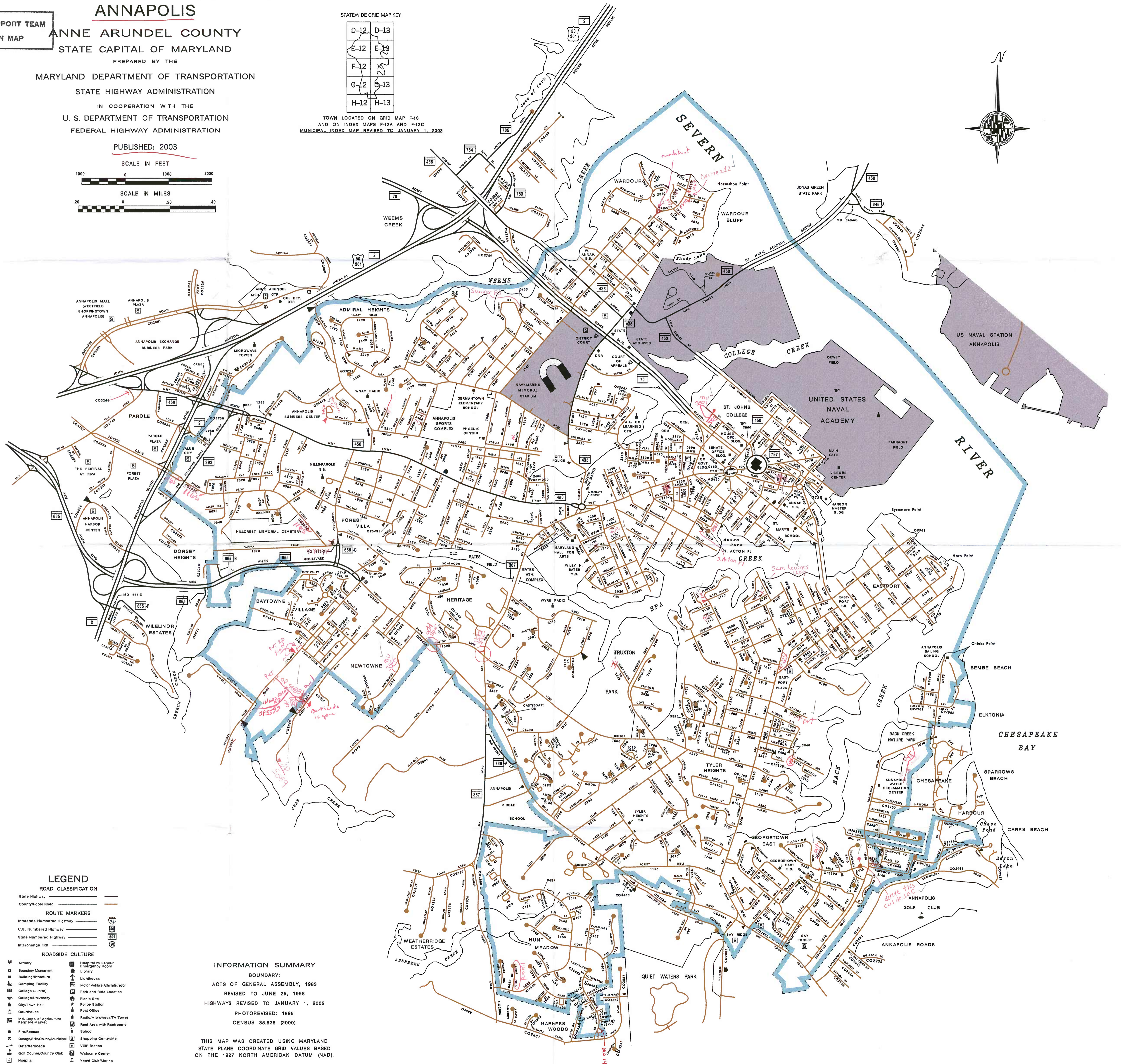
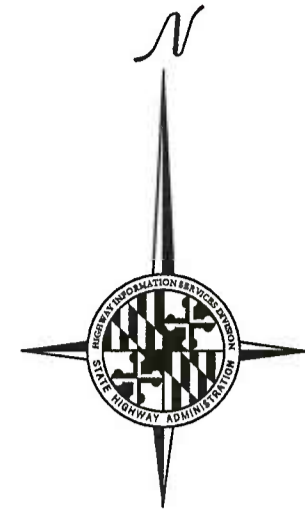

LEGEND

- ROAD CLASSIFICATION**
- State Highway
 - County/Local Road
- ROUTE MARKERS**
- Interstate Numbered Highway
 - U.S. Numbered Highway
 - State Numbered Highway
 - Interchange Exit
- ROADSIDE CULTURE**

- Army
- Boundary Monument
- Building/Structure
- Camping Facility
- College (Junior)
- College/University
- City/Town Hall
- Courthouse
- MD Dept. of Agriculture Farmers Market
- Fire/Rescue
- Gas/Shell/Dump/Airport
- Gas/Barbecue
- Golf Course/Country Club
- Hospital
- Integral w/ Airport Emergency Room
- Library
- Lighthouse
- Motor Vehicle Administration
- Park and Ride Location
- Piano Site
- Police Station
- Post Office
- Radio/Microwave/TV Tower
- Rent Area with Restrooms
- School
- Shopping Center/Mall
- VEIP Station
- Welcome Center
- Yacht Club/Marina

INFORMATION SUMMARY

BOUNDARY:
ACTS OF GENERAL ASSEMBLY, 1993
REVISED TO JUNE 25, 1998
HIGHWAYS REVISED TO JANUARY 1, 2002
PHOTO REVISED: 1995
CENSUS 35,838 (2000)

THIS MAP WAS CREATED USING MARYLAND
STATE PLANE COORDINATE GRID VALUES BASED
ON THE 1927 NORTH AMERICAN DATUM (NAD).

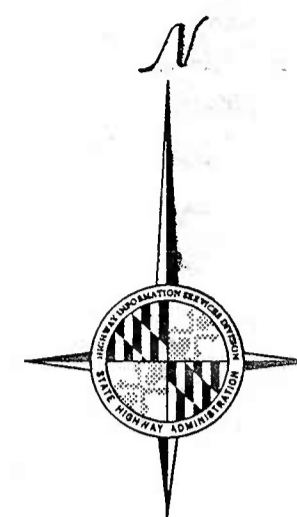
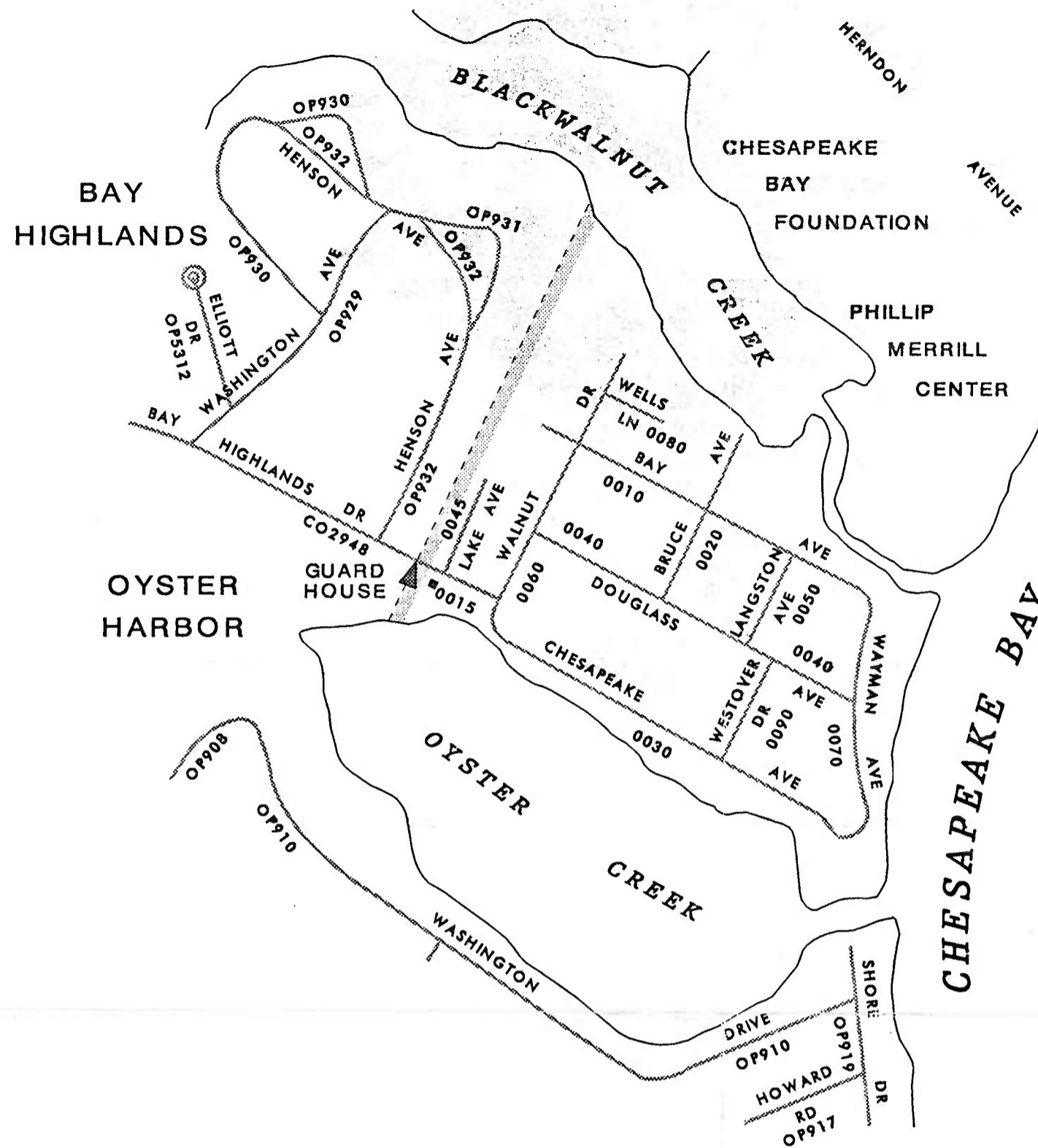

**HISD / DATA SUPPORT TEAM
CORRECTION MAP**

ROUTE NUMBER INDEX MAP HIGHLAND BEACH ANNE ARUNDEL COUNTY MARYLAND

PREPARED BY THE
MARYLAND DEPARTMENT OF TRANSPORTATION
 STATE HIGHWAY ADMINISTRATION
 IN COOPERATION WITH THE
 U. S. DEPARTMENT OF TRANSPORTATION
 FEDERAL HIGHWAY ADMINISTRATION

PUBLISHED: 2003

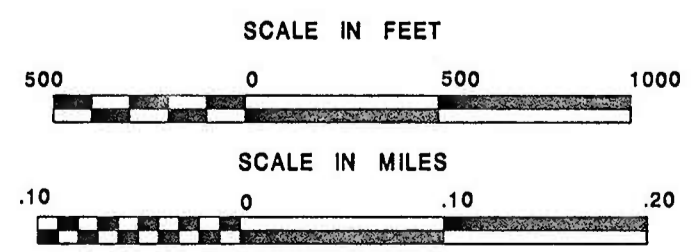

- LEGEND**
- ROAD CLASSIFICATION**
- State Highway
 - County/Local Road
- ROUTE MARKERS**
- Interstate Numbered Highway
 - U.S. Numbered Highway
 - State Numbered Highway
 - Interchange Exit

- ROADSIDE CULTURE**
- Army
 - Boundary Monument
 - Building/Structure
 - Camping Facility
 - College (Junior)
 - College/University
 - City/Town Hall
 - Courthouse
 - Md. Dept. of Agriculture Farmers Market
 - Fire/Rescue
 - Garage/SHA/County/Municipal
 - Gate/Barricade
 - Golf Course/Country Club
 - Hospital
 - Hospital w/ 24hour Emergency Room
 - Library
 - Lighthouse
 - Motor Vehicle Administration
 - Park and Ride Location
 - Picnic Site
 - Police Station
 - Post Office
 - Radio/Microwave/TV Tower
 - Rest Area with Restrooms
 - School
 - Shopping Center/Mall
 - VEIP Station
 - Welcome Center
 - Yacht Club/Marina

STATEWIDE GRID MAP KEY

D-12	D-13
E-12	E-13
F-12	F-13
G-12	G-13
H-12	H-13

TOWN LOCATED ON GRID MAP F-13
 AND ON INDEX MAPS F-13C AND F-13D
 MUNICIPAL INDEX MAP REVISED TO JANUARY 1, 2003

INFORMATION SUMMARY

BOUNDARY:
 ACTS OF GENERAL ASSEMBLY, 1983
 REVISED TO APRIL 10, 1988
 HIGHWAYS REVISED TO JANUARY 1, 2002
 PHOTOREVISED: 1994
 CENSUS 109 (2000)

THIS MAP WAS CREATED USING MARYLAND
 STATE PLANE COORDINATE GRID VALUES BASED
 ON THE 1927 NORTH AMERICAN DATUM (NAD).

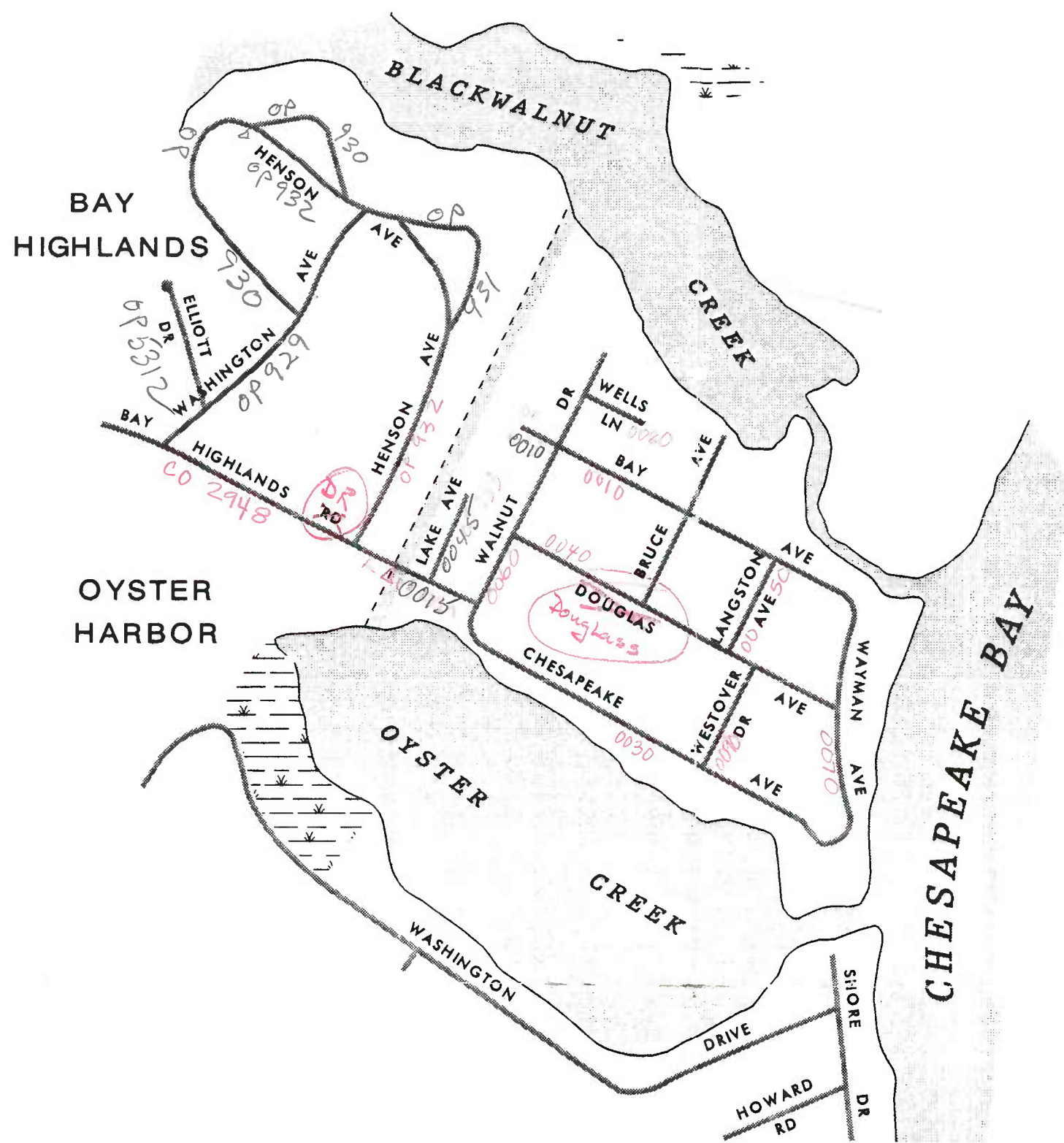

STATEWIDE GRID MAP KEY

D-12	D-13
E-12	E-13
F-12	F-13
G-12	G-13
H-12	H-13

TOWN LOCATED ON GRID MAP F-13

LEGEND

STATE HIGHWAY	
COUNTY ROADS	
MUNICIPAL ROAD	
OTHER PUBLIC ROAD	
RESERVATION/PVT ROAD	
INTERSTATE NUMBERED HIGHWAY	
U.S. NUMBERED HIGHWAY	
STATE NUMBERED HIGHWAY	
ARMORY	
CITY HALL/MUNICIPAL BLDG.	
COURTHOUSE	
FIRE DEPARTMENT	
HIGHWAY GARAGE	
HOSPITAL	
LIBRARY	
PARK AND RIDE	
POLICE DEPARTMENT	
POST OFFICE	
SCHOOL	

INFORMATION SUMMARY

BOUNDARY:
 ACTS OF GENERAL ASSEMBLY, 1983
 REVISED TO APRIL 10, 1988
 HIGHWAYS REVISED TO JANUARY 1, 1998
 PHOTOREVISED: 1994
 CENSUS 102 (1990)

THIS MAP WAS CREATED USING MARYLAND
 STATE PLANE COORDINATE GRID VALUES BASED
 ON THE 1927 NORTH AMERICAN DATUM (NAD).

HISD / DATA SUPPORT TEAM
 CORRECTION MAP

HIGHLAND BEACH

ANNE ARUNDEL COUNTY

MARYLAND

PREPARED BY THE

MARYLAND DEPARTMENT OF TRANSPORTATION

STATE HIGHWAY ADMINISTRATION

IN COOPERATION WITH THE

U. S. DEPARTMENT OF TRANSPORTATION

FEDERAL HIGHWAY ADMINISTRATION

PUBLISHED: 1999

SCALE IN FEET



SCALE IN MILES



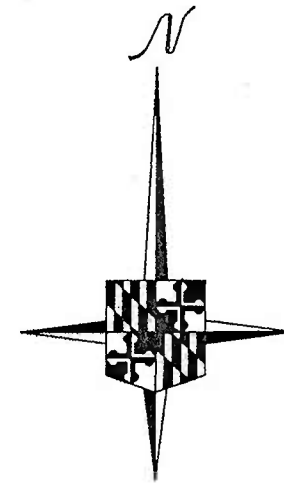
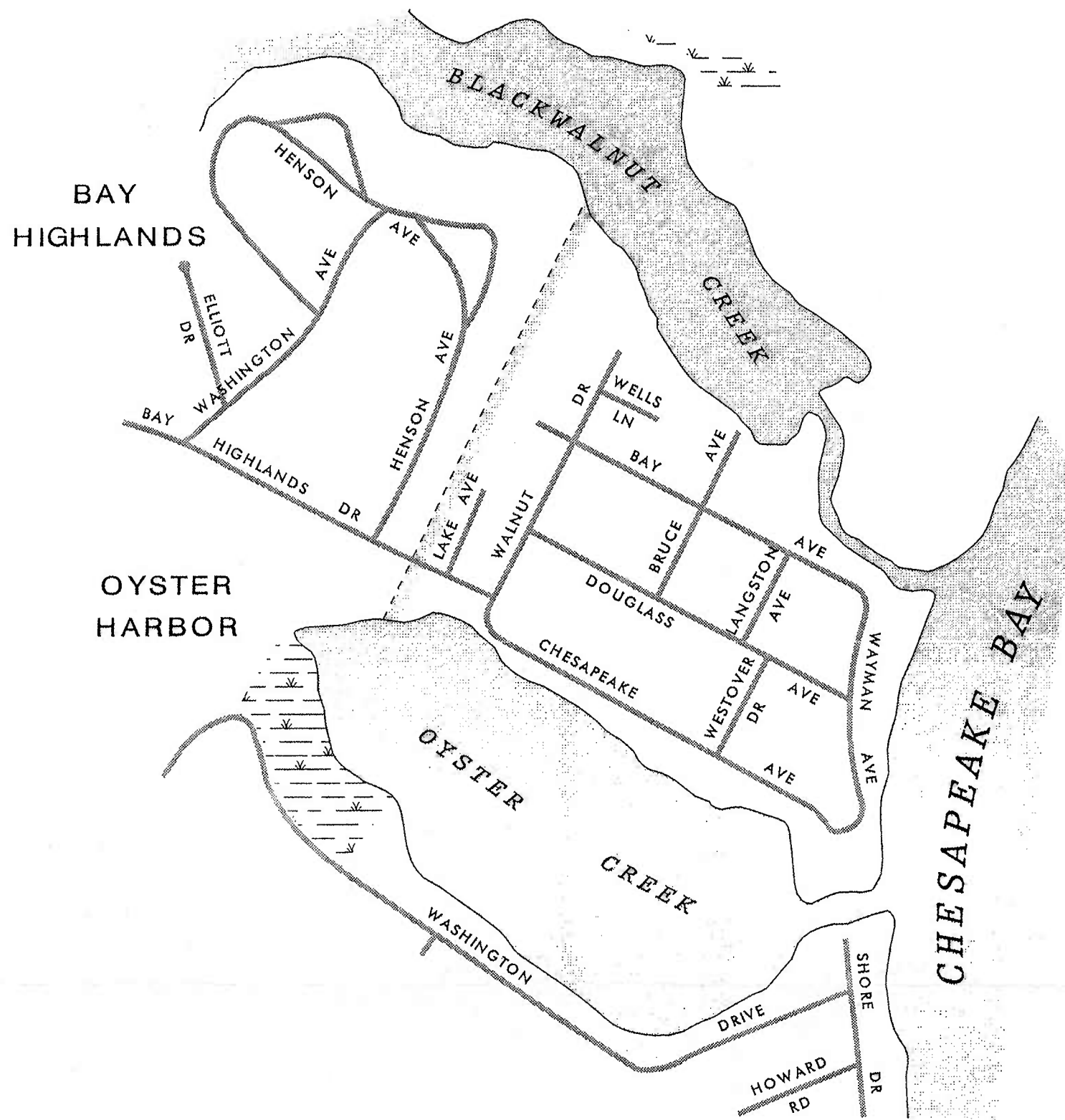

STATEWIDE GRID MAP KEY

D-12	D-13
E-12	E-13
F-12	F-13
G-12	G-13
H-12	H-13

TOWN LOCATED ON GRID MAP F-13

LEGEND

- STATE HIGHWAY
- COUNTY ROADS
- MUNICIPAL ROAD
- OTHER PUBLIC ROAD
- RESERVATION/PVT ROAD
- INTERSTATE NUMBERED HIGHWAY
- U.S. NUMBERED HIGHWAY
- STATE NUMBERED HIGHWAY
- ARMORY
- CITY HALL/MUNICIPAL BLDG.
- COURTHOUSE
- FIRE DEPARTMENT
- HIGHWAY GARAGE
- HOSPITAL
- LIBRARY
- PARK AND RIDE
- POLICE DEPARTMENT
- POST OFFICE
- SCHOOL

INFORMATION SUMMARY

BOUNDARY:
 ACTS OF GENERAL ASSEMBLY, 1983
 REVISED TO APRIL 10, 1988
 HIGHWAYS REVISED TO JANUARY 1, 1999
 PHOTOREVISED: 1994
 CENSUS 102 (1990)

THIS MAP WAS CREATED USING MARYLAND
 STATE PLANE COORDINATE GRID VALUES BASED
 ON THE 1927 NORTH AMERICAN DATUM (NAD).

MISD / DATA SUPPORT TEAM
 CORRECTION MAP

HIGHLAND BEACH

ANNE ARUNDEL COUNTY

MARYLAND

PREPARED BY THE

MARYLAND DEPARTMENT OF TRANSPORTATION

STATE HIGHWAY ADMINISTRATION

IN COOPERATION WITH THE

U. S. DEPARTMENT OF TRANSPORTATION

FEDERAL HIGHWAY ADMINISTRATION

PUBLISHED: 2000

SCALE IN FEET



SCALE IN MILES



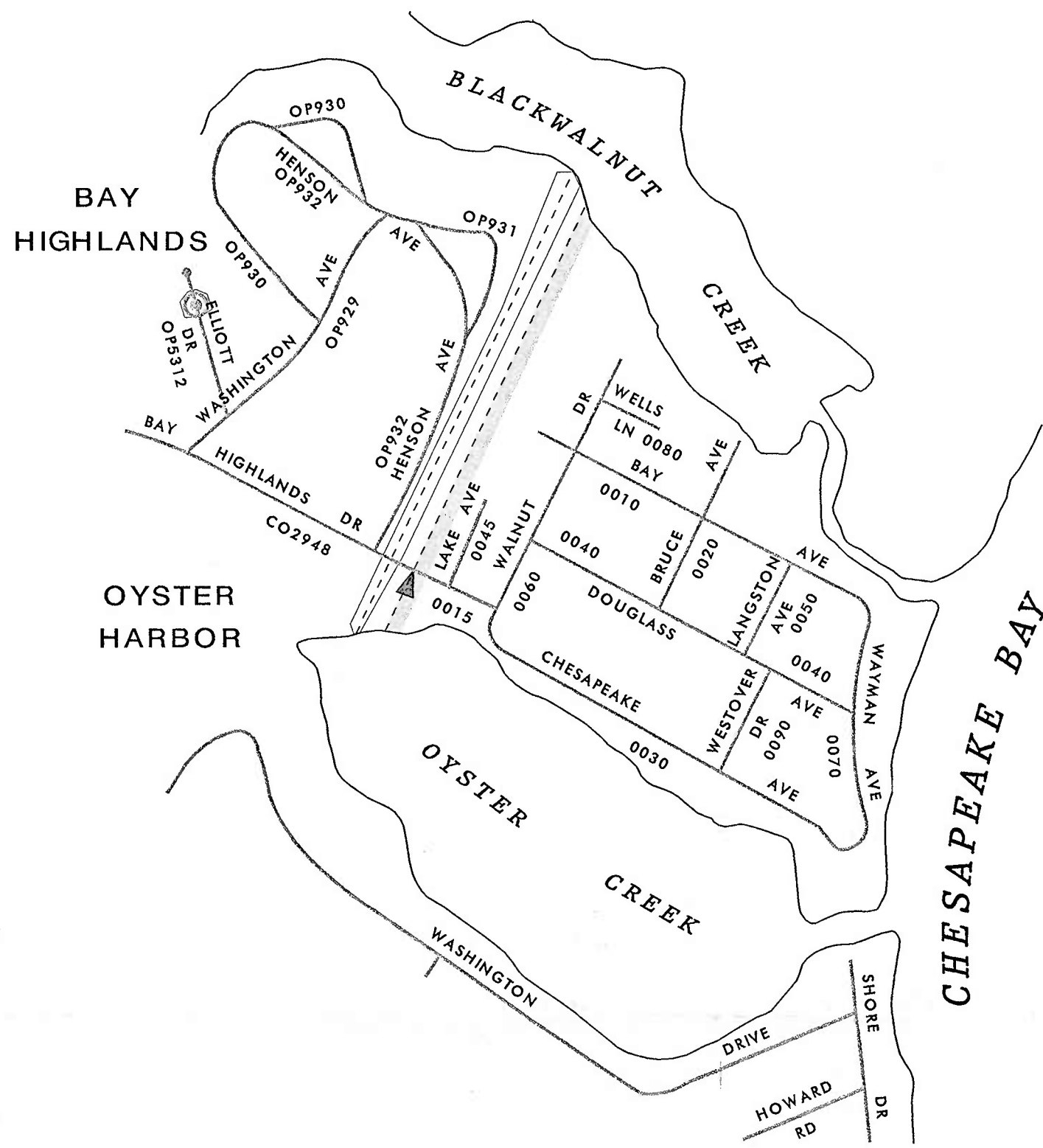

STATEWIDE GRID MAP KEY

D-12	D-13
E-12	E-13
F-12	F-13
G-12	G-13
H-12	H-13

TOWN LOCATED ON GRID MAP F-13
AND ON INDEX MAPS F-13C AND F-13D

LEGEND

STATE HIGHWAY	
COUNTY ROADS	
MUNICIPAL ROAD	
OTHER PUBLIC ROAD	
RESERVATION/PVT ROAD	
INTERSTATE NUMBERED HIGHWAY	
U.S. NUMBERED HIGHWAY	
STATE NUMBERED HIGHWAY	
ARMORY	
CITY HALL/MUNICIPAL BLDG.	
COURTHOUSE	
FIRE DEPARTMENT	
HIGHWAY GARAGE	
HOSPITAL	
LIBRARY	
PARK AND RIDE	
POLICE DEPARTMENT	
POST OFFICE	
SCHOOL	

INFORMATION SUMMARY

BOUNDARY:
ACTS OF GENERAL ASSEMBLY, 1983
REVISED TO APRIL 10, 1988
HIGHWAYS REVISED TO JANUARY 1, 1999
PHOTOREVISED: 1994
CENSUS 102 (1990)

THIS MAP WAS CREATED USING MARYLAND
STATE PLANE COORDINATE GRID VALUES BASED
ON THE 1927 NORTH AMERICAN DATUM (NAD).

ROUTE NUMBER INDEX MAP
HIGHLAND BEACH

ANNE ARUNDEL COUNTY

MARYLAND

PREPARED BY THE

MARYLAND DEPARTMENT OF TRANSPORTATION

STATE HIGHWAY ADMINISTRATION

IN COOPERATION WITH THE

U. S. DEPARTMENT OF TRANSPORTATION

FEDERAL HIGHWAY ADMINISTRATION

PUBLISHED: 2000

SCALE IN FEET



SCALE IN MILES



Highland Beach

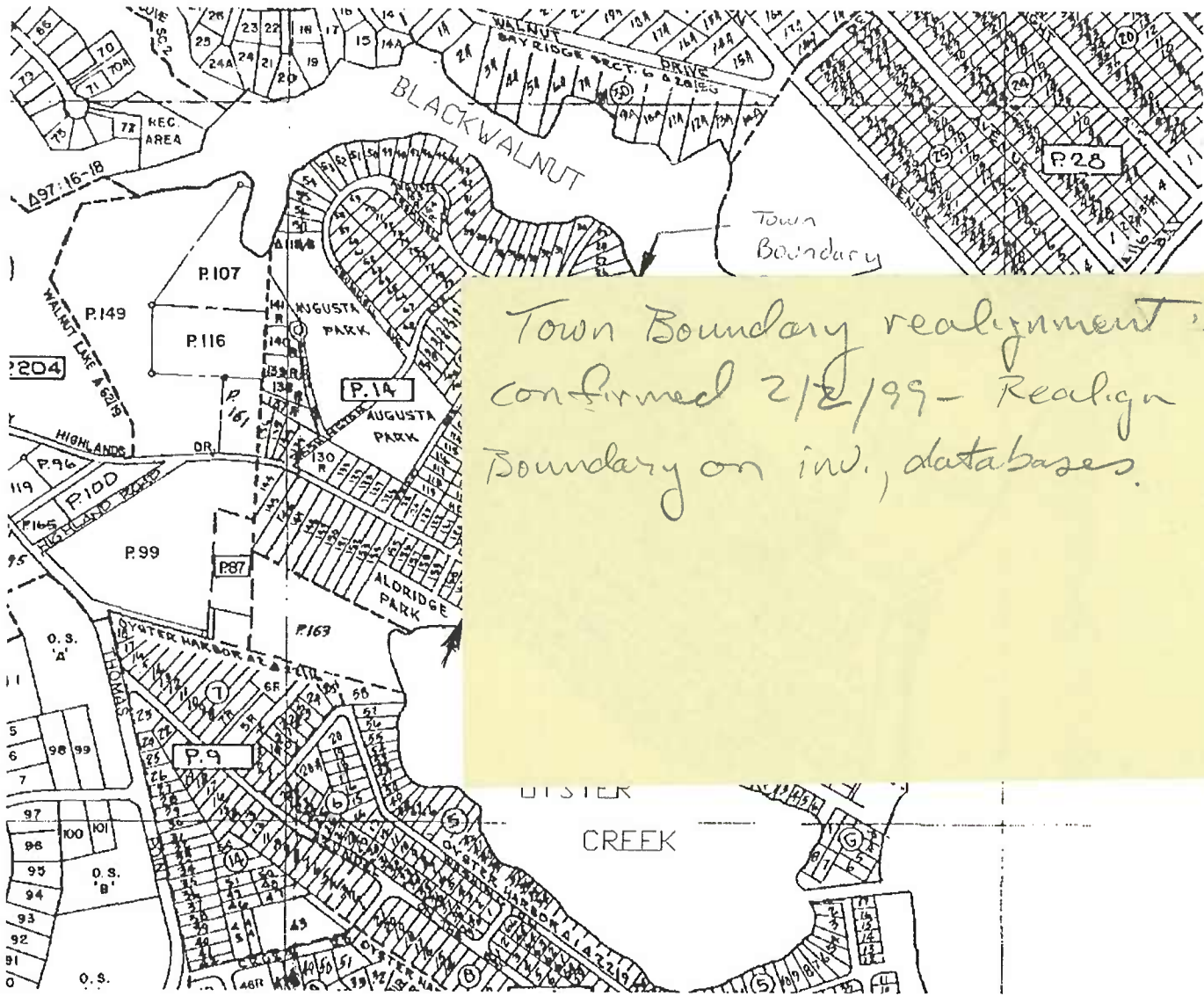

Town Boundary realignment is confirmed 2/2/99 - Realign Boundary on inv. databases.

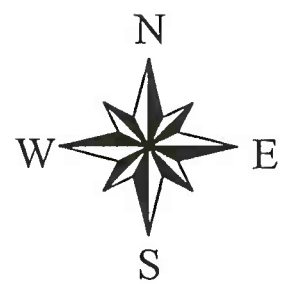

Highland Beach

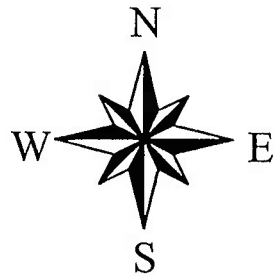
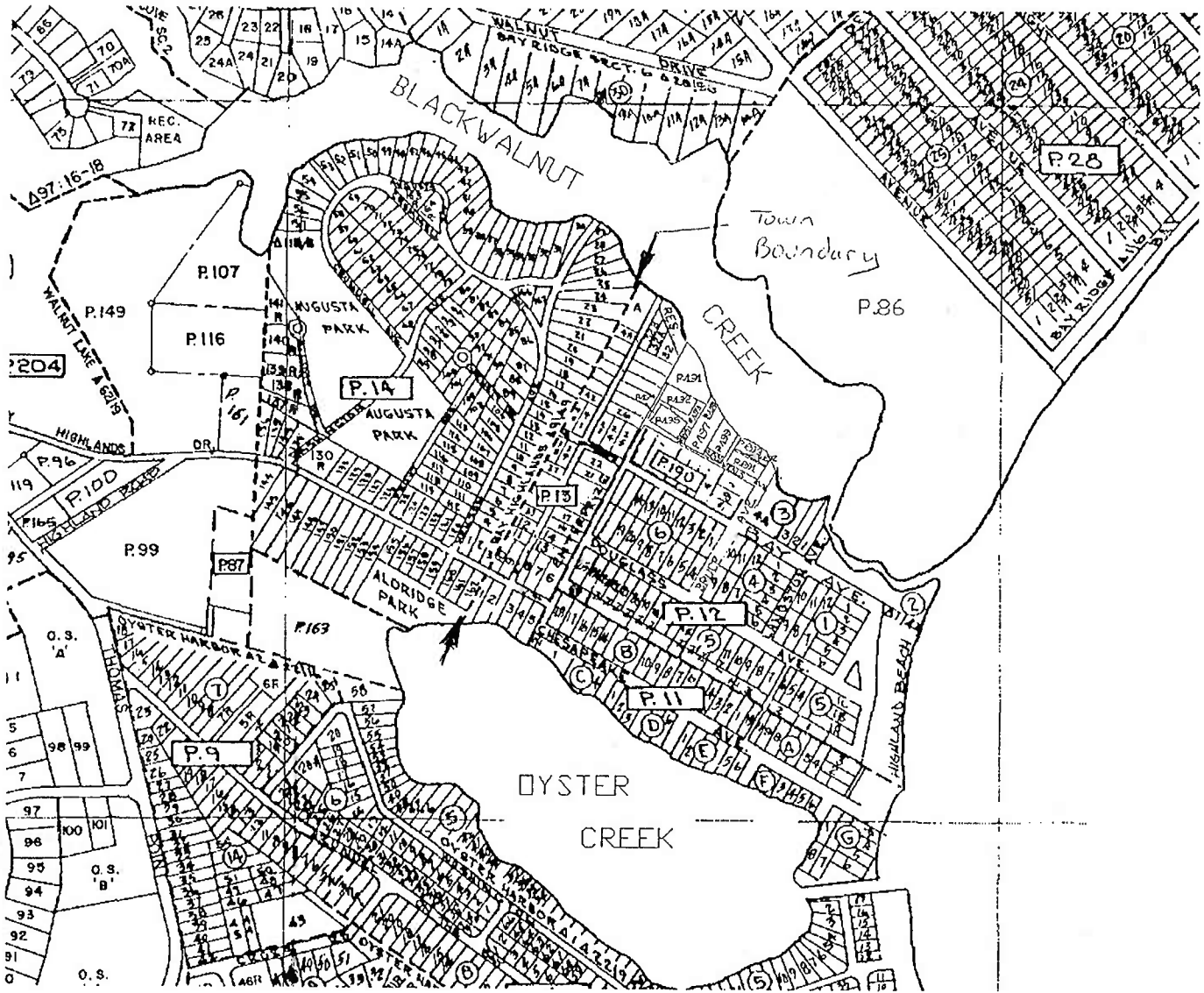

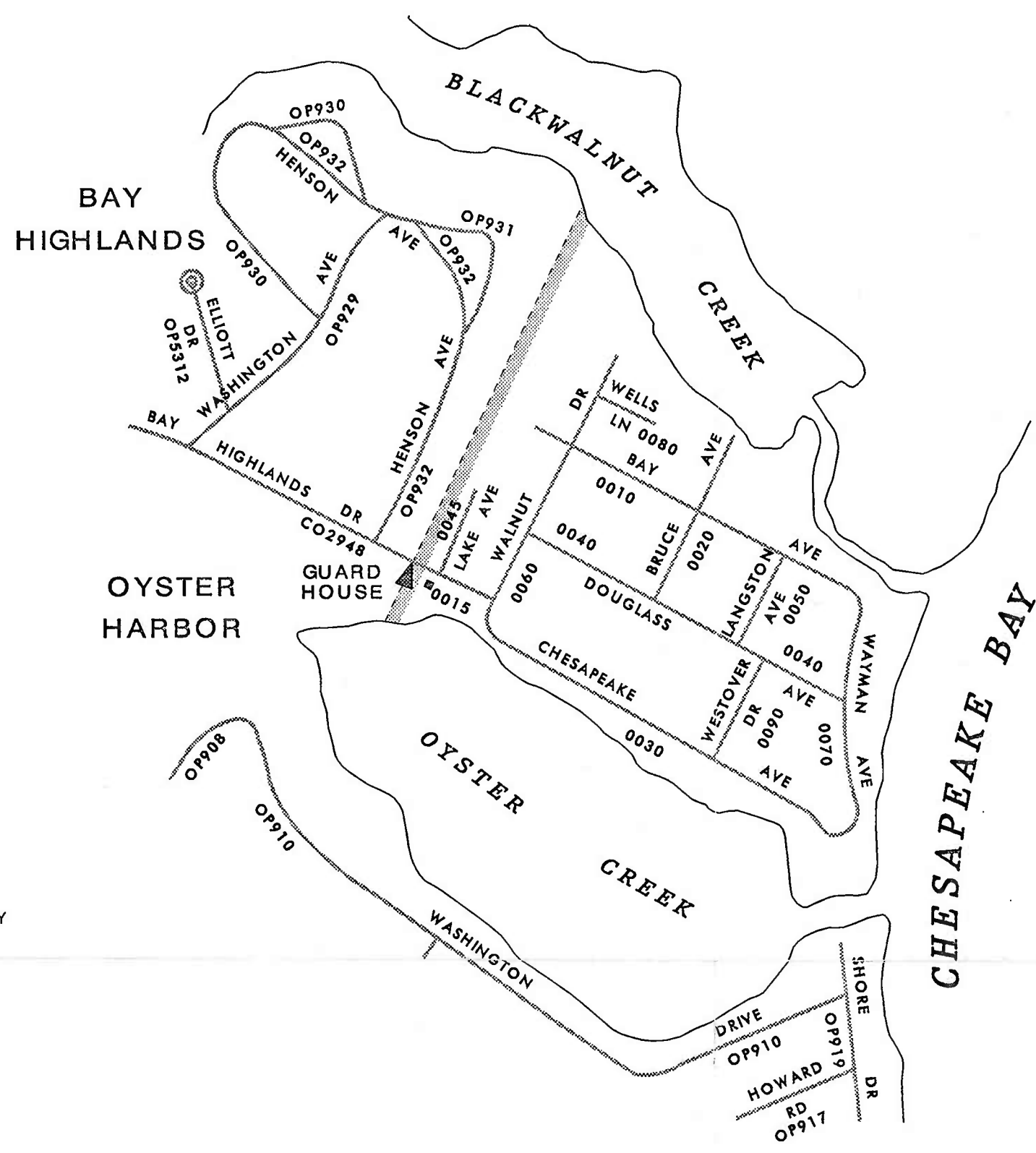

STATEWIDE GRID MAP KEY

D-12	D-13
E-12	E-13
F-12	F-13
G-12	G-13
H-12	H-13

TOWN LOCATED ON GRID MAP F-13
AND ON INDEX MAPS F-13C AND F-13D

LEGEND

STATE HIGHWAY	
COUNTY ROADS	
MUNICIPAL ROAD	
OTHER PUBLIC ROAD	
RESERVATION/PVT ROAD	
INTERSTATE NUMBERED HIGHWAY	
U.S. NUMBERED HIGHWAY	
STATE NUMBERED HIGHWAY	
ARMORY	
CITY HALL/MUNICIPAL BLDG.	
COURTHOUSE	
FIRE DEPARTMENT	
HIGHWAY GARAGE	
HOSPITAL	
LIBRARY	
PARK AND RIDE	
POLICE DEPARTMENT	
POST OFFICE	
SCHOOL	

Index Map updated to Jan 1, 2002

INFORMATION SUMMARY

BOUNDARY:
ACTS OF GENERAL ASSEMBLY, 1883
REVISED TO APRIL 10, 1988
HIGHWAYS REVISED TO JANUARY 1, 2000
PHOTOREVISED: 1994
CENSUS 108 (2000)

THIS MAP WAS CREATED USING MARYLAND
STATE PLANE COORDINATE GRID VALUES BASED
ON THE 1927 NORTH AMERICAN DATUM (NAD).

HISD / DATA SUPPORT TEAM
CORRECTION MAP

ROUTE NUMBER INDEX MAP
HIGHLAND BEACH

ANNE ARUNDEL COUNTY

MARYLAND

PREPARED BY THE

MARYLAND DEPARTMENT OF TRANSPORTATION

STATE HIGHWAY ADMINISTRATION

IN COOPERATION WITH THE

U. S. DEPARTMENT OF TRANSPORTATION

FEDERAL HIGHWAY ADMINISTRATION

PUBLISHED: 2001

SCALE IN FEET



SCALE IN MILES



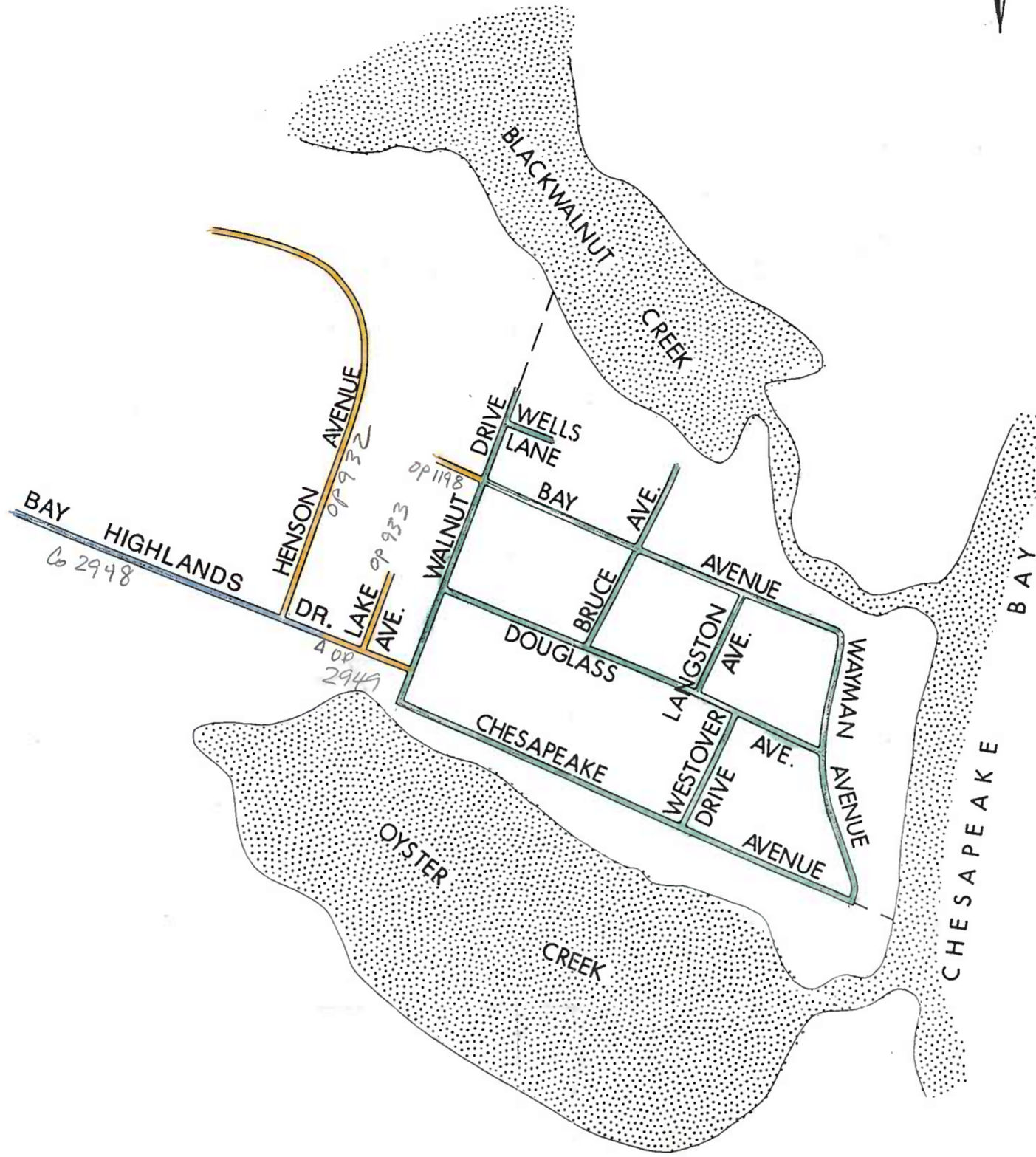

HIGHLAND BEACH 1990 MAP VERIFIED WITH:

INVENTORIES: 7/9/91

MASTER FILE:
HPMS:

BY: J SMITH

HIGHLAND BEACH

ANNE ARUNDEL COUNTY

MARYLAND

PREPARED BY THE

STATE HIGHWAY ADMINISTRATION

IN COOPERATION WITH THE

U.S. DEPARTMENT OF TRANSPORTATION

FEDERAL HIGHWAY ADMINISTRATION

JANUARY 1994

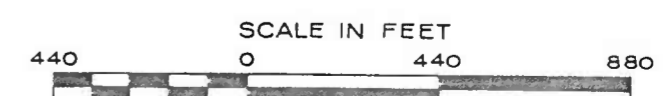

HISD / DATA SUPPORT TEAM
CORRECTION MAP

LEGEND

DIVIDED HIGHWAY	
NUMBERED HIGHWAY	
MUNICIPAL ROAD	
PROJECTED ROAD	
BRIDGE — SPAN 20' OR MORE	
INTERSTATE NUMBERED HIGHWAY	
U.S. NUMBERED HIGHWAY	
STATE NUMBERED HIGHWAY	
POST OFFICE	
SCHOOL	
TOWN HALL OR COMMUNITY HALL	
COURTHOUSE	
HOSPITAL	
HIGHWAY GARAGE	
POLICE STATION	
FIRE ENGINE HOUSE	

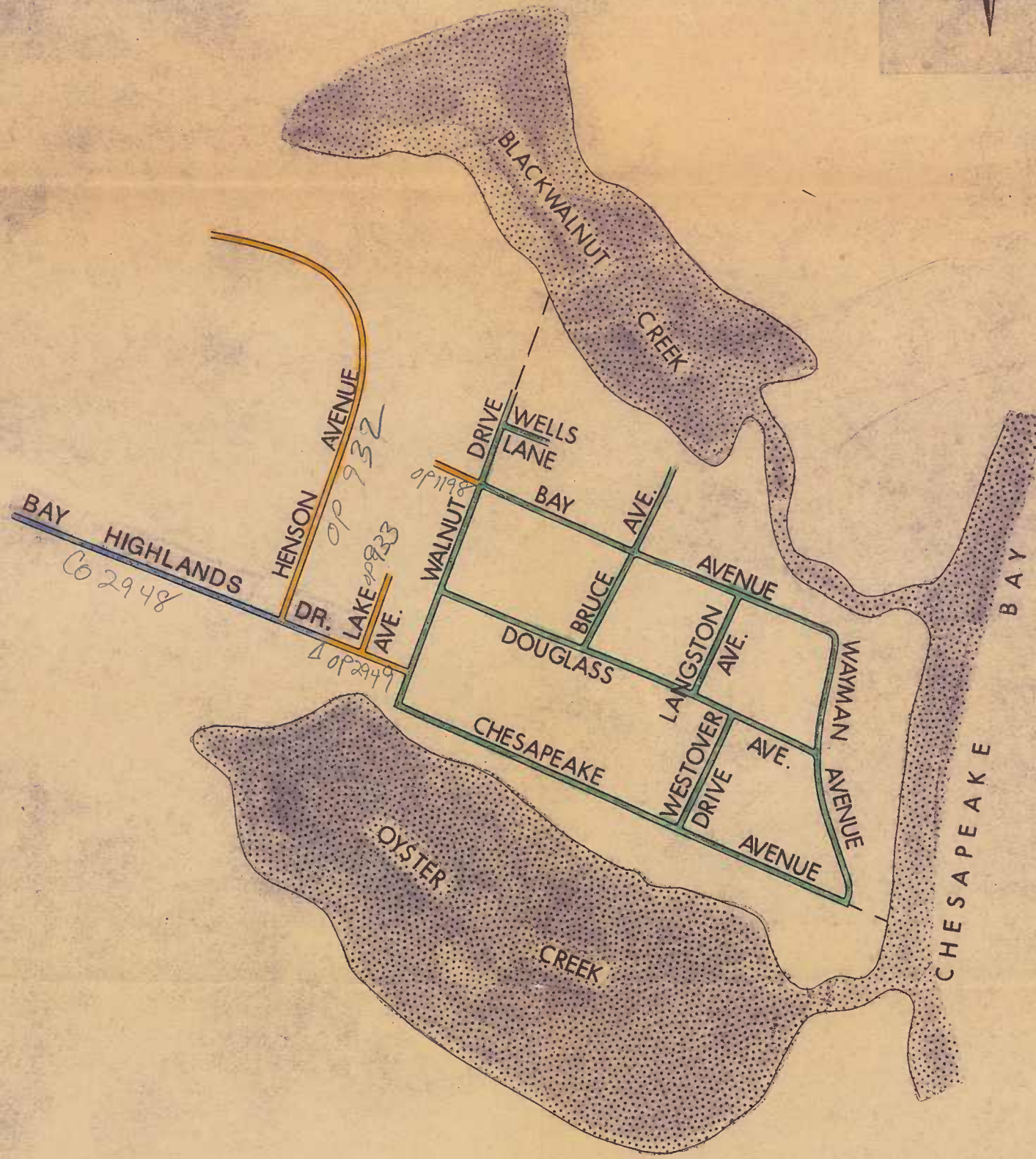
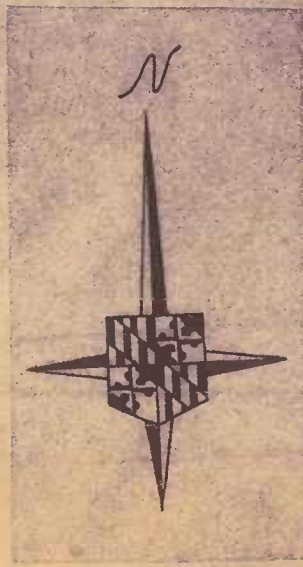

LEGEND

- DIVIDED HIGHWAY
- NUMBERED HIGHWAY
- MUNICIPAL ROAD
- PROJECTED ROAD
- BRIDGE — SPAN 20' OR MORE
- INTERSTATE NUMBERED HIGHWAY
- U.S. NUMBERED HIGHWAY
- STATE NUMBERED HIGHWAY
- POST OFFICE
- SCHOOL
- TOWN HALL OR COMMUNITY HALL
- COURTHOUSE
- HOSPITAL
- HIGHWAY GARAGE
- POLICE STATION
- FIRE ENGINE HOUSE

January 1990 map checked with inventory - 7/9/91 JTS

HIGHLAND BEACH

ANNE ARUNDEL COUNTY

MARYLAND

PREPARED BY THE
STATE HIGHWAY ADMINISTRATION

IN COOPERATION WITH THE
U.S. DEPARTMENT OF TRANSPORTATION
FEDERAL HIGHWAY ADMINISTRATION

JANUARY 1993

