

Martin O'Malley
Governor

Anthony G. Brown
Lt. Governor



Margaret G. McHale
Chair

Ren Serey
Executive Director

STATE OF MARYLAND
CRITICAL AREA COMMISSION
CHESAPEAKE AND ATLANTIC COASTAL BAYS

1804 West Street, Suite 100, Annapolis, Maryland 21401
(410) 260-3460 Fax: (410) 974-5338
www.dnr.state.md.us/criticalarea/

March 10, 2009

Mr. P. Douglas Gosnell
Commissioners of Sharptown
P.O. Box 338
Sharptown, Maryland 21681-0338

Mr. Rick Konrad
Wicomico County Recreation, Parks and Tourism
28302 Owens Branch Road
Salisbury, MD 21801

Re: Cherry Beach and Cope Bennett Park Improvements
Town of Sharptown and Wicomico County

Dear Mr. Gosnell and Mr. Konrad:

The purpose of this letter is to officially notify you of the Critical Area Commission's action on the above referenced project. On March 4, 2009, the Critical Area Commission unanimously approved the Town of Sharptown and Wicomico County's proposal and site plan to improve the existing Cherry Beach and Cope Bennett Parks in the Town of Sharptown and Wicomico County on the Nanticoke River. This approval included the following conditions:

- (1) Prior to the start of construction, the Wicomico County Department of Recreation and Parks shall provide copies of the erosion and sediment control and stormwater management authorizations to Commission staff; and
- (2) Any signage that may be added to the project in the future may be approved by Commission staff.

I have received the project plans showing the County's stamp of approval for the erosion and sediment control and stormwater management authorizations, and therefore condition number one above has been fulfilled.

The approval was also based on the mitigation package provided by the applicant which consisted of 27,600 square feet of mitigation plantings for disturbance in the Buffer. Please complete and return the enclosed planting agreement form within 30 days from receipt of this letter. Also, please notify me once the planting plan has been implemented.

Cherry Beach and Cope Bennett Park Improvements
March 10, 2009
Page Two

Please note that should any changes to the site plan be proposed in the future, additional review and approval by the full Commission will be required. Should you have any questions, please feel free to contact me at 410-260-3481.

Sincerely,



Amber Widmayer
Natural Resources Planner

cc: SH 228-08

Martin O'Malley
Governor

Anthony G. Brown
Lt. Governor



Margaret G. McHale
Chair

Ren Serey
Executive Director

STATE OF MARYLAND
CRITICAL AREA COMMISSION
CHESAPEAKE AND ATLANTIC COASTAL BAYS

1804 West Street, Suite 100, Annapolis, Maryland 21401
(410) 260-3460 Fax: (410) 974-5338
www.dnr.state.md.us/criticalarea/

December 30, 2008

Mr. P. Douglas Gosnell
Commissioners of Sharptown
P.O. Box 338
Sharptown, Maryland 21681-0338

Mr. Rick Konrad
Wicomico County Recreation, Parks and Tourism
28302 Owens Branch Road
Salisbury, MD 21801

Re: Sharptown Living Shoreline at Cherry Beach and Cope Bennett Park
Town of Sharptown and Wicomico County
Consistency Report

Dear Mr. Gosnell:

We have received final plans and a consistency report for the above-referenced project per the requirements of COMAR 27.02.02 - State and Local Agency Actions Resulting in Development of Local Significance on Private Lands or Lands Owned by Local Jurisdictions. The Town of Sharptown and Wicomico County in cooperation with Maryland Department of Natural Resources' Riparian and Wetland Restoration Division are proposing to construct a living shoreline at the water's edge of Cherry Beach, which is owned by the Town of Sharptown, and Cope Bennett Park, which is owned by Wicomico County. The 23,710 square foot project site is entirely within the Critical Area and is designated as an Intensely Developed Area (IDA).

Because the proposed project will enhance and restore the condition of the 100-foot Buffer on the Town and County property, and because the 23,710 square foot area of disturbance within the Buffer will be mitigated at a 1:1 ratio as described in the enclosed signed planting agreement, we have determined that the proposed project is consistent with the Critical Area programs for the Town of Sharptown and Wicomico County and will therefore require no further Commission review or action. If any changes are made to the current plans, the revised project must be reviewed by the Commission.

We appreciate the opportunity to provide comments on this development proposal. If you have any questions, please contact me at 410-260-3481.



Sharptown Living Shoreline Consistency Determination
December 30, 2008
Page Two

Sincerely,



Amber Widmayer
Natural Resources Planner

cc: SH 218-08
David Wilson, MD Eastern Shore RC&D Council
Bhaskaran Subramanian, DNR Riparian and Wetland Restoration Division

Martin O'Malley
Governor

Anthony G. Brown
Lt. Governor



Margaret G. McHale
Chair

Ren Serey
Executive Director

STATE OF MARYLAND
CRITICAL AREA COMMISSION
CHESAPEAKE AND ATLANTIC COASTAL BAYS

1804 West Street, Suite 100, Annapolis, Maryland 21401

(410) 260-3460 Fax: (410) 974-5338

www.dnr.state.md.us/criticalarea/

May 13, 2008

Mr. P. Douglas Gosnell
Commissioners of Sharptown
P.O. Box 338
Sharptown, Maryland 21681-0338

Re: Cherry Beach Boat Ramp and Park
Town of Sharptown

Dear Mr. Gosnell:

Thank you for forwarding the above-referenced project proposal for the Cherry Beach Boat Ramp and Park. The 9.79 acre property is in the Critical Area and it appears that the property is designated as an Intensely Developed Area (IDA). The project proposes the restoration of an existing boat ramp, the expansion and resurfacing of the existing parking lot, the installation of a playground module, the creation of a living shoreline, and the construction of an eight-foot wide asphalt walking trail. Due to the extent of the proposed disturbance for the above activities within the 100-foot Buffer, the proposed project will need to be presented to the Critical Area Commission for conditional approval.

The Town may seek a conditional approval from the Critical Area Commission for approval of a project on Town lands under Code of Maryland Regulations 27.02.06 'Conditional Approval of State or Local Agency Programs in the Critical Area'. Under this section, if development proposed by a State or local agency located in the Critical Area is prohibited from occurring then the agency proposing the development may seek conditional approval for the project.

In order for the Critical Area Commission to process this request as a conditional approval, the applicant must submit information demonstrating how the proposed project meets the following criteria.

In order to qualify for consideration by the Commission for conditional approval, it shall be shown by the proposing or sponsoring agency that the project or program has the following characteristics:

TTY for the Deaf

Annapolis: (410) 974-2609 D.C. Metro: (301) 586-0450



B.(1) That there exist special features of the site or there are other special circumstances such that the literal enforcement of these regulations would prevent a project or program from being implemented;

B.(2) That the project or program otherwise provides substantial public benefits to the Chesapeake Bay Critical Area Program;

B.(3) That the project or program is otherwise in conformance with this subtitle;

The conditional approval request shall, at a minimum, contain the following:

C.(1) A showing that the literal enforcement of the provisions of this subtitle would prevent the conduct of an authorized State or local agency program or project;

C.(2) A proposed process by which the program or project could be so conducted as to conform, insofar as possible, with the approved local Critical Area program or if the development is to occur on State-owned lands, with the criteria set forth in COMAR 27.02.05;

C.(3) Measures proposed to mitigate adverse effects of the project or program or an approved local Critical Area program or, if on State-owned lands, on the criteria set forth in COMAR 27.02.05.

In addition to providing the information above, a complete application will include any necessary State or local agency permits, a letter from Maryland Department of Natural Resources' Wildlife and Heritage Service stating that the proposed project will not impact rare, threatened or endangered species, and a letter from the Maryland Historical Trust that the proposed project will not impact any historic resources.

As soon as we receive your complete application, we will be able to schedule the presentation of your proposed project on the agenda for a Critical Area Commission meeting. Projects must be received at least one month prior to the next scheduled Commission meeting in order to be included on that meeting agenda. The Commission meets on the first Wednesday of each month, and the schedule is posted at <http://www.dnr.state.md.us/criticalarea/aboutthecommission>.

This office has reviewed the submitted project plans and we have provided comments and recommendations below:

- 1) It is unclear how much of what is shown on the submitted Master Plan is proposed at this time. For instance, in addition to the park improvements described above, the Master Plan also shows the following proposed features: sidewalks, two foot bridges, a comfort station, volleyball court, pier with a dump station, retaining wall, a five-foot wide walkway, and a kayak launch. Please clarify whether these features are proposed at this time.

- 2) It is unclear whether any of the proposed park improvements have already been constructed. The applicant's April 16, 2008 letter indicates that the restoration of the existing boat ramp, the restoration and expansion of the parking lot and the installation of a playground module are all complete. However, the letter also indicates that the requested timeline for the parking lot expansion ranges from June 30th to August 8th. Please clarify which, if any, of the proposed park improvements have been commenced or completed. This office notes that the remaining proposed activities may not be started prior to receiving the Critical Area Commission's approval.
- 3) Please confirm that the entire project area within the Critical Area is designated as IDA. Also, please quantify the area of the property that is within the Critical Area.
- 4) Please provide drainage maps for the site and more detailed information about which existing and proposed impervious surfaces have been included in the submitted 10% pollutant removal calculations. The drainage maps should indicate how the site area used for the 10% calculations was determined.
- 5) COMAR 27.01.02.03.D(4) requires that if practicable, permeable areas within IDA shall be established in vegetation. Please provide a landscape plan demonstrating that this requirement has been addressed, or an explanation for why more plantings are not practicable in the Buffer and on the rest of the property. Also, please include a planting list with the plan that demonstrates that the proposed plantings will be native species. A list of such native plants can be found in the U.S. Fish and Wildlife Service's Native Plants for Wildlife Habitat and Conservation Landscaping: Chesapeake Bay Watershed document which is available at <http://www.nps.gov/plants/pubs/chesapeake/>.
- 6) Please confirm that the 100-foot Buffer on the plans was mapped from the edge of tidal wetlands or waters based on a field delineation.
- 7) Please quantify the total area of disturbance within the Buffer for each of the proposed activities. Buffer impacts are calculated based on the total area of proposed disturbance within the Buffer from grading, clearing, and the footprint of structures and impervious surfaces.
- 8) This office recommends that the proposed walking trail be located outside of the Buffer to the extent feasible.
- 9) According to our records, there is a rare, threatened or endangered species located on or in the vicinity of the project site. Also, the waters adjacent to the property area designated as a Wetland of Special State Concern. The applicant must obtain and submit a letter of review from the Maryland Department of Natural Resources' Wildlife and Heritage Service identifying any known protected

Mr. Gosnell
May 13, 2008
Page 4 of 4

species on the property and providing guidance as to what measures should be taken by the applicant for protection of such species. These measures must be incorporated into the project plans.

Please feel free to contact me at 410-260-3481 if you have any questions.

Sincerely,



Amber Widmayer
Natural Resources Planner

cc: SH 228-08
Jimmy Sharp

Consistency Report for Local Government Projects

228-08

Project Name: Sharptown Living Shoreline	Jurisdiction: Wicomico County
Project Description: Construction of sill structure with tidal freshwater marsh opening. Kayak launch with beach and tree protection revetment. Buffer (25-ft.) existing turf to be replaced with native grasses & shrub clusters.	
Local Agency proposing project: Maryland Eastern Shore RC&D Council, Inc.	
Contact Name and Phone Number: David H. Wilson, Coordinator	
Project Location (include street address, tax map and parcel number): 100 Cherry Beach Road, Sharptown, MD 21861 Tax map # 3; Parcel# 80 and 95	<div style="border: 1px solid black; padding: 5px; display: inline-block;"> DEC 3 2008 </div>
Critical Area acreage and designation: 23,710 sq. ft. and IDA	

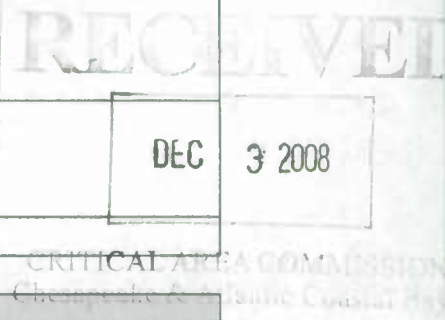

Project Data	
Existing forest/woodland/trees: 26 trees ≥ 3 in. dbh	% of site: 5.0 percent
Proposed clearing: 4 trees	% of existing forest: 0.8 percent
Mitigation to be provided: 6,330 square feet	
Planting location & species (also show on site plan): On-site (see Sheet 2) Sycamore, Red Oak, White Oak, Southern Red Oak (see Sheet 5)	
Existing impervious surface: 0 square feet	% of site: 0 percent
Proposed new impervious: 0 square feet	
Total impervious surface: 0 square feet	
% of site: 0 percent	
If the % of impervious cover exceeds the permitted amount in the LDA or RCA, the project may need a Conditional Approval from the Critical Area Commission. Please contact your Commission planner for assistance.	
Total Area Disturbed: 23,710 sq. ft. (Coastal shrub plantings: 10,600 sq. ft; Coastal grass plantings: 6,780 sq. ft. and Beach: 6,330 sq. ft.)	
Stormwater Management: (If site is in the IDA, the 10% worksheets must be attached. Otherwise, local stormwater requirements must be addressed.) Not Required.	
Has project received local approval of SWM and sediment and erosion control plans? Stormwater not required. Sediment & erosion control permit requirement is unknown.	
Buffer impacts? 23,710 sq. ft.	Is project water dependent? Yes
If there are Buffer impacts proposed and the project is not water dependent, the project may need a Conditional Approval from the Critical Area Commission. Please contact your Commission planner for assistance.	
<u>Other Habitat Protection Areas:</u>	
Colonial Nesting Waterbird site? Yes <input type="checkbox"/> No <input checked="" type="checkbox"/>	Waterfowl Staging Area? Yes <input type="checkbox"/> No <input checked="" type="checkbox"/>
Endangered / threatened species? Yes <input type="checkbox"/> No <input checked="" type="checkbox"/>	Forest Interior Dwelling Bird Habitat? Yes <input type="checkbox"/> No <input checked="" type="checkbox"/>
Anadromous Fish Propagation Waters? Yes <input checked="" type="checkbox"/> No <input type="checkbox"/>	
Non-tidal Wetland Impacts? Yes <input type="checkbox"/> No <input checked="" type="checkbox"/> If yes, MDE permit #: N/A	
Tidal Wetland Impacts? Yes <input checked="" type="checkbox"/> No <input type="checkbox"/> If yes, MDE permit #: 08-1007 (Wetlands License #)	

In accordance with COMAR 27.02.02, we hereby certify that this local agency project is consistent with the requirements of the local Critical Area Program.

(Signature)

REC 1 103

Planting Agreement for State/Local Projects

State/Local Agency

Town of Sharptown

Project Number

SH228-08

Agency Contact

David H. Wilson

Phone Number

(410) 822-9300

Commission Approval Date

TBA

CAC Planner

Amber Widmayer

Project Name

Cherry Beach Living Shoreline Project

Project Location

Cherry Beach Park; Sharptown, Maryland

Square Feet Cleared Outside 100ft Buffer

0 sq. ft

Mitigation Ratio for Clearing Outside Buffer

1:1

Mitigation Calculation Outside Buffer

0

Square Feet Disturbed/Cleared Within Buffer*

23,710 sq. ft.

Mitigation Ratio for Disturbance/Clearing Within Buffer*

1:1

15% Afforestation Requirement Met?

N/A

Mitigation Calculation Within Buffer

1:1

Total Mitigation Requirement

23,710 sq. ft.

Planting and Natural Regeneration Plan (attach additional sheets if necessary)

Please refer to "Sharptown Living Shoreline Final Design V10-15-08"

Planting Date

Spring

Year

2009

First Site Visit Date

Completed by

Second Site Visit Date

Completed By

Date Mitigation Complete

David H. Wilson
Responsible Contact for Mitigation (Print)

Signature

12/02/08
Date

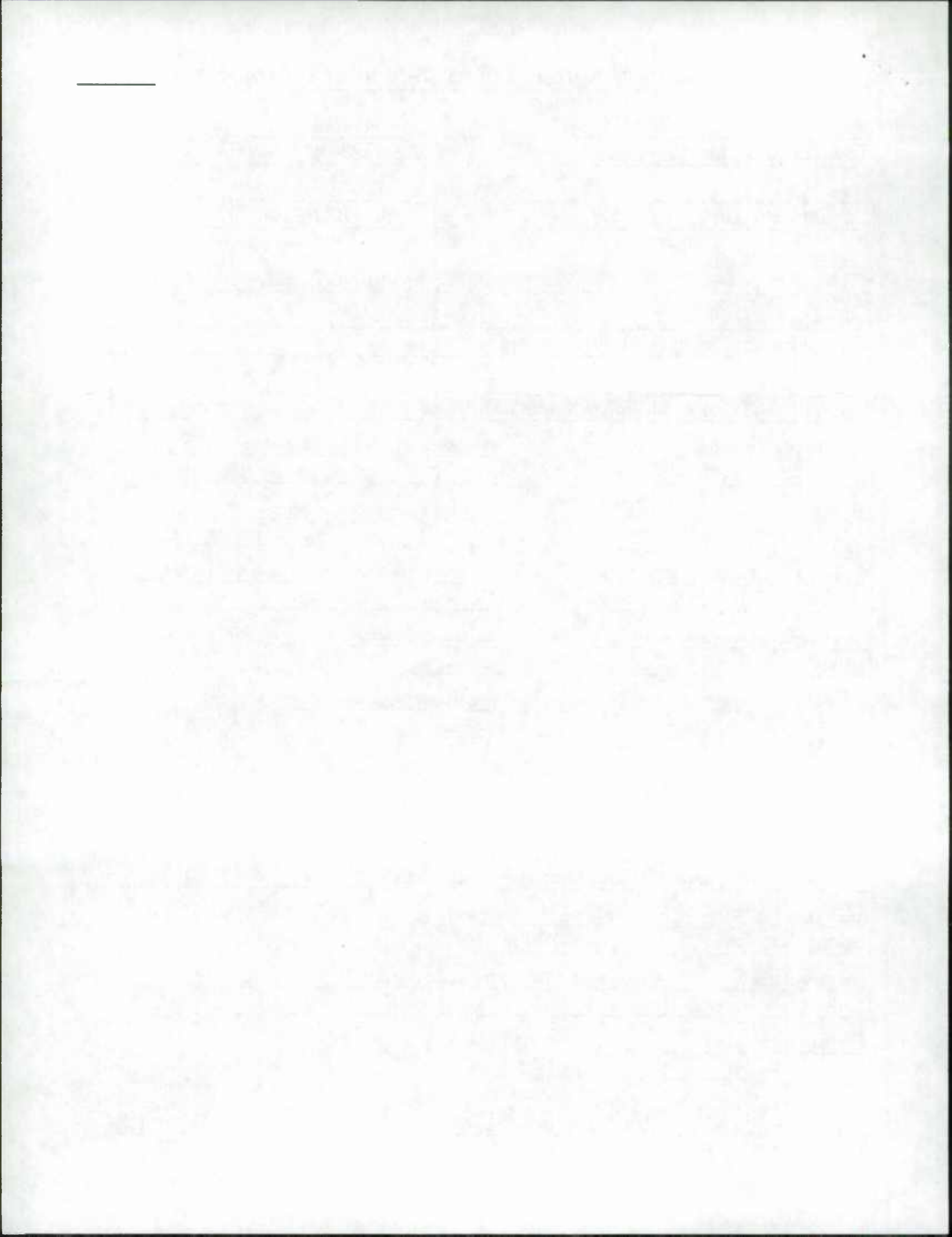

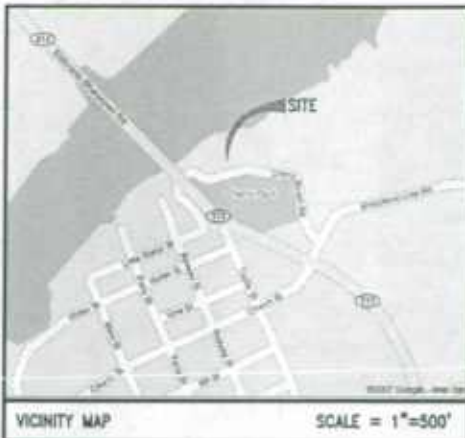

BENCHMARK
 USGS MARKER #142742 - ELEVATION 61.0
 BENCHMARK TRANSFERRED TO NAIL-SET IN EDGE OF PAVEMENT ON NORTHWEST CORNER OF EXISTING PARKING AREA BY AWB ENGINEERS ON 28 SEPT. 07
 NAIL-SET AT ELEVATION 17.62

- LEGEND**
- PROPERTY LINE, IRON PIN FOUND & CONCRETE MONUMENT FOUND
 - LIMITS OF DISTURBANCE
 - EXISTING EASEMENT LINES
 - EXISTING UTILITY POLE
 - EDGE OF EXISTING TREE LINE
 - PROPOSED ASPHALT PAVING (REF. SPECIFICATIONS/SP-1)
 - EXISTING PAVED PARKING TO BE MILLED AND REPAVED
 - EXISTING STRUCTURES TO BE REMOVED

PROJECT DATA

OWNER
 WICOMICO COUNTY MARYLAND
 P.O. BOX 870 SALISBURY, MARYLAND 21803-0870 (MAILING)
 CHERRY BEACH ROAD SHARPTOWN, MARYLAND 21861 (PHYSICAL)

CONTACT
 WICOMICO COUNTY RECREATION, PARKS & TOURISM
 RICK D. KONRAD
 SUPERINTENDENT OF PARKS
 26302 OWENS BRANCH ROAD
 SALISBURY, MARYLAND 21801
 410-548-4870 (PHONE)
 410-860-1413 (FAX)
 rkonrad@wicomicocounty.org (EMAIL)

ENGINEER
 AWB ENGINEERS
 1942 NORTHWOOD DRIVE
 SALISBURY, MARYLAND 21801-7824
 410-742-7299 (PHONE)
 410-742-0273 (FAX)
 PROJECT MGR: DAN TOUBERT
 dtoubert@awbengineers.com (EMAIL)

LAND AREA 43.0 ACRES
TAX MAP 3
TAX GRID 3
TAX PARCEL 80
DEED REFERENCE(S) JWTS 630/65
PLAT REFERENCE IDT 213/1, 172/20. BOUNDARY SURVEY PROVIDED BY BRIAN M. DENNIS AND ASSOCIATES, INC. ENTITLED "TOPOGRAPHIC SURVEY FOR CHERRY BEACH PARK" (NOT RECORDED).

ZONING TT (TOWN TRANSITION) AND CBCA (CHESAPEAKE BAY CRITICAL AREA)

PARKING SPACES

	REGULAR	H/C	TOTAL
REQUIRED	44	2	46
PROVIDED	44	2	46

BUILDING SETBACKS
 FRONT 30000X
 REAR 300000X
 SIDE 300000X

SURVEY DATA
 METES AND BOUNDS WERE TAKEN FROM PLAT REFERENCED ABOVE.
 TOPOGRAPHIC DATA WAS COLLECTED BY AWB ENGINEERS ON 09/28/07.
 THIS PROPERTY APPEARS TO BE IN FLOOD ZONE "C" AND "AS" ON F.L.R.M. COMMUNITY PANEL #240078-001-C, DATED SEPT. 28, 1984. BASED ON THE ABOVE INFORMATION, PORTIONS OF THE PROPERTY ARE WITHIN THE 100-YEAR FLOODPLAIN. THE ENTIRE PROPERTY LIES IN THE CRITICAL AREA.
 OWNER IS RESPONSIBLE FOR SURVEY TO ESTABLISH BOUNDARIES AND CLEARLY MARK THEM.

SPECIFICATIONS
 STONE STABILIZATION FOR TRUCK TRAFFIC SHALL CONSIST OF 6" OF CR-6 OVER COMPACTED STRUCTURAL FILL COMPACT BOTH CR-6 AND FILL TO 95% OF THE APPROXIMATE STANDARD PROCTOR MAXIMUM DRY DENSITY.
 LIGHT ASPHALT PAVING SHALL CONSIST OF 4 INCHES OF CR-6 STONE OVER SUBSOIL AND BOTH COMPACTED TO 95% OF THE MODIFIED PROCTOR TEST. THIS SHALL BE OVERLAYED WITH 2 INCHES OF 9.5 mm HOT MIX ASPHALT.

RELEASE BY
 04 MAR 08 DRT
 15 APR 08 DRT

PROJECT NORTH

ENGINEERS/ARCHITECTS
 1942 NORTHWOOD DRIVE SALISBURY, MARYLAND 21801-7824
 PH. (410) 742-7299 FAX. (410) 742-0273

AWBENGINEERS

Wicomico County
 Recreation, Parks & Tourism

SITE IMPROVEMENTS PLAN
 CHERRY BEACH PARK
 SHARPTOWN, MARYLAND

PRELIMINARY
 SCALE 1"=30'
 DRAWN DRT
 CHECKED DRT
 JOB 070802
 FILE DRT-1
 SHEET SP-1

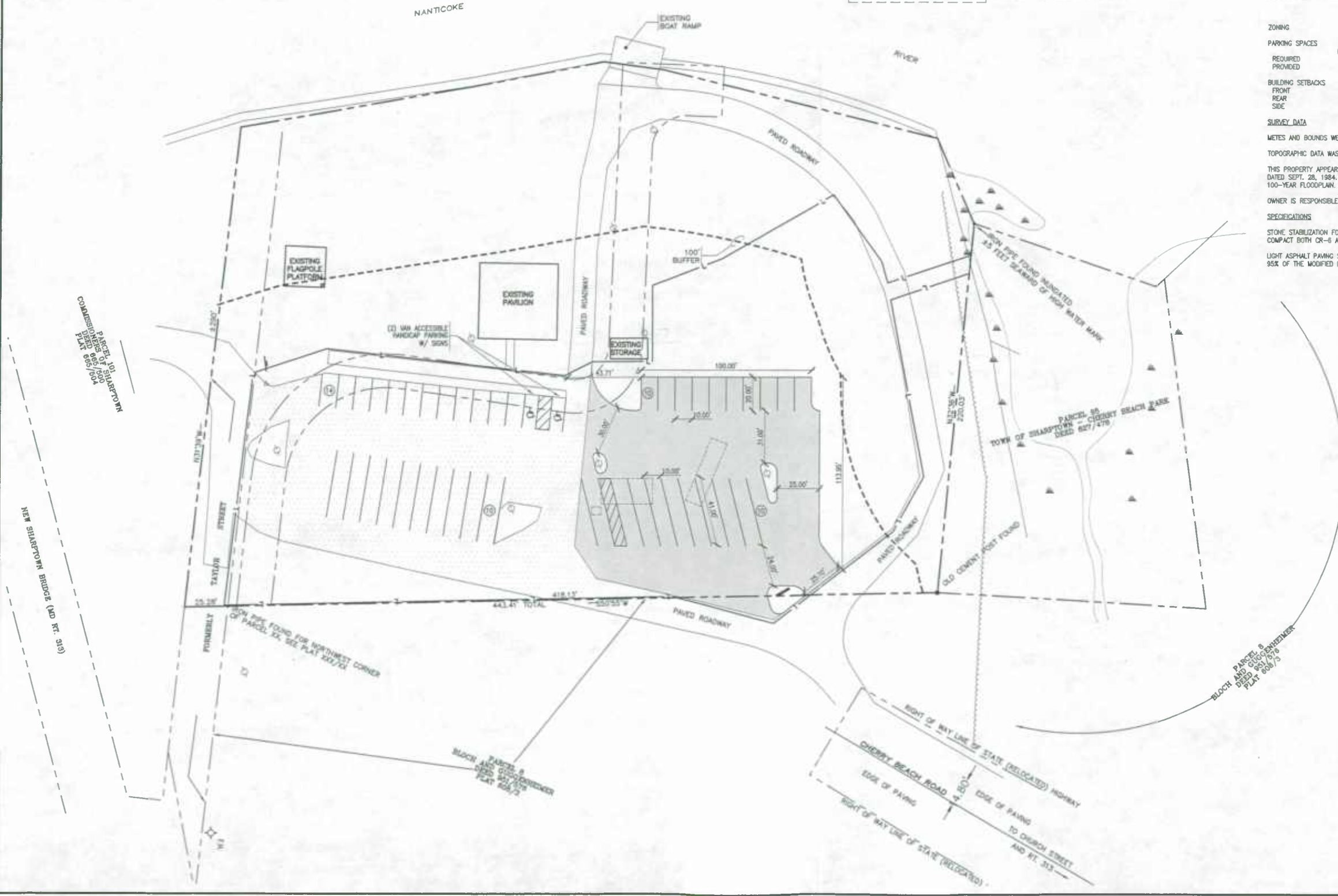

RECEIVED
 APR 21 2008
 CRITICAL AREA COMMISSION
 Chesapeake & Atlantic Coastal Bays

THE INFORMATION PRESENTED ON THIS PLAN IS PRELIMINARY IN NATURE AND SHOULD NOT BE RELIED UPON FOR FINAL PRICING OR CONSTRUCTION. THE USER MUST RECOGNIZE THAT THE INFORMATION PRESENTED ON THIS DRAWING MAY CHANGE AS THE FINAL CONSTRUCTION PLANS ARE DEVELOPED. INCREASED PROJECT COSTS OR DELAYS IN EXECUTION OF THIS PROJECT DUE TO FUTURE DESIGN CHANGES ARE NOT THE RESPONSIBILITY OF AWB ENGINEERS OR ITS SUB-CONTRACTORS.



VICINITY MAP SCALE = 1"=500'

NOTE:
 PROPOSED NET DRAINAGE WILL SERVE AS TEMPORARY SEDIMENT BASIN DURING CONSTRUCTION.

SEDIMENT BASIN VOLUME
 STORAGE REQUIREMENT = 3,600 CU. FT. / AC.
 DRAINAGE AREA = 1.29 ACRES
 STORAGE REQUIRED = 4,644 CU. FT.
 STORAGE PROVIDED (@ EL. 9.40) = 4,872 CU. FT.

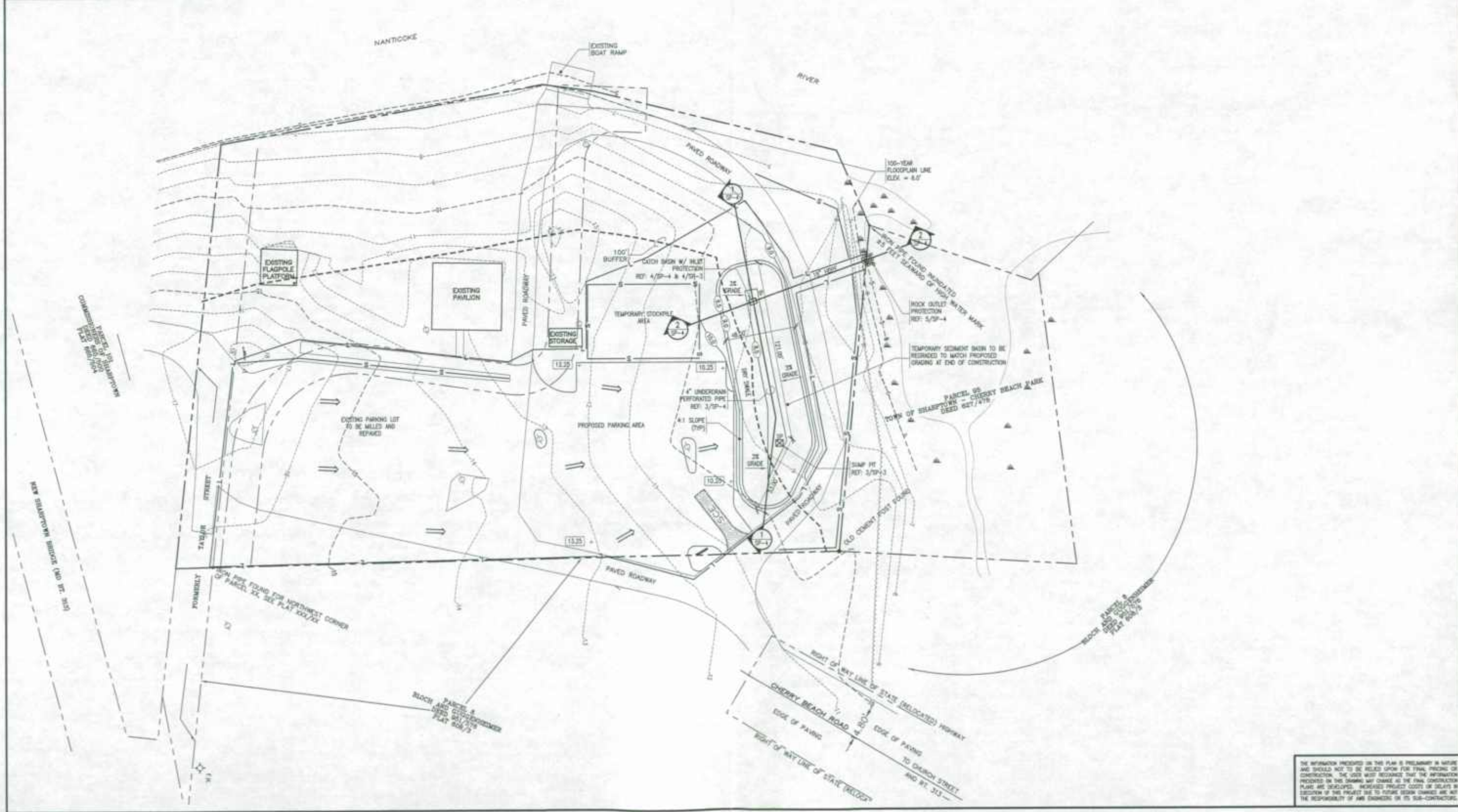
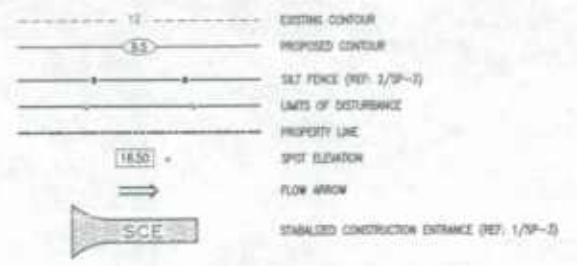

THE INFORMATION PRESENTED ON THIS PLAN IS PRELIMINARY IN NATURE AND SHOULD NOT BE RELIED UPON FOR FINAL PRICING OR CONSTRUCTION. THE USER MUST RECOGNIZE THAT THE INFORMATION PRESENTED ON THE DRAWING MAY CHANGE AS THE FINAL CONSTRUCTION PLANS ARE DEVELOPED. INCREASED PROJECT COSTS OR DELAYS IN COMPLETION OF THIS PROJECT DUE TO FUTURE DESIGN CHANGES ARE NOT THE RESPONSIBILITY OF ABE ENGINEERS OR ITS SUB-CONTRACTORS.

RELEASE	BY
04 APR 08	DRT
15 APR 08	DRT
ENGINEERS/ARCHITECTS <small>1943 WOODBRIDGE ROAD, ANNAPOLIS, MARYLAND 21403-7000 TEL: (410) 791-7000 FAX: (410) 791-0033</small>	
SITE DRAINAGE PLAN CHERRY BEACH PARK <small>SHARPTOWN, MARYLAND</small>	
DATE	PRELIMINARY
SCALE	1"=50'
DRAWN	DRT
PREPARED	DRT
JOB	070802
FILE	DRT-1
SHEET	SP-2

COPYRIGHT © 2008, ANDREW W. BOOTH & ASSOCIATES, INC.

SEDIMENT CONTROL PLAN NOTES

ALL EROSION AND SEDIMENT CONTROL PRACTICES SHALL BE CONSISTENT WITH THE 1994 MARYLAND STANDARDS AND SPECIFICATIONS FOR SOIL EROSION AND SEDIMENT CONTROL.

A RESPONSIBLE PERSON INVOLVED IN THE CONSTRUCTION PROJECT WILL HAVE A CERTIFICATE OF TRAINING AT A DEPARTMENT OF NATURAL RESOURCES APPROVED TRAINING PROGRAM FOR THE CONTROL OF SEDIMENT AND EROSION BEFORE BEGINNING THE PROJECT.

AN APPROVED DETAILED EROSION AND SEDIMENT CONTROL PLAN WILL BE EFFECTIVE FOR THE DURATION OF THE PROJECT. MAINTENANCE SHALL BE PERFORMED AS NECESSARY TO ENSURE THE STABILIZED AREAS CONTINUOUSLY MEET THE STANDARDS.

THE SILT FENCE SYSTEM SHALL BE CONSTRUCTED AS SHOWN ON THE PLANS. ALL PERIMETER CONTROLS SHALL BE VEGETATIVELY STABILIZED WITHIN SEVEN DAYS.

FOLLOWING INITIAL SOIL DISTURBANCE OR RESTURBANCE, PERMANENT OR TEMPORARY STABILIZATION SHALL BE COMPLETED WITHIN SEVEN (7) CALENDAR DAYS AS TO THE SURFACE OF ALL PERIMETER CONTROL, DICES, SWALES, DITCHES, PERIMETER SLOPES, AND ALL SLOPES GREATER THAN 3 HORIZONTAL TO 1 VERTICAL (3:1) AND FOURTEEN (14) DAYS TO ALL OTHER DISTURBED OR GRADED AREAS ON THE PROJECT SITE. ALL SOIL STOCKPILE AREAS MUST BE SURROUNDED BY SILT FENCE.

THE CONTRACTOR SHALL TAKE WHATEVER MEASURES MAY BE REQUIRED TO PREVENT SEDIMENT LADEN WATER FROM RUNNING OFF THE SITE DURING CONSTRUCTION. THE GENERAL CONTRACTOR IS RESPONSIBLE TO MAINTAIN AND REPAIR ALL EROSION AND SEDIMENT CONTROL MEASURES.

ALL DISTURBED AREAS SHALL BE PROTECTED TO PREVENT OFF-SITE EROSION AND SEDIMENT DAMAGES TO ADJACENT PROPERTIES, PUBLIC RIGHTS-OF-WAYS, STORM DRAINS AND/OR STREAMS.

STORM DRAINAGE WILL BE HANDLED BY PROVIDING POSITIVE DRAINAGE INTO A STABILIZED AREA CONSISTENT WITH ESTABLISHED DRAINAGE PATTERNS.

AN INSPECTION MAY BE REQUESTED UPON COMPLETION OF THE INSTALLATION OF PERIMETER EROSION AND SEDIMENT CONTROLS BEFORE PROCEEDING WITH ANY OTHER EARTH DISTURBANCE. THE DEPARTMENT OF THE ENVIRONMENT SEDIMENT AND EROSION CONTROL INSPECTOR MUST BE NOTIFIED TWO (2) WEEKS PRIOR TO THE START OF CONSTRUCTION, FOR AN ON SITE REVIEW OF PROPOSED SEDIMENT AND EROSION CONTROL MEASURES.

A FINAL INSPECTION WILL BE REQUIRED PRIOR TO THE REMOVAL OF THE SEDIMENT CONTROL MEASURES.

IF THE APPROVED PLAN NEEDS TO BE MODIFIED, ADDITIONAL EROSION AND SEDIMENT CONTROL MEASURES MAY BE REQUIRED AS DEEMED NECESSARY BY THE SOIL CONSERVATION DISTRICT.

CONTACT THE MARYLAND DEPARTMENT OF THE ENVIRONMENT INSPECTION OFFICE 48 HOURS PRIOR TO ANY PRE-CONSTRUCTION MEETING OR INSPECTION.

1. OWNER/APPLICANT:

WICOMICO COUNTY MARYLAND
P.O. BOX 870 SALISBURY, MARYLAND 21803-0870 (MAILING)
CHERRY BEACH ROAD SHARPTOWN, MARYLAND 21861 (PHYSICAL)

2. DEVELOPER:

WICOMICO COUNTY RECREATION, PARKS & TOURISM
RICK O. KONRAD
SUPERINTENDENT OF PARKS
28302 OWENS BRANCH ROAD
SALISBURY, MARYLAND 21801
410-548-4870 (PHONE)
410-860-1413 (FAX)
rkonrad@wicomicoounty.org (EMAIL)

NOTE:

ALL EROSION AND SEDIMENT CONTROLS MEASURES MUST BE IN PLACE BEFORE ANY EARTHMOVING OPERATIONS MAY START. THE SCHEDULE THAT APPEARS ON THIS SHEET IS AN ENGINEER'S ESTIMATE AND MAY VARY DUE TO THE ELEMENTS, ETC.

GRASSED AREA AND LANDSCAPING

TEMPORARY VEGETATION: ALL DISTURBED AREAS REQUIRING TEMPORARY VEGETATION SHALL BE SEEDED AS FOLLOWS:

SEED MIXTURE (FOR HARDINESS ZONE 7A) (FROM TABLE 26)					FERTILIZER RATE (10-10-10)	LIME RATE
NO.	SPECIES	APPLICATION RATE (LB/AC)	SEEDING DATES	SEEDING DEPTHS		
1	ANNUAL RYEGRASS	100	2/1-4/30 8/15-11/30	1/4-1/2 INCH	800 LB/AC (15 LB/ 1000 SF)	2 TONS/AC (100 LB/1000 SF)

STRAW MULCH WITH 92 LB. PER 1000 SQ. FT. WITH ANCHORAGE AS REQUIRED BY ONE OF THE FOLLOWING METHODS: MULCH ANCHORING TOOL, "TRACKING", OR LIQUID MULCH BINDERS, USING APPROVED PROCEDURES AND RATES. ASPHALT MULCH BINDER IS UNACCEPTABLE. A SYNTHETIC BINDER IS RECOMMENDED.

PERMANENT VEGETATION

AFTER ALL FINAL GRADING IS COMPLETE, ALL AREAS NOT TO BE PAVED OR OTHERWISE TREATED SHALL BE SEEDED BY APPROVED METHODS. MINIMUM SEEDING SHALL BE AS FOLLOWS ON 4" MINIMUM TOP SOIL. CONTRACTOR MAY OBTAIN A SOIL TEST THRU THE COOP. EXTENSION SERVICE TO DETERMINE LIME & FERTILIZER REQUIRED IN LIEU OF THE BELOW RECOMMENDATIONS.

SEED MIXTURE (FOR HARDINESS ZONE 7A) (FROM TABLE 25)					FERTILIZER RATE (10-20-20)			LIME RATE
NO.	SPECIES	APPLICATION RATE (LB/AC)	SEEDING DATES	SEEDING DEPTHS	N	P205	K20	
3	TALL FESCUE 85%	125	3/1-5/15	1/4-1/2	90 LB/AC (2.0 LB/ 1000 SF)	175 LB/AC (4 LB/ 1000 SF)	175 LB/AC (4 LB/ 1000 SF)	2 TONS/AC (100 LB/ 1000 SF)
	PERENNIAL RYEGRASS 10%	15	8/15-11/15	INCH				
	KENTUCKY BLUEGRASS 5%	10						

STRAW MULCH WITH 92 LB. PER 1000 SQ. FT. WITH ANCHORAGE AS REQUIRED BY ONE OF THE FOLLOWING METHODS: MULCH ANCHORING TOOL, "TRACKING", OR LIQUID MULCH BINDERS, USING APPROVED PROCEDURES AND RATES. ASPHALT MULCH BINDER IS UNACCEPTABLE. A SYNTHETIC BINDER IS RECOMMENDED.

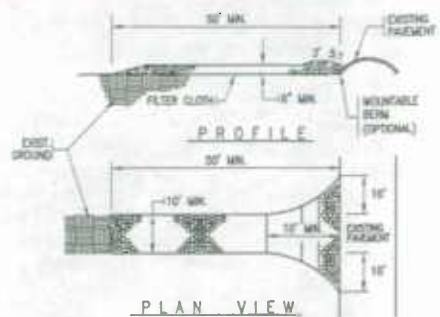

- STONE SIZE - USE 2" STONE, OR RECLAIMED OR RECYCLED EQUIVALENT.
- LENGTH - AS REQUIRED, BUT NOT LESS THAN 50 FEET (EXCEPT ON A SINGLE RESIDENCE LOT WHERE A THIRTY (30) FOOT MINIMUM LENGTH WOULD APPLY).
- THICKNESS - NOT LESS THAN SIX (6) INCHES.
- WIDTH - TEN (10) FOOT MINIMUM, BUT NOT LESS THAN THE FULL WIDTH AT POINTS WHERE INGRESS OR EGRESS OCCURS.
- FILTER CLOTH - WILL BE PLACED OVER THE ENTIRE AREA PRIOR TO PLACING OF STONE.
- SURFACE WATER - ALL SURFACE WATER FLOWING OR DIVERTED TOWARD CONSTRUCTION ENTRANCE SHALL BE PIPED ACROSS THE ENTRANCE. IF PIPING IS IMPRACTICAL, A MOUNTABLE BEAM WITH 5:1 SLOPES WILL BE PERMITTED.
- MAINTENANCE - THE ENTRANCE SHALL BE MAINTAINED IN A CONDITION WHICH WILL PREVENT TRACKING OR FLOWING OF SEDIMENT ONTO PUBLIC RIGHTS-OF-WAY. THIS MAY REQUIRE PERIODIC TOP DRESSING WITH ADDITIONAL STONE AS CONDITIONS DEMAND AND REPAIR AND/OR CLEANOUT OF ANY MEASURES USED TO TRAP SEDIMENT. ALL SEDIMENT SPILLED, DROPPED, WASHED OR TRACKED ONTO PUBLIC RIGHTS-OF-WAY MUST BE REMOVED IMMEDIATELY.
- WASHING - VEHICLE WHEELS SHALL BE CLEANED TO REMOVE SEDIMENT PRIOR TO ENTRANCE ONTO PUBLIC RIGHTS-OF-WAY. WHEN WASHING IS REQUIRED, IT SHALL BE DONE ON AN AREA STABILIZED WITH STONE AND WHICH DRAINS INTO AN APPROVED SEDIMENT TRAPPING DEVICE. 9. PERIODIC INSPECTION AND NEEDED MAINTENANCE SHALL BE PROVIDED AFTER EACH RAIN.

1 STABILIZED CONSTRUCTION ENTRANCE DETAIL
SCALE: N.T.S.

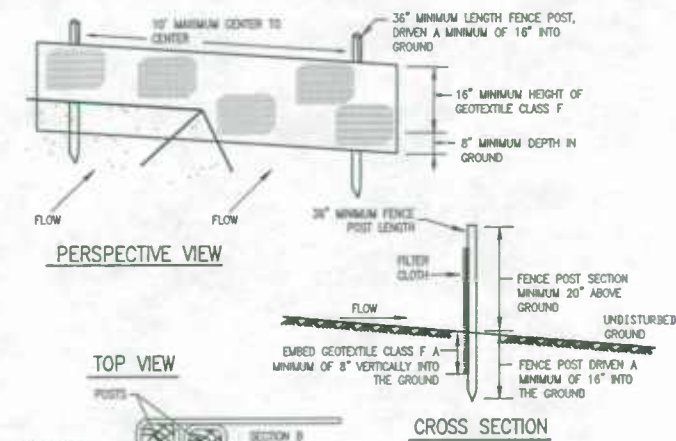

CONSTRUCTION SPECIFICATIONS

- FENCE POSTS SHALL BE A MINIMUM OF 36" LONG DRIVEN 16" MINIMUM INTO THE GROUND. WOOD POSTS SHALL BE 1 1/2" X 1 1/2" SQUARE (MINIMUM) CUT, OR 1 3/4" DIAMETER (MINIMUM) ROUND AND SHALL BE OF SOUND QUALITY HARDWOOD. STEEL POSTS WILL BE STANDARD T OR U SECTION WEIGHING NOT LESS THAN 1.00 POUND PER LINEAR FOOT.
- GEOTEXTILE SHALL BE FASTENED SECURELY TO EACH FENCE POST WITH WIRE TIES OR STAPLES AT TOP AND MID-SECTION AND SHALL MEET THE FOLLOWING REQUIREMENTS:

TENSILE STRENGTH	50 LBS/IN (MIN.)	TEST: MSMT 509
TENSILE MODULUS	20 LBS/IN (MIN.)	TEST: MSMT 509
FLOW RATE	0.3 GAL FT / MINUTE (MAX.)	TEST: MSMT 322
FILTERING EFFICIENCY	75% (MIN.)	TEST: MSMT 322
- WHERE ENDS OF GEOTEXTILE FABRIC COME TOGETHER, THEY SHALL BE OVERLAPPED, FOLDED AND STAPLED TO PREVENT SEDIMENT BYPASS.
- SILT FENCE SHALL BE INSPECTED AFTER EACH RAINFALL EVENT AND MAINTAINED WHEN BULGES OCCUR OR WHEN SEDIMENT ACCUMULATION REACHED 50% OF THE FABRIC HEIGHT.

2 SILT FENCE DETAIL
SCALE: N.T.S. MDE DETAIL 22 (PAGE E-15-3)

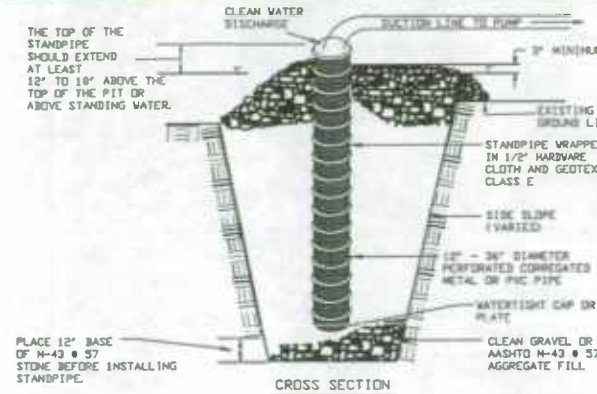

- Pit dimensions are variable, with the minimum diameter being 2 times the standpipe diameter.
- The standpipe should be constructed by perforating a 12" to 24" diameter corrugated or PVC pipe. Then wrapping with 1/2" hardware cloth and Geotextile Class E. The perforations shall be 1/2" x 6" slits or 1" diameter holes.
- A base of filter material consisting of clean gravel or #57 stone should be placed in the pit to a depth of 12". After installing the standpipe, the pit surrounding the standpipe should then be backfilled with the same filter material.
- The standpipe should extend 12" to 18" above the lip of the pit or the riser crest elevation (basin dewatering only) and the filter material should extend 3" minimum above the anticipated standing water elevation.

3 SUMP PIT DEWATERING DEVICE DETAIL
SCALE: N.T.S. MDE DETAIL 20B (PAGE D-13-2)

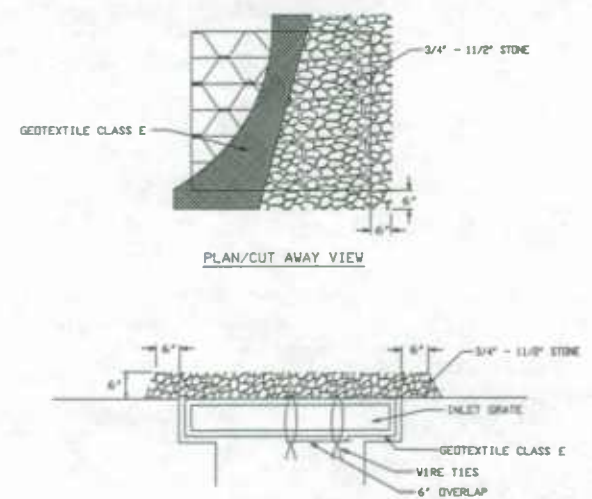

- Lift grate and wrap with Geotextile Class E to completely cover all openings, then set grate back in place.
- Place 3/4" to 1 1/2" stone, 4'-6" thick on the grate to secure the fabric and provide additional filtration.

4 AT GRADE INLET PROTECTION
SCALE: N.T.S. MDE DETAIL 23B (PAGE E-16-5A)

CONSTRUCTION SEQUENCE

- SCHEDULE A PRE-CONSTRUCTION CONFERENCE WITH THE COUNTY ROADS INSPECTOR, COUNTY SWM INSPECTOR, MARYLAND DEPARTMENT OF ENVIRONMENT (410-901-4020), AND THE WICOMICO COUNTY PUBLIC WORKS DEPT. TO OBTAIN A LAND DISTURBING PERMIT. AT THE PRE-CONSTRUCTION CONFERENCE OBTAIN A CERTIFICATE OF COMPLIANCE PRIOR TO MASS CLEARING AND GRUBBING.
- CLEAR AND GRUB SITE ONLY AS NECESSARY FOR INSTALLATION OF EROSION CONTROL MEASURES.
- BEGIN CLEARING AND GRUBBING FOR SITE. MAINTAIN EROSION CONTROL DEVICES AS NEEDED. ROUGH GRADE SITE.
- INSTALL STABILIZED CONSTRUCTION ENTRANCE, SILT FENCE, SEDIMENT BASIN, OR OTHER MEASURES AS SHOWN ON THE APPROVED PLAN. DEWATERING DEVICE TO BE INSTALLED AS SHOWN ON THE APPROVED PLAN.
- BEGIN PARKING LOT CONSTRUCTION.
- STABILIZE SITE AS AREAS ARE BROUGHT UP TO FINISH GRADE WITH VEGETATION. SEED AND MULCH DENuded AREAS WITHIN FIFTEEN (15) DAYS OF COMPLETION OF ANY PHASE OF CONSTRUCTION.
- WHEN CONSTRUCTION IS COMPLETE AND ALL AREAS ARE STABILIZED COMPLETELY, CALL 410-910-4020 FOR AN INSPECTION BY THE MARYLAND DEPARTMENT OF ENVIRONMENT.
- IF SITE IS APPROVED, REMOVE TEMPORARY DIVERSIONS, SILT FENCE, ETC., AND SEED OUT OR STABILIZE ANY RESULTING BARE AREAS. TEMPORARY SEDIMENT BASIN SHALL BE CONVERTED TO A PERMANENT DRY SWALE BY REGRADING AND STABILIZING WITH VEGETATION AND INSTALLING UNDERDRAIN PIPE, CATCH BASIN AND OUTFALL PIPE. DEWATERING DEVICE SHALL BE REMOVED AT THIS TIME.
- WHEN VEGETATION HAS BECOME ESTABLISHED, CALL FOR A FINAL INSPECTION BY THE ENVIRONMENTAL ENGINEER. OBTAIN A CERTIFICATE OF COMPLETION.

PROPOSED GRADING AND EARTH DISTURBANCE

TOTAL SITE: ±3.0 ACRES, ±130,680 SQ. FT.
SURFACE AREA DISTURBED - APPROX. 1.51 ACRES.
DRY SWALE TO ACT AS SEDIMENT BASIN DURING CONSTRUCTION. UPON PROJECT COMPLETION, THE SWALE IS TO BE REGRADED TO PROPOSED ELEVATIONS.

VOLUMES OF SPOIL - IT IS ESTIMATED THAT AN AVERAGE OF 6 TO 8 INCHES OF TOP SOIL WILL BE STRIPPED FROM THE PARKING AREA WITHIN 1 YEAR; THE BALANCE IS PRESENTLY STABILIZED. TOP SOIL WILL BE USED TO ESTABLISH FINAL GRADES.

VOLUME OF BORROW MATERIAL - AS REQUIRED.

THE DOMINANT SOIL TYPES AT THE PROJECT ARE RUNCLINT SAND (Rsb) AND UNDORENTS (Uob). HYDROLOGIC SOIL GROUPS A & B.

MISCELLANEOUS NOTES

THE 100 YEAR FLOOD ZONE AND STATE OR FEDERAL WETLANDS APPLY AT DISCHARGE POINT OF OUTFALL PIPE. FILTER CLOTH TO BE MIRAFL 100X, TYPAR 340I OR EQUIVALENT.
IF DUST CONTROL BECOMES A PROBLEM; USE WATER, OR PELLETTED CALCIUM CHLORIDE TO PREVENT DUST EROSION.
THE GENERAL CONTRACTOR WILL MAINTAIN AND REPAIR ANY EROSION AND SEDIMENT CONTROL DEVICE DAMAGED DURING UTILITY INSTALLATION.

OWNER'S CERTIFICATE: I (WE) THE UNDERSIGNED, DO HEREBY CERTIFY THAT ALL LAND CLEARING, CONSTRUCTION AND DEVELOPMENT SHALL BE DONE PURSUANT TO THIS PLAN AND THAT THE RESPONSIBLE PERSONNEL INVOLVED IN THE CONSTRUCTION PROJECT WILL HAVE A CERTIFICATION OF TRAINING AT A DEPARTMENT APPROVED TRAINING PROGRAM FOR THE CONTROL OF SEDIMENT AND EROSION BEFORE BEGINNING THE PROJECT.

REPRESENTATIVE - TITLE _____ DATE _____
PHONE _____

THE WICOMICO SOIL CONSERVATION DISTRICT APPROVES THIS PLAN FOR SOIL EROSION AND SEDIMENT CONTROL.

WICOMICO SCD _____ DATE _____

REVIEWED FOR THE WICOMICO SOIL CONSERVATION DISTRICT AND MEETS TECHNICAL REQUIREMENTS.

U.S. NATURAL RESOURCES CONSERVATION SERVICE _____ DATE _____

RELEASE BY
04 MAR 08 DRT
15 APR 08 DRT

ENGINEERS/ARCHITECTS
1843 WICOMICO DRIVE SALISBURY, MARYLAND 21801-7824
PH. (410) 742-2288 FAX. (410) 742-0230

AWB ENGINEERS

Wicomico County
Recreation, Parks & Tourism

ESC NOTES & DETAILS
CHERRY BEACH PARK
SHARPTOWN, MARYLAND

DATE PRELIMINARY
SCALE AS SHOWN
DRAWN DRT
PROJ. MGR. DRT
JOB 070802
FILE DRT-1
SHEET SP-3

THE INFORMATION PRESENTED ON THIS PLAN IS PRELIMINARY IN NATURE AND SHOULD NOT TO BE RELIED UPON FOR FINAL PRICING OR CONSTRUCTION. THE USER MUST RECOGNIZE THAT THE INFORMATION PRESENTED ON THIS DRAWING MAY CHANGE AS THE FINAL CONSTRUCTION PLANS ARE DEVELOPED. INCREASED PROJECT COSTS OR DELAYS IN COMPLETION OF THIS PROJECT DUE TO FUTURE DESIGN CHANGES ARE NOT THE RESPONSIBILITY OF AEB ENGINEERS OR ITS SUB-CONTRACTORS.

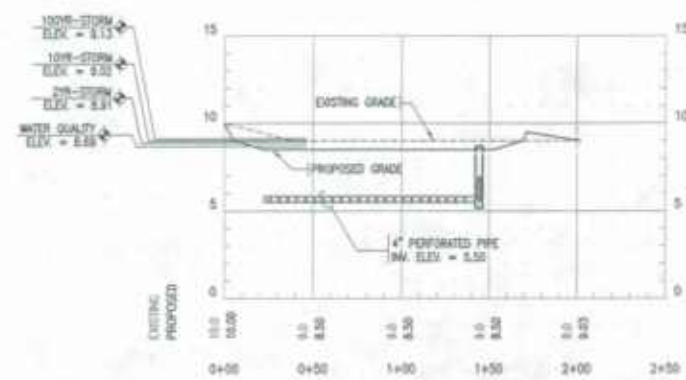

1 DRY SWALE PROFILE
SCALE: 1"=50' (HORIZ.)
1"=5' (VERT.)

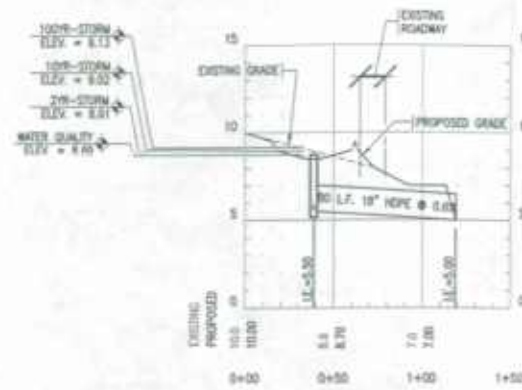

2 DRY SWALE SECTION
SCALE: 1"=50' (HORIZ.)
1"=5' (VERT.)

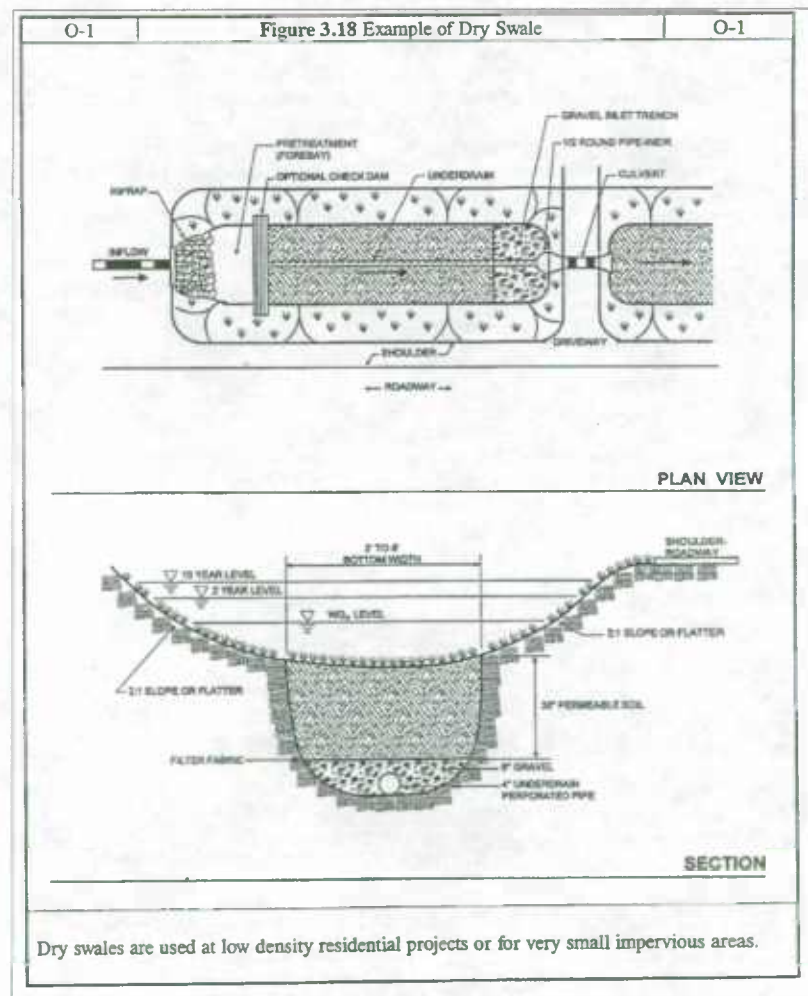

3 MDE DRY SWALE DETAIL
SCALE: NONE

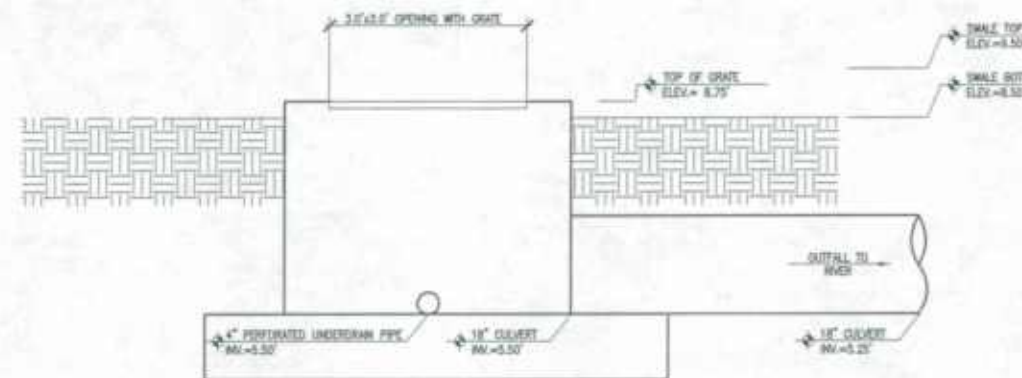

PRE-DEVELOPMENT PEAK FLOW		POST-DEVELOPMENT PEAK FLOW	
2 YEAR	1.02 CFS	2 YEAR	2.49 CFS
10 YEAR	3.44 CFS	10 YEAR	5.50 CFS
100 YEAR	6.66 CFS	100 YEAR	9.02 CFS

4 CATCH BASIN DETAIL
SCALE: 3/4"=1.0'

WICOMICO COUNTY STANDARD CONSTRUCTION NOTES

- WICOMICO COUNTY DEPARTMENT OF PUBLIC WORKS RESERVES THE RIGHT TO ALTER THESE PLANS, DURING THE CONSTRUCTION PHASE, AS FIELD CONDITIONS MAY WARRANT.
- NO OCCUPANCY PERMIT SHALL BE ISSUED UNTIL ALL IMPROVEMENTS (ROADS, DRAINAGE, STORMWATER MANagements, ETC.) HAVE BEEN COMPLETED AND THE AS-BUILT PLANS HAVE BEEN ACCEPTED BY WICOMICO COUNTY DEPARTMENT OF PUBLIC WORKS.
- WICOMICO COUNTY DEPARTMENT OF PUBLIC WORKS SHALL BE NOTIFIED AT LEAST 48 HOURS PRIOR TO THE START OF CONSTRUCTION OF THE STORMWATER MANAGEMENT FACILITIES.
- APPROVAL OF THESE PLANS BY WICOMICO COUNTY DEPARTMENT OF PUBLIC WORKS IS NOT A REPRESENTATION, GUARANTEE OR WARRANTY OF ANY KIND AND SHALL CREATE NO LIABILITY UPON THE COUNTY, ITS OFFICIALS OR EMPLOYEES.
- AN "AS-BUILT" PLAN SHALL BE PROVIDED TO THE WICOMICO COUNTY DEPARTMENT OF PUBLIC WORKS WITHIN THIRTY (30) DAYS AFTER COMPLETION OF CONSTRUCTION.
- AN ENTRANCE PERMIT SHALL BE OBTAINED FROM THE WICOMICO COUNTY ROADS DIVISION PRIOR TO CONSTRUCTION OF AN ENTRANCE ONTO A COUNTY MAINTAINED ROAD.
- ALL UNDERGROUND UTILITIES SHALL BE INSTALLED PRIOR TO STABILIZATION OF THE ROADWAY.
- SHOULD PRECAST STRUCTURES BE USED, THEN SHOP DRAWINGS SHALL BE APPROVED BY THE WICOMICO COUNTY DEPARTMENT OF PUBLIC WORKS PRIOR TO THEIR INSTALLATION.
- THE CONTRACTOR SHALL DESIGNATE AND SUBMIT TO THE COUNTY THE NAME OF THE PERSON DESIGNATED AS THE TRAFFIC MANAGER FOR THIS PROJECT PRIOR TO CONSTRUCTION. ALL SIGNS, ARROW BOARDS, BARRICADES, LIGHTS, FLAGMEN, ETC. NEEDED FOR MAINTENANCE OF TRAFFIC SHALL BE FURNISHED BY THE CONTRACTOR. ALL TRAFFIC CONTROL DEVICES SHALL BE PROPERLY MAINTAINED TO INSURE THAT THE GENERAL PUBLIC'S SAFETY IS NEVER JEOPARDIZED. ALL TRAFFIC CONTROL DEVICES ARE TO CONFORM AND ADHERE TO THOSE SPECIFIED AND SET FORTH IN THE MARYLAND DEPARTMENT OF TRANSPORTATION "NEW WORK ZONE TRAFFIC CONTROL" AND/OR "MANUAL ON UNIFORM TRAFFIC CONTROL DEVICES FOR STREETS AND HIGHWAYS." THE CONTRACTOR WILL BE RESPONSIBLE FOR NOTIFICATION TO ALL PROPERTIES OR BUSINESSES DIRECTLY AFFECTED BY DETOURS OR CHANGES IN TRAFFIC PATTERNS BEFORE BEGINNING OF CONSTRUCTION AND AS DETERMINED BY WICOMICO COUNTY.

I HEREBY CERTIFY THAT THIS PLAN HAS BEEN PREPARED UNDER MY SUPERVISION AND IN ACCORDANCE WITH THE MANUAL ON UNIFORM TRAFFIC CONTROL DEVICES FOR STREETS AND HIGHWAYS FOR MARYLAND REQUIREMENTS, LATEST EDITION. I FURTHER CERTIFY THAT THE PLAN FEATURES THE MINIMUM AMOUNT OF TRAFFIC DISRUPTION FOR THE SHORTEST PERIOD OF TIME NECESSARY TO COMPLETE THE WORK IN AND ALONG THE PUBLIC ROADWAY WHILE GUARANTEEING THE SAFETY OF THE GENERAL PUBLIC.

REPRESENTATIVE - TITLE _____ DATE _____

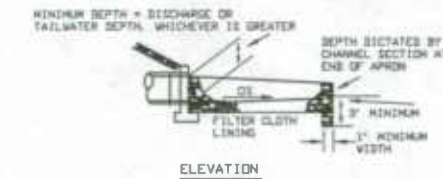

NOTE: FILTER CLOTH MUST EXTEND A MINIMUM OF 6" BEYOND APRON AND SIDES



NOTE: FILTER CLOTH SHALL BE GEOTEXTILE CLASS C

5 ROCK OUTLET PROTECTION
SCALE: N.T.S. MDE DETAIL 25 (PAGE F-18-B)

RELEASE BY
04 MAR 08 DRT
15 APR 08 DRT

COPYRIGHT © 2006, ANDREW W. BOOTH & ASSOCIATES, INC.

ENGINEERS/ARCHITECTS
1942 BROADWAY DRIVE (Baltimore Office) BALTIMORE, MARYLAND 21201-1004
PH: (410) 751-2200 FAX: (410) 751-0222

AWB ENGINEERS

Wicomico County
Recreation, Parks & Tourism

PROFILES, SECTIONS & NOTES
CHERRY BEACH PARK
SHARPTOWN, MARYLAND

DATE: PRELIMINARY
SCALE: AS SHOWN
DRAWN: DRT
PROJ. MGR: DRT
JOB: 070802
FILE: DRT-1
SHEET: SP-4

THE INFORMATION PRESENTED ON THIS PLAN IS PRELIMINARY IN NATURE AND SHOULD NOT BE RELIED UPON FOR FINAL PRICING OR CONSTRUCTION. THE USER MUST RECOGNIZE THAT THE INFORMATION PRESENTED ON THIS DRAWING MAY CHANGE AS THE FINAL CONSTRUCTION PLANS ARE DEVELOPED. INCREASED PROJECT COSTS OR DELAYS IN DECISION OF THIS PROJECT DUE TO FUTURE DESIGN CHANGES ARE NOT THE RESPONSIBILITY OF AWB ENGINEERS OR ITS SUB-CONTRACTORS.

