

PA 302-07 Manokin Park Fiber Optic
Site Plan Conduit

51829-6667

Martin O'Malley
Governor

Anthony G. Brown
Lt. Governor



Margaret G. McHale
Chairman

Ren Serey
Executive Director

**STATE OF MARYLAND
CRITICAL AREA COMMISSION
CHESAPEAKE AND ATLANTIC COASTAL BAYS**

1804 West Street, Suite 100, Annapolis, Maryland 21401
(410) 260-3460 Fax: (410) 974-5338
www.dnr.state.md.us/criticalarea/

June 5, 2007

Mr. Keith Lackie
Maryland Department of Planning
Lower Eastern Shore Regional Office
Salisbury Multi-Service Center
201 Baptist Street, Suite 24
Salisbury, MD 21801-4974

Re: Fiber Optic Conduit through Manokin Park

Dear Mr. Lackie,

Thank you for forwarding the above-referenced project to this office per the requirements of COMAR 27.02.02 - State and Local Agency Actions Resulting in Development of Local Significance on Private Lands or Lands Owned by Local Jurisdictions. The applicant indicates that the conduit will pass through the multiple parcels, each of which is located in either a Limited Development Area (LDA) or Resource Conservation Area (RCA). Additionally, several of the parcels have a portion that is a Buffer Exempt Area (BEA). These parcels have the following designation (Tax Map 202): 154 (LDA/BEA), 132 (LDA/BEA), 157 (LDA), 122 (LDA/BEA), 131 (RCA/LDA), 156 (LDA), and 155 (LDA/BEA). After reviewing your consistency determination and the accompanying site plan, this office agrees that the project is consistent with the Princess Anne Critical Area Program for the reasons outlined below.

The project will result in the following:

- The installation of the fiber optic lines will be temporary (1-3 days) and at the daily end of construction, no soil will be exposed or unseeded.
- No additional impervious surfaces will be created.
- No trees or natural vegetation will be removed for construction.
- Any requested staging areas will not be located within the 100-foot Buffer and will not necessitate the need for clearing of natural vegetation or trees.

Mr. Keith Lackie

6/5/2007

Page 2 of 2

- There will be 600 square feet or less of temporary disturbance for the entire project. The area of disturbance in the Buffer is significantly more limited.
- While portions of the conduit will be within the 100-foot Buffer, the Code of Maryland Regulations Title 27.01.02.04(1)(b) permits utilities within the Buffer where no feasible alternative exists.
- Due to the width (3") of the fiber optic being laid and because it is only temporary disturbance, no mitigation is required for this particular utility project.

Since the project is consistent with the local program, it will not require formal approval by the Chesapeake Bay Critical Area Commission, notwithstanding any other required resource agency approvals.

Thank you again for your cooperation and assistance with reviewing this project. Please call me if you have any questions at (410) 260-3476.

Sincerely,

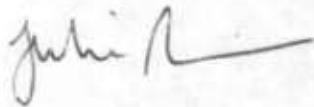
A handwritten signature in cursive script, appearing to read "Julie Roberts", written in black ink.

Julie Roberts
Natural Resources Planner

Cc: PA 302-07

Consistency Report for Local Government Projects

Project Name: Fiber Optic Conduit Through Manokin Park (ADESTA)
Project Description: Installation of approximately 2,400 linear feet of "144 count" fiber optic line (1 ¼ inch conduit) traversing Town of Princess Anne Right of Way and Town Park. Fiber Optic Line to be installed by both directional boar and 3" wide plow width (trench). No existing trees or shrubs shall be removed. Trench will be immediately filled in and planted in grass seed.
Local Agency proposing project: Town of Princess Anne
Contact Name and Phone Number: Keith Lackie, MDP Circuit Rider
Project Location (include street address, tax map and parcel number): Tax Map 202, Parcels 154, 132, 157, 122, 131, 156 and 155.
Critical Area acreage: Trench and Boar, undetermined acreage, however, approximately 600 square feet (or less) disturbed.

Project Data	
Existing forest/woodland/trees:	N/A % of site: N/A
Proposed clearing:	None % of existing forest: 0%
Mitigation to be provided: None Proposed, temporary disturbance of less than 600 sq. ft.	
Planting location & species (also show on site plan): N/A	
Existing impervious surface:	N/A % of site: N/A
Proposed new impervious: None	
Total impervious surface:	N/A % of site: N/A
If the % of impervious cover exceeds the permitted amount in the LDA or RCA, the project may need a Conditional Approval from the Critical Area Commission. Please contact your Commission planner for assistance.	
Total Area Disturbed: Less than 600 square feet temp. disturbed to be replanted in grass seed	
Stormwater Management: (If site is in the IDA, the 10% worksheets must be attached. Otherwise, local stormwater requirements must be addressed.) N/A	
Has project received local approval of SWM and sediment and erosion control plans? N/A	
Buffer impacts? dependent? No	Yes, Utility Permitted Is project water
If there are Buffer impacts proposed and the project is not water dependent, the project may need a Conditional Approval from the Critical Area Commission. Please contact your Commission planner for assistance.	
Other Habitat Protection Areas: None	

Colonial Nesting Waterbird site? Yes <input type="checkbox"/> No <input checked="" type="checkbox"/>	Waterfowl Staging Area? Yes <input type="checkbox"/> No <input checked="" type="checkbox"/>
Endangered / threatened species? Yes <input type="checkbox"/> No <input checked="" type="checkbox"/>	Forest Interior Dwelling Bird Habitat? Yes <input type="checkbox"/> No <input checked="" type="checkbox"/>
Anadromous Fish Propagation Waters? Yes <input type="checkbox"/> No <input checked="" type="checkbox"/>	
Non-tidal Wetland Impacts? Yes <input type="checkbox"/> No <input checked="" type="checkbox"/> If yes, MDE permit #:	
Tidal Wetland Impacts? Yes <input type="checkbox"/> No <input checked="" type="checkbox"/> If yes, MDE permit #:	

Attach the site plan to this report and submit to the Critical Area Commission at 1804 West St., Suite 100, Annapolis, MD 21401

302-07



Town of Princess Anne
30489 Broad Street
Princess Anne, Maryland 21853
410-651-1818

Commissioners
Frank White, President
Garland Hayward, Vice President
Steve Golston
Tanitta Thomas
Dennis Williams

Winslow "Jay" Parker
Town Manager

May 7, 2007

Mr. Keith Lackie
Maryland Department of Planning
Lower Eastern Shore Regional Office
Salisbury Multi-Service Center
201 Baptist Street, Suite 24
Salisbury, Maryland 21801-4974

RE: Fiber Optic Conduit Thru Manokin Park

Keith:

The attached site plan is for the proposed plowing of a fiber optic conduit thru Manokin Park. The conduit will pass thru the following parcels (all parcels are located within Tax Map 202): 154, 132, 157, 122, 131, 156, and 155. The entire site is flagged if you would like to see it. They are not proposing the removal of any trees; any sensitive areas will be bored as indicated on site plan.

Please review and advise.

Sincerely,

Tracy Grangier
Code Compliance Director

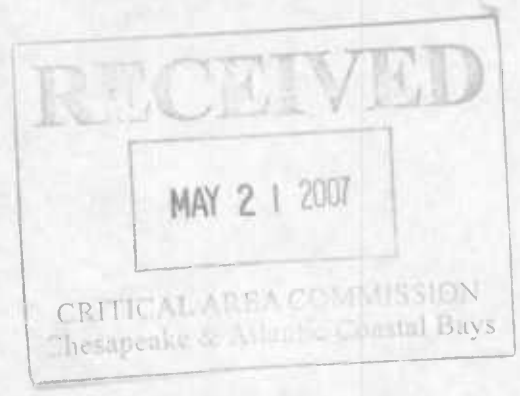

RECEIVED
MD. DEPARTMENT OF PLANNING

MAY 7 2007

LOWER EASTERN SHORE OFFICE

CONSTRUCTION NOTES:

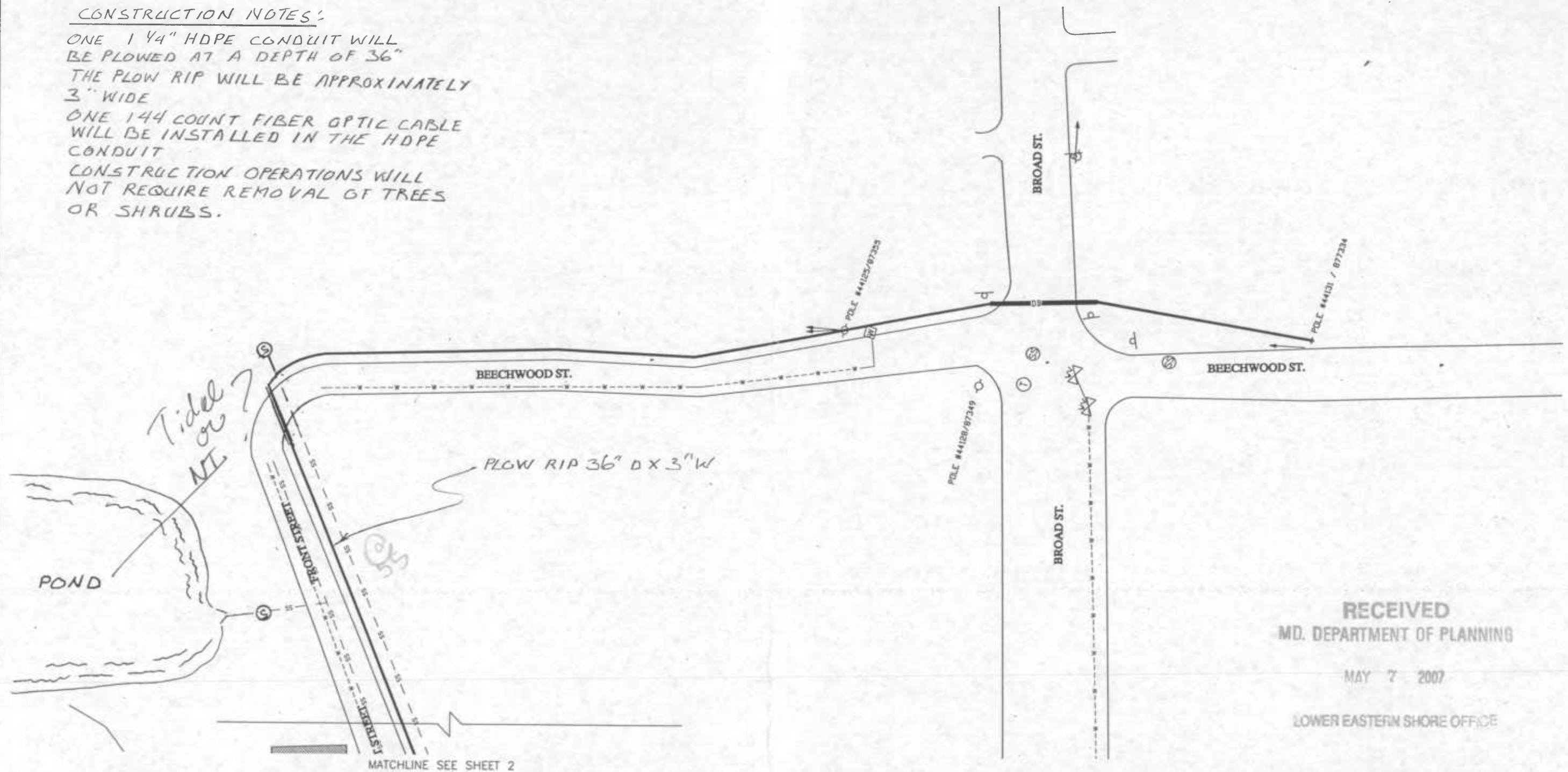

ONE 1 1/4" HDPE CONDUIT WILL BE PLOWED AT A DEPTH OF 36"
 THE PLOW RIP WILL BE APPROXIMATELY 3" WIDE
 ONE 144 COUNT FIBER OPTIC CABLE WILL BE INSTALLED IN THE HDPE CONDUIT
 CONSTRUCTION OPERATIONS WILL NOT REQUIRE REMOVAL OF TREES OR SHRUBS.



RECEIVED
 MD. DEPARTMENT OF PLANNING
 MAY 7 2007
 LOWER EASTERN SHORE OFFICE

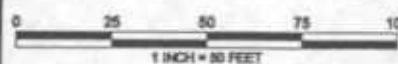

ADESTA
 910 Oak Tree Road, Suite L
 South Plainfield, N.J. 07080
 Phone: 908-756-1181
 Fax: 908-756-1182

SCALE:



DATE:	5/03/07
DESIGNED:	MB
DRAWN:	EA
CHECKED:	CK
QA/QC:	-

REVISIONS		
DATE	DESCRIPTION	INITIALS



Maryland Broadband Cooperative
 Backbone Initiative
 Proposed Fiber-Optic Line

UNDERGROUND UTILITIES HAVE BEEN PLOTTED FROM AVAILABLE RECORDS AND FIELD OBSERVATIONS BUT ARE NOT NECESSARILY EXACT. IT IS THE CONTRACTOR'S RESPONSIBILITY TO FIELD LOCATE ALL UNDERGROUND OBSTRUCTIONS AND UTILITIES PRIOR TO CONSTRUCTION. COMPLETE REPAIR OF ANY AND ALL DAMAGES INCURRED SHALL BE AT THE EXPENSE OF THE CONTRACTOR.



1-800-257-7777
 CALL BEFORE YOU DIG
 72 HOURS NOTICE REQUIRED

DOCUMENT NO. 105219-003-A
MARYLAND PERMITTING
SHEET NO. 1 OF 5

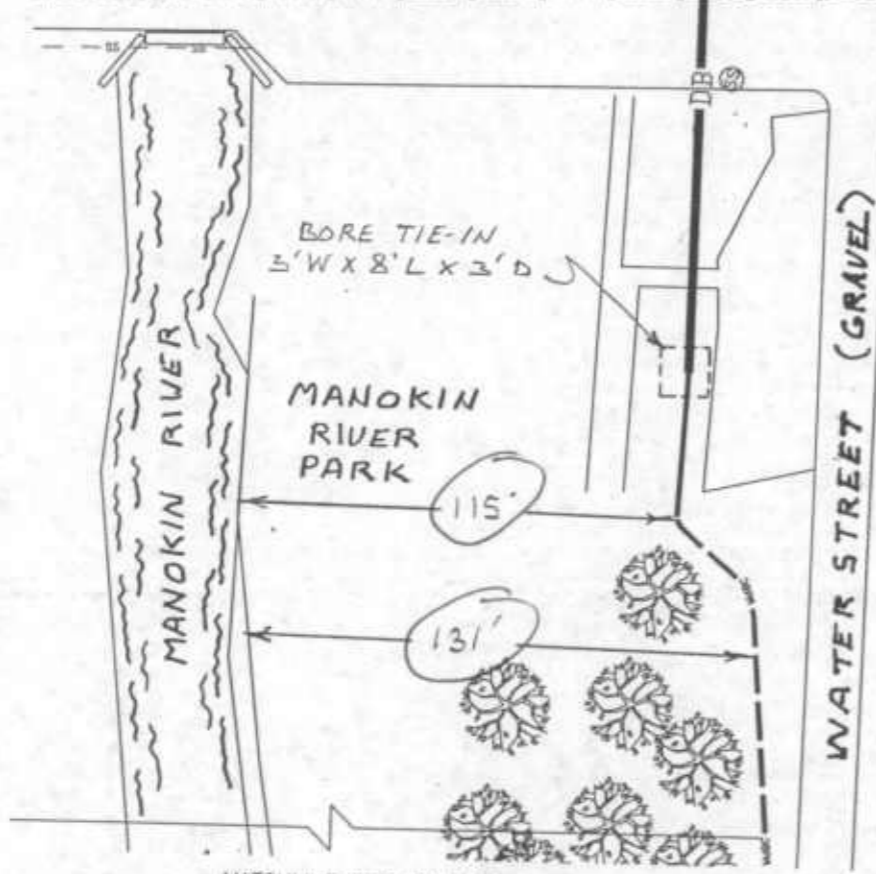
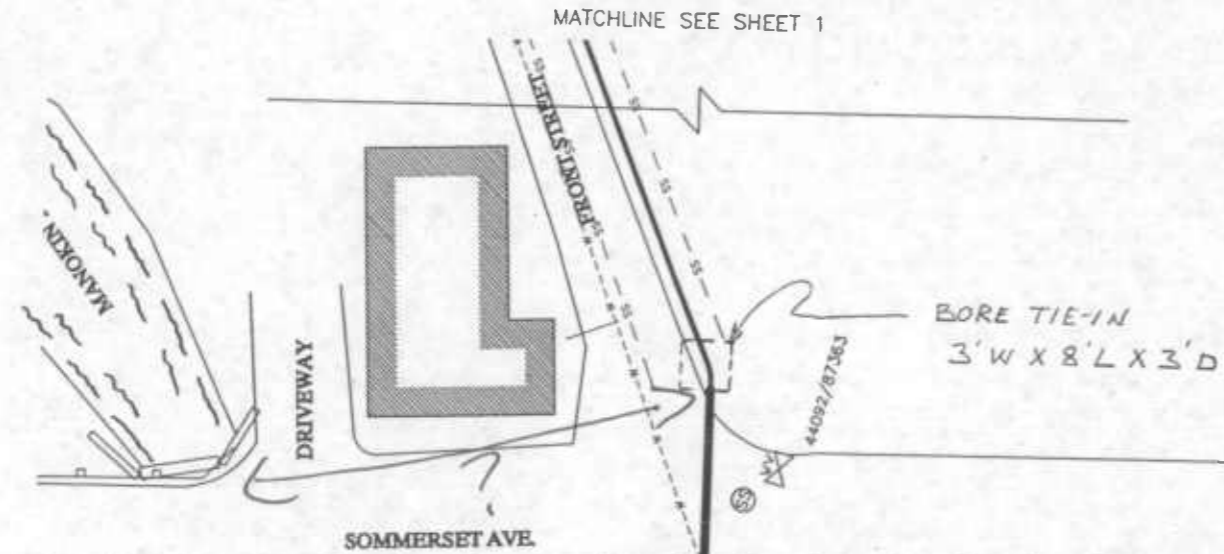

CONSTRUCTION NOTES:
 ONE 1 1/4" HDPE CONDUIT WILL BE PLOWED AT A DEPTH OF 36". THE PLOW RIP WILL BE APPROXIMATELY 3" WIDE. ONE 144 COUNT FIBER OPTIC CABLE WILL BE INSTALLED IN THE HDPE CONDUIT.
 CONSTRUCTION OPERATIONS WILL NOT REQUIRE REMOVAL OF TREES OR SHRUBS

BROAD ST.
 BROAD ST.

RECEIVED
 MD. DEPARTMENT OF PLANNING
 MAY 7 2007
 LOWER EASTERN SHORE OFFICE

MATCHLINE SEE SHEET 35B

MATCHLINE SEE SHEET 3



ADESTA

910 Oak Tree Road, Suite L
 South Plainfield, N.J. 07080
 Phone: 908-756-1181
 Fax: 908-756-1182



DATE:	5/03/07
DESIGNED:	MB
DRAWN:	EA
CHECKED:	CK
QA / QC:	

REVISIONS		
DATE	DESCRIPTION	INITIALS



Maryland Broadband Cooperative
 Backbone Initiative
 Proposed Fiber-Optic Line

UNDERGROUND UTILITIES HAVE BEEN PLOTTED FROM AVAILABLE RECORDS AND FIELD OBSERVATIONS BUT ARE NOT NECESSARILY EXACT. IT IS THE CONTRACTORS RESPONSIBILITY TO FIELD LOCATE ALL UNDERGROUND OBSTRUCTIONS AND UTILITIES PRIOR TO CONSTRUCTION. COMPLETE REPAIR OF ANY AND ALL DAMAGES INCURRED SHALL BE AT THE EXPENSE OF THE CONTRACTOR.



1-800-257-7777
 CALL BEFORE YOU DIG
 72 HOURS NOTICE REQUIRED

DOCUMENT NO. 105219-003-A
MARYLAND PERMITTING
SHEET NO. 2 OF 5

MATCHLINE SEE SHEET 2

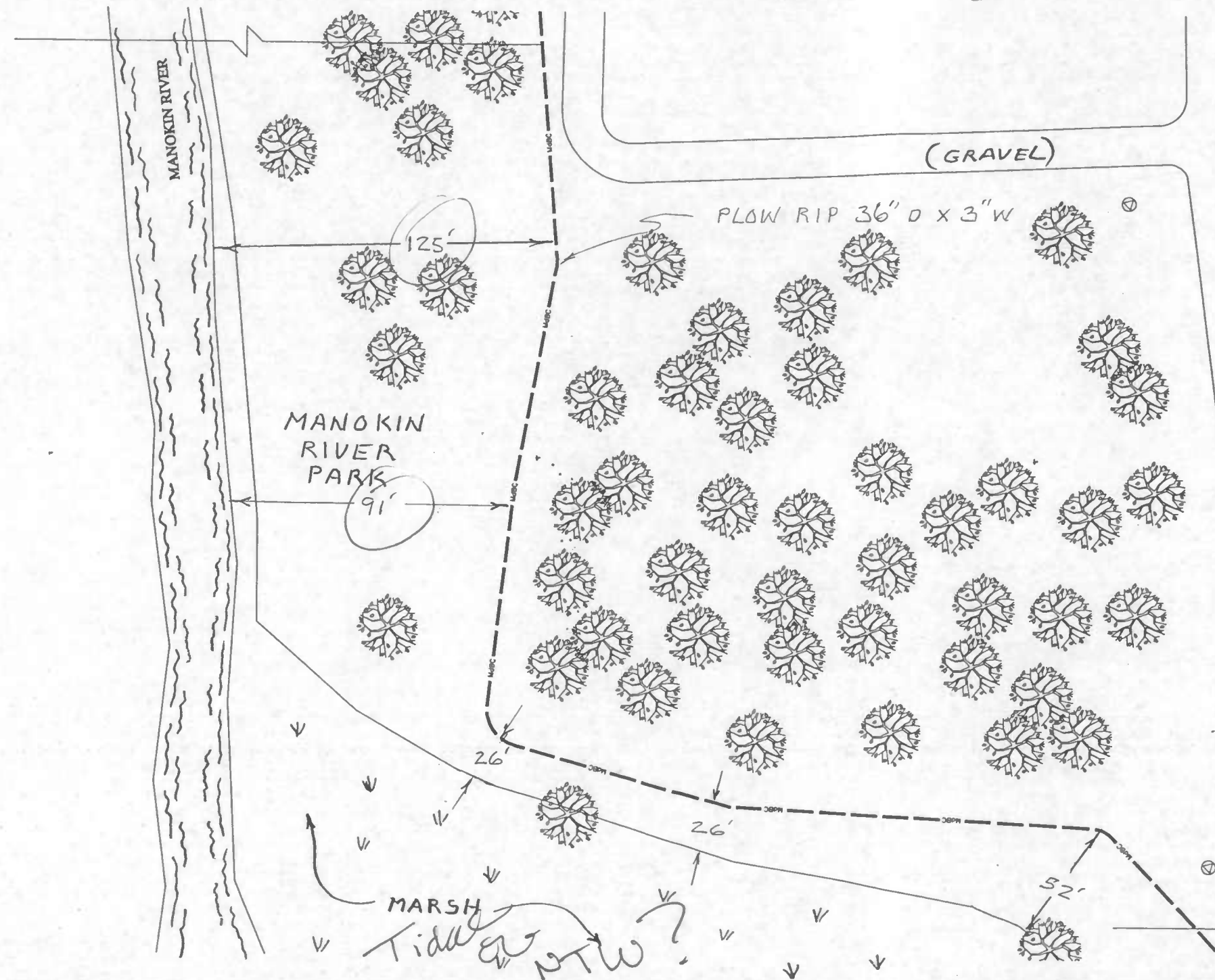

CHURCH ST.

BROAD ST.

BECKFORD AVE.

CONSTRUCTION NOTES:
 ONE 1 1/4" HDPE CONDUIT WILL BE PLOWED AT A DEPTH OF 36"
 THE PLOW RIP WILL BE APPROXIMATELY 3" WIDE
 ONE 144 COUNT FIBEROPTIC CABLE WILL BE INSTALLED IN THE HDPE CONDUIT.
 CONSTRUCTION OPERATIONS WILL NOT REQUIRE REMOVAL OF TREES OR SHRUBS.

RECEIVED
 MD. DEPARTMENT OF PLANNING
 MAY 7 2007
 LOWER EASTERN SHORE OFFICE

MATCHLINE SEE SHEET 4

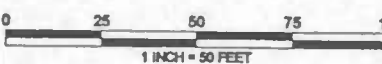

ADESTA
 910 Oak Tree Road, Suite L
 South Plainfield, N.J. 07080
 Phone: 908-756-1181
 Fax: 908-756-1182

SCALE:

 1 INCH = 50 FEET



DATE:	5/03/07
DESIGNED:	MB
DRAWN:	EA
CHECKED:	CK
QA / QC:	-

REVISIONS		
DATE	DESCRIPTION	INITIALS
	RECEIVED	
MAY 21 2007		
	CRITICAL AREA COMM	
	Chesapeake & Atlantic Coast	



Maryland Broadband Cooperative
 Backbone Initiative
 Proposed Fiber-Optic Line

UNDERGROUND UTILITIES HAVE BEEN PLOTTED FROM AVAILABLE RECORDS AND FIELD OBSERVATIONS BUT ARE NOT NECESSARILY EXACT. IT IS THE CONTRACTORS RESPONSIBILITY TO FIELD LOCATE ALL UNDERGROUND OBSTRUCTIONS AND UTILITIES PRIOR TO CONSTRUCTION. COMPLETE REPAIR OF ANY AND ALL DAMAGES INCURRED SHALL BE AT THE EXPENSE OF THE CONTRACTOR.



1-800-257-7777
 CALL BEFORE YOU DIG
 72 HOURS NOTICE REQUIRED

DOCUMENT NO. 106219-003-A
MARYLAND PERMITTING
SHEET NO. 3 OF 5

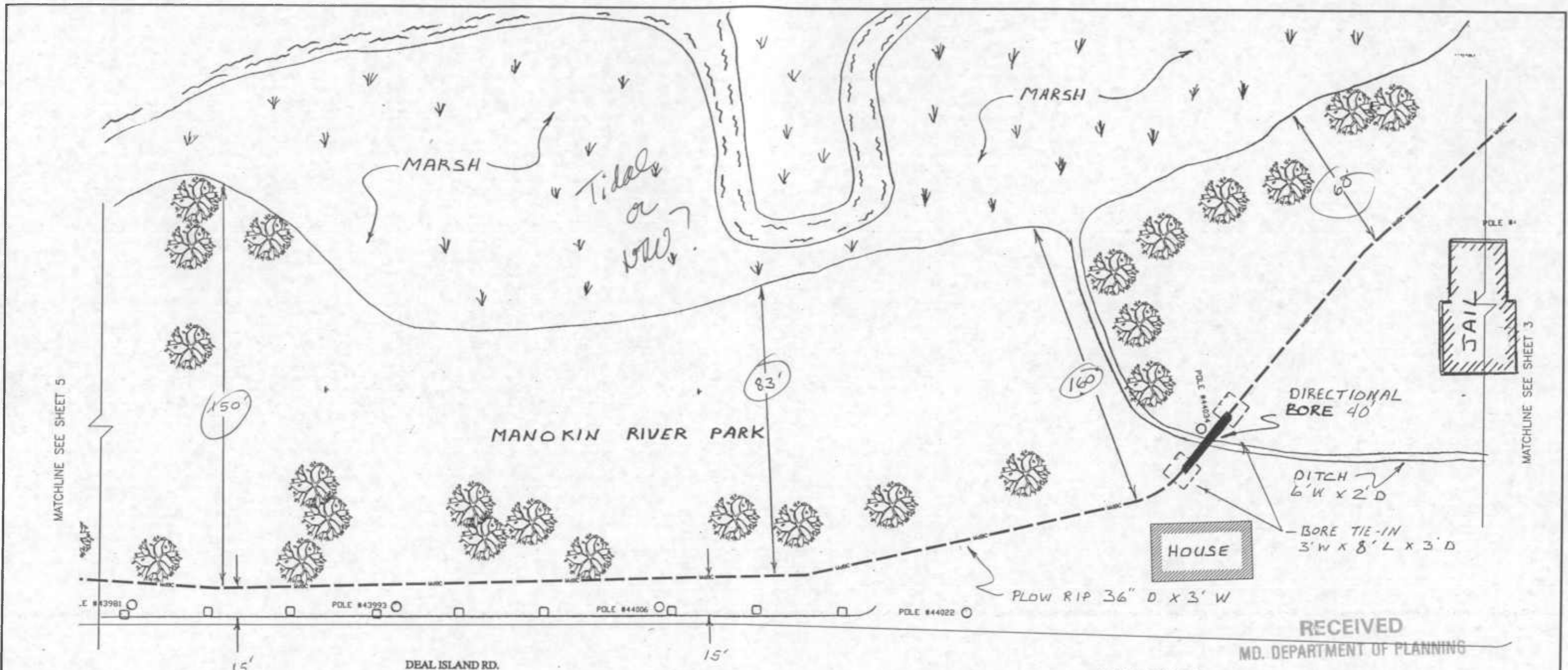



CONSTRUCTION NOTES:

ONE 1 1/4" HDPE CONDUIT WILL BE PLOWED AT A DEPTH OF 36" THE PLOW RIP WILL BE APPROXIMATELY 3" WIDE
 ONE 144 CORE FIBER OPTIC CABLE WILL BE INSTALLED IN THE HDPE CONDUIT
 CONSTRUCTION OPERATIONS WILL NOT REQUIRE REMOVAL OF TREES OR SHRUBS

RECEIVED
 MD. DEPARTMENT OF PLANNING
 MAY 7 2007
 LOWER EASTERN SHORE OFFICE

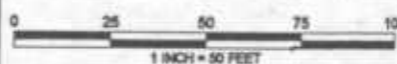

ADESTA
 910 Oak Tree Road, Suite L
 South Plainfield, N.J. 07080
 Phone: 908-756-1181
 Fax: 908-756-1182

SCALE:



DATE:	5/03/07
DESIGNED:	MB
DRAWN:	EA
CHECKED:	CK
QA/QC:	-

REVISIONS		
DATE	DESCRIPTION	INITIALS



Maryland Broadband Cooperative
 Backbone Initiative
 Proposed Fiber-Optic Line

UNDERGROUND UTILITIES HAVE BEEN PLOTTED FROM AVAILABLE RECORDS AND FIELD OBSERVATIONS BUT ARE NOT NECESSARILY EXACT. IT IS THE CONTRACTOR'S RESPONSIBILITY TO FIELD LOCATE ALL UNDERGROUND OBSTRUCTIONS AND UTILITIES PRIOR TO CONSTRUCTION. COMPLETE REPAIR OF ANY AND ALL DAMAGES INCURRED SHALL BE AT THE EXPENSE OF THE CONTRACTOR.



1-800-257-7777
 CALL BEFORE YOU DIG
 72 HOURS NOTICE REQUIRED

DOCUMENT NO. 105219-003-A
MARYLAND PERMITTING
SHEET NO. 4 OF 5

MATCHLINE SEE SHEET 4

CONSTRUCTION NOTES:

ONE 1 1/4" HDPE CONDUIT WILL BE PLOWED AT A DEPTH OF 36" THE PLOW RIP, WILL BE APPROXIMATELY 3" WIDE.
 ONE 144 COUNT FIBER OPTIC CABLE WILL BE INSTALLED IN THE HDPE CONDUIT.
 CONSTRUCTION OPERATIONS WILL NOT REQUIRE REMOVAL OF TREES OR SHRUBS

DEAL ISLAND RD.

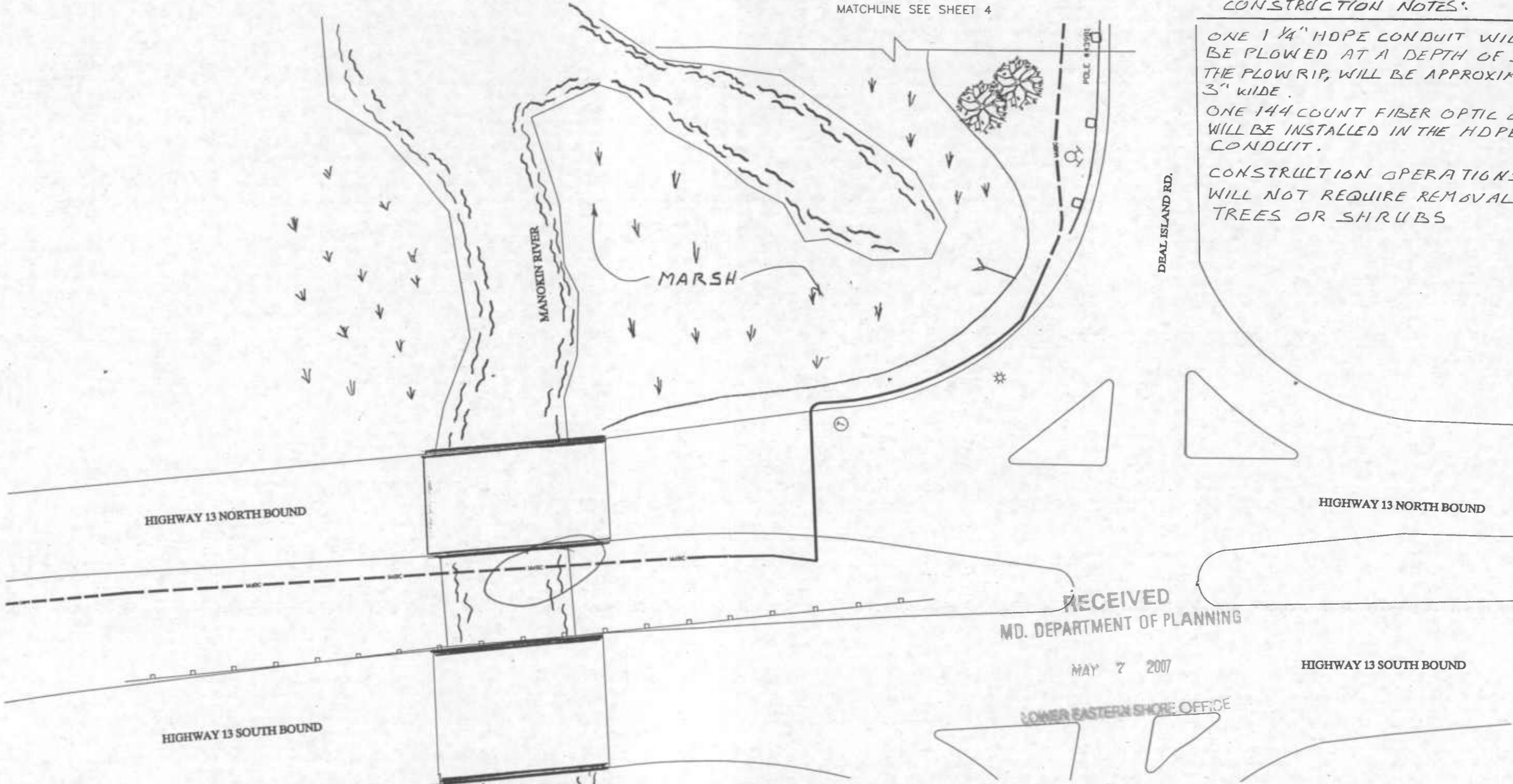

RECEIVED
 MD. DEPARTMENT OF PLANNING

MAY 7 2007

LOWER EASTERN SHORE OFFICE

ADESTA
 910 Oak Tree Road, Suite L
 South Plainfield, N.J. 07080
 Phone: 908-756-1181
 Fax: 908-756-1182

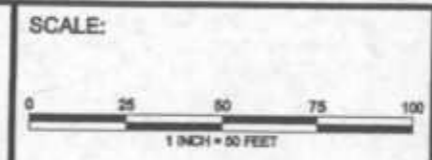

DATE:	5/03/07
DESIGNED:	MB
DRAWN:	EA
CHECKED:	CK
QA / QC:	-

REVISIONS		
DATE	DESCRIPTION	INITIALS



Maryland Broadband Cooperative
 Backbone Initiative
 Proposed Fiber-Optic Line

UNDERGROUND UTILITIES HAVE BEEN PLOTTED FROM AVAILABLE RECORDS AND FIELD OBSERVATIONS BUT ARE NOT NECESSARILY EXACT. IT IS THE CONTRACTOR'S RESPONSIBILITY TO FIELD LOCATE ALL UNDERGROUND OBSTRUCTIONS AND UTILITIES PRIOR TO CONSTRUCTION. COMPLETE REPAIR OF ANY AND ALL DAMAGES INCURRED SHALL BE AT THE EXPENSE OF THE CONTRACTOR.



1-800-257-7777
 CALL BEFORE YOU DIG
 72 HOURS NOTICE REQUIRED

DOCUMENT NO. 105219-003-A
MARYLAND PERMITTING
SHEET NO. 5 OF 5