

AN 233-07 Truxton Park Boat Launch
Site Plan Facility

51829-640

Martin O'Malley
Governor

Anthony G. Brown
Lt. Governor



Margaret G. McHale
Chair

Ren Serey
Executive Director

STATE OF MARYLAND
CRITICAL AREA COMMISSION
CHESAPEAKE AND ATLANTIC COASTAL BAYS

1804 West Street, Suite 100, Annapolis, Maryland 21401
(410) 260-3460 Fax: (410) 974-5338
www.dnr.state.md.us/criticalarea/

January 22, 2009

Ms. Sally Nash
City of Annapolis
Department of Planning and Zoning
145 Gorman Street
Annapolis, Maryland 21401

Re: Truxtun Park Boat Ramp Redevelopment
Consistency Report

Dear Ms. Nash:

Thank you for forwarding the above-referenced project to this office per the requirements of COMAR 27.02.02 - State and Local Agency Actions Resulting in Development of Local Significance on Private Lands or Lands Owned by Local Jurisdictions. The City of Annapolis Recreation and Parks Department is proposing to renovate the public boating facilities at Truxtun Park along the shoreline of Spa Creek which includes removing and replacing the existing timber dock, two concrete boat ramps, and two piers. Improvements will also be made to the existing parking area and two new handicap accessible parking spaces will be constructed. The 32 acre property is within the Critical Area and is designated as a Resource Conservation Area (RCA). In conjunction with the proposed project, the City will provide Buffer plantings in the amount of 67 shrubs and five trees to address the new disturbance in the Buffer for providing public waterfront access.

We concur that the proposed project is consistent with the City of Annapolis' Critical Area Program and will therefore require no further Commission review or action.

We appreciate the opportunity to provide comments on this development proposal. If you have any questions, please contact me at 410-260-3481.

Sincerely,

A handwritten signature in dark ink, appearing to read "Amber Widmayer".

Amber Widmayer
Natural Resources Planner

cc: AN 233-07





STATE OF MARYLAND
CRITICAL AREA COMMISSION
CHESAPEAKE AND ATLANTIC COASTAL BAYS

1804 West Street, Suite 100, Annapolis, Maryland 21401
(410) 260-3460 Fax: (410) 974-5338
www.dnr.state.md.us/criticalarea/

April 23, 2007

Ms. Carla Fleming
Federal Project Coordinator
Maryland Department of Natural Resources
Tawes State Office Building
580 Taylor Avenue, Annapolis, MD 21401

Re: Truxton Park Boating Access Facility Improvements

Dear Ms. Fleming:

Thank you for providing information on the above referenced clearinghouse project. I have reviewed the materials forwarded to my attention. While the details provided are not extensive enough to offer project specific comments at this time, please consider the following:

It appears that the proposed project, while funded in part by the Department of Natural Resources (DNR) and the US Fish and Wildlife Service (FWS), is proposed on a property owned by the City of Annapolis. As such, the project qualifies under COMAR 27.01.02 or COMAR 27.02.04 as a Local Agency Action Resulting in either Development of Local Significance or Major Development on Lands Owned by Local Jurisdictions. These provisions within the Criteria require the City to submit detailed site plans to Commission staff for review and approval prior to the initiation of any construction activities, including grading. Should the project be deemed to be of local significance, the City would be required to submit a consistency report for review by Commission staff. Alternatively, the project could potentially be classified as major development. In this case, the City would need to obtain formal Commission approval. It is not possible to determine the extent and scope of the project and whether the project will qualify as locally significant or as major development at this time. A full site plan submission will be necessary in order to make this determination.

The information received states that the proposed project improvements are intended to begin in June of 2007. Please keep in mind that an in-house review by Commission staff generally takes 30 days to complete. Should the project require formal Commission approval, the Commission meets on the first Wednesday of each month. All projects for full Commission approval must be submitted to staff and must be 100% complete in their submission 30 days prior to the next Commission meeting in order to be scheduled for a vote. I would be happy to further discuss project submission or procedural requirements with you at any time.

Carla Fleming
April 23, 2007
Page 2

Thank you for the opportunity to provide comments for this clearinghouse review. I recommend that the City begin coordination with Commission staff as soon as possible in order to assure that the proper approvals can be obtained within the timeframe desired by the applicants. If you have any questions, please contact me at 410-260-3482.

Sincerely,



Kerrie L. Gallo
Natural Resource Planner

CC: Sally Nash, City of Annapolis
John Wilson, DNR

Consistency Report for Local Government Projects

Project Name: Truxtun Park Public Boating Facilities Improvement	Jurisdiction: City of Annapolis
Project Description: The City of Annapolis is proposing to renovate the public boating facilities at Truxtun Park along the shoreline of Spa Creek. The City is proposing to remove and replace the timber dock, two concrete boat ramps, and two piers, and make associated parking lot improvements.	
Local Agency proposing project: City of Annapolis, Department of Planning and Zoning	
Contact Name and Phone Number: Sally Nash, 410.263.7961	
Project Location (include street address, tax map and parcel number): Primrose Avenue, Map 0051F, Parcel 2230	
Critical Area acreage and designation: 32 acres/RCA	

Project Data	
Existing forest/woodland/trees:	60% of site:
Proposed clearing:	1% of existing forest:
Mitigation to be provided: 5 trees and 67 shrubs	
Planting location & species (also show on site plan): Near the water	
Existing impervious surface:	7.3% of site:
Proposed new impervious: 4,291 sq. ft.	
Total impervious surface:	7.7% of site:
If the % of Impervious cover exceeds the permitted amount in the LDA or RCA, the project may need a Conditional Approval from the Critical Area Commission. Please contact your Commission planner for assistance.	
Total Area Disturbed: .19 acres	
Stormwater Management: (If site is in the IDA, the 10% worksheets must be attached. Otherwise, local stormwater requirements must be addressed.)	
Has project received local approval of SWM and sediment and erosion control plans? Stormwater and sediment and erosion control approval is pending	
Buffer impacts? Yes	Is project water dependent? Yes
If there are Buffer Impacts proposed and the project is not water dependent, the project may need a Conditional Approval from the Critical Area Commission. Please contact your Commission planner for assistance.	
<u>Other Habitat Protection Areas:</u>	
Colonial Nesting Waterbird site? Yes <input type="checkbox"/> No <input checked="" type="checkbox"/>	Waterfowl Staging Area? Yes <input type="checkbox"/> No <input checked="" type="checkbox"/>
Endangered / threatened species? Yes <input type="checkbox"/> No <input checked="" type="checkbox"/>	Forest Interior Dwelling Bird Habitat? Yes <input type="checkbox"/> No <input checked="" type="checkbox"/>
Anadromous Fish Propagation Waters? Yes <input checked="" type="checkbox"/> No <input type="checkbox"/>	
Non-tidal Wetland Impacts? Yes <input type="checkbox"/> No <input checked="" type="checkbox"/> If yes, MDE permit #:	
Tidal Wetland Impacts? Yes <input checked="" type="checkbox"/> No <input type="checkbox"/> If yes, MDE permit #: 200864629	

In accordance with COMAR 27.02.02, we hereby certify that this local agency project is consistent with the requirements of the local Critical Area Program.



(Signature)

Consistency Report for Local Government Projects

Project Name: Truxtun Park Public Boating Facility Improvements	Jurisdiction: City of Annapolis
Project Description: The City of Annapolis is proposing to renovate the public boating facilities at Truxtun Park along the shoreline of Spa Creek. The City is proposing to remove and replace the timber dock, two concrete boat ramps, and two piers, and make associated parking lot improvements.	
Local Agency proposing project: City of Annapolis, Department of Planning and Zoning	
Contact Name and Phone Number: Ms. Sally Nash, 410-263-1129	
Project Location (include street address, tax map and parcel number): Primrose Avenue, Map 0051F, Parcel 2230	
Critical Area acreage and designation: Entire 1.46-acre project area in Resource Conservation Area	

Project Data	
Existing forest/woodland/trees:	% of site: 0
Proposed clearing:	% of existing forest: 0
Mitigation to be provided:	N/A
Planting location & species (also show on site plan):	N/A
Existing impervious surface:	% of site: 65%
Proposed new impervious:	4291 square feet
Total impervious surface:	% of site: 72%
If the % of impervious cover exceeds the permitted amount in the LDA or RCA, the project may need a Conditional Approval from the Critical Area Commission. Please contact your Commission planner for assistance.	
Total Area Disturbed:	
Stormwater Management: (If site is in the IDA, the 10% worksheets must be attached. Otherwise, local stormwater requirements must be addressed.) Project not in IDA	
Has project received local approval of SWM and sediment and erosion control plans? Stormwater and sediment and erosion control approval is pending.	
Buffer impacts? Yes	Is project water dependent? Yes
If there are Buffer impacts proposed and the project is not water dependent, the project may need a Conditional Approval from the Critical Area Commission. Please contact your Commission planner for assistance.	
<u>Other Habitat Protection Areas:</u>	
Colonial Nesting Waterbird site? Yes <input type="checkbox"/> No <input checked="" type="checkbox"/>	Waterfowl Staging Area? Yes <input type="checkbox"/> No <input checked="" type="checkbox"/>
Endangered / threatened species? Yes <input type="checkbox"/> No <input checked="" type="checkbox"/>	Forest Interior Dwelling Bird Habitat? Yes <input type="checkbox"/> No <input checked="" type="checkbox"/>
Anadromous Fish Propagation Waters? Yes <input checked="" type="checkbox"/> No <input type="checkbox"/> (see attached correspondence)	
Non-tidal Wetland Impacts? Yes <input type="checkbox"/> No <input checked="" type="checkbox"/> If yes, MDE permit #:	
Tidal Wetland Impacts? Yes <input checked="" type="checkbox"/> No <input type="checkbox"/> If yes, MDE permit #: Pending	

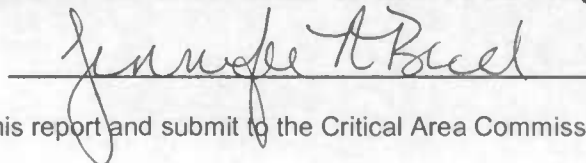
In accordance with COMAR 27.02.02, we hereby certify that this local agency project is consistent with the requirements of the local Critical Area Program.

 (Signature)

Please sign above, attach the site plan to this report and submit to the Critical Area Commission at 1804 West St., Suite 100, Annapolis, MD 21401



ENGINEERS • PLANNERS • SCIENTISTS • CONSTRUCTION MANAGERS

10 North Park Drive • Hunt Valley, MD 21030-1846 • Phone 410-316-7800 • Fax 410-316-7817

January 9, 2009

Ms. Amber Widmayer
Critical Area Commission
1804 West Street, Suite 100
Annapolis, Maryland 21401

RECEIVED

JAN 12 2009

CRITICAL AREA COMMISSION

RE: City of Annapolis
Truxtun Park Public Boating Facility Improvements
Annapolis, Maryland
KCI Job Order No. 01071530

SUBJ: Critical Area Commission Project Application
Response to Comments

Dear Ms. Widmayer:

KCI Technologies, Inc. (KCI) is in receipt of your comments dated December 31, 2008 regarding the Critical Area Commission (CAC) application for the Truxtun Park public boating facility improvements along Spa Creek. We are providing the following point by point responses to your comments as well as revised mapping.

Comment 1: It appears that the project is located within the approximately 32-acre Parcel 2230. Please quantify the acreage within this parcel that is in the Critical Area and how much of this area is a Resource Conservation Area (RCA), Limited Development Area (LDA) or Intensely Developed Area (IDA).

Response: The entire 32 acre parcel is within the Resource Conservation Area (RCA).

Comment 2: Please provide the total area of existing and proposed lot coverage for both the Critical Area portion of Parcel 2230, and for the smaller project site area.

Response: The requested measurements are provided below.

Feature	Area
Existing Lot Coverage, Parcel 2230	102,567 square feet / 2.35 acres
Proposed Lot Coverage, Parcel 2230	107,503 square feet / 2.47 acres
Existing Lot Coverage, Project area	22,344 square feet / 0.51 acre
Proposed Lot Coverage, Project area	27,280 square feet / 0.62 acre

Comment 3: *The information from KCI indicates that the project site is 1.64 acres, while the consistency form indicates that it is 1.46 acres. Please clarify which is the correct project site area.*

Response: The project site has since been revised and is included on the attached plan sets. The project site is 1.2 acres.

Comment 4: *Please provide larger plans that more clearly illustrate the proposed redevelopment activities.*

Response: KCI has provided a full sized plan set for your review.

Comment 5: *It is unclear what is proposed within the limits of disturbance in the parking areas, along the road to the pier and boat ramp, and on the existing path in the 100-foot Buffer between the boat ramp and pier. Please provide information about the existing and proposed development within these limits of disturbance, including the location of existing and proposed lot coverage. Also, if any work will be done on the existing parking spots that are currently outside of the limits of disturbance, the limits of disturbance should be expanded to include these parking spaces.*

Response: The features within the limits of disturbance are described below. The attached plans illustrate all of the proposed work.

- The project includes a 30-foot wide stone overlay through the existing parking area within the LOD as shown. There will be no work in the parking spaces outside of the LOD.
- An asphalt handicapped parking space will be provided between the existing parking lot and the bathroom facility.
- The project also includes installation of a 5-foot wide concrete sidewalk along the north side of the park road, extending from the parking lot to the boat ramp.
- An additional handicapped parking space will be provided near the boat ramp.
- The existing brick walk extending from the park road to the L-shaped pier will be replaced with pervious pavers.
- The piers and boat ramps will be replaced in-kind.

The only additional lot coverage will result from the addition of the sidewalk and the handicapped parking spaces.

Comment 6: *Please add the following features to the plans: the mean high water line, the 25-foot nontidal wetland buffer, and the 100-foot Buffer measured in the field from the landward edge of tidal waters, and expanded to include any contiguous slopes 15% or greater, and any hydric or highly erodible soils.*

Response: The 100-foot buffer and mean high water line are shown on the attached revised Critical Area Map. There are no non-tidal wetlands within the project site or surrounding area and therefore no associated buffer. Additionally, no 15% slopes or hydric or highly erodible soils are present within the LOD.

Comment 7: Please quantify the area within the limits of disturbance for the project that is within the Buffer and above mean high water. This is the area of disturbance within the Buffer. Also, please identify how much of the Buffer disturbance is required for replacement of the boat ramps and pier as distinguished from Buffer disturbance for water access paths, the ADA parking space and any other Buffer disturbances. The area of proposed Buffer disturbance for in-kind replacement of existing development need not be mitigated. Non-in-kind Buffer disturbance that is proposed for the pier and boat ramp redevelopment or for providing access to the waterfront will require mitigation at a 2:1 ratio.

Response: The requested measurements are provided below.

Feature	Area
LOD within the buffer, above MHW	8,266 square feet/0.19 acre
Buffer disturbance for boat ramps, piers	1,668 square feet/0.04 acre
Buffer disturbance for land-based activities	6598 square feet/0.15 acre
Non in-kind buffer disturbance	2146 square feet/0.05 acre

Comment 8: The applicant must provide a planting plan showing how the Buffer mitigation requirement described above will be addressed. These plantings should be provided within the Buffer.

Response: As requested, KCI is currently developing a buffer planting plan and will submit this plan for your consideration upon completion.

Sincerely,
KCI TECHNOLOGIES, INC.



Jennifer Bird
 Senior Environmental Scientist
 Natural Resource Management Division

JB/jd

Enclosures:	Attachment 1: Truxtun Critical Area Map Attachment 2: City of Annapolis Truxtun Park Floating Docks, Fixed Piers, and Boat Ramps plan set
--------------------	--

CC:	Chris Overcash, PE, BCEE, KCI Environmental Engineering Harry Sandrouni, City of Annapolis Sally Nash, City of Annapolis File
------------	--



MARYLAND
DEPARTMENT OF
NATURAL RESOURCES

Martin O'Malley, Governor
Anthony G. Brown, Lt. Governor
John R. Griffin, Secretary
Eric Schwaab, Deputy Secretary

15 April 2008

RECEIVED

APR 21 2008

Ans'd.....

Ms. Jennifer Bird
KCI Technologies
10 North Park Drive
Hunt Valley, Maryland 21030

Dear Ms. Bird:

This letter is in response to your letter of request, dated April 4, 2008, for information on the presence of finfish species related to **Truxtun Park Public Boating Facility Improvements** in Anne Arundel County.

From a review of the information provided with your request it appears that Spa Creek could be impacted by the subject project. Spa Creek and all tributaries (West Chesapeake Bay Drainage Area) are classified as a Use I waters (Water Contact Recreation and Protection of Nontidal Warmwater Aquatic Life) or Use II waters (Shellfish). The Use I classification would be most applicable to your project. Generally, instream work is prohibited in Use I streams during the period March 1 through June 15, inclusive, during any year.

The Department's Fisheries Service has documented the following anadromous fish spawning in Spa Creek: White perch (*Morone americanus*). Fisheries resources in the creek would be adequately protected by the instream work restriction period mentioned above, sediment and erosion control methods and other Best Management Practices typically used for the protection of aquatic resources.

If you have any questions concerning these comments, you may contact me at 410-260-8333.

Sincerely,

Roland J. Limpert
Environmental Review Unit



Martin O'Malley, Governor
Anthony G. Brown, Lt. Governor
John R. Griffin, Secretary
Eric Schwaab, Deputy Secretary

April 9, 2008

Jennifer Bird
KCI Technologies
10 North Park Drive
Hunt Valley, MD 21030-1846

RECEIVED

APR 14 2008

Ans'd.....

RE: Environmental Review for KCI # 01071530, Truxtun Park Public Boating facility improvements, Anne Arundel County, MD.

Dear Ms. Bird:

The Wildlife and Heritage Service has determined that there are no State or Federal records for rare, threatened or endangered species within the boundaries of the project site as delineated. As a result, we have no specific comments or requirements pertaining to protection measures at this time. This statement should not be interpreted however as meaning that rare, threatened or endangered species are not in fact present. If appropriate habitat is available, certain species could be present without documentation because adequate surveys have not been conducted.

Thank you for allowing us the opportunity to review this project. If you should have any further questions regarding this information, please contact me at (410) 260-8573.

Sincerely,

A handwritten signature in cursive script that reads "Lori A. Byrne".

Lori A. Byrne,
Environmental Review Coordinator
Wildlife and Heritage Service
MD Dept. of Natural Resources

ER# 2008.0542

NOTE: THE ENTIRE PROJECT AREA IS WITHIN THE CHESEAPEAKE BAY RESOURCE CONSERVATION AREA (RCA).



VICINITY MAP
SCALE 1" = 2000'

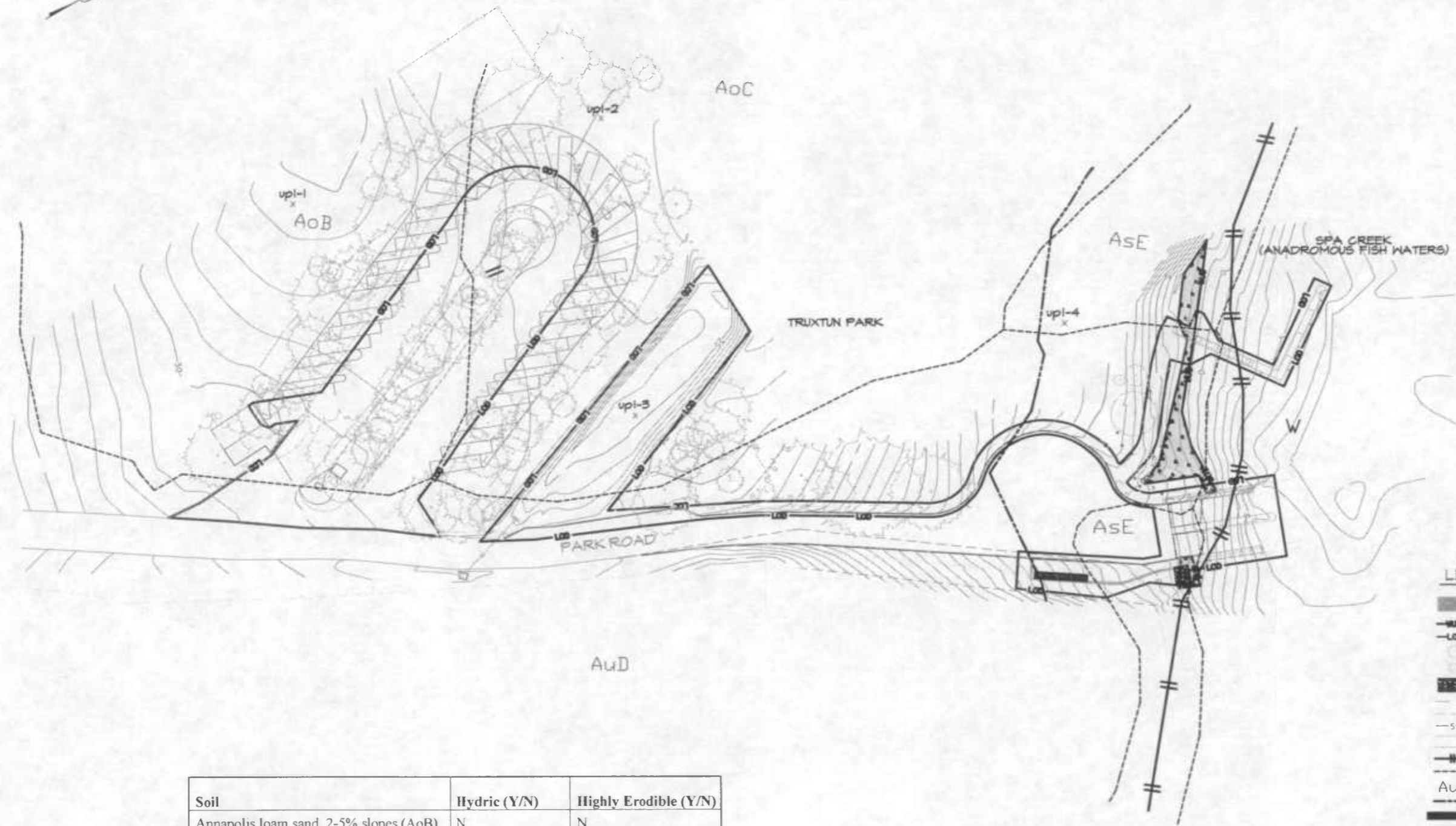

LEGEND

- WETLANDS
- WATERS OF THE US
- LIMIT OF DISTURBANCE
- EXISTING DECIDUOUS TREE
- EXISTING EVERGREEN TREE
- PROPOSED RIPRAP
- EXISTING PARKING EDGE
- EXISTING DRIVEWAY EDGE
- MAJOR CONTOUR
- MINOR CONTOUR
- CHAIN LINK FENCE
- 100-YEAR FLOODPLAIN
- SOIL LINE
- SOIL LABEL
- HABITAT PROTECTION AREA
- PROPOSED PARKING SPACES
- PROPOSED HANDRAIL

Soil	Hydric (Y/N)	Highly Erodible (Y/N)
Annapolis loam sand, 2-5% slopes (AoB)	N	N
Annapolis loam sand, 5-10% slopes (AoC)	N	N
Annapolis-Urban Land complex, 5-15% slopes (AuD)	N	N
Annapolis fine sandy loam, 15-25% slopes (AsE)	N	N



REVISIONS	
#	DATE BY DESCRIPTION

City of Annapolis
DEPARTMENT OF PUBLIC WORKS

APPROVED: _____
 CHIEF, BUREAU OF ENGINEERING & CONSTRUCTION
 DATE: _____
 DEPARTMENT OF PUBLIC WORKS

TRUXTUN
CRITICAL AREA MAP

FILENAME: _____
 DESIGNED BY: _____
 DRAWN BY: MCP
 CHECKED BY: _____
 DATE: _____
 SCALE: 1" = 40'

KCI
TECHNOLOGIES

ENGINEERS
PLANNERS
SURVEYORS
CONSTRUCTION MANAGERS

10 NORTH PARK DRIVE
DROTT SALES, MD 21870
PHONE (410) 316-7800
FAX (410) 316-7817
WWW.KCI.COM

RECEIVED

DEC 8 2008

CRITICAL AREA COMMISSION
Chesapeake & Atlantic Coastal Bay

NOTE: THE ENTIRE PROJECT AREA IS WITHIN THE CHEESAPEAKE BAY RESOURCE CONSERVATION AREA (RCA).

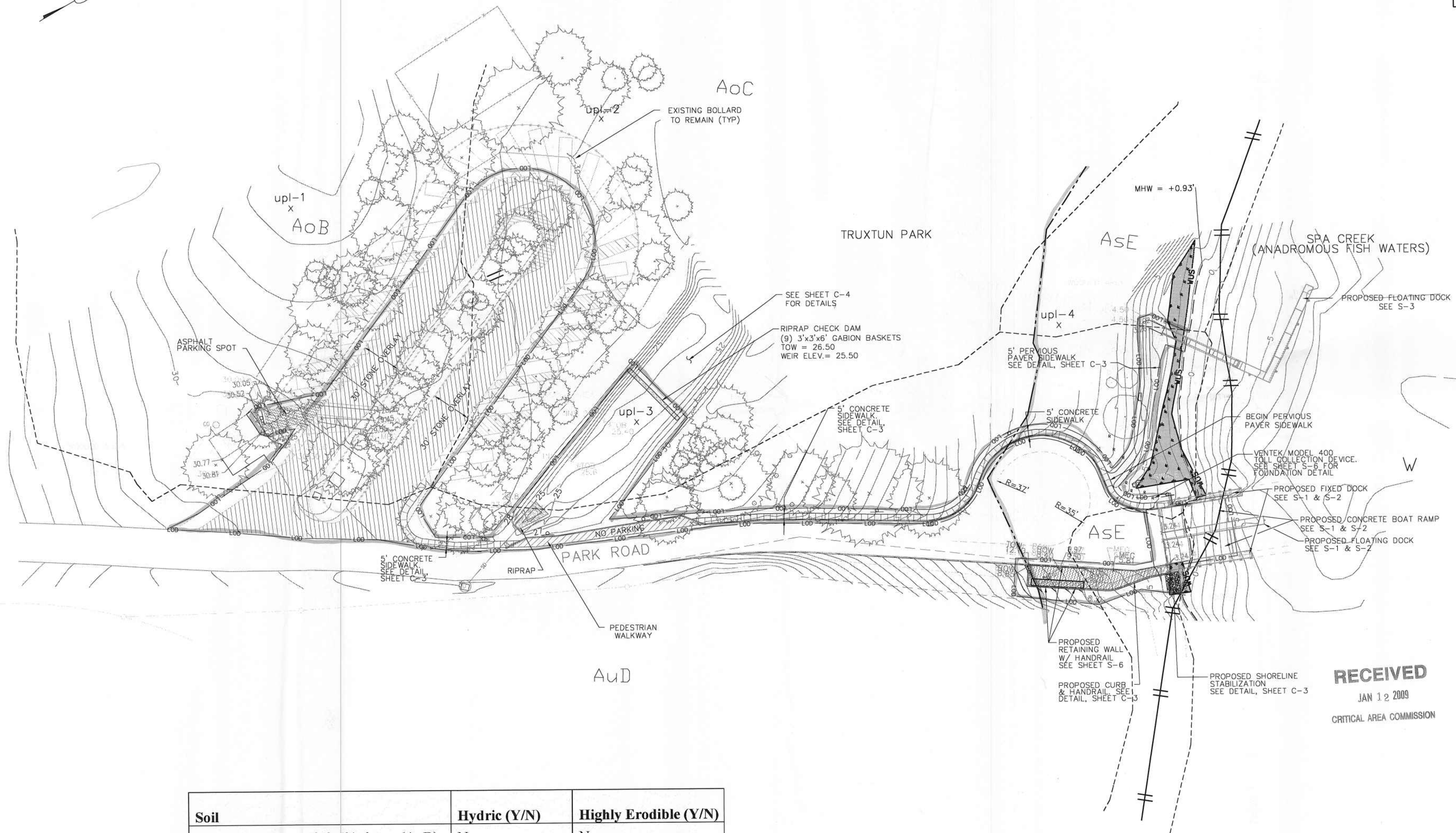
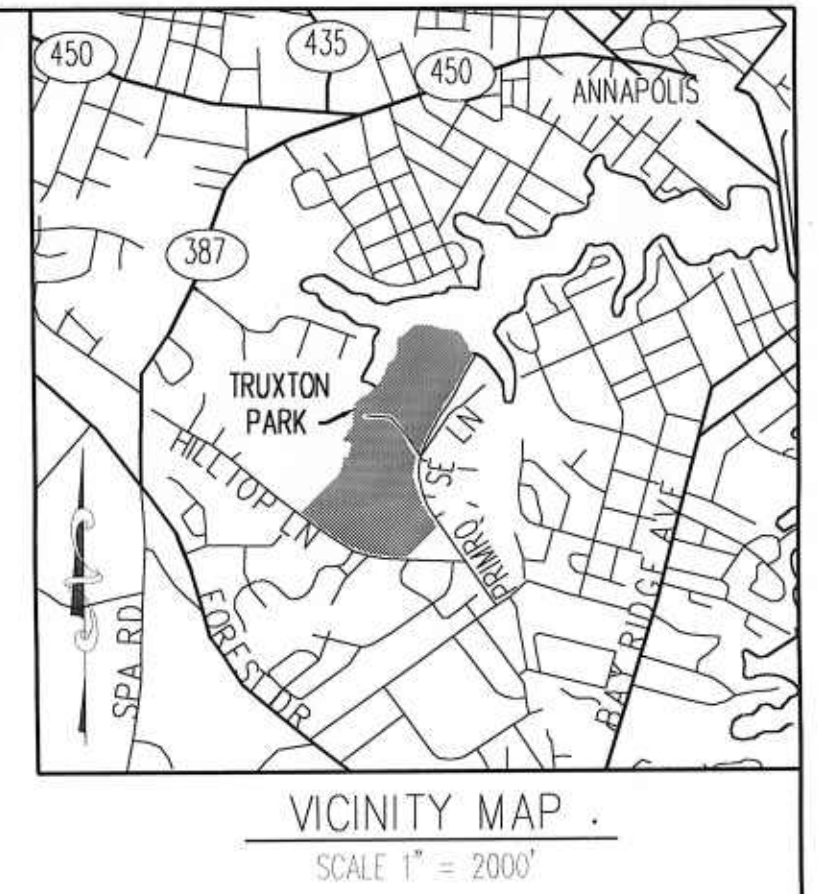

LEGEND

- WETLANDS
- WATERS OF THE US
- LIMIT OF DISTURBANCE
- EXISTING DECIDUOUS TREE
- EXISTING EVERGREEN TREE
- PROPOSED RIPRAP
- EXISTING PARKING EDGE
- EXISTING DRIVEWAY EDGE
- MAJOR CONTOUR
- MINOR CONTOUR
- CHAIN LINK FENCE
- 100-YEAR FLOODPLAIN
- SOIL LINE
- SOIL LABEL
- HABITAT PROTECTION AREA
- PROPOSED PARKING SPACES
- PROPOSED HANDRAIL

RECEIVED
JAN 12 2009
CRITICAL AREA COMMISSION

Soil	Hydric (Y/N)	Highly Erodible (Y/N)
Annapolis loam sand, 2-5% slopes (AoB)	N	N
Annapolis loam sand, 5-10% slopes (AoC)	N	N
Annapolis-Urban Land complex, 5-15% slopes (AuD)	N	N
Annapolis fine sandy loam, 15-25% slopes (AsE)	N	N

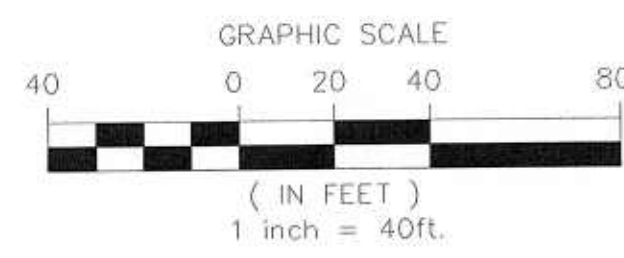

REVISIONS

#	DATE	BY	DESCRIPTION

City of Annapolis
DEPARTMENT OF PUBLIC WORKS

APPROVED: _____
CHIEF, BUREAU OF ENGINEERING & CONSTRUCTION

DESIGNED BY: RB
DRAWN BY: GH MCP
CHECKED BY: JCH
DATE: 12/2008
SCALE: 1" = 40'

TRUXTUN
CRITICAL AREA MAP

SHEET NO. 1 OF 1

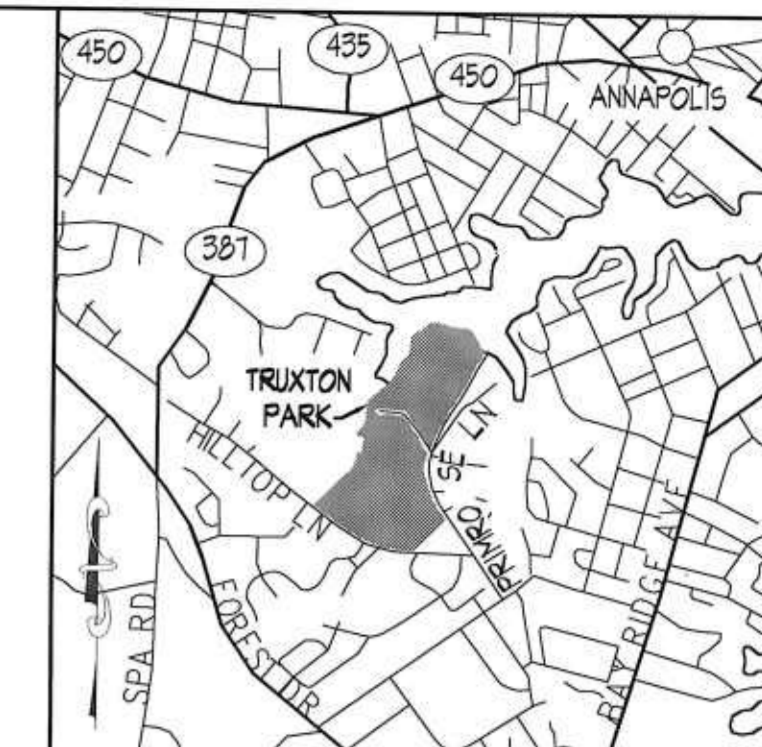

VICINITY MAP
SCALE 1" = 2000'

NOTE: THE ENTIRE PROJECT AREA IS WITHIN THE CHESEAPEAKE BAY RESOURCE CONSERVATION AREA (RCA).

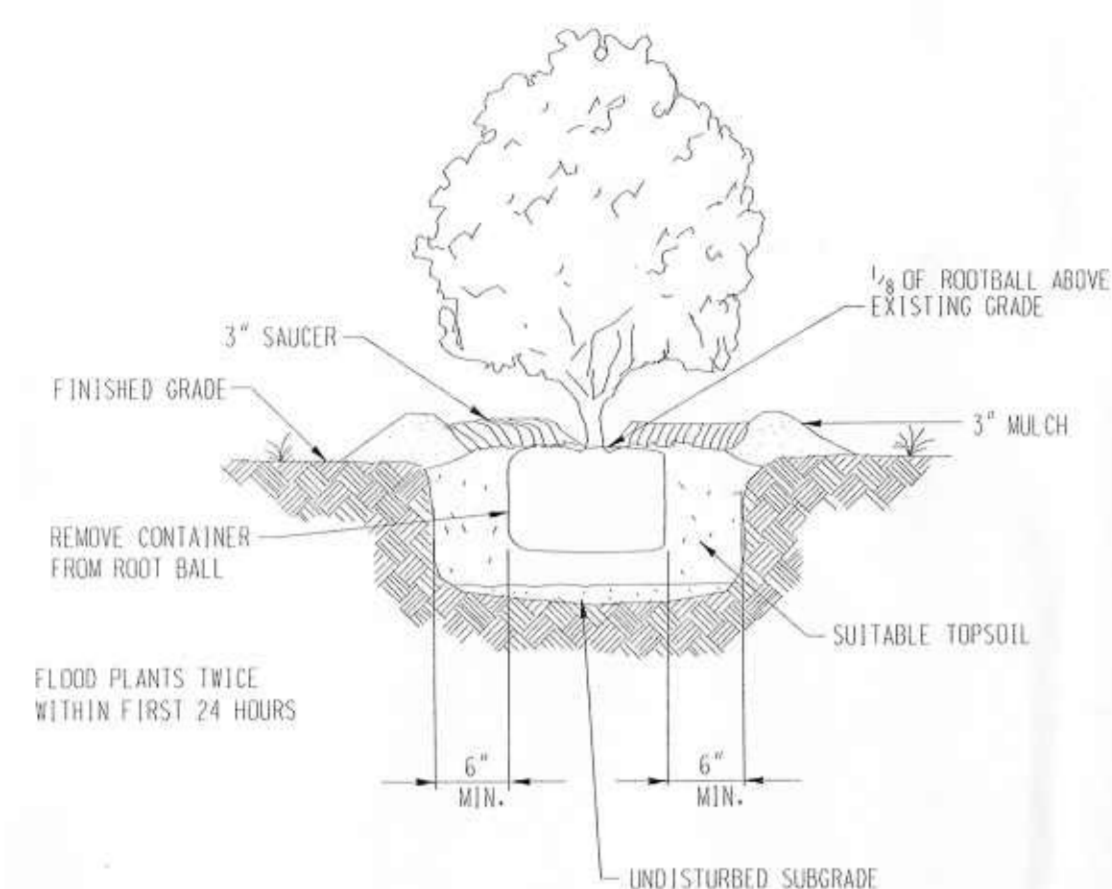

SHRUB PLANTING DETAIL
NOT TO SCALE

SHRUB PLANTING SCHEDULE (4,300SF/.09AC)				
NO.	COMMON NAME	BOTANICAL NAME	SIZE	SPACING
39	INKBERRY HOLLY	<i>Ilex glabra</i>	1'-2' HEIGHT	8' O.C.
22	RED CHOKEBERRY	<i>Aronia arbutifolia</i>	1'-2' HEIGHT	8' O.C.
6	COMMON WINTERBERRY	<i>Ilex verticillata</i>	2'-3' HEIGHT	8' O.C.

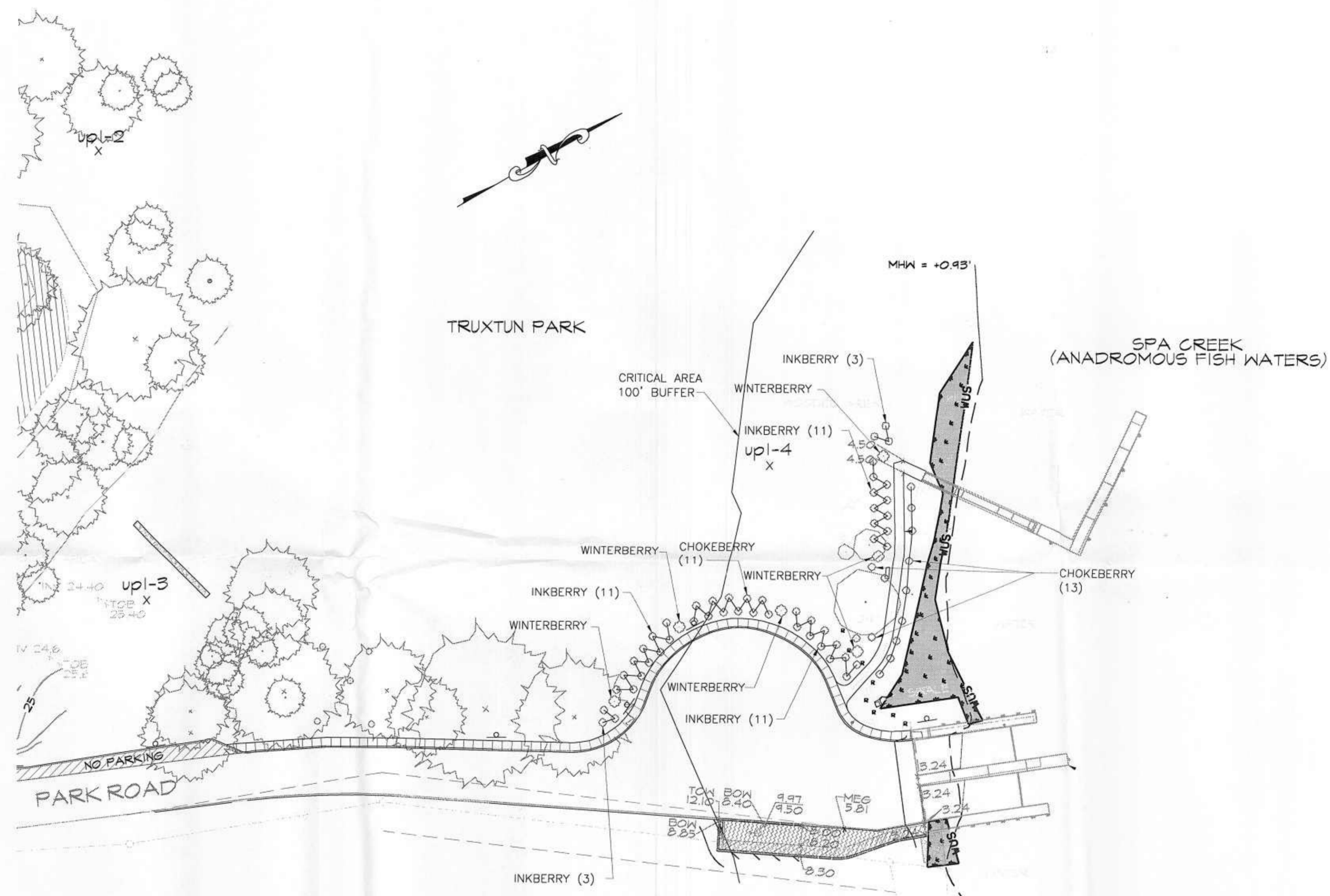

LEGEND

- WETLANDS
- WUS— WATERS OF THE US
- EXISTING DECIDUOUS TREE
- EXISTING EVERGREEN TREE
- PROPOSED RIPRAP
- EXISTING PARKING EDGE
- EXISTING DRIVEWAY EDGE
- CHAIN LINK FENCE
- HABITAT PROTECTION AREA
- PROPOSED PARKING SPACES
- PROPOSED HANDRAIL
- PROPOSED INK/ CHOKEBERRY
- PROPOSED WINTERBERRY

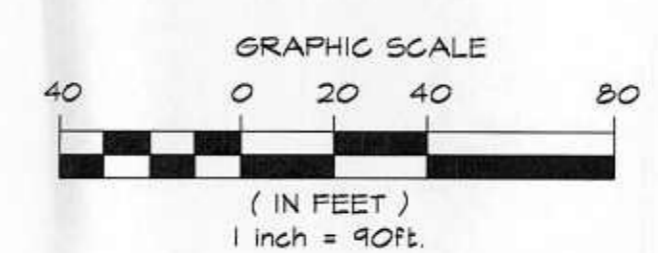

REVISIONS		
#	DATE	DESCRIPTION

City of Annapolis
DEPARTMENT OF PUBLIC WORKS

APPROVED: _____	FILENAME: _____
CHEF, BUREAU OF ENGINEERING & CONSTRUCTION	DESIGNED BY: RB
DIRECTOR, DEPARTMENT OF PUBLIC WORKS	DRAWN BY: GH MCP
	CHECKED BY: JCH
	DATE: 01/2009
	SCALE: 1" = 90'

TRUXTUN PARK SHRUB PLANTING PLAN
SHEET NO. 1 OF 1

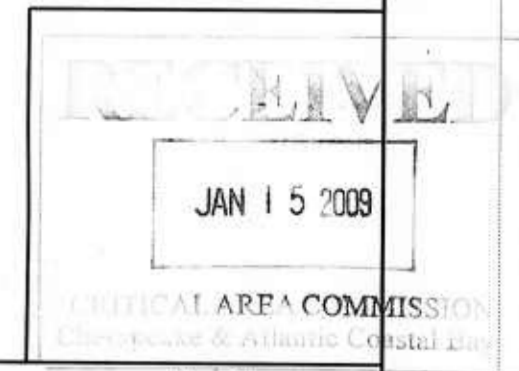

KCI TECHNOLOGIES
ENGINEERS
PLANNERS
SCIENTISTS
CONSTRUCTION MANAGERS
10 NORTH PARK DRIVE
HUNT VALLEY, MD 21030
PHONE (410) 316-7800
FAX (410) 316-7817
www.kci.com

PLOTTED, RAYES, B. S. 1/15/09