

WI 157-06 Wetipquin Creek  
Consist. Report Bridge Replacement

4  
L  
1/24/11

MSA.S. 1829-6157



STATE OF MARYLAND  
CRITICAL AREA COMMISSION  
CHESAPEAKE AND ATLANTIC COASTAL BAYS  
1804 West Street, Suite 100, Annapolis, Maryland 21401  
(410) 260-3460 Fax: (410) 974-5338  
[www.dnr.state.md.us/criticalarea/](http://www.dnr.state.md.us/criticalarea/)

January 24, 2007

Mr. Jimmy Sharp  
Chesapeake Bay Critical Area Planner  
Wicomico County  
Department of Planning, Zoning and Community Development  
P.O. Box 870  
Salisbury, Maryland 21803-0870

**RE: Wetipquin Bridge Replacement**

Dear Mr. Sharp:

Thank you for forwarding the above-referenced project to this office per the requirements of COMAR 27.02.02 - State and Local Agency Actions Resulting in Development of Local Significance on Private Lands or Lands Owned by Local Jurisdictions. After reviewing your consistency determination and the accompanying information, this office agrees that the project is consistent with the Wicomico County Critical Area Program for the reasons outlined below. The project will result in the following:

- 1) The bridge replacement is not considered to be major development and does not substantially affect the local jurisdiction's Critical Area program.
- 2) No Habitat Protection Areas will be disturbed except in the 100-foot Buffer where necessary to replace the bridge.
- 3) While there will be some impacts to the 100-foot Buffer, this is a water-dependent structure and these impacts are unavoidable.
- 4) Mitigation for impacts to the 100-foot Buffer will be provided at a 3:1 ratio.
- 5) All required permits from the Maryland Department of the Environment have been issued.
- 6) This project replaces an existing bridge due to safety reasons, and the new bridge will be in the exact same footprint as the current bridge.

Mr. Sharp  
January 24, 2007  
Page Two

Since the project is consistent with the local program, it will not require formal approval by the Chesapeake Bay Critical Area Commission, notwithstanding any other required resource agency approvals.

Thank you again for your cooperation and assistance with reviewing this project. If you have any questions, please telephone me at (410) 260-3478.

Sincerely,

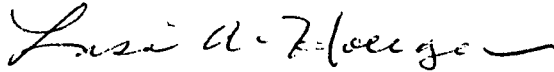
A handwritten signature in cursive script that reads "Lisa A. Hoerger". The signature is written in black ink and includes a long horizontal flourish at the end.

Lisa A. Hoerger, Chief  
Project Evaluation Division

cc: WI 157-06

### Consistency Report for Local Government Projects

Project Name: Replacement of Bridge No. WI 4781 on Wetipquin rd over Wetipquin Creek
Project Description: Replacing Wetipquin Bridge
Local Agency proposing project: Wicomico County Department of Public Works
Contact Name and Phone Number: Jimmy Sharp 410-548-4860
Project Location (include street address, tax map and parcel number): Wetipquin rd, Map 44, parcel 82
Critical Area acreage: 59 acres

Project Data	
Existing forest/woodland/trees: -	% of site: -
Proposed clearing: 8 shrubs	% of existing forest:
Mitigation to be provided: 24 shrubs to be planted in County Park within buffer	
Planting location & species (also show on site plan): Riverside Boat Ramp Verticillium shrub species	
Existing impervious surface: .24 acres	% of site:
Proposed new impervious: <del>.24 acres</del>	
Total impervious surface: .24 acres	% of site:
Total Area Disturbed: .37 acres	
Stormwater Management: (If site is in the IDA, the 10% worksheets must be attached. Otherwise, local stormwater requirements must be addressed.)	
Buffer impacts? minimal	Is project water dependent? Yes
<b>If there are Buffer Impacts proposed and the project is not water dependent, the project may need a Conditional Approval from the Critical Area Commission. Please contact your Commission planner for assistance.</b>	
Other Habitat Protection Areas:	
Colonial Nesting Waterbird site? Yes <input type="checkbox"/> No <input checked="" type="checkbox"/>	
Waterfowl Staging Area? Yes <input type="checkbox"/> No <input checked="" type="checkbox"/>	
Anadromous Fish Propagation Waters? Yes <input type="checkbox"/> No <input checked="" type="checkbox"/>	
Endangered or threatened species? Yes <input type="checkbox"/> No <input checked="" type="checkbox"/>	
Forest Interior Dwelling Bird Habitat? Yes <input type="checkbox"/> No <input checked="" type="checkbox"/>	
Non-tidal Wetland Impacts? Yes <input type="checkbox"/> No <input checked="" type="checkbox"/> If yes, MDE permit #:	
Tidal Wetland Impacts? Yes <input checked="" type="checkbox"/> No <input type="checkbox"/> If yes, MDE permit #: 04-6L-0473	

Attach the site plan to this report and submit to the Critical Area Commission at 1804 West St., Suite 100, Annapolis, MD 21401

**Hoerger, Lisa**

---

**From:** Jimmy Sharp [jsharp@wicomiconcounty.org]  
**Sent:** Monday, January 22, 2007 3:48 PM  
**To:** Hoerger, Lisa  
**Subject:** RE: Project status question

Thanks for the quick reply. I will get that report to you tomorrow morning. The site is in the LDA and RCA. Im going to attach a rough map to give you an idea. The tanish color is LDA and the green is RCA. Thanks again for the reply. The company doing the project had given me a bunch of calls in the last week or so. Usually i wouldnt worry what the construction company thinks but it has been a while.

---

**From:** Hoerger, Lisa [mailto:LHOERGER@dnr.state.md.us]  
**Sent:** Mon 1/22/2007 3:22 PM  
**To:** Jimmy Sharp  
**Subject:** RE: Project status question

Hello Jimmy,

I asked LeeAnne to email or fax you some language about State versus private tidal wetlands earlier. Did you get it? If not, let me know.

Jennifer was unable to get to the Wetipquin Bridge replacement before she left, so I have it on my desk. I took a quick look at it and it appears we can handle it as a consistency report. Can you fax or email me the one page consistency report? I believe you did one for the Rewastico Bridge replacement.

I do have a question about Wetipquin which is what is the Critical Area designation? The project notification form indicates it is partially in the LDA and partially in the RCA; however, other documents indicate it is in the IDA. If it is in the IDA, then the 10% calculations need to be forwarded with your consistency form.

Thanks Jimmy. I should be able to turn this one around for you quickly if you can determine it to be consistent with the local program, which it appears to be based on my brief review of the information submitted thus far.

Sincerely,

Lisa A. Hoerger, Chief  
 Project Evaluation Division  
 Critical Area Commission for the Chesapeake and Atlantic Coastal Bays  
 1804 West Street, Suite 100  
 Annapolis, Maryland 21401  
 (410) 260-3478

-----Original Message-----

**From:** Jimmy Sharp [mailto:jsharp@wicomiconcounty.org]  
**Sent:** Monday, January 22, 2007 2:59 PM  
**To:** Hoerger, Lisa  
**Subject:** Project status question

Hello again,

I had sent a project up to jennifer when she was there. I sent it out on the 5th of December. The project was the Wetipquin Bridge replacement. I was curious if you could tell me the status of the project when you get a chance. I appreciate it.

1/22/2007

Partners:

Joseph S. Makar  
John S. Meynes  
David B. McCormick  
Dennis J. Hesson

# WHITMAN, REQUARDT AND ASSOCIATES, LLP

*Engineers, Architects and Planners*

801 South Caroline Street  
Baltimore, Maryland 21231

(410) 235-3450

Fax: (410) 243-5716

[www.wrallp.com](http://www.wrallp.com)

October 20, 2006

Associates:

Richard J. Kane  
Eerl L. Swartzendruber, Jr.  
Herbert W. Lew  
Luther E. Bathurst  
John D. Emerson  
Gary B. Bush  
William W. Fitchett, Jr.  
Gregory D. Mucci  
William A. Geschrei  
Douglas A. Kelso  
Amiteva Podder  
Neil M. Leary  
Gregory King  
Jeffrey F. Giza  
Jeffrey R. Riegner  
Charles E. Henck  
Keren L. Moran  
Jeson D. Cosler  
J. Andrew Landrum  
Robert D. Britt

Senior Associates:

James O. Armacost, III  
Louis W. Klinefelter  
Thomas J. Hannen, Jr.  
John P. Meddow  
William P. Wegner  
Walter P. Miller  
Daniel J. Seli  
Anthony U. Olsen  
Robert J. Krellinger

Mr. Jim Sharp  
Chesapeake Bay Critical Area Planner  
Wicomico County  
Department of Planning, Zoning and  
Community Development  
125 North Division Street, Room 203  
Salisbury, MD 21801

Re: Wetipquin Road Bridge, No. WI-4781  
Over Wetipquin Creek  
Wicomico County, MD  
WR&A WO #31543-09

Dear Mr. Sharp:

This is to respond to your e-mail, dated August 16, 2006, regarding Chesapeake Bay Critical Area area calculations for the Wicomico County Department of Public Works and Transportation Division of Engineering Services Wetipquin Road Bridge project. The requested areas are as follows:

- Total Critical Area Acreage = 31,871 SF**
- Existing Impervious Surface = 15,530 SF (includes existing pavement and bridge)**
- Proposed Impervious Surface = 16,784 SF (includes proposed bridge, full depth pavement, and pavement mill and overlay)**
- Total Disturbed Area = 19,565 SF (area within LOD landside) + 5,602 SF (proposed bridge deck area) = 25,167 SF**
- Woodlands = None**

Although no woodlands occur within the site, approximately eight (8) shrubs are located within the Limits of Disturbance (see attached photographs). These shrubs are located with the CBCA 100-ft buffer and should be mitigated 3:1. We plan to mitigate for these shrubs by requesting the Wicomico County Department of Recreation, Parks & Tourism to plant 24 shrubs within the 100-ft buffer on existing county parkland at the adjacent Riverside Boat Ramp on the Wetipquin River (see attached Memorandum of Understanding).

The project engineering design was modified to meet the navigational clearance requirements of the original US Coast Guard permit after the original wetlands license and permit issuance. We have applied for a modification to the current wetlands license and permit (see attached Joint Permit Application, dated October 17, 2006).

Sincerely,  
WHITMAN, REQUARDT AND ASSOCIATES, LLP



Laura Callens  
Environmental Scientist

Enclosures: Photo Log  
Signed Memorandum of Understanding  
Joint Permit Application, dated October 17, 2006  
Full Set of Construction Plans

cc: P. Rai Sharma, Wicomico County DPW  
Bill Geschrei/Aaron Keel, WR&A



**MEMORANDUM OF UNDERSTANDING**

TO: P. Rai Sharma, Wicomico County Department of Public Works  
FROM: Rick Konrad, Superintendent of Parks Wicomico County, Maryland  
SUBJECT: Mitigation for Chesapeake Bay Critical Area - Wetipquin Bridge Project  
DATE: 10/19/06

This memorandum will serve to verify the conditions of agreement to mitigate the removal of 8 shrubs in the Chesapeake Bay Critical Area on the Wetipquin Bridge Project.

- Wicomico County Parks Division agrees to plant 24 shrubs in the watershed critical area (within 100 foot buffer) at the site of Riverside Boat Ramp on Riverside Drive directly adjoining the Wicomico River in Salisbury, Maryland.
- Wicomico County Parks Division will waive the cost of materials and labor for planting of 24 shrubs at the above mentioned Critical Area site.

Please sign and return this agreement as soon as possible.

RDK/ac

I hereby agree to abide by all conditions contained in this Memorandum of Understanding.

P. Rai Sharma 10/20/06  
 P. Rai Sharma Date  
 Wicomico County DPW

Rick D. Konrad 10/19/06  
 Rick D. Konrad, Superintendent Date  
 Wicomico Recreation, Parks & Tourism

Betha J. Ford 10/20/06  
 Witness Date

Annette Covey 10/19/06  
 Witness Date



Partners:

Joseph S. Makar  
John S. Maynes  
David B. McCormick  
Dennis J. Hasson

Senior Associates:

James O. Armacost, III  
Louis W. Klinefelter  
Thomas J. Hannan, Jr.  
John P. Maddox  
William P. Wagner  
Walter P. Miller  
Daniel J. Seli  
Anthony U. Olsen  
Robert J. Krallinger

**WHITMAN, REQUARDT AND ASSOCIATES, LLP**  
*Engineers, Architects and Planners*

801 South Caroline Street  
Baltimore, Maryland 21231

(410) 235-3450

Fax: (410) 243-5716

[www.wrallp.com](http://www.wrallp.com)

Associates:

Richard J. Kane  
Earl L. Swartzendruber, Jr.  
Herbert W. Lew  
Luther E. Bathurst  
John D. Emerson  
Gary B. Bush  
William W. Fitchett, Jr.  
Gregory D. Mucci  
William A. Geschrei  
J. Mark Parker  
Douglas A. Kelso  
Amitava Podder  
Neil M. Leary  
Gregory King  
Jeffrey F. Giza  
Jeffrey R. Riegner  
Charles E. Henck  
Karen L. Moran  
Jason D. Costler  
J. Andrew Landrum  
Robert D. Britt

October 19, 2006

Ms. Andi Cunabaugh  
Maryland Department of the Environment  
Regulatory Service, Coordination Office  
1800 Washington Boulevard, Suite 430  
Baltimore, MD 21230-1708

Re: Wetipquin Road Bridge, No. WI-4781  
Wicomico County, MD  
Joint State and Federal Permit Application  
for impacts to Waters of the United States  
WR&A WO #31474-06

Dear Ms. Cunabaugh:

Wicomico County is pleased to present five (5) copies of this Joint State and Federal Permit Application for permanent and temporary impacts to tidal wetlands and Waters of the US for the Wetipquin Road Bridge Replacement project.

This project has received previous MDE Authorization, General Tidal Wetlands License 04-GL-0473. To meet the navigational clearance requirements of the original US Coast Guard permit, the bridge design was modified from the original plans. We are requesting a modification to the previously issued wetlands license. Enclosed are copies of the Joint Permit Application, 8.5"x11" Permit Impact Plates, Waters of the US Identification and Delineation Report, agency response letters, construction plans and General Tidal Wetlands License 04-GL-0473.

We look forward to cooperating with the State/Federal permit reviewers on this project authorization. If there are any questions or concerns with this application, please contact me at (443) 224-1633. Thank you for your assistance in the processing of this application.

Sincerely,  
WHITMAN, REQUARDT AND ASSOCIATES, LLP



Laura C. Callens  
Environmental Scientist

Enclosures (5 permit application submittal packages)

cc: P. Rai Sharma, Wicomico County DPW  
Bill Geschrei/Aaron Keel, WR&A



**CITY OF SALISBURY - WICOMICO COUNTY  
DEPARTMENT OF PLANNING, ZONING  
AND COMMUNITY DEVELOPMENT**



Tel: 410-548-4860

*- Jim Sharp*

Fax: 410-548-4955

Planning & Zoning Commission  
Historic District Commission  
Metropolitan Planning Organization

Wicomico County Board of Appeals  
Salisbury Board of Zoning Appeals  
Agricultural Land Preservation Advisory Board

Kerrie Galo, Natural Resource Planner  
Chesapeake Bay Critical Area Commission  
1804 West Street, Suite 100  
Annapolis, Md  
21401

March 3, 2006

**RECEIVED**

MAR 07 2006

CRITICAL AREA COMMISSION

**Wicomico County  
Proposed Bridge Replacement- Project Summary  
Wetipquin Creek**

On the 2<sup>nd</sup> of March I received the file from Whitman, Requardt, and Associates, LLP on the Wetipquin Creek bridge replacement. Attached are copies of construction plans and maps showing wetlands, natural features and limits of disturbance. Also included are the sediment and erosion control plans. Whitman, Requardt, and Associates, LLP has already received their wetlands license and permit from Maryland Department of The Environment. MDE has also established that there is no endangered plant or animal species that will be affected by the project. They have also received approval from the Army Corps of Engineers for a Maryland State Programmatic General Permit. The US Department of the Interior has determined that there may be one federally endangered species in the area, the Delmarva Fox Squirrel. However, they also state that any clearing of forest could adversely affect the Squirrel. No trees are going to be cut down for this project. Also included are letters from the Maryland Department of Housing and Community Development and the Department of Natural Resources. They have made some suggestions to Whitman, Requardt, and Associates, LLP as to how they might go about protecting various historical aspects of the area and fish species located in and around the area to be affected by the construction.

All these letters are in the group of papers you received along with the maps. The proposed bridge replacement will be placed in the same footprint as the old bridge. The area of land that the bridge connects to is located in the IDA. However, there will be no



**CITY OF SALISBURY - WICOMICO COUNTY  
DEPARTMENT OF PLANNING, ZONING  
AND COMMUNITY DEVELOPMENT**



**Tel: 410-548-4860**

**Fax: 410-548-4955**

**Planning & Zoning Commission  
Historic District Commission  
Metropolitan Planning Organization**

**Wicomico County Board of Appeals  
Salisbury Board of Zoning Appeals  
Agricultural Land Preservation Advisory Board**

addition of impervious surface added to the critical area. No tree removal or vegetation disturbance is expected.

STATE	FEDERAL AID PROJECT NO.	SHEET NO.	TOTAL SHEETS
MD.			



**WICOMICO COUNTY**  
**DEPARTMENT OF PUBLIC WORKS**  
**SALISBURY, MARYLAND**  
**REPLACEMENT OF BRIDGE NO. WI4781**  
**ON WETIPQUIN ROAD**  
**OVER WETIPQUIN CREEK**  
**S.H.A. CONTRACT NO. WI662BM1**  
**FEDERAL AID PROJECT NO.**

**INDEX OF SHEETS**

SHEET NO.	TITLE
1	TITLE SHEET
2	DETOUR PLAN
3	CONSTRUCTION WARNING SIGN DETAILS
4	TRAFFIC CONTROL PLANS
5	ROADWAY TYPICAL SECTION
6	ROADWAY PLAN - 1
7	ROADWAY PLAN - 2
8	PROFILE - 1
9	PROFILE - 2
10	EROSION AND SEDIMENT CONTROL NOTES
11	EROSION AND SEDIMENT CONTROL PLAN - 1
12	EROSION AND SEDIMENT CONTROL PLAN - 2
13	CROSS SECTIONS - 1
14	CROSS SECTIONS - 2
15	GENERAL DETAILS
16	GENERAL PLAN AND ELEVATION
17	TYPICAL BRIDGE SECTION
18	PIER PLAN AND ELEVATION
19	TYPICAL SECTIONS - ABUTMENT AND WINGWALL
20	BORING LOCATION PLAN - 1
21	BORING LOCATION PLAN - 2
22	BORING LOCATION PLAN - 3
23	BORING LOCATION PLAN - 4

CRITICAL AREA COMMISSION

MAR 07 2006

**RECEIVED**

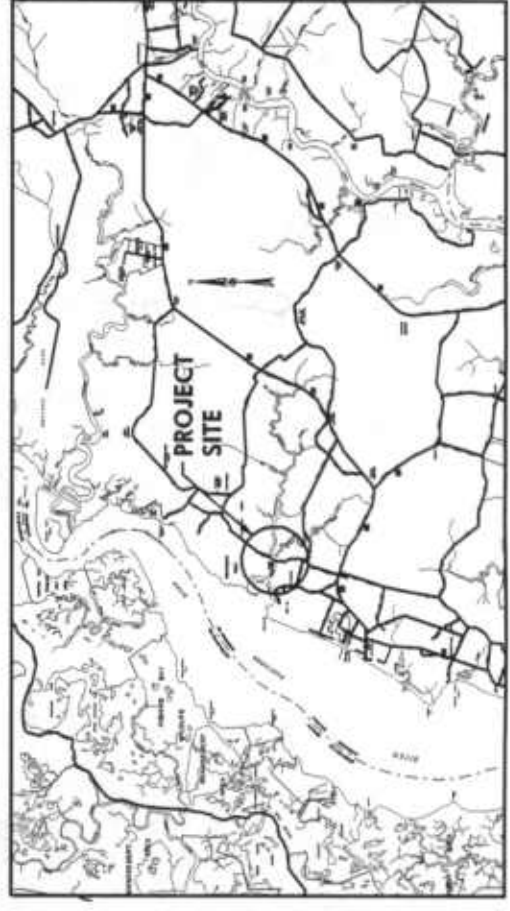
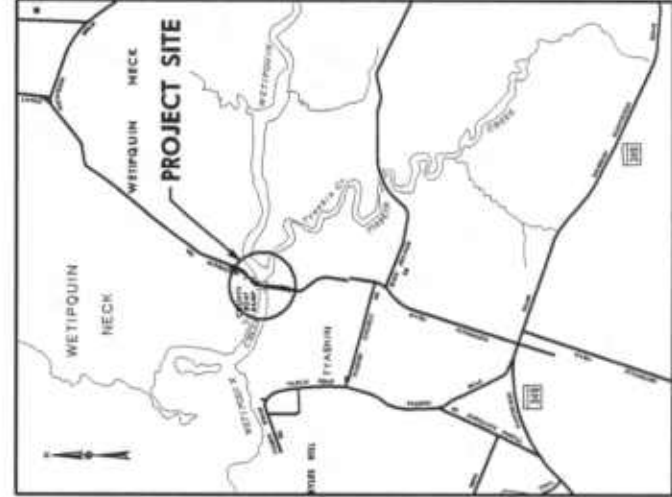

**ABBREVIATIONS**

ACT.	P.O.E.
B	PVC
CB	PM
CC	PVT
CMP	RFR
CONC	PT
CPP	RC
ELEV	RCEP
FM	RT
HORIZ	RHW
H.P.	SE
L.F.	SK
L.P.	SS
LL	SSD
MAC	STA
MD	TEL
MH	TERR
NO.	TYP.
PC	UG
PAGE	V.C.
PGL	VERT.
PGL	W
PI	WM
P.O.B.	WP
P.O.C.	WV



DESIGNATION	2000	2008
CONTROLS / YEARS	152	275
AVERAGE DAILY TRAFFIC (ADT)	5	28
DESIGN HOURLY VOLUME (DHV)	50%	50%
DIRECTIONAL DISTRIBUTION	5%	5%
% TRUCKS - ADT	5%	5%
% TRUCKS - DHV	5%	5%
DESIGN SPEED	40 MPH	
FUNCTIONAL CLASSIFICATION	RURAL LOCAL	
CONTROL OF ACCESS	NONE	
INTENSITY OF DEVELOPMENT	RURAL	
TERRAIN	LEVEL	
ANTICIPATED POSTED SPEED	40 MPH	

**RMA**  
**RAJAN MAHIMA ASSOCIATES, INC.**  
 CONSULTING ENGINEERS  
 Rockville, Maryland 20850

**WRA**  
 Whitman, Reardon and Associates, LLP  
 Engineers, Architects and Planners  
 80 South Caroline Street  
 Baltimore, Maryland 21201  
 410-235-1450

**WRA**  
 Whitman, Reardon and Associates, LLP  
 Engineers and Planners  
 80 South Caroline Street  
 Baltimore, Maryland 21201  
 410-235-1450

APPROVED \_\_\_\_\_ DATE \_\_\_\_\_  
 JOSEPH B. MAKAR, P.E.

SHAW-WALKER ENGINEERING AND ARCHITECTURE  
 1000 WASHINGTON AVENUE  
 BALTIMORE, MARYLAND 21201

**NOTES:**

1. REFER TO SHEET NO. 3 OF 23 FDR CONSTRUCTION WARNING SIGN DETAILS
2. EXACT SIGN LOCATION SHALL BE APPROVED BY THE COUNTY ENGINEER TO ASSURE COORDINATION WITH EXISTING SIGNING AND EXISTING SIGHT DISTANCES.
3. EXACT PLACEMENT OF TYPE III BARRICADES TO BE DETERMINED BY FIELD ENGINEER. ALL BARRICADES SHALL HAVE YELLOW FLASHING WARNING BEACONS PER MDSHA SPECIFICATIONS.
4. ALL SIGNS SHALL CONFORM TO MDSHA MATERIAL AND REFLECTIVITY REQUIREMENTS.
5. DO NOT INSTALL SIGNS ON CONCRETE BARRIERS.
6. INSTALL ADVANCE NOTICE SIGNS #13 AND #14 AT CLOSURE LOCATIONS 2 WEEKS PRIOR TO SCHEDULED CLOSURE. IF CLOSURE DID NOT TAKE PLACE WITHIN 7 CALENDAR DAYS OF THE DATE NOTED ON THE SIGN, THE CONTRACTOR IS RESPONSIBLE FOR CHANGING THE DATE AT NO COST TO WICOMICO COUNTY.
7. THE CONTRACTOR IS RESPONSIBLE FOR MAINTAINING ALL TRAFFIC DEVICES. ANYTIME THE CONTRACTOR DOES NOT MAKE NECESSARY REPAIRS WITHIN 24 HOURS OF NOTIFICATION, APPROPRIATE WORK TIME REDUCTION AND/OR FINES WILL BE APPLIED.
8. ALL TRAFFIC CONTROL DEVICES SHALL MEET NATIONAL COOPERATIVE HIGHWAY RESEARCH PROGRAM (NCHRP) REPORT 350 CRASHWORTHY REQUIREMENTS.
9. MAINTAIN BICYCLE AND PEDESTRIAN TRAFFIC AT ALL TIME DURING CONSTRUCTION.

**LEGEND:**

-  DENOTES CONSTRUCTION WARNING SIGNS ON TYPE III BARRICADES
-  DENOTES CONSTRUCTION WARNING SIGNS ON TEMPORARY SUPPORTS

THE EXISTING ROADWAY WILL BE CLOSED TO TRAFFIC DURING CONSTRUCTION AND WILL REMAIN CLOSED UNTIL ALL CONSTRUCTION IS COMPLETE.

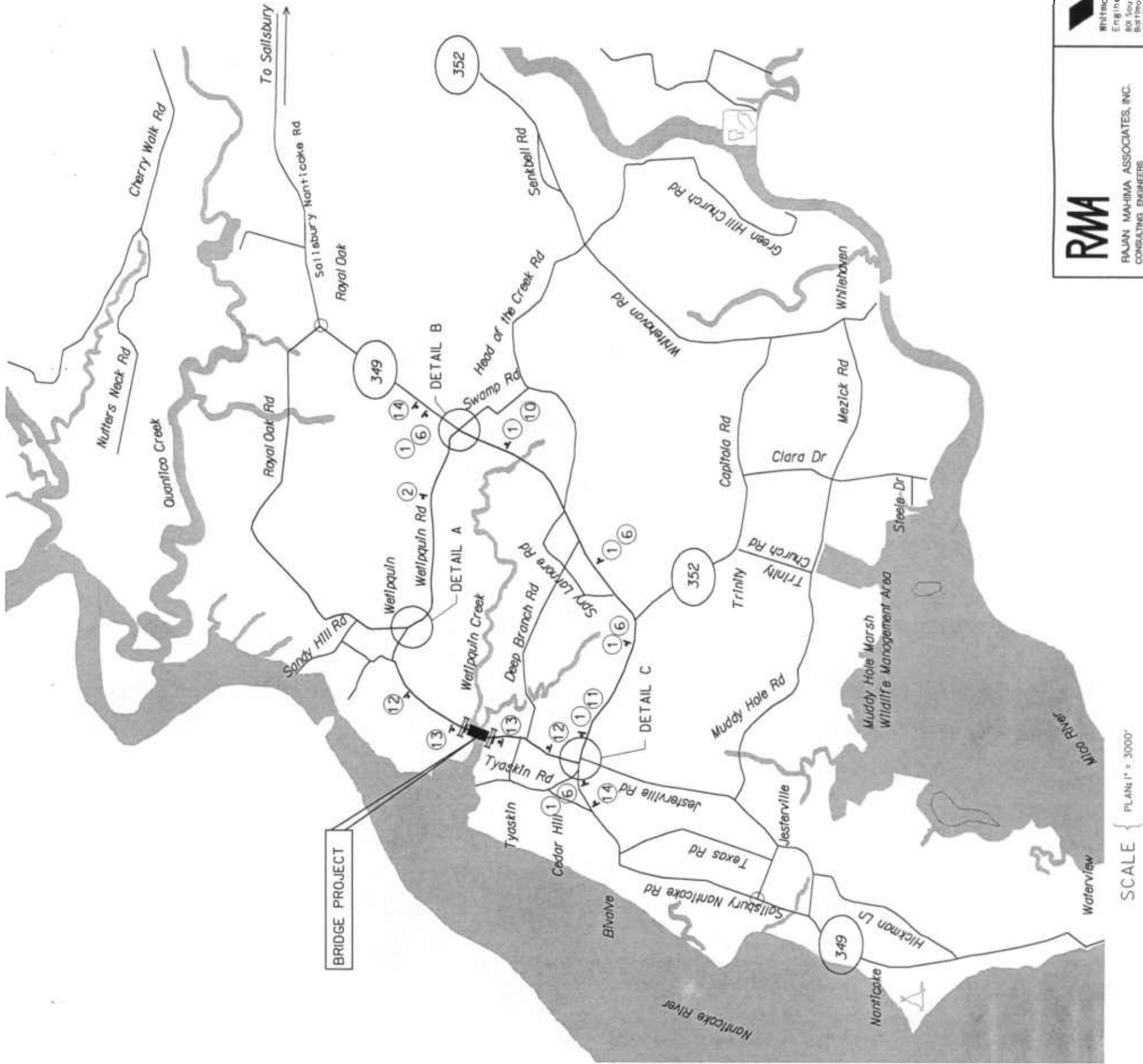

SCALE { PLANS 1" = 3000'

**RMA**  
 RAJAN MAHIMA ASSOCIATES, INC.  
 CONSULTING ENGINEERS  
 Rockville, Maryland 20850

**WR&A**  
 Whitman, Requardt and Associates, LLP  
 Engineers, Architects and Planners  
 800 South Caroline Street  
 Baltimore, Maryland 21201  
 410-235-3450

REVISIONS



WICOMICO COUNTY  
 DEPARTMENT OF PUBLIC WORKS  
 SALISBURY, MARYLAND  
 REPLACEMENT OF BRIDGE NO. W14781  
 ON WETIPQUIN ROAD  
 OVER WETIPQUIN CREEK  
 ROADWAY PLAN - 1

REVISIONS

**WMRA**  
 Whitman, Reardon and Associates, LLP  
 Engineers, Architects and Planners  
 801 South Caroline Street  
 Baltimore, Maryland 21231  
 410-235-3450

**RMA**  
 RAJANI MAHIMA ASSOCIATES, INC.  
 CONSULTING ENGINEERS  
 Rockville, Maryland 20850

SCALE { PLAN: 1" = 20'-0"



STATION	LEFT LANE RATE	RIGHT LANE RATE
103+55.07	-2.00	-2.00
103+96.45	0.00	-2.00
104+00.00	+0.17	-2.00
104+37.83	+2.00	-2.00
104+50.00	+2.59	-2.59
105+00.00	+5.00	-5.00
105+16.45	+5.80	-5.80
105+50.00	+5.80	-5.80
106+00.00	+5.80	-5.80
106+50.00	+5.80	-5.80
107+00.00	+5.80	-5.80
107+50.00	+5.80	-5.80
108+00.00	+5.80	-5.80
108+12.71	+5.80	-5.80
108+50.00	+3.72	-3.72
109+00.00	+0.93	-0.93
109+16.58	0.00	0.00

TRANSITION LENGTH = 120 FT  
 MAX. S.E. = 5.8%  
 R = 650 FT V = 40 MPH

CURVE 1  
 P.I. STA. 106+70.02  
 DELTA = 33°10'01"  
 T = 193.57'  
 L = 376.27'  
 R = 650.00'  
 E = 28.21'

MATCH LINE STA. 106+50

WETIPQUIN CREEK

PLACE:  
 I TIMBER BRIDGE RAILING END  
 POST ON EACH END  
 I-30 FT. FLAREO ANCHOREO  
 TERMINAL SECTIONS ON EACH SIDE

MILL AND OVERLAY  
 STA. 103+35 TO STA. 104+05  
 270 SQ. YD.

NOTE:  
 ALL SELECTIVE OR THINNING AT THE BRIDGE  
 SITE FOR THE MOVEMENT OF CONSTRUCTION  
 EQUIPMENT SHALL BE INCLUDED IN THE  
 CLEARING AND GRUBBING ITEM.

COUNTY COMMISSIONERS  
 OF WICOMICO COUNTY  
 LIBER 569 FOLIO 539



- LEGEND:
- FULL DEPTH PAVEMENT
  - MILLING AND OVERLAY
  - EX. RW
  - WL
  - EW
  - INDICATES CUT AND FILL LIMITS
  - APPROXIMATE LIMITS OF WETLAND
  - INDICATES EDGE OF WATER

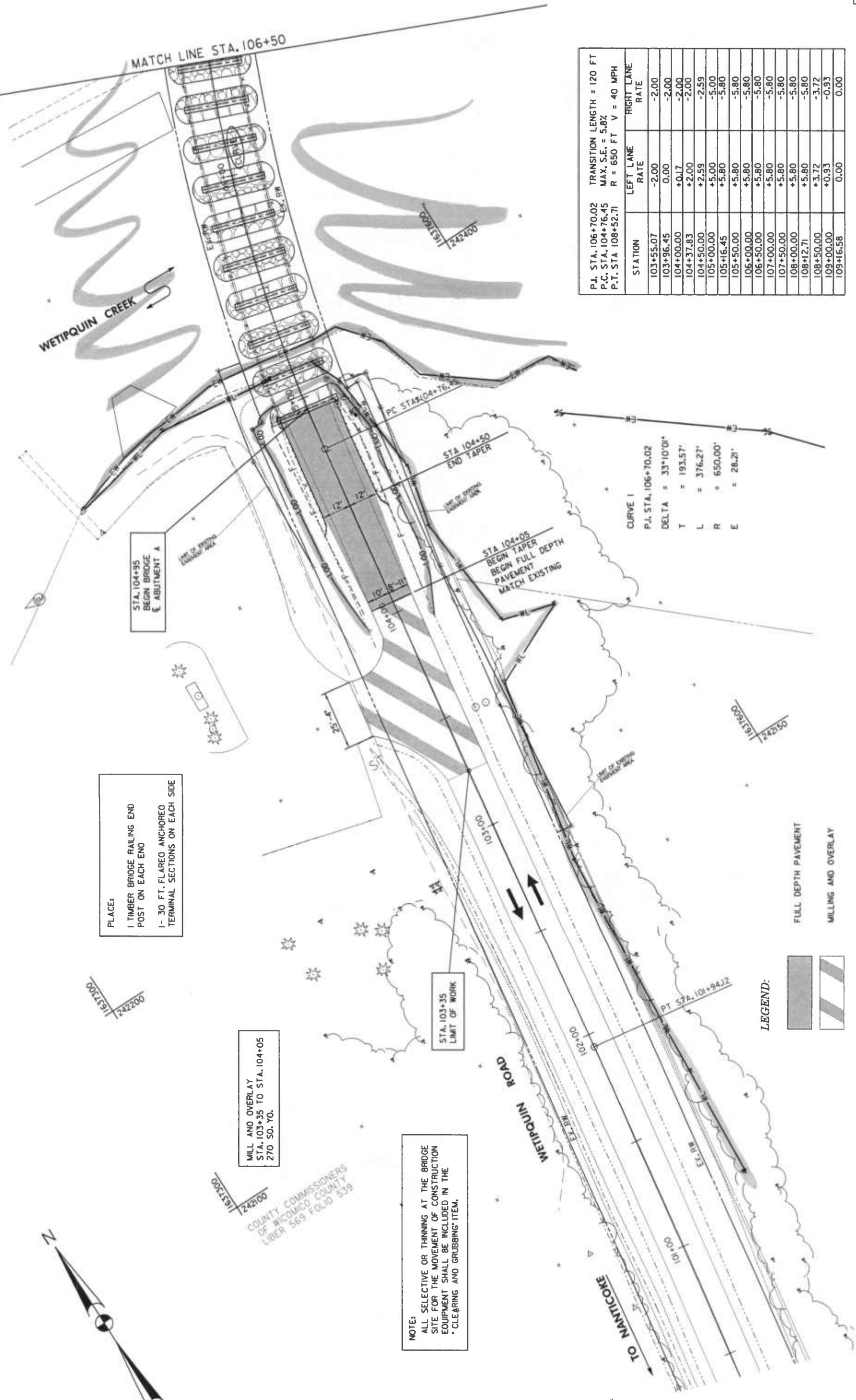

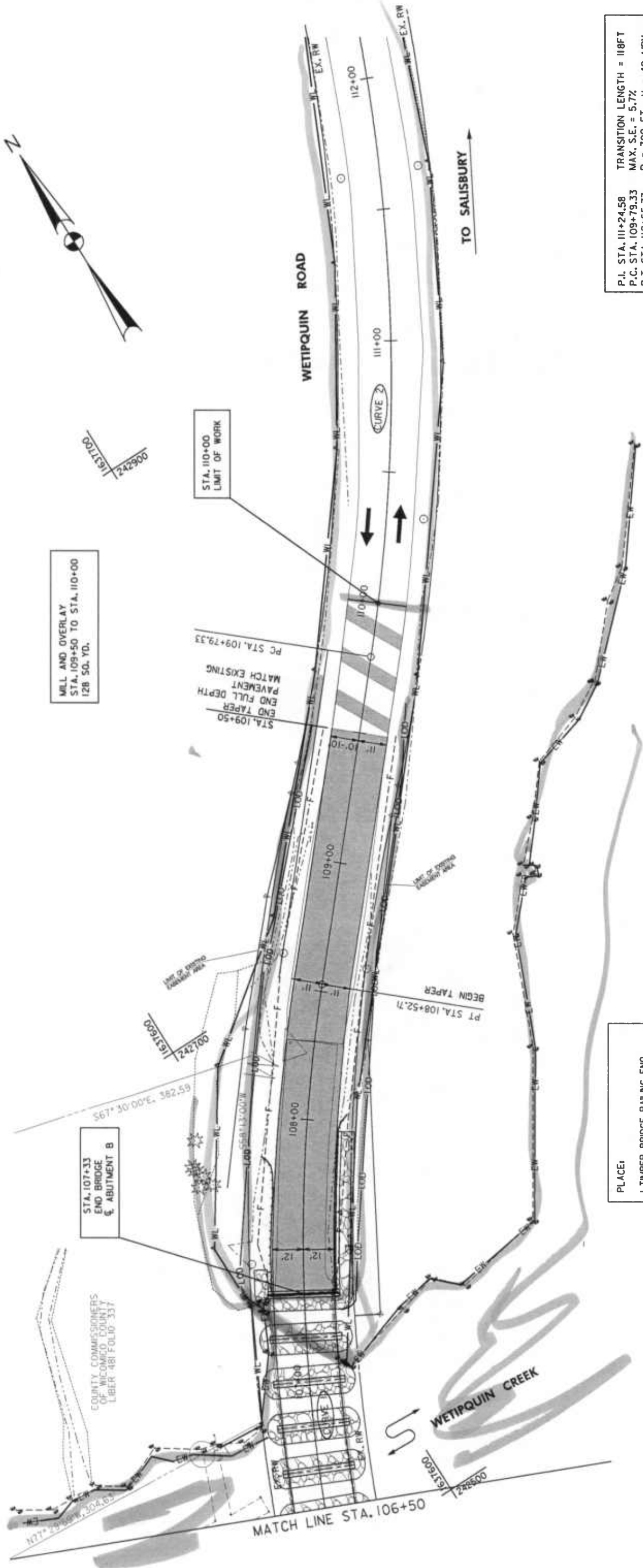

MILL AND OVERLAY  
STA. 109+50 TO STA. 110+00  
128 50. YD.

STA. 110+00  
LIMIT OF WORK

163700  
242900

STA. 107+33  
END BRIDGE  
& ABUTMENT B

COUNTY COMMISSIONERS  
OF WICOMICO COUNTY  
LIBER 481 FOLIO 337

PC STA. 109+79.33  
MATCH EXISTING  
PAVEMENT  
END FULL DEPTH  
END TAPER  
STA. 109+50

BEGIN TAPER  
PT STA. 108+52.71

MATCH LINE STA. 106+50

TO SALISBURY

PLACE:  
1- TIMBER BRIDGE RAILING END  
POST ON EACH END  
1- 30 FT. FLAREO ANCHOREO  
TERMINAL SECTIONS ON EACH SIDE

- LEGEND:**
- FULL DEPTH PAVEMENT
  - MILLING AND OVERLAY
  - EXISTING RIGHT OF WAY
  - APPROXIMATE LIMITS OF WETLAND
  - INDICATES EDGE OF WATER
  - INDICATES CUT AND FILL LIMITS



SCALE { PLAN: 1" = 20'-0"

CURVE 2  
P.I. STA. 111+24.58  
DELTA = 23° 26' 42"  
T = 145.25'  
L = 286.44'  
R = 700.00'  
E = 14.91'

STATION	LEFT LANE RATE	RIGHT LANE RATE
109+16.58	0.00	0.00
109+50.00	-1.87	+1.87
110+00.00	-4.66	+4.66
110+18.66	-5.70	+5.70
110+50.00	-5.70	+5.70
111+00.00	-5.70	+5.70
111+50.00	-5.70	+5.70
112+00.00	-5.70	+5.70
112+26.44	-5.70	+5.70
113+00.00	-4.56	+4.56
113+03.04	-2.15	+2.15
113+44.44	-2.00	+2.00
113+50.00	-2.00	0.00
113+85.84	-2.00	-2.00

P.I. STA. 111+24.58    TRANSITION LENGTH = 118FT  
P.C. STA. 109+79.33    MAX. S.E. = 5.7%  
P.T. STA. 112+65.77    R = 700 FT    V = 40 MPH

REVISIONS

**WR&A**  
Whitman, Reardon and Associates, LLP  
Engineers, Architects and Planners  
80 South Caroline Street  
Baltimore, Maryland 21201  
410-238-3400

**RMA**  
RAJAN MAHIMA ASSOCIATES, INC.  
CONSULTING ENGINEERS  
Rockville, Maryland 20850

WICOMICO COUNTY  
DEPARTMENT OF PUBLIC WORKS  
SALISBURY, MARYLAND  
REPLACEMENT OF BRIDGE NO. W4781  
ON WETIPQUIN ROAD  
OVER WETIPQUIN CREEK  
ROADWAY PLAN - 2

C-6 OF C-14

CONT. NO. \_\_\_\_\_ SEE TITLE SHEET \_\_\_\_\_  
PREL. TRAC. BY \_\_\_\_\_ RIB \_\_\_\_\_ F.A.P. NO. \_\_\_\_\_  
SHEET NO. 7 OF 21

Partners:

Joseph S. Makar  
John S. Maynes  
David B. McCormick  
Dennis J. Hasson

Senior Associates:

James O. Armacost, III  
Louis W. Kliefelder  
Thomas J. Hannan, Jr.  
John P. Maddox  
William P. Wagner  
Walter P. Miller  
Daniel J. Seli  
Anthony U. Olsen  
Robert J. Krellinger

# WHITMAN, REQUARDT AND ASSOCIATES, LLP

*Engineers, Architects and Planners*

801 South Caroline Street  
Baltimore, Maryland 21231

(410) 235-3450

Fax: (410) 243-5716

www.wrallp.com

February 28, 2006

Associates:

Richard J. Kene  
Earl L. Swertzendruber, Jr.  
Herbert W. Lew  
Luther E. Bathurst  
John D. Emerson  
Gary B. Bush  
William W. Fitchett, Jr.  
Gregory D. Mucci  
William A. Geschrei  
J. Mark Perker  
Douglas A. Kelso  
Amiteva Podder  
Neil M. Leery  
Gregory King  
Jeffrey F. Gize  
Jeffrey R. Riegner  
Charles E. Henck  
Keren L. Moren  
Jeson D. Cosler  
J. Andrew Lendrum  
William J. Spyhelski  
William T. Timberleke  
Robert D. Britt

Mr. Jim Sharp  
Chesapeake Bay Critical Area Planner  
Wicomico County  
Department of Planning, Zoning and  
Community Development  
P.O. Box 870  
Salisbury, MD 21803-0870

Re: Wetipquin Road Bridge, No. WI-4781  
Over Wetipquin Creek  
Wicomico County, MD  
WR&A WO #31474-06

**RECEIVED**  
**PLANNING DEPARTMENT**  
**RECEIVED** MAR 07 2006  
DATE 3/2/06 BY bt CRITICAL AREA COMMISSION

Dear Mr. Sharp:

The Wicomico County Department of Public Works and Transportation Division of Engineering Services is proposing the replacement of Bridge No. WI-4781 along a portion of Wetipquin Road over Wetipquin Creek in Wicomico County, Maryland.

On behalf of Wicomico County, Whitman, Requardt and Associates is gathering information on the potential environmental impacts of the proposed Wetipquin Road Bridge No. WI-4781 replacement project. Enclosed is the following information:

- Complete set of construction plans, showing wetlands, natural features, limits of disturbance, and the sediment and erosion control plans.
- USGS 7.5 minute Quadrangle
- FEMA Flood Insurance Rate Map
- USGS National Wetlands Map
- Tidal Wetlands license and permit issued by MDE February 9, 2004
- State Agency responses regarding rare, threatened or endangered species and cultural resources

The proposed bridge will be the same foot print as the existing bridge and will not add any new impervious areas. Tree removal and vegetation disturbance is not expected during construction, as demonstrated on the enclosed plan (see sheet 5 of 14). Please note: the project engineering design has been modified slightly since the original wetlands license and permit issuance. However, impacts have not changed. We plan to apply for a modification of the current wetlands license and permit.



Please review the project information to confirm it satisfies the requirements of the Wicomico County Critical Area Program. If you have any questions regarding the project, please do not hesitate to call me at (443) 224-1633 or email me at lcallens@wrallp.com.

Very truly yours,  
WHITMAN, REQUARDT AND ASSOCIATES, LLP



Laura Callens  
Environmental Scientist

Enclosures

cc: Peter Anamasi/Aaron Keel, WR&A