

MSA.S.1829 5943

cc 11/30/06
lac 3/29/07
lac 10/25/07
MT 3/31/08

57

Martin O'Malley
Governor

Anthony G. Brown
Lt. Governor



Margaret G. McHale
Chair

Ren Serey
Executive Director

STATE OF MARYLAND
CRITICAL AREA COMMISSION
CHESAPEAKE AND ATLANTIC COASTAL BAYS

1804 West Street, Suite 100, Annapolis, Maryland 21401
(410) 260-3460 Fax: (410) 974-5338
www.dnr.state.md.us/criticalarea/

March 31, 2008

Ms. Jennifer Jackson
Queen Anne's County
Department of Land Use, Growth Management
and Environment
160 Coursevall Drive
Centerville, MD 21617

RE: Corsica River Sailing Center – Revision

Dear Ms. Rhodes:

Thank you for submitting revised plans for the Corsica River Yacht Club proposed pier and access project. The site is owned by the County and leased by the Club. As stated in the previous letter from this office, we understand that the applicants are requesting a public service exemption under Chapter 18. However, Critical Area requirements will still apply even if an exemption is granted. We are still awaiting a submission from the County, either requesting confirmation of consistency with the County Critical Area Program, or stating that the County will seek a conditional approval from the Critical Area Commission per COMAR 27.02.06. With the understanding that necessary MDE permits are pending, Commission staff has reviewed the most recent information and we have the following comments:

1. In order to qualify as a public water-oriented recreation area, the County should document how the proposed facility meets the legal definition of "public" given the lease and operation of the site by the Corsica River Yacht Club. Resubmitted information from McCrone, Inc references a letter that will be sent from the County. I have not received this letter at this time.
2. Impacts to the Buffer include any disturbance related to the development activity for this project. These impacts must be minimized and any permitted impacts mitigated on a minimum 2:1 ratio for the footprint of disturbance. A Buffer mitigation plan must be provided, including details of the restoration plan for the area of *Phragmites* control.

Ms. Rhodes
March 31, 2008
Page 2 of 2

3. A Buffer violation occurred on this property in 2005 and mitigation at a 3:1 ratio was required. During our site visit, it was apparent that many of the trees planted were dead or dying. Before permitting additional development, the dead or dying trees should be replaced. The applicant should determine how many of the trees are currently surviving and replace the remaining amount of mitigation that has not survived from the former planting requirement.

Thank you for the opportunity to comment on this submittal. If you have any questions or concerns, please contact me at (410) 260-3479.

Sincerely,



Marshall Johnson
Natural Resources Planner

cc: MDE
QC 721-06

Martin O'Malley
Governor

Anthony G. Brown
Lt. Governor



Margaret G. McHale
Chair

Ren Serey
Executive Director

**STATE OF MARYLAND
CRITICAL AREA COMMISSION
CHESAPEAKE AND ATLANTIC COASTAL BAYS**

1804 West Street, Suite 100, Annapolis, Maryland 21401

(410) 260-3460 Fax: (410) 974-5338

www.dnr.state.md.us/criticalarea/

October 25, 2007

Ms. Jennifer Rhodes
Queen Anne's County Planning & Zoning
160 Coursevall Drive
Centreville, MD 21617

RE: Corsica River Sailing Center – Revision #2

Dear Ms. Rhodes:

Thank you for submitting revised plans for the Corsica River Yacht Club proposed pier and access project. The site is owned by the County and leased by the Club. As stated in the previous letter from this office, we understand that the applicants are requesting a public service exemption under Chapter 18. However, Critical Area requirements will still apply even if an exemption is granted. We are still awaiting a submission from the County, either requesting confirmation of consistency with the County Critical Area Program, or stating that the County will seek a conditional approval from the Critical Area Commission per COMAR 27.02.06. With the understanding that necessary MDE permits are pending, Commission staff has reviewed the most recent information and we have the following comments:

1. If the County wishes to submit the project as a "public beach or other water-oriented recreation or education area," it must be documented that the project is consistent with Chapter 14:1-46. Such facilities may be permitted in the Buffer in the RCA if conditions of County Code § 14:1-46.B 1-5 are met. Additionally, in order to qualify as a public water-oriented recreation area, the County should document how the proposed facility meets the legal definition of "public" given the lease and operation of the site by the Corsica River Yacht Club.
2. The project must meet all of the provisions of Chapter 14:1-39, Development Standards in Resource Conservation Areas. This includes the 15% impervious surface limit, protection of steep slopes, limits on forest/woodland clearing and protection of Habitat Protection Areas. Habitat Protection Areas include the Buffer.

TTY for the Deaf

Annapolis: (410) 974-2609 D.C. Metro: (301) 586-0450

3. Please confirm that all proposed improvements are shown on the site plan. Please note that there is no access path to the pier through the Buffer.
4. Please submit documentation that any requirements of the Wildlife and Heritage Service for waterfowl concentration areas have been met by the proposal as requested in the submitted DNR letter.
5. Impacts to the Buffer must be minimized and any permitted impacts mitigated on a minimum 2:1 ratio for the footprint of disturbance. A Buffer mitigation plan must be provided, including details of the restoration plan for the area of *Phragmites* control.
6. A Buffer violation occurred on this property in 2005 and mitigation at a 3:1 ratio was required. During our site visit, it was apparent that many of the trees planted were dead or dying. Before permitting additional development, the dead or dying trees should be replaced.

Thank you for the opportunity to comment on this submittal. If you have any questions or concerns, please contact me at (410) 260-3479.

Sincerely,



for Marshall Johnson
Natural Resources Planner

cc: Tressa Ellis, MDE
QC721-06



STATE OF MARYLAND
CRITICAL AREA COMMISSION
CHESAPEAKE AND ATLANTIC COASTAL BAYS

1804 West Street, Suite 100, Annapolis, Maryland 21401
(410) 260-3460 Fax: (410) 974-5338
www.dnr.state.md.us/criticalarea/

March 29, 2007

Ms. Jean Fabi
Queen Anne's County Planning & Zoning
160 Coursevall Drive
Centreville, MD 21617

RE: Corsica River Sailing Center – Revision #1

Dear Ms. Fabi:

This office is in receipt of revised plans for the proposed access road and turn-around on County land that is leased by the Corsica River Yacht Club. Commission staff also visited the site with the applicants, Nancy Scozzari of Recreation and Parks, and Lee Schnappinger of McCrone, Inc. We understand that the applicants are requesting a public service exemption under Chapter 18. However, Critical Area requirements will still apply even if an exemption is granted.

The project can be handled in one of two ways, depending upon a determination of consistency with the County's Critical Area ordinance. If the project is determined by the Planning Department to be consistent with Chapter 14:1, then documentation of that consistency determination must be provided to the Commission for verification (see enclosed COMAR 27.02.02). If the project is not found to be consistent with all applicable provisions, the applicant may seek a conditional approval from the Critical Area Commission (see enclosed COMAR 27.02.06).

With the understanding that necessary MDE permits are pending, Commission staff has reviewed the most recent information and we have the following comments:

1. The project must meet all of the provisions of Chapter 14:1-39, Development Standards in Resource Conservation Areas. This includes the 15% impervious surface limit, protection of steep slopes, limits on forest/woodland clearing and protection of Habitat Protection Areas. Habitat Protection Areas include the Buffer as well as any other habitats that may be identified by the Heritage Program with the Department of Natural Resources. Documentation from the Department of Natural Resources has not been provided.

Ms. Jean Fabi
March 29, 2007
Page 2 of 2

2. In addition, the project, as a "public beach or other water-oriented recreation or education area", must be consistent with Chapter 14:1-46. Such facilities may be permitted in the Buffer in the RCA provided that adequate sanitary facilities exist (among other things). It is not clear if sanitary facilities exist or are proposed in the vicinity of this site. This should be verified.
3. In order to qualify as a public water-oriented recreation area, the County should document how the proposed facility meets the legal definition of "public" given the lease and operation of the site by the Corsica River Yacht Club.
4. Impacts to the Buffer must be minimized and any permitted impacts mitigated on a minimum 2 to 1 ratio for the footprint of disturbance. A Buffer mitigation plan must be provided.
5. As we discussed in the field, a restoration plan for the area of *Phragmites* control should be provided.
6. We have concerns about the long-term viability of the gravel surface with the sand substrate. A significant storm event could easily inundate much of the access road. Waves hitting along the hardened outer edge of the circle could cause significant scouring and create an erosion problem when one does not currently exist.
7. Lastly, a Buffer violation occurred on this property in 2005 and mitigation at a 3:1 ratio was required. During our site visit, it was apparent that many of the trees planted were dead or dying. Before permitting additional development, we strongly recommend that dead or dying trees be replaced at the cost of the Yacht Club.

Thank you for the opportunity to comment on this submittal. If you have any questions or concerns, please contact me at (410) 260-3477.

Sincerely,



LeeAnne Chandler
Science Advisor

cc: Tressa Ellis, MDE
Nancy Scozzari
QC721-06

Robert L. Ehrlich, Jr.
Governor

Michael S. Steele
Lt. Governor



Martin G. Madden
Chairman

Ren Serey
Executive Director

**STATE OF MARYLAND
CRITICAL AREA COMMISSION
CHESAPEAKE AND ATLANTIC COASTAL BAYS**

1804 West Street, Suite 100, Annapolis, Maryland 21401
(410) 260-3460 Fax: (410) 974-5338
www.dnr.state.md.us/criticalarea/

November 28, 2006

Mr. Steve Cohoon
Queen Anne's County
Department of Planning and Zoning
160 Couresevall Drive
Centreville, MD 21617

RE: Corsica River Sailing Center

Dear Mr. Cohoon:

Thank you for the information concerning the intent of the above applicant to seek input from the Critical Area Commission related to the recent submission of site plans for an access road and pier configuration on lands owned by the Commissioners of Queen Anne's County. The subject site is part of a 227.5 acre± parcel located on Queen Anne's County Tax Map 27, Grid 18, Parcel 6. The access would intrude through the Critical Area Buffer toward the Corsica River and is intended to allow access to the water for the public as an educational facility with handicapped capabilities. The Commission staff believes this can qualify as a water dependent facility. Based on the site plan provided we offer the following comments:

1. As a water dependent facility the subject site would be required to conform to all aspects of COMAR 27.01.03.04 and the applicant should be prepared to make findings addressing these requirements.
2. Similarly, the applicant will be required to address Queen Anne's County Critical Area Code § 14:1-46.B. In particular, the following requirements must be addressed:
 - Adequate sanitary facilities exist;
 - Service facilities are, to the extent possible, located outside the Buffer;
 - Disturbance to natural vegetation is minimized

3. Can the project design be further minimized to cause less disturbance? (i.e. roadway width, road location, road type and style of turnaround?)
4. Does the road need to access the tidal wetlands or could the piers be extended to an upland portion of the site?
5. Please be advised that mitigation at a ratio of 2:1 will be required for all areas of disturbance in the Buffer.
6. Would the County require a variance for the portion of the development on steep slopes?
7. How will stormwater on the site be controlled?
8. Commission staff would like to conduct a site visit before any further site plans are prepared.

Thank you for the opportunity to review this project. If you have any further questions or comments please call me directly at 410-260-3476.

Best regards,



Chris Clark
Natural Resources Planner

cc: QC721-06

CRITICAL AREA DEVELOPMENT PLAN FOR PROPOSED CORSICA RIVER SAILING CENTER

FOURTH ELECTION DISTRICT, QUEEN ANNE'S COUNTY, MARYLAND
PREPARED FOR : CORSICA RIVER YACHT CLUB

DEVELOPERS CERTIFICATE

I HEREBY CERTIFY THAT: 1. ANY CLEARING, GRADING, CONSTRUCTION OR DEVELOPMENT, OR ALL OF THESE, WILL BE DONE PURSUANT TO THIS PLAN AND; 2. THAT RESPONSIBLE PERSONNEL INVOLVED IN THE CONSTRUCTION WILL HAVE A CERTIFICATE OF TRAINING AT A DEPARTMENT OF ENVIRONMENT APPROVED TRAINING PROGRAM FOR THE CONTROL OF SEDIMENT AND EROSION BEFORE BEGINNING THE PROJECT; AND 3. THE DEVELOPER WILL PROVIDE THE DISTRICT ONE COPY OF A RED LINE AS-BUILT DRAWING OF EACH STORMWATER MANAGEMENT FACILITY.

IT WILL BE THE RESPONSIBILITY OF THE CONTRACTOR OR THE SUBCONTRACTOR TO NOTIFY THE ENGINEER OF ANY DEVIATION FROM THIS PLAN. ANY CHANGE MADE IN THIS PLAN WITHOUT WRITTEN AUTHORIZATION FROM THE ENGINEER WILL PLACE RESPONSIBILITY FOR SAID CHANGE ON THE CONTRACTOR OR SUBCONTRACTOR.

SIGNATURE: Steve Davis DATE: 11/14/08
STEVE DAVIS
QUEEN ANNE'S COUNTY PARKS & RECREATION
P.O. BOX 37
1945 4-H PARK ROAD
CENTREVILLE, MD 21617
410-758-1419

SITE NOTES

- FOR DEED REFERENCE, SEE S.M. 642/438
- PROPERTY IS ZONED COUNTRYSIDE DISTRICT (CS).
- SITE IS LOCATED IN THE CHESAPEAKE BAY CRITICAL AREA, AND IS DESIGNATED RCA.
- SOIL TYPES ON SITE ARE: UoB - UNICORN SILT LOAM, 2-5% SLOPES
PIA - PINEYNECK SILT LOAM, 0-2% SLOPES
Ho - HONGA PEAT, HYDRIC SOILS
TAKEN FROM THE U.S. DEPARTMENT OF AGRICULTURE SCS SOIL SURVEY OF QUEEN ANNE'S COUNTY, MARYLAND, UPDATED IN 2002.
- THIS SITE IS LOCATED WITHIN THE 100 YEAR FLOOD PLAIN ACCORDING TO THE FEDERAL EMERGENCY MANAGEMENT AGENCY'S F.I.R.M. MAP FOR QUEEN ANNE'S COUNTY, PANEL NO. 240054 0025 B, DATED: JUNE 16, 1992.
- EXISTING TOPOGRAPHY SHOWN HEREON IS THE RESULT OF A FIELD RUN SURVEY BY McCRONE, INC., DATED: SEPTEMBER 6, 2005, IN COMBINATION WITH FLOWN TOPOGRAPHY OF THE CONQUEST AREA FOR QUEEN ANNE'S COUNTY.
- TIDAL WETLANDS SHOWN HAVE BEEN TAKEN FROM THE 1972 NON-TIDAL INVENTORY AND ARE NOT FIELD DELINEATED.
- THIS SITE IS SERVED BY A PRIVATE WELL. THERE IS A PORTABLE SEWAGE DISPOSAL FACILITY.
- NO FUEL DOCKS OR GASOLINE STORAGE TANKS ARE PROPOSED.
- THE PROPOSED PIER DOES WILL NOT ALTER WATER CIRCULATION PATTERNS OR SALINITY REGIMES ALONG ANY PORTION OF THE CHANNEL AND WILL CONTINUE TO ALLOW ADEQUATE FLUSHING AS THE PIER WILL BE SUPPORTED BY ADEQUATELY SPACED PILING AND NO BARRIERS ARE PROPOSED IN THE WATER.
- NO SUBMERGED AQUATIC BEDS ARE HISTORICALLY LOCATED IN THE AREA OF THE PROPOSED PIER. DISTURBANCE TO WETLANDS HAS BEEN MINIMIZED TO INCLUDE ONLY THAT SMALL AREA WHERE THE PIER CONNECTS TO THE SHORELINE, BETWEEN THE MEAN HIGH WATER LINE AND THE EXISTING BANK.
- THERE WILL BE NO ADDITIONAL NON-POINT SOURCE RUNOFF ON SITE. THE AREA IS ALREADY USED AS A LAUNCH FOR SAILBOATS AND WILL CONTINUE AS SUCH. ADDITIONAL IMPERVIOUS IS NOT PROPOSED. SEWAGE IS CURRENTLY HANDLED BY A PORTABLE SEWAGE FACILITY AND SAILBOATS USED BY THE CLUB DO NOT HAVE RESTROOM FACILITIES.
- THERE IS AN EXISTING SHELLFISH SANCTUARY ADJACENT TO THE SITE. A PORTION OF THIS BED HAS BEEN SEEDED AS SHOWN ON THE SITE PLAN. THE PROPOSED PIER DOES NOT IMPACT THE SEEDED OYSTER BED.
- THERE IS NO DREDGING PROPOSED FOR THE CONSTRUCTION OF THIS PIER.
- THERE WILL BE NO INTERFERENCE WITH THE NATURAL TRANSPORT OF SAND. THE PIER CONNECTS TO SHORE ABOVE THE MEAN HIGH WATER LINE AND WILL NOT BLOCK AND LENGTH OF THE SHORELINE.
- THE SITE IS ADJACENT TO OPEN WATERS THAT ARE KNOWN HISTORIC WATERFOWL CONCENTRATION AREAS. THE PROPOSED PROJECT PROJECTS LESS THAN 150' INTO OPEN WATER AND IS NOT SUBJECT TO RESTRICTIONS.

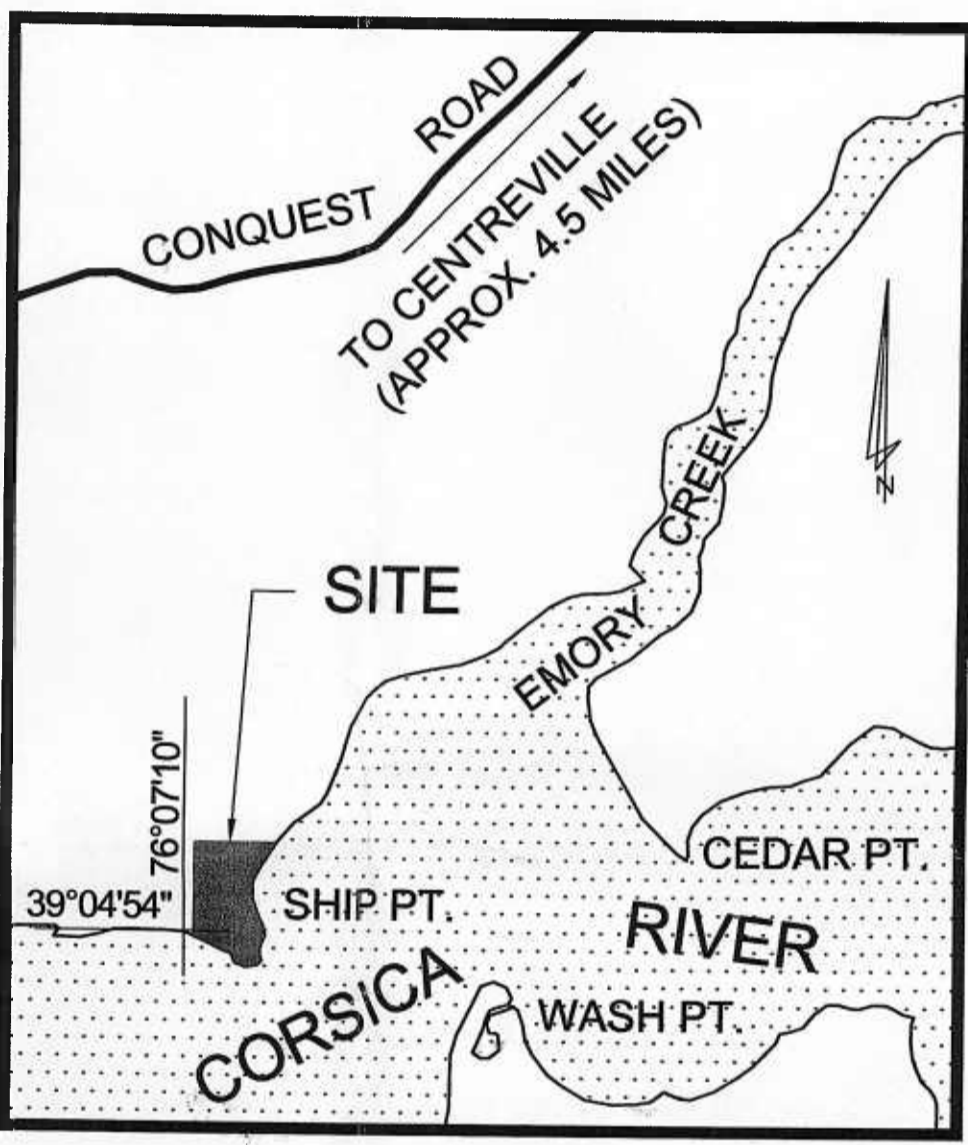

VICINITY MAP
SCALE: 1" = 1,000'

NOTE: INFORMATION FOR THE VICINITY MAP TAKEN FROM THE 1954 USGS QUADRANGLE OF CENTREVILLE, MD (PHOTOREVISED 1973) AND ACD ROAD MAP OF QUEEN ANNE'S COUNTY, 8TH EDITION)

DEVELOPER

CORSICA RIVER YACHT CLUB
P.O. BOX 24
CENTREVILLE, MD 21617
C.O. FITZ TURNER, B.O.D.
410-827-8877
QUEEN ANNE'S COUNTY PARKS & RECREATION
P.O. BOX 37
1945 4-H PARK ROAD
CENTREVILLE, MD 21617
410-758-1419

OWNER

COMMISSIONERS OF QUEEN ANNE'S COUNTY
107 NORTH LIBERTY STREET
CENTREVILLE, MD 21617
410-758-4098

ENGINEER/SURVEYOR

McCRONE, INC.
207 N. LIBERTY STREET
CENTREVILLE, MARYLAND 21617
410-758-2237

STATEMENT OF PURPOSE AND INTENT

THE PURPOSE OF THIS PLAN IS TO CREATE A FULLY HANDICAPPED-ACCESSIBLE FIXED AND FLOATING PIER COMBINATIONS FOR USE BY THE CORSICA RIVER SAILING CENTER. COMPLETION OF THIS PROJECT WILL PROVIDE THE ONLY FULLY ACCESSIBLE BOAT LAUNCH ON THE EASTERN SHORE OF MARYLAND. THE TIDAL WETLAND ON THE SITE IS CURRENTLY COVERED ALMOST ENTIRELY WITH PHRAGMITES WHICH THE CORSICA RIVER YACHT CLUB PROPOSES TO REMOVE AND CONTROL AS PART OF THE PROJECT. TIDAL WETLAND RESTORATION IS ALSO PROPOSED AS PART OF THE MITIGATION FOR THE PIER.

THE PROPOSED PROJECT WILL SERVE AS A WATER ACCESS POINT FOR INDIVIDUALS OF ALL MOBILITY LEVELS THAT WISH TO SAIL AND, ALTHOUGH NOT OPEN TO THE PUBLIC AT ALL TIMES, WILL BE AVAILABLE FOR USE BY THE PUBLIC.

PARKING CALCULATIONS

PER MARINA PARKING REQUIREMENTS	
SLIPS PROPOSED (EACH 20' OF PROPOSED PIER)	= 19
PARKING SPACES REQUIRED (1 PER 2 SLIPS)	= 10
TRAILER PARKING SPACES REQUIRED (8 PER LAUNCH)	= 8
EMPLOYEE PARKING SPACES REQUIRED	= 0

EACH REGULAR PARKING SPACE TO BE 9' X 18' FOR A TOTAL OF 1,620 SQ. FT. OF PARKING AREA. EACH TRAILER PARKING SPACE TO BE 10' X 40' FOR A TOTAL OF 3,200 SQ. FT. OF TRAILER PARKING AND STORAGE AREA. THESE AREAS ARE ON THE LAYOUT PLAN TO SHOW THAT THERE IS ADEQUATE SPACE OUTSIDE OF THE 100' BUFFER AND ACCOUNT FOR THIS EXISTING IMPERVIOUS AREA IN THE CALCULATIONS. BECAUSE THIS AREA IS GRASS, PARKING AND/OR STORAGE MAY NOT OCCUR IN THESE EXACT LOCATIONS.

WETLAND CALCULATIONS

TOTAL TIDAL WETLAND TO BE DISTURBED	= 0.004 AC.±
PERMANENT DISTURBANCE	= 0.004 AC.±
TOTAL TIDAL WETLAND ON SITE	= 10.587 AC.±
PROPOSED TIDAL WETLAND DISTURBANCE	= 0.0004%
TOTAL NONTIDAL WETLAND ON SITE	= 0.000 AC.±

FLOOD PLAIN CALCULATIONS

AREA OF SITE IN 100 YEAR FLOOD PLAIN	= 46.278 AC.±
PROPOSED DISTURBANCE IN FLOOD PLAIN	= 0.004 AC.±
DISTURBANCE IN FLOOD PLAIN	= 0.0001%

PARCEL 6 - SITE STATISTICS

CURRENT ZONING - CS - COUNTRYSIDE DISTRICT FOR DEED REFERENCE. SEE S.M. 642/438
SITE IS LOCATED WITHIN THE 100-YEAR FLOODPLAIN
PROPOSED USE - WATER-ORIENTED RECREATION AND EDUCATION AREA
TAX MAP 27, BLOCK 18, PARCEL 6

CRITICAL AREA IMPERVIOUS CALCULATIONS

	ACTUAL	ROUNDED
SITE AREA	= 9,908,811 sq. ft.	(227.475 AC.±)
SITE AREA IN CRITICAL AREA	= 5,332,896 sq. ft.	(122.426 AC.±)
EXISTING IMPERVIOUS COVER (15%)	= 799,934 sq. ft.	(18.364 AC.±)
EXISTING IMPERVIOUS COVER TO BE REMOVED	= 42,972 sq. ft.	(0.987 AC.±)
PROPOSED IMPERVIOUS COVER	= 0 sq. ft.	(0.000 AC.±)
TOTAL IMPERVIOUS COVER	= 42,972 sq. ft.	(0.987 AC.±)

*INCLUDES THE EXISTING GRAVEL LANE AT 100% IMPERVIOUS.

CRITICAL AREA WOODLAND CALCULATIONS

	ACTUAL	ROUNDED
SITE AREA	= 9,908,811 sq. ft.	(227.475 AC.±)
SITE AREA IN CRITICAL AREA	= 5,332,896 sq. ft.	(122.426 AC.±)
EXISTING FOREST IN THE CRITICAL AREA	= 1,338,082 sq. ft.	(30.718 AC.±)
FOREST REQUIRED (15%)	= 799,934 sq. ft.	(18.364 AC.±)
FOREST TO BE REMOVED	= 0 sq. ft.	(0.000 AC.±)
AFFORESTATION REQUIRED	= 0 sq. ft.	(0.000 AC.±)

INDIVIDUAL TREES MAY BE DISTURBED IN THE CONSTRUCTION OF THE PIER (THERE ARE SOME EXISTING CEDAR TREES). TWO (2) TREES HAVE BEEN PROPOSED TO BE PLANTED FOR MITIGATION. ANY ADDITIONAL DISTURBANCE THAT RESULTS IN THE LOSS OF TREES IN THE CRITICAL AREA WILL ALSO REQUIRE MITIGATION.

CRITICAL AREA DISTURBANCE CALCULATIONS

	ACTUAL	ROUNDED
SITE AREA	= 9,908,811 sq. ft.	(227.475 AC.±)
SITE AREA IN CRITICAL AREA	= 5,332,896 sq. ft.	(122.426 AC.±)
CRITICAL AREA IN RCA	= 5,332,896 sq. ft.	(122.426 AC.±)
PROPOSED DISTURBANCE IN THE RCA	= 195 sq. ft.	(0.004 AC.±)
DISTURBANCE IN THE RCA	= 0.00003 %	

SHEET NO.	DESCRIPTION
1	TITLE SHEET
2	LAYOUT SHEET
3	DETAILS

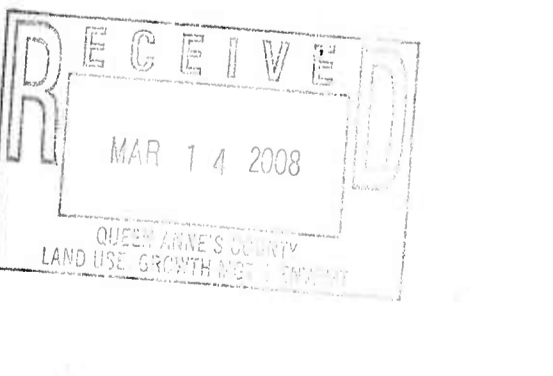

APPROVED BY	DATE	APPROVED BY	DATE
QA Co. COUNTY DEPT OF PUBLIC WORKS	DATE	QA Co. COUNTY DEPT OF PUBLIC WORKS	DATE
REVIEWED BY (FOR SEDIMENT CONTROL REVIEW ONLY)	DATE	REVIEWED BY	DATE
NATURAL RESOURCES CONSERVATION SERVICE	DATE	QA Co. COUNTY SOIL CONSERVATION SERVICE	DATE

REVISIONS			DATE
REV #	DATE	DESCRIPTION	SEPTEMBER, 2006
1	9/27/07	PER AGENCY COMMENTS AND SITE VISIT	JOB NUMBER D1050190
2	11/27/07	PER LGE AND MDE COMMENTS	SCALE NOT APPLICABLE
			DRAWN BY R.C.P.
			DESIGNED BY L.A.S.
			APPROVED BY SEL
			FOLDER REFERENCE 2029

• Engineering • Environmental Sciences
• Construction Services • Land Planning & Surveying

ANNAPOLIS • CENTREVILLE • DOVER • ELKTON • SALISBURY

207 NORTH LIBERTY STREET
CENTREVILLE, MARYLAND 21617
(410) 758-2237 * FAX (410) 758-2464
www.mccrone-inc.com Copyright 2006

TITLE SHEET
FOR
**CORSICA RIVER
SAILING CENTER**

TAX MAP 27, GRID 18, PARCEL 6
THIRD ELECTION DISTRICT, QUEEN ANNE'S COUNTY, MARYLAND
PREPARED FOR: QUEEN ANNE'S COUNTY & THE CORSICA RIVER YACHT CLUB

SHEET NO	1 OF 3
FILE NO	D1050190-01-TITLE SHEET

F:\DWG\2006\1050190 - CORSICA RIVER YACHT CLUB\CONSTRUCTION-907D1050190-01-TITLE SHEET.dwg.....Tab.24 x 36 BOTTOM

PLOTTED: Jan 03, 2008 - 9:00am

F:\DWG\005\01050190 - CORSICA RIVER YACHT CLUB\CONSTRUCTION-9-07\01050190-02-LAYOUT SHEET.dwgTab.24 x 36 BOTTOM lscmappinger
 PLOTTED: Jan 03, 2008 - 9:02am

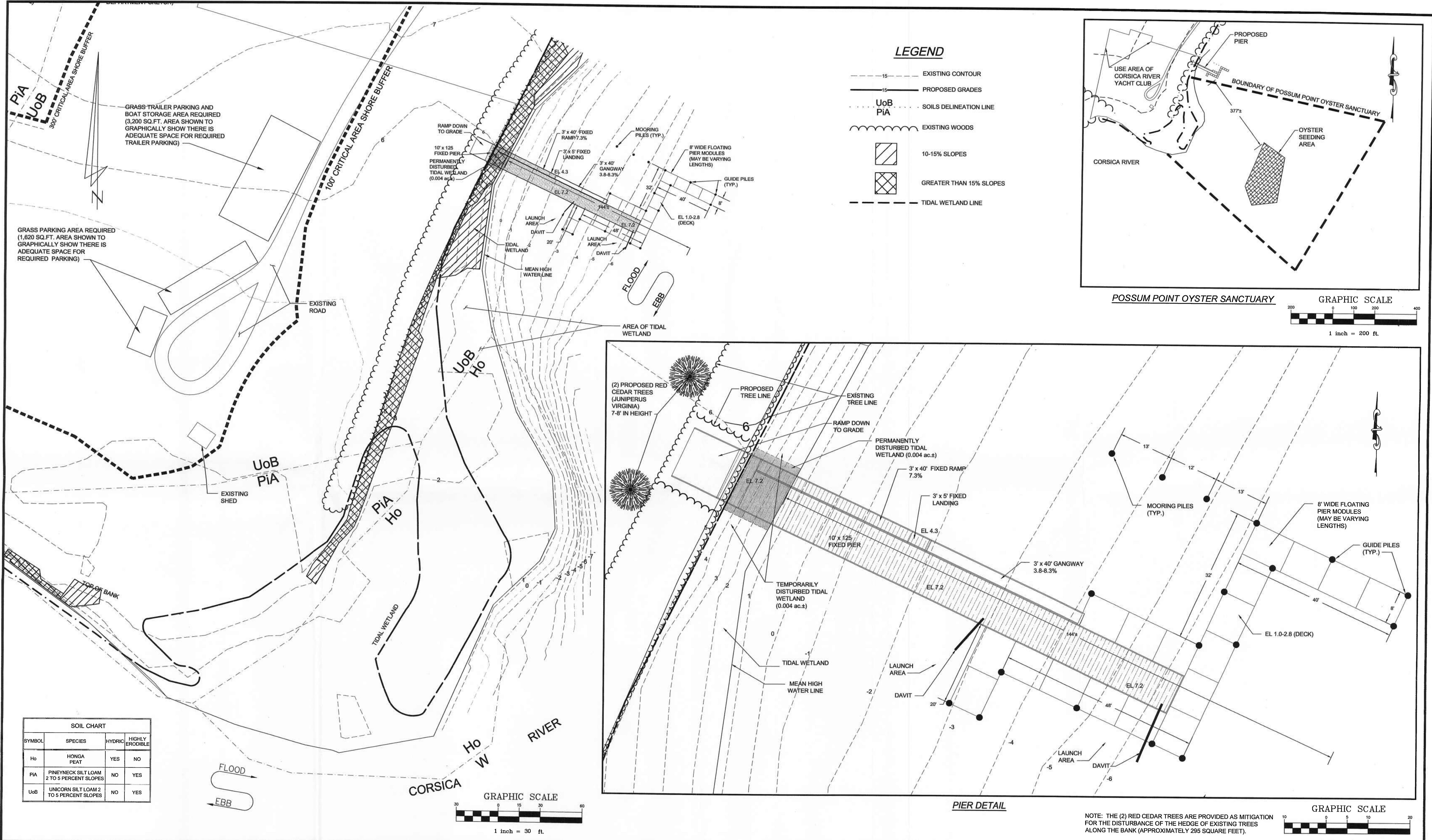

APPROVED BY	APPROVED BY
QA Co. COUNTY DEPT OF PUBLIC WORKS	QA Co. COUNTY DEPT OF PUBLIC WORKS
REVIEWED BY (FOR SEDIMENT CONTROL REVIEW ONLY)	REVIEWED BY
NATURAL RESOURCES CONSERVATION SERVICE	QA Co. COUNTY SOIL CONSERVATION SERVICE

REVISIONS			DATE
REV #	DATE	DESCRIPTION	SEPTEMBER, 2006
1	9/27/07	PER AGENCY COMMENTS AND SITE VISIT	JOB NUMBER D1050190
2	11/27/07	PER LGE AND MDE COMMENTS	SCALE AS SHOWN
			DRAWN BY R.C.P.
			DESIGNED BY L.A.S.
			APPROVED BY SEL
			FOLDER REFERENCE 2029

McCRONE

- Engineering
- Construction Services
- Environmental Sciences
- Land Planning & Surveying

ANNAPOLIS • CENTREVILLE • DOVER • ELKTON • SALISBURY

207 NORTH LIBERTY STREET
CENTREVILLE, MARYLAND 21617
(410) 758-2237 • FAX (410) 758-2464

www.mccrone-inc.com Copyright 2006

LAYOUT SHEET FOR

CORSICA RIVER SAILING CENTER

TAX MAP 27, GRID 18, PARCEL 6
THIRD ELECTION DISTRICT, QUEEN ANNE'S COUNTY, MARYLAND
PREPARED FOR: QUEEN ANNE'S COUNTY & THE CORSICA RIVER YACHT CLUB

SHEET NO **2 OF 3**

FILE NO D1050190-02-LAYOUT SHEET