

MSA-5-1829-5102

lc
3/17/05

Robert L. Ehrlich, Jr.
Governor

Michael S. Steele
Lt. Governor



Martin G. Madden
Chairman

Ren Serey
Executive Director

STATE OF MARYLAND
CRITICAL AREA COMMISSION
CHESAPEAKE AND ATLANTIC COASTAL BAYS
1804 West Street, Suite 100, Annapolis, Maryland 21401
(410) 260-3460 Fax: (410) 974-5338
www.dnr.state.md.us/criticalarea/

March 17, 2005

Ms. Faith Elliott Rossing, Director
Queen Anne's Planning & Zoning
160 Coursevall Drive
Centreville, MD 21617

RE: Consistency Report – Kent Narrows/Stevensville/Grasonville WWTP ENR Upgrade

Dear Ms. Elliott Rossing:

This office has received the information provided on the proposed expansion and upgrade of the wastewater treatment plant (WWTP) on Kent Island. We understand that its capacity will be increased from two million gallons per day (GPD) to three million GPD. Also, construction will include infrastructure necessary to provide enhanced nutrient removal using the latest technology. Stormwater management for the facility is also proposed. The documents indicate that the project area is approximately 27 acres, with the majority being designated an Intensely Developed Area. No Habitat Protection Areas were identified. Permits have been acquired for the non-tidal wetland impacts that are proposed. Commission staff reviewed the information for consistency with the local Critical Area Program in accordance with COMAR 27.02.02.

The primary Critical Area issue for this project is stormwater management (i.e., compliance with the 10% pollutant reduction requirement). An extended detention stormwater pond is proposed as the primary best management practice providing stormwater management. The pond, together with the open areas of the treatment system itself, provide the necessary pollutant removal to meet the 10% pollutant reduction requirement. We note the location of the stormwater facility for the WWTP in a portion of the project site designated RCA. This is permitted by the County's Critical Area Program and §14:1-39(B)(3)(c)[14] of the County Code.

Commission staff concurs with the finding that the proposed project is consistent with the Queen Anne's County Critical Area Program. If you have any questions regarding this matter, please contact me at (410) 260-3477.

Sincerely,

A handwritten signature in cursive script that reads "LeeAnne Chandler".

LeeAnne Chandler
Natural Resources Planner

cc: Alan Quimby, DPW



DEPARTMENT OF PLANNING & ZONING
QUEEN ANNE'S COUNTY
160 COURSEVALL DRIVE
CENTREVILLE, MARYLAND 21617

410-758-4088 Permits
410-758-3972 Fax
410-758-1255 Planning
410-758-2905 Fax
410-758-2126 TDD

Monday, March 14, 2005

Ms. LeAnn Chandler
Critical Area Commission
1804 West Street, Suite 100
Annapolis, MD 21401

**RE: CHAPTER 02 LETTER FOR THE EXPANSION OF THE KENT
NARROWS/STEVENSVILLE/GRASONVILLE (KNS&G) SEWER
TREATMENT PLANT**

Dear Ms. Chandler:

In accordance with Title 27, Chesapeake Bay Critical Area Commission, Subtitle 02, Development in the Critical Area resulting from State and Local Agency Programs, Chapter 02, State and Local Agency Actions Resulting in Development of Local Significance on Private Lands or Lands owned by Local Jurisdictions, Queen Anne's County is submitting for your review the following information pertaining to the expansion and upgrade of the KNS&G wastewater treatment plant located at 310 Bateau Drive in Stevensville from 2MM gpd to 3MM gpd:

1. Plan with existing conditions highlighted in yellow and proposed conditions highlighted orange. (Attachments #1 and #2)
2. Stormwater Management Analysis as provided by the Department of Public Works (Attachment #3)
3. Nontidal Wetlands Jurisdictional Determination and the permits to disturb nontidal wetlands (Attachment #4)

The site is more specifically identified as Tax Map 48, Parcel 131, zoned Suburban Industrial (SI) and has a Critical Area IDA overlay. As previously noted, approximately 2400 sq. ft. of the new plant will be constructed on adjacent County lands zoned Countryside (CS) with a RCA Critical Area Designation.

Major components of the existing wastewater treatment facilities are a septage receiving lagoon, primary clarification, secondary treatment utilizing rotating biological contractors (RBC), final clarification, chlorination, dechlorination, re-aeration, sludge handling with aerobic digesters, drying beds, flow equalization lagoon, and an emergency storage lagoon. Due to the outfall's location within shellfish waters, an emergency storage lagoon capable of holding 24 hours of flow is required.

Construction is underway to replace the existing 2.0 Mgd RBC treatment train and clarifiers with a 3.0 Mgd activated sludge treatment plant capable of achieving Enhanced Nutrient Removal in accordance with the goals of the Chesapeake Bay nutrient reduction initiatives. Other major new components being grit removal, secondary clarifiers, dynamic sand filters, and UV disinfection. This construction should be complete by 2007.

The information provided should be helpful in your review; however, if you have any additional questions, please do not hesitate to contact me at 410-758-1255.

Sincerely,

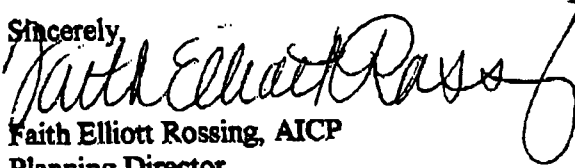

Faith Elliott Rossing, AICP
Planning Director

CC: Steve Walls, Director Department of Public Works
Alan Quimby, Chief Sanitary Engineer
Paul Comfort, Esq., County Administrator



DEPARTMENT OF PLANNING & ZONING
QUEEN ANNE'S COUNTY
160 COURSEVALL DRIVE
CENTREVILLE, MARYLAND 21617

410-758-4088 Permits
410-758-3972 Fax
410-758-1255 Planning
410-758-2905 Fax
410-758-2126 TDD

Friday, March 11, 2005

Ms. LeeAnn Chandler
Critical Area Commission
1804 West Street, Suite 100
Annapolis, MD 21401

RE: Chapter 2 Letter for the Expansion of the Kent Narrows/Stevensville/Grasonville (KNS&G) Sewer Treatment Plant

Dear Ms. Chandler:

This letter is intended to fulfill the reporting requirements for development in the Critical Area resulting from what will ultimately be a local government project.

The County Commissioners are proposing to upgrade and expand the existing wastewater treatment plant located at 310 Bateau Drive in Stevensville from 2MM gpd to 3MM gpd

The site is more specifically identified as Tax Map 48, Parcel 131, zoned Suburban Industrial (SI) and has an IDA overlay.

A copy of the overall site plan, as requested, is attached for your review.

Please provide a written response that the Critical Area Commission concurs with staff's findings that this project is consistent with our program.

Should you have any questions, please do not hesitate to contact me at your convenience.

Sincerely,

Faith Elliott Rossing
Planning Director

Cc: PC, RW, SW, SC, File

RECEIVED

MAR 11 2005

CHESAPEAKE BAY
CRITICAL AREA COMMISSION

MATCH LINE 'A-A' FOR CONTINUATION SEE DWG. C-3

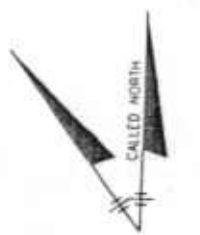

Bldg 2 - B04-1330 existing
 Bldg 3 - B04-1329
 Bldg 4 - B04-1331
 Bldg 5 - B04-1328
 Bldg 6 - B04-1326
 Bldg 7 - B04-1327

↓ REA
 New

→ 10% calcs
 → JD @ Public Works office
 → Some non-tidal wetland impacts
 George Boston } MDE
 Bob Cooper }
 → 25' Buffer from non-tidal

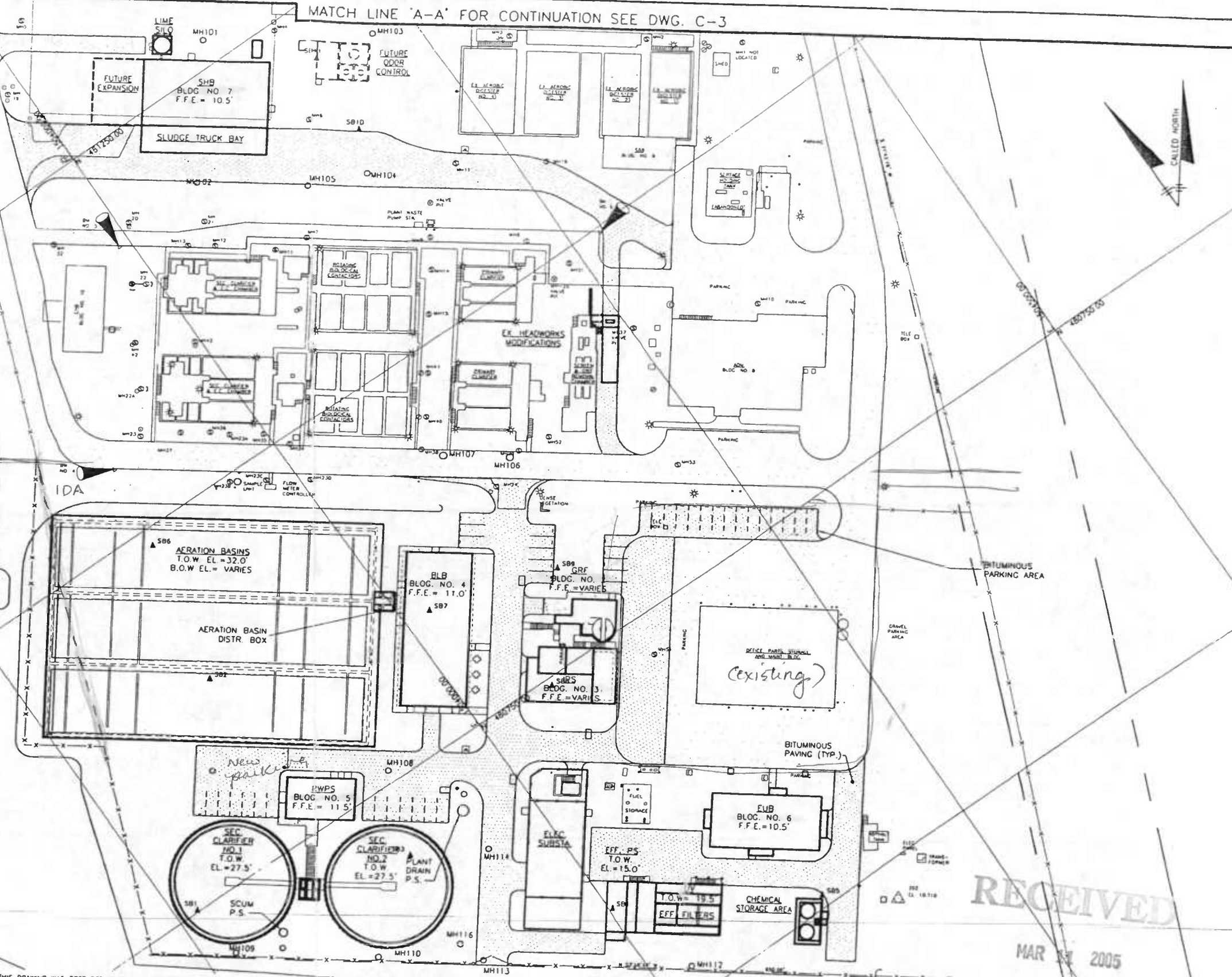

THIS DRAWING WAS PREPARED AT THE SCALE INDICATED IN THE TITLE BLOCK. INACCURACIES IN THE STATED SCALE MAY BE INTRODUCED WHEN DRAWINGS ARE REPRODUCED BY ANY MEANS. USE THE GRAPHIC SCALE BAR IN THE TITLE BLOCK TO DETERMINE THE ACTUAL SCALE OF THE DRAWING.

IT IS A VIOLATION OF LAW FOR ANY PERSON, UNLESS ACTING UNDER THE DIRECTION OF A LICENSED ENGINEER, TO ALTER THIS DOCUMENT.

RECEIVED
 MAR 11 2005

The DEPARTMENT of PUBLIC WORKS
 of
QUEEN ANNE'S COUNTY
 MARYLAND

APPROVED	
QUEEN ANNE'S COUNTY DEPARTMENT OF PUBLIC WORKS	
NAME	DATE
NAME	DATE



O'BRIEN & GERE
 ENGINEERS INC.



NO	DATE	REVISION	INIT.

KENT NARROWS/STEVENSVILLE/GRASONVILLE WWTP
 ENR UPGRADE

CIVIL
**SOUTH
 LOCATION/CONTROL
 PARTIAL PLAN**

IN CHARGE OF ORP	FILE NO 1619.33990-11
DESIGNED BY PS	SHEET NO C-4
CHECKED BY PS	ISSUE DATE MAY 2004
DRAWN BY RPW	

MAR-17-2005 02:25 AM

STATE OF
DEPARTMENT
WATER MANAG

Post-It® Fax Note	7871	Date	3.16.5	# of pages	21
To	Faith ER	From	AQ		
Co./Dept.	NTW Perm. &	Co.			
Phone #	for Leg Anne	Phone #			
Fax #		Fax #			

MODIFICATION OF AUTHORIZATION

AUTHORIZATION NUMBER: 98-NT-0554/199866788

MODIFICATION DATE: October 6, 2003

EXPIRATION DATE: March 23, 2007

AUTHORIZED PERSON: Queen Anne's County Commissioners
Queen Anne's County Sanitary District
P. O. Box 10
Stevensville, Maryland 21666
Attn: Alan Quimby



IN ACCORDANCE WITH ENVIRONMENT ARTICLE 5-503(A) AND 5-906(A), ANNOTATED CODE OF MARYLAND (1996 REPLACEMENT VOLUME), COMAR 26.17.04, 26.23.01 and 26.08.02, NONTIDAL WETLANDS AND WATERWAYS PERMIT AND WATER QUALITY CERTIFICATION NUMBER 98-NT-0554/199866788 ISSUED TO Queen Anne's County Commissioners, Queen Anne's County Sanitary District ("AUTHORIZED PERSON"), IS HEREBY MODIFIED BY THE WATER MANAGEMENT ADMINISTRATION ("ADMINISTRATION") AS DESCRIBED BELOW:

Modification is made to extend the expiration date of the Permit and Water Quality Certification to the date listed above.

THIS MODIFICATION SHALL BE CONSIDERED AS PART OF NONTIDAL WETLANDS AND WATERWAYS PERMIT AND WATER QUALITY CERTIFICATION NUMBER 98-NT-0554/199866788. ALL OTHER CONDITIONS AND ELEMENTS OF THE AUTHORIZATION REMAIN IN EFFECT.

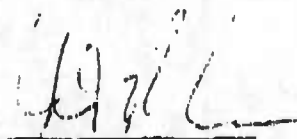
for Amanda Sigillito, Chief
Nontidal Wetlands & Waterways Division

cc: WMA Compliance Program w/modification request
U. S. Army Corps of Engineers

MAR-17-2005 02:26 AM

③

STATE OF MARYLAND
DEPARTMENT OF THE ENVIRONMENT
WATER MANAGEMENT ADMINISTRATION

MODIFICATION OF PERMIT/CERTIFICATION

PERMIT/CERTIFICATION NUMBER: 98-NT-0554/199866788

MODIFICATION DATE: August 7, 2002

EXPIRATION DATE: March 23, 2004

PERMITEE: Queen Anne's County Commissioners
Queen Anne's County Sanitary District
P.O. Box 10
Stevensville, Maryland 21666
Attn: Alan Quimby



IN ACCORDANCE WITH ENVIRONMENT ARTICLE 5-503(A) AND 5-906(A), ANNOTATED CODE OF MARYLAND (1996 REPLACEMENT VOLUME), COMAR 26.17.04, 26.23.01 and 26.08.02, NONTIDAL WETLANDS AND WATERWAYS PERMIT/CERTIFICATION NUMBER 98-NT-0554/199866788 ISSUED TO Queen Anne's County Commissioners ("PERMITEE"), IS HEREBY MODIFIED BY THE WATER MANAGEMENT ADMINISTRATION ("ADMINISTRATION") AS DESCRIBED BELOW:

To upgrade an existing outfall pipe at the KNSG Wastewater Treatment Plant. The work is in addition to previously permitted work and will result in additional temporary forested nontidal wetland impacts of 6,919 square feet of forested nontidal wetland, and temporary emergent nontidal wetland impacts of 7,874 square feet, as per the enclosed approved plans.

THIS MODIFICATION SHALL BE CONSIDERED AS PART OF NONTIDAL WETLANDS AND WATERWAYS PERMIT/CERTIFICATION NUMBER 98-NT-0554/199866788. ALL OTHER CONDITIONS AND ELEMENTS OF THE PERMIT/CERTIFICATION REMAIN IN EFFECT.

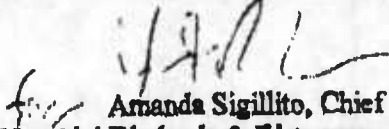

for Amanda Sigillito, Chief
Nontidal Wetlands & Waterways Division

cc: WMA Compliance Program w/modification request
U.S. Army Corps of Engineers, Lynette Rhodes
Principal Contact, Tom Davis

F:\Dwg_N-2\0\Bris...Gere\WWTP 7-04\0427207.dwg

MATCHLINE SEE SHEET C-6

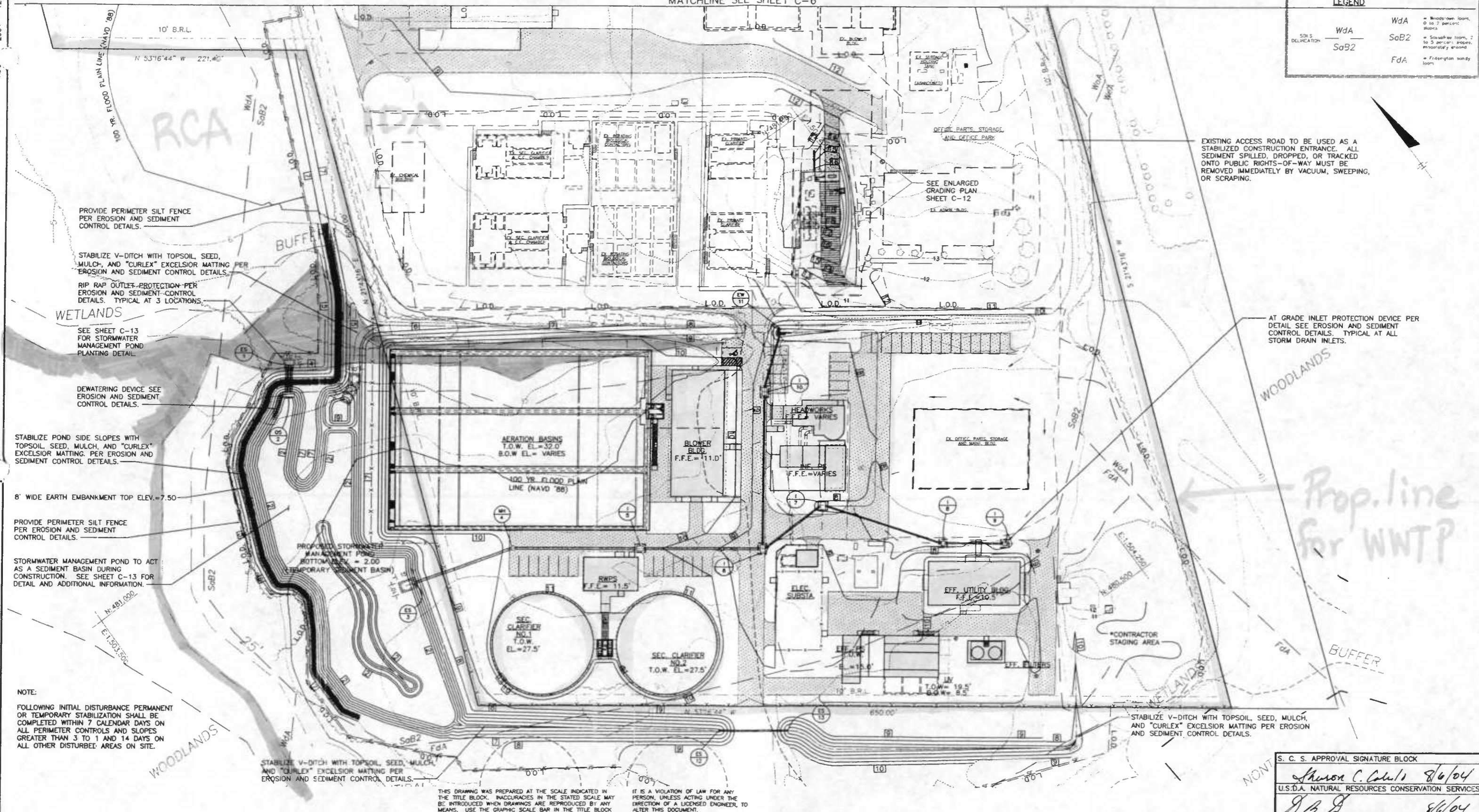
LEGEND	
WdA	WdA = Woods own loam, 0 to 2 percent slopes
SaB2	SaB2 = Sandier loam, 2 to 5 percent slopes, moderately eroded
FdA	FdA = Fertilizer sandy loam



QUEEN ANNE'S COUNTY
1708

The DEPARTMENT of PUBLIC WORKS
of
QUEEN ANNE'S COUNTY
MARYLAND

APPROVED	NAME	DATE
QUEEN ANNE'S COUNTY DEPARTMENT OF PUBLIC WORKS	<i>Shirley L. Clark</i>	8-19-04
NAME	DATE	

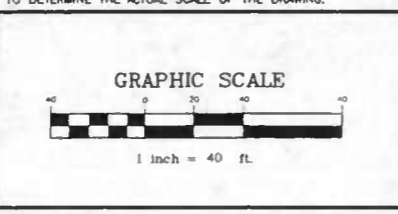

MICRONE
ENGINEERING & ENVIRONMENTAL SERVICES
LAND PLANNING & SURVEYING • CONSTRUCTION SERVICES

O'BRIEN & GERE
ENGINEERS INC.

STATE OF MARYLAND DEPARTMENT OF PUBLIC WORKS REGISTERED PROFESSIONAL ENGINEER No. 11000 Shirley L. Clark 8/16/04	08/20/04 ISSUED FOR BID ORP	NO.	DATE	REVISION	INIT.
---	-----------------------------	-----	------	----------	-------

KENT NARROWS/STEVENSVILLE/GRASONVILLE WWTP
ENR UPGRADE

CIVIL
SOUTH
SEDIMENT & EROSION
CONTROL PLAN

S. C. S. APPROVAL SIGNATURE BLOCK <i>Shirley L. Clark</i> 8/6/04 U.S.D.A. NATURAL RESOURCES CONSERVATION SERVICES <i>J.B.G.</i> 8/6/04 QUEEN ANNE'S SOIL CONSERVATION DISTRICT	IN CHARGE OF V.L.D.	FILE NO. D1040272
DESIGNED BY D.P.	CHECKED BY V.L.D.	SHEET NO. C-7
DRAWN BY MCOG	ISSUE DATE AUGUST 2004	