

MSA SC 6111-1-2

Survey of Wye M.E. Church 1897/10/20

STATE of MARYLAND
QUEEN ANNES COUNTY,

Y to wit

I certify that I have surveyed for the Trustees of the Wye M. E. Church, at Wye Mills a lot of land situated in County and State aforesaid, being in the Third Election District, and lying on the North side of the Public Road leading from Wye Mills to Queen Annas Station, between the lands of James Ahearn on the West and James Godwin and Wilson Hopkins on the East, the Mill Pond on the North and the Public Road before mentioned on the South,

Beginning at the Mill Pond at a stake on division with Wilson Hopkins, and with said division South Fifteen Degrees West, Sixteen rods to the road, thence North Fifty Nine Degrees West, Nineteen and one half rods with public road to James Ahearn's fence (a stone is to be set) with said fence North Twenty Eight and one half Degrees, East ten rods to a Beech tree at edge of Mill Pond, thence South Eighty Degrees East, Fifteen rods to beginning,

CONTAINING, one acre, one rood and twenty two sq. perches of land.

October 20th. 1897

Geo. M. Parviz

Surveyor.

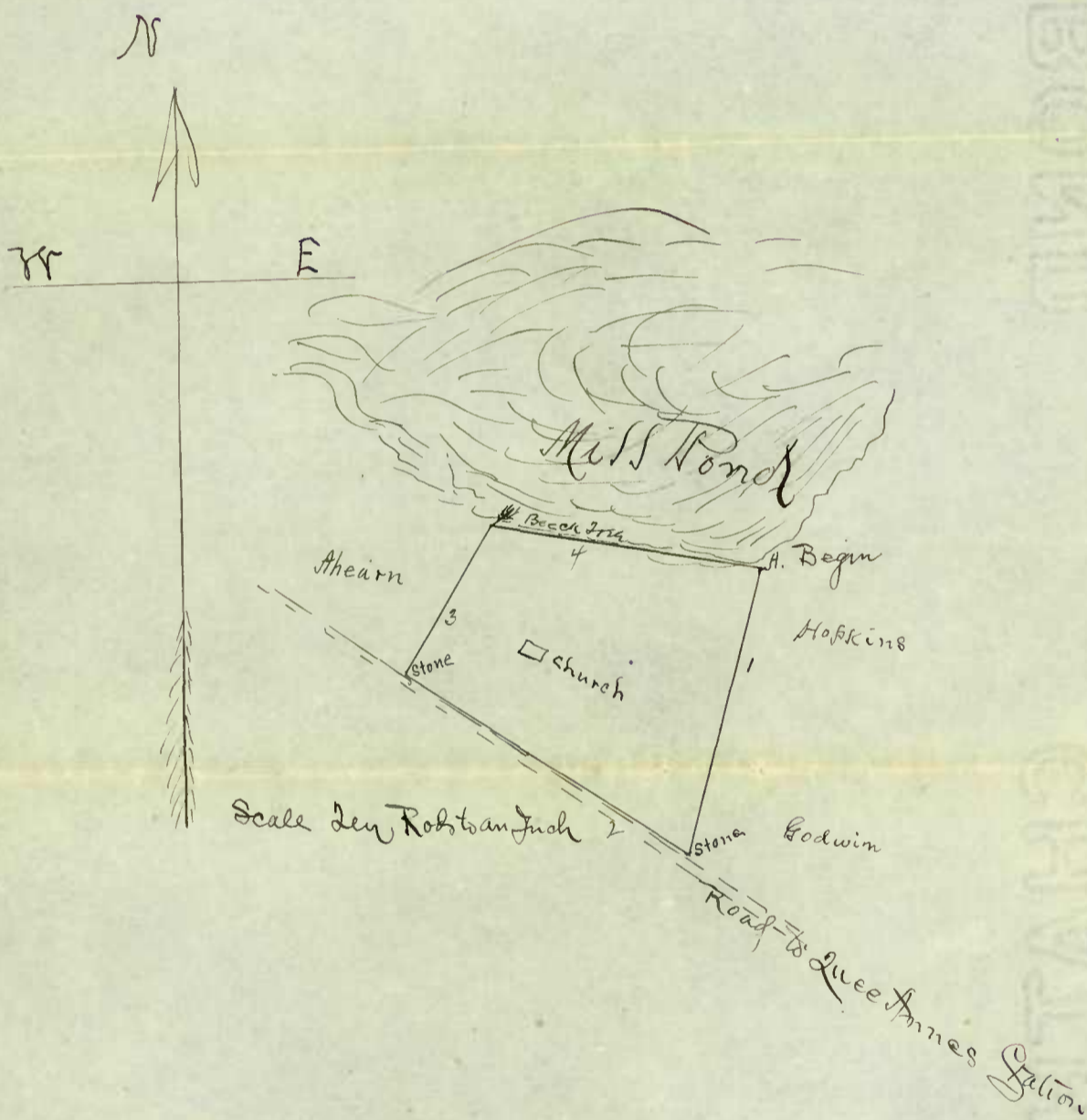

WATMAN BOND

Post

Wagon M & Chud
Papers

BOND

WATMAN BOND

WATMAN BOND

WATMAN BOND

WATMAN BOND

WATMAN BOND

WATMAN BOND