

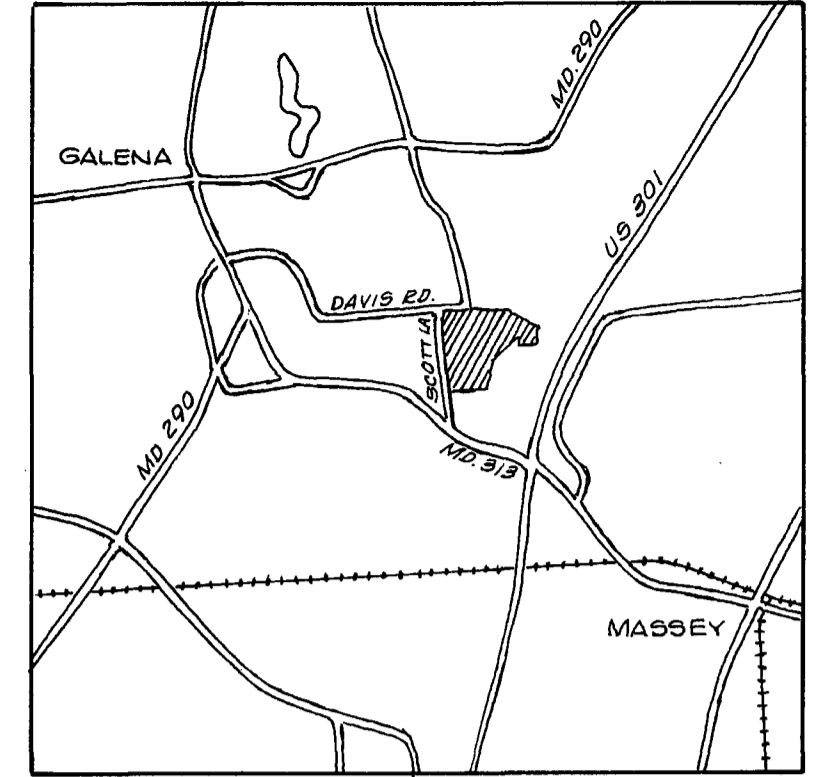

Maryland State Archives

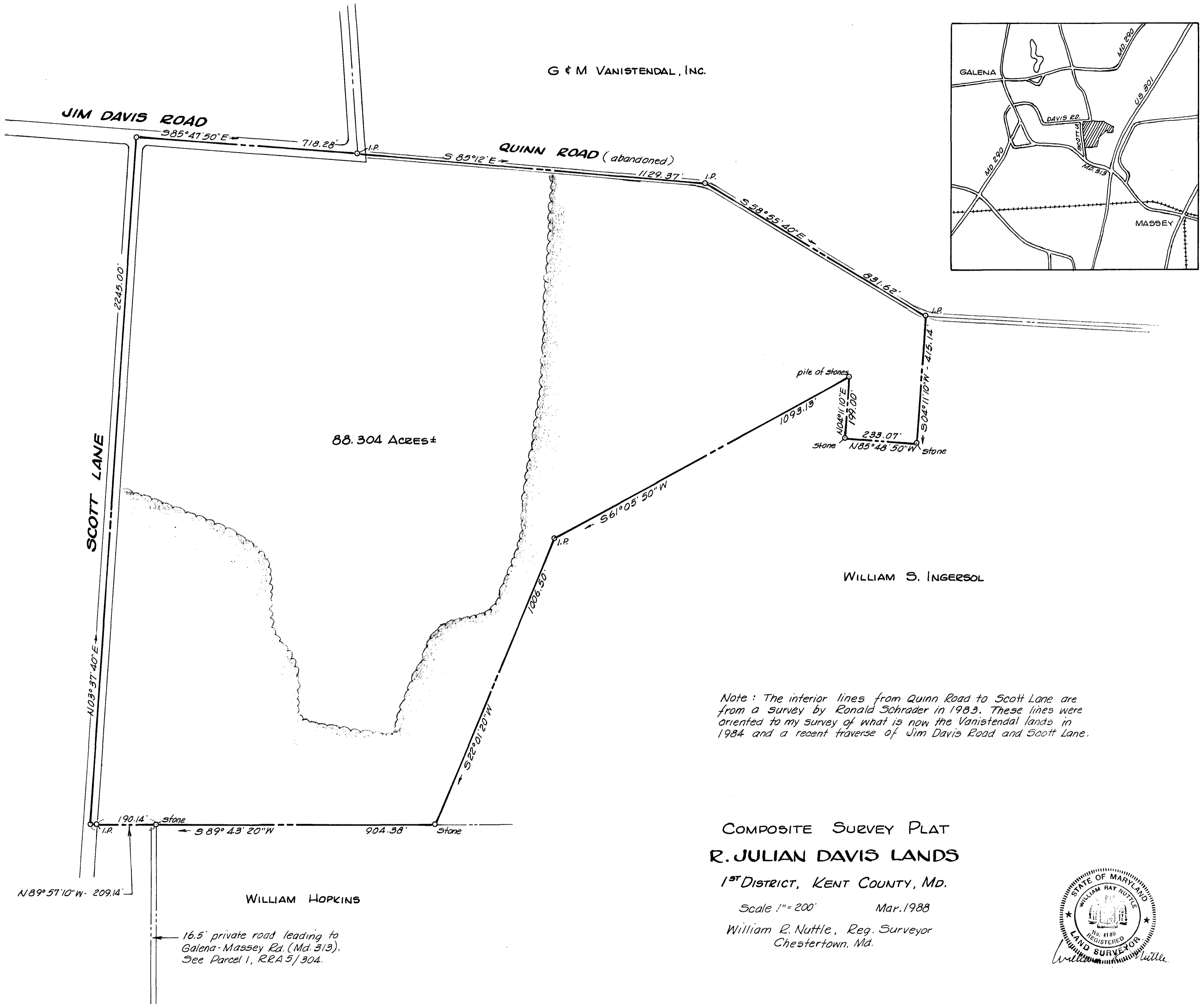

Note: The interior lines from Quinn Road to Scott Lane are from a survey by Ronald Schrader in 1983. These lines were oriented to my survey of what is now the Vanistendal lands in 1984 and a recent traverse of Jim Davis Road and Scott Lane.

COMPOSITE SURVEY PLAT
R. JULIAN DAVIS LANDS
 1ST DISTRICT, KENT COUNTY, MD.

Scale 1" = 200' Mar. 1988
 William R. Nuttle, Reg. Surveyor
 Chestertown, Md.

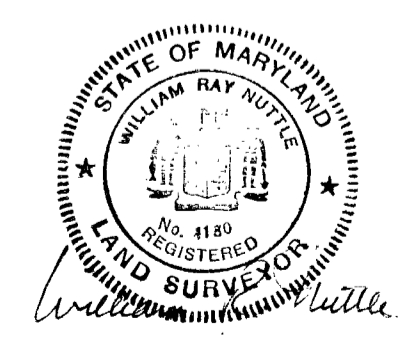

I.P. = iron pipe