

768

HARFORD COUNTY.

Snow Hill

Acres 5-7

SURVEYED FOR

Israel Cox

26th Nov. 1796

Returned 21st April 1797

Ex'd. and Passed 19th April 1797

Comp. \$ Pd. 19th April 1797

PATENTED TO

Israel Cox

14th May 1798

Rec. of Cert. J.C. no. 7 folio 293

Rec. of Patent

I hereby assign transfer and make over unto Israel
Coxe of Hartford County all my right title interest and
claim of in and to thirty acres part of a special
warrant for one hundred and eighty four acres issued
to me the 14 day of November 1795. in consequence
of the vacation of a Certificate - as also all my right
and title to fifteen acres and three eighths of an
acre part of a common warrant for 85 acres issued
to me the fourteenth day of March 1797. in consequence
of the correction of a Certificate - Witness my
hand and seal this 19th day of April 1797.

Test
Henry Wheteroff

David West Seal

State of Maryland &c

By Virtue of a special Warrant granted out of the Land Office for
the Western Show of this State on the 16th day of May 1796 to lay
out for Israel Cox of Harford County twenty five acres of Land
as appears &c

Daniel Scott surveyor of Harford County hereby Certify that
I have surveyed for him the said Israel Cox a tract or parcel of Land
lying in Harford County Beginning at the beginning of a tract
called Guffeys Romantick Prospect being a pile of Stones near the
head of a hollow North sixteen degrees West three perches and six
tenths of a perch from a white Oak sapling now bounded and
running thence With and bounding on said Land the two following
Lines to wit South fifty one degrees East sixty four perches North
forty three degrees East twenty two perches then South sixty four
degrees East thirty four perches to the end of the South sixty four
degrees East thirty four perches line of a tract called Fullers Mount
then with and bounding on said Land the eight following lines viz
South twenty two degrees West thirty eight perches to a bounded Black
oak South forty nine degrees East twenty eight perches South twenty
seven degrees and thirty minutes West thirty seven perches North thirty
four degrees West sixty seven perches to a bounded White Oak standing
on the South side of a hill South fifty five degrees West twenty four perches
South nineteen degrees East ^{to a bounded thorough oak the last Corner of said Land} twenty perches North eighty degrees East
~~as a bounded thorough oak the last Corner of said~~
forty three perches to a Rock the Beginning of said Fullers Mount
North twenty nine degrees East sixty four perches then South fifty
four degrees East seventy seven perches to a rock the Beginning of a
tract surveyed for Stephen Union called The Meadow then with and
bounding on said Land the six following lines to wit North West by
West seventy four perches South twenty five degrees and forty five
minutes West sixty four perches South fifty degrees and forty five
minutes West thirty perches South eighty five degrees & forty five minutes
West sixty eight perches, South sixty degrees and forty five minutes
West sixty perches South forty degrees and forty five minutes West fifty
four perches until it intersects a tract called James Beginning then
North eighty eight degrees and forty five minutes West twenty seven
perches to a stone placed by Commissioners at the end of the second
line of a tract called Johns Beginning then North forty seven degrees
and thirty minutes East fifty three perches and half a perch to a stone
marked I.C on the East side of a Branch then North twenty five deg.
West six and a half perches to the end of the South twenty five deg.
East sixty two perches line of Guffeys Romantick Prospect aforesaid
then with and bounding on said Land the three following lines to
wit North sixty seven degrees East eighty perches North eighty six
degrees East thirty four perches and then with a straight line to
the first beginning containing fifty seven acres more or less
by the name of Snow Hill. D.D. Nov. 26th 1796 Dan. Scott Svr

Courses

1	S 51 E	64
2	N 43 E	22
3	S 44 E	34
4	S 22 W	38
5	S 49 E	28
6	S 27 W	37
7	N 30 W	67
8	S 55 W	24
9	S 19 E	70
10	N 80 E	43
11	N 29 E	66
12	S 54 E	77
13	N 56 1/2 W	74
14	S 25 3/4 W	64
15	S 50 3/4 W	30
16	S 85 3/4 W	68
17	S 60 3/4 W	60
18	S 40 3/4 W	54
19	N 88 3/4 W	27
20	N 47 E	53
	N 25 W	6
22	N 67 E	80
23	N 86 E	34

thence by 57

Scale 50 ft. in an inch

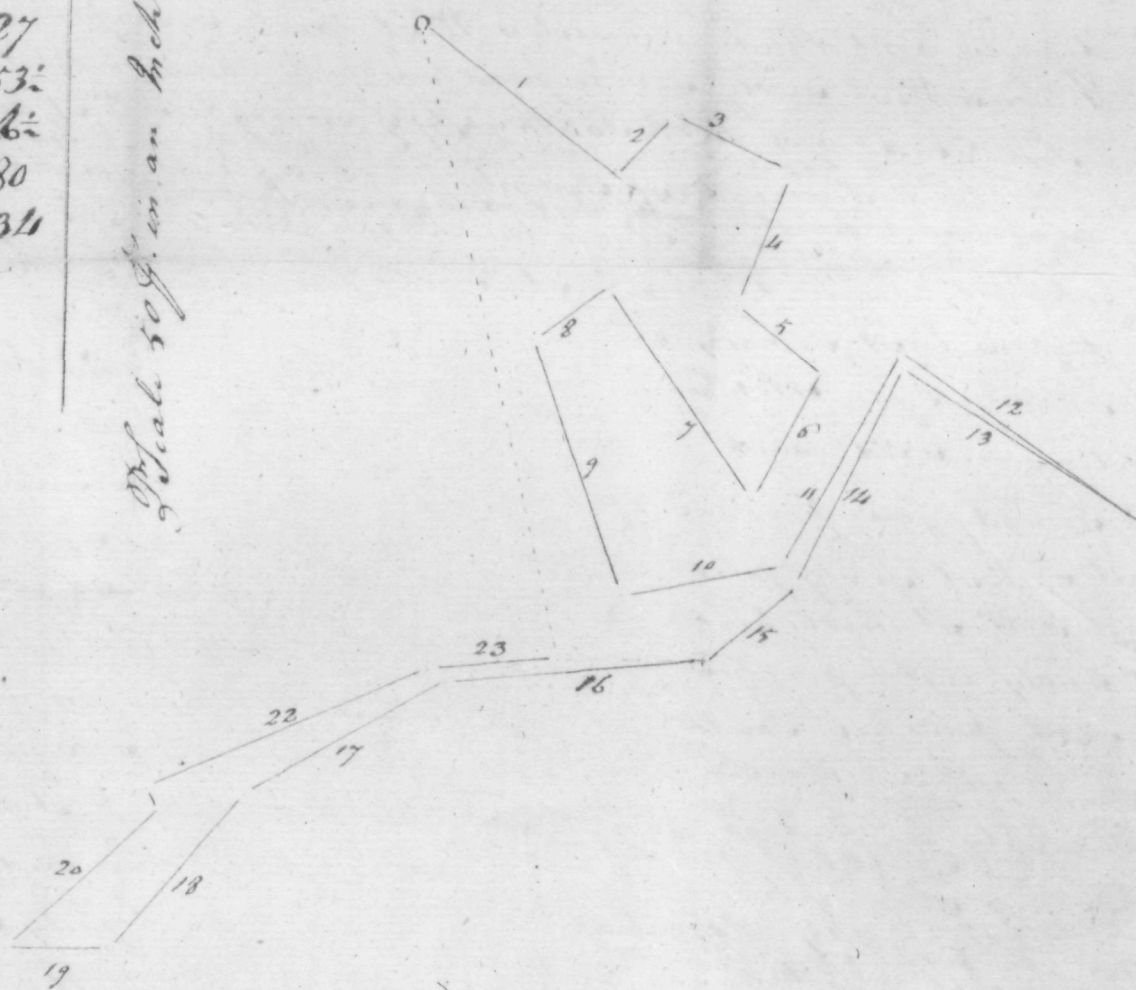

There is on this Survey about 300 pounds
of fence chiefly poles and partly rotten In
my opinion may be worth one dollar

1870
C. S.
1870

29 June 1797

John P. Walker

45 3/8 acres

Shirley Fort, Mt. Pine Wood on the 1st day of November 1795
 obtained out of the western shore land office a special warrant for 18 1/2
 in consequence of the purchase of a certificate - 30 acres is hereof he hath
 signed to the within signed (see) - that the same (Pine Wood
 on the 14th day of March 1797 also obtained a Certificate or Warrant
 for 30 in consequence of the purchase of a certificate - 15 3/8 acres
 whereof he hath likewise assigned to the said signed (see) the
 making together the quantity of 45 3/8 acres, and that while
 making of the said signed (see) the same in fact do
 the consideration due on this certificate.

Harford County
Israel Cox Att.^d

Snow Hill

57th

For the Office

April 19th 1797

Examined *auspicio*

Sachol Meers Esq. Clerk

returned 21st Apr. 1797

Patented 14 May 1798.

Recorded in Liber & Chart.

folio 293

Per A. Spauldy 1797. Snow Hill, and the Parish of Harford

the Standard 34

1/4

Emb