

316

HARFORD COUNTY.

Grove Enlarged

Acres 392

SURVEYED FOR

John Barclay

22nd June 1797

Returned 16th Oct. 1797

Ex'd. and Passed 15th Oct. 1797

Comp. \$ Pd. 16th Oct. 1797

PATENTED TO

John Barclay

12th May 1798

Rec. of Cert. L.C. No. 7 folio 289

Rec. of Patent

Harford County

By virtue of a special warrant granted out of the Land Office on the Western Shore in the State of Maryland bearing date the 11th of August 1796 to resurvey and lay out for John Barclay Esq^r of said County the following lands lying and being in the County aforesaid and contiguous to each other *viz* The Grove originally on the 13 day of June 1734 granted William Smith for 210 acres and The Deer Park originally on the — day of — granted — for — acres ^{according to its ancient metes and bounds} Nevertheless correcting and amending any errors in the original survey and by my out lines adding any vacant land thereto contiguous to be the same Cultivated or otherwise &c.

(It appears said Barclay is not seized in fee of and in the Deer Park)
 I David Clark Surveyor of Harford County do hereby certify that I have Resurveyed and carefully laid out for and in the name of him the said John Barclay Esq^r all that tract of land called The Grove according to its ancient metes and bounds as shewed to me and find it Contains two hundred and six acres and three quarters. I have also added the quantity of one hundred and eighty five acres and a quarter of vacant land, and lastly I have reduced the whole into one entire tract bounded as follows *viz* Lying in Harford County Beginning at a large stone set up by Commission near the head of a spring which runs into ^{the North side of} Broad Creek marked I.B.N. 1, at the beginning of the original survey called The Grove and Running thence bounding on the original survey as settled by Commission the seven following Courses *viz* North sixty nine degrees and a quarter West thirty five perches to a stone marked I.B.N. 2, North fifty four degrees and a quarter West one hundred perches to a stone marked I.B.N. 3, North five degrees and three quarters East twenty eight perches to a stone marked I.B.N. 4, North forty four degrees and a quarter West forty perches to a stone marked I.B.N. 5, North twenty five degrees and three quarters East forty eight perches to a stone marked I.B.N. 6, North fifty five degrees and three quarters East one hundred perches to a stone marked I.B.N. 7, North eighty five degrees and three quarters East one hundred and forty perches to a stone marked I.B.N. 8 thence bounding on the given line of said land South twenty three degrees and a half West eighty seven perches thence South twenty four degrees East thirteen perches to a bounded Chestnut on the North side of the said Barclays Spring branch thence South sixty four degrees East eleven perches North eighty four degrees East twenty four perches South fifty three degrees East nine perches South eighty nine degrees East fourteen perches to a bounded Spanish Oak thence North four degrees East fifty five perches North fifty five degrees East fifteen perches North eleven degrees East twenty perches to a bounded Spanish Oak in a small hollow thence North fifty four degrees East a half East seventy nine perches and three quarters to a bounded white Oak sapling by the side of a small branch thence South forty two degrees and a quarter East nine perches and a half North fifty seven degrees and a half East thirty perches to a bounded Spanish Oak on the south side of a hill thence South forty two degrees ~~and a half~~ East twenty four perches East twenty perches to a bounded forked Spanish Oak thence

North eighteen degrees East fifty seven perches to a bounded water Oak thence North twenty eight degrees East eleven perches to two bounded white Oaks on the side of a hill thence North sixty five degrees East twenty one perches to a bounded white Oak thence South forty four degrees East thirty perches and a half South twenty three degrees and a half East twelve perches to two bounded Chestnuts on the side of a hill thence South seventy eight degrees West thirty two perches South thirty seven degrees West sixty six perches to a stone thence South fifty one degrees West twenty seven perches and a half to a stone thence South eighty nine degrees West sixty six perches to a bounded Water Oak thence South eight degrees West forty three perches and a half to a bounded Chestnut sapling on the side of a hill thence North seventy eight degrees and a half East sixty seven perches and a half South thirty one degrees East twenty perches to a bounded white Oak the beginning tree of a tract of Leased land called Williams Delight thence North sixty three degrees East seventeen perches to two bounded Spanish Oaks on the side of a hill near a rock stone thence South thirteen degrees and a half West ten perches and a half South thirty four degrees West twenty six perches South seventeen degrees West forty perches South seventy three degrees West twelve perches to a bounded black Oak of Plessers Enlargement thence South forty three degrees and a quarter West seventy seven perches to a bounded white Oak sapling thence North eleven degrees and a quarter West seventeen perches and a half South eighty seven degrees West thirty two perches to a bounded black oak sapling marked with the letter R thence South nine degrees West twenty perches to the third line of a tract of land called Guffeys Romantic Prospect thence bounding on said line North sixty nine degrees West sixty five perches to the end thereof thence South seventy five degrees West fifty six perches South thirty one degrees and three quarters West fifty one perches to the given line of the original survey and thence by a straight line to the beginning containing and laid out for three hundred and ninety two acres more or less to be held by the name of The Grove Enlarged June the 22nd 1797

David Cash S.H.C.

Courses of the original
as settled by
Commission

1	N	69 $\frac{1}{2}$	W	35
2	N	54 $\frac{1}{2}$	W	100
3	N	53 $\frac{1}{2}$	E	28
4	N	44 $\frac{1}{2}$	W	40
5	N	25 $\frac{3}{4}$	E	48
6	N	55 $\frac{3}{4}$	E	100
7	N	85 $\frac{3}{4}$	E	140
thence by for 206 $\frac{3}{4}$				

Courses of
The Survey

1	N	69 $\frac{1}{2}$	W	35
2	N	54 $\frac{1}{2}$	W	100
3	N	53 $\frac{1}{2}$	E	28
4	N	44 $\frac{1}{2}$	W	40
5	N	25 $\frac{3}{4}$	E	48
6	N	55 $\frac{3}{4}$	E	100

7	N	85 $\frac{3}{4}$	E	140
8	S	23 $\frac{1}{2}$	W	87
9	S	24	E	13
10	S	64	E	11
11	N	84	E	24
12	S	53	E	9
13	S	89	E	14
14	N	4	E	55
15	N	55	E	15
16	N	11	E	20
17	N	54 $\frac{1}{2}$	E	79 $\frac{3}{4}$
18	S	42 $\frac{1}{2}$	E	9 $\frac{1}{2}$
19	N	57 $\frac{1}{2}$	E	30
20	S	42	E	24
21			E	20
22	N	18	E	57
23	N	28	E	11
24	N	65	E	21
25	S	44	E	30 $\frac{1}{2}$
26	S	23 $\frac{1}{2}$	E	12
27	S	78	W	32
28	S	37	W	66

29	S	51	W	27 $\frac{1}{2}$
30	S	89	W	66
31	S	8	W	43 $\frac{1}{2}$
32	N	78 $\frac{1}{2}$	E	67 $\frac{1}{2}$
33	S	31	E	20
34	N	63	E	17
35	S	13 $\frac{1}{2}$	W	10 $\frac{1}{2}$
36	S	34	W	26
37	S	17	W	40
38	S	73	W	12
39	S	43 $\frac{3}{4}$	W	77
40	N	11 $\frac{1}{2}$	W	17 $\frac{1}{2}$
41	S	87	W	32
42	S	9	W	20
43	N	69	W	65
44	S	75	W	56
45	S	31 $\frac{3}{4}$	N	51
thence by for 392 ^{acres}				

A Beginning of The Grove in dotted lines
also of the Resurvey in plain lines

The Grove was formerly surveyed for . . . 210^{ac}

Falls Shot $3\frac{1}{4}$ 206 $\frac{3}{4}$

B Shows the vacant land added and Contains . . . 185 $\frac{1}{4}$

The Resurvey Contains 392

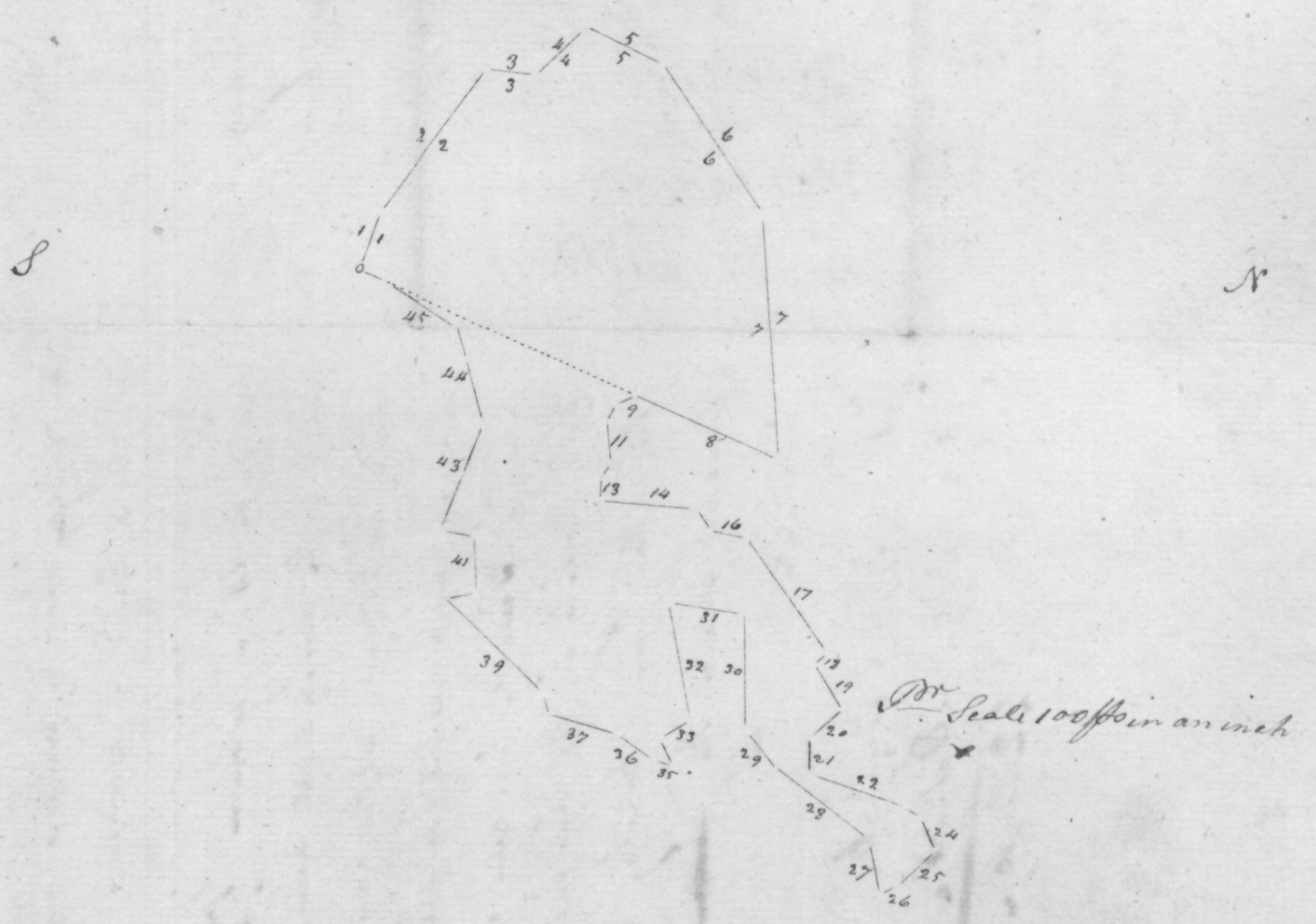

There is on the Vacant added in this Resurvey }
about 100 farnels of old sorry fence } 3 in 9

I certify that Alexander Gordon on the 18th of November
 1796 obtained a common warrant for eighty five
 acres due in consequence of the variation of a certain
 and on the 14th of September 1796 obtained a special
 warrant for ninety eight acres more half an acre, being
 paid for the same at the rate of 1/3 per acre, amounting
 to eight pounds twelve shillings and four pence half
 penny - Twenty four acres of the first of which remain
 The whole of the last mentioned be hereafter made
 The within John Barclay at whose request & apply
 the said boards the ~~same~~ comparison due on this
 Certificate.

John Atcheron High Sheriff.
 Oct 10. 1797.

742 3/4
 98 1/2 = 21/9
 £ 13. 17. 6.
 £ 22. 9. 10 1/2

1661 41 by
 The Harwood Esq
 In witness whereof
 I have signed my hand
 and seal this 14th day of
 July 1797.

Harford County
 John Barclay Esq.
 Certificate of The Grove
 - enlarged 392 acres
 For the Office
 July 17th 1797
 The body of the certificate and
 plat disagree in the direction
 of 8th line disalt
 Nathel Stevens Esq. J. Secy
 July 21st 1797 Corrected
 David Clarke M.
 Oct. 15th 1797
 Examined and signed
 Nathel Stevens Esq. J. Secy
 Re: 10 Oct 1797 10 7 8 1/2
 Patented 12th May 1798. Ent

Rec'd Oct. 16. 1797. Elwynpound, twelve Mullings and seven
 Pennebelt perry sa Canton and Thre Mulling and more
 Pennebelt perry
 The Harwood Esq
 J. C. No. 289.
 Records Libr