

Pratt

Street

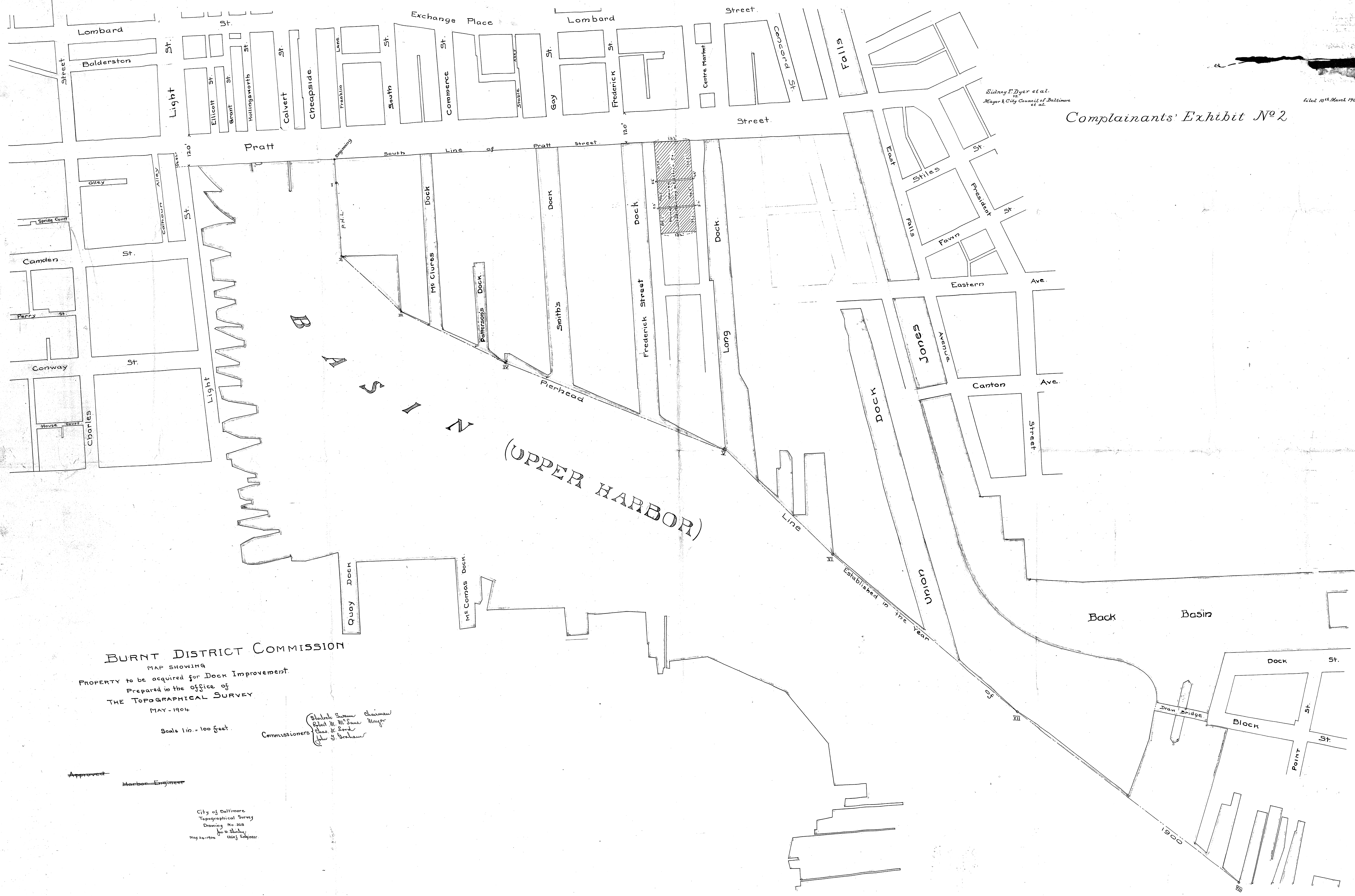

Scale = 50 feet to one inch.



Sidney T. Dyer et al.
vs.
Mayor & City Council of Baltimore et al.

Filed 10th March 1905

Complainants' Exhibit No 2

BURNT DISTRICT COMMISSION

MAP SHOWING
PROPERTY to be acquired for Dock Improvement.
Prepared in the Office of
THE TOPOGRAPHICAL SURVEY
MAY - 1904

Scale 1 in. = 100 feet.

Commissioners
Shelton Swan Chairman
Robert M. M'Namee Mayor
Charles St. Bond
John J. Graham

Approved
Harbor Engineer

City of Baltimore
Topographical Survey
Drawing No. 322
for W. Stanley
May 24-1904 Chief Engineer

Sidney T. Dyer et al.
Mayor & City Council of Baltimore
et al.

Complainants' Exhibit N^o 4

Filed 10th March 1905.

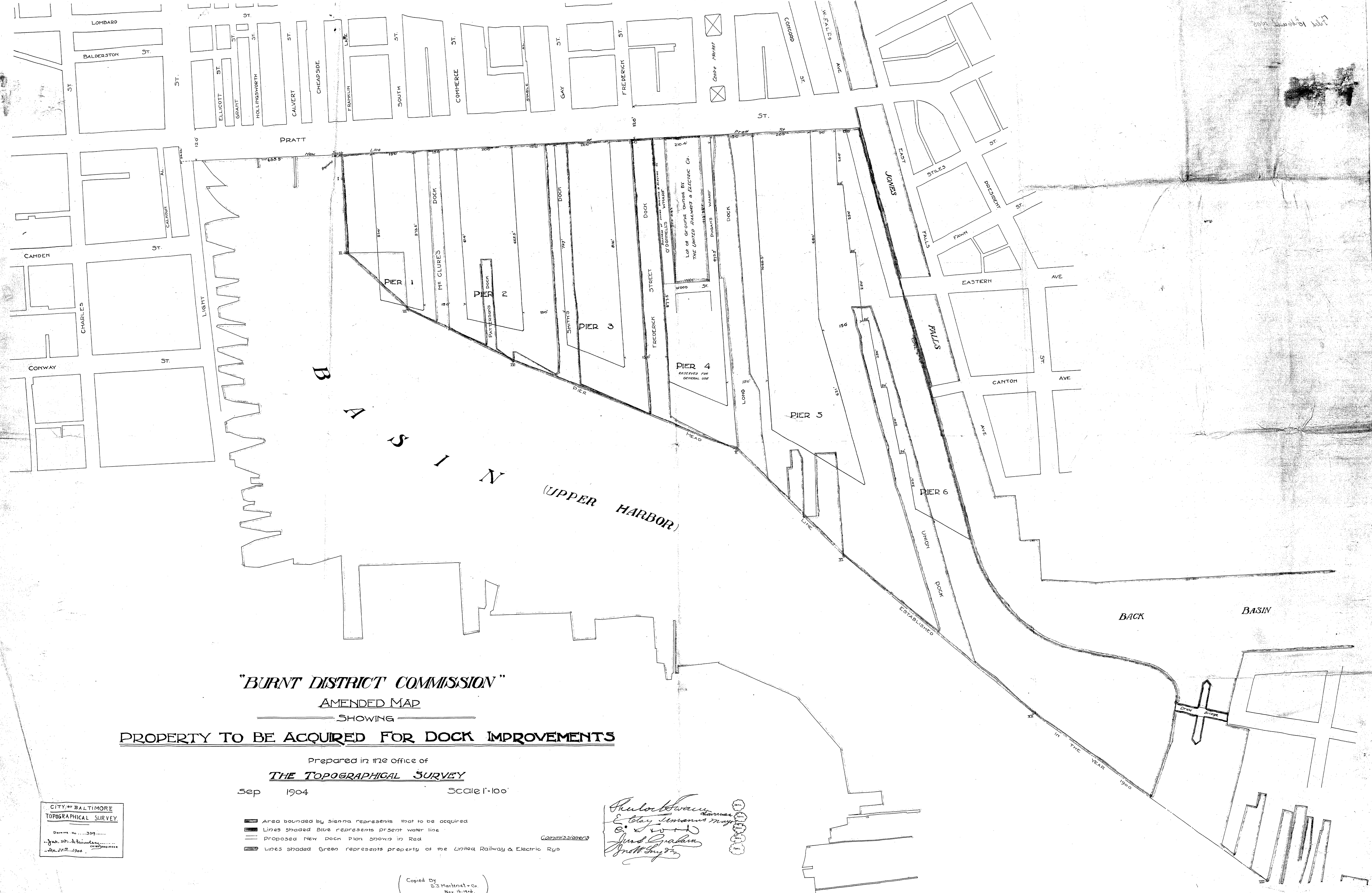

"BURNT DISTRICT COMMISSION"
AMENDED MAP
 SHOWING
PROPERTY TO BE ACQUIRED FOR DOCK IMPROVEMENTS

Prepared in the office of
THE TOPOGRAPHICAL SURVEY
 Sep 1904 Scale 1"=100'

CITY OF BALTIMORE
 TOPOGRAPHICAL SURVEY
 Drawing No. 339
 Sep. 20th 1904

- Area bounded by sienna represents that to be acquired
- Lines shaded Blue represents present water line
- Proposed New Dock Plan shown in Red
- Lines shaded Green represents property of the United Railway & Electric Ry

Shelock Swann
E. Clay Tomann
J. S. Galan
Small
 Commissioners

Copied by
 S. J. Martens & Co.
 Nov. 14, 1904.