

TYPICAL ROAD CROSS SECTION

Scale 1"=10'

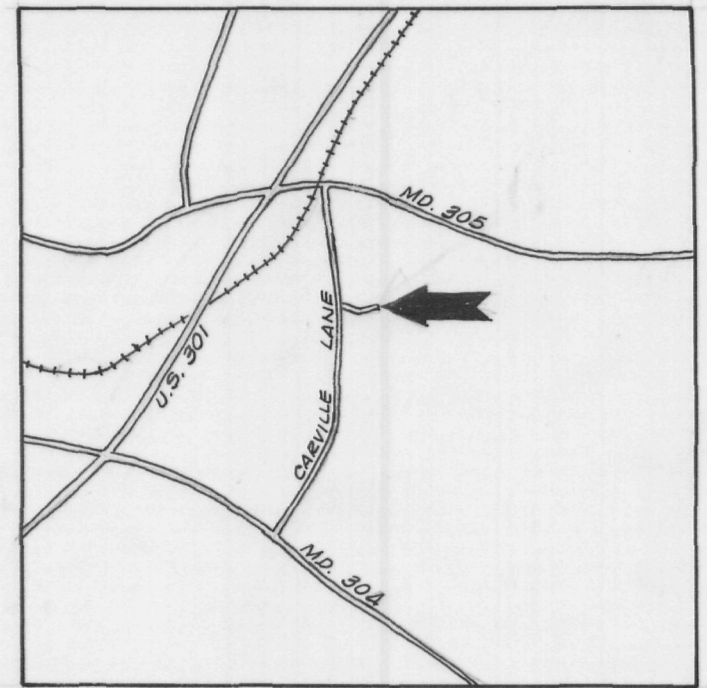

OTHER LANDS OF J. WILSON CLARK

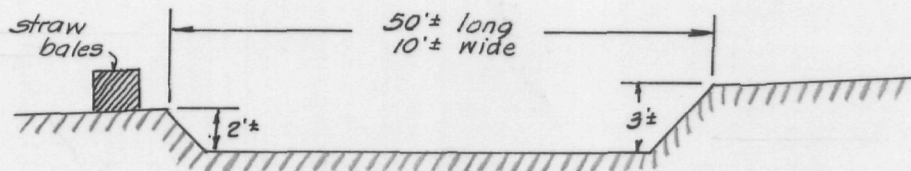
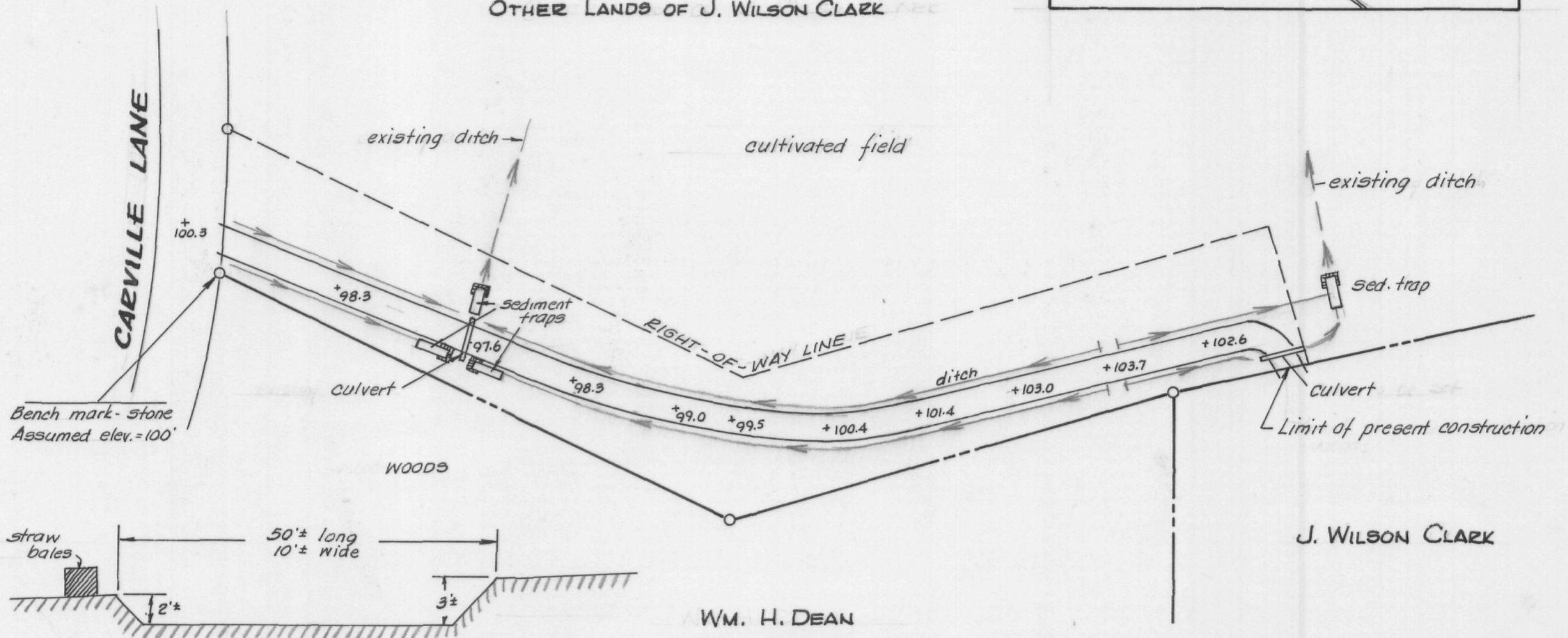

TEMPORARY SEDIMENT TRAP  
(67 cu. yds. per acre)

Note: Seeding and mulching (stabilization), temporary and permanent, to be done according to pages 3.003, 3.100-3.104 in "Standards and Specifications for Soil Erosion and Sediment Control in Urbanizing Areas."

I certify that all development and/or construction will be done according to this sediment control plan.

Owner



SEDIMENT CONTROL PLAN  
ENTRANCE ROAD OVER A PART OF THE  
J. WILSON CLARK LANDS  
6<sup>TH</sup> DISTRICT, QUEEN ANNES CO., MD.

Scale 1"=100' May 1979.  
William R. Nuttle, Reg. Surveyor  
Chestertown, Md.

