

CHESTER RIVER

Note: Shore line along Chester River located 3:00-3:30 P.M. January 12, 1972. Property lines established from position of concrete monuments and stone found.

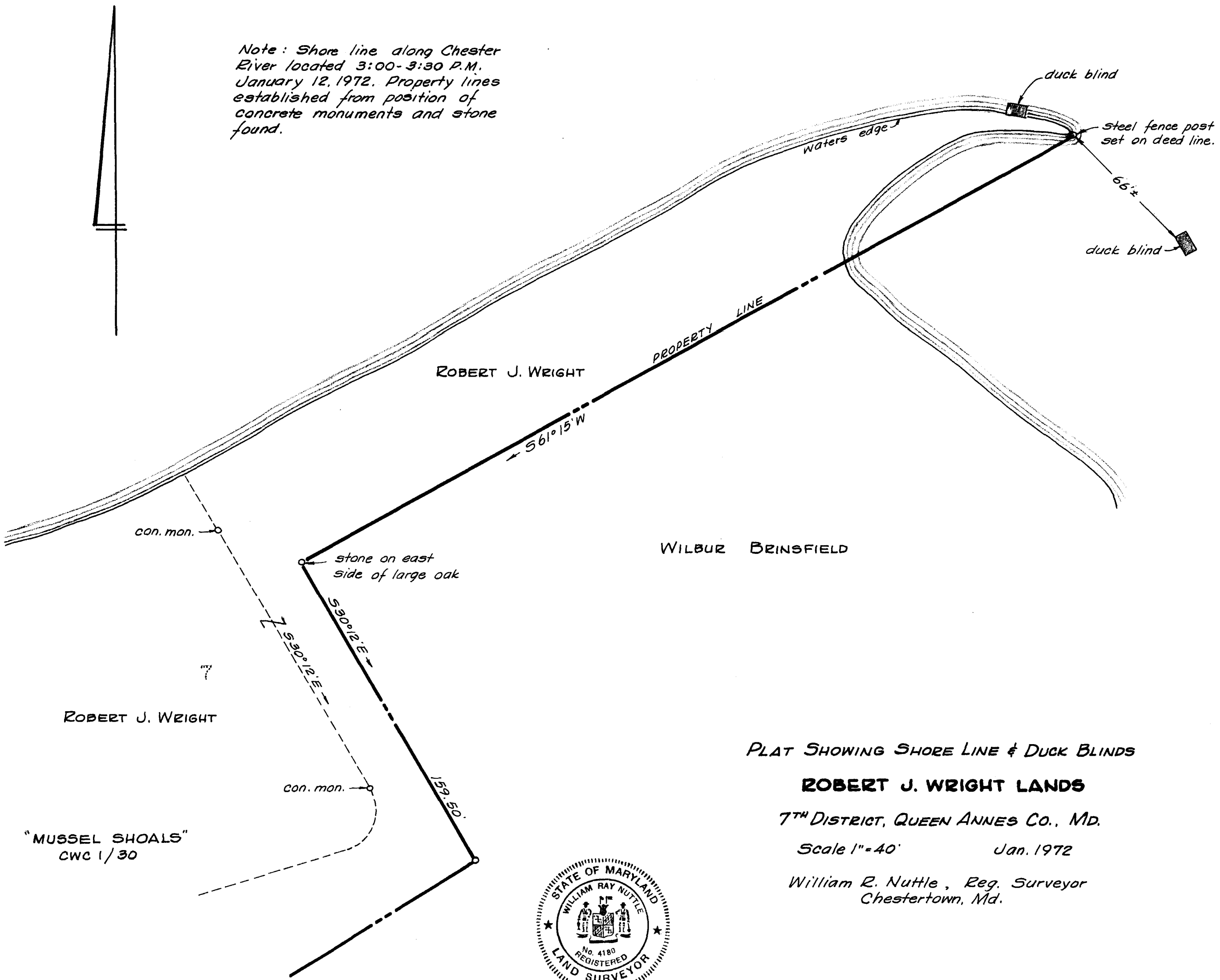

PLAT SHOWING SHORE LINE & DUCK BLINDS

ROBERT J. WRIGHT LANDS

7TH DISTRICT, QUEEN ANNES CO., MD.

Scale 1"=40'

Jan. 1972

William R. Nuttle, Reg. Surveyor
Chestertown, Md.

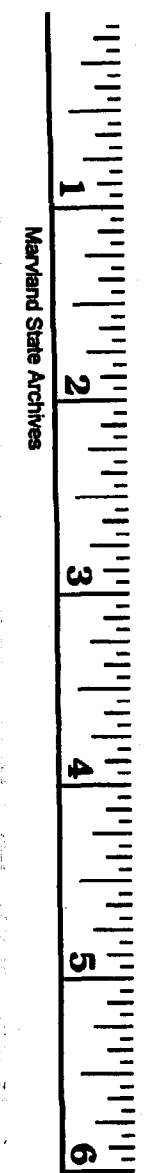
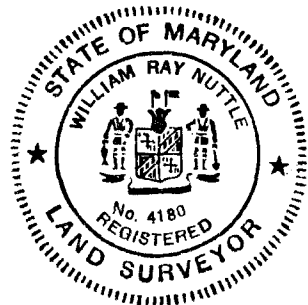

MSA SC 5593-7-427