



WILLIAM E. TROUT

CHESTER RIVER

Mean high water, elevation = 0'

top of bank

Bench Mark - top of iron pipe, elev. = 19.22'

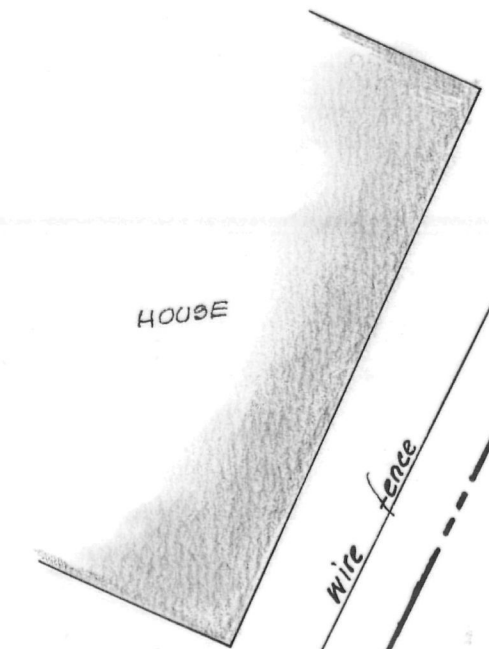

HOUSE

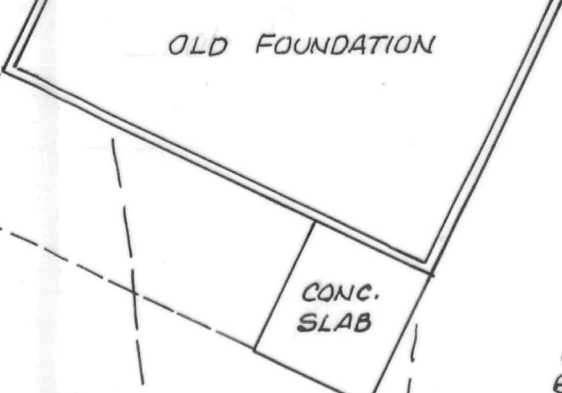

OLD FOUNDATION

CONC. SLAB



tile field

septic tank



GARAGE

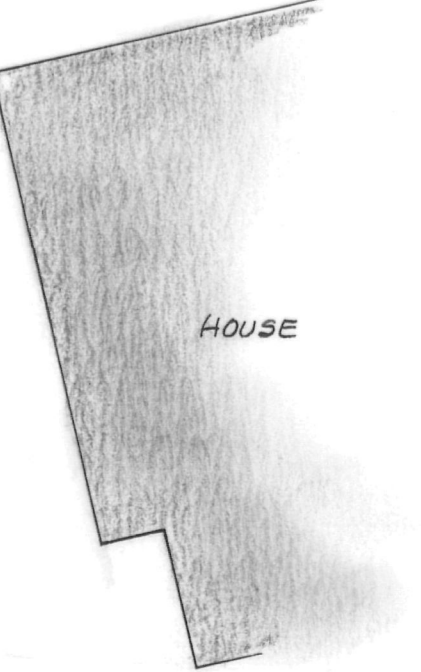

HOUSE

AARONSON & BASS

beach fence  
N 28° 08' E

N 63° 32' W

HOFFMAN LANE

telephone

iron pipe

TOPOGRAPHICAL SURVEY

LOT 4 & 1/2 OF LOT 3, HOFFMAN SUBDIVISION

7<sup>TH</sup> DISTRICT, QUEEN ANNES CO., MD.

Scale 1/16" = 1'

June 1995

William B. Nuttle, Reg. Surveyor  
Chestertown, Md.



Note: This lot is in the Critical Area, but it is buffer exempt; the normal setback from the river is not required. The zoning district is NC 20.  
15 NC 20.

Points marked thus "o" are pine trees unless otherwise noted.

