

WATER COURSES

NO	BEARING	DIST.
1	N 55° 42' 30" W	87.83'
2	S 74° 13' 10" W	525.82'
3	S 69° 47' 10" W	439.66'
4	S 50° 15' 20" W	434.93'
5	N 28° 18' 00" W	236.24'
6	N 09° 21' 10" E	172.29'
7	N 62° 43' 10" W	250.91'
8	S 33° 41' 20" W	234.36'
9	N 77° 11' 20" W	374.32'
10	N 36° 14' 00" W	287.62'
11	N 56° 50' 40" E	475.40'
12	S 51° 20' 30" E	96.04'
13	N 61° 13' 20" E	345.81'
14	N 47° 06' 10" E	276.97'
15	N 12° 42' 50" W	605.61'

Note: The interior property lines were taken from a survey by John C. Fisher, December 26, 1941, the shore line bearings and distances were computed from coordinates scaled from U.S.D.A. aerial photo AHW-5DD-291, and the proposed new line, boat basin, stone monument and a part of Md. Rte. 18 were located by survey.

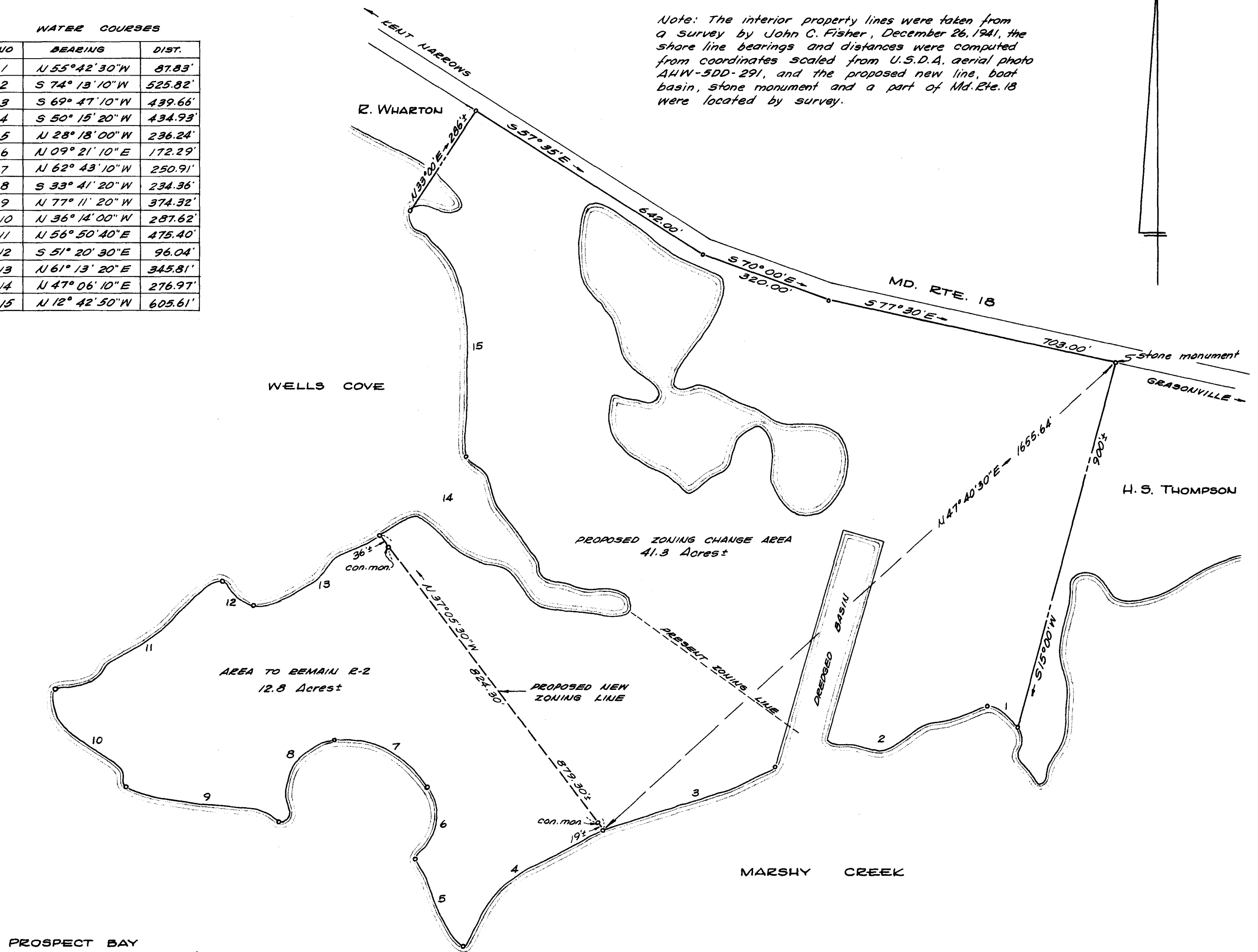

PLAT SHOWING PROPOSED CHANGES
IN ZONING CLASSIFICATION
WALTER E. THOMPSON LANDS
5TH DISTRICT, QUEEN ANNES CO., MD.

Scale 1" = 200' July 1965

William R. Nuttle, Reg. Surveyor
Chestertown, Md.

