

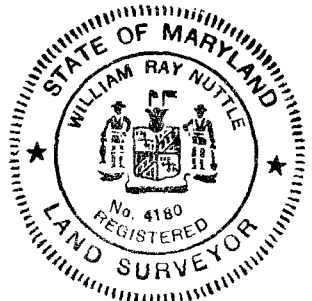

Maryland State Archives

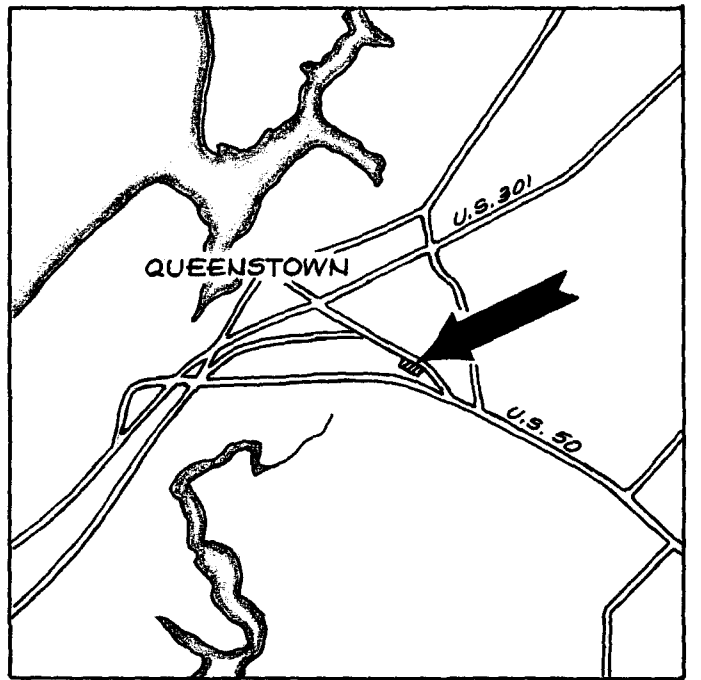
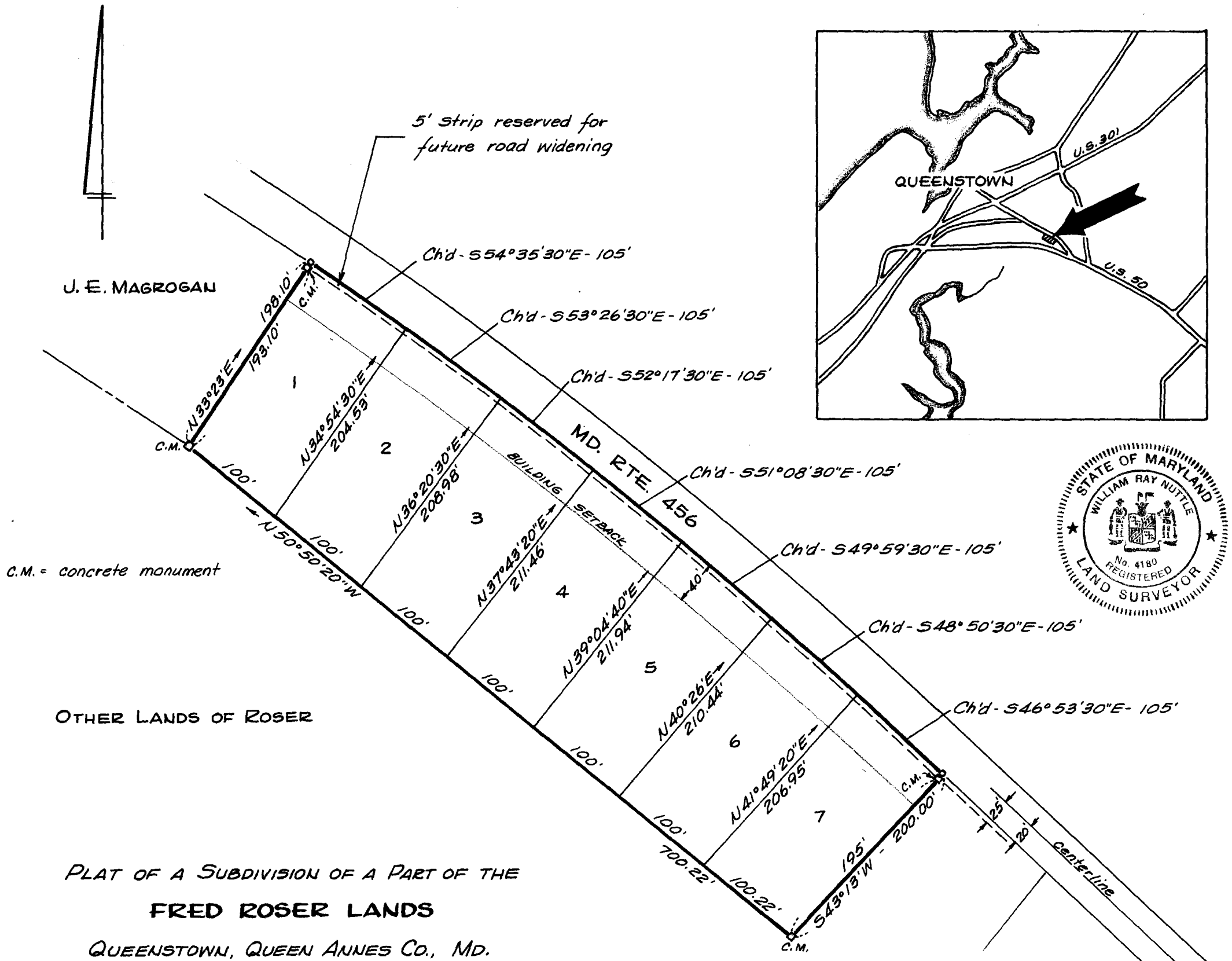

**PLAT OF A SUBDIVISION OF A PART OF THE
FRED ROSER LANDS**

QUEENSTOWN, QUEEN ANNES CO., MD.

Scale 1"=100' Feb. 1969

William R. Nuttle, Reg. Surveyor
Chestertown, Md.

Approved by the Queen Annes County Health Dept.

Approved by the Queen Annes County Planning & Zoning Comm.

This is to certify that this plat represents a survey by me and that the monuments shown actually exist in accordance with Section 60, Article 17, Annotated Code of Maryland.

William R. Nuttle
Surveyor

Owner