

CHANCILL WHITTINGTON

VAN TYRONE WHITTINGTON

OLIVER LYNCH

BERNARD STEWART

"WHITE HOUSE ACRES"

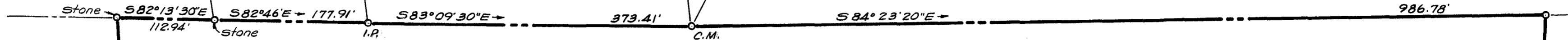

ANDREW GRIFFIN

ERNEST WARWICK

TOTAL ACREAGE, INCLUDING CLAIMED AREA = 32.630 ACRES±

AREA CLAIMED BY FOSTER & EWING 2.181 ACRES±

GRAVEL RUN ROAD

COUNTY LANDFILL

FOSTER & EWING (formerly Coursey)

FRANCES FISHER

PLAT OF A SURVEY OF THE FOSTER & EWING LANDS

5TH DISTRICT, QUEEN ANNES CO., MD.

Scale 1"=100' Mar. 1973.

William R. Nuttle, Reg. Surveyor Chestertown, Md.

I.P. = iron pipe
C.M. = concrete monument

MSA SC 5593-7-346



Maryland State Archives