

NO.	BEARING	DIST.
1	S 86° 53' 40" E	2515.48'
2	S 73° 24' 10" E	1237.98'
3	S 67° 33' 00" E	514.89'
4	S 12° 53' 20" E	959.00'
5	S 23° 25' 00" E	421.92'
6	S 19° 37' 00" W	194.15'
7	N 85° 06' 20" W	224.76'
8	S 01° 25' 50" W	205.17'
9	S 56° 26' 00" W	314.87'
10	S 46° 43' 40" W	562.64'
11	S 04° 17' 40" W	321.79'
12	S 87° 48' 40" W	1710.40'
13	S 14° 21' 10" W	596.07'
14	S 64° 16' 20" E	732.52'
15	S 05° 01' 40" W	289.90'
16	N 69° 24' 20" W	290.80'
17	S 84° 11' 50" W	146.91'
18	S 29° 28' 40" E	403.20'
19	S 64° 06' 20" W	103.22'
20	S 25° 52' 00" E	160.27'
21	S 78° 41' 00" E	35.72'
22	S 63° 08' 20" W	79.01'
23	N 73° 41' 00" W	583.07'
24	S 16° 19' 00" W	20.00'
25	N 73° 41' 00" W	2558.00'
26	N 62° 28' 30" W	1013.41'
27	N 44° 02' 30" E	157.58'
28	N 21° 27' 20" E	431.93'
29	N 21° 03' 10" W	283.95'
30	S 89° 36' 10" W	144.00'
31	N 20° 41' 40" W	43.10'
32	N 49° 32' 00" E	232.65'
33	N 46° 42' 40" W	94.79'
34	N 46° 50' 50" E	109.66'
35	N 01° 48' 50" W	158.08'
36	N 82° 52' 30" W	104.81'
37	N 02° 18' 10" E	174.14'
38	N 15° 26' 50" E	157.70'
39	S 85° 53' 10" E	139.36'
40	N 47° 39' 50" E	365.26'
41	S 78° 01' 30" E	39.73'
42	N 40° 58' 30" E	382.78'
43	N 39° 41' 40" E	323.80'
44	N 34° 18' 10" W	129.53'
45	N 31° 42' 50" E	209.24'
46	S 87° 59' 30" E	57.04'
47	S 22° 20' 30" E	78.92'
48	N 37° 57' 30" E	135.21'
49	N 39° 54' 30" E	233.73'
50	N 36° 46' 00" E	746.28'
51	N 33° 11' 10" E	372.74'

* Chord ; Radius = 2607.93'

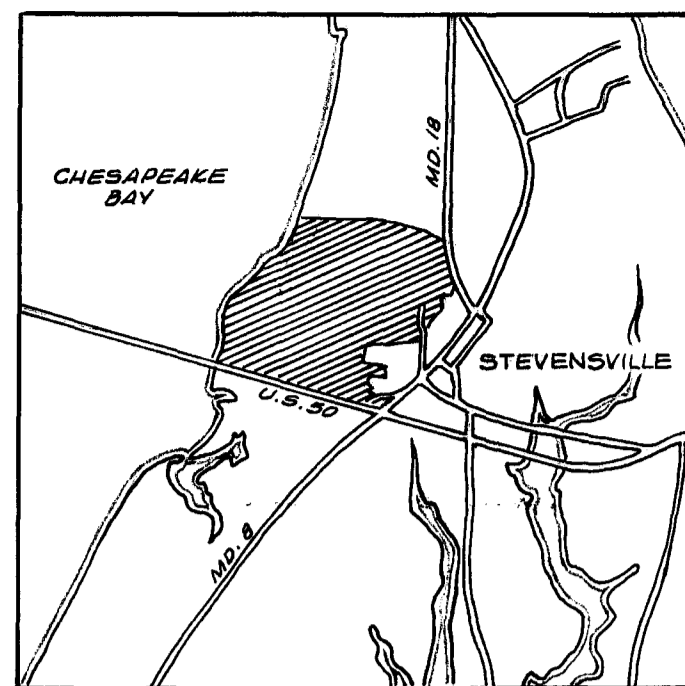

CHESAPEAKE BAY

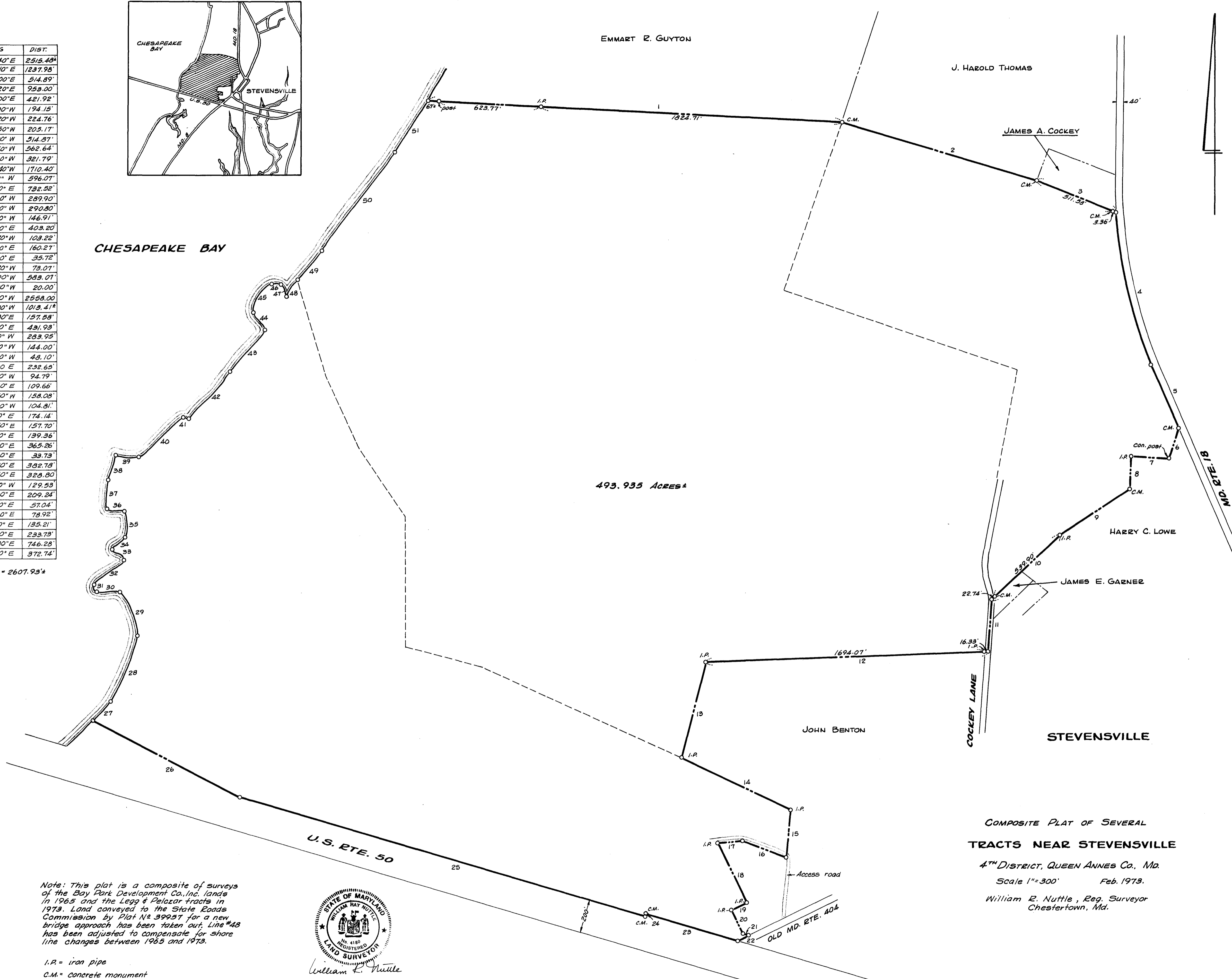

493.935 Acres ±

J. HAROLD THOMAS

JAMES A. COCKEY

HARRY C. LOWE

JOHN BENTON

STEVENSVILLE

JAMES E. GARNER

COCKEY LANE

U.S. RTE. 50

OLD MD. RTE. 404

COMPOSITE PLAT OF SEVERAL
TRACTS NEAR STEVENSVILLE
4TH DISTRICT, QUEEN ANNES CO., MD.
Scale 1"=300' Feb. 1973.
William E. Nuttle, Reg. Surveyor
Chestertown, Md.

Note: This plat is a composite of surveys of the Bay Park Development Co., Inc. lands in 1965 and the Legg & Pelczar tracts in 1973. Land conveyed to the State Roads Commission by Plat N# 39957 for a new bridge approach has been taken out. Line #48 has been adjusted to compensate for shore line changes between 1965 and 1973.

I.P. = iron pipe
C.M. = concrete monument

