

Churchill St. N. side  
East of Light St.

---

John O. Dumler

---

9-28-1951

107 1/109

See 10-4-1919  
11-2-1979

#9116

906

K2  
KW

George O'Brien Giam } July 28 1943

Loretta Giam - wife

Charles B Miller }  
Margaret M " wife  
M.L.P. 6485-266

Req. for the same on the line of the  
N. side of Little Church (now called  
Church Hill) St at the dist. of 93 ft 1/2  
w/o Nly. from the corner formed by  
the intersection of the N. side of Little Church St and  
the west side of William St and running th Nly.  
Evidently on the N. side of Little Church St 112 ft 1/2 w/o  
th Nly. and parallel w/ William St. 60 ft 2 w/o  
and th Ely. and parallel w/ Little Church St 12 ft  
4 1/2 w/o and th Sly. by a straight line 60 ft 2 w/o  
to the place of Ref. Annual Rent 27<sup>52</sup>

Being the 2ndly decs. lot of ground whch by deed  
of assignment dated July 24 1941. recd L.R. to Balt  
State Cur Deck, M.L.P. No 6132-422 was granted and  
assigned by the Tenants to the ward Geo O'Brien Giam  
- wife

From Mr. Dunder's  
Abstract of Title

S.P.+D. No Churchill St. E. of Light St.  
John O. Dunder, Atty

No. 122 E, Churchill St.

Req. for same on line of No Churchill St. (only Little Church St.)  
at dist. of 66'-6" Ely from N.E. cor. Churchill St. and "Z" Alley,  
and runq th. Ely bdy. on Churchill St. 12'-6" th. N. parallel with  
"Z" Alley 56'-6" to a 4 foot Alley; th. Wly bdy. on said 4 ft. alley  
12'-6" and th. Sly 56'-6" to place of beg.

No. 124 E, Churchill St.

Req. for the same on the N. side of Churchill St. (only L. Church St.)  
at the dist. of 77'-1" Ely from the N.E. cor. Churchill St. and  
"Z" Alley, and running thence Ely on Churchill St. 12'-6" thence  
Nly parallel with William St. 55 ft. to an alley 4 feet wide,  
with the use thereof in common; th. Wly along S.S. said alley,  
and parallel with Churchill St. 12'-6" and th. Sly by st. line to beg.

MONTGOMERY ST.

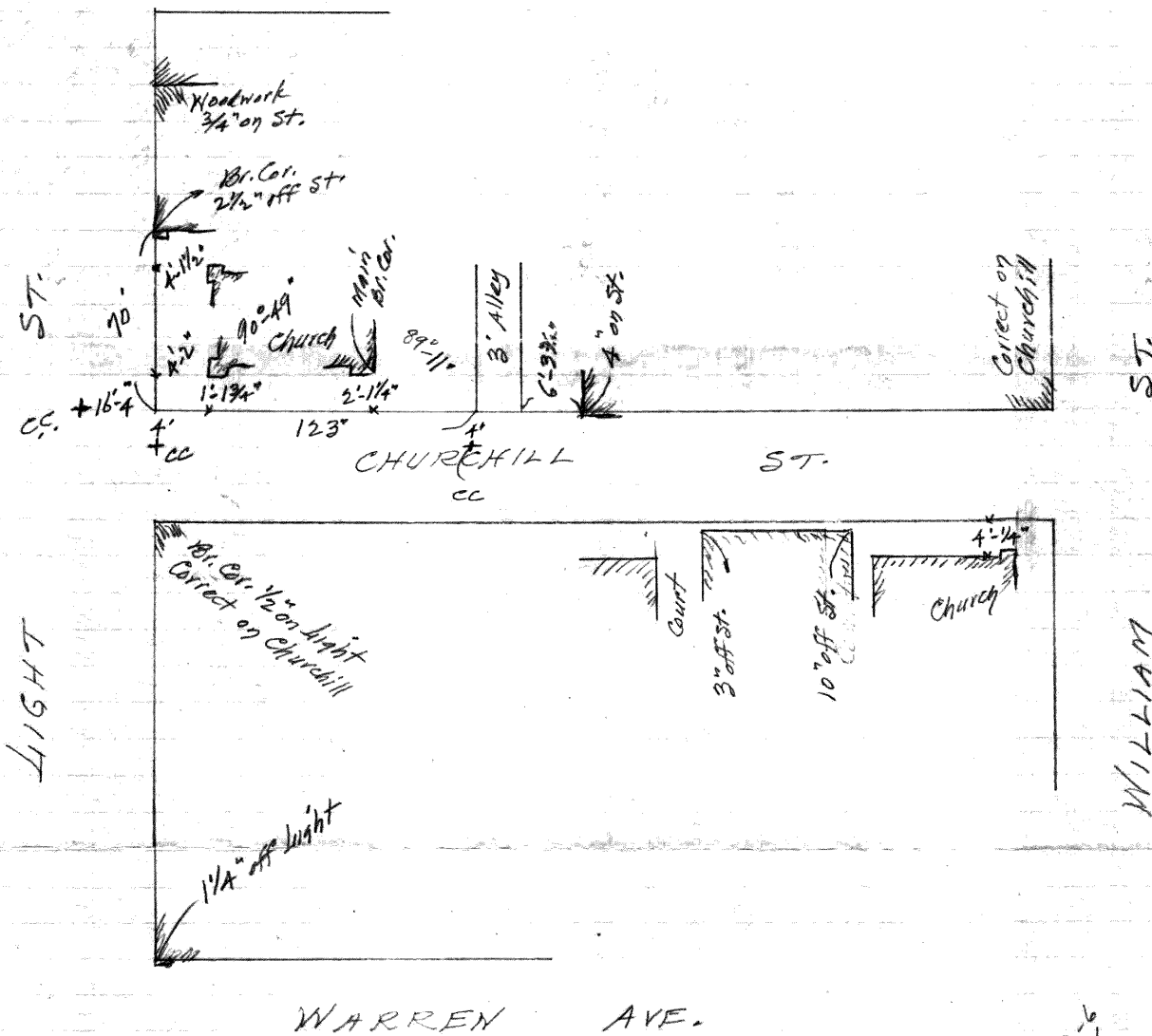

22-6  
20-6  
21  
74

LAW OFFICES OF  
**KOHLERMAN AND DUMLER**  
1405-1406-1407 FIDELITY BUILDING  
CHARLES AND LEXINGTON STREETS  
BALTIMORE-1. MARYLAND

HARRY A. KOHLERMAN  
JOHN O. DUMLER  
—  
PAUL BEALL

TELEPHONE  
PLAZA 1188

October 23, 1951

S. J. Martenet, & Co.  
9 E. Lexington Street  
Baltimore 2, Maryland

Gentlemen:

Enclosed, herewith, you will find  
our check in the amount of Sixty-Five Dollars (\$65.00)  
in payment of plat and location survey on 122-124 E.  
Churchill Street.

Please send me a receipt for this  
amount.

AG  
Enc.

Yours very truly,

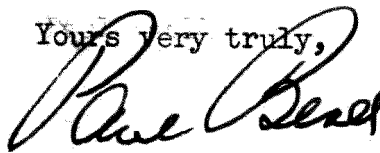

Paul Beall

NOS. 122-124 E. CHURCHILL ST.

BEGINNING for the same on the North side of Churchill St. at the distance of 198 feet and 6 inches Easterly from the Northeast corner of Churchill and Light Streets, which place of beginning is also distant 66 feet and 6 inches Easterly from the Northeast corner of Churchill St. and an alley 12 feet wide now partially closed, but heretofore laid out and known in the past as "Z" Alley; and running thence Easterly, binding on the North side of Churchill St. 25 feet and 1-3/4 inches to the Southeasternmost corner of the brick building erected on the lot of ground now being described, thence Northerly binding along the East side of the Easternmost wall of said brick building, 56 feet and 5 inches to the Northeasternmost corner thereof; thence Westerly, parallel with Churchill St. and binding along the North side of the Northernmost wall of said brick building, 25 feet and 2-3/4 inches to the Northwesternmost corner thereof, which last described point is now found to be distant 199 feet and 3-1/4 inches Easterly from the East side of Light St. and 67 feet and 3-1/4 inches Easterly from the East side of said alley 12 feet wide now partially closed, but heretofore laid out and known in the past as "Z" Alley; and thence Southerly, parallel or nearly so, with the line herein secondly described, 56 feet and 5 inches to the place of beginning.

Subject to the right, if any such exists, of the owners and occupants of the premises adjacent to the East of the lot hereinabove described, to maintain an overlapping of their building onto the aforesaid Easternmost wall of the building erected on the lot hereinabove described, to the extent of about 4 inches at the North side of Churchill St. and of about 8 inches at a point about 36 feet and 6 inches North of said North side of Churchill St. as said condition now exists.

October 15, 1951

2nd

Desen 10-15-1951 for John O. Dumlery

Nos 122-124 E. Churchill St.

Req. for the same on the N. side of Churchill St. at the distance of 198 feet and ~~6~~<sup>6</sup> ins. Ely from the N.E. corner of Churchill and Light streets, which place of beginning is ~~at the SW most corner of the Brick Building erected on the lot of ground now being described,~~ is also distant 66 feet and 6 ins. Ely from the N.E. corner of Churchill St. and an alley 12 feet wide now partially closed, but heretofore laid out and known in the past as "Z" Alley; and running thence Ely, binding on the N. side of Churchill St. 25 feet and 1<sup>3</sup>/<sub>4</sub> ins. to the SE most corner of the Brick Building erected on the lot of ground now being described, thence Nly binding along the E. side of the Easternmost wall of said Brick Building, 56 feet and 5 ins. to the NE most corner thereof, thence Wly, ~~binding~~ parallel with Churchill St. and binding along the N. side of the Northernmost wall of said Brick Building, 25 feet and 2<sup>3</sup>/<sub>4</sub> ins. to the NW most corner thereof, which last described point is ~~distant~~ now found to be distant 199 feet and 3<sup>1</sup>/<sub>4</sub> ins. Ely from the E. side of Light St. and 67 feet and 3<sup>1</sup>/<sub>4</sub> ins. Ely from the E. side of said alley 12 feet wide now partially closed, but heretofore laid out and known in the past as "Z" Alley; and thence Sly, parallel or nearly so, with the line heretofore secondly described, 56 feet and 5 ins. to the place of beginning.

Subject to the right, if any such exists, of the owners and occupants of the premises adjacent to the East of the lot hereinabove described, to maintain an overlapping of ~~the building erected~~ their building onto the aforesaid Easternmost wall of the building erected on the lot hereinabove described, to the extent of about 4 inches at the North side of Churchill St. and of about 8 inches at a point about 36 feet and 6 inches North of said N. side of Churchill St. as said condition now exists,

October 15-1951





8427

OMIOM  
TVE COM ENT

11.7  
13.6  
15.7

Montgomery St



Ally's work Church of Churchill St

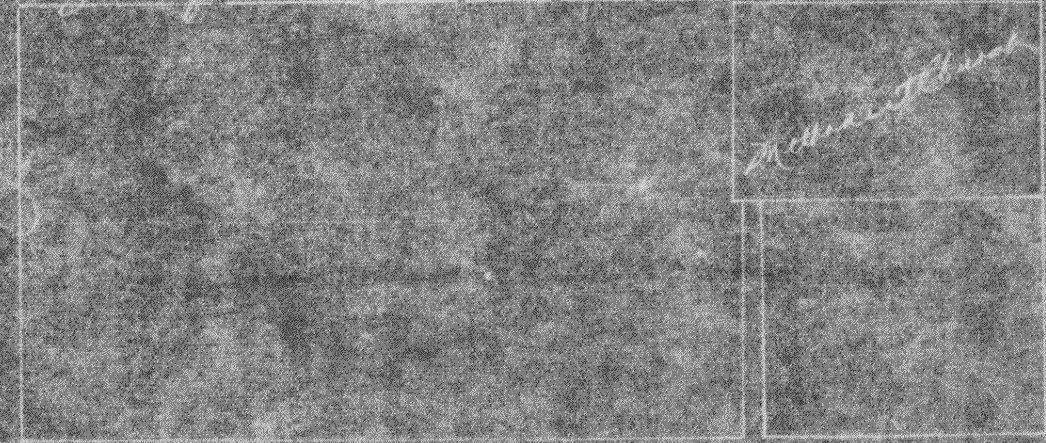

11.7  
13.6  
15.7  
10-90  
11-50  
MILLERS FALLS  
OMIOM



