

Satapesco Neck
Todd, Green, et al

144
—
12

96

Patapsco Neck.

Goodwin, Todd, Green

and others papers

Goodwin's Land
now

Roberts & Hill -

Palapoo Neck
E. of Todd's Land
& adj it.

Philip Jones } ✓ 6.
to }
Ruxton Gay } Lowrey²

63rd part of Dickenson

Received the ninth Day
of November 1759 of Grantee
to be Recorded (duty paid) &
then Recorded in Liber **B**
N. H fol 2, 3, & 4
Bordley Clerk of the
Court

(Exam.)

~~27-24
Received Grantee of November 1759~~

This Indenture made the Eleventh . . . Day of August, in the year of our Lord One Thousand Seven hundred and fifty Nine. Between Philip Jones of Baltimore County in the Province of Maryland Gentleman, of the one part, and Nicholas Ruxton Gay of the same County and Province of the other part Witnesseth. That the said Philip Jones for and in consideration of the sum of Eighteen Hundred pounds of Tobacco and Seven pounds current money to him in hand by the said Nicholas Ruxton Gay paid, the receipt of which he the said Philip Jones doth hereby acknowledge and himselfe to be therewith fully satisfied, contented and paid, hath given, granted, Bargained sold, Alien, Infeoffed, & confirmed; and by these presents doth give, grant, Bargain, Sell, Alien, Infeoffe, & confirm unto him the said Nicholas Ruxton Gay his Heirs and assigns for ever all that part of a tract or parcel of Land called Dickenson, lying & being in the County aforesaid, which is contained within the following metes and bounds, courses and Distances Viz Beginning at the beginning of the whole tract as mentioned in the Certificate and Patent of said Land; and running thence bounding on the original courses of the whole tract the two following courses Viz. North North East bounding off Chas a peak Bay fifty perches unto the South side of a Marsh known by the name of the great Marsh; Then North West by North two hundred and forty eight perches untill it intersects the South line (being the second line) of a tract of land called Thwreld Neck. Then bounding on and with that line South Eighty three perches untill it intersects the given line of the whole tract called Dickenson; and then bounding on and with that line straight unto the beginning containing Sixty three acres more or less; Together with all rights, Proffits, Benefits, Priviledges, and advantages Premises and appurtenances, to the said Bargained parcel of Land belonging or in anywise appertaining. To have and to hold the said Bargained Parcel of Land with the premises and appurtenances unto him the said Nicholas Ruxton Gay his Heirs and assigns for ever and to his and their only proper use and behoofe. And the said Philip Jones for himselfe and his Heirs doth hereby covenant, grant promise and agree to and with the said Nicholas Ruxton Gay his Heirs and assigns, that he the said Philip Jones & his Heirs shall and will Warrant and defend the said Bargained parcel of Land with the premises and appurtenances unto him the said Nicholas Ruxton Gay his Heirs and assigns for ever against all, and all, manner of person or persons lawfully claiming from by, or under him the said Philip Jones or his Heirs, or by his or their means or procurement. In Witness whereof the said Philip Jones hath hereunto set his Hand, and affixed his Seal the Day & year above written

Sealed and Delivered in Presence of

Philip Jones

Wm: Rogers
Wm: Lyon

Received Novem. 8th 1759 Two Shillings & Sixpence half
penny Sterling Alienation fine on Joseph Three Acres the
Within mentioned Land for his Roadways use by order
Edw^d Lloyd Esq. Agent

John McCaully Junr

Received this 11. day of Aug^r 1759 of Nicholas Auston Gay
Eighteen hundred pounds of Tobacco and Seven pounds current money
being the consideration mentioned in the within Deed for the within
bargained parcel of Land and Premises; as Witness my Hand &
Witness

Wm: Rogers

Philip Jones

Copy (under seal)
Certificate
Sampsons addition

Copy Under seal
Certificate
Sampsons addition

Richard Sampson October the 20th 1698.

Cert. 500 acres } By Virtue of a warrant granted unto Richard Sampson
of Baltimore County for fifty @ of Land bearing date the 4 day of
August 1699 - These are therefore to Certify that I Thomas Richardson
Dy. Just under Clement Hale Jun. Con. of the western shire have
cut out for the said Richard Sampson a parcel of Land called Sampsons
Addition lying in afe County on the south side of Back River
Beginning at a bounded red oak on a point of woods nigh
unto a great Marsh running thence to North with a line of a
parcel of Land of the afe: Sampson one hundred and fifty ps to the
side of Back River thence West and by South half a point southerly
seventy four ps to a bounded water oak of a parcel of Land formerly
taken up by Richard Thorrold running thence with the line
Thorrolds line South one hundred and thirteen ps to a bounded
red oak thence with a direct line to the first bound tree Cont: fifty
@ of Land to be hold of the Manor Baltimore fmo

Thos. Richardson Dy. Just

In Testimony

that the foregoing is a true Copy from
Liber C. C. No. 4 folio 129. one of the
Books belonging to the Land Office of
The State of Maryland I have here to
set my hand and affixed the seal of
Office this 12 day of September 1795

In Callahan Roydoff

130¹⁹ 66: @ 1246.
is 479

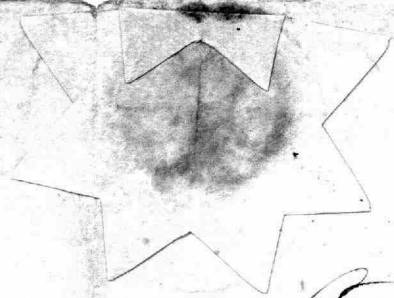

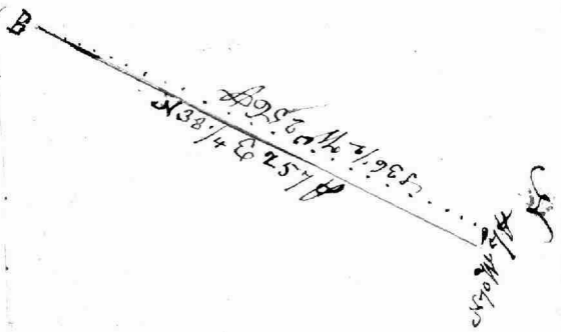

B The Beginning at a Stone at
 dentons Creek running N 38 1/4 E 257 ft
 thence N 70 1/2 W 7 ft to a Stone
 Thence running the division
 line S 36 1/2 W 256 to Beginning

Capt Ridgely
from

N. R. Gay-

Roberts Land
+

Hills Land

Palapsovek

Plat from N. Gay

For Capt Charles Ridgely

For Capt Charles Ridgely

Plat from N. B. Gray

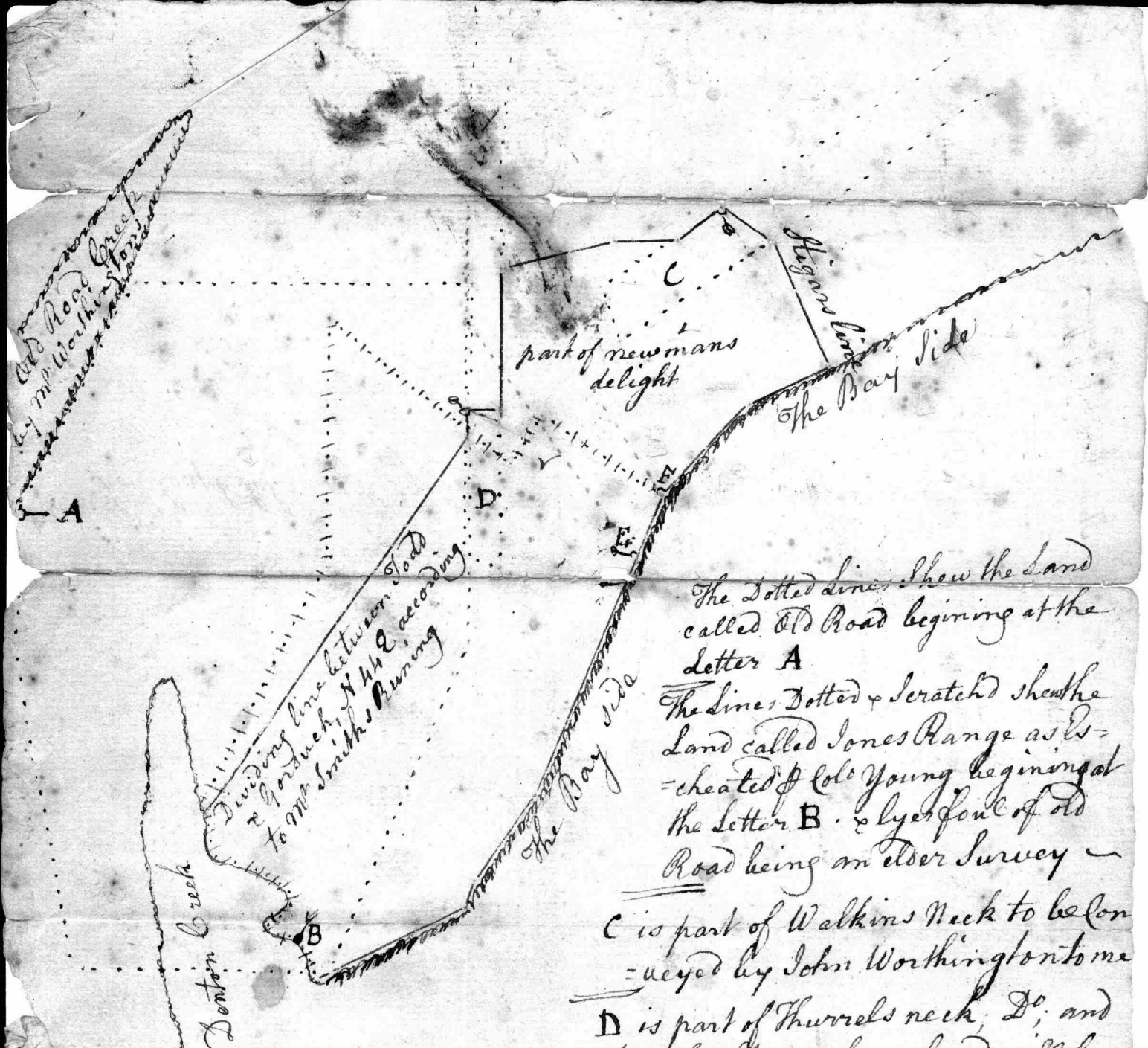

The Dotted lines show the Land called Old Road beginning at the Letter A

The lines Dotted & Scratched show the Land called Jones Range as is - cheated of Colo Young beginning at the Letter B. & lies foul of old Road being an older Survey -

C is part of Walkins Neck to be conveyed by John Worthington to me

D is part of Thurrels neck; D; and then the shape of my land will be as the plain black lines;

In 1683 Charles Gorsuch owned ~~Jones Range~~ part of old Road; & Thomas Tod the other part. and in that year made a Division of old road

Charles Gorsuch conveyed all the tract called Jones's Range to Roger Newman in 1680 -

Roger Newman took up Newmans delight in 1688 -

Said Newman dyed near abt 70 year agoe & left only one Sister, married to Doct^r Coatsworth (of London) - She & her Husband died within a few years of each other, above 20 years agoe, without a child, or any Relation of hers, that can yet be found

Colo Young & cheated Jones Range near 20 years agoe; & I afterwards & cheated Newmans delight, & bought Jones's Range from him

After that I bought from Philip Jones 63. ^a part of a tract called Dickinson, beginning at E. & running to F. & then as ff the red dotted lines; - Dickinson is younger than Jones's Range, but older than Newmans delight

Old References
- to

Patent lines

Jodd-Roberts

Hill &

Course of several Tracts of land

N. 13.

60 fts in the S line of Thurrells neck clear the P. plantation
At end of 220 fts in the above line is the N side of the marsh

25	
100	
2500	/ 15
16	
90	

11

The courses of old Road S. by the creek 90 ffs to a branch. Then
S by E from the branch 230 ffs. E to the bay, NNE 250 ffs. N 250 ffs.
W untill it Intersects a Parallel from the head of old Road Creek; on the
W with the said Creek & River for 1100 acres; Copy from Lib^r D. folo 26.

Ardens Adventure, Begins at abounded hichory standing in Gum
Bite, & running thence S 100 ffs. W 160 ffs. then N with a lode called Thurr-
rells Coue to Back River; then with said River to the first bounded tree
for 100 acres; from Patent dated April 11. 1682

Bagfords fortune, Begins at ab Gum being the first b^r tree of the land
called Walkins Neck, and running with the said land S 56 1/2 W 80 ffs. S.
E 20 ffs. S 57 E 60 ffs. N 65 E 86 ffs. N 38 W 68 ffs. N 10 E 57 ffs. N 44 E
40 ffs. N 32 ffs. S 75 W 36 ffs. S 42 W 106 ffs. & then to the begining for 80.
Warrt Issued in 1724

Walkins Neck lying between Back River & Walkins Creek, bounded by
the said Creek from a marked Sweet Gum, running along the River N N W
for breadth 40 ffs, unto a marked white Oak. S W by W for length 320 ffs.
SSE 40 ffs. N E by E 320 ffs. to the marked Sweet Gum for 80.

Thurrrells neck begins at a marked red Oak & running up the River W
N W 25 ffs. to a chestnut Oak. Then S. up along by a marked 320 ffs. ESE 25
ffs. then to the beg^r for 50 acres - Pat^r Feb^r 21. 1661

Hoopers Island, Begins at a marked sweet Gum tree & runs thence
50 ffs for breadth N N W to the River side cross the Island, S W 320 ffs.
SSE 50 ffs. & then to the begining for 100 acres.

from the end of the N 100 ffs line of Newman's delight, N 100 ffs. N 72
E 14 ffs. to the beg^r of Thurrrells neck

At the end of 431 ffs in the 442 ffs line of Newman's delight, blazed a
white Oak on 4 Sides by the edge of the Marsh near Luckolds Coue &
add 10 ffs to S^d 442 ffs line to reach the Coue

from end of said 452 ffs line by S^d line N 80 W 60 ffs. N 23 W 57 ffs.
to ab Gum the beg^r of Walkins neck & Bagfords fortune

from said Gum N 70 1/2 W 38 ffs. S 76 W 46 ffs. S 72 W 30 ffs. to the beg^r
of Ardens Adventure

from the end of the above 452 ffs line ran back 4 ffs, then S 39 E 39 ffs to
the bay

Priviledge Granted to Tho Todd June 13th 1734. Beginning
at ab^o Gum & ab^o Hickory standing by the said River &
Running thence S W 286 ffs; N W 30 ffs; N 5 W 112 ffs; E
100 ffs; N 50 E 92 ffs; & then ~~at~~ for 100^a a true copy
from Patent

at end of ^{220 ffs in} S W by W line of Walkin ^{marked} a Wh oak with
9 notches at the head of ^{where} the marsh from ^{to} divide ran
S 30 E to the given line

60 ffs in the S line of Thurrells necks clear the Plantation

At end of 220 ffs in the above line is the N side of the ^{marsh}

Courses of several Tracts of land

N. 13.

25
100
2500 / 15
16
90

11

N 73 E 20
 N 64 1/2 E 38
 N 15 E 4
 N 50 E 32
 N 47 1/2 E 52
 N 36 1/2 E 50
 N 31 E 70
 N 39 E 36
 N 25 E 84
 N 36 E 100
 N 55 1/2 E 160
 N 60 E 74 *Sw pt 332 E*
 N 83 W 14
 N 38 1/2 W 6
 WNW 10
 S 13 W 30
 S 60 W 30
 N 35 W 37 to *BR*
 N 87 1/2 W 40
 S 82 W 50
 S 24 W 20
 S 40 W 20
 S 63 W 30
 S 77 W 26
 S 89 W 86

$$\frac{741(2\frac{1}{2})}{640}$$

$$\frac{101}{80}$$

S 25 E 40
 S 21 E 20
 S 12 E 44
 S 3 W 52
 S 10 W 56
 S 27 1/2 W 90
 S 50 W 24
 S 59 W 30
 S 83 W 60
 S 18 1/2 W 14
 S 5 W 20 *at 2 ft all along*
 S 19 E - 24
 S 65 E - 5
 S 30 E - 10
 S 8 W - 10
 S W - 26 *to where we began*
 from beginning S pt S 46 1/2 E
 we ran to W ³⁸ pt over
 the gut from where the end
 of the 452 ft line of row-
 mans delight bears N
 39 W

(copy of descent on 10/10/18)

Course of
The Asthenus of Davion

The Attornies of Daxion Granted Nichol^s Ruxton Gay the
 29th Oct. 1755. lying in Balt^o Co. on the bay side between the mouth
 of Patuxent and the Mouth of back river. Beginning at the end of
 the first line of a tract of Land called Bagfords fortune and in the given
 line of a tract called Watkins Neck and running thence bounding on
 and with Bagfords fortune the two following Courses viz. S 25° E 20 p^{er}
 S 31° E 32 p^{er} until it intersects the second line of the original survey then
 bounding on the Original survey N 81° 45' E 49 p^{er} until it intersects
 the N 65° E 80 p^{er} line (being the fourth line of the afo^{re} tract of Land
 called Bagfords fortune then bounding) on that line of Bagfords
 fortune to the end thereof N 65° E 25 p^{er} unto Cuckolds Cove then bounding
 round on said Cove the four following Courses viz. S 63° and 30' E 15 p^{er}
 S 36° E 32 p^{er} N 61° and 30' E 16 p^{er} N 16° W 70 p^{er} unto the point of
 Marsh making the mouth of Cuckolds Cove on the east side thereof
 then bounding down on and with back river the three following Courses
 viz. N 73° 43' E 15 p^{er} N 53° E 54 p^{er} S 26° E 120 p^{er} until it intersects
 the East South East of the original survey then bounding on that side of
 the original survey N 10° E 36 p^{er} unto Chesapeake bay side then bounding
 down on said bay with the said bay side the seven following Courses viz.
 S 34° 30' W 179 p^{er} S 51° W 87 p^{er} S 10° W 10 p^{er} S 61° W 72 p^{er} S 40°
 W 220 p^{er} S 64° W 84 p^{er} S 42° 30' W 107 p^{er} unto the end of the N 10° E
 230 p^{er} line of a tract of Land lately coveanted by a certain W^m Young
 and formerly belonging to Roger Newman called Joneses Range then
 bounding on Joneses Range as surveyed for the said William Young the
 three following Courses viz. N 71° W 94 p^{er} S 33° W 39 p^{er} S 74° W 8
 p^{er} until it intersects the given line of a tract of Land called Sherrills
 rock then bounding on the said given line N 131 p^{er} unto the end of the
 S 113 p^{er} line of a tract of Land called Sampsons Addition then
 bounding on the given line of Sampsons Addition and a tract of Land
 called Ardens Adventure N 81° 45' E 115 p^{er} until it intersects
 the S 41° W 320 p^{er} line of a tract of Land called Watkins Rock
 then bounding on that line of Watkins Rock to the end thereof N 41° W 11
 54 p^{er} then still bounding on Watkins Rock S 10° E 40 p^{er} then
 bounding on the given line of said Land N 10° E by E 120 p^{er} until it
 intersects the W 100 p^{er} line of the afo^{re} tract of Land called
 Ardens Adventure then bounding on that line of Ardens
 Adventure reverse of the same E 152 p^{er} unto the end of the fourth
 line (being the first line of said Land) then bounding on said fourth
 line of said Land reverse of the same N 34 p^{er} until it intersects
 the given line of the afo^{re} tract of Land called Watkins Rock
 and then with a straight line to the place of beginning cont^{inued}
 and laid out for 300 Acres more or less

True & Trust from Lib^{er} B. H. G. No 34. 235

Wm. Callahan Prop^{er}

William Lux's Cert. of
The Isthmus of Darien
300 acres

Pty

1800
~~1768~~
46
75
30.

81 ³/₄
~~1 ¹/₄~~
82 ¹/₄

Parent of
"Ismus of
Darian"

West 107 fts, unto the end of the NNE 230 fts line of a tract of land lately escheated by a certain William Young & formerly belonging to ~~the~~ Roger Newman, called Jones's Range. Then bounding on Jones's Range as surveyed for the said William Young

of land lying and being in the County afores. called Newman's delight Originally granted unto a certain Roger Newman for 450 acres, & to my out lines to add any vacant Land thereto contiguous &

I Nicholas Ruxton Gay Deputy Surveyor of Baltimore County have ^{carefully} surveyed & laid out for & in the name of him the said William Young the aforesaid Tract or parcel of escheated Land according to its antient Metes & bounds ^{viz} Beginning at a White Oak tree blown down some years agoe, and lyes on the North side of a Large Marshy Branch; The said tree being shewn to me by Philip Jones late Deputy Surveyor of Baltimore County and other Neighbouring persons to be a Dividing tree between ~~the~~ Thomas Todd & the afores. Roger Newman and the Original beginning bounded tree of Newman's delight. And running thence N 100 fts, N 01.° E 045 Min & 452 fts, to the West side of a place called Gucholds Cove (The bounded white Oak called for at the end of this Course said to stand on the W side of Gucholds Cove not being known.) Then N 26° E 30 Min & 310 fts. ESE 145 fts, to Chesapeake Bay side, (The bounded white Oak called for at the end of this Course, said to stand by the Bay side, not being known,) Then bounding down on the Bay side as expressed in the Original Certificate the 7 following Courses ^{viz} S 34° E 30 Min W 179 fts; S 51° W 07 fts; S 10° W 10 fts; S 61° W 72 fts; S 70° W 220 fts; S 64° W 08 fts; S 42° E 30 Min W 107 fts, to the lower end of a Marsh called the Great Marsh (The bounded white Oak called for at the end of this line not being known)

then with a straight line to the beginning containing & laid out for 495 acres more or less 153 acres part of which lyeth in Navigable water & 46 Acres other part thereof is taken away by elder Surveys

I also Certifie that I have excluded such parts of the aforesaid tract of land as lyeth in Navigable Water & elder Surveys and have added to the residue of said tract of Land the quantity of nine Acres of vacant Land, and have reduced the said residue & vacant Land added into one entire Tract bounded as follows ^{viz} lying in Baltimore County on the Bay side between the Mouth of Back River and the Mouth of Back River; Beginning at the end of the first division of a tract of Land called Bagford's, and in the given line of a tract of Land called Walker's Neck, and running

thence bounding on and with Bagford's fortune the 2 following Courses ^{viz} S 57° E 32 fts, untill it Intersects the 2. line of the Original Survey; Then bounding on the original Survey, N 01.° E 45 Min & 79 fts, untill it Intersects the N 65° E 26 fts line, (being the 4. line of the afores tract of Land called Bagford's fortune). Then bounding on that line of Bagford's fortune to the end thereof N 65° E 25 fts, unto Gucholds Cove; Then bounding round on the said Cove the 4 following Courses ^{viz} S 63° E 30 Min & 15 fts; S 06° E 32 fts; N 61° E 30 Min & 61 fts; N 16° W 70 fts, unto the point of Marsh making the mouth of Gucholds Cove on the East side thereof; Then bounding down on & with Back River the three following Courses ^{viz} N 73° E 30 Min & 05 fts; N 53° E 57 fts; N 26° E 120 fts; ~~Then~~ untill it Intersects the ESE line of the original Survey; Then bounding on that line of the Original Survey;

50 & 30 fts, unto Chesapeake Bay side; then the said Bay side the 7 following Courses ^{viz} S 34° E 30 Min W 179 fts; S 51° W 07 fts; S 10° W 10 fts; S 61° W 72 fts; S 70° W 220 fts; S 64° W 08 fts; S 42° E 30 Min W 107 fts (New)

Walkins Acker
No. 7 Feb. 1661

Sampson's
Addition

Oct. 1698

beginning of my father's fortune of
Waltham street, my father's fortune
worth 56 $\frac{1}{4}$ west 100 hundred
£256 20 hundred 357 East
Capt. Charles Ridgely
60 hundred Mr. G's East 106, 100
Mr. 300 W 600 N. Mr. 10 £ 57
Mr. 44 East 240 N

D^r Sir)

I have partly agreed with Mr. Usher. It now depends upon
my selling my own Land about which I would wish to see
you, if you go into the Forest to morrow I will meet you
there the next day as I must determine in two days —
Acc^{ts} from Virginia say that there is about 4000 of the
Enemy landed. They have taken the Fort at Portsmouth
and the Garrison Prisoners — The Inhabitants of this
Place are much alarm'd —

Yours &c^a

J. M. Stoddard

Tuesday - 18 May 1779 —

Positiv

Courses from Deed to Washington
Mary his Wife

to
V. 15 N. D. Gay

Sept. of Watkins Neck 27 Oct.
Sept. of Thumelle Neck 15 Oct.

Deed of

John Worthington & Mary his Wife's Deed to Klyp
of Malkin's Neck & Thurnell's Necks, contained within
the following Meets & Bounds, Courses & Distances —

Beginning for the part of Malkin's Neck at the End of
220 ft. in the SW by W Line of the said Land at or near
which Place the White Oak Tree is now marked with nine
notches & running thence bounding on the said line unto the
end thereof SW by W 100 ft., then S E 40 ft. N E by E 116 ft.

& then with a straight Line unto the aforesaid place of
Beginning containing 27 Acres more or less, Beginning for
the part of Thurnell's Necks hereby bargained & sold & at the
End of 220 ft. in the Southline of the said Land at or near
which place a sweet Gum Saplin is now marked with
9 notches & running thence bounding on the aforesaid line
unto the end thereof S 100 ft. then S E 25 ft. N 110 ft. then with
a straight Line to the Beginning aforesaid for 15 Acres
more or less

SSE. 22 1/2
NE by E. N 5 1/4 W - 116 ft

45
11 1/4
11 1/4
89 1/2 320
 116
 204
 173

Walkers Neck

Beginning at Abound Sweet ham
and running thence

N. N. W. — 40 f.

S. W. by W. — 220

S. S. E. — 40. Thence to the
first beginning. Said out for
200 Ac.

~~Private~~
Murchison's Neck

W. N. W. — 25 f. to a Chestnut
Oak

S. — 320^v

E. S. E. — 25

N. — 320 to by ²

Barrow S 33 1/2 E 8^v

49 1/2
27
—
76 1/2

17
12
—
204
5.10
—
2.10

Walkers Neck
Beginning at Abound Sweet ham
and running thence

N. N. E. — 40^o

S. W. by W. — 92^o

S. S. E. — 40. Thence to the
first beginning. Laid out for
100 Ac.

~~Private~~
Shurcks Neck

W. N. W. — 25^o to a Mount

Oak

S. — 92^o

E. S. E. — 25

N. — 320 to by

Narrow S 34^o E 8^o

49^o
27
76

17
204
S. 10
2. 10

on the 2^d line of Dalhousie Neck
S 6^o W 26^o to the water

N 73^o E 8^o
N 64^o E 2^o S.
N 59^o E 22
N 44^o E 30 to the 2^d line of
Dalhousie Neck three Camps
since the Survey

Gods Industry

Aug: at a bound white Oak

E by N. 100 up a valley

N $\frac{1}{2}$ pt. E 225

S by W. 30

N 70 $\frac{1}{2}$ W. 24

S 90 $\frac{1}{2}$ W. 40 Down Hill

S 90 E - 60

S 70 W - 20

N 84 W - 36

N 42 $\frac{1}{2}$ W - 32

S 25 $\frac{1}{2}$ W - 32

S 25 $\frac{1}{2}$ W - 12 Bound on Do.

S 40 W. ~~16~~ 24

S 100 E - 24

S 69 W - 16

S 98 $\frac{1}{2}$ W - ~~24~~ - 24

Th. 2 by fa. 120⁰

$\frac{56 \frac{1}{2}}{4} = 14 \frac{1}{8}$

$\frac{56 \frac{1}{2}}{4 \frac{1}{2}} = 12 \frac{1}{2}$

Nil in the N. 1/2 pt.

[Faint handwritten notes at the top of the right page, possibly including "Bound on white Oak"]

[Faint handwritten notes on the right page, including "S 60 E", "S 60 W", "S 90 E", "S 90 W"]

23rd
Ducting from
state of Georgia as
run N 7 1/2 E 1/4 of
to a large state

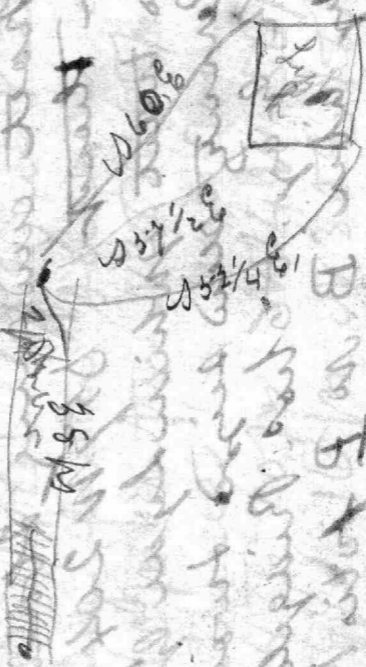

[Faint, mostly illegible handwritten text, likely bleed-through from the reverse side of the page.]

Lot No 1 is composed of the following tracts and parts of tracts of land lying in Patuxent Neck in Baltimore County. to wit. Part of "Mottin Neck". part of "Thurman's Neck". part of "De Kerson". "Jones Range". "The Isthmus of Darien". old road better secured "The Angle" and "the Oblong". Beg. for the out bounds of the said several tracts at a large red oak tree at the letter A. upon the plat, being the last boundary of the Tract of land called "Sampsons Addition" and may thence N 82 E 68 ps North 130 ps to Back River then with the River East 5 ps then South 118 ps then East 12 ps N 56 1/4 E 72 ps S 45 E 40 ps S 56 1/4 W 14 ps East 71 ps North 48 ps N 56 1/4 E 54 ps S 25 E 20 ps S 59 E 60 ps N 65 E 86 ps to Cuckolds Cove then bounding on the water of the Cove S 39 E 33 1/2 ps to the Bay side. then bounding on the water of the Chesapeake Bay. the following courses S 69 W 132 ps S 24 1/2 W 17 ps S 56 W 220 ps S 34 1/2 W 80 ps S 19 1/2 W 26 ps S 27 1/2 W 53 ps S 14 1/2 W 98 ps S 56 W 18 ps S 3 W 56 ps S 2 E 24 ps S 40 W 16 ps N 76 1/2 W 22 ps S 50 1/2 W 50 ps S 67 W 27 1/2 ps N 81 1/2 W 13 ps to the mouth of Denton Creek then run up and bounding on the water of the said Creek to a stone marked C. hereupon planted as the beginning of the line dividing the land of said Lyde Goodwin from the land of the late Bernard Todd then running and bounding on said division line the 2 following Cos. viz N 39 E 242 ps to a stone N 2 W 109 ps to

A stone stile N 21 W 27 ps to the 2nd line of
Dickerson thence S 39 E 33 ps to the last
line of Sampsons addition and thence
to the begining containing 680 $\frac{1}{4}$ $\frac{1}{2}$ $\frac{1}{4}$
and 32 square perches of 20 more or less

No. 2 being part of a tract of land called
Pasture granted Charles Bridgely 12th
Dec: 1783. lying in Patuxent Neck

Begin for the same at the distance
of 60 ps on the N 38 W 68 ps line of "Bridgelys
Fortune" and run thence
N 48 E 20 ps N 14 W 36 ps N 22 E 30 ps
N 59 $\frac{1}{2}$ E 16 ps N 30 E 18 ps East 18 ps
N 7 E 30 ps N 51 W 26 ps N 4 W 10 ps
S 62 W 32 ps S 33 W 31 ps N 45 E 36 ps
S 32 ps S 44 W 40 ps S 10 W 57 ps and
thence by a straight line to the begining
containing 15 $\frac{1}{2}$ of 20 more or less.

True extracts from the return of
the Commission for the Divi-
= sion of the Real Estate of Lyde Good
= vinn

Two Glenn Hill to Meritt
all those two parcels above and
Bottle Co. at the lower end of Potops
= co neck of which Mulgoodwin lot of
Bottle County and seized to wit

all the following part of "Notkins Neck"
Beg. for the said part at the beginning
of the whole tract and may stand
on the outside thereof S57W 204 ps to
the part of said tract which by de Goodwin
lot of Bottle County and seized two cer-
= veys by N. B. Gay, & Chas. Bridgely as
will appear by liber B. no P folio 164 the
one of the records of Bottin County Court
then binding on said part N45W 40 ps
to the outside of the said land called Notkins
Neck - ~~S45W 40 ps~~ 2 courses to wit
N57E 219 ps D23E 40 ps to the begin-
= ning, containing 53 1/2 acres of land

All the tract of land called Beggs
Fortune surveyed for Geo. Stone 23^d
Feby 1724. on the west side of
Bottle River Beginning at a
boarded gum tree beginning
tree of Notkins Neck and may. with
said land S57W 80 ps D25E 20 ps
S57E 60 ps N65E 86 ps N38W 68 ps
N10E 57 ps N44E 40 ps North 32 ps
S45W 36 ps D42W 106 ps then to per
S1a 2.28th per measurement of Plat. of which

2^a 3^m 33^h the soil in Potkin
Noch. -

D. 26 1/4 N 40 4/16 ps
 Light house bear 29 1/2
 S 8 N 26 7/10 ps
 South 8 1/2 ps
 S 21 1/2 N 42 1/2 ps
 S 25 N 28 ps
 S 34 N 39 5/10 ps
 Explorer winter track
 the light house
 S 28 1/2 N 13 8/10 ps
 S 5 1/2 N 6 1/10 ps
 S 42 N 30 ps
 S 54 N 28 ps
 Light horn 29 3/4 N
 S 66 N 27 4/10 ps
 of Light house bear
 S 22 1/2 N
 S 8 5 3/4 N 13 ps
 N 37 1/2 N 2 ps
 N 8 7 1/4 N 22 ps
 S 67 N 2 ps
 S 80 N 10 3/10 ps

D. Curritum
 S 21 N 13 8/10 ps
 S 30 1/2 N 7 5/10 ps
 S 15 E 8 ps
 S 30 N 8 ps
 S 13 N 19 3/10 ps
 end of N E 44 5/10 ps
 line bear, S 55 1/2 N
 Light house bear
 S 13 E
 N 74 E 7 1/2 ps
 S 66 1/4 E 5 5/10 ps
 S 38 E 11 5/10 ps
 S 10 E 9 ps
 S 19 3/4 N 16 ps
 then
 run S 43 3/4 E 7 8/10 ps
 station is at 50 1/4 E
 11 ps line as run this
 day on Boylston
 then run from end
 of 16 ps line along shore
 S 44 3/4 N 6 1/2 ps to a
 station S 8-2 N 23 3/10 ps
 station I began at

N 72 1/2 E 63 2/10 ps
 to stat end of S 33 E 3 1/4
 line as run Wednesday
 S W Corn d. Light house
 bear S 84 1/4 E. N W Corn
 S 87 E. stat at Point
 of Island bar, N 75 1/2 E.
 Tall state bears
 N 75 3/4 E. then line to
 stat end of 448 ps. from
 S W Corn Light house
 bears S 78 1/2 E. & then
 from from stat end of
 448 ps are run
 N 77 N 60 ps.
 the N 20. W 57 the
 N 82 1/4 E 4 ps ending
 in chain then went to
 stem by Gato and to
 N 57 3/4 E 23 1/16 ps to end
 of 51 2/10 ps on the N 20 W 57.
 ps line as run

9 1/2
 17 1/2
 2 1/2

Courses of the Land
 Sold by
 J. Glenn & Wm H. Gatchell
 Trustees to
 Joseph Hart
 Nov

Phoenix Island
 Friday April 14th 1876
 Current survey for
 N W Hill began at
 a stem end of 60 ps line
 of Bagpuss Station at
 being a run below
 Hill & Easter and
 run line survey to
 N 55 3/4 W 59 ps then then
 at 27 ps a stem by fence
 then run from stem
 N 24 W 21 1/10 ps to a stem
 planted on north side of
 Easter house.
 line then S 22 1/2 E.
 then run from stem
 S 57 3/4 W 54 ps end of
 S 51 1/4 E from a north side
 at 23 1/2 ps fence, fence

Corner
~~Post~~ Post 24½ feet
 to right then run
 from end of 34 ps
 S 17° W. 48 ps then
 strike in marsh
 at 16½ ps crossed
 the cr 448 ps
 line as run on Medway
 near a stream on same
 line. Supper to a stream
 of 258 ps on same
 then N 89° W 74 ps
 set a stone in marsh
 then N 57½° E 16 ps
 N 29° W 68 feet to
 state and a stone in
 marsh. then run
 from end of 16 ps line
 N 44° W 40 ps then
 run N 23° W 4¾ ps to a pile
 of stones then run
 from stone pile the line
 of Mattins creek runs
 as run by at 12 in 1851
 S 58½° W 72 ps set a stone
 at 24 to center of road

Measure a small
 Chestnut tree
 then N 88¾° W 12 ps
 set a stone at 9½ ps
 center of a road
 then run line
 of Hads low how
 Hill
 S 60¾° E. 154. ¾ ps set
 stone at Bay shore.
 at 56 ps edge of
 marsh
 at 90 ps light house
 bears N 79° E from end
 of 154¾ ps run
 N 60¾° W 12 ps
 then N 55° E 82 ps
 Bay shore 200 feet on right
 then N 71¾° E 70 ps
 water 7 feet to right
 N 69° E ps then
 feet to right at 33 ps
 then 96 feet to right
 at 60 ps water 23 ps on
 right. at 76 ps water
 run N 73½° W 70. 10 ps at
 S E corner of house. Light
 House bears N 83° E,

at 39 1/2 p a Mark
 had out by x 1 person
 My rights.

Courses Comprising Part of the tract of land called the
 Esthims of Cabin and Part of the tract called Walkins Neck sold
 by John Clem and William H. Patchell Esq^s Trustees to Joseph
 Hart Beginning for the same at the end of West 160 perches line
 of Adens Adventure and running thence bounding on said line
 reversely East twelve perches until it intersects the Second line of Walkins
 Neck then bounding on said line reversely North 56 3/4 degrees East 72 per-
 ches then South forty five degrees East 40 perches until it intersects the given
 line of Walkins Neck then reversing said line and bounding thereon
 South fifty Six and three quarter degrees West ~~fourteen~~^{fourteen} perches until it
 intersects the Second line of Adens Adventure then running and bound-
 ing on said land reversely the two following courses viz East 70 perches
 North 48 perches until it intersects the given line of Walkins Neck then
 running and bounding on said line North fifty Six and three quarter
 degrees East fifty four perches until it intersects the end of the first
 line of Bagfords Fortune then running and bounding on said land
 the three following courses viz South 25 degrees East 20 perches South 57
 degrees East 60 perches North 63 degrees East 86 perches ^{the water of} to the holds
 Cove then bounding on the water of said Cove South 39 degrees East
 thirty three and a half perches to the water of Chesapeake Bay then run-
 ning and bounding on the water of said Bay the three following cour-
 ses viz South 69 degrees West 132 perches South 24 1/2 degrees West 9 per-
 ches South 36 degrees West 94 perches until it intersects a line drawn
 from the beginning South 62 1/2 degrees East and thence reversing said
 line North 62 1/2 West to the place of Beginning containing One
 Hundred and fifty Eight ²⁷ acres ^{and} ³⁸ ^{1/2} ³⁸ ^{1/2}
 four perches of land More or less

A. J. Bouldin S. C.

July 1839

1839
 1876

 37.
 20

 17.

62 1/2
 1 3/4

 60 3/4

39 3/4

 37

Bouldin.
 division of the Real Estate
 of Lyde Goodwin decd.

Extract

$$\begin{array}{r} 1601 \\ 87 \\ \hline 173 \end{array} \quad \begin{array}{r} 12 \\ 75 \\ \hline 87 \end{array}$$

$$\begin{array}{r} 72 \\ 14 \\ \hline 88 \\ 38 \\ \hline 464 \\ 290 \\ \hline 3364 \\ 10000 \\ \hline 14364 \text{ (St.)} \\ 36 \\ \hline \end{array}$$

$$\begin{array}{r} 17 \\ 307 \\ \hline 324 \\ 11 \\ \hline \end{array} \quad \begin{array}{r} 1744 \\ 756 \\ \hline 8 \end{array}$$

Widows Dower.

Beginning for the Wood Lot at the letter B on the Plat
It being at a stone heretofore planted at the beginning of
the North four degrees West one hundred & more perches
line dividing the Lands of the late Bernard Todd from
the Lands of the late Lyde Goodwin, running thence
bounding on said line North three degrees west seventy
one and a half perches then north Eighty seven degrees
east Twenty Eight perches then South three degrees East
thirty perches, South thirty five degrees West nineteen
perches, South six degrees East Eight perches South
Seventy seven degrees East ten perches South thirty eight
degrees East eight perches south thirty eight degrees
West six perches, South fifty four degrees West eight
perches, South Seventy and a half degrees west fourteen
perches, North eighty one degrees West ten perches thence
North thirty nine degrees East three perches to the place
of beginning containing Ten acres of Land more or less.

Beginning for the second part (on which is erected the
mansion house) M. A on the Plat, it being at a
stone now planted on the West side of the Lane lead-
ing to the dwelling house running thence along the
west side of the Lane South 28 degrees west 23 & 1/2
half perches to a stone thence south eighty two & 1/2
degrees, West seven and a half perches thence south 32
degrees west 130 perches to water of Denton Creek, then run-
ning and bounding on the waters of Denton Creek & Chesee
Peake Bay the following courses. South sixty seven & a
half degrees East 33 perches South 81 & 1/2 degrees East 13 perches

North 67 degrees east 27 $\frac{1}{2}$ perches North 50 $\frac{1}{2}$ degrees east
50 perches South 76 $\frac{1}{2}$ degrees East 22 perches North 40 degrees
East 16 $\frac{1}{2}$ perches, North 2 degrees west 24 perches North 31
degrees East 56 perches until it intersects a line drawn from
East thereof ^{expressing said line bounding them} North 68 degrees
the beginning, South 68 degrees West to the beginning con-
-taining Ninety acres of Land More or less.

Courses of Number One Exclusive of the parts assign-
ed to the widow for her dower. And is composed of the
following tracts & parts of tracts of land lying in Patapsco
Neck, viz. Part of Walkins Neck, part of Thunells Neck
Part of Dickinson, Jones Range The Isthmus of Owen, Old
Road better secured. The angle and the Oblong Beginning
for the out bounds thereof at a large red oak tree at the
letter A on the plat. It being the last boundary of the Tract
of land called Sampsons Addition running thence bounding
on said land the two following courses viz North Eighty
two degrees east 68 perches North 130 perches to Back River
then bounding on the River east 5 perches to the North line
of Adams Adventure then reversing the lines of Adams Ad-
venture and bounding thereon the two following courses, viz
South 118 perches, East 12 perches until it intersects the second
line of Walkins Neck then reversing said line North 56 $\frac{3}{4}$
degrees East 72 perches thence ~~thence~~ South forty five degrees
east forty perches until it intersects the given line of
Walkins Neck then reversing said line South fifty six
three quarter degrees West 14 perches until it intersects the
second line of Adams Adventure then running & bounding
on said land reversely the two following courses, viz East
71 perches North 48 perches until it intersects the given line of

June 26th 1837.

Halkins Creek then running & bounding on said line...
From fifty six & three quarter degrees east fifty four
until it intersects the end of the first line of Bagfuss...
Fortune then running & bounding on said land the three
following courses. viz. South twenty five degrees east 20
perches. South 57 degrees east 60 perches. North 65
degrees. East 86 perches to Cuckolds Cove then bounding on
said Cove South thirty nine degrees. East 38 $\frac{1}{2}$ perches to
the water of Chesapeake ^{Bay}, then running & bounding on the water
of said Bay the following courses ^{South} Sixty nine degrees West
one hundred & thirty two perches South 24 $\frac{1}{2}$ degrees 17 perches
South 56. degrees West 220 perches. South 34 $\frac{1}{2}$ degrees.
West 80 perches South 19 $\frac{1}{2}$ degrees West 26 perches South
twenty seven & a half degrees West 58 perches South 14 $\frac{1}{2}$
degrees. West 98 $\frac{1}{2}$ perches South 56 degrees. West 18...
perches until it intersects the end of the last line of
the second part assigned to the widow for her dower then
reversing the lines of said dower and bounding thereon the
four following courses. viz. North 108 degrees West 90
perches South 28 degrees. West 238 $\frac{1}{2}$ perches South 82 $\frac{1}{2}$
 $\frac{1}{2}$ degrees. West 78 $\frac{1}{2}$ perches. South 32 degrees West 100
& thirty perches to the Water of Denton Creek then running
& bounding on the water of said Creek the following courses. viz North 67 $\frac{1}{2}$ degrees West 9 perches North half a
degree West 8 perches North 37 $\frac{1}{2}$ degrees east 18 perches
North 49 $\frac{1}{2}$ degrees West 24 $\frac{1}{2}$ perches. North Eighty four
degrees West 13 perches North 37 degrees. West 8 perches...
North 3 degrees East 12 perches. North 76 degrees West 20 perches
North 10 degrees East 8 perches North 29 degrees East 10 perches
North 49 degrees. East 8 perches North 72 degrees East 10 perches

South 65 degrees. East 16 perches. North 47 degrees east ten
perches. North 9 degrees East 18 perches North 64 degrees West 38 perches
North 13 degrees East 7 perches North fifty four degrees east 14
perches South 68 degrees East 27 perches North 42 degrees East
14 perches North 13 degrees West 12 perches North 52 degrees East
24 perches. North 27 degrees West 10 perches North 89 degrees
West 16 perches North 22 1/2 degrees West 17 perches to a stone
a boundary of Thomas Todd's & Lyde Goodwin's land. then
running & bounding ~~bounding~~ on their division line North thirty
nine degrees East 239 perches to the Lower Wood Lot then running
(bounding) on the said Lower Lot South 81 degrees East 10 perches
North Seventy & a half degrees East fourteen perches North 54
degrees East 8 perches. North 38 degrees. East 6 perches North
38 degrees West 8 perches. North 77 degrees West 10 perches
North 6 degrees West eight perches. North 35 degrees East 19 perches
North 3 degrees West 30 perches South 87. West 28 perches North
3 degrees West 64 & a half perches then South 59 degrees East
33 perches thence to the place of beginning containing Five
Hundred Eighty Acres three quarters & Thirty two square
perches of Land more or less.

true Extract taken from the Return of Proceedings of
Commissioners for the division of the Real Estate of Lyde Good-
win dead.
test
Tho^s Rice &c.

Rough Description
of Land sold
by G. H. Miller to Mr Todd

¹⁸
12th District

"Courses" comprising the Land to be conveyed by George H. Miller wife to M^{rs}. Todd. Situate lying and being in Baltimore County and contained within the meter bounds Courses and Distances following that is to say Beginning for the same at a stake now planted on the East side of Patapsco river and at the beginning of $N 72 \frac{1}{2} E. 65 \frac{8}{10}$ per line of the land conveyed by John H. Sharpe wife to said Miller by Indenture bearing date the 13th day of June 1852. H. M. C. N^o. 2 folio 388. thence running with and bounding on Patapsco river the 4 following Courses viz. $N 17 E. 18 \frac{8}{10}$ per. $N 33 \frac{1}{2} E. 8 \frac{2}{10}$ per. $N 16 \frac{1}{2} E. 12$ per. $N 13 \frac{1}{2} E. 7 \frac{3}{10}$ per to a marked cecamore tree, thence running across the tract $S 69 \frac{1}{2} E. 11 \frac{1}{2}$ per to the Centre of the road leading to North Point thence running with and bounding on the Centre of said road the 5 following Courses. $S 27 \frac{1}{2} W. 5 \frac{1}{10}$ per. $S 44 W. 6 \frac{4}{10}$ per $S 26 W. 14 \frac{9}{10}$ per $S 31 W. 7 \frac{9}{10}$ per $S 10 \frac{1}{2} W. 13$ per until it intersects the $S 72 \frac{1}{2} E. 65 \frac{8}{10}$ per line and thence running with and bounding on said line reversely $N 82 \frac{1}{2} W. 60 \frac{7}{10}$ per to the beginning containing $17 \frac{1}{4}$ Acres of Land more or less.

Surveyed N^o. 24th 1856
 Augustus Bouldin
 Surveyor

$\begin{array}{r} 1815' \\ 122' \\ 71' \\ 4413' \\ \hline \end{array}$
 $\begin{array}{r} 511' \\ 614' \\ 1415' \\ 131' \\ 4614' \\ \hline \end{array}$

6581
3816

702

Monday Nov 24th 1856

Run the lines of the land
sold by Mr. Miller to
Mr. Jacob Bryan as a state
non-planters on the land of
Patapec River and from
up the river as follows N 17 E

18 $\frac{8}{10}$ ps. N 23 $\frac{1}{2}$ E. 8 $\frac{3}{10}$ ps
N 16 $\frac{1}{2}$ E 12 ps. N 13 $\frac{1}{2}$ E 7 $\frac{3}{10}$ ps

to a marked sicum tree
then run across the tract
S 69 $\frac{1}{2}$ E 7 $\frac{1}{2}$ ps to a ~~state~~

center of road leading to
North Point then along the
center of road S 27 $\frac{1}{2}$ W 3 $\frac{1}{10}$ ps
S 49 W. 6 $\frac{4}{10}$ ps. S 56 W 14 $\frac{5}{10}$ ps

S 31 W. 7 $\frac{5}{10}$ ps S 10 $\frac{1}{2}$ W 13 ps
to line between Isaac Scharp
and Miller, at 5 $\frac{1}{10}$ ps from
N 17 E the begin of N 7 E $\frac{1}{2}$ W
65 $\frac{8}{10}$ ps line of Scharp's land

Friday February 22nd 1856.

Run the lines of land sold
by Miller to Mr.

Dodder. Began at a stake
now planted, at the end of the
line of the land now

owned by Miller it being the
begin of the land conveyed by
Scharf to Mann and run
down the core & the following

courses by. S 18 W. 15 ps.

S 35 E 20¹⁰ ps. S 45³/₄ E. 7 ps

S 33¹/₄ E. 4 ps S 3 E. 5 ps. then

S 65 W. 12. S 86 W. 13³/₄ ps. S 59 W.

11⁸/₁₀ ps. S 15 W. 10²/₁₀ ps. set

a stake in the head of hog core,

then run across the land

N 85¹/₂ W. 75 ps. ^{at cross ends} ^{at 7³/₁₀ ps}

near as mountain plain
Centre of North Point road.

bears S 1 E. at 39 ps opposite

Mr. home house
to Water of Patapsco river

then run up the river

as follow N 23¹/₄ E. 16 ps.

then ^{at} 14¹/₂ E. 50 ps. then

N 20³/₄ E. 12⁹/₁₀ ps. N 37¹/₂ E. 13 ps

N 17¹/₂ E. 7⁶/₁₀ ps. N 55 E 8⁸/₁₀ ps

N 29 E. 4²/₁₀ ps. N 37 E. 8⁸/₁₀ ps.

N 44 E. 24 ps. ^{near a stake}

then went to ^{cedar tree} ~~stake~~ at end

of milk & notch a stone layed

down at end of 1st line of

stains land, and run

N 59¹/₄ W. 2 ps. then N 38 E

14 ps. N 9 E. 8 ps N 47 W. 8 ps

N 6 E. 12 ps. N 1¹/₂ W. 11 ps.

N 52 W. 4⁹/₁₀ ps. then run

S 44 W. 4¹/₂ ps. to stake set

at end of 24 ps line &

1838

John Hemlock to
Mr Hart No 1 as de
Culled by A S Brewer
Culmery - 127.0 38

No 2 sold to Harrow
Culmery 353. 2. 34

in a paper 1839 he sold
the tract of Land called
Parting to J Merrit
for \$50 and received the
money as appears
by the report of sales filed
9 a paper 1839

198
66
07
289
998

2015.575
263
374
2015.575

1800
1234
264
2502
3718
80
1434
1800
3718
80
1434
1800

$3 \frac{3}{4}$
 $2 \frac{13}{4}$
 $\times 10$

1800

1724
 76

1724
 1800

 764

80
 5418

 2502

$3 \frac{3}{4}$

20115.57.5

$25 \frac{3}{4}$
 $17 \frac{3}{4}$
 $17 \frac{3}{4}$

$20 \overline{) 286.37}$
 20

 866

440
 40

 664

$5 \frac{1}{5}$

in April 1839 the Rev
 the Dean of Rochester
 Richard A. Stewart
 left 50 annuities the
 property of a person
 by the report of their
 9 April 1839

in the
 353. 2. 34

John Stewart
 Mr Stewart
 127.0 38

80

54.8
25.2

20 = 330

82.5
3 30

38

3 141 30

Copy of Deeds

Muxton Gay

to

Charles Ridgely

for Jones Range 400 Ac.

pt. of the Isthmus of Darien 100.

pt. of Dickinson - - 63

pt. of Walkins Neck 27

pt. of Thurels Neck 15

608

100

705

Nich's Quaton Gay }
to Charles Ridgely } Conveyance of all his the said Nich's
Rights & Title of in and to
the following Tracts ~~of~~ and parts of
Tracts of Land all lying & being in the County

Aforesaid Contiguous to each other on the Bay side in Patapsco
Neck Viz - a Tract Called Jones's Range Containing four Hundred
Acres More or less as Escheated by a certain William Young
and butted & bounded according to the Meter and bounds as
Mentioned in said Young's Certificate and Patent, One Hundred
Acres of Land More or less part of a Tract Called the Isthmus
of Darien being all the part of said Tract which lieth to
the South westward and Westward of a line extended from
where the West line of the land Called Ardens Adventure
and the North East by North line of the land Called Walkin's
Neck Cross each other South twenty four degrees East unto
the Bay side Which line so extended is the Most South
West part of One Hundred Acres part of the said Tract Called
the Isthmus of Darien which the said Nicholas Quaton
Gay hath sold unto a certain Andrew Stegar and passed
his Bond to Convey to him, Sixty three Acres More or less
part of a Tract of Land Called Dickenson being the same that
was heretofore Conveyed unto the said Nicholas Quaton Gay
by a certain Philip Jones Twenty seven Acres part of a Tract
of Land Called Walkin's Neck and fifteen Acres part of a Tract
Called Thundells Neck being the same Lands lately Conveyed by
unto the said Nich's Quaton Gay by a certain John Worthington & Mary
his wife

True Copy for Liber B N P 10 1654 this 11th day of June
1777 & William Gibson Clerk of the Court

then still bounding on the outline of the whole tract N 25° E
 up to Back River thence running boundry on North the water
 of Back River to the key stone of containing 160 ac of Canon or less.

Survey 541 1893/46 to the Mulberry in

181 2 to 303
 N 35 1/4 E 12 by the
 181 2 to 30 to the
 S 38 2 E 4 1/2 to the
 place where the track
 cross 187 2 to the
 fence of 30 pch
 in 187 2 to 51 1/2 to the
 base of Dory is 1 pch
 by left
 S 25 E 20 by
 S 63 W 14 by the
 of the track road
 the along the base of
 said road
 N 48 1/2 to 60 by
 at 44 to the track
 track & then on the
 S side of the road is
 S 07 E 4 1/2 by Mill also
 the road is
 the
 N 63 W 34 by
 N 67 1/2 W 7 by to the
 make boundary between
 Thomas Shaw and J C
 Howard

1820
miles N side of the Neck road

N 24 1/2 E 152 1/2 m to the top of the
river slope now down the stream at
the base of Turple Run

N 58 3/4 W 160 m to the river

S 52 E 6 1/4 m

S 71 E 46 1/4 m

S 54 E 26 1/4 m

S 49 E 26 1/4 m

S 67 E 14 1/4 m

S 55 E 12 1/4 m

S 80 E 19 1/4 m

S 53 E 22 1/4 m to the same

S 76 E 30 1/4 m

S 3 W 12 1/4 m

S 44 W 10 1/4 m

S 1 1/2 W 25 1/4 m

S 27 E 21 1/4 m

S 49 1/2 E 15 1/4 m

S 12 E 12 1/4 m to the same S 53 W

S 72 W 35 1/4 m

S 24 E 12 1/8 1/2 m to the same

Thos Knight Smith Joyce } Deed dated 1815
 to } Recorded W.G. v. 131 fo 449
 Mrs Shaw } W Bull Fry lot 4 3/4 as

Thos R G Joyce } Deed dated March 25th 1816.
 to } Recorded W.G. v. 135 folio 403
 Mary Todd } Thos Shaw Discovery No 2 as.

"All that pt of a tract of ¹⁰00 acres situate in Patuxent Neck in Baltimore County called Thos Shaw Discovery, originally on the 28th day of Decr 1786 granted to a certain Thos Knight Smith Shaw who by his Ex^{or} & test duly proved & recorded among the Records of the Reg^y of Bills for Balt City did devise and bequeath the same unto the sd Thos R G Joyce as by reference to the sd Will more fully appears which pt of sd tract hereby conveyed is contained within the metes bounds corners & distances brow Reg^y for sd pt at a show set up on a plot by a great chain it being the by & the whole tract & running & bounding back river as expressed in the certificate of the whole tract S 2 3/4 W 24 ps N 31 E 20 ps, S 18 1/2 W 44 ps to a quarter the by of Shurrells Neck & Har-rymans Hope thence still bounding on the out line of the whole tract N 6 7/2 W 20 ps, S 2 1/2 ps until it intersects a tract of land called Jidew-son thence bounding on sd Ed Worth West N 79 ps until it int a path of l^d called Daby thence bounding on sd J N 33 3/4 E 7 ps to the center of a small marsh where that line of Daby crosses sd Marsh thence running up the sd Marsh or gut N 70 3/4 ps to a stake at the head of sd Marsh, thence S 85 1/2 W 34 ps bounding on W B Bond pt of Daby thence bounding on the given line of Daby S 27 E 20 ps thence S 61 W 23 1/2 ps to the center of the N 7th Road thence running up along the middle of the sd Road N 52 1/4 W 46 ps until it cuts the N 60 ps line of the whole tract thence bounding on sd Line N 4 1/2 W 58 ps to the center of

then still bounding on the outlines of the whole tract N 25 1/2 E
12 1/2 p to Back River thence running & bounding on & north the water
of Back River to the key stone as continuing 162 as of 1st more or less.

Run 546 089 3/4 E

to the Mulberry tree

Beck

11/152



Cambridge

houses comprising the ground
to be conveyed by George Todd to
Wilson situated lying and being in
Ball's Co and described as follows
Beginning for the same at the point or
place where the $N 87^{\circ} W 29$ ps line of
George Todd's land crosses or intersects
the center of the North Point road
and running thence with and bounding
on part of said line $N 87^{\circ} W 2\frac{3}{10}$ ps
to a stone then running with and
bounding on part of the $S 4\frac{1}{2}^{\circ} W 142$ ps
line of George Todd's part $S 4\frac{1}{2}^{\circ} W 36$ ps
more or less to the center of the North
Point road then running with and
bounding on the center of said road
 $N 87^{\circ} E 636$ ps more or less to the place
of beginning containing 92 Acs of
land more or less.

Courses comprising the land to be
conveyed by John H. Wilson to George Todd
situate lying and being in Ball's County
and described as follows Beginning for the
same at a stone standing at the end of the
S 4 1/2° W 142 ps line of George Todd's land
and running thence with an obounding on part
of the S 64 3/4° W 108 ps line of said G. Todd's part
S 64 3/4° W 39 ps to the Centre of the North point
road thence running with and bounding on
the Centre of said road the following
Courses viz N 39 1/2° E 16 ps, N 23° E 12 ps, N 19 1/2° E 16 ps
N 27 1/2° E 34 ps, N 11° E 28 ps, ^{N 108° 27' 10"} more or less until
it intersects the S 4 1/2° W 142 ps line of said
G. Todd's part thence running with and
bounding on part of said line S 4 1/2° W 102 ps
more or less to the place of beginning
containing 6 1/2 Acre of land more or less.

Beginning for the survey as a line
 heretofore planted in the green line
 of Watters' tract and as the beginning
 of the green line of a deed from
 John Watters & wife to Nicholas
 Knapp on July 24th 1766 and being
 then bounding green line of
 Watters' tract as heretofore seen
 at 58° E 124 p. to 2nd line planted at
 the end of the 1st line of Bagford
 Johnson then being and being on
 said tract at 24 1/4° E 20 p. S 56 1/2° E 60 p.
 N 63 3/4° E 86 p. then continuing same
 course at 64 3/4° E 13 p. to and in
 the water of Cuckolds Cove as a
 point 100 yds distant from lower
 water mark, to the new line of
 said line then being and being with
 the water of said Cove 100 yds distant
 from said lower water mark
 N 61 1/2° W 36 1/2 p. N 37 1/4° W 30 p. N 50° E 20 1/2 p.
 N 12° W 36 p. at 24° E 30 p. N 61 1/2° E 16 p.
 N 32° E 10 p. S 88° E 21 p. S 9° W 52 p.
 S 88° E 25 p. N 9° E 87 1/2 p. N 40° W 7 1/2 p.
 S 35° W 49 p. to the end of the S 52° W
 32 p. line of Pasture, from then
 bounding on said line S 35° W 31 p. to
 the end of the N 75° W 36 p. line of Bagford
 Johnson then bounding on said line
 S 41 1/4° W 104 p. to intersect the 2nd line

of water's head & thin bones
 on same line 18-8^m 194^{1/2} p to ~~the~~
~~beginning~~ ~~of~~ stem planted at
 the beginning of same day from
 nothing to lay thin bones in
 the line of hair I see very
 143^{1/4} 6. 40 p to the beginning
 Cantary 171 a & 20 of plan
 now the sugar May 10th
 1861 & are Calm & Lower Point

$$\begin{array}{r}
 29.3 \\
 26.1 \\
 \hline
 3.2
 \end{array}$$

This Ind made the 30th of Apr in the year 1853. between
Geo F Miller & Sarah Miller his wife of Ball Co. & St of Ia of 1st pt
vs the C.B. & A. a corporation of Camden City St of Ia
party of the 2nd pt. Whereas the sd Geo F Miller in & by a
certain obligation or warranty obligation under his hand
& seal duly executed & bearing date even date herewith stands
bound unto the C.B. & A. in the sum of \$200 conditioned for
the payment of 100 with lawful interest therefor at such times
& at such places & in such instalments as is now or may
hereafter be provided for & required by the constitution & by laws
of the sd C.B. & A. without any fraud or further delay, as in
& by the sd recited obligation & consideration thereof relation
to the same being had may more fully & at large appear.
Now this Ind wit that ~~for~~ the sd parties of the 1st pt well
as for & in consideration of the aforesaid debt or sum of \$100
dollars & for the better securing the payment thereof unto the
party of the 2nd pt their successors & assigns in discharge of the
said obligation above recited as for & in consideration of the
further sum of \$1 well & truly pd to the sd parties of the 1st pt by
the sd party of the 2nd pt at & before the sealing & delivery hereof the
receipt of which one dollar is herby acknowledged & have
granted bargain sold released & confirmed and
by their presents do grant bargain sell release &
confirm unto the sd parties of the 2nd pt their
successors & assigns all the fol desc tract or piece of land
situated in the County of Ball in the State of Ia
& described as follows, Toz (description) Together
with all & singular the buildings & improvements woods
ways rights privileges liberties hereditaments and
appurtenances to the same belonging or in any way
appertaining and the reversion & reversions, remainder
& remainders rents issues & profits thereof. In H & T to the
said hereditaments & premises above granted or intended
to be with the appurtenances unto the sd C.B. & A. of
the County of Camden their successors and assigns

for ever, provided always nevertheless that if the said
 Geo F Miller or any person in his behalf or his heirs
 executor's administrators or assigns do and shall well
 & truly or cause to be paid unto the 2d CB & SA of
 the City of Camden or their successors and assigns
 the aforesaid debt or sum of _____ on the
 days & time herein before mentioned & appointed
 for the payment thereof together with law full int
 for the same in like money in way & manner
 herein before specified therefor without any fraud
 or further delay & without any deduction defalcation
 or abatement to be made for or in respect of any
 tax, charges or assessments whatsoever that then &
 from thenceforth as well this present Indenture & estat
 hereby granted at the said obligation above recited
 shall close determine & become absolutely null &
 void to all intents & purposes any thing herein before
 contained to the contrary thereof in any wise with-
 standing. In witness whereof the 2d parties of the first part
 have set their hands & seals hereunto the day & year first
 above written.

Sealed & Delivered
 in presence of
 N.P.
 W.R.D.

G.F.M. Seal
 J.M. Seal

State of Mo }
 Bull Co Co } We the subscribers 2 J of P of St of Mo
 (Ordinary, acknowledged) " And at the same time also
 before us personally appeared Thomas S. Mahan Secretary
 of the CB & SA the City within named and acting
 for & on behalf of said Corporation & made oath in due
 form of law that the consideration in said deed of
 Mo named is true & bona fide as therein set forth.

In testimony whereof we hereunto subscribe our names on the
day & year aforesaid.

A P
W R S

from 12 to 12
the 68th line
12 to
and 88 to 36

April 29th 1783 Names of the land of the ^{late} Richard Shaw

Simpsons Addition and Ardens Adventure

as agreed on by Capt^t Ridgely and others

Mr Worthington & Co

to

Mr Gay

10

10/10/00

10/10/00

Received of Mr Gay the sum of 10/10/00

W. B. W.

John Worthington & Convey^{is}
his wife

to Nicholas Ruxton Gay
This Indenture made the twenty
fourth day of July in the Year of our Lord
One Thousand Seven Hundred and Sixty Six

Between John Worthington and Mary his Wife of the one part, which
Mary is one of the Daughters and Heiresses of Captain Thomas
Todd late of Baltimore County in the Province of Maryland
deceased, and Nicholas Ruxton Gay of the same County and Province
of the other part Witnesseth that the said John Worthington and
Mary his Wife for and in consideration of the sum of One Hundred
and Sixty pounds Current Money to them in hand by the said Nicholas
Ruxton Gay paid the Receipt whereof the said John Worthington and
Mary his Wife doth hereby acknowledge and themselves to be
therewith fully satisfied contented and paid hath granted bargained
sold conveyed enfeoffed and confirmed and by these presents doth
Grant bargain sell alien in feoff and confirm unto the said
Nicholas Ruxton Gay his Heirs and Assigns forever all those
parts of two tracts or parcels of Land lying and being within
County aforesaid Between Potomac River and Back River the
one called Watkins Neck the other called Thurrills Neck which
is contained within the following Measur Bounds Course and distance, to wit
Beginning for the part of Watkins Neck hereby bargained and sold at the
end of two Hundred and twenty perches in the South West by West line
of the said Land at or near which place a White Oak Tree is now
marked with nine Notches and running thence bounding on the said
line into the end hereof South West by West One Hundred perches then
South South East forty perches North East by East One Hundred and
Sixteen perches and then by a straight line unto the aforesaid place of
Beginning containing hereby seven Acres or More or Less Beginning for
the part of Thurrills Neck hereby bargained and sold at the end of
two Hundred and twenty perches in the South line of said Land at
or near which place a Sweet Gum Sapling is now marked with
nine Notches and running thence bounding on the said line into the end
hereof South One Hundred perches then East South East Twenty five perches
(North)

North One Hundred and ten perches and then with a straight line to the
place of Virginia aforesaid containing fifteen Acres, More or less
together with all Rights, profits, Benefits, Priviledges, and Advantages,
Premises and Appurtenances, he said Bargained two parcels of land
belonging or in any wise Appertaining To Have and to Hold the
said Bargained two parcels of Land with their premises and
Appurtenances unto the said Nicholas Rector Say his Heirs and
Assigns forever And to his and their only proper Use and behoof
And the said John Worthington and Mary his Wife for themselves
and their respective Heirs do hereby Covenant Grant and
Agree to and with the said Nicholas Rector Say that they
the said John Worthington and Mary his Wife and their
respective Heirs shall and lawfully Demand and receive the
said Bargained two parcels of Land ^{with their} premises
and Appurtenances unto the said Nicholas Rector Say his
Heirs and Assigns forever against all and all manner
of Person or Persons lawfully Claiming or which may
hereafter lawfully Claim from by or under them the said
John Worthington and Mary his Wife or their or either of
their Heirs or by their or either of their means or
Procurement In Witness Whereof the said John Worthington
and Mary his Wife have hereunto set their Hands and affixed
their Seals the day and Year first above written

Signed sealed & Delivered
in presence of
Benjamin Rogers
Petram Bisquit

John Worthington seal
Mary Worthington seal

Received the day and Year within mentioned of the within named
Nicholas Ruston Gay One Hundred and Seely pounds Current
Money being the consideration money mentioned in the within Deed
as Witness our hands

Witnessed by
Benjamin Rogee
Wm. Disquith

John Worthington
Mary Worthington

On the 24th day of July 1766 came the within named John
Worthington and Mary his wife before us the Subscribers two Justices
of the peace for Baltimore County and severally acknowledged the
within Deed to be their Acts and the two parcels of Land therein
Bargained and Sold with their premises and Appurtenances to be
the right Title and Estate of the within named Nicholas Ruston
Gay his Heirs and Assigns forever according to the true intent
and meaning of the within Deed - the said Mary being by us
examined out of her Husbands hearing declared she made such
acknowledgment of her own free and Voluntary Will and became
a party to the Deed in like manner without being induced so
to do by threats or ill usage of or from her said Husband or
through fear of his displeasure as Witness our hands.

Benjamin Rogee
Wm. Disquith

Recd Aug 7 - 1766 One Shilling and Eight pence Sterling
Allegation fine on the within mentioned forty two Acres of Land
for the Lord Baltimore - By Order of his Lordships Great
Edward Lloyd Esq

John Boyd

Recorded this 8th day of Aug^r 1766 And Examined by

P. Bradley Clerk

This Copy from the Land Records of Baltimore County
Liber B No P folio 208 &c

William Gibson Clerk

Sperry 7. May 2^d 1799 Met accordingly to adjourn
Hotten } at a post said to stand at the end of the
Third Line of Powell where was sworn Henry
Curtis & Edward Sweeting &

Then went to a stone marked the beginning of Johnson
where was sworn Edward Sweeting who proved said stone
to be the beginning of Johnson & also said the John Mearns
told him that the line of Powell runs to said beginning
2 km from the said stone N 43 $\frac{1}{2}$ W 17 ft then
S 52 W 26 ft & 29 W 9.4 ft to base of plain then same
course 3 ft to then plain proved by E Sweeting to be
where the division fence formerly stood then
leghted S 4 39 E along where said Sweeting says the
fence runs then from N 34 W 10 ft N 60 E about 60 ft
The Depl. above mentioned is mentioned by Edward
Sweeting in his deposition when giving testimony relative
to the division fence between Phillip Jones and Mr
Sperry

I run from the end of the end of 9 ft & 11 Links & runs
S 37 $\frac{1}{2}$ W 104 ft to the place where I may find
marked is the boundary of us in the line of the said land
he was shown the place where the tree did stand
was lying when he put the stone to be the
of Powell by Mr Wm Smith who informed
that he had his Depl. under fence
Jacob Mearns at which time there was
a Post marked in the said plain by
consent of Mr Sperry & Mr Mearns

Spiegel's case of 1857 - 1858 began at the Sheriff's office
as John Foster was sworn William Flanagan and admitted
~~to be sold by the Defendant~~ to have been sold by him
and amount 20½ C 22 B 53¼ C 54 B to the second of mentioned
In said Com. Flanagan's Deposition

11072
 1326
 3225
 0630
 11655
 9794
 18630
 1150
 60

$\frac{160}{64} / \frac{655412}{154} / \frac{409}{184} / 102$

173
 64
 692
 1030
 11072

$\frac{162}{01} \frac{01}{230}$
 2430
 162
 10630

$\frac{166}{19} \frac{18}{29}$
 1494
 830
 9794
 $\frac{20}{10}$
 1150

$\frac{120}{64} \frac{70}{17} \frac{34}{17}$

546
 78
 102

$\frac{215}{15}$
 1075
 215
 3225

$\frac{105}{63} \frac{126}{63}$
 555
 1110
 11655
 $\frac{86}{13}$
 143
 429
 143
 1059

$\frac{30}{60}$

Large numbers

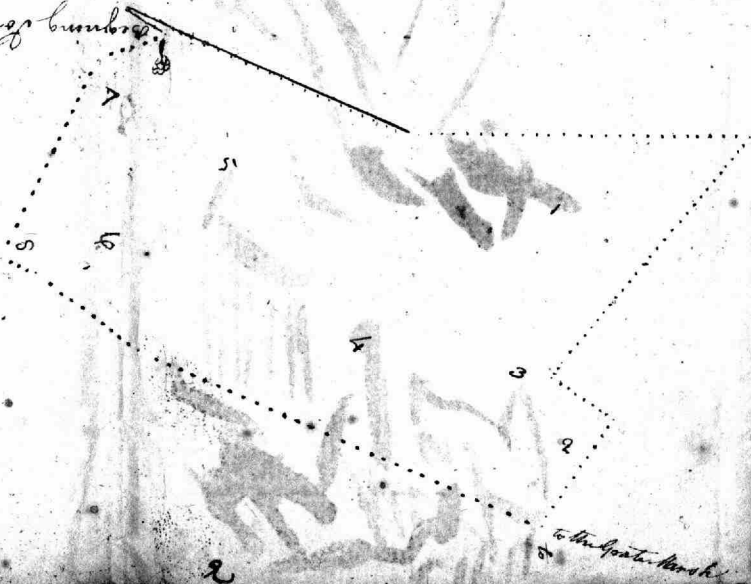

April 29th 1783

From the end of the ~~100~~ 40 perch line the same
course 8 perches to the west then from the distance of
25 p on the 2nd line of Watkins creek when it interse-
cts the water is 39^o E 27 p bounding on the water
until it intersecks all we continued ~~100~~ W
from a gun the the beginning of Watkins creek

at the distance of 74 p on the west 160 p line
of ardens adventure intersects the given line
of Watkins creek

then from a bounder black gun the beginning
of Churrells creek 108 p the S 43^o E 13 p to a
bounder read at the 3 bounder of Sampsons
addition

then from the end of the W 160 p line of
ardens adventure the same course west 5 p to
intersect the N 150 p line of Sampsons addition
it being the first line of said land

Sampsons addition^s north line to back
river from the place where the west 5 p line
intersects said line is 116 p to said river

then from the stump marked on the plat by
letter B is 9^o E 97 p then west 22 p then
to the beginning at the aforesaid letter B

Notes taken in making Capt Ridgelys survey

Courses of
the Oblong
Hampson's Neglect

taken from the Patents

The Oblong - Surveyed for Cap. Chidgey 1st May 1783. lying being in Patapsco Neck
Beginning at the End of the West 160 p. Line of a Tract of Land called Ardens Adventure^{ly}
and running thence East ten p. reverse on said Line until it intersects the SW by W
320 p. Line of Walkers Neck then running and bounding on that Line
SW by W 20 p. until it intersects the N 150 p. Line of Sampsons Addition,
then running & bounding on that Line N 116 p. to the Water of Back River
then running & bounding on the Water of said River E 5 p. until it intersects
the N-Line of Ardens Adventure then running & bounding on that Line
reverse South to the first Place of Beginning Cont^y 3 ³/₄ Acres of Land more or less

Sampsons Neglect, Surveyed for Cap. Chidgey 1st May 1783, lying in Patapsco Neck
Beginning at a bounded Gum standing in the Root of a Red Oak being the Original
Beginning Tree of Thumells Neck and running thence South 81 p. bounding on
Thumells Neck to a Tract of Land called Dickinson, thence S 4 ¹/₂ E 9 p. to
Sampsons Addition, and then to the Beginning Cont^y 1 ¹/₄ Acres of Land more or less

Courses

Sampson's Additions

Certificates

Tom beq of Thwred S 117

of S 63 E D P to be red

at of Sampson's Additions

town Side of Be

on a Point of Woods right unto a
a line of a parcel of Land of the late
Poucho to the Side of Back River
South by seventy four Poucho to a
formerly taken up by Richard The
South one hundred and thirty

River Beginning at a bounded

A Marsh running thence North with
Sampson one hundred and fifty
then West & by South half a Point
bounded Water Oak of a parcel of Land
roll running thence with said Thurrell
Poucho to a bounded Red Oak

then with a Direct Line to 1.29

Acres of Land

True Copy
J

70 3/4
5 1/2

73 1/4

Triple Union

The People's Union
Call 1734

The Triple Union Granted Richard Jests 10th June 1734
Beginning for the out bounds of the whole Tract at the Beginning Trees
of Martingon and turning thence for the out bounds of the whole
N. 75° E. 10 ff. to bank of or thence with the s^a River N. 57° W.
24 ff. W. 20 ff. N. 76° W. 18 ff. N. 51° W. 24 ff. N. 26° W. 24 ff.
to a point at the Mouth of a small brook of the s^a River thence
with the s^a brook S. 42° W. 40 ff. thence above the Head of the s^a
brook N. 22° E. 58 ff. N. 73° E. 22 ff. N. 87° E. 24 ff. to the ap^s

S. E. 64 ff. to arden addⁿ to wallons Neck thence with
Land S. W. 106 ff. to a brook which leads out of Potapostown
called Sparrows Branch or Humphreys brook thence still
more S. W. 11 ff. over the Head of s^a brook thence with s^a brook
N. 77° W. 21 ff. S. 41° W. 20 ff. N. 61° W. 17 ff. S. 74° W. 30 ff. S. 23
N. 38 ff. N. 67° W. 16 ff. cross above of s^a brook thence still with
s^a brook S. 83° W. 45 ff. S. 70° W. 28 ff. N. 66° W. 12 ff. S. W. 8 ff.
to the N. W. Line of Howells Powell thence S. E. 61 ff. N. 58 ff. S. E.
64 ff. thence S. W. 75 ff. thence S. E. 52 ff. thence N. E. 9 ff.

bank River thence with the s^a River S. 26° W. 640 ff. to
ff. to the Mouth of a brook called Wattons brook thence up
with the s^a brook S. 17° E. 33 ff. S. 41° W. 34 ff. to the beginning Trees
of arden addition to wallons Neck thence with the s^a brook S. 31° W.
17 ff. N. 61° W. 48 ff. S. 67° W. 10 ff. S. 18° W. 20 ff. S. W. 28 ff. N. 79°
W. 14 ff. N. 16° W. 10 ff. N. 53° W. 30 ff. N. 60° W. 17 ff. thence S. 6° W. 15 ff.
to the End of the N. E. & by E. Line of the ap^s Martingon
thence with the s^a Martingon Reversing the s^a N. E. & by E.
thence with the s^a Martingon S. W. 50 ff. still with s^a Land

thence S. E. 32 ff. S. 59° W. 148 ff. thence W. 43 ff. S. E. 9 ff. to
S. E. 2 ff. N. E. 276 ff. S. E. 44 ff. thence N. E. 12 ff. to the s^a
Martingon thence S. E. 108 ff. thence by a direct Line to
the first Rounder Tree containing and now laid out for 325
acres of Land more or less

Charge 60th 300th
[Signature]

True Copy from Lib. C. 7. n. 4 fo. 215
[Signature] Stewart & [Signature]

Shaw's Discovery

Granted

Thomas K. Shaw

28th Dec 1786

Shaw Descending Granted Thomas Knight Smith
Shaw 28 Dec 1786 begun at a stone set up on a
point by a great mark where bounded white oak of
Lodds Range old stand and by the side of Back
River and runny and bounding on said river
N 1/4 E 24 p 130 p E 20 p S 1/8 3/4 W 48 p to a gum
tree the line of Ferrills neck and Ferrills neck
then runny and bounding on Ferrills neck W 1/4 N
25 p S 1/2 p until it intersects a tract of
land called Dickerson then bounding on
said land N W by 79 p until it intersects
Dorley then bounding on said land N E by 7
p then N W by 11 7/8 p to the head of the
above mentioned mark then S 33 E 40 7/8 p
until it intersects the above mentioned
Dickerson then bounding on said land
N W by 13 p S W by 16 p then S 33 W 60 1/4
to the beginning of Dorley then bounding on
Dorley runny S 27 E 49 p until it intersects
a tract of land called Indistrey then bounding
on said land S W by 120 p N 78 1/2 W 74 p to
old Road Creek then on said creek
N 12 1/4 E 60 p to 2 white oaks at the head of
old Road Creek then N 60 p N 26 1/2 E 108 p
to Back River then with the River

March 11th 1816

Commence from a Juniper said to be a boundary of
Richard Shaws Land $N 18 \frac{1}{4} E 48 \frac{1}{2}$ ft to back line then up the
River $N 31 W 20$ ft $N 47 \frac{1}{2} E 24$ ft to the beginning of Shaws Discovery
A Juniper $N 35 E 8 \frac{1}{2}$ ft from a white oak tree then state up the
River $N 1 \frac{1}{2} W 2$ ft $N 42 \frac{1}{2} E 3 \frac{1}{2}$ ft $N 5 E 2$ ft $N 66 E 3 \frac{1}{4}$ ft
 $N 17 E 13$ ft $N 34 W 2$ ft $N 70 \frac{1}{2} W 6$ ft $S 86 \frac{1}{2} W 8$ ft $N 64 \frac{3}{4} W 40$ ft
 $N 73 \frac{1}{4} W 40$ ft $N 51 W 40$ ft $N 64 W 18 \frac{1}{2}$ ft thence $S 25 \frac{3}{4} W 121 \frac{1}{4}$
 $S \frac{1}{2} E 40$ ft $S 17 W 12$ ft $S 25 E 8 \frac{1}{4}$ ft to the white oak by the pass
and thence $N \frac{1}{2} W 2$ ft to the middle of the Road The beginning of
Daryl Shown by Thomas Shaw is $S 84 \frac{1}{2} E 39 \frac{1}{2}$ ft thence from along
the middle of said Road $S 52 \frac{1}{4} E 47$ ft thence a Juniper

I am of opinion that the beginning of Daryl is $N 50 W 2$ ft from the
place shown by Thomas Shaw and at the place where Judge Daryl
in 1795 showed me a white oak stump as the beginning of
Daryl by my plot of Shaws Lands made in April 1795
It so appearing on examination I find Shaw shows the true beginning

12th I commenced again at the Juniper and came $N 68 W 25$ ft to a tree
in the old orchard thence south $72 \frac{1}{2}$ ft to a stone $N 30 \frac{1}{2} W 79$ ft the
Mulberry stump to my right $1 \frac{1}{2}$ ft thence ~~to the~~ from the stump $N 10 E 7 \frac{1}{2}$
 $167 W 26$ ft to a stake standing by the head of the Mark and
 $S 86 \frac{3}{4} W 23 \frac{1}{2}$ ft from the Mulberry stump thence $S 85 \frac{1}{2} W 54 \frac{1}{2}$ to the
beginning of Daryl thence $S 27 E 20$ ft $S 61 W 13 \frac{1}{2}$ ft to the centre of
the Neck Road

Causes to be put in a Deed Beginning at the beginning of the
whole tract and running thence bounding on Back line

- $S 2 \frac{3}{4} W 24$
- $S 31 E - 20$ thence
- $N 8 \frac{1}{4} W 14$ to the house thence bounding on the east lines of the whole
- Survey $N 68 W 25$
- South $72 \frac{1}{2}$
- $N 30 \frac{1}{2} W 79$ ft. to the Mulberry
- $S 30 W 3 \frac{1}{2}$ to the SW by line of Daryl thence as that line reversely
- $N 33 \frac{3}{4} E 7$ thence to the Mark -
- $167 W 30$ to a stake at the head of ~~the Mark~~ Here of
- thence $S 85 \frac{1}{2} W 54 \frac{1}{2}$ to the beginning of Daryl thence
- $S 27 E 20$ ft bounding with rear line of Daryl thence
- $S 61 W 13 \frac{1}{2}$ ft to the centre of the Road thence along the middle of

near the following farms 173 1/2 E 37 1/2 S 1/4 E 22

S E 22 1/2 N 174 E 24 1/2 S 169 E 46 1/2 S 160 E 12 S 85 1/4 E 10 1/2 S

S E 4 1/2 S 110 1/2 W 12 1/2 S and then to the Agency

for 203 3/4 ^{424 1/2} acres Surveyed July 1st 1795

Courses of
Thames Discovery
for
St. Bouldin

of said head ~~to~~ N 52 $\frac{1}{4}$ W 46 ft until it intersects the N 60 ft
line of Shaws Descandy then on said line N $\frac{1}{2}$ W 58 ft to the
end thereof thence N 25 $\frac{1}{2}$ E 121 ft to said Shaws thence boundary on
the River the following courses to wit 164 E 18 $\frac{1}{2}$ ft

151 E 40 ft

173 $\frac{1}{4}$ E 40 ft

164 $\frac{3}{4}$ E 40 ft

186 $\frac{1}{2}$ E 8 ft

170 $\frac{1}{2}$ E 6 ft

134 E 2

17 W 13 ft and thence still boundary on the said River to the beginning

Say ~~178 W 12 ft~~ 133 W 13 - Containing ~~162~~ ¹⁶² acres of Land
162 acres of Land more or less. ~~John~~

Shaws Discovery. Beginning for the said part at a stone
set up on a point by a great Marsh it being the beginning of
the whole tract and running and bounding on Back River
as expressed in the Certificate of the whole tract South two
and three quarters ^{degrees} West 24 perches South 31 degrees East
20 perches South 18 $\frac{1}{4}$ degrees West 44 perches to a gum tree
the beginning of Shurrells Deck and Harrimans Hope and
thence still binding on the out lines of the whole tract
North 6 $\frac{1}{2}$ degrees West 25 perches South 72 $\frac{1}{2}$ perches until it
intersects a tract of land called Dickinson * thence bounding
on said land North 33 $\frac{1}{4}$ degrees East 17 perches to the centre
of a small mark where that line of Darby crosses said mark
thence running up the said Marsh or gut South 67 degrees
West 30 perches to a stake at the head of said Marsh thence with
85 $\frac{1}{2}$ degrees West 54 perches bounding on W^r Jones's part of
Darby to the beginning of Darby thence bounding on the given
line of Darby South 27 degrees East 20 perches thence South
61 degrees West 13 $\frac{1}{2}$ perches to the centre of the North Point
road thence running up along the middle of said road North
52 $\frac{1}{4}$ degrees West 42 perches until it intersects the North
60 perch line of the whole tract thence bounding on said
line North $\frac{1}{2}$ degree West 58 perches to the end thereof
thence still bounding on the out line of the whole tract
North 25 $\frac{1}{2}$ degrees East 120 perches to Back River thence
running and bounding on and with the water of Back River
to the beginning Stone.

Acres
162

* At the place marked the deed is interlined with the
following words thence bounding on said line N^W by
N^W 79 perches until it intersects a tract of land called
Darby

Table of Courses

1800

1734
66. $3\frac{1}{4}$

199
33. $1\frac{3}{4}$

N 22 E 68 $\frac{1}{2}$

8 $\frac{1}{4}$
18 $\frac{3}{4}$
5
23 $\frac{3}{4}$

N 22 E
13 $\frac{1}{4}$
23. $\frac{3}{4}$

11 $\frac{1}{4}$
9

47 $\frac{1}{2}$
1 $\frac{3}{4}$
65. $\frac{3}{4}$

Beginning at the
white oak of the
Shawland and run
along shore

- 1 S 25 1/2 W 22
- 2 S 83 3/4 W 24
- 3 S 42 3/4 W 18
- 4 S 5 1/2 W 14
- 5 S 52 W 16
- 6 S 81 1/2 W 12
- 7 S 9 1/2 W 14
- 8 S 84 1/2 W 17
- 9 S 11 1/4 E 31
- 10 S 78 1/4 W 16
- 11 S 80 1/4 W 16
- 12 S 37 1/4 W 34
- 13 S 59 1/2 W 14
- 14 S 12 1/2 E 52
- 15 S 53 3/4 E 20
- 16 S 5 1/2 E 20
- 17 S 70 1/2 W 38
- 18 S 30 1/2 W 26
- 19 S 14 1/2 W 44
- 20 S 21 1/4 W 46
- 21 S 14 1/2 W 68
- 22 S 10 1/2 W 42 at

16 f is a white oak the
beginning of North Point
23 S 1 1/2 E 24

- 24 S 21 E 48
- 25 S 38 3/4 E 46
- 26 S 48 E 38
- 27 S 61 E 12
- 28 S 82 1/2 E 18
- 29 S 2 E by E 14
- 30 S 36 3/4 E 16
- 31 S 33 3/4 E 108
- 32 S 49 E 20
- 33 S 11 1/4 E 48
- 34 S 87 1/2 W 14
- 35 S 75 W 18
- 36 S 53 1/2 W 8
- 37 S 84 1/2 W 10
- 38 S 67 W 24
- 39 S 63 1/2 W 4
- 40 S 42 1/2 W 6
- 1 S 76 W 10
- 2 S 50 1/2 W 4
- 3 S 60 1/2 W 4
- 4 S 68 1/2 W 30
- 5 S 29 W 8
- 6 S 56 1/4 W 22
- 7 S 13 E 10
- 8 S 87 1/2 E 20
- 9 S 78 1/2 E 16
- 10 S 57 1/2 E 24
- 11 S 79 E 34

- 34
1408 1/4
- 1 S 17 1/2 E 1408 1/4
 - 3 S 83 1/2 E 23
 - 4 S 26 1/2 E 7
 - 5 S 31 1/4 W 20
 - 6 S 39 1/2 W 14
 - 7 S 80 W 20
 - 8 S 68 W 19
 - 9 S 60 W 4
 - 10 S 89 W 12
 - 1 S 57 1/2 W 17
 - 2 S 33 W 12
 - 3 S 6 1/2 E 14
 - 4 S 45 E 14
 - 5 S 89 E 16
 - 6 S 58 1/2 E 10
 - 7 S 4 E 5
 - 8 S 41 1/4 W 32
 - 9 S 12 3/4 E 14
 - 10 S 57 3/4 E 22
 - 1 S 88 E 10
 - 2 S 47 1/2 E 11
 - 3 S 38 E 8
 - 4 S 13 3/4 W 11.3
 - 5 S 71 1/2 E 13.3
 - 6 S 77 1/4 E 12.3
 - 7 S 32 3/4 E 14
 - 8 S 73 E 13.6
 - 9 S 11 1/2 W 17.3
 - 10 S 42 1/2 W 8
 - 11 S 65 W 7

- 2 S 23 3/4 W 44
- 3 S 26 E 20.8
- 4 S 64 E 12
- 5 S 50 E 13
- 6 S 14 1/2 E 12
- 7 S 7 1/2 W 12
- 8 S 76 E 6
- 9 S 74 1/4 E 12
- 10 S 54 1/2 E 10
- 11 S 50 1/2 E 32
- 12 S 41 1/2 E 7
- 13 S 1/2 E 38
- 14 S 24 1/2 W 20
- 15 S 50 E 24
- 16 S 66 E 22
- 17 S 1 1/2 E 19
- 18 S 48 1/2 E 22
- 19 S 36 1/2 W 16
- 20 S 58 1/4 W 12
- 1 S 6 W 6
- 2 S 67 E 3.2 ft
- to the stump of a
Double white oak
- 3 S 35 E 24 ft
- 4 S 69 W 5 ft to
Clear Post
- 5 S 4 W 126 ft
- 6 West 108

- 7 S 5 1/2 W 138 ft
- 8 S 61 E 11 3/4
- to the top of the stump
- 9 S 64 W 14
- 10 S 53 3/4 W 93
- 11 S 41 1/2 W 12
- to the beginning
white oak then
- 12 S 41 1/2 E 12
- 13 S 20 W 97 ft to
the East end of the
Course
- 14 S 21 E 31 ft to
the end of the S 20 E 13
perch line of the bar

36 2
5 0

Mrs Brian

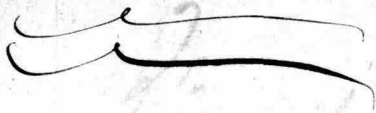

Wm. C. Conine & wife,
& Robt. Purviance Jr.
& Peter Douglass & wife

to
Wm. Mier

Lease dated 29th Sep '43
Liber T.H. N^o 334
fol 170.

for 99 yrs renewable
rent 1 cent.

Wm. Mier

to

Purviance & Conine

Mortgage 29 Sep 1843.
Liber T.H. N^o 334.
fol 174.

Land in Balto County
cont 9 75 acres.

Purviance & Conine
to
Mier.

Rel. of the above
mortg. 13th Sept 1850.
Aw B. N^o 449.
fol 317 &c.

I do not find any mortgage or other in-
cumbrance against the above mentioned land,
in the County or City offices, back from this date
to the time of the release from Purviance &
Conine above noted.

A. J.
apt. 3/1856.

#5.

The Ball's Run

May 7 1838. Run of Ball's Run
commenced at a certain point

and run $N 87^{\frac{1}{2}} E$ 94 p. to a
stone then run $N 25^{\frac{1}{2}} E$ 22 p.
 ~~$N 26^{\circ} E$ 65 p.~~ $N 25^{\frac{3}{4}} E$ 115 $\frac{1}{2}$

to the base of Green Hill (see the
map) then from the south base

off one ³ $N 78^{\frac{3}{4}} E$ 12 p. $N 34^{\frac{1}{4}} E$ 12 p.
⁴ $N 86^{\frac{3}{4}} E$ 4 p. $N 26^{\frac{1}{2}} E$ 12 p. $N 4^{\circ}$

E 7 p. $N 64^{\frac{1}{2}} E$ 14 p. $N 45^{\circ} E$ 12 p.
⁷ $N 16^{\circ} E$ 20 p. $N 24^{\frac{1}{2}} W$ 14 p. $N 4^{\circ}$

W 32 p. $N 36^{\frac{1}{2}} W$ 22 p. $N 14^{\frac{1}{2}} W$
¹² $N 28^{\circ} W$ 16 p. $N 47^{\frac{1}{2}} W$ 14 p.

$N 68^{\circ} W$ 16 p. then $N 47^{\frac{1}{2}} W$ 12 p.
¹⁴ $N 18^{\circ} E$ 26 p. $N 24^{\frac{1}{2}} W$ 12 p.

$N 5^{\circ} W$ 10 p. $S 51^{\circ} W$ 12 p. $N 52^{\circ} W$ 12 p.
¹⁶ $S 89^{\circ} W$ 11 p. $N 19^{\frac{1}{2}} W$ 6 p. $N 68^{\circ} W$

$N 71^{\frac{1}{4}} W$ 10 p. to a small stone
¹⁸ ¹⁹ ²⁰ ²¹ ²² ²³ ²⁴ ²⁵

then went to a stone (see map)
 $N 58^{\circ} E$ 68 p. to the edge of the
marsh the northward marsh

75 1/2 E 6 ps. S 87 3/4 E 7 1/2
N 36 E. 10 ps N 87 1/2 E 2 1/2
to the stake set. Then went
back to the stone at the N 58 E
and on. S 25 1/2 E 100 ps to
the stone where I began this
morning —

Industry

$8\frac{1}{2}$
 $\frac{11\frac{1}{2}}{12}$
 $\frac{23\frac{1}{2}}{12}$

General fine line
110 W
General fine line N49 W

run from the end of 108

line S28 9/2 W 8 1/2
S54 E143 1/2 W
S41 W 36 1/2 W

53
Walt

12 1/2

run from the top of line
S8 1/2 W 7 1/2 W

Dove

line S28 W 23 1/2 W
S8 1/2 W 7 1/2 W
S32 W 120 W

$$157 \text{ @ } 108/13 = 82 \text{ lb}$$

$$132 \text{ lb } 158$$

108 in lane

128 W20 lb at 11 in off

bag

1163 W 7.6 lb

~~132~~ 132/1034 at 16 lb bag

4 lb to left

$$\begin{array}{r} 134 \\ 82 \\ \hline 268 \\ 1072 \\ \hline 160 \overline{) 10988} \end{array} \begin{array}{l} 6 \\ 6 \\ 6 \end{array}$$

1150 @ 12 lb

$$\begin{array}{r} 82 \\ 4 \\ \hline 328 \end{array}$$

$$\begin{array}{r} 158 \\ 2 \\ \hline 316 \end{array}$$

$$\begin{array}{r}
 69 \quad 700 \quad 6 \\
 \hline
 3 \overline{) 4200} \\
 \underline{1400} \\
 2800 \\
 \underline{2100} \\
 700 \\
 \hline
 2100
 \end{array}$$

$$\begin{array}{r}
 100 \\
 \underline{10} \\
 1000
 \end{array}$$

$$\begin{array}{r}
 140 \\
 \underline{10} \\
 140 \\
 \underline{4} \\
 560
 \end{array}$$

$$\begin{array}{r}
 100 \\
 \underline{2} \\
 2000
 \end{array}$$

$$\begin{array}{r}
 70 \\
 \underline{20} \\
 1400 \\
 \underline{420} \\
 1080
 \end{array}$$

$$\begin{array}{r}
 70 \\
 \underline{6} \\
 420
 \end{array}$$

$$\begin{array}{r}
 7600 \\
 \underline{4} \\
 15200
 \end{array}$$

$$\begin{array}{r}
 100 \\
 \underline{20} \\
 2000 \\
 \underline{500} \\
 1500
 \end{array}$$

$$\begin{array}{r}
 100 \\
 \underline{16}
 \end{array}$$

$$\begin{array}{r}
 700 \\
 \underline{4} \\
 3 \overline{) 4900} \\
 \underline{1200} \\
 1653.33\frac{1}{3}
 \end{array}$$

$$\begin{array}{r}
 1700 \\
 \underline{4} \\
 3 \overline{) 4900} \\
 \underline{1200} \\
 1653.33
 \end{array}$$

$$\begin{array}{r}
 100 \\
 \underline{16 \frac{1}{3}} \\
 600 \\
 \underline{100} \\
 1600 \\
 \underline{33 \frac{33}{2}} \\
 1633 \frac{32}{2} \\
 \underline{700} \\
 933.33 \frac{1}{3}
 \end{array}$$

$$\begin{array}{r}
 700 \\
 \underline{5} \\
 5 \overline{) 5600} \\
 \underline{1866} \\
 66
 \end{array}$$

$$\begin{array}{r}
 40 \\
 \underline{16} \\
 560 \\
 \underline{90} \\
 1440
 \end{array}$$

$$\begin{array}{r}
 80 \\
 \underline{20 \frac{1}{2}} \\
 1600 \\
 \underline{40} \\
 0
 \end{array}$$

$$\begin{array}{r}
 90 \\
 \underline{20} \\
 1800 \\
 \underline{720}
 \end{array}$$

80

Copy Certificate
Industry

ms 42
1712

ms 10-14

From the End of the $N 1/2 W 1 E 225$ of line of Industry
to the Beginning Line of Darby Run $N 70 W 24$ of 3 feet
 $N 2 1/4 W 54 1/2$

$$\begin{array}{r} 56 1/4 \\ 33 1/4 \\ \hline 22 1/2 \end{array}$$

The. Todd m. Cert. of Treby 21st 1760

180
 By virtue of a special warrant granted unto Thomas Todd
 Jm^{rs} of Baltimore County Gent^l of his Lordship's land office according to the Statute in that behalf made
 thousand seven hundred and fourteen to refuse a tract of land called Industry by the death of
 the original patentee which heirs the same became due to his Lordship
 in and in the name of the said

5 1/2 40
 3 3/4
 1 3/4

5 1/2
 4
 1 3/4

5 37
 4 27
 1 10

180
 17 14
 86
 2 5 37 1
 4 27 2
 1 10

Prof Thomas J Todd

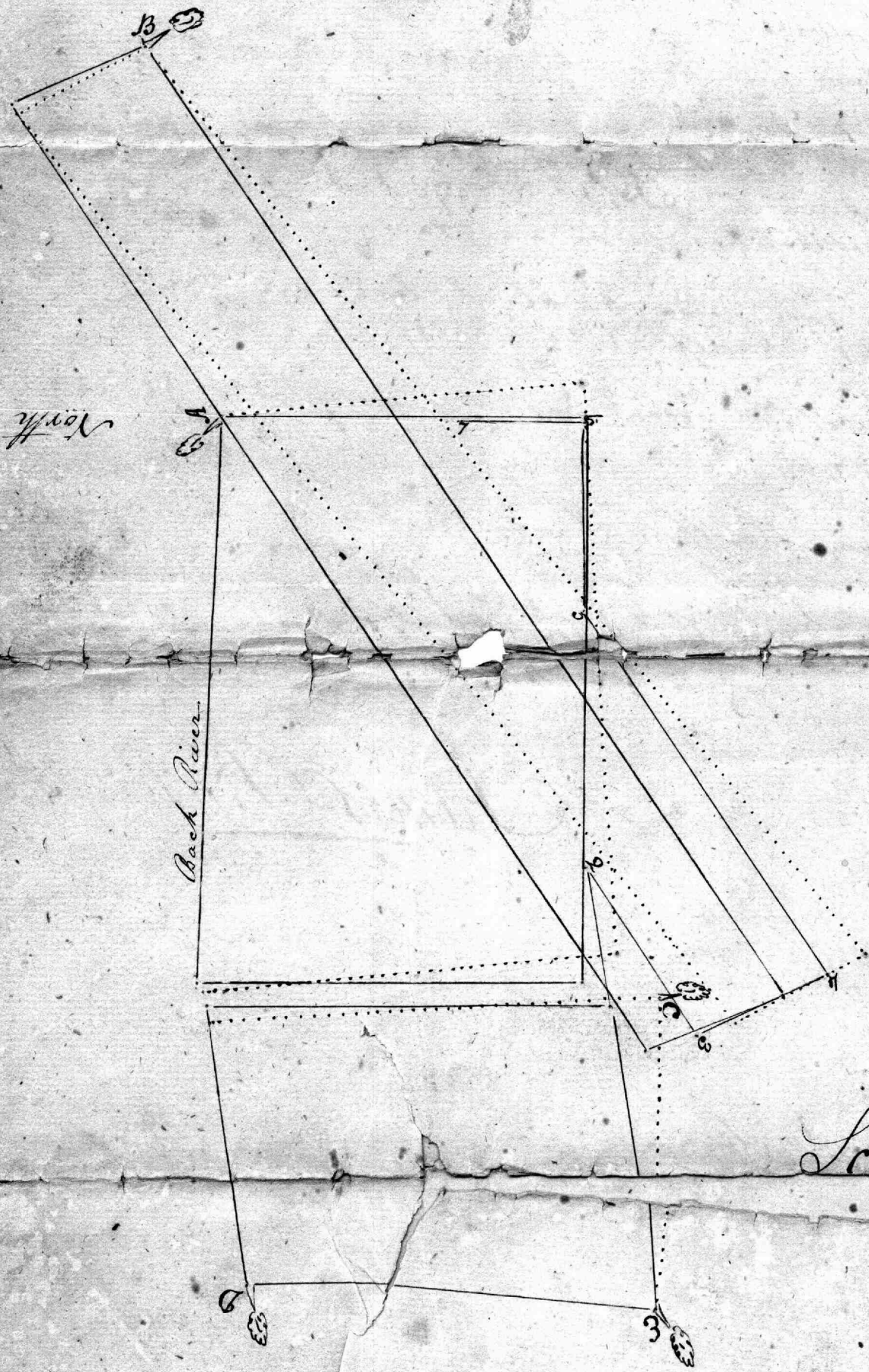

North

Back River

Scale of 50

A shows the begining of Ardens Adventure laid down in black lines. as agreed upon by Capt^l Charles Ridgely and others -

Ditto - laid down by dotted lines with an allowance of five and three quarters degrees Variation

B shows the Begining of Watkins's Neck laid down by black lines as agreed upon by Capt^l Ridgely and others -

Ditto - laid down by dotted lines with an allowance of 6 1/2 Degrees Variation -

C Shows the Begining of Sampsons Addition as shown by John Sergeant - and laid down by dotted lines with an allowance of 15 3/4 Degrees Variation

Ditto laid down by black lines as agreed upon by Capt^l Ridgely and others -

D Shows the second bounded Trce of Sampsons Addition -

E Shows the third bounded Trce of Ditto

I have laid down part of a track of Land called the Isthmus of Darien begining at E running to 2. 3. 4. 5. 6. 7.

James Baker

Scale on an Inch

James Baker

Thos Shaw
John E Howard
Sheppard & Leukin
A P Giles & Co

Wm Shaw et al } Wm No 189 for 36, 39, 45, 48
Luke Ravens Estate }

Thos Shaw } Wm No 185 fo 67
for } N E Corn Bank & Eden St
Handish Perry }

" } Wm No 183 fo 331
} N E Corn Bank & Eden St

Richd Shaw & wife } Wm No 160 fo 271
Thos Shaw Senr } P Shaw Discover 162 as

Wm Johnson } Died dated Feb 16th 1804.
to } Recorded Wm No 178 for
Wm Johnson of Wm } Johnsons Choice patented to
Wm Johnson Senr 2nd 1790

tract called "Johnson" Acres to Todd No 109 fo 309 &c.
"Johnson" "Wiser to Wiser No 121 fo 300 &c.
"Johnson" Rogers to Howard No 136 " 83 &c 2 Mas
"Johnson" Navyman to Kimmell 150 " 40 &c 200 as
"Johnson" Wiser to Kimmell " " 43 &c "
"Johnson" Adventure 153 " 76 &c 12 1/4 as
"Johnson" Kimmell to Kimmell 167 " 67 &c Lease 9th

Todd's Part
of
Gassaway Ridge

MA/8

Todd's Out of ^{Standing} Casways and
Beginning of Stone ^{near the} North line of the whole tract and If said Stone
Should be found to stand out of said line To
Begin where a line drawn $89\frac{1}{2}$ W from the
said Stone will cross or intersect the aforesaid
North line there being $1189\frac{1}{2}$ & 200 ft
No stone placed in the ground on or near
the ground line of the whole tract there being
in the said ground line ^{twice} 200 ft
to the end of the third line of the whole
tract three or said line ^{twice} 200 ft
to the end of the second line of said tract
and three bounding on said line to the
Place of Beginning (according to the
more or less)

Baltimore Co.
The Certificates
of Parran =
Containing 150
Acres Land

Novemb^r 4th 1719.

Says out for Henry Owens a parcel of Land called
Paran, lying on the South end of Quin's Falls beginning at two
bounded White Oaks and one bounded Spanish Oak on a plain above
Scots' Mill Branch, and running as follows, vizt.

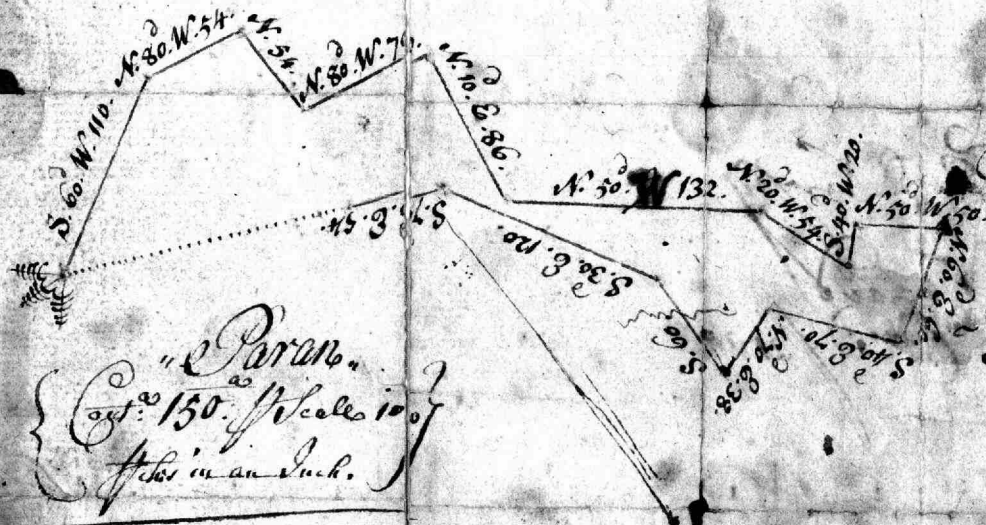

"Paran"
Cont^d 150. Scale 100
feet in an Inch.

Two plates
of
John Brown

Comes of Plat. of part of
Triple Union

160 / 1104 / 80 3/4
 220 / 39 1/2

 100 1/2
 205 1/2
 105 1/2

83
 82
 145
 165

Jan. 138. 101
 8 1/2
 1104
 89
 1173
 3402
 1740

126 101
 27 1/2
 5052
 252
 3402

92 103
 12
 1740

16 / 63 1/2
 15 1/2
 126 1/2
 165 0

$$\begin{array}{r} 182 \\ 62 \\ \hline 364 \\ 1092 \\ \hline 11284 \\ 5642 \end{array}$$

$$\begin{array}{r} 54 \\ 17 \\ \hline 78 \text{ no. 1} \\ 54 \\ \hline 918 \end{array}$$

$$\begin{array}{r} 70 \\ 66 \\ \hline 420 \\ 35 \\ \hline 17 \text{ no. 3} \end{array}$$

$$\begin{array}{r} 47 \\ \hline 376 \text{ no. 6} \end{array}$$

$$\begin{array}{r} 10920 \\ 3000 \\ 710 - 1 \\ 1092 - 2 \\ 555 - 3 \\ 2020 - 4 \\ 564 - 5 \\ 376 - 6 \end{array}$$

$$\begin{array}{r} 16/20225 \\ 126-38 \end{array}$$

$$\begin{array}{r} 16/20225/126 \\ 42 \\ \hline 102 \\ \hline : 35 \end{array}$$

$$\begin{array}{r} 182 \\ 58 \\ \hline 1856 \\ 910 \\ \hline 10556 \\ 5278 \\ 5642 \\ \hline 10920 \end{array}$$

$$\begin{array}{r} 52 \\ 21 \\ \hline 52 \\ 104 \\ \hline 1092 \text{ no. 2} \end{array}$$

$$\begin{array}{r} 94 \\ 30 \\ \hline 2820 \text{ no. 4} \end{array}$$

$$\begin{array}{r} 47 \\ 12 \\ \hline 564 \text{ no. 5} \end{array}$$

$$\frac{16}{9}$$

20225

$$\begin{array}{r} 182 \\ 66 \\ \hline 10920 \end{array}$$

$$\begin{array}{r} 154 \\ 920 \\ \hline 9080 \end{array}$$

$$\begin{array}{r} 154 \\ 40 \\ \hline 6160 \\ 3080 \end{array}$$

X 75 710

X 57 1224

W 20

X 76 1218

X 51 1224

X 260 26 to a floor

X 42 1240

X 70 1222 to a floor

X 65 1231

X 44 132 + 64

154

20

6160

3080

43
2
17

Rich^d. Gist } Convey^d. 6th March. 1739. of part of Triple Union
 to } being a survey of Martinson. Walton & Addis
 Luke Trotter } to Walton's Test. of Ardens Marsh. Begins at
 a Locust post. on the End of the N. 70 W. line of Triple Union
 near the head of a Creek. leading out of Back River &
 runs down the Creek. N 22 58 P. N. 73 E. 22 P. N 87 E. 24 P.
 to Back River N 26 E 40 to the Mouth of Walton
 Creek. thence up the Creek. N 70 E 33 P. S 41 W 34 P. to the
 Beginning of Addition to Walton Test. thence S 31 W 70 P. N 61 W
 40 P. S 67 W 10 P. S 10 W 20 P. S 10 W 28 P. N 79 W 14 P. N 16 W 10 P.
 N 53 W 30 P. N 60 W 70 S 6 1/4 W 10 P. to the End of N 8 by E
 of Martinson thence with the ~~line~~ of Martinson reversing
 the N 8 by E line running S to W 50 P. still in the land
 E N 196 then to the post. 137 acres of Land.

Rich^d Gist } Convey^d. 18th Mar. 1739 of part of Triple Union
 to } beginning at bound red Oak stand
 Jacob Howles } on a pole } being the beginning
 of Mart } E 10 P. to the
 } N 51 W 24 P.
 N 26 W 24 P. to a point } of a small creek
 then W. Creek S 42 W 40 P } a locust post
 S 65 W 31 P. till it intersects the W N W line of Martinson
 then W. said line W N W 132 P. S W 106 P. to Sparrow
 branch then S 50 E 70 P. S 67 E 24 P. N 1140 P. N 44 P. N 8 12 P.
 to the W N W line of Martinson then E N 100 P. then
 to the Beginning

175 90
 177 124
 178 20
 176 118
 171 124
 176 24 to a point
 172 140
 170 122 to a point
 165 131
 174 132 464

Read & follow
to
Learner
and
Beachman

1218
711
914

2912

Wm Geo Read & Sophie } Deed dated Apr 5th 1892.
 Caroline his wife } Recorded in Libe Wb No 217 foli 446 & c
 to }
 J C Scatter and }
 James Beacham }

"All that tract of land called 'Howards Point' which was conveyed by Ruth Howard to the above named J & C by deed or Ind bearing date on or abt the 4th day of Sept 1890 & recorded among the Land Record of Baltimore county of in Libe Wb No 217 foli 216 & c according to the location of the bey abt tract and the last by lines thereof by Tho Jones Philip Rogers Thomas Chas Mrs Eager Howard and Wm Todd by their Agreent of the 28th of May 1813 recorded in Libe Wb No 79 foli 110 & c. A tract or parcel of land called ^{Wm} Minow and Todd's Range which was conveyed by Tobias Estlin by & the Commissioners appointed for dividing & making lot of the real estate of Ferdinand & Maria & Isabella Batten the said J & C by Ind dated June 28th 1820 in Libe Wb No 156 fo 222 & c a part of a tract or parcel called Johns Interest which was conveyed by Tho Chas by the above named J & C by Ind Dec 7th 1820 recorded Wb No 157 fo 709 & c and a part of 'Johnson' conveyed by P Rogers to the afo J & C by Ind dated June 6th 1816 Wb No 131 fo 80 & c leaving & reserving out of the afo tract called Howard ^{Wm} the said grave yard where Bur Eager lies buried as the same is now enclosed & excepting also out of the afo tract or parcel called Todd's Range the quantity of 4 acs 126 sq ps conveyed by J & C to Tho Chas by Ind dated Dec 7th 1820, Wb No 158 fo 40 & c, the whole tract referre hereby intended to be granted and conveyed comprehending the said grave yard & also of excepted & reserved being cont within the metes & bounds courses & distances following that is to say **BEGINNING** for the same at the stone set up by the afo Tho Jones & the at the Agreent for marking & bounding afo (May 28th 1813) at the end of the end of the ^{Wm} line of the former called Richardson but at that time the Pasture Ground, the same being the beginning of Howards ^{Wm} turning thence E by S 3/4 ps more or less to the end of the first line of Howards ^{Wm} which is on the creek thence N 75 E 12 ps

N 95 E 20 ps, N 65 E 20 ps, N 49 E 40 ps, N 34 E 23 ps, N 5 W 14 ps to a pt on the south
side of the Mouth of a cove, thence up the cove N 84 W 20 ps, S 71 W 9 ps, thence
crossing the head of the cove N 30 W 5 ps, thence down the cove three courses
N 35 E 18 ps, East 4 ps, N 65 E 17 ps to a pt thence up Old Road Creek
3 courses, N 12 W 12 ps, N 60 E 14 ps, N 14 E 12 ps to a pt, thence up Long
Creek N 81 W 22 ps, West 24 ps, S 26 W 10 ps, N 40 W 11 ps, N 76 W 8 ps,
N 88 W 13 ps, thence crossing the head of the cove N 78 1/2 W 20 ps, thence down
the cove 5 courses N 71 E 29 ps, S 87 1/2 E 13 ps, N 75 E 37 ps, S 81 E 22 ps,
N 72 E 16 ps to a pt on the north side of the Cove thence up Old Rd Creek
4 courses N 32 1/2 E 10 ps, N 75 E 8 ps, N 13 1/2 E 13 ps, N 2 W 11 ps to the north
side of the mouth of another cove with 2 tranches, thence up the
same 3 courses N 43 W 12 ps, N 77 W 8 ps, S 85 W 23 ps, thence across
South Branch N 5 E 4 ps, thence down the branch 4 courses, N 74 E 10 ps,
N 13 E 4 ps N 62 E 5 ps N 65 E 13 ps to the mouth of North Branch
thence up the same N 30 E 8 ps, N 5 E 17 ps thence across the head
of North Branch S 73 E 5 ps, thence down the Branch 2 courses
S 13 E 24 ps, S 35 E 4 ps to a pt thence up Old Road Creek 5 courses
N 56 E 17 ps, N 49 E 23 ps, N 8 W 8 ps, N 55 E 21 ps, N 17 E 7 ps to a stone
set up by Tho^r Jones & others at the Agent of May 30th 1813 when
a Spanish Oak formerly stood, thence with the land covered by
the Comar of to the S 2 E 4 S 73 E 10 ps, thence N 40 E 27 ps, more
less to two bounded white oaks, thence N 12 W 10 ps, thence N 6 1/2 W
62 ps to a stone set up on the north edge of the North Pt Road by
B G H & Tho^r Shaw at their Agent for marking & bounding of 1820
& which is marked "boundary between Tho^r Shaw & B G H 1820",
thence N 23 E 16 ps to a stone standing on the corner of Buck Run
which was set up by B G H & Tho^r Shaw at their Agent of and is
marked "Boundary between B G Howard & Tho^r Shaw 1820" thence
N 71 W 10 ps to the end of the 2nd line of John's Interest thence
up the river N 85 W 23 ps, thence with the given line of Purple Union
to the key of the tract, thence up the river 6 courses N 20 E 10 ps, N 6 1/4 W 20 ps,
S 75 W 18 ps, N 67 1/2 W 22 ps, N 57 1/2 W 26 ps, N 31 1/2 W 24 ps to a pt at the
mouth of Small Creek, thence up said Creek S 32 W 40 ps thence
across the Creek N 89 W 23 ps to a stake thence S 65 W 32 ps to

the 2nd line of "Marlborough" at 124 ps on 2^d line thence on 2^d line N 69^o W
28 ps to the 2^d line Meiser thence with Meiser's Land S 46^o E 72 ps to a white
oak standing in the Neck Rd thence bounding on the 2^d line S 25^o E
44 ps to the syd of the North 44 E 79^o 4 ps line being the 20th line of land
deeded to Geo Meiser by Philip Rogers by deed of 1807 thence
S 44^o W 79^o 4 ps to a stone standing in the second line of Johnson
& which is called a boundary of Sth Meiser's land, thence South 9^o 1/2 ps to
a stone thence S 3^o 1/4 W 22^o 1/10 ps to the stone set up by Tho Jones & others, at
the Agent of May 28th 1803 at the end of the 2^d line of Richardson,
then called Pasture Ground, thence S 7^o 57' W 320 ps to the place
of beginning. Said out for and said to contain 462³/₄ acs
of land more or less.

Wm Shaw of Wt } Deca dated 11th of Oct. 1848
Chy J. Poole } Recorded AOK No 402 folio 184c.
No Description

Wm Collins + } No 4th 1845. AOK No 359 folio 1184c.
J. G. Walsh }
to
Wm Shaw }
No Description

Shaw }
or }
Pennington }
Chancery, N. H. No 34 fo

Thos Shaw's Last Will & Testament dated Sept 21/1829 and admitted to probate Dec 30th 1829.

"I will bequeath unto my wife Ann Shaw, all that tract of land in Patuxent Neck Balt Co, called Shaw's Discovery, also a tract adjoining the same called Johnson's Adventure and part of Todd's Range. Also a tract adjoining the tracts above mentioned called Understry for her use & behoof as long as she lives."

Wills Shaw's Discovery, Johnson's Adventure & Todd's Range at death of his wife to his son Thos Shaw.

10
8
5
19
10
3
5
10
6

79 +
29
79 +

23
29.
11
16

79

Andrew S Rogers
and wife
to
Elizabeth Andynck

Mortgage dated
the 24th day of
December A.D.,
1866 and recd
in Lib. S, H, L,

No. 23 folio 327, for \$1130 dollars
for ten years on until the 24th day
December A.D. 1876,

same land as conveyed Joseph
Rogers and wife to A. R. Gooden
bearing date the 11th of A.D. 1868, Lib
S, H, L, No. 46 folio 304 &

A. L. Rogers & wife

to
Board of School Comm^{rs} of Dist^{ct} C^y

2 doc^s dated
July 2nd A.D. 1867
Lib S, H, L No 53 folio

105 for 1/2 acres of land in w^{est}.

The Courses of the
lines of L Goodwin
part of a tract
of Land lying in
Armadillo County
known by the name
of Poplar Plains
as Divided between
C. D. G. & himself
J.

Beginning for Lyde Goodwin's ^{part} of said land call'd
Poplar Plains at the end of the NW 300 perch
line of the tract call'd Poplar Plains and running
East 246 p^{er} SE ¹¹³ ~~113~~ p^{er} S 74 p^{er} W 201 p^{er} thence
to the Beginning for 154 acres of Land more

or less In witness whereof we have hereunto
set our hands & Seals this 25th Day of Nov^r 1811

True extract from original
in possession of Caleb
Goodwin

Oliver Cromwell
Charles Stewart

15 Jan^y 1810

Courses of
Pasture
The old road better
secured &
The Angle

Pasture granted Charles Ridgely the 12th of December 1783.

Beginning the tract of land called Backford Pasture. Beginning at the distance of sixty perches on the north 39° N. 68 ft. line of Backford Pasture and running thence N. 48° E. 20 ft. N. 14° W. 36 ft. N. 22° E. 30 ft. N. 59 1/2° E. 16 ft. N. 30° E. 18 ft. E. 18 ft. N. 7° E. 30 ft. N. 51° W. 26 ft. N. 4° W. 10 ft. S. 62° W. 32 ft. S. 33° W. 31 ft. N. 75° E. 30 ft. S. 32 ft. S. 44° W. 40 ft. S. 10° W. 57 ft. and then with a straight line to the beginning containing and laid out for 16 acm of land more or less. True extract from Lib. I. C. 1. c. 245.

C 3/6

Test J. Callahan High Sheriff.

The Old Road better secured granted Charles Ridgely the 30th of December 1783.

In Potatoes neck. Beginning for the said part as now surveyed at a bounded locust post set up on the East side of Denton creek, where a double white oak stump did formerly stand, which said stump is agreed upon by Captain Charles Ridgely and W. Thomas Dods, to divide their lands in said neck and running thence N. 41° 30' E. 123 ft. bounding on said dividing line until it intersects the S. 173 ft. line of Jones's change then running and bounding on said line S. 11 ft. to the end thereof thence S. S. W. 118 ft. still bounding on said land to Denton Creek thence running and bounding on Denton Creek N. 79° W. 21 ft. then still bounding on said creek to the beginning containing and new laid out for 19 1/2 acm of land more or less. True extract from Lib. I. C. 1. c. 246.

C 3/3

Test J. Callahan High Sheriff.

The Angle granted to Charles Ridgely the 30th of December 1783.

In Potatoes neck. Beginning for said part as now surveyed at a bounded red oak the third boundary of a tract of land called Sampsons Addition and running thence S. 13° W. 40 ft. thence N. 45° E. 15 ft. thence E. 8 ft. and then with a straight line to the first beginning containing and new laid out for 1 1/2 acm of Land more or less. True extract from Lib. I. C. 1. c. 266.

C 2/3

Test J. Callahan High Sheriff.

Courses of my land in
the Neck from the County
records ~~~~~

Courses of the Range
Hones Range

The Bounds lines & Courses of a Tract or parcel of Land called the Range extracted from an Instrument of writing made or mentioned to be made the 21th day of February in the Year of our Lord one Thousand six hundred Eighty Between between six & seven Between Charles Gorsuch & Sarah his wife of Potapoco River in Baltimore in the Province of Maryland of the one part & Roger Newman of London in the Kingdom of England Merchant and recorded in Liber R M No HS Folio 220 are as follows that is to say — All that Tract of Land called the Range being situate on the west side of Chesapeake Bay neigh the mouth of Potapoco River being butted and bounded as follows Next Beginning at a bounded double white oak standing near the head of a Creek called Denton Creek and running thence North east and by north one hundred seventy one Perches to a great Marsh then East south east one hundred perches to the Bay side then down the said Bay south south West two hundred Ninety five perches then west south west seventy ~~perches~~ five perches then West north west fifty perches to the mouth of the said Denton Creek then up the said Creek and bounded with the said Creek to the first mentioned bounds — containing two hundred & sixty acres of Land —

In Testimony that the above going is a true extract from Pages 220 of the Book above mentioned I have hereunto set my hand this 11th day of February Anno Dom 1757 —
B Bordley Clk Baltimore Court

The Bounds lines & Courses of a Tract of Land called Jones his Range extracted from an Instrument of writing made or mentioned to be made the 3th day of December in the Year of our Lord one Thousand six hundred Seventy Nine Between David Jones of Baltimore County in the Province of Maryland of the one part & Charles Gorsuch of Talbot County in the said Province of the other part and recorded among the records of Baltimore County Court Liber I R No PP Folio A7 are as follows that is to say — All that parcel or Tract of Land called Jones his Range situate lying on the West side of Chesapeake Bay ~~and~~ adjoining to a parcel of land former — ^{laid out} for Thomas & William Battent on the North side of Potapoco in Baltimore County — Beginning at a bounded sapling by a Creek side called Denton Creek and running according to the bounds of the Patent being laid for three hundred & eighty acres of Land more or less —

In Testimony that the above going is a true extract from Folio A7 of the book above mentioned I have hereunto set my hand this 11th day of Feb^r Anno Dom 1757
B Bordley Clk Baltimore County Court

Copy of Courses
for 20 Acres of
Land lying near
the Bedkin in
Annan^e County
called Poplar
Plains

Copy of Courses
for 20 Acres of
Land lying near
the Bedkin in
Annan^e County
called Poplar
Plains

Beginning for 25 acres of the land called Poplar
plain at the end of the NW line of the whole tract
and running thence with said land E by S 12 1/2 yds. thence
S 43 N 88 yds. to the aforesaid NW line then bounding
on said line to the Beginning for 25 acres Mow or Pigg

114
94

208
92

300

Platt

of the Countivance

James's Controversy Survey for Capt. John Blane

2. 1/2
1. 1/2
6. 1/2

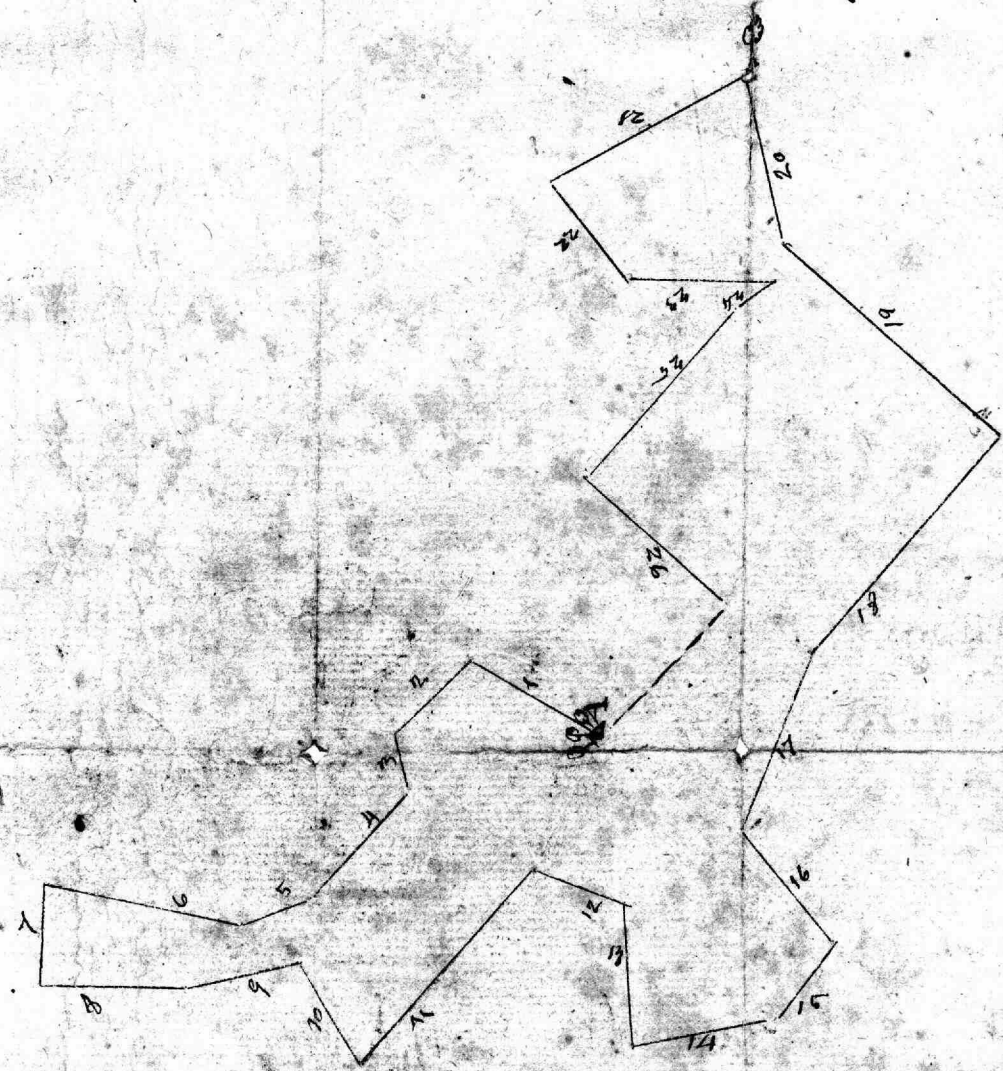

[Handwritten signature]

¹⁵
 20 N 75 E 72
²⁴
 21 N 30 to 94
 22 S 50 to 50
 23 S ~~50~~ -- 60
 24 N 40 to 20
 25 N 50 to 94
 26 S 40 to 78

5 Courses Stone & Calc. A. 100 ft. ^{range} from Parrishes Forest ^{to Gornells large} and 5 Courses of
 Adton to McLevin Hill

S 38 to 48

N 42 to 50

S 43 to 80

S 34 E 56 to intersect 22 Line of Jones Contiguance.

N 32 E 48 ^{which} intersects 21 Line Jones Contiguance then

bound of ~~the~~ preceding Line of Jones
 Contiguance 5 Courses.

John McLane

To
Richard Porter

John McClain
To
Richard Porter
45th Addition to --
McClains Hills --

Deed dated 18th day of October 1760
All that parcel of Land being part of a
Tract of Land Addition to McClains
Hills granted the said John McClain
the 31st day of August 1752 for 575 acres more or Less
Which said part hereby bargained begins at the beginning
tree of a parcel of Land called Williams Defence formerly
surveyed for a certain William Beasman and running
thence North 40 Degrees West 20 perches North 28 Degrees
East 20 perches North 52 Degrees West 66 perches North
35 degrees East 24 perches North 10 Degrees East 21
perches North 66 degrees East 72 perches till it intersects
the 18th line of a Tract of Land called Jones's contrivance
then south 50 Degrees East 30 perches and then with a
straight line to the Beginning containing forty five acres
of Land more or Less

Copied from B. N. H. Folio 375.

Wm Gibson of Baltimore

Received 20 January 1769.

Four Shillings Sterling
Alienation Fine on the
within Land for the use
of Lord Baltimore by
order of Dan: of St. Thomas
Jonison, Esq.

Dan Bowly

Deed

Nicholas Ruxton Esq
Charles Ridgely Esq

100 Acres part of The
Isthmus of Darien.

Rec: to be recorded this 6th
Day of Feb: 1769 and then invol:
led among the Land Records of
Baltimore County Court in
Lib. A.L. N. A. fol. 12. &^{co}

and Examined by
Lawson

This Indenture made the twenty seventh Day of January in the Year of our Lord One thousand seven hundred and sixty nine

Between Nicholas Ruxton Esq of Baltimore County & Province of Maryland Gentleman of the One part And Charles Ridgely Junior of the same County & Province Merchant of the other part

Witnesseth That the said Nicholas Ruxton Esq for and in Consideration of the sum of Two hundred Pounds Current Money of Pennsylvania to him in hand paid by the said Charles Ridgely Junior

as and before the sealing & Delivery of these presents the receipt whereof he doth hereby Acknowledge & himself therewith fully satisfied Contented and paid hath granted bargained sold aliened released and confirmed and by these presents doth grant bargain sell release

release enjoy and confirm unto the said Charles Ridgely Junior his Heirs and Assigns forever A Certain piece or parcel of Land Situate in the County aforesaid on Chesapeake Bay side being part of a Tract of Land called the Isthmus of Carier Beginning

for the same at the end of the first line of a Tract of Land called Bagfords Fortune and running thence bounding on a Tract of Land called Walkins Neck South West by West fifty four perches unto the South line of a Tract of Land called Ardens Adventure then bounding on that

line to the end thereof South thirty six perches then bounding still on Ardens Adventure West fifty Perches untill it intersects the given line of Walkins neck then South twenty four Degrees East Eighty four perches into Chesapeake Bay then bounding on the said Bay unto a Gut lately Washed out of it into Cuckolds Cove then bounding on the said Gut & Cove unto the aforesaid Tract of Land called

Bagfords Fortune and then bounding on the several lines of Bagfords Fortune river in the same unto the aforesaid place of Beginning containing One hundred Acres more or less Together with all and singular the Houses Buildings Improvements

Rights Liberties Privileges Hereditaments & Appurtenances whatsoever to the said One hundred Acres of Land & premises belonging it in any way appertaining and the River in & River in Remainder & Remainders Rents Issues & Profits thereof and also all the

estate Rights Title Interest Use Possession Trust Property Claim & Demand whatsoever of him the said Nicholas Ruxton Esq & his Heirs in to or out of the same or of or into or out of any part or parcel thereof To have & To hold the said One hundred Acres of Land

& all other the premises hereby granted bargained & sold or mentioned or Intended to be hereby granted bargained & sold and every part & parcel thereof with their & every of their Appurtenances unto the said Charles Ridgely Junior his Heirs & Assigns for ever and to the only proper Use

& behoof of the said Charles Ridgely Junior his Heirs & Assigns for ever And the said Nicholas Ruxton Esq for himself and his Heirs doth hereby Covenant Promise Grant and Agree to and with the said Charles Ridgely Junior his Heirs & Assigns by these presents

That he the said Nicholas Ruxton Esq & his Heirs the said Tract of One hundred Acres of Land & premises with all & every the Appurtenances unto the said Charles Ridgely Junior his Heirs & Assigns from against him the said Nicholas Ruxton Esq and his Heirs and against all & every other person or persons claiming or hereafter to Claim the same or any part or parcel thereof by from or under him them

or any of them shall & will Warrant & for ever Defend by these presents In Witness whereof the said Nicholas Ruxton Esq hath hereunto set his Hand & Affixed his Seal the Day Month & Year first above written.

Sealed & Delivered In the presence of
Jon^r Stowman
Benjamin Roges

Nuxton Gay

I Received the 27th Day of January 1769 of Charles Ridgely Junior Two hundred Pounds being the full Consideration of Money within mentioned.

£200

Witness present

Jon: Cowman

Nicholas Ruxton Gay

WITNESSETH that on the 20th Day of January 1769. Before us the Subscriber Two of his Lordships Justices of the Peace in & for the County of Baltimore Came Nicholas Ruxton Gay party to the within Indenture of Bargain & Sale who Acknowledged the same to be his Act and Deed according to the True Intent & meaning thereof And the Land therein mentioned to be bargained & sold with the Appurtenances to be the Right Title Estate & Property of the within named Charles Ridgely Junior his Heirs & Assigns Also Came Ann the Wife of the said Nicholas Ruxton Gay who being by us privately Examined apart from her said Husband did Acknowledge all her Right of Dower to the within bargained parcel of Land & Premises to be the Right Title Property & Estate of the within named Charles Ridgely Junior his Heirs & Assigns for ever And at the same Time declared that she made such Acknowledgment of her own free & Voluntary Will & Accord without being thereto Compelled by any Fears Threats or other ill usage of her said Husband or through fear of his Displeasure or any other means whatsoever

Jon: Cowman
Benjamin Rogers

Received 28 January 1769.
Four Shillings Sterling
Alienation Fine on the
within Land for the use
of Lord Baltimore by
order of Dan: of St. Thomas
Jonison Esq.

Dan: Cowley

Deed
Nicholas Ruxton Gay
to
Charles Ridgely Jr.

100 Acres part of The
Isthmus of Darien.

Rec: to be recorded this 6th
Day of Feb: 1769 and then invol-
uted among the Land Records of
Baltimore County Court in
Lib. A.L. N. A. fol. 12. 8^{co}
and Examined by Lawson

√ 5
Wm Young
to
N. Gay —

Received Ath November 175,
to be recorded (Duty paid)
and then Recorded in Libro
B N. G folio 77 & 78 and
Examined by
Wm Cordley Ck of Balt
County Court

Maryland to wit. This Indenture made this Third Day of Nov^r in the Year of our Lord Seventeen
hundred and fifty seven Between Colonel William Young of Baltimore County in the Province of
Maryland of the one part and Nicholas Ruxton Gay of the same County and Province Gent. of the other
part Witnesseth That the said William Young for and in consideration of the Sum of
Two Hundred & Ten pounds Sterling Money ——— to him in hand paid by
the said Nicholas Ruxton Gay before the Insealing and Delivery of these Presents the Receipt whereof the said
William Young doth hereby acknowledge and therefrom and every part thereof doth for ever acquit and
discharge the said Nicholas Ruxton Gay Hath given granted bargained and sold and by these Presents
Doth give grant bargain and sell unto the said Nicholas Ruxton Gay all his the said William Young's
Right Title and Interest in and to a certain Tract or parcel of Land called Jones's Range lying in Balti-
more County in Patuxent Neck containing four hundred Acres taken up by the said William Young by a
special Warrant of Resurvey and patented to him accordingly as by the Patent bearing date the Twenty
fourth Day of May Seventeen hundred and fifty four may appear. To have and to hold the said bargained
and sold Premises with all and every Privilege and Advantage thereto belonging which the said William
Young by Virtue of the Patent aforesaid have any Right to unto the said Nicholas Ruxton Gay his
Heirs and Assigns for ever. And the said William Young his Heirs and Assigns the aforesaid bargained
and sold Premises unto him the said Nicholas Ruxton Gay his Heirs and Assigns for ever against
all and every Person or Persons whatsoever claiming by from or under him the said William Young
or his Heirs or by their Means or Procurement shall and will warrant and defend by these Presents
In Witness whereof the said William Young hath hereunto set his Hand and Seal the Day
and Year first above written.

W. Young

Sealed & Delivered,
In Presence of us,
D. Chamusca
The Seller

Recd the sum of Two Hundred and Ten Pounds Sterling being the consideration for the within mentioned Land.

Wm. D. Chambers
Chas. Folger

Received November 3rd 1757 Justice Shallice's Ballinacree County Nov. 3rd 1757
Meriting Alienation money for 400 Acres
the within Land for the use of his Lordships
by order of his Lord's Agent
John McCaul Junr

The within Named William Young Acknowledged
The within said and the land and premises -
to the Right wife of the within named Nicholas
Nixon Gay: and Likewyse Elizabeth Young wife
of the said William being Examined apart from
her said Husband Acknowledged that she relinquish
all her Right of Dower of the within Land: and
that she did the same Voluntarily without
being Compell'd thereto by her said Husband or
any Oppression of his His pleasure
John Hall

Received A. H. November 1757
to the Records (Out of Hand)
B. N. G. 1757 p. 70 and
Examined by
Wm. D. Chambers
Chas. Folger
County of Ballinacree

Wm Young
15
Nixon

Plat of
Goodwin's Row
Roberts & Hill's Land

Err 95

127-5-32
 1803-32
 Martin Solo I. Meant
 See report of Sales from
 9 Apr 1839 for 1500
 11 whole parcels many
 parcels

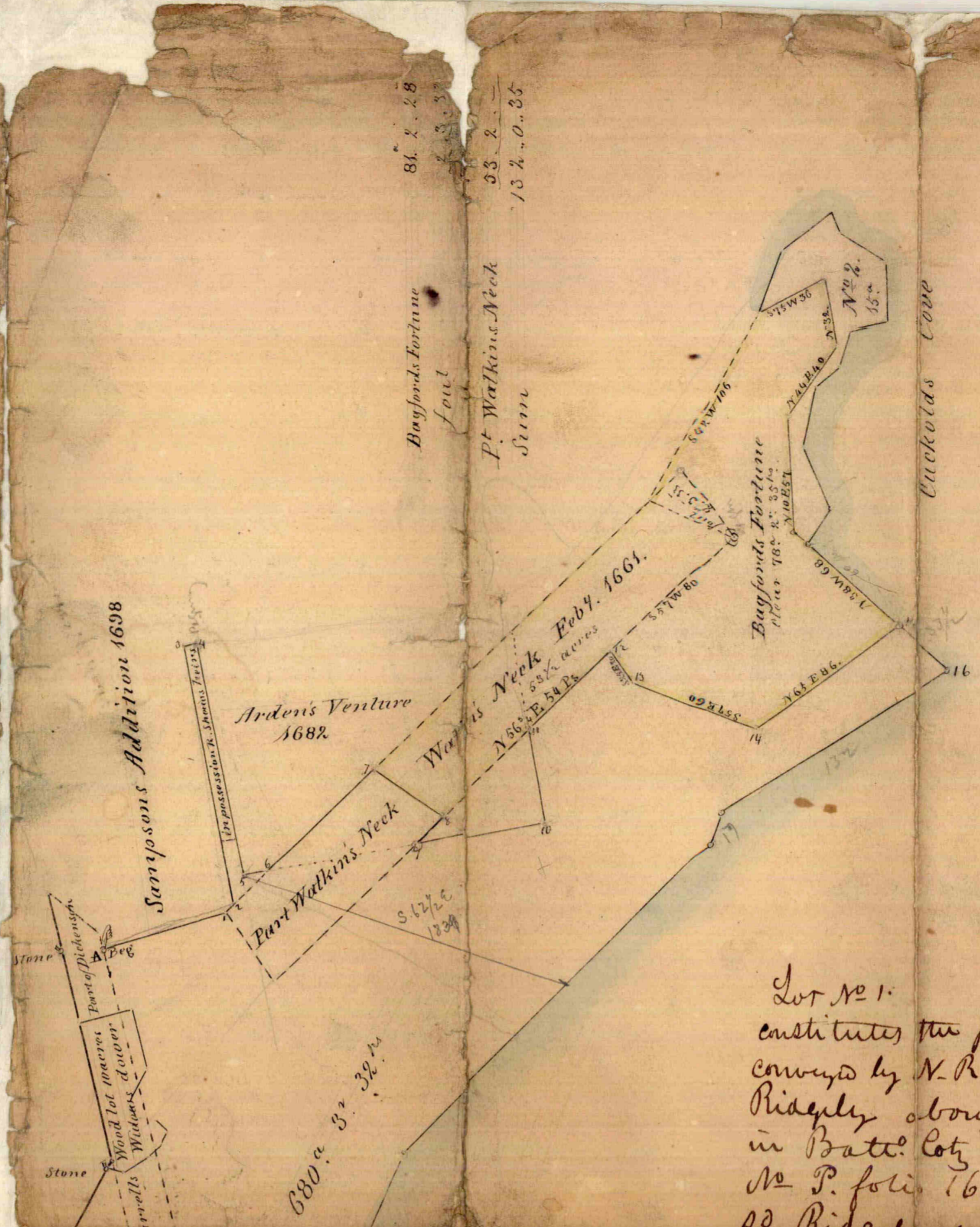

81 x 28
 Bayfords Fortine
 Part
 Pt. Walkins Neck
 33 x 2
 13 1/2 x 0.35

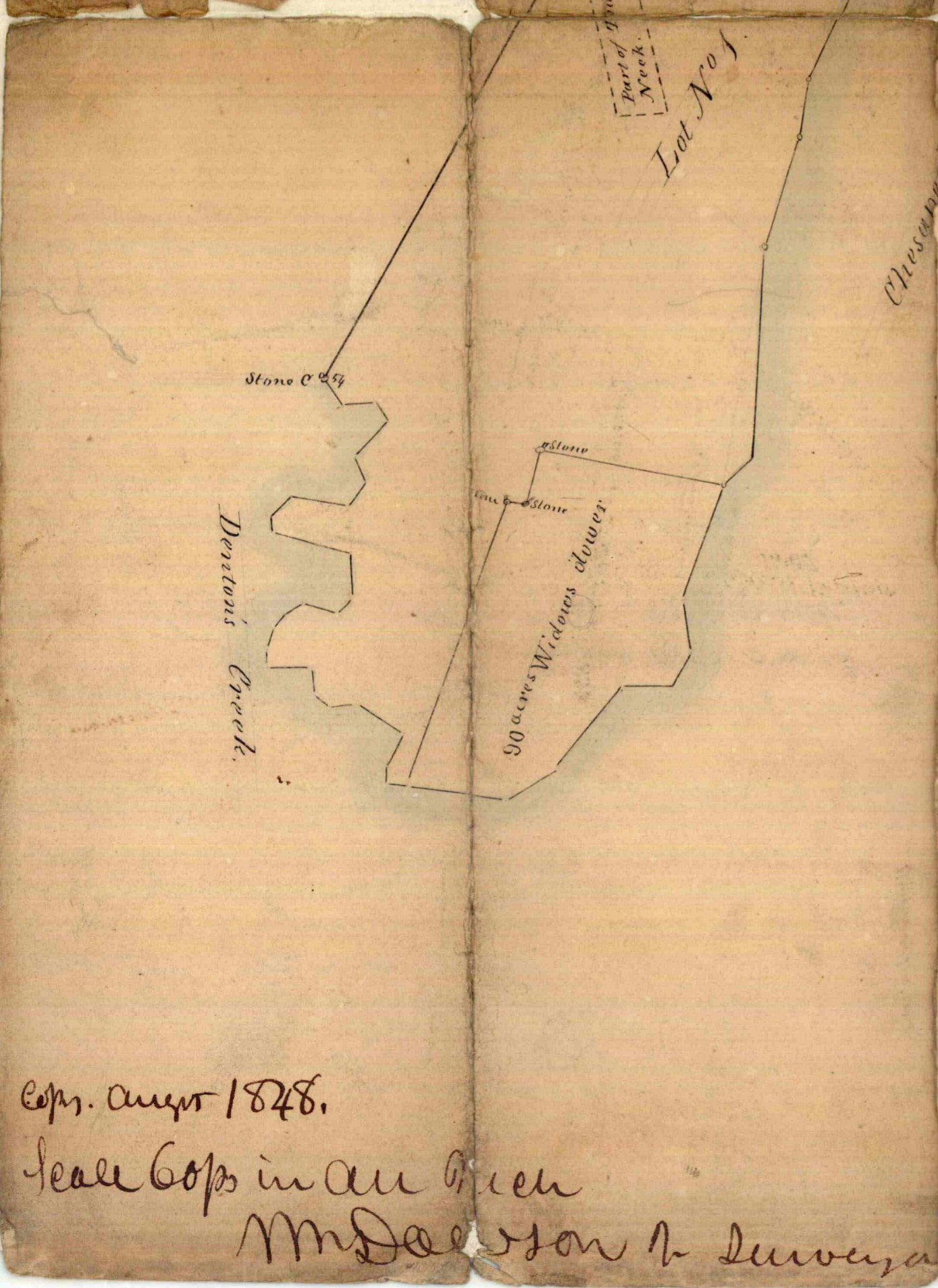

Lot No 1.
 constitutes the property that was
 conveyed by N. R. Goy to Charles
 Ridgely about 1765 of record
 in Batt. Co. in Lib. B.
 No. P. folio 164 &c. The
 sd. Ridgely devised the same
 to Lyde Goodum together
 with the land called Clap Pos=
 =ture.

Lyde Goodum died in the
 year 1836 leaving a widow
 & 12 Children
 Wm Goodum one of the heirs
 filed his petition for a division
 of the property. The Commis=
 =sioners lay off the widows
 dower in 2 parcels of 10^{ac} & 90^{ac}
 in all 100^{ac} - and state that the

property is not capable of further divi=
 sion. return 26th June 1837.
 from Record Baltimore County Court

Goodum vs. Goodum } in Baltimore County
 Court in Equity
 Proglenn appointed trustee to make
 sale of the property.

Cops. Aug 1848.
 Seal Cops in all such
 M. Deason & Surveyor

Plan of the Grounds to be
conveyed by Messrs. Tatters
&
Crosland

*Courses of Part of Wall Town and Shavers Mt Cole
conveyed by the Messrs Trotters to Mr Townsend*

*Beginning for the same at a stone planted by John E. Howard, Thomas Hillen,
and Josias Green Referees appointed by Dr. Stewart and the Messrs Trotters as the
end of the first line of Wall Town and running thence bounding on said line fixed*

Begin as afterward

1	S 47 1/2 E	172 1/2 ps	to stone then
2	S 16 1/2 E	27 ps	to the head of above of Madaways creek then running

and bounding on said creek the following courses

3	N 27 1/2 E	4 ps
4	S 17 1/2 W	11 ps
5	S 35 1/2 W	3 ps
6	S 75 W	7 ps
7	S 57 1/2 E	9 ps
8	S 26 W	7 ps
9	S 37 W	12 ps
10	S 28 1/2 E	4 ps
11	S 12 E	8 ps
12	N 81 E	2 ps
13	N 18 E	8 ps
14	N 57 E	8 ps
15	N 88 1/2 E	2 ps
16	N 42 E	4 ps
17	S 74 1/2 E	3 ps
18	S 56 E	5.6 ps
19	N 23 W	10 ps
20	N 46 1/2 E	5 ps
21	S 79 E	4 ps
22	S 56 1/2 E	11 ps
23	N 70 E	8 ps
24	S 75 E	14 ps
25	N 86 1/2 E	18 ps
26	S 61 E	18 ps
27	S 44 E	6 ps
28	S 30 1/2 W	20 ps
29	S 66 W	14 ps
30	S 77 1/2 W	8 ps
31	N 56 W	11 ps
32	S 50 W	8 ps
33	S 20 1/2 W	8 ps
34	S 10 1/2 E	8 ps
35	S 42 W	8 ps
36	S 67 W	6 ps
37	N 55 1/2 W	4 ps
38	S 4 W	6.5 ps

*and Josias Green as the end of the first line of the same from Town to Trotters, thence reversing
said line and bounding thereon -*

of the land conveyed as aforesaid

39	S 87 1/2 W	153 ps	to stone planted by the above named persons as being the beginning
----	------------	--------	--

of said tract, then running and bounding on the Waters of the upper cypress creek the following courses

40	N 74 1/2 W	16 ps
41	N 67 1/2 W	56 ps
42	N 66 W	36 ps
43	N 15 W	12 ps
44	N 62 E	12 ps
45	N 65 1/2 E	14 ps
46	N 71 E	15 ps
47	N 53 E	10 ps
48	N 64 E	16 ps
49	N 46 1/2 E	20 ps
50	N 53 1/2 E	10 ps
51	N 69 E	14 ps
52	N 4 E	30 ps
53	S 88 E	21 ps
54	N 75 E	12 ps
55	N 62 W	48 ps
56	N 25 W	4 ps
57	N 72 W	2 ps
58	S 26 W	10 ps
59	S 65 W	16 ps
60	S 3 E	2 ps
61	S 78 1/2 W	14 ps
62	N 77 W	8 ps
63	N 7 E	34 ps
64	N 5 E	46 ps
65	N 18 E	10 ps

*Beginning bounding on the Waters of the upper cypress creek and thence by a straight line to the place of
of Land under a cypress*

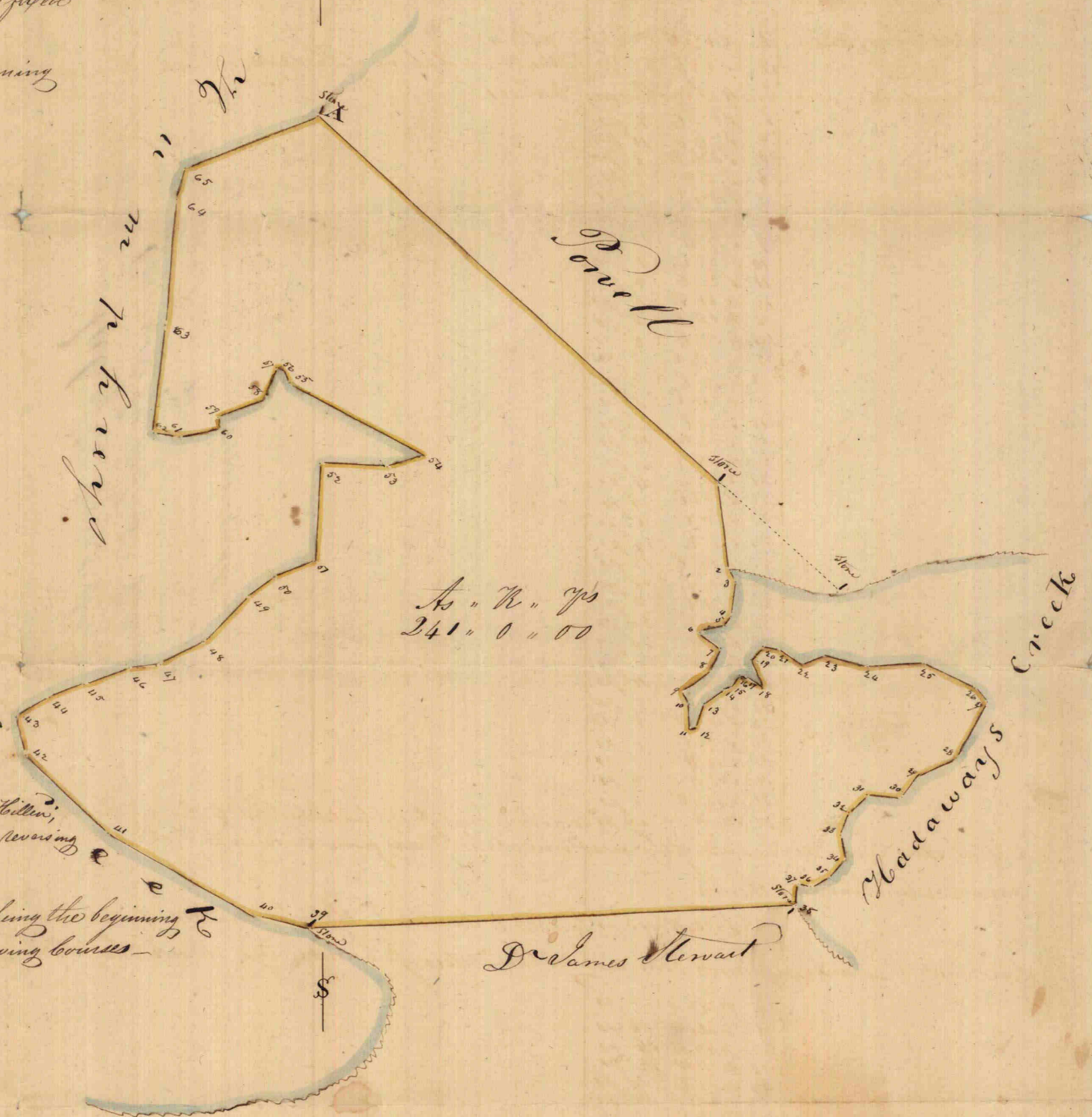

*As "N" cyp
341 " 0 " 00*

*172
27
199 1/2
99 3/4*

*Scale of foppin an Creek
Surveyed March 21st 1830
Alex. J. Mountain M.C.*

Plat of Goodwins Land in Palapsoo Neck

242613.51 07/10

286 5
171 9
12033 00
9704
22290

242613.51 07/10

33
4480
2678
5158 00 102
2426
7000

2638.00
5.25
2117
1.88
1335
1.71
14.31

85
4219
100
1881
1619
81
42
100
18
51

Map of the Sands in Patapsco Neck

Belonging to the Heirs of
Lyde Goodwin (deceased)

And is composed of the following Tracts and Parts of Tracts of Land viz. Part of Watkins Neck, part of Thurrells Neck, Part of Dickinson Jones Range, the Addition of Quien Old Road better known as the angle the oblong and the tract of Land called Pasture

The tract called Pasture is distant from the rest and contains

The Remaining tracts contains in the whole and designated by yellow shades

The tract of Land called oblong containing 3.3.00 Lays chiefly between Ardens Adventure and Sampsons Addition and is in the possession of Mr. Richard Shawkins

A 16. 0. 04
180 3. 32
695. 3. 36



9. 1. 1
3. 3. 0
16. 1. 0
180 3. 32
695. 3. 36
181

Scale of 100 feet in an Inch
A. A. Boulton 1826