

Ivy Mill

22
—
0

Reisterstown Rd

Barker & Mallard

55

McClains Hills

" Folly

Williams Defence

Solomons Grove

Jones Contrivance

McClains Industry

Recovery

Cross's Chance

55

Jonas Contreras

Richard Griffes
Deed to
Edmund Howard Stockdale

Dated the 9th Jan^y 1809.
Recorded in Lib^r W^het^r 101 & C
70

For all that part of a Tract of Land called Jones's Contrivance lying and being in the County aforesaid which is contained within the metes bounds courses and Distances. to wit: Beginning for the part hereby bargained and sold at the end of twenty perches on the South Eighty five degrees West Sixty ps. line of the whole Tract of Land called Jones Contrivance and running thence bounding on the old lines of the whole tract the four following courses as run with an allowance of three Degrees for Variation viz. S 82° West; 40 ps. S 13° E. 60 ps S 58° E. 42 ps at 47° E. 1 perch and $\frac{3}{4}$ of a perch until it inter^s a line drawn S 6° 30' E. from the first place of Beginning then at 6° 30' W. reversing S. line to the 1st place of Beginning, containing and laid out for $16\frac{2}{3}$ acres of Land more or less.

Wm Whalen
Deed to
George Campbell

Dated 9th Oct 1822.
Recorded in Lib^r W^het^r N^o 165
581.

For all that part of the Tracts of Land called "Jones Contrivance" for 56 acres, "Stockdale abode" for 5 acres, "Cropes Chance" for 19 acres of Land more or less. & also a Mill, calculated for Merchant & Country work. Hales a Saw mill & all the land appertaining thereto & all the Buildings & improvements thereto belonging the whole being devised to Edward Griffes afores^d by the Will of Rich^d Griffes as by said Will duly Recorded in Lib^r W^het^r N^o 101. Page 137. One of the Registered Books of Ball & Co for Recording Wills

Thomas Jones
Deed to
Richard Griffes

Dated 27th January 1801.
Recorded in Lib^r W^het^r 67 folio 311 & C.

For all that part of a Tract of Land lying & being in the County afores^d called & known by the name of "Jones's Contrivance" which lies on the Western side of the Main Falls of Palapoco, containing by Estimation 72 acres of Land more or less. & C. & C.

John Parker, Esq^r

S. W. 1^a

Received 14 July 1849

A. J. Boucsein

| | | |
|----------------------------|--------------|------------------------------|
| | Cost | \$ 2.50 ^{cts} |
| Paid in Treas ^y | | |
| for tithing | | 24 |
| | <u>Paid,</u> | <u>\$ 2.74^{cts}</u> |

STATE OF MARYLAND, Sect:

WHEREAS *John Parker, of the City of Baltimore* ~~County~~, did set forth, that there was about the quantity of *One* - ACRE OF VACANT LAND, lying *partly in the County of Carroll and partly in Baltimore County, adjoining a tract of land called "Cross's Chance," and a tract called "Stockdale's Abode Resurveyed;"* = -

partly cultivated, by means whereof the same could not be affected by a COMMON WARRANT, he therefore required a SPECIAL WARRANT to affect and secure it, and that on return of a CERTIFICATE OF SURVEY thereof, he complying with all other requisites according to law, may obtain a GRANT thereon. *(he having paid to the Treasurer of the State, the sum of twenty four cents, caution for the same, as appears H^o.)* = -

George G. Brewer
Reg^r Land Off. Md.

LAY OUT, THEREFORE, AND CAREFULLY SURVEY, for, and in the name of him, the said *John Parker*, the aforesaid *One* - Acre of Vacant Land, be the same cultivated or otherwise, not running your lines within the lines of any former or more ancient survey, and return your CERTIFICATE OF SURVEY thereof, with the name of the place, the exact quantity therein contained, with the improvements thereon, (if any,) and the value of such improvements, on oath, to the EXAMINER GENERAL, for due examination, within one year from the date hereof, thence to be transmitted to the LAND OFFICE, and for your so doing this shall be your sufficient WARRANT AND AUTHORITY.

Given under the Seal of Office, this *12th*, day of *July*, 1849,
To the SURVEYOR of *Baltimore* County,

~~Am~~ Bolder

Surveyor for Pratt County

Pratt

May 27. N 1859

Dr Sir I have been informed that
you are expected to run the lines for Mr
Barker one day next week - now this is to
say to you that, owing to some business
that I have to attend to in Wash^{ton} next
Wednesday will prevent my being present
I therefore desire that you will post
pone the hurry till Monday next following

Respectfully

Yours. J. S. [unclear]

Comfort Tiffany Esq

Small Neighbors

Tiffany & Durall Esq
Baltimore Company

Stamphell Company
Smith Company
Carpenter Comp

Samuel Carroll - Hingham

Courses of
"Cross's Chance,"

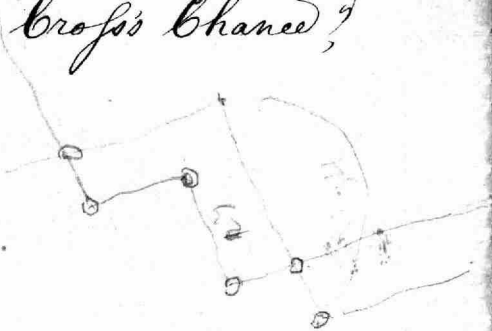

| | | | |
|---------------|-----------|----|----------------|
| | Cost | 40 | ^{cts} |
| Postage paid, | - - - | 5 | |
| paid, | <u>\$</u> | 45 | ^{cts} |

"Cross's Chance," surveyed for Robert Cross, the 18th, day
of February, 1766, and patented to him the 18th, day of October,
1766. —

Lying in Patterson County, Beginning at
three bounded White Oak trees, being the beginning of a tract of
land called "Jones's Contrivance," and running thence N. 30° E. 64 ft.,
S. 75° E. 36 ft., S. 33° W. 17 ft., S. 10° E. 14 ft., S. 16° W. 16
ft., S. 30° W. 35 ft., and thence with a straight line to the
Beginning, containing, and laid out for 19 acres of land more
or less, —

See Extract from Liber B. C. & G. S. No. 29 folio 459. —
Test,

George G. Brewer,
Reg^l Land Off. Md.,

Tring Plot of
M. Mallalues Land
Crosses Channel &
Ivy Factory

— " —



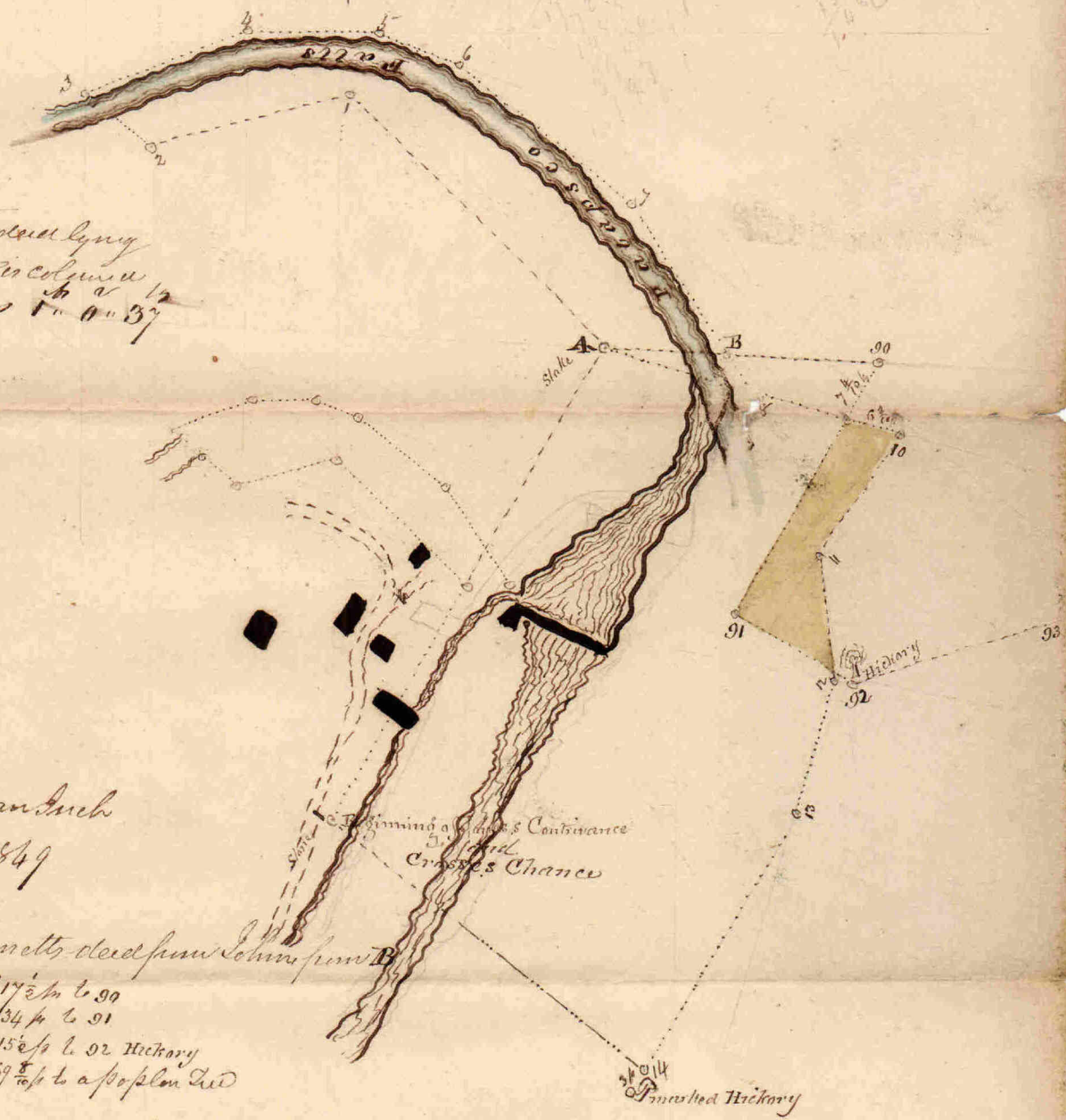

The part of Mr Bennett's dead line
 part of Jones's Chance in column
 yellow and contains 1st 0th 37

Scale of 20 paces to an inch
 Surveyed July 6th 1849

Boundaries of Bennett's dead line from Column point B

- 187³/₄ E 17¹/₂ p to 90
- 239²/₄ W 34¹/₄ p to 91
- 150 E 15¹/₂ p to 92 Hickory
- 172³/₄ E 69¹/₂ p to a Poplar tree

The dead line of Hodge to Shaffer the 13th of March 1777 begins at A and runs on Jones's Containment
 as runs north with 1 degree allowance for variation

- N 46 W 42¹/₂ p
- S 74 W 24¹/₂ p then corner and distance
- N 50 W 9¹/₂ p to the N side of the falls then
- N 68 E 20¹/₂ p
- N 89 E 13¹/₂ p
- S 70 E 10¹/₂ p
- S 52 E 26¹/₂ p
- S 33 E 27¹/₂ p
- then to A

- Crosses Chance from the begining of
 Jones's Containment on
- 1 N 29 E 64¹/₂ p then corner and distance
 - 2 S 75 E 36¹/₂ p to 10
 - 3 S 33 W 17¹/₂ p to 11
 - 4 S 10 E 14¹/₂ p to 12
 - 5 S 16 W 14¹/₂ p to 13
 - 6 S 30 W 33¹/₂ p to 14 then to the begining
 of Jones's Containment

you Joseph Dineen and
 James Miller Do severally
 make oath on the Holy Evan-
 gely of Almighty God that
 you will carefully perform
 the duty assigned you as
 Chain carriers and give
 a true account of the out
 to help your Lodges
 George Miller poleman

McLains Hills granted
 John McLain 7th Sept 1765
 Beginning at 2 bounded
 by standing on a Hill near
 arm called Timber run
 and running

- | | |
|--------------|---------------|
| N 76° W | 112 to 16 1/2 |
| N 50 to 26 W | 132 to 26 1/4 |
| N 60 to 58 W | 162 to 58 1/2 |
| N 60 to 58 W | 148 to 40 1/4 |
| S 50 to 40 W | 220 E 18 1/4 |
| S 18 E 18 W | 152 E 20 1/4 |
| S 50 E 20 W | 182 E 50 1/2 |

by a straight line to
 beginning Cont 3 25
 more or less 1/2 Oct 18 1/2

MacLains Holly granted
 John McClain 20th February
 1743 Survey 20 Feb 1743 Begⁿ at
 2 bounded 100 standing on a
 hill side near the Northern
 fork of the great Falls of
 Potapoco River and on the
 East side of the said Falls
 and near a run called timber
 run by the side of a small
 branch running into the Falls
 and on the south side of a
 tract of Land called Sonson-
 trivance and running thence

- | | |
|--------------------------|---------------------------|
| 1139 E 40 p ⁿ | 1137 E 40 p ⁿ |
| 1177 E 60 p ⁿ | 1175 E 60 p ⁿ |
| 1170 E 40 p ⁿ | 1174 E 40 p ⁿ |
| 1129 E 34 p ⁿ | 1131 E 34 p ⁿ |
| 1133 W 36 p ⁿ | 1133 to 36 p ⁿ |
| 1182 W 81 p ⁿ | 1180 to 81 p ⁿ |

by a straight line to the begⁿ
 containing 30 acres more or less

Patent Lib^r P^t W¹ folio
 184

Williams Defence

Patented to William Baziana
 24th December 1744 Beginning
 at 2 small bounded white and
 one bounded red and 1/2 the
 north of a small
 Draught

Draught descending into a run call
 Timber run and running thence

- 1 1100 W 20 pⁿ
- 2 1165 W 66 pⁿ
- 3 1173 W 72 pⁿ
- 4 1128 W 45 pⁿ
- 5 1186 W 30 pⁿ
- 6 1170 W 17 1/2 pⁿ
- 7 1134 W 126 pⁿ
- 8 1114 W 64 pⁿ
- 9 1118 E 90 pⁿ
- 10 South 92 pⁿ
- 11 1167 E 33 pⁿ
- 12 115 E 132 pⁿ
- 13 1143 W 62 pⁿ
- 14 1115 W 50 pⁿ
- 15 1114 E 24 pⁿ
- 16 1129 E 34 pⁿ
- 17 1165 E 80 pⁿ
- 18 1111 W 86 pⁿ
- 19 1170 E 127 pⁿ
- 20 1150 E 236 pⁿ

407

by a straight line to the begⁿ
 Contⁿ 213 acres of Land more
 or less Lib^r P^t W² folio 131

Solomon Groves

for Solomon Stockdale & the March
 1765 granted 8th March 1765 Begⁿ
 at the begⁿ trees of a tract of Land
 called MacLains (venture) and
 running thence

- 1 1150 W 18 pⁿ
- 2 1162 1/2 W 28 pⁿ

2 141 1/2 E 33 p
 160 E 38 p
 150 E 26 p
 163 3/4 E 23 p
 155 W 20 p
 110 W 44 p
 165 W 23 p

43 1/2 E 33 p
 162 E 58 p
 152 E 26 p
 161 1/4 E 23 p
 157 W 20 p
 112 W 44 p
 163 W 33 p

with straight line to the place
 of Beginning Cont^g 16 acres more
 or less Lib^o B^o of Ind^o No^o 27
 folio 474

Jones Controversance

Granted to Philip Jones 21st April
 1729 Beginning at 3 bounded
 white oaks standing on the south
 side of the main Falls of Yakop.
 200 and running

1 130 E 64 p 1129 E 64
 2 145 W 42 p 1146 W 42
 3 175 W 24 p 174 W 24
 4 150 W 62 p 1151 W 9 1/2
 5 120 W 30 p
 6 110 E 84 p
 7 West 42 p
 8 South 62 p
 9 115 E 48 p
 10 155 W 50 p
 11 150 E 108 p
 12 115 W 40 p
 13 185 W 60 p
 14 110 E 60 p
 15 153 E 42 p
 16 150 E 60 p
 17 170 E 80 p
 18 160 E 120

1050
 1050
 1050

19 140 E 120 p
 20 175 E 72 p
 21 130 W 94 p
 150 W 50 p
 South 64 p
 140 W 20 p
 150 W 94 p
 140 W 78 p

and thence
 with straight line to the beginning
 containing 250 acres more or less

Maclains Industry as
 surveyed for Agarack Maclain
 17th Septentris 1771 Beginning at
 the original place of Beginning
 and thence

139 E 40 p
 177 E 60 p
 170 E 40 p
 129 E 34 p
 135 W 36 p
 182 W 40 p

and thence
 by straight line to the beginning
 containing 45 acres all of which
 I find to lay within the lines of
 Elders survey And by virtue of
 the aforesaid warrant I have laid
 out 20 acres of vacant Land lying
 in one parcel Beginning at 2
 bounded white oaks they being the
 original beginning and running
 thence

161 W 50 p 1163 60 50
 130 E 10 p 1228 E 10
 172 E 28 p 1170 E 28 p
 155 E 14 p 157 E 14 p
 150 E 60 p 1148 E 60 p
 170 E 38 p 170 E 38

1117
23

2 1/2

then went to the head
end of N 87 3/4 E 17 1/2 S
line of the 69 ft line
and ran S 29 1/4 W 7 1/4 S
to the line of 75 E 36 S at
60 ft in sand

In the end of 14 ft line
ran S 86 E 2 ft to the
Hickory tree



Friday July 6th 1849 Began
at the blow the beginning
of Jones & Carver's line
ran N 29 E 64 ft
N 46 W 42 ft
S 74 W 24 ft
N 51 W 9.9 ft to the N side
of the faces at 5 1/2 ft side of
the faces then run down the
faces N 68 E 20 ft
N 89 E 15 ft
S 70 E 10 ft
S 52 E 26 ft
S 33 E 27 ft set up stake
then went to the stake set at
end of the 64 ft line and an
line of crosses chance

N 15 1/2 W 69 feet to the
N side of the faces
then
N 51 W 69 feet to the
the faces 69 feet to the
N side of the faces
about 4 feet N of the line
then went to the stake set at
end of the 64 ft line
N 69 E 20 ft
N 89 E 15 ft
S 70 E 10 ft
S 52 E 26 ft
S 33 E 27 ft
In the end of 27 ft line
then went to the stake set at
end of the 64 ft line
and ran S 75 E 36 ft at
11 ft the full about 60 feet
then

1117
23
 N 15 1/2 W 69 feet
 N 51 W 69 feet
 N 69 E 20 ft
 N 89 E 15 ft
 S 70 E 10 ft
 S 52 E 26 ft
 S 33 E 27 ft
 In the end of 27 ft line
 then went to the stake set at
 end of the 64 ft line
 and ran S 75 E 36 ft at
 11 ft the full about 60 feet
 then

N 15 1/2 W 69 feet
 N 51 W 69 feet
 N 69 E 20 ft
 N 89 E 15 ft
 S 70 E 10 ft
 S 52 E 26 ft
 S 33 E 27 ft
 In the end of 27 ft line
 then went to the stake set at
 end of the 64 ft line
 and ran S 75 E 36 ft at
 11 ft the full about 60 feet
 then
 N 140 W 28
 N 29 E 16 1/2
 64
 16 1/2

A 845 to 36 ft at 11 ft the W side
of the faces At 85 ft East side
of the faces at 36 ft line set above
then went to the Stake shown to
Mr Bennett as standing at the top
of the 87 1/4 to 17 1/2 ft line of the
Lined Curved by Mr Johns
where and ~~some~~ distance of
said line

829 1/4 to 7 1/4 ft entered at
the 36 ft line at 6 7/8 ft from the
end of said line
Then went to the Stake set at
end of 36 ft line and Centered
the lines of Crosser Channel

833 to 17 ft
850 to 14 ft the Hooking called
for at end of the 860 to 15 1/2 ft line
of the Lined Curved by Johns to
Bennett stands 886 to 17

816 to 16 1/2
830 to 38 ft to an old center
Hooking said by Mr Mallard
to have been the repeated Center
of one Lined circle top of
of Crosser Channel

W^o Modge }
To }
Richarda Gaffer }

Deed Date this 15th day
of March 1777

For all that part of a tract or parcel of Land
Called Stockdale above described situate
lying and being in Baltimore County & province
aforesaid on the Main Falls of Patapsco River
beginning for the part hereby Bargained and
Sold at the end of the first line of a tract
of Land Called Jones Contiguance and
Running thence with & bounding on the said
Land the three following Courses N. W. 42 p.
South 75. N. 24 p. S. 50. N. 9 p. untill it
crosses the aforesaid Main falls of Patapsco
River and Running thence bounding on the East
side of said Falls N. 68. E. 20 p. S. 89. E. 15 p.
then South 70. E. 10 p. S. 52. E. 26 p. then S. 33.
E. 27 p. & thence by a straight line to the beginning
Containing & laid out for five acres & an half
acre & 30 perches of Land more or less

Extract taken from Liber
W. G. N. A. Folio 1 &c

South 19 p 1/2 E 10 1/2 p
 277 W 60 p and thence 1/2

by a straight line to the begining
 containing 23 acres more or less

See Extract from original
 Copy signed Geo W. Brown
 D. W. J. M. S.

Maclain Recovery a resurvey
 on 44 acres part of Maclain's Holly
 granted to Jaeharal Maclain 27
 November 1776 resurveyed 17th of April
 1772 Beginning at the origin
 Beginning and running thence

- 260 W 30 p 262 W 30 p
- North 10 p 262 W 10 p
- 285 E 20 p 283 E 20 p
- 285 E 32 p 287 E 32 p
- 23 N 18 p 25 W 18 p
- 250 E 47 p 243 E 47 p
- 270 E 40 p 272 E 40 p
- 27 E 24 p 29 E 24 p
- 270 E 40 p 272 E 40 p
- 229 E 34 p 231 E 34 p
- 235 W 36 p 233 W 36 p
- 282 W 40 p and thence

by a straight line to the place
 of Beginning containing 65th then
 more or less to patent

Isaac Mercer } Deeds dated
 Henry Miller } the 11th of April
 1824 for all that
 piece or parcel of land situated
 and being in Baltimore County
 being composed of the following
 tracts of land to wit Addition
 to Maclain's Hills Maclain's In-
 dustry Maclain's Holly and Maclain's
 Hills and contained within the
 following metes bounds courses
 and distances to wit Beginning at
 2 bounded stones instead of 2
 bounds to White Oaks and running
 thence

- 116 p
- 250 W 6 p
- 260 W 35 p
- 272 W 11 p
- 278 W 6 p
- 269 W 18 p
- 265 W 12 p
- met 14 p
- 232 W 22 p
- S. W. 8 p
- South 25 p
- 282 E 45 p
- 232 E 12 p
- 236 E 16 p
- South 11 p
- 270 E 106 p
- 286 E 30 p
- 228 E 45 p
- 275 E 72 p
- 265 E 60 p
- 240 W 20 p
- 228 E 20 p
- 252 W 66 p
- 235 E 24 p
- 210 E 21 p
- 266 E 38 p
- 230 W 79 p
- 270 W 50 p
- 248 W 16 p
- 24 E 20 p
- 280 W 28 p
- 285 W 24 p and
 thence to the begining
 containing 192 acres
 and 25 perches

Friday morning May 25th 1828

Began at the beginning of William
Defence and run the 6th first line of
said tract with an allowance of
2 degrees for variation

N46 W 20 P N42 W 20 P
N63 W 66 P N67 W 66 P
N75 W 72 P N77 W 72 P
N48 W 48 P N28 W 48 P
N86 W 30 P N88 W 30 P
N70 W 17 P N72 W 17 P

Then went to the beginning of
Maclains Hills & being also the
beginning of Addition to Maclain
Hills and running there

N20
North 16 P N12 W 16 P

N50 W 26 P N52 W 26 P

running the lines of Addition
to Maclain Hills

N9 P W 38 P N11 P W 38 P

N5 W 60 P N7 W 60 P

N68 W 19 P N70 W 19 P

S40 W 42 P S38 W 42 P

S58 W 100 P S56 W 100 P

S45 P E 95 P S43 P E 95 P

at 75 6 P the E side of the Falls
the falls 4 P wide

falls 2 P long right.

N68 P the Falls the N side of
at 20 P out of the track at
S145 P the Falls

After running the N62 W 58 P
line went to the beginning of
Solomons Grove at being the
beginning of Maclain's venture
and run the 2nd first line of
Solomons Grove

S50 W 18 P S48 W 18 P

N62 P W 28 P N64 P W 28

Then went to the end of the
N62 W 58 P line and run

N11 P W 38 P at 20 P
the

The stake at the end of the
N64 1/2 W 28 1/2 line of Adams
grove is N70 3/4 W 9.2 1/2 then

N7 W 60 1/2

N70 W 19 1/2

S38 W 42 1/2

S36 W 100 1/2

S43 1/2 E 95 1/2 1/2 to the stake

at the end of the 8th line of
Williams Defene then adjourned
Saturday morning commencing at
the beginning of Williams Defene
and run the lines of addition to
MacLaurin Hills with 2" allowance

S65 E 18 1/2 - N67 E 18 1/2

S16 E 66 1/2 - N18 E 66 1/2

East 70 1/2 - N88 E 70 1/2

N18 E 92 1/2 - N16 E 92 1/2

N35 W 26 1/2 - N37 W 26 1/2

N46 E 110 1/2 - N44 E 110 1/2

N27 E 96 1/2 - N29 E 96 1/2

N39 E 78 1/2 - East 78 1/2 then

went to the beginning of Jones Contour
and run

S30 E

S28 E 100 1/2 to the end of

the 17th line of Jones Contour

then reversing the 17th line

N70 W 80 1/2 - N72 W 80 1/2

N50 W 60 1/2 - S48 W 60 1/2 at 141 1/2

N65 W 42 1/2 - N67 W 42 1/2

N10 W 68 1/2 - N12 W 60 1/2

N85 E 60 1/2 - N83 E 60 1/2

N18 E 40 1/2 - N16 E 40 1/2

N50 W 108 1/2 - N52 W 108 1/2

N55 E 50 1/2 - N45 E 50 1/2

N15 W 48 1/2 - N17 W 48 1/2

North 62 1/2 - S12 W 62 1/2

East 42 1/2 - N88 E 42 1/2

S10 W 84 1/2 - S12 W 84 1/2

S20 E 30 1/2 - S22 E 30 1/2

S50 E 62 1/2 - S48 E 62 1/2 at 50 1/2

N75 E 24 1/2 - N73 E 24 1/2

S45 E 42 1/2 - S47 E 42

S50 W 64 1/2 - S28 W 64 1/2 then run

N36 1/4 W 5.3 1/2 to the beg of
Jones Contour and

at 4 1/2 the falls at 8 1/2 cup the trees

the falls at 34 1/2 across the falls
at 58 1/2 partially 2 1/2 to the east

Monday Morning commenced at
the end of the 17th line of Jones
Continued it being also the end
of the N30 W 120th line of Ad-
dition to MacLaurin Hills and on

N70 W 38th N72 W 38th
S 12th E 19th then reversed the
S70 E 40th S72 E 40th
S29 E 34th S31 E 34th
S35 W 36th S33 W 36th
S82 W 40th S80 W 40th
N74 W 85th N76 W 85th which ends
the beginning of MacLaurin Holly

1st line of Holly N77 E 60th S75 E 60th
N39 E 40th S77 W 50th

To the spot said to be the beg^g of
MacLaurin Holly then run N63 W
44th 4th to the beg^g of MacLaurin
Hills then went to the end of
the S2 E 19th line and run the
courses of addition to McElaun
Hills

S72 W 40th

S31 E 34th

S33 W 36th

S80 W 40th

N75 W 85th which ends

N51th E 30th 1st from the end of the
3rd line of MacLaurin defended
then run N83th E 11th 1st to the beg^g
of MacLaurin Holly

Tuesday morning commenced at
the stake at the end of the
N11th W 38th line of addition
to MacLaurin Hills and runs
the two first lines of McElaun
venture N42th E 63th E 28th
N48 E 15th

on the 147 E 42 line run
38 then run the 150 to 64

49.6
5.8
55.4
62
6.8

M65 No 6 1/4

~~128 E 2.8~~ 1/4 90
62 152 E

128 E 10, 2 38

162 No 4 1/4

148 1/2 E 1/3

28
20 1/2 52
19
33

10 30
10.24
20 54
10 27

M73 E

100
89.8
10.2
100.0

M52 No 2 6 1/4

12.8
38.8

108.8
38.8
69.2